

Beveridge Williams
development & environment consultants

Melbourne ph : 03 9528 4444

Ref: M3830/6A
M3830-S6A-BE-V6.dwg Page 1 of 3

Notations:

1. The Building Envelopes on this plan are shown enclosed by continuous thick lines.
2. This diagram is to be read in conjunction with "Profile Diagrams" in this document.
3. Profile types (A), (B), (C), (D), (E), (F), (G), (H), (I), (J), (K), (L), (R), (S) & (T) are contained in "Profile Diagrams" in this document.

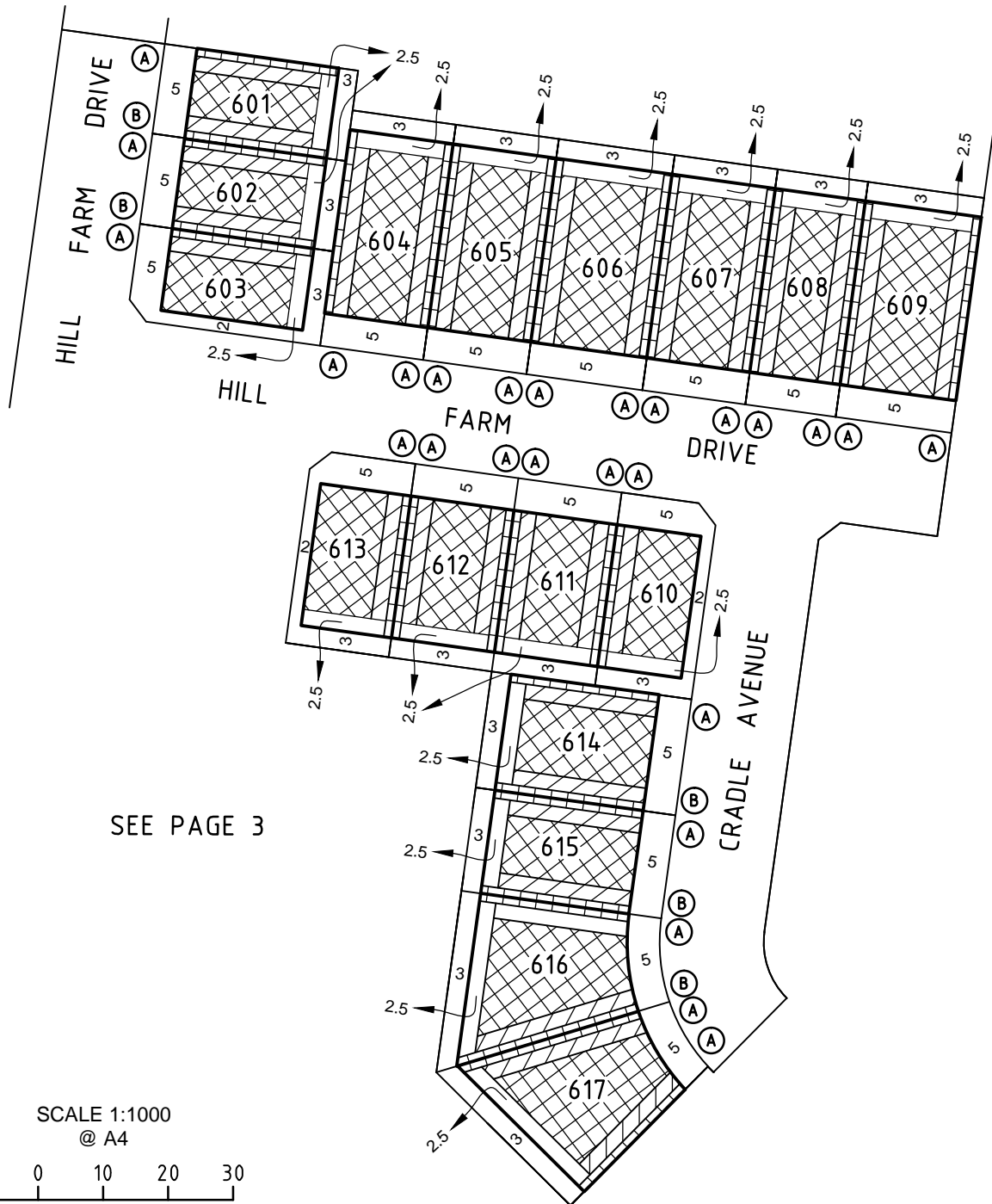

SEE PAGE 3

SCALE 1:1000
@ A4

10 0 10 20 30

LENGTHS ARE IN METRES



4 April 2013



Beveridge Williams
development & environment consultants

Melbourne ph : 03 9528 4444

Notations:

1. The Building Envelopes on this plan are shown enclosed by continuous thick lines.
2. This diagram is to be read in conjunction with "Profile Diagrams" in this document.
3. Profile types (A), (B), (C), (D), (E), (F), (G), (H), (I), (J), (K), (L), (R), (S) & (T) are contained in "Profile Diagrams" in this document.

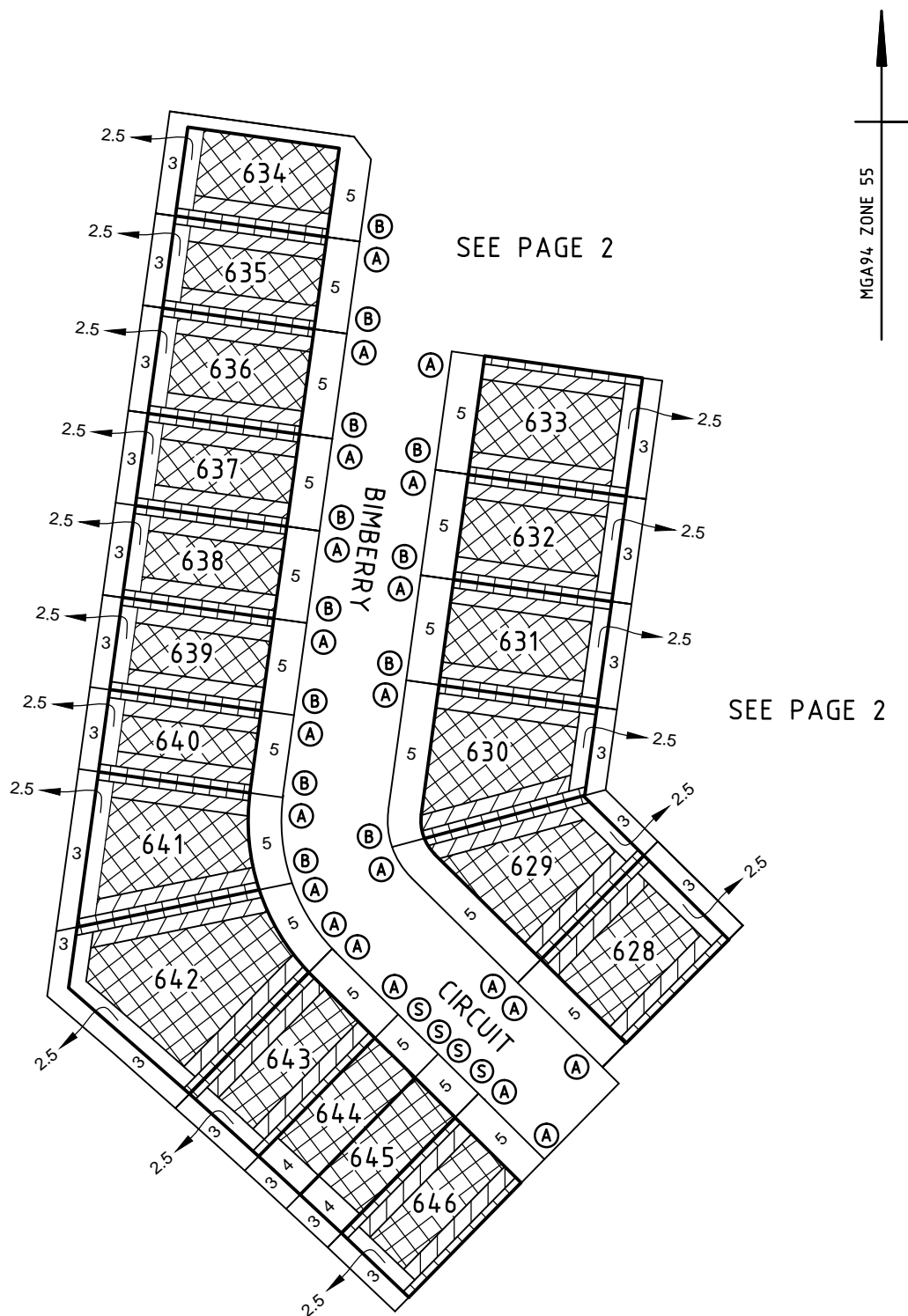

4 April 2013

SCALE 1:1000
@ A4

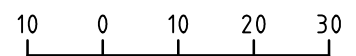

LENGTHS ARE IN METRES



Beveridge Williams
development & environment consultants

Melbourne ph : 03 9528 4444

Notations:

1. The Building Envelopes on this plan are shown enclosed by continuous thick lines.
2. This diagram is to be read in conjunction with "Profile Diagrams" in this document.
3. Profile types (A), (B), (C), (D), (E), (F), (G), (H), (I), (J), (K), (L), (R), (S) & (T) are contained in "Profile Diagrams" in this document.