

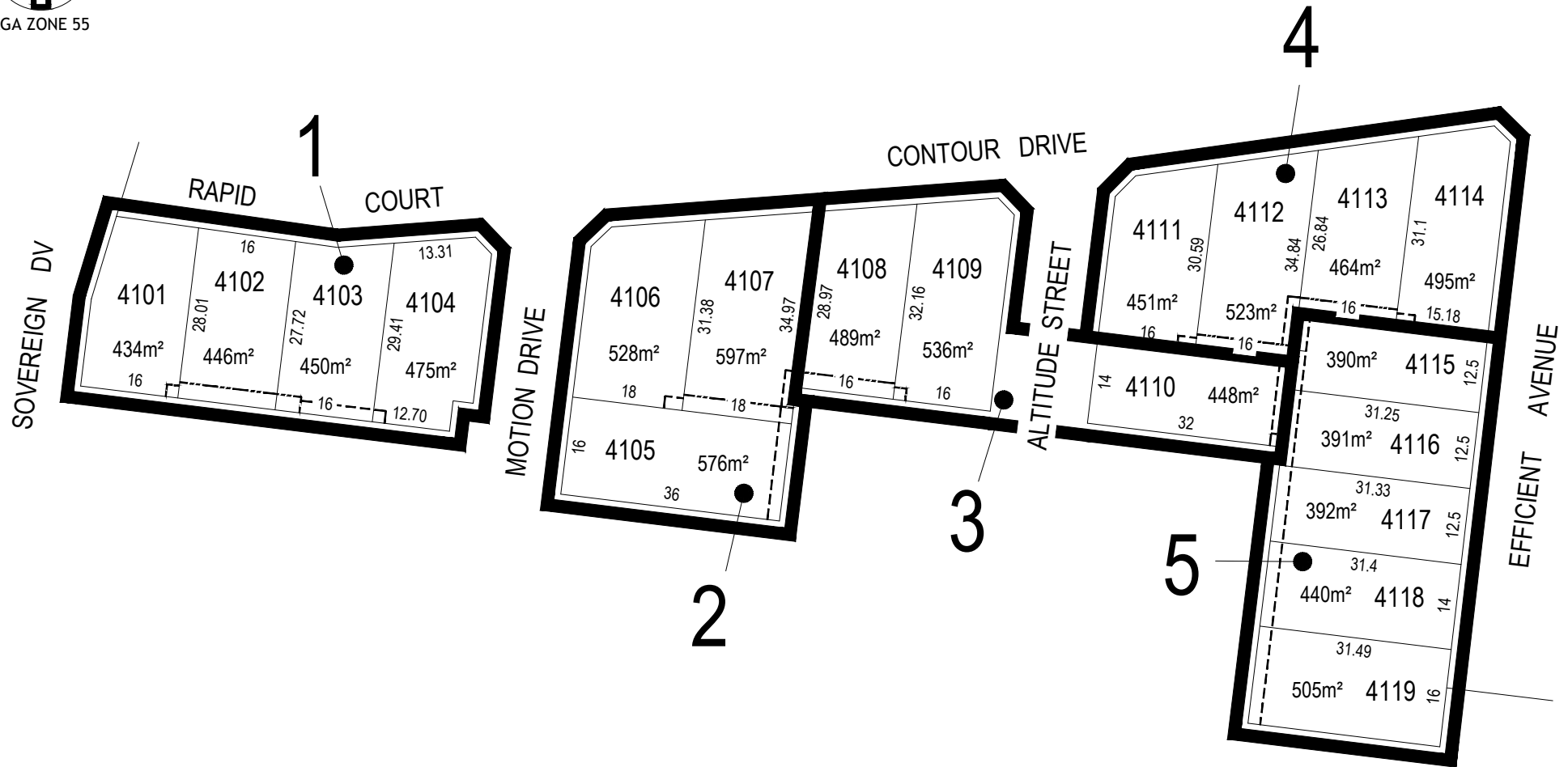

MGA ZONE 55



KEY TO SHEETS

REFER TO SHEETS
1 TO 6
FOR DETAIL

ARMSTRONG Mt DUNED



BUILDING ENVELOPE PLAN
STAGE 41

August 2017
Version:A

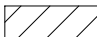

MGA ZONE 55

NOTATIONS

-  Single Storey Building Envelope (height not exceeding 3.6m)
-  Overlooking Zone - Habitable room windows/raised open spaces are a source of overlooking
-  Non Overlooking Zone - Habitable room windows/raised open spaces are not a source of overlooking
-  Building to Boundary Zone

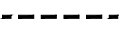
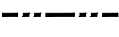
-  Building Envelope Boundary Profile Type
-  2 metre wide easement
-  3 metre wide easement
- 4105** Lot number
- 3** Setback minimum required (if 0, a building can be constructed on the boundary provided that the building height and length requirements are met)

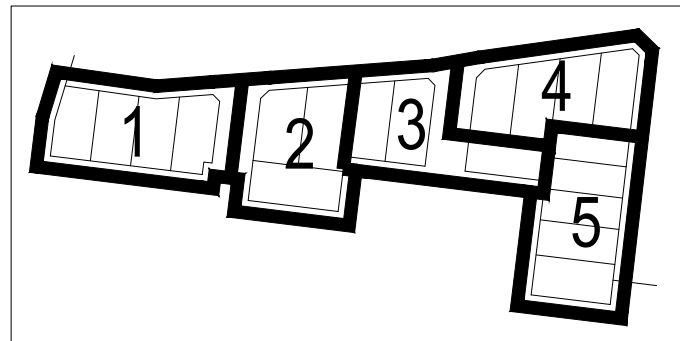
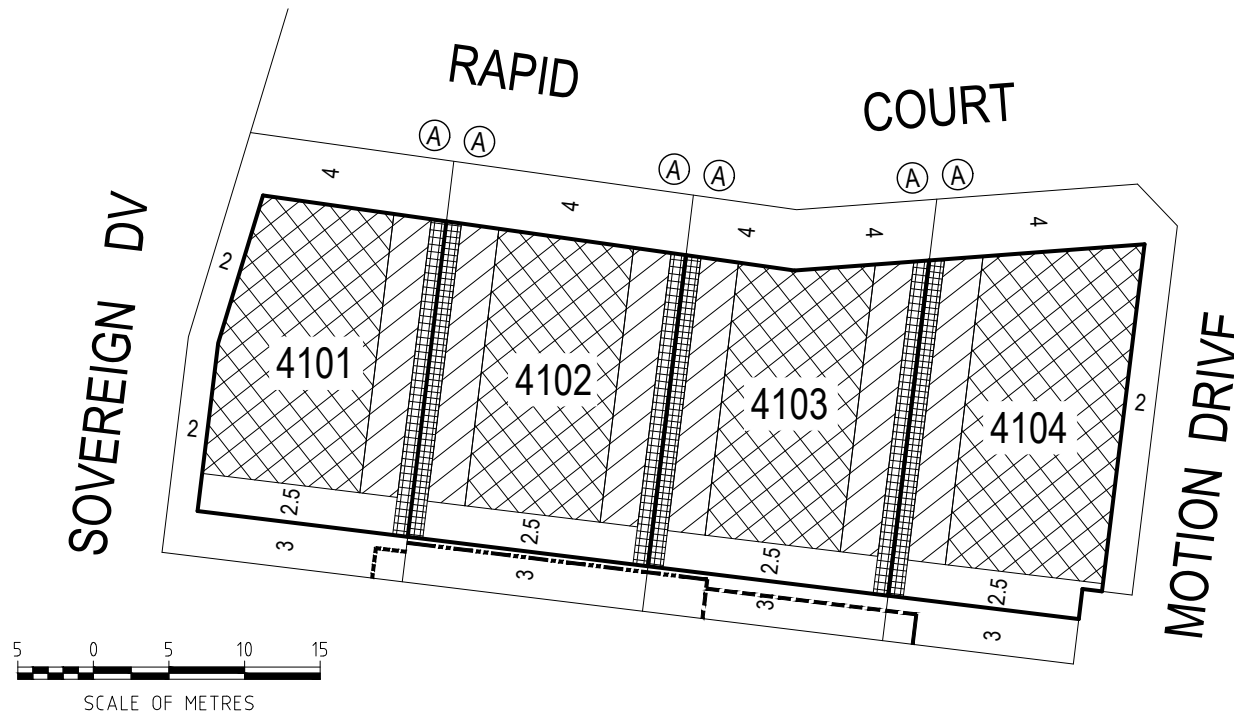

KEY TO SHEETS

This Building Envelope Plan is to be read in conjunction with the associated Building Envelope Profiles and Design Guidelines.

The registered proprietor/s of the lot are required to build in accordance with building envelopes shown hereon and in the "Profile Diagrams" in sheet 6.

Detailed design of roads, driveways and footpaths is provided in the relevant Engineering Plans.

Detailed design of landscape works is provided in the relevant Landscape Plans.

All details subject to City of Greater Geelong Council approval.

ARMSTRONG Mt DUNED

**BUILDING ENVELOPE PLAN
STAGE 41**

41/1
stage sheet

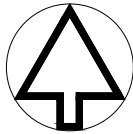

MGA ZONE 55

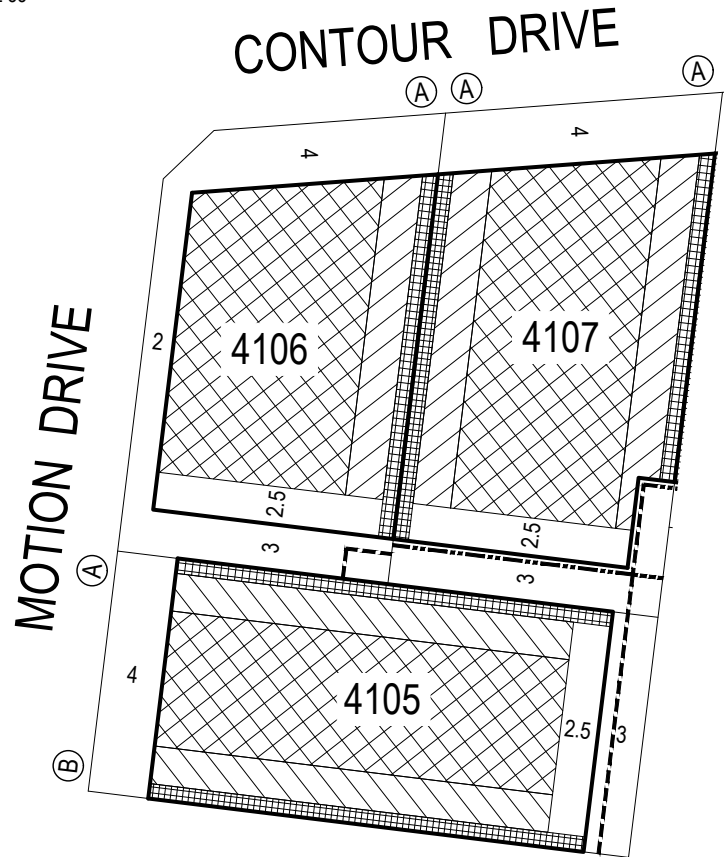

NOTATIONS

- Single Storey Building Envelope (height not exceeding 3.6m)
- Overlooking Zone - Habitable room windows/raised open spaces are a source of overlooking
- Non Overlooking Zone - Habitable room windows/raised open spaces are not a source of overlooking
- Building to Boundary Zone

- Building Envelope Boundary Profile Type
- 2 metre wide easement
- 3 metre wide easement
- 4105** Lot number
- 3** Setback minimum required (if 0, a building can be constructed on the boundary provided that the building height and length requirements are met)

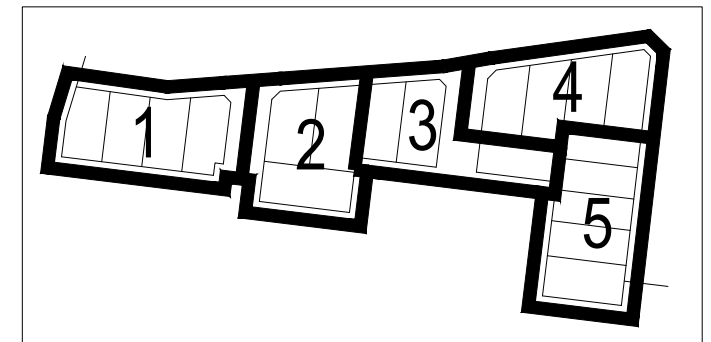

KEY TO SHEETS



This Building Envelope Plan is to be read in conjunction with the associated Building Envelope Profiles and Design Guidelines.

The registered proprietor/s of the lot are required to build in accordance with building envelopes shown hereon and in the "Profile Diagrams" in sheet 6.

Detailed design of roads, driveways and footpaths is provided in the relevant Engineering Plans.

Detailed design of landscape works is provided in the relevant Landscape Plans.

All details subject to City of Greater Geelong Council approval.

ARMSTRONG Mt DUNED

BUILDING ENVELOPE PLAN STAGE 41

41/2
stage sheet

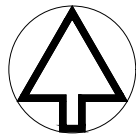

MGA ZONE 55

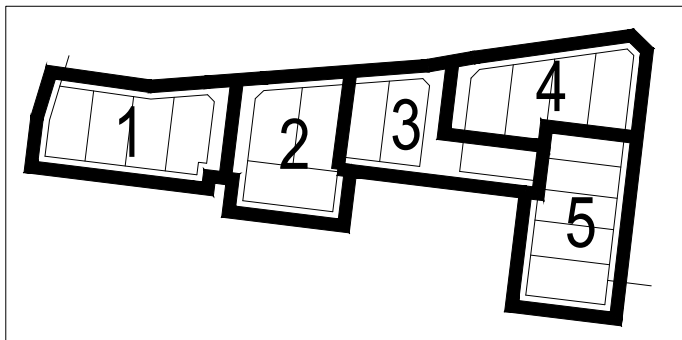

KEY TO SHEETS

This Building Envelope Plan is to be read in conjunction with the associated Building Envelope Profiles and Design Guidelines.

The registered proprietor/s of the lot are required to build in accordance with building envelopes shown hereon and in the "Profile Diagrams" in sheet 6.

Detailed design of roads, driveways and footpaths is provided in the relevant Engineering Plans.

Detailed design of landscape works is provided in the relevant Landscape Plans.

All details subject to City of Greater Geelong Council approval.

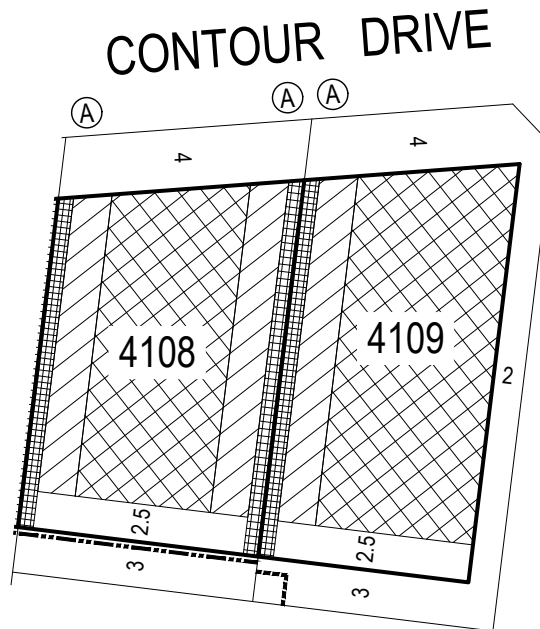



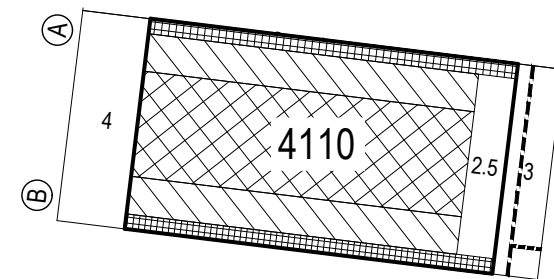



ALTITUDE STREET

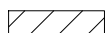

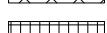
SCALE OF METRES

NOTATIONS

-  Single Storey Building Envelope (height not exceeding 3.6m)
-  Overlooking Zone - Habitable room windows/raised open spaces are a source of overlooking
-  Non Overlooking Zone - Habitable room windows/raised open spaces are not a source of overlooking
-  Building to Boundary Zone

-  Building Envelope Boundary Profile Type
-  2 metre wide easement
-  3 metre wide easement
- 4105** Lot number
- 3** Setback minimum required (if 0, a building can be constructed on the boundary provided that the building height and length requirements are met)

ARMSTRONG Mt DUNED

**BUILDING ENVELOPE PLAN
STAGE 41**

41 / 3
stage sheet

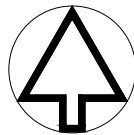

MGA ZONE 55

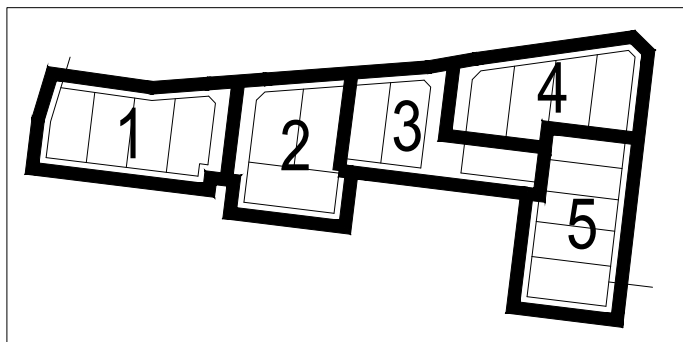

KEY TO SHEETS

This Building Envelope Plan is to be read in conjunction with the associated Building Envelope Profiles and Design Guidelines.

The registered proprietor/s of the lot are required to build in accordance with building envelopes shown hereon and in the "Profile Diagrams" in sheet 6.

Detailed design of roads, driveways and footpaths is provided in the relevant Engineering Plans.

Detailed design of landscape works is provided in the relevant Landscape Plans.

All details subject to City of Greater Geelong Council approval.

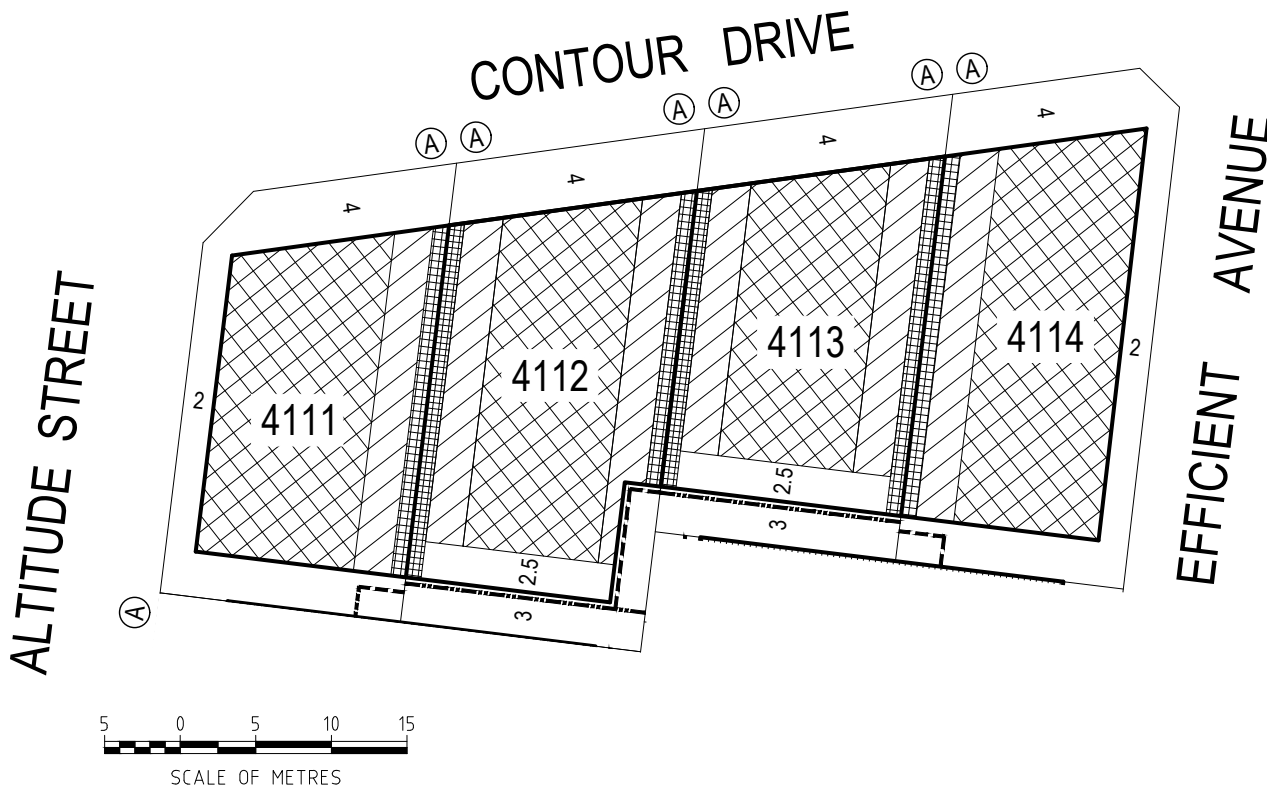

NOTATIONS

- Single Storey Building Envelope (height not exceeding 3.6m)
- Overlooking Zone - Habitable room windows/raised open spaces are a source of overlooking
- Non Overlooking Zone - Habitable room windows/raised open spaces are not a source of overlooking
- Building to Boundary Zone

- Building Envelope Boundary Profile Type
- 2 metre wide easement
- 3 metre wide easement
- 4105** Lot number
- 3** Setback minimum required (if 0, a building can be constructed on the boundary provided that the building height and length requirements are met)

ARMSTRONG Mt DUNED

**BUILDING ENVELOPE PLAN
STAGE 41**

41/4
stage sheet



Detailed design of roads, driveways and footpaths is provided in the relevant Engineering Plans.

Detailed design of landscape works is provided in the relevant Landscape Plans.

All details subject to City of Greater Geelong Council approval.

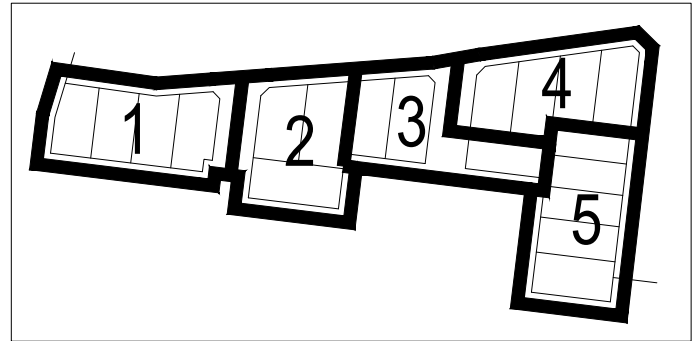

KEY TO SHEETS

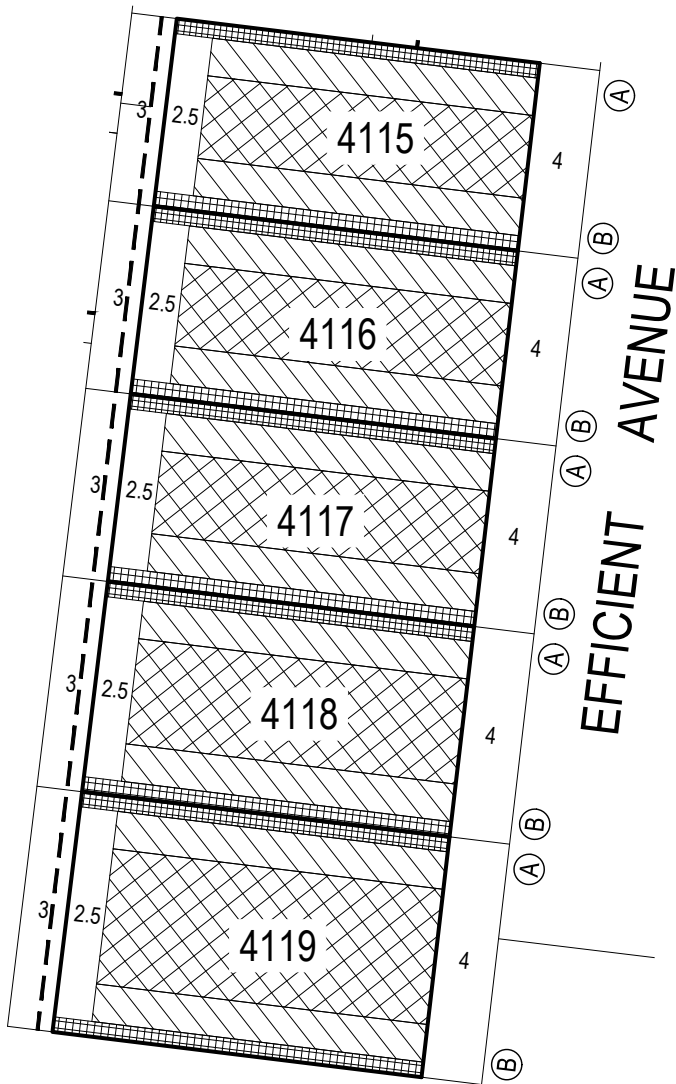

NOTATIONS

- Single Storey Building Envelope (height not exceeding 3.6m)
- Overlooking Zone - Habitable room windows/raised open spaces are a source of overlooking
- Non Overlooking Zone - Habitable room windows/raised open spaces are not a source of overlooking
- Building to Boundary Zone)
- Building Envelope Boundary Profile Type
- 2 metre wide easement
- 3 metre wide easement
- 4105** Lot number
- 3** Setback minimum required (if 0, a building can be constructed on the boundary provided that the building height and length requirements are met)

This Building Envelope Plan is to be read in conjunction with the associated Building Envelope Profiles and Design Guidelines. The registered proprietor/s of the lot are required to build in accordance with building envelopes shown hereon and in the "Profile Diagrams" in sheet 6.

ARMSTRONG Mt DUNED

**BUILDING ENVELOPE PLAN
STAGE 41**

41 / 5
stage sheet



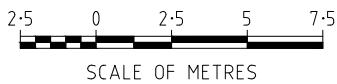
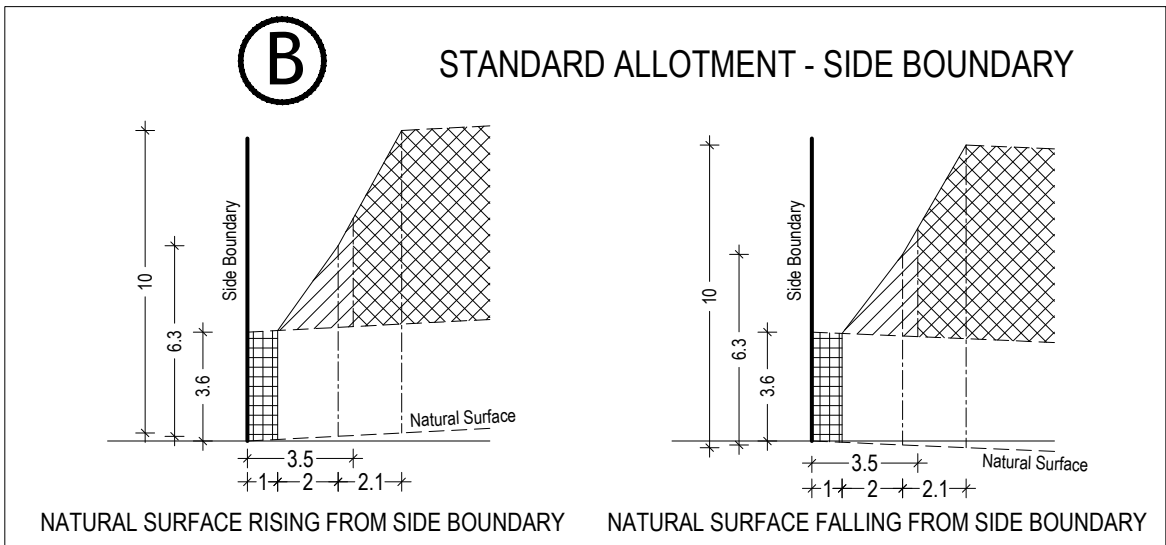
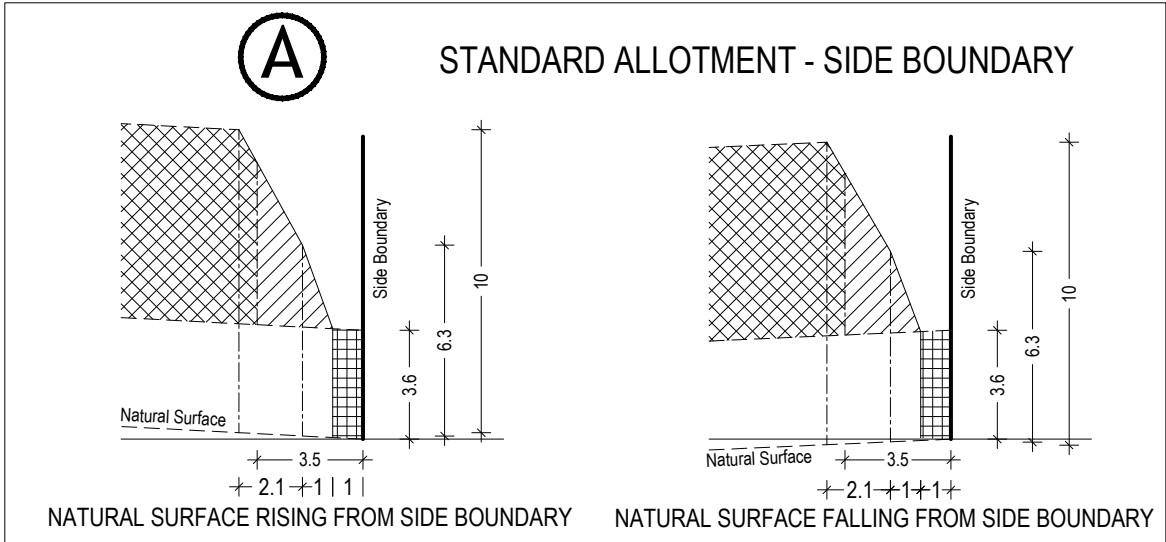

ARMSTRONG Mt DUNEED

**BUILDING ENVELOPE PROFILES
STAGE 41**

Single Storey Building Envelope

Non Overlooking Zone
Habitable room windows/raised open spaces are not a source of overlooking

Overlooking Zone
Habitable room windows/raised open spaces are a source of overlooking

Building to Boundary Zone

41 / 6
stage sheet

Sheet 6 of 6

August 2017
Version:A