

MGA ZONE 55



KEY TO SHEETS

REFER TO SHEETS
1 TO 8
FOR DETAIL

ARMSTRONG Mt DUNEED

BUILDING ENVELOPE PLAN
STAGE 29

August 2015
Version:E



Detailed design of roads, driveways and footpaths is provided in the relevant Engineering Plans.

Detailed design of landscape works is provided in the relevant Landscape Plans.

All details subject to City of Greater Geelong Council approval.

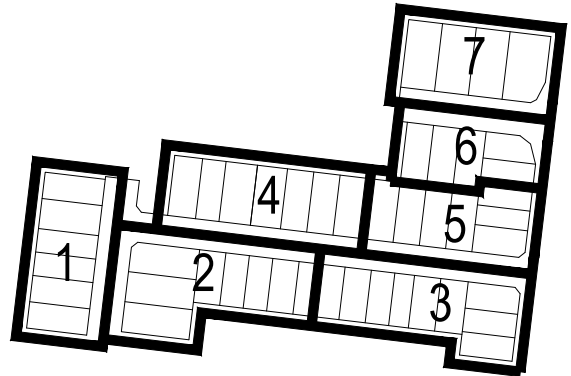
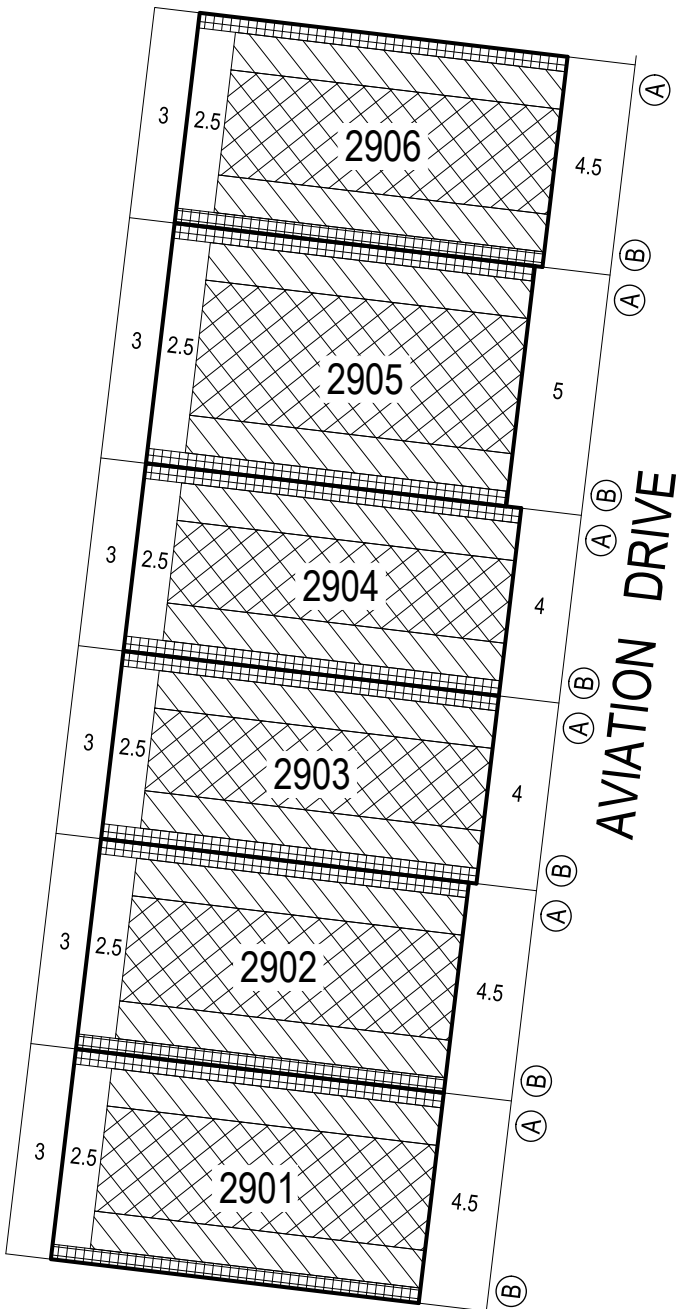

KEY TO SHEETS

NOTATIONS

- Single Storey Building Envelope (height not exceeding 3.6m)
- Overlooking Zone - Habitable room windows/raised open spaces are a source of overlooking
- Non Overlooking Zone - Habitable room windows/raised open spaces are not a source of overlooking
- Building to Boundary Zone)
- Building Envelope Boundary Profile Type
- 2 metre wide easement
- 3 metre wide easement
- 2906** Lot number
- 3** Setback minimum required (if 0, a building can be constructed on the boundary provided that the building height and length requirements are met)

This Building Envelope Plan is to be read in conjunction with the associated Building Envelope Profiles and Design Guidelines.
The registered proprietor/s of the lot are required to build in accordance with building envelopes shown hereon and in the "Profile Diagrams" in sheet 8.

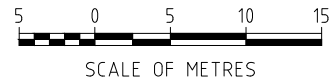

ARMSTRONG Mt DUNEED

BUILDING ENVELOPE PLAN
STAGE 29



29 / 1



stage sheet

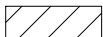

MGA ZONE 55

NOTATIONS

-  Single Storey Building Envelope (height not exceeding 3.6m)
-  Overlooking Zone - Habitable room windows/raised open spaces are a source of overlooking
-  Non Overlooking Zone - Habitable room windows/raised open spaces are not a source of overlooking
-  Building to Boundary Zone

-  Building Envelope Boundary Profile Type
-  2 metre wide easement
-  3 metre wide easement
- 2906** Lot number
- 3** Setback minimum required (if 0, a building can be constructed on the boundary provided that the building height and length requirements are met)

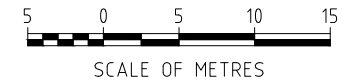
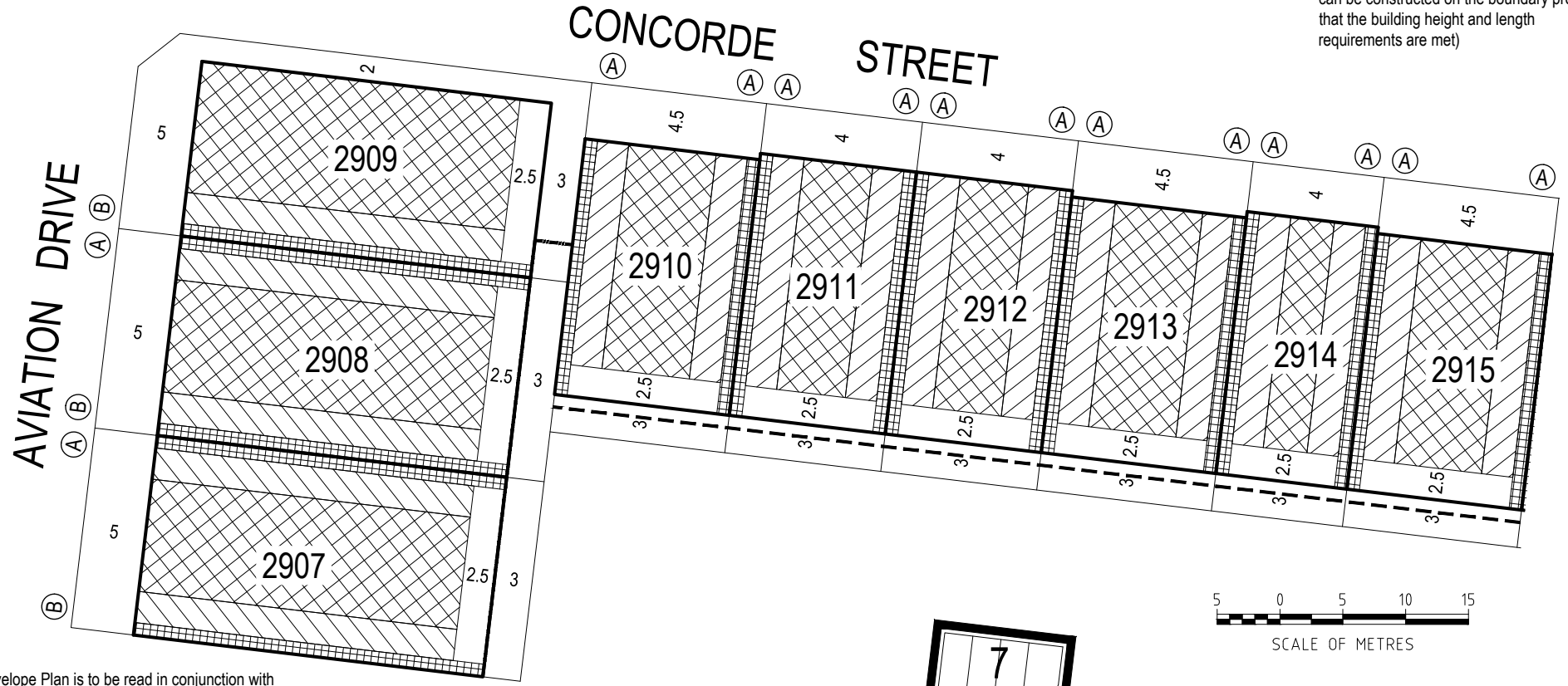

This Building Envelope Plan is to be read in conjunction with the associated Building Envelope Profiles and Design Guidelines.

The registered proprietor/s of the lot are required to build in accordance with building envelopes shown hereon and in the "Profile Diagrams" in sheet 8.

Detailed design of roads, driveways and footpaths is provided in the relevant Engineering Plans.

Detailed design of landscape works is provided in the relevant Landscape Plans.

All details subject to City of Greater Geelong Council approval.

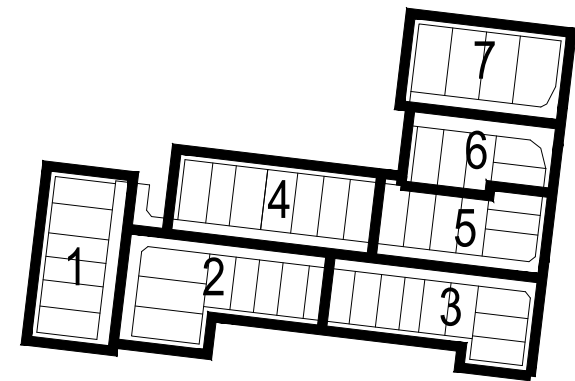



KEY TO SHEETS



ARMSTRONG Mt DUNEED
BUILDING ENVELOPE PLAN
STAGE 29
29/2
stage sheet

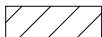

MGA ZONE 55

NOTATIONS

-  Single Storey Building Envelope (height not exceeding 3.6m)
-  Overlooking Zone - Habitable room windows/raised open spaces are a source of overlooking
-  Non Overlooking Zone - Habitable room windows/raised open spaces are not a source of overlooking
-  Building to Boundary Zone

-  Building Envelope Boundary Profile Type
-  2 metre wide easement
-  3 metre wide easement
- 2906** Lot number
- 3** Setback minimum required (if 0, a building can be constructed on the boundary provided that the building height and length requirements are met)

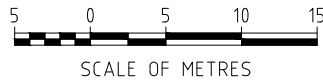
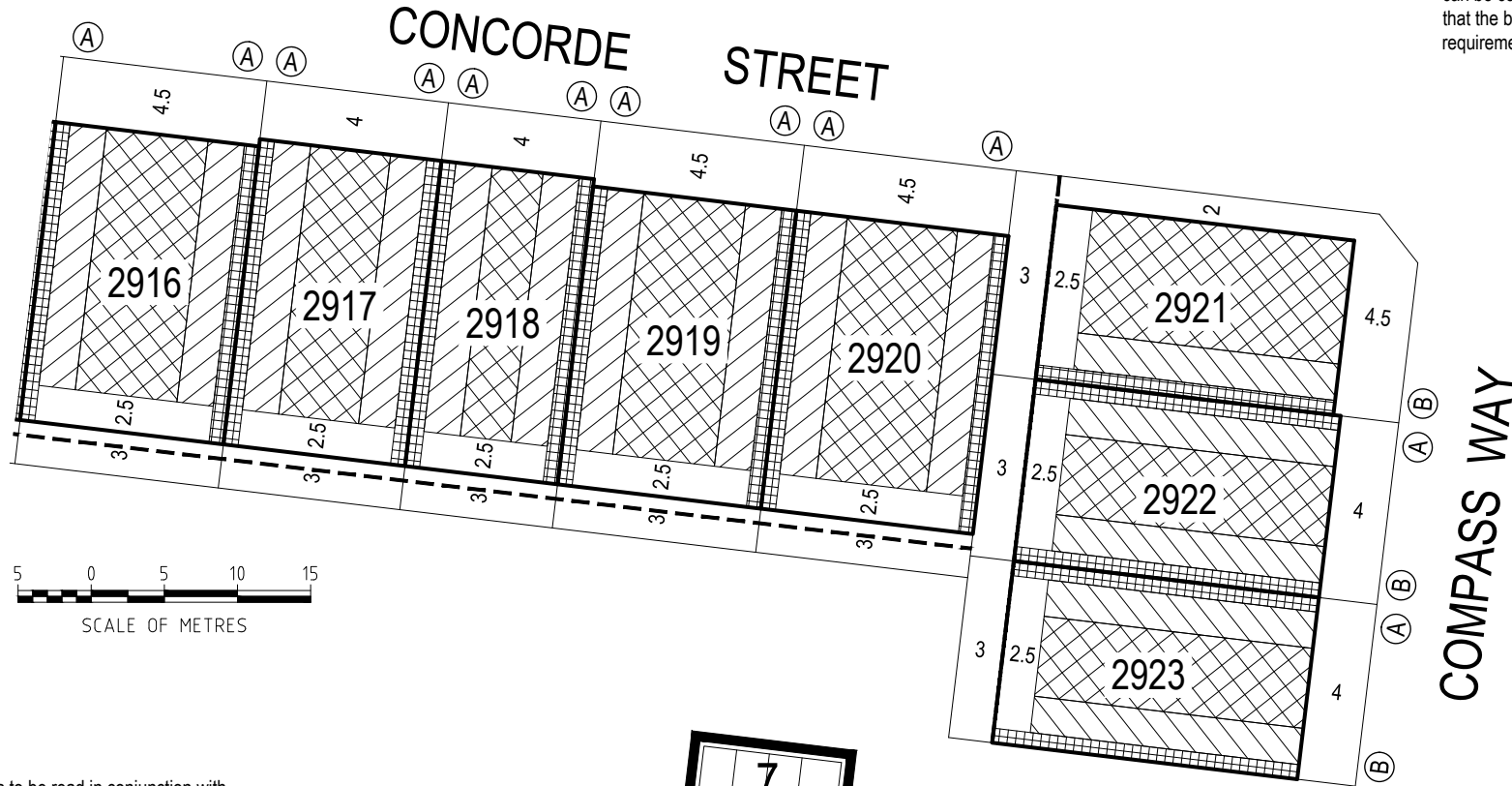

This Building Envelope Plan is to be read in conjunction with the associated Building Envelope Profiles and Design Guidelines.

The registered proprietor/s of the lot are required to build in accordance with building envelopes shown hereon and in the "Profile Diagrams" in sheet 8.

Detailed design of roads, driveways and footpaths is provided in the relevant Engineering Plans.

Detailed design of landscape works is provided in the relevant Landscape Plans.

All details subject to City of Greater Geelong Council approval.

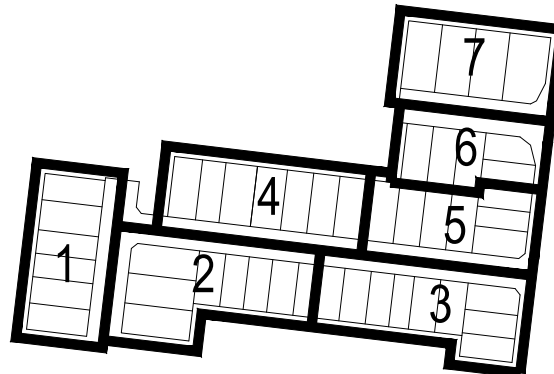

KEY TO SHEETS

ARMSTRONG Mt DUNEED



BUILDING ENVELOPE PLAN
STAGE 29



29/3
stage sheet

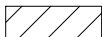

MGA ZONE 55

NOTATIONS

-  Single Storey Building Envelope (height not exceeding 3.6m)
-  Overlooking Zone - Habitable room windows/raised open spaces are a source of overlooking
-  Non Overlooking Zone - Habitable room windows/raised open spaces are not a source of overlooking
-  Building to Boundary Zone

-  Building Envelope Boundary Profile Type
-  2 metre wide easement
-  3 metre wide easement
- 2906 Lot number
- 3 Setback minimum required (if 0, a building can be constructed on the boundary provided that the building height and length requirements are met)

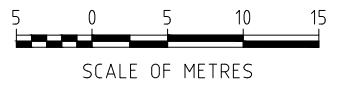
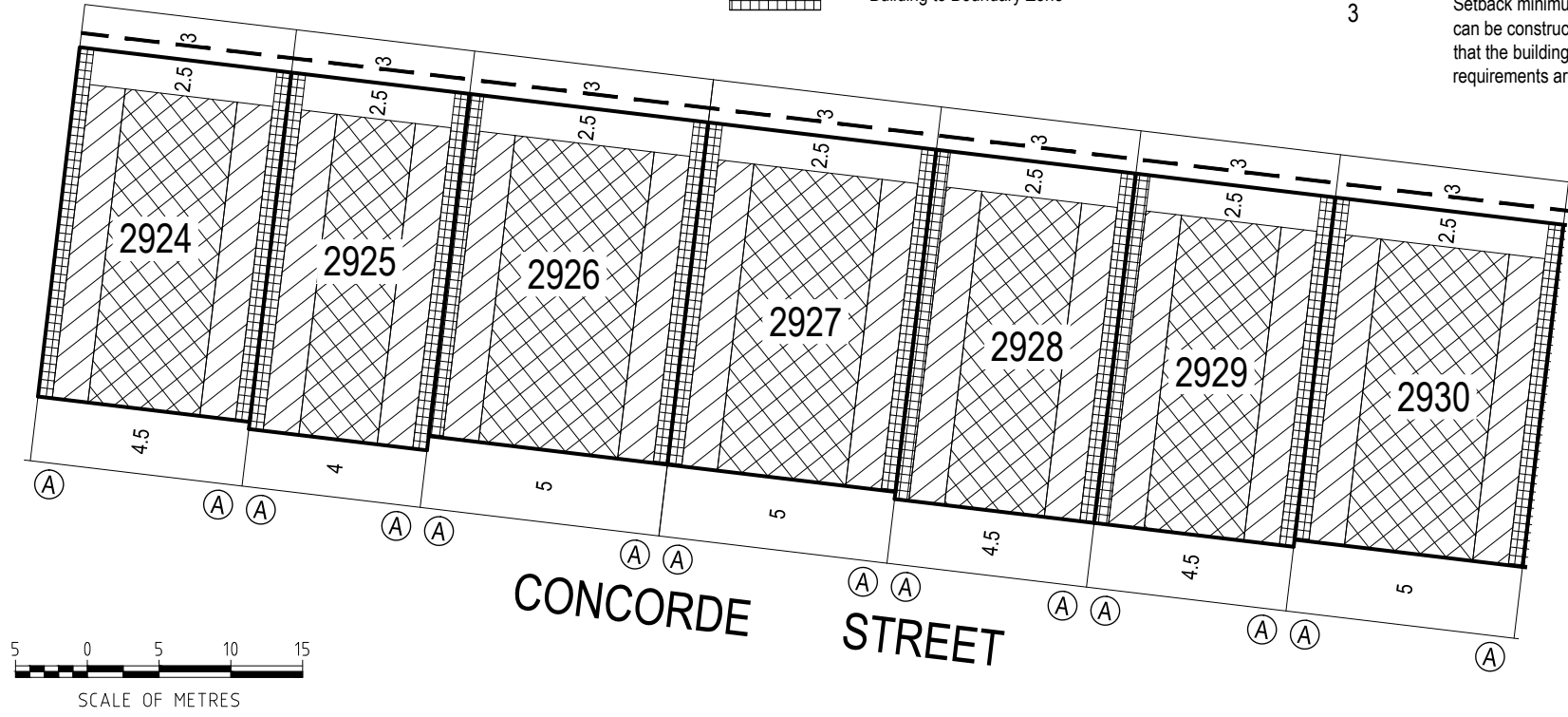

This Building Envelope Plan is to be read in conjunction with the associated Building Envelope Profiles and Design Guidelines.
 The registered proprietor/s of the lot are required to build in accordance with building envelopes shown hereon and in the "Profile Diagrams" in sheet 8.
 Detailed design of roads, driveways and footpaths is provided in the relevant Engineering Plans.
 Detailed design of landscape works is provided in the relevant Landscape Plans.
 All details subject to City of Greater Geelong Council approval.

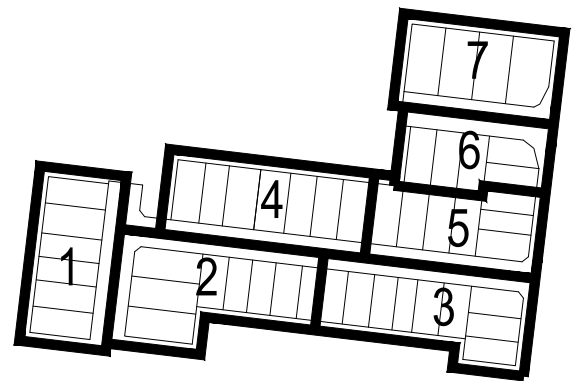

KEY TO SHEETS

ARMSTRONG Mt DUNEED



BUILDING ENVELOPE PLAN
 STAGE 29



29/4
 stage sheet

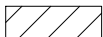

MGA ZONE 55

NOTATIONS

-  Single Storey Building Envelope (height not exceeding 3.6m)
-  Overlooking Zone - Habitable room windows/raised open spaces are a source of overlooking
-  Non Overlooking Zone - Habitable room windows/raised open spaces are not a source of overlooking
-  Building to Boundary Zone

-  Building Envelope Boundary Profile Type
-  2 metre wide easement
-  3 metre wide easement
- 2906 Lot number
- 3 Setback minimum required (if 0, a building can be constructed on the boundary provided that the building height and length requirements are met)

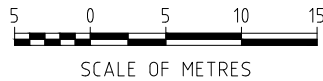
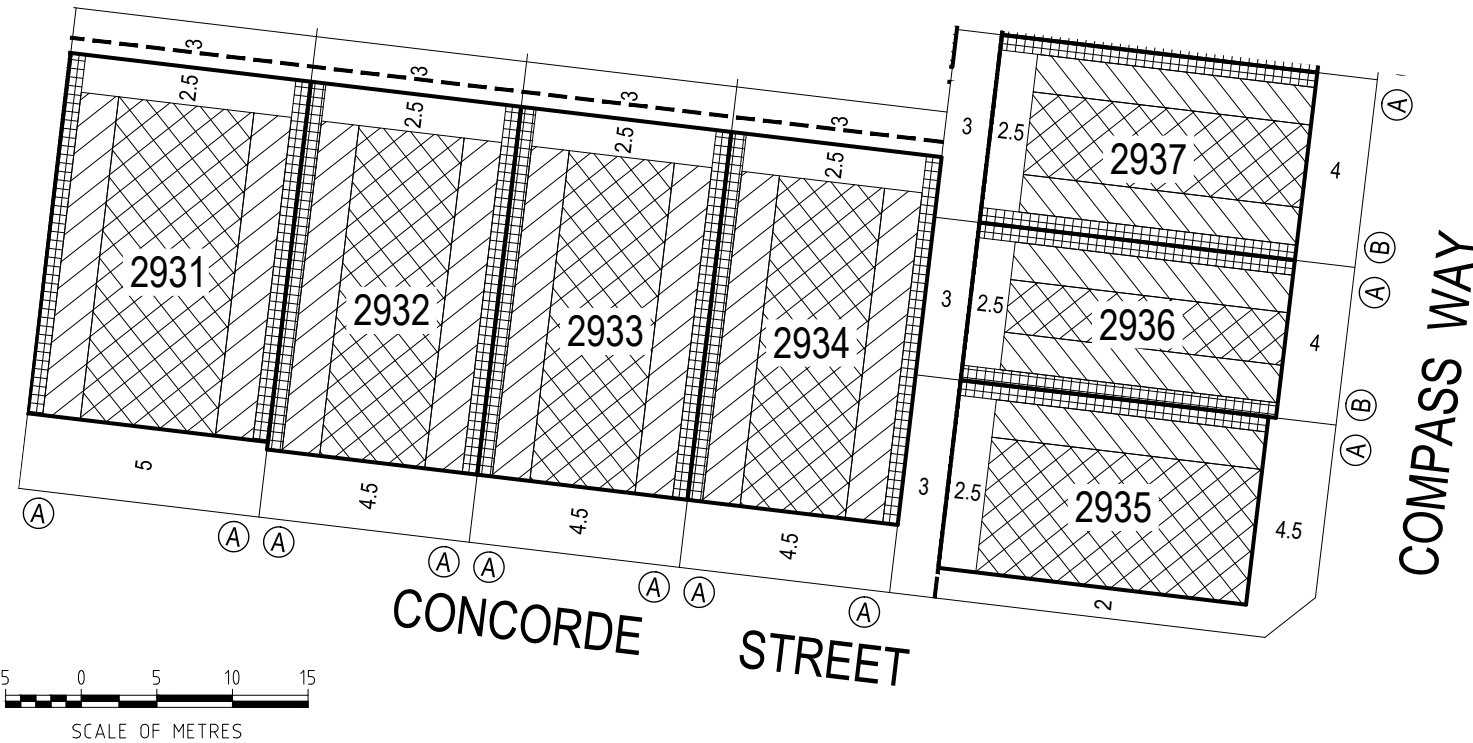

This Building Envelope Plan is to be read in conjunction with the associated Building Envelope Profiles and Design Guidelines.

The registered proprietor/s of the lot are required to build in accordance with building envelopes shown hereon and in the "Profile Diagrams" in sheet 8.

Detailed design of roads, driveways and footpaths is provided in the relevant Engineering Plans.

Detailed design of landscape works is provided in the relevant Landscape Plans.

All details subject to City of Greater Geelong Council approval.

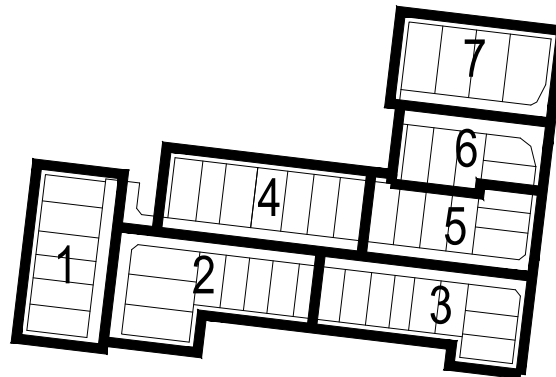

ARMSTRONG Mt DUNEED



BUILDING ENVELOPE PLAN
STAGE 29

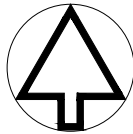

29/5
stage sheet

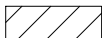

MGA ZONE 55

NOTATIONS

-  Single Storey Building Envelope (height not exceeding 3.6m)
-  Overlooking Zone - Habitable room windows/raised open spaces are a source of overlooking
-  Non Overlooking Zone - Habitable room windows/raised open spaces are not a source of overlooking
-  Building to Boundary Zone

-  Building Envelope Boundary Profile Type
-  2 metre wide easement
-  3 metre wide easement
- 2906 Lot number
- 3 Setback minimum required (if 0, a building can be constructed on the boundary provided that the building height and length requirements are met)

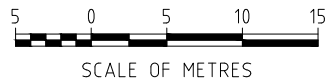
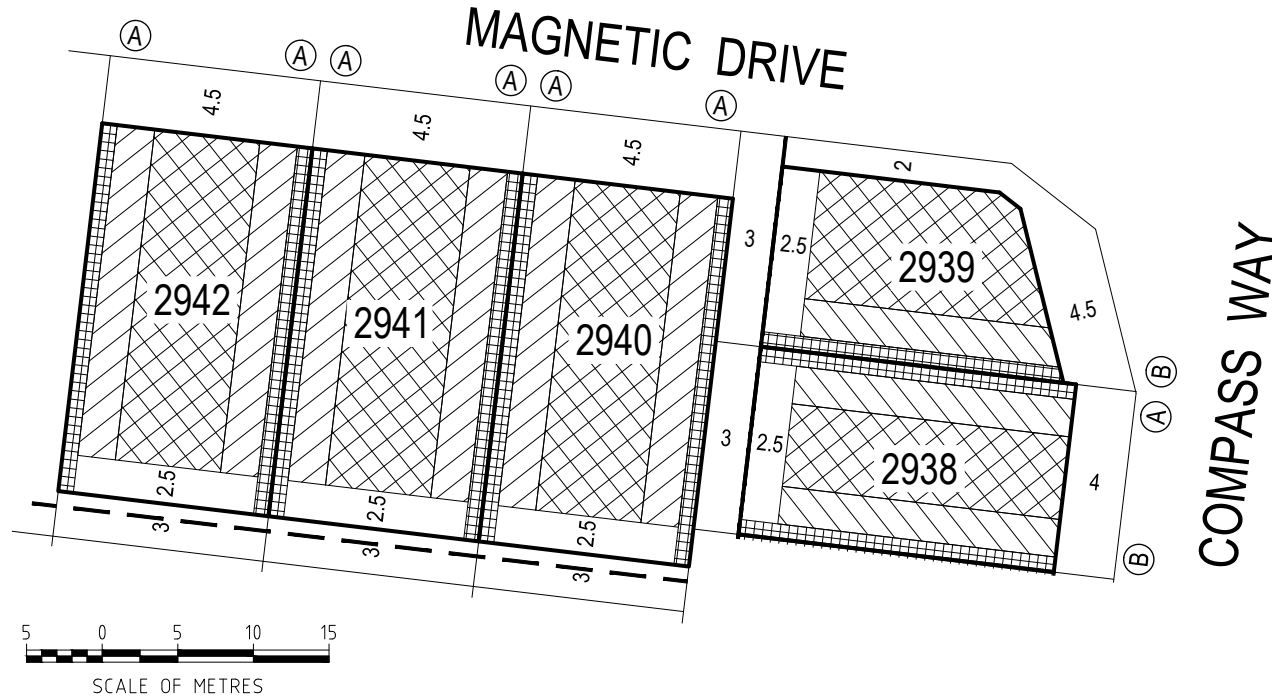

This Building Envelope Plan is to be read in conjunction with the associated Building Envelope Profiles and Design Guidelines.

The registered proprietor/s of the lot are required to build in accordance with building envelopes shown hereon and in the "Profile Diagrams" in sheet 8.

Detailed design of roads, driveways and footpaths is provided in the relevant Engineering Plans.

Detailed design of landscape works is provided in the relevant Landscape Plans.

All details subject to City of Greater Geelong Council approval.

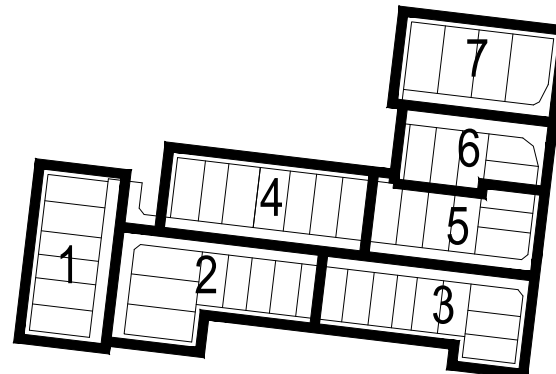

KEY TO SHEETS

ARMSTRONG Mt DUNEED

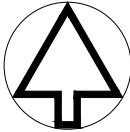

BUILDING ENVELOPE PLAN
STAGE 29

29/6
stage sheet

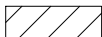

MGA ZONE 55

NOTATIONS

-  Single Storey Building Envelope (height not exceeding 3.6m)
-  Overlooking Zone - Habitable room windows/raised open spaces are a source of overlooking
-  Non Overlooking Zone - Habitable room windows/raised open spaces are not a source of overlooking
-  Building to Boundary Zone

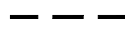
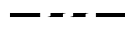
-  Building Envelope Boundary Profile Type
-  2 metre wide easement
-  3 metre wide easement
- 2906 Lot number
- 3 Setback minimum required (if 0, a building can be constructed on the boundary provided that the building height and length requirements are met)

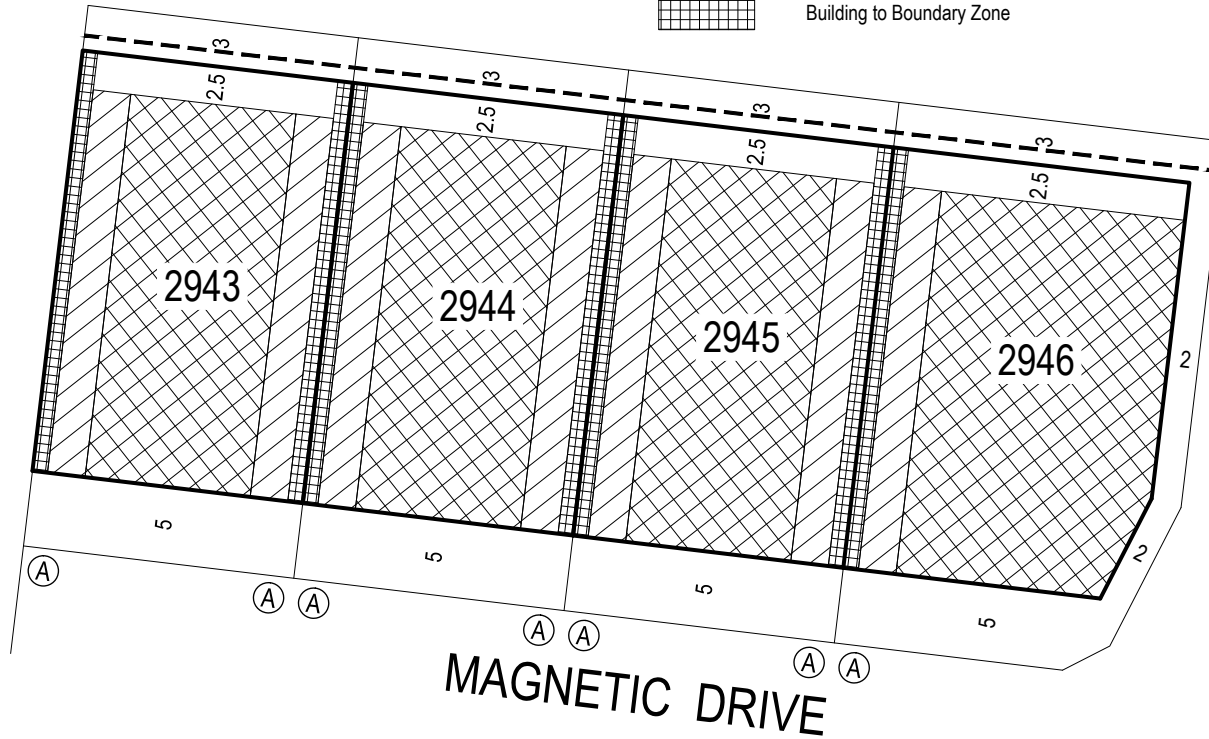

This Building Envelope Plan is to be read in conjunction with the associated Building Envelope Profiles and Design Guidelines.

The registered proprietor/s of the lot are required to build in accordance with building envelopes shown hereon and in the "Profile Diagrams" in sheet 8.

Detailed design of roads, driveways and footpaths is provided in the relevant Engineering Plans.

Detailed design of landscape works is provided in the relevant Landscape Plans.

All details subject to City of Greater Geelong Council approval.

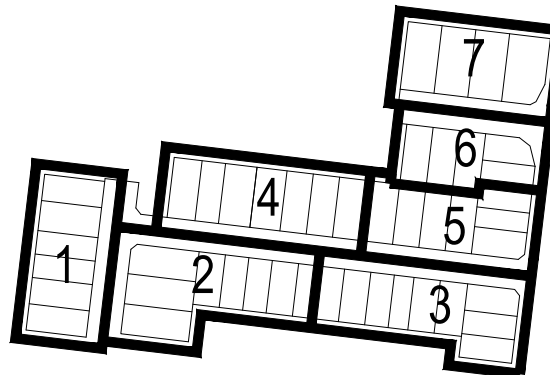

KEY TO SHEETS

ARMSTRONG Mt DUNEED

BUILDING ENVELOPE PLAN
STAGE 29

29/7

stage sheet

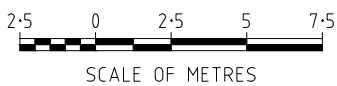
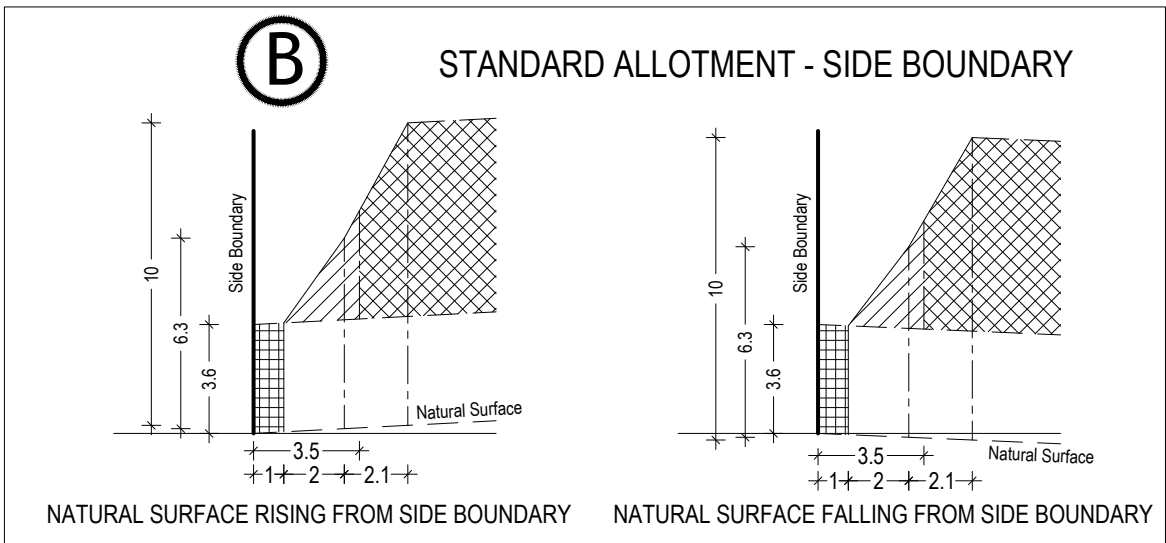
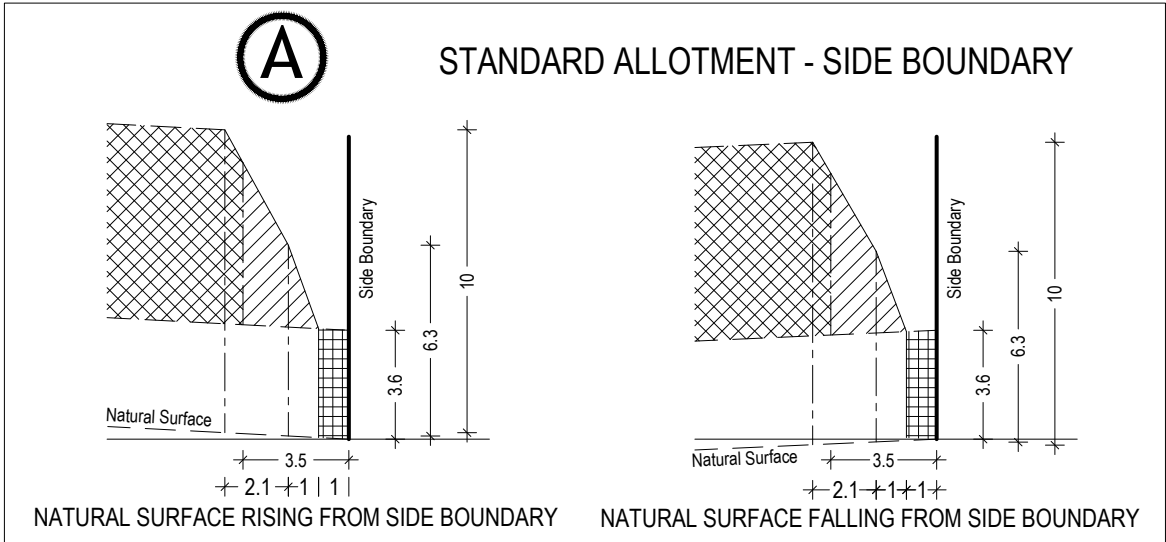

ARMSTRONG Mt DUNEED

BUILDING ENVELOPE PROFILES
STAGE 29

29 / 8
stage sheet

Single Storey Building Envelope



Non Overlooking Zone
Habitable room windows/raised open spaces are not a source of overlooking

Overlooking Zone
Habitable room windows/raised open spaces are a source of overlooking



Building to Boundary Zone

sheet 8 of 8

August 2015
Version: E