



## CIVIL GEOTECHNICAL SERVICES

ABN 26 474 013 724

PO Box 678 Croydon Vic 3136

Telephone: 9723 0744 Facsimile: 9723 0799

15 December 2014

Our Reference: 14470:PJF1958/726

Cranbourne Road Holdings

c/- Villawood Properties

Level 1 6 Riverside Quay

SOUTHBANK VIC 3006

Dear Sirs,

RE: LOT 726 OF THE PASADENA ESTATE (STAGE 7), CLYDE

Winslow Constructors Pty Ltd has recently constructed a residential subdivision (referred to as Stage 7 of The Pasadena Estate) which is located on the west side of Clyde – Five Ways Road in Clyde. As part of the subdivisional works, Civil Geotechnical Services were engaged by Winslow Constructors to provide inspection and testing services for the bulk earthworks associated with the construction of the residential allotments. The testing and inspection services were undertaken in accordance with the Level 1 requirements of AS 3798 – Guidelines on Earthworks for Commercial and Residential Developments.

Construction of the Lot noted above essentially involved a fill operation, with the estimated maximum depth of fill materials (excluding topsoil placement) being up to 1 metre in depth. However, there could be localised areas of slightly deeper fill materials arising from site stripping and foundation preparation works.

The fill materials were spread and compacted in 0.2 to 0.3 metre (solid) lifts using a vibrating pad foot roller and/or compactor. The fill materials essentially comprised clays that were sourced from adjacent stages of the Pasadena Estate. Compaction testing of these materials was performed at regular intervals (both vertically and laterally) during fill placement. The resulting density ratios were all in excess of 95% (standard compactive effort) and a copy of the Level 1 report is attached.

The Cranbourne sheet of the Geological Survey Maps of Victoria shows the above site to be underlain by Tertiary aged deposits associated with the Baxter formation. These latter materials essentially comprise high plasticity clays that exhibit moderate to high shrink-swell surface movements when subjected to changes in seasonal soil moisture content. The anticipated geology and the foregoing description of the underlying materials were generally confirmed by site observations undertaken during construction of the subdivision (eg foundation preparation works, trench excavations etc).

As a consequence of the site earthworks, the founding medium for a conventional shallow footing system will most likely comprise the compacted fill materials. As the depth of the compacted clayey fill materials is in excess of 0.4 metres, a Class P classification in accordance with Section 2 of AS 2870 – Residential Slabs and Footings would normally be appropriate. However, as the fill materials that have been placed during the recent phase of construction have been placed in a controlled manner, a less severe classification would, in appropriate circumstances, be applicable.

After a consideration of the foregoing, together with the depth of fill placed and the materials utilised as controlled fill, the site has been reclassified as **CLASS M**. Accordingly, a conventional shallow footing system that is founded in the ‘undisturbed’ fill materials could be satisfactorily utilised at this allotment.

The most appropriate foundation system for this allotment is a conventional stiffened raft slab founding in the controlled fill materials. Accordingly, it is recommended that a stiffened raft slab be utilised, with the slab designed and detailed in accordance with the Class M classification requirements of AS 2870. The edge and load bearing beams should be founded in the 'undisturbed' compacted clayey fill materials at a minimum depth of 0.5 metres below finished surface levels. Edge and load bearing beams founding in this manner would have an allowable bearing pressure of 100 kPa. The raft stiffening beams, provided that their contact pressures do not exceed 50 kPa, should be founded in the 'undisturbed' fill materials at a minimum depth of 0.2 metres below finished surface levels. The slab infill panels can be founded directly onto the 'undisturbed' compacted fill materials.

Consideration could also be given to utilising a waffle raft slab. However, if a waffle raft slab is utilised, the near surface topsoil and any loose and disturbed materials will need to be removed from the building footprint prior to construction. Previous experience suggests that this option will require the removal of up to 0.25 metres of topsoil materials and the like. However, there may be sections of the site where additional excavation depths are required. If a waffle raft slab is to be utilised, the waffle raft slab should be designed and detailed in accordance with the Class M classification requirements of AS 2870. Particular attention will also need to be directed towards ensuring that a stable moisture regime is maintained around the slab periphery. Furthermore, due to the significant problems that have been experienced with washout from the undersides of slab edges and corners, it will be necessary to found the perimeter beams into the 'undisturbed' compacted clayey fill materials for a distance of not less than 0.4 metres. Perimeter beams founding in this manner would have an allowable bearing pressure of 100 kPa. Internal beams may be founded in the 'undisturbed' compacted clayey fill materials at higher levels than the perimeter beams. An allowable bearing pressure of 100 kPa is also available for these latter beams.

The site classifications and design recommendations presented above assume that the current natural drainage and infiltration conditions at the site will not be markedly affected by the proposed site development work. Care should therefore be taken to ensure that surface water is not permitted to collect adjacent to any structure and that significant changes to seasonal soil moisture equilibria do not develop as a result of service trench construction, garden bed development or tree root action.

Attention is drawn to Appendix B of AS 2870 and its referenced documents as a guide to maintenance requirements for any proposed structures. In particular, attention should be directed at the design stage towards ensuring that any structures are relatively flexible and well articulated (eg closely spaced full height articulation joints, minimal brickwork over or under widow openings etc). Guidance on articulation spacings and associated detailing are provided in Technical Note 61 - Articulated Walling which is published by The Cement and Concrete Association of Australia.

The base of all footing trenches should be carefully inspected to ensure that a satisfactory founding medium is achieved. If any doubt exists to the suitability or otherwise of the founding medium, this office should be consulted immediately.

Civil Geotechnical Services

A handwritten signature in black ink, appearing to read 'Peter Fry', is written over a circular stamp or seal that is mostly obscured by the ink.

Peter Fry

Attachment: Level 1 report dated 10 December 2014 - Our Reference: 11145:PJF1957



**CIVIL GEOTECHNICAL SERVICES**  
**ABN 26 474 013 724**  
**PO Box 678 Croydon Vic 3136**  
**Telephone: 9723 0744 Facsimile: 9723 0799**

10 December 2014

Our Reference: 11145:PJF1957

Cranbourne Road Holdings  
c/- Villawood Properties  
Level 1 6 Riverside Quay  
SOUTHBANK VIC 3006

Dear Sirs,

**RE: LEVEL 1 EARTHWORKS INSPECTION AND TESTING**  
**PASADENA ESTATE, CLYDE – STAGE 7**

Please find attached our Report Nos 11145AA to 11145AH, 11189AA and 11189AB and 11370AA to 11370AJ that relate to the field density testing that was conducted within the filled allotments associated with the construction of Stage 7 of the above subdivision. It should be noted that Stage 7 was constructed concurrently with Stage 5, with the latter Stage located immediately south of Stage 7 (refer to the attached drawings). Hence, whilst the attached compaction reports reference Stage 5, the results also include testing that was conducted within the Stage 7 footprint.

The site stripping and associated filling works within this stage of the estate commenced in early April 2011 and continued on an ad hoc basis until mid to late October 2011.

The inspection and testing duties, which were performed by experienced geotechnical engineers and geotechnicians from this office, were undertaken in accordance with the Level 1 guidelines presented in AS 3798 - Guidelines on earthworks for commercial and residential developments. The testing was performed to the relevant Australian Standards and the accompanying test reports carry NATA endorsement.

Prior to fill placement, the stripped surfaces were inspected to ensure that a firm foundation free of organic matter and the like was achieved. Any soft spots and unstable areas and the like that were encountered were removed down to a firm base and replaced with suitably compacted clays.

The fill materials during the recent construction phase were initially spread by a track mounted dozer and then compacted in 0.3 to 0.35 metre (loose) lifts using both a heavy vibrating pad foot roller and a compactor. The fill materials essentially comprised high plasticity clays that were sourced from adjacent stages. Compaction testing of these materials was performed at regular intervals (both vertically and laterally) to confirm that the method of fill placement was appropriate. Any areas that were deemed unsatisfactory were re-worked or given extra rolling to ensure that the compaction criteria was met.

The purpose of performing Level 1 inspection and testing duties is to ensure the quality of the as constructed fill pad(s) and to both minimise the costs of extensive testing and eliminate any unnecessary time delays arising from the testing process. Hence, the provision of Level 1 duties allows the contractor to undertake the filling operation whilst the testing authority monitors the quality control process of the

operation. As part of this latter process, the testing authority monitors the compaction methodology on a visual basis and undertakes a number of randomly placed spot checks (ie field density and associated compaction tests) to confirm that the adopted methodology is appropriate.

The attached compaction results, which were located randomly throughout the depth and breadth of the filled areas, are considered to be representative of the bulk fill materials that were placed within the abovementioned stage by Winslow Constructors Pty Ltd during the aforementioned period (Winslow were contracted to undertake the bulk earthworks for Stages 5 and 7 of the Pasadena Estate).

The density ratios were all in excess of 95% (standard compactive effort) and the corresponding moisture ratios varied 2.5% either side of optimum moisture.

We are of the view that the bulk fill materials that have been placed within Stage 7 of the Pasadena Estate by Winslow Constructors during the aforementioned period can be considered as having been placed in a controlled manner to a minimum density ratio of 95% (standard compactive effort).

Accordingly, the fill materials would be deemed to comply with both the controlled fill requirements of Clause 1.8.13 of AS 2870 – Residential slabs and footings and the structural fill requirements of Clause 1.2.13 of AS 3798.

Please contact the undersigned if you require any additional information.

Yours faithfully,

Civil Geotechnical Services

A handwritten signature in black ink, appearing to read 'Peter Fry', with a stylized, scribbled flourish extending from the end of the name.

Peter Fry

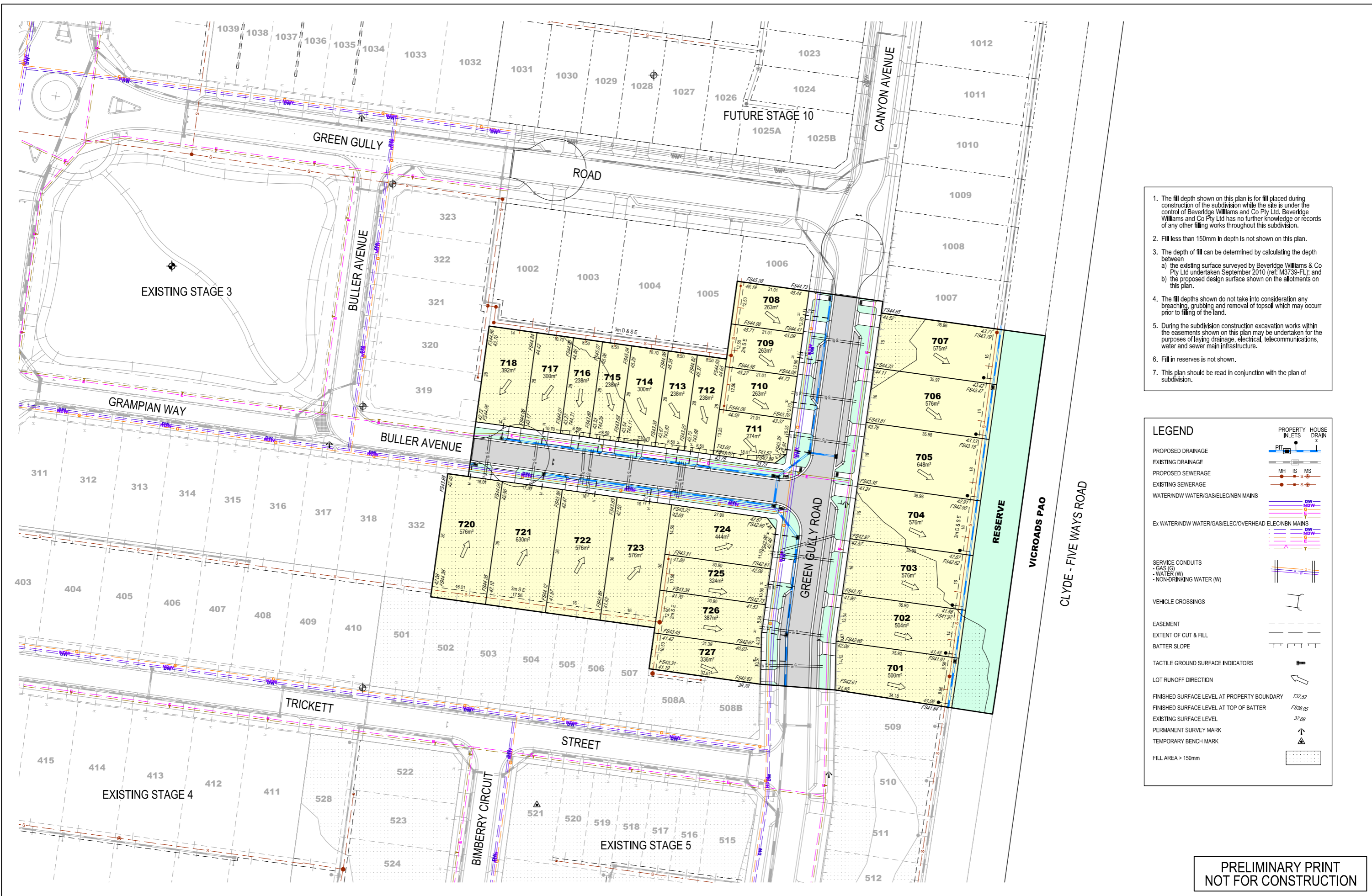

- The fill depth shown on this plan is for fill placed during construction of the subdivision while the site is under the control of Beveridge Williams and Co Pty Ltd. Beveridge Williams and Co Pty Ltd has no further knowledge or records of any other filling works throughout this subdivision.
- Fill less than 150mm in depth is not shown on this plan.
- The depth of fill can be determined by calculating the depth between:
  - the existing surface surveyed by Beveridge Williams & Co Pty Ltd undertaken September 2010 (ref: M3739-FL); and
  - the proposed design surface shown on the allotments on this plan.
- The fill depths shown do not take into consideration any breaching, grubbing and removal of topsoil which may occur prior to filling of the land.
- During the subdivision construction excavation works within the easements shown on this plan may be undertaken for the purposes of laying drainage, electrical, telecommunications, water and sewer main infrastructure.
- Fill in reserves is not shown.
- This plan should be read in conjunction with the plan of subdivision.

**LEGEND**

- PROPOSED DRAINAGE: Blue dashed line with arrow
- EXISTING DRAINAGE: Grey dashed line with arrow
- PROPOSED SEWERAGE: Red dashed line with arrow
- EXISTING SEWERAGE: Black dashed line with arrow
- WATER/NDW WATER/GAS/ELEC/NBN MAINS: Various colored solid lines
- Ex WATER/NDW WATER/GAS/ELEC/OVERHEAD ELEC/NBN MAINS: Various colored dashed lines
- SERVICE CONDUITS:
  - GAS (G): Red solid line
  - WATER (W): Blue solid line
  - NON-DRINKING WATER (W): Green solid line
- VEHICLE CROSSINGS: Two parallel lines with a gap
- EASEMENT: Dashed line with 'E' label
- EXTENT OF CUT & FILL: Dotted area
- BATTER SLOPE: Two parallel lines with a gap and arrow
- TACTILE GROUND SURFACE INDICATORS: Dashed line with 'T' label
- LOT RUNOFF DIRECTION: Arrow
- FINISHED SURFACE LEVEL AT PROPERTY BOUNDARY: 737.52
- FINISHED SURFACE LEVEL AT TOP OF BATTER: 738.05
- EXISTING SURFACE LEVEL: 77.69
- PERMANENT SURVEY MARK: Triangle with 'P' label
- TEMPORARY BENCH MARK: Triangle with 'B' label
- FILL AREA > 150mm: Dotted pattern

**PROPERTY HOUSE INLETS**

- PROPERTY HOUSE INLETS: Circle with 'PIT' label
- DRAIN: Line with 'D' label

**PRELIMINARY PRINT  
NOT FOR CONSTRUCTION**

Rev	Description	Date	By	App
P3	AMENDED FILL AREA FROM EXISTING SURFACE	02.10.14	RH	RH
P2	SECOND ISSUE	18.06.14	MJ	CW
P1	FIRST ISSUE	10.04.14	MJ	CW

Designated Date	M. JONES	10.04.14
Drawn	M. JONES	
Approved Date	C. WHITE	10.04.14
PS Number	PS726052H	

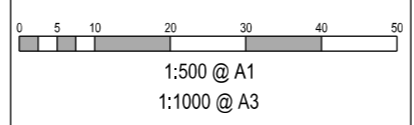

**BW Beveridge Williams**  
development & environment consultants

1 Glenferrie Road  
Malvern VIC 3144  
ph: 03 9524 8888  
www.beveridgewilliams.com.au

Project Details: PASADENA STAGE 7  
CLYDE DEVELOPMENTS  
CITY OF CASEY

Drawing Title: ENGINEERING DESIGN FOR  
CONTRACT OF SALE

Scale: AS SHOWN

Project Ref: 3830 Stage No: 07 SP 001 Drawing No: P3

**SERVICE OFFSET TABLE**

STREET	SERVICE	WATER	ND WATER	GAS	POWER	NBN	SEWER
TRICKETT STREET		3.1 N	2.6 N	1.85 N	2.6 S	2.1 S	N/A
BIMBERRY CIRCUIT		3.1 E	2.6 E	2.1 E	2.6 W	2.1 W	N/A
OSSA CRESCENT		3.1 S	2.6 S	2.1 S	2.6 N	2.1 N	N/A
GREEN GULLY ROAD		3.1 W	2.6 W	2.1 W	2.6 E	2.1 E	1.0 W

NOTE: OFFSETS ARE FROM ROAD RESERVE BOUNDARY



- The fill depth shown on this plan is for fill placed during construction of the subdivision while the site is under the control of Beveridge Williams and Co Pty Ltd. Beveridge Williams and Co Pty Ltd has no further knowledge or records of any other filling works throughout this subdivision.
- Fill less than 150mm in depth is not shown on this plan.
- The depth of fill can be determined by calculating the depth between:
  - the existing surface surveyed by Beveridge Williams & Co Pty Ltd undertaken September 2010 (ref: M3739-FL); and
  - the proposed design surface shown on the allotments on this plan.
- The fill depths shown do not take into consideration any breaching, grubbing and removal of topsoil which may occur prior to filling of the land.
- During the subdivision construction excavation works within the easements shown on this plan may be undertaken for the purposes of laying drainage, electrical, telecommunications, water and sewer main infrastructure.
- Fill in reserves is not shown.
- This plan should be read in conjunction with the plan of subdivision.

**LEGEND**

- PROPOSED DRAINAGE:
- EXISTING DRAINAGE:
- PROPOSED SEWERAGE:
- EXISTING SEWERAGE:
- WATER/NDW WATER/GAS/ELEC/NBN MAINS:
- Ex WATER/NDW WATER/GAS/ELEC/OVERHEAD ELEC/NBN MAINS:
- SERVICE CONDUITS:
  - GAS (G)
  - WATER (W)
  - NON-DRINKING WATER (W)
- VEHICLE CROSSINGS:
- EASEMENT:
- EXTENT OF CUT & FILL:
- BATTER SLOPE:
- TACTILE GROUND SURFACE INDICATORS:
- LOT RUNOFF DIRECTION:
- FINISHED SURFACE LEVEL AT PROPERTY BOUNDARY:
- FINISHED SURFACE LEVEL AT TOP OF BATTER:
- EXISTING SURFACE LEVEL:
- PERMANENT SURVEY MARK:
- TEMPORARY BENCH MARK:
- FILL AREA > 150mm:

**PRELIMINARY PRINT  
NOT FOR CONSTRUCTION**

Rev	Description	Date	By	App
P3	AMENDED FILL AREA FROM EXISTING SURFACE	01.10.14	RH	RH
P2	REMOVED LOTS 513 AND 531	21.03.14	RH	
P1	FIRST ISSUE	15.11.13	RH	

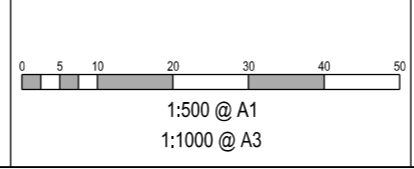

Designed Date: R.HABEL 13.11.13  
 Drawn: L.SUTHERLAND  
 Approved Date: C.WHITE APPDT  
 PS Number: PS708779H

**BW Beveridge Williams**  
 development & environment consultants  
 1 Glenferrie Road  
 Malvern VIC 3144  
 ph: 03 9524 8888  
 www.beveridgewilliams.com.au

Project Details: PASADENA STAGE 5  
 CLYDE DEVELOPMENTS  
 CITY OF CASEY  
 Drawing Title: ENGINEERING DESIGN FOR  
 CONTRACT OF SALE

Scale: 1:500 @ A1	
Project Ref: 3830	
Stage No: 05	Drawing No: SP 101
Rev: P3	



## COMPACTION ASSESSMENT

Job No 11145  
 Report No 11145AA  
 Date Issued 09/05/11

### CIVIL GEOTECHNICAL SERVICES

6 - 8 Rose Avenue, Croydon 3136

Client	WINSLOW CONSTRUCTORS PTY LTD (CAMPBELLFIELD)	Tested by	KC
Project	PASADENA - STAGE 5	Date tested	19/04/11
Location	CLYDE NORTH	Checked by	JHF

<b>Feature</b>	<b>EARTHWORKS</b>	Layer thickness	200 mm	Time: 11:37
----------------	-------------------	-----------------	--------	-------------

Test procedure AS 1289.2.1.1 & 5.8.1

Test No	1	2	3	4	5	-
Location	REFER TO FIGURE 1	REFER TO FIGURE 1	REFER TO FIGURE 1	REFER TO FIGURE 1	REFER TO FIGURE 1	
Approximate depth below FSL	-	-	-	-	-	-
Measurement depth <i>mm</i>	175	175	175	175	175	-
Field wet density <i>t/m<sup>3</sup></i>	1.75	1.79	1.75	1.74	1.79	-
Field moisture content <i>%</i>	39.8	35.3	39.4	41.5	39.7	-

Test procedure AS 1289.5.7.1

Test No	1	2	3	4	5	-
Compactive effort	Standard					
Oversize rock retained on sieve <i>mm</i>	19.0	19.0	19.0	19.0	19.0	-
Percent of oversize material <i>wet</i>	0	0	0	0	0	-
Peak Converted Wet Density <i>t/m<sup>3</sup></i>	1.73	1.79	1.73	1.71	1.77	-
Adjusted Peak Converted Wet Density <i>t/m<sup>3</sup></i>	-	-	-	-	-	-
Optimum Moisture Content <i>%</i>	39.5	33.5	39.0	40.5	38.0	-

Moisture Variation From Optimum Moisture Content	0.5% wet	1.5% wet	0.5% wet	1.0% wet	1.5% wet	-
--	----------	----------	----------	----------	----------	---

<b>Density Ratio ( <math>R_{HD}</math> )</b>	<b>%</b>	<b>101.0</b>	<b>100.5</b>	<b>101.0</b>	<b>101.5</b>	<b>101.0</b>	<b>-</b>
--	----------	--------------	--------------	--------------	--------------	--------------	----------

Material description

Test No 1 - 5 Clay Fill
-------------------------

A581HILF V1.10 OCT 09



This document is issued in accordance with NATA's accreditation requirements. Accredited for compliance with ISO/IEC 17025

Accreditation No 9909

Approved Signatory Justin Fry



## COMPACTION ASSESSMENT

Job No 11145  
 Report No 11145AB  
 Date Issued 30/04/11

**CIVIL GEOTECHNICAL SERVICES**

6 - 8 Rose Avenue, Croydon 3136

Client	WINSLOW CONSTRUCTORS PTY LTD (CAMPBELLFIELD)	Tested by	KC
Project	PASADENA - STAGE 5	Date tested	27/04/11
Location	CLYDE	Checked by	JHF

<b>Feature</b>	<b>EARTHWORKS</b>	Layer thickness	200 mm	Time: 10:34
----------------	-------------------	-----------------	--------	-------------

Test procedure AS 1289.2.1.1 & 5.8.1

Test No	6	7	8	9	10	-
Location	REFER TO FIGURE 1	REFER TO FIGURE 1	REFER TO FIGURE 1	REFER TO FIGURE 1	REFER TO FIGURE 1	
Approximate depth below FSL	-	-	-	-	-	-
Measurement depth <i>mm</i>	175	175	175	175	175	-
Field wet density <i>t/m<sup>3</sup></i>	1.75	1.75	1.76	1.73	1.78	-
Field moisture content <i>%</i>	42.0	40.5	39.0	40.8	38.4	-

Test procedure AS 1289.5.7.1

Test No	6	7	8	9	10	-
Compactive effort	Standard					
Oversize rock retained on sieve <i>mm</i>	19.0	19.0	19.0	19.0	19.0	-
Percent of oversize material <i>wet</i>	0	0	0	0	0	-
Peak Converted Wet Density <i>t/m<sup>3</sup></i>	1.75	1.72	1.71	1.74	1.77	-
Adjusted Peak Converted Wet Density <i>t/m<sup>3</sup></i>	-	-	-	-	-	-
Optimum Moisture Content <i>%</i>	39.5	39.5	38.0	39.0	36.0	-

Moisture Variation From Optimum Moisture Content	2.5% wet	1.0% wet	1.0% wet	1.5% wet	2.5% wet	-
--	----------	----------	----------	----------	----------	---

<b>Density Ratio ( <math>R_{HD}</math> )</b>	<b>%</b>	<b>100.0</b>	<b>101.5</b>	<b>103.0</b>	<b>99.5</b>	<b>101.0</b>	<b>-</b>
--	----------	--------------	--------------	--------------	-------------	--------------	----------

Material description

Test No 6 - 10 Clay Fill	
--------------------------	--

A581HILF V1.10 OCT 09



This document is issued in accordance with NATA's accreditation requirements. Accredited for compliance with ISO/IEC 17025

Accreditation No 9909

Approved Signatory Justin Fry





# COMPACTION ASSESSMENT

Job No 11145  
 Report No 11145AC  
 Date Issued 09/05/11

## CIVIL GEOTECHNICAL SERVICES

6 - 8 Rose Avenue, Croydon 3136

Client	WINSLOW CONSTRUCTORS PTY LTD (CAMPBELLFIELD)	Tested by	KC
Project	PASADENA - STAGE 5	Date tested	28/04/11
Location	CLYDE NORTH	Checked by	JHF

Feature	EARTHWORKS	Layer thickness	200 mm	Time: 13:29
---------	------------	-----------------	--------	-------------

Test procedure AS 1289.2.1.1 & 5.8.1

Test No	11	12	13	14	-	-
Location	REFER TO FIGURE 1	REFER TO FIGURE 1	REFER TO FIGURE 1	REFER TO FIGURE 1		
Approximate depth below FSL	-	-	-	-	-	-
Measurement depth	mm	175	175	175	175	-
Field wet density	t/m <sup>3</sup>	1.96	1.96	1.94	1.92	-
Field moisture content	%	21.7	19.8	23.4	24.6	-

Test procedure AS 1289.5.7.1

Test No	11	12	13	14	-	-
Compactive effort	Standard					
Oversize rock retained on sieve	mm	19.0	19.0	19.0	19.0	-
Percent of oversize material	wet	0	0	0	0	-
Peak Converted Wet Density	t/m <sup>3</sup>	1.91	1.99	1.93	1.92	-
Adjusted Peak Converted Wet Density	t/m <sup>3</sup>	-	-	-	-	-
Optimum Moisture Content	%	23.5	20.0	23.5	24.5	-

Moisture Variation From Optimum Moisture Content	2.0% dry	0.0%	0.0%	0.0%	-	-
--	----------	------	------	------	---	---

Density Ratio ( R <sub>HD</sub> )	%	102.5	98.5	100.5	100.0	-
-----------------------------------	---	-------	------	-------	-------	---

Material description

Test No 11 - 14 Clay Fill
---------------------------

A581HILF V1.10 OCT 09



This document is issued in accordance with NATA's accreditation requirements. Accredited for compliance with ISO/IEC 17025

Accreditation No 9909

Approved Signatory Justin Fry



# COMPACTION ASSESSMENT

Job No 11145  
 Report No 11145AD  
 Date Issued 09/05/11

## CIVIL GEOTECHNICAL SERVICES

6 - 8 Rose Avenue, Croydon 3136

Client	WINSLOW CONSTRUCTORS PTY LTD (CAMPBELLFIELD)	Tested by	KC
Project	PASADENA - STAGE 5	Date tested	29/04/11
Location	CLYDE NORTH	Checked by	JHF

Feature	EARTHWORKS	Layer thickness	200 mm	Time: 14:23
---------	------------	-----------------	--------	-------------

Test procedure AS 1289.2.1.1 & 5.8.1

Test No	15	16	17	18	19	-
Location	REFER TO FIGURE 1	REFER TO FIGURE 1	REFER TO FIGURE 1	REFER TO FIGURE 1	REFER TO FIGURE 1	
Approximate depth below FSL	-	-	-	-	-	-
Measurement depth	mm 175	175	175	175	175	-
Field wet density	t/m <sup>3</sup> 1.99	1.86	2.00	1.99	1.84	-
Field moisture content	% 16.6	26.3	20.2	17.3	27.1	-

Test procedure AS 1289.5.7.1

Test No	15	16	17	18	19	-
Compactive effort	Standard					
Oversize rock retained on sieve	mm 19.0	19.0	19.0	19.0	19.0	-
Percent of oversize material	wet 0	0	0	0	0	-
Peak Converted Wet Density	t/m <sup>3</sup> 1.99	1.90	1.96	1.99	1.85	-
Adjusted Peak Converted Wet Density	t/m <sup>3</sup> -	-	-	-	-	-
Optimum Moisture Content	% 19.0	25.5	22.5	19.0	26.5	-

Moisture Variation From Optimum Moisture Content	2.5% dry	0.5% wet	2.0% dry	1.5% dry	0.5% wet	-
--	----------	----------	----------	----------	----------	---

Density Ratio ( R <sub>HD</sub> )	%	100.0	98.0	102.5	100.0	99.5	-
-----------------------------------	---	-------	------	-------	-------	------	---

Material description

Test No 15 - 19 Clay Fill
---------------------------

A581HILF V1.10 OCT 09



This document is issued in accordance with NATA's accreditation requirements. Accredited for compliance with ISO/IEC 17025

Accreditation No 9909

*Justin Fry*  
 Approved Signatory Justin Fry



# COMPACTION ASSESSMENT

Job No 11145  
 Report No 11145AE  
 Date Issued 11/05/11

## CIVIL GEOTECHNICAL SERVICES

6 - 8 Rose Avenue, Croydon 3136

Client	WINSLOW CONSTRUCTORS PTY LTD (CAMPBELLFIELD)	Tested by	KC
Project	PASADENA - STAGE 5	Date tested	04/05/11
Location	CLYDE NORTH	Checked by	JHF

Feature	EARTHWORKS	Layer thickness	200 mm	Time: 11:05
---------	------------	-----------------	--------	-------------

Test procedure AS 1289.2.1.1 & 5.8.1

Test No	20	21	22	23	24	25
Location	REFER TO FIGURE 1	REFER TO FIGURE 1	REFER TO FIGURE 1	REFER TO FIGURE 1	REFER TO FIGURE 1	REFER TO FIGURE 1
Approximate depth below FSL	-	-	-	-	-	-
Measurement depth	mm	175	175	175	175	175
Field wet density	t/m <sup>3</sup>	1.88	1.67	1.75	1.77	1.83
Field moisture content	%	22.6	41.4	44.0	41.4	34.7

Test procedure AS 1289.5.7.1

Test No	20	21	22	23	24	25
Compactive effort	Standard					
Oversize rock retained on sieve	mm	19.0	19.0	19.0	19.0	19.0
Percent of oversize material	wet	0	0	0	0	0
Peak Converted Wet Density	t/m <sup>3</sup>	1.97	1.72	1.71	1.74	1.79
Adjusted Peak Converted Wet Density	t/m <sup>3</sup>	-	-	-	-	-
Optimum Moisture Content	%	22.5	40.0	44.0	40.0	33.5

Moisture Variation From Optimum Moisture Content	0.0%	1.5% wet	0.0%	1.5% wet	1.0% wet	0.0%
--	------	----------	------	----------	----------	------

Density Ratio ( R <sub>HD</sub> )	%	95.5	97.5	102.0	101.0	102.0	99.0
-----------------------------------	---	------	------	-------	-------	-------	------

Material description

Test No 20 - 25 Clay Fill
---------------------------

A581HILF V1.10 OCT 09



This document is issued in accordance with NATA's accreditation requirements. Accredited for compliance with ISO/IEC 17025

Accreditation No 9909

*Justin Fry*  
 Approved Signatory Justin Fry



# COMPACTION ASSESSMENT

Job No 11145  
 Report No 11145AF  
 Date Issued 13/05/11

## CIVIL GEOTECHNICAL SERVICES

6 - 8 Rose Avenue, Croydon 3136

Client	WINSLOW CONSTRUCTORS PTY LTD (CAMPBELLFIELD)	Tested by	KC
Project	PASADENA - STAGE 5	Date tested	05/05/11
Location	CLYDE NORTH	Checked by	JHF

Feature	EARTHWORKS	Layer thickness	200 mm	Time:	09:15
---------	------------	-----------------	--------	-------	-------

Test procedure AS 1289.2.1.1 & 5.8.1

Test No	26	27	28	29	30	31
Location	REFER TO FIGURE 1	REFER TO FIGURE 1	REFER TO FIGURE 1	REFER TO FIGURE 1	REFER TO FIGURE 1	REFER TO FIGURE 1
Approximate depth below FSL	-	-	-	-	-	-
Measurement depth	mm	175	175	175	175	175
Field wet density	t/m <sup>3</sup>	1.75	1.80	1.77	1.75	1.89
Field moisture content	%	42.3	41.0	42.3	42.3	26.3

Test procedure AS 1289.5.7.1

Test No	26	27	28	29	30	31
Compactive effort	Standard					
Oversize rock retained on sieve	mm	19.0	19.0	19.0	19.0	19.0
Percent of oversize material	wet	0	0	0	0	0
Peak Converted Wet Density	t/m <sup>3</sup>	1.76	1.82	1.83	1.76	1.86
Adjusted Peak Converted Wet Density	t/m <sup>3</sup>	-	-	-	-	-
Optimum Moisture Content	%	40.0	38.5	40.5	40.0	24.0

Moisture Variation From Optimum Moisture Content	2.5% wet	2.5% wet	1.5% wet	2.5% wet	2.5% wet	1.5% wet
--	----------	----------	----------	----------	----------	----------

Density Ratio ( R <sub>HD</sub> )	%	99.0	99.0	97.0	99.5	102.0	101.5
-----------------------------------	---	------	------	------	------	-------	-------

Material description

Test No 26 - 31 Clay Fill
---------------------------

A581HILF V1.10 OCT 09



This document is issued in accordance with NATA's accreditation requirements. Accredited for compliance with ISO/IEC 17025

Accreditation No 9909

*Justin Fry*  
 Approved Signatory Justin Fry



## COMPACTION ASSESSMENT

Job No 11145  
 Report No 11145AG  
 Date Issued 05/05/11

**CIVIL GEOTECHNICAL SERVICES**

6 - 8 Rose Avenue, Croydon 3136

Client	WINSLOW CONSTRUCTORS PTY LTD (CAMPBELLFIELD)	Tested by	KC
Project	PASADENA - STAGE 5	Date tested	05/05/11
Location	CLYDE NORTH	Checked by	JHF

<b>Feature</b>	EARTHWORKS	Layer thickness	200 mm	Time: 10:30
----------------	------------	-----------------	--------	-------------

Test procedure AS 1289.2.1.1 & 5.8.1

Test No	32	33	-	-	-	-
Location	REFER TO FIGURE 1	REFER TO FIGURE 1				
Approximate depth below FSL	-	-	-	-	-	-
Measurement depth <i>mm</i>	175	175	-	-	-	-
Field wet density <i>t/m<sup>3</sup></i>	1.99	1.78	-	-	-	-
Field moisture content <i>%</i>	25.0	37.6	-	-	-	-

Test procedure AS 1289.5.7.1

Test No	32	33	-	-	-	-
Compactive effort	Standard					
Oversize rock retained on sieve <i>mm</i>	19.0	19.0	-	-	-	-
Percent of oversize material <i>wet</i>	0	0	-	-	-	-
Peak Converted Wet Density <i>t/m<sup>3</sup></i>	1.92	1.78	-	-	-	-
Adjusted Peak Converted Wet Density <i>t/m<sup>3</sup></i>	-	-	-	-	-	-
Optimum Moisture Content <i>%</i>	24.5	35.0	-	-	-	-

Moisture Variation From Optimum Moisture Content	0.5% wet	2.5% wet	-	-	-	-
--	-------------	-------------	---	---	---	---

Density Ratio ( $R_{HD}$ ) <i>%</i>	<b>103.5</b>	<b>100.0</b>	-	-	-	-
-------------------------------------	--------------	--------------	---	---	---	---

Material description

Test No 32 - 33 Clay Fill
---------------------------

A581HILF V1.10 OCT 09



This document is issued in accordance with NATA's accreditation requirements. Accredited for compliance with ISO/IEC 17025

Accreditation No 9909

Approved Signatory Justin Fry



# COMPACTION ASSESSMENT

Job No 11145  
 Report No 11145AH  
 Date Issued 17/05/11

## CIVIL GEOTECHNICAL SERVICES

6 - 8 Rose Avenue, Croydon 3136

Client	WINSLOW CONSTRUCTORS PTY LTD (CAMPBELLFIELD)	Tested by	KC
Project	PASADENA - STAGE 5	Date tested	06/05/11
Location	CLYDE NORTH	Checked by	JHF

Feature	EARTHWORKS	Layer thickness	200 mm	Time: 14:27
---------	------------	-----------------	--------	-------------

Test procedure AS 1289.2.1.1 & 5.8.1

Test No	34	35	-	-	-	-
Location	REFER TO FIGURE 1	REFER TO FIGURE 1				
Approximate depth below FSL	-	-	-	-	-	-
Measurement depth	mm	175	175	-	-	-
Field wet density	t/m <sup>3</sup>	1.83	1.84	-	-	-
Field moisture content	%	35.5	31.5	-	-	-

Test procedure AS 1289.5.7.1

Test No	34	35	-	-	-	-
Compactive effort	Standard					
Oversize rock retained on sieve	mm	19.0	19.0	-	-	-
Percent of oversize material	wet	0	0	-	-	-
Peak Converted Wet Density	t/m <sup>3</sup>	1.73	1.83	-	-	-
Adjusted Peak Converted Wet Density	t/m <sup>3</sup>	-	-	-	-	-
Optimum Moisture Content	%	33.5	29.5	-	-	-

Moisture Variation From Optimum Moisture Content	2.0% wet	2.0% wet	-	-	-	-
--	----------	----------	---	---	---	---

Density Ratio ( R <sub>HD</sub> )	%	105.5	100.5	-	-	-
-----------------------------------	---	-------	-------	---	---	---

Material description

Test No 34 - 35 Clay Fill
---------------------------

A581HILF V1.10 OCT 09



This document is issued in accordance with NATA's accreditation requirements. Accredited for compliance with ISO/IEC 17025

Accreditation No 9909

*Justin Fry*  
 Approved Signatory Justin Fry



# COMPACTION ASSESSMENT

Job No 11189  
 Report No 11189AA  
 Date Issued 16/05/11

## CIVIL GEOTECHNICAL SERVICES

6 - 8 Rose Avenue, Croydon 3136

Client	WINSLOW CONSTRUCTORS PTY LTD (CAMPBELLFIELD)	Tested by	KC
Project	PASADENA - STAGE 5	Date tested	06/05/11
Location	CLYDE NORTH	Checked by	JHF

Feature	EARTHWORKS	Layer thickness	200 mm	Time: 11:57
---------	------------	-----------------	--------	-------------

Test procedure AS 1289.2.1.1 & 5.8.1

Test No	1	2	3	4	-	-
Location	REFER TO FIGURE 1	REFER TO FIGURE 1	REFER TO FIGURE 1	REFER TO FIGURE 1		
Approximate depth below FSL	-	-	-	-	-	-
Measurement depth	mm	175	175	175	175	-
Field wet density	t/m <sup>3</sup>	1.88	1.74	1.83	1.93	-
Field moisture content	%	27.8	38.2	35.5	30.7	-

Test procedure AS 1289.5.7.1

Test No	1	2	3	4	-	-
Compactive effort	Standard					
Oversize rock retained on sieve	mm	19.0	19.0	19.0	19.0	-
Percent of oversize material	wet	0	0	0	0	-
Peak Converted Wet Density	t/m <sup>3</sup>	1.87	1.71	1.79	1.92	-
Adjusted Peak Converted Wet Density	t/m <sup>3</sup>	-	-	-	-	-
Optimum Moisture Content	%	27.0	37.0	33.5	29.0	-

Moisture Variation From Optimum Moisture Content	1.0% wet	1.0% wet	2.0% wet	2.0% wet	-	-
--	----------	----------	----------	----------	---	---

Density Ratio ( R <sub>HD</sub> )	%	100.5	101.5	102.0	100.5	-
-----------------------------------	---	-------	-------	-------	-------	---

Material description

Test No 1 - 4 Clay Fill
-------------------------

A581HILF V1.10 OCT 09



This document is issued in accordance with NATA's accreditation requirements. Accredited for compliance with ISO/IEC 17025

Accreditation No 9909

*Justin Fry*  
 Approved Signatory Justin Fry



## COMPACTION ASSESSMENT

Job No 11189  
 Report No 11189AB  
 Date Issued 18/05/11

**CIVIL GEOTECHNICAL SERVICES**

6 - 8 Rose Avenue, Croydon 3136

Client	WINSLOW CONSTRUCTORS PTY LTD (CAMPBELLFIELD)	Tested by	KC
Project	PASADENA - STAGE 5	Date tested	10/05/11
Location	CLYDE NORTH	Checked by	JHF

<b>Feature</b>	EARTHWORKS	Layer thickness	200 mm	Time: 10:02
----------------	------------	-----------------	--------	-------------

Test procedure AS 1289.2.1.1 & 5.8.1

Test No	5	6	7	8	-	-
Location	REFER TO FIGURE 1	REFER TO FIGURE 1	REFER TO FIGURE 1	REFER TO FIGURE 1		
Approximate depth below FSL	-	-	-	-	-	-
Measurement depth <i>mm</i>	175	175	175	175	-	-
Field wet density <i>t/m<sup>3</sup></i>	1.79	1.81	1.81	1.73	-	-
Field moisture content <i>%</i>	41.5	43.5	40.9	40.4	-	-

Test procedure AS 1289.5.7.1

Test No	5	6	7	8	-	-
Compactive effort	Standard					
Oversize rock retained on sieve <i>mm</i>	19.0	19.0	19.0	19.0	-	-
Percent of oversize material <i>wet</i>	0	0	0	0	-	-
Peak Converted Wet Density <i>t/m<sup>3</sup></i>	1.80	1.82	1.82	1.77	-	-
Adjusted Peak Converted Wet Density <i>t/m<sup>3</sup></i>	-	-	-	-	-	-
Optimum Moisture Content <i>%</i>	39.5	41.0	39.0	38.5	-	-

Moisture Variation From Optimum Moisture Content	2.0% wet	2.5% wet	2.0% wet	1.5% wet	-	-
--	----------	----------	----------	----------	---	---

<b>Density Ratio ( <math>R_{HD}</math> )</b>	<b>%</b>	<b>99.5</b>	<b>99.5</b>	<b>99.0</b>	<b>98.0</b>	<b>-</b>	<b>-</b>
--	----------	-------------	-------------	-------------	-------------	----------	----------

Material description

Test No 5 - 8 Clay Fill
-------------------------

A581HILF V1.10 OCT 09



This document is issued in accordance with NATA's accreditation requirements. Accredited for compliance with ISO/IEC 17025

Accreditation No 9909

Approved Signatory Justin Fry





# COMPACTION ASSESSMENT

Job No 11370  
 Report No 11370AA  
 Date Issued 07/10/11

## CIVIL GEOTECHNICAL SERVICES

6 - 8 Rose Avenue, Croydon 3136

Client	WINSLOW CONSTRUCTORS PTY LTD (CAMPBELLFIELD)	Tested by	TG
Project	PASADENA - STAGE 5	Date tested	03/10/11
Location	CLYDE	Checked by	JHF

Feature	EARTHWORKS	Layer thickness	200 mm	Time: 13:15
---------	------------	-----------------	--------	-------------

### Test procedure AS 1289.2.1.1 & 5.8.1

Test No	1	2	3	-	-	-
Location	REFER TO FIGURE 1	REFER TO FIGURE 1	REFER TO FIGURE 1			
Approximate depth below FSL	-	-	-	-	-	-
Measurement depth	mm	175	175	175	-	-
Field wet density	t/m <sup>3</sup>	1.83	1.77	1.76	-	-
Field moisture content	%	30.4	38.7	39.5	-	-

### Test procedure AS 1289.5.7.1

Test No	1	2	3	-	-	-
Compactive effort	Standard					
Oversize rock retained on sieve	mm	19.0	19.0	19.0	-	-
Percent of oversize material	wet	0	0	0	-	-
Peak Converted Wet Density	t/m <sup>3</sup>	1.87	1.71	1.77	-	-
Adjusted Peak Converted Wet Density	t/m <sup>3</sup>	-	-	-	-	-
Optimum Moisture Content	%	29.5	38.0	38.5	-	-

Moisture Variation From Optimum Moisture Content	1.0% wet	1.0% wet	1.0% wet	-	-	-
--	----------	----------	----------	---	---	---

Density Ratio ( R <sub>HD</sub> )	%	98.0	104.0	99.5	-	-
-----------------------------------	---	------	-------	------	---	---

### Material description

Test No 1 - 3 Clay Fill
-------------------------

A581HILF V1.10 OCT 09



This document is issued in accordance with NATA's accreditation requirements. Accredited for compliance with ISO/IEC 17025  
 Accreditation No 9909

Approved Signatory: Justin Fry



# COMPACTION ASSESSMENT

Job No 11370  
 Report No 11370AB  
 Date Issued 07/10/11

## CIVIL GEOTECHNICAL SERVICES

6 - 8 Rose Avenue, Croydon 3136

Client	WINSLOW CONSTRUCTORS PTY LTD (CAMPBELLFIELD)	Tested by	JHF
Project	PASADENA - STAGE 5	Date tested	04/10/11
Location	CLYDE	Checked by	JHF

Feature	EARTHWORKS	Layer thickness	200 mm	Time: 10:51
---------	------------	-----------------	--------	-------------

Test procedure AS 1289.2.1.1 & 5.8.1

Test No	4	5	6	-	-	-
Location	REFER TO FIGURE 1	REFER TO FIGURE 1	REFER TO FIGURE 1			
Approximate depth below FSL	-	-	-	-	-	-
Measurement depth	mm	175	175	175	-	-
Field wet density	t/m <sup>3</sup>	1.72	1.85	1.93	-	-
Field moisture content	%	34.0	29.8	26.3	-	-

Test procedure AS 1289.5.7.1

Test No	4	5	6	-	-	-
Compactive effort	Standard					
Oversize rock retained on sieve	mm	19.0	19.0	19.0	-	-
Percent of oversize material	wet	0	0	0	-	-
Peak Converted Wet Density	t/m <sup>3</sup>	1.81	1.95	1.98	-	-
Adjusted Peak Converted Wet Density	t/m <sup>3</sup>	-	-	-	-	-
Optimum Moisture Content	%	33.0	30.5	27.0	-	-

Moisture Variation From Optimum Moisture Content	1.0% wet	0.5% dry	1.0% dry	-	-	-
--	----------	----------	----------	---	---	---

Density Ratio ( R <sub>HD</sub> )	%	95.0	95.0	97.5	-	-
-----------------------------------	---	------	------	------	---	---

Material description

Test No 4 - 6 Clay Fill
-------------------------



This document is issued in accordance with NATA's accreditation requirements. Accredited for compliance with ISO/IEC 17025  
 Accreditation No 9909

Approved Signatory: Justin Fry



# COMPACTION ASSESSMENT

Job No 11370  
 Report No 11370AC  
 Date Issued 07/10/11

## CIVIL GEOTECHNICAL SERVICES

6 - 8 Rose Avenue, Croydon 3136

Client	WINSLOW CONSTRUCTORS PTY LTD (CAMPBELLFIELD)	Tested by	TG
Project	PASADENA - STAGE 5	Date tested	05/10/11
Location	CLYDE	Checked by	JHF

Feature	EARTHWORKS	Layer thickness	200 mm	Time: 09:10
---------	------------	-----------------	--------	-------------

Test procedure AS 1289.2.1.1 & 5.8.1

Test No	7	8	9	-	-	-
Location	REFER TO FIGURE 1	REFER TO FIGURE 1	REFER TO FIGURE 1			
Approximate depth below FSL	-	-	-	-	-	-
Measurement depth	mm	175	175	175	-	-
Field wet density	t/m <sup>3</sup>	1.90	1.89	1.97	-	-
Field moisture content	%	21.9	22.2	22.6	-	-

Test procedure AS 1289.5.7.1

Test No	7	8	9	-	-	-
Compactive effort	Standard					
Oversize rock retained on sieve	mm	19.0	19.0	19.0	-	-
Percent of oversize material	wet	0	0	0	-	-
Peak Converted Wet Density	t/m <sup>3</sup>	2.00	1.98	2.04	-	-
Adjusted Peak Converted Wet Density	t/m <sup>3</sup>	-	-	-	-	-
Optimum Moisture Content	%	21.0	22.0	24.5	-	-

Moisture Variation From Optimum Moisture Content	0.5% wet	0.5% wet	2.0% dry	-	-	-
--	----------	----------	----------	---	---	---

Density Ratio ( R <sub>HD</sub> )	%	95.0	95.5	96.5	-	-
-----------------------------------	---	------	------	------	---	---

Material description

Test No 7 - 9 Clay Fill
-------------------------

A581HILF V1.10 OCT 09



This document is issued in accordance with NATA's accreditation requirements. Accredited for compliance with ISO/IEC 17025

Accreditation No 9909

Approved Signatory: Justin Fry



# COMPACTION ASSESSMENT

Job No 11370  
 Report No 11370AD  
 Date Issued 11/10/11

## CIVIL GEOTECHNICAL SERVICES

6 - 8 Rose Avenue, Croydon 3136

Client	WINSLOW CONSTRUCTORS PTY LTD (CAMPBELLFIELD)	Tested by	JHF
Project	PASADENA - STAGE 5	Date tested	06/10/11
Location	CLYDE	Checked by	JHF

Feature	EARTHWORKS	Layer thickness	200 mm	Time: 12:44
---------	------------	-----------------	--------	-------------

Test procedure AS 1289.2.1.1 & 5.8.1

Test No	10	11	12	-	-	-
Location	REFER TO FIGURE 1	REFER TO FIGURE 1	REFER TO FIGURE 1			
Approximate depth below FSL	-	-	-	-	-	-
Measurement depth	mm	175	175	175	-	-
Field wet density	t/m <sup>3</sup>	1.99	1.98	2.01	-	-
Field moisture content	%	21.5	24.9	21.5	-	-

Test procedure AS 1289.5.7.1

Test No	10	11	12	-	-	-
Compactive effort	Standard					
Oversize rock retained on sieve	mm	19.0	19.0	19.0	-	-
Percent of oversize material	wet	0	0	0	-	-
Peak Converted Wet Density	t/m <sup>3</sup>	2.05	1.97	2.01	-	-
Adjusted Peak Converted Wet Density	t/m <sup>3</sup>	-	-	-	-	-
Optimum Moisture Content	%	19.5	24.5	21.0	-	-

Moisture Variation From Optimum Moisture Content	2.0% wet	0.5% wet	0.5% wet	-	-	-
--	----------	----------	----------	---	---	---

Density Ratio ( R <sub>HD</sub> )	%	97.0	100.5	100.0	-	-
-----------------------------------	---	------	-------	-------	---	---

Material description

Test No 10 - 12 Clay Fill
---------------------------

A581HILF V1.10 OCT 09



This document is issued in accordance with NATA's accreditation requirements. Accredited for compliance with ISO/IEC 17025

Accreditation No 9909

Approved Signatory: Justin Fry



# COMPACTION ASSESSMENT

Job No 11370  
 Report No 11370AE  
 Date Issued 13/10/11

## CIVIL GEOTECHNICAL SERVICES

6 - 8 Rose Avenue, Croydon 3136

Client	WINSLOW CONSTRUCTORS PTY LTD (CAMPBELLFIELD)	Tested by	JHF
Project	PASADENA - STAGE 5	Date tested	11/10/11
Location	CLYDE	Checked by	JHF

Feature	EARTHWORKS	Layer thickness	200 mm	Time: 13:44
---------	------------	-----------------	--------	-------------

Test procedure AS 1289.2.1.1 & 5.8.1

Test No	13	14	15	-	-	-
Location	REFER TO FIGURE 1	REFER TO FIGURE 1	REFER TO FIGURE 1			
Approximate depth below FSL	-	-	-	-	-	-
Measurement depth	mm	175	175	175	-	-
Field wet density	t/m <sup>3</sup>	1.90	1.92	1.92	-	-
Field moisture content	%	29.0	28.8	29.5	-	-

Test procedure AS 1289.5.7.1

Test No	13	14	15	-	-	-
Compactive effort	Standard					
Oversize rock retained on sieve	mm	19.0	19.0	19.0	-	-
Percent of oversize material	wet	0	0	0	-	-
Peak Converted Wet Density	t/m <sup>3</sup>	1.90	1.95	1.95	-	-
Adjusted Peak Converted Wet Density	t/m <sup>3</sup>	-	-	-	-	-
Optimum Moisture Content	%	28.0	27.0	28.5	-	-

Moisture Variation From Optimum Moisture Content	1.0% wet	2.0% wet	0.5% wet	-	-	-
--	----------	----------	----------	---	---	---

Density Ratio ( R <sub>HD</sub> )	%	100.5	98.5	98.5	-	-
-----------------------------------	---	-------	------	------	---	---

Material description

Test No 13 - 15 Clay Fill
---------------------------



This document is issued in accordance with NATA's accreditation requirements. Accredited for compliance with ISO/IEC 17025

Accreditation No 9909

Approved Signatory: Justin Fry



# COMPACTION ASSESSMENT

Job No 11370  
 Report No 11370AF  
 Date Issued 28/10/11

## CIVIL GEOTECHNICAL SERVICES

6 - 8 Rose Avenue, Croydon 3136

Client	WINSLOW CONSTRUCTORS PTY LTD (CAMPBELLFIELD)	Tested by	JHF
Project	PASADENA - STAGE 5	Date tested	12/10/11
Location	CLYDE	Checked by	JHF

Feature	EARTHWORKS	Layer thickness	200 mm	Time: 13:50
---------	------------	-----------------	--------	-------------

Test procedure AS 1289.2.1.1 & 5.8.1

Test No	16	17	18	-	-	-
Location	REFER TO FIGURE 1	REFER TO FIGURE 1	REFER TO FIGURE 1			
Approximate depth below FSL	-	-	-	-	-	-
Measurement depth	mm	175	175	175	-	-
Field wet density	t/m <sup>3</sup>	1.97	1.89	2.03	-	-
Field moisture content	%	25.3	32.0	19.4	-	-

Test procedure AS 1289.5.7.1

Test No	16	17	18	-	-	-
Compactive effort	Standard					
Oversize rock retained on sieve	mm	19.0	19.0	19.0	-	-
Percent of oversize material	wet	0	0	0	-	-
Peak Converted Wet Density	t/m <sup>3</sup>	1.95	1.93	2.05	-	-
Adjusted Peak Converted Wet Density	t/m <sup>3</sup>	-	-	-	-	-
Optimum Moisture Content	%	23.5	32.0	19.0	-	-

Moisture Variation From Optimum Moisture Content	1.5% wet	0.0%	0.5% wet	-	-	-
--	----------	------	----------	---	---	---

Density Ratio ( R <sub>HD</sub> )	%	101.0	98.0	99.0	-	-
-----------------------------------	---	-------	------	------	---	---

Material description

Test No 16 - 18 Clay Fill
---------------------------

A581HILF V1.10 OCT 09



This document is issued in accordance with NATA's accreditation requirements. Accredited for compliance with ISO/IEC 17025  
 Accreditation No 9909

Approved Signatory: Justin Fry



# COMPACTION ASSESSMENT

Job No 11370  
 Report No 11370AG  
 Date Issued 28/10/11

## CIVIL GEOTECHNICAL SERVICES

6 - 8 Rose Avenue, Croydon 3136

Client	WINSLOW CONSTRUCTORS PTY LTD (CAMPBELLFIELD)	Tested by	TG
Project	PASADENA - STAGE 5	Date tested	13/10/11
Location	CLYDE	Checked by	JHF

Feature	EARTHWORKS	Layer thickness	200 mm	Time: 14:15
---------	------------	-----------------	--------	-------------

Test procedure AS 1289.2.1.1 & 5.8.1

Test No	19	20	21	-	-	-
Location	REFER TO FIGURE 1	REFER TO FIGURE 1	REFER TO FIGURE 1			
Approximate depth below FSL	-	-	-	-	-	-
Measurement depth	mm	175	175	175	-	-
Field wet density	t/m <sup>3</sup>	1.90	1.89	1.89	-	-
Field moisture content	%	25.7	26.9	27.8	-	-

Test procedure AS 1289.5.7.1

Test No	19	20	21	-	-	-
Compactive effort	Standard					
Oversize rock retained on sieve	mm	19.0	19.0	19.0	-	-
Percent of oversize material	wet	0	0	0	-	-
Peak Converted Wet Density	t/m <sup>3</sup>	1.97	1.93	1.93	-	-
Adjusted Peak Converted Wet Density	t/m <sup>3</sup>	-	-	-	-	-
Optimum Moisture Content	%	24.0	26.5	26.0	-	-

Moisture Variation From Optimum Moisture Content	1.5% wet	0.5% wet	1.5% wet	-	-	-
--	----------	----------	----------	---	---	---

Density Ratio ( R <sub>HD</sub> )	%	96.5	98.5	98.0	-	-
-----------------------------------	---	------	------	------	---	---

Material description

Test No 19 - 21 Clay Fill
---------------------------

A581HILF V1.10 OCT 09



This document is issued in accordance with NATA's accreditation requirements. Accredited for compliance with ISO/IEC 17025

Accreditation No 9909

Approved Signatory: Justin Fry



# COMPACTION ASSESSMENT

Job No 11370  
 Report No 11370AH  
 Date Issued 28/10/11

## CIVIL GEOTECHNICAL SERVICES

6 - 8 Rose Avenue, Croydon 3136

Client	WINSLOW CONSTRUCTORS PTY LTD (CAMPBELLFIELD)	Tested by	JHF
Project	PASADENA - STAGE 5	Date tested	14/10/11
Location	CLYDE	Checked by	JHF

Feature	EARTHWORKS	Layer thickness	200 mm	Time: 12:27
---------	------------	-----------------	--------	-------------

Test procedure AS 1289.2.1.1 & 5.8.1

Test No	22	23	24	25	-	-
Location	REFER TO FIGURE 1	REFER TO FIGURE 1	REFER TO FIGURE 1	REFER TO FIGURE 1		
Approximate depth below FSL	-	-	-	-	-	-
Measurement depth	mm 175	175	175	175	-	-
Field wet density	t/m <sup>3</sup> 1.92	1.95	1.95	1.91	-	-
Field moisture content	% 27.2	15.9	23.8	24.7	-	-

Test procedure AS 1289.5.7.1

Test No	22	23	24	25	-	-
Compactive effort	Standard					
Oversize rock retained on sieve	mm 19.0	19.0	19.0	19.0	-	-
Percent of oversize material	wet 0	0	0	0	-	-
Peak Converted Wet Density	t/m <sup>3</sup> 1.92	2.04	1.93	1.95	-	-
Adjusted Peak Converted Wet Density	t/m <sup>3</sup> -	-	-	-	-	-
Optimum Moisture Content	% 26.5	16.0	23.5	24.5	-	-

Moisture Variation From Optimum Moisture Content	0.5% wet	0.0%	0.5% wet	0.0%	-	-
--	----------	------	----------	------	---	---

Density Ratio ( R <sub>HD</sub> )	% 100.0	95.5	101.0	98.0	-	-
-----------------------------------	---------	------	-------	------	---	---

Material description

Test No 22 - 25 Clay Fill
---------------------------

A581HILF V1.10 OCT 09



This document is issued in accordance with NATA's accreditation requirements. Accredited for compliance with ISO/IEC 17025

Accreditation No 9909

Approved Signatory: Justin Fry





# COMPACTION ASSESSMENT

Job No 11370  
 Report No 11370AI  
 Date Issued 28/10/11

## CIVIL GEOTECHNICAL SERVICES

6 - 8 Rose Avenue, Croydon 3136

Client	WINSLOW CONSTRUCTORS PTY LTD (CAMPBELLFIELD)	Tested by	KC
Project	PASADENA - STAGE 5	Date tested	17/10/11
Location	CLYDE	Checked by	JHF

Feature	EARTHWORKS	Layer thickness	200 mm	Time: 15:05
---------	------------	-----------------	--------	-------------

Test procedure AS 1289.2.1.1 & 5.8.1

Test No	26	27	28	-	-	-
Location	REFER TO FIGURE 1	REFER TO FIGURE 1	REFER TO FIGURE 1			
Approximate depth below FSL	-	-	-	-	-	-
Measurement depth	mm	175	175	175	-	-
Field wet density	t/m <sup>3</sup>	1.80	1.91	2.00	-	-
Field moisture content	%	31.5	17.9	17.6	-	-

Test procedure AS 1289.5.7.1

Test No	26	27	28	-	-	-
Compactive effort	Standard					
Oversize rock retained on sieve	mm	19.0	19.0	19.0	-	-
Percent of oversize material	wet	0	0	0	-	-
Peak Converted Wet Density	t/m <sup>3</sup>	1.86	2.01	2.02	-	-
Adjusted Peak Converted Wet Density	t/m <sup>3</sup>	-	-	-	-	-
Optimum Moisture Content	%	31.0	18.0	18.0	-	-

Moisture Variation From Optimum Moisture Content	0.5% wet	0.5% dry	0.5% dry	-	-	-
--	----------	----------	----------	---	---	---

Density Ratio ( R <sub>HD</sub> )	%	97.0	95.0	99.0	-	-
-----------------------------------	---	------	------	------	---	---

Material description

Test No 26 - 28 Clay Fill
---------------------------

A581HILF V1.10 OCT 09



This document is issued in accordance with NATA's accreditation requirements. Accredited for compliance with ISO/IEC 17025  
 Accreditation No 9909

Approved Signatory: Justin Fry



# COMPACTION ASSESSMENT

Job No 11370  
 Report No 11370AJ  
 Date Issued 31/10/11

## CIVIL GEOTECHNICAL SERVICES

6 - 8 Rose Avenue, Croydon 3136

Client	WINSLOW CONSTRUCTORS PTY LTD (CAMPBELLFIELD)	Tested by	KC
Project	PASADENA - STAGES 5, 8 AND 9	Date tested	19/10/11
Location	CLYDE	Checked by	JHF

Feature	EARTHWORKS	Layer thickness	200 mm	Time:	11:39
---------	------------	-----------------	--------	-------	-------

### Test procedure AS 1289.2.1.1 & 5.8.1

Test No	29	30	31	32	-	-
Location	REFER TO FIGURE 1	REFER TO FIGURE 1	REFER TO FIGURE 1	REFER TO FIGURE 1		
Approximate depth below FSL	-	-	-	-	-	-
Measurement depth	mm	175	175	175	175	-
Field wet density	t/m <sup>3</sup>	1.92	1.89	1.94	1.96	-
Field moisture content	%	11.0	12.6	13.1	12.8	-

### Test procedure AS 1289.5.7.1

Test No	29	30	31	32	-	-
Compactive effort	Standard					
Oversize rock retained on sieve	mm	19.0	19.0	19.0	19.0	-
Percent of oversize material	wet	0	0	0	0	-
Peak Converted Wet Density	t/m <sup>3</sup>	1.99	1.96	2.05	2.06	-
Adjusted Peak Converted Wet Density	t/m <sup>3</sup>	-	-	-	-	-
Optimum Moisture Content	%	13.0	14.0	14.5	14.5	-

Moisture Variation From Optimum Moisture Content	2.0% dry	1.5% dry	1.5% dry	2.0% dry	-	-
--	----------	----------	----------	----------	---	---

Density Ratio ( R <sub>HD</sub> )	%	96.5	96.0	95.0	95.0	-
-----------------------------------	---	------	------	------	------	---

### Material description

Test No 29 - 32 Clay Fill
---------------------------



This document is issued in accordance with NATA's accreditation requirements. Accredited for compliance with ISO/IEC 17025

Accreditation No 9909

Approved Signatory: Justin Fry