

**ARMSTRONG Mt DUNED**  
**BUILDING ENVELOPE PLAN**  
**STAGE 4**

June 2013  
 Version:F

Detailed design of roads, driveways and footpaths is provided in the relevant Engineering Plans.

Detailed design of landscape works is provided in the relevant Landscape Plans.

All details subject to City of Greater Geelong Council approval.

This version of the building envelope plan corresponds with version B of the Plan of Subdivision for stage 4.

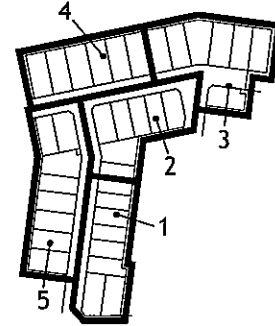
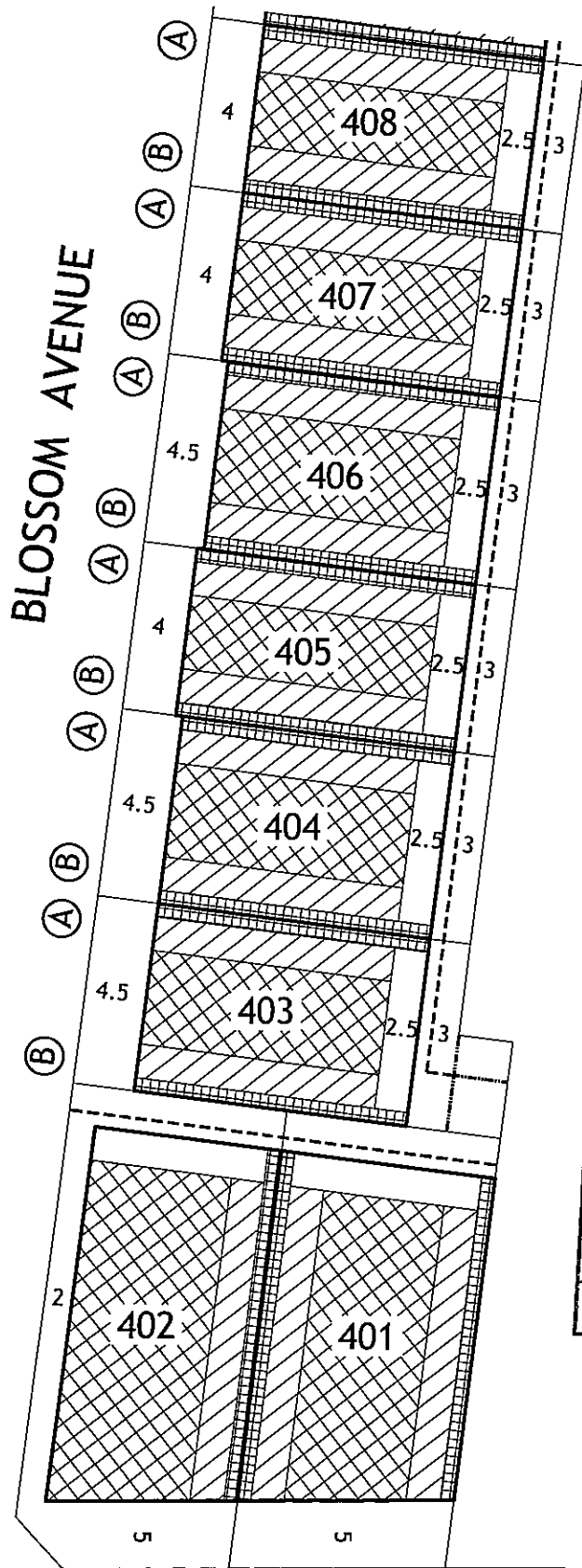

**KEY TO SHEETS**

**NOTATIONS**

- Single Storey Building Envelope (height not exceeding 3.6m)
- Overlooking Zone - Habitable room windows/raised open spaces are a source of overlooking
- Non Overlooking Zone - Habitable room windows/raised open spaces are not a source of overlooking
- Building to Boundary Zone
- Building Envelope Boundary Profile Type
- 2 metre wide easement
- 3 metre wide easement

- 401 Lot number
- 3 Setback minimum required (if 0, a building can be constructed on the boundary provided that the building height and length requirements are met)

PLANNING & ENVIRONMENT DEPARTMENT  
 CITY OF GREATER GEELONG PLANNING SCHEME  
 Amended Plan Endorsed  
 under Condition .....6..... of  
 Permit No. 2012-0018 dated 19.09.2013  
 This Building Envelope Plan is to be read in conjunction with the associated Building Envelope Profiles and Design Code.  
 The registered proprietors of the lot are required to build in accordance with building envelopes shown hereon and in the "Profile Diagrams" in sheet 6.  
 Signed [Signature] For and on behalf of the Council of the City of Greater Geelong  
 Date 01/08/2013  
 Sheet No. 5 of 7 sheets







SCALE OF METRES

**ARMSTRONG Mt DUNED**  
**BUILDING ENVELOPE PLAN**  
**STAGE 4**

**4 / 1**  
 stage sheet

**ARMSTRONG BOULEVARD**

**NOTATIONS**

-  Single Storey Building Envelope (height not exceeding 3.6m)
-  Overlooking Zone - Habitable room windows/raised open spaces are a source of overlooking
-  Non Overlooking Zone - Habitable room windows/raised open spaces are not a source of overlooking
-  Building to Boundary Zone
-  Building Envelope Boundary Profile Type
-  2 metre wide easement
-  3 metre wide easement
- 401 Lot number
- 3 Setback minimum required (if 0, a building can be constructed on the boundary provided that the building height and length requirements are met)

This Building Envelope Plan is to be read in conjunction with the associated Building Envelope Profiles and Design Guidelines. The registered proprietors of the lot are required to build in accordance with building envelopes shown hereon and in the "Profile Diagrams" in sheet 6.

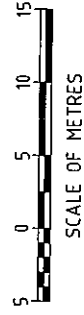

**ARMSTRONG Mt DUNEED**  
**BUILDING ENVELOPE PLAN**  
**STAGE 4**

**4/2**  
 stage sheet

Sheet 2 of 6  
 June 2013  
 Version: F

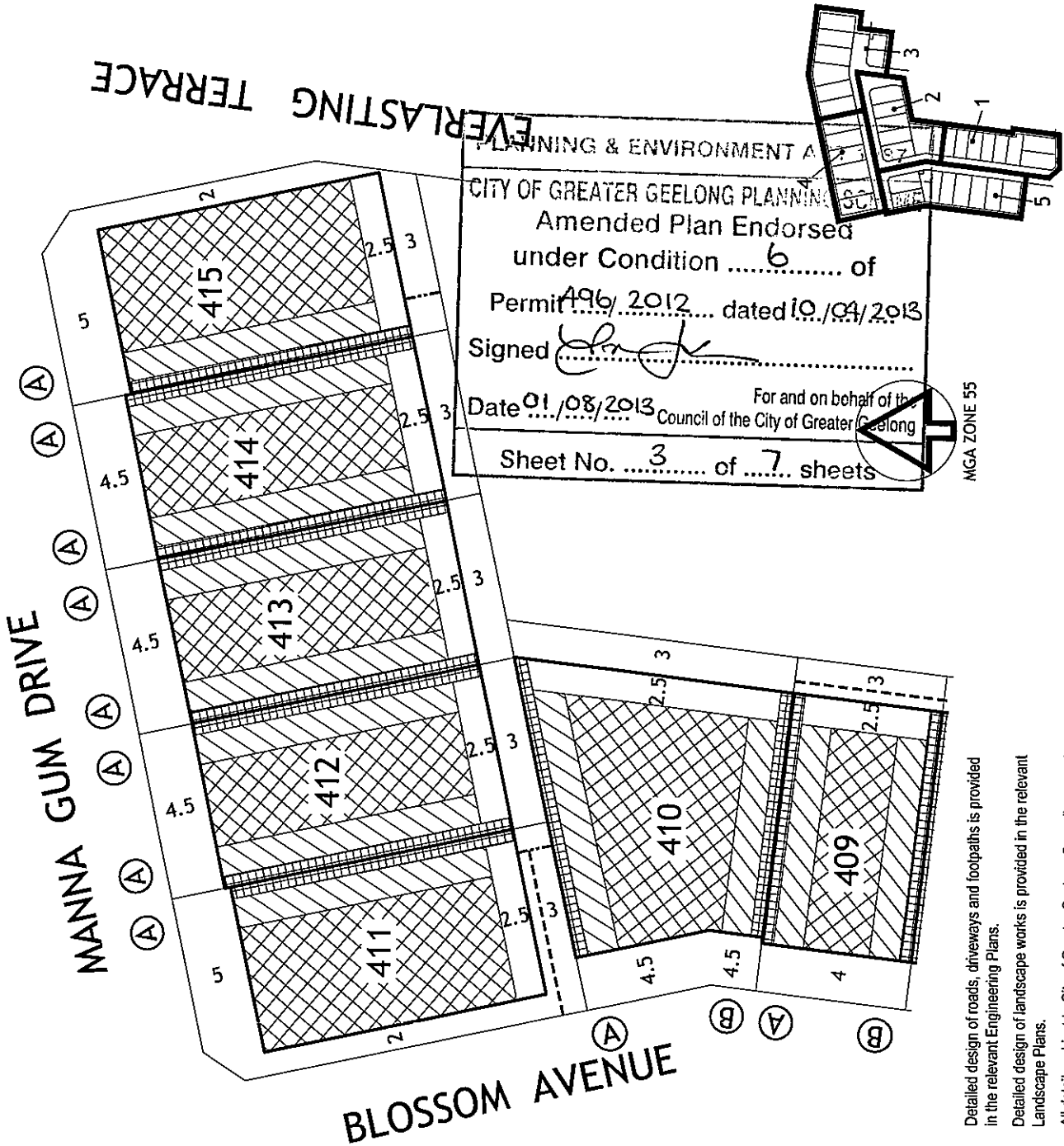

**KEY TO SHEETS**

Detailed design of roads, driveways and footpaths is provided in the relevant Engineering Plans.  
 Detailed design of landscape works is provided in the relevant Landscape Plans.  
 All details subject to City of Greater Geelong Council approval.  
 This version of the building envelope plan corresponds with version B of the Plan of Subdivision for stage 4.

**NOTATIONS**

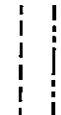
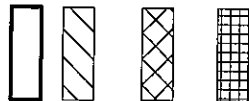

401

Lot number

3  
Setback minimum required (if 0, a building can be constructed on the boundary provided that the building height and length requirements are met)

This Building Envelope Plan is to be read in conjunction with the associated Building Envelope Profiles and Design Guidelines.  
The registered proprietors of the lot are required to build in accordance with building envelopes shown hereon and in the "Profile Diagrams" in sheet 6.

**ARMSTRONG Mt DUNEED  
BUILDING ENVELOPE PLAN  
STAGE 4**

**4/3**  
stage sheet

June 2013  
Version F

Sheet 3 of 6

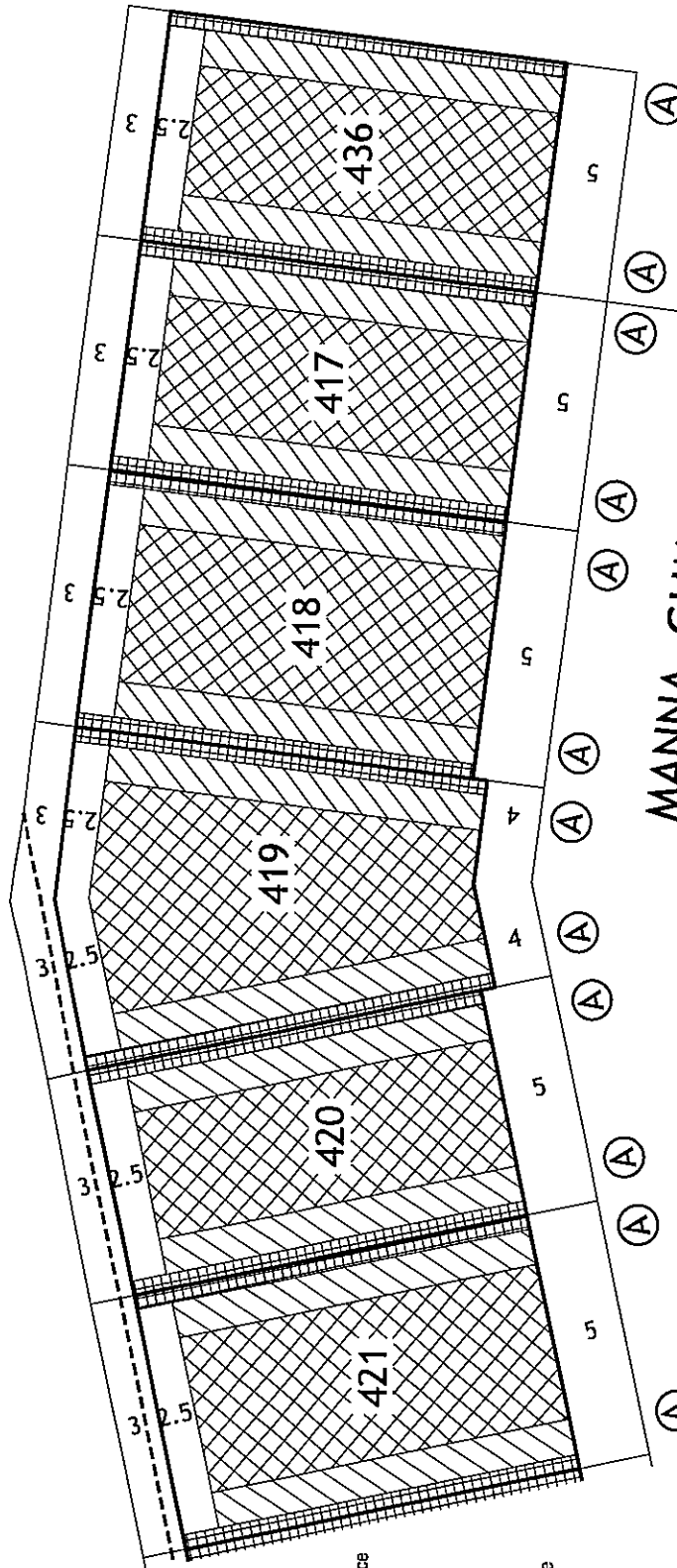

**MANNA GUM DRIVE**

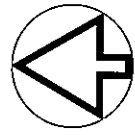

MGA ZONE 55

PLANNING & ENVIRONMENT ACT 1987  
CITY OF GREATER GEELONG PLANNING SCHEME  
Everlasting Terrace  
under Condition ...  
Permit 404/2012 dated 10/01/2013  
Signed ...  
Date 11/01/2013 For and on behalf of the Council of the City of Greater Geelong  
Sheet No. 4 of 7 sheets

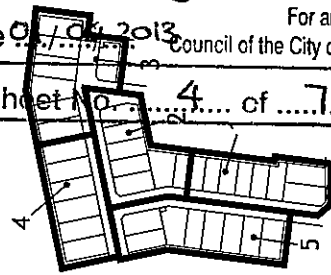







**KEY TO SHEETS**



Detailed design of roads, driveways and footpaths is provided in the relevant Engineering Plans.  
Detailed design of landscape works is provided in the relevant Landscape Plans.  
All details subject to City of Greater Geelong Council approval.  
This version of the building envelope plan corresponds with version B of the Plan of Subdivision for stage 4.

PLANNING & ENVIRONMENT ACT 1947  
 CITY OF GREATER GEELONG PLANNING SCHEME  
 Amended Plan Endorsed  
 under Condition ..... 6 ..... of  
 MGA ZONE 51  
 Unit 496/2012... dated 10/04/2013  
 Signed *[Signature]*  
 For and on behalf of  
 Date 01/08/2013 Council of the City of Greater Geelong  
 Sheet No. .... 5 ..... of .... 7 ..... sheets

**NOTATIONS**

-  Single Storey Building Envelope (height not exceeding 3.6m)
-  Overlooking Zone - Habitable room windows/raised open spaces are a source of overlooking
-  Non Overlooking Zone - Habitable room windows/raised open spaces are not a source of overlooking
-  Building to Boundary Zone
-  Building Envelope Boundary Profile Type
-  2 metre wide easement
-  3 metre wide easement

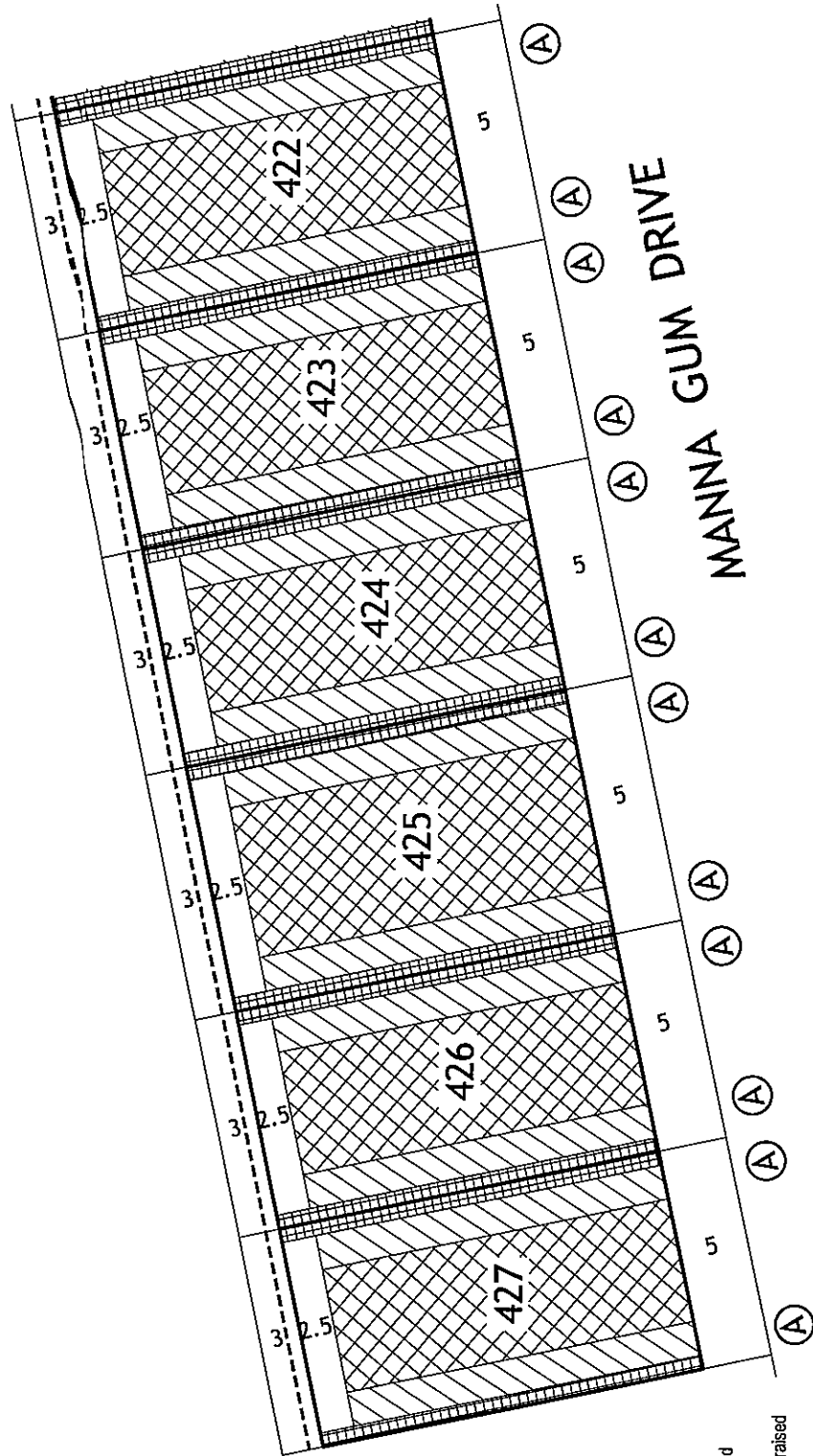

**ARMSTRONG Mt DUNEED**  
**BUILDING ENVELOPE PLAN**  
**STAGE 4**

**4/4**  
 sheet  
 stage

Sheet 4 of 6  
 June 2013  
 Version: F

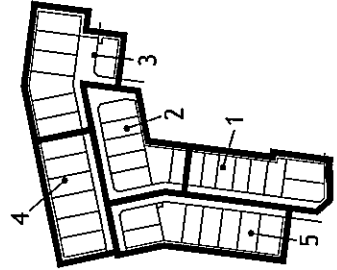

**KEY TO SHEETS**

Detailed design of roads, driveways and footpaths is provided in the relevant Engineering Plans.  
 Detailed design of landscape works is provided in the relevant Landscape Plans.  
 All details subject to City of Greater Geelong Council approval.  
 This version of the building envelope plan corresponds with version B of the Plan of Subdivision for stage 4.

- 401 Lot number
- 3 Setback minimum required (if 0, a building can be constructed on the boundary provided that the building height and length requirements are met)

This Building Envelope Plan is to be read in conjunction with the associated Building Envelope Profiles and Design Guidelines.  
 The registered proprietor/s of the lot are required to build in accordance with building envelopes shown hereon and in the "Profile Diagrams" in sheet 6.

# MANNA GUM DRIVE

Detailed design of roads, driveways and footpaths is provided in the relevant Engineering Plans.

Detailed design of landscape works is provided in the relevant Landscape Plans.

All details subject to City of Greater Geelong Council approval.

This version of the building envelope plan corresponds with version B of the Plan of Subdivision for stage 4.

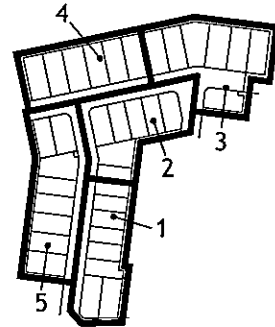
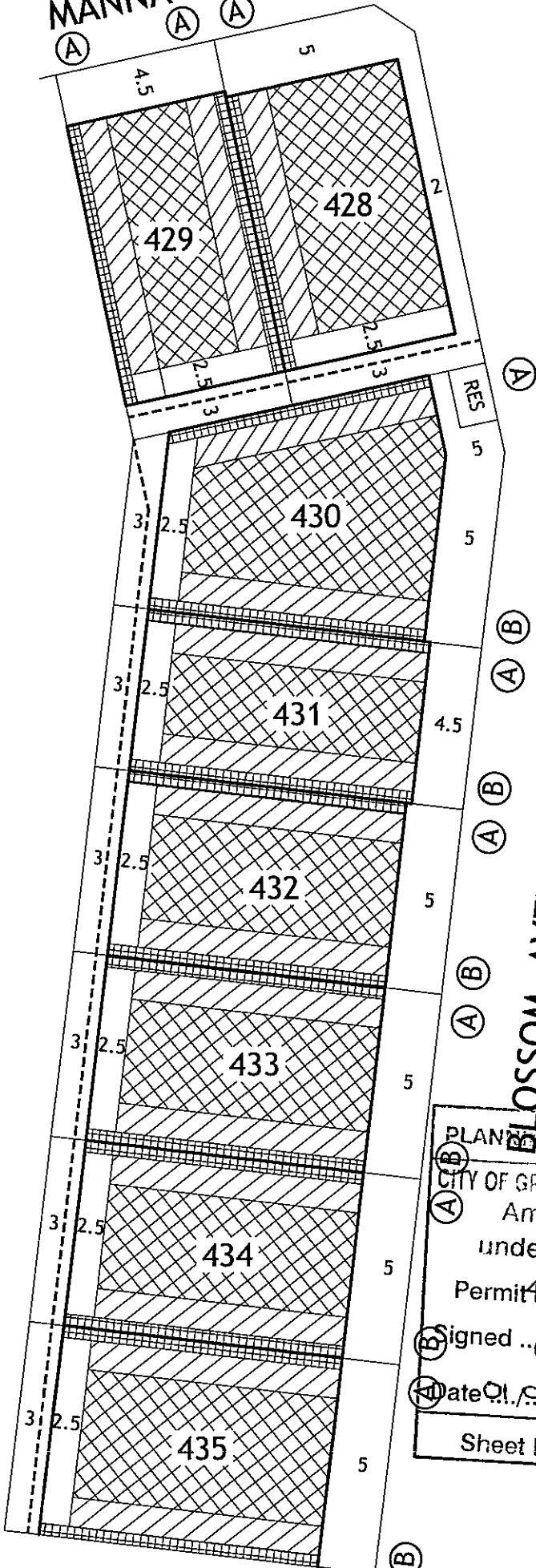

## KEY TO SHEETS

### NOTATIONS

- Single Storey Building Envelope (height not exceeding 3.6m)
- Overlooking Zone - Habitable room windows/raised open spaces are a source of overlooking
- Non Overlooking Zone - Habitable room windows/raised open spaces are not a source of overlooking
- Building to Boundary Zone
- Building Envelope Boundary Profile Type
- 2 metre wide easement
- 3 metre wide easement
- 401** Lot number
- 3** Setback minimum required (if 0, a building can be constructed on the boundary provided that the building height and length requirements are met)

This Building Envelope Plan is to be read in conjunction with the associated Building Envelope Profiles and Design Guidelines. The registered proprietor/s of the lot are required to build in accordance with building envelopes shown hereon and in the "Profile Diagrams" in sheet 6.

PLANNING & ENVIRONMENT ACT 1987  
 CITY OF GREATER GEELONG PLANNING SCHEME  
 Amended Plan Endorsed  
 under Condition ... 6 ... of  
 Permit 496/2012, dated 10/09/2012  
 Signed *[Signature]*  
 Date 01/08/2013  
 For and on behalf of the Council of the City of Greater Geelong

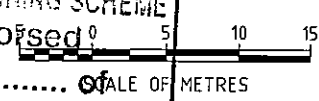

**ARMSTRONG M DUNEED**  
**BUILDING ENVELOPE PLAN**  
**STAGE 4**

**4 / 5**  
 stage sheet

Sheet No. ... 6 ... of ... 7 ... sheets

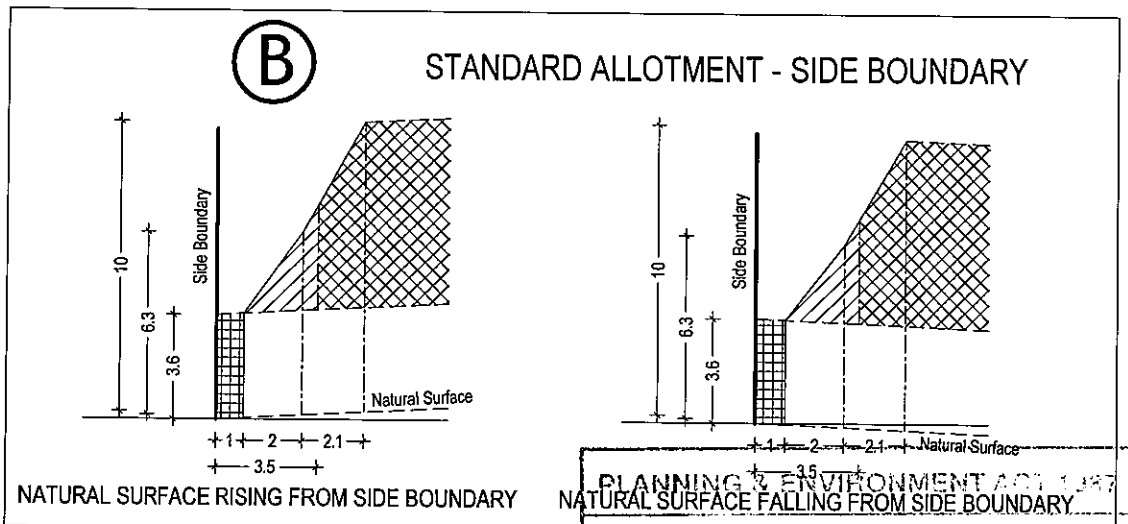
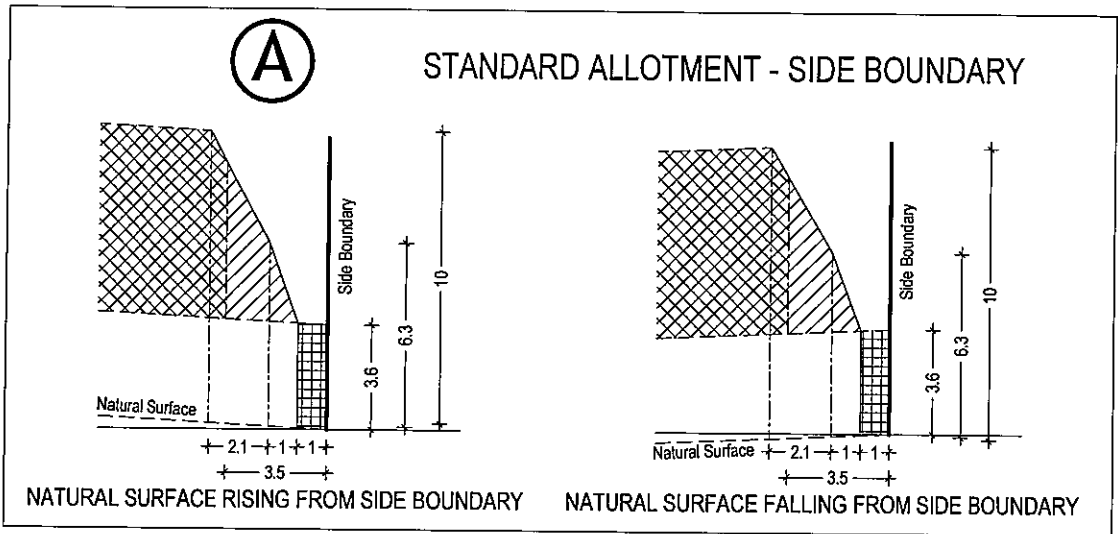

PLANNING & ENVIRONMENT ACT 1987  
 CITY OF GREATER GEELONG PLANNING SCHEME  
 Amended Plan Endorsed  
 under Condition 6 of  
 Permit 496/2012 dated 10/04/2013  
 Signed *[Signature]*  
 For and on behalf of the  
 Date 01/08/2013 Council of the City of Greater Geelong  
**ARMSTRONG Mc DUNEED**  
 Sheet No.          of          sheets  
**BUILDING ENVELOPE PROFILES**

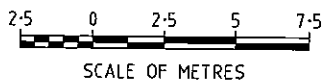

- Single Storey Building Envelope
- Overlooking Zone  
Habitable room windows/raised open spaces are a source of overlooking

- Non Overlooking Zone  
Habitable room windows/raised open spaces are not a source of overlooking
- Building to Boundary Zone

**4 / 6**  
 stage sheet