

KEY TO SHEETS

REFER TO SHEETS
1 TO 5
FOR DETAIL

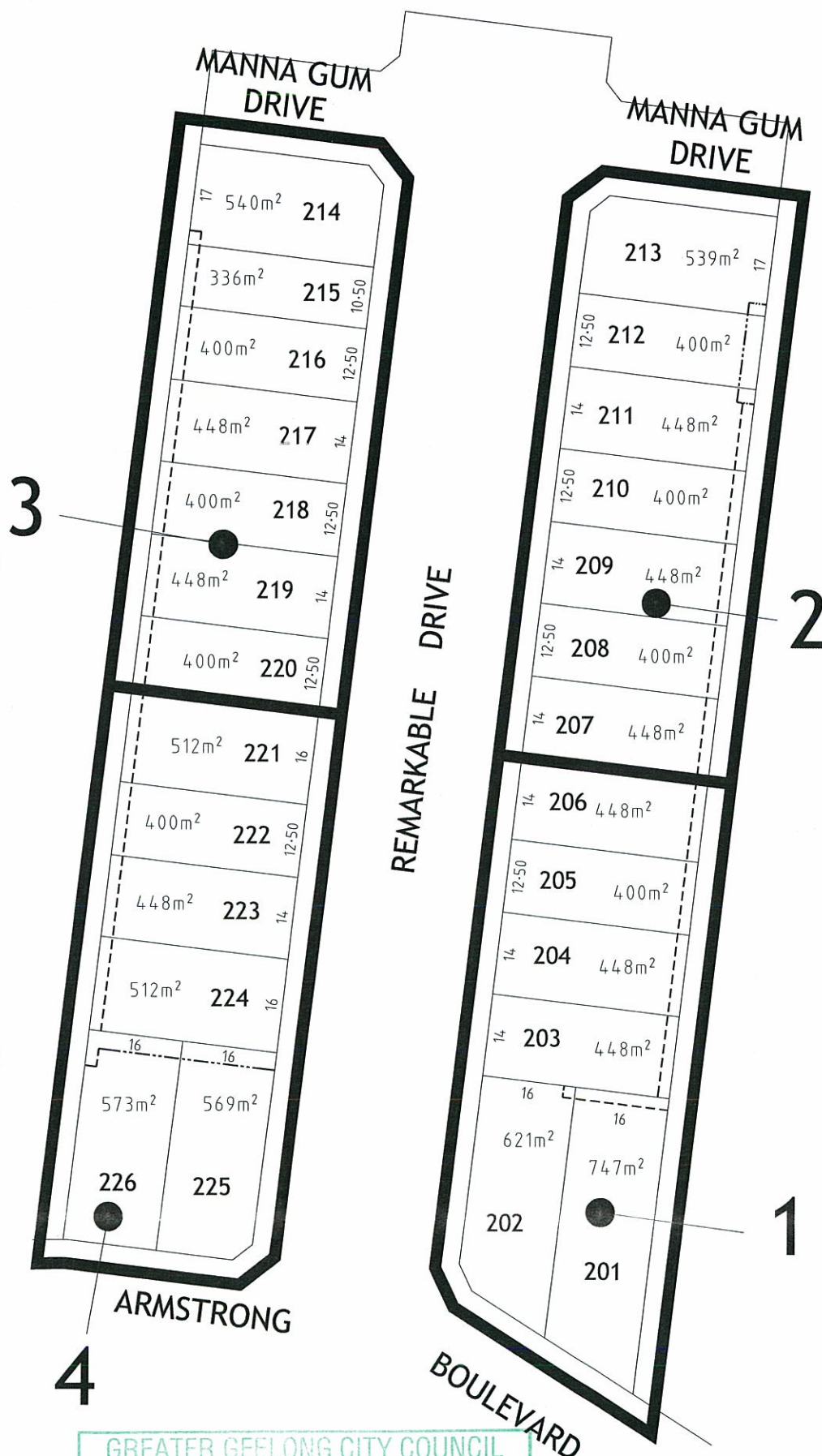

GREATER GEELONG CITY COUNCIL
PLANNING & ENVIRONMENT ACT 1987
GREATER GEELONG PLANNING SCHEME
Endorsed Plan referred to in Permit No. 496/2012
Signed: [Signature] Date: 19/04/13
FOR AND ON BEHALF OF THE GREATER GEELONG
CITY COUNCIL AS RESPONSIBLE AUTHORITY
NOTE: THIS IS NOT A BUILDING APPROVAL

ARMSTRONG Mt DUNEED

BUILDING ENVELOPE PLAN
STAGE 2

April 2013
Version: F

Detailed design of roads, driveways and footpaths is provided in the relevant Engineering Plans.

Detailed design of landscape works is provided in the relevant Landscape Plans.

All details subject to City of Greater Geelong Council approval.

This version of the building envelope plan corresponds with version E of the Plan of Subdivision for stage 2.



MGA ZONE 55

REMARKABLE DRIVE

ARMSTRONG BOULEVARD

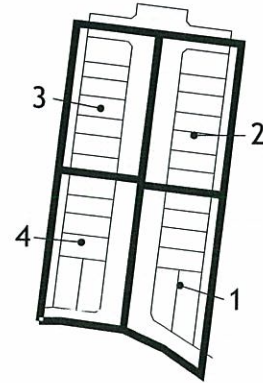
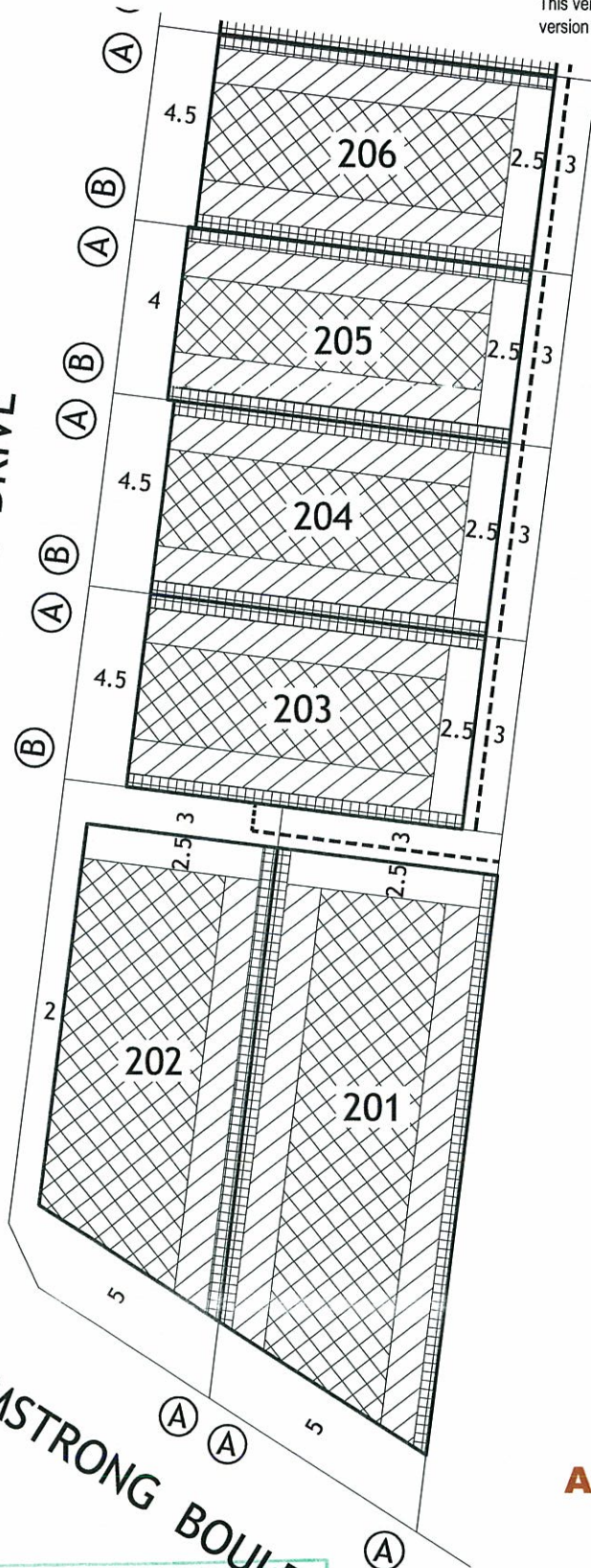

KEY TO SHEETS

NOTATIONS

- Single Storey Building Envelope (height not exceeding 3.6m)
- Overlooking Zone - Habitable room windows/raised open spaces are a source of overlooking
- Non Overlooking Zone - Habitable room windows/raised open spaces are not a source of overlooking
- Building to Boundary Zone
- Building Envelope Boundary Profile Type
- 2 metre wide easement
- 3 metre wide easement
- 201** Lot number
- 3** Setback minimum required (if 0, a building can be constructed on the boundary provided that the building height and length requirements are met)

This Building Envelope Plan is to be read in conjunction with the associated Building Envelope Profiles and Design Guidelines.

The registered proprietor/s of the lot are required to build in accordance with building envelopes shown hereon and in the "Profile Diagrams" in sheet 5.



ARMSTRONG Mt DUNEED

BUILDING ENVELOPE PLAN STAGE 2

2/1
stage sheet

Sheet 1 of 5

April 2013
Version: F

GREATER GEELONG CITY COUNCIL
PLANNING & ENVIRONMENT ACT 1987
GREATER GEELONG PLANNING SCHEME
Endorsed Plan referred to in Permit No. 496/2012.
Signed *[Signature]* Date 19/04/13
FOR AND ON BEHALF OF THE GREATER GEELONG
CITY COUNCIL AS RESPONSIBLE AUTHORITY
NOTE: THIS IS NOT A BUILDING APPROVAL

Detailed design of roads, driveways and footpaths is provided in the relevant Engineering Plans.

Detailed design of landscape works is provided in the relevant Landscape Plans.

All details subject to City of Greater Geelong Council approval.

This version of the building envelope plan corresponds with version E of the Plan of Subdivision for stage 2.



MGA ZONE 55

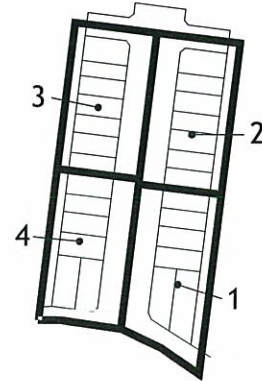
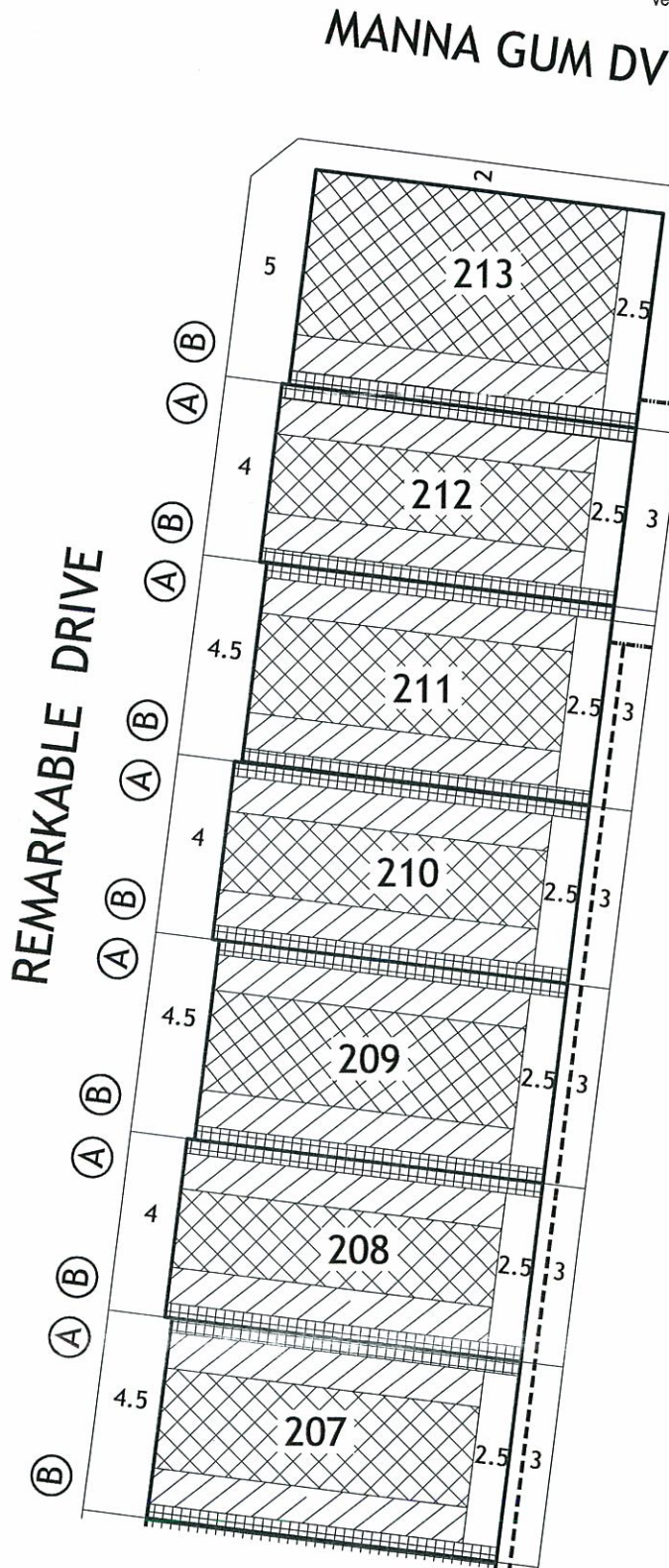

KEY TO SHEETS

NOTATIONS

- Single Storey Building Envelope (height not exceeding 3.6m)
- Overlooking Zone - Habitable room windows/raised open spaces are a source of overlooking
- Non Overlooking Zone - Habitable room windows/raised open spaces are not a source of overlooking
- Building to Boundary Zone
- Building Envelope Boundary Profile Type
- 2 metre wide easement
- 3 metre wide easement
- 201** Lot number
- 3** Setback minimum required (if 0, a building can be constructed on the boundary provided that the building height and length requirements are met)

This Building Envelope Plan is to be read in conjunction with the associated Building Envelope Profiles and Design Guidelines.

The registered proprietor/s of the lot are required to build in accordance with building envelopes shown hereon and in the "Profile Diagrams" in sheet 5.



ARMSTRONG Mt DUNED

BUILDING ENVELOPE PLAN STAGE 2

2 / 2
stage sheet

Sheet 2 of 5

April 2013
Version: F

GREATER GEELONG CITY COUNCIL
PLANNING & ENVIRONMENT ACT 1987
GREATER GEELONG PLANNING SCHEME
Endorsed Plan referred to in Permit No. 496/2012
Signed  Date 19/04/13
FOR AND ON BEHALF OF THE GREATER GEELONG
CITY COUNCIL AS RESPONSIBLE AUTHORITY
NOTE: THIS IS NOT A BUILDING APPROVAL

Detailed design of roads, driveways and footpaths is provided in the relevant Engineering Plans.

Detailed design of landscape works is provided in the relevant Landscape Plans.

All details subject to City of Greater Geelong Council approval.

This version of the building envelope plan corresponds with version E of the Plan of Subdivision for stage 2.

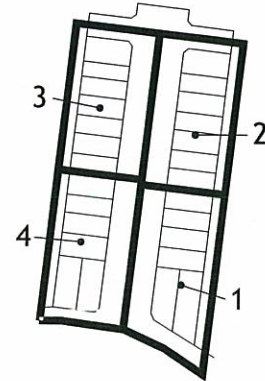
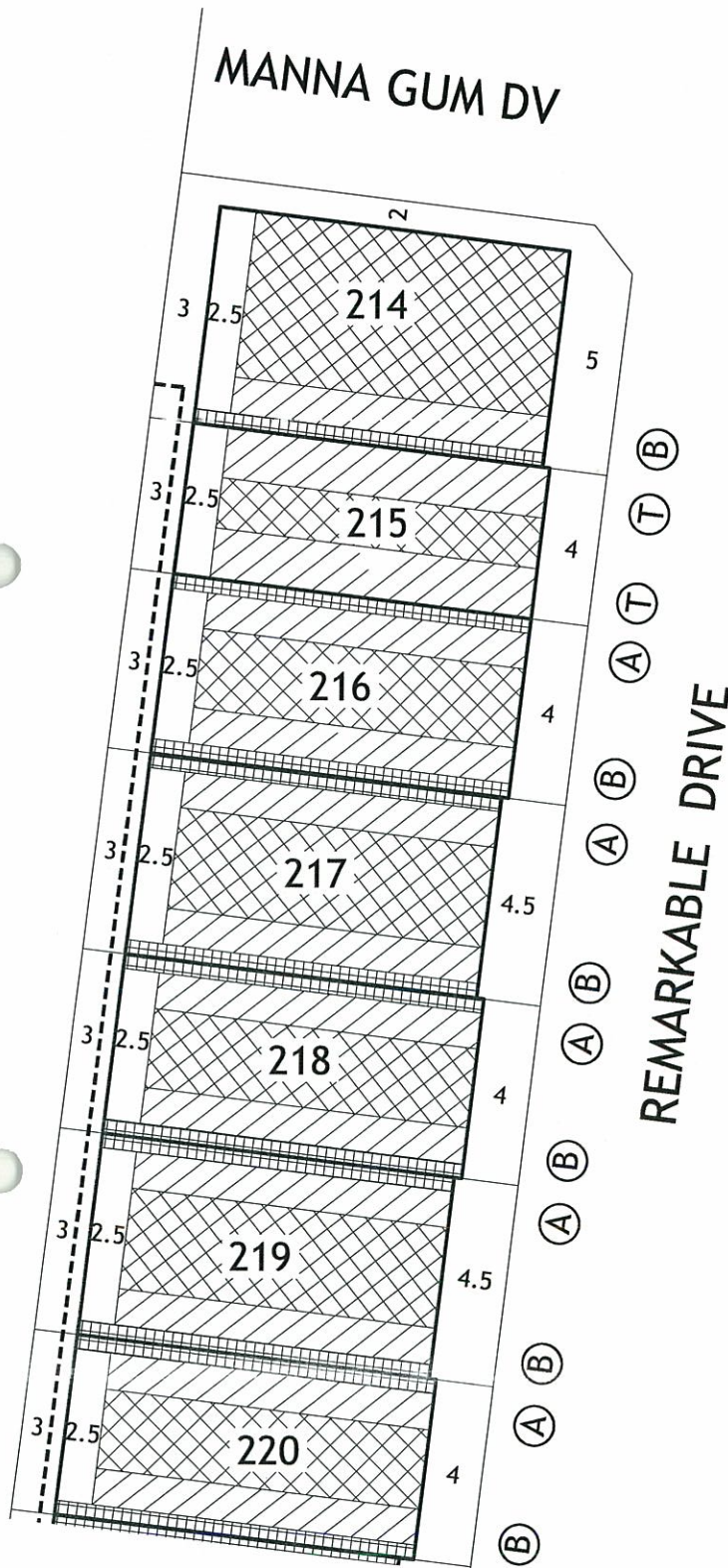

KEY TO SHEETS

NOTATIONS

- Single Storey Building Envelope (height not exceeding 3.6m)
- Overlooking Zone - Habitable room windows/raised open spaces are a source of overlooking
- Non Overlooking Zone - Habitable room windows/raised open spaces are not a source of overlooking
- Building to Boundary Zone
- Building Envelope Boundary Profile Type
- 2 metre wide easement
- 3 metre wide easement
- 201** Lot number
- 3** Setback minimum required (if 0, a building can be constructed on the boundary provided that the building height and length requirements are met)

This Building Envelope Plan is to be read in conjunction with the associated Building Envelope Profiles and Design Guidelines.
The registered proprietor/s of the lot are required to build in accordance with building envelopes shown hereon and in the "Profile Diagrams" in sheet 5.



ARMSTRONG Mt DUNEED

BUILDING ENVELOPE PLAN STAGE 2

2 / 3
stage sheet

Sheet 3 of 5

April 2013
Version: F

GREATER GEELONG CITY COUNCIL
PLANNING & ENVIRONMENT ACT 1987
GREATER GEELONG PLANNING SCHEME
Endorsed Plan referred to in Permit No. 496/2012
Signed *[Signature]* Date 19/04/13
FOR AND ON BEHALF OF THE GREATER GEELONG
CITY COUNCIL AS RESPONSIBLE AUTHORITY
NOTE: THIS IS NOT A BUILDING APPROVAL

Detailed design of roads, driveways and footpaths is provided in the relevant Engineering Plans.

Detailed design of landscape works is provided in the relevant Landscape Plans.

All details subject to City of Greater Geelong Council approval.

This version of the building envelope plan corresponds with version E of the Plan of Subdivision for stage 2.

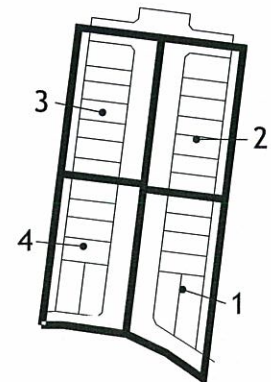
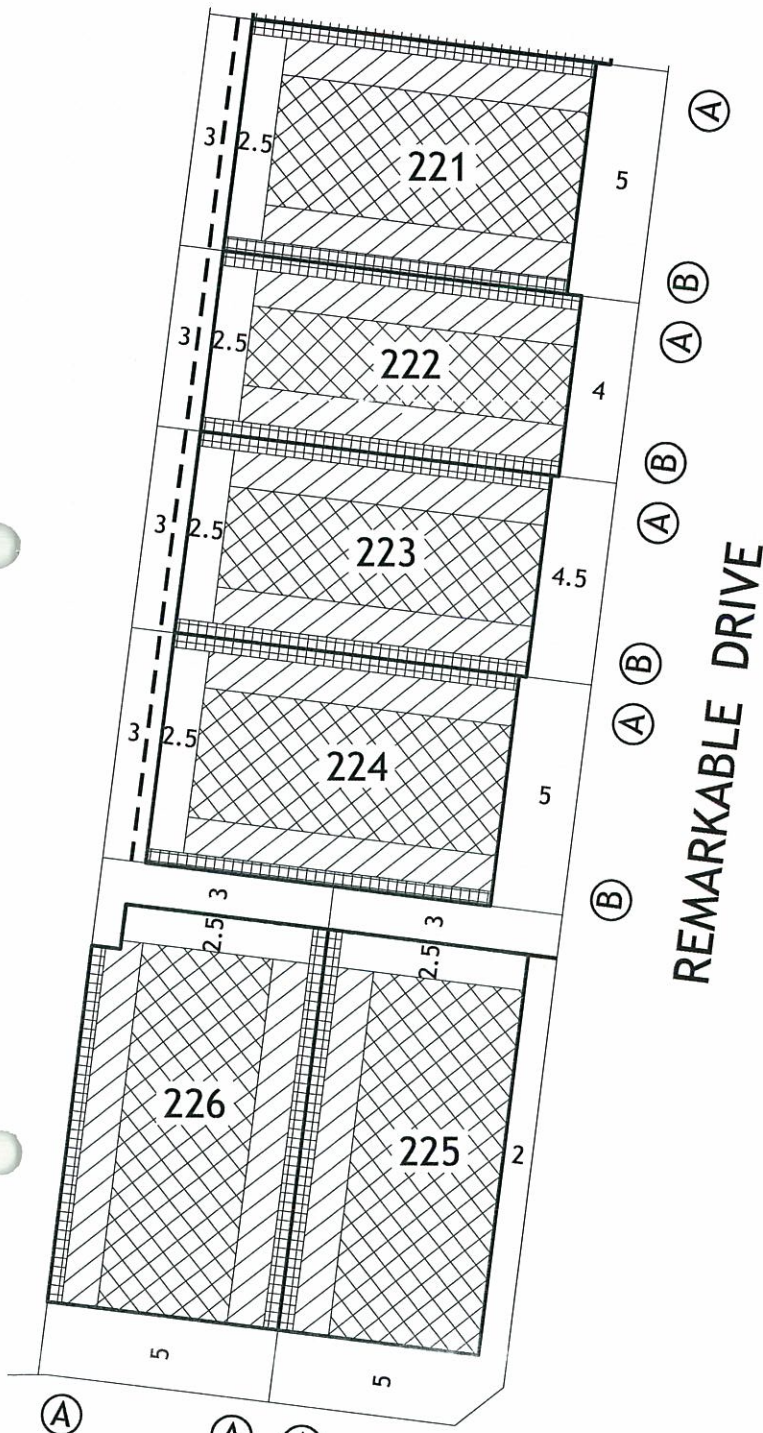

KEY TO SHEETS

NOTATIONS

- Single Storey Building Envelope (height not exceeding 3.6m)
- Overlooking Zone - Habitable room windows/raised open spaces are a source of overlooking
- Non Overlooking Zone - Habitable room windows/raised open spaces are not a source of overlooking
- Building to Boundary Zone
- Building Envelope Boundary Profile Type
- 2 metre wide easement
- 3 metre wide easement
- 201** Lot number
- 3** Setback minimum required (if 0, a building can be constructed on the boundary provided that the building height and length requirements are met)

This Building Envelope Plan is to be read in conjunction with the associated Building Envelope Profiles and Design Guidelines.
The registered proprietor/s of the lot are required to build in accordance with building envelopes shown hereon and in the "Profile Diagrams" in sheet 5.



ARMSTRONG BOULEVARD

ARMSTRONG Mt DUNEED

**BUILDING ENVELOPE PLAN
STAGE 2**

2 / 4
stage sheet

Sheet 4 of 5

April 2013
Version: F

GREATER GEELONG CITY COUNCIL
PLANNING & ENVIRONMENT ACT 1987
GREATER GEELONG PLANNING SCHEME
Endorsed Plan referred to in Permit No. 496/2012
Signed: [Signature] Date: 19/04/13
FOR AND ON BEHALF OF THE GREATER GEELONG
CITY COUNCIL AS RESPONSIBLE AUTHORITY
NOTE: THIS IS NOT A BUILDING APPROVAL

(A)

STANDARD ALLOTMENT - SIDE BOUNDARY

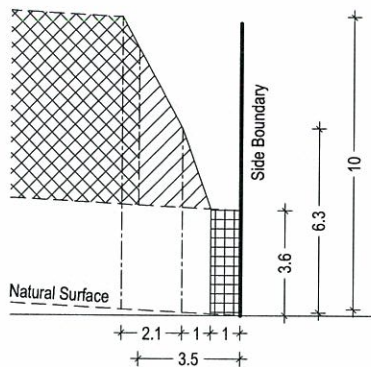

NATURAL SURFACE RISING FROM SIDE BOUNDARY

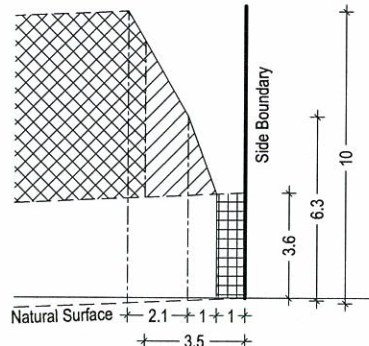

NATURAL SURFACE FALLING FROM SIDE BOUNDARY

(B)

STANDARD ALLOTMENT - SIDE BOUNDARY

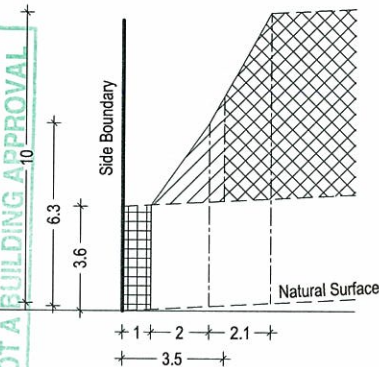

NATURAL SURFACE RISING FROM SIDE BOUNDARY

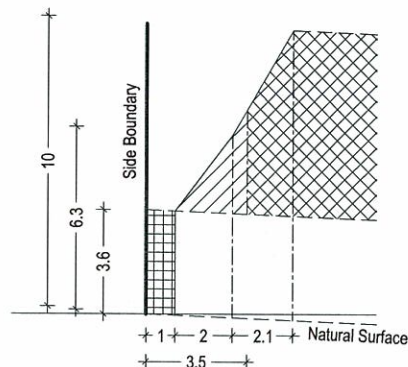

NATURAL SURFACE FALLING FROM SIDE BOUNDARY

(T)

STANDARD ALLOTMENT - SIDE BOUNDARY

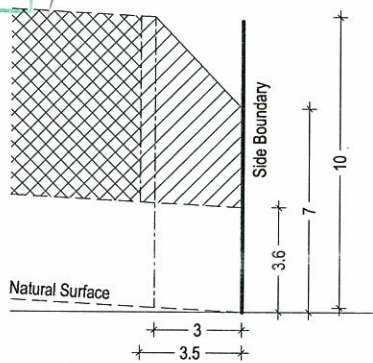

NATURAL SURFACE RISING FROM SIDE BOUNDARY

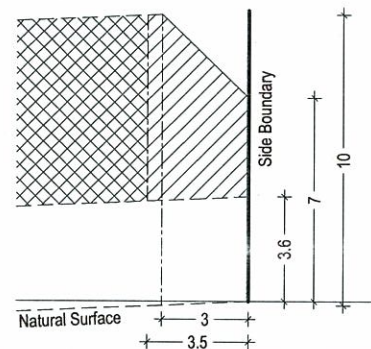

NATURAL SURFACE FALLING FROM SIDE BOUNDARY



SCALE OF METRES

ARMSTRONG Mt DUNEED

BUILDING ENVELOPE PROFILES STAGE 2

2 / 5
stage sheet

Single Storey Building Envelope

Overlooking Zone
Habitable room windows/raised open spaces are a source of overlooking



Non Overlooking Zone
Habitable room windows/raised open spaces are not a source of overlooking



Building to Boundary Zone

Sheet 5 of 5

April 2013
Version: F