

Notes:

- Final areas are subject to design changes, Council approval and field survey and may differ from those shown on this Disclosure Plan.
- Final presentation of areas will comply with requirements of the Registrar of Titles and may vary from the format on this Disclosure Plan
- The Seller, under the Contract Terms, is entitled to make Variations to the lot, including its location, area, size, dimensions, and elevation. Without limitation, if the area of the Lot on the Plan is not more than 5% different to the total area of the Lot as shown on this Disclosure Plan, the Variation is deemed to be a Permitted Variation and the Buyer cannot object.
- Design contours are approximate only and may change during construction
- Services have been plotted from design information only and may change during construction
- All earthworks fill to lots will be placed and compacted on Level 1 basis in accordance with Australian Standard AS3798-2007 "Guidelines on earthworks for commercial and residential developments".

LEGEND

- ⊕ . . . STORMWATER MANHOLE
- ⊞ . . . STORMWATER GULLY PIT
- ⊞ . . . FIELD INLET
- ⊞ . . . GULLY TRAP
- ▭ . . . HEADWALL
- ⊞ . . . WATER METER
- ⊞ . . . FIRE HYDRANT
- ⊞ . . . STOP VALVE
- W-W- WATER PIPE
- SW-SW- STORMWATER
- UE-UE- UNDERGROUND ELECTRICITY
- ⊞ . . . ELECTRICITY PILLAR
- ⊞ . . . COMMS PIT
- ⊞ . . . LIGHT POLE
- - - 41 - - - EXISTING SURFACE CONTOURS
- 41 — DESIGN CONTOURS
- █ DESIGN FILL
- ▭ BUILDING ENVELOPE
- EASEMENT

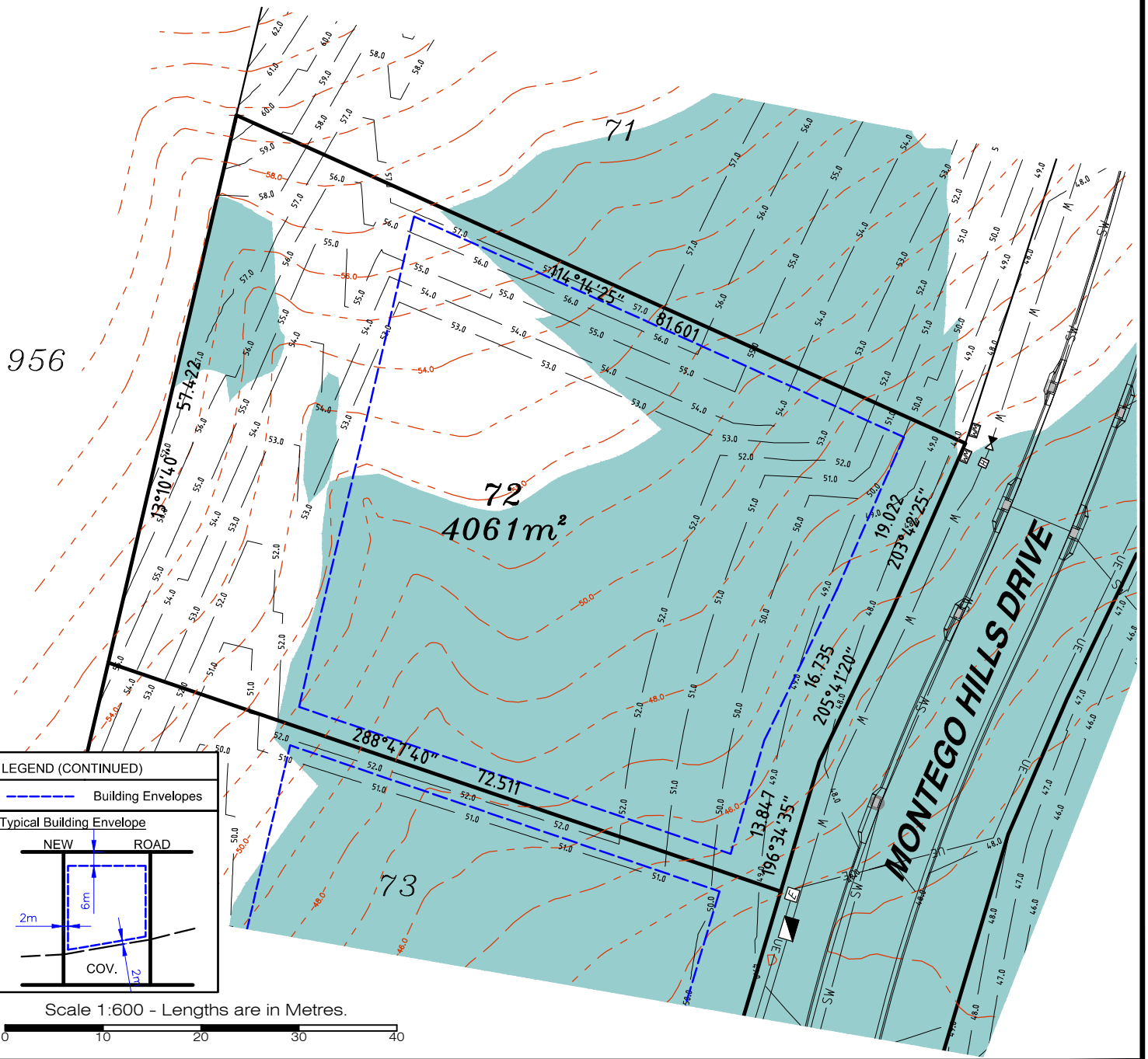

LEGEND (CONTINUED)

- ▭ Building Envelopes

Typical Building Envelope

Scale 1:600 - Lengths are in Metres.

gassman development perspectives

est 1985

planning | environment | landscape | engineering | survey

T: 3807 3333 | F: 3287 5461 | www.gassman.com.au

Gold Coast & Logan | 176 Business Street, Yatala QLD | PO Box 392, Beenleigh 4207

Client	Kingsholme Developments Pty. Ltd.
Project	DISCLOSURE PLAN LOT 72 (Survey plan: SP280831) MONTEGO HILLS Montego Hills Drive, Kingsholme

Issue Date	22/12/2017
Meridian	SP264750
Level Datum	AHD
Contour Interval	1.0m
Drawn	N. Boyce
Date Drafted	15/12/2017
Checked	T. Geraghty

Real Property Description:
Lot 954 on SP264750

REFERENCE No. **5543-14**
PLAN No. **5543 S DC LOT 72**

Notes:

- Final areas are subject to design changes, Council approval and field survey and may differ from those shown on this Disclosure Plan.
- Final presentation of areas will comply with requirements of the Registrar of Titles and may vary from the format on this Disclosure Plan
- The Seller, under the Contract Terms, is entitled to make Variations to the lot, including its location, area, size, dimensions, and elevation. Without limitation, if the area of the Lot on the Plan is not more than 5% different to the total area of the Lot as shown on this Disclosure Plan, the Variation is deemed to be a Permitted Variation and the Buyer cannot object.
- Design contours are approximate only and may change during construction
- Services have been plotted from design information only and may change during construction
- All earthworks fill to lots will be placed and compacted on Level 1 basis in accordance with Australian Standard AS3798-2007 "Guidelines on earthworks for commercial and residential developments".

LEGEND

- STORMWATER MANHOLE
- STORMWATER GULLY PIT
- FIELD INLET
- GULLY TRAP
- HEADWALL
- WATER METER
- FIRE HYDRANT
- STOP VALVE
- WATER PIPE
- STORMWATER
- UNDERGROUND ELECTRICITY
- ELECTRICITY PILLAR
- COMMS PIT
- LIGHT POLE
- EXISTING SURFACE CONTOURS
- DESIGN CONTOURS
- DESIGN FILL
- BUILDING ENVELOPE
- EASEMENT

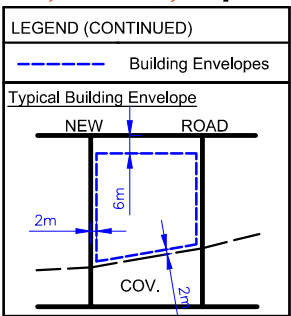
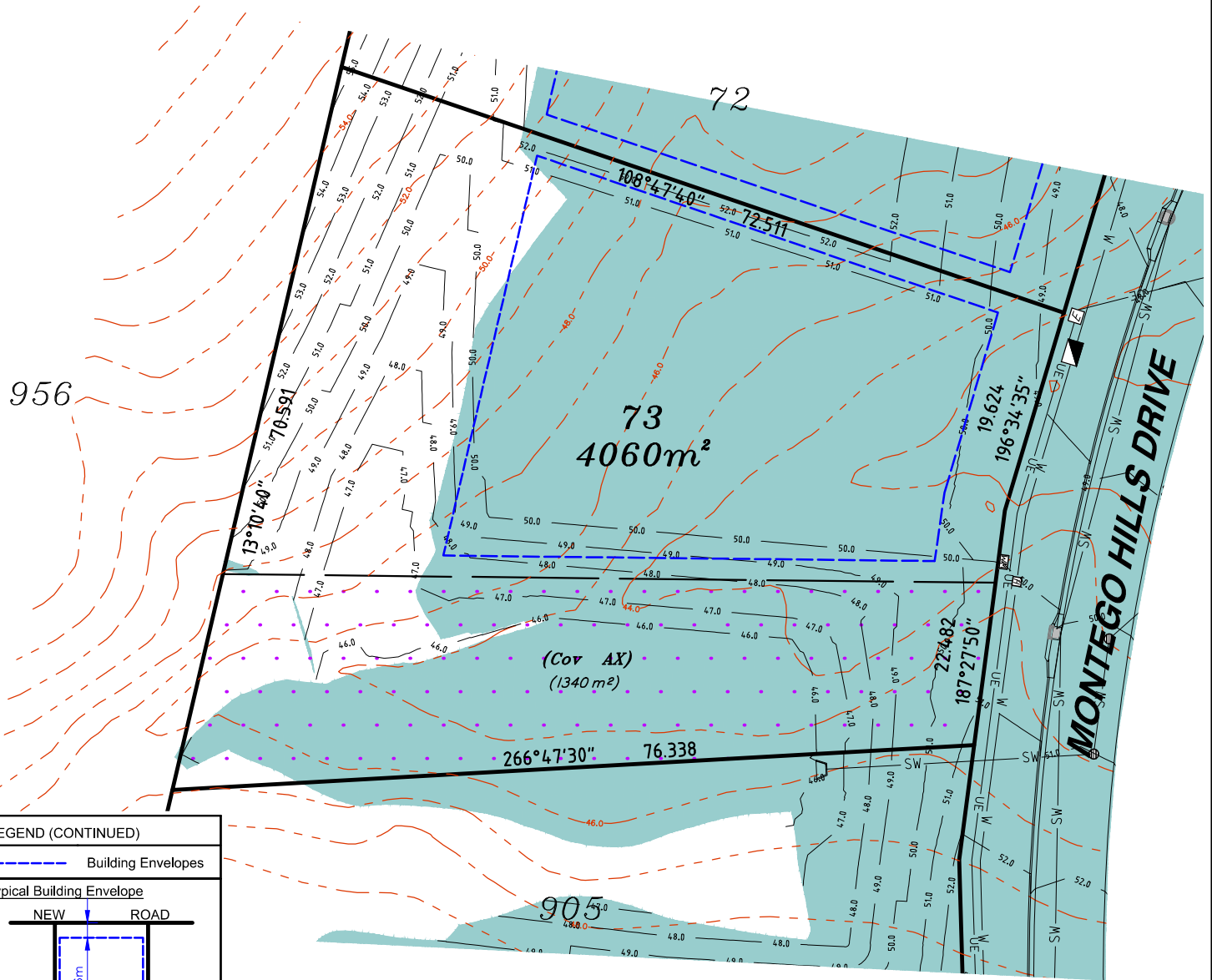

Scale 1:600 - Lengths are in Metres.

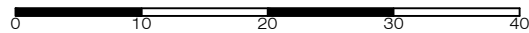

gassman
development
perspectives

est 1985

planning | environment | landscape | engineering | survey

T: 3807 3333 | F: 3287 5461 | www.gassman.com.au

Gold Coast & Logan | 176 Business Street, Yatala QLD | PO Box 392, Beenleigh 4207

Client	Kingsholme Developments Pty. Ltd.
Project	DISCLOSURE PLAN LOT 73 (Survey plan: SP280831) MONTEGO HILLS Montego Hills Drive, Kingsholme
Real Property Description:	Lot 954 on SP264750

Issue Date	22/12/2017
Meridian	SP264750
Level Datum	AHD
Contour Interval	1.0m
Drawn	N. Boyce
Date Drafted	15/12/2017
Checked	T. Geraghty
Scale (on A4 original)	1:600
REFERENCE No.	5543-14
PLAN No.	5543 S DC LOT 73

Notes:

- Final areas are subject to design changes, Council approval and field survey and may differ from those shown on this Disclosure Plan.
- Final presentation of areas will comply with requirements of the Registrar of Titles and may vary from the format on this Disclosure Plan
- The Seller, under the Contract Terms, is entitled to make Variations to the lot, including its location, area, size, dimensions, and elevation. Without limitation, if the area of the Lot on the Plan is not more than 5% different to the total area of the Lot as shown on this Disclosure Plan, the Variation is deemed to be a Permitted Variation and the Buyer cannot object.
- Design contours are approximate only and may change during construction
- Services have been plotted from design information only and may change during construction
- All earthworks fill to lots will be placed and compacted on Level 1 basis in accordance with Australian Standard AS3798-2007 "Guidelines on earthworks for commercial and residential developments".

LEGEND

- STORMWATER MANHOLE
- STORMWATER GULLY PIT
- FIELD INLET
- GULLY TRAP
- HEADWALL
- WATER METER
- FIRE HYDRANT
- STOP VALVE
- WATER PIPE
- STORMWATER PIPE
- UNDERGROUND ELECTRICITY
- ELECTRICITY PILLAR
- COMMS PIT
- LIGHT POLE
- EXISTING SURFACE CONTOURS
- DESIGN CONTOURS
- DESIGN FILL
- BUILDING ENVELOPE
- EASEMENT

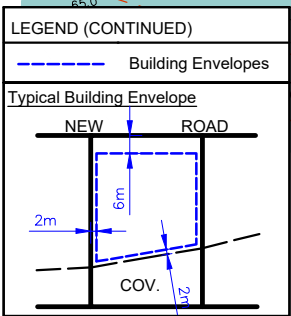
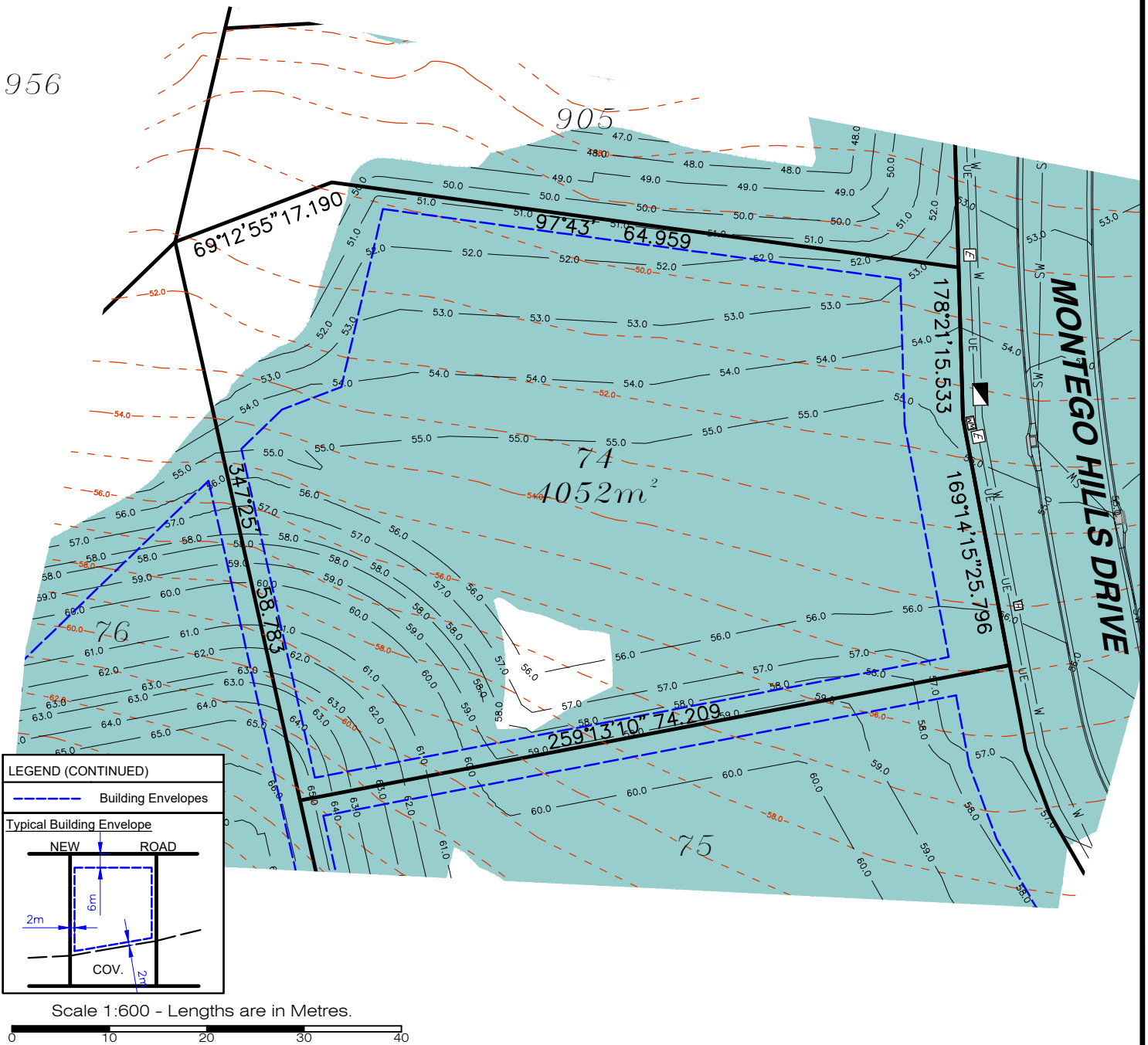

Scale 1:600 - Lengths are in Metres.

gassman development perspectives
est 1985
planning | environment | landscape | engineering | survey
T: 3807 3333 | F: 3287 5461 | www.gassman.com.au
Gold Coast & Logan | 176 Business Street, Yatala QLD | PO Box 392, Beenleigh 4207

Client Kingsholme Developments Pty. Ltd.

Project **DISCLOSURE PLAN**
LOT 74
(Survey plan: SP280831)
MONTENEGO HILLS
Montego Hills Drive, Kingsholme

Locality	Kingsholme	Issue Date	22/12/2017
Local Govt	GOLD COAST CITY COUNCIL	Meridian	SP264750
Scale (on A4 original)	1:600	Level Datum	AHD
REFERENCE No.	5543-14	Contour Interval	1.0m
PLAN No.	5543 S DC LOT 74	Drawn	N. Boyce
		Date Drafted	15/12/2017
		Checked	T. Geraghty

Real Property Description:
Lot 954 on SP264750

Notes:

- Final areas are subject to design changes, Council approval and field survey and may differ from those shown on this Disclosure Plan.
- Final presentation of areas will comply with requirements of the Registrar of Titles and may vary from the format on this Disclosure Plan
- The Seller, under the Contract Terms, is entitled to make Variations to the lot, including its location, area, size, dimensions, and elevation. Without limitation, if the area of the Lot on the Plan is not more than 5% different to the total area of the Lot as shown on this Disclosure Plan, the Variation is deemed to be a Permitted Variation and the Buyer cannot object.
- Design contours are approximate only and may change during construction
- Services have been plotted from design information only and may change during construction
- All earthworks fill to lots will be placed and compacted on Level 1 basis in accordance with Australian Standard AS3798-2007 "Guidelines on earthworks for commercial and residential developments".

LEGEND

- STORMWATER MANHOLE
- STORMWATER GULLY PIT
- FIELD INLET
- GULLY TRAP
- HEADWALL
- WATER METER
- FIRE HYDRANT
- STOP VALVE
- WATER PIPE
- STORMWATER
- UNDERGROUND ELECTRICITY
- ELECTRICITY PILLAR
- COMMS PIT
- LIGHT POLE
- EXISTING SURFACE CONTOURS
- DESIGN CONTOURS
- DESIGN FILL
- BUILDING ENVELOPE
- EASEMENT

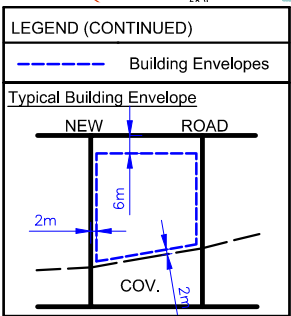
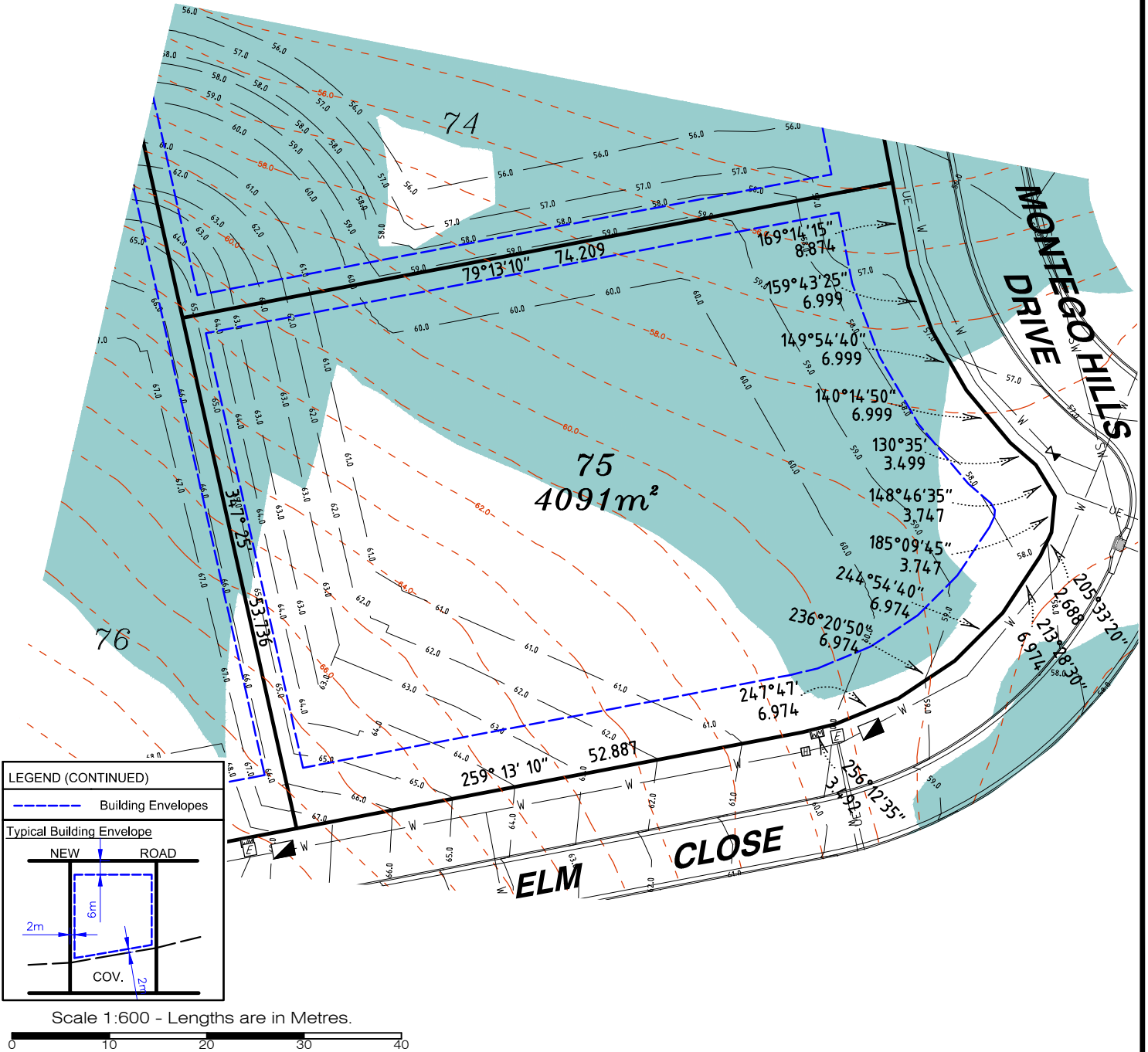

Scale 1:600 - Lengths are in Metres.

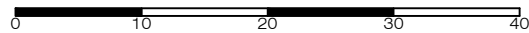

gassman development perspectives
 est 1985
 planning | environment | landscape | engineering | survey
 T: 3807 3333 | F: 3287 5461 | www.gassman.com.au
 Gold Coast & Logan | 176 Business Street, Yatala QLD | PO Box 392, Beenleigh 4207

Client	Kingsholme Developments Pty. Ltd.
Project	DISCLOSURE PLAN LOT 75 (Survey plan: SP280831) MONTEGO HILLS Montego Hills Drive, Kingsholme
Real Property Description:	Lot 954 on SP264750

Issue Date	22/12/2017
Meridian	SP264750
Level Datum	AHD
Contour Interval	1.0m
Drawn	N. Boyce
Date Drafted	15/12/2017
Checked	T. Geraghty
REFERENCE No.	5543-14
PLAN No.	5543 S DC LOT 75

Notes:

- Final areas are subject to design changes, Council approval and field survey and may differ from those shown on this Disclosure Plan.
- Final presentation of areas will comply with requirements of the Registrar of Titles and may vary from the format on this Disclosure Plan
- The Seller, under the Contract Terms, is entitled to make Variations to the lot, including its location, area, size, dimensions, and elevation. Without limitation, if the area of the Lot on the Plan is not more than 5% different to the total area of the Lot as shown on this Disclosure Plan, the Variation is deemed to be a Permitted Variation and the Buyer cannot object.
- Design contours are approximate only and may change during construction
- Services have been plotted from design information only and may change during construction
- All earthworks fill to lots will be placed and compacted on Level 1 basis in accordance with Australian Standard AS3798-2007 "Guidelines on earthworks for commercial and residential developments".

LEGEND

- STORMWATER MANHOLE
- STORMWATER GULLY PIT
- FIELD INLET
- GULLY TRAP
- HEADWALL
- WATER METER
- FIRE HYDRANT
- STOP VALVE
- WATER PIPE
- STORMWATER
- UNDERGROUND ELECTRICITY
- ELECTRICITY PILLAR
- COMMS PIT
- LIGHT POLE
- EXISTING SURFACE CONTOURS
- DESIGN CONTOURS
- DESIGN FILL
- BUILDING ENVELOPE
- EASEMENT



956

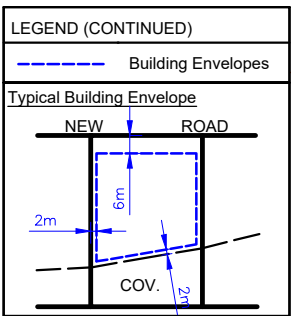
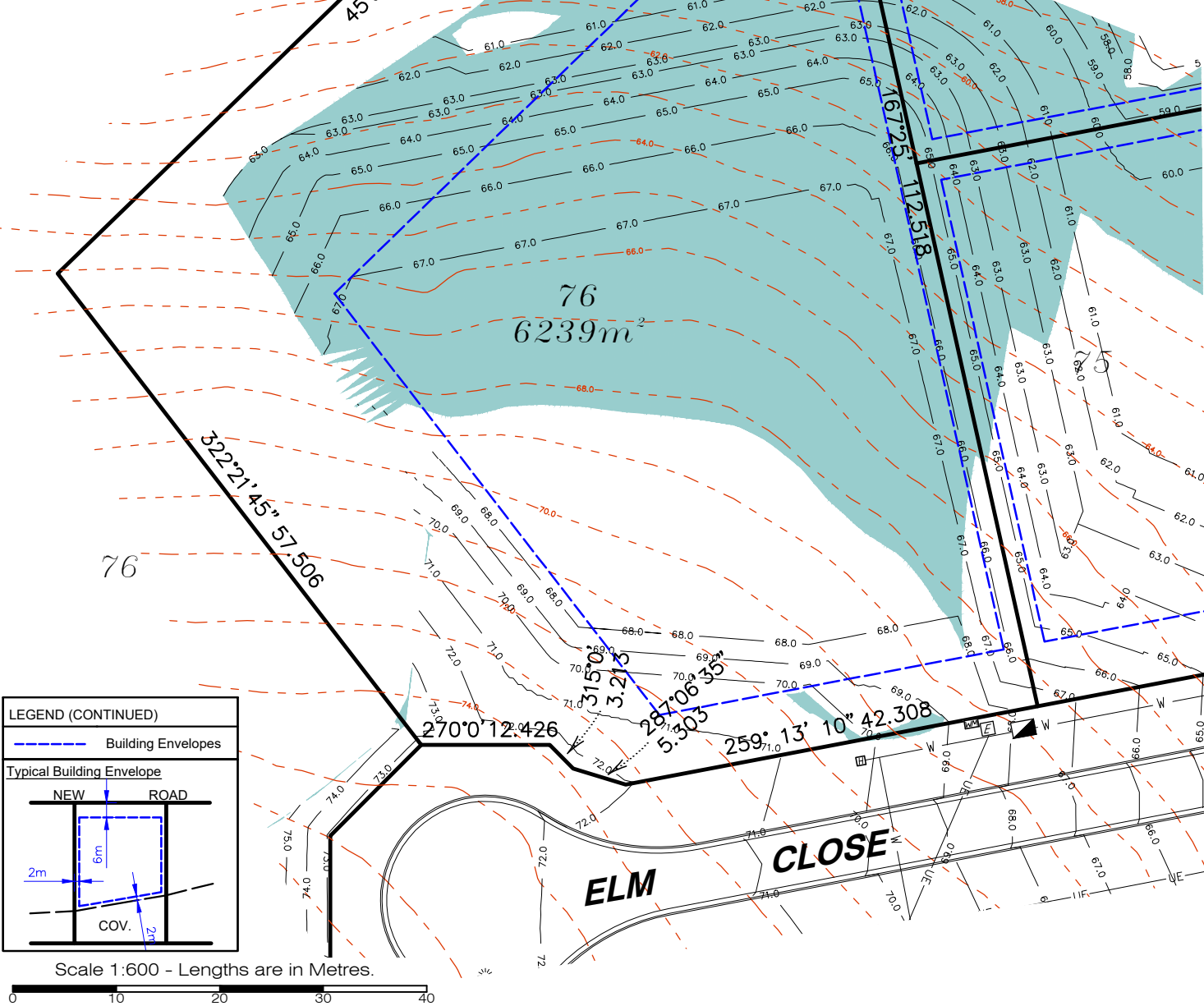

Scale 1:600 - Lengths are in Metres.

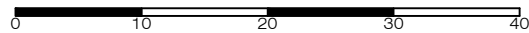

gassman
development
perspectives

est 1985

planning | environment | landscape | engineering | survey

T: 3807 3333 | F: 3287 5461 | www.gassman.com.au

Gold Coast & Logan | 176 Business Street, Yatala QLD | PO Box 392, Beenleigh 4207

Client Kingsholme Developments Pty. Ltd.

Project **DISCLOSURE PLAN**
LOT 76
(Survey plan: SP280831)
MONTEGO HILLS
Montego Hills Drive, Kingsholme

Real Property Description:
Lot 954 on SP264750

Issue Date	22/12/2017
Meridian	SP264750
Level Datum	AHD
Contour Interval	1.0m
Drawn	N. Boyce
Date Drafted	15/12/2017
Checked	T. Geraghty
Scale (on A4 original)	1:600
REFERENCE No.	5543-14
PLAN No.	5543 S DC LOT 76

LEGEND

- ⊙ ... STORMWATER MANHOLE
- ⊞ ... STORMWATER GULLY PIT
- ⊞ ... FIELD INLET
- ⊞ ... GULLY TRAP
- ⊞ ... HEADWALL
- ⊞ ... WATER METER
- ⊞ ... FIRE HYDRANT
- ⊞ ... STOP VALVE
- W—W WATER PIPE
- SW—SW STORMWATER
- UE—UE UNDERGROUND ELECTRICITY
- ⊞ ... ELECTRICITY PILLAR
- ⊞ ... COMMS PIT
- ⊞ ... LIGHT POLE
- - - 41 EXISTING SURFACE CONTOURS
- 41 DESIGN CONTOURS
- █ DESIGN FILL
- - - BUILDING ENVELOPE
- EASEMENT

Notes:

- Final areas are subject to design changes, Council approval and field survey and may differ from those shown on this Disclosure Plan.
- Final presentation of areas will comply with requirements of the Registrar of Titles and may vary from the format on this Disclosure Plan
- The Seller, under the Contract Terms, is entitled to make Variations to the lot, including its location, area, size, dimensions, and elevation. Without limitation, if the area of the Lot on the Plan is not more than 5% different to the total area of the Lot as shown on this Disclosure Plan, the Variation is deemed to be a Permitted Variation and the Buyer cannot object.
- Design contours are approximate only and may change during construction
- Services have been plotted from design information only and may change during construction
- All earthworks fill to lots will be placed and compacted on Level 1 basis in accordance with Australian Standard AS3798-2007 "Guidelines on earthworks for commercial and residential developments".

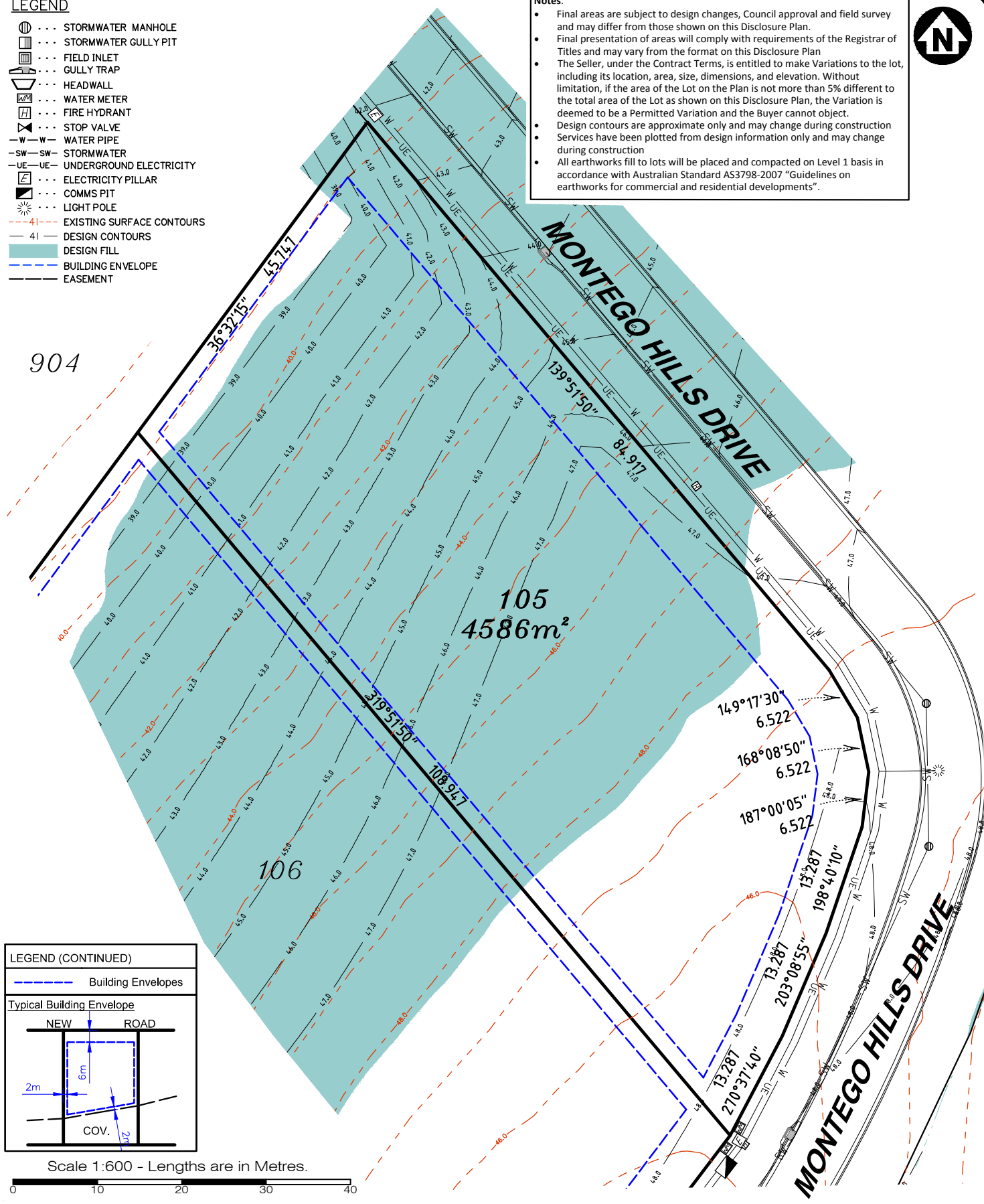

LEGEND (CONTINUED)

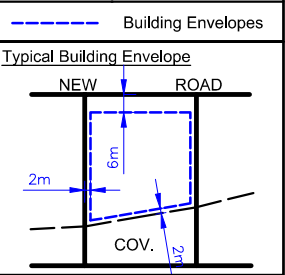

Scale 1:600 - Lengths are in Metres.

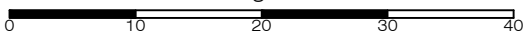

gassman development perspectives

est 1985

planning | environment | landscape | engineering | survey

T: 3807 3333 | F: 3287 5461 | www.gassman.com.au

Gold Coast & Logan | 176 Business Street, Yatala QLD | PO Box 392, Beenleigh 4207

Client	Kingsholme Developments Pty. Ltd.
Project	DISCLOSURE PLAN LOT 105 (Survey plan: SP280831) MONTEGO HILLS Montego Hills Drive, Kingsholme

Issue Date	22/12/2017
Meridian	SP264750
Level Datum	AHD
Contour Interval	1.0m
Drawn	N. Boyce
Date Drafted	15/12/2017
Checked	T. Geraghty

Real Property Description:
Lot 954 on SP264750

REFERENCE No. **5543-14**
PLAN No. **5543 S DC LOT 105**

LEGEND

- ⊙ . . . STORMWATER MANHOLE
- ⊞ . . . STORMWATER GULLY PIT
- ⊞ . . . FIELD INLET
- ⊞ . . . GULLY TRAP
- ⊞ . . . HEADWALL
- ⊞ . . . WATER METER
- ⊞ . . . FIRE HYDRANT
- ⊞ . . . STOP VALVE
- W-W- WATER PIPE
- SW-SW- STORMWATER
- UE-UE- UNDERGROUND ELECTRICITY
- ⊞ . . . ELECTRICITY PILLAR
- ⊞ . . . COMMS PIT
- ⊞ . . . LIGHT POLE
- - - 41- EXISTING SURFACE CONTOURS
- - - 41- DESIGN CONTOURS
- █ DESIGN FILL
- - - BUILDING ENVELOPE
- - - EASEMENT

Notes:

- Final areas are subject to design changes, Council approval and field survey and may differ from those shown on this Disclosure Plan.
- Final presentation of areas will comply with requirements of the Registrar of Titles and may vary from the format on this Disclosure Plan
- The Seller, under the Contract Terms, is entitled to make Variations to the lot, including its location, area, size, dimensions, and elevation. Without limitation, if the area of the Lot on the Plan is not more than 5% different to the total area of the Lot as shown on this Disclosure Plan, the Variation is deemed to be a Permitted Variation and the Buyer cannot object.
- Design contours are approximate only and may change during construction
- Services have been plotted from design information only and may change during construction
- All earthworks fill to lots will be placed and compacted on Level 1 basis in accordance with Australian Standard AS3798-2007 "Guidelines on earthworks for commercial and residential developments".



904

105

106
4566m²

107

LEGEND (CONTINUED)

- - - Building Envelopes

Typical Building Envelope

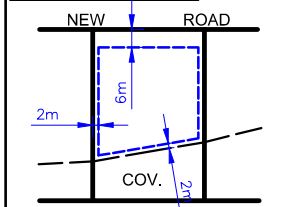

Scale 1:600 - Lengths are in Metres.

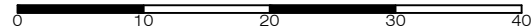

**gassman
development
perspectives**

planning | environment | landscape | engineering | survey

T: 3807 3333 | F: 3287 5461 | www.gassman.com.au

Gold Coast & Logan | 176 Business Street, Yatala QLD | PO Box 392, Beenleigh 4207

Client **Kingsholme Developments Pty. Ltd.**

Project **DISCLOSURE PLAN
LOT 106**
(Survey plan: SP280831)
MONTEGO HILLS
Montego Hills Drive, Kingsholme

Real Property Description:
Lot 954 on SP264750

Locality Kingsholme
Local Govt GOLD COAST CITY COUNCIL
Scale (on A4 original)
1:600

Issue Date 22/12/2017
Meridian SP264750
Level Datum AHD
Contour Interval 1.0m
Drawn N. Boyce
Date Drafted 15/12/2017
Checked T. Geraghty

REFERENCE No. **5543-14**
PLAN No. **5543 S DC LOT 106**

LEGEND

- ⊙ . . . STORMWATER MANHOLE
- ⊞ . . . STORMWATER GULLY PIT
- ⊞ . . . FIELD INLET
- ⊞ . . . GULLY TRAP
- ⊞ . . . HEADWALL
- ⊞ . . . WATER METER
- ⊞ . . . FIRE HYDRANT
- ⊞ . . . STOP VALVE
- W-W- WATER PIPE
- SW-SW- STORMWATER
- UE-UE- UNDERGROUND ELECTRICITY
- ⊞ . . . ELECTRICITY PILLAR
- ⊞ . . . COMMS PIT
- ⊞ . . . LIGHT POLE
- - -41- EXISTING SURFACE CONTOURS
- 41— DESIGN CONTOURS
- DESIGN FILL
- - - BUILDING ENVELOPE
- EASEMENT

Notes:

- Final areas are subject to design changes, Council approval and field survey and may differ from those shown on this Disclosure Plan.
- Final presentation of areas will comply with requirements of the Registrar of Titles and may vary from the format on this Disclosure Plan
- The Seller, under the Contract Terms, is entitled to make Variations to the lot, including its location, area, size, dimensions, and elevation. Without limitation, if the area of the Lot on the Plan is not more than 5% different to the total area of the Lot as shown on this Disclosure Plan, the Variation is deemed to be a Permitted Variation and the Buyer cannot object.
- Design contours are approximate only and may change during construction
- Services have been plotted from design information only and may change during construction
- All earthworks fill to lots will be placed and compacted on Level 1 basis in accordance with Australian Standard AS3798-2007 "Guidelines on earthworks for commercial and residential developments".

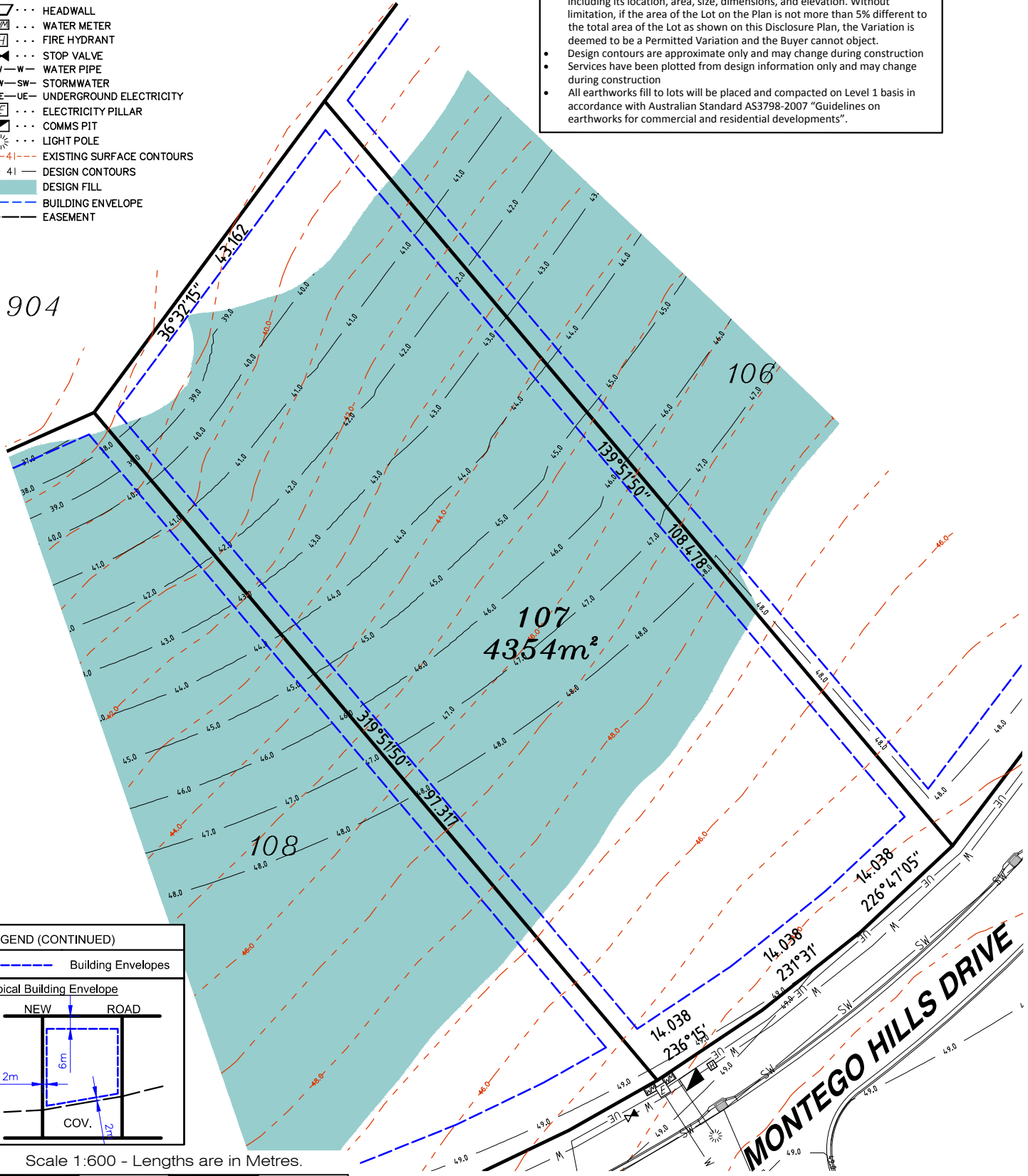

LEGEND (CONTINUED)

- - - Building Envelopes

Typical Building Envelope

NEW ROAD

6m

2m

COV.

gassman development perspectives

est 1985

planning | environment | landscape | engineering | survey

T: 3807 3333 | F: 3287 5461 | www.gassman.com.au

Gold Coast & Logan | 176 Business Street, Yatala QLD | PO Box 392, Beenleigh 4207

Client	Kingsholme Developments Pty. Ltd.
Project	DISCLOSURE PLAN LOT 107 (Survey plan: SP280831) MONTEGO HILLS Montego Hills Drive, Kingsholme

Issue Date	22/12/2017
Meridian	SP264750
Level Datum	AHD
Contour Interval	1.0m
Drawn	N. Boyce
Date Drafted	15/12/2017
Checked	T. Geraghty

Real Property Description:
Lot 954 on SP264750

REFERENCE No. **5543-14**
PLAN No. **5543 S DC LOT 107**

LEGEND

- ⊙ . . . STORMWATER MANHOLE
- ⊞ . . . STORMWATER GULLY PIT
- ⊞ . . . FIELD INLET
- ⊞ . . . GULLY TRAP
- ⊞ . . . HEADWALL
- ⊞ . . . WATER METER
- ⊞ . . . FIRE HYDRANT
- ⊞ . . . STOP VALVE
- W-W- WATER PIPE
- SW-SW- STORMWATER
- UE-UE- UNDERGROUND ELECTRICITY
- ⊞ . . . ELECTRICITY PILLAR
- ⊞ . . . COMMS PIT
- ⊞ . . . LIGHT POLE
- - - 41 - - - EXISTING SURFACE CONTOURS
- 41 — DESIGN CONTOURS
- █ DESIGN FILL
- - - BUILDING ENVELOPE
- EASEMENT

Notes:

- Final areas are subject to design changes, Council approval and field survey and may differ from those shown on this Disclosure Plan.
- Final presentation of areas will comply with requirements of the Registrar of Titles and may vary from the format on this Disclosure Plan
- The Seller, under the Contract Terms, is entitled to make Variations to the lot, including its location, area, size, dimensions, and elevation. Without limitation, if the area of the Lot on the Plan is not more than 5% different to the total area of the Lot as shown on this Disclosure Plan, the Variation is deemed to be a Permitted Variation and the Buyer cannot object.
- Design contours are approximate only and may change during construction
- Services have been plotted from design information only and may change during construction
- All earthworks fill to lots will be placed and compacted on Level 1 basis in accordance with Australian Standard AS3798-2007 "Guidelines on earthworks for commercial and residential developments".

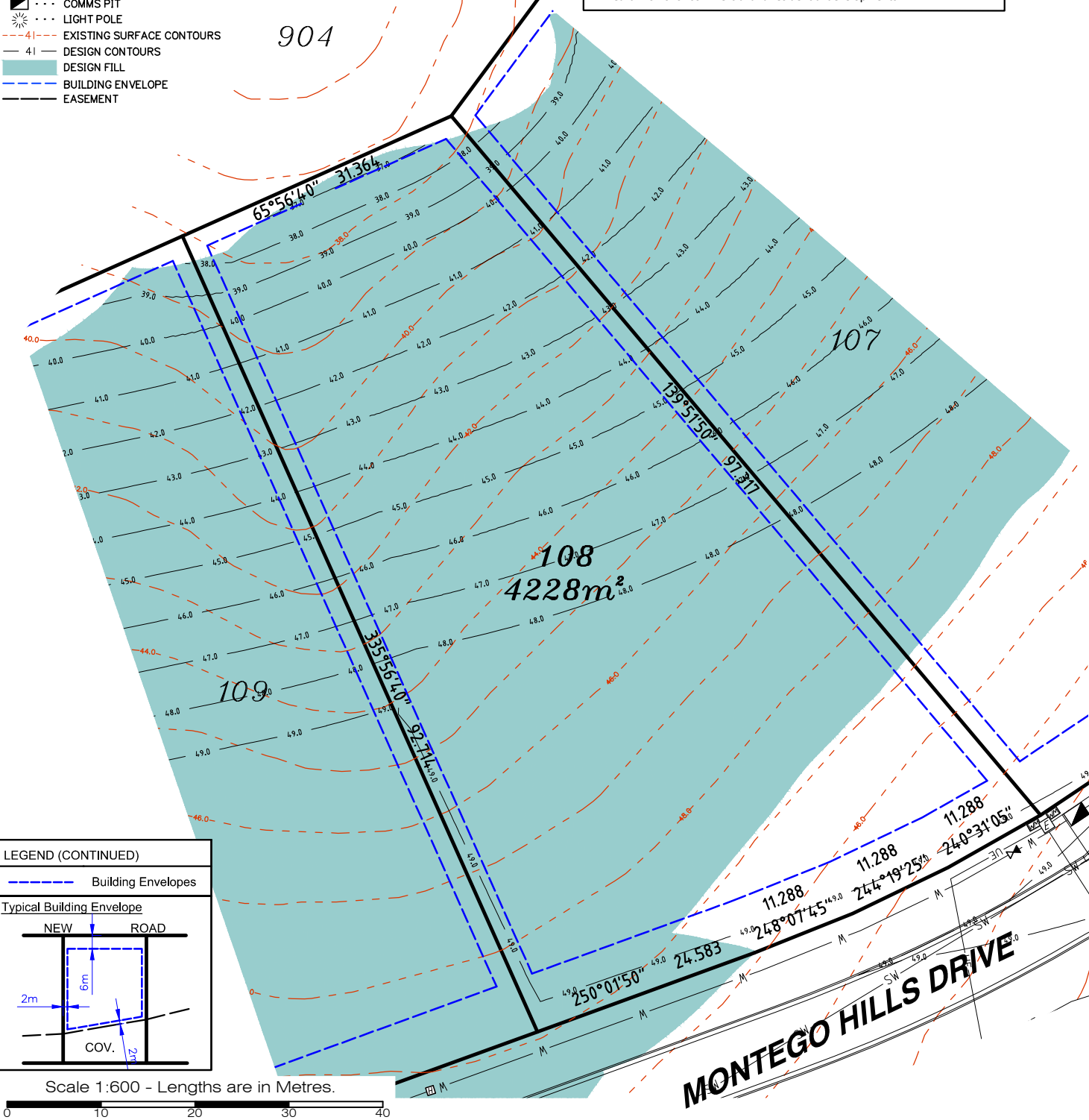

LEGEND (CONTINUED)

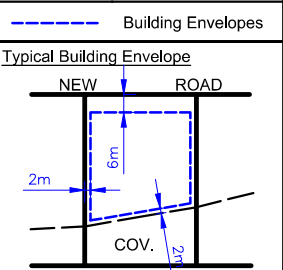

Scale 1:600 - Lengths are in Metres.



**gassman
development
perspectives**

planning | environment | landscape | engineering | survey

T: 3807 3333 | F: 3287 5461 | www.gassman.com.au

Gold Coast & Logan | 176 Business Street, Yatala QLD | PO Box 392, Beenleigh 4207

Client **Kingsholme Developments Pty. Ltd.**

Project **DISCLOSURE PLAN
LOT 108**
(Survey plan: SP280831)
MONTAGO HILLS
Montago Hills Drive, Kingsholme

Real Property Description:
Lot 954 on SP264750

Locality Kingsholme
Local Govt GOLD COAST CITY COUNCIL
Scale (on A4 original) **1:600**

Issue Date 22/12/2017
Meridian SP264750
Level Datum AHD
Contour Interval 1.0m
Drawn N. Boyce
Date Drafted 15/12/2017
Checked T. Geraghty

REFERENCE No. **5543-14**
PLAN No. **5543 S DC LOT 108**

LEGEND

- ⊙ . . . STORMWATER MANHOLE
- ⊞ . . . STORMWATER GULLY PIT
- ⊞ . . . FIELD INLET
- ⊞ . . . GULLY TRAP
- ⊞ . . . HEADWALL
- ⊞ . . . WATER METER
- ⊞ . . . FIRE HYDRANT
- ⊞ . . . STOP VALVE
- W-W- WATER PIPE
- SW-SW- STORMWATER
- UE-UE- UNDERGROUND ELECTRICITY
- ⊞ . . . ELECTRICITY PILLAR
- ⊞ . . . COMMS PIT
- ⊞ . . . LIGHT POLE
- - -41- - - EXISTING SURFACE CONTOURS
- 41 - - - DESIGN CONTOURS
- █ DESIGN FILL
- - - BUILDING ENVELOPE
- - - EASEMENT

Notes:

- Final areas are subject to design changes, Council approval and field survey and may differ from those shown on this Disclosure Plan.
- Final presentation of areas will comply with requirements of the Registrar of Titles and may vary from the format on this Disclosure Plan
- The Seller, under the Contract Terms, is entitled to make Variations to the lot, including its location, area, size, dimensions, and elevation. Without limitation, if the area of the Lot on the Plan is not more than 5% different to the total area of the Lot as shown on this Disclosure Plan, the Variation is deemed to be a Permitted Variation on the Buyer cannot object.
- Design contours are approximate only and may change during construction
- Services have been plotted from design information only and may change during construction
- All earthworks fill to lots will be placed and compacted on Level 1 basis in accordance with Australian Standard AS3798-2007 "Guidelines on earthworks for commercial and residential developments".

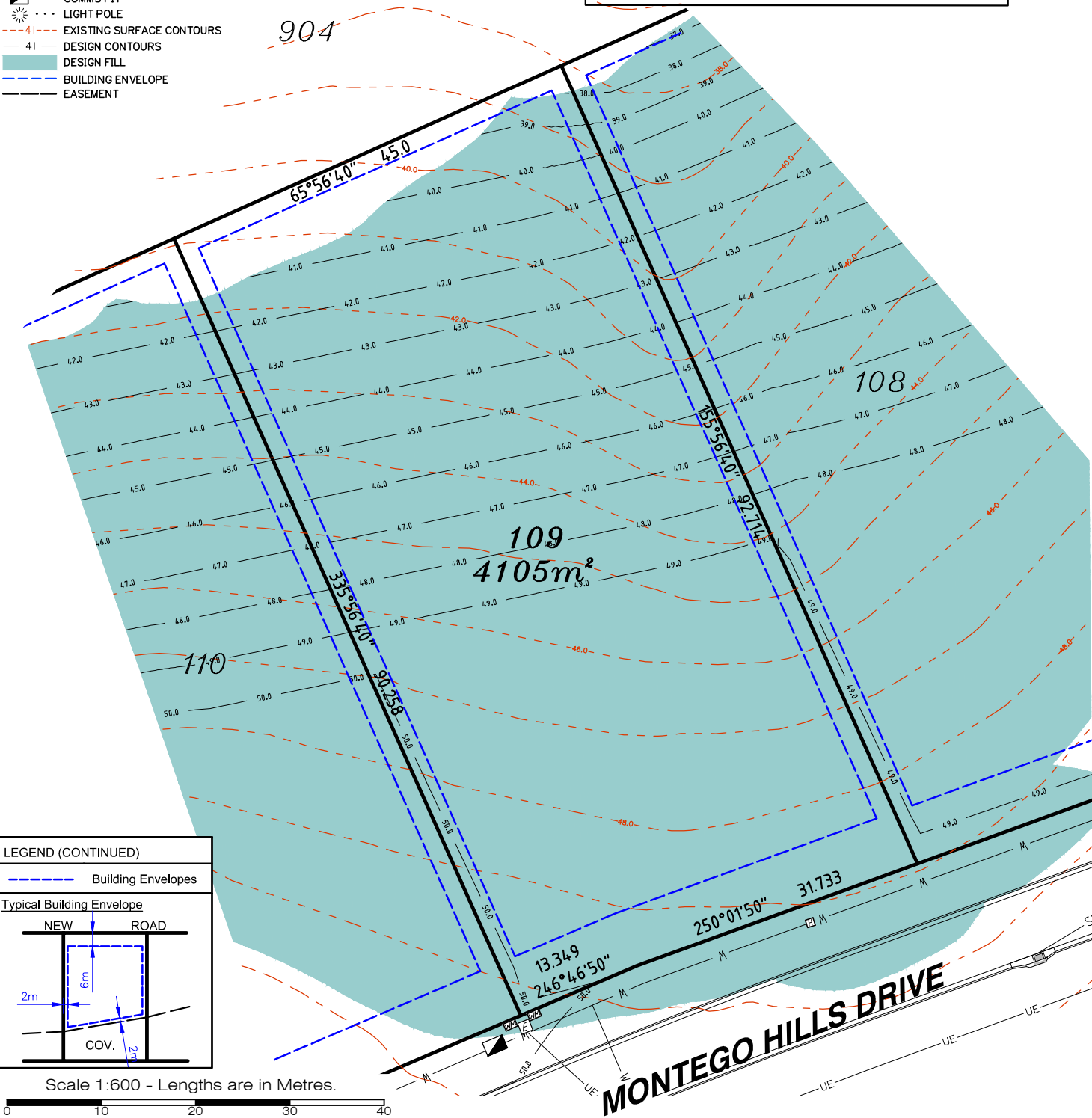

LEGEND (CONTINUED)

- - - Building Envelopes

Typical Building Envelope

Scale 1:600 - Lengths are in Metres.

gassman
development
perspectives

est 1985

planning | environment | landscape | engineering | survey

T: 3807 3333 | F: 3287 5461 | www.gassman.com.au

Gold Coast & Logan | 176 Business Street, Yatala QLD | PO Box 392, Beenleigh 4207

Client Kingsholme Developments Pty. Ltd.

Project **DISCLOSURE PLAN**
LOT 109
(Survey plan: SP280831)
MONTENGO HILLS
Montenago Hills Drive, Kingsholme

Locality	Kingsholme	Issue Date	22/12/2017
Local Govt	GOLD COAST CITY COUNCIL	Meridian	SP264750
		Level Datum	AHD
		Contour Interval	1.0m
Scale (on A4 original)	1:600	Drawn	N. Boyce
		Date Drafted	15/12/2017
		Checked	T. Geraghty

Real Property Description:
Lot 954 on SP264750

REFERENCE No. 5543-14
PLAN No. 5543 S DC LOT 109

LEGEND

- ⊙ . . . STORMWATER MANHOLE
- ⊞ . . . STORMWATER GULLY PIT
- ⊞ . . . FIELD INLET
- ⊞ . . . GULLY TRAP
- ⊞ . . . HEADWALL
- ⊞ . . . WATER METER
- ⊞ . . . FIRE HYDRANT
- ⊞ . . . STOP VALVE
- W-W- WATER PIPE
- SW-SW- STORMWATER
- UE-UE- UNDERGROUND ELECTRICITY
- ⊞ . . . ELECTRICITY PILLAR
- ⊞ . . . COMMS PIT
- ⊞ . . . LIGHT POLE
- 41-41- EXISTING SURFACE CONTOURS
- 41 — DESIGN CONTOURS
- █ DESIGN FILL
- - - BUILDING ENVELOPE
- EASEMENT

Notes:

- Final areas are subject to design changes, Council approval and field survey and may differ from those shown on this Disclosure Plan.
- Final presentation of areas will comply with requirements of the Registrar of Titles and may vary from the format on this Disclosure Plan
- The Seller, under the Contract Terms, is entitled to make Variations to the lot, including its location, area, size, dimensions, and elevation. Without limitation, if the area of the Lot on the Plan is not more than 5% different to the total area of the Lot as shown on this Disclosure Plan, the Variation is deemed to be a Permitted Variation and the Buyer cannot object.
- Design contours are approximate only and may change during construction
- Services have been plotted from design information only and may change during construction
- All earthworks fill to lots will be placed and compacted on Level 1 basis in accordance with Australian Standard AS3798-2007 "Guidelines on earthworks for commercial and residential developments".

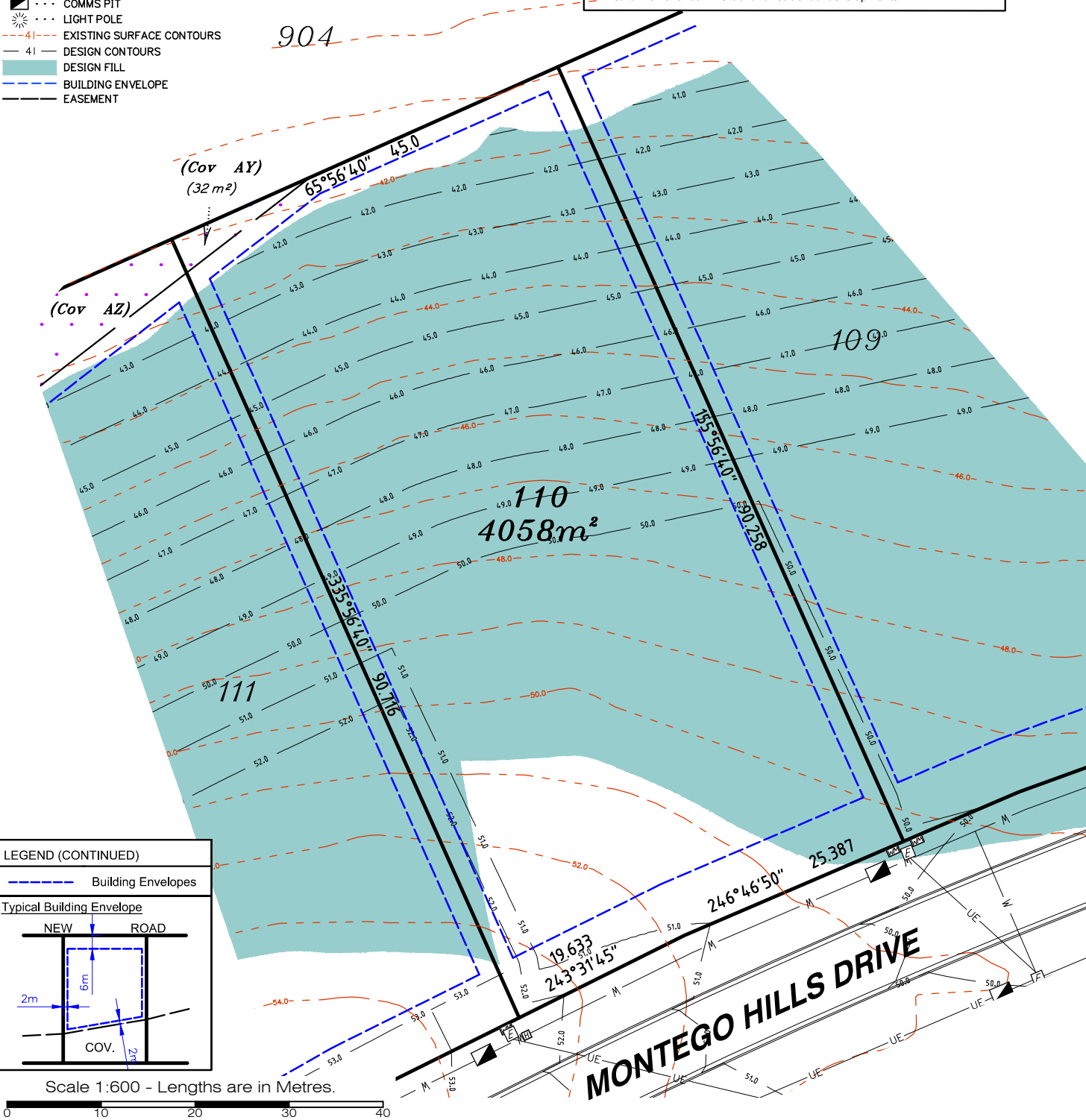

gassman development perspectives

est 1985

planning | environment | landscape | engineering | survey

T: 3807 3333 | F: 3287 5461 | www.gassman.com.au

Gold Coast & Logan | 176 Business Street, Yatala QLD | PO Box 392, Beenleigh 4207

Client	Kingsholme Developments Pty. Ltd.
Project	DISCLOSURE PLAN LOT 110 (Survey plan: SP280831) MONTEGO HILLS Montego Hills Drive, Kingsholme
Real Property Description:	Lot 954 on SP264750

Locality	Kingsholme	Issue Date	22/12/2017
Local Govt	GOLD COAST CITY COUNCIL	Meridian	SP264750
Scale (on A4 original)	1:600	Level Datum	AHD
REFERENCE No.	5543-14	Contour Interval	1.0m
PLAN No.	5543 S DC LOT 110	Drawn	N. Boyce
		Date Drafted	15/12/2017
		Checked	T. Geraghty

LEGEND

- ⊙ ... STORMWATER MANHOLE
- ⊞ ... STORMWATER GULLY PIT
- ⊞ ... FIELD INLET
- ⊞ ... GULLY TRAP
- ⊞ ... HEADWALL
- ⊞ ... WATER METER
- ⊞ ... FIRE HYDRANT
- ⊞ ... STOP VALVE
- W-W- WATER PIPE
- SW-SW- STORMWATER
- UE-UE- UNDERGROUND ELECTRICITY
- ⊞ ... ELECTRICITY PILLAR
- ⊞ ... COMMS PIT
- ⊞ ... LIGHT POLE
- - -41- EXISTING SURFACE CONTOURS
- - -41- DESIGN CONTOURS
- █ DESIGN FILL
- - - BUILDING ENVELOPE
- - - EASEMENT

Notes:

- Final areas are subject to design changes, Council approval and field survey and may differ from those shown on this Disclosure Plan.
- Final presentation of areas will comply with requirements of the Registrar of Titles and may vary from the format on this Disclosure Plan
- The Seller, under the Contract Terms, is entitled to make Variations to the lot, including its location, area, size, dimensions, and elevation. Without limitation, if the area of the Lot on the Plan is not more than 5% different to the total area of the Lot as shown on this Disclosure Plan, the Variation is deemed to be a Permitted Variation and the Buyer cannot object.
- Design contours are approximate only and may change during construction
- Services have been plotted from design information only and may change during construction
- All earthworks fill to lots will be placed and compacted on Level 1 basis in accordance with Australian Standard AS3798-2007 "Guidelines on earthworks for commercial and residential developments".

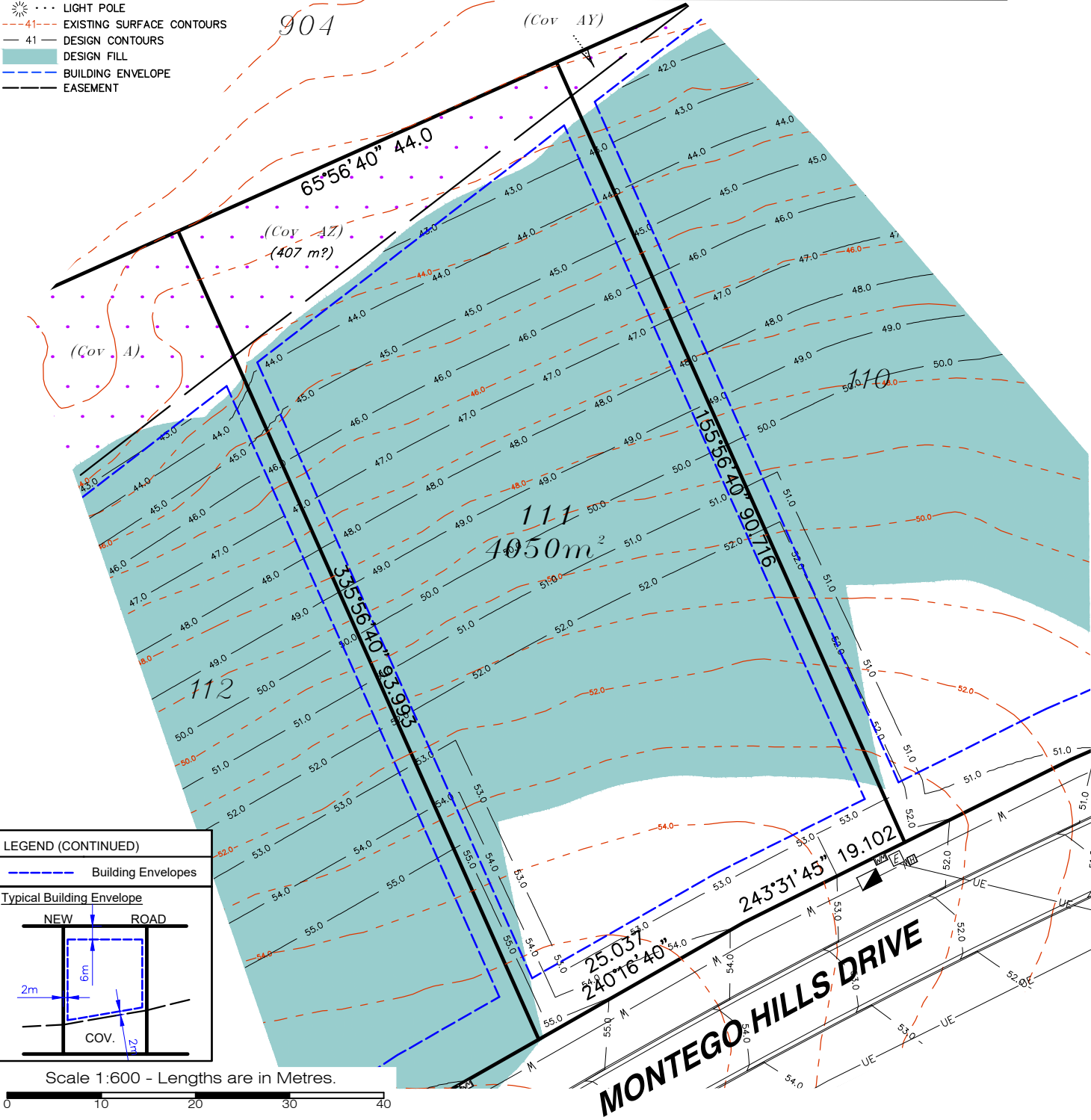

LEGEND (CONTINUED)

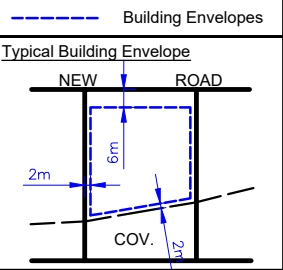

Scale 1:600 - Lengths are in Metres.



gassman
development
perspectives

planning | environment | landscape | engineering | survey
T: 3807 3333 | F: 3287 5461 | www.gassman.com.au
Gold Coast & Logan | 176 Business Street, Yatala QLD | PO Box 392, Beenleigh 4207

Client **Kingsholme Developments Pty. Ltd.**

Project **DISCLOSURE PLAN**
LOT 111
(Survey plan: SP280831)
MONTEGO HILLS
Montego Hills Drive, Kingsholme

Real Property Description:
Lot 954 on SP264750

Locality **Kingsholme**
Local Govt **GOLD COAST CITY COUNCIL**
Scale (on A4 original)
1:600

Issue Date **22/12/2017**
Meridian **SP264750**
Level Datum **AHD**
Contour Interval **1.0m**
Drawn **N. Boyce**
Date Drafted **15/12/2017**
Checked **T. Geraghty**

REFERENCE No. **5543-14**
PLAN No. **5543 S DC LOT 111**

LEGEND

- ⊙ . . . STORMWATER MANHOLE
- ⊞ . . . STORMWATER GULLY PIT
- ⊞ . . . FIELD INLET
- ⊞ . . . GULLY TRAP
- ⊞ . . . HEADWALL
- ⊞ . . . WATER METER
- ⊞ . . . FIRE HYDRANT
- ⊞ . . . STOP VALVE
- W-W- WATER PIPE
- SW-SW- STORMWATER
- UE-UE- UNDERGROUND ELECTRICITY
- ⊞ . . . ELECTRICITY PILLAR
- ⊞ . . . COMMS PIT
- ⊞ . . . LIGHT POLE
- - - 41- EXISTING SURFACE CONTOURS
- - - 41- DESIGN CONTOURS
- █ DESIGN FILL
- - - BUILDING ENVELOPE
- - - EASEMENT

Notes:

- Final areas are subject to design changes, Council approval and field survey and may differ from those shown on this Disclosure Plan.
- Final presentation of areas will comply with requirements of the Registrar of Titles and may vary from the format on this Disclosure Plan
- The Seller, under the Contract Terms, is entitled to make Variations to the lot, including its location, area, size, dimensions, and elevation. Without limitation, if the area of the Lot on the Plan is not more than 5% different to the total area of the Lot as shown on this Disclosure Plan, the Variation is deemed to be a Permitted Variation and the Buyer cannot object.
- Design contours are approximate only and may change during construction
- Services have been plotted from design information only and may change during construction
- All earthworks fill to lots will be placed and compacted on Level 1 basis in accordance with Australian Standard AS3798-2007 "Guidelines on earthworks for commercial and residential developments".

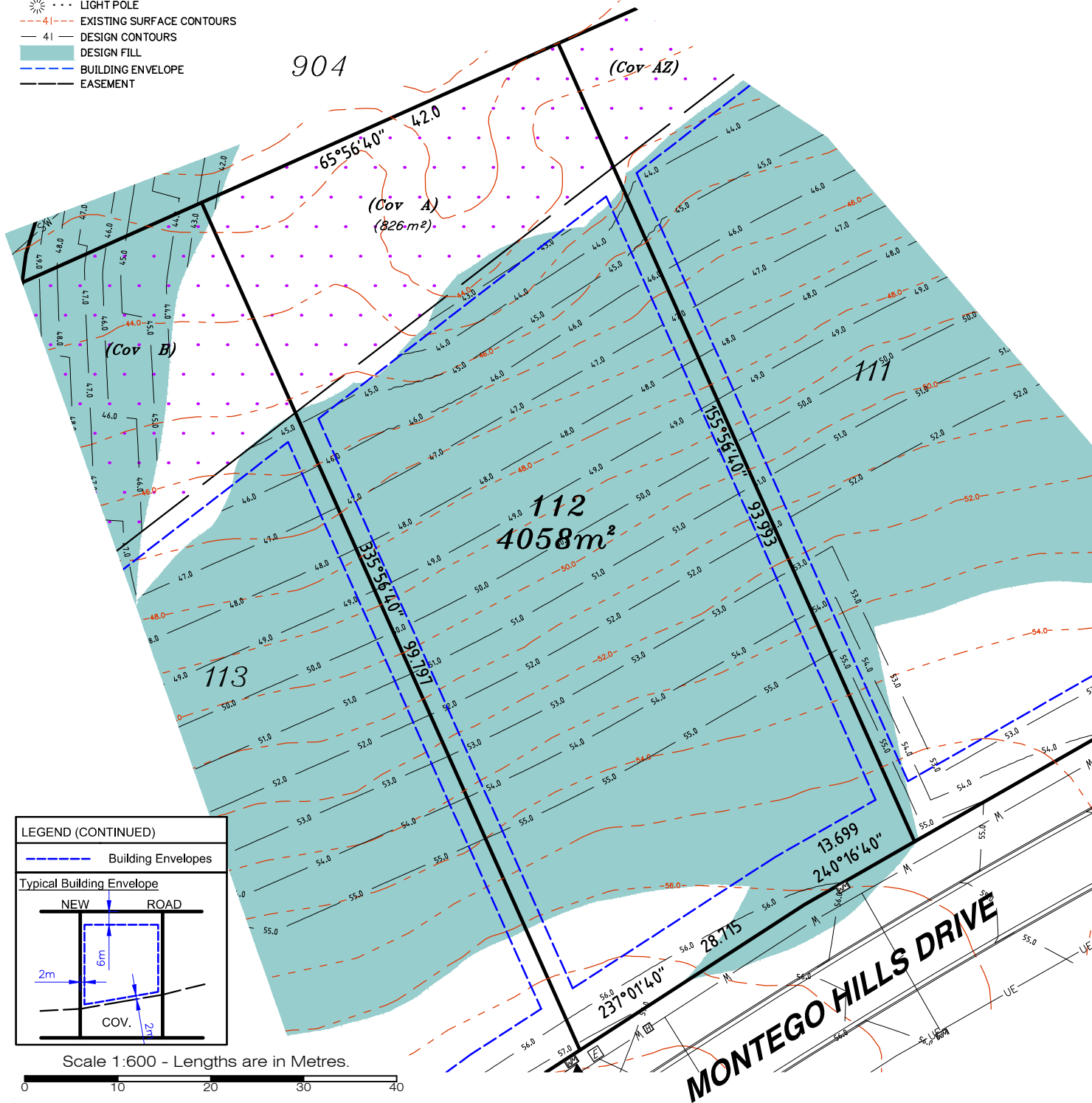

LEGEND (CONTINUED)

- - - Building Envelopes

Typical Building Envelope

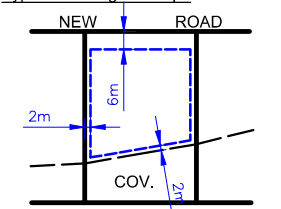

Scale 1:600 - Lengths are in Metres.

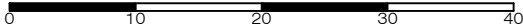

**gassman
development
perspectives**

planning | environment | landscape | engineering | survey

T: 3807 3333 | F: 3287 5461 | www.gassman.com.au

Gold Coast & Logan | 176 Business Street, Yatala QLD | PO Box 392, Beenleigh 4207

Client **Kingsholme Developments Pty. Ltd.**

Project **DISCLOSURE PLAN
LOT 112**
(Survey plan: SP280831)
MONTAGO HILLS
Montago Hills Drive, Kingsholme

Real Property Description:
Lot 954 on SP264750

Locality **Kingsholme**
Local Govt **GOLD COAST
CITY COUNCIL**
Scale (on A4 original)
1:600

Issue Date **22/12/2017**
Meridian **SP264750**
Level Datum **AHD**
Contour Interval **1.0m**
Drawn **N. Boyce**
Date Drafted **15/12/2017**
Checked **T. Geraghty**

REFERENCE No. **5543-14**
PLAN No. **5543 S DC LOT 112**

LEGEND

- ⊙ ... STORMWATER MANHOLE
- ⊞ ... STORMWATER GULLY PIT
- ⊞ ... FIELD INLET
- ⊞ ... GULLY TRAP
- ⊞ ... HEADWALL
- ⊞ ... WATER METER
- ⊞ ... FIRE HYDRANT
- ⊞ ... STOP VALVE
- W—W WATER PIPE
- SW—SW STORMWATER
- UE—UE UNDERGROUND ELECTRICITY
- ⊞ ... ELECTRICITY PILLAR
- ⊞ ... COMMS PIT
- ⊞ ... LIGHT POLE
- - -41- - - EXISTING SURFACE CONTOURS
- 41 — DESIGN CONTOURS
- █ DESIGN FILL
- - - BUILDING ENVELOPE
- EASEMENT

Notes:

- Final areas are subject to design changes, Council approval and field survey and may differ from those shown on this Disclosure Plan.
- Final presentation of areas will comply with requirements of the Registrar of Titles and may vary from the format on this Disclosure Plan
- The Seller, under the Contract Terms, is entitled to make Variations to the lot, including its location, area, size, dimensions, and elevation. Without limitation, if the area of the Lot on the Plan is not more than 5% different to the total area of the Lot as shown on this Disclosure Plan, the Variation is deemed to be a Permitted Variation and the Buyer cannot object.
- Design contours are approximate only and may change during construction
- Services have been plotted from design information only and may change during construction
- All earthworks fill to lots will be placed and compacted on Level 1 basis in accordance with Australian Standard AS3798-2007 "Guidelines on earthworks for commercial and residential developments".

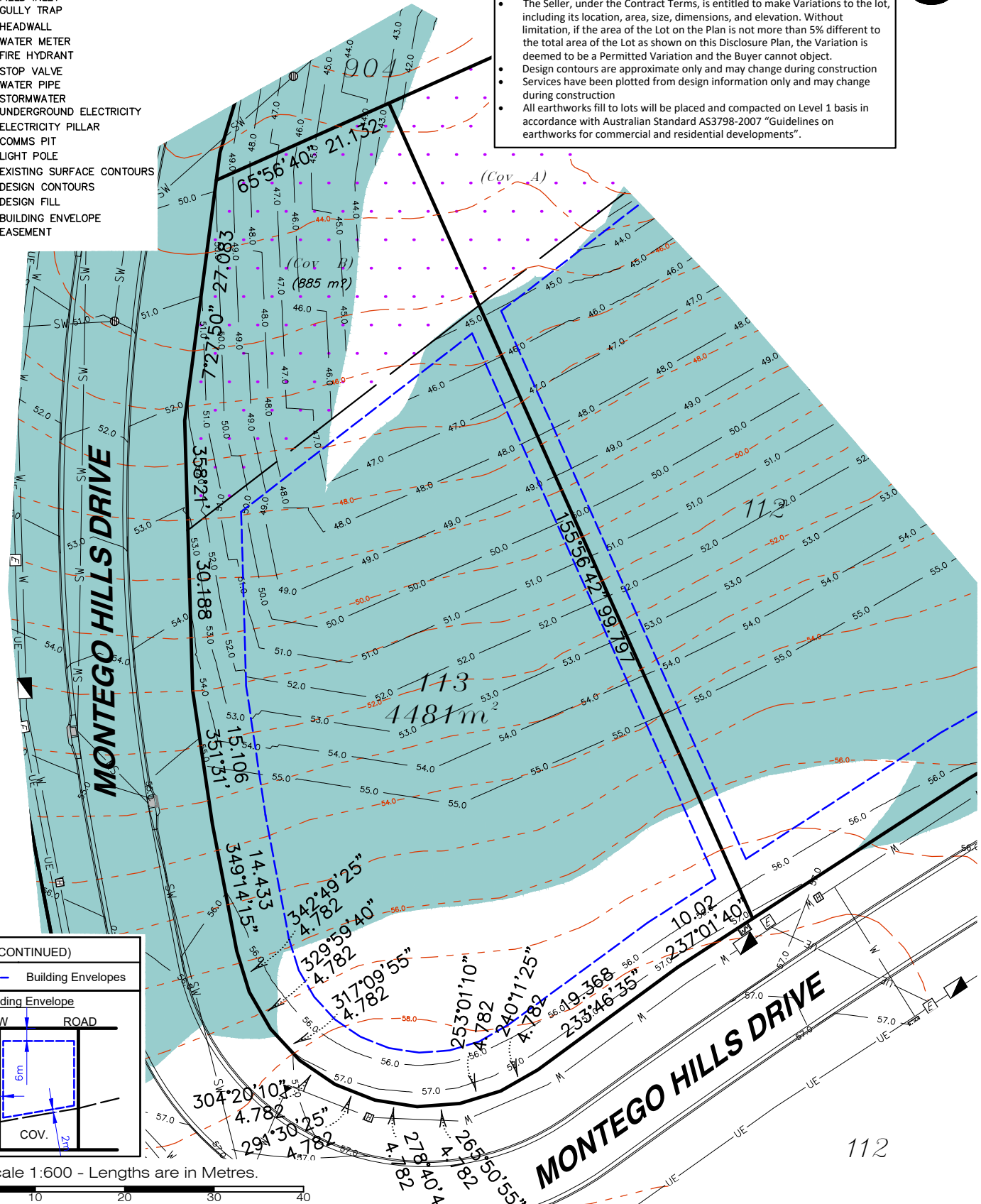

LEGEND (CONTINUED)

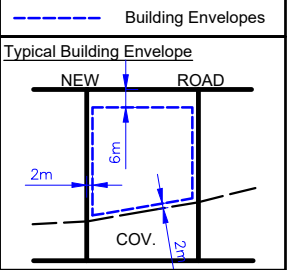

Scale 1:600 - Lengths are in Metres.

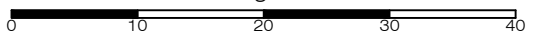

gassman development perspectives

planning | environment | landscape | engineering | survey

T: 3807 3333 | F: 3287 5461 | www.gassman.com.au

Gold Coast & Logan | 176 Business Street, Yatala QLD | PO Box 392, Beenleigh 4207

Client	Kingsholme Developments Pty. Ltd.
Project	DISCLOSURE PLAN LOT 113 (Survey plan: SP280831) MONTEGO HILLS Montego Hills Drive, Kingsholme

Issue Date	22/12/2017
Meridian	SP264750
Level Datum	AHD
Contour Interval	1.0m
Drawn	N. Boyce
Date Drafted	15/12/2017
Checked	T. Geraghty

Real Property Description:
Lot 954 on SP264750

REFERENCE No. **5543-14**
PLAN No. **5543 S DC LOT 113**

LEGEND

- ... STORMWATER MANHOLE
- ... STORMWATER GULLY PIT
- ... FIELD INLET
- ... GULLY TRAP
- ... HEADWALL
- ... WATER METER
- ... FIRE HYDRANT
- ... STOP VALVE
- ... WATER PIPE
- ... STORMWATER
- ... UNDERGROUND ELECTRICITY
- ... ELECTRICITY PILLAR
- ... COMMS PIT
- ... LIGHT POLE
- ... EXISTING SURFACE CONTOURS
- ... 41 DESIGN CONTOURS
- ... DESIGN FILL
- ... BUILDING ENVELOPE
- ... EASEMENT

- Notes:**
- Final areas are subject to design changes, Council approval and field survey and may differ from those shown on this Disclosure Plan.
 - Final presentation of areas will comply with requirements of the Registrar of Titles and may vary from the format on this Disclosure Plan
 - The Seller, under the Contract Terms, is entitled to make Variations to the lot, including its location, area, size, dimensions, and elevation. Without limitation, if the area of the Lot on the Plan is not more than 5% different to the total area of the Lot as shown on this Disclosure Plan, the Variation is deemed to be a Permitted Variation and the Buyer cannot object.
 - Design contours are approximate only and may change during construction
 - Services have been plotted from design information only and may change during construction
 - All earthworks fill to lots will be placed and compacted on Level 1 basis in accordance with Australian Standard AS3798-2007 "Guidelines on earthworks for commercial and residential developments".

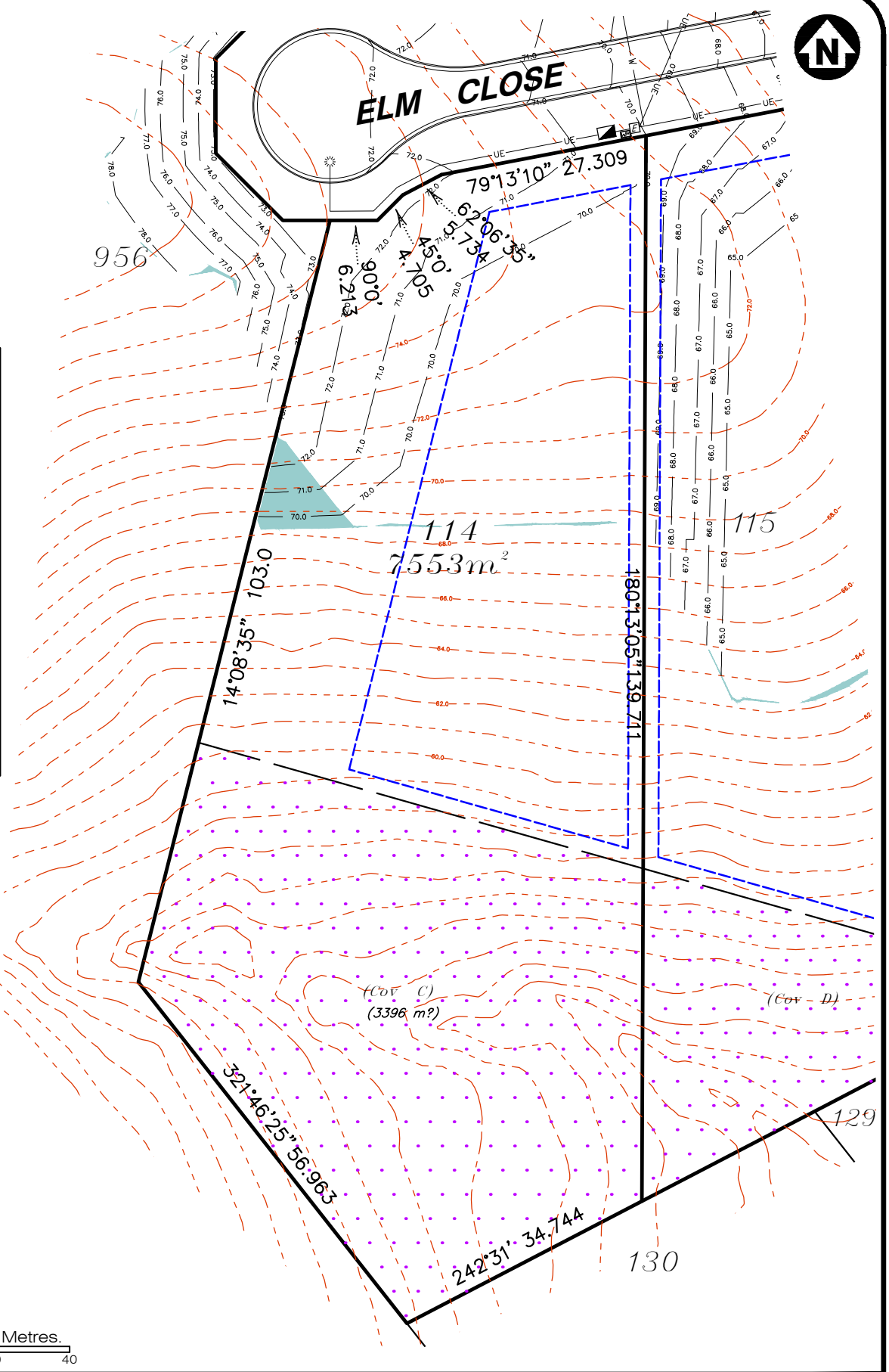

LEGEND (CONTINUED)

- Building Envelopes

Typical Building Envelope

Scale 1:750 - Lengths are in Metres.

gassman development perspectives
est 1985

planning | environment | landscape | engineering | survey

T: 3807 3333 | F: 3287 5461 | www.gassman.com.au

Gold Coast & Logan | 176 Business Street, Yatala QLD | PO Box 392, Beenleigh 4207

Client Kingsholme Developments Pty. Ltd.

Project **DISCLOSURE PLAN**
LOT 114
(Survey plan: SP280831)
MONTEGO HILLS
Montego Hills Drive, Kingsholme

Locality	Kingsholme	Issue Date	22/12/2017
Local Govt	GOLD COAST CITY COUNCIL	Meridian	SP264750
Scale (on A4 original)	1:750	Level Datum	AHD
		Contour Interval	1.0m
		Drawn	N. Boyce
		Date Drafted	15/12/2017
		Checked	T. Geraghty

Real Property Description:
Lot 954 on SP264750

REFERENCE No. 5543-14
PLAN No. 5543 S DC LOT 114

LEGEND

- ... STORMWATER MANHOLE
- ... STORMWATER GULLY PIT
- ... FIELD INLET
- ... GULLY TRAP
- ... HEADWALL
- ... WATER METER
- ... FIRE HYDRANT
- ... STOP VALVE
- ... WATER PIPE
- ... STORMWATER
- ... UNDERGROUND ELECTRICITY
- ... ELECTRICITY PILLAR
- ... COMMS PIT
- ... LIGHT POLE
- ... EXISTING SURFACE CONTOURS
- ... DESIGN CONTOURS
- ... DESIGN FILL
- ... BUILDING ENVELOPE
- ... EASEMENT

- Notes:**
- Final areas are subject to design changes, Council approval and field survey and may differ from those shown on this Disclosure Plan.
 - Final presentation of areas will comply with requirements of the Registrar of Titles and may vary from the format on this Disclosure Plan
 - The Seller, under the Contract Terms, is entitled to make Variations to the lot, including its location, area, size, dimensions, and elevation. Without limitation, if the area of the Lot on the Plan is not more than 5% different to the total area of the Lot as shown on this Disclosure Plan, the Variation is deemed to be a Permitted Variation and the Buyer cannot object.
 - Design contours are approximate only and may change during construction
 - Services have been plotted from design information only and may change during construction
 - All earthworks to lots will be placed and compacted on Level 1 basis in accordance with Australian Standard AS3798-2007 "Guidelines on earthworks for commercial and residential developments".

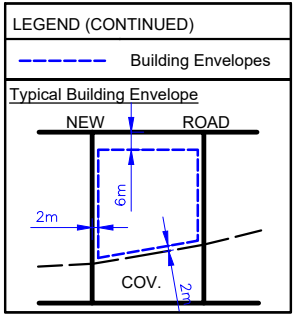
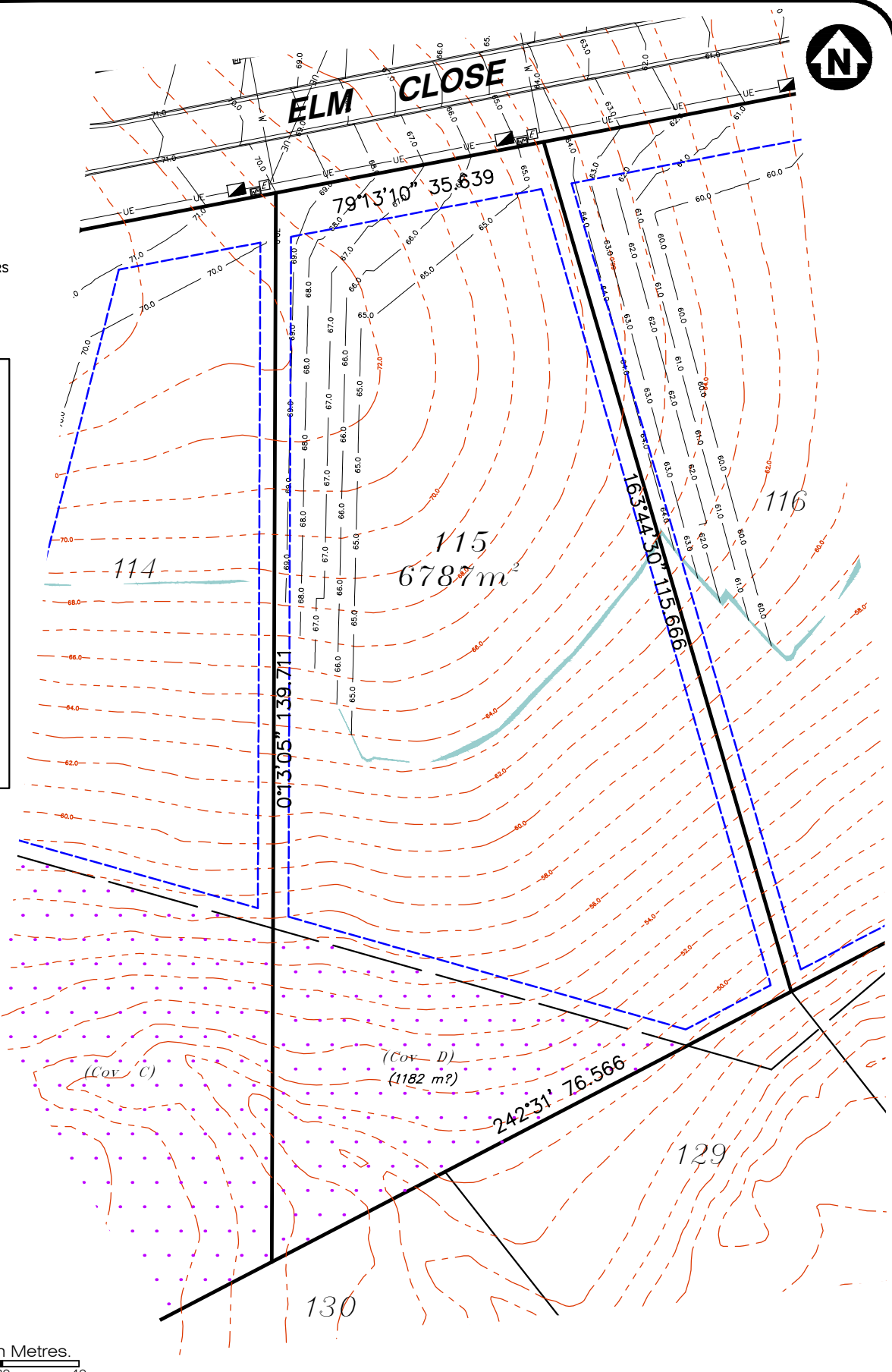

Scale 1:750 - Lengths are in Metres.

gassman development perspectives
est 1985

planning | environment | landscape | engineering | survey

T: 3807 3333 | F: 3287 5461 | www.gassman.com.au

Gold Coast & Logan | 176 Business Street, Yatala QLD | PO Box 392, Beenleigh 4207

Client Kingsholme Developments Pty. Ltd.

Project **DISCLOSURE PLAN**
LOT 115
(Survey plan: SP280831)
MONTEGO HILLS
Montego Hills Drive, Kingsholme

Locality	Kingsholme	Issue Date	22/12/2017
Local Govt	GOLD COAST CITY COUNCIL	Meridian	SP264750
		Level Datum	AHD
		Contour Interval	1.0m
Scale (on A4 original)	1:750	Drawn	N. Boyce
		Date Drafted	15/12/2017
		Checked	T. Geraghty

Real Property Description:
Lot 954 on SP264750

REFERENCE No. 5543-14
PLAN No. 5543 S DC LOT 115

LEGEND

- ... STORMWATER MANHOLE
- ... STORMWATER GULLY PIT
- ... FIELD INLET
- ... GULLY TRAP
- ... HEADWALL
- ... WATER METER
- ... FIRE HYDRANT
- ... STOP VALVE
- ... WATER PIPE
- ... STORMWATER
- ... UNDERGROUND ELECTRICITY
- ... ELECTRICITY PILLAR
- ... COMMS PIT
- ... LIGHT POLE
- ... 41 EXISTING SURFACE CONTOURS
- ... 41 DESIGN CONTOURS
- ... DESIGN FILL
- ... BUILDING ENVELOPE
- ... EASEMENT



- Notes:**
- Final areas are subject to design changes, Council approval and field survey and may differ from those shown on this Disclosure Plan.
 - Final presentation of areas will comply with requirements of the Registrar of Titles and may vary from the format on this Disclosure Plan
 - The Seller, under the Contract Terms, is entitled to make Variations to the lot, including its location, area, size, dimensions, and elevation. Without limitation, if the area of the Lot on the Plan is not more than 5% different to the total area of the Lot as shown on this Disclosure Plan, the Variation is deemed to be a Permitted Variation and the Buyer cannot object.
 - Design contours are approximate only and may change during construction
 - Services have been plotted from design information only and may change during construction
 - All earthworks fill to lots will be placed and compacted on Level 1 basis in accordance with Australian Standard AS3798-2007 "Guidelines on earthworks for commercial and residential developments".

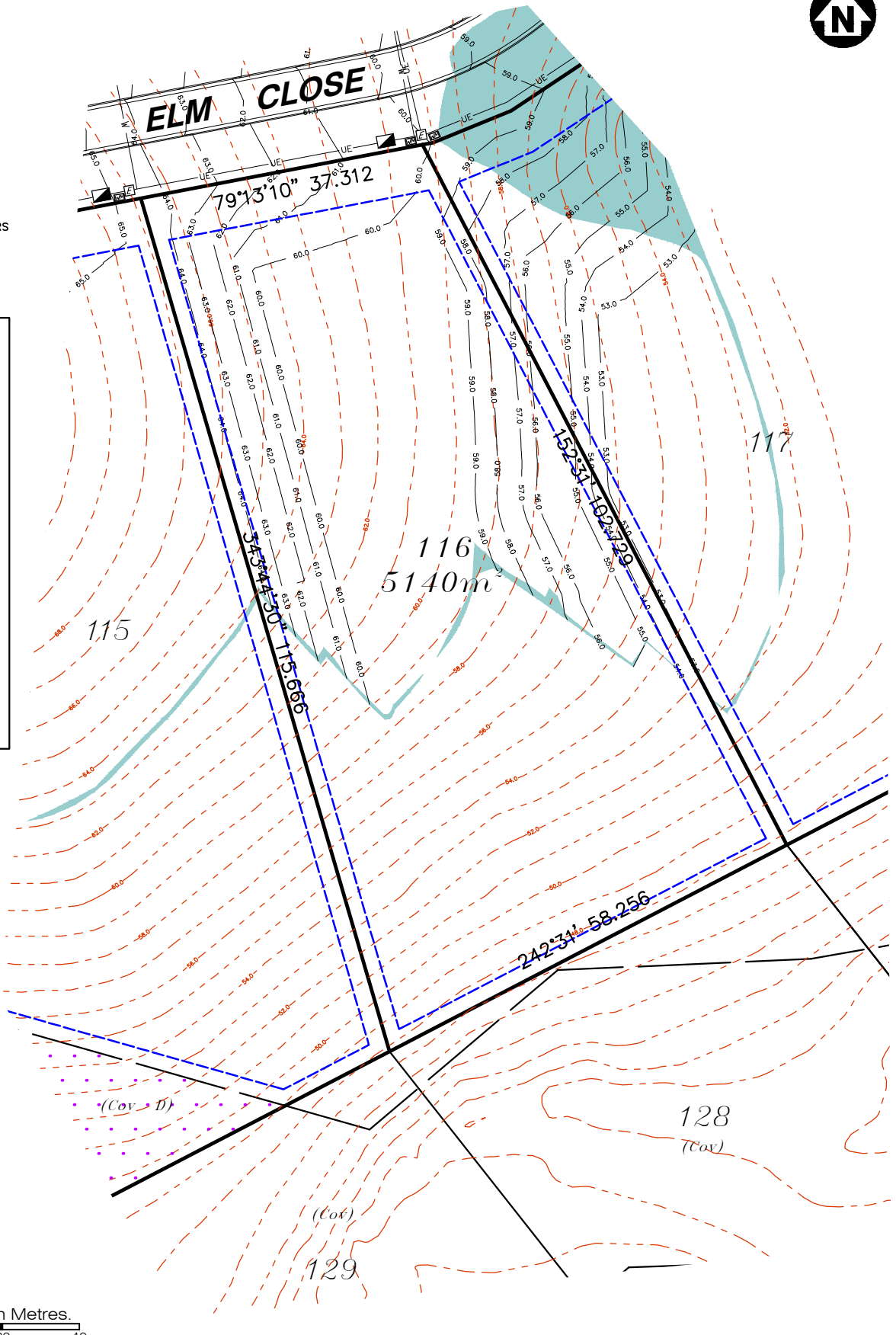

LEGEND (CONTINUED)

- Building Envelopes

Typical Building Envelope

Scale 1:750 - Lengths are in Metres.

gassman development perspectives
est 1985

planning | environment | landscape | engineering | survey

T: 3807 3333 | F: 3287 5461 | www.gassman.com.au

Gold Coast & Logan | 176 Business Street, Yatala QLD | PO Box 392, Beenleigh 4207

Client	Kingsholme Developments Pty. Ltd.
Project	DISCLOSURE PLAN LOT 116 (Survey plan: SP280831) MONTEGO HILLS Montego Hills Drive, Kingsholme

Issue Date	22/12/2017
Meridian	SP264750
Level Datum	AHD
Contour Interval	1.0m
Drawn	N. Boyce
Date Drafted	15/12/2017
Checked	T. Geraghty

Real Property Description:
Lot 954 on SP264750

REFERENCE No. **5543-14**
PLAN No. **5543 S DC LOT 116**

LEGEND

- ... STORMWATER MANHOLE
- ... STORMWATER GULLY PIT
- ... FIELD INLET
- ... GULLY TRAP
- ... HEADWALL
- ... WATER METER
- ... FIRE HYDRANT
- ... STOP VALVE
- ... WATER PIPE
- ... STORMWATER
- ... UNDERGROUND ELECTRICITY
- ... ELECTRICITY PILLAR
- ... COMMS PIT
- ... LIGHT POLE
- ... EXISTING SURFACE CONTOURS
- ... 41 DESIGN CONTOURS
- ... DESIGN FILL
- ... BUILDING ENVELOPE
- ... EASEMENT

- Notes:**
- Final areas are subject to design changes, Council approval and field survey and may differ from those shown on this Disclosure Plan.
 - Final presentation of areas will comply with requirements of the Registrar of Titles and may vary from the format on this Disclosure Plan
 - The Seller, under the Contract Terms, is entitled to make Variations to the lot, including its location, area, size, dimensions, and elevation. Without limitation, if the area of the Lot on the Plan is not more than 5% different to the total area of the Lot as shown on this Disclosure Plan, the Variation is deemed to be a Permitted Variation and the Buyer cannot object.
 - Design contours are approximate only and may change during construction
 - Services have been plotted from design information only and may change during construction
 - All earthworks fill to lots will be placed and compacted on Level 1 basis in accordance with Australian Standard AS3798-2007 "Guidelines on earthworks for commercial and residential developments".

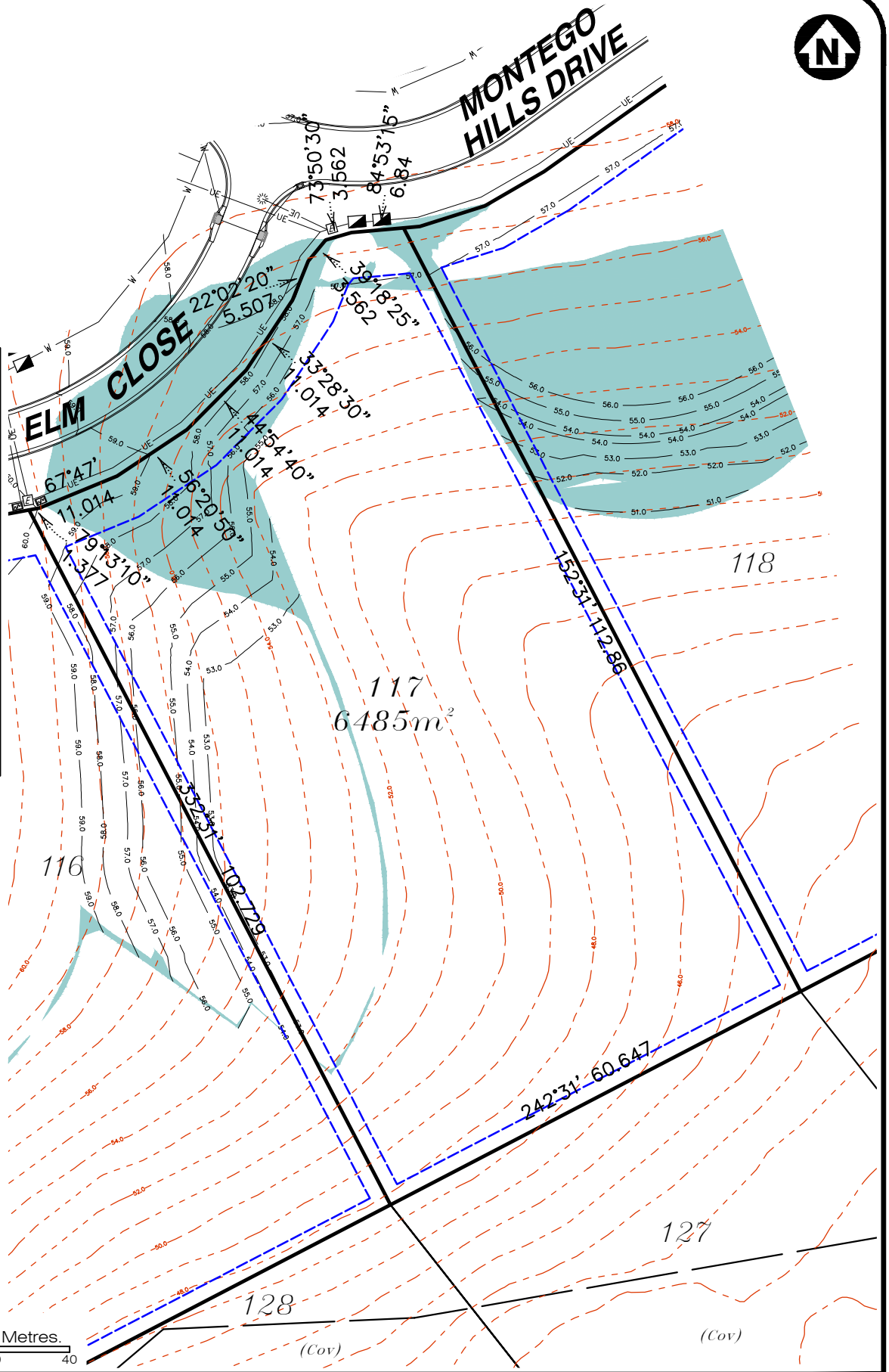

LEGEND (CONTINUED)

- Building Envelopes

Typical Building Envelope

Scale 1:750 - Lengths are in Metres.

gassman development perspectives
est 1985

planning | environment | landscape | engineering | survey

T: 3807 3333 | F: 3287 5461 | www.gassman.com.au

Gold Coast & Logan | 176 Business Street, Yatala QLD | PO Box 392, Beenleigh 4207

Client	Kingsholme Developments Pty. Ltd.
Project	DISCLOSURE PLAN LOT 117 (Survey plan: SP280831) MONTEGO HILLS Montego Hills Drive, Kingsholme

Issue Date	22/12/2017
Meridian	SP264750
Level Datum	AHD
Contour Interval	1.0m
Drawn	N. Boyce
Date Drafted	15/12/2017
Checked	T. Geraghty

Real Property Description:
Lot 954 on SP264750

REFERENCE No. **5543-14**
PLAN No. **5543 S DC LOT 117**



LEGEND

- ... STORMWATER MANHOLE
- ... STORMWATER GULLY PIT
- ... FIELD INLET
- ... GULLY TRAP
- ... HEADWALL
- ... WATER METER
- ... FIRE HYDRANT
- ... STOP VALVE
- ... WATER PIPE
- ... STORMWATER
- ... UNDERGROUND ELECTRICITY
- ... ELECTRICITY PILLAR
- ... COMMS PIT
- ... LIGHT POLE
- ... 41 EXISTING SURFACE CONTOURS
- ... 41 DESIGN CONTOURS
- ... DESIGN FILL
- ... BUILDING ENVELOPE
- ... EASEMENT

- Notes:**
- Final areas are subject to design changes, Council approval and field survey and may differ from those shown on this Disclosure Plan.
 - Final presentation of areas will comply with requirements of the Registrar of Titles and may vary from the format on this Disclosure Plan
 - The Seller, under the Contract Terms, is entitled to make Variations to the lot, including its location, area, size, dimensions, and elevation. Without limitation, if the area of the Lot on the Plan is not more than 5% different to the total area of the Lot as shown on this Disclosure Plan, the Variation is deemed to be a Permitted Variation and the Buyer cannot object.
 - Design contours are approximate only and may change during construction
 - Services have been plotted from design information only and may change during construction
 - All earthworks fill to lots will be placed and compacted on Level 1 basis in accordance with Australian Standard AS3798-2007 "Guidelines on earthworks for commercial and residential developments".

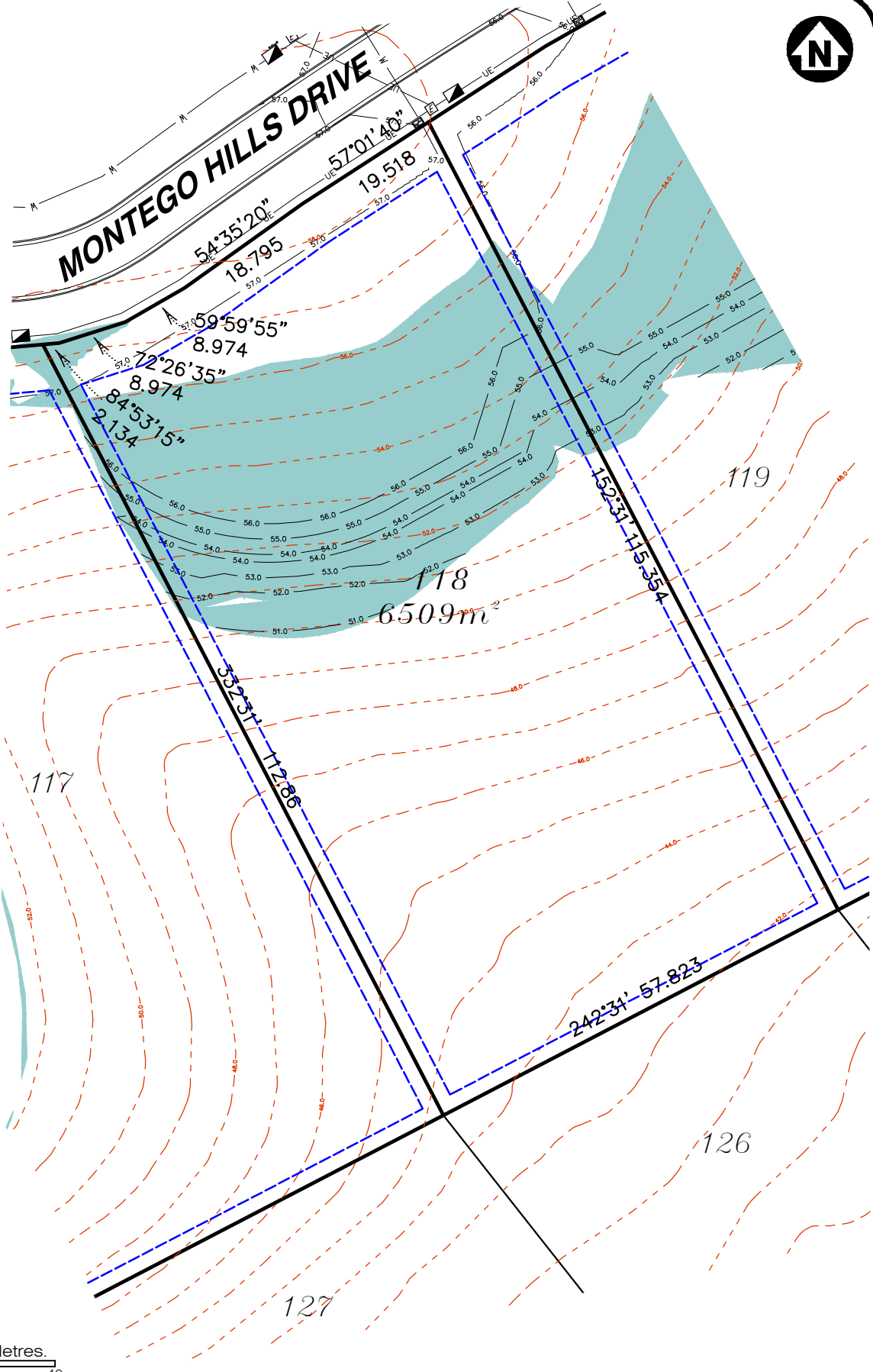

LEGEND (CONTINUED)

- Building Envelopes

Typical Building Envelope

Scale 1:750 - Lengths are in Metres.

gassman development perspectives
est 1985
planning | environment | landscape | engineering | survey
T: 3807 3333 | F: 3287 5461 | www.gassman.com.au
Gold Coast & Logan | 176 Business Street, Yatala QLD | PO Box 392, Beenleigh 4207

Client Kingsholme Developments Pty. Ltd.

Project **DISCLOSURE PLAN**
LOT 118
(Survey plan: SP280831)
MONTEGO HILLS
Montego Hills Drive, Kingsholme

Locality	Kingsholme	Issue Date	22/12/2017
Local Govt	GOLD COAST CITY COUNCIL	Meridian	SP264750
Scale (on A4 original)	1:750	Level Datum	AHD
		Contour Interval	1.0m
		Drawn	N. Boyce
		Date Drafted	15/12/2017
		Checked	T. Geraghty

Real Property Description:
Lot 954 on SP264750

REFERENCE No. 5543-14
PLAN No. 5543 S DC LOT 118

LEGEND

- ⊙ ... STORMWATER MANHOLE
- ⊞ ... STORMWATER GULLY PIT
- ⊞ ... FIELD INLET
- ⊞ ... GULLY TRAP
- ⊞ ... HEADWALL
- ⊞ ... WATER METER
- ⊞ ... FIRE HYDRANT
- ⊞ ... STOP VALVE
- W—W WATER PIPE
- SW—SW STORMWATER
- UE—UE UNDERGROUND ELECTRICITY
- ⊞ ... ELECTRICITY PILLAR
- ⊞ ... COMMS PIT
- ⊞ ... LIGHT POLE
- - -41- - - EXISTING SURFACE CONTOURS
- 41 — DESIGN CONTOURS
- █ DESIGN FILL
- - - BUILDING ENVELOPE
- EASEMENT

- Notes:**
- Final areas are subject to design changes, Council approval and field survey and may differ from those shown on this Disclosure Plan.
 - Final presentation of areas will comply with requirements of the Registrar of Titles and may vary from the format on this Disclosure Plan
 - The Seller, under the Contract Terms, is entitled to make Variations to the lot, including its location, area, size, dimensions, and elevation. Without limitation, if the area of the Lot on the Plan is not more than 5% different to the total area of the Lot as shown on this Disclosure Plan, the Variation is deemed to be a Permitted Variation and the Buyer cannot object.
 - Design contours are approximate only and may change during construction
 - Services have been plotted from design information only and may change during construction
 - All earthworks fill to lots will be placed and compacted on Level 1 basis in accordance with Australian Standard AS3798-2007 "Guidelines on earthworks for commercial and residential developments".

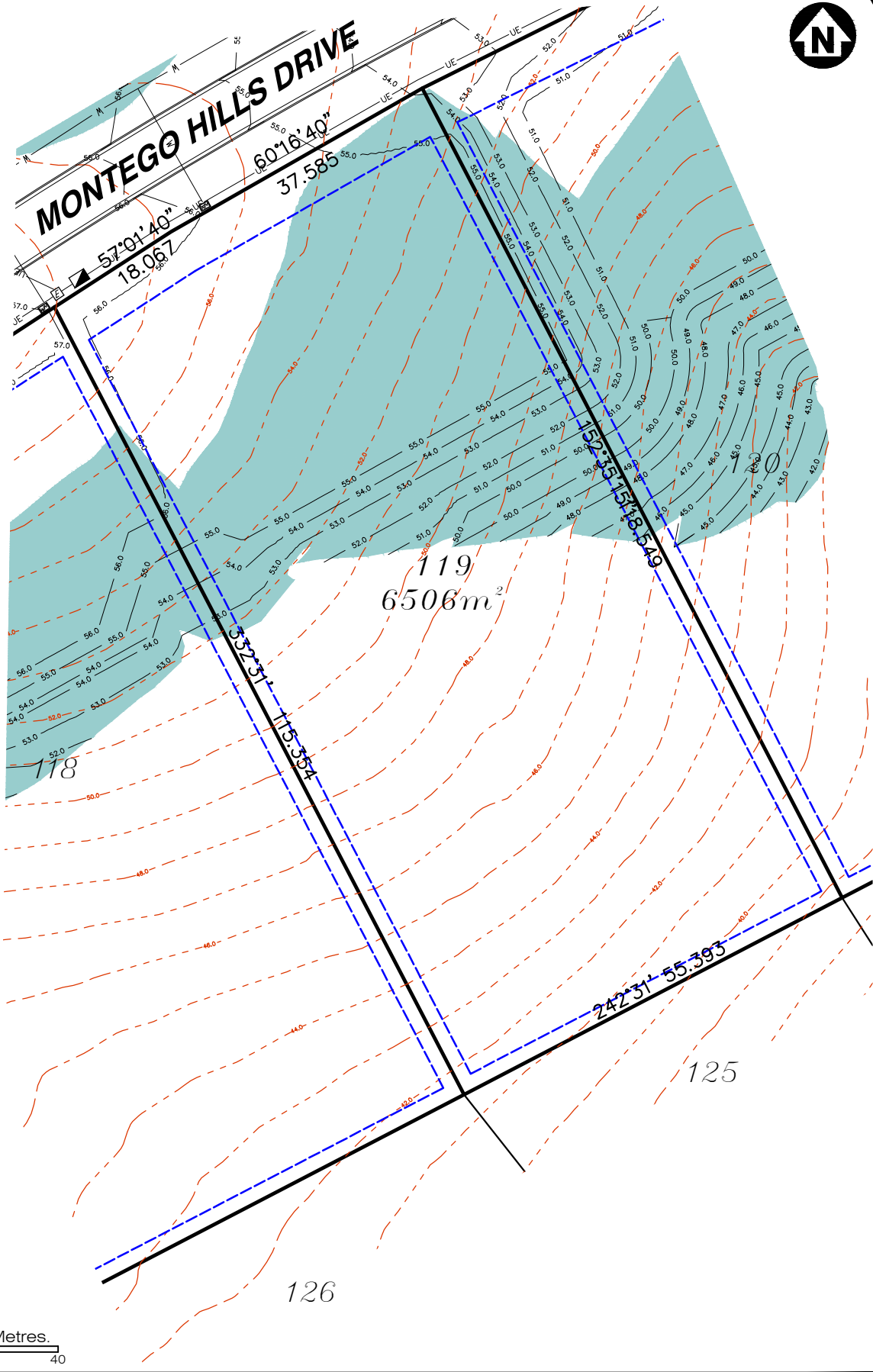

LEGEND (CONTINUED)

- - - Building Envelopes

Typical Building Envelope

Scale 1:750 - Lengths are in Metres.

gassman development perspectives
 est 1985
 planning | environment | landscape | engineering | survey
 T: 3807 3333 | F: 3287 5461 | www.gassman.com.au
 Gold Coast & Logan | 176 Business Street, Yatala QLD | PO Box 392, Beenleigh 4207

Client Kingsholme Developments Pty. Ltd.

Project **DISCLOSURE PLAN**
LOT 119
 (Survey plan: SP280831)
MONTEGO HILLS
Montego Hills Drive, Kingsholme

Locality	Kingsholme	Issue Date	22/12/2017
Local Govt	GOLD COAST CITY COUNCIL	Meridian	SP264750
Scale (on A4 original)	1:750	Level Datum	AHD
		Contour Interval	1.0m
		Drawn	N. Boyce
		Date Drafted	15/12/2017
		Checked	T. Geraghty

Real Property Description:
 Lot 954 on SP264750

REFERENCE No. 5543-14
PLAN No. 5543 S DC LOT 119

LEGEND

- ... STORMWATER MANHOLE
- ... STORMWATER GULLY PIT
- ... FIELD INLET
- ... GULLY TRAP
- ... HEADWALL
- ... WATER METER
- ... FIRE HYDRANT
- ... STOP VALVE
- ... WATER PIPE
- ... STORMWATER
- ... UNDERGROUND ELECTRICITY
- ... ELECTRICITY PILLAR
- ... COMMS PIT
- ... LIGHT POLE
- ... EXISTING SURFACE CONTOURS
- ... DESIGN CONTOURS
- ... DESIGN FILL
- ... BUILDING ENVELOPE
- ... EASEMENT

- Notes:**
- Final areas are subject to design changes, Council approval and field survey and may differ from those shown on this Disclosure Plan.
 - Final presentation of areas will comply with requirements of the Registrar of Titles and may vary from the format on this Disclosure Plan
 - The Seller, under the Contract Terms, is entitled to make Variations to the lot, including its location, area, size, dimensions, and elevation. Without limitation, if the area of the Lot on the Plan is not more than 5% different to the total area of the Lot as shown on this Disclosure Plan, the Variation is deemed to be a Permitted Variation and the Buyer cannot object.
 - Design contours are approximate only and may change during construction
 - Services have been plotted from design information only and may change during construction
 - All earthworks fill to lots will be placed and compacted on Level 1 basis in accordance with Australian Standard AS3798-2007 "Guidelines on earthworks for commercial and residential developments".

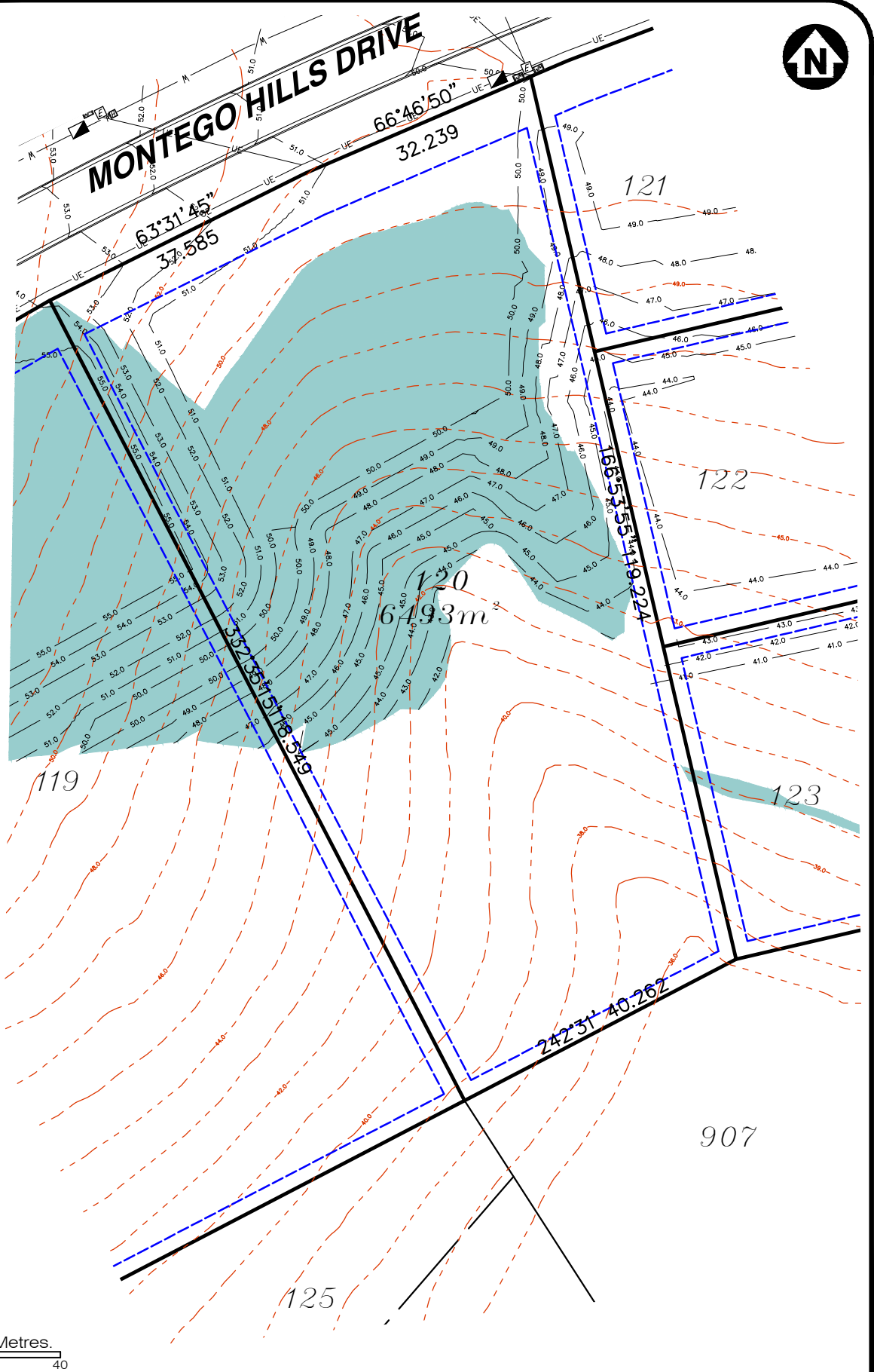

LEGEND (CONTINUED)

- Building Envelopes

Typical Building Envelope

Scale 1:750 - Lengths are in Metres.

gassman development perspectives
est 1985

planning | environment | landscape | engineering | survey

T: 3807 3333 | F: 3287 5461 | www.gassman.com.au

Gold Coast & Logan | 176 Business Street, Yatala QLD | PO Box 392, Beenleigh 4207

Client	Kingsholme Developments Pty. Ltd.
Project	DISCLOSURE PLAN LOT 120 (Survey plan: SP280831) MONTEGO HILLS Montego Hills Drive, Kingsholme

Issue Date	22/12/2017
Meridian	SP264750
Level Datum	AHD
Contour Interval	1.0m
Drawn	N. Boyce
Date Drafted	15/12/2017
Checked	T. Geraghty

Real Property Description:
Lot 954 on SP264750

REFERENCE No. **5543-14**
PLAN No. **5543 S DC LOT 120**

LEGEND

- ⊙ ... STORMWATER MANHOLE
- ⊞ ... STORMWATER GULLY PIT
- ⊞ ... FIELD INLET
- ⊞ ... GULLY TRAP
- ⊞ ... HEADWALL
- ⊞ ... WATER METER
- ⊞ ... FIRE HYDRANT
- ⊞ ... STOP VALVE
- W-W- WATER PIPE
- SW-SW- STORMWATER
- UE-UE- UNDERGROUND ELECTRICITY
- ⊞ ... ELECTRICITY PILLAR
- ⊞ ... COMMS PIT
- ⊞ ... LIGHT POLE
- - - 41 EXISTING SURFACE CONTOURS
- 41 DESIGN CONTOURS
- DESIGN FILL
- BUILDING ENVELOPE
- EASEMENT

Notes:

- Final areas are subject to design changes, Council approval and field survey and may differ from those shown on this Disclosure Plan.
- Final presentation of areas will comply with requirements of the Registrar of Titles and may vary from the format on this Disclosure Plan
- The Seller, under the Contract Terms, is entitled to make Variations to the lot, including its location, area, size, dimensions, and elevation. Without limitation, if the area of the Lot on the Plan is not more than 5% different to the total area of the Lot as shown on this Disclosure Plan, the Variation is deemed to be a Permitted Variation and the Buyer cannot object.
- Design contours are approximate only and may change during construction
- Services have been plotted from design information only and may change during construction
- All earthworks fill to lots will be placed and compacted on Level 1 basis in accordance with Australian Standard AS3798-2007 "Guidelines on earthworks for commercial and residential developments".

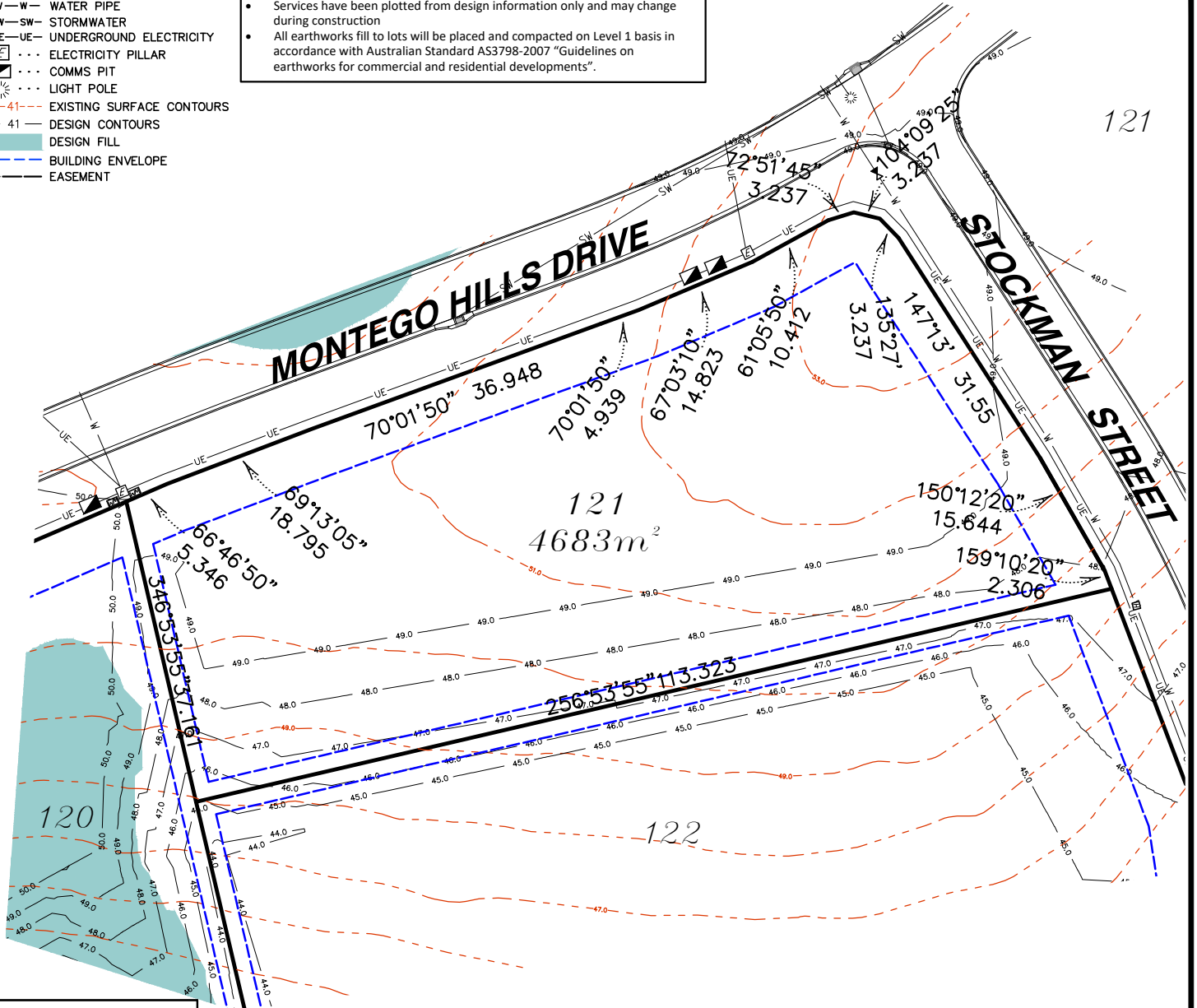

LEGEND (CONTINUED)

--- Building Envelopes

Typical Building Envelope

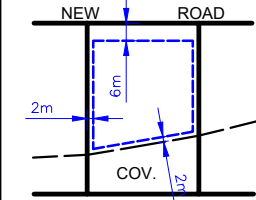

Scale 1:750 - Lengths are in Metres.

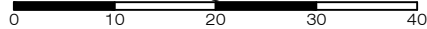

**gassman
development
perspectives**
est 1985

planning | environment | landscape | engineering | survey

T: 3807 3333 | F: 3287 5461 | www.gassman.com.au

Gold Coast & Logan | 176 Business Street, Yatala QLD | PO Box 392, Beenleigh 4207

Client Kingsholme Developments Pty. Ltd.

Project **DISCLOSURE PLAN**
LOT 121
(Survey plan: SP280831)
MONTEGO HILLS
Montego Hills Drive, Kingsholme

Locality	Kingsholme	Issue Date	22/12/2017
Local Govt	GOLD COAST CITY COUNCIL	Meridian	SP264750
Scale (on A4 original)	1:750	Level Datum	AHD
		Contour Interval	1.0m
		Drawn	N. Boyce
		Date Drafted	15/12/2017
		Checked	T. Geraghty

Real Property Description:
Lot 954 on SP264750

REFERENCE No. 5543-14
PLAN No. 5543 S DC LOT 121

LEGEND

- ⊙ ... STORMWATER MANHOLE
- ⊞ ... STORMWATER GULLY PIT
- ⊞ ... FIELD INLET
- ⊞ ... GULLY TRAP
- ⊞ ... HEADWALL
- ⊞ ... WATER METER
- ⊞ ... FIRE HYDRANT
- ⊞ ... STOP VALVE
- W-W- WATER PIPE
- SW-SW- STORMWATER
- UE-UE- UNDERGROUND ELECTRICITY
- ⊞ ... ELECTRICITY PILLAR
- ⊞ ... COMMS PIT
- ⊞ ... LIGHT POLE
- - -41- EXISTING SURFACE CONTOURS
- 41- DESIGN CONTOURS
- DESIGN FILL
- - - BUILDING ENVELOPE
- - - EASEMENT

Notes:

- Final areas are subject to design changes, Council approval and field survey and may differ from those shown on this Disclosure Plan.
- Final presentation of areas will comply with requirements of the Registrar of Titles and may vary from the format on this Disclosure Plan
- The Seller, under the Contract Terms, is entitled to make Variations to the lot, including its location, area, size, dimensions, and elevation. Without limitation, if the area of the Lot on the Plan is not more than 5% different to the total area of the Lot as shown on this Disclosure Plan, the Variation is deemed to be a Permitted Variation and the Buyer cannot object.
- Design contours are approximate only and may change during construction
- Services have been plotted from design information only and may change during construction
- All earthworks fill to lots will be placed and compacted on Level 1 basis in accordance with Australian Standard AS3798-2007 "Guidelines on earthworks for commercial and residential developments".



917

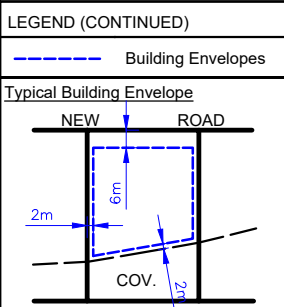
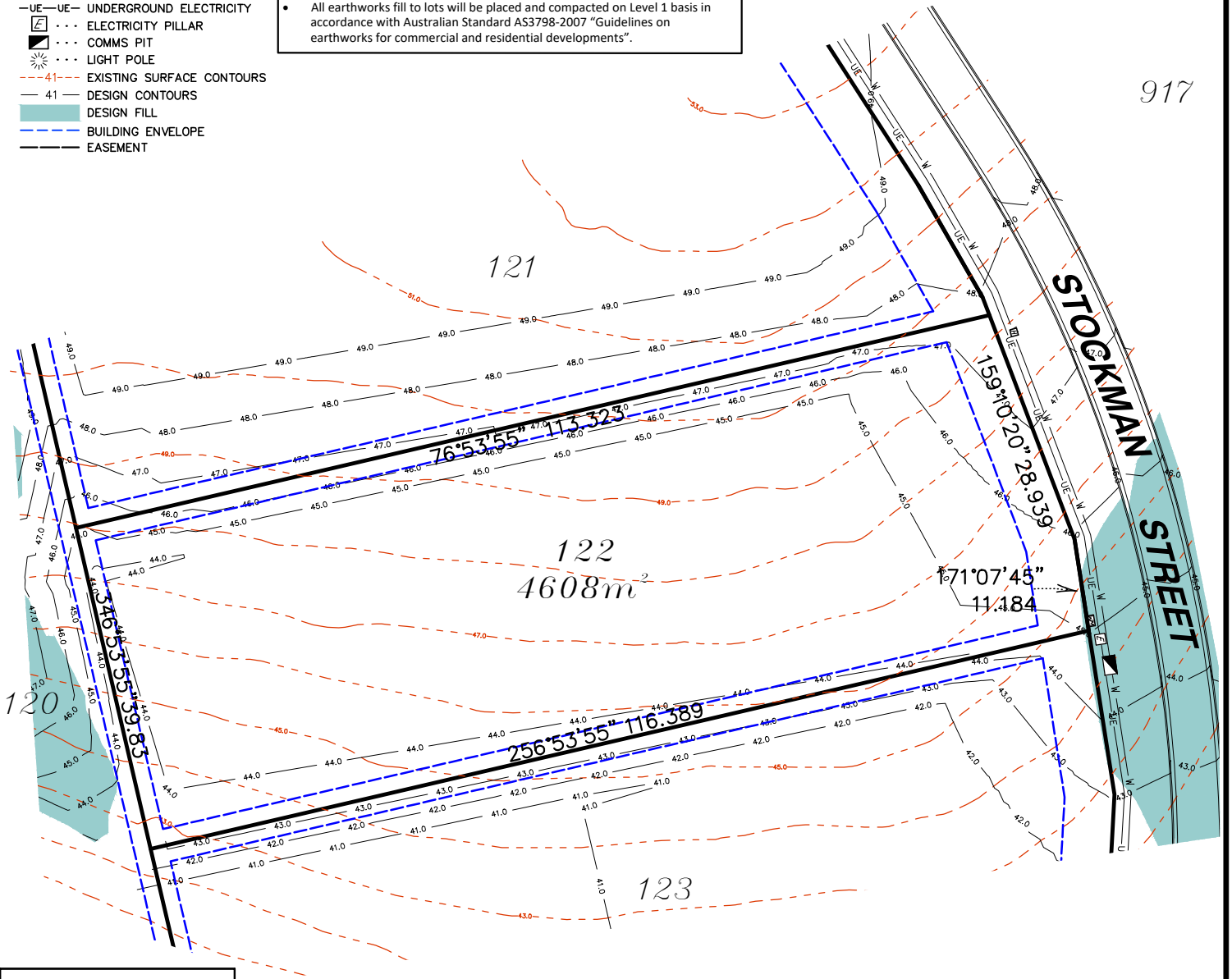

Scale 1:750 - Lengths are in Metres.

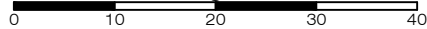

gassman development perspectives

est 1985

planning | environment | landscape | engineering | survey

T: 3807 3333 | F: 3287 5461 | www.gassman.com.au

Gold Coast & Logan | 176 Business Street, Yatala QLD | PO Box 392, Beenleigh 4207

Client	Kingsholme Developments Pty. Ltd.
Project	DISCLOSURE PLAN LOT 122 (Survey plan: SP280831) MONTEGO HILLS Montego Hills Drive, Kingsholme

Locality	Kingsholme	Issue Date	22/12/2017
Local Govt	GOLD COAST CITY COUNCIL	Meridian	SP264750
Scale (on A4 original)	1:750	Level Datum	AHD
		Contour Interval	1.0m
		Drawn	N. Boyce
		Date Drafted	15/12/2017
		Checked	T. Geraghty

Real Property Description:
Lot 954 on SP264750

REFERENCE No. **5543-14**
PLAN No. **5543 S DC LOT 122**

LEGEND

- ... STORMWATER MANHOLE
- ... STORMWATER GULLY PIT
- ... FIELD INLET
- ... GULLY TRAP
- ... HEADWALL
- ... WATER METER
- ... FIRE HYDRANT
- ... STOP VALVE
- ... WATER PIPE
- ... STORMWATER
- ... UNDERGROUND ELECTRICITY
- ... ELECTRICITY PILLAR
- ... COMMS PIT
- ... LIGHT POLE
- ... EXISTING SURFACE CONTOURS
- ... DESIGN CONTOURS
- ... DESIGN FILL
- ... BUILDING ENVELOPE
- ... EASEMENT

Notes:

- Final areas are subject to design changes, Council approval and field survey and may differ from those shown on this Disclosure Plan.
- Final presentation of areas will comply with requirements of the Registrar of Titles and may vary from the format on this Disclosure Plan
- The Seller, under the Contract Terms, is entitled to make Variations to the lot, including its location, area, size, dimensions, and elevation. Without limitation, if the area of the Lot on the Plan is not more than 5% different to the total area of the Lot as shown on this Disclosure Plan, the Variation is deemed to be a Permitted Variation and the Buyer cannot object.
- Design contours are approximate only and may change during construction
- Services have been plotted from design information only and may change during construction
- All earthworks fill to lots will be placed and compacted on Level 1 basis in accordance with Australian Standard AS3798-2007 "Guidelines on earthworks for commercial and residential developments".

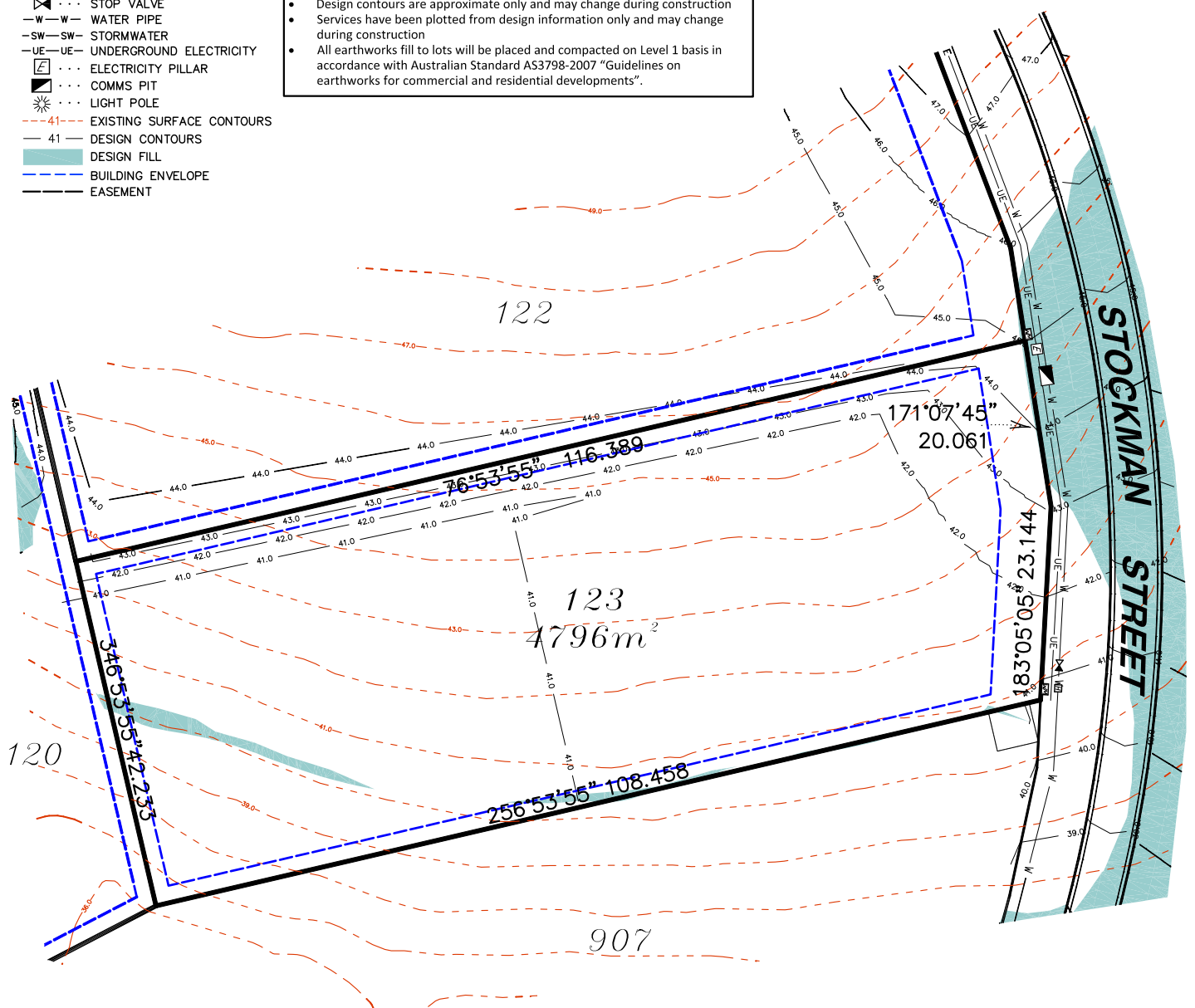

LEGEND (CONTINUED)

- Building Envelopes

Typical Building Envelope

Scale 1:750 - Lengths are in Metres.

T: 3807 3333 | F: 3287 5461 | www.gassman.com.au
 Gold Coast & Logan | 76 Business Street, Yatala QLD | PO Box 392, Beenleigh 4207

Client Kingsholme Developments Pty. Ltd.

Project **DISCLOSURE PLAN**
LOT 123
 (Survey plan: SP280831)
MONTEGO HILLS
 Montego Hills Drive, Kingsholme

Real Property Description:
 Lot 954 on SP264750

Locality	Kingsholme	Issue Date	21/12/2017
Local Govt	GOLD COAST CITY COUNCIL	Meridian	SP264750
Scale (on A4 original)	1:750	Level Datum	AHD
REFERENCE No.	5543-14	Contour Interval	1.0m
PLAN No.	5543 S DC LOT 123	Drawn	N. Boyce
		Date Drafted	15/12/2017
		Checked	T. Geraghty