

LOCALITY PLAN  
NTS  
MELWAYS: 135 C5

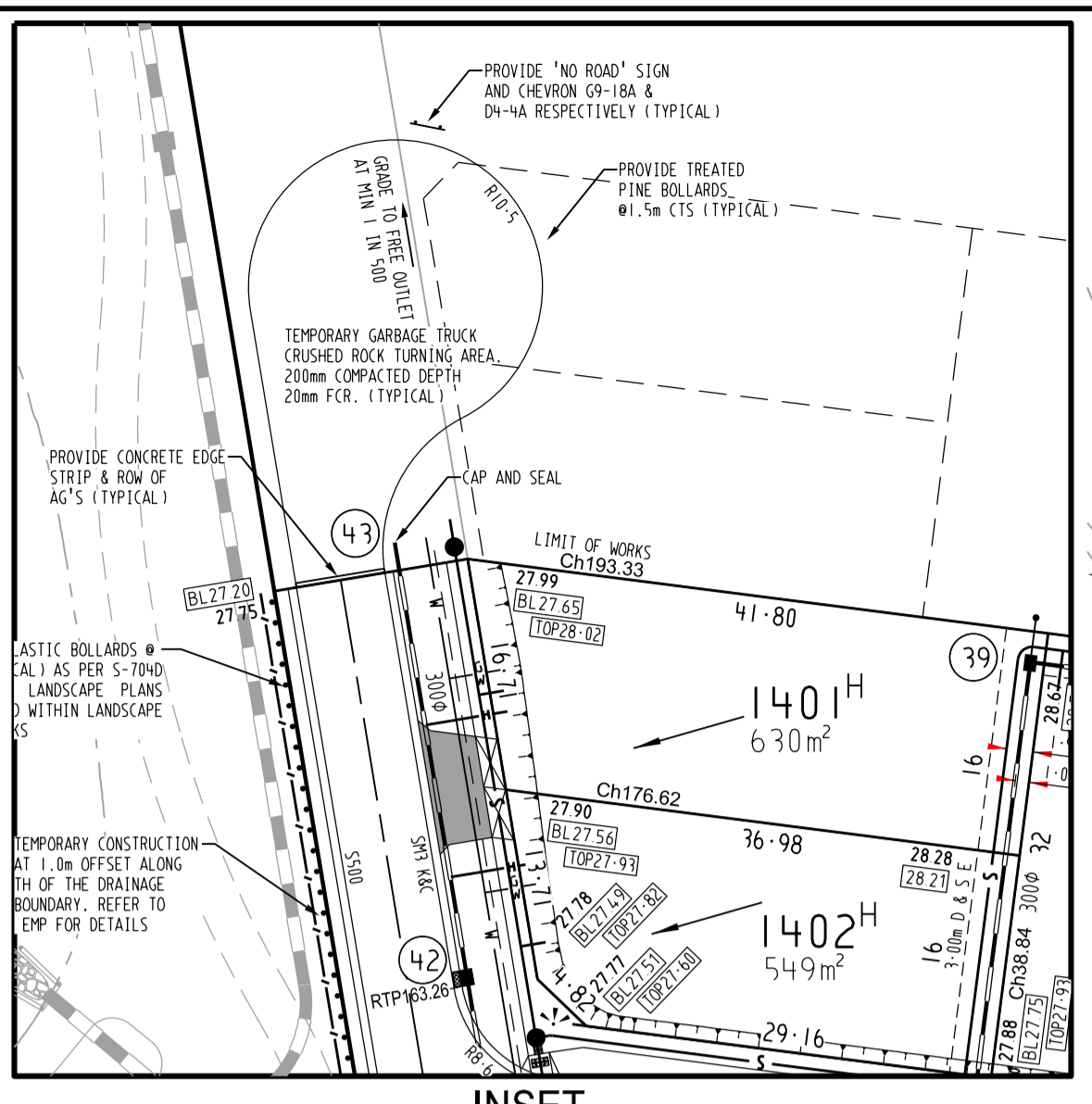

INSET

**SHEET INDEX**

SHT No.	VBR	DESCRIPTION	SHT No.	VBR	DESCRIPTION
1	G	DETAIL PLAN, SERVICES SCHEDULE & SHEET INDEX	11	B	SAVAGE WAY - LONGITUDINAL & CROSS SECTIONS
2	C	NOTES, PAVEMENT DETAILS & TYPICAL SECTIONS	12	B	BRIGGS STREET - LONGITUDINAL & CROSS SECTIONS
3	E	INTERSECTION DETAILS - SHEET 1	13	C	DRAINAGE LONGITUDINAL SECTIONS
4	C	INTERSECTION DETAILS - SHEET 2	14	B	DRAINAGE LONGITUDINAL SECTIONS
5	C	HEATHER GROVE - LONGITUDINAL SECTION	15	C	DRAINAGE LONGITUDINAL SECTIONS
6	C	HEATHER GROVE - CROSS SECTIONS	16	C	DRAINAGE PIT SCHEDULE
7	B	HEATHER GROVE - CROSS SECTIONS	17	C	WETLAND RETARDING BASIN
8	A	DOMINGO AVENUE - LONGITUDINAL SECTION	18	B	WETLAND RETARDING BASIN
9	B	DOMINGO AVENUE - CROSS SECTIONS	19	B	SIGNAGE & LINEMARKING PLAN
10	B	KEIGHERY DRIVE - LONGITUDINAL & CROSS SECTIONS			

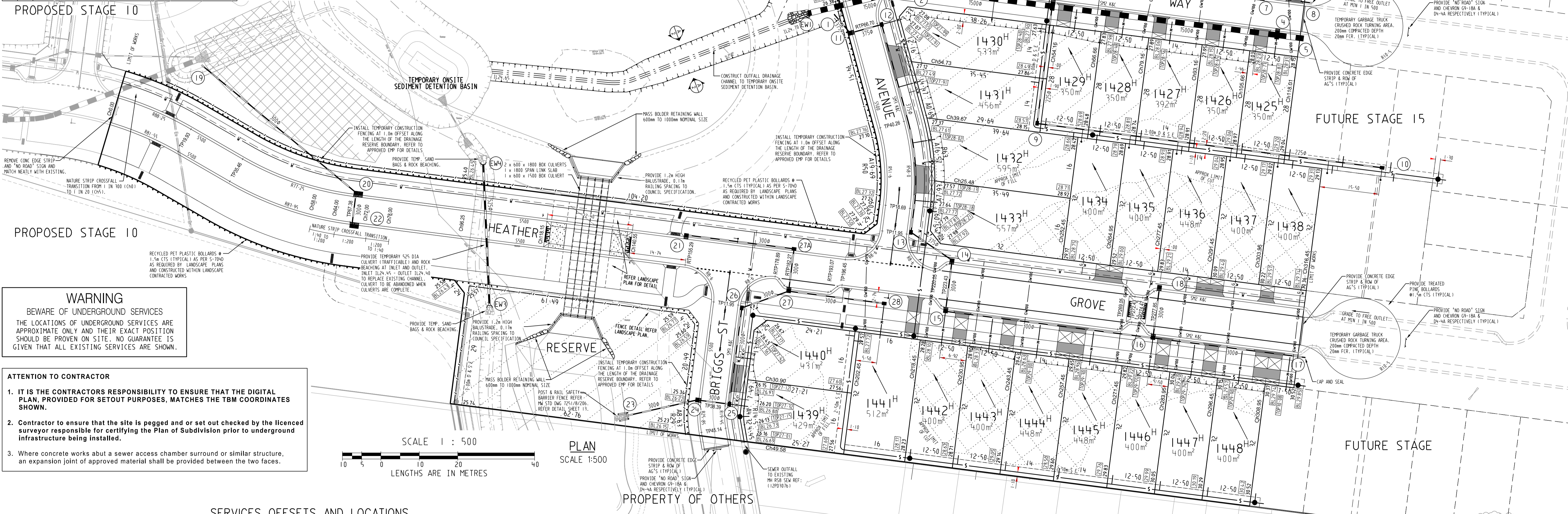

**WARNING**  
BEWARE OF UNDERGROUND SERVICES  
THE LOCATIONS OF UNDERGROUND SERVICES ARE APPROXIMATE ONLY AND THEIR EXACT POSITION SHOULD BE PROVEN ON SITE. NO GUARANTEE IS GIVEN THAT ALL EXISTING SERVICES ARE SHOWN.

**ATTENTION TO CONTRACTOR**

- IT IS THE CONTRACTORS RESPONSIBILITY TO ENSURE THAT THE DIGITAL PLAN, PROVIDED FOR SETOUT PURPOSES, MATCHES THE TBM COORDINATES SHOWN.
- Contractor to ensure that the site is pegged and/or set out checked by the licenced surveyor responsible for certifying the Plan of Subdivision prior to underground infrastructure being installed.
- Where concrete works about a sewer access chamber surround or similar structure, an expansion joint of approved material shall be provided between the two faces.

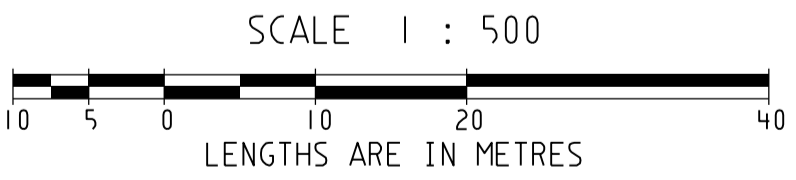

PLAN SCALE 1:500

**SERVICES OFFSETS AND LOCATIONS**

STREET NAME	Rd. RESERVE		WATER		GAS		ELECTRICITY		FIBRE TO THE HOME		Bk. of KERB	JOINT TRENCHING	STREET CLASSIFICATION
	DW	NDW	DW	NDW	DW	NDW	POLES	CABLES	P/TH CABLES	P/TH PITS			
HEATHER GROVE (LOT 1440 - LOT 1448)	25-50	3-20 N	2-70 N	2-25 N	3-10 S	1-00 BOK	1-95 S	1-78 N/S	4-35 N/6-65 N	8-65 S/10-95 S	G & W, FTTH & E	CONNECTOR ROAD	
HEATHER GROVE (WEST OF CULVERT)	25-50	3-20 N	2-70 N	2-25 N	4-10 S	1-00 BOK	3-50 S	1-78 N/S	6-65 N	0-95 S	G & W, FTTH & E	CONNECTOR ROAD	
KEIGHERY DRIVE (LOT 1416)	16-00	3-20 S	2-70 S	2-25 S	2-40 N	1-00 BOK	1-00 S	1-00 S	4-05 N	4-35 S	G & W, FTTH & E	STREET - LEVEL I	
KEIGHERY DRIVE (LOT 1403 - LOT 1409)	16-00	3-20 S	2-70 S	2-25 S	2-45 N	1-00 BOK	1-85 N	1-78 N/S	4-05 N	4-35 S	G & W, FTTH & E	STREET - LEVEL I	
SAVAGE WAY	20-00	3-20 S	2-70 S	2-25 N	2-55 S	1-00 BOK	1-95 S	1-78 N/S	6-05 N	6-05 S	G & W, FTTH & E	STREET - LEVEL I	
BRIGGS STREET	14-50	3-10 E	2-60 E	2-10 E	1-00 W	1-00 BOK	0-30 W	1-20 #	4-35 E	2-55 W	G & W, FTTH & E	STREET - LEVEL I	
DOMINGO AVENUE	14-00	2-75 E	2-25 E	1-80 E	3-90 E	1-00 BOK	3-20 E	1-20 #	5-40 E	1-00 W	G & W, FTTH & E	STREET - LEVEL I	

# DENOTES PIT IS LOCATED IN FOOTPATH

**SYMBOL LEGEND**

Prop	Exist
Drains	Sewer <300
Sewer >300	Water
Water	House Drain
Property Inlet	Street Sign
PSM	Retaining Wall
Conduits 50mm	Conduits 100mm
Ex Gas/Elect/Tel	

**AMENDMENTS**

VER	DATE	REMARKS
G	28/11/17	CONDUIT ADDED ADJACENT TO LOT 1410
F	25/10/17	BALUSTRADE ADDED & SPEED HUMP LINE MARKING ADDED ADJACENT TO CULVERT
E	27/09/17	SPEED HUMP AMENDED, G&W CONDUITS LOCATION AMENDED
D	25/08/17	SPEED HUMP MOVED ON TOP OF CULVERT
C	17/07/17	SHEET INDEX AMENDED
B	14/07/17	CROSSOVER ADJACENT TO LOT 1410 DELETED & ALL GAS & WATER CONDUITS LOCATION AMENDED
A	04/07/17	ISSUED FOR CONSTRUCTION

**breese pitt dixon pty. ltd.**  
land surveyors civil engineers

1/19 cato street hawthorn east, 3123 telephone 8823 2300 fax no. 8823 2310

MELWAY REF. 135-C-5

**DELARAY ESTATE**  
STAGE 14  
DETAIL PLAN

MUNICIPALITY CASEY

REFERENCE 8974 E/14

VER DATE REMARKS CHECKED SCALE AS SHOWN DATUM AHD DATE MAR'17 SHEET 1 OF 19