

BUILDING ENVELOPES

LEGEND

Refer "Diagrams and Plans" in this document for further definitions



Single Storey Building Envelope (Height not exceeding 3.6m)

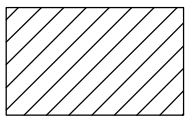

Overlooking Zone - Habitable room windows / raised open spaces are a source of overlooking

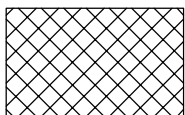

Non Overlooking Zone Habitable room windows / raised open spaces are not a source of overlooking

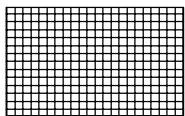

Building to Boundary Zone

The registered proprietor or proprietors of the lot are required to build in accordance with building envelopes shown hereon and in the "Profile Diagrams" in this document

MASIMO ROAD

BARNEY GROVE

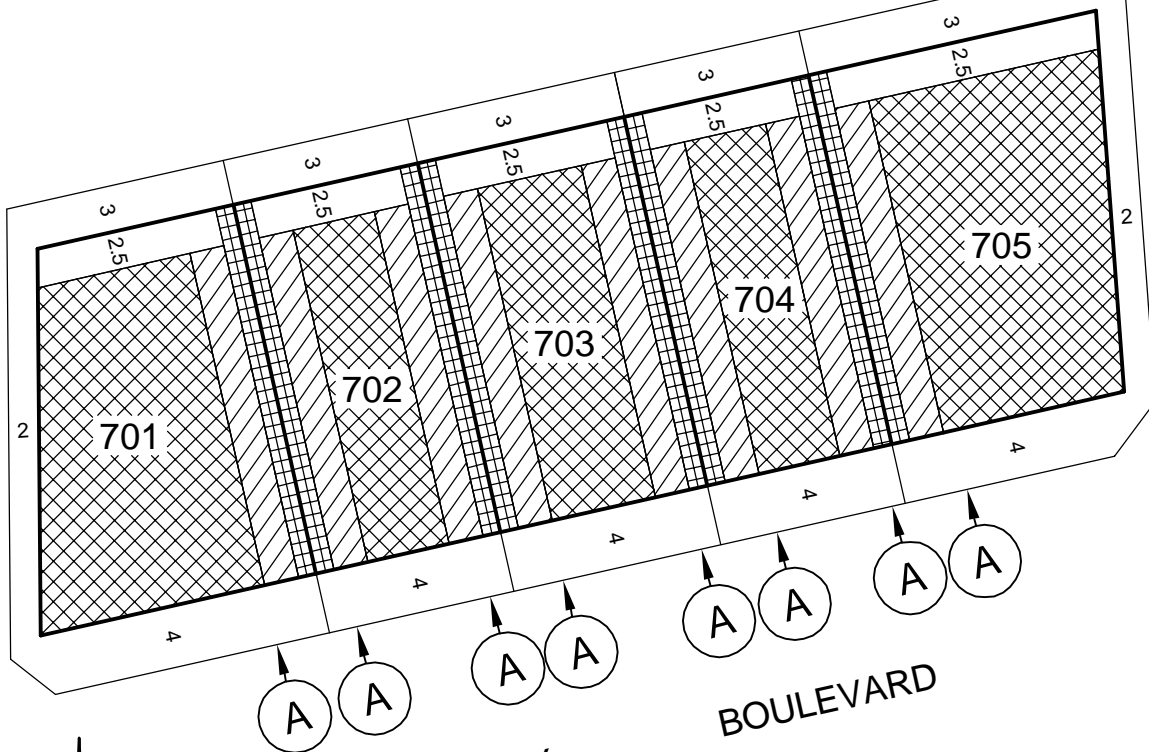

ESTUARY

BOULEVARD

TREEFERN STREET

707

SEE SHEET 3

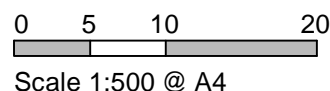
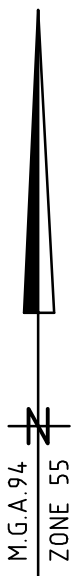

Notations:

- 1 - The Building Envelopes on this plan are shown enclosed by continuous thick lines
- 2 - This diagram is to be read in conjunction with "Profile Diagrams" in this document
- 3 - Profile types (A) & (B) are contained in "Profile Diagrams" in this document
- 4a- The western boundary of Lot 758 is deemed to be the front street boundary of the said lot
- 4b- The southern boundary of Lot 758 is deemed to be the side boundary of the said lot

Ref: 3440248sEST07
Date: 23 February 2012
Version: H

SEE SHEET 2

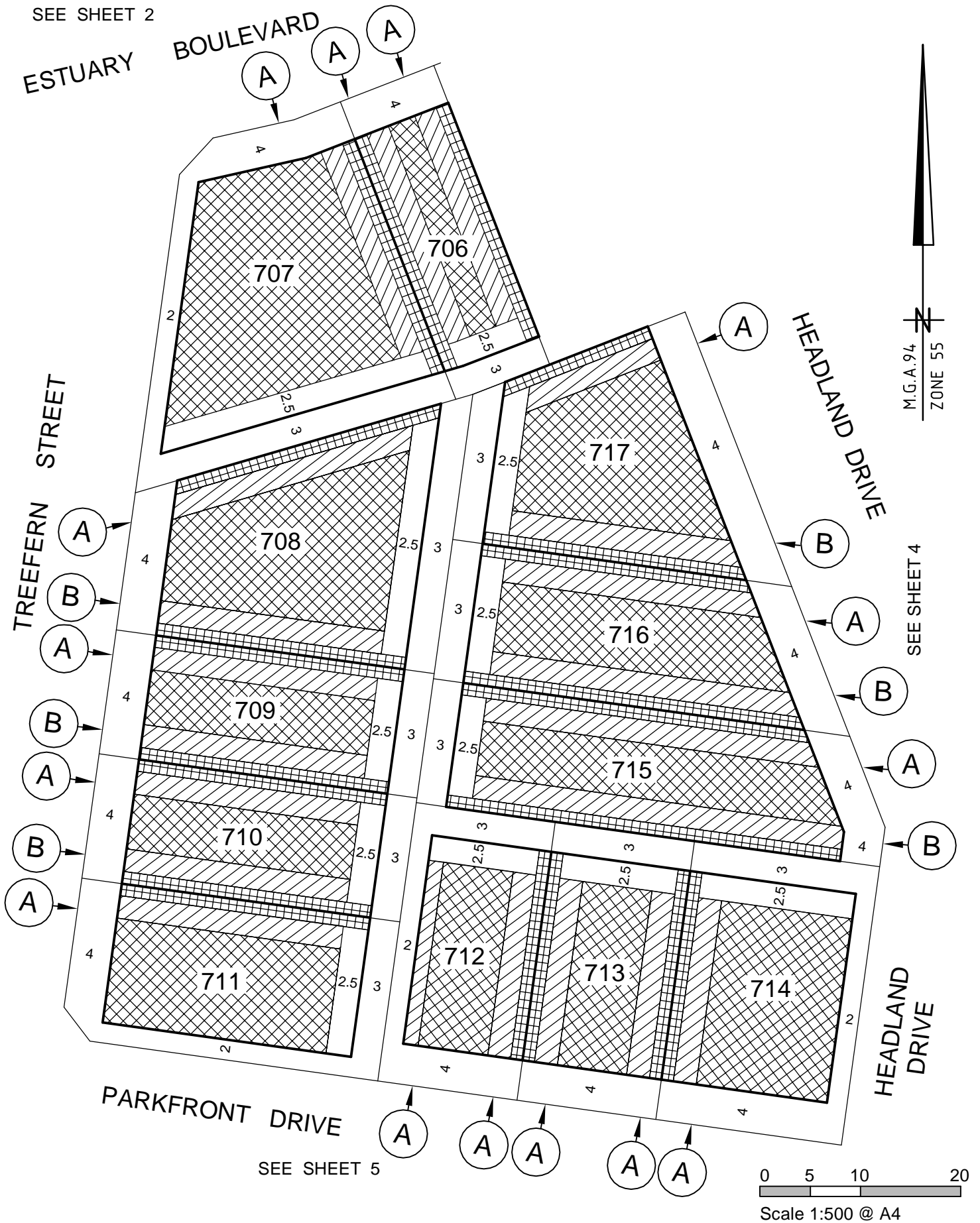

Notations:

- 1 - The Building Envelopes on this plan are shown enclosed by continuous thick lines
- 2 - This diagram is to be read in conjunction with "Profile Diagrams" in this document
- 3 - Profile types (A) & (B) are contained in "Profile Diagrams" in this document

- 4a- The western boundary of Lot 758 is deemed to be the front street boundary of the said lot
- 4b- The southern boundary of Lot 758 is deemed to be the side boundary of the said lot

Ref: 3440248sEST07
Date: 23 February 2012
Version: H



Geelong Tel +61 3 5228 3100

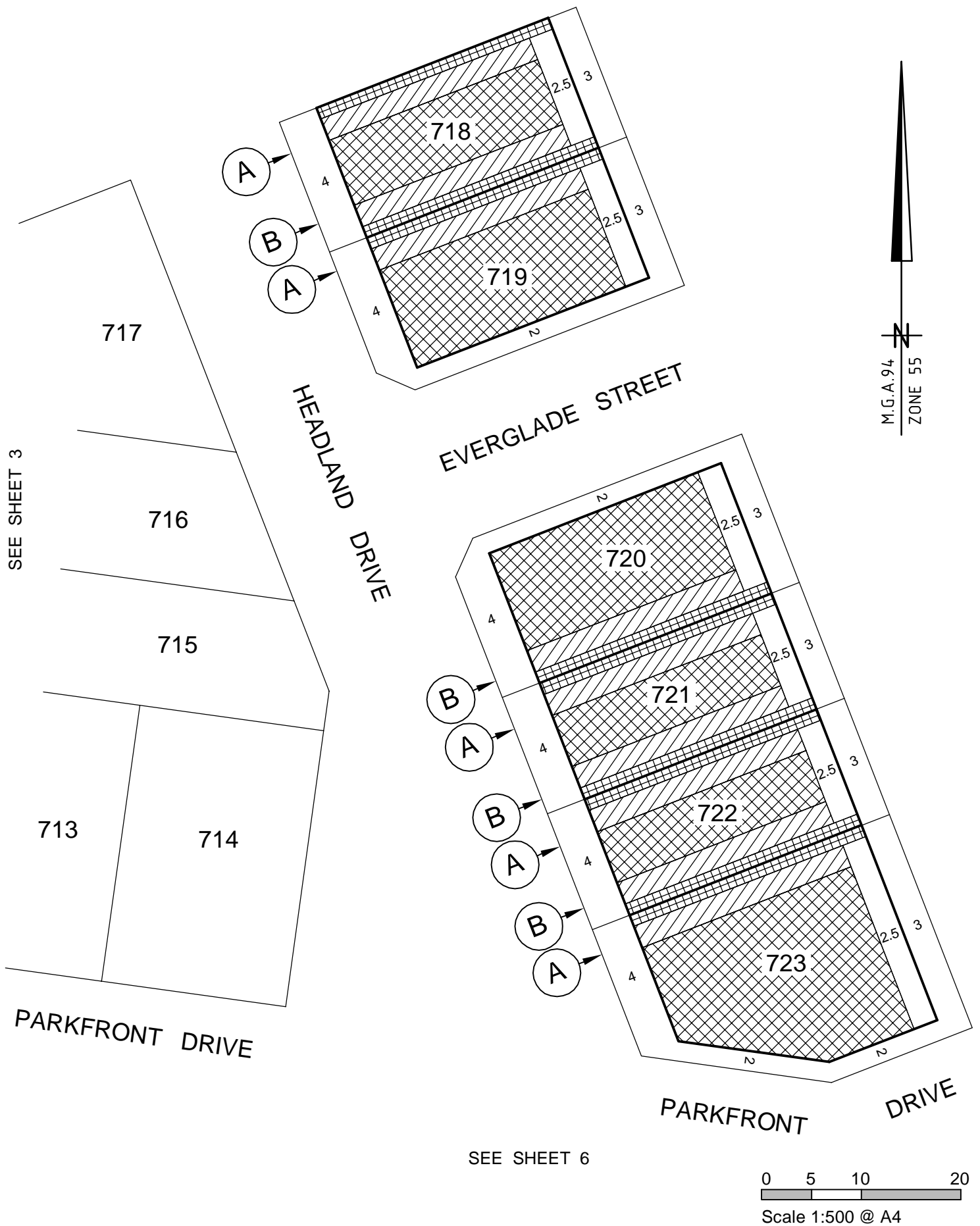

Notations:

- 1 - The Building Envelopes on this plan are shown enclosed by continuous thick lines
- 2 - This diagram is to be read in conjunction with "Profile Diagrams" in this document
- 3 - Profile types (A) & (B) are contained in "Profile Diagrams" in this document

- 4a- The western boundary of Lot 758 is deemed to be the front street boundary of the said lot
- 4b- The southern boundary of Lot 758 is deemed to be the side boundary of the said lot

Ref: 3440248sEST07
Date: 23 February 2012
Version: H

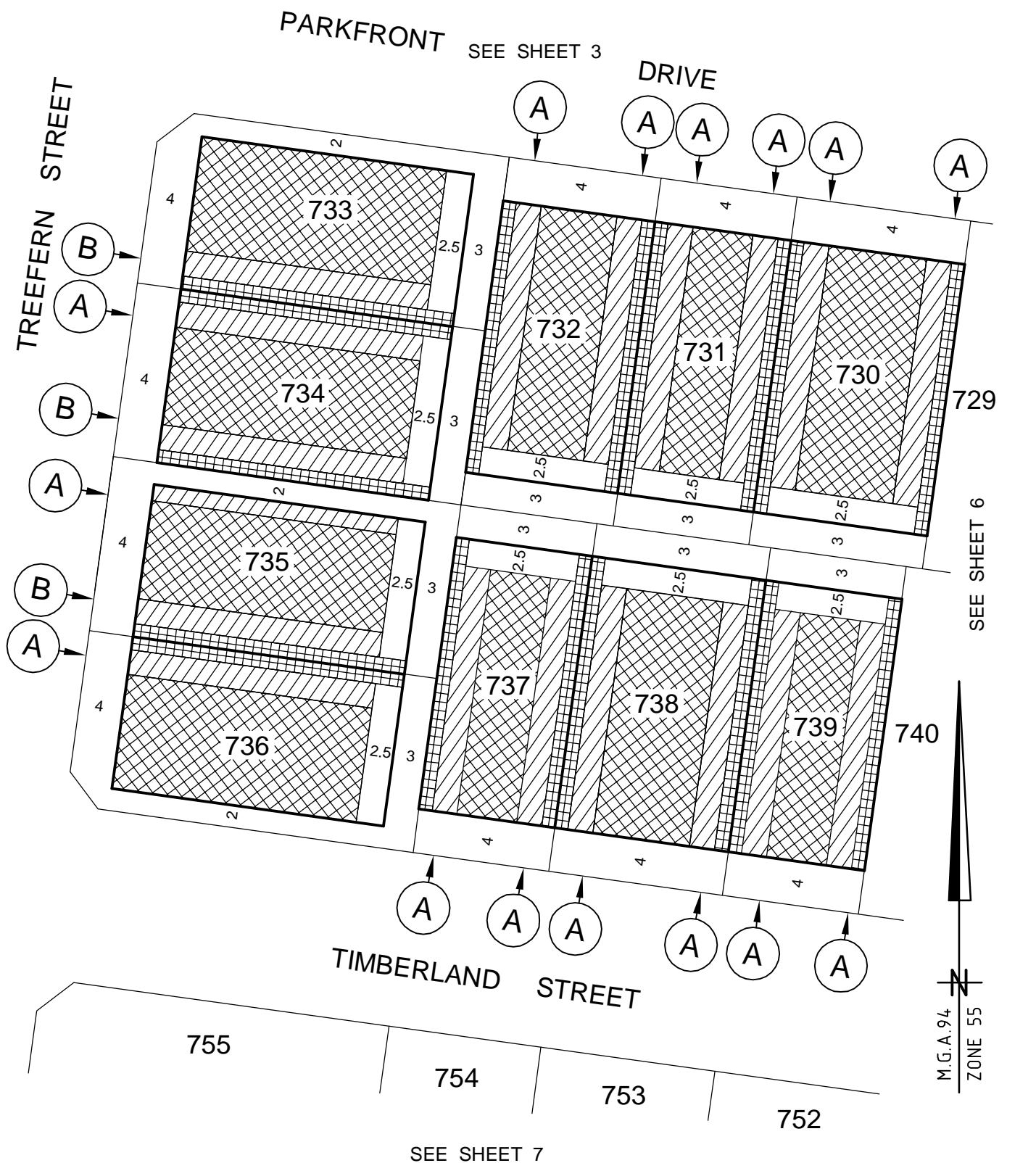

Notations:

- 1 - The Building Envelopes on this plan are shown enclosed by continuous thick lines
- 2 - This diagram is to be read in conjunction with "Profile Diagrams" in this document
- 3 - Profile types A & B are contained in "Profile Diagrams" in this document

- 4a- The western boundary of Lot 758 is deemed to be the front street boundary of the said lot
- 4b- The southern boundary of Lot 758 is deemed to be the side boundary of the said lot

Ref: 3440248sEST07
 Date: 23 February 2012
 Version: H



Geelong Tel +61 3 5228 3100

SEE SHEET 4

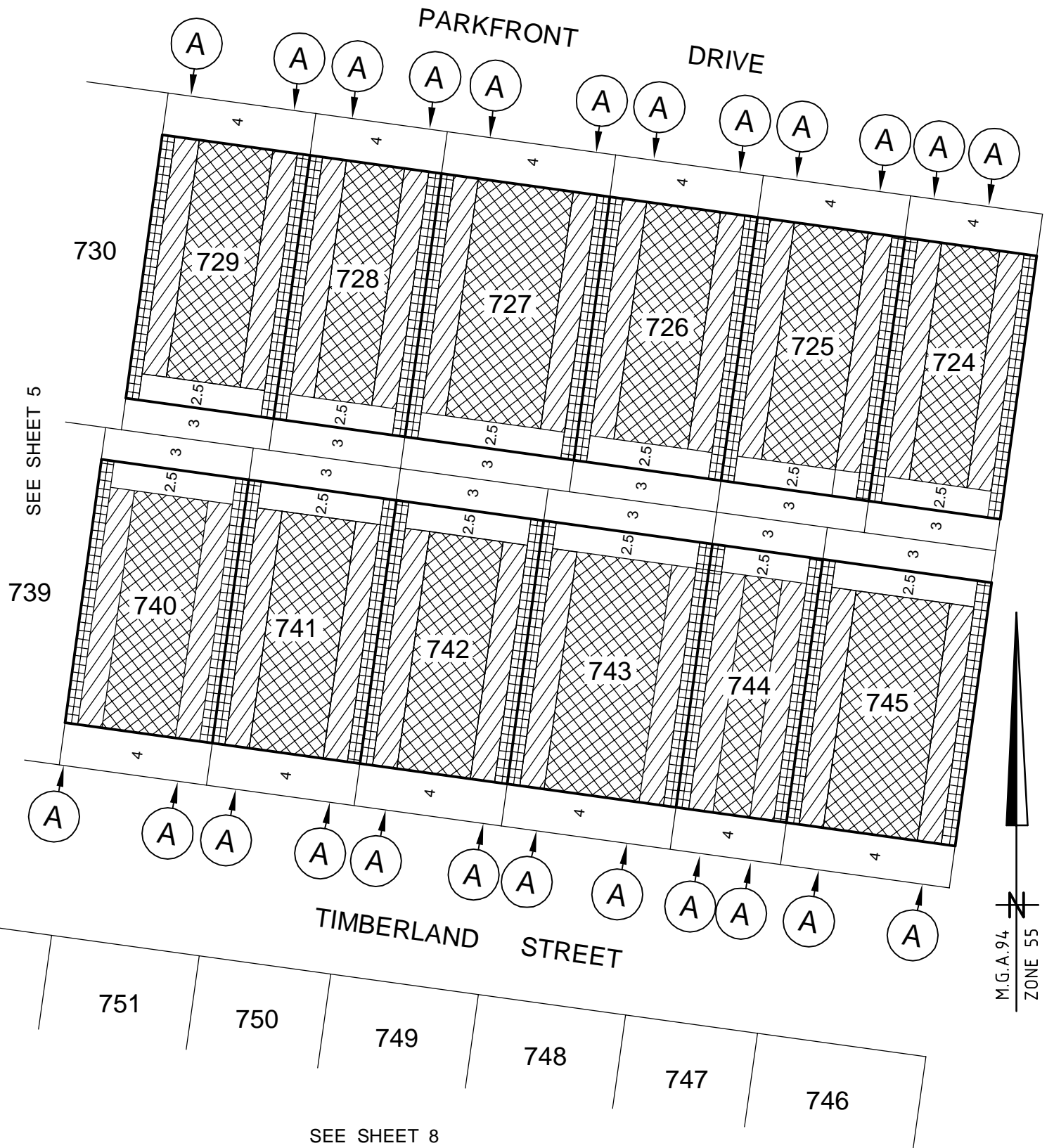

0 5 10 20
Scale 1:500 @ A4

Notations:

- 1 - The Building Envelopes on this plan are shown enclosed by continuous thick lines
- 2 - This diagram is to be read in conjunction with "Profile Diagrams" in this document
- 3 - Profile types A & B are contained in "Profile Diagrams" in this document
- 4a- The western boundary of Lot 758 is deemed to be the front street boundary of the said lot
- 4b- The southern boundary of Lot 758 is deemed to be the side boundary of the said lot

Ref: 3440248sEST07
Date: 23 February 2012
Version: H

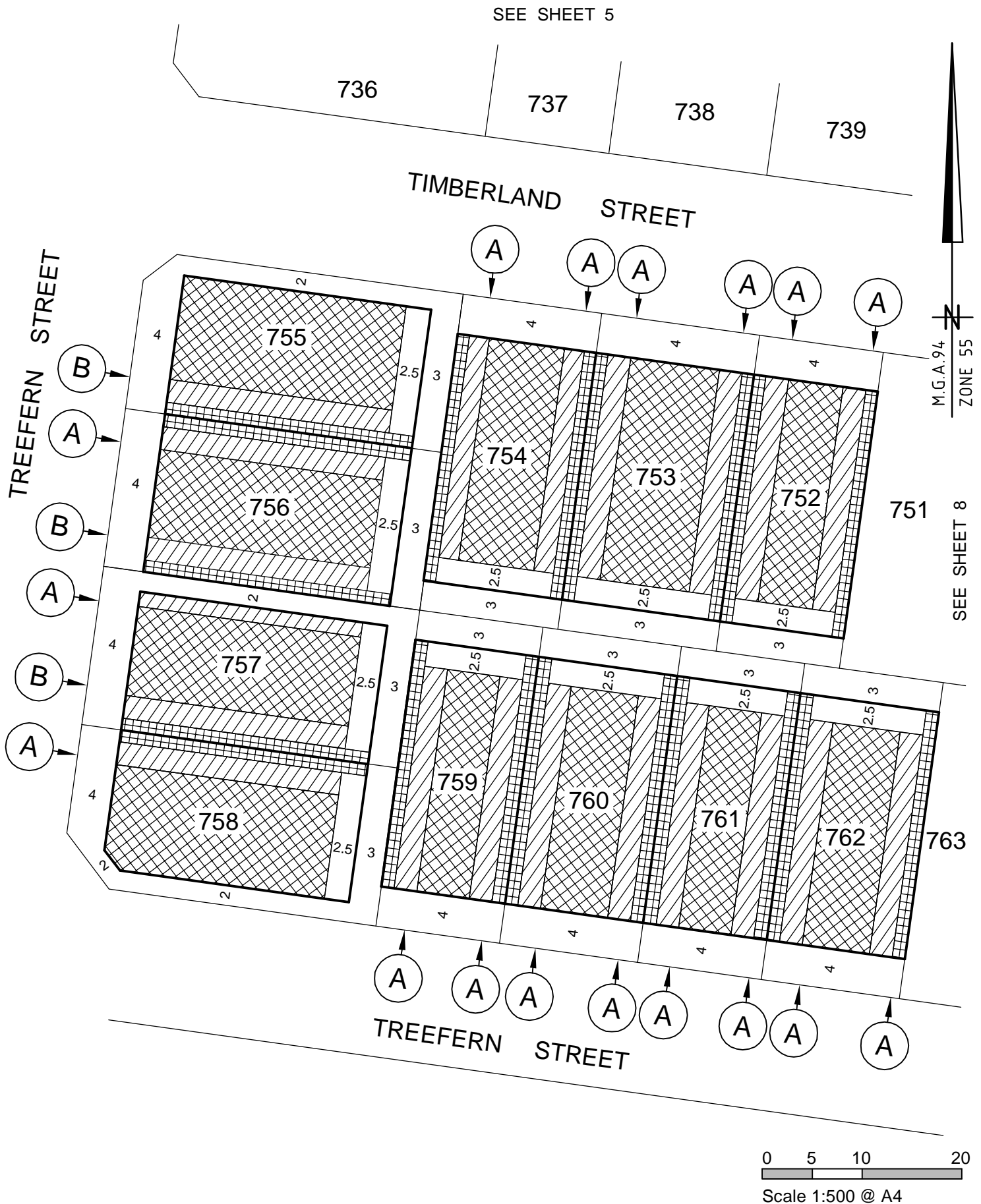

Notations:

- 1 - The Building Envelopes on this plan are shown enclosed by continuous thick lines
- 2 - This diagram is to be read in conjunction with "Profile Diagrams" in this document
- 3 - Profile types (A) & (B) are contained in "Profile Diagrams" in this document

- 4a- The western boundary of Lot 758 is deemed to be the front street boundary of the said lot
- 4b- The southern boundary of Lot 758 is deemed to be the side boundary of the said lot

Ref: 3440248sEST07
Date: 23 February 2012
Version: H

SEE SHEET 6

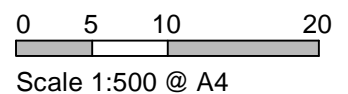
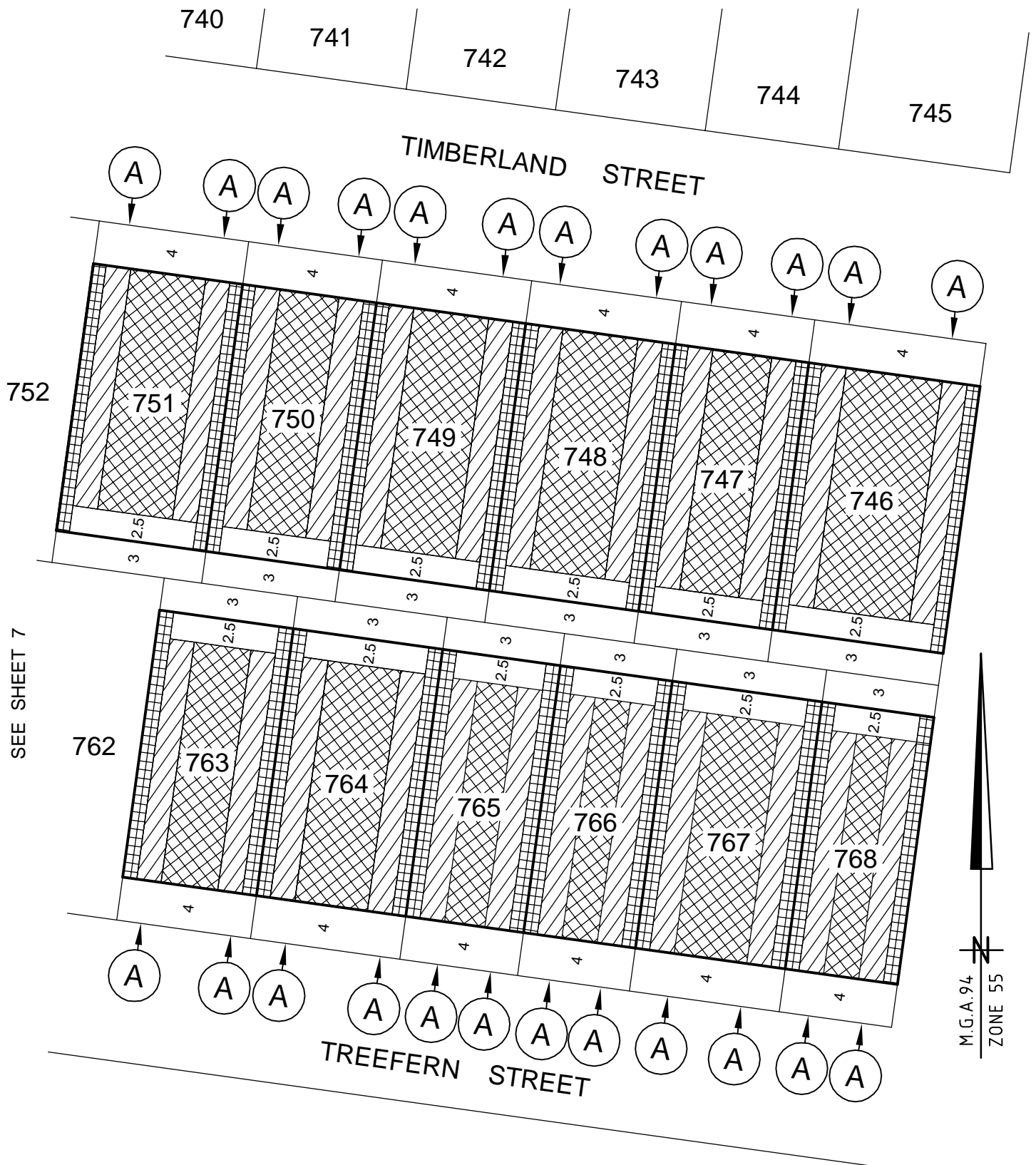

Notations:

- 1 - The Building Envelopes on this plan are shown enclosed by continuous thick lines
- 2 - This diagram is to be read in conjunction with "Profile Diagrams" in this document
- 3 - Profile types A & B are contained in "Profile Diagrams" in this document
- 4a- The western boundary of Lot 758 is deemed to be the front street boundary of the said lot
- 4b- The southern boundary of Lot 758 is deemed to be the side boundary of the said lot

Ref: 3440248sEST07
Date: 23 February 2012
Version: H