

LEGEND

Electricity (Underground)	Electricity (Overhead)
Water	Water
Stormwater Drain (P)	Stormwater Drain (W)
Stormwater Drain (S)	Stormwater Drain (D)
Gas	Gas
Gas & Water Conduits	Gas & Water Conduits
Tackle Paver - Directional	Tackle Paver - Directional
Tackle Paver - Standard	Tackle Paver - Standard
Existing Electricity (Overhead)	Existing Electricity (Overhead)
Existing Gas	Existing Gas
Existing Telecom	Existing Telecom
Existing Stormwater Drain	Existing Stormwater Drain
Existing Sewer	Existing Sewer
Existing Tree to Remain	Existing Tree to Remain
Existing Tree to be Removed	Existing Tree to be Removed
Existing Swept Drain	Existing Swept Drain
Existing Surface Level	Existing Surface Level
Finished Building Line Level	Finished Building Line Level
Top of Retaining Wall	Top of Retaining Wall
Bottom of Retaining Wall	Bottom of Retaining Wall
Retaining Wall	Retaining Wall
Intersection Threshold Treatment	Intersection Threshold Treatment
Saved Fill - 200mm Deep	Saved Fill - 200mm Deep
Ex. Select Fill - 200mm Deep	Ex. Select Fill - 200mm Deep
Proposed Driveway	Proposed Driveway
Alignment to be graded evenly in direction of flow	Alignment to be graded evenly in direction of flow
Direction of Flow	Direction of Flow
Overhead Survey Mark	Overhead Survey Mark
Temporary Survey Mark	Temporary Survey Mark
Concrete Edge Strip with Subsoil Drain underneath "No Road"	Concrete Edge Strip with Subsoil Drain underneath "No Road"
Building Envelope	Building Envelope
Limit of Works	Limit of Works

ROAD NAME	RESERVE WIDTH (m)	WIDTH (m)	TYPE	STH/EAST	STH/EAST	STH/EAST
SOVEREIGN DRIVE (27m WIDE)	25.00	15.40	CONCRETE	82	82	82
SOVEREIGN DRIVE (127m WIDE)	27.00	17.40	CONCRETE	82	82	82
EATON ROAD	18.00	6.70	GRASS	82	82	82
CONQUEST STREET	16.00	6.70	GRASS	82	82	82

ROAD NAME	RESERVE WIDTH (m)	WIDTH (m)	TYPE	STH/EAST	STH/EAST	STH/EAST
SOVEREIGN DRIVE	2.10	2.60	WEST	3.40	3.40	2.775
EATON ROAD	2.10	2.60	NORTH	3.10	2.60	1.775
CONQUEST STREET	2.10	2.60	NORTH	3.10	2.60	1.775

ROAD NAME	RESERVE WIDTH (m)	WIDTH (m)	TYPE	STH/EAST	STH/EAST	STH/EAST
SOVEREIGN DRIVE	2.10	2.60	WEST	3.40	3.40	2.775
EATON ROAD	2.10	2.60	NORTH	3.10	2.60	1.775
CONQUEST STREET	2.10	2.60	NORTH	3.10	2.60	1.775

ROAD NAME	RESERVE WIDTH (m)	WIDTH (m)	TYPE	STH/EAST	STH/EAST	STH/EAST
SOVEREIGN DRIVE	2.10	2.60	WEST	3.40	3.40	2.775
EATON ROAD	2.10	2.60	NORTH	3.10	2.60	1.775
CONQUEST STREET	2.10	2.60	NORTH	3.10	2.60	1.775

ROAD NAME	RESERVE WIDTH (m)	WIDTH (m)	TYPE	STH/EAST	STH/EAST	STH/EAST
SOVEREIGN DRIVE	2.10	2.60	WEST	3.40	3.40	2.775
EATON ROAD	2.10	2.60	NORTH	3.10	2.60	1.775
CONQUEST STREET	2.10	2.60	NORTH	3.10	2.60	1.775

ROAD NAME	RESERVE WIDTH (m)	WIDTH (m)	TYPE	STH/EAST	STH/EAST	STH/EAST
SOVEREIGN DRIVE	2.10	2.60	WEST	3.40	3.40	2.775
EATON ROAD	2.10	2.60	NORTH	3.10	2.60	1.775
CONQUEST STREET	2.10	2.60	NORTH	3.10	2.60	1.775

ROAD NAME	RESERVE WIDTH (m)	WIDTH (m)	TYPE	STH/EAST	STH/EAST	STH/EAST
SOVEREIGN DRIVE	2.10	2.60	WEST	3.40	3.40	2.775
EATON ROAD	2.10	2.60	NORTH	3.10	2.60	1.775
CONQUEST STREET	2.10	2.60	NORTH	3.10	2.60	1.775

ROAD NAME	RESERVE WIDTH (m)	WIDTH (m)	TYPE	STH/EAST	STH/EAST	STH/EAST
SOVEREIGN DRIVE	2.10	2.60	WEST	3.40	3.40	2.775
EATON ROAD	2.10	2.60	NORTH	3.10	2.60	1.775
CONQUEST STREET	2.10	2.60	NORTH	3.10	2.60	1.775

ROAD NAME	RESERVE WIDTH (m)	WIDTH (m)	TYPE	STH/EAST	STH/EAST	STH/EAST
SOVEREIGN DRIVE	2.10	2.60	WEST	3.40	3.40	2.775
EATON ROAD	2.10	2.60	NORTH	3.10	2.60	1.775
CONQUEST STREET	2.10	2.60	NORTH	3.10	2.60	1.775

ROAD NAME	RESERVE WIDTH (m)	WIDTH (m)	TYPE	STH/EAST	STH/EAST	STH/EAST
SOVEREIGN DRIVE	2.10	2.60	WEST	3.40	3.40	2.775
EATON ROAD	2.10	2.60	NORTH	3.10	2.60	1.775
CONQUEST STREET	2.10	2.60	NORTH	3.10	2.60	1.775

ROAD NAME	RESERVE WIDTH (m)	WIDTH (m)	TYPE	STH/EAST	STH/EAST	STH/EAST
SOVEREIGN DRIVE	2.10	2.60	WEST	3.40	3.40	2.775
EATON ROAD	2.10	2.60	NORTH	3.10	2.60	1.775
CONQUEST STREET	2.10	2.60	NORTH	3.10	2.60	1.775

ROAD NAME	RESERVE WIDTH (m)	WIDTH (m)	TYPE	STH/EAST	STH/EAST	STH/EAST
SOVEREIGN DRIVE	2.10	2.60	WEST	3.40	3.40	2.775
EATON ROAD	2.10	2.60	NORTH	3.10	2.60	1.775
CONQUEST STREET	2.10	2.60	NORTH	3.10	2.60	1.775

ROAD NAME	RESERVE WIDTH (m)	WIDTH (m)	TYPE	STH/EAST	STH/EAST	STH/EAST
SOVEREIGN DRIVE	2.10	2.60	WEST	3.40	3.40	2.775
EATON ROAD	2.10	2.60	NORTH	3.10	2.60	1.775
CONQUEST STREET	2.10	2.60	NORTH	3.10	2.60	1.775

ROAD NAME	RESERVE WIDTH (m)	WIDTH (m)	TYPE	STH/EAST	STH/EAST	STH/EAST
SOVEREIGN DRIVE	2.10	2.60	WEST	3.40	3.40	2.775
EATON ROAD	2.10	2.60	NORTH	3.10	2.60	1.775
CONQUEST STREET	2.10	2.60	NORTH	3.10	2.60	1.775

ROAD NAME	RESERVE WIDTH (m)	WIDTH (m)	TYPE	STH/EAST	STH/EAST	STH/EAST
SOVEREIGN DRIVE	2.10	2.60	WEST	3.40	3.40	2.775
EATON ROAD	2.10	2.60	NORTH	3.10	2.60	1.775
CONQUEST STREET	2.10	2.60	NORTH	3.10	2.60	1.775

ROAD NAME	RESERVE WIDTH (m)	WIDTH (m)	TYPE	STH/EAST	STH/EAST	STH/EAST
SOVEREIGN DRIVE	2.10	2.60	WEST	3.40	3.40	2.775
EATON ROAD	2.10	2.60	NORTH	3.10	2.60	1.775
CONQUEST STREET	2.10	2.60	NORTH	3.10	2.60	1.775

ROAD NAME	RESERVE WIDTH (m)	WIDTH (m)	TYPE	STH/EAST	STH/EAST	STH/EAST
SOVEREIGN DRIVE	2.10	2.60	WEST	3.40	3.40	2.775
EATON ROAD	2.10	2.60	NORTH	3.10	2.60	1.775
CONQUEST STREET	2.10	2.60	NORTH	3.10	2.60	1.775

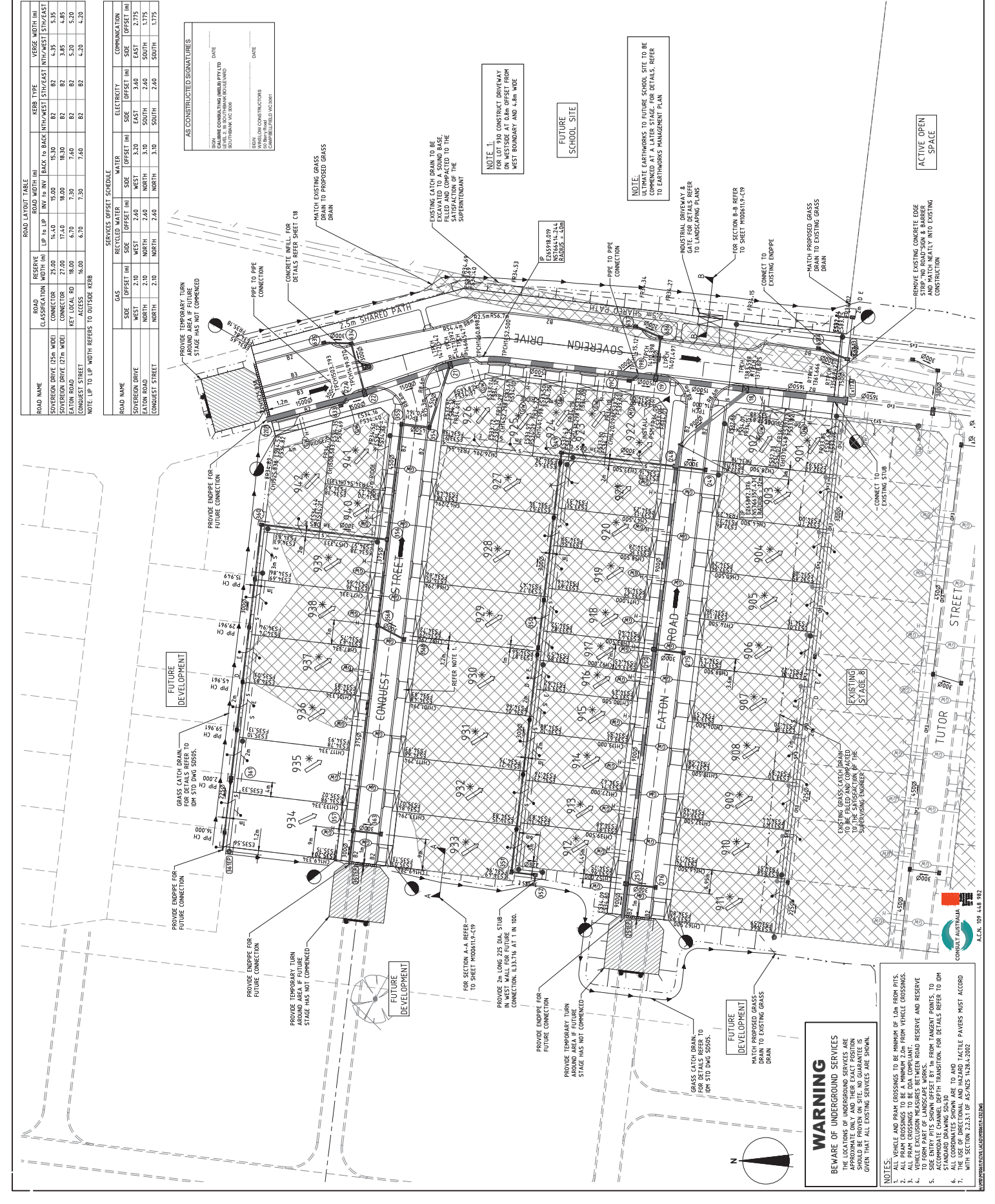

WARNING

BWARE OF UNDERGROUND SERVICES

THE LOCATIONS OF UNDERGROUND SERVICES ARE APPROXIMATE ONLY AND THEIR EXACT POSITION SHOULD BE PROVEN ON SITE. NO GUARANTEE IS GIVEN THAT ALL EXISTING SERVICES ARE SHOWN.

- ALL VEHICLE AND PRAM CROSSINGS TO BE MINIMUM OF 1.0m FROM PITS.
- ALL PRAM CROSSINGS TO BE A MINIMUM 2.0m FROM VEHICLE CROSSINGS.
- ALL PRAM CROSSINGS TO BE 0.0m COMPLIANT.
- ALL PRAM CROSSINGS TO BE 0.0m COMPLIANT.
- SIDE ENTRY PITS SHOWN OFFSET BY 1m FROM TANGENT POINTS TO FORM PART OF LANDSCAPE WORKS.
- SIDE ENTRY PITS SHOWN OFFSET BY 1m FROM TANGENT POINTS TO FORM PART OF LANDSCAPE WORKS.
- ALL COORDINATES SHOWN ARE TO AND FROM THE DATUM POINTS SHOWN IN THE STANDARD DRAWING S430.
- WITH SECTION 2.2.3.1 OF AS/NZS 4459.1:2002.

NOTE 1:

ULTIMATE EARTHWORKS TO FUTURE SCHOOL SITE TO BE DETERMINED BY THE ARCHITECT FOR DETAILS. REFER TO EARTHWORKS MANAGEMENT PLAN.

NOTE 2:

INDUSTRIAL DRIVEWAY & GATE FOR DETAILS REFER TO LANDSCAPING PLANS.

NOTE 3:

FOR SECTION A-A REFER TO SHEET M006119-C9

NOTE 4:

FOR SECTION A-A REFER TO SHEET M006119-C9

NOTE 5:

FOR SECTION A-A REFER TO SHEET M006119-C9

NOTE 6:

FOR SECTION A-A REFER TO SHEET M006119-C9

NOTE 7:

FOR SECTION A-A REFER TO SHEET M006119-C9

NOTE 1:

ULTIMATE EARTHWORKS TO FUTURE SCHOOL SITE TO BE DETERMINED BY THE ARCHITECT FOR DETAILS. REFER TO EARTHWORKS MANAGEMENT PLAN.

NOTE 2:

INDUSTRIAL DRIVEWAY & GATE FOR DETAILS REFER TO LANDSCAPING PLANS.

NOTE 3:

FOR SECTION A-A REFER TO SHEET M006119-C9

NOTE 4:

FOR SECTION A-A REFER TO SHEET M006119-C9

NOTE 5:

FOR SECTION A-A REFER TO SHEET M006119-C9

NOTE 6:

FOR SECTION A-A REFER TO SHEET M006119-C9

NOTE 7:

FOR SECTION A-A REFER TO SHEET M006119-C9

NOTE 1:

ULTIMATE EARTHWORKS TO FUTURE SCHOOL SITE TO BE DETERMINED BY THE ARCHITECT FOR DETAILS. REFER TO EARTHWORKS MANAGEMENT PLAN.

NOTE 2:

INDUSTRIAL DRIVEWAY & GATE FOR DETAILS REFER TO LANDSCAPING PLANS.

NOTE 3:

FOR SECTION A-A REFER TO SHEET M006119-C9

NOTE 4:

FOR SECTION A-A REFER TO SHEET M006119-C9

NOTE 5:

FOR SECTION A-A REFER TO SHEET M006119-C9

NOTE 6:

FOR SECTION A-A REFER TO SHEET M006119-C9

NOTE 7:

FOR SECTION A-A REFER TO SHEET M006119-C9

NOTE 1:

ULTIMATE EARTHWORKS TO FUTURE SCHOOL SITE TO BE DETERMINED BY THE ARCHITECT FOR DETAILS. REFER TO EARTHWORKS MANAGEMENT PLAN.

NOTE 2:

INDUSTRIAL DRIVEWAY & GATE FOR DETAILS REFER TO LANDSCAPING PLANS.

NOTE 3:

FOR SECTION A-A REFER TO SHEET M006119-C9

NOTE 4:

FOR SECTION A-A REFER TO SHEET M006119-C9

NOTE 5:

FOR SECTION A-A REFER TO SHEET M006119-C9

NOTE 6:

FOR SECTION A-A REFER TO SHEET M006119-C9

NOTE 7:

FOR SECTION A-A REFER TO SHEET M006119-C9

NOTE 1:

ULTIMATE EARTHWORKS TO FUTURE SCHOOL SITE TO BE DETERMINED BY THE ARCHITECT FOR DETAILS. REFER TO EARTHWORKS MANAGEMENT PLAN.

NOTE 2:

INDUSTRIAL DRIVEWAY & GATE FOR DETAILS REFER TO LANDSCAPING PLANS.

NOTE 3:

FOR SECTION A-A REFER TO SHEET M006119-C9

NOTE 4:

FOR SECTION A-A REFER TO SHEET M006119-C9

NOTE 5:

FOR SECTION A-A REFER TO SHEET M006119-C9

NOTE 6:

FOR SECTION A-A REFER TO SHEET M006119-C9

NOTE 7:

FOR SECTION A-A REFER TO SHEET M006119-C9

NOTE 1:

ULTIMATE EARTHWORKS TO FUTURE SCHOOL SITE TO BE DETERMINED BY THE ARCHITECT FOR DETAILS. REFER TO EARTHWORKS MANAGEMENT PLAN.

NOTE 2:

INDUSTRIAL DRIVEWAY & GATE FOR DETAILS REFER TO LANDSCAPING PLANS.

NOTE 3:

FOR SECTION A-A REFER TO SHEET M006119-C9

NOTE 4:

FOR SECTION A-A REFER TO SHEET M006119-C9

NOTE 5:

FOR SECTION A-A REFER TO SHEET M006119-C9

NOTE 6:

FOR SECTION A-A REFER TO SHEET M006119-C9

NOTE 7:

FOR SECTION A-A REFER TO SHEET M006119-C9

NOTE 1:

ULTIMATE EARTHWORKS TO FUTURE SCHOOL SITE TO BE DETERMINED BY THE ARCHITECT FOR DETAILS. REFER TO EARTHWORKS MANAGEMENT PLAN.

NOTE 2:

INDUSTRIAL DRIVEWAY & GATE FOR DETAILS REFER TO LANDSCAPING PLANS.

NOTE 3:

FOR SECTION A-A REFER TO SHEET M006119-C9

NOTE 4:

FOR SECTION A-A REFER TO SHEET M006119-C9

NOTE 5:

FOR SECTION A-A REFER TO SHEET M006119-C9

NOTE 6:

FOR SECTION A-A REFER TO SHEET M006119-C9

NOTE 7:

FOR SECTION A-A REFER TO SHEET M006119-C9