

WARNING
BEWARE OF UNDERGROUND SERVICES
THE LOCATIONS OF UNDERGROUND SERVICES ARE APPROXIMATE ONLY AND THEIR EXACT POSITION SHOULD BE PROVEN ON SITE. NO GUARANTEE IS GIVEN THAT ALL EXISTING SERVICES ARE SHOWN.

- LEGEND**
- E Electricity (Underground)
 - G Gas
 - T Telstra
 - W Water
 - SD Stormwater Drain, Pit and Property Inlet
 - SW Swale Drain
 - SS Sewer, Maintenance Structures and Property Connection
 - HD House Drain
 - GW Gas & Water Conduits
 - TP Tactile Paver - Directional
 - TH Tactile Paver - Hazard
 - Ex E Existing Electricity (Underground)
 - Ex G Existing Gas
 - Ex T Existing Telstra
 - Ex W Existing Water
 - Ex SD Existing Stormwater Drain
 - Ex SS Existing Sewer
 - Ex HD Existing House Drain
 - Ex TR Existing Tree to Remain
 - Ex TRX Existing Tree to be Removed
 - Ex SD Existing Swale Drain
 - ES14.134 Existing Surface Level
 - FS14.035 Finished Building Line Level
 - FR17.40 Finished Ridge Line Level
 - TW159.30 Top of Retaining Wall
 - BW159.30 Bottom of Retaining Wall
 - Retaining Wall
 - Intersection Threshold Treatment
 - Structural Fill > 200mm Deep
 - Ex. Structural Fill > 200mm Deep
 - Proposed Driveway
 - Allotment to be graded evenly in direction of fall to levels indicated
 - Direction of Fall
 - Overland Flow
 - Permanent Survey Mark
 - Temporary Bench Mark
 - Concrete Edge Strip with Subsoil Drain underneath "No Road" sign and Barrier
 - Building Envelope
 - Limit of Works

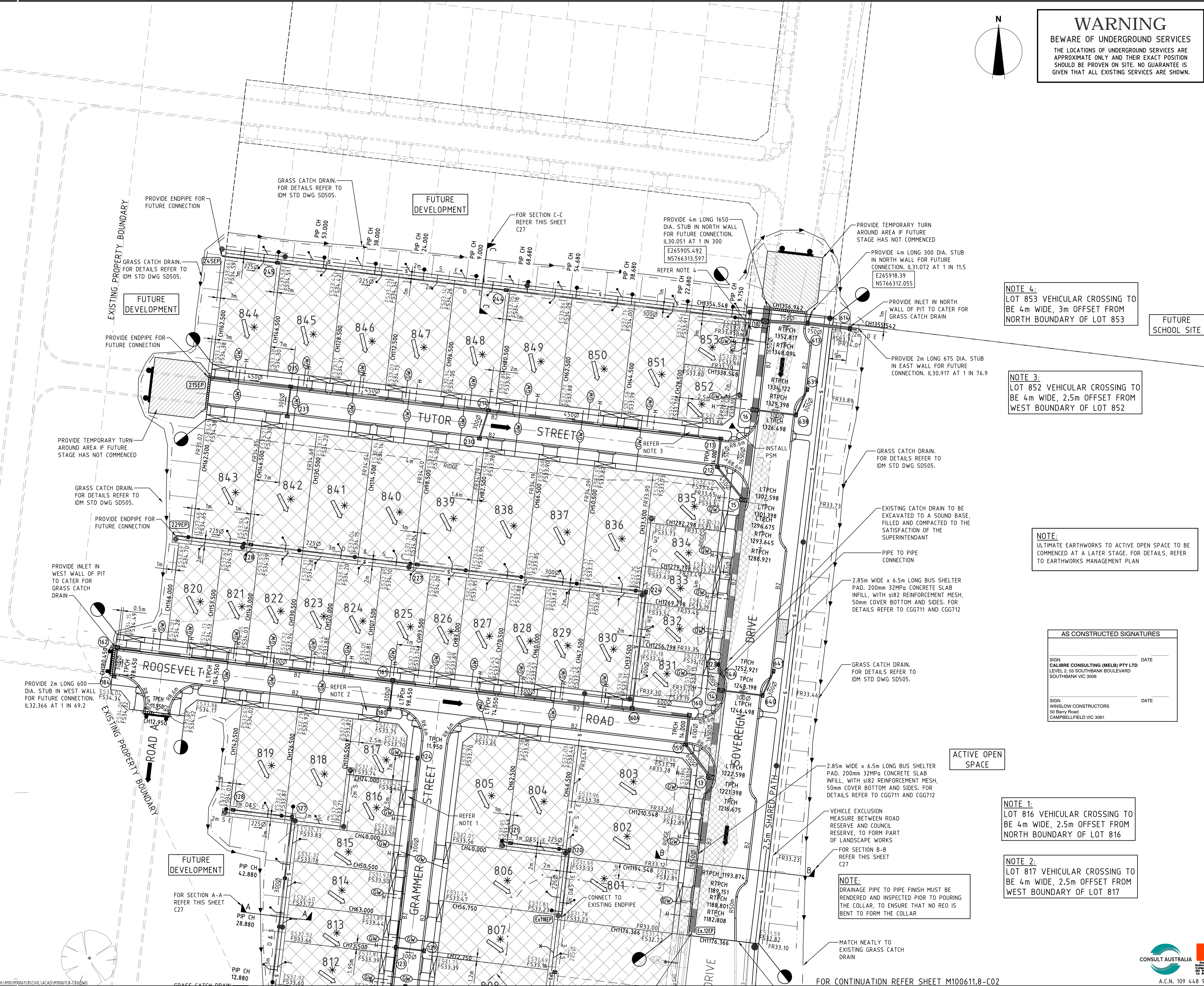

NOTE 4:
LOT 853 VEHICULAR CROSSING TO BE 4m WIDE, 3m OFFSET FROM NORTH BOUNDARY OF LOT 853

NOTE 3:
LOT 852 VEHICULAR CROSSING TO BE 4m WIDE, 2.5m OFFSET FROM WEST BOUNDARY OF LOT 852

NOTE:
ULTIMATE EARTHWORKS TO ACTIVE OPEN SPACE TO BE COMMENCED AT A LATER STAGE. FOR DETAILS, REFER TO EARTHWORKS MANAGEMENT PLAN

AS CONSTRUCTED SIGNATURES

SIGN: CALIBRE CONSULTING (MELB) PTY LTD DATE: _____
LEVEL 2, 55 SOUTH BANK BOULEVARD
SOUTH BANK VIC 3006

SIGN: WINLOW CONSTRUCTORS DATE: _____
50 Barry Road
CAMPBELLFIELD VIC 3081

NOTE 1:
LOT 816 VEHICULAR CROSSING TO BE 4m WIDE, 2.5m OFFSET FROM NORTH BOUNDARY OF LOT 816

NOTE 2:
LOT 817 VEHICULAR CROSSING TO BE 4m WIDE, 2.5m OFFSET FROM WEST BOUNDARY OF LOT 817

REV	DATE	COMMENTS
AC	20/02/15	AS CONSTRUCTED ISSUE
3	28/10/14	LOTS 816, 817, 852 & 853 DRIVEWAYS RELOCATED
2	26/08/14	BUS SHELTER PADS ADDED
1	10/07/14	DRIVEWAY LOT 341 MOVED TO EAST SIDE
0	11/04/14	ISSUED FOR CONSTRUCTION
B		COUNCIL COMMENTS DATED 10/12/13
A	11/11/13	ISSUED FOR APPROVAL



ARMSTRONG
STAGE 8

BROWN
Smart Consulting

BROWN CONSULTING (VIC) PTY LTD
Engineers, Town Planners and Surveyors
Level 2, 55 Southbank Boulevard
Southbank VIC 3006 T 03 9203 9000

LAYOUT PLAN - 2
1:500 10 5 0 10 20 A1
1:1000 A3

SCALE @ A1	DRAWN	DESIGNED
1:500	R.KOZUL	R.KOZUL
PROJECT ENGINEER	PROJECT MANAGER	DATE FIRST ISSUE
J.CONSIGLIO	T.PALIOS	11/11/13

AS CONSTRUCTED

SIGNED: _____ DATE: _____
DRAWING NUMBER: **M100611.8-C03** REVISION: **AC**



FOR CONTINUATION REFER SHEET M100611.8-C02