

Memorandum of common provisions
Section 91A Transfer of Land Act 1958

PLANNING AND ENVIRONMENT ACT 1987



This plan/document is endorsed in
 accordance with Condition No. 7 of Permit
 No. P22159.01

Sheet No. 7 of 11
 Date: 23-09-2021

Signature for the Responsible Authority:
 Christopher Bryce

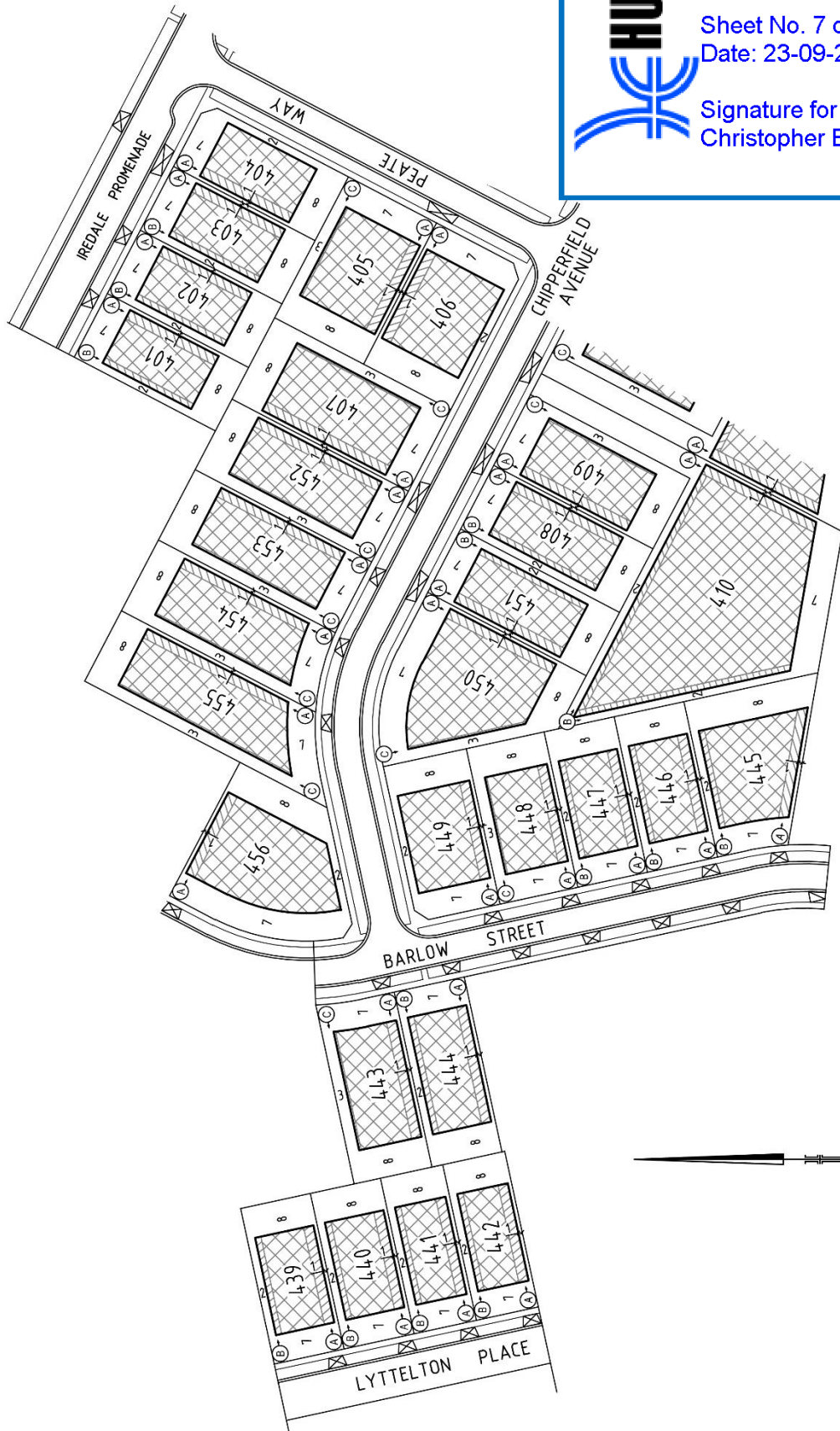

Notations

The Building envelopes on this plan are shown endorsed by
 continuous thick lines.
 Profile types are contained in "Profile Diagrams" in this document.

Memorandum of common provisions

Section 91A Transfer of Land Act 1958

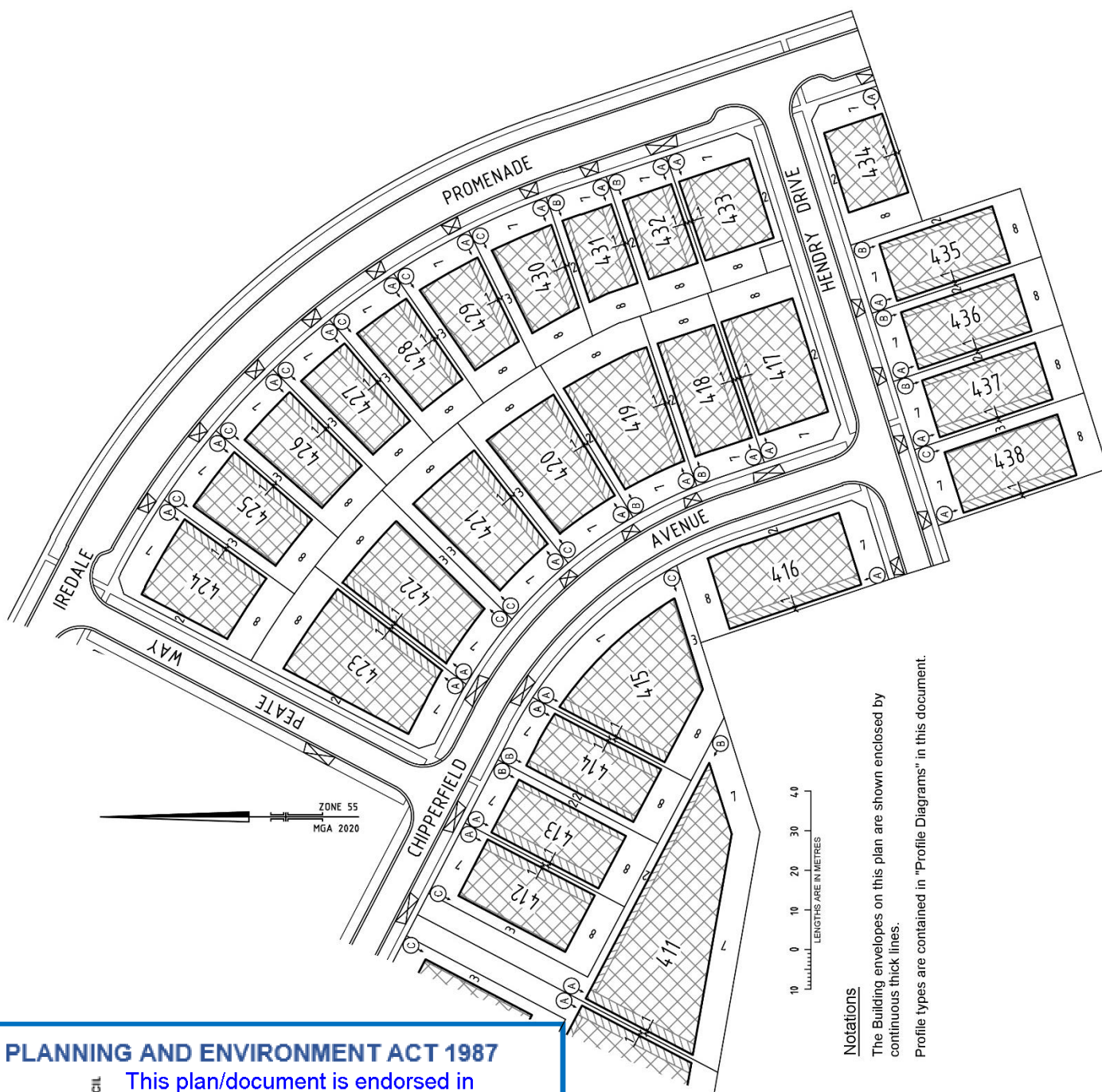

Notations

The Building envelopes on this plan are shown enclosed by continuous thick lines.

Profile types are contained in "Profile Diagrams" in this document.

PLANNING AND ENVIRONMENT ACT 1987



This plan/document is endorsed in accordance with Condition No. 7 of Permit No. P22159.01

Sheet No. 8 of 11
Date: 23-09-2021

Signature for the Responsible Authority:
Christopher Bryce