

LEGEND

- SEWER MANHOLE
- STORMWATER MANHOLE/
MAINTENANCE SHAFT
- GULLY TRAP
- FIELD INLET
- WATER METER
- FIRE HYDRANT
- STORMWATER
STORMWATER SWALE
- WATER PIPE
- TRUNK SEWER
- SEWER
- + 3.44 SURFACE LEVEL
IL INVERT LEVEL
SL SURFACE LEVEL
- DRIVEWAY / FOOTPATH
- KERB & CHANNEL
- ROOFWATER DRAINAGE PIPE
- ROOFWATER KERB ADAPTOR
- ROOFWATER KERB ADAPTOR
WITH CONNECTION TO LOT

Scale 1:300 - Lengths are in Metres.

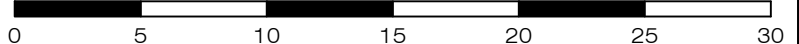

gassman
development
perspectives

planning | environment | landscape | engineering | survey
T: 3807 3333 | F: 3287 5461 | www.gassman.com.au
Gold Coast | 76 Business Street, Yatala QLD | PO Box 392, Beenleigh 4207

Client
Burleigh Heads Estate Pty Ltd

Project **SERVICE LOCATION SKETCH PLAN**

LOT 67 on SP329492

Stage 4, The Arbour Burleigh
Cowell Drive, Burleigh Heads

Locality	BURLEIGH HEADS	Issue Date	07/11/2023
Local Govt	GOLD COAST CITY COUNCIL	Meridian	SP329492
		Level Datum	AHD
Scale (on A4 original)	1:300	Drawn	S. Holt
		Date Drafted	30/10/2023
		Checked	A. Geraghty

Real Property Description:
Lot 67 on SP329492

REFERENCE No. **5967- 4**
PLAN No. **5967 S SK LOT 67**

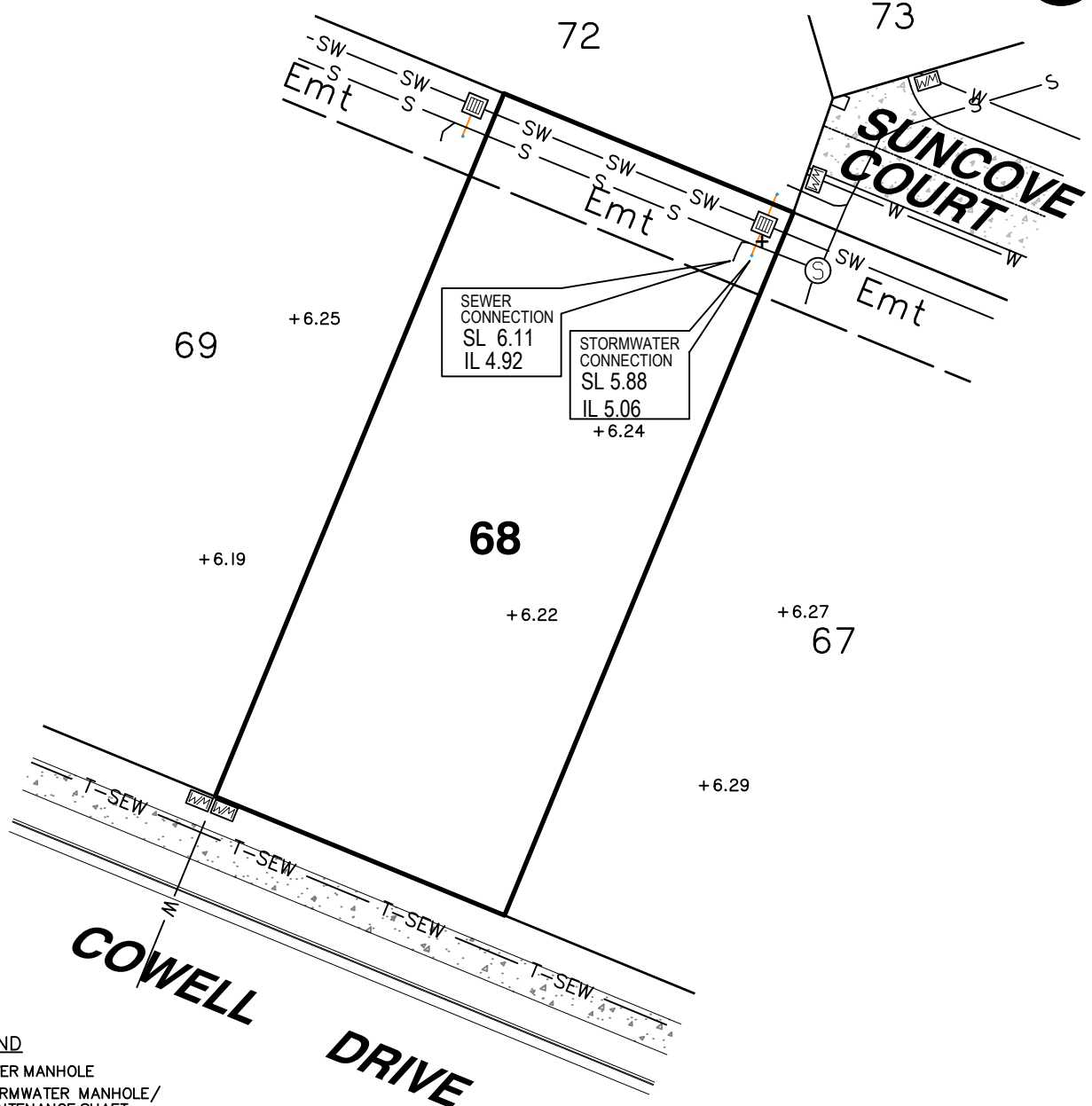

LEGEND

- SEWER MANHOLE
- STORMWATER MANHOLE/ MAINTENANCE SHAFT
- GULLY TRAP
- FIELD INLET
- WATER METER
- FIRE HYDRANT
- STORMWATER SWALE
- WATER PIPE
- TRUNK SEWER
- SEWER
- + 3.44 SURFACE LEVEL
- IL INVERT LEVEL
- SL SURFACE LEVEL
- DRIVEWAY / FOOTPATH
- KERB & CHANNEL
- ROOFWATER DRAINAGE PIPE
- ROOFWATER KERB ADAPTOR
- ROOFWATER KERB ADAPTOR WITH CONNECTION TO LOT

Scale 1:300 - Lengths are in Metres.

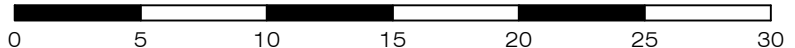

gassman
development
perspectives

planning | environment | landscape | engineering | survey
T: 3807 3333 | F: 3287 5461 | www.gassman.com.au
Gold Coast | 76 Business Street, Yatala QLD | PO Box 392, Beenleigh 4207

Client
Burleigh Heads Estate Pty Ltd

Project **SERVICE LOCATION SKETCH PLAN**

LOT 68 on SP329492

Stage 4, The Arbour Burleigh
Cowell Drive, Burleigh Heads

Locality	BURLEIGH HEADS	Issue Date	07/11/2023
Local Govt	GOLD COAST CITY COUNCIL	Meridian	SP329492
		Level Datum	AHD
Scale (on A4 original)	1:300	Drawn	S. Holt
		Date Drafted	30/10/2023
		Checked	A.Geraghty

Real Property Description:
Lot 68 on SP329492

REFERENCE No. 5967- 4
PLAN No. 5967 S SK LOT 68

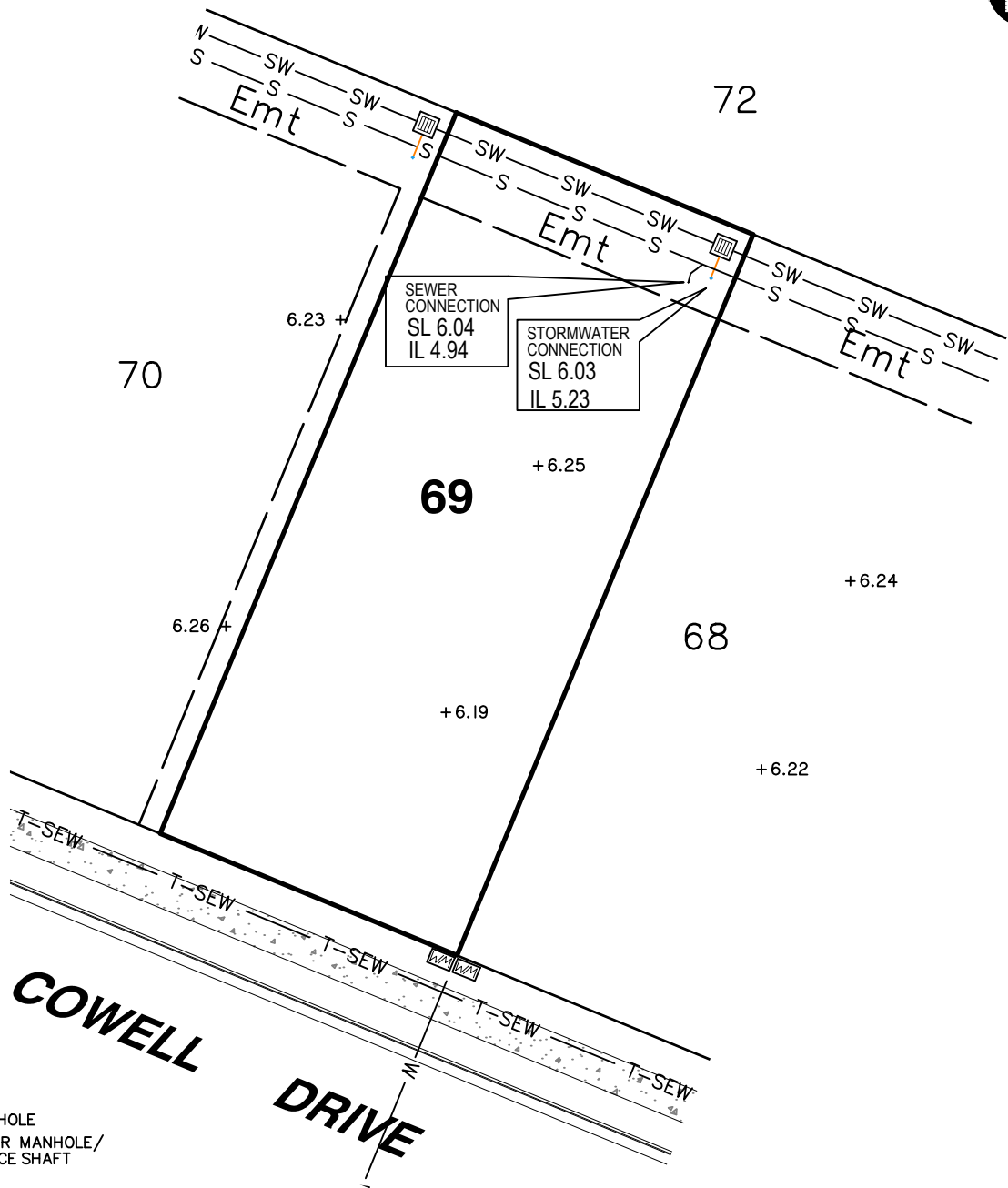

LEGEND

- SEWER MANHOLE
- STORMWATER MANHOLE/ MAINTENANCE SHAFT
- GULLY TRAP
- FIELD INLET
- WATER METER
- FIRE HYDRANT
- STORMWATER SWALE
- WATER PIPE
- TRUNK SEWER
- SEWER
- + 3.44 SURFACE LEVEL
- IL INVERT LEVEL
- SL SURFACE LEVEL
- DRIVEWAY / FOOTPATH
- KERB & CHANNEL
- ROOFWATER DRAINAGE PIPE
- ROOFWATER KERB ADAPTOR
- ROOFWATER KERB ADAPTOR WITH CONNECTION TO LOT

Scale 1:300 - Lengths are in Metres.

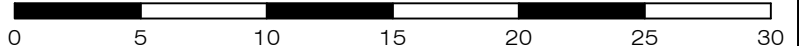

gassman
development
perspectives

planning | environment | landscape | engineering | survey
T: 3807 3333 | F: 3287 5461 | www.gassman.com.au
Gold Coast | 76 Business Street, Yatala QLD | PO Box 392, Beenleigh 4207

Client
Burleigh Heads Estate Pty Ltd

Project **SERVICE LOCATION SKETCH PLAN**

LOT 69 on SP329492

Stage 4, The Arbour Burleigh
Cowell Drive, Burleigh Heads

Locality	BURLEIGH HEADS	Issue Date	07/11/2023
Local Govt	GOLD COAST CITY COUNCIL	Meridian	SP329492
		Level Datum	AHD
Scale (on A4 original)	1:300	Drawn	S. Holt
		Date Drafted	30/10/2023
		Checked	A.Geraghty

Real Property Description:
Lot 69 on SP329492

REFERENCE No. 5967- 4
PLAN No. 5967 S SK LOT 69

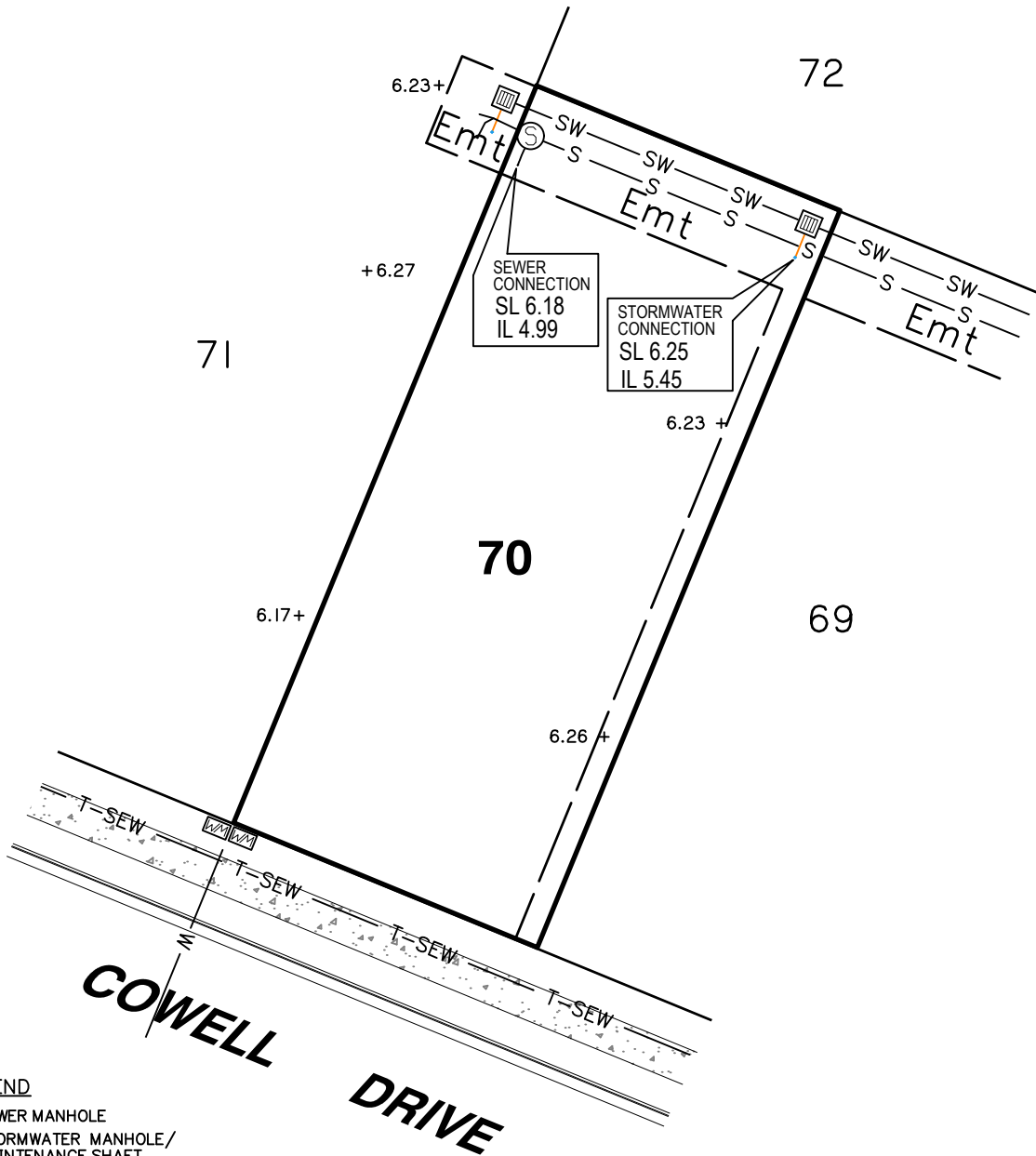

LEGEND

- SEWER MANHOLE
- STORMWATER MANHOLE/ MAINTENANCE SHAFT
- GULLY TRAP
- FIELD INLET
- WATER METER
- FIRE HYDRANT
- STORMWATER
- STORMWATER SWALE
- WATER PIPE
- TRUNK SEWER
- SEWER
- + 3.44 SURFACE LEVEL
- IL INVERT LEVEL
- SL SURFACE LEVEL
- DRIVEWAY / FOOTPATH
- KERB & CHANNEL
- ROOFWATER DRAINAGE PIPE
- ROOFWATER KERB ADAPTOR
- ROOFWATER KERB ADAPTOR WITH CONNECTION TO LOT

Scale 1:300 - Lengths are in Metres.

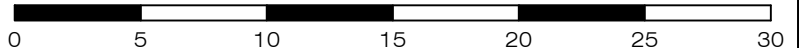

gassman
development
perspectives

planning | environment | landscape | engineering | survey
T: 3807 3333 | F: 3287 5461 | www.gassman.com.au
Gold Coast | 76 Business Street, Yatala QLD | PO Box 392, Beenleigh 4207

Client
Burleigh Heads Estate Pty Ltd

Project **SERVICE LOCATION SKETCH PLAN**

LOT 70 on SP329492

Stage 4, The Arbour Burleigh
Cowell Drive, Burleigh Heads

Locality	BURLEIGH HEADS	Issue Date	07/11/2023
Local Govt	GOLD COAST CITY COUNCIL	Meridian	SP329492
		Level Datum	AHD
Scale (on A4 original)	1:300	Drawn	S. Holt
		Date Drafted	30/10/2023
		Checked	A.Geraghty

Real Property Description:
Lot 70 on SP329492

REFERENCE No. 5967- 4
PLAN No. 5967 S SK LOT 70



903
SP316142

ROAD

72

Emt

SEWER CONNECTION
SL 6.11
IL 5.03

STORMWATER CONNECTION
SL 6.12
IL 5.55

71

Emt AC
SP316142

+6.24











70

6.17+

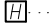
COWELL DRIVE

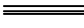
DRIVE

LEGEND

-  SEWER MANHOLE
-  STORMWATER MANHOLE/ MAINTENANCE SHAFT
-  GULLY TRAP
-  FIELD INLET
-  WATER METER
-  FIRE HYDRANT
- SW—SW STORMWATER
- W— WATER PIPE
- T-SEW— TRUNK SEWER
- S—S— SEWER
- + 3.44 SURFACE LEVEL
- IL INVERT LEVEL
- SL SURFACE LEVEL
-  DRIVEWAY / FOOTPATH
-  KERB & CHANNEL
-  ROOFWATER DRAINAGE PIPE
-  ROOFWATER KERB ADAPTOR
-  ROOFWATER KERB ADAPTOR WITH CONNECTION TO LOT

Scale 1:300 - Lengths are in Metres.

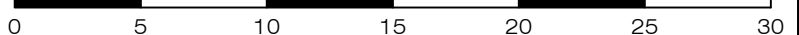

gassman
development
perspectives

planning | environment | landscape | engineering | survey
T: 3807 3333 | F: 3287 5461 | www.gassman.com.au
Gold Coast | 76 Business Street, Yatala QLD | PO Box 392, Beenleigh 4207

Client **Burleigh Heads Estate Pty Ltd**
Project **SERVICE LOCATION SKETCH PLAN**
LOT 71 on SP329492
Stage 4, The Arbour Burleigh
Cowell Drive, Burleigh Heads

Locality BURLEIGH HEADS
Local Govt GOLD COAST CITY COUNCIL
Scale (on A4 original) **1:300**

Issue Date 07/11/2023
Meridian SP329492
Level Datum AHD
Drawn S. Holt
Date Drafted 30/10/2023
Checked A. Geraghty

Real Property Description:
Lot 71 on SP329492

REFERENCE No. **5967- 4**
PLAN No. **5967 S SK LOT 71**



903
SP316142

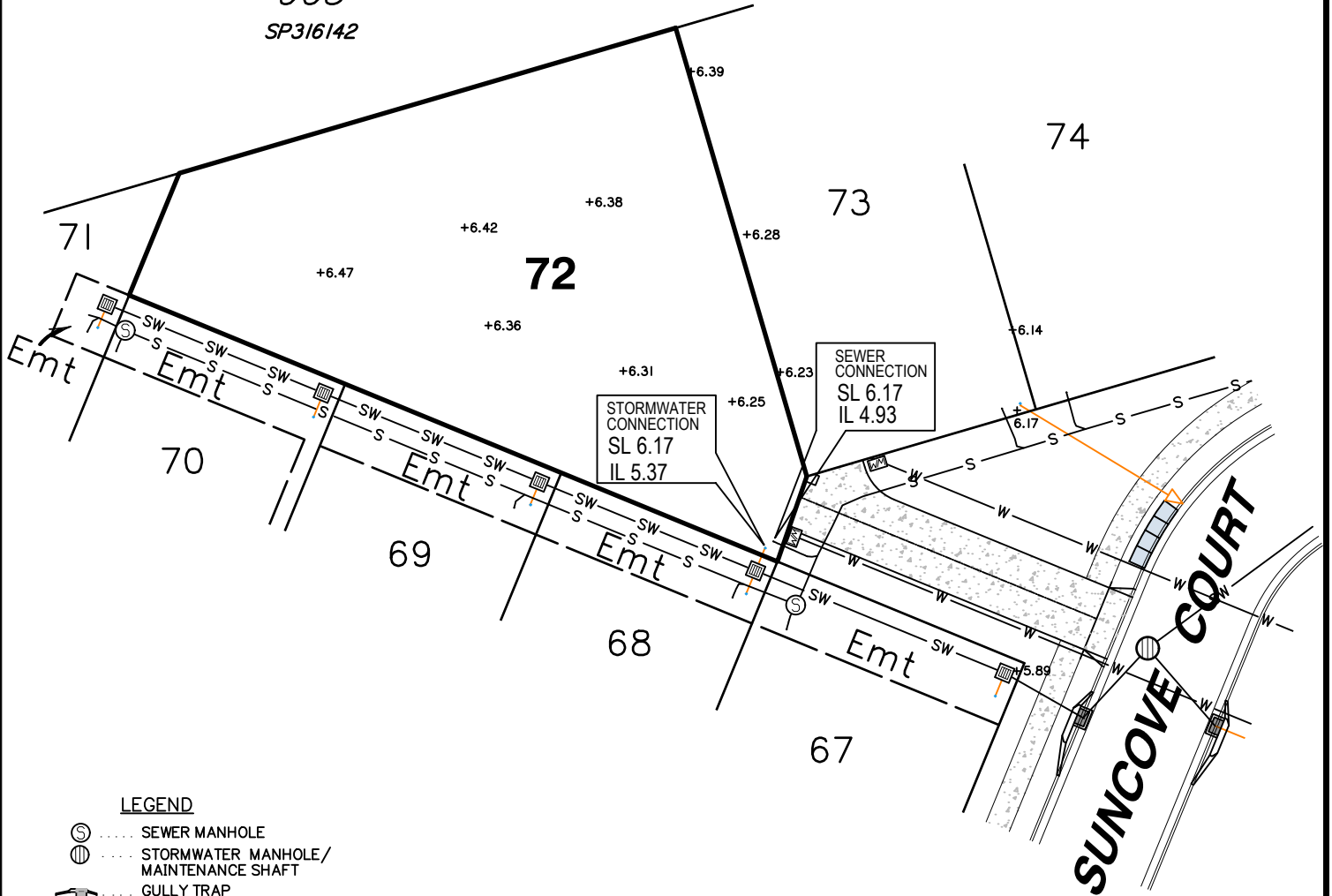

LEGEND

- SEWER MANHOLE
- STORMWATER MANHOLE/ MAINTENANCE SHAFT
- GULLY TRAP
- FIELD INLET
- WATER METER
- FIRE HYDRANT
- STORMWATER SWALE
- WATER PIPE
- TRUNK SEWER
- SEWER
- + 3.44 SURFACE LEVEL
- IL INVERT LEVEL
- SL SURFACE LEVEL
- DRIVEWAY / FOOTPATH
- KERB & CHANNEL
- ROOFWATER DRAINAGE PIPE
- ROOFWATER KERB ADAPTOR
- ROOFWATER KERB ADAPTOR WITH CONNECTION TO LOT

Scale 1:400 - Lengths are in Metres.

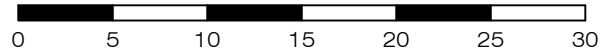

gassman
development
perspectives

est 1985
planning | environment | landscape | engineering | survey
T: 3807 3333 | F: 3287 5461 | www.gassman.com.au
Gold Coast | 76 Business Street, Yatala QLD | PO Box 392, Beenleigh 4207

Client
Burleigh Heads Estate Pty Ltd

Project **SERVICE LOCATION SKETCH PLAN**

LOT 72 on SP329492

Stage 4, The Arbour Burleigh
Cowell Drive, Burleigh Heads

Real Property Description:
Lot 72 on SP329492

Locality	BURLEIGH HEADS	Issue Date	07/11/2023
Local Govt	GOLD COAST CITY COUNCIL	Meridian	SP329492
		Level Datum	AHD
Scale (on A4 original)	1:400	Drawn	S. Holt
		Date Drafted	30/10/2023
		Checked	A.Geraghty

REFERENCE No. 5967- 4

PLAN No. 5967 S SK LOT 72



903
SP316142

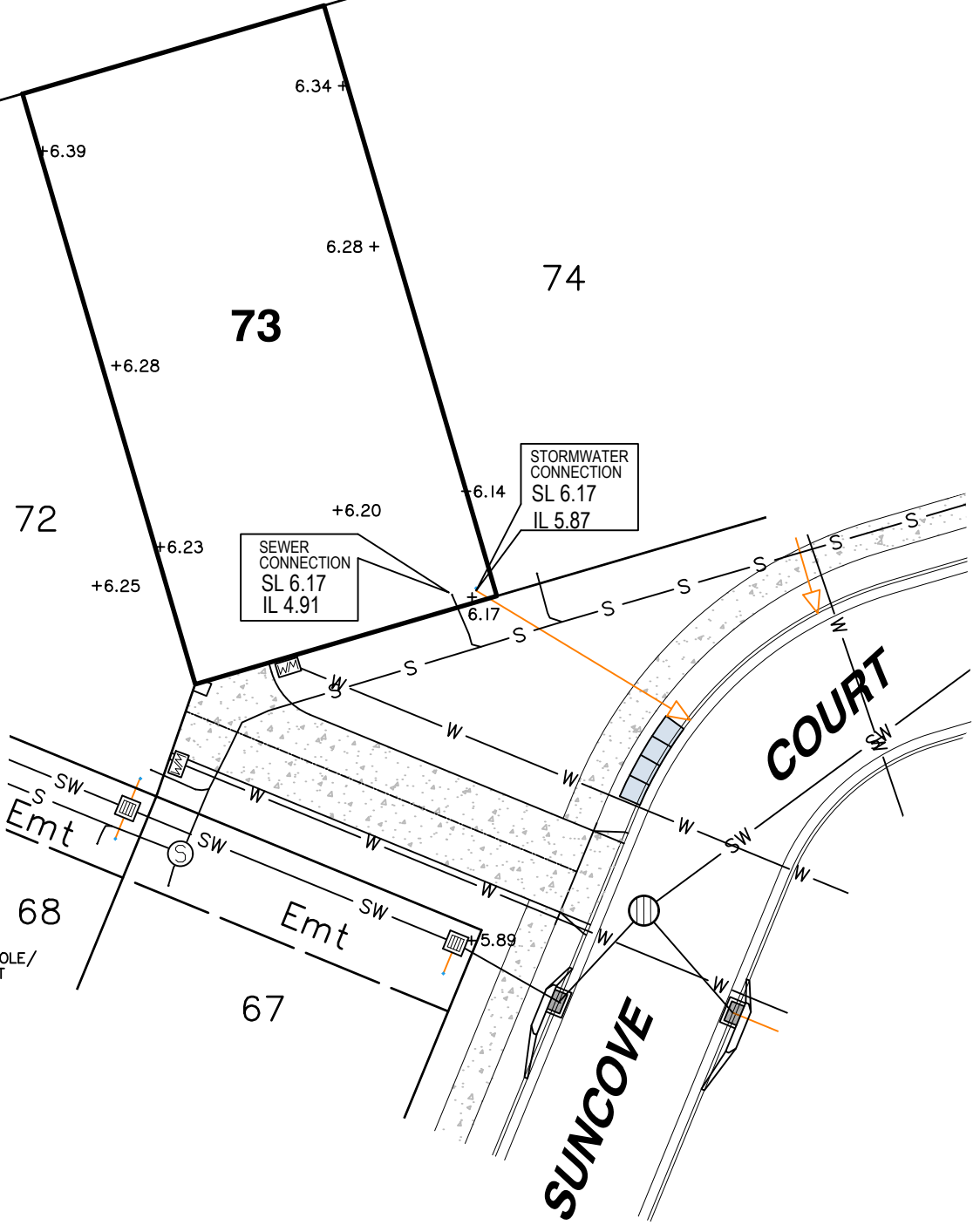

LEGEND

- SEWER MANHOLE
- STORMWATER MANHOLE/
MAINTENANCE SHAFT
- GULLY TRAP
- FIELD INLET
- WATER METER
- FIRE HYDRANT
- STORMWATER
- STORMWATER SWALE
- WATER PIPE
- TRUNK SEWER
- SEWER
- + 3.44 SURFACE LEVEL
- IL INVERT LEVEL
- SL SURFACE LEVEL
- DRIVEWAY / FOOTPATH
- KERB & CHANNEL
- ROOFWATER DRAINAGE PIPE
- ROOFWATER KERB ADAPTOR
- ROOFWATER KERB ADAPTOR
WITH CONNECTION TO LOT

Scale 1:300 - Lengths are in Metres.

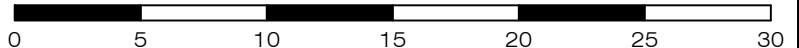

gassman
development
perspectives

planning | environment | landscape | engineering | survey
T: 3807 3333 | F: 3287 5461 | www.gassman.com.au
Gold Coast | 76 Business Street, Yatala QLD | PO Box 392, Beenleigh 4207

Client
Burleigh Heads Estate Pty Ltd

Project **SERVICE LOCATION SKETCH PLAN**

LOT 73 on SP329492

Stage 4, The Arbour Burleigh
Cowell Drive, Burleigh Heads

Real Property Description:
Lot 73 on SP329492

Locality BURLEIGH HEADS

Local Govt GOLD COAST
CITY COUNCIL

Scale (on A4 original)
1:300

Issue Date 07/11/2023

Meridian SP329492

Level Datum AHD

Drawn S. Holt

Date Drafted 30/10/2023

Checked A. Geraghty

REFERENCE No. **5967- 4**

PLAN No. **5967 S SK LOT 73**



903
SP316142

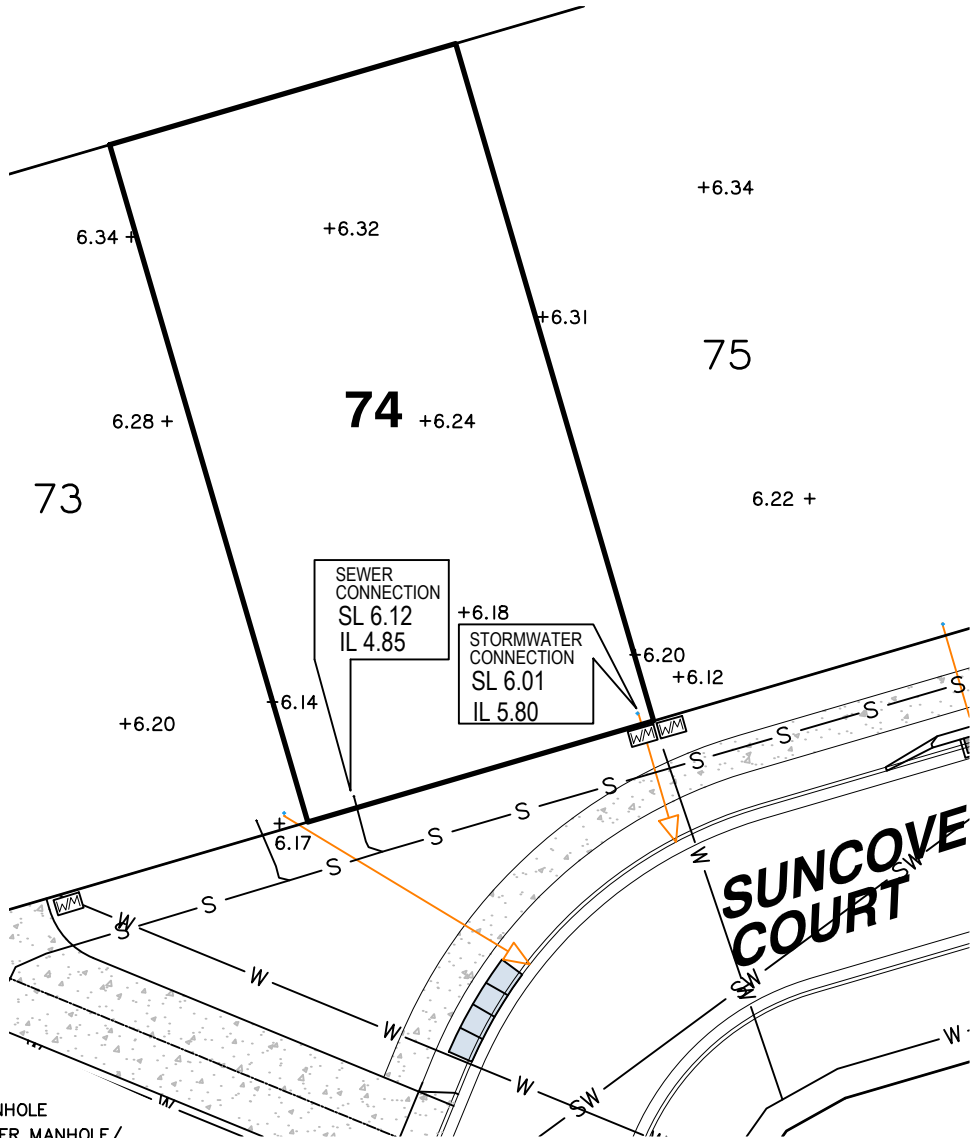

LEGEND

- SEWER MANHOLE
- STORMWATER MANHOLE/ MAINTENANCE SHAFT
- GULLY TRAP
- FIELD INLET
- WATER METER
- FIRE HYDRANT
- SW**—**SW**— STORMWATER
- STORMWATER SWALE
- WATER PIPE
- TRUNK SEWER
- SEWER
- + 3.44** SURFACE LEVEL
- IL** INVERT LEVEL
- SL** SURFACE LEVEL
- DRIVEWAY / FOOTPATH
- KERB & CHANNEL
- ROOFWATER DRAINAGE PIPE
- ROOFWATER KERB ADAPTOR
- ROOFWATER KERB ADAPTOR WITH CONNECTION TO LOT

Scale 1:300 - Lengths are in Metres.

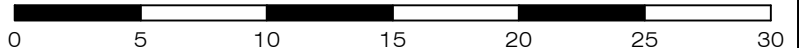

gassman
development
perspectives

planning | environment | landscape | engineering | survey
T: 3807 3333 | F: 3287 5461 | www.gassman.com.au
Gold Coast | 76 Business Street, Yatala QLD | PO Box 392, Beenleigh 4207

Client
Burleigh Heads Estate Pty Ltd

Project **SERVICE LOCATION SKETCH PLAN**

LOT 74 on SP329492

Stage 4, The Arbour Burleigh
Cowell Drive, Burleigh Heads

Real Property Description:
Lot 74 on SP329492

Locality	BURLEIGH HEADS	Issue Date	07/11/2023
Local Govt	GOLD COAST CITY COUNCIL	Meridian	SP329492
Scale (on A4 original)	1:300	Level Datum	AHD
Drawn	S. Holt	Date Drafted	30/10/2023
Checked	A. Geraghty	REFERENCE No.	5967- 4
PLAN No. 5967 S SK LOT 74			



903
SP316142

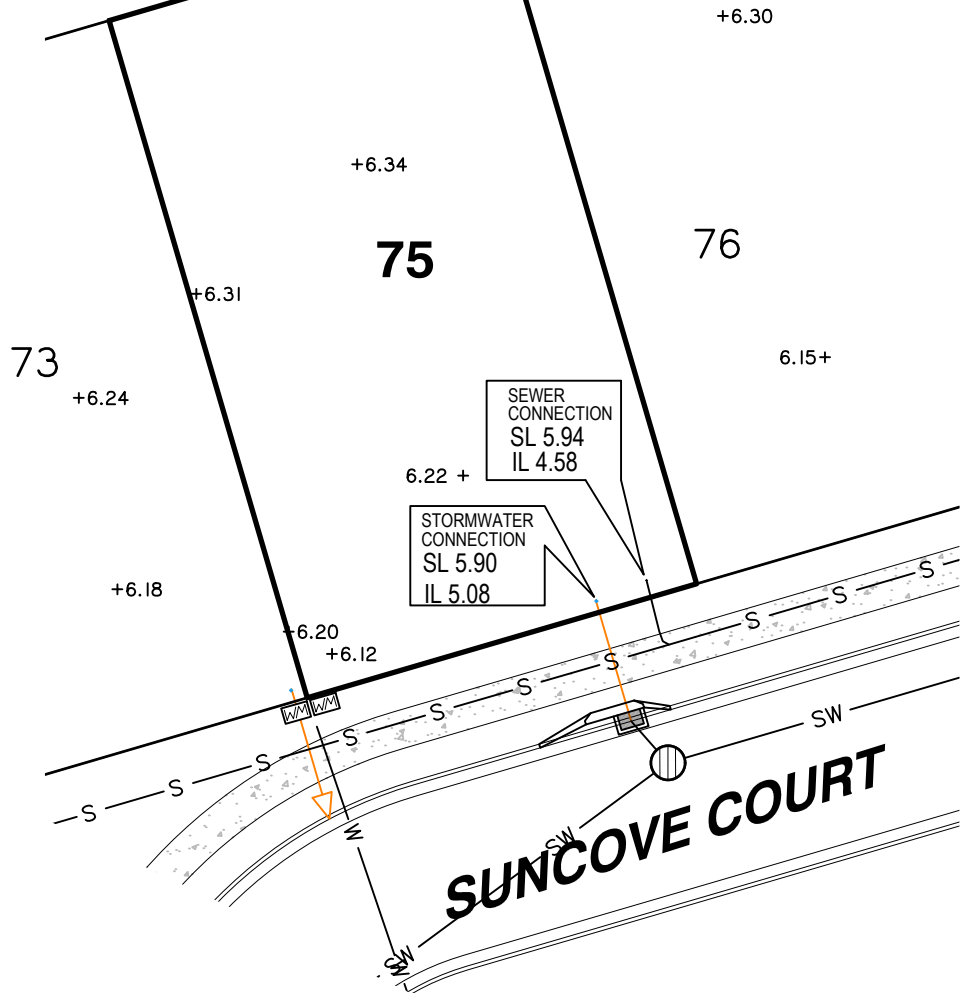

LEGEND

- ⊙ SEWER MANHOLE
- ⊕ STORMWATER MANHOLE/
MAINTENANCE SHAFT
- ⌒ GULLY TRAP
- ⊞ FIELD INLET
- ⊞ WATER METER
- ⊞ FIRE HYDRANT
- SW—SW— STORMWATER
- STORMWATER SWALE
- w— WATER PIPE
- T—SEW— TRUNK SEWER
- S—S— SEWER
- + 3.44 SURFACE LEVEL
- IL INVERT LEVEL
- SL SURFACE LEVEL
- ⊞ DRIVEWAY / FOOTPATH
- ==== KERB & CHANNEL
- ROOFWATER DRAINAGE PIPE
- ▽ ROOFWATER KERB ADAPTOR
- ▷ ROOFWATER KERB ADAPTOR
WITH CONNECTION TO LOT

Scale 1:300 - Lengths are in Metres.

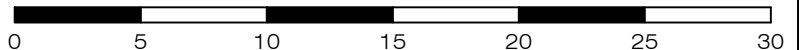

gassman
development
perspectives

planning | environment | landscape | engineering | survey
T: 3807 3333 | F: 3287 5461 | www.gassman.com.au
Gold Coast | 76 Business Street, Yatala QLD | PO Box 392, Beenleigh 4207

Client
Burleigh Heads Estate Pty Ltd

Project **SERVICE LOCATION SKETCH PLAN**

LOT 75 on SP329492

Stage 4, The Arbour Burleigh
Cowell Drive, Burleigh Heads

Locality	BURLEIGH HEADS	Issue Date	07/11/2023
Local Govt	GOLD COAST CITY COUNCIL	Meridian	SP329492
		Level Datum	AHD
Scale (on A4 original)	1:300	Drawn	S. Holt
		Date Drafted	30/10/2023
		Checked	A.Geraghty

Real Property Description:
Lot 75 on SP329492

REFERENCE No. **5967- 4**

PLAN No. **5967 S SK LOT 75**



903
SP316142

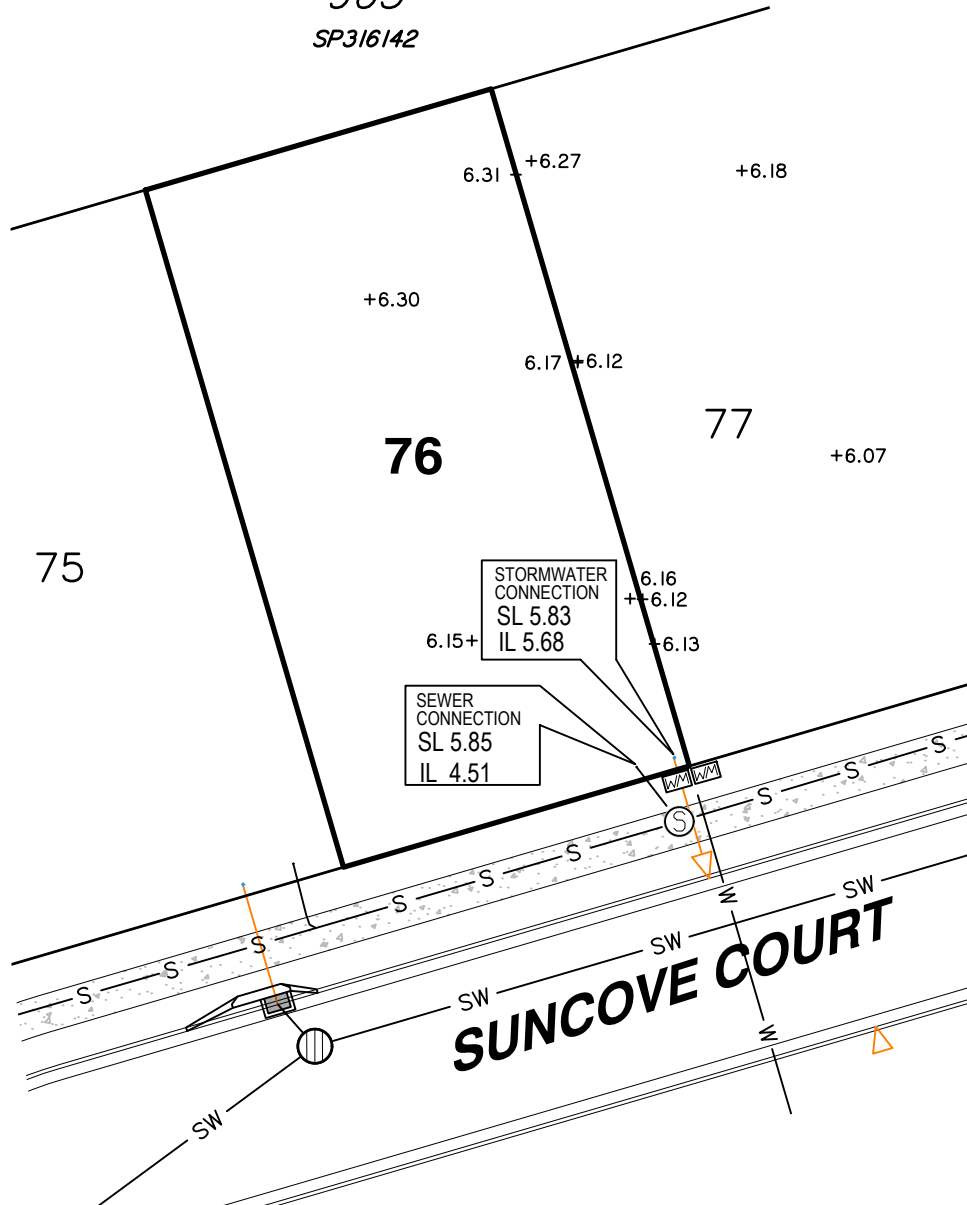

LEGEND

- SEWER MANHOLE
- STORMWATER MANHOLE/
MAINTENANCE SHAFT
- GULLY TRAP
- FIELD INLET
- WATER METER
- FIRE HYDRANT
- SW—SW— STORMWATER
- w— WATER PIPE
- T—SEW— TRUNK SEWER
- S—S— SEWER
- + 3.44 SURFACE LEVEL
- IL INVERT LEVEL
- SL SURFACE LEVEL
- DRIVEWAY / FOOTPATH
- KERB & CHANNEL
- ROOFWATER DRAINAGE PIPE
- ROOFWATER KERB ADAPTOR
- ROOFWATER KERB ADAPTOR
WITH CONNECTION TO LOT

Scale 1:300 - Lengths are in Metres.

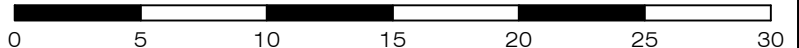

gassman
development
perspectives

planning | environment | landscape | engineering | survey
T: 3807 3333 | F: 3287 5461 | www.gassman.com.au
Gold Coast | 76 Business Street, Yatala QLD | PO Box 392, Beenleigh 4207

Client
Burleigh Heads Estate Pty Ltd

Project **SERVICE LOCATION SKETCH PLAN**

LOT 76 on SP329492

Stage 4, The Arbour Burleigh
Cowell Drive, Burleigh Heads

Locality **BURLEIGH HEADS**

Local Govt **GOLD COAST
CITY COUNCIL**

Issue Date 07/11/2023
Meridian SP329492
Level Datum AHD

Drawn S. Holt
Date Drafted 30/10/2023
Checked A.Geraghty

Scale (on A4 original)
1:300

Real Property Description:
Lot 76 on SP329492

REFERENCE No. **5967- 4**
PLAN No. **5967 S SK LOT 76**



903
SP316142

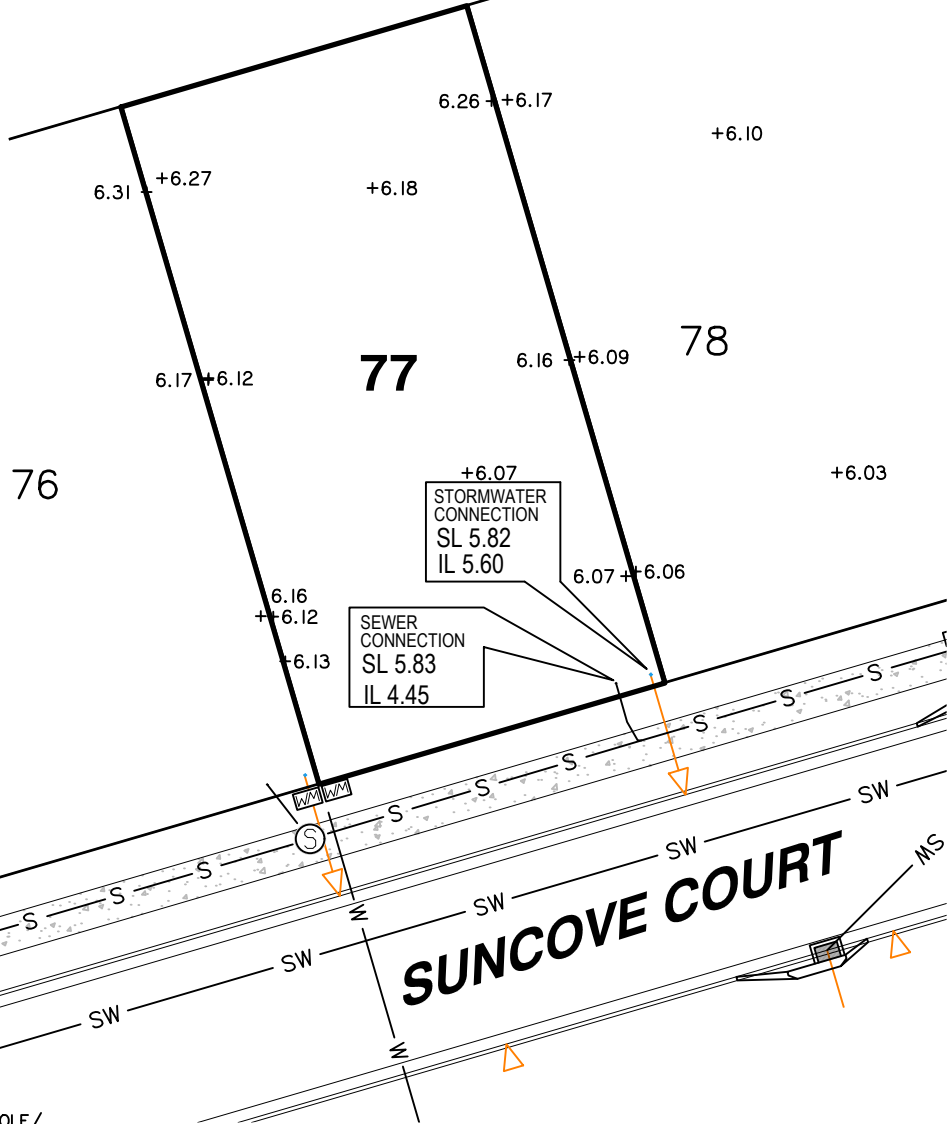

LEGEND

- SEWER MANHOLE
- STORMWATER MANHOLE/
MAINTENANCE SHAFT
- GULLY TRAP
- FIELD INLET
- WATER METER
- FIRE HYDRANT
- SW—SW— STORMWATER
- STORMWATER SWALE
- w— WATER PIPE
- T—SEW— TRUNK SEWER
- S—S— SEWER
- + 3.44 SURFACE LEVEL
- IL INVERT LEVEL
- SL SURFACE LEVEL
- DRIVEWAY / FOOTPATH
- KERB & CHANNEL
- ROOFWATER DRAINAGE PIPE
- ROOFWATER KERB ADAPTOR
- ROOFWATER KERB ADAPTOR
WITH CONNECTION TO LOT

Scale 1:300 - Lengths are in Metres.

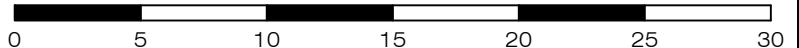

gassman
development
perspectives

planning | environment | landscape | engineering | survey
T: 3807 3333 | F: 3287 5461 | www.gassman.com.au
Gold Coast | 76 Business Street, Yatala QLD | PO Box 392, Beenleigh 4207

Client
Burleigh Heads Estate Pty Ltd

Project **SERVICE LOCATION SKETCH PLAN**

LOT 77 on SP329492

Stage 4, The Arbour Burleigh
Cowell Drive, Burleigh Heads

Locality	BURLEIGH HEADS	Issue Date	07/11/2023
Local Govt	GOLD COAST CITY COUNCIL	Meridian	SP329492
		Level Datum	AHD
Scale (on A4 original)	1:300	Drawn	S. Holt
		Date Drafted	30/10/2023
		Checked	A. Geraghty

Real Property Description:
Lot 77 on SP329492

REFERENCE No. **5967- 4**
PLAN No. **5967 S SK LOT 77**



903
SP316142

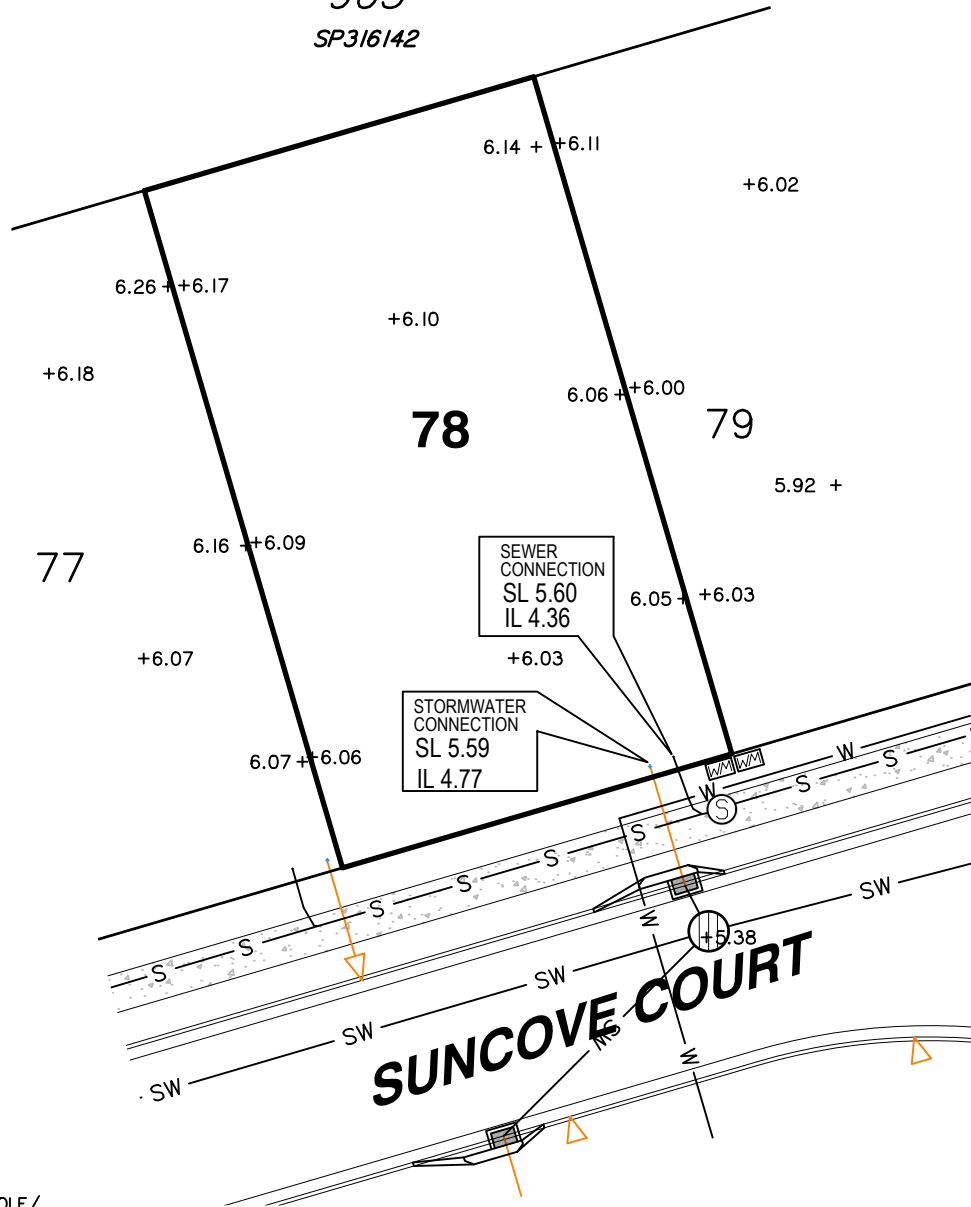

LEGEND

- SEWER MANHOLE
- STORMWATER MANHOLE/
MAINTENANCE SHAFT
- GULLY TRAP
- FIELD INLET
- WATER METER
- FIRE HYDRANT
- SW—SW— STORMWATER
- STORMWATER SWALE
- W— WATER PIPE
- T—SEW— TRUNK SEWER
- S—S— SEWER
- + 3.44 SURFACE LEVEL
- IL INVERT LEVEL
- SL SURFACE LEVEL
- DRIVEWAY / FOOTPATH
- KERB & CHANNEL
- ROOFWATER DRAINAGE PIPE
- ROOFWATER KERB ADAPTOR
- ROOFWATER KERB ADAPTOR
WITH CONNECTION TO LOT

Scale 1:300 - Lengths are in Metres.

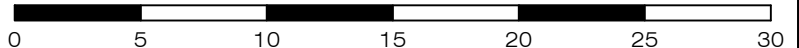

gassman
development
perspectives

planning | environment | landscape | engineering | survey
T: 3807 3333 | F: 3287 5461 | www.gassman.com.au
Gold Coast | 76 Business Street, Yatala QLD | PO Box 392, Beenleigh 4207

Client
Burleigh Heads Estate Pty Ltd

Project **SERVICE LOCATION SKETCH PLAN**

LOT 78 on SP329492

Stage 4, The Arbour Burleigh
Cowell Drive, Burleigh Heads

Locality	BURLEIGH HEADS	Issue Date	07/11/2023
Local Govt	GOLD COAST CITY COUNCIL	Meridian	SP329492
Scale (on A4 original)	1:300	Level Datum	AHD
		Drawn	S. Holt
		Date Drafted	30/10/2023
		Checked	A. Geraghty

Real Property Description:
Lot 78 on SP329492

REFERENCE No. 5967- 4
PLAN No. 5967 S SK LOT 78



903
SP316142

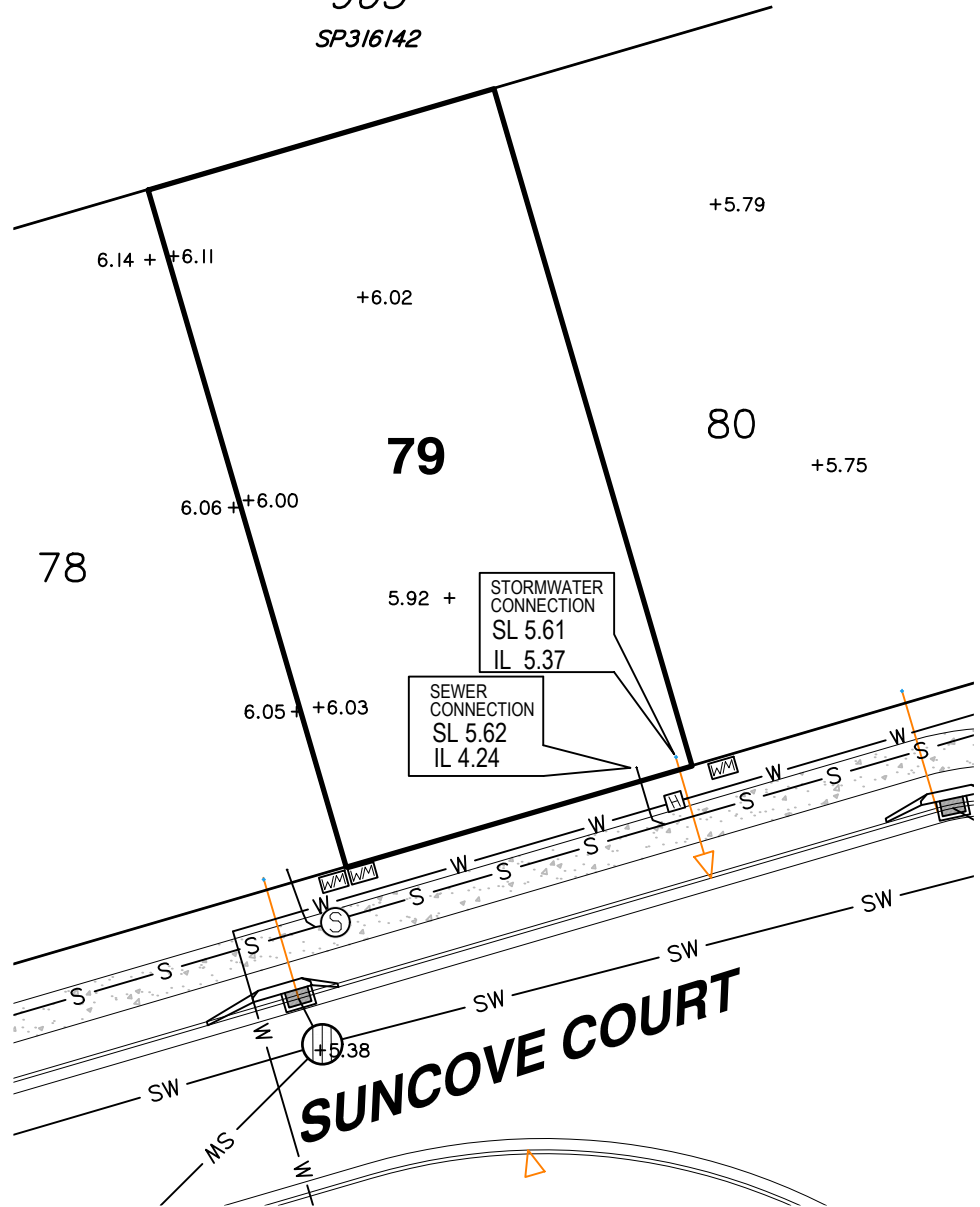

LEGEND

- SEWER MANHOLE
- STORMWATER MANHOLE/ MAINTENANCE SHAFT
- GULLY TRAP
- FIELD INLET
- WATER METER
- FIRE HYDRANT
- SW—SW— STORMWATER
- STORMWATER SWALE
- W— WATER PIPE
- T-SEW— TRUNK SEWER
- S—S— SEWER
- + 3.44 SURFACE LEVEL
- IL INVERT LEVEL
- SL SURFACE LEVEL
- DRIVEWAY / FOOTPATH
- KERB & CHANNEL
- ROOFWATER DRAINAGE PIPE
- ROOFWATER KERB ADAPTOR
- ROOFWATER KERB ADAPTOR WITH CONNECTION TO LOT

Scale 1:300 - Lengths are in Metres.

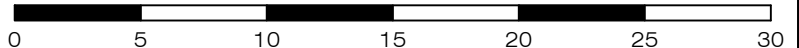

gassman
development
perspectives

planning | environment | landscape | engineering | survey
T: 3807 3333 | F: 3287 5461 | www.gassman.com.au
Gold Coast | 76 Business Street, Yatala QLD | PO Box 392, Beenleigh 4207

Client
Burleigh Heads Estate Pty Ltd

Project **SERVICE LOCATION SKETCH PLAN**

LOT 79 on SP329492

Stage 4, The Arbour Burleigh
Cowell Drive, Burleigh Heads

Locality	BURLEIGH HEADS	Issue Date	07/11/2023
Local Govt	GOLD COAST CITY COUNCIL	Meridian	SP329492
		Level Datum	AHD
Scale (on A4 original)	1:300	Drawn	S. Holt
		Date Drafted	30/10/2023
		Checked	A.Geraghty

Real Property Description:
Lot 79 on SP329492

REFERENCE No. 5967- 4
PLAN No. 5967 S SK LOT 79



903
SP316142

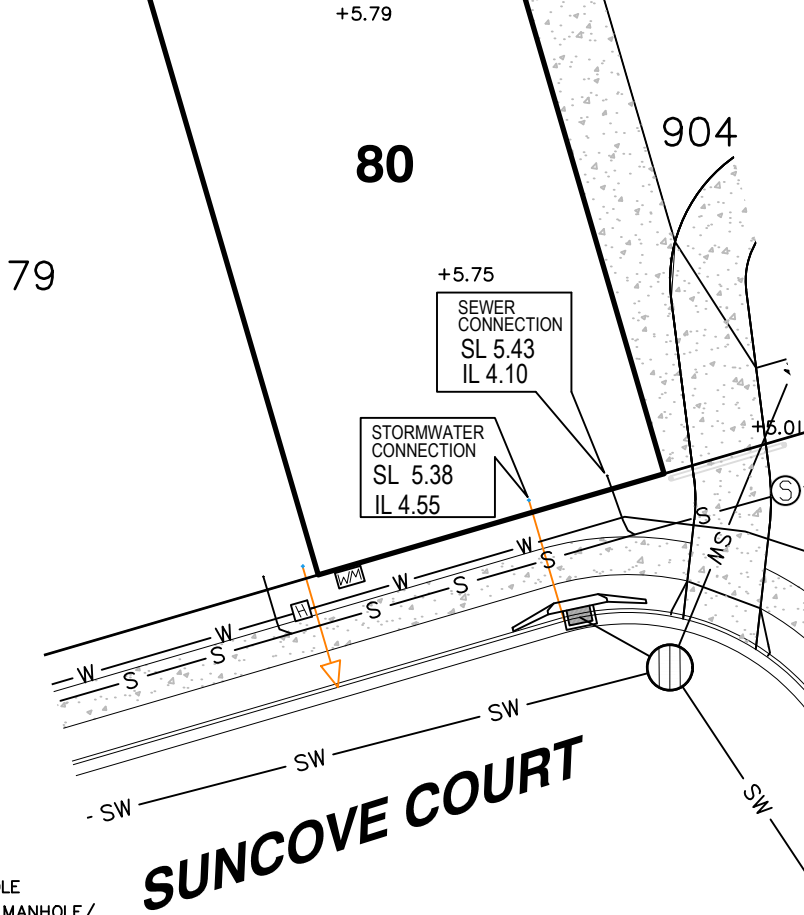

LEGEND

- SEWER MANHOLE
- STORMWATER MANHOLE/
MAINTENANCE SHAFT
- GULLY TRAP
- FIELD INLET
- WATER METER
- FIRE HYDRANT
- STORMWATER
STORMWATER SWALE
- WATER PIPE
- TRUNK SEWER
- SEWER
- + 3.44 SURFACE LEVEL
IL INVERT LEVEL
SL SURFACE LEVEL
- DRIVEWAY / FOOTPATH
- KERB & CHANNEL
- ROOFWATER DRAINAGE PIPE
- ROOFWATER KERB ADAPTOR
- ROOFWATER KERB ADAPTOR
WITH CONNECTION TO LOT

Scale 1:300 - Lengths are in Metres.

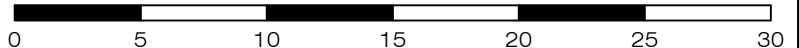

gassman
development
perspectives

planning | environment | landscape | engineering | survey
T: 3807 3333 | F: 3287 5461 | www.gassman.com.au
Gold Coast | 76 Business Street, Yatala QLD | PO Box 392, Beenleigh 4207

Client
Burleigh Heads Estate Pty Ltd

Project **SERVICE LOCATION SKETCH PLAN**

LOT 80 on SP329492

Stage 4, The Arbour Burleigh
Cowell Drive, Burleigh Heads

Locality	BURLEIGH HEADS	Issue Date	07/11/2023
Local Govt	GOLD COAST CITY COUNCIL	Meridian	SP329492
		Level Datum	AHD
Scale (on A4 original)	1:300	Drawn	S. Holt
		Date Drafted	30/10/2023
		Checked	A.Geraghty

Real Property Description:
Lot 80 on SP329492

REFERENCE No. 5967- 4
PLAN No. 5967 S SK LOT 80

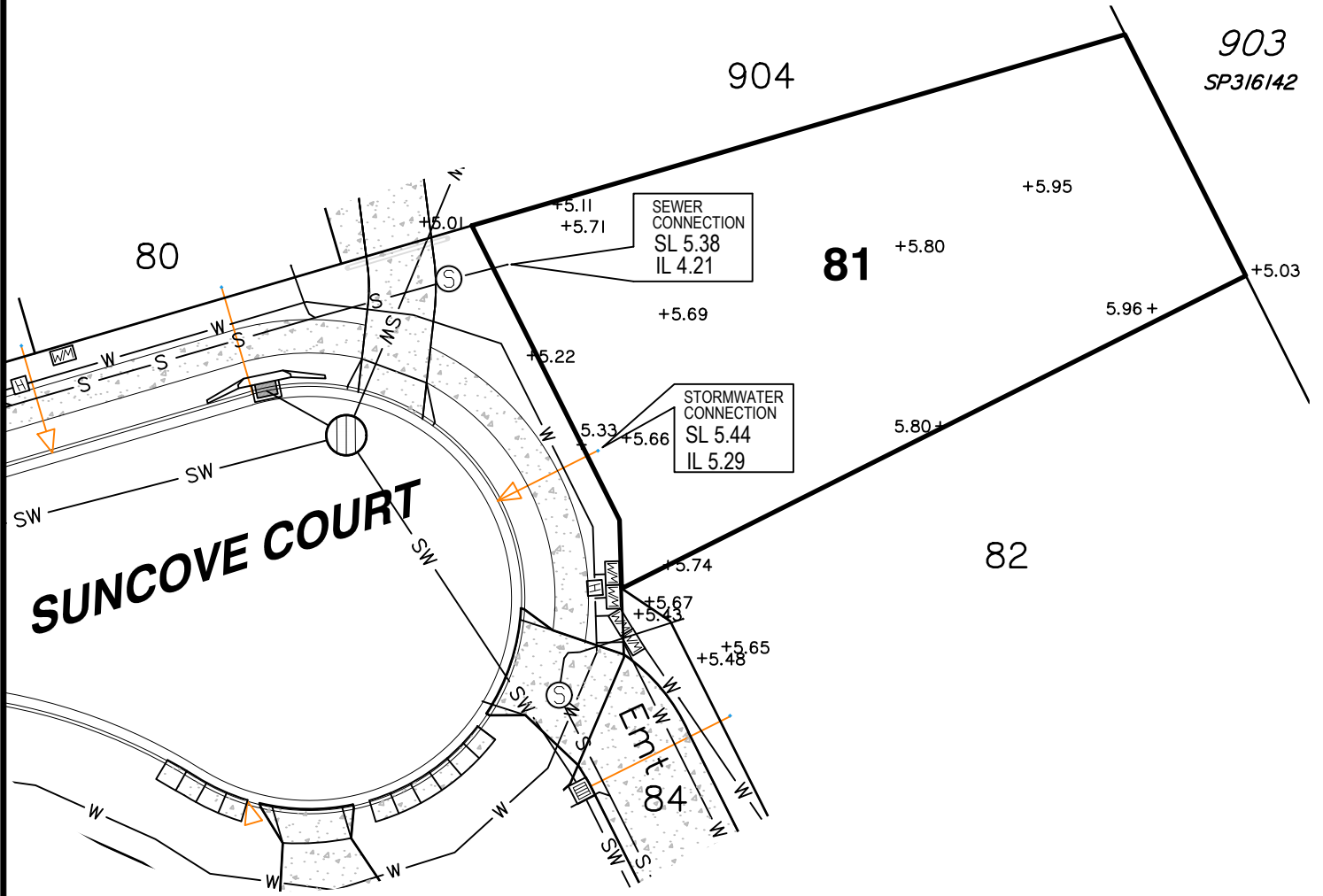

LEGEND

- ⊙ SEWER MANHOLE
- ⊕ STORMWATER MANHOLE/ MAINTENANCE SHAFT
- ⌂ GULLY TRAP
- ▭ FIELD INLET
- ⌂ WATER METER
- ⌂ FIRE HYDRANT
- SW—SW— STORMWATER
- STORMWATER SWALE
- W — WATER PIPE
- T-SEW — TRUNK SEWER
- S — SEWER
- + 3.44 SURFACE LEVEL
- IL INVERT LEVEL
- SL SURFACE LEVEL
- ▭ DRIVEWAY / FOOTPATH
- ▬▬▬ KERB & CHANNEL
- ROOFWATER DRAINAGE PIPE
- ▽ ROOFWATER KERB ADAPTOR
- ▷ ROOFWATER KERB ADAPTOR WITH CONNECTION TO LOT

Scale 1:300 - Lengths are in Metres.

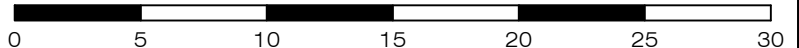

gassman
development
perspectives

planning | environment | landscape | engineering | survey
T: 3807 3333 | F: 3287 5461 | www.gassman.com.au
Gold Coast | 76 Business Street, Yatala QLD | PO Box 392, Beenleigh 4207

Client
Burleigh Heads Estate Pty Ltd

Project **SERVICE LOCATION SKETCH PLAN**

LOT 81 on SP329492

Stage 4, The Arbour Burleigh
Cowell Drive, Burleigh Heads

Locality BURLEIGH HEADS

Local Govt GOLD COAST CITY COUNCIL

Scale (on A4 original)
1:300

Issue Date 07/11/2023

Meridian SP329492

Level Datum AHD

Drawn S. Holt

Date Drafted 30/10/2023

Checked A.Geraghty

Real Property Description:
Lot 81 on SP329492

REFERENCE No. **5967- 4**

PLAN No. **5967 S SK LOT 81**

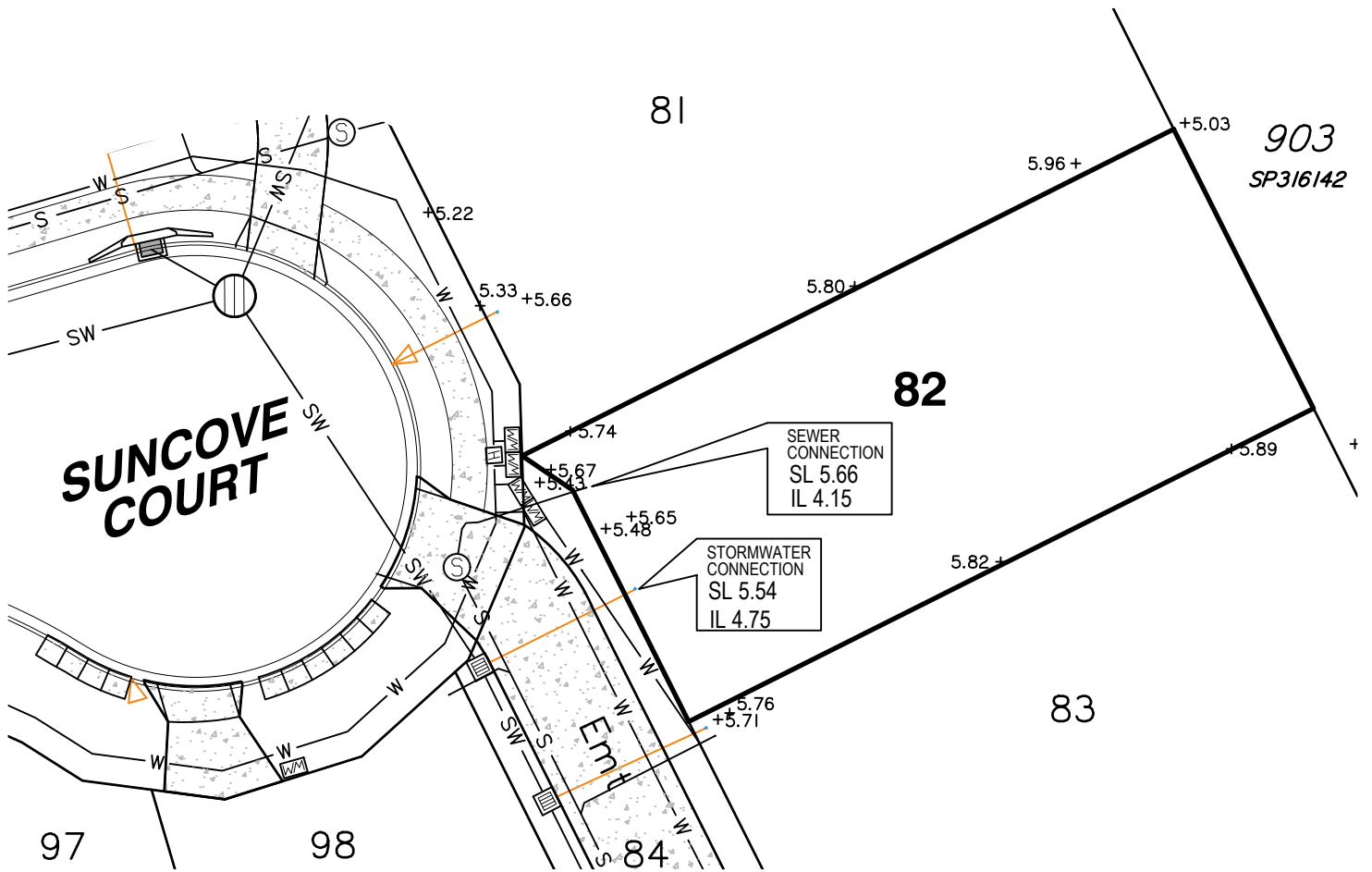

LEGEND

- SEWER MANHOLE
- STORMWATER MANHOLE/
MAINTENANCE SHAFT
- GULLY TRAP
- FIELD INLET
- WATER METER
- FIRE HYDRANT
- SW**—**SW**— STORMWATER
- STORMWATER SWALE
- WATER PIPE
- TRUNK SEWER
- SEWER
- + 3.44** SURFACE LEVEL
- IL** INVERT LEVEL
- SL** SURFACE LEVEL
- DRIVEWAY / FOOTPATH
- KERB & CHANNEL
- ROOFWATER DRAINAGE PIPE
- ROOFWATER KERB ADAPTOR
- ROOFWATER KERB ADAPTOR
WITH CONNECTION TO LOT

Scale 1:300 - Lengths are in Metres.

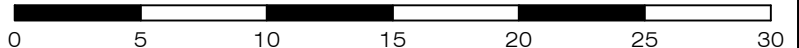

gassman
development
perspectives

planning | environment | landscape | engineering | survey
T: 3807 3333 | F: 3287 5461 | www.gassman.com.au
Gold Coast | 76 Business Street, Yatala QLD | PO Box 392, Beenleigh 4207

Client
Burleigh Heads Estate Pty Ltd

Project **SERVICE LOCATION SKETCH PLAN**

LOT 82 on SP329492

Stage 4, The Arbour Burleigh
Cowell Drive, Burleigh Heads

Real Property Description:
Lot 82 on SP329492

Locality **BURLEIGH HEADS**

Local Govt **GOLD COAST
CITY COUNCIL**

Scale (on A4 original)
1:300

Issue Date 06/09/2023
Meridian SP329492
Level Datum AHD

Drawn S. Holt
Date Drafted 30/10/2023
Checked A. Geraghty

REFERENCE No. **5967- 4**

PLAN No. **5967 S SK LOT 82**

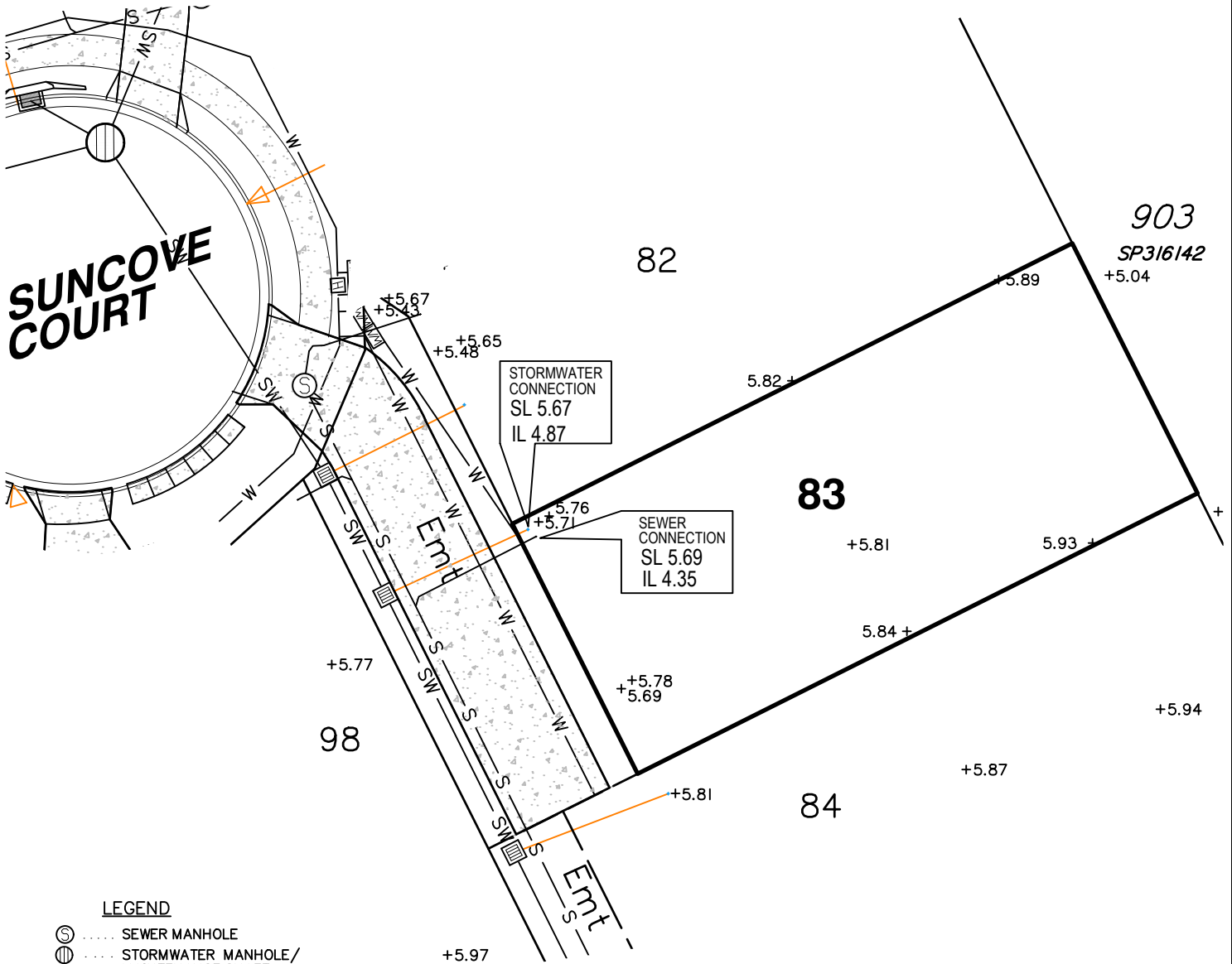

LEGEND

- SEWER MANHOLE
- STORMWATER MANHOLE/ MAINTENANCE SHAFT
- GULLY TRAP
- FIELD INLET
- WATER METER
- FIRE HYDRANT
- SW**—**SW**— STORMWATER
- STORMWATER SWALE
- w**—**w**— WATER PIPE
- T-SEW**—**S**— TRUNK SEWER
- S**—**S**— SEWER
- + 3.44** SURFACE LEVEL
- IL** INVERT LEVEL
- SL** SURFACE LEVEL
- DRIVEWAY / FOOTPATH
- KERB & CHANNEL
- ROOFWATER DRAINAGE PIPE
- ROOFWATER KERB ADAPTOR
- ROOFWATER KERB ADAPTOR WITH CONNECTION TO LOT

Scale 1:300 - Lengths are in Metres.

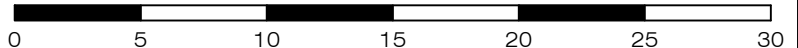

gassman
development
perspectives

est 1985
planning | environment | landscape | engineering | survey
T: 3807 3333 | F: 3287 5461 | www.gassman.com.au
Gold Coast | 76 Business Street, Yatala QLD | PO Box 392, Beenleigh 4207

Client
Burleigh Heads Estate Pty Ltd

Project **SERVICE LOCATION SKETCH PLAN**

LOT 83 on SP329492

Stage 4, The Arbour Burleigh
Cowell Drive, Burleigh Heads

Locality	BURLEIGH HEADS	Issue Date	02/10/2023
Local Govt	GOLD COAST CITY COUNCIL	Meridian	SP329492
		Level Datum	AHD
Scale (on A4 original)	1:300	Drawn	S. Holt
		Date Drafted	30/10/2023
		Checked	A.Geraghty

Real Property Description:
Lot 83 on SP329492

REFERENCE No. 5967- 4
PLAN No. 5967 S SK LOT 83

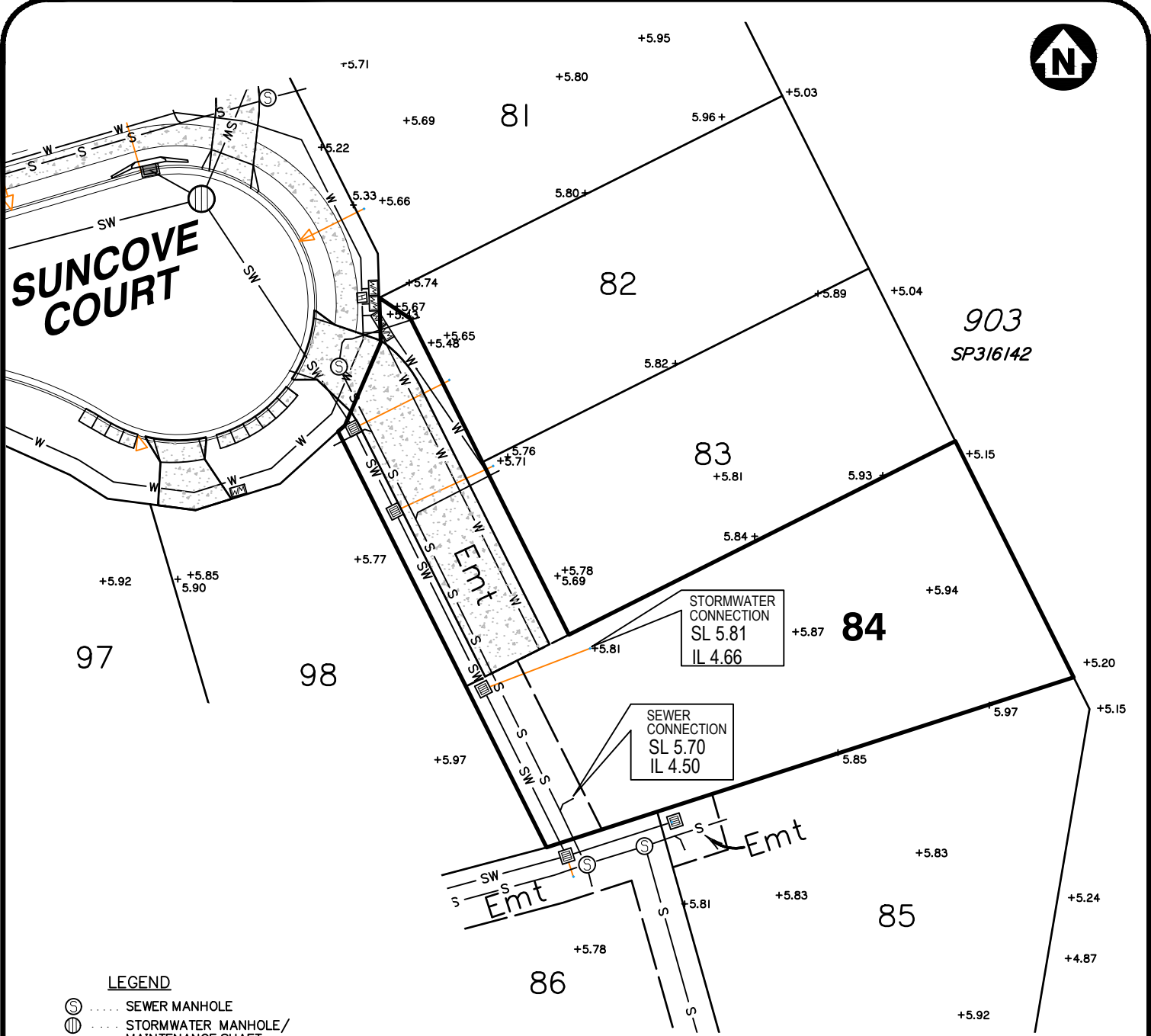

LEGEND

- ⊙ SEWER MANHOLE
- ⊕ STORMWATER MANHOLE/ MAINTENANCE SHAFT
- ⌒ GULLY TRAP
- ⊠ FIELD INLET
- ⊞ WATER METER
- ⊞ FIRE HYDRANT
- SW-SW STORMWATER
- STORMWATER SWALE
- W- WATER PIPE
- T-SEW- TRUNK SEWER
- S-S- SEWER
- + 3.44 SURFACE LEVEL
- IL INVERT LEVEL
- SL SURFACE LEVEL
- ▭ DRIVEWAY / FOOTPATH
- ▬▬▬ KERB & CHANNEL
- ROOFWATER DRAINAGE PIPE
- ▽ ROOFWATER KERB ADAPTOR
- ▷ ROOFWATER KERB ADAPTOR WITH CONNECTION TO LOT

Scale 1:400 - Lengths are in Metres.

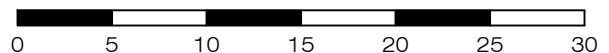

**gassman
development
perspectives**

planning | environment | landscape | engineering | survey
 T: 3807 3333 | F: 3287 5461 | www.gassman.com.au
 Gold Coast | 76 Business Street, Yatala QLD | PO Box 392, Beenleigh 4207

Client
 Burleigh Heads Estate Pty Ltd

Project **SERVICE LOCATION SKETCH PLAN**

LOT 84 on SP329492

**Stage 4, The Arbour Burleigh
 Cowell Drive, Burleigh Heads**

Real Property Description:
 Lot 84 on SP329492

Locality	BURLEIGH HEADS	Issue Date	07/11/2023
Local Govt	GOLD COAST CITY COUNCIL	Meridian	SP329492
		Level Datum	AHD
Scale (on A4 original)	1:400	Drawn	S. Holt
		Date Drafted	30/10/2023
		Checked	A. Geraghty
REFERENCE No. 5967- 4			
PLAN No. 5967 S SK LOT 84			

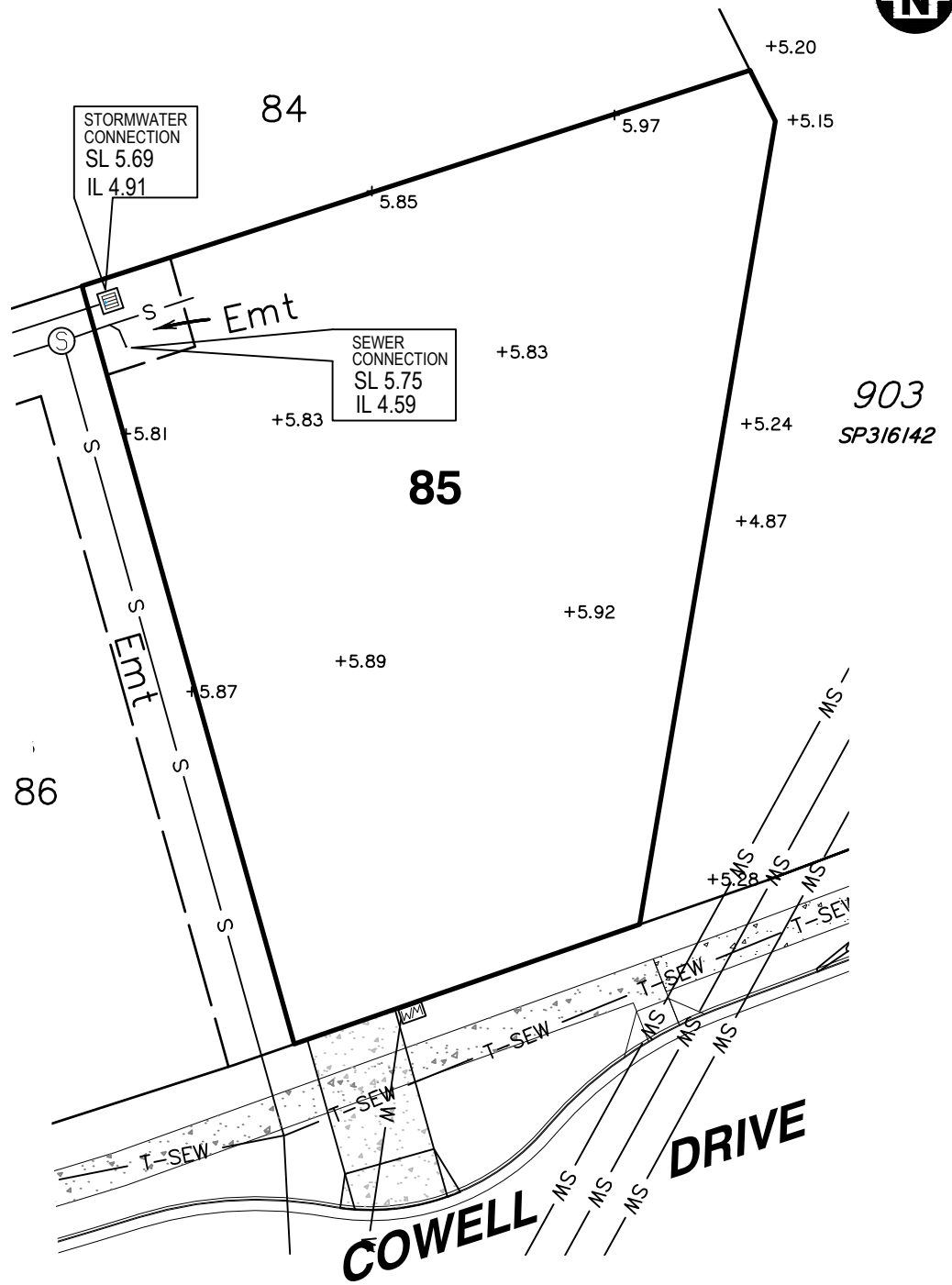

LEGEND

- SEWER MANHOLE
- STORMWATER MANHOLE/ MAINTENANCE SHAFT
- GULLY TRAP
- FIELD INLET
- WATER METER
- FIRE HYDRANT
- SW** — **SW** — STORMWATER
- STORMWATER SWALE
- W** — **W** — WATER PIPE
- T-SEW** — **T-SEW** — TRUNK SEWER
- S** — **S** — SEWER
- + 3.44** SURFACE LEVEL
- IL** INVERT LEVEL
- SL** SURFACE LEVEL
- DRIVEWAY / FOOTPATH
- KERB & CHANNEL
- ROOFWATER DRAINAGE PIPE
- ROOFWATER KERB ADAPTOR
- ROOFWATER KERB ADAPTOR WITH CONNECTION TO LOT

Scale 1:300 - Lengths are in Metres.

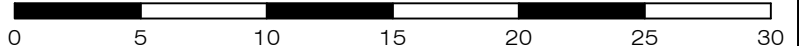

gassman
development
perspectives

planning | environment | landscape | engineering | survey
T: 3807 3333 | F: 3287 5461 | www.gassman.com.au
Gold Coast | 76 Business Street, Yatala QLD | PO Box 392, Beenleigh 4207

Client
Burleigh Heads Estate Pty Ltd

Project **SERVICE LOCATION SKETCH PLAN**

LOT 85 on SP329492

Stage 4, The Arbour Burleigh
Cowell Drive, Burleigh Heads

Locality	BURLEIGH HEADS	Issue Date	07/11/2023
Local Govt	GOLD COAST CITY COUNCIL	Meridian	SP329492
		Level Datum	AHD
Scale (on A4 original)	1:300	Drawn	S. Holt
		Date Drafted	30/10/2023
		Checked	A.Geraghty

Real Property Description:
Lot 85 on SP329492

REFERENCE No. 5967- 4
PLAN No. 5967 S SK LOT 85

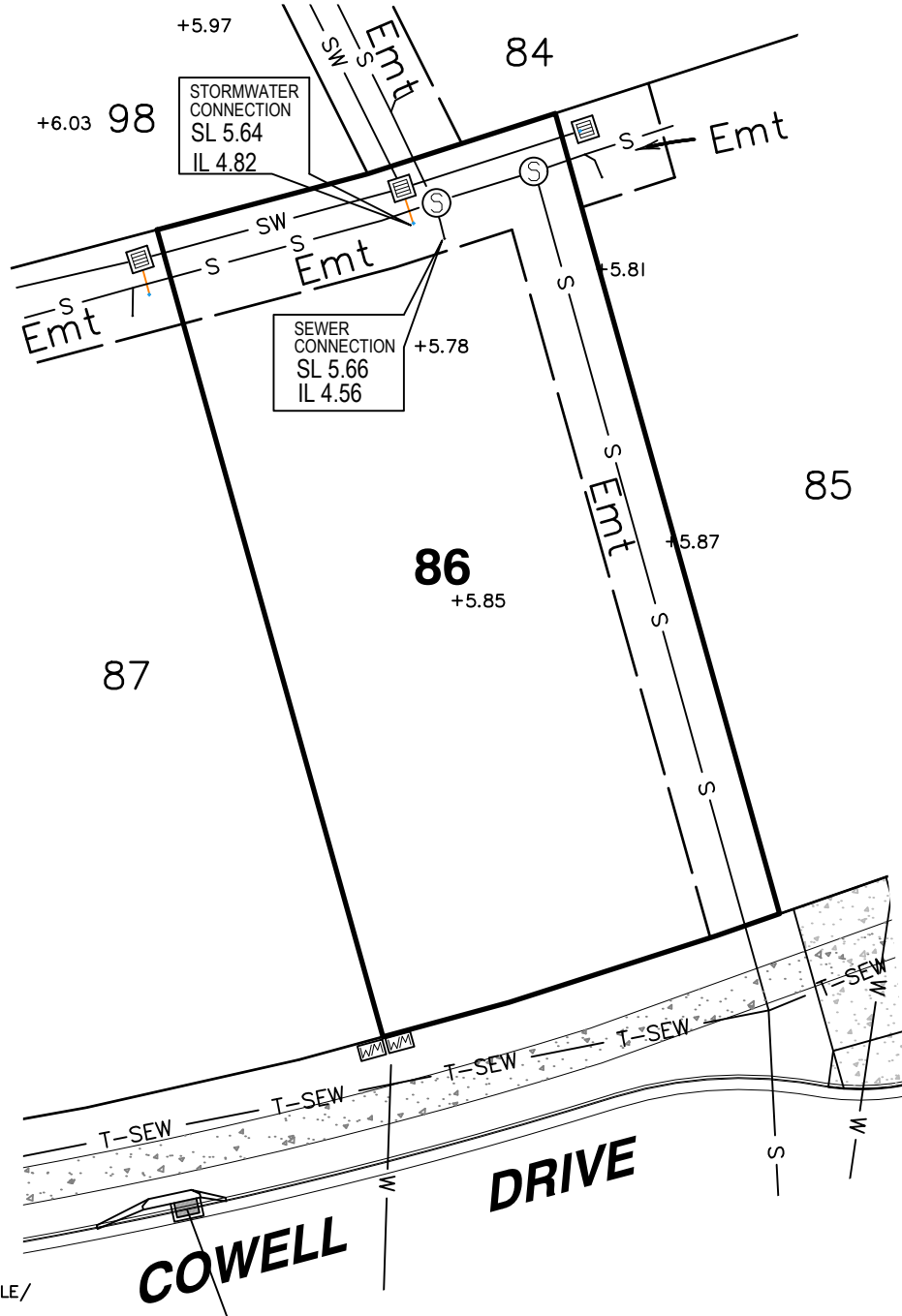

LEGEND

- SEWER MANHOLE
- STORMWATER MANHOLE/ MAINTENANCE SHAFT
- GULLY TRAP
- FIELD INLET
- WATER METER
- FIRE HYDRANT
- SW** — **SW** — STORMWATER
- STORMWATER SWALE
- W** — **W** — WATER PIPE
- T-SEW** — **T-SEW** — TRUNK SEWER
- S** — **S** — SEWER
- + 3.44** SURFACE LEVEL
- IL** INVERT LEVEL
- SL** SURFACE LEVEL
- DRIVEWAY / FOOTPATH
- KERB & CHANNEL
- ROOFWATER DRAINAGE PIPE
- ROOFWATER KERB ADAPTOR
- ROOFWATER KERB ADAPTOR WITH CONNECTION TO LOT

Scale 1:300 - Lengths are in Metres.

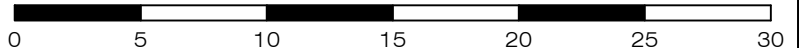

gassman
development
perspectives

planning | environment | landscape | engineering | survey
T: 3807 3333 | F: 3287 5461 | www.gassman.com.au
Gold Coast | 76 Business Street, Yatala QLD | PO Box 392, Beenleigh 4207

Client
Burleigh Heads Estate Pty Ltd

Project **SERVICE LOCATION SKETCH PLAN**

LOT 86 on SP329492

Stage 4, The Arbour Burleigh
Cowell Drive, Burleigh Heads

Locality	BURLEIGH HEADS	Issue Date	07/11/2023
Local Govt	GOLD COAST CITY COUNCIL	Meridian	SP329492
		Level Datum	AHD
Scale (on A4 original)	1:300	Drawn	S. Holt
		Date Drafted	30/10/2023
		Checked	A.Geraghty

Real Property Description:
Lot 86 on SP329492

REFERENCE No. 5967- 4
PLAN No. 5967 S SK LOT 86

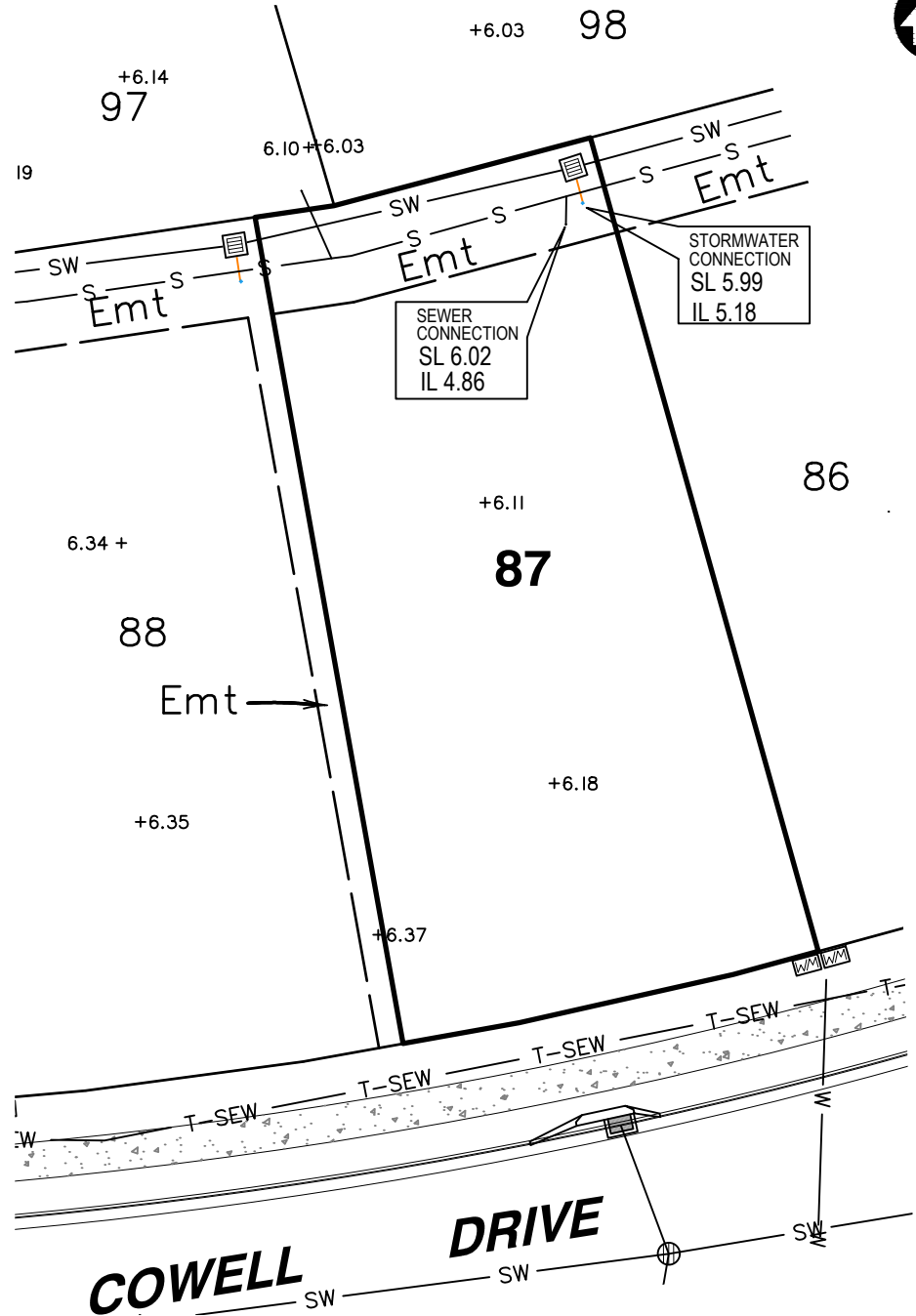

LEGEND

- SEWER MANHOLE
- STORMWATER MANHOLE/ MAINTENANCE SHAFT
- GULLY TRAP
- FIELD INLET
- WATER METER
- FIRE HYDRANT
- SW—SW— STORMWATER
- STORMWATER SWALE
- W — WATER PIPE
- T-SEW — TRUNK SEWER
- S — SEWER
- + 3.44 SURFACE LEVEL
- IL INVERT LEVEL
- SL SURFACE LEVEL
- DRIVEWAY / FOOTPATH
- KERB & CHANNEL
- ROOFWATER DRAINAGE PIPE
- ROOFWATER KERB ADAPTOR
- ROOFWATER KERB ADAPTOR WITH CONNECTION TO LOT

Scale 1:300 - Lengths are in Metres.

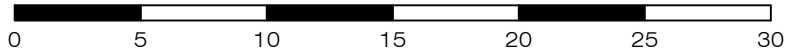

gassman
development
perspectives

planning | environment | landscape | engineering | survey
T: 3807 3333 | F: 3287 5461 | www.gassman.com.au
Gold Coast | 76 Business Street, Yatala QLD | PO Box 392, Beenleigh 4207

Client
Burleigh Heads Estate Pty Ltd

Project **SERVICE LOCATION SKETCH PLAN**

LOT 87 on SP329492

Stage 4, The Arbour Burleigh
Cowell Drive, Burleigh Heads

Locality	BURLEIGH HEADS	Issue Date	07/11/2023
Local Govt	GOLD COAST CITY COUNCIL	Meridian	SP329492
		Level Datum	AHD
Scale (on A4 original)	1:300	Drawn	S. Holt
		Date Drafted	30/10/2023
		Checked	A. Geraghty

Real Property Description:
Lot 87 on SP329492

REFERENCE No. 5967- 4
PLAN No. 5967 S SK LOT 87

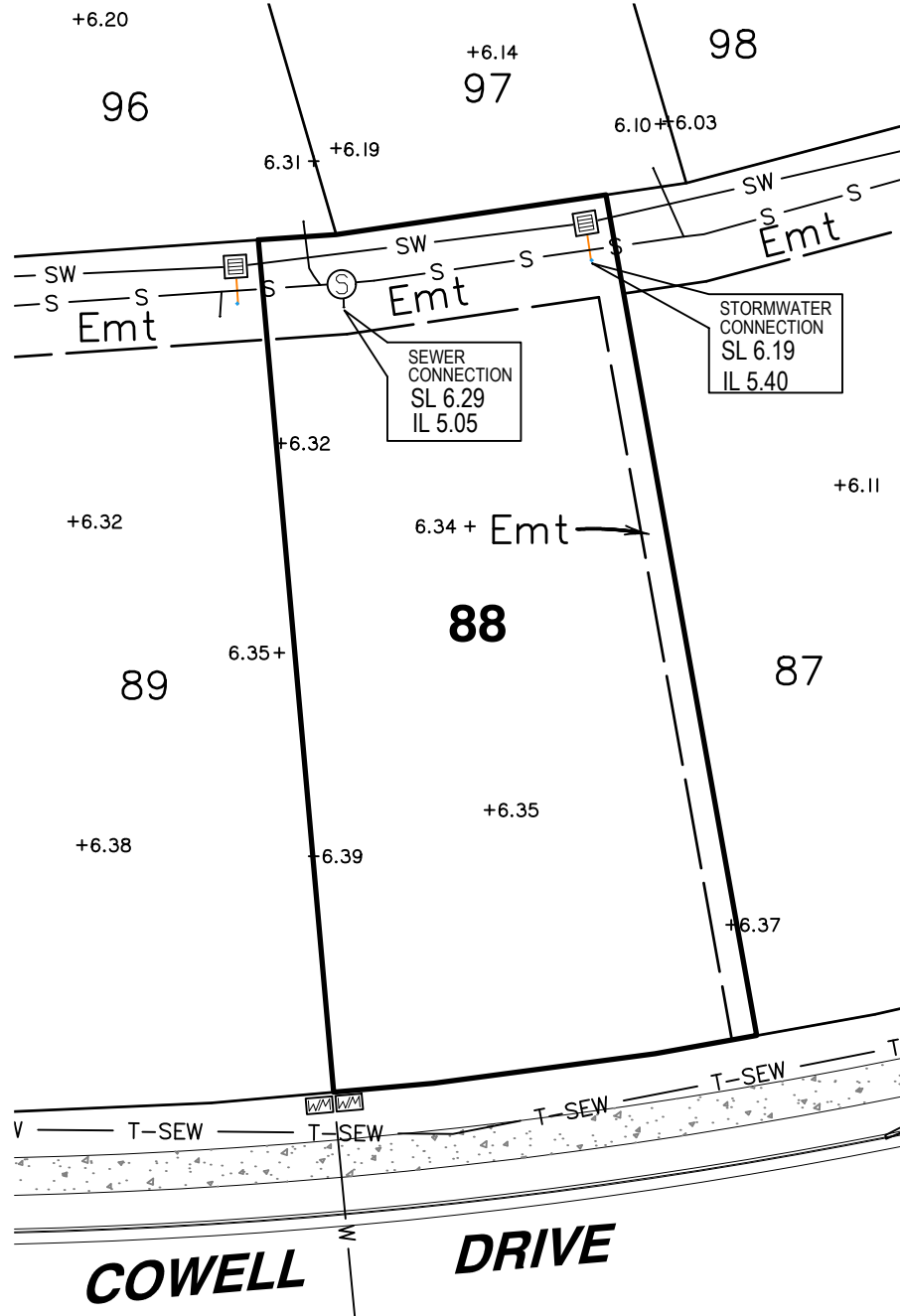

LEGEND

- SEWER MANHOLE
- STORMWATER MANHOLE/ MAINTENANCE SHAFT
- GULLY TRAP
- FIELD INLET
- WATER METER
- FIRE HYDRANT
- STORMWATER
- STORMWATER SWALE
- WATER PIPE
- TRUNK SEWER
- SEWER
- + 3.44 SURFACE LEVEL
- IL INVERT LEVEL
- SL SURFACE LEVEL
- DRIVEWAY / FOOTPATH
- KERB & CHANNEL
- ROOFWATER DRAINAGE PIPE
- ROOFWATER KERB ADAPTOR
- ROOFWATER KERB ADAPTOR WITH CONNECTION TO LOT

Scale 1:300 - Lengths are in Metres.

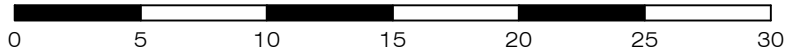

gassman
development
perspectives

planning | environment | landscape | engineering | survey
T: 3807 3333 | F: 3287 5461 | www.gassman.com.au
Gold Coast | 76 Business Street, Yatala QLD | PO Box 392, Beenleigh 4207

Client
Burleigh Heads Estate Pty Ltd

Project **SERVICE LOCATION SKETCH PLAN**

LOT 88 on SP329492

Stage 4, The Arbour Burleigh
Cowell Drive, Burleigh Heads

Locality	BURLEIGH HEADS	Issue Date	07/11/2023
Local Govt	GOLD COAST CITY COUNCIL	Meridian	SP329492
Scale (on A4 original)	1:300	Level Datum	AHD
		Drawn	S. Holt
		Date Drafted	30/10/2023
		Checked	A. Geraghty

Real Property Description:
Lot 88 on SP329492

REFERENCE No. 5967- 4
PLAN No. 5967 S SK LOT 88

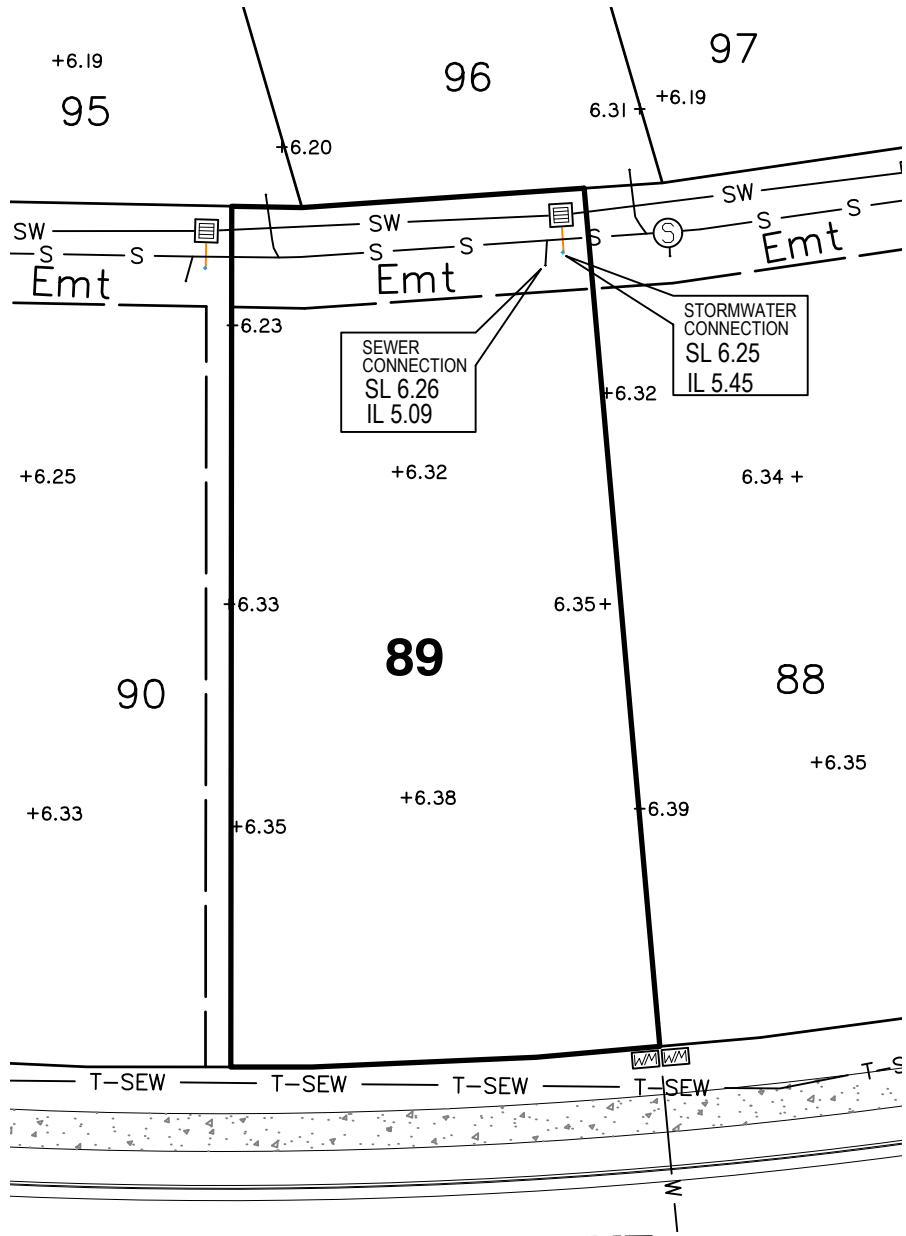

COWELL DRIVE

LEGEND

- SEWER MANHOLE
- STORMWATER MANHOLE/ MAINTENANCE SHAFT
- GULLY TRAP
- FIELD INLET
- WATER METER
- FIRE HYDRANT
- STORMWATER SWALE
- STORMWATER SWALE
- WATER PIPE
- TRUNK SEWER
- SEWER
- + 3.44 SURFACE LEVEL
- IL INVERT LEVEL
- SL SURFACE LEVEL
- DRIVEWAY / FOOTPATH
- KERB & CHANNEL
- ROOFWATER DRAINAGE PIPE
- ROOFWATER KERB ADAPTOR
- ROOFWATER KERB ADAPTOR WITH CONNECTION TO LOT

Scale 1:300 - Lengths are in Metres.

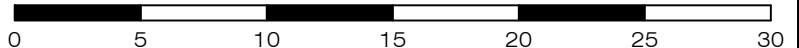

gassman
development
perspectives

planning | environment | landscape | engineering | survey
T: 3807 3333 | F: 3287 5461 | www.gassman.com.au
Gold Coast | 76 Business Street, Yatala QLD | PO Box 392, Beenleigh 4207

Client
Burleigh Heads Estate Pty Ltd

Project **SERVICE LOCATION SKETCH PLAN**

LOT 89 on SP329492

Stage 4, The Arbour Burleigh
Cowell Drive, Burleigh Heads







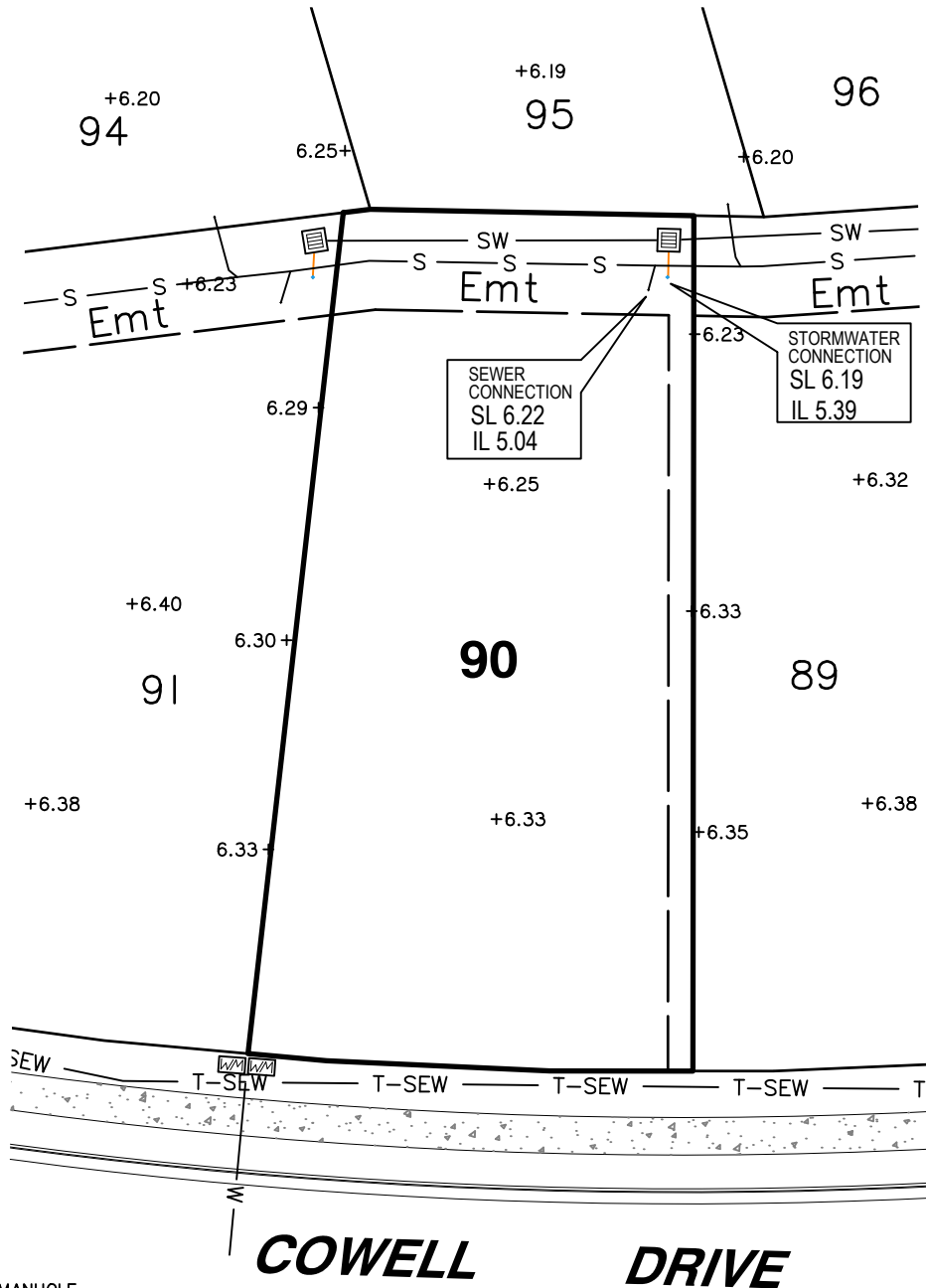



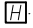
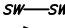
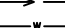
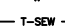
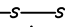
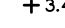

Locality	BURLEIGH HEADS	Issue Date	07/11/2023
Local Govt	GOLD COAST CITY COUNCIL	Meridian	SP329492
		Level Datum	AHD
Scale (on A4 original)	1:300	Drawn	S. Holt
		Date Drafted	30/10/2023
		Checked	A. Geraghty

Real Property Description:
Lot 89 on SP329492

REFERENCE No. 5967- 4
PLAN No. 5967 S SK LOT 89



LEGEND

-  SEWER MANHOLE
-  STORMWATER MANHOLE/ MAINTENANCE SHAFT
-  GULLY TRAP
-  FIELD INLET
-  WATER METER
-  FIRE HYDRANT
-  STORMWATER SWALE
-  STORMWATER SWALE
-  WATER PIPE
-  TRUNK SEWER
-  SEWER
-  + 3.44 SURFACE LEVEL
-  IL INVERT LEVEL
-  SL SURFACE LEVEL
-  DRIVEWAY / FOOTPATH
-  KERB & CHANNEL
-  ROOFWATER DRAINAGE PIPE
-  ROOFWATER KERB ADAPTOR
-  ROOFWATER KERB ADAPTOR WITH CONNECTION TO LOT

Scale 1:300 - Lengths are in Metres.

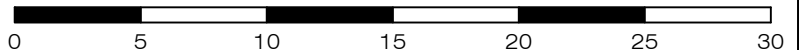

gassman
development
perspectives

planning | environment | landscape | engineering | survey
T: 3807 3333 | F: 3287 5461 | www.gassman.com.au
Gold Coast | 76 Business Street, Yatala QLD | PO Box 392, Beenleigh 4207

Client
Burleigh Heads Estate Pty Ltd

Project **SERVICE LOCATION SKETCH PLAN**

LOT 90 on SP329492

Stage 4, The Arbour Burleigh
Cowell Drive, Burleigh Heads

Real Property Description:
Lot 90 on SP329492

Locality	BURLEIGH HEADS	Issue Date	07/11/2023
Local Govt	GOLD COAST CITY COUNCIL	Meridian	SP329492
		Level Datum	AHD
Scale (on A4 original)	1:300	Drawn	S. Holt
		Date Drafted	30/10/2023
		Checked	A. Geraghty

REFERENCE No. 5967- 4
PLAN No. 5967 S SK LOT 90

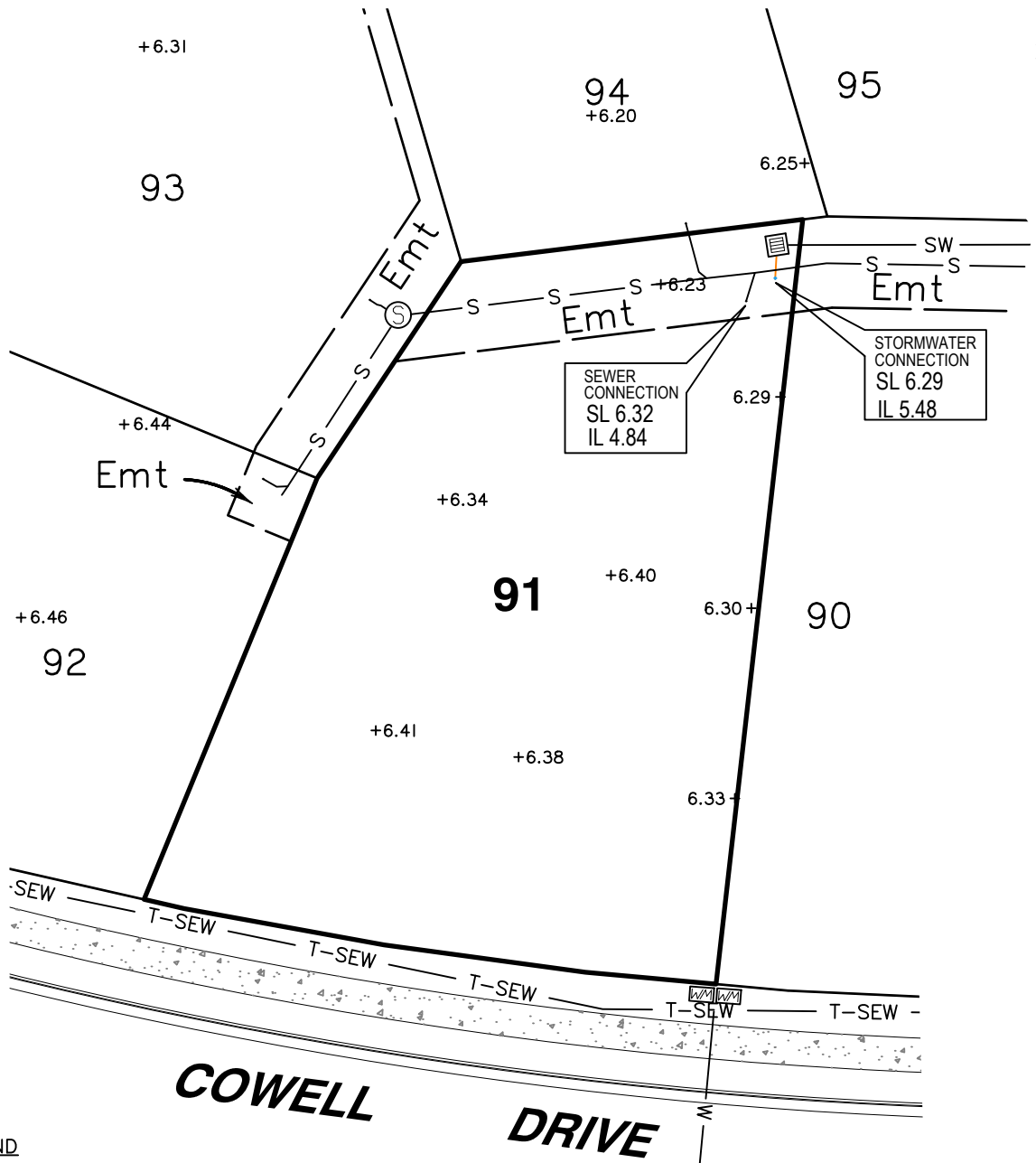

LEGEND

- SEWER MANHOLE
- STORMWATER MANHOLE/ MAINTENANCE SHAFT
- GULLY TRAP
- FIELD INLET
- WATER METER
- FIRE HYDRANT
- STORMWATER SWALE
- STORMWATER SWALE
- WATER PIPE
- TRUNK SEWER
- SEWER
- + 3.44 SURFACE LEVEL
- IL INVERT LEVEL
- SL SURFACE LEVEL
- DRIVEWAY / FOOTPATH
- KERB & CHANNEL
- ROOFWATER DRAINAGE PIPE
- ROOFWATER KERB ADAPTOR
- ROOFWATER KERB ADAPTOR WITH CONNECTION TO LOT

Scale 1:300 - Lengths are in Metres.

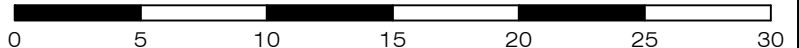

gassman
development
perspectives

planning | environment | landscape | engineering | survey
T: 3807 3333 | F: 3287 5461 | www.gassman.com.au
Gold Coast | 76 Business Street, Yatala QLD | PO Box 392, Beenleigh 4207

Client
Burleigh Heads Estate Pty Ltd

Project **SERVICE LOCATION SKETCH PLAN**

LOT 91 on SP329492

Stage 4, The Arbour Burleigh
Cowell Drive, Burleigh Heads







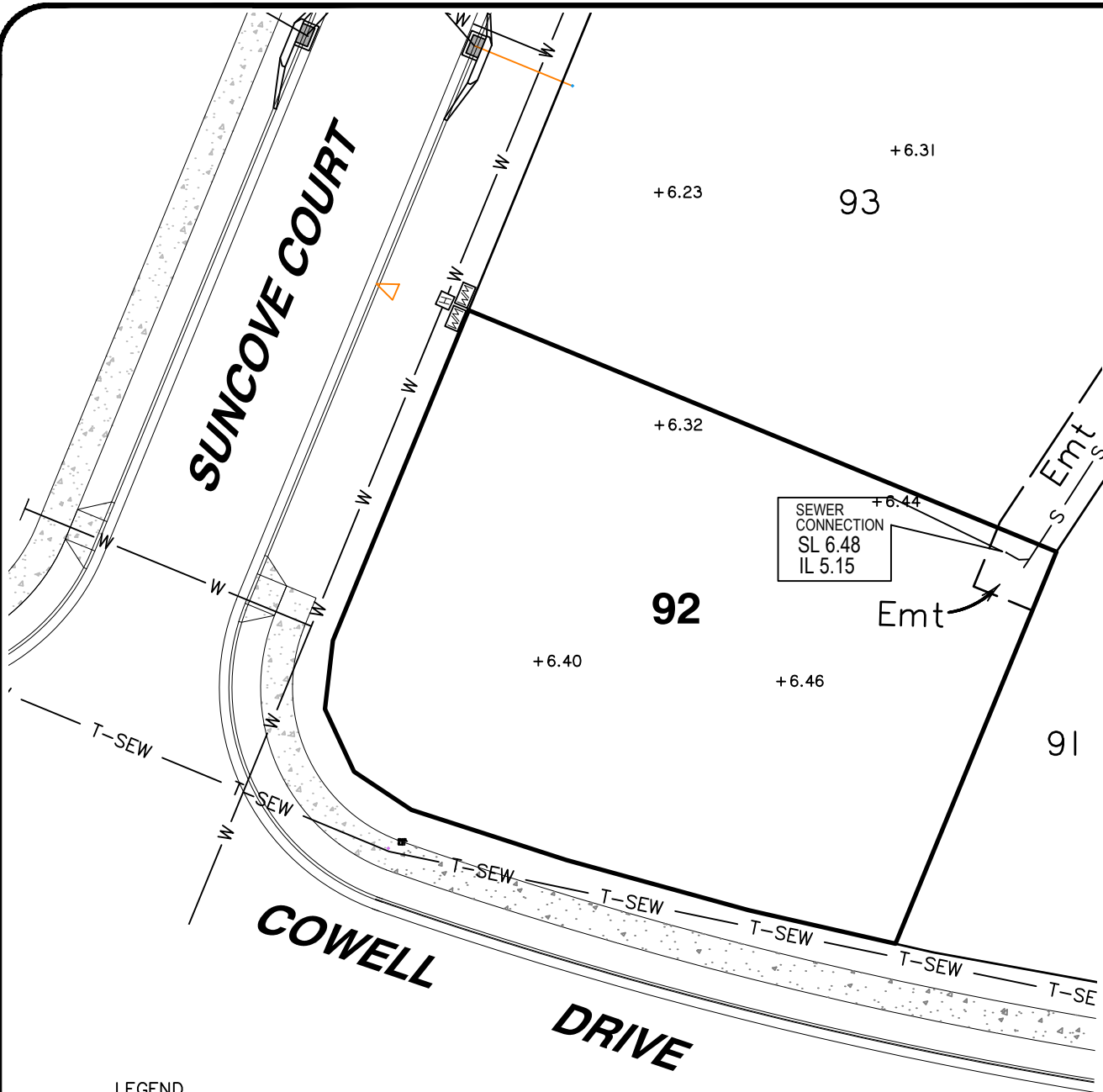



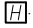
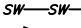
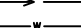
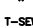
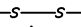
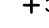

Locality	BURLEIGH HEADS	Issue Date	07/11/2023
Local Govt	GOLD COAST CITY COUNCIL	Meridian	SP329492
		Level Datum	AHD
Scale (on A4 original)	1:300	Drawn	S. Holt
		Date Drafted	30/10/2023
		Checked	A.Geraghty

Real Property Description:
Lot 91 on SP329492

REFERENCE No. 5967- 4
PLAN No. 5967 S SK LOT 91



LEGEND

-  SEWER MANHOLE
-  STORMWATER MANHOLE/ MAINTENANCE SHAFT
-  GULLY TRAP
-  FIELD INLET
-  WATER METER
-  FIRE HYDRANT
-  STORMWATER SWALE
-  STORMWATER SWALE
-  WATER PIPE
-  TRUNK SEWER
-  SEWER
-  + 3.44 SURFACE LEVEL
-  IL INVERT LEVEL
-  SL SURFACE LEVEL
-  DRIVEWAY / FOOTPATH
-  KERB & CHANNEL
-  ROOFWATER DRAINAGE PIPE
-  ROOFWATER KERB ADAPTOR
-  ROOFWATER KERB ADAPTOR WITH CONNECTION TO LOT

Scale 1:300 - Lengths are in Metres.

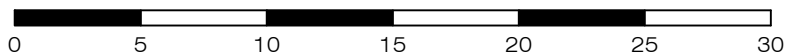

gassman
development
perspectives

planning | environment | landscape | engineering | survey
T: 3807 3333 | F: 3287 5461 | www.gassman.com.au
Gold Coast | 76 Business Street, Yatala QLD | PO Box 392, Beenleigh 4207

Client
Burleigh Heads Estate Pty Ltd

Project **SERVICE LOCATION SKETCH PLAN**

LOT 92 on SP329492

Stage 4, The Arbour Burleigh
Cowell Drive, Burleigh Heads

Locality	BURLEIGH HEADS	Issue Date	07/11/2023
Local Govt	GOLD COAST CITY COUNCIL	Meridian	SP329492
		Level Datum	AHD
Scale (on A4 original)	1:300	Drawn	S. Holt
		Date Drafted	30/10/2023
		Checked	A. Geraghty

Real Property Description:
Lot 92 on SP329492

REFERENCE No. **5967- 4**

PLAN No. **5967 S SK LOT 92**

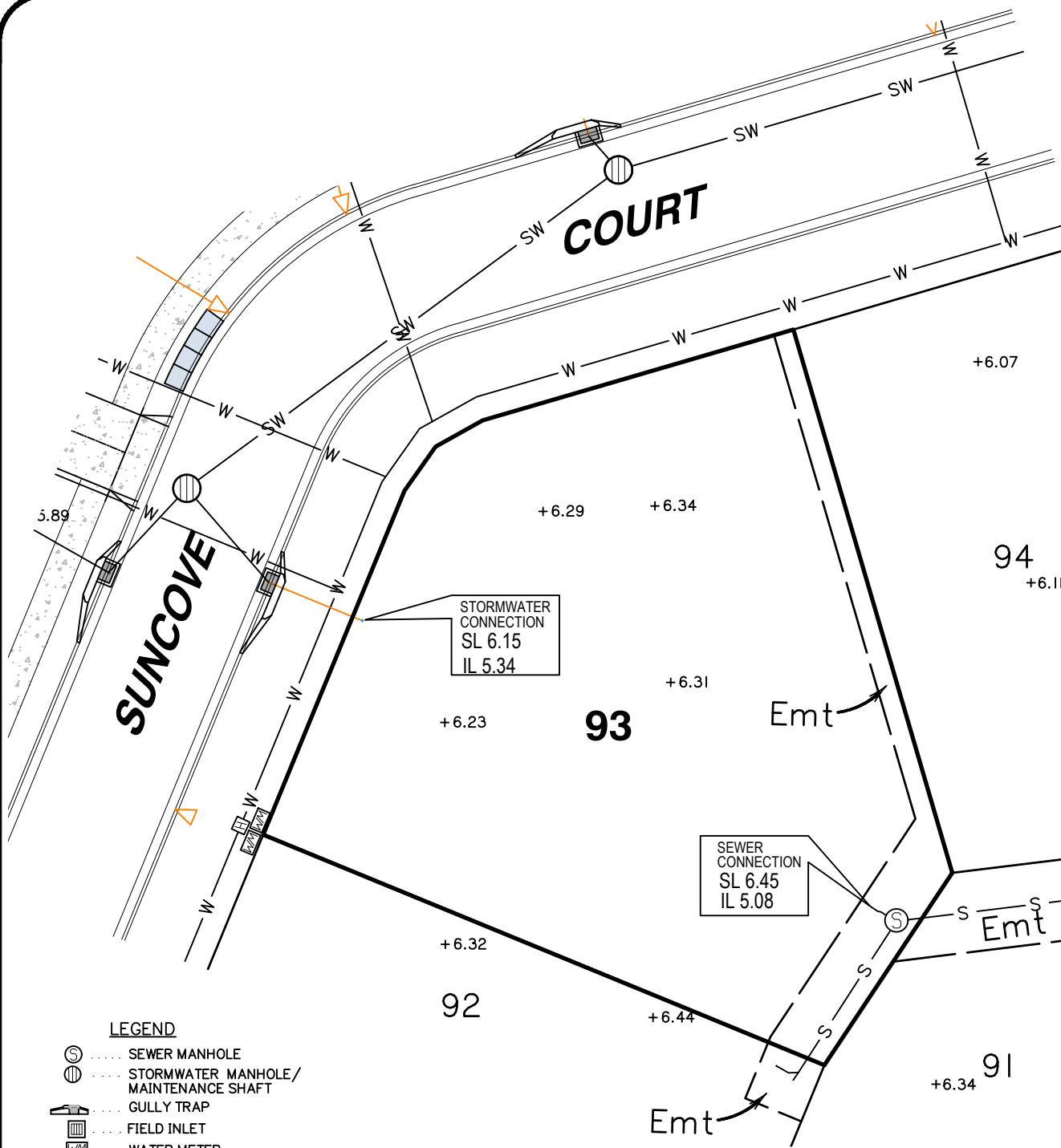

LEGEND

- SEWER MANHOLE
- STORMWATER MANHOLE/ MAINTENANCE SHAFT
- GULLY TRAP
- FIELD INLET
- WATER METER
- FIRE HYDRANT
- STORMWATER SWALE
- WATER PIPE
- TRUNK SEWER
- SEWER
- SURFACE LEVEL
- INVERT LEVEL
- SURFACE LEVEL
- DRIVEWAY / FOOTPATH
- KERB & CHANNEL
- ROOFWATER DRAINAGE PIPE
- ROOFWATER KERB ADAPTOR
- ROOFWATER KERB ADAPTOR WITH CONNECTION TO LOT

Scale 1:300 - Lengths are in Metres.

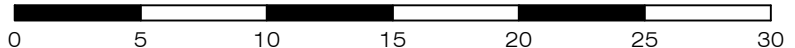

gassman
development
perspectives

planning | environment | landscape | engineering | survey
T: 3807 3333 | F: 3287 5461 | www.gassman.com.au
Gold Coast | 76 Business Street, Yatala QLD | PO Box 392, Beenleigh 4207

Client
Burleigh Heads Estate Pty Ltd

Project **SERVICE LOCATION SKETCH PLAN**

LOT 93 on SP329492

Stage 4, The Arbour Burleigh
Cowell Drive, Burleigh Heads

Locality	BURLEIGH HEADS	Issue Date	07/11/2023
Local Govt	GOLD COAST CITY COUNCIL	Meridian	SP329492
		Level Datum	AHD
Scale (on A4 original)	1:300	Drawn	S. Holt
		Date Drafted	30/10/2023
		Checked	A.Geraghty

Real Property Description:
Lot 93 on SP329492

REFERENCE No. 5967- 4
PLAN No. 5967 S SK LOT 93

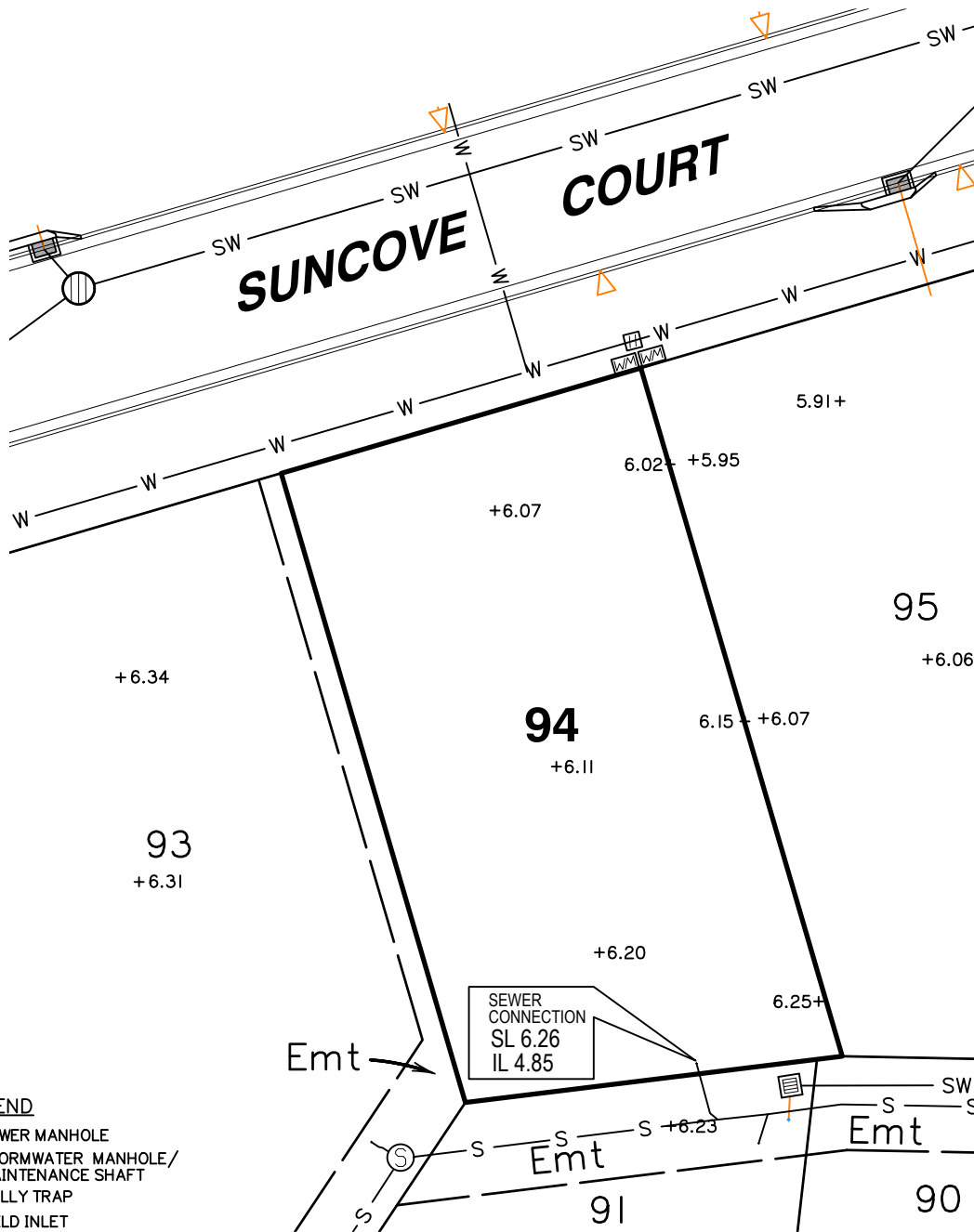

LEGEND

- SEWER MANHOLE
- STORMWATER MANHOLE/ MAINTENANCE SHAFT
- GULLY TRAP
- FIELD INLET
- WATER METER
- FIRE HYDRANT
- STORMWATER SWALE
- WATER PIPE
- TRUNK SEWER
- SEWER
- + 3.44 SURFACE LEVEL
- IL INVERT LEVEL
- SL SURFACE LEVEL
- DRIVEWAY / FOOTPATH
- KERB & CHANNEL
- ROOFWATER DRAINAGE PIPE
- ROOFWATER KERB ADAPTOR
- ROOFWATER KERB ADAPTOR WITH CONNECTION TO LOT

Scale 1:300 - Lengths are in Metres.

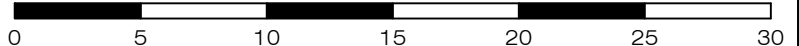

**gassman
development
perspectives**

planning | environment | landscape | engineering | survey
T: 3807 3333 | F: 3287 5461 | www.gassman.com.au
Gold Coast | 76 Business Street, Yatala QLD | PO Box 392, Beenleigh 4207

Client
Burleigh Heads Estate Pty Ltd

Project **SERVICE LOCATION SKETCH PLAN**

LOT 94 on SP329492

**Stage 4, The Arbour Burleigh
Cowell Drive, Burleigh Heads**

Real Property Description:
Lot 94 on SP329492

Locality	BURLEIGH HEADS	Issue Date	07/11/2023
Local Govt	GOLD COAST CITY COUNCIL	Meridian	SP329492
Scale (on A4 original)	1:300	Level Datum	AHD
		Drawn	S. Holt
		Date Drafted	30/10/2023
		Checked	A.Geraghty

REFERENCE No. 5967- 4
PLAN No. 5967 S SK LOT 94

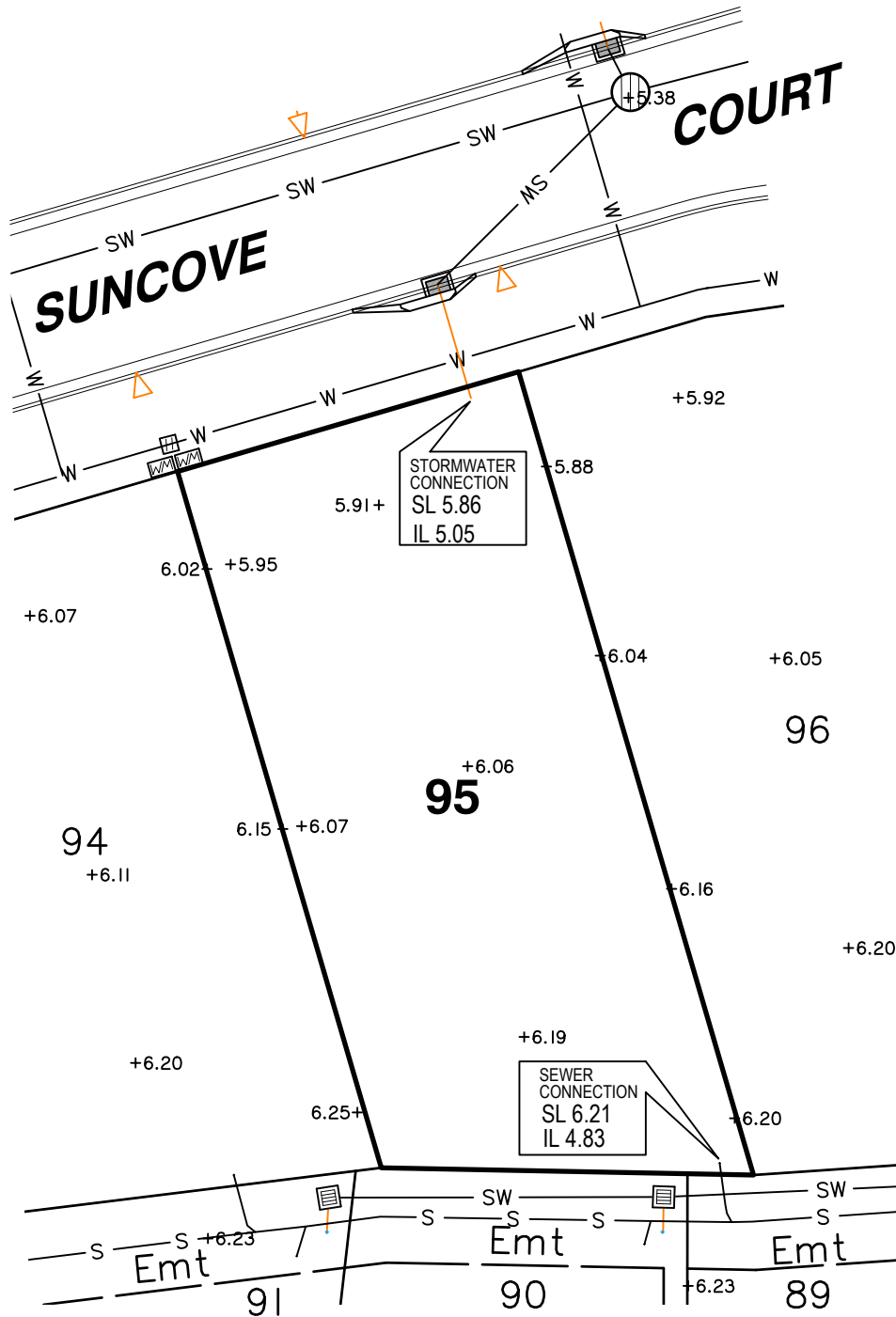

LEGEND

- ⊙ SEWER MANHOLE
- ⊕ STORMWATER MANHOLE/
MAINTENANCE SHAFT
- ⌘ GULLY TRAP
- ⊞ FIELD INLET
- ⊞ WATER METER
- ⊞ FIRE HYDRANT
- SW-SW STORMWATER
- STORMWATER SWALE
- W— WATER PIPE
- T-SEW— TRUNK SEWER
- S—S— SEWER
- + 3.44 SURFACE LEVEL
- IL INVERT LEVEL
- SL SURFACE LEVEL
- ⌘ DRIVEWAY / FOOTPATH
- ==== KERB & CHANNEL
- ROOFWATER DRAINAGE PIPE
- ▽ ROOFWATER KERB ADAPTOR
- ▷ ROOFWATER KERB ADAPTOR
WITH CONNECTION TO LOT

Scale 1:300 - Lengths are in Metres.

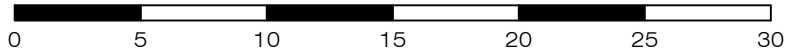

gassman
development
perspectives

est 1985
planning | environment | landscape | engineering | survey
T: 3807 3333 | F: 3287 5461 | www.gassman.com.au
Gold Coast | 76 Business Street, Yatala QLD | PO Box 392, Beenleigh 4207

Client
Burleigh Heads Estate Pty Ltd

Project **SERVICE LOCATION SKETCH PLAN**

LOT 95 on SP329492

Stage 4, The Arbour Burleigh
Cowell Drive, Burleigh Heads

Locality BURLEIGH HEADS

Local Govt GOLD COAST
CITY COUNCIL

Scale (on A4 original)
1:300

Issue Date 07/11/2023

Meridian SP329492

Level Datum AHD

Drawn S. Holt

Date Drafted 30/10/2023

Checked A.Geraghty

Real Property Description:
Lot 95 on SP329492

REFERENCE No. **5967- 4**

PLAN No. **5967 S SK LOT 95**

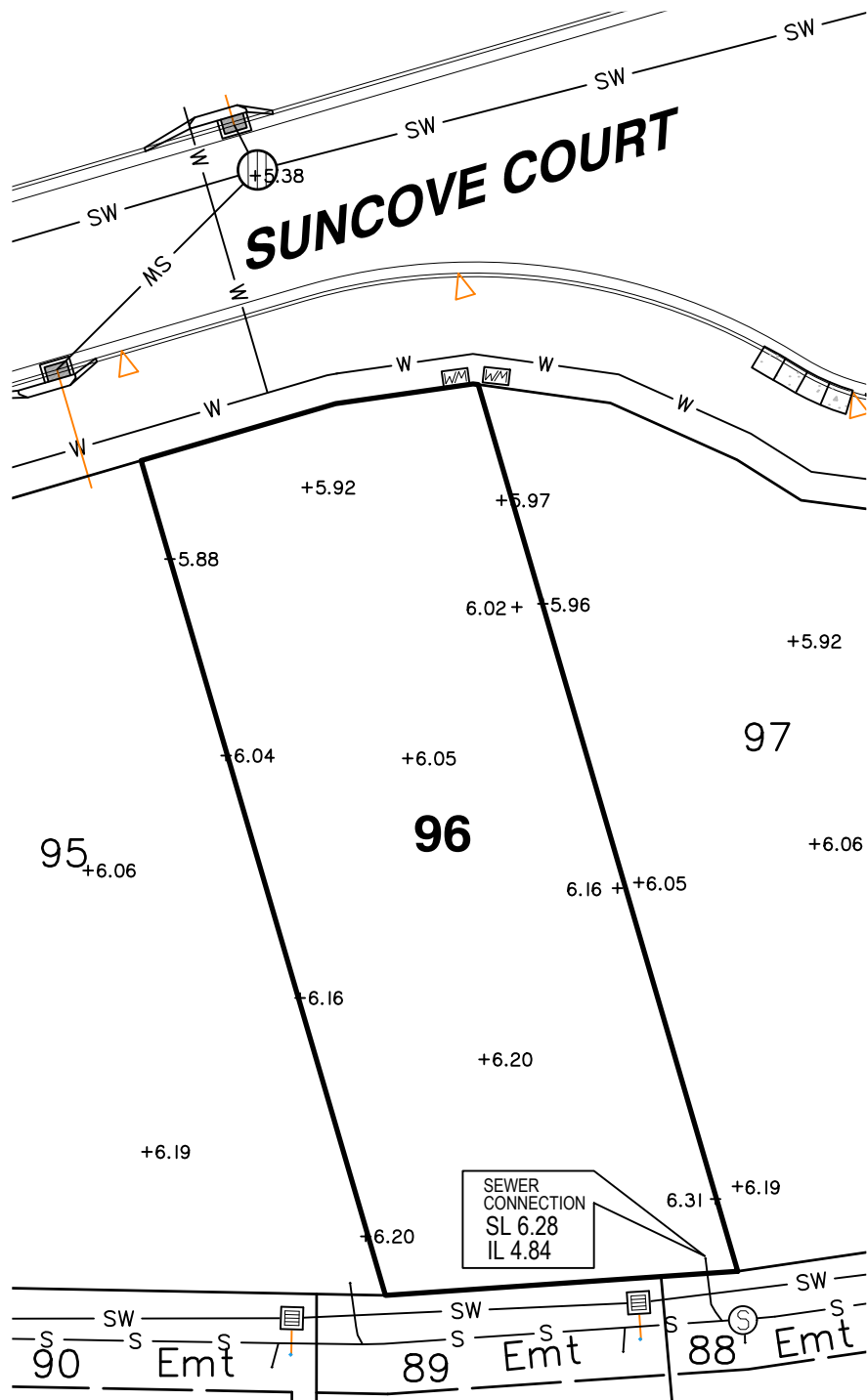

LEGEND

- ⊙ SEWER MANHOLE
- ⊕ STORMWATER MANHOLE/
MAINTENANCE SHAFT
- ⌒ GULLY TRAP
- ⊞ FIELD INLET
- ⊞ WATER METER
- ⊞ FIRE HYDRANT
- SW—SW— STORMWATER
- STORMWATER SWALE
- W — WATER PIPE
- T—SEW — TRUNK SEWER
- S — S — SEWER
- + 3.44 SURFACE LEVEL
- IL INVERT LEVEL
- SL SURFACE LEVEL
- ⊞ DRIVEWAY / FOOTPATH
- ==== KERB & CHANNEL
- ROOFWATER DRAINAGE PIPE
- ▽ ROOFWATER KERB ADAPTOR
- ▷ ROOFWATER KERB ADAPTOR
WITH CONNECTION TO LOT

Scale 1:300 - Lengths are in Metres.

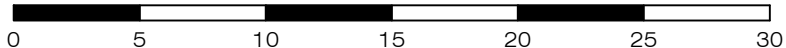

**gassman
development
perspectives**

planning | environment | landscape | engineering | survey
T: 3807 3333 | F: 3287 5461 | www.gassman.com.au
Gold Coast | 76 Business Street, Yatala QLD | PO Box 392, Beenleigh 4207

Client
Burleigh Heads Estate Pty Ltd

Project **SERVICE LOCATION SKETCH PLAN**

LOT 96 on SP329492

**Stage 4, The Arbour Burleigh
Cowell Drive, Burleigh Heads**

Locality	BURLEIGH HEADS	Issue Date	07/11/2023
Local Govt	GOLD COAST CITY COUNCIL	Meridian	SP329492
Scale (on A4 original)	1:300	Level Datum	AHD
		Drawn	S. Holt
		Date Drafted	30/10/2023
		Checked	A. Geraghty

Real Property Description:
Lot 96 on SP329492

REFERENCE No. 5967- 4
PLAN No. 5967 S SK LOT 96

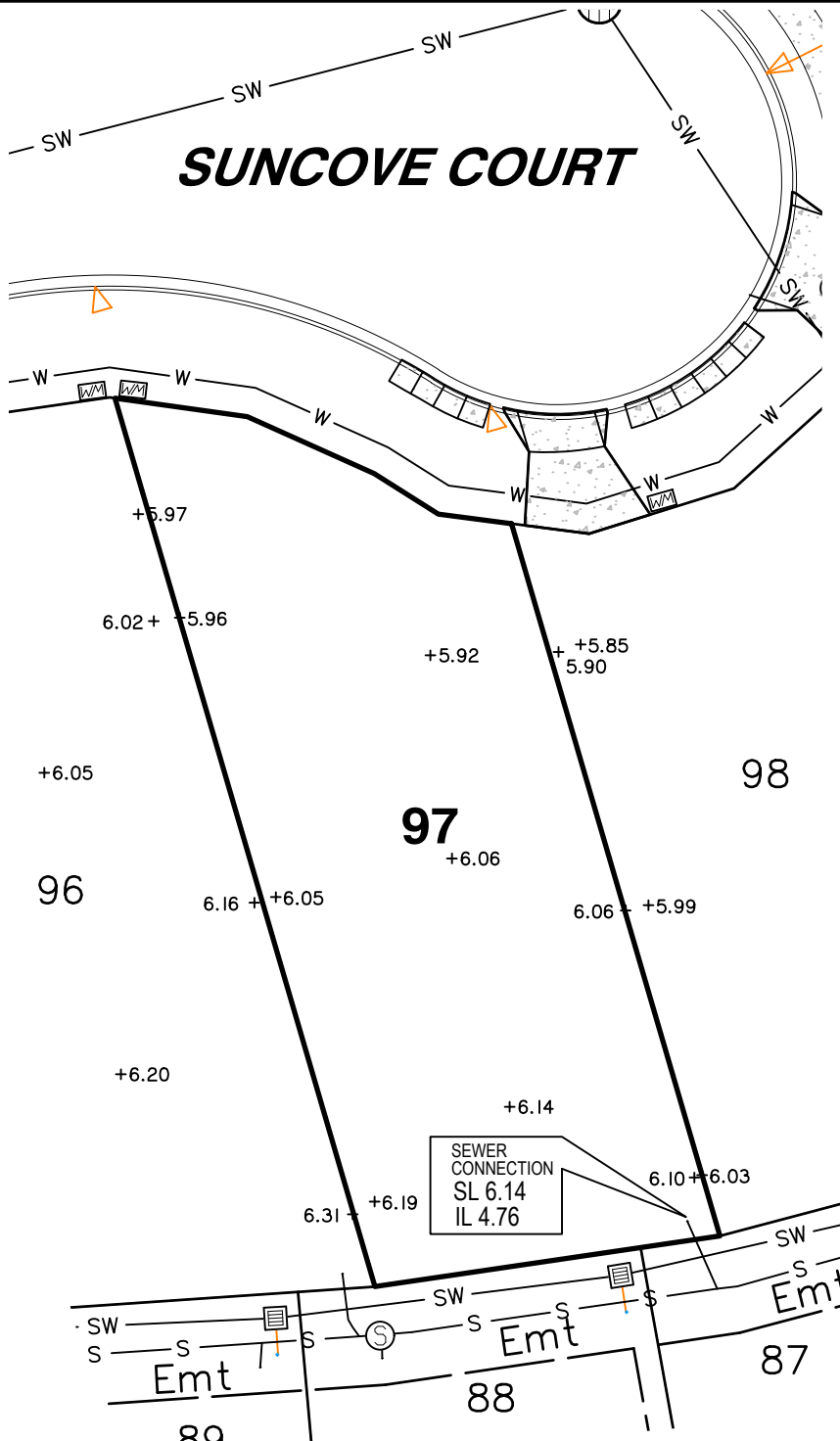

LEGEND

- SEWER MANHOLE
- STORMWATER MANHOLE/ MAINTENANCE SHAFT
- GULLY TRAP
- FIELD INLET
- WATER METER
- FIRE HYDRANT
- STORMWATER SWALE
- WATER PIPE
- TRUNK SEWER
- SEWER
- + 3.44 SURFACE LEVEL
- IL INVERT LEVEL
- SL SURFACE LEVEL
- DRIVEWAY / FOOTPATH
- KERB & CHANNEL
- ROOFWATER DRAINAGE PIPE
- ROOFWATER KERB ADAPTOR
- ROOFWATER KERB ADAPTOR WITH CONNECTION TO LOT

Scale 1:300 - Lengths are in Metres.

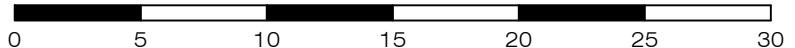

gassman
development
perspectives

planning | environment | landscape | engineering | survey
T: 3807 3333 | F: 3287 5461 | www.gassman.com.au
Gold Coast | 76 Business Street, Yatala QLD | PO Box 392, Beenleigh 4207

Client
Burleigh Heads Estate Pty Ltd

Project **SERVICE LOCATION SKETCH PLAN**

LOT 97 on SP329492

Stage 4, The Arbour Burleigh
Cowell Drive, Burleigh Heads

Locality	BURLEIGH HEADS	Issue Date	07/11/2023
Local Govt	GOLD COAST CITY COUNCIL	Meridian	SP329492
Scale (on A4 original)	1:300	Level Datum	AHD
		Drawn	S. Holt
		Date Drafted	30/10/2023
		Checked	A. Geraghty

Real Property Description:
Lot 97 on SP329492

REFERENCE No. 5967- 4
PLAN No. 5967 S SK LOT 97

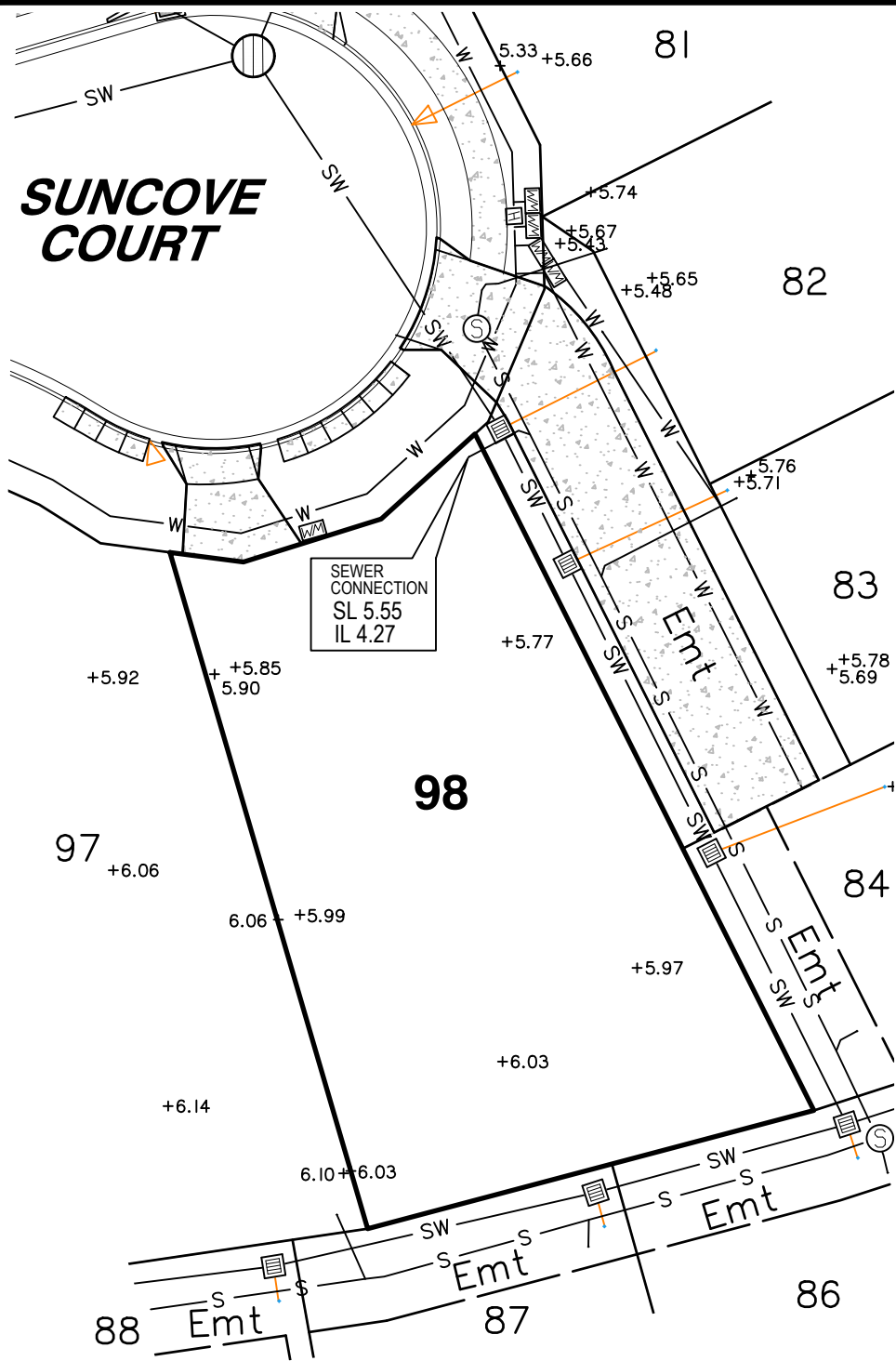

LEGEND

- SEWER MANHOLE
- STORMWATER MANHOLE/
MAINTENANCE SHAFT
- GULLY TRAP
- FIELD INLET
- WATER METER
- FIRE HYDRANT
- STORMWATER
- STORMWATER SWALE
- WATER PIPE
- TRUNK SEWER
- SEWER
- + 3.44 SURFACE LEVEL
- IL INVERT LEVEL
- SL SURFACE LEVEL
- DRIVEWAY / FOOTPATH
- KERB & CHANNEL
- ROOFWATER DRAINAGE PIPE
- ROOFWATER KERB ADAPTOR
- ROOFWATER KERB ADAPTOR
WITH CONNECTION TO LOT

Scale 1:300 - Lengths are in Metres.

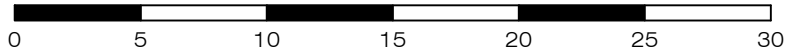

gassman
development
perspectives

planning | environment | landscape | engineering | survey
T: 3807 3333 | F: 3287 5461 | www.gassman.com.au
Gold Coast | 76 Business Street, Yatala QLD | PO Box 392, Beenleigh 4207

Client
Burleigh Heads Estate Pty Ltd

Project **SERVICE LOCATION SKETCH PLAN**

LOT 98 on SP329492

Stage 4, The Arbour Burleigh
Cowell Drive, Burleigh Heads

Locality	BURLEIGH HEADS	Issue Date	07/11/2023
Local Govt	GOLD COAST CITY COUNCIL	Meridian	SP329492
		Level Datum	AHD
Scale (on A4 original)	1:300	Drawn	S. Holt
		Date Drafted	30/10/2023
		Checked	A. Geraghty

Real Property Description:
Lot 98 on SP329492

REFERENCE No. 5967-4
PLAN No. 5967 S SK LOT 98