

**KEY TO SHEETS**

REFER TO SHEETS  
1 TO 8  
FOR DETAIL



**ARMSTRONG Mt DUNEED**

**BUILDING ENVELOPE PLAN**  
**STAGE 69**

May 2022  
Version:D

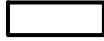
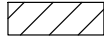

### NOTATIONS

-  Single Storey Building Envelope (height not exceeding 3.6m)
-  Overlooking Zone - Habitable room windows/raised open spaces are a source of overlooking
-  Non Overlooking Zone - Habitable room windows/raised open spaces are not a source of overlooking
-  Building to Boundary Zone



Building Envelope Boundary Profile Type

6905

Lot number

3

Setback minimum required (if 0, a building can be constructed on the boundary provided that the building height and length requirements are met)

\*

The registered proprietor or proprietors for the time being of lots identified thus must not build or permit to be built any building(s) that does not provide 1.0 metre clear horizontal access along the full length of a minimum one side boundary of the lot.

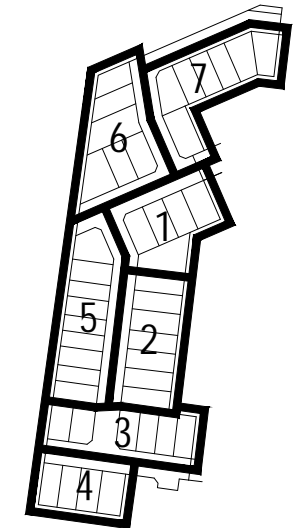
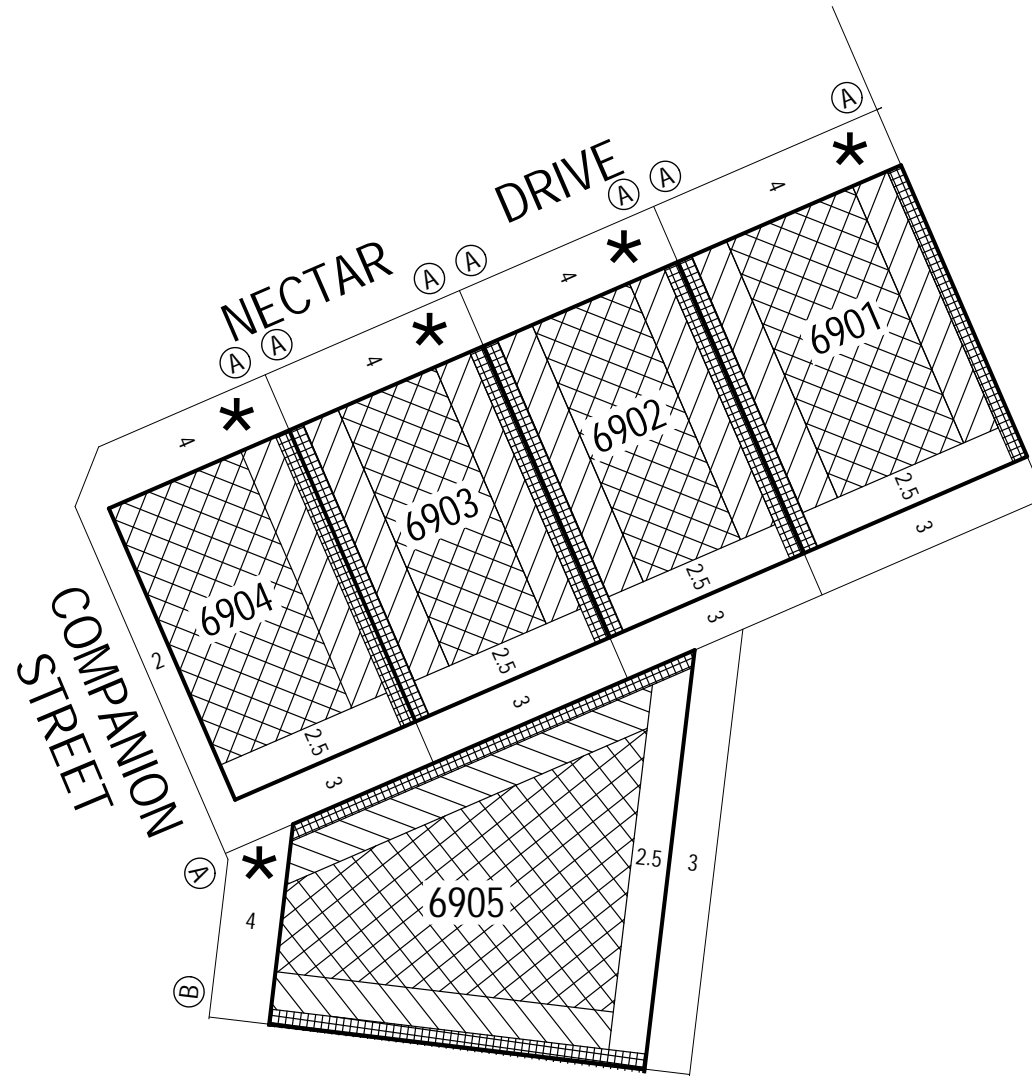

### KEY TO SHEETS

## ARMSTRONG Mt DUNED

BUILDING ENVELOPE PLAN  
STAGE 69

# 69/1

stage sheet

This Building Envelope Plan is to be read in conjunction with the associated Building Envelope Profiles and Design Guidelines.

The registered proprietor/s of the lot are required to build in accordance with building envelopes shown hereon and in the "Profile Diagrams" in sheet 8.

Detailed design of roads, driveways and footpaths is provided in the relevant Engineering Plans.

Detailed design of landscape works is provided in the relevant Landscape Plans.

All details subject to City of Greater Geelong Council approval.

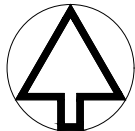

MGA ZONE 55

Detailed design of roads, driveways and footpaths is provided in the relevant Engineering Plans.

Detailed design of landscape works is provided in the relevant Landscape Plans.

All details subject to City of Greater Geelong Council approval.

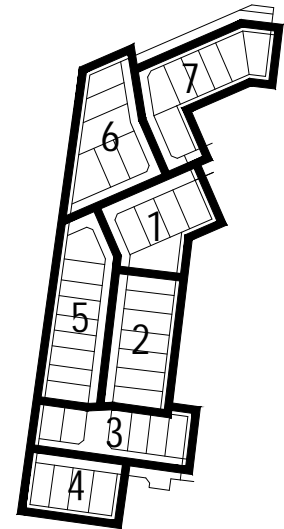

KEY TO SHEETS

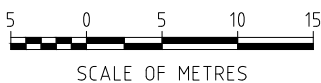
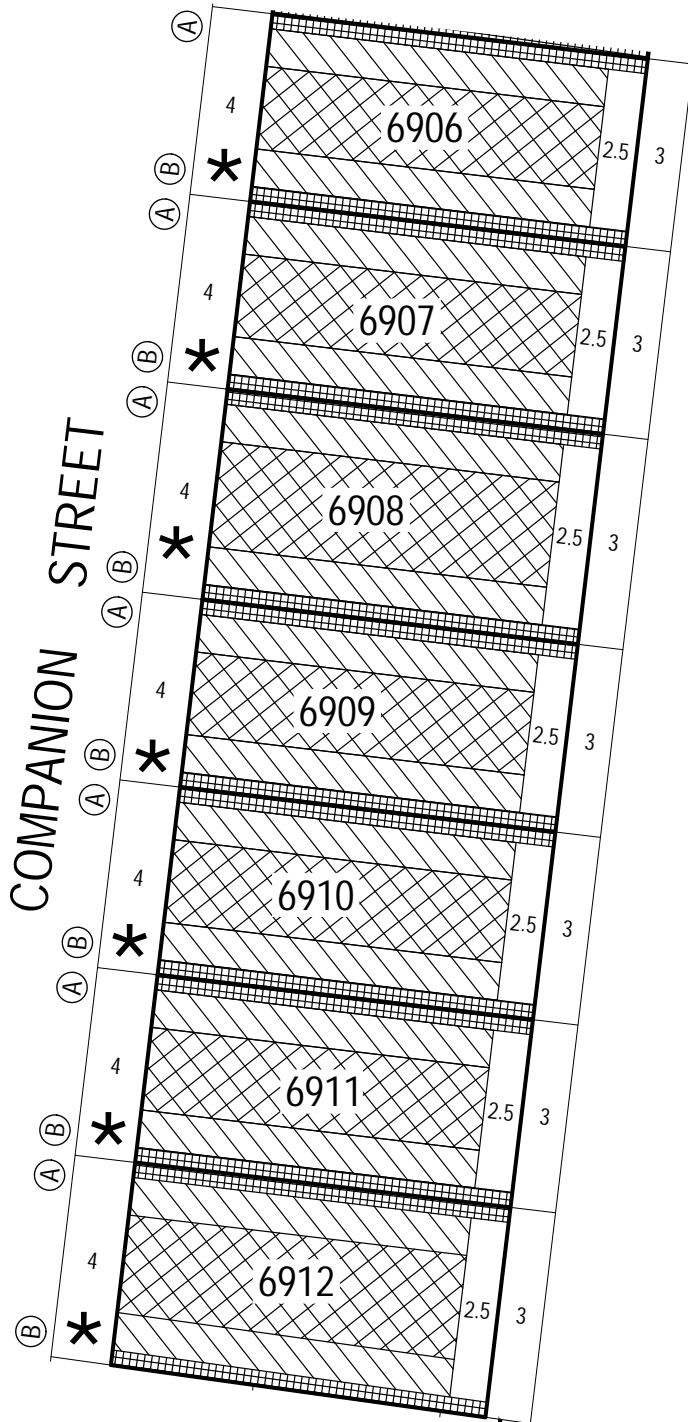

NOTATIONS

- Single Storey Building Envelope (height not exceeding 3.6m)
- Overlooking Zone - Habitable room windows/raised open spaces are a source of overlooking
- Non Overlooking Zone - Habitable room windows/raised open spaces are not a source of overlooking
- Building to Boundary Zone)
- Building Envelope Boundary Profile Type
- 6905** Lot number
- 3** Setback minimum required (if 0, a building can be constructed on the boundary provided that the building height and length requirements are met)
- \*** The registered proprietor or proprietors for the time being of lots identified thus must not build or permit to be built any building(s) that does not provide 1.0 metre clear horizontal access along the full length of a minimum one side boundary of the lot.

ARMSTRONG Mt DUNED

BUILDING ENVELOPE PLAN  
STAGE 69

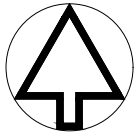

**69/2**  
stage sheet

This Building Envelope Plan is to be read in conjunction with the associated Building Envelope Profiles and Design Guidelines.  
The registered proprietor/s of the lot are required to build in accordance with building envelopes shown hereon and in the "Profile Diagrams" in sheet 8.

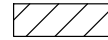

MGA ZONE 55

### NOTATIONS

-  Single Storey Building Envelope (height not exceeding 3.6m)
-  Overlooking Zone - Habitable room windows/raised open spaces are a source of overlooking
-  Non Overlooking Zone - Habitable room windows/raised open spaces are not a source of overlooking
-  Building to Boundary Zone

-  Building Envelope Boundary Profile Type
- 6905** Lot number
- 3** Setback minimum required (if 0, a building can be constructed on the boundary provided that the building height and length requirements are met)
- \*** The registered proprietor or proprietors for the time being of lots identified thus must not build or permit to be built any building(s) that does not provide 1.0 metre clear horizontal access along the full length of a minimum one side boundary of the lot.

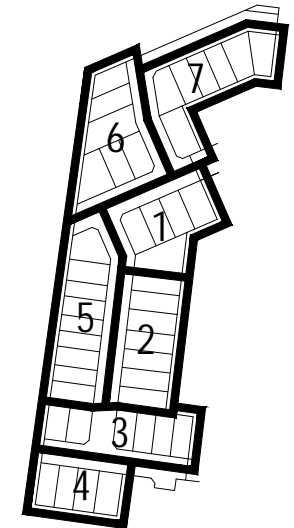
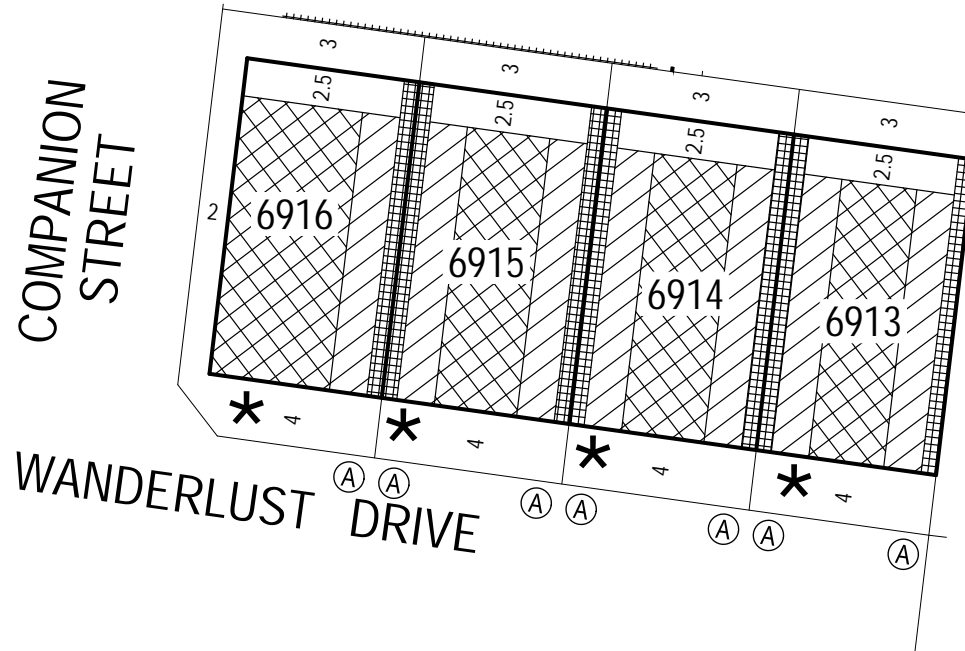
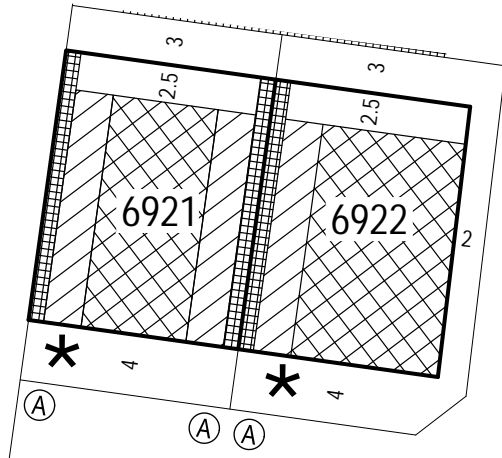

This Building Envelope Plan is to be read in conjunction with the associated Building Envelope Profiles and Design Guidelines.

The registered proprietor/s of the lot are required to build in accordance with building envelopes shown hereon and in the "Profile Diagrams" in sheet 8.

Detailed design of roads, driveways and footpaths is provided in the relevant Engineering Plans.

Detailed design of landscape works is provided in the relevant Landscape Plans.

All details subject to City of Greater Geelong Council approval.

### KEY TO SHEETS

## ARMSTRONG Mt DUNED





BUILDING ENVELOPE PLAN  
STAGE 69

# 69/3

stage sheet



**NOTATIONS**

-  Single Storey Building Envelope (height not exceeding 3.6m)
-  Overlooking Zone - Habitable room windows/raised open spaces are a source of overlooking
-  Non Overlooking Zone - Habitable room windows/raised open spaces are not a source of overlooking
-  Building to Boundary Zone

-  Building Envelope Boundary Profile Type
- 6905** Lot number
- 3** Setback minimum required (if 0, a building can be constructed on the boundary provided that the building height and length requirements are met)
- \*** The registered proprietor or proprietors for the time being of lots identified thus must not build or permit to be built any building(s) that does not provide 1.0 metre clear horizontal access along the full length of a minimum one side boundary of the lot.

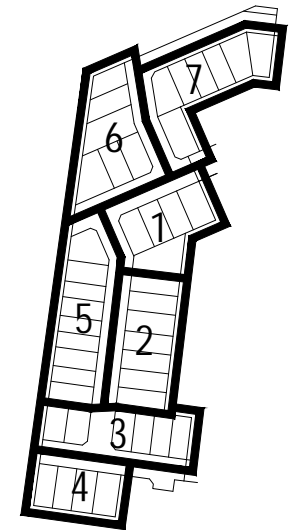
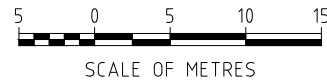
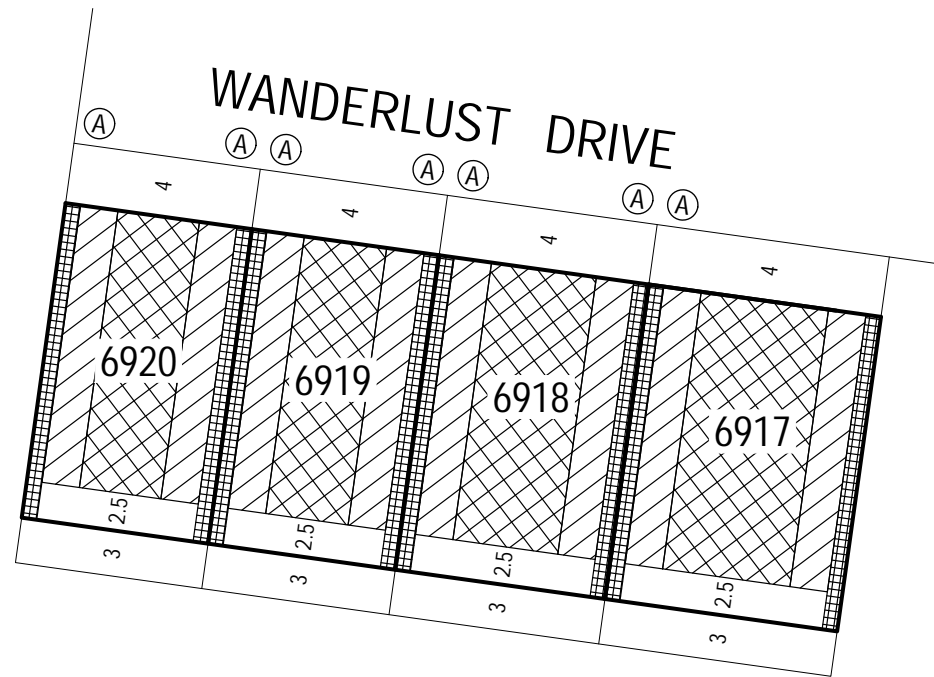

**KEY TO SHEETS**

**ARMSTRONG Mt DUNED**

BUILDING ENVELOPE PLAN  
STAGE 69

**69/4**  
stage sheet

This Building Envelope Plan is to be read in conjunction with the associated Building Envelope Profiles and Design Guidelines.

The registered proprietor/s of the lot are required to build in accordance with building envelopes shown hereon and in the "Profile Diagrams" in sheet 8.

Detailed design of roads, driveways and footpaths is provided in the relevant Engineering Plans.

Detailed design of landscape works is provided in the relevant Landscape Plans.

All details subject to City of Greater Geelong Council approval.





Detailed design of roads, driveways and footpaths is provided in the relevant Engineering Plans.

Detailed design of landscape works is provided in the relevant Landscape Plans.

All details subject to City of Greater Geelong Council approval.

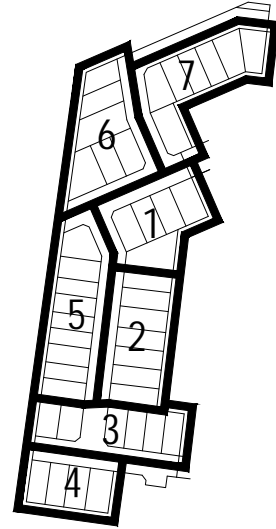
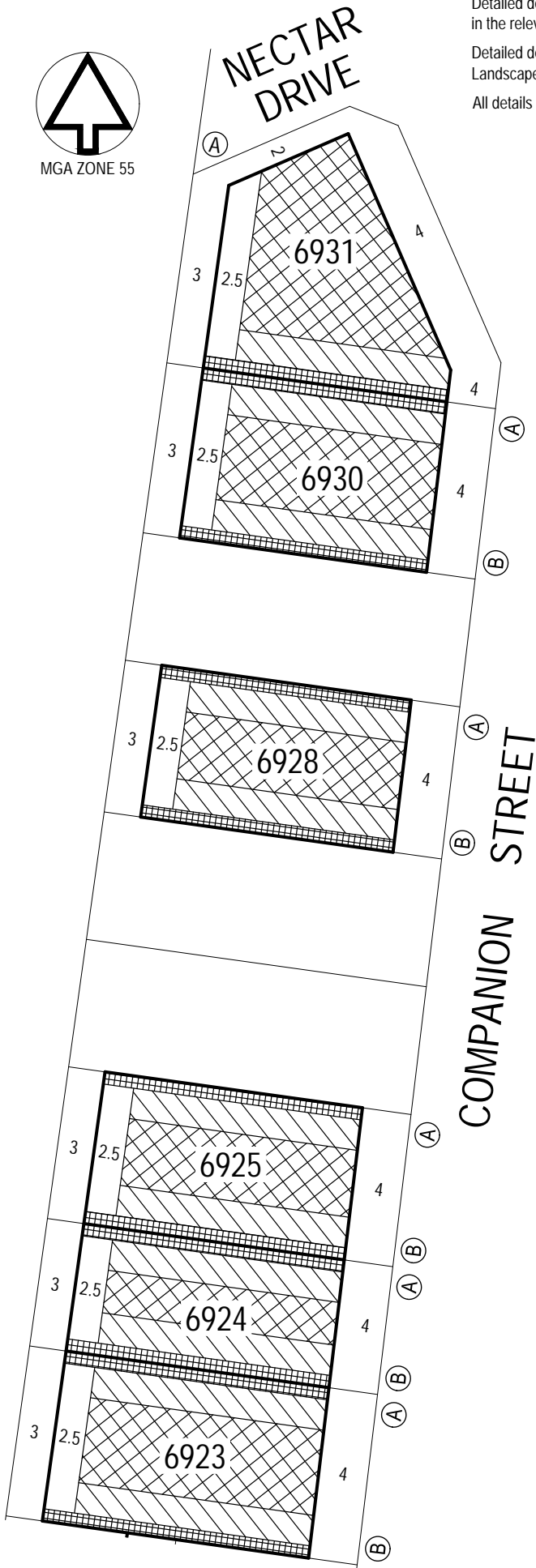

### KEY TO SHEETS

#### NOTATIONS

- Single Storey Building Envelope (height not exceeding 3.6m)
- Overlooking Zone - Habitable room windows/raised open spaces are a source of overlooking
- Non Overlooking Zone - Habitable room windows/raised open spaces are not a source of overlooking
- Building to Boundary Zone)

Building Envelope Boundary Profile Type

6905

3 Setback minimum required (if 0, a building can be constructed on the boundary provided that the building height and length requirements are met)

\* The registered proprietor or proprietors for the time being of lots identified thus must not build or permit to be built any building(s) that does not provide 1.0 metre clear horizontal access along the full length of a minimum one side boundary of the lot.

This Building Envelope Plan is to be read in conjunction with the associated Building Envelope Profiles and Design Guidelines. The registered proprietor/s of the lot are required to build in accordance with building envelopes shown hereon and in the "Profile Diagrams" in sheet 8.

## ARMSTRONG Mt DUNED



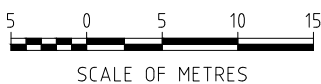

BUILDING ENVELOPE PLAN  
STAGE 69

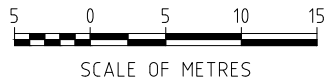
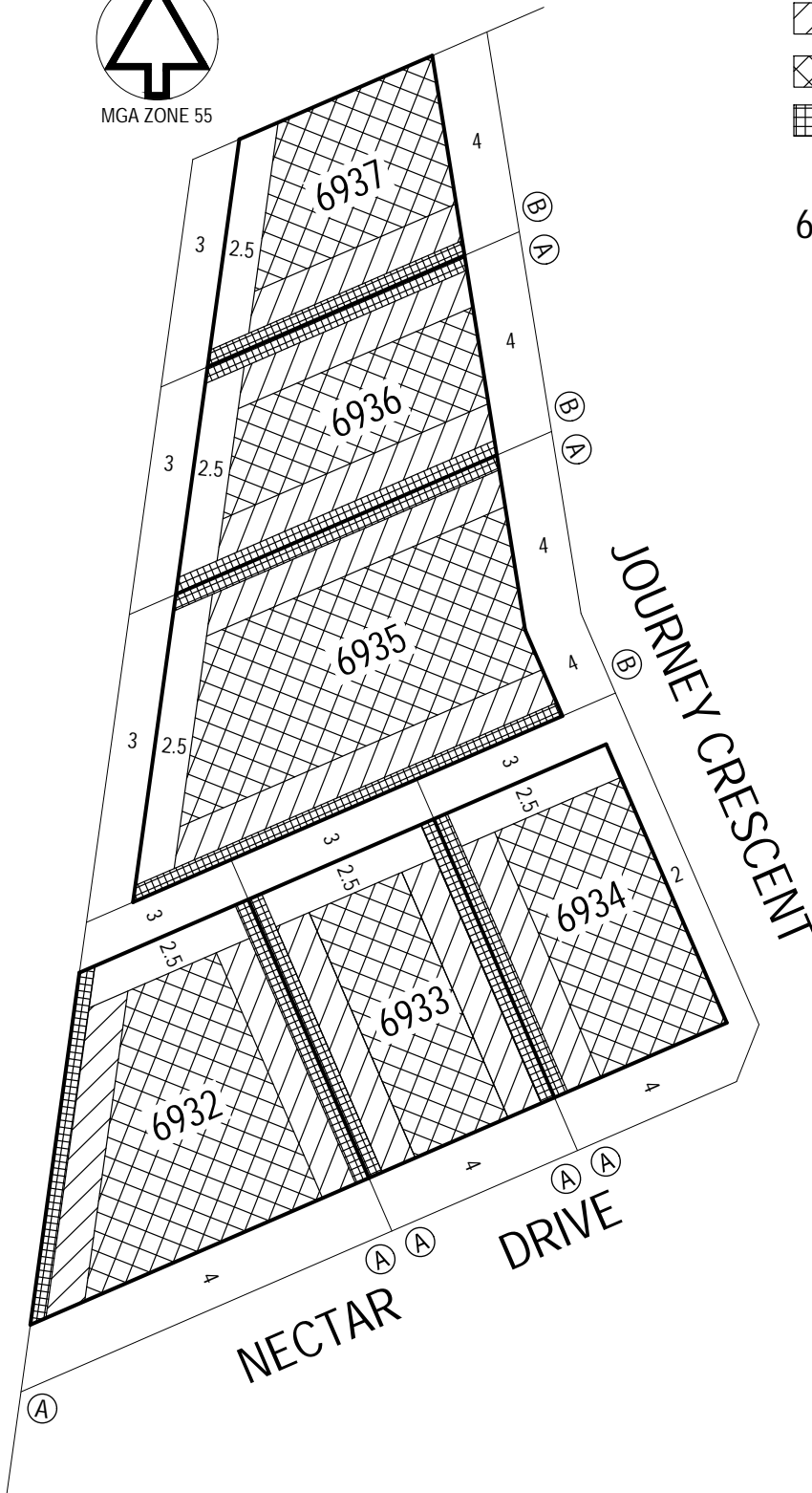
**69 / 5**  
stage sheet



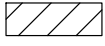

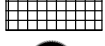
**NOTATIONS**

-  Single Storey Building Envelope (height not exceeding 3.6m)
-  Overlooking Zone - Habitable room windows/raised open spaces are a source of overlooking
-  Non Overlooking Zone - Habitable room windows/raised open spaces are not a source of overlooking
-  Building to Boundary Zone)
-  Building Envelope Boundary Profile Type
- 6905** Lot number
- 3** Setback minimum required (if 0, a building can be constructed on the boundary provided that the building height and length requirements are met)
- \*** The registered proprietor or proprietors for the time being of lots identified thus must not build or permit to be built any building(s) that does not provide 1.0 metre clear horizontal access along the full length of a minimum one side boundary of the lot.

Detailed design of roads, driveways and footpaths is provided in the relevant Engineering Plans.  
 Detailed design of landscape works is provided in the relevant Landscape Plans.  
 All details subject to City of Greater Geelong Council approval.

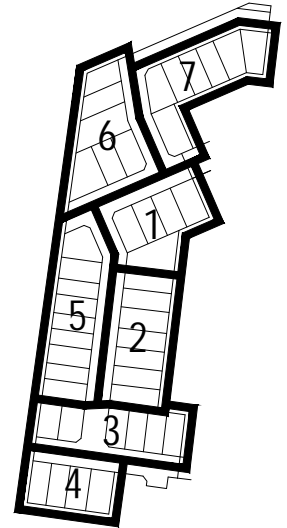

KEY TO SHEETS

**ARMSTRONG Mt DUNED**

BUILDING ENVELOPE PLAN  
 STAGE 69

**69 / 6**  
 stage sheet

This Building Envelope Plan is to be read in conjunction with the associated Building Envelope Profiles and Design Guidelines.  
 The registered proprietor/s of the lot are required to build in accordance with building envelopes shown hereon and in the "Profile Diagrams" in sheet 8.

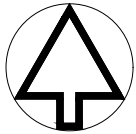

MGA ZONE 55

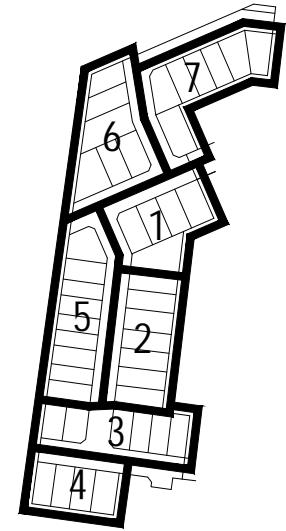
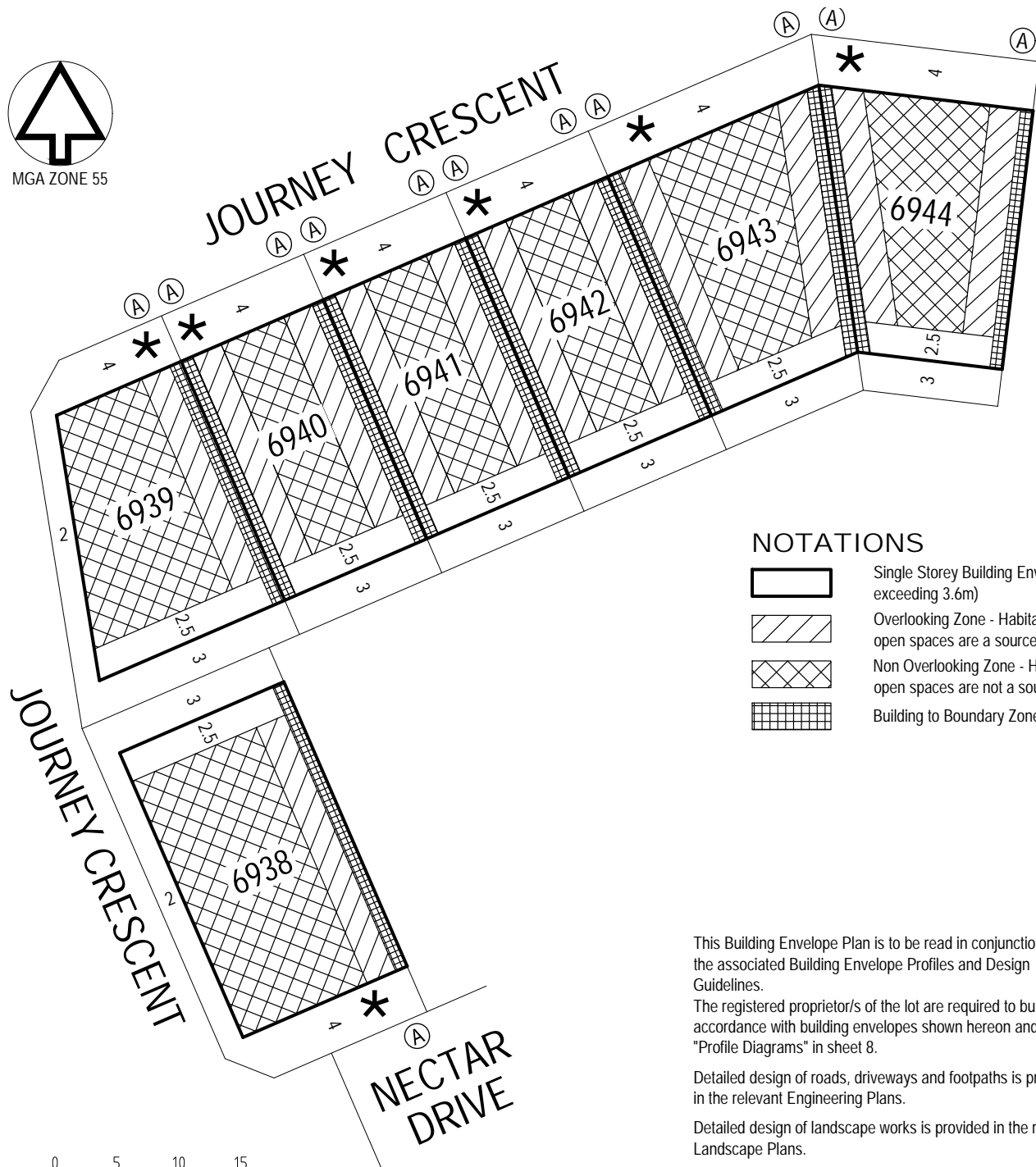

### KEY TO SHEETS

- (A)** Building Envelope Boundary Profile Type
- 6905** Lot number
- 3** Setback minimum required (if 0, a building can be constructed on the boundary provided that the building height and length requirements are met)
- \*** The registered proprietor or proprietors for the time being of lots identified thus must not build or permit to be built any building(s) that does not provide 1.0 metre clear horizontal access along the full length of a minimum one side boundary of the lot.

### NOTATIONS

- Single Storey Building Envelope (height not exceeding 3.6m)
- Overlooking Zone - Habitable room windows/raised open spaces are a source of overlooking
- Non Overlooking Zone - Habitable room windows/raised open spaces are not a source of overlooking
- Building to Boundary Zone

This Building Envelope Plan is to be read in conjunction with the associated Building Envelope Profiles and Design Guidelines.

The registered proprietor/s of the lot are required to build in accordance with building envelopes shown hereon and in the "Profile Diagrams" in sheet 8.

Detailed design of roads, driveways and footpaths is provided in the relevant Engineering Plans.

Detailed design of landscape works is provided in the relevant Landscape Plans.

All details subject to City of Greater Geelong Council approval.



SCALE OF METRES

## ARMSTRONG Mt DUNED

BUILDING ENVELOPE PLAN  
STAGE 69

# 6917

stage sheet



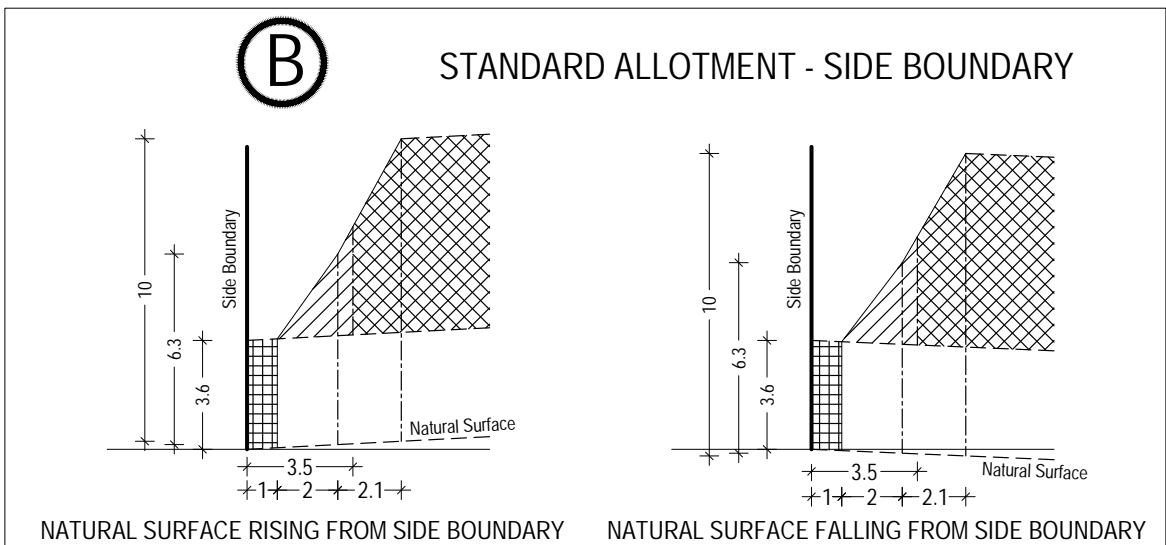
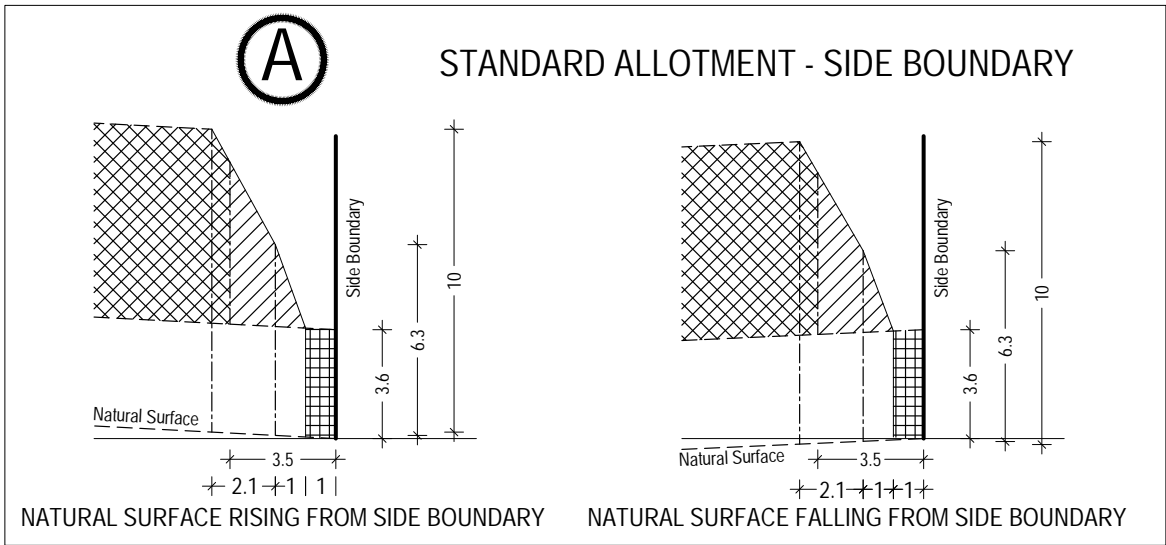

SCALE 1:250@A4

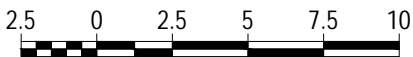

## ARMSTRONG Mt DUNEED

BUILDING ENVELOPE PROFILES  
STAGE 69

**69 / 8**  
stage      sheet

 Single Storey Building Envelope



Non Overlooking Zone  
Habitable room windows/raised open spaces are not a source of overlooking

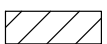

Overlooking Zone  
Habitable room windows/raised open spaces are a source of overlooking



Building to Boundary Zone

Sheet 8 of 8

May 2022  
Version:D