

- 2 metre wide easement
- . - . - . 2.5 metre wide easement
- 3 metre wide easement

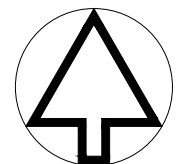

MGA ZONE 55

KEY TO SHEETS

REFER TO SHEETS
1 TO 7
FOR DETAIL

ARMSTRONG Mt DUNEED

BUILDING ENVELOPE PLAN
STAGE 66

March 2021
Version: C



MGA ZONE 55

Detailed design of roads, driveways and footpaths is provided in the relevant Engineering Plans.



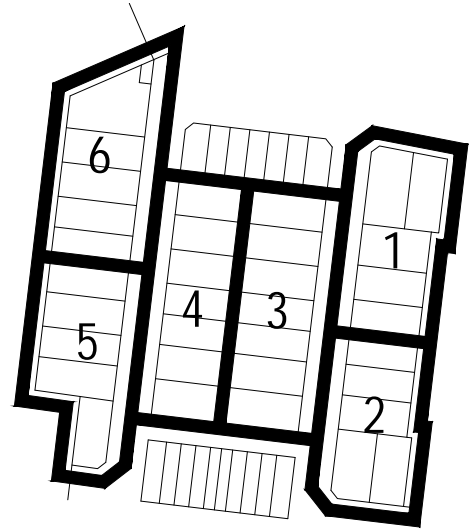
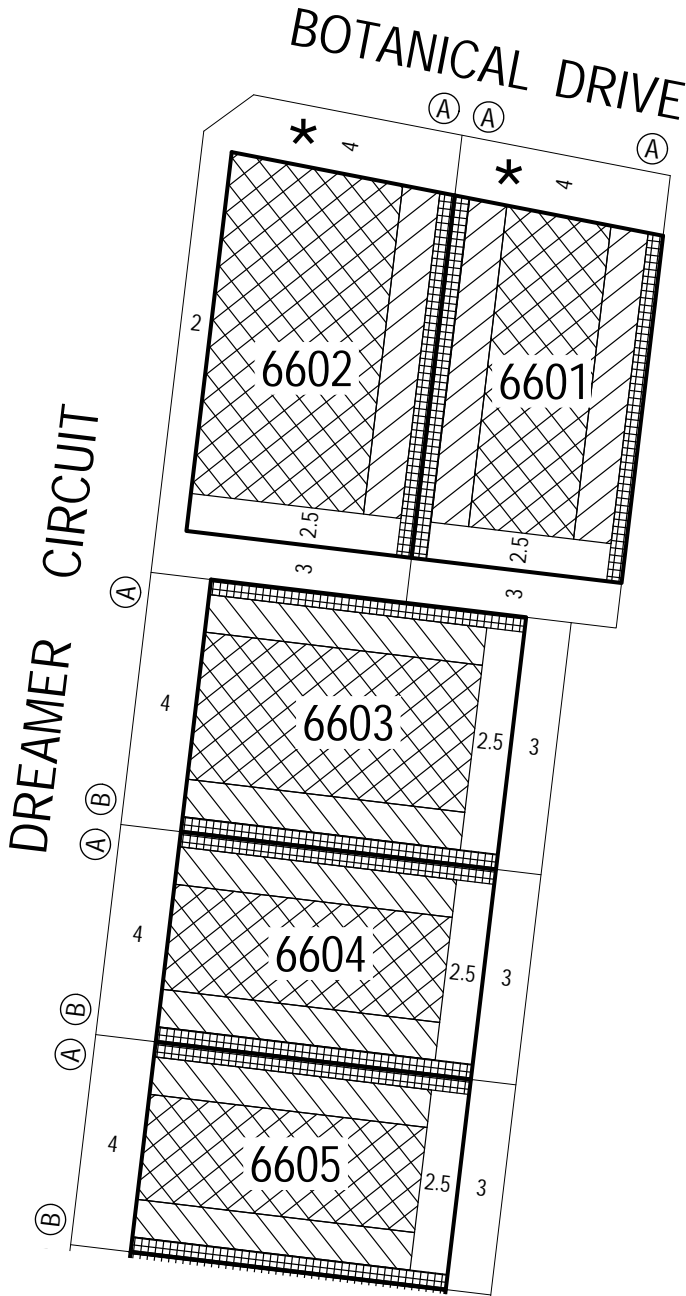

Detailed design of landscape works is provided in the relevant Landscape Plans.

All details subject to City of Greater Geelong Council approval.



KEY TO SHEETS

NOTATIONS

-  Single Storey Building Envelope (height not exceeding 3.6m)
-  Overlooking Zone - Habitable room windows/raised open spaces are a source of overlooking
-  Non Overlooking Zone - Habitable room windows/raised open spaces are not a source of overlooking
-  Building to Boundary Zone)
-  Building Envelope Boundary Profile Type
- 6606** Lot number
- 3** Setback minimum required (if 0, a building can be constructed on the boundary provided that the building height and length requirements are met)
- *** The registered proprietor or proprietors for the time being of lots identified thus must not build or permit to be built any building(s) that does not provide 1.0 metre clear horizontal access along the full length of a minimum one side boundary of the lot.

This Building Envelope Plan is to be read in conjunction with the associated Building Envelope Profiles and Design Guidelines.
The registered proprietor/s of the lot are required to build in accordance with building envelopes shown hereon and in the "Profile Diagrams" in sheet 7.

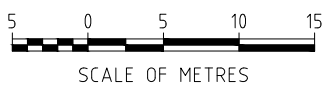

ARMSTRONG Mt DUNED

BUILDING ENVELOPE PLAN
STAGE 66

66 / 1
stage sheet

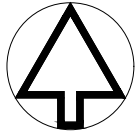

MGA ZONE 55

Detailed design of roads, driveways and footpaths is provided in the relevant Engineering Plans.

Detailed design of landscape works is provided in the relevant Landscape Plans.

All details subject to City of Greater Geelong Council approval.

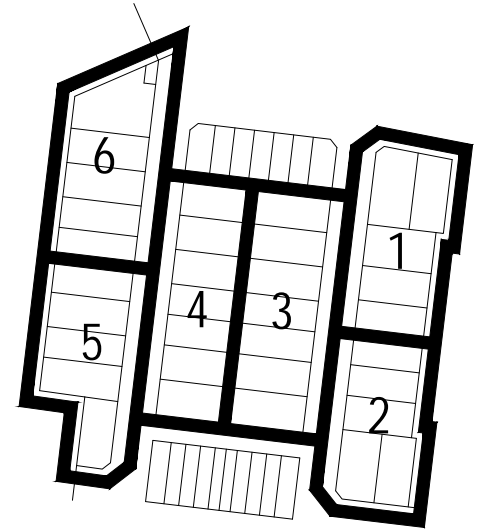
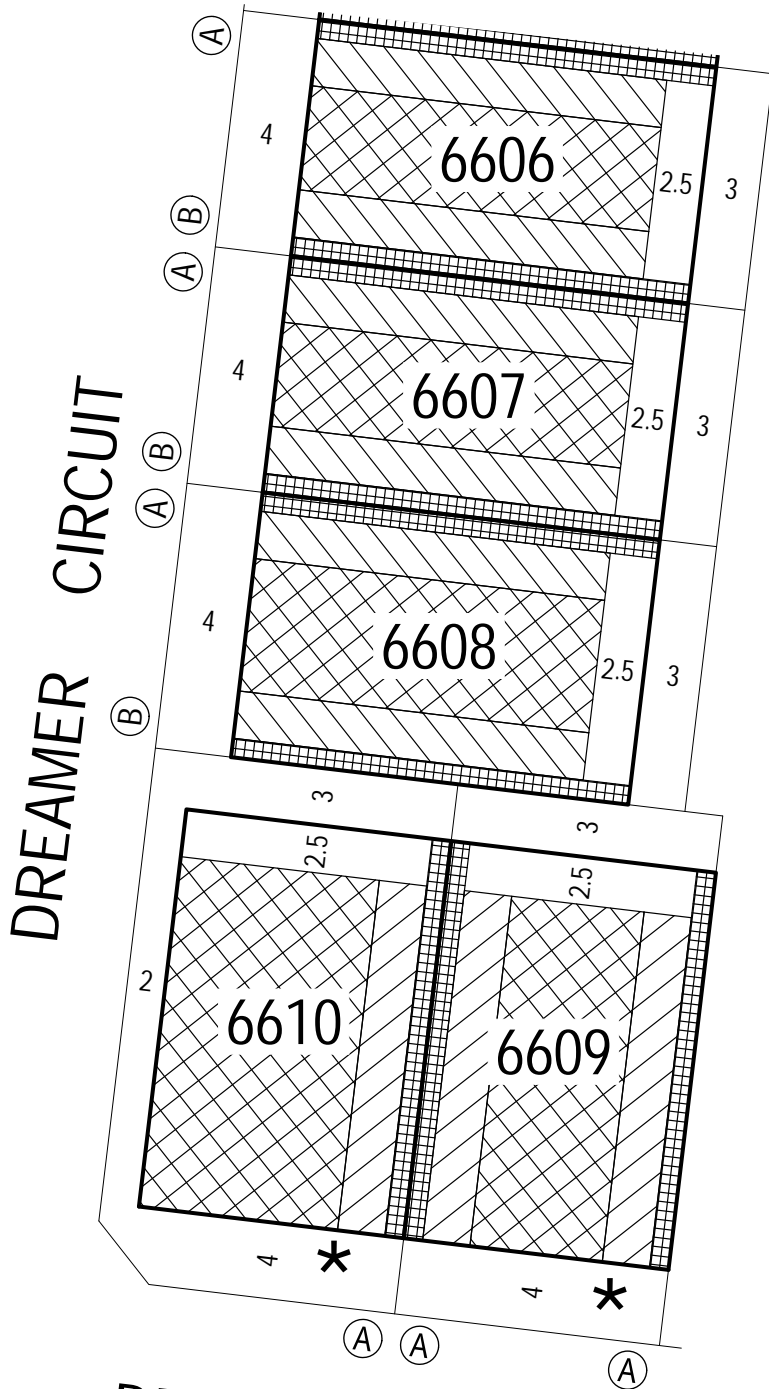

KEY TO SHEETS

NOTATIONS

- Single Storey Building Envelope (height not exceeding 3.6m)
- Overlooking Zone - Habitable room windows/raised open spaces are a source of overlooking
- Non Overlooking Zone - Habitable room windows/raised open spaces are not a source of overlooking
- Building to Boundary Zone)
- Building Envelope Boundary Profile Type
- 6606** Lot number
- 3** Setback minimum required (if 0, a building can be constructed on the boundary provided that the building height and length requirements are met)
- *** The registered proprietor or proprietors for the time being of lots identified thus must not build or permit to be built any building(s) that does not provide 1.0 metre clear horizontal access along the full length of a minimum one side boundary of the lot.

This Building Envelope Plan is to be read in conjunction with the associated Building Envelope Profiles and Design Guidelines. The registered proprietor/s of the lot are required to build in accordance with building envelopes shown hereon and in the "Profile Diagrams" in sheet 7.

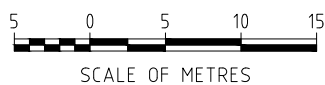

ARMSTRONG Mt DUNED

BUILDING ENVELOPE PLAN
STAGE 66

66 / 2
stage sheet

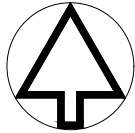

MGA ZONE 55

Detailed design of roads, driveways and footpaths is provided in the relevant Engineering Plans.



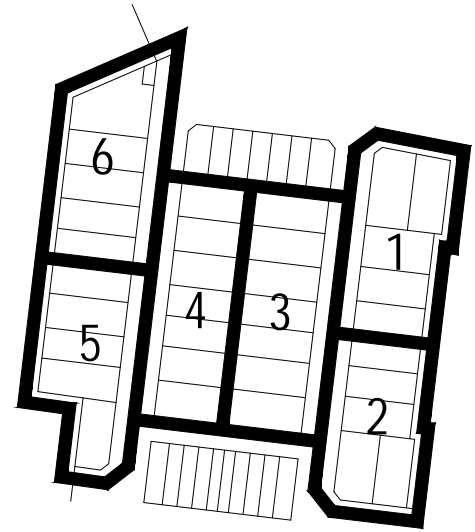
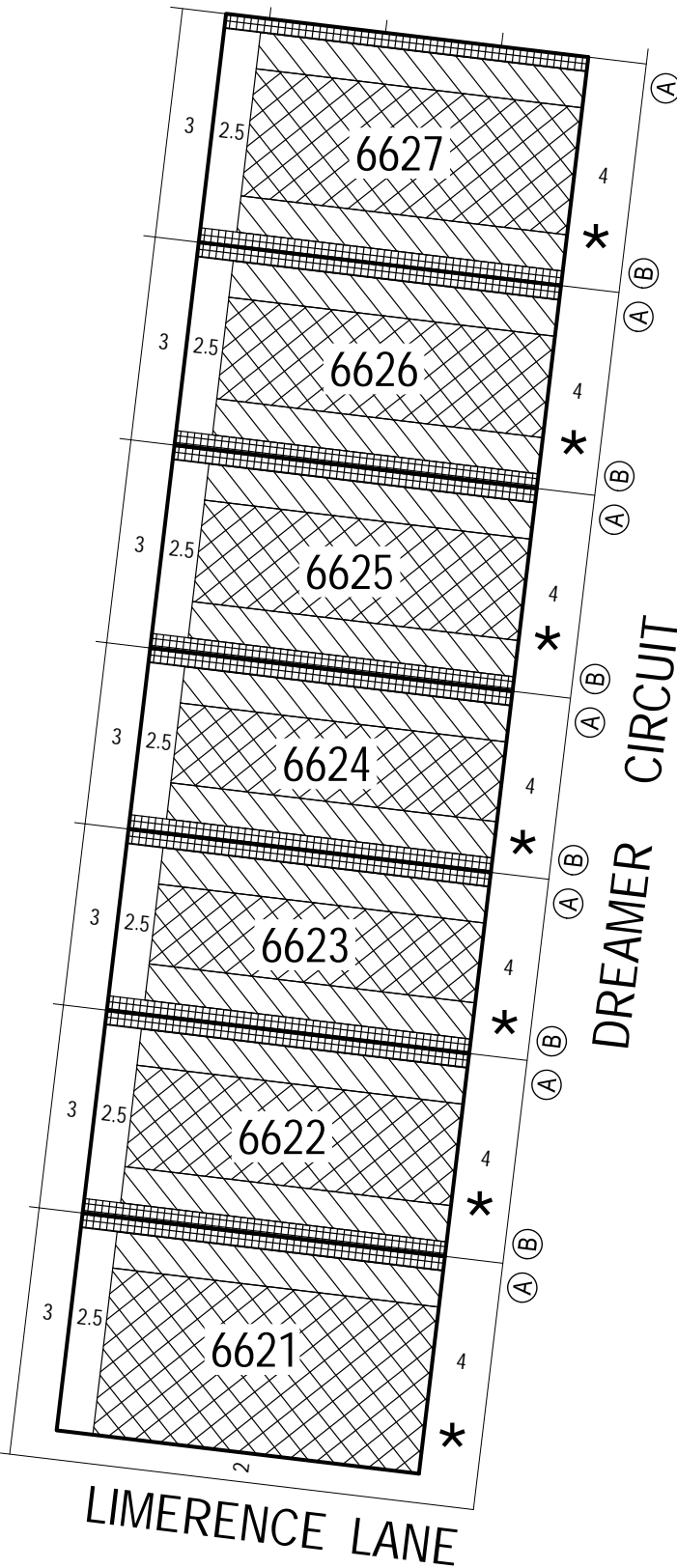

Detailed design of landscape works is provided in the relevant Landscape Plans.

All details subject to City of Greater Geelong Council approval.

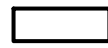
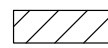

KEY TO SHEETS

NOTATIONS

-  Single Storey Building Envelope (height not exceeding 3.6m)
-  Overlooking Zone - Habitable room windows/raised open spaces are a source of overlooking
-  Non Overlooking Zone - Habitable room windows/raised open spaces are not a source of overlooking
-  Building to Boundary Zone)
-  Building Envelope Boundary Profile Type
- 6606** Lot number
- 3** Setback minimum required (if 0, a building can be constructed on the boundary provided that the building height and length requirements are met)
- *** The registered proprietor or proprietors for the time being of lots identified thus must not build or permit to be built any building(s) that does not provide 1.0 metre clear horizontal access along the full length of a minimum one side boundary of the lot.

This Building Envelope Plan is to be read in conjunction with the associated Building Envelope Profiles and Design Guidelines. The registered proprietor/s of the lot are required to build in accordance with building envelopes shown hereon and in the "Profile Diagrams" in sheet 7.

ARMSTRONG Mt DUNED

BUILDING ENVELOPE PLAN
STAGE 66

66 / 3

stage sheet

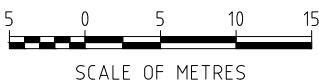



MGA ZONE 55

Detailed design of roads, driveways and footpaths is provided in the relevant Engineering Plans.



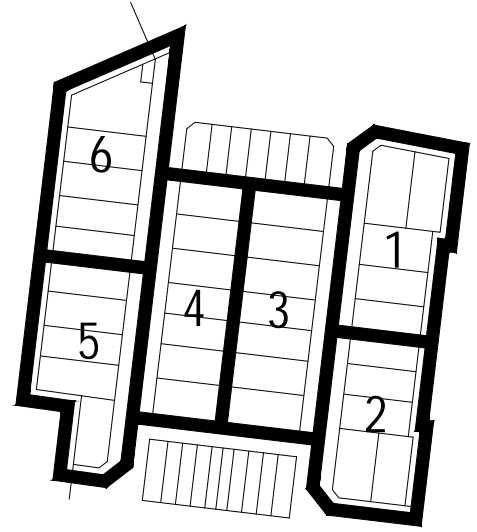
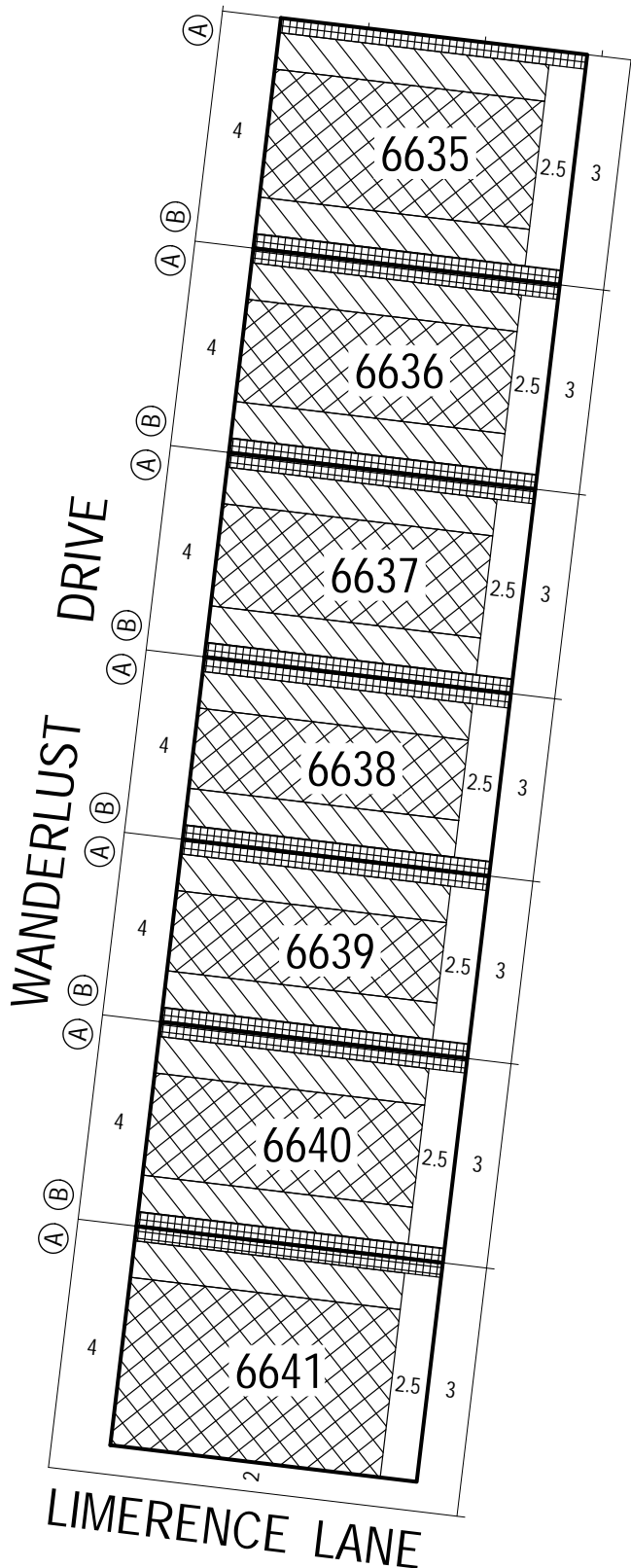

Detailed design of landscape works is provided in the relevant Landscape Plans.

All details subject to City of Greater Geelong Council approval.

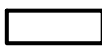
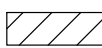

KEY TO SHEETS

NOTATIONS

-  Single Storey Building Envelope (height not exceeding 3.6m)
-  Overlooking Zone - Habitable room windows/raised open spaces are a source of overlooking
-  Non Overlooking Zone - Habitable room windows/raised open spaces are not a source of overlooking
-  Building to Boundary Zone)
-  Building Envelope Boundary Profile Type
- 6606** Lot number
- 3** Setback minimum required (if 0, a building can be constructed on the boundary provided that the building height and length requirements are met)
- *** The registered proprietor or proprietors for the time being of lots identified thus must not build or permit to be built any building(s) that does not provide 1.0 metre clear horizontal access along the full length of a minimum one side boundary of the lot.

This Building Envelope Plan is to be read in conjunction with the associated Building Envelope Profiles and Design Guidelines.

The registered proprietor/s of the lot are required to build in accordance with building envelopes shown hereon and in the "Profile Diagrams" in sheet 7.

ARMSTRONG Mt DUNED

BUILDING ENVELOPE PLAN
STAGE 66

66 / 4
stage sheet



SCALE OF METRES



MGA ZONE 55

Detailed design of roads, driveways and footpaths is provided in the relevant Engineering Plans.

Detailed design of landscape works is provided in the relevant Landscape Plans.

All details subject to City of Greater Geelong Council approval.

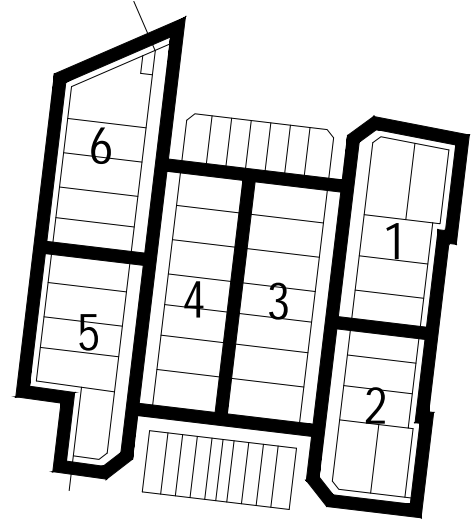
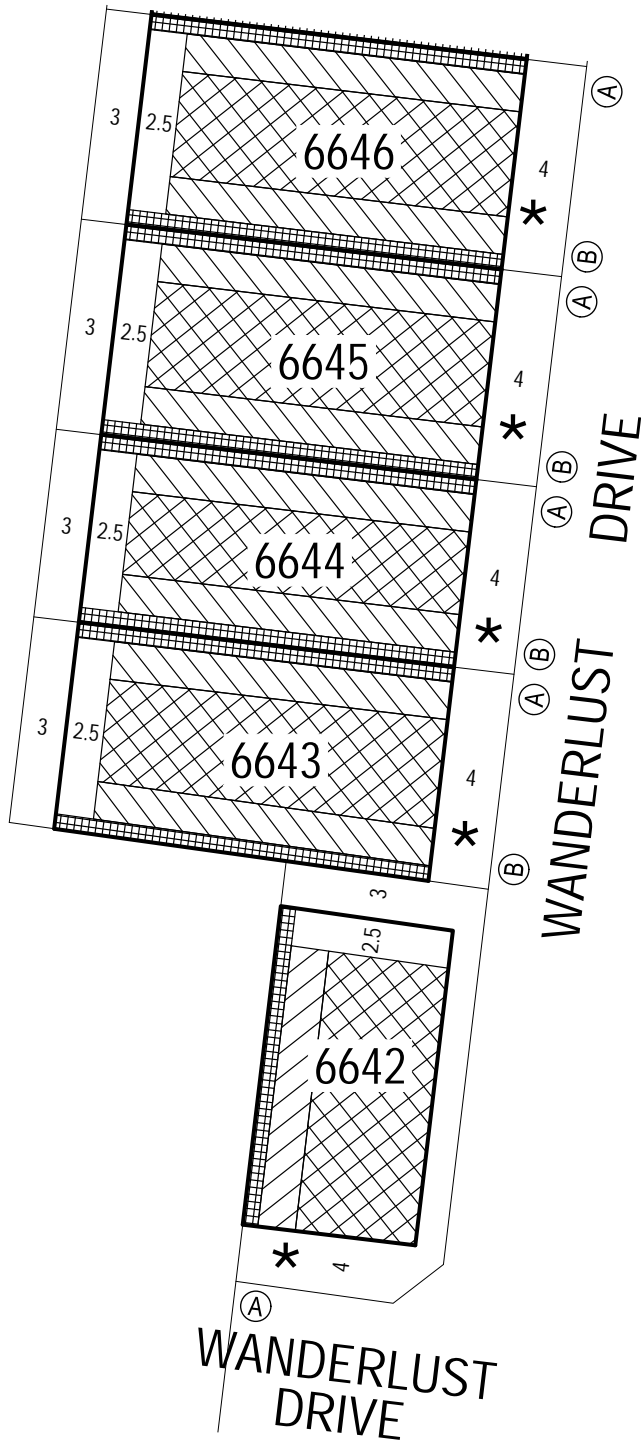

KEY TO SHEETS

NOTATIONS

- Single Storey Building Envelope (height not exceeding 3.6m)
- Overlooking Zone - Habitable room windows/raised open spaces are a source of overlooking
- Non Overlooking Zone - Habitable room windows/raised open spaces are not a source of overlooking
- Building to Boundary Zone)
- Building Envelope Boundary Profile Type
- 6606** Lot number
- 3** Setback minimum required (if 0, a building can be constructed on the boundary provided that the building height and length requirements are met)
- *** The registered proprietor or proprietors for the time being of lots identified thus must not build or permit to be built any building(s) that does not provide 1.0 metre clear horizontal access along the full length of a minimum one side boundary of the lot.

This Building Envelope Plan is to be read in conjunction with the associated Building Envelope Profiles and Design Guidelines. The registered proprietor/s of the lot are required to build in accordance with building envelopes shown hereon and in the "Profile Diagrams" in sheet 7.

ARMSTRONG Mt DUNED

BUILDING ENVELOPE PLAN
STAGE 66

66 / 5
stage sheet

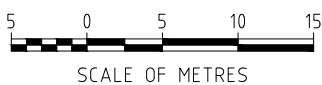

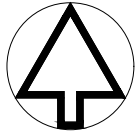

MGA ZONE 55

Detailed design of roads, driveways and footpaths is provided in the relevant Engineering Plans.



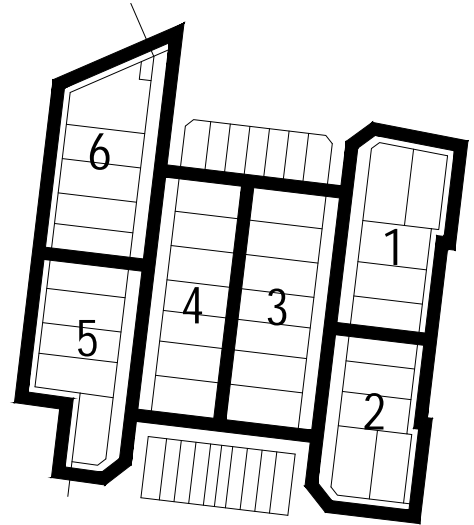
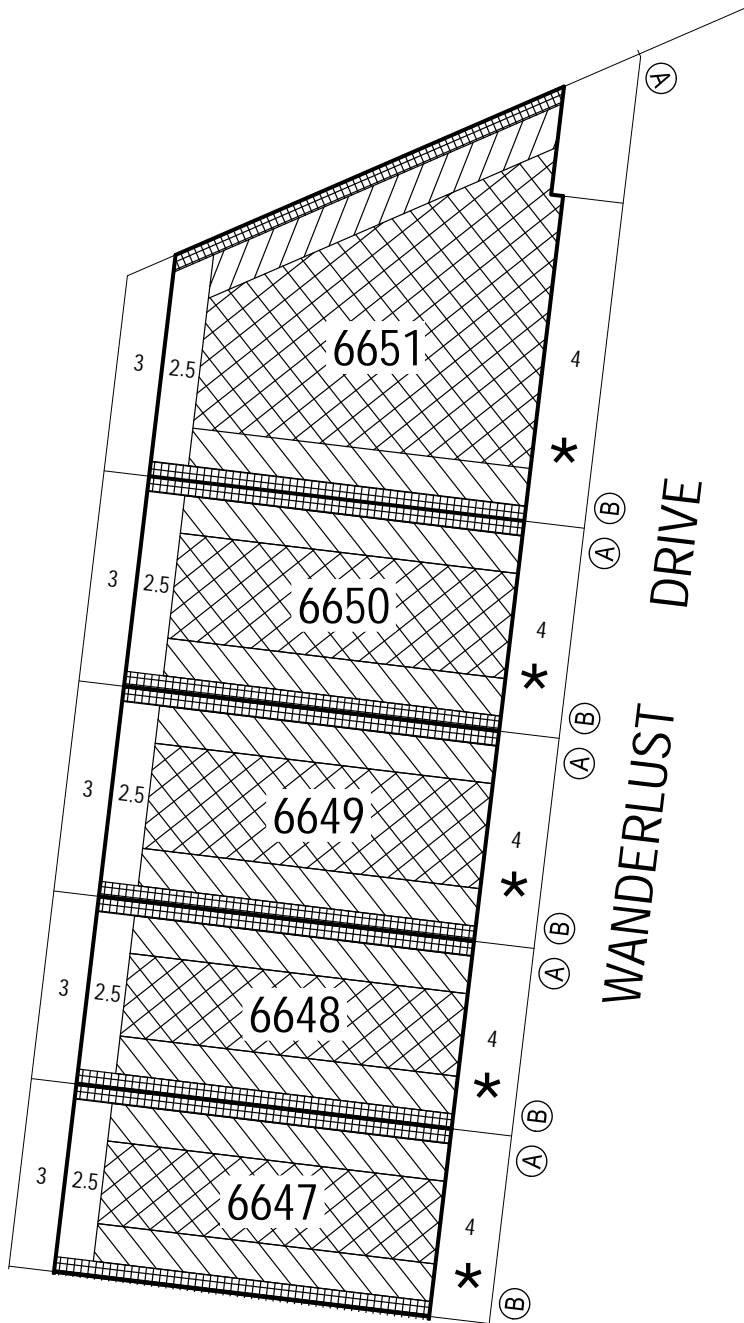

Detailed design of landscape works is provided in the relevant Landscape Plans.

All details subject to City of Greater Geelong Council approval.

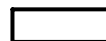
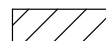

KEY TO SHEETS

NOTATIONS

-  Single Storey Building Envelope (height not exceeding 3.6m)
-  Overlooking Zone - Habitable room windows/raised open spaces are a source of overlooking
-  Non Overlooking Zone - Habitable room windows/raised open spaces are not a source of overlooking
-  Building to Boundary Zone)
-  Building Envelope Boundary Profile Type
- 6606** Lot number
- 3** Setback minimum required (if 0, a building can be constructed on the boundary provided that the building height and length requirements are met)
- *** The registered proprietor or proprietors for the time being of lots identified thus must not build or permit to be built any building(s) that does not provide 1.0 metre clear horizontal access along the full length of a minimum one side boundary of the lot.

This Building Envelope Plan is to be read in conjunction with the associated Building Envelope Profiles and Design Guidelines.

The registered proprietor/s of the lot are required to build in accordance with building envelopes shown hereon and in the "Profile Diagrams" in sheet 7.

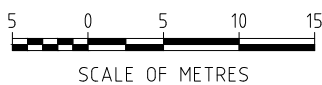

ARMSTRONG Mt DUNED

BUILDING ENVELOPE PLAN
STAGE 66

66 / 6
stage sheet

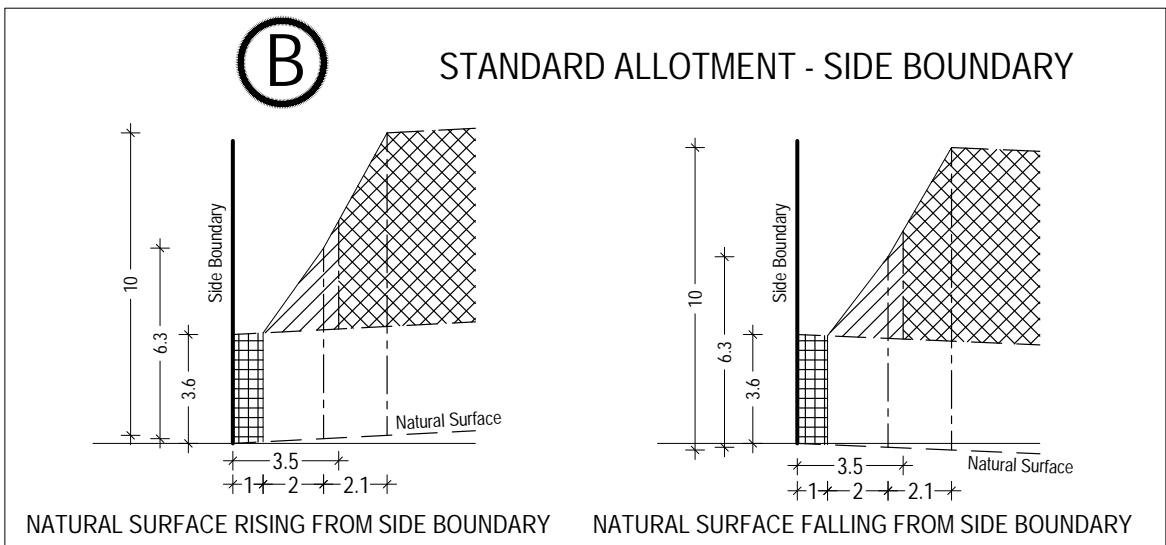
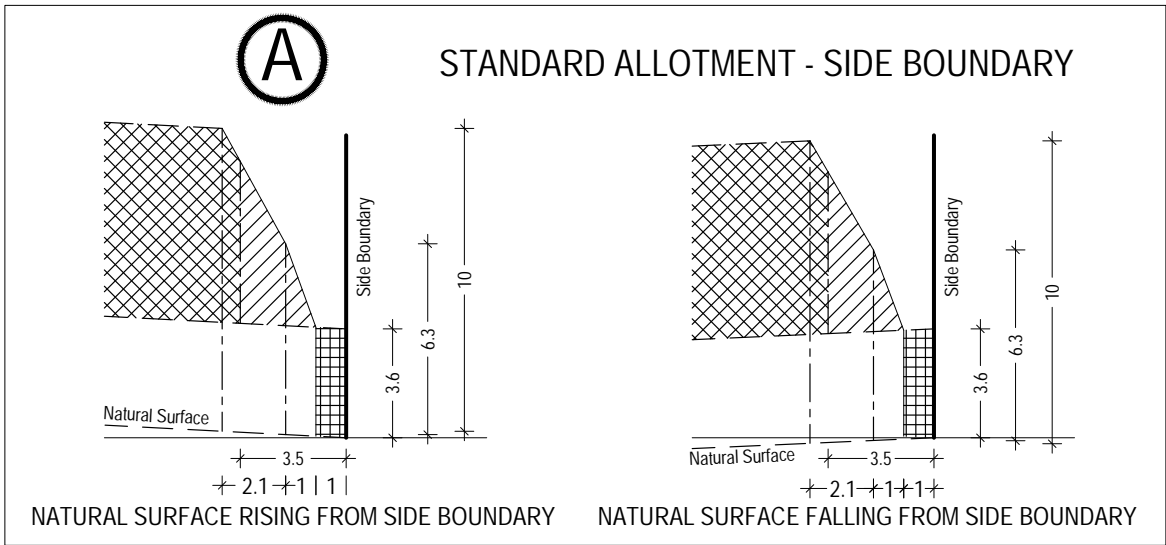

SCALE 1:250@A4

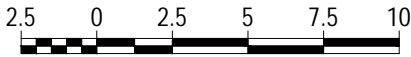

ARMSTRONG Mt DUNEED

BUILDING ENVELOPE PROFILES
STAGE 66

66 / 17
stage sheet

 Single Storey Building Envelope

 Non Overlooking Zone
Habitable room windows/raised open spaces are not a source of overlooking

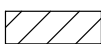
 Overlooking Zone
Habitable room windows/raised open spaces are a source of overlooking

 Building to Boundary Zone

sheet 7 of 7

March 2021
Version:C