

**KEY TO SHEETS**

REFER TO SHEETS  
1 TO 5  
FOR DETAIL

**ARMSTRONG Mt DUNEED**

BUILDING ENVELOPE PLAN  
STAGE 65B

December 2020  
Version:C

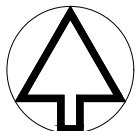

MGA ZONE 55

Detailed design of roads, driveways and footpaths is provided in the relevant Engineering Plans.

Detailed design of landscape works is provided in the relevant Landscape Plans.

All details subject to City of Greater Geelong Council approval.

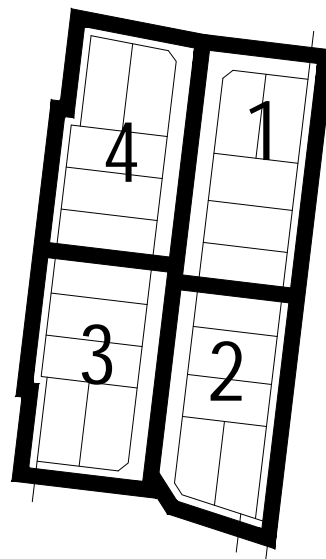

KEY TO SHEETS

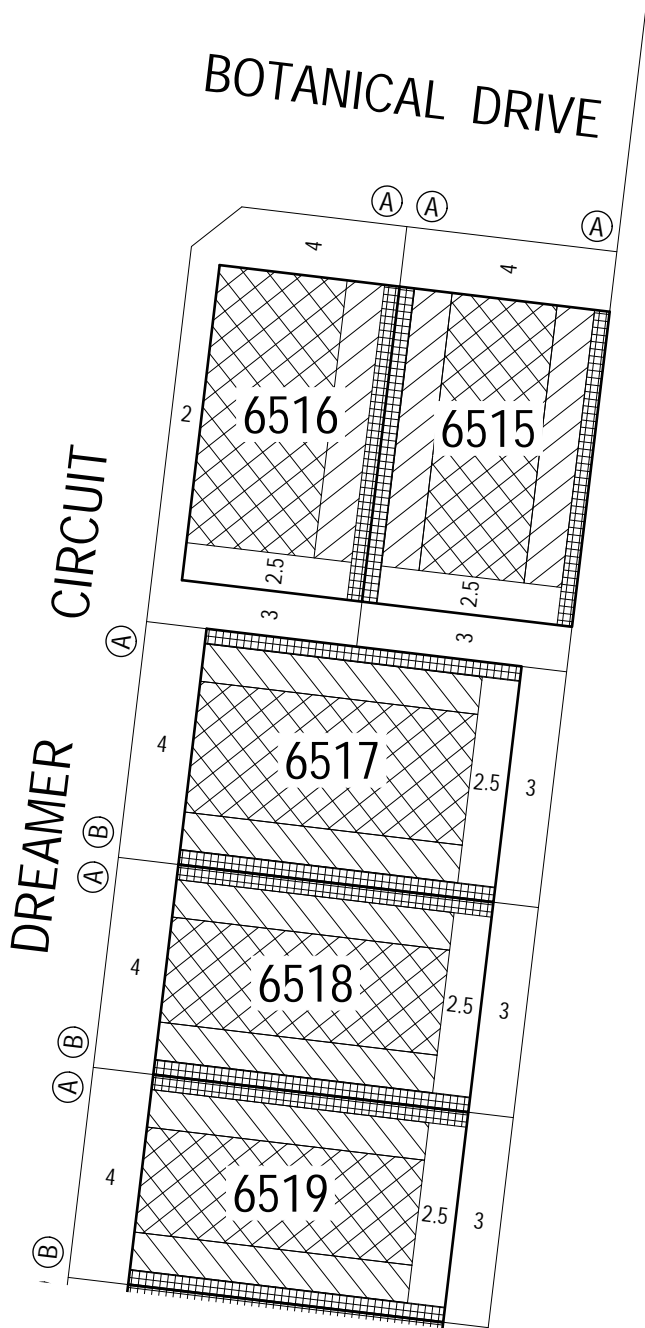

NOTATIONS

- Single Storey Building Envelope (height not exceeding 3.6m)
- Overlooking Zone - Habitable room windows/raised open spaces are a source of overlooking
- Non Overlooking Zone - Habitable room windows/raised open spaces are not a source of overlooking
- Building to Boundary Zone)
- Building Envelope Boundary Profile Type
- 6515** Lot number
- 3** Setback minimum required (if 0, a building can be constructed on the boundary provided that the building height and length requirements are met)

This Building Envelope Plan is to be read in conjunction with the associated Building Envelope Profiles and Design Guidelines. The registered proprietor/s of the lot are required to build in accordance with building envelopes shown hereon and in the "Profile Diagrams" in sheet 5.

ARMSTRONG Mt DUNED

BUILDING ENVELOPE PLAN  
STAGE 65B

**65B / 1**

stage sheet

Sheet 1 of 5 December 2020  
Version: C





Detailed design of roads, driveways and footpaths is provided in the relevant Engineering Plans.



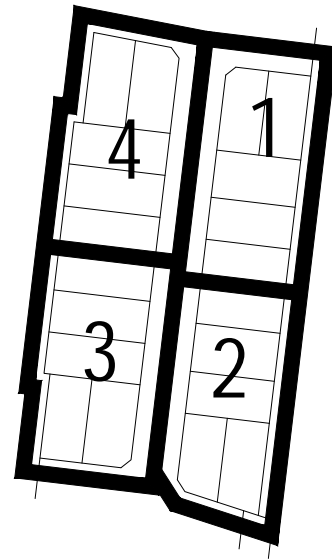
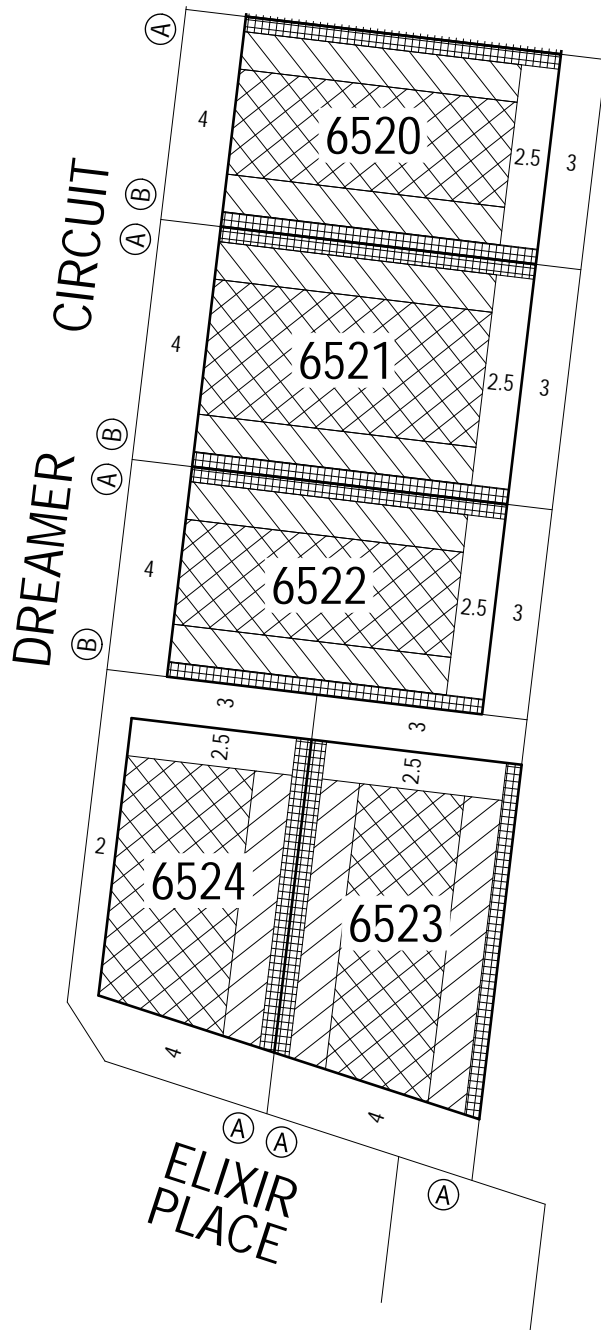

Detailed design of landscape works is provided in the relevant Landscape Plans.

All details subject to City of Greater Geelong Council approval.

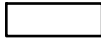
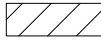

KEY TO SHEETS

NOTATIONS

-  Single Storey Building Envelope (height not exceeding 3.6m)
-  Overlooking Zone - Habitable room windows/raised open spaces are a source of overlooking
-  Non Overlooking Zone - Habitable room windows/raised open spaces are not a source of overlooking
-  Building to Boundary Zone)
-  Building Envelope Boundary Profile Type
- 6515 Lot number
- 3 Setback minimum required (if 0, a building can be constructed on the boundary provided that the building height and length requirements are met)

This Building Envelope Plan is to be read in conjunction with the associated Building Envelope Profiles and Design Guidelines. The registered proprietor/s of the lot are required to build in accordance with building envelopes shown hereon and in the "Profile Diagrams" in sheet 5.

ARMSTRONG Mt DUNED

BUILDING ENVELOPE PLAN  
STAGE 65B

65B / 2  
stage sheet





Detailed design of roads, driveways and footpaths is provided in the relevant Engineering Plans.



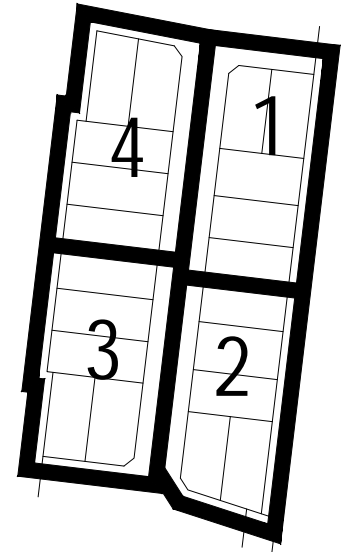

Detailed design of landscape works is provided in the relevant Landscape Plans.

All details subject to City of Greater Geelong Council approval.

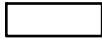

KEY TO SHEETS

NOTATIONS

-  Single Storey Building Envelope (height not exceeding 3.6m)
-  Overlooking Zone - Habitable room windows/raised open spaces are a source of overlooking
-  Non Overlooking Zone - Habitable room windows/raised open spaces are not a source of overlooking
-  Building to Boundary Zone)
-  Building Envelope Boundary Profile Type
- 6505** Lot number
- 3** Setback minimum required (if 0, a building can be constructed on the boundary provided that the building height and length requirements are met)

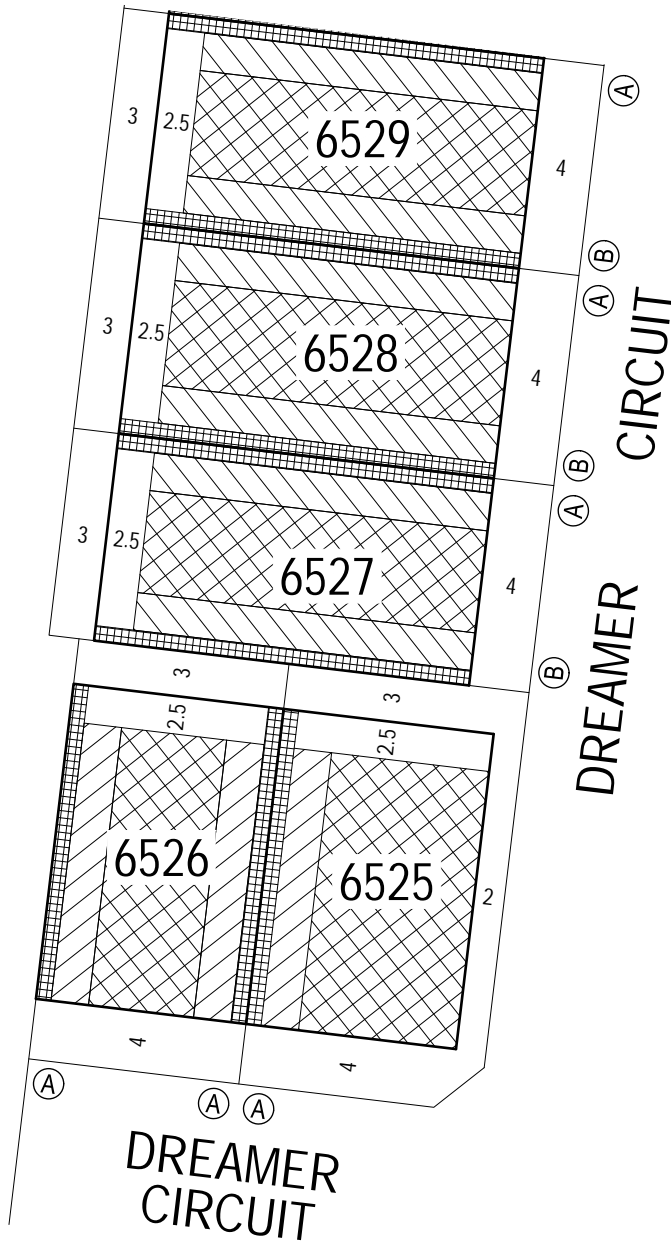

This Building Envelope Plan is to be read in conjunction with the associated Building Envelope Profiles and Design Guidelines. The registered proprietor/s of the lot are required to build in accordance with building envelopes shown hereon and in the "Profile Diagrams" in sheet 5.

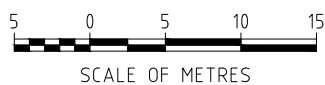

ARMSTRONG Mt DUNED

BUILDING ENVELOPE PLAN  
STAGE 65B

**65B / 3**  
stage sheet



Detailed design of roads, driveways and footpaths is provided in the relevant Engineering Plans.



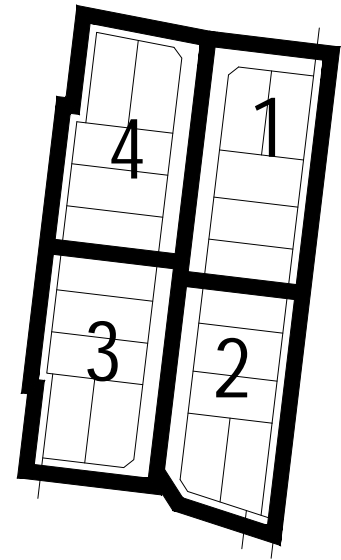
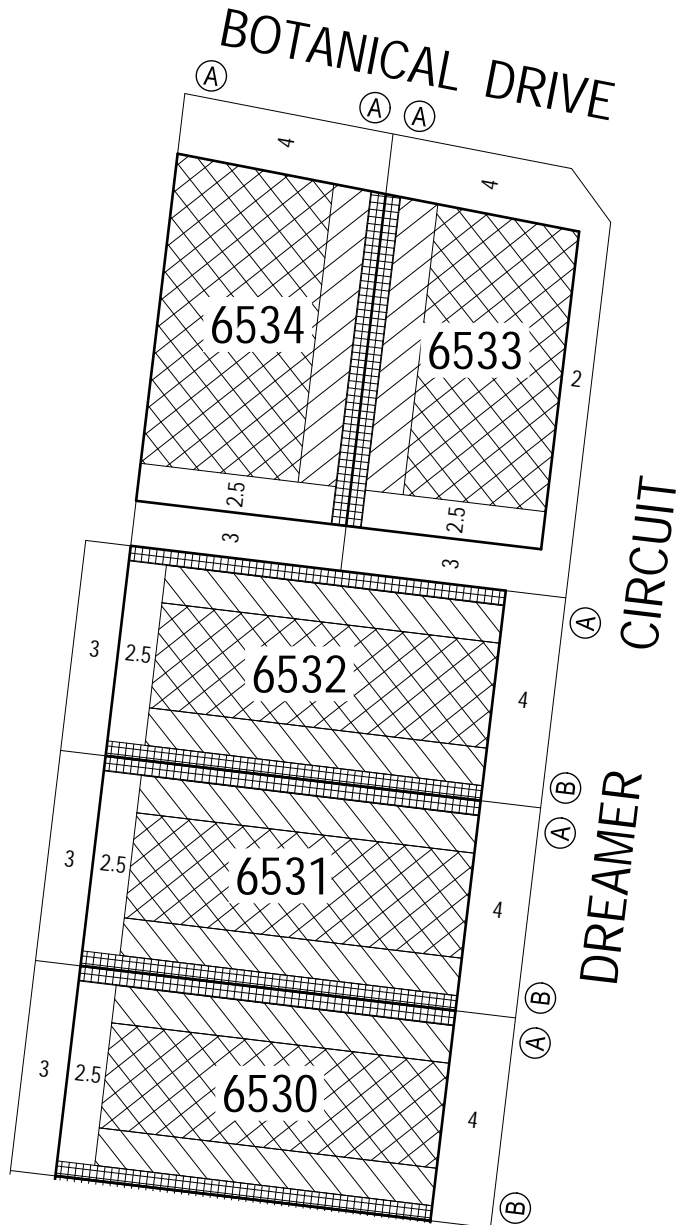

Detailed design of landscape works is provided in the relevant Landscape Plans.

All details subject to City of Greater Geelong Council approval.

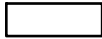
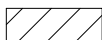

KEY TO SHEETS

NOTATIONS

-  Single Storey Building Envelope (height not exceeding 3.6m)
-  Overlooking Zone - Habitable room windows/raised open spaces are a source of overlooking
-  Non Overlooking Zone - Habitable room windows/raised open spaces are not a source of overlooking
-  Building to Boundary Zone)
-  Building Envelope Boundary Profile Type
- 6515** Lot number
- 3** Setback minimum required (if 0, a building can be constructed on the boundary provided that the building height and length requirements are met)

This Building Envelope Plan is to be read in conjunction with the associated Building Envelope Profiles and Design Guidelines. The registered proprietor/s of the lot are required to build in accordance with building envelopes shown hereon and in the "Profile Diagrams" in sheet 5.

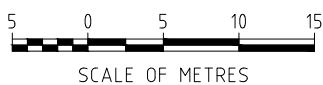

ARMSTRONG Mt DUNED

BUILDING ENVELOPE PLAN  
STAGE 65B

**65B/4**  
stage sheet

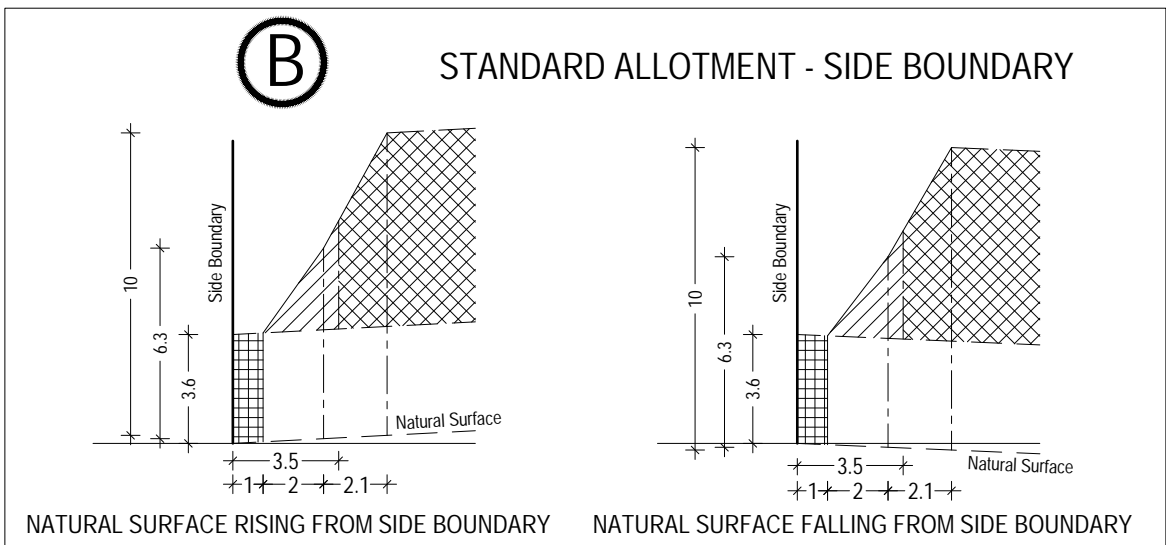
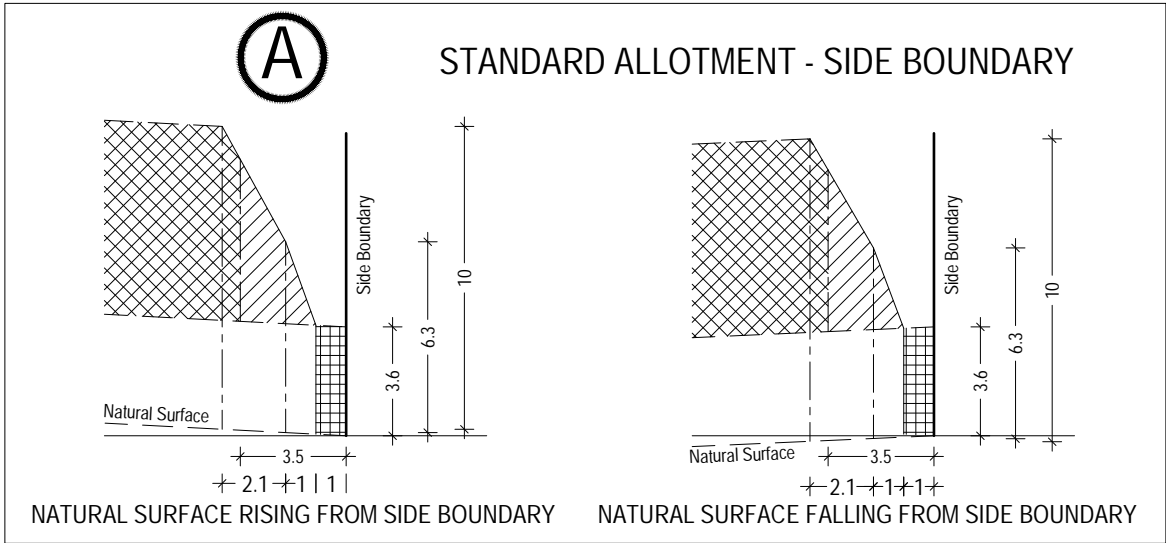

SCALE 1:250@A4

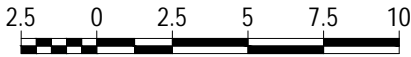

## ARMSTRONG Mt DUNEED

BUILDING ENVELOPE PROFILES  
STAGE 65B

**65B / 5**  
stage                      sheet

 Single Storey Building Envelope

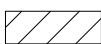

Non Overlooking Zone  
Habitable room windows/raised open spaces are not a source of overlooking

 Overlooking Zone  
Habitable room windows/raised open spaces are a source of overlooking



Building to Boundary Zone

sheet 5 of 5

December 2020  
Version:C