

- 2 metre wide easement
- - - - - 2.5 metre wide easement
- 3 metre wide easement

## KEY TO SHEETS

REFER TO SHEETS  
1 TO 3  
FOR DETAIL

## ARMSTRONG Mt DUNEED

BUILDING ENVELOPE PLAN  
STAGE 65A

August 2020  
Version: A



Detailed design of roads, driveways and footpaths is provided in the relevant Engineering Plans.

Detailed design of landscape works is provided in the relevant Landscape Plans.

All details subject to City of Greater Geelong Council approval.

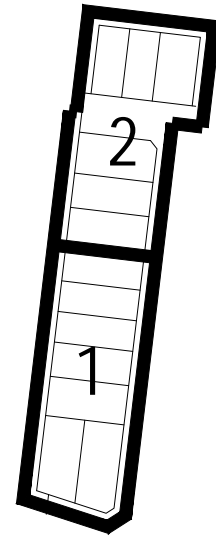
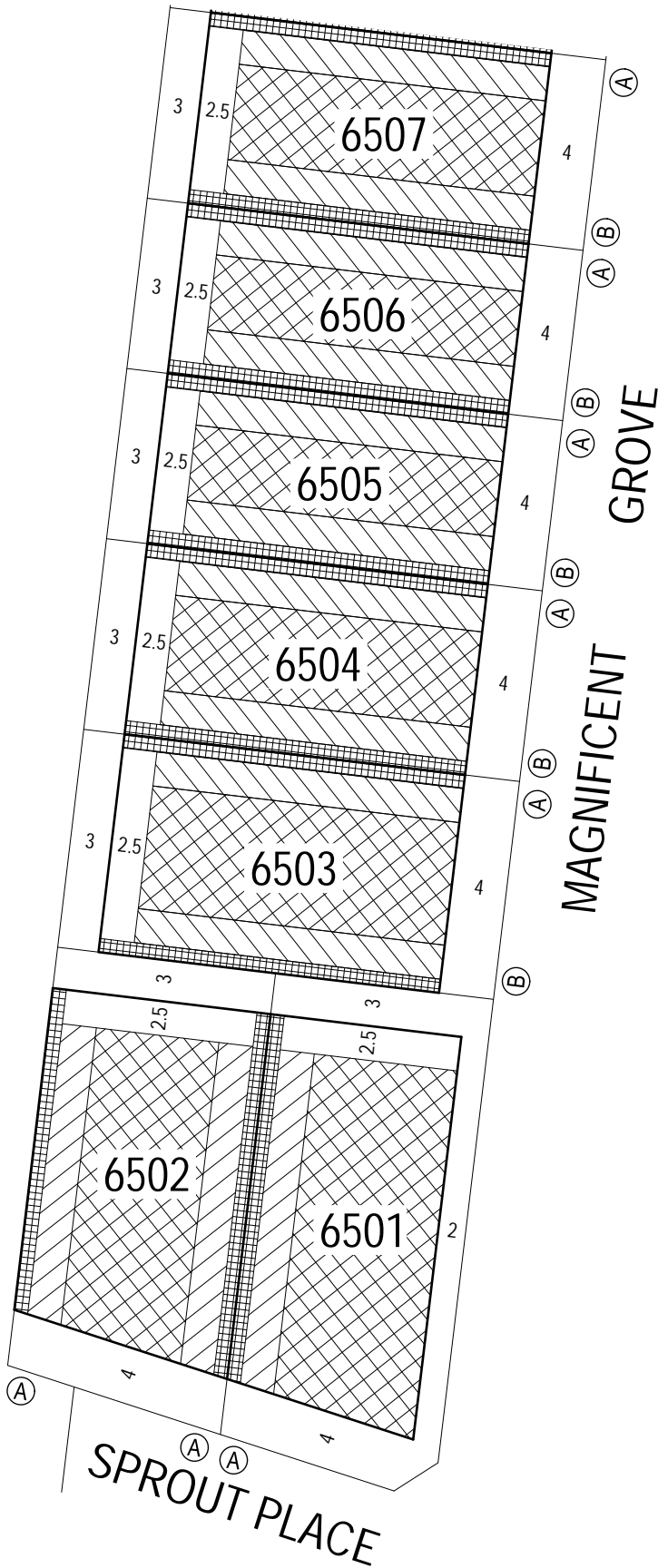

## KEY TO SHEETS

### NOTATIONS

	Single Storey Building Envelope (height not exceeding 3.6m)
	Overlooking Zone - Habitable room windows/raised open spaces are a source of overlooking
	Non Overlooking Zone - Habitable room windows/raised open spaces are not a source of overlooking
	Building to Boundary Zone)
	Building Envelope Boundary Profile Type
6505	Lot number
3	Setback minimum required (if 0, a building can be constructed on the boundary provided that the building height and length requirements are met)

This Building Envelope Plan is to be read in conjunction with the associated Building Envelope Profiles and Design Guidelines.

The registered proprietor/s of the lot are required to build in accordance with building envelopes shown hereon and in the "Profile Diagrams" in sheet 3.

## ARMSTRONG Mt DUNED

BUILDING ENVELOPE PLAN  
STAGE 65A

**65A /1**  
stage sheet

Sheet 1 of 3

August 2020  
Version:A

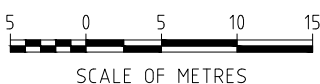



Detailed design of roads, driveways and footpaths is provided in the relevant Engineering Plans.

Detailed design of landscape works is provided in the relevant Landscape Plans.

All details subject to City of Greater Geelong Council approval.

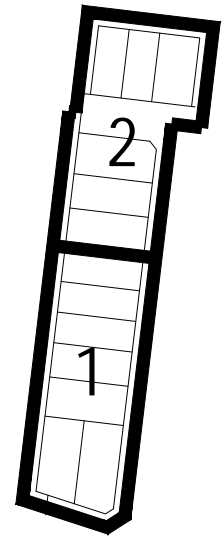
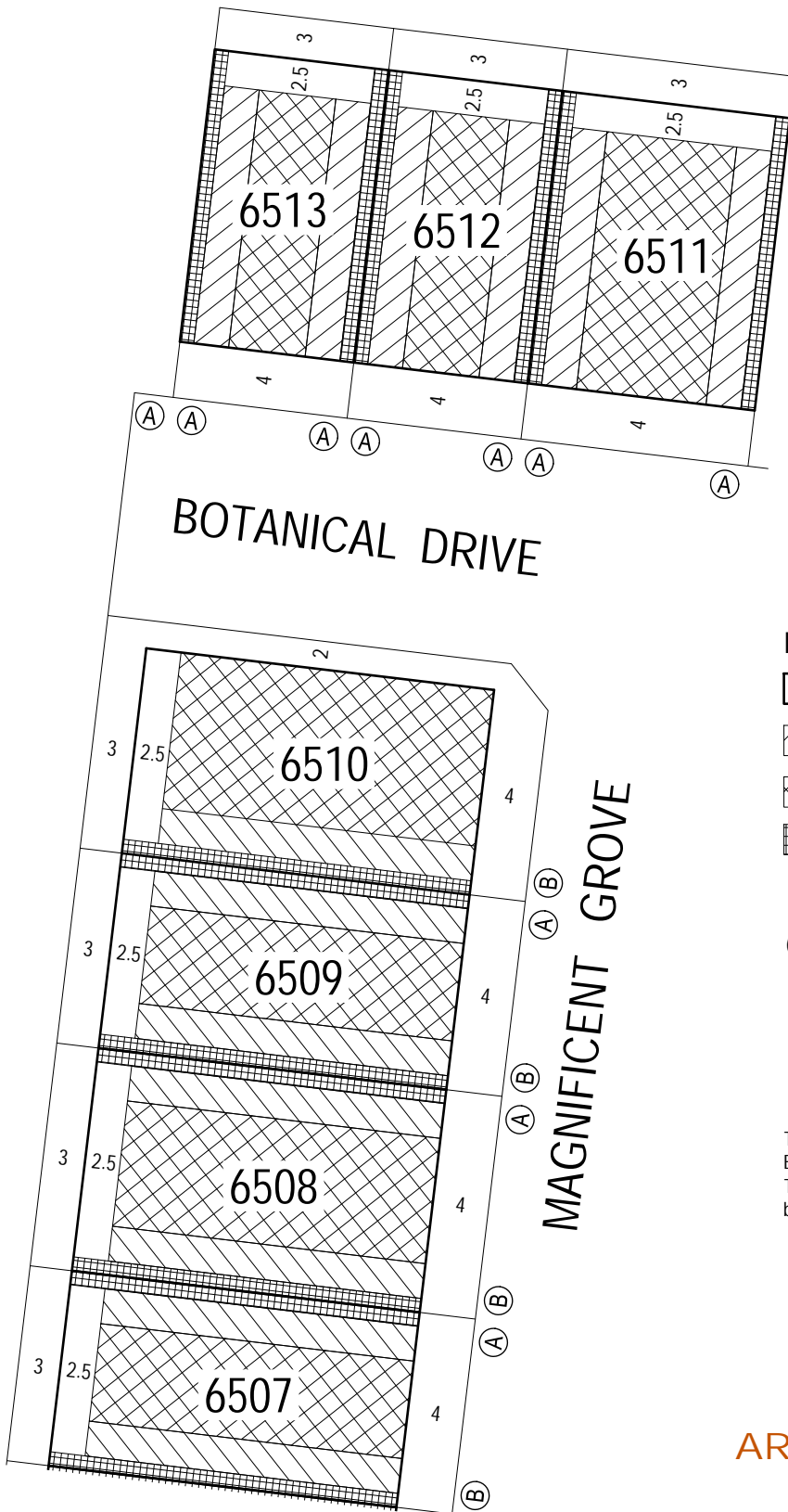

## KEY TO SHEETS

## NOTATIONS

	Single Storey Building Envelope (height not exceeding 3.6m)
	Overlooking Zone - Habitable room windows/raised open spaces are a source of overlooking
	Non Overlooking Zone - Habitable room windows/raised open spaces are not a source of overlooking
	Building to Boundary Zone)
	Building Envelope Boundary Profile Type
6505	Lot number
3	Setback minimum required (if 0, a building can be constructed on the boundary provided that the building height and length requirements are met)

This Building Envelope Plan is to be read in conjunction with the associated Building Envelope Profiles and Design Guidelines.  
The registered proprietor/s of the lot are required to build in accordance with building envelopes shown hereon and in the "Profile Diagrams" in sheet 3.

## ARMSTRONG Mt DUNED

BUILDING ENVELOPE PLAN  
STAGE 65A

**65A/2**  
stage sheet

Sheet 2 of 3

August 2020  
Version:A



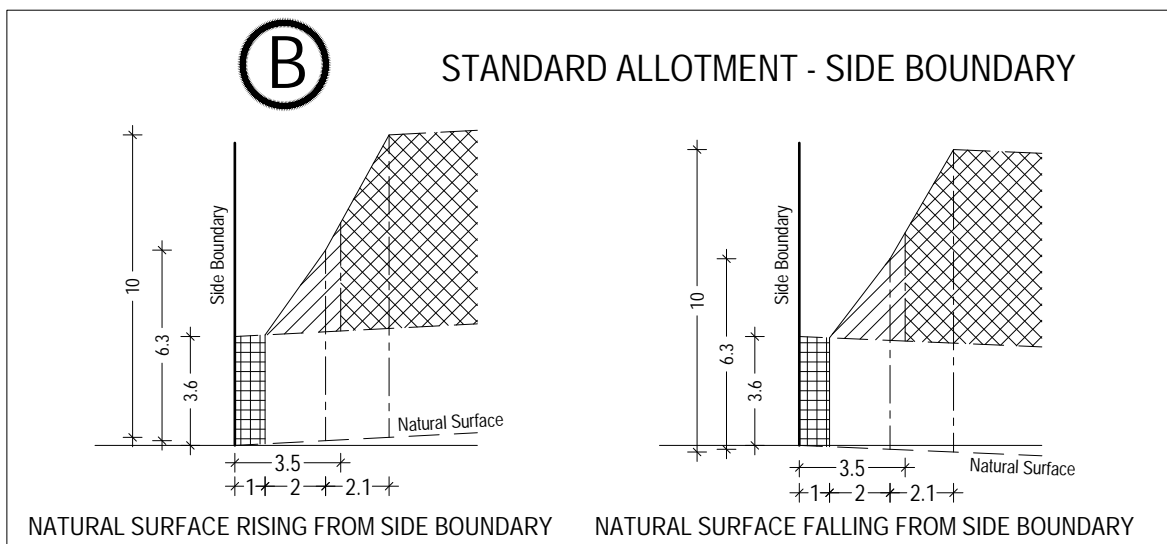
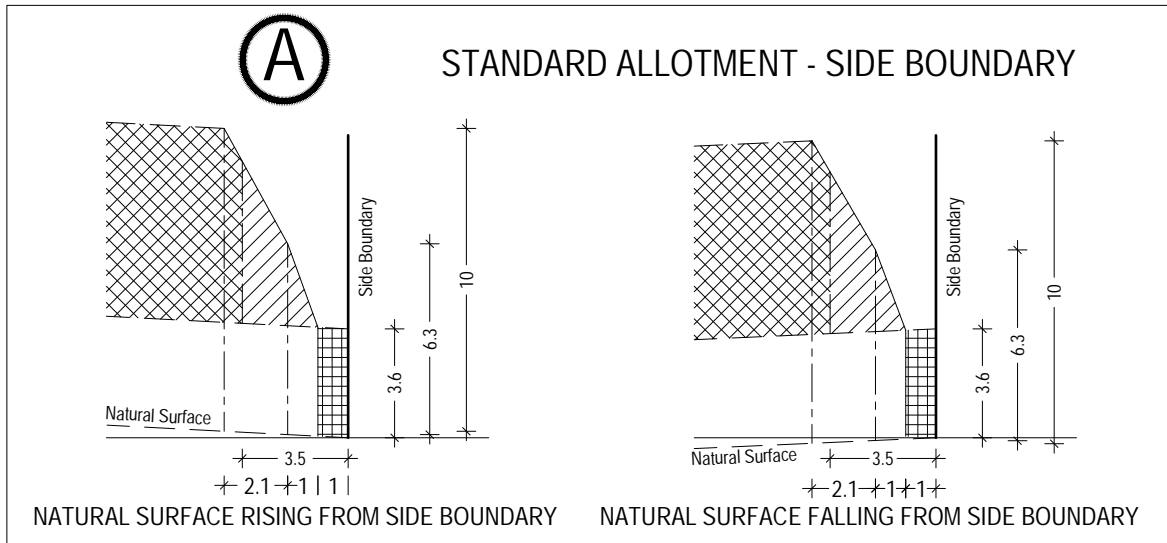

SCALE 1:250@A4

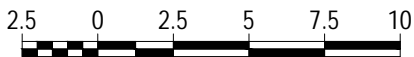

## ARMSTRONG Mt DUNEED

BUILDING ENVELOPE PROFILES  
STAGE 65A

**65A / 3**  
stage sheet

Single Storey Building Envelope

Overlooking Zone  
Habitable room windows/raised open spaces are a source of overlooking



Non Overlooking Zone  
Habitable room windows/raised open spaces are not a source of overlooking

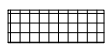

Building to Boundary Zone

Sheet 3 of 3

August 2020  
Version:A