

MGA ZONE 55

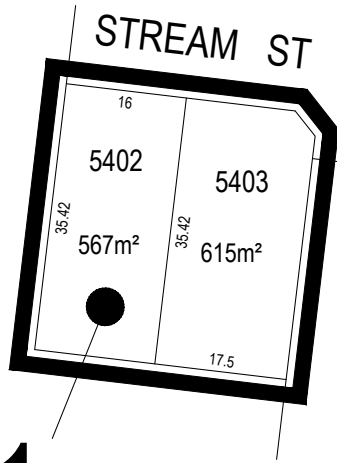

1

SOVEREIGN DRIVE

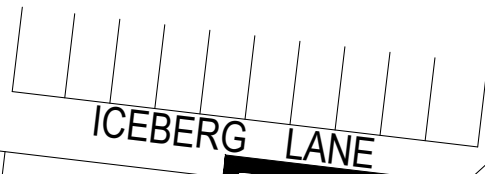

2

ICEBERG LANE

ELECTRIC CRESCENT

BOTANY

CIRCUIT

3

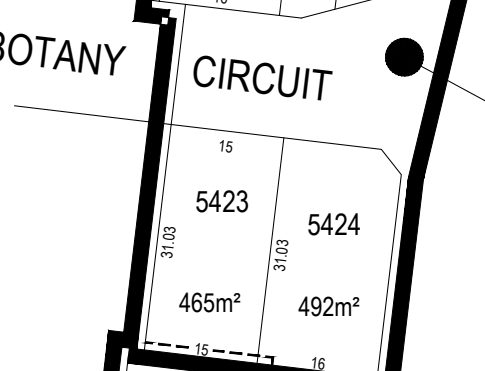

4

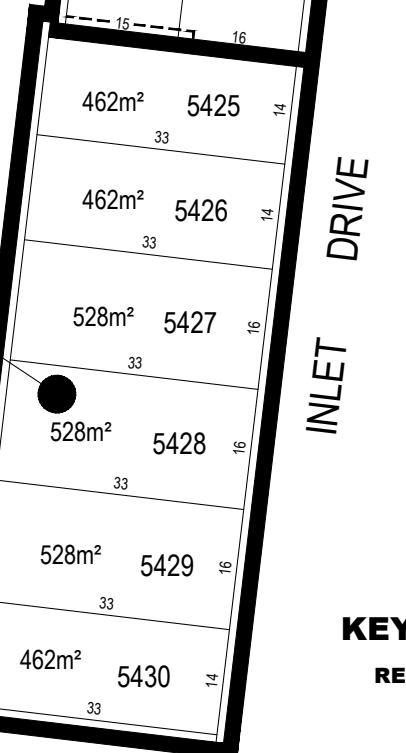

INLET DRIVE

- 2 or 2.5 metre wide easement
- - - - - 3 metre wide easement

ARMSTRONG Mt DUNED

**BUILDING ENVELOPE PLAN
STAGE 54**

January 2020
Version:G

KEY TO SHEETS

REFER TO SHEETS
1 TO 5
FOR DETAIL

This Building Envelope Plan is to be read in conjunction with the associated Building Envelope Profiles and Design Guidelines.
 The registered proprietor/s of the lot are required to build in accordance with building envelopes shown hereon and in the "Profile Diagrams" in sheet 5.

Detailed design of roads, driveways and footpaths is provided in the relevant Engineering Plans.

Detailed design of landscape works is provided in the relevant Landscape Plans.



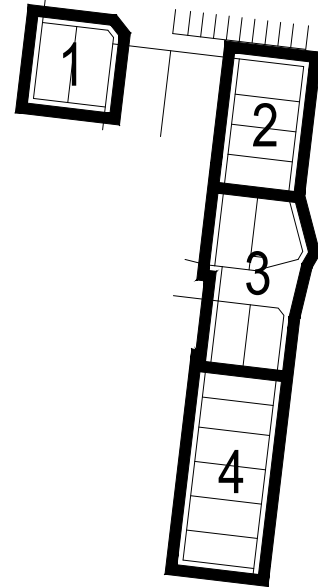

All details subject to City of Greater Geelong Council approval.

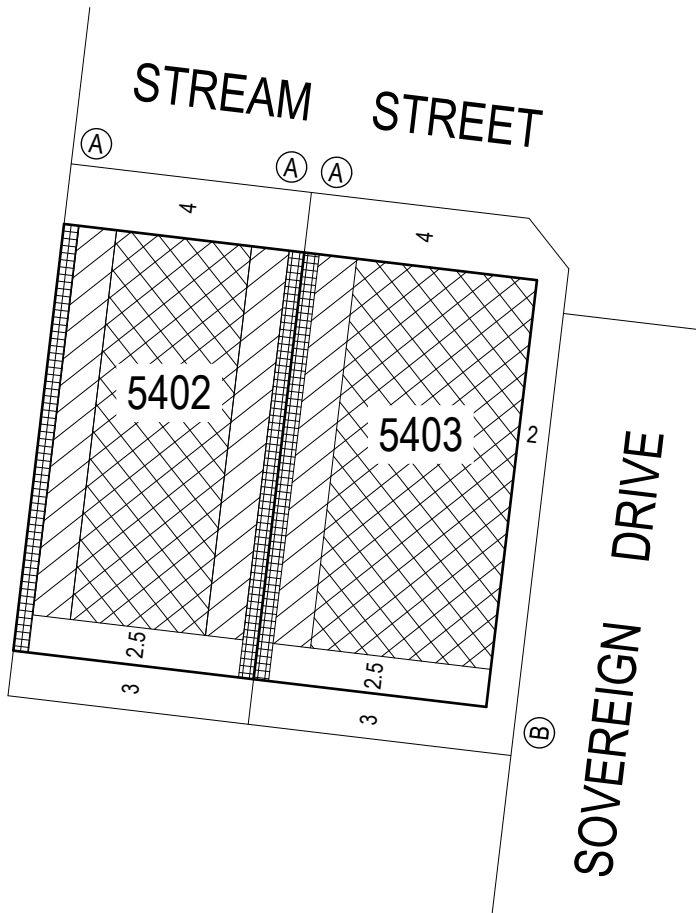

KEY TO SHEETS

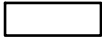

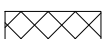
NOTATIONS

-  Single Storey Building Envelope (height not exceeding 3.6m)
-  Overlooking Zone - Habitable room windows/raised open spaces are a source of overlooking
-  Non Overlooking Zone - Habitable room windows/raised open spaces are not a source of overlooking
-  Building to Boundary Zone)
-  Building Envelope Boundary Profile Type
- 5403** Lot number
- 3** Setback minimum required (if 0, a building can be constructed on the boundary provided that the building height and length requirements are met)
- *** The registered proprietor or proprietors for the time being of lots identified thus must not build or permit to be built any building(s) that does not provide 1.0 metre clear horizontal access along the full length of a minimum one side boundary of the lot.





ARMSTRONG Mt DUNED

**BUILDING ENVELOPE PLAN
 STAGE 54**

54 / 1
 stage sheet



NOTATIONS

-  Single Storey Building Envelope (height not exceeding 3.6m)
-  Overlooking Zone - Habitable room windows/raised open spaces are a source of overlooking
-  Non Overlooking Zone - Habitable room windows/raised open spaces are not a source of overlooking
-  Building to Boundary Zone
-  Building Envelope Boundary Profile Type
- 5403** Lot number
- 3** Setback minimum required (if 0, a building can be constructed on the boundary provided that the building height and length requirements are met)
- *** The registered proprietor or proprietors for the time being of lots identified thus must not build or permit to be built any building(s) that does not provide 1.0 metre clear horizontal access along the full length of a minimum one side boundary of the lot.



MGA ZONE 55

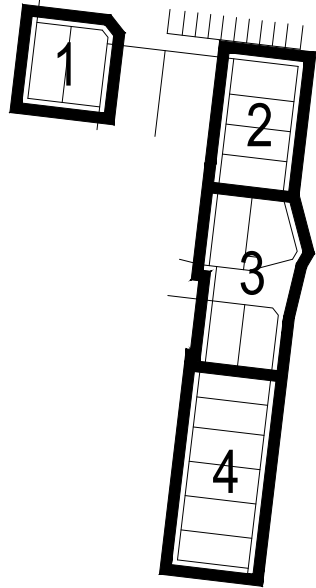

KEY TO SHEETS

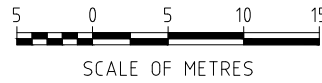

This Building Envelope Plan is to be read in conjunction with the associated Building Envelope Profiles and Design Guidelines.
 The registered proprietor/s of the lot are required to build in accordance with building envelopes shown hereon and in the "Profile Diagrams" in sheet 5.

Detailed design of roads, driveways and footpaths is provided in the relevant Engineering Plans.
 Detailed design of landscape works is provided in the relevant Landscape Plans.
 All details subject to City of Greater Geelong Council approval.

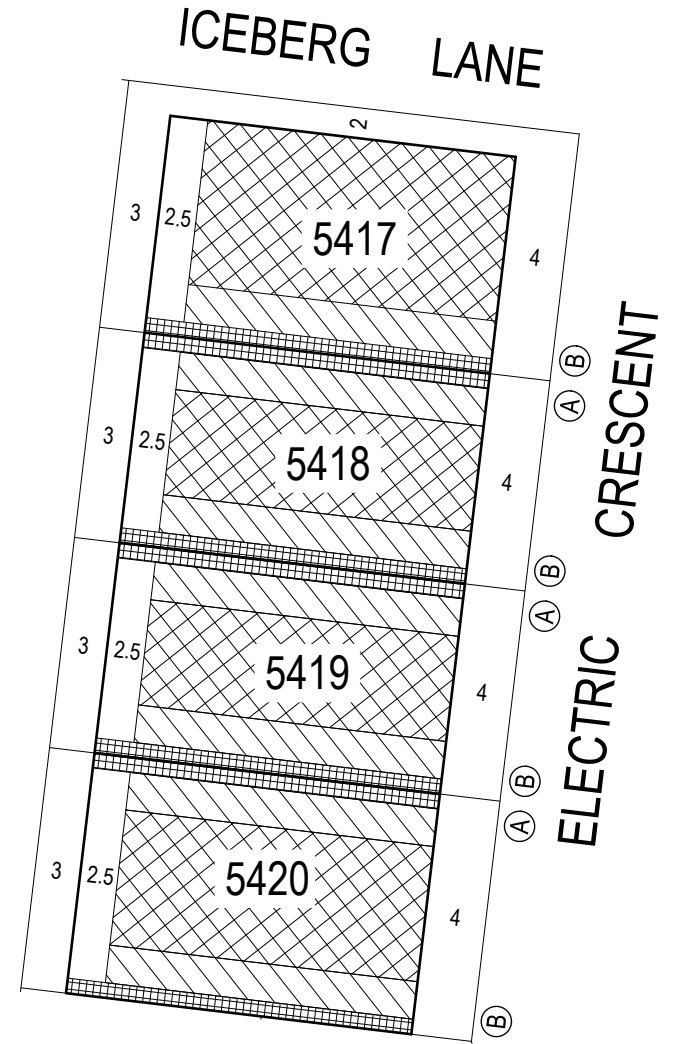

ARMSTRONG Mt DUNED

**BUILDING ENVELOPE PLAN
 STAGE 54**

54/2
 stage sheet



MGA ZONE 55

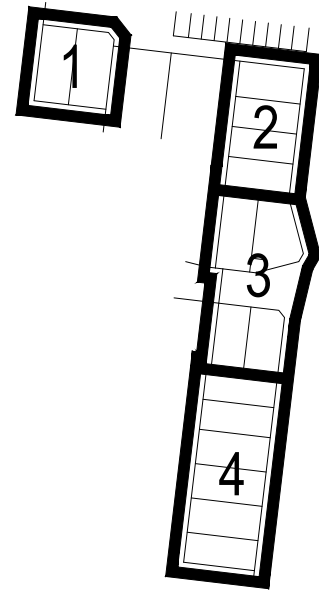

KEY TO SHEETS

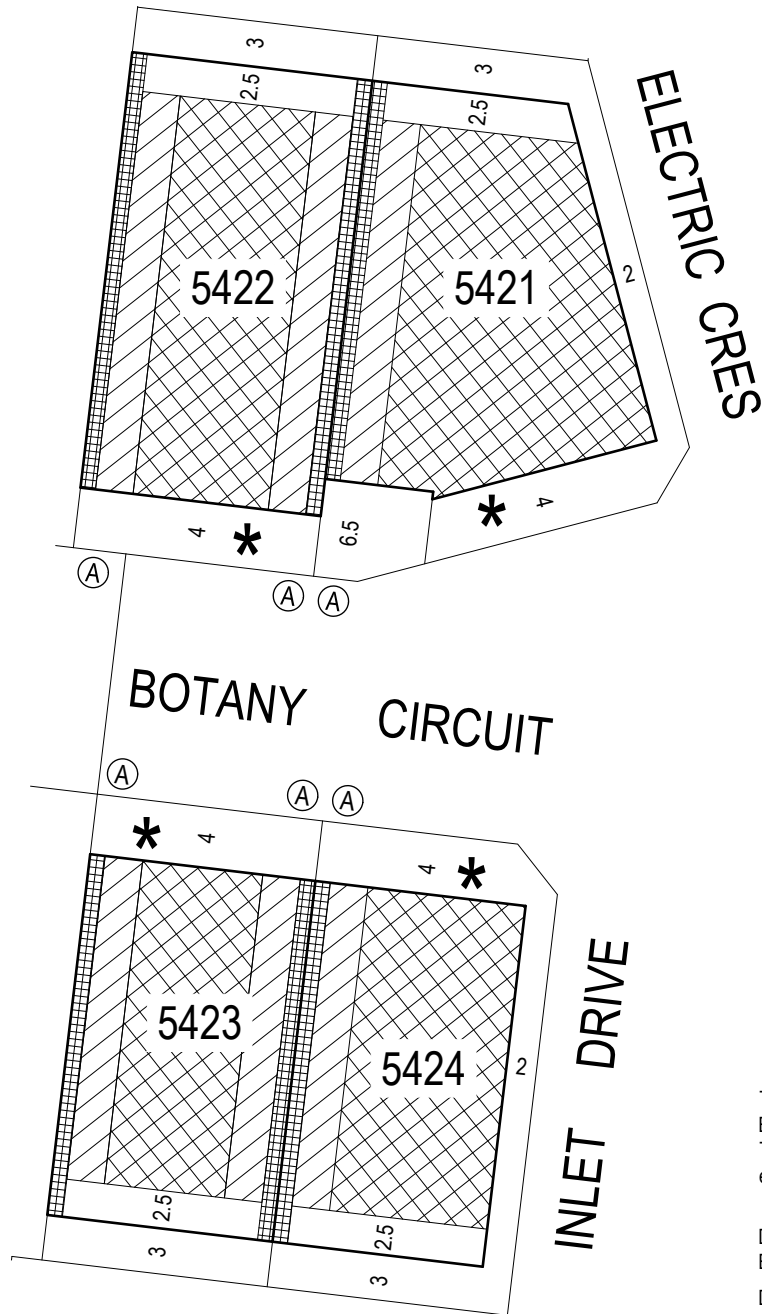

NOTATIONS

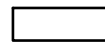

Single Storey Building Envelope (height not exceeding 3.6m)

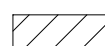

Overlooking Zone - Habitable room windows/raised open spaces are a source of overlooking



Non Overlooking Zone - Habitable room windows/raised open spaces are not a source of overlooking



Building to Boundary Zone)



Building Envelope Boundary Profile Type

5403

Lot number

3

Setback minimum required (if 0, a building can be constructed on the boundary provided that the building height and length requirements are met)

*

The registered proprietor or proprietors for the time being of lots identified thus must not build or permit to be built any building(s) that does not provide 1.0 metre clear horizontal access along the full length of a minimum one side boundary of the lot.

This Building Envelope Plan is to be read in conjunction with the associated Building Envelope Profiles and Design Guidelines.

The registered proprietor/s of the lot are required to build in accordance with building envelopes shown hereon and in the "Profile Diagrams" in sheet 5.

Detailed design of roads, driveways and footpaths is provided in the relevant Engineering Plans.

Detailed design of landscape works is provided in the relevant Landscape Plans.

All details subject to City of Greater Geelong Council approval.

ARMSTRONG Mt DUNED

BUILDING ENVELOPE PLAN STAGE 54

54 / 3

stage sheet



SCALE OF METRES





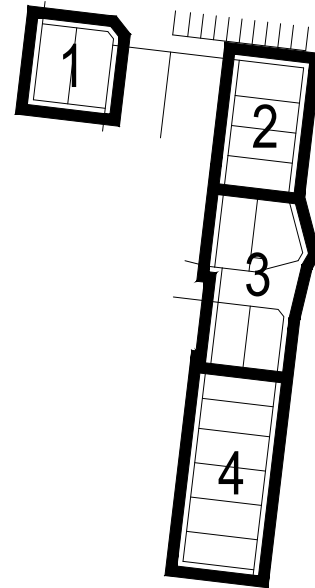
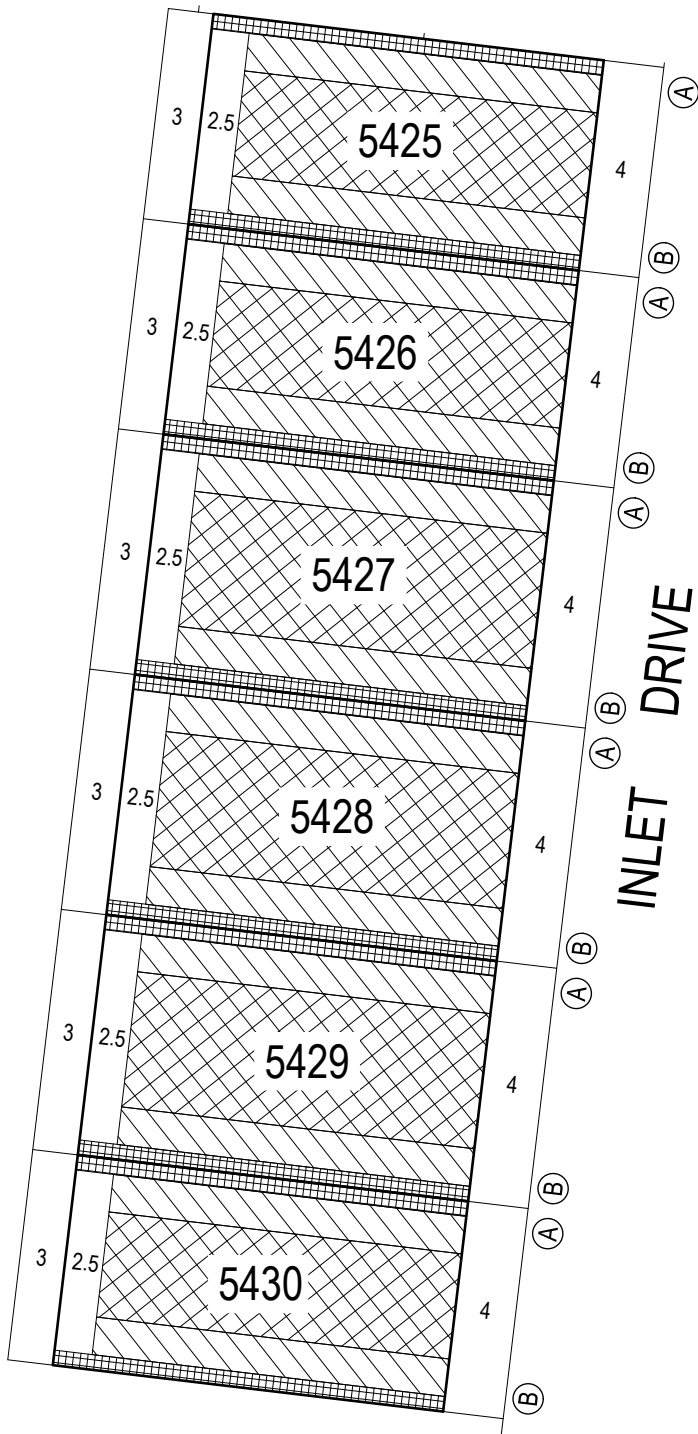

MGA ZONE 55

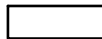
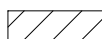

KEY TO SHEETS

NOTATIONS

-  Single Storey Building Envelope (height not exceeding 3.6m)
-  Overlooking Zone - Habitable room windows/raised open spaces are a source of overlooking
-  Non Overlooking Zone - Habitable room windows/raised open spaces are not a source of overlooking
-  Building to Boundary Zone)
-  Building Envelope Boundary Profile Type
- 5403** Lot number
- 3** Setback minimum required (if 0, a building can be constructed on the boundary provided that the building height and length requirements are met)
- *** The registered proprietor or proprietors for the time being of lots identified thus must not build or permit to be built any building(s) that does not provide 1.0 metre clear horizontal access along the full length of a minimum one side boundary of the lot.

This Building Envelope Plan is to be read in conjunction with the associated Building Envelope Profiles and Design Guidelines.

The registered proprietor/s of the lot are required to build in accordance with building envelopes shown hereon and in the "Profile Diagrams" in sheet 5.

Detailed design of roads, driveways and footpaths is provided in the relevant Engineering Plans.

Detailed design of landscape works is provided in the relevant Landscape Plans.

All details subject to City of Greater Geelong Council approval.

ARMSTRONG Mt DUNED

BUILDING ENVELOPE PLAN STAGE 54

54 / 4

stage sheet

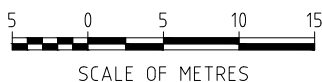

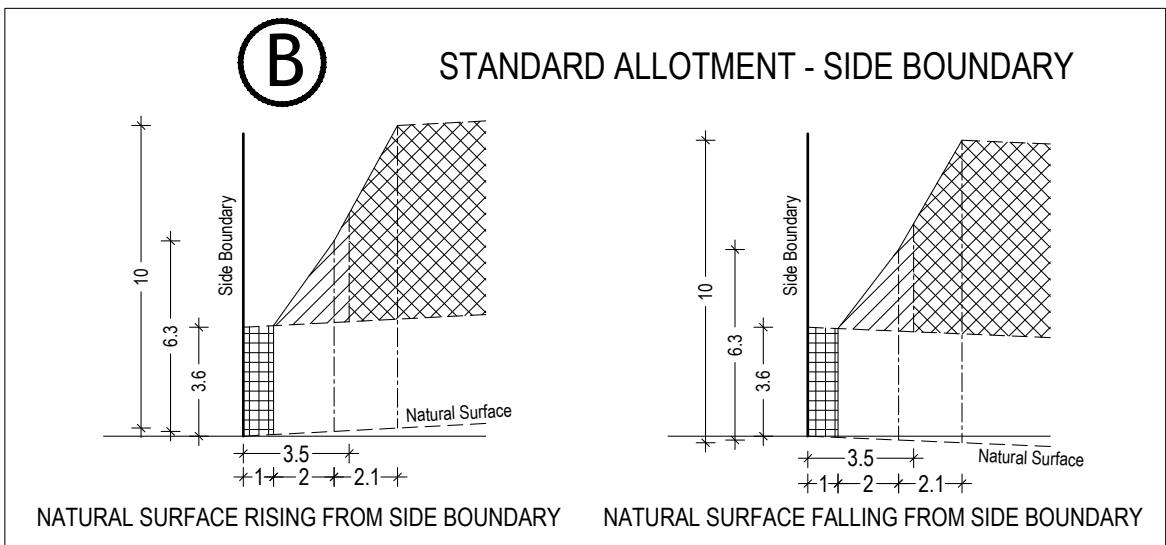
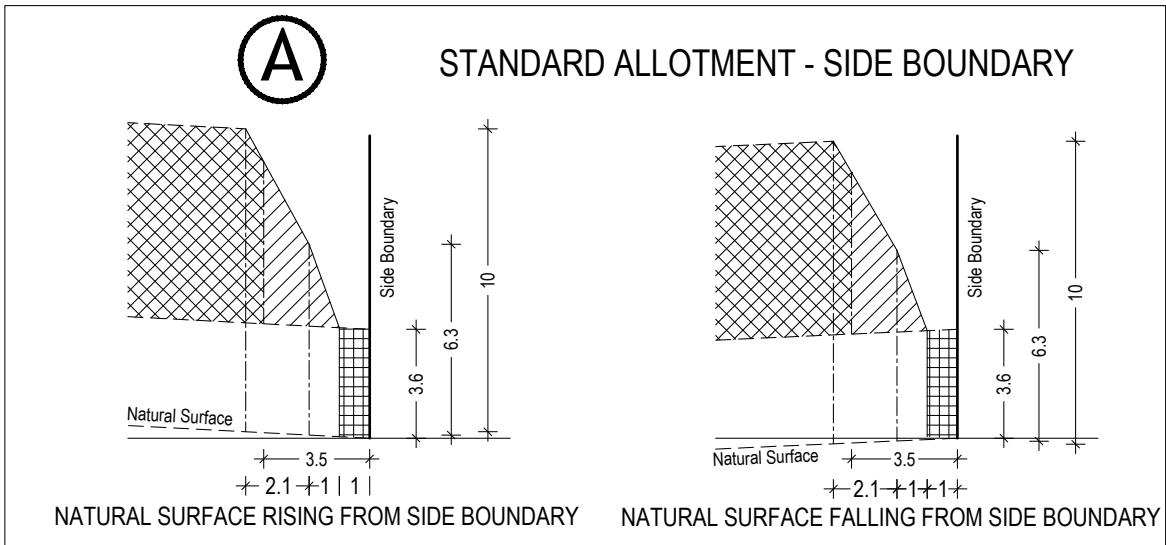

SCALE 1:250@A4

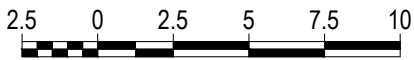

ARMSTRONG Mt DUNEED

**BUILDING ENVELOPE PROFILES
STAGE 54**

54 / 5
stage sheet

 Single Storey Building Envelope



Non Overlooking Zone
Habitable room windows/raised open spaces are not a source of overlooking

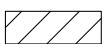

Overlooking Zone
Habitable room windows/raised open spaces are a source of overlooking



Building to Boundary Zone

Sheet 5 of 5

January 2020
Version:G