

MGA ZONE 55

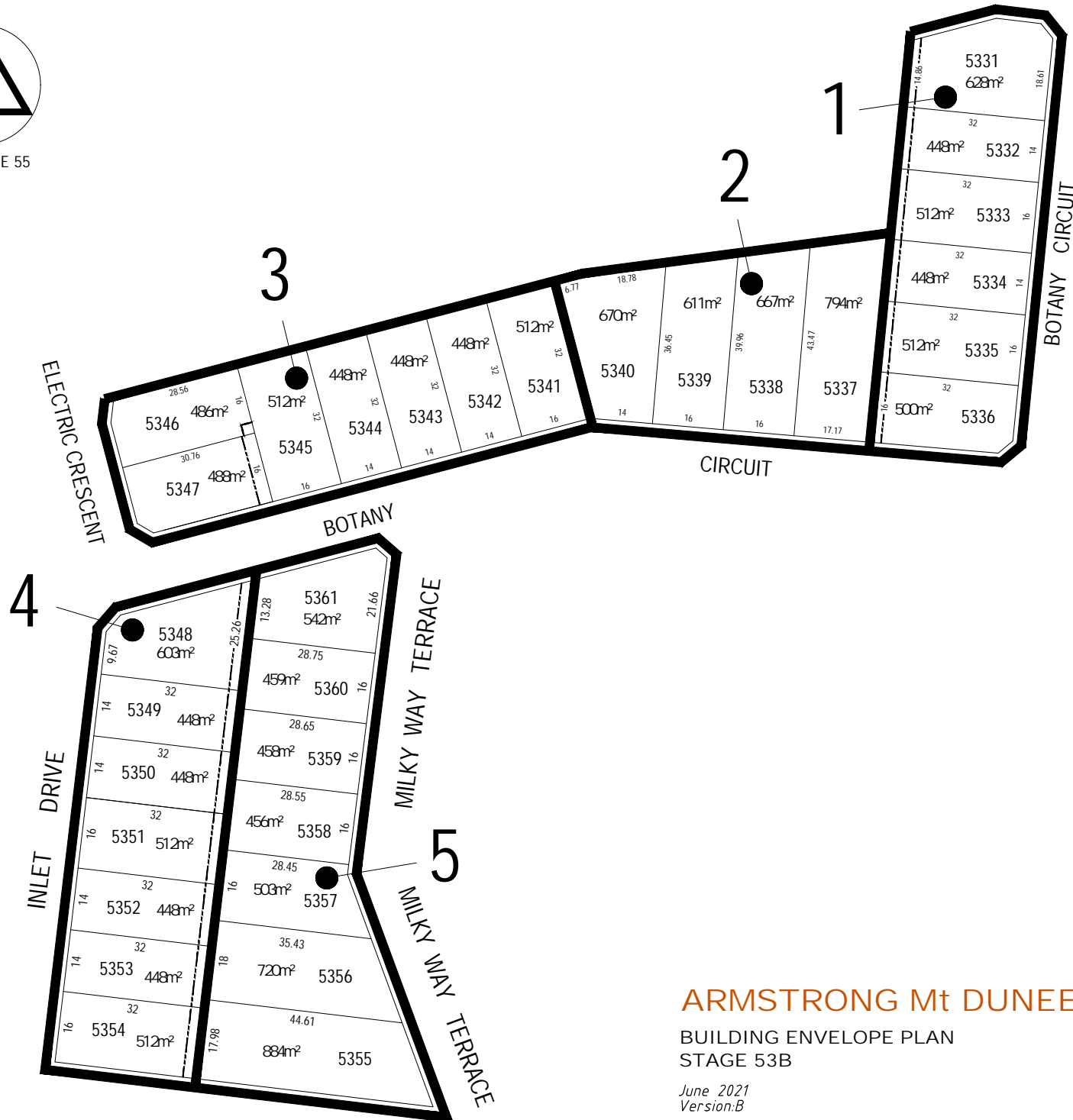

----- 2 metre wide easement  
----- 2.5 or 3 metre wide easement

## ARMSTRONG Mt DUNEED

BUILDING ENVELOPE PLAN  
STAGE 53B

June 2021  
Version:B

## KEY TO SHEETS

REFER TO SHEETS  
1 TO 6  
FOR DETAIL

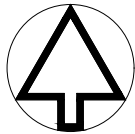

MGA ZONE 55

BOTANY CIRCUIT

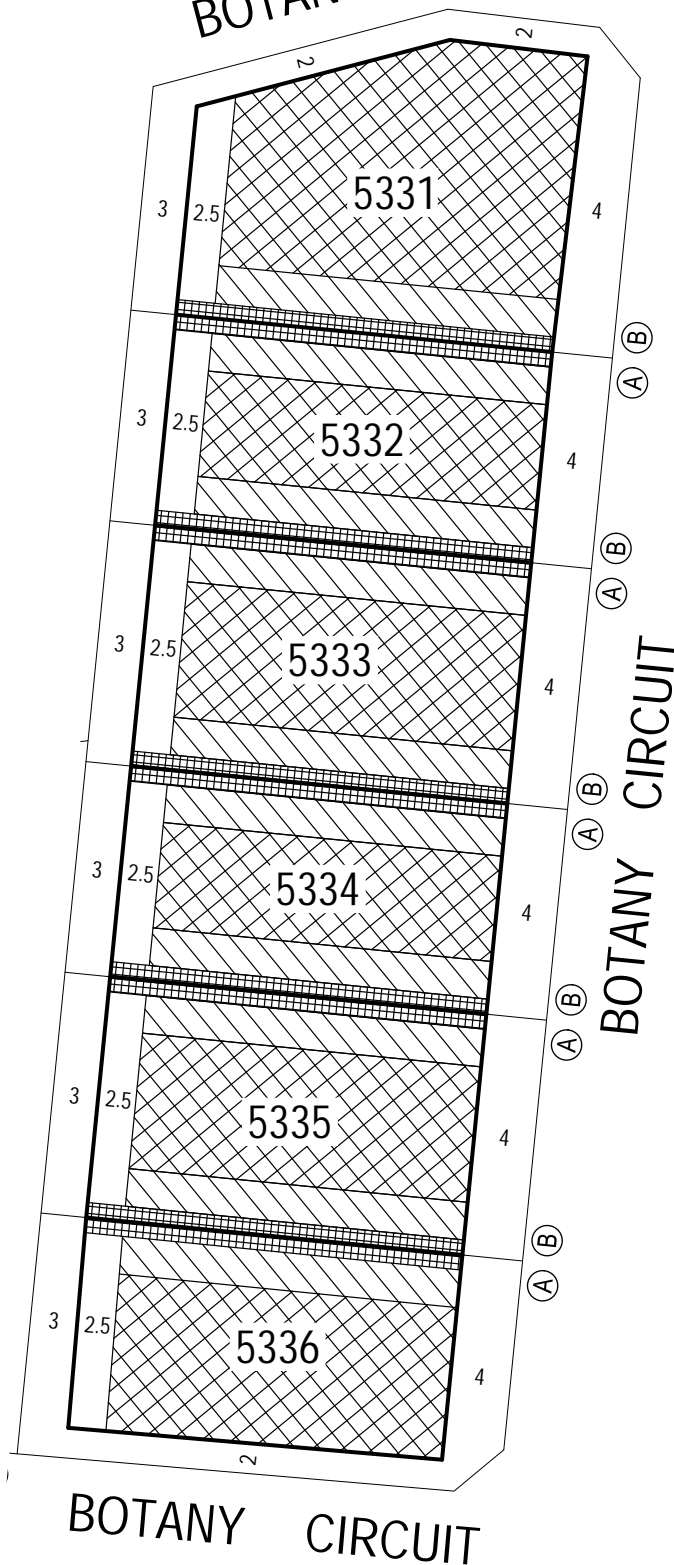

BOTANY CIRCUIT



SCALE OF METRES

Detailed design of roads, driveways and footpaths is provided in the relevant Engineering Plans.

Detailed design of landscape works is provided in the relevant Landscape Plans.

All details subject to City of Greater Geelong Council approval.

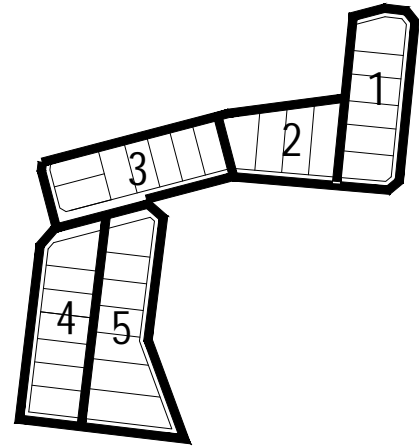

## KEY TO SHEETS

### NOTATIONS

	Single Storey Building Envelope (height not exceeding 3.6m)
	Overlooking Zone - Habitable room windows/raised open spaces are a source of overlooking
	Non Overlooking Zone - Habitable room windows/raised open spaces are not a source of overlooking
	Building to Boundary Zone)
	Building Envelope Boundary Profile Type
5305	Lot number
3	Setback minimum required (if 0, a building can be constructed on the boundary provided that the building height and length requirements are met)

This Building Envelope Plan is to be read in conjunction with the associated Building Envelope Profiles and Design Guidelines.  
The registered proprietor/s of the lot are required to build in accordance with building envelopes shown hereon and in the "Profile Diagrams" in sheet 6.

ARMSTRONG Mt DUNED

BUILDING ENVELOPE PLAN  
STAGE 53B

53B /1  
stage sheet

Sheet 1 of 6

June 2021  
Version:B

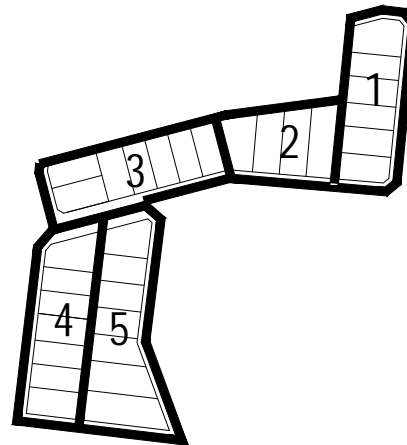
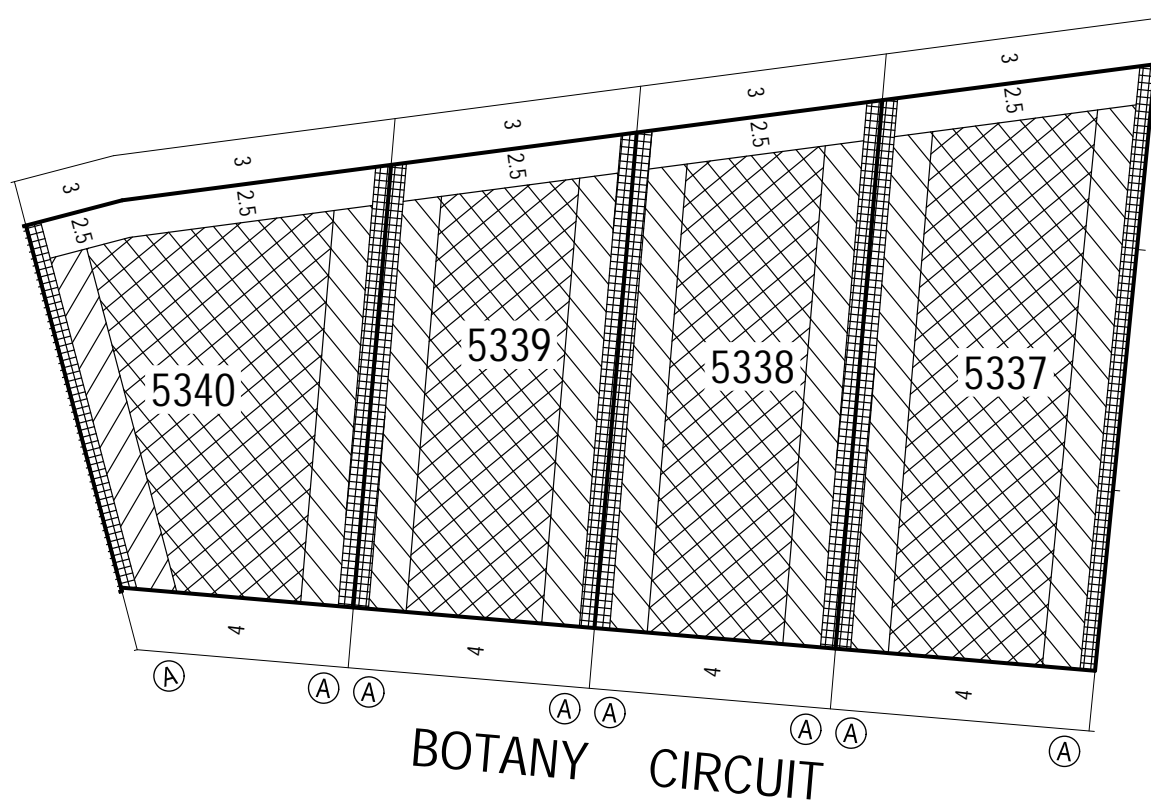

KEY TO SHEETS

## NOTATIONS



Single Storey Building Envelope (height not exceeding 3.6m)



Overlooking Zone - Habitable room windows/raised open spaces are a source of overlooking



Non Overlooking Zone - Habitable room windows/raised open spaces are not a source of overlooking



Building to Boundary Zone



Building Envelope Boundary Profile Type

5305

Lot number

3

Setback minimum required (if 0, a building can be constructed on the boundary provided that the building height and length requirements are met)

## ARMSTRONG Mt DUNEED

BUILDING ENVELOPE PLAN  
STAGE 53B

**53B/2**  
stage sheet

Sheet 2 of 6

June 2021  
Version:B

This Building Envelope Plan is to be read in conjunction with the associated Building Envelope Profiles and Design Guidelines.

The registered proprietor/s of the lot are required to build in accordance with building envelopes shown hereon and in the "Profile Diagrams" in sheet 6.

Detailed design of roads, driveways and footpaths is provided in the relevant Engineering Plans.

Detailed design of landscape works is provided in the relevant Landscape Plans.

All details subject to City of Greater Geelong Council approval.

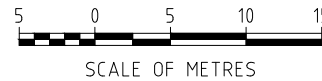
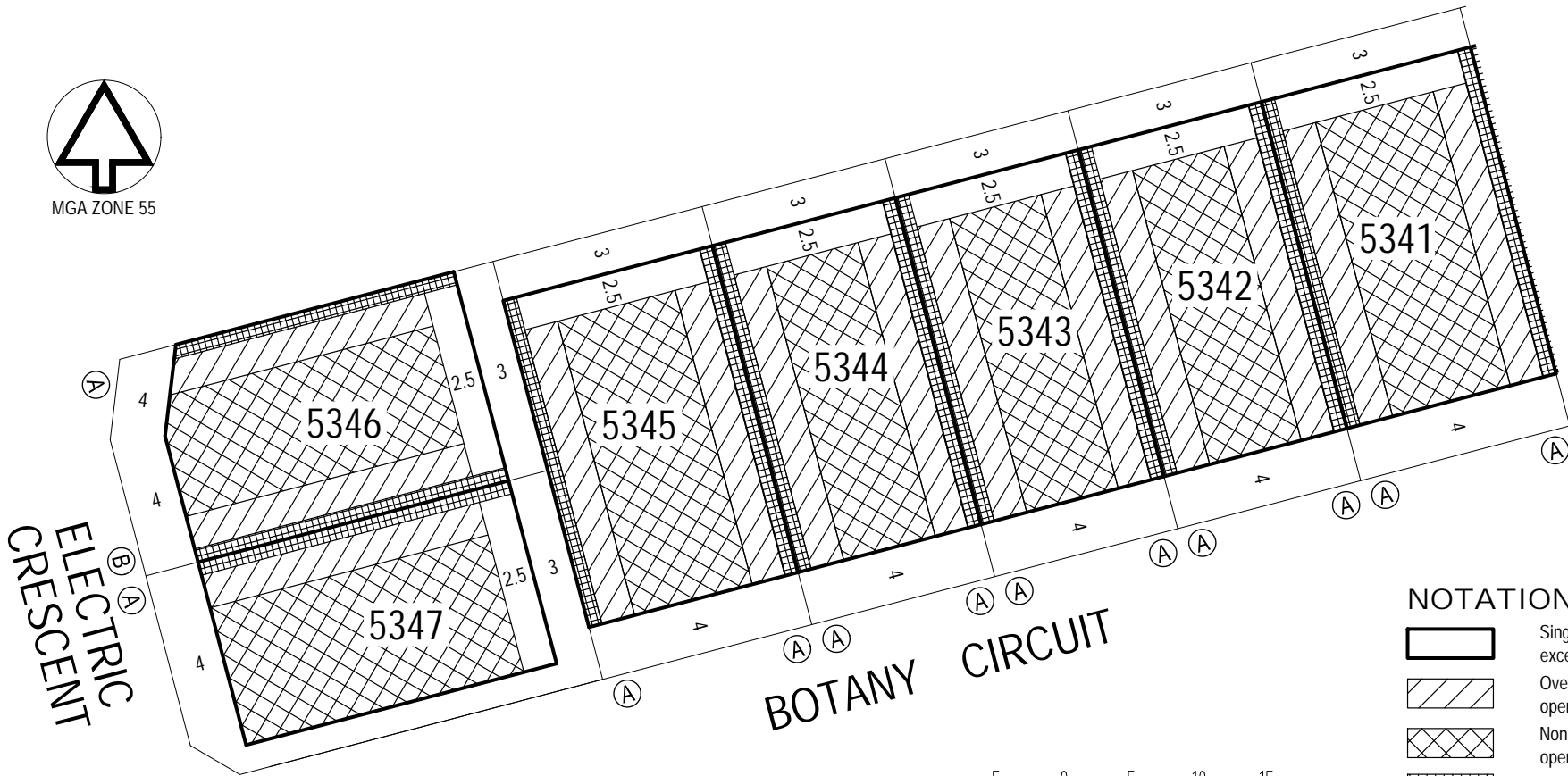

#### NOTATIONS

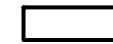

Single Storey Building Envelope (height not exceeding 3.6m)

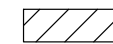

Overlooking Zone - Habitable room windows/raised open spaces are a source of overlooking



Non Overlooking Zone - Habitable room windows/raised open spaces are not a source of overlooking



Building to Boundary Zone



Building Envelope Boundary Profile Type

5305

Lot number

3

Setback minimum required (if 0, a building can be constructed on the boundary provided that the building height and length requirements are met)

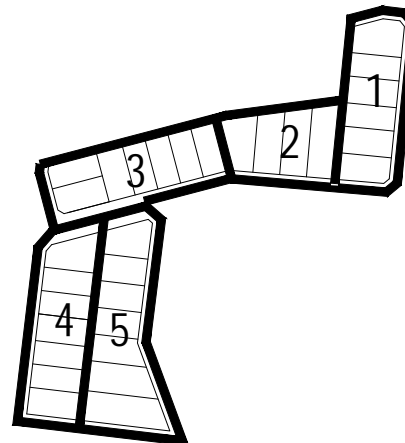

KEY TO SHEETS

This Building Envelope Plan is to be read in conjunction with the associated Building Envelope Profiles and Design Guidelines.

The registered proprietor/s of the lot are required to build in accordance with building envelopes shown hereon and in the "Profile Diagrams" in sheet 6.

Detailed design of roads, driveways and footpaths is provided in the relevant Engineering Plans.

Detailed design of landscape works is provided in the relevant Landscape Plans.

All details subject to City of Greater Geelong Council approval.

ARMSTRONG Mt DUNEED

BUILDING ENVELOPE PLAN  
STAGE 53B

53B/3  
stage sheet

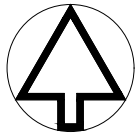

MGA ZONE 55

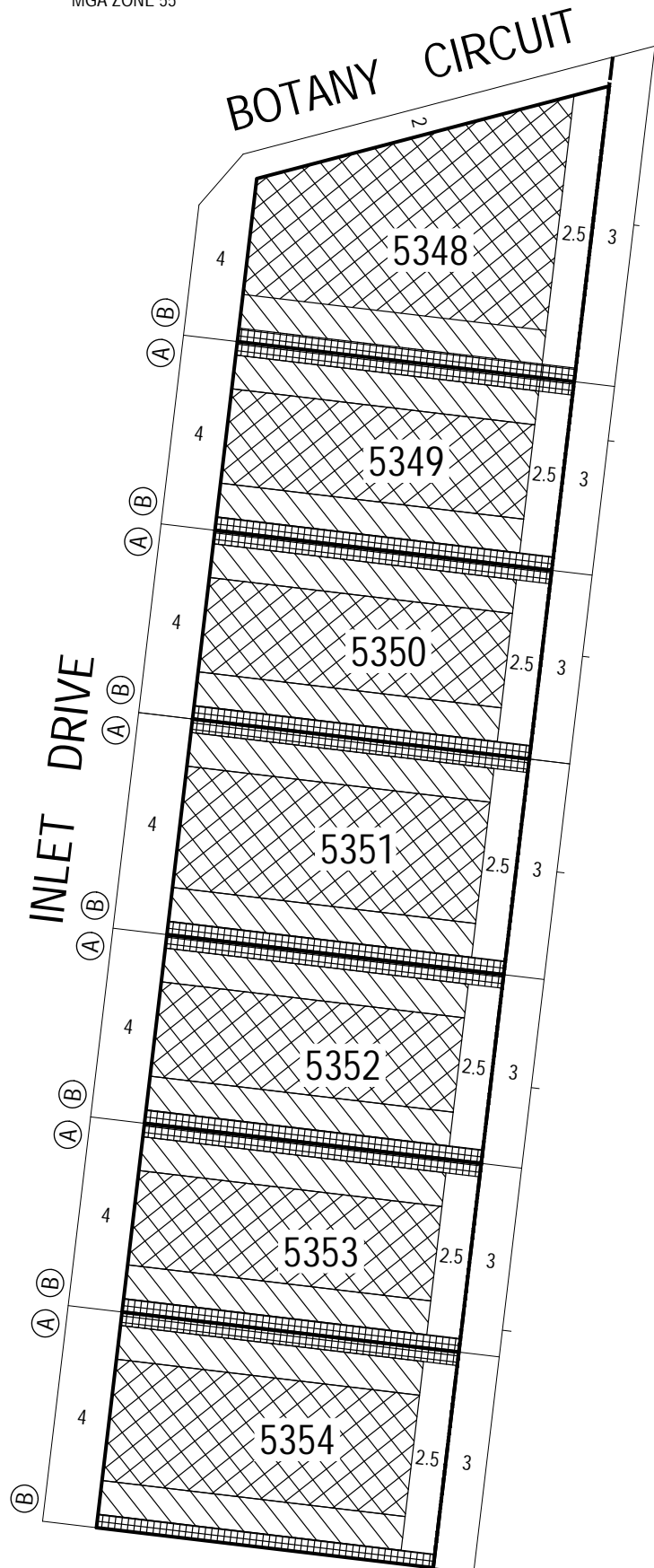

## NOTATIONS

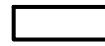

Single Storey Building Envelope (height not exceeding 3.6m)

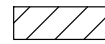

Overlooking Zone - Habitable room windows/raised open spaces are a source of overlooking

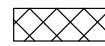

Non Overlooking Zone - Habitable room windows/raised open spaces are not a source of overlooking



Building to Boundary Zone)



Building Envelope Boundary Profile Type

5305

Lot number

3

Setback minimum required (if 0, a building can be constructed on the boundary provided that the building height and length requirements are met)

Detailed design of roads, driveways and footpaths is provided in the relevant Engineering Plans.

Detailed design of landscape works is provided in the relevant Landscape Plans.

All details subject to City of Greater Geelong Council approval.

This Building Envelope Plan is to be read in conjunction with the associated Building Envelope Profiles and Design Guidelines. The registered proprietor/s of the lot are required to build in accordance with building envelopes shown hereon and in the "Profile Diagrams" in sheet 6.

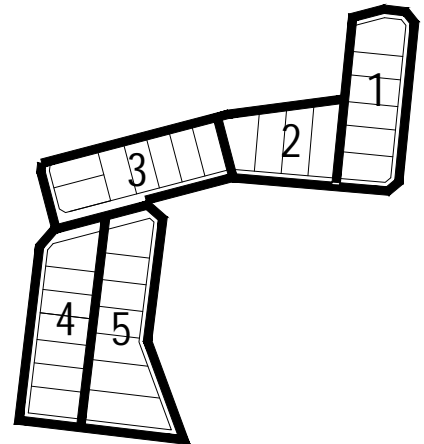

KEY TO SHEETS

## ARMSTRONG Mt DUNED

BUILDING ENVELOPE PLAN  
STAGE 53B

# 53B /4

stage

sheet

Sheet 4 of 6

June 2021  
Version:B



SCALE OF METRES





BOTANY CIRCUIT

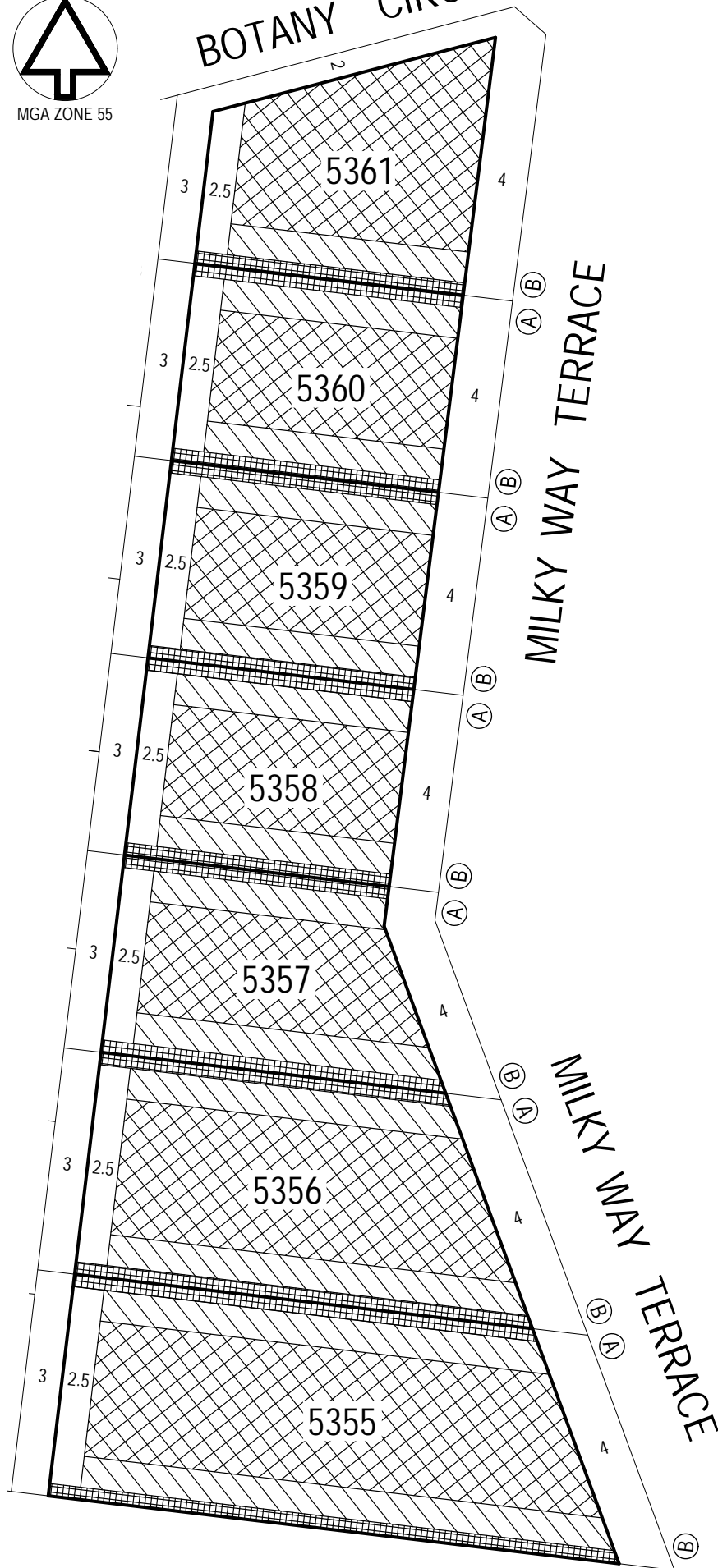

## NOTATIONS

- Single Storey Building Envelope (height not exceeding 3.6m)
- Overlooking Zone - Habitable room windows/raised open spaces are a source of overlooking
- Non Overlooking Zone - Habitable room windows/raised open spaces are not a source of overlooking
- Building to Boundary Zone)



Building Envelope Boundary Profile Type

5305

Lot number

3

Setback minimum required (if 0, a building can be constructed on the boundary provided that the building height and length requirements are met)

Detailed design of roads, driveways and footpaths is provided in the relevant Engineering Plans.

Detailed design of landscape works is provided in the relevant Landscape Plans.

All details subject to City of Greater Geelong Council approval.

This Building Envelope Plan is to be read in conjunction with the associated Building Envelope Profiles and Design Guidelines. The registered proprietor/s of the lot are required to build in accordance with building envelopes shown hereon and in the "Profile Diagrams" in sheet 6.

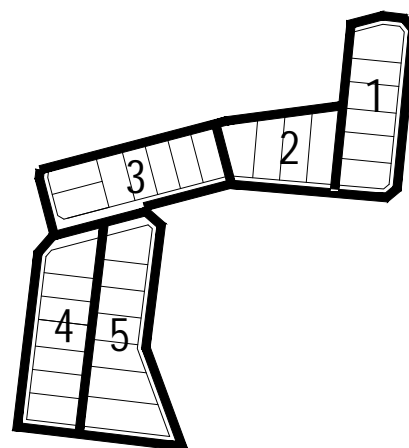

KEY TO SHEETS



SCALE OF METRES

ARMSTRONG Mt DUNED

BUILDING ENVELOPE PLAN  
STAGE 53B

53B /5

stage

sheet

Sheet 5 of 6

June 2021  
Version: B

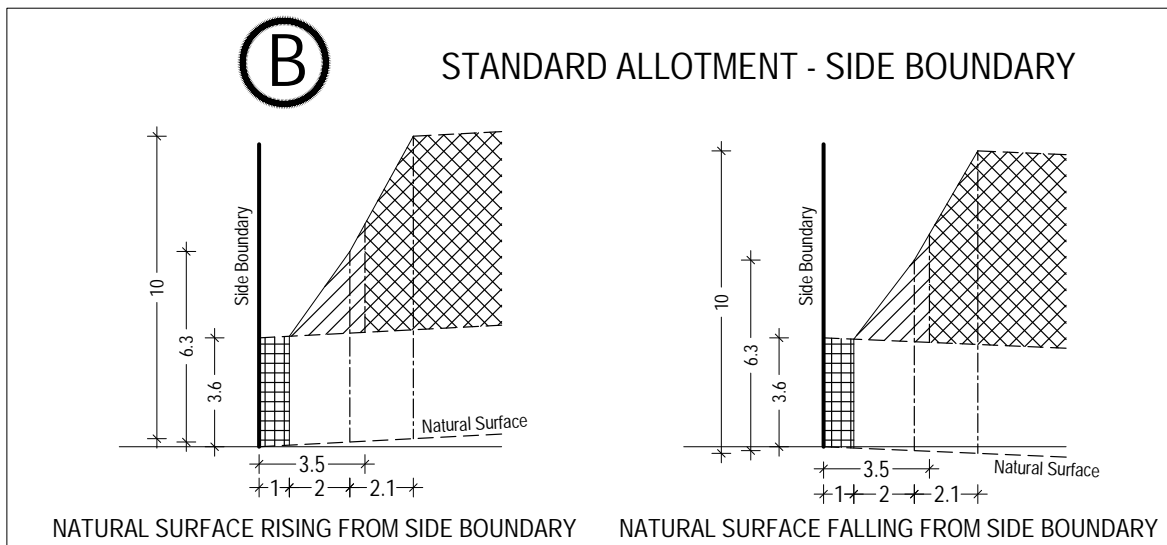
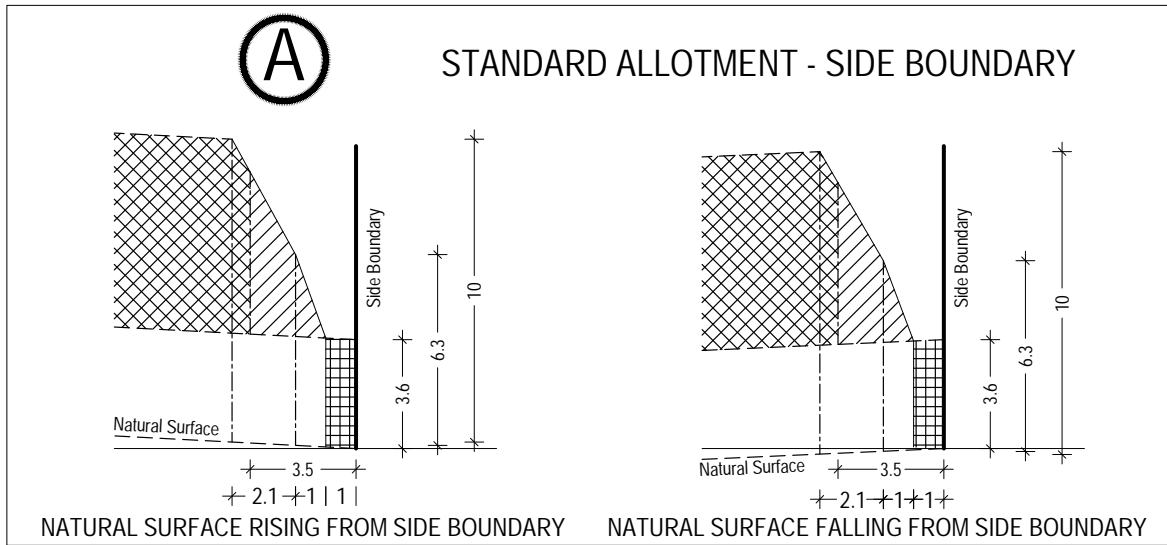

SCALE 1:250@A4

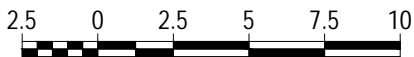

## ARMSTRONG Mt DUNEED

BUILDING ENVELOPE PROFILES  
STAGE 53B

**53B /6**  
stage      sheet

Sheet 6 of 6

June 2021  
Version:B

Single Storey Building Envelope

Overlooking Zone  
Habitable room windows/raised open spaces are a source of overlooking

Non Overlooking Zone  
Habitable room windows/raised open spaces are not a source of overlooking

Building to Boundary Zone