

Memorandum of common provisions
Section 91A Transfer of Land Act 1958

Privacy Collection Statement

The information in this form is collected under statutory authority and is used for the purpose of maintaining publicly searchable registers and indexes.

Lodged by	
Name:	
Phone:	
Address:	
Reference:	
Customer code:	

This memorandum contains provisions which are intended for inclusion in instruments and plans to be subsequently lodged for registration.

Provisions:

Preliminary

All Provisions not addressed in this Memorandum of Common Provisions (MCP) are as required in the current Building Regulations. This MCP cannot be changed or amended unless with the written consent of the Responsible Authority.

Approved Building Envelopes

Any building on Lot 2901 to Lot 2917, Lot 2929 to Lot 2940 (all inclusive) within subdivision plan PS835646S must be contained within the building envelopes, associated setback profiles and written notes contained therein, except with the written consent of the Responsible Authority.

Text of restrictions:

The registered proprietor or proprietors for the time being of a lot on Plan of Subdivision PS835646S, his, her, their or its heirs, executors, administrators and transferees shall not at any time on the said lot or any part or parts thereof:

- (i) Build or cause to be built or allow to be built or allow to remain standing more than one private dwelling-house (which expression shall include a house, apartment, unit or flat) prior to 31 December 2031;
- (ii) Build or cause to be built or allow to be built or allow to remain built a dwelling-house or any other improvements, or carry out, cause to be carried out or allow to be carried out any building or construction works on the lot prior to 31 December 2031 unless:
 - (A) copies of building plans, elevations, roof plan, site plan (incorporating set-back from all boundaries, building envelope, existing contours, proposed finished floor levels and site levels, all proposed driveways and paths, details of fences and outbuildings and landscaping) and schedule of external colours and materials ("plans") have been submitted to the Design Assessment Panel, at the address in the Design Guidelines (as amended from time to time); and
 - (B) the plans comply with the Design Guidelines and Building Envelopes that deal with all siting and other matters that would otherwise be regulated by Part 5 of the Building Regulations 2018 (or any superseding regulation), a copy of which can be obtained from the website at www.aspirefraserise.com.au; and
 - (C) the Design Assessment Panel or such other entity as may be nominated by the Design Assessment Panel from time to time has given its written approval to the plans prior to the commencement of works; and
 - (D) any building or construction works are carried out in accordance with the approved plans.

35271702A

V2

- 1. The provisions are to be numbered consecutively from number 1.
- 2. Further pages may be added but each page should be consecutively numbered.
- 3. To be used for the inclusion of provisions in instruments and plans.

91ATLA

Page 1 of 9

THE BACK OF THIS FORM MUST NOT BE USED

Land Use Victoria contact details: see www.delwp.vic.gov.au/property>Contact us

Memorandum of common provisions

Section 91A Transfer of Land Act 1958

(iii) Build or cause to be built or allow to be built or allow to remain a dwelling-house with a floor area of less than:

- (A) 160 square metres in the case of a lot having an area of 500 square metres or greater; or
- (B) 130 square metres in the case of a lot having an area of 400 square metres or greater but less than 500 square metres; or
- (C) 100 square metres in the case of a lot having an area of 300 square metres or greater but less than 400 square metres; or
- (D) 75 square metres in the case of a lot having an area of less than 300 square metres.

For the purposes of calculating the floor area of a dwelling-house the area of the garages, terraces, pergolas or verandahs shall be excluded.

(iv) Build or cause to be built or allow to be built or allow to remain any fencing:

- (A) along a front street boundary; or
- (B) between the front street boundary and the building line; or
- (C) upon a side or rear boundary of a lot except a fence:
 - a. which is constructed of timber palings with exposed posts capped across the top of the palings; and
 - b. which does not exceed 1.8 metres in height excluding a screen erected to meet the requirements of Part 5 of the Building Regulations 2018 in relation to overlooking.

The foregoing restriction shall not apply during any period that the lot is being used as a display home.

(v) Build or cause to be built or allow to be built or allow to remain standing any buildings constructed on a lot containing a building envelope that does not conform to the relevant building envelope as shown in the attached Building Envelope Schedule, except the written consent of the Responsible Authority.

(vi) Subdivide or cause to subdivide or allow to be subdivided the lot prior to 31 December 2031.

Memorandum of common provisions
Section 91A Transfer of Land Act 1958

BUILDING ENVELOPE SCHEDULE

See Plan of Subdivision PS835646S

LEGEND

EXAMPLE OF TYPICAL BUILDING ENVELOPE SETBACKS

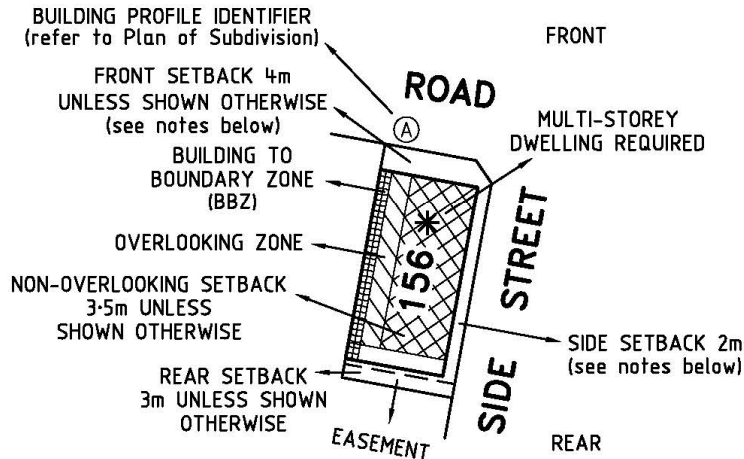

Notations

- The front and side setbacks are measured to the outermost walls of the buildings.
- Garages must be setback a minimum of 5.0m from the front street boundary unless otherwise noted.
- Walls less than 1.0m from the boundary must be within 200mm of the boundary.
- The BBZ shall be applicable to one side boundary only, one side boundary must be kept clear of buildings. Terrace style lots are exempt from this requirement.
- The setback to a side street boundary for a corner lot is 2m unless noted otherwise.
- Where the minimum front setback is 3.0m or more, porches, verandahs and architectural features can encroach into the front setback by up to 1.5m.
- Where the minimum front setback is less than 3.0m, porches, verandahs and architectural features can encroach into the front setback by up to 1.0m.
- Two storey dwellings must be setback a minimum of 5.5m from the rear boundary unless otherwise noted.
- The building regulations apply to construction of dwellings and need to be adhered to in relation to design principles.

Refer "Diagrams and Plans" in this document for further definitions

Single Storey Building Envelope hatch types

 Single storey Building Envelope (wall height not exceeding 3.6m)

 Building to Boundary Zone

Double Storey Building Envelope hatch types

 Overlooking Zone - Habitable room windows or raised open spaces are a source of overlooking

 Non Overlooking Zone - Habitable room windows or raised open spaces are not a source of overlooking

ASPIRE - Stage 29

Dwg: 329896-ST29-BB

Date: 19/04/2021

Level 3, 1 Southbank Boulevard
 Southbank, Victoria 3006
 03) 7019 8400

www.veris.com.au

DEVELOP WITH CONFIDENCE™ Formerly **Bosco Jonson**



Memorandum of common provisions
Section 91A Transfer of Land Act 1958

BUILDING ENVELOPE DIAGRAM

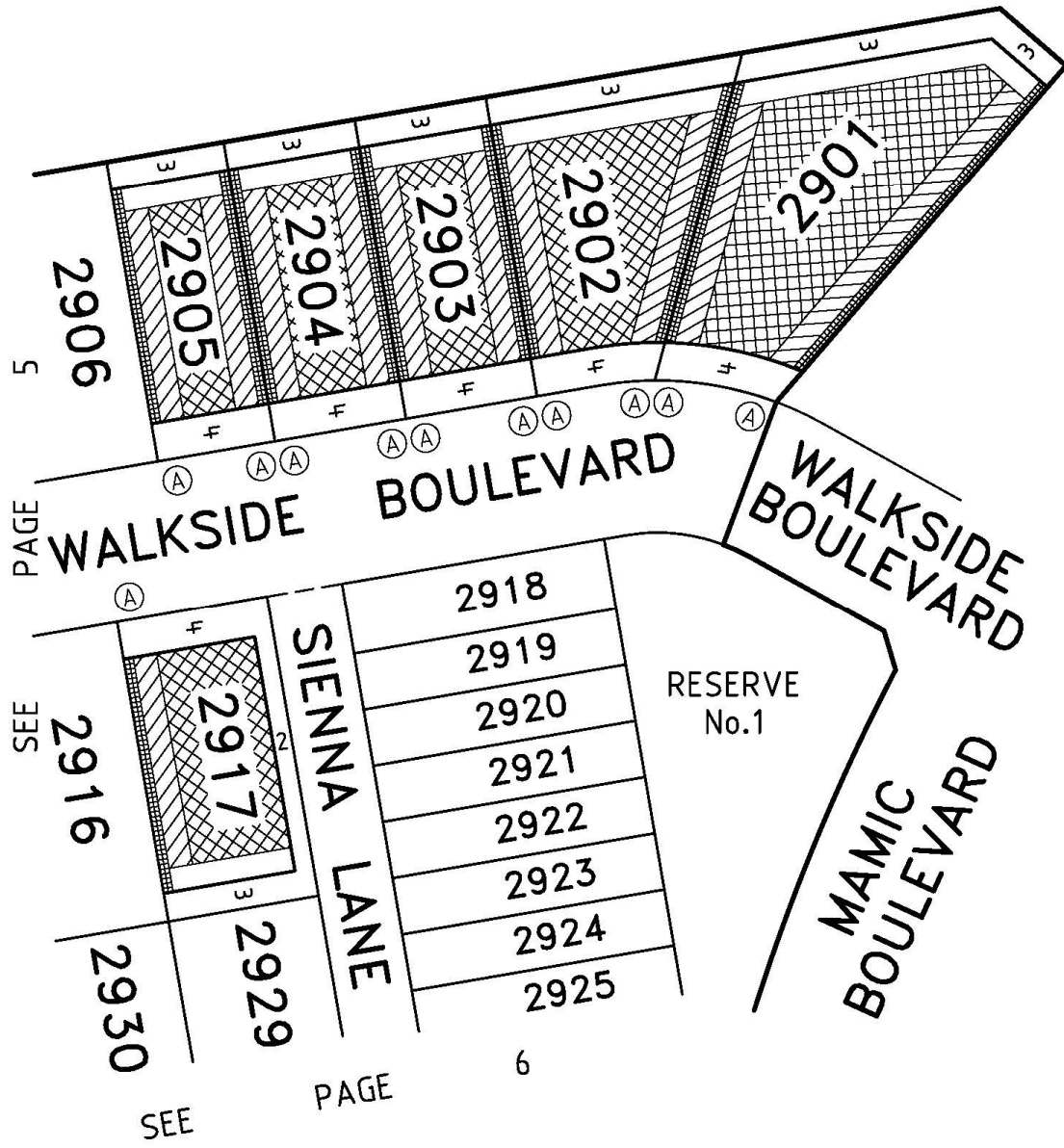
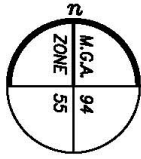

ASPIRE - Stage 29
 Dwg: 329896-ST29-BB
 Date: 19/04/2021

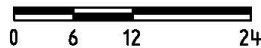

Level 3, 1 Southbank Boulevard
 Southbank, Victoria 3006
 03) 7019 8400
 www.veris.com.au
 DEVELOP WITH CONFIDENCE™
 Formerly **Bosco Jonson**



Memorandum of common provisions
Section 91A Transfer of Land Act 1958

BUILDING ENVELOPE DIAGRAM



ASPIRE - Stage 29
 Dwg: 329896-ST29-BB
 Date: 19/04/2021

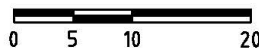

Level 3, 1 Southbank Boulevard
 Southbank, Victoria 3006
 (03) 7019 8400
 www.veris.com.au
 DEVELOP WITH CONFIDENCE™ Formerly **Bosco Jonson**



Memorandum of common provisions
Section 91A Transfer of Land Act 1958

BUILDING ENVELOPE DIAGRAM

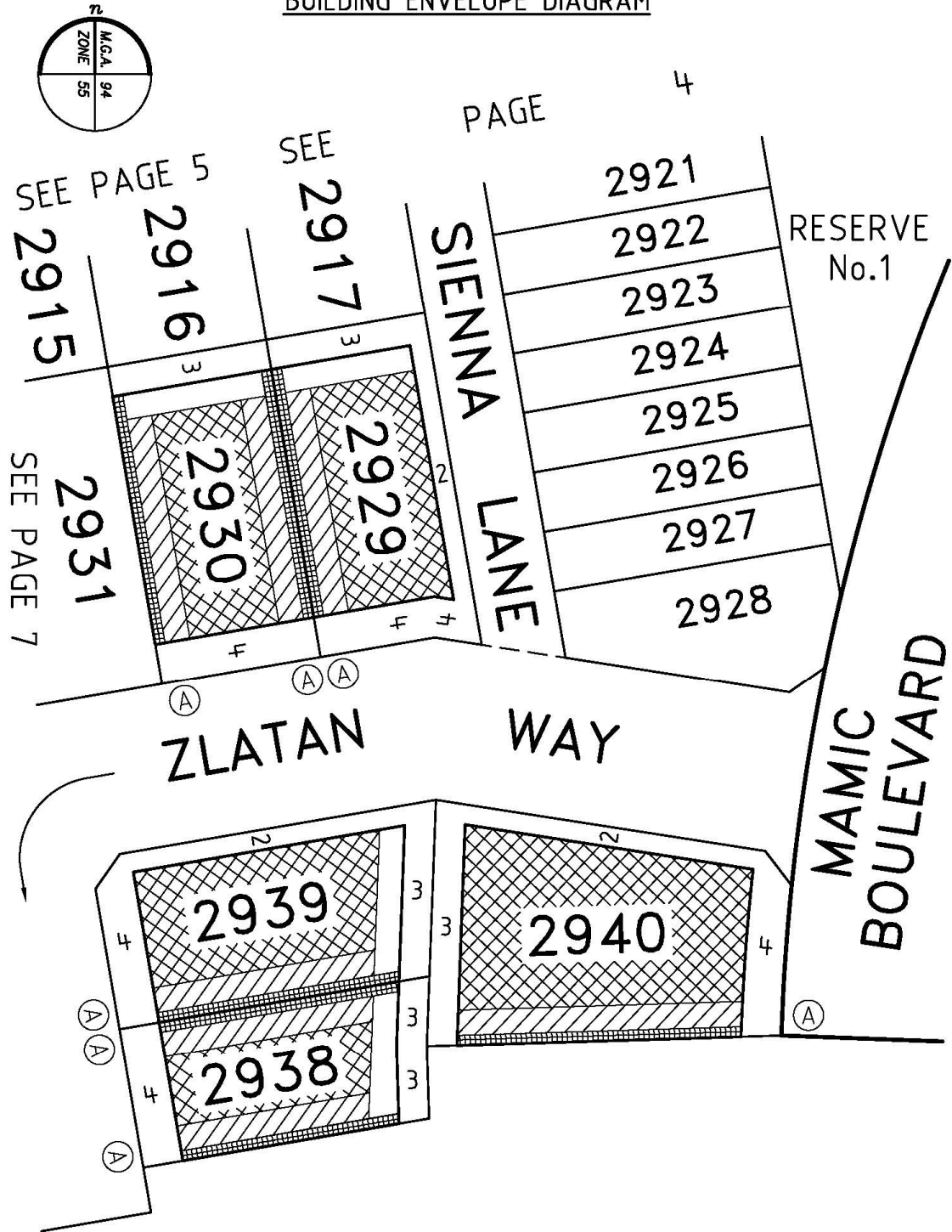

ASPIRE - Stage 29
 Dwg: 329896-ST29-BB
 Date: 19/04/2021

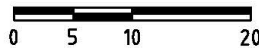

Level 3, 1 Southbank Boulevard
 Southbank, Victoria 3006
 (03) 7019 8400
 www.veris.com.au
 DEVELOP WITH CONFIDENCE™ Formerly **Bosco Jonson**



Memorandum of common provisions
Section 91A Transfer of Land Act 1958

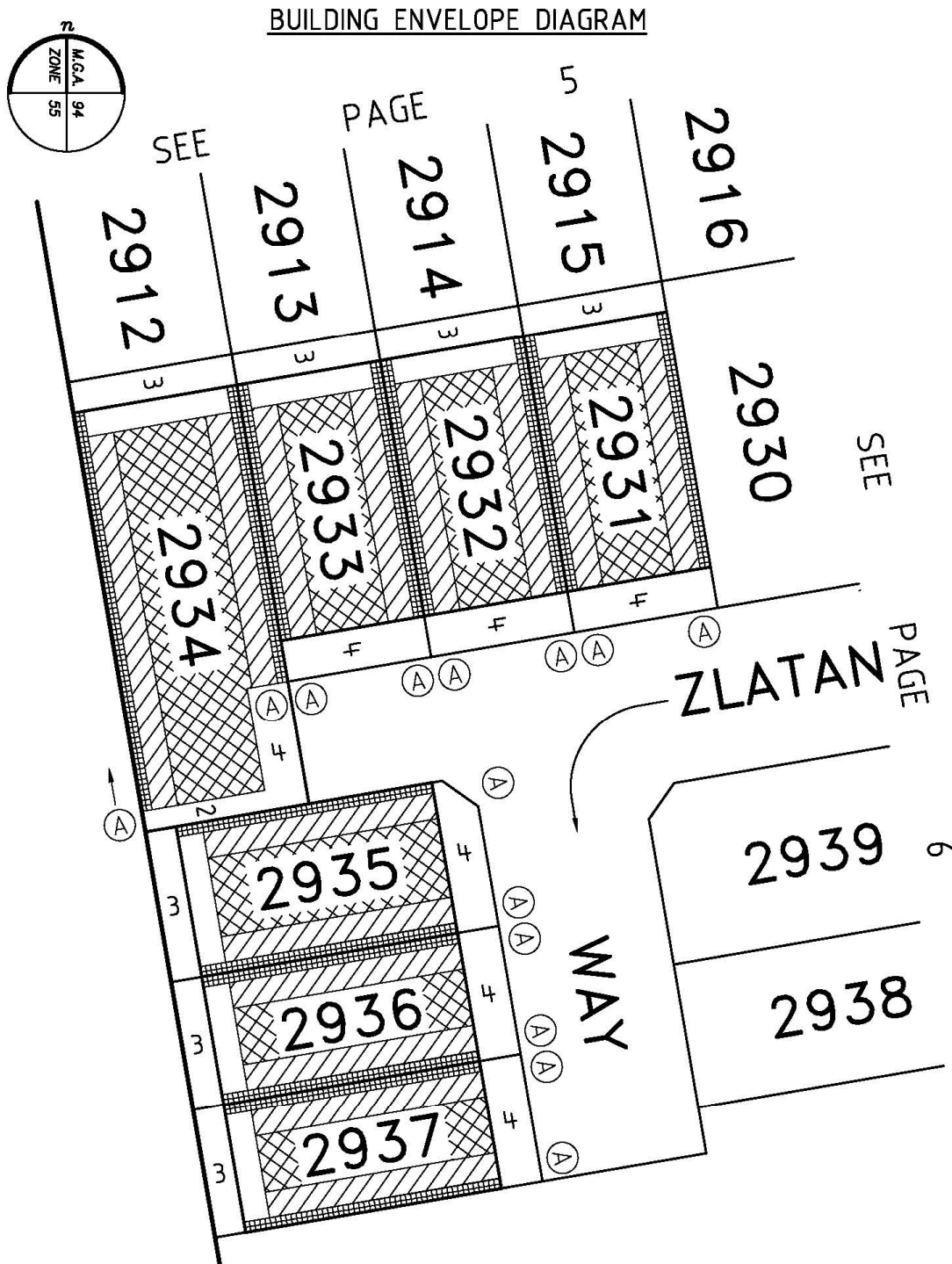

ASPIRE - Stage 29
 Dwg: 329896-ST29-BB
 Date: 19/04/2021

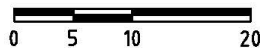

Level 3, 1 Southbank Boulevard
 Southbank, Victoria 3006
 03) 7019 8400
 www.veris.com.au
 DEVELOP WITH CONFIDENCE™
 Formerly **Bosco Jonson**



PROFILE DIAGRAM

Ⓐ Profile

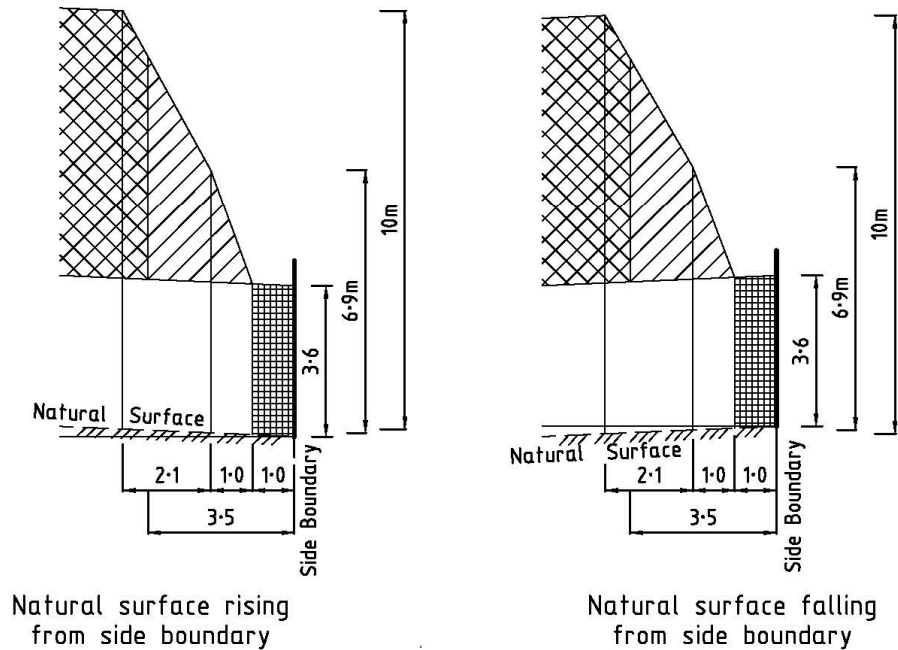

ASPIRE - Stage 29
 Dwg: 329896-ST29-BB
 Date: 19/04/2021

Level 3, 1 Southbank Boulevard
 Southbank, Victoria 3006
 03) 7019 8400
 www.veris.com.au
 DEVELOP WITH CONFIDENCE™
 Formerly **Bosco Jonson**

