

AS-BUILT

PIT LEGEND	
Shared Trench Symbol	
PIT-ID	Service Drop Access Pit
2	650mm(L) x 280mm(W) x 565mm(D)
PIT-ID	Network Boundary/Local Network Pit
5	700mm(L) x 450mm(W) x 650mm(D)
PIT-ID	Distribution/Local Network Connection Pit
6	1360mm(L) x 555mm(W) x 650mm(D)
PIT-ID	Distribution/Local Network Connection Pit
8	1360mm(L) x 555mm(W) x 860mm(D)
PIT-ID	Fibre Distribution Hub Pit
9	2000mm(L) x 555mm(W) x 900mm(D)

PIT LIDS TO BE LABELLED "NBN".

CONSTRUCTOR IS TO ENSURE PITS ARE INSTALLED IN NON-TRAFFICABLE AREAS, AT LEAST 15m AWAY FROM EPR ZONES AND CLEAR OF OTHER AUTHORITY EASEMENTS.

SERVICES CLEARANCES	
SERVICES ITEM	MINIMUM RADIAL CLEARANCES
GAS - LARGE MAIN (OVER 110mm DIA.)	300mm
SMALL MAIN (110mm DIA. OR LESS)	150mm
ELECTRICAL - HIGH VOLTAGE	300mm
LOW VOLTAGE	100mm *2
WATER - HIGH CAPACITY MAIN	300mm
LOCAL RETICULATION	150mm
SEWER - MAIN	300mm
CONNECTION PIPE	150mm
OTHER TELECOMMUNICATIONS	100mm*1
DRAINAGE - MAIN	300mm
CONNECTION PIPE	150mm

* 1 - REDUCED SEPARATION IS POSSIBLE WHERE ALL PARTIES ARE CONSULTED AND AGREEMENT IS REACHED
 * 2 - ONLY WHERE PROTECTION BARRIERS ARE USED, FOR EXAMPLE, CONDUIT, BEDDING, MARKER TAPE & COVER BATTEN

PCD / NTD LOCATIONS

P20 LEAD-IN LOCATIONS ARE INDICATIVE ONLY, AND ARE TO BE CONFIRMED AT TIME OF CONSTRUCTION.

FOR LOCATION REQUIREMENTS REFER TO NBN DOCUMENT: NBN-DES-STD-0011

RESIDENTIAL PREPARATION AND INSTALLATION: SINGLE DWELLING UNITS (SDUs) AND MULTI DWELLING UNITS (MDUs)

ISSUE DATE: 12 DEC 2016 REVISION NO. 11.0

DESIGN & INSTALLATION SPECIFICATIONS

THIS DESIGN IS TO BE READ IN CONJUNCTION WITH NBN DOCUMENT: NBN-TE-C10-194

"NEW DEVELOPMENTS: DEPLOYMENT OF THE NBN PIT AND CONDUIT NETWORK"

ISSUE DATE: 08/12/2017, REVISION: 8

ALL DEPLOYMENT WORKS TO BE COMPLETED TO NBN SPECIFICATIONS AS OUTLINED IN THE ABOVE DOCUMENT

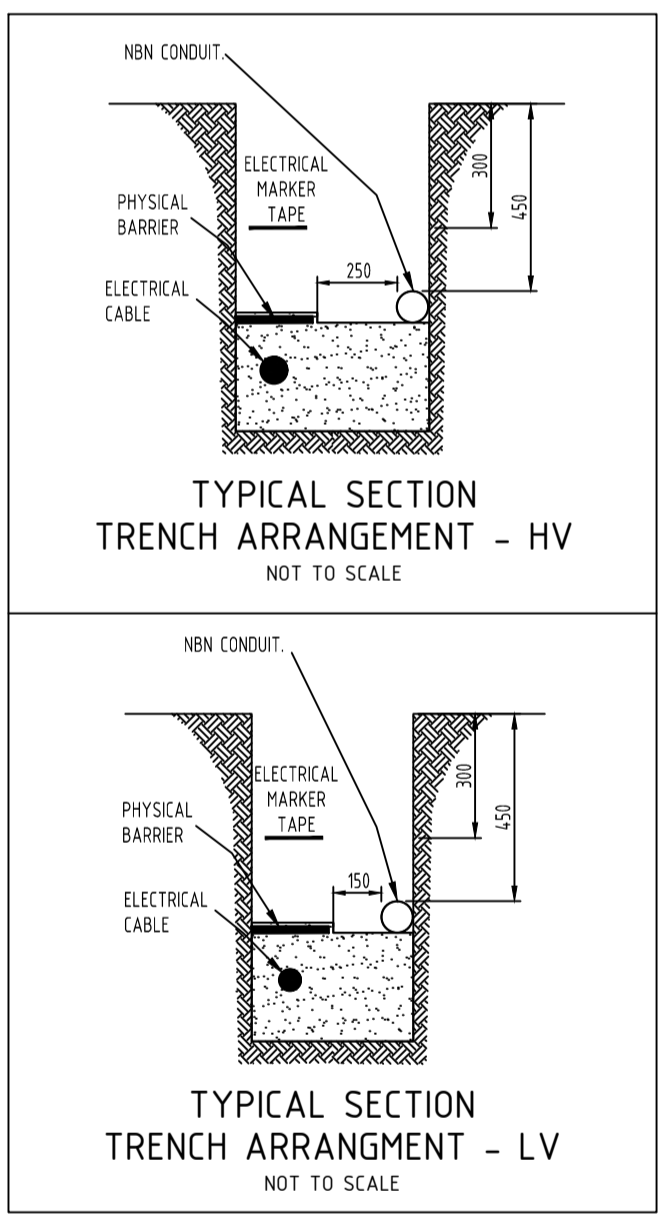

SDU Development Information

Development Name: IMAGINE ESTATE

Developer Company: ADTECH CONTRACTING PTY LTD

Development Address: IMAGINE DRIVE, STRATHFIELDSAYE, VIC

Authorised Rep: TEGAN LINGARD

Phone: 03 5441 7179

E-Mail: tegan.lingard@adtechcontracting.com.au

nbn Reference Number: STG-W000109323

Stage Number: 15

Design Revision: A

BILL OF MATERIAL				
NO OF LOTS: 26				
PITS		DUCTS		
SIZE	QTY	SIZE	QTY	MTRS
2	13	P100	21	684.9
5	10	P50	13	319.0
6	4	P20	26	325.0
8	1			
9	0			
TOTAL NUMBER OF PITS: 28				
TOTAL NUMBER OF MANHOLES: 0				
TOTAL NUMBER OF CONDUITS: 60				
TOTAL LENGTH OF CONDUITS: 1328.9				

STREET NAME	ELECTRICITY		PUBLIC LIGHT		NBN*		GAS		WATER		SEWER	
	OFFSET	SIDE	OFFSET	SIDE	OFFSET	SIDE	OFFSET	SIDE	OFFSET	SIDE	OFFSET	SIDE
IMAGINE DRIVE	1.40m	NORTH	1.1m BOK 3.0m BL	SOUTH	3.80m	NORTH	2.10m	SOUTH	3.00m	SOUTH	100m	SOUTH
SPECTRUM LANE	2.40m	EAST	1.0m BOK 3.0m BL	WEST	1.80m	EAST	1.90m	WEST	2.40m	WEST	100m	EAST
TRANQUIL STREET	2.40m	EAST	0.8m BOK 3.4m BL	EAST	1.90m	EAST	1.90m	WEST	2.40m	WEST	100m	WEST
PEACEFUL CRESCENT	2.40m	SOUTH	0.8m BOK 3.4m BL	SOUTH	1.90m	SOUTH	1.90m	NORTH	2.40m	NORTH	100m	SOUTH
UNITY WAY	2.40m	WEST	0.8m BOK 3.4m BL	WEST	1.90m	WEST	1.90m	EAST	2.40m	EAST		
ACCORD STREET	2.40m	EAST	0.8m BOK 3.2m BL	EAST	1.90m	EAST	1.90m	WEST	2.40m	WEST		

* OFFSET FOR NBN OFFSIDE P2 PITS IS 2.80m FROM B/L UNLESS OTHERWISE STATED
 NOTE: THIS TABLE IS FOR DESIGN PURPOSES ONLY AND CANNOT BE USED FOR ASSET LOCATIONS.



REV	DATE	DRAFTER	DESCRIPTION	APPROVED
C	31.08.2022	GJ (G3NS)	AS-BUILT	SM (G3NS)
B	03.08.2022	GJ (G3NS)	DESIGN REVIEW COMPLETED BY NBN, DRAWING ISSUED FOR CONSTRUCTION	SM (G3NS)
A	31.05.2022	KT (G3NS)	INITIAL DESIGN OF INTENT	GJ (G3NS)

STRICTLY CONFIDENTIAL

NBNC APPROVAL RECORD:

SIGNATURE: _____ DATE: _____

DD _____

WD _____

AB _____

QUALITY RECORD:

NBNC DISCLAIMER

THIS DOCUMENT HAS BEEN PREPARED SOLELY FOR THE USE OF NBNC LIMITED (ABN 86 136 533 741) FOR USE IN MAINTAINING NBNC FACILITIES. IT HAS NOT BEEN CREATED FOR ANY OTHER USE. IT SHOULD NOT BE SCALED TO LOCATE NBNC ASSETS. NO WARRANTY IS GIVEN THAT THE INFORMATION IS ACCURATE OR COMPLETE.

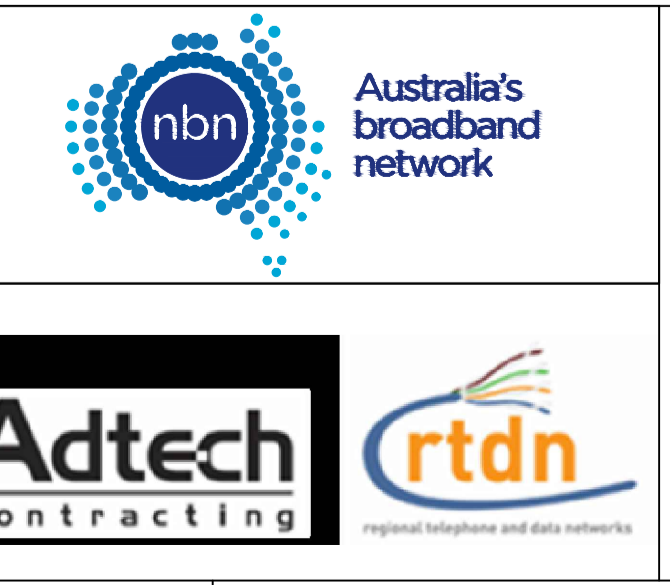

KEY PLAN

DRAWING TITLE: NBN PIT & PIPE AS-BUILT DESIGN

IMAGINE ESTATE STAGE 15

STRATHFIELDSAYE

26 LOTS

ENABLE#: 277108

STATE: VIC REGION:

PSA: SAM: ADA:

PROJECT No: STG-W000109323

CADREF No: G3NS4415

SCALE: N/A SHEET No. 1 OF 1 REV. C