

**Memorandum of common provisions
Restrictive covenants in a plan
Section 91A Transfer of Land Act 1958**

AA9749

Privacy Collection Statement

The information in this form is collected under statutory authority and is used for the purpose of maintaining publicly searchable registers and indexes.

Lodged by	
Name:	Robertson Hyetts
Phone:	03 5434 6666
Address:	386 Hargreaves Street, Bendigo 3550
Reference:	580142-19 REV
Customer code:	17512A

This memorandum contains provisions which are intended for inclusion in plans under the Subdivision Act 1988 to be subsequently lodged for registration.

Operative words including words to bind the burdened land and words of annexation must not be included.

Provisions to apply to the plan:

Burdened land: As set out in the plan.

Benefited land: As set out in the plan.

Covenants: Definitions (if any):

Building envelope means an area within each allotment (defined by the particular allotment setbacks) where development of a dwelling, shed, garage or carport is allowed subject to the particular provisions of this document, the Permit and the Scheme.

Building envelope plan means the plan which is attached to this MCP and which shows the building envelopes, certain setbacks and other related matters for the allotments within the plan of subdivision.

Coridale Design Guidelines means the Coridale Design Guidelines prepared by the Developer and in force at the time of DAP approval. The Developer may amend the Coridale Design Guidelines at its discretion.

35402012

V3

1. The provisions are to be numbered consecutively from number 1.
2. Further pages may be added but each page should be consecutively numbered.
3. To be used for the inclusion of provisions in plans.

91ATLA

Page 1 of 5

THE BACK OF THIS FORM MUST NOT BE USED

Land Use Victoria contact details: see www.delwp.vic.gov.au/property>Contact us

Original

AA9749

Memorandum of common provisions
Section 91A Transfer of Land Act 1958

DAP means the Design Assessment Panel appointed by the developer responsible for approving designs to be in accordance with this MCP.

Developer means Villawood Properties.

Lot means Lot 1101 to Lot 1153 (inclusive) within the Plan of Subdivision.

MCP means this Memorandum of Common Provisions.

Plan of Subdivision means the Plan of Subdivision PS:821033G.

Regulations means the Building Regulations 2018 or any subsequent regulations made pursuant to the Building Act which relate to the siting of a building.

Covenants:

1. Any building on a Lot must be contained within the building envelope (if any) shown on the attached building envelope plan and defined by the associated setback profiles and written notes contained therein.
2. The design of a dwelling to be built on a Lot must comply with this MCP and be consistent with the Coridale Design Guidelines and approved by the DAP.

**Memorandum of common provisions
Section 91A Transfer of Land Act 1958**

CORIDALE STAGE 11 BUILDING ENVELOPE PLAN
SEE PLAN OF SUBDIVISION PS821033G

LEGEND

EXAMPLE OF TYPICAL BUILDING
ENVELOPE SETBACK

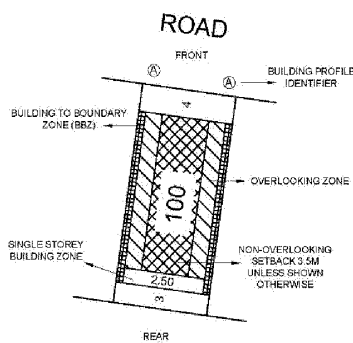

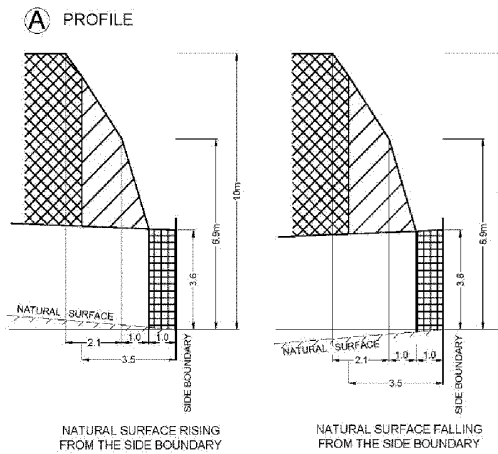

PROFILE DIAGRAM





NOTATIONS:

- THE FRONT AND SIDE SETBACKS ARE MEASURED TO THE OUTERMOST WALLS OF THE BUILDING.
- GARAGES MUST BE SETBACK A MINIMUM OF 5.0m FROM THE FRONT STREET BOUNDARY UNLESS OTHERWISE NOTED.
- WALLS LESS THAN 1m FROM THE BOUNDARY MUST BE WITHIN 200mm OF THE BOUNDARY.
- THE BBZ SHALL BE APPLICABLE TO ONE SIDE BOUNDARY ONLY, ONE SIDE BOUNDARY MUST BE KEPT CLEAR OF BUILDINGS. TERRACE STYLE LOTS ARE EXEMPT FROM THIS REQUIREMENT.
- THE SETBACK TO A SIDE STREET BOUNDARY FOR A CORNER LOT IS 2m UNLESS NOTED OTHERWISE.
- WHERE THE MINIMUM FRONT SETBACK IS 3.0m OR MORE, PORCHES, VERANDAHS AND ARCHITECTURAL FEATURES CAN ENCROACH INTO THE FRONT SETBACK BY UP TO 1.5m AT HEIGHTS OF UP TO 4.5m FOR A SINGLE STOREY HOME AND HEIGHTS OF UP TO 9.0m FOR A TWO-STOREY HOME.
- WHERE THE MINIMUM FRONT SETBACK IS LESS THAN 3.0m PORCHES, VERANDAHS, AND ARCHITECTURAL FEATURES CAN ENCROACH INTO THE FRONT SETBACK BY UP TO 1.0m AT HEIGHTS OF UP TO 4.5m FOR A SINGLE STOREY HOME AND HEIGHTS OF UP TO 9.0m FOR A TWO-STOREY HOME.
- TWO-STOREY DWELLINGS MUST BE SETBACK A MINIMUM OF 5.5m FROM THE REAR BOUNDARY UNLESS OTHERWISE NOTED.
- THE BUILDING REGULATIONS APPLY TO CONSTRUCTION OF DWELLINGS AND NEED TO BE ADHERED TO IN RELATION TO DESIGN PRINCIPLES.

SINGLE STOREY BUILDING ENVELOPE HATCH TYPE

-  BUILDING BOUNDARY ZONE (BBZ)
-  SINGLE STOREY BUILDING ZONE

DOUBLE STOREY BUILDING ENVELOPE HATCH TYPE

-  OVERLOOKING ZONE - Habitable room windows or raised open spaces are a source of overlooking
-  NON OVERLOOKING ZONE - Habitable room windows or raised open spaces are not a source of overlooking

THE REGISTERED PROPRIETOR OR PROPRIETORS OF THE LOT ARE REQUIRED TO BUILD IN ACCORDANCE WITH THE BUILDING ENVELOPES SHOWN HEREON AND IN THE "PROFILE DIAGRAMS" IN THIS DOCUMENT.

Lyssna Group Pty Ltd
 ABN 18 916 913 193
 Tel: +61 3 9515 6599
 PO Box 1098, South Melbourne 3205
 Suite 3, 102 Dooda Street
 Southbank VIC 3006 Australia
 lyssnaGroup.com

Sheet 1 of 3 VERSION 4
 Drawing Date 16/01/23
 Job Number AA0049
 Drawing Number BE11AG
 Drawn By BA

**Memorandum of common provisions
Section 91A Transfer of Land Act 1958**

AA9749

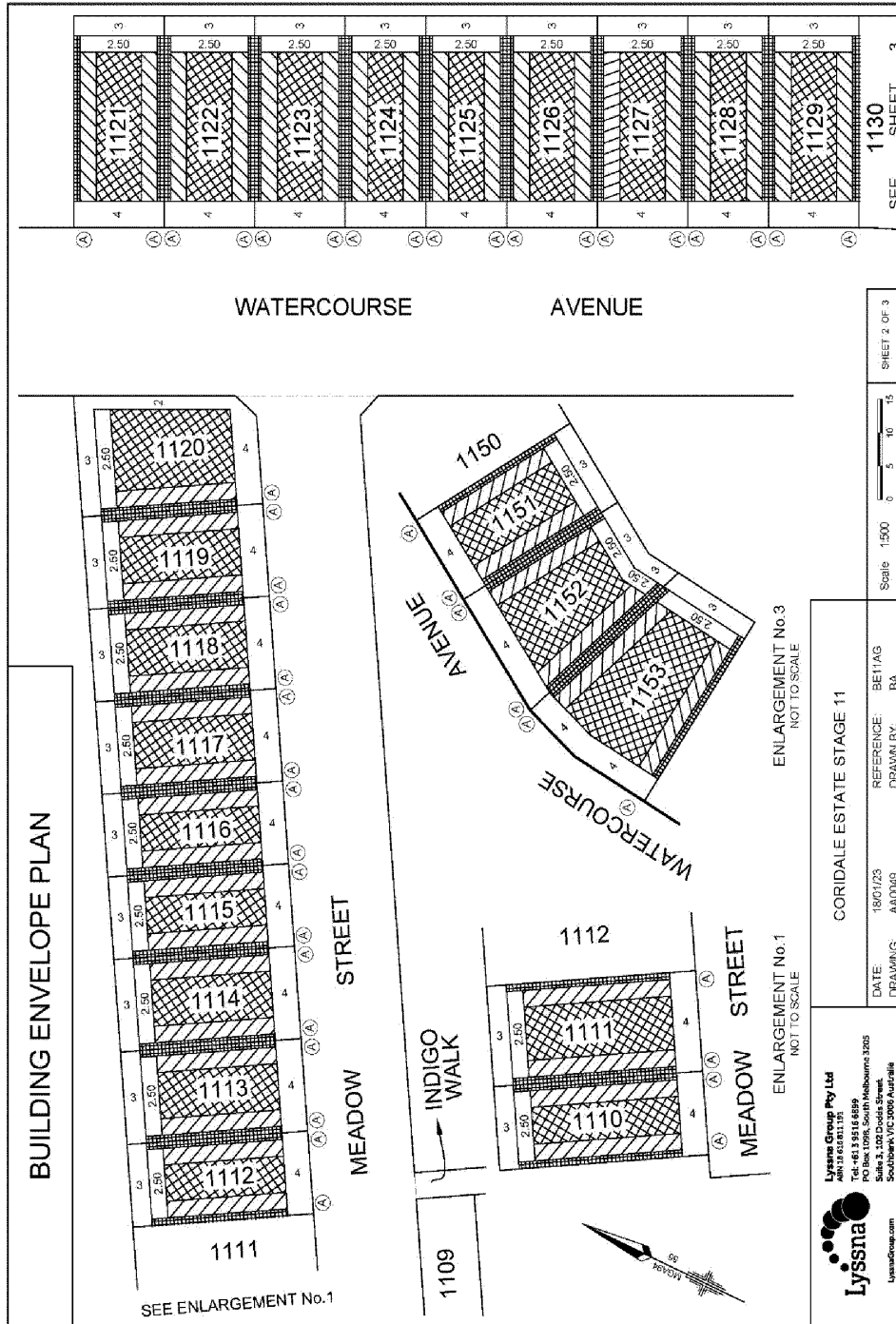

Lyssna Group Pty Ltd
 Admin 20 Melburn 1125
 Tel: +61 3 9516 6599
 PO Box 12016, South Melbourne 3205
 Suite 3, 120 Collins Street
 Southbank VIC 3207 Australia
 LyssnaGroup.com



DATE: 18/07/23
DRAWING: A0008

REFERENCE: BE11AG
DRAWN BY: BA

Scale: 1:1500
0 5 10 15
SHEET 2 OF 3

ENLARGEMENT No.3
NOT TO SCALE

ENLARGEMENT No.1
NOT TO SCALE

CORIDALE ESTATE STAGE 11

Memorandum of common provisions Section 91A Transfer of Land Act 1958

AA9749

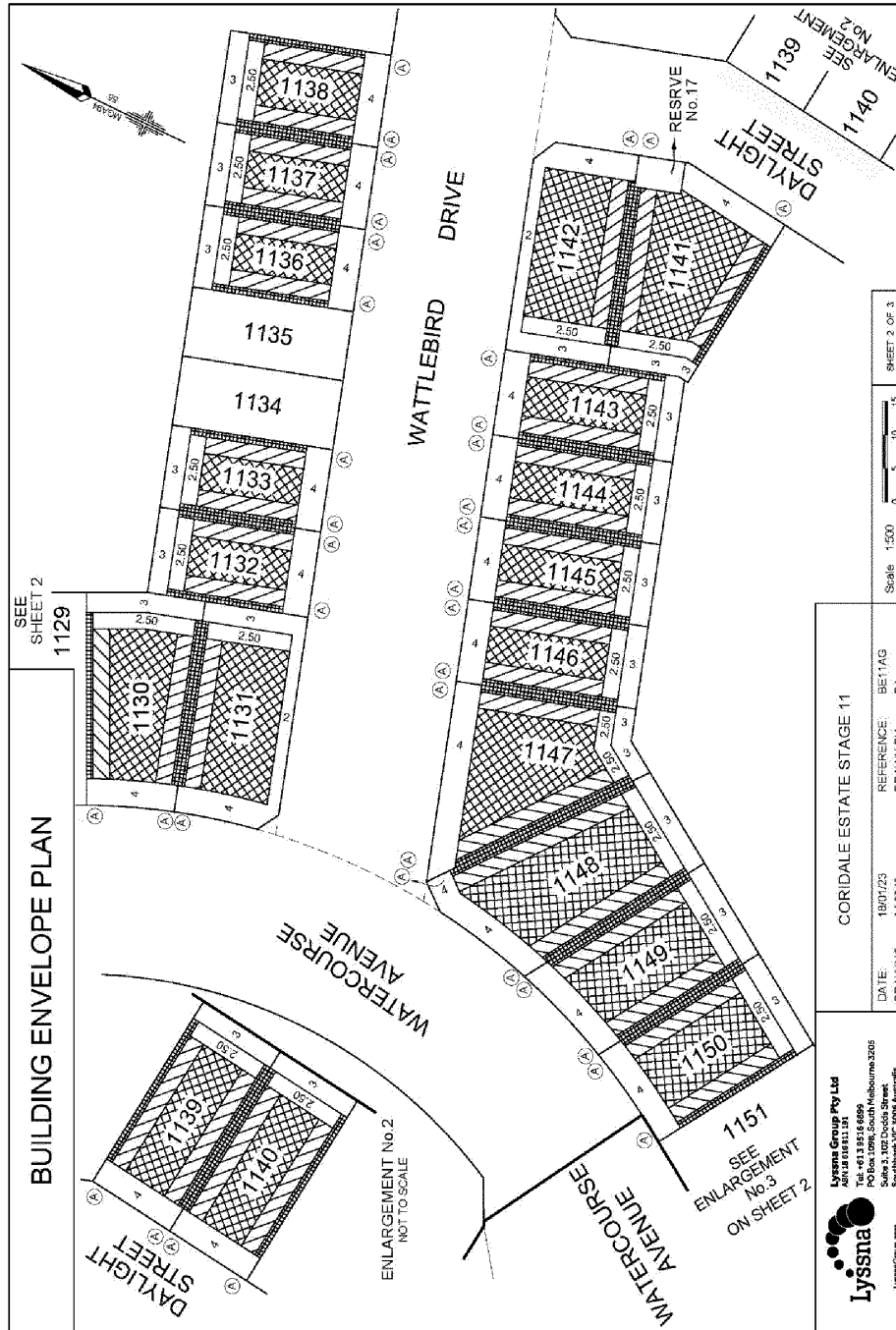

Expiry: _____

91ATLA

Page 5 of 5

V3

THE BACK OF THIS FORM MUST NOT BE USED

Land Use Victoria contact details: see www.delwp.vic.gov.au/property > Contact us

OFFICIAL