

SERVICE OFFSET TABLE

ROAD NAME	FILTERED-WATER		RAW-WATER		GAS		NBN*		ELEC	
	SIDE	O/S	SIDE	O/S	SIDE	O/S	SIDE	O/S	SIDE	O/S
MAYFLOWER DRIVE	W	2.15	W	2.45	W	3.15	E	1.20	E	0.40
EMERALD AVENUE	S	2.12	S	2.55	S	2.95	N	1.20	N	0.40

*OFFSET FOR NBN OFFSIDE P2 PITS IS 4.30m FROM B/L UNLESS OTHERWISE STATED.
NOTE: THIS TABLE IS FOR DESIGN PURPOSES ONLY AND CANNOT BE USED FOR ASSET LOCATIONS.

PIT LEGEND

Shared Trench Symbol

PIT-ID	Service Drop Access Pit
2	650mm(L) x 280mm(W) x 565mm(D)
PIT-ID	Network Boundary/Local Network Pit
5	700mm(L) x 450mm(W) x 650mm(D)
PIT-ID	Distribution/Local Network Connection Pit
6	1360mm(L) x 555mm(W) x 650mm(D)
PIT-ID	Distribution/Local Network Connection Pit
8	1360mm(L) x 555mm(W) x 860mm(D)
PIT-ID	Fibre Distribution Hub Pit
9	2000mm(L) x 555mm(W) x 900mm(D)

PIT LIDS TO BE LABELLED "NBN".

CONSTRUCTOR IS TO ENSURE PITS ARE INSTALLED IN NON-TRAFFICABLE AREAS, AT LEAST 15m AWAY FROM EPR ZONES AND CLEAR OF OTHER AUTHORITY EASEMENTS.

SERVICES CLEARANCES

SERVICES ITEM	MINIMUM RADIAL CLEARANCES
GAS - LARGE MAIN (OVER 110mm DIA.)	300mm
SMALL MAIN (110mm DIA. OR LESS)	150mm
ELECTRICAL - HIGH VOLTAGE	300mm
LOW VOLTAGE	100mm *2
WATER - HIGH CAPACITY MAIN	300mm
LOCAL RETICULATION	150mm
SEWER - MAIN	300mm
CONNECTION PIPE	150mm
OTHER TELECOMMUNICATIONS	100mm *1
DRAINAGE - MAIN	300mm
CONNECTION PIPE	150mm

* 1 - REDUCED SEPARATION IS POSSIBLE WHERE ALL PARTIES ARE CONSULTED AND AGREEMENT IS REACHED.
* 2 - ONLY WHERE PROTECTION BARRIERS ARE USED, FOR EXAMPLE, CONDUIT, BEDDING, MARKER TAPE & COVER BATTEN.

PCD / NTD LOCATIONS

P20 LEAD-IN LOCATIONS ARE INDICATIVE ONLY, AND ARE TO BE CONFIRMED AT TIME OF CONSTRUCTION.

FOR LOCATION REQUIREMENTS REFER TO NBN DOCUMENT: NBN-DES-STD-0011

RESIDENTIAL PREPARATION AND INSTALLATION: SINGLE DWELLING UNITS (SDUs) AND MULTI DWELLING UNITS (MDUs)

ISSUE DATE: 12 DEC 2016 REVISION NO. 11.0

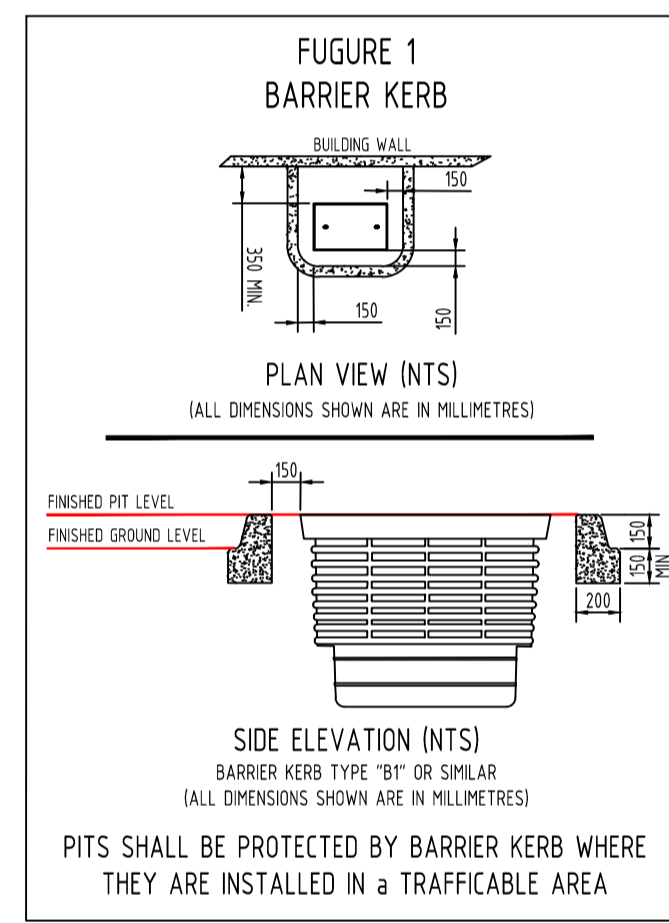

DESIGN & INSTALLATION SPECIFICATIONS

THIS DESIGN IS TO BE READ IN CONJUNCTION WITH NBN DOCUMENT: NBN-TE-CTO-194

"NEW DEVELOPMENTS: DEPLOYMENT OF THE NBN PIT AND CONDUIT NETWORK"

ISSUE DATE: 08/12/2017, REVISION: 8

ALL DEPLOYMENT WORKS TO BE COMPLETED TO NBN SPECIFICATIONS AS OUTLINED IN THE ABOVE DOCUMENT

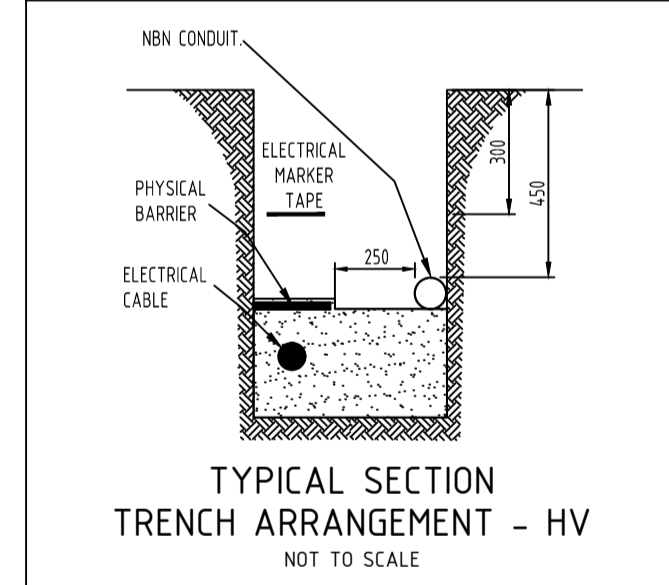

SDU Development Information

Development Name: MAIDENS GREEN ESTATE
Developer Company: ADTECH CIVIL PTY LTD
Development Address: MAYFLOWER DRIVE, MOAMA, VIC
Authorised Rep: GEORGE PETROV
Phone: 0447 959 248
E-Mail: george.petrov@adtechcontracting.com.au

nbn Reference Number: STG-W000229645	Stage Number: 1
	Design Revision: C

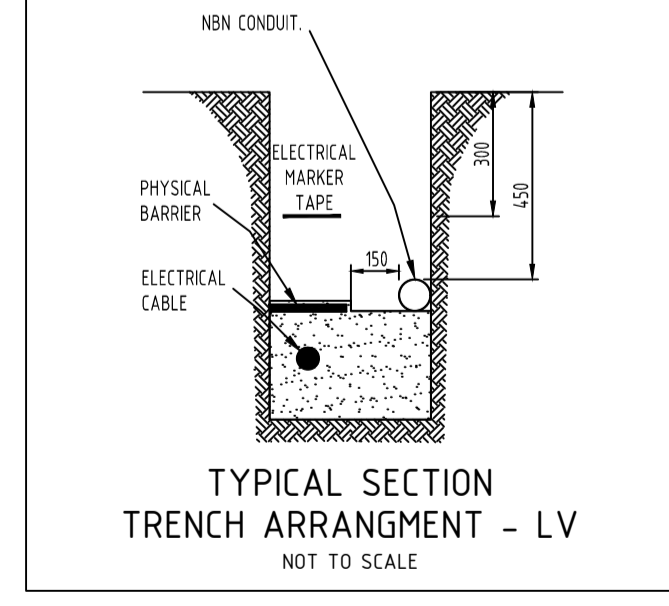

BILL OF MATERIAL

NO OF LOTS: 23

PITS		DUCTS		
SIZE	QTY	SIZE	QTY	MTRS
2	5	P100	11	293.1
5	8	P50	5	144.0
6	1	P20	23	305.0
8	0			
9	0			

TOTAL NUMBER OF PITS: 14
TOTAL NUMBER OF MANHOLES: 0
TOTAL NUMBER OF CONDUITS: 39
TOTAL LENGTH OF CONDUITS: 742.1



REV	DATE	DRAFTER	DESCRIPTION	APPROVED
C	03.10.2022	GJ (G3NS)	AS-BUILT	SM (G3NS)
B	10.05.2022	GJ (G3NS)	DESIGN REVIEW COMPLETED BY NBN, DRAWING ISSUED FOR CONSTRUCTION	SM (G3NS)
A	21.01.2022	KT (G3NS)	INITIAL DESIGN OF INTENT	GJ (G3NS)

STRICTLY CONFIDENTIAL

NBNC APPROVAL RECORD:

SIGNATURE	DATE
<input type="checkbox"/> DD	_____
<input type="checkbox"/> WD	_____
<input type="checkbox"/> AB	_____

QUALITY RECORD:

NBNC DISCLAIMER
THIS DOCUMENT HAS BEEN PREPARED SOLELY FOR THE USE OF NBNC LIMITED (ABN 86 136 533 741) FOR USE IN MAINTAINING NBNC FACILITIES. IT HAS NOT BEEN CREATED FOR ANY OTHER USE. IT SHOULD NOT BE SCALED TO LOCATE NBNC ASSETS. NO WARRANTY IS GIVEN THAT THE INFORMATION IS ACCURATE OR COMPLETE.

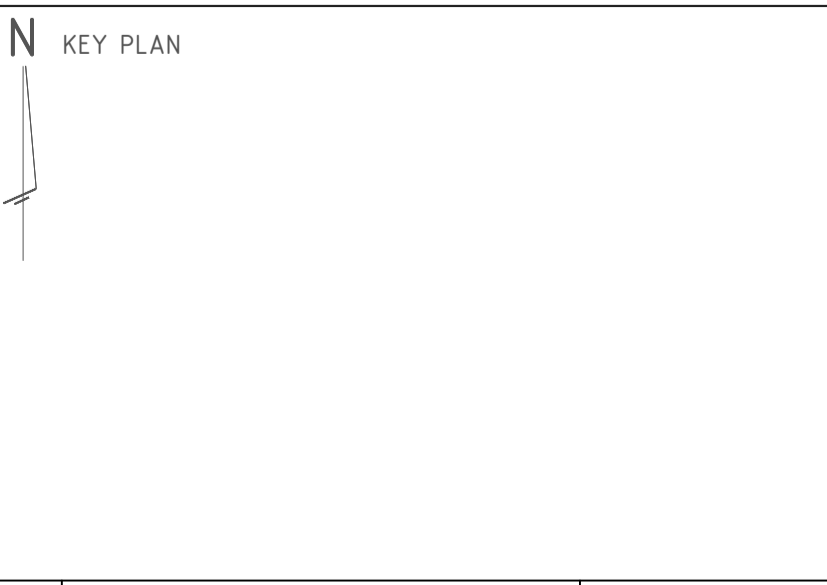
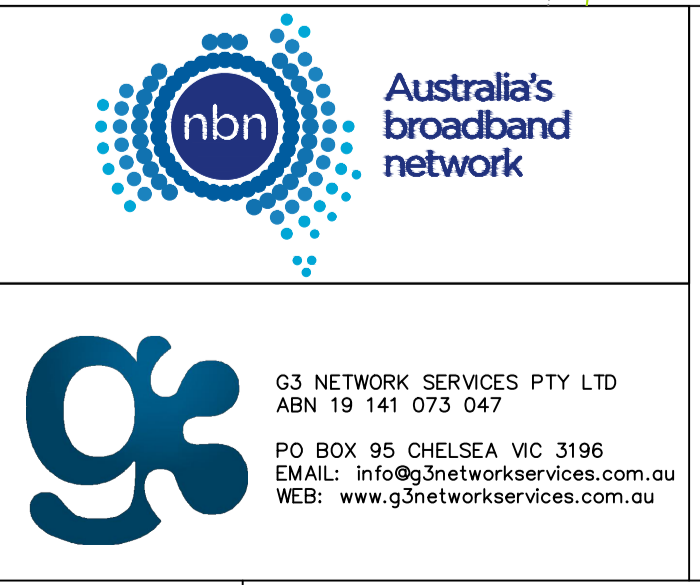

DRAWING TITLE: NBN PIT & PIPE AS-BUILT DESIGN
MAIDENS GREEN ESTATE STAGE 1
MOAMA
23 LOTS

ENABLE#: 277108

STATE: NSW REGION: _____

PROJECT No: STG-W000229645

CADREF No: G3NS4212

SCALE: N/A SHEET No. 1 OF 1 REV. C