

IMAGINE STAGE 30

ROADS & DRAINAGE PLANS

53 DUKES LANE - STRATHFIELDSAYE

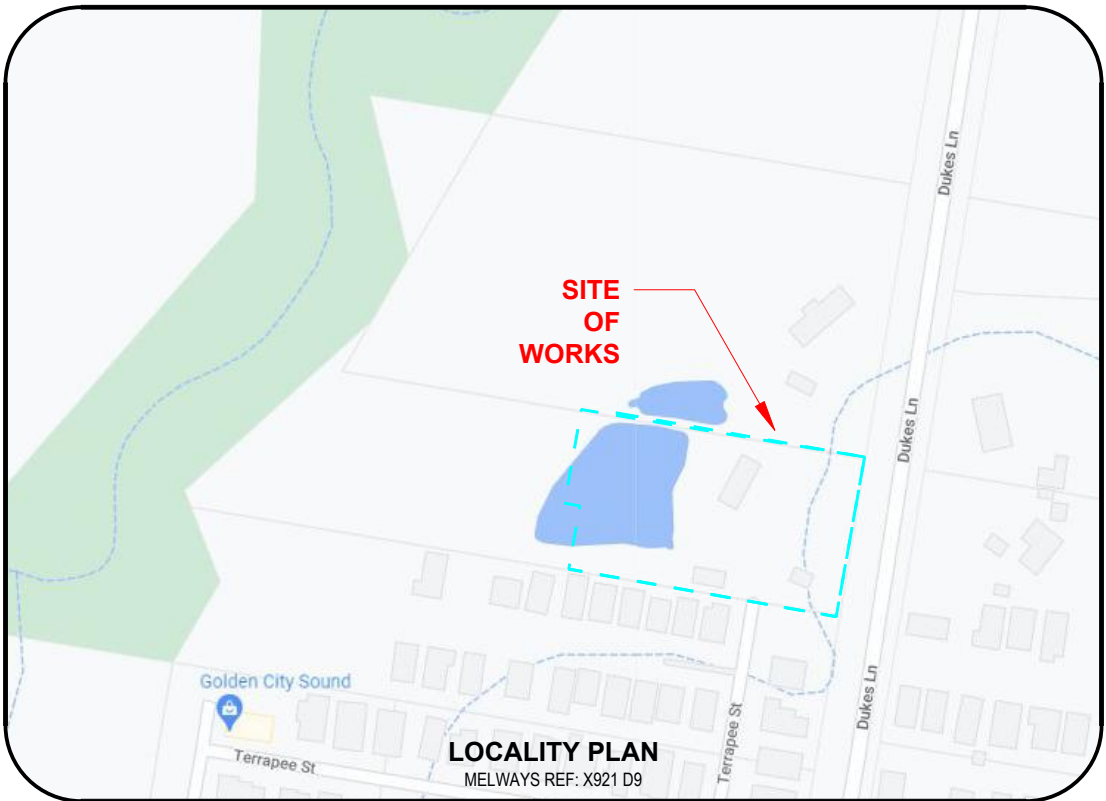

LOCALITY PLAN
MELWAYS REF: X921 D9

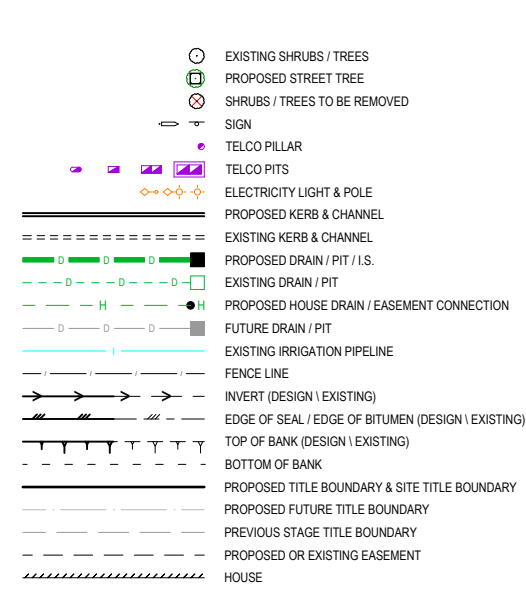

DRAWING LIST

1352030R01	LOCALITY PLAN & GENERAL NOTES
1352030R02	OVERALL DEVELOPMENT PLAN
1352030R03	EXISTING CONDITIONS & SURVEY STATIONS \ TBM'S
1352030R04	DETAIL PLAN
1352030R05	CUT & FILL DEPTH RANGE & LOT LEVELS
1352030R06	PAVEMENT, SIGNAGE & LINEMARKING PLAN
1352030R07	SHARED DRIVEWAY & 90° BEND DETAILS
1352030R08	INTERSECTION DETAILS
1352030R09	TYPICAL SECTIONS
1352030R10	TERRAPEE STREET LONG SECTION
1352030R11-12	TERRAPEE STREET CROSS SECTION (2 SHEETS)
1352030R13	MYRTLE LANE LONG & CROSS SECTION
1352030R14	SHARED DRIVEWAY CROSS & LONG SECTIONS
1352030R15	DRAINAGE LONG SECTIONS (1 OF 2)
1352030R16	DRAINAGE LONG SECTION (2 OF 2) + PIT SCHEDULE
1352030R17	DRAINAGE CATCHMENT PLAN
1352030R18	DRAINAGE HYDRAULIC / HYDROLOGY CALC SHEET

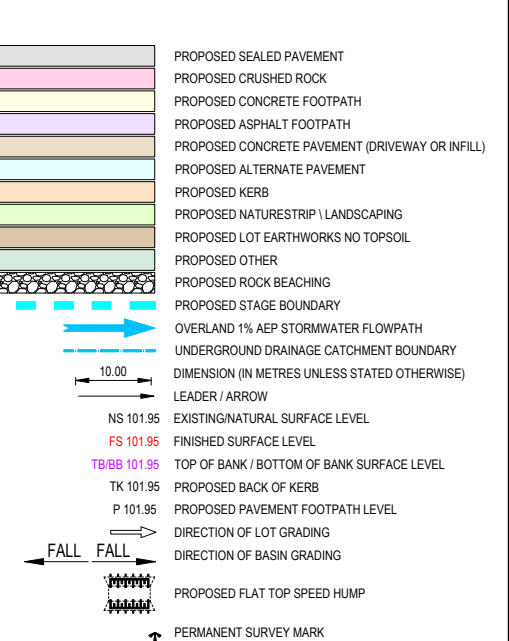
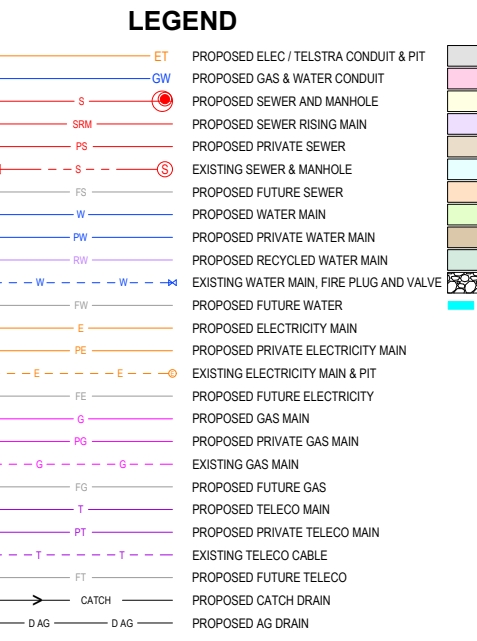

TABLE OF OFFSETS FOR SERVICES

STREET	GAS	NDW	DW	TELCO	UG ELEC	LIGHTING	BOK
TERRAPEE STREET E-W	-	-	2.40	S	1.90	N	2.40
TERRAPEE STREET S-N	-	-	2.40	W	1.90	E	2.40
MYRTLE LANE	-	-	3.70	N	1.90	N	2.40

REVISION C CHANGES TO PLANS ENCLOSED BY A REVISION BOUNDARY



REFER TO ELECTRICAL AND TELSTRA PLANS FOR SERVICE AND CONDUIT DETAILS

WARNING
BEWARE OF UNDERGROUND SERVICES
THE LOCATIONS OF UNDERGROUND SERVICES ARE APPROXIMATE ONLY AND THEIR EXACT POSITION SHOULD BE PROVEN ON SITE. NO GUARANTEE IS GIVEN THAT ALL EXISTING SERVICES ARE SHOWN.

GENERAL NOTES

- PRIOR TO THE COMMENCEMENT OF WORKS**
- THE CONTRACTOR MUST NOTIFY THE RELEVANT AUTHORITY 7 DAYS PRIOR TO COMMENCEMENT OF CONSTRUCTION OF THE RELEVANT WORKS.
 - THE CONTRACTOR MUST OBTAIN ALL NECESSARY PERMITS FROM THE MUNICIPALITY & VICROADS FOR ANY WORKS UNDERTAKEN WITHIN AN EXISTING ROAD RESERVE PRIOR TO THE COMMENCEMENT OF WORKS.
 - THE CONSULTANT HAS MADE EVERY REASONABLE ATTEMPT TO LOCATE EXISTING SERVICES AND HAS SHOWN THESE ON THE DRAWINGS. THE CONTRACTOR SHALL TAKE PHOTOGRAPHS AND PROVIDE A WRITTEN REPORT DETAILING THE CONDITION REGARDING ALL EXISTING INFRASTRUCTURE WHICH THEY ARE INTERFACING WITH, OR OTHERWISE HAVING AN IMPACT ON.
 - PRIOR TO COMMENCING WORKS THE CONTRACTOR SHALL VERIFY THE LOCATION OF ALL SERVICES BY SITE SURVEY (INSPECTION AND CONSULTATION WITH ALL RELEVANT SERVICING AUTHORITIES). THE CONTRACTOR SHALL BE RESPONSIBLE FOR ANY DAMAGE TO EXISTING SERVICES, WHETHER SHOWN OR NOT.
 - THE CONTRACTOR MUST CONTACT DIAL BEFORE YOU DIG (CALL 1100), OR VISIT THE DIAL BEFORE YOU DIG WEBSITE PRIOR TO COMMENCING WORKS AND SATISFY THEMSELVES THAT THERE ARE NO SERVICES WITHIN THE VICINITY OF THE WORK AREA.
 - NO WORK IS TO COMMENCE BEFORE THE CONTRACTOR HAS ASCERTAINED WHAT UNDERGROUND SERVICES ARE PRESENT.
 - CONTRACTOR MUST FOLLOW THE "NO GO ZONE" SAFETY PROCEDURES AT ALL TIMES, WHICH ARE AVAILABLE FROM ALL UTILITY AND TELECOMMUNICATIONS COMPANIES, INCLUDING THE OFFICE OF THE CHIEF ELECTRICAL INSPECTOR, THE OFFICE OF GAS SAFETY AND WORKSAFE VICTORIA.
 - IF THESE SAFETY PROCEDURES CANNOT BE COMPLIED WITH THEN NO WORK IS TO BE UNDERTAKEN WITHOUT PERMISSION FROM THE UTILITY COMPANY.
 - THE CONTRACTOR MUST PREPARE A PROJECT MANAGEMENT PLAN (OTHERWISE CALLED A CONSTRUCTION OR SITE MANAGEMENT PLAN) AND HAVE IT APPROVED BY BOTH COUNCIL & THE SUPERINTENDENT PRIOR TO THE COMMENCEMENT OF ANY WORKS. THIS PROJECT MANAGEMENT PLAN IS TO INCORPORATE THE FOLLOWING AT A MINIMUM AND IN ACCORDANCE WITH ANY LEGISLATION REQUIREMENTS:
 - OCCUPATIONAL HEALTH & SAFETY PROCEDURES
 - SITE STAFFING INCLUDING CONTACT DETAILS
 - TRAFFIC MANAGEMENT PLAN

- CONSTRUCTION SETOUT**
- ALL LEVELS ARE TO A.H.D. AND ARE REFERENCED TO THE T.B.M. INDICATED.
 - COORDINATION OF THIS DESIGN USES MGA2020, CORRECT AS OF THE DATE OF THESE PLANS. MGA94 MAY HAVE BEEN USED PREVIOUSLY ON THIS SITE OR AN ADJOINING PROPERTY AND SUCH WORK WILL DIFFER IN POSITION BY AROUND 1.8 METRES FROM THIS DOCUMENT. ORIENTATION (NORTH) REMAINS THE SAME BETWEEN MGA94 AND MGA2020.
 - NO TBM CAN BE USED WITHOUT FIRST PROVING IT TO BE CORRECT TO A SECOND TBM. NO HORIZONTAL SETOUT CONTROL CAN BE USED WITHOUT FIRST PROVING IT TO BE CORRECT TO A THIRD KNOWN POINT. THE CONSULTING SURVEYOR IS TO BE NOTIFIED OF ANY DISCREPANCIES IMMEDIATELY. TITLE PEGS AND T.B.M.'S TO BE RE-ESTABLISHED BY A LICENSED SURVEYOR IF FOUND TO BE MISSING.
 - IF USING GNSS \ GPS TO SETOUT FOR CONSTRUCTION PLEASE NOTE:
 - GNSS HAS REDUCED VERTICAL PRECISION COMPARED TO TRADITIONAL SURVEY METHODS.
 - ONLY USE A SINGLE POINT CALIBRATION FOR THE VERTICAL THEN TEST TO AT LEAST 1 OTHER STATED TBM BEFORE PROCEEDING.
 - IF YOU HAVE ANY QUERIES OR CONCERNS CONTACT THE CONSULTING SURVEYOR.
- SITE MANAGEMENT DURING CONSTRUCTION**
- THE SUPERINTENDENT IS RESPONSIBLE FOR THE DESIGN AND MANAGEMENT OF THE CONSTRUCTION WORKS. ANY PROBLEMS ARISING DURING CONSTRUCTION SHALL BE DIRECTED TO THE SUPERINTENDENT.
 - ALL WORKS SHALL BE CONSTRUCTED IN ACCORDANCE WITH THE INFRASTRUCTURE DESIGN MANUAL AND ANY OTHER RELEVANT AUTHORITY SPECIFICATIONS. A COPY OF THE INFRASTRUCTURE DESIGN MANUAL CAN BE FOUND AT www.designmanual.com.au. IF YOU HAVE ANY ISSUES INTERPRETING THE MANUAL CONTACT THE SUPERINTENDENT.
 - ALL WORKS MUST ABIDE BY THE APPROVED CONSTRUCTION MANAGEMENT PLAN AND MUST COMPLY WITH THE RECOMMENDATIONS OF THE ENVIRONMENT PROTECTION AUTHORITY PUBLICATION "CONSTRUCTION TECHNIQUES FOR SEDIMENT POLLUTION CONTROL" (PUBLICATION NO 275). APPROPRIATE SILTATION CONTROL IS TO BE CARRIED OUT DURING THE CONSTRUCTION AND MAINTENANCE PERIOD.
 - BEFORE COMMENCING ANY EXCAVATION WORKS OF 1.5m DEPTH OR GREATER,

- THE CONTRACTOR IS REQUIRED TO SUBMIT THE REQUIRED NOTIFICATION TO WORKSAFE VICTORIA. THE NOTIFICATION MUST BE RECEIVED BY THE AUTHORITY AT LEAST 3 DAYS PRIOR TO COMMENCING EXCAVATIONS, A COPY OF THE NOTIFICATION IS TO BE PROVIDED TO THE SUPERINTENDENT. THE CONTRACTOR SHALL COMPLY WITH THE MINES ACT, OCCUPATIONAL HEALTH AND SAFETY ACT, WORKSAFE VICTORIA REQUIREMENTS INCLUDING COMPLIANCE CODES.
- TWENTY-FOUR (24) HOURS NOTIFICATION TO INSPECTORS OF RELEVANT AUTHORITY IS REQUIRED PRIOR TO AN INSPECTION BEING CONDUCTED ON ANY PARTICULAR PORTION OF THE WORKS.
 - THE CONTRACTOR SHALL TAKE THE UTMOST CARE TO PRESERVE EXISTING TREES. NO TREES SHALL BE REMOVED WITHOUT THE PRIOR APPROVAL OF THE SUPERINTENDENT.
 - THE CONTRACTOR IS REQUIRED TO CONFINED CONSTRUCTION VEHICLES TO THE ROAD RESERVE AND EASEMENTS. ANY DAMAGE CAUSED TO THE ALLOTMENTS MUST BE MADE GOOD.
 - THE CONTRACTOR SHALL TO THE SATISFACTION OF THE SUPERINTENDENT AND COUNCIL'S SUPERVISING OFFICER PROVIDE AND MAINTAIN ALL NECESSARY WARNING SIGNAGE, LIGHTING AND BARRICADING TO COMPLY WITH THE REQUIREMENTS OF THE ROAD MANAGEMENT ACT.
 - DISPOSAL OF EXCESS SPOIL TRUCK ROUTE AND DISPOSAL LOCATION ARE TO BE APPROVED BY THE MUNICIPAL ENGINEERING DEPARTMENT.
 - AT THE COMPLETION OF WORKS ALL RUBBISH, DEBRIS AND SURPLUS SPOIL IS TO BE REMOVED AND ALL LOTS AND ROAD RESERVE TO BE LEFT IN A TIDY CONDITION TO THE SATISFACTION OF THE SUPERINTENDENT & RELEVANT AUTHORITY.
- PROTECTION OF VEGETATION**
- NO WORKS ARE TO BE UNDERTAKEN WITHIN THE DRIP ZONE (CANOPY) OF AN EXISTING TREE UNLESS APPROVED BY THE RESPONSIBLE AUTHORITY.
 - MACHINERY IS NOT TO BE DRIVEN OVER OR PARKED WITHIN THE DRIP ZONE OF ANY TREE.
- EARTHWORKS**
- ALL EARTHWORKS ARE TO BE UNDERTAKEN IN ACCORDANCE WITH AS 3798 (2007) - GUIDELINES ON EARTHWORKS FOR COMMERCIAL AND RESIDENTIAL DEVELOPMENTS.
 - ALL FILLING WITHIN AREAS OF PROPOSED ROAD PAVEMENT IS TO ACHIEVE A MINIMUM COMPACTION OF 98% STANDARD.

- ALL FILLING WITHIN OTHER AREAS IS TO ACHIEVE A MINIMUM COMPACTION OF 95% STANDARD.
 - ANY FILLING IN EXCESS OF 300mm DEPTH IS TO BE CARRIED OUT UNDER LEVEL 1 SUPERVISION UNLESS DIRECTED OTHERWISE. FILL AREAS ARE TO BE STRIPPED OF TOPSOIL & FILLED USING APPROVED CLAY FILL. TOPSOIL IS TO BE REPLACED NO MORE THAN 150mm THICK TO OBTAIN FINAL FILL LEVELS AS SHOWN ON PLANS. ALL FILLING TO BE CARRIED OUT IN 150mm LAYERS AND COMPACTED AS DETAILED ABOVE IN ACCORDANCE WITH AS 3798-2007 (GUIDELINES ON EARTHWORKS FOR COMMERCIAL AND RESIDENTIAL DEVELOPMENTS). ON COMPLETION THE CONTRACTOR SHALL PRESENT A "LEVEL 1" TYPED REPORT NOMINATING THE EXTENT OF FILL PLACED, ITS CONFORMANCE WITH THE SPECIFICATION AND ITS CLASSIFICATION AS "CONTROLLED FILL". IF ANY SUBSTANDARD FILLING IS ENCOUNTERED ON THE SITE IT MUST BE REMOVED AND REPLACED WITH VERIFICATION PROVIDED TO THE SUPERVISING ENGINEER. A GEO-TECHNICAL REPORT MUST BE SUBMITTED SHOWING DETAILS OF DEPTH, TYPE OF MATERIAL AND DENSITY OF THE FILL AREAS CONCERNED.
 - THE SUPERINTENDENT IS TO BE ADVISED OF ANY FILLING THAT ACHIEVES A DEPTH OF 300mm OR GREATER.
 - THE CONTRACTOR IS RESPONSIBLE FOR ENSURING THAT ALL IMPORTED FILL MATERIAL, INCLUDING TOPSOIL, SATISFIES THE DESCRIPTION FOR CLEAN FILL MATERIAL IN EPA BULLETIN PUBLICATION NO. 448 (MAY 2007) AND SUBSEQUENT REVISIONS. THE CONTRACTOR SHALL PROVIDE VERIFICATION INCLUDING TEST CERTIFICATES TO THE SUPERVISING ENGINEER.
 - ALL TRENCHES ARE TO ACHIEVE THE SPECIFIED COMPACTION RESULTS WITHOUT EXCEPTION. THE SUPERINTENDENT RESERVES THE RIGHT TO REQUIRE COMPACTION TESTING BY A NATA APPROVED LABORATORY AT THE CONTRACTORS EXPENSE.
 - ALL EXCAVATIONS OF DEPTH 1.5m OR GREATER MUST COMPLY WITH LEGISLATION ENFORCED BY WORKSAFE VICTORIA. A "NOTICE OF INTENTION TO COMMENCE EXCAVATION" MUST BE SUBMITTED TO YOUR LOCAL WORKSAFE OFFICE.
 - ALL LOTS ARE TO ACHIEVE A MINIMUM CROSS FALL OF 1 IN 150 (0.67%) TO A LEGAL POINT OF DISCHARGE (DRAINAGE POINT OR ROAD RESERVE) UNLESS STATED OTHERWISE.
 - RESERVES TO BE FREE DRAINING AND TO BE LEFT IN A CONDITION SATISFACTORY TO THE SUPERINTENDENT.
- ROAD WORKS AND FOOTPATHS**
- ALL KERB & CHANNEL IS MODIFIED SM2 (IDM SD 100) UNLESS STATED OTHERWISE.

- ALL ASPHALT ROAD SEALS ARE TO BE 7mm TYPE 'N' UNLESS STATED OTHERWISE.
 - ALL KERB RADII ARE TO BACK OF KERB UNLESS STATED OTHERWISE.
 - ALL FOOTPATHS ARE TO BE CONSTRUCTED AS PER INFRASTRUCTURE DESIGN MANUAL (IDM) 200 SERIES STANDARD DRAWINGS AND IN ACCORDANCE WITH COUNCIL STANDARDS UNLESS STATED OTHERWISE.
 - TGSis ARE TO BE INSTALLED ON ALL PEDESTRIAN CROSSINGS AS PER AS 1428.4.
 - ALL NEW INTERSECTIONS ARE TO HAVE STREET SIGNS INSTALLED TO COUNCIL STANDARDS IRRESPECTIVE OF WHETHER THEY ARE DETAILED ON THE ENGINEERING PLANS OR NOT.
 - AT ALL TEMPORARY STAGE BOUNDARY TERMINATIONS TO ROADS THE CONTRACTOR IS TO INSTALL A D4-HAZARD SIGN.
 - ALL CONCRETE IS TO HAVE A MINIMUM COMPRESSIVE STRENGTH OF 25MPa AT 28 DAYS AND MINIMUM CEMENT CONTENT OF 320 kg/m³.
 - TRANSITIONS BETWEEN DIFFERENT KERB TYPES TO BE OVER 3.0m MINIMUM, IF IT CANNOT BE ACHIEVED AT A PRAM CROSSING OR DRIVEWAY CROSSOVER.
 - ROAD PAVEMENT DESIGN & TESTING REQUIREMENTS ARE AS PER THE INFRASTRUCTURE DESIGN MANUAL.
- STORMWATER DRAINAGE AND SERVICE CONDUIT NOTES**
- ALL EASEMENT DRAINAGE PIPES ARE 1.0m OFFSET TITLE BOUNDARY UNLESS DIMENSIONED OTHERWISE.
 - ALL EASEMENT DRAINAGE PITS ARE TO BE ARE 1.0m PAST TITLE BOUNDARY UNLESS DIMENSIONED OTHERWISE.
 - ALL PROPERTY DRAINAGE CONNECTIONS FROM ROAD RESERVES ARE TO ENTER THE PROPERTY 1.0m O/S SIDE BOUNDARY ON THE LOW SIDE WITH 0.5m COVER UNLESS NOTED OTHERWISE.
 - ALL STORMWATER AND CONDUIT TRENCHES UNDER ROAD PAVEMENT, KERB & CHANNEL AND FOOTPATH SHALL BE BACKFILLED IN ACCORDANCE WITH THE IDM UNLESS STATED OTHERWISE.
 - REFER TO THE CERTIFIED PLAN OF SUBDIVISION FOR ALL EASEMENT WIDTHS, DO NOT SCALE FROM DRAWING.
 - STORMWATER DRAINS SHALL BE RCP FLUSH JOINTED CLASS 2 OR PVC CLASS S8B UNLESS OTHERWISE SHOWN.
 - ALL RCP FLUSH JOINTED PIPES BELOW 600mm DIA ARE TO HAVE EXTERIOR

- MORTARED JOINTS. ALL PIPES 600 DIA AND GREATER ARE TO HAVE INTERIOR MORTAR JOINTS.
 - ALL PROPOSED DRAINAGE STUBS TO BE BLANKED OFF AT END OF PIPE WITH TIMBER PLANKS TO THE SATISFACTION OF THE SUPERVISING ENGINEER.
 - ALL CONDUIT LOCATIONS ARE TO BE STAMPED IN THE CONCRETE KERBING.
 - ALL CONCRETE IS TO HAVE A MINIMUM COMPRESSIVE STRENGTH OF 25MPa AT 28 DAYS.
 - ALL GRATES ARE TO BE HOT DIPPED GALVANISED.
 - 100mm DEEP CATCH DRAINS TO BE CONSTRUCTED ALONG ALL EASEMENT DRAINAGE AND DIRECTED TO LEGAL POINT OF DISCHARGE.
 - STEP IRONS ARE NOT TO BE INSTALLED IN ANY DRAINAGE PIT. ACCESS LIDS ARE TO BE LOCATED TO ENABLE REASONABLE ACCESS.
 - ALL HOUSE DRAIN CONNECTIONS TO REINFORCED CONCRETE PIPES ARE TO UTILISE "CONCONNECT" OR COUNCIL APPROVED EQUIVALENT PRODUCTS TO AVOID PIPE PROTRUSIONS INTO THE LARGER PIPE.
 - REFER ROAD LAYOUT PLANS FOR WATER & GAS ROAD SERVICE CONDUIT LOCATIONS. INTERSECTION DETAILS PLANS DO NOT SHOW CONDUITS.
 - ELECTRICITY & TELECOMMUNICATIONS CONDUITS SHOWN ON THESE PLANS ARE CONCEPTUAL ONLY. REFER TO ELECTRICITY & TELECOMMUNICATION PLANS FOR ACTUAL ROAD SERVICE CONDUIT LOCATIONS. IF THERE ARE ANY DISCREPANCIES BETWEEN THESE PLANS CONTACT SUPERINTENDENT FOR CLARIFICATION.
- CONSTRUCTION HOLD POINTS**
- CONSTRUCTION HOLD POINTS ARE TO BE IN ACCORDANCE WITH THE INFRASTRUCTURE DESIGN MANUAL.
- EMERGENCY CONTACTS**
- THE PROJECT AREA CONTAINS THE FOLLOWING SERVICES FOR ASSISTANCE IN EMERGENCY CONTACT.
- | SERVICE | AUTHORITY & CONTACT | TELEPHONE |
|----------------|-------------------------|--------------|
| DRAINAGE | CITY OF GREATER BENDIGO | 5434 6000 |
| ELECTRICITY | POWERCOR | 132 412 |
| GAS | SP AUSNET | 136 707 |
| COMMUNICATIONS | TELSTRA | 132 203 |
| SEWER & WATER | COLIBAN WATER | 1300 363 200 |
- IN ANY EMERGENCY IF YOU BELIEVE LIFE OR PROPERTY IS THREATENED DO NOT HESITATE TO CONTACT STATE EMERGENCY SERVICES ON TELEPHONE 000.

C	REGRADED LOTS - ADDED DRAINAGE LINE 76, 77 & 78 - AMENDED SHARED DRIVEWAY	SA	SA	NJB	NJB	29/10/24
B	ISSUED FOR CONSTRUCTION	NJB	SA	HB	AR	11/12/23
A	AS SUBMITTED TO COUNCIL	NJB	SA	AR	AR	12/10/23
REV	REVISION	DES	DWG	CHK	AUTH	DATE

RPE: N/BAWIKEN - 0018036

Tomkinson
SURVEY | ENGINEERING | PLANNING | PROJECT MANAGEMENT

HEAD OFFICE: 57 MYERS STREET BENDIGO PH 03 5445 8700
ABN 11 103 336 358 WWW.TOMKINSON.COM

imagine
STRATHFIELDSAYE

SCALE N/A
LENGTHS ARE IN METRES - PAPER SIZE A3

© COPYRIGHT THE INFORMATION CONTAINED ON THIS DRAWING IS THE INTELLECTUAL PROPERTY OF TOMKINSON GROUP. COPYING OR USING THIS DRAWING IN WHOLE OR IN PART WITHOUT THE EXPRESS WRITTEN PERMISSION OF TOMKINSON GROUP INFRINGES COPYRIGHT.

BEFORE YOU DIG www.byda.com.au

COMPASS ASSURANCE ISO 9001 QUALITY

IMAGINE STAGE 30
53 DUKES LANE STRATHFIELDSAYE
LOCALITY PLAN & GENERAL NOTES
CITY OF GREATER BENDIGO REF: DS/188/216
EMU CREEK HOLDINGS 2 PTY LTD

DWG STATUS:
PRELIMINARY

PROJECT & DWG No: 1352030R01 / 18 C

REV: _____

NOTE: THIS IS AN UNCONTROLLED DOCUMENT AND WILL NOT BE UPDATED. IT IS THE RESPONSIBILITY OF THE USER TO CONFIRM THAT THIS IS CURRENT COPY AND SUITABLE FOR THE PROPOSED USE - THIS SHEET MUST BE READ IN CONJUNCTION WITH ALL SHEETS OF THIS SET AND ANY ACCOMPANYING DOCUMENTS. PLOT DATE: 28/10/2024 FILE: C:\T\2\DATA\TOMKINSON\3098\530320\30 R-D PLANS REV CADWG



REV	DES	DWG	CHK	AUTH	DATE
C	SA	SA	NJB	NJB	29/10/24
B	NJB	SA	HB	AR	11/12/23
A	NJB	SA	AR	AR	12/10/23

REVISION

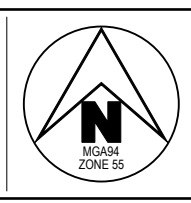

Tomkinson
 SURVEY > ENGINEERING > PLANNING > PROJECT MANAGEMENT
 HEAD OFFICE: 57 MYERS STREET BENDIGO PH 03 5445 8700
 ABN 11 103 336 358 WWW.TOMKINSON.COM



SCALE 1:1,000
 LENGTHS ARE IN METRES - PAPER SIZE A3

© COPYRIGHT THE INFORMATION CONTAINED ON THIS DRAWING IS THE INTELLECTUAL PROPERTY OF TOMKINSON GROUP. COPYING OR USING THIS DRAWING IN WHOLE OR IN PART WITHOUT THE EXPRESS WRITTEN PERMISSION OF TOMKINSON GROUP INFRINGES COPYRIGHT.

BEFORE YOU DIG
www.you.dig.com.au

COMPASS ASSURANCE ISO 9001 QUALITY

IMAGINE STAGE 30
53 DUKES LANE STRATHFIELDSAYE
 OVERALL DEVELOPMENT PLAN
 CITY OF GREATER BENDIGO REF: DS/188/216
 EMU CREEK HOLDINGS 2 PTY LTD

DWG STATUS: **PRELIMINARY**

PROJECT & DWG No: 1352030R02 / 18 C

NOTE: THIS IS AN UNCONTROLLED DOCUMENT AND WILL NOT BE UPDATED. IT IS THE RESPONSIBILITY OF THE USER TO CONFIRM THAT THIS IS A CURRENT COPY AND SUITABLE FOR THE PROPOSED USE. THIS SHEET MUST BE READ IN CONJUNCTION WITH ALL SHEETS OF THIS SET AND ANY ACCOMPANYING DOCUMENTS.
 PLOT DATE: 28/10/2024 FILE: C:\12\DATA\TOMKINSON\1352030\1352030_03\EMUCREEK\1352030_03\1352030_R-D PLANS REV.CADWG

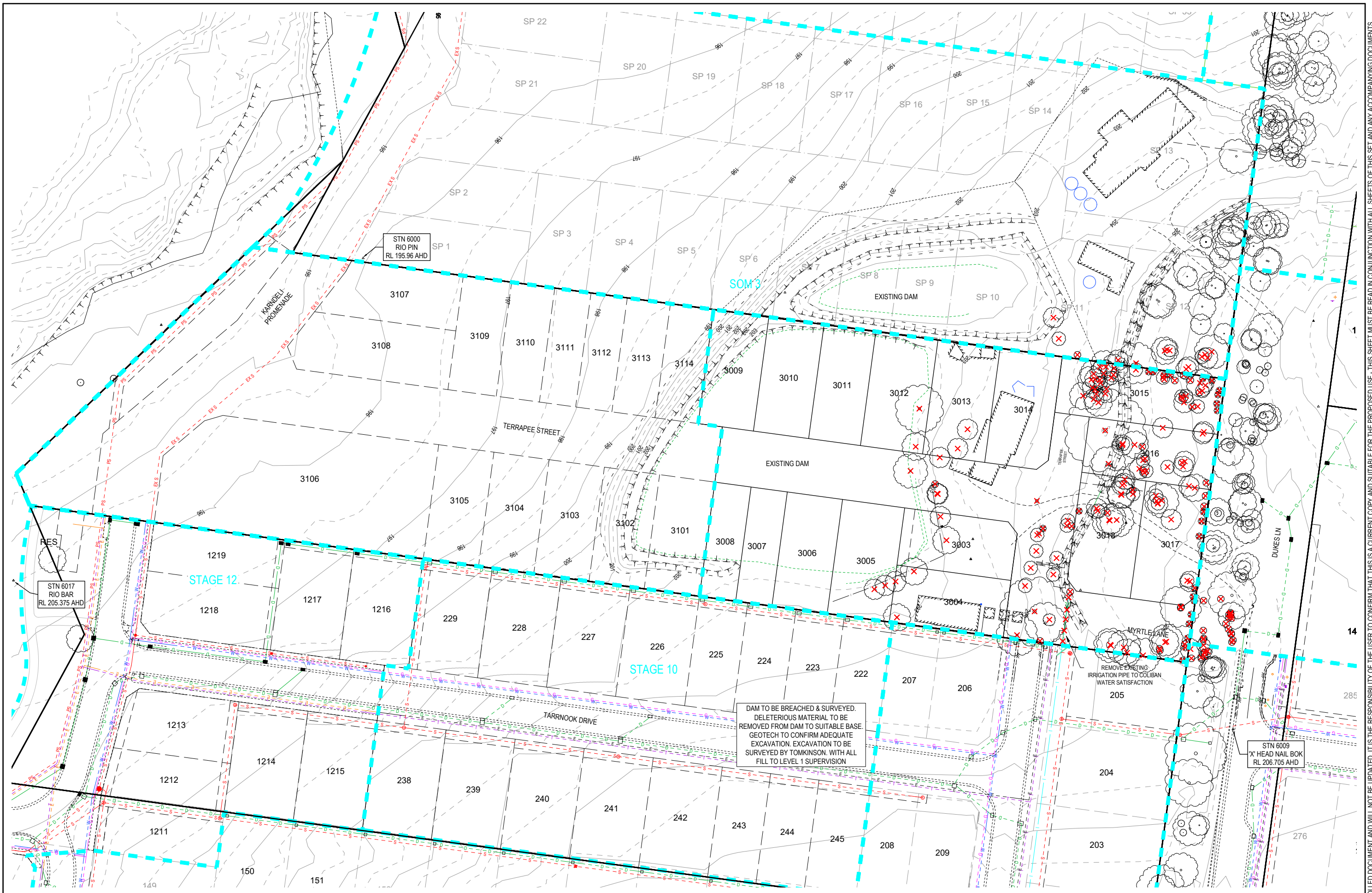

C	REGRADED LOTS - ADDED DRAINAGE LINE 76, 77 & 78 - AMENDED SHARED DRIVEWAY	SA	SA	NJB	NJB	29/10/24
B	ISSUED FOR CONSTRUCTION	NJB	SA	HB	AR	11/12/23
A	AS SUBMITTED TO COUNCIL	NJB	SA	AR	AR	12/10/23
REV		DES	DWG	CHK	AUTH	DATE

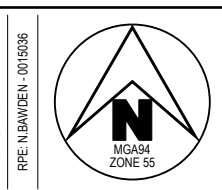

Tomkinson
SURVEY • ENGINEERING • PLANNING • PROJECT MANAGEMENT

HEAD OFFICE: 57 MYERS STREET BENDIGO PH 03 5445 8700
ABN 11 103 336 358 WWW.TOMKINSON.COM

imagine
STRATHFIELDSAYE

SCALE 1:1,000
LENGTHS ARE IN METRES - PAPER SIZE A3

© COPYRIGHT
THE INFORMATION CONTAINED
ON THIS DRAWING IS THE
INTELLECTUAL PROPERTY OF
TOMKINSON GROUP. COPYING
OR USING THIS DRAWING IN
WHOLE OR IN PART WITHOUT
THE EXPRESS WRITTEN
PERMISSION OF TOMKINSON
GROUP INFRINGES COPYRIGHT

IMAGINE STAGE 30
53 DUKES LANE STRATHFIELDSAYE
EXISTING CONDITIONS & TBM PLAN
CITY OF GREATER BENDIGO REF: DS/188/216
EMU CREEK HOLDINGS 2 PTY LTD

DWG STATUS:
PRELIMINARY

PROJECT & DWG No:
1352030R03 / 18 C

REV: _____

NOTE: THIS IS AN UNCONTROLLED DOCUMENT AND WILL NOT BE UPDATED. IT IS THE RESPONSIBILITY OF THE USER TO CONFIRM THAT THIS IS A CURRENT COPY AND SUITABLE FOR THE PROPOSED USE. THIS SHEET MUST BE READ IN CONJUNCTION WITH ALL SHEETS OF THIS SET AND ANY ACCOMPANYING DOCUMENTS.
PLOT DATE: 28/10/2024 FILE: C:\12\DATA\TOMKINSON\1352030\1352030_03\STRATHFIELDSAYE_3098ENG000\CAD\CURRENT\STAGE 30\1352030 R-D PLANS REV.CADWG

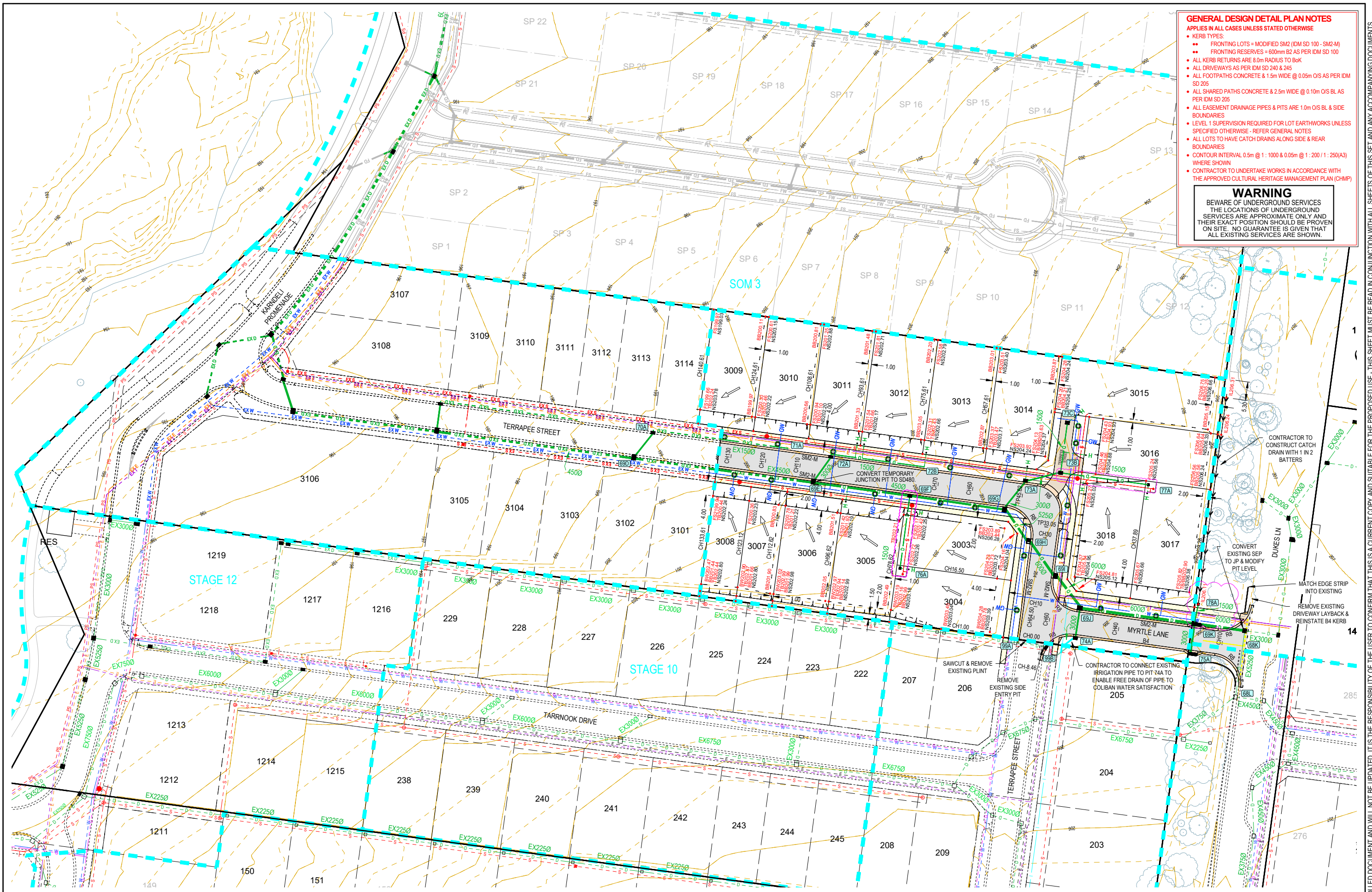

GENERAL DESIGN DETAIL PLAN NOTES
 APPLIES IN ALL CASES UNLESS STATED OTHERWISE

- KERB TYPES:
 - FRONTING LOTS = MODIFIED SM2 (DM SD 100 - SM2-M)
 - FRONTING RESERVES = 600mm B2 AS PER DM SD 100
- ALL KERB RETURNS ARE 8.0m RADIUS TO B&K
- ALL DRIVEWAYS AS PER DM SD 240 & 245
- ALL FOOTPATHS CONCRETE & 1.5m WIDE @ 0.05m O/S AS PER DM SD 205
- ALL SHARED PATHS CONCRETE & 2.5m WIDE @ 0.10m O/S BL AS PER DM SD 205
- ALL EASEMENT DRAINAGE PIPES & PITS ARE 1.0m O/S BL & SIDE BOUNDARIES
- LEVEL 1 SUPERVISION REQUIRED FOR LOT EARTHWORKS UNLESS SPECIFIED OTHERWISE - REFER GENERAL NOTES
- ALL LOTS TO HAVE CATCH DRAINS ALONG SIDE & REAR BOUNDARIES
- CONTOUR INTERVAL 0.5m @ 1:1000 & 0.05m @ 1:200 (1:250(A3)) WHERE SHOWN
- CONTRACTOR TO UNDERTAKE WORKS IN ACCORDANCE WITH THE APPROVED CULTURAL HERITAGE MANAGEMENT PLAN (CHMP)

WARNING
 BEWARE OF UNDERGROUND SERVICES
 THE LOCATIONS OF UNDERGROUND SERVICES ARE APPROXIMATE ONLY AND THEIR EXACT POSITION SHOULD BE PROVEN ON SITE. NO GUARANTEE IS GIVEN THAT ALL EXISTING SERVICES ARE SHOWN.

C	REGRADED LOTS - ADDED DRAINAGE LINE 76, 77 & 78 - AMENDED SHARED DRIVEWAY	SA	SA	NJB	NJB	29/10/24
B	ISSUED FOR CONSTRUCTION	NJB	SA	HB	AR	11/12/23
A	AS SUBMITTED TO COUNCIL	NJB	SA	AR	AR	12/10/23
REV		DES	DWG	CHK	AUTH	DATE



Tomkinson
 SURVEY • ENGINEERING • PLANNING • PROJECT MANAGEMENT

HEAD OFFICE: 57 MYERS STREET BENDIGO PH 03 5445 8700
 ABN 11 103 336 358 WWW.TOMKINSON.COM



SCALE 1:1,000
 LENGTHS ARE IN METRES - PAPER SIZE A3

© COPYRIGHT
 THE INFORMATION CONTAINED ON THIS DRAWING IS THE INTELLECTUAL PROPERTY OF TOMKINSON GROUP. COPYING OR USING THIS DRAWING IN WHOLE OR IN PART WITHOUT THE EXPRESS WRITTEN PERMISSION OF TOMKINSON GROUP INFRINGES COPYRIGHT

BEFORE YOU DIG
 www.byd.com.au

COMPASS ASSURANCE
 ISO 9001 QUALITY

IMAGINE STAGE 30
53 DUKES LANE STRATHFIELDSAYE
 CONSTRUCTION LAYOUT PLAN
 CITY OF GREATER BENDIGO REF: DS/188/216
 EMU CREEK HOLDINGS 2 PTY LTD

DWG STATUS: **PRELIMINARY**

PROJECT & DWG No: 1352030R04 / 18 C

NOTE: THIS IS AN UNCONTROLLED DOCUMENT AND WILL NOT BE UPDATED. IT IS THE RESPONSIBILITY OF THE USER TO CONFIRM THAT THIS IS A CURRENT COPY AND SUITABLE FOR THE PROPOSED USE. THIS SHEET MUST BE READ IN CONJUNCTION WITH ALL SHEETS OF THIS SET AND ANY ACCOMPANYING DOCUMENTS.
 PLOT DATE: 28/10/2024 FILE: C:\TZD\DATA\TOMKINGG-1205011352001 - EMU CREEK HOLDINGS 2 PTY LTD - STRATHFIELDSAYE_3098ENG000\CAD\CURRENT\STAGE 30\1352030 R-D PLANS REV.CADWG

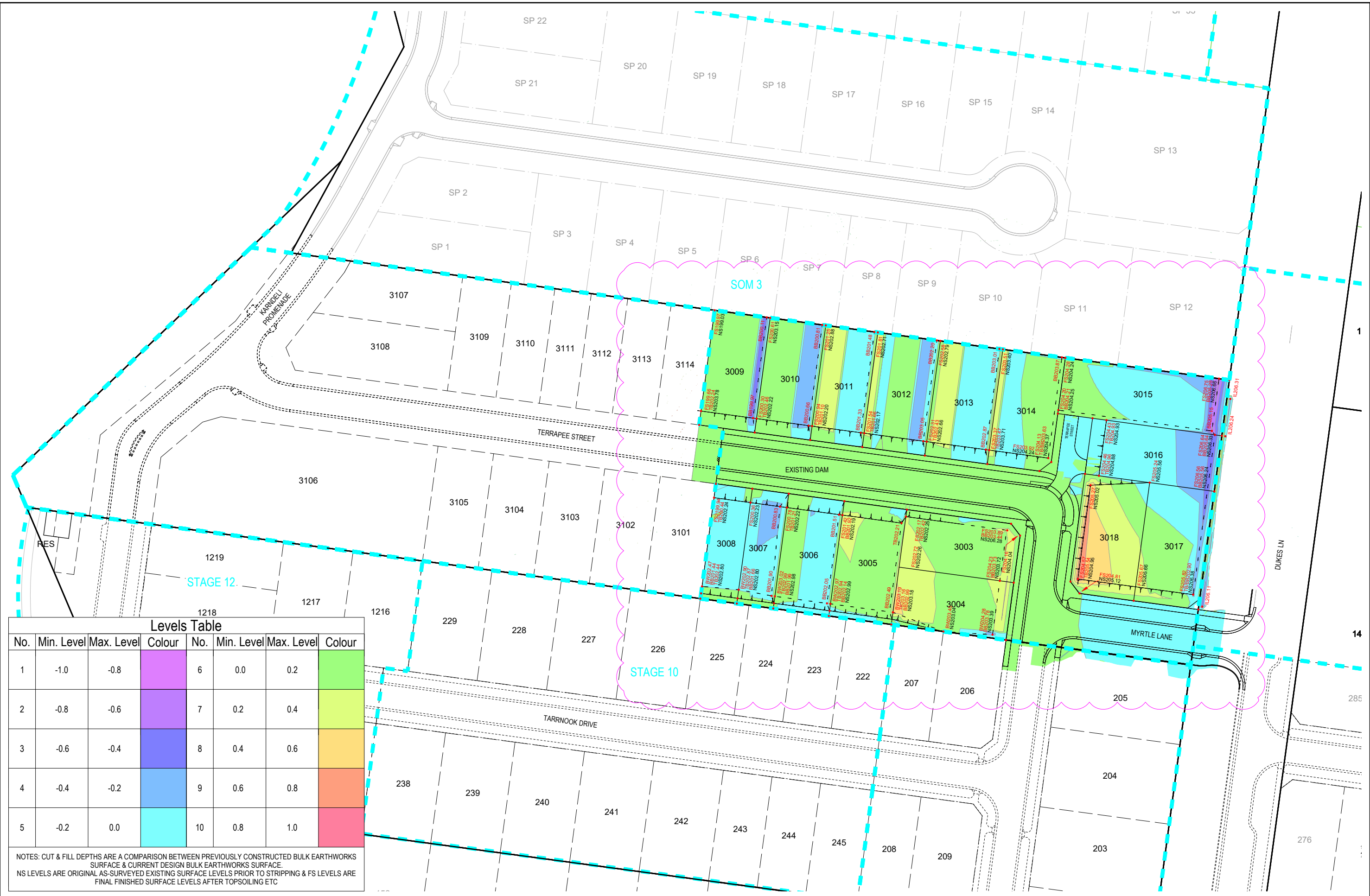

Levels Table

No.	Min. Level	Max. Level	Colour	No.	Min. Level	Max. Level	Colour
1	-1.0	-0.8	Green	6	0.0	0.2	Red
2	-0.8	-0.6	Yellow	7	0.2	0.4	Orange
3	-0.6	-0.4	Blue	8	0.4	0.6	Light Blue
4	-0.4	-0.2	Light Green	9	0.6	0.8	Light Blue
5	-0.2	0.0	Light Blue	10	0.8	1.0	Light Blue

NOTES: CUT & FILL DEPTHS ARE A COMPARISON BETWEEN PREVIOUSLY CONSTRUCTED BULK EARTHWORKS SURFACE & CURRENT DESIGN BULK EARTHWORKS SURFACE.
 NS LEVELS ARE ORIGINAL AS-SURVEYED EXISTING SURFACE LEVELS PRIOR TO STRIPPING & FS LEVELS ARE FINAL FINISHED SURFACE LEVELS AFTER TOPSOILING ETC

C	REGRADED LOTS - ADDED DRAINAGE LINE 76, 77 & 78 - AMENDED SHARED DRIVEWAY	SA	SA	NJB	NJB	29/10/24
B	ISSUED FOR CONSTRUCTION	NJB	SA	HB	AR	11/12/23
A	AS SUBMITTED TO COUNCIL	NJB	SA	AR	AR	12/10/23
REV	REVISION	DES	DWG	CHK	AUTH	DATE

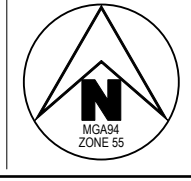

Tomkinson
 SURVEY > ENGINEERING > PLANNING > PROJECT MANAGEMENT
 HEAD OFFICE: 57 MYERS STREET BENDIGO PH 03 5445 8700
 ABN 11 103 336 358 WWW.TOMKINSON.COM



SCALE 1:1,000
 LENGTHS ARE IN METRES - PAPER SIZE A3

© COPYRIGHT THE INFORMATION CONTAINED ON THIS DRAWING IS THE INTELLECTUAL PROPERTY OF TOMKINSON GROUP. COPYING OR USING THIS DRAWING IN WHOLE OR IN PART WITHOUT THE EXPRESS WRITTEN PERMISSION OF TOMKINSON GROUP INFRINGES COPYRIGHT.

BEFORE YOU DIG
 www.byda.com.au

COMPASS ASSURANCE
 ISO 9001 QUALITY

IMAGINE STAGE 30
53 DUKES LANE STRATHFIELDSAYE
 CUT & FILL DEPTH RANGE & LOT LEVELS
 CITY OF GREATER BENDIGO REF: DS/188/216
 EMU CREEK HOLDINGS 2 PTY LTD
 DWG STATUS: **PRELIMINARY**
 PROJECT & DWG No: 1352030R05 / 18 C

NOTE: THIS IS AN UNCONTROLLED DOCUMENT AND WILL NOT BE UPDATED. IT IS THE RESPONSIBILITY OF THE USER TO CONFIRM THAT THIS IS A CURRENT COPY AND SUITABLE FOR THE PROPOSED USE. THIS SHEET MUST BE READ IN CONJUNCTION WITH ALL SHEETS OF THIS SET AND ANY ACCOMPANYING DOCUMENTS.
 PLOT DATE: 28/10/2024 FILE: C:\12\0\DATA\TOMKINSON\3099\EMUCR\CAD\CURRENT\STAGE 30\1352030 R-D PLANS REV.CADWG

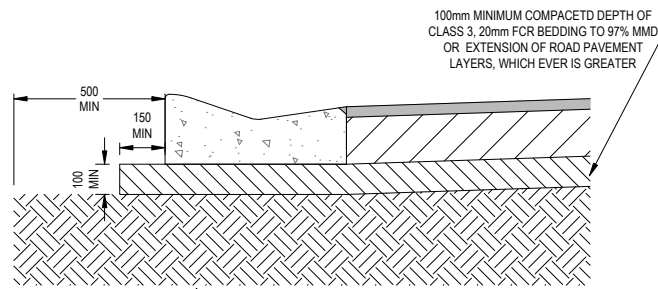

SM2-M KERB & CHANNEL INSTALLATION
490mm DEPTH PAVEMENT
SCALE 1:25 (A3)

LEGEND

- PROPOSED LINEMARKING
- EXISTING LINEMARKING TO BE MAINTAINED
- EXISTING LINEMARKING TO BE REMOVED
- PROPOSED SIGNAGE
- PROPOSED PSM
- HYDRANT MARKING

NOTE:

- ALL STREET NAME SIGNAGE TO BE IN ACCORDANCE WITH CITY OF GREATER BENDIGO STANDARD.
- ALL LINEMARKING & SIGNAGE TO BE IN ACCORDANCE WITH AUSTRALIAN STANDARD AS1742.

PAVEMENT NOTES:

- ROAD PAVEMENT DESIGNS PRODUCED IN ACCORDANCE WITH GTS REPORT 230 0048 DATED MARCH 2023. ALL OTHER PAVEMENT TO IDM STANDARDS
- PAVEMENT BASE COURSES ARE TO BE COMPACTED TO A MINIMUM DRY DENSITY RATIO OF 99% MODIFIED WITH MOISTURE CONTENT WITHIN ±3% OF MODIFIED OPTIMUM MOISTURE CONTENT (MOMC).
- PAVEMENT SUBBASE COURSES ARE TO BE COMPACTED TO A MINIMUM DRY DENSITY RATIO OF 98% MODIFIED WITH MOISTURE CONTENT WITHIN ±3% OF MODIFIED OPTIMUM MOISTURE CONTENT (MOMC).
- PAVEMENT LAYERS SHOULD BE PLACED AND COMPACTED IN LAYERS NOT EXCEEDING 200mm THICKNESS.
- STRUCTURAL FILL TO HAVE A MINIMUM CBR OF 8 AND COMPACTED TO A MINIMUM DRY DENSITY RATIO OF 98% MODIFIED WITH MOISTURE CONTENT WITHIN ±3% OF MODIFIED OPTIMUM MOISTURE CONTENT (MOMC).
- SUBGRADE PREPARATION AND ENGINEERED FILL CONSTRUCTION (PAYEMENTS) TO BE IN ACCORDANCE WITH RELEVANT STANDARDS.
- WHEN PAVEMENT EXCAVATION IS IN ROCK, ALL LOOSE MATERIAL (INCL. ROCK & CLAY) MUST BE REMOVED. THE SUBGRADE MUST THEN BE REGULATED WITH COUNCIL APPROVED MATERIAL.
- PRIOR TO PLACEMENT OF THE FILL MATERIAL UNDER NEW PAVEMENT, APPROVAL OF THE MATERIAL TO BE USED MUST BE OBTAINED FROM COUNCIL.

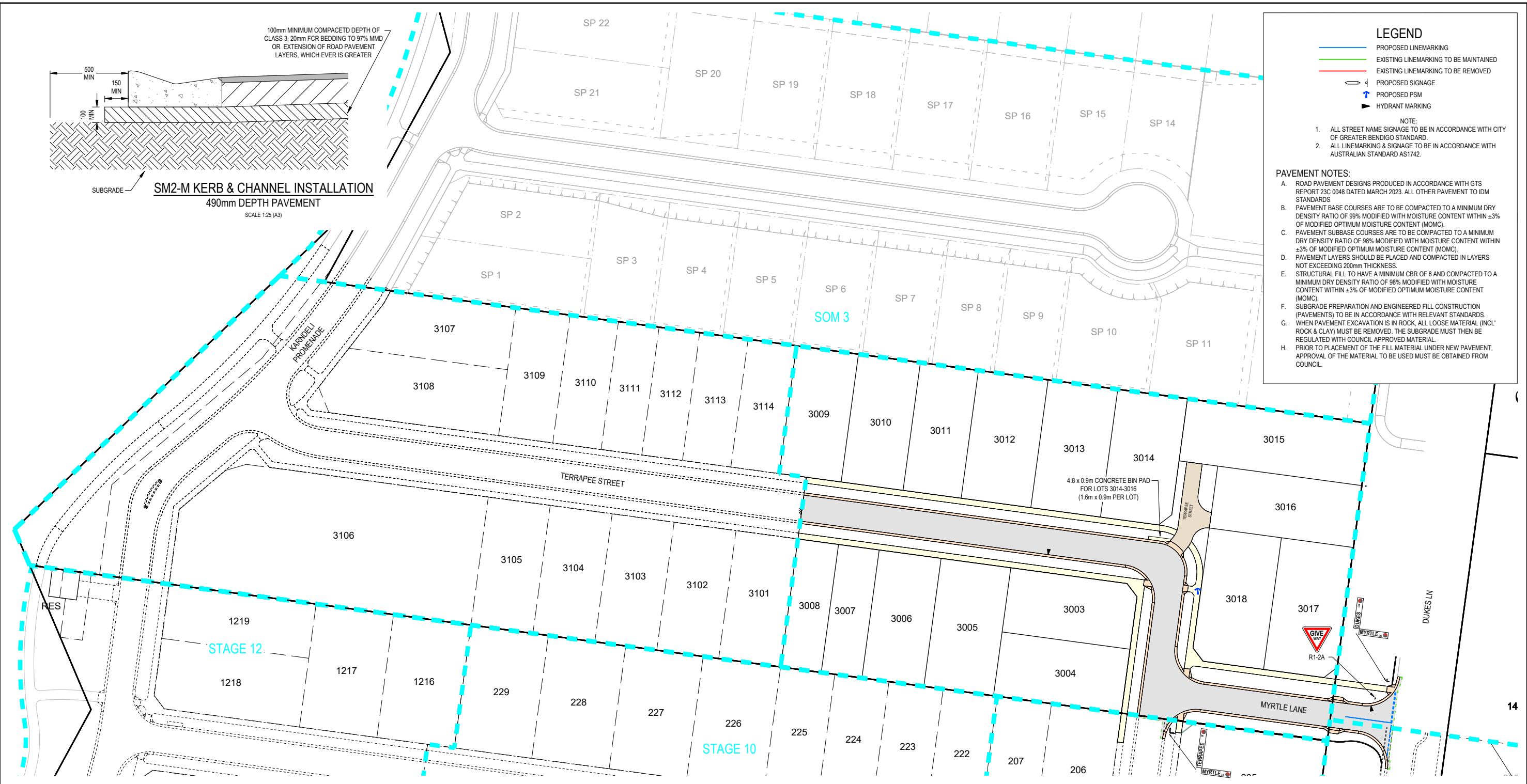

290mm DEPTH PAVEMENT		
PAVEMENT LAYER	LAYER THICKNESS (mm)	MATERIAL
1 WEARING COURSE	30	SIZE 10 TYPE N ASPHALT
PRIME		
3 BASE COURSE	160	20mm NOM. SIZE CLASS 2 FINE CRUSHED ROCK (SEE NOTE B)
4 SUBBASE COURSE	100	20mm NOM. SIZE CLASS 3 FINE CRUSHED ROCK (SEE NOTE C)
5 SUBGRADE	300	SUBGRADE STABILISATION 3% LIME & 3% CEMENT (MINIMUM CBR 8)

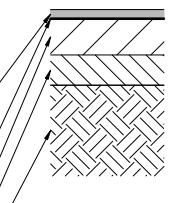

150mm CONCRETE SHARED DRIVEWAY PAVEMENT (DERIVED FROM IDM SD 250)		
PAVEMENT LAYER	LAYER THICKNESS (mm)	MATERIAL
1 SURFACE FINISH		BROOMED FINISH & TOOLED JOINTS. FINISHED SURFACE TO COMPLY WITH AS 4586 - SLIP RESISTANT CLASSIFICATION OF NEW PEDESTRIAN SURFACE MATERIALS
2 CONCRETE	150	CONCRETE 32MPa WITH SL82 MESH LOCATED CENTRALLY
3 BASE	100	20mm NOM. SIZE CLASS 3 FINE CRUSHED ROCK (SEE NOTE C)
4 SUBGRADE		SUBGRADE PREPARATION (SEE NOTE 6 BELOW). SUBGRADE IMPROVEMENT AS DIRECTED BY SUPERINTENDENT

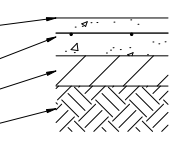

CONCRETE FOOTPATH & SHARED PATH PAVEMENT DETAILS (IDM SD 205)		
PAVEMENT LAYER	LAYER THICKNESS (mm)	MATERIAL
1 SURFACE FINISH		BROOMED FINISH & TOOLED JOINTS. FINISHED SURFACE TO COMPLY WITH AS 4586 - SLIP RESISTANT CLASSIFICATION OF NEW PEDESTRIAN SURFACE MATERIALS
2 CONCRETE	125	CONCRETE 32MPa WITH SL72 MESH LOCATED CENTRALLY
3 BASE	100	20mm NOM. SIZE CLASS 3 FINE CRUSHED ROCK (SEE NOTE C)
4 SUBGRADE		SUBGRADE PREPARATION (SEE NOTE 6 BELOW). SUBGRADE IMPROVEMENT AS DIRECTED BY SUPERINTENDENT

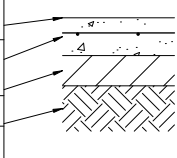

C REGRADED LOTS - ADDED DRAINAGE LINE 76, 77 & 78 - AMENDED SHARED DRIVEWAY	SA SA NJB NJB 29/10/24
B ISSUED FOR CONSTRUCTION	NJB SA HB AR 11/12/23
A AS SUBMITTED TO COUNCIL	NJB SA AR AR 12/10/23
REV	DES DWG CHK AUTH DATE

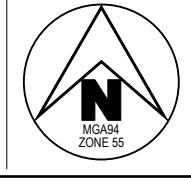

Tomkinson
SURVEY • ENGINEERING • PLANNING • PROJECT MANAGEMENT

HEAD OFFICE: 57 MYERS STREET BENDIGO PH 03 5445 8700
ABN 11 103 336 358 WWW.TOMKINSON.COM



SCALE 1:1,000
LENGTHS ARE IN METRES - PAPER SIZE A3

© COPYRIGHT THE INFORMATION CONTAINED ON THIS DRAWING IS THE INTELLECTUAL PROPERTY OF TOMKINSON GROUP. COPYING OR USING THIS DRAWING IN WHOLE OR IN PART WITHOUT THE EXPRESS WRITTEN PERMISSION OF TOMKINSON GROUP INFRINGES COPYRIGHT.

BEFORE YOU DIG
www.byda.com.au

COMPASS ASSURANCE
ISO 9001 QUALITY

IMAGINE STAGE 30
53 DUKES LANE STRATHFIELDSAYE
PAVEMENT, SIGNAGE & LINEMARKING PLAN
CITY OF GREATER BENDIGO REF: DS/188/216
EMU CREEK HOLDINGS 2 PTY LTD

DWG STATUS: **PRELIMINARY**
PROJECT & DWG No: 1352030R06 / 18 C

NOTE: THIS IS AN UNCONTROLLED DOCUMENT AND WILL NOT BE UPDATED. IT IS THE RESPONSIBILITY OF THE USER TO CONFIRM THAT THIS IS A CURRENT COPY AND SUITABLE FOR THE PROPOSED USE. THIS SHEET MUST BE READ IN CONJUNCTION WITH ALL SHEETS OF THIS SET AND ANY ACCOMPANYING DOCUMENTS.
PLOT DATE: 28/10/2024 FILE: C:\TZD\DATA\TOMKING\3098ENG\00\CAD\CURRENT\STAGE 30\1352030 R-D PLANS REV.CADWG

GENERAL DESIGN DETAIL PLAN NOTES
 APPLIES IN ALL CASES UNLESS STATED OTHERWISE

- KERB TYPES:
 - FRONTING LOTS = MODIFIED SM2 (DM SD 100 - SM2-M)
 - FRONTING RESERVES = 600mm B2 AS PER DM SD 100
- ALL KERB RETURNS ARE 8.0m RADIUS TO BOK
- ALL DRIVEWAYS AS PER DM SD 240 & 245
- ALL FOOTPATHS CONCRETE & 1.5m WIDE @ 0.05m O/S AS PER DM SD 205
- ALL SHARED PATHS CONCRETE & 2.5m WIDE @ 0.10m O/S BL AS PER DM SD 205
- ALL EASEMENT DRAINAGE PIPES & PITS ARE 1.0m O/S BL & SIDE BOUNDARIES
- LEVEL 1 SUPERVISION REQUIRED FOR LOT EARTHWORKS UNLESS SPECIFIED OTHERWISE - REFER GENERAL NOTES
- ALL LOTS TO HAVE CATCH DRAINS ALONG SIDE & REAR BOUNDARIES
- CONTOUR INTERVAL 0.5m @ 1:1000 & 0.05m @ 1:200 (1:250(A3) WHERE SHOWN)
- CONTRACTOR TO UNDERTAKE WORKS IN ACCORDANCE WITH THE APPROVED CULTURAL HERITAGE MANAGEMENT PLAN (CHMP)

WARNING
 BEWARE OF UNDERGROUND SERVICES
 THE LOCATIONS OF UNDERGROUND SERVICES ARE APPROXIMATE ONLY AND THEIR EXACT POSITION SHOULD BE PROVEN ON SITE. NO GUARANTEE IS GIVEN THAT ALL EXISTING SERVICES ARE SHOWN.

DESIGN LIP OF KERB
 HORIZ GEOMETRY
 DATUM RL 202.0

DESIGN LIP OF KERB	203.83	203.80	203.76	203.67	203.63	203.58	203.48	203.39	203.32
DESIGN BACK OF KERB	203.88	203.84	203.79	203.68	203.62	203.53	203.48	203.44	203.37
CHAINAGE	0.00	2.00	3.38	6.00	6.75	8.00	10.00	12.00	13.51

6.75m VC
 -1.16%
 R-8.6m HC
 -4.7%
 -4.45%

RSK11L01
 SCALE H 1:250 V 1:50

LAYBACK EXTENDED WING
 SHARED DRIVEWAY LAYBACK
 LAYBACK EXTENDED WING

DESIGN LIP OF KERB	204.11	204.07	204.02	203.97	203.93	203.89	203.84	203.77	203.69	203.64	203.55	203.49
DESIGN BACK OF KERB	204.15	204.11	204.07	204.01	203.95	203.89	203.84	203.81	203.75	203.69	203.64	203.55
CHAINAGE	0.00	2.00	3.95	6.00	7.44	8.44	9.76	12.00	13.85	14.66	15.57	16.00

9.76m VC
 -1.79%
 R-7.4m HC
 -3.55%
 -3.81%

RSK11R01
 SCALE H 1:250 V 1:50

DESIGN LIP OF KERB	204.11	204.07	204.02	203.97	203.93	203.89	203.84	203.77	203.69	203.64	203.55	203.49
DESIGN BACK OF KERB	204.15	204.11	204.07	204.01	203.95	203.89	203.84	203.81	203.75	203.69	203.64	203.55
CHAINAGE	0.00	2.00	3.95	6.00	7.44	8.44	9.76	12.00	13.85	14.66	15.57	16.00

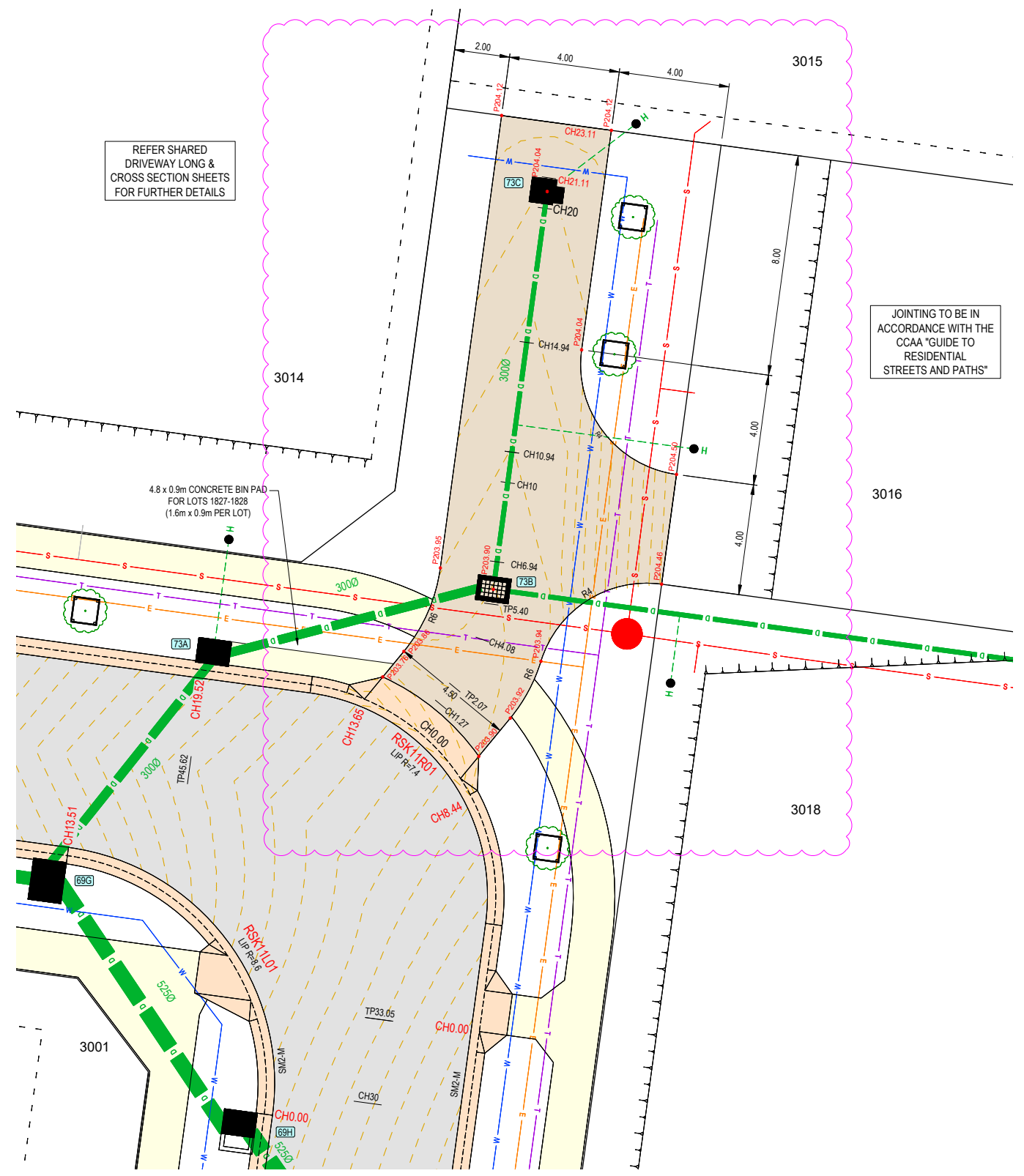

SCALE 1:200
 LENGTHS ARE IN METRES - PAPER SIZE A3

© COPYRIGHT THE INFORMATION CONTAINED ON THIS DRAWING IS THE INTELLECTUAL PROPERTY OF TOMKINSON GROUP. COPYING OR USING THIS DRAWING IN WHOLE OR IN PART WITHOUT THE EXPRESS WRITTEN PERMISSION OF TOMKINSON GROUP INFRINGES COPYRIGHT

BEFORE YOU DIG
 www.byda.com.au

COMPASS ASSURANCE
 ISO 9001 QUALITY

IMAGINE STAGE 30
53 DUKES LANE STRATHFIELDSAYE
 SHARED DRIVEWAY & 90° BEND DETAILS
 CITY OF GREATER BENDIGO REF: DS/188/216
 EMU CREEK HOLDINGS 2 PTY LTD

DWG STATUS:
PRELIMINARY

PROJECT & DWG No: 1352030R07 / 18 C

C	REGRADED LOTS - ADDED DRAINAGE LINE 76, 77 & 78 - AMENDED SHARED DRIVEWAY	SA	SA	NJB	NJB	29/10/24
B	ISSUED FOR CONSTRUCTION	NJB	SA	HB	AR	11/12/23
A	AS SUBMITTED TO COUNCIL	NJB	SA	AR	AR	12/10/23
REV	REVISION	DES	DWG	CHK	AUTH	DATE

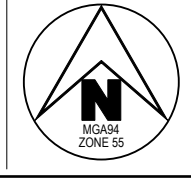

Tomkinson
 SURVEY | ENGINEERING | PLANNING | PROJECT MANAGEMENT

HEAD OFFICE: 57 MYERS STREET BENDIGO PH 03 5445 8700
 ABN 11 103 336 358 WWW.TOMKINSON.COM



NOTE: THIS IS AN UNCONTROLLED DOCUMENT AND WILL NOT BE UPDATED. IT IS THE RESPONSIBILITY OF THE USER TO CONFIRM THAT THIS IS A CURRENT COPY AND SUITABLE FOR THE PROPOSED USE. THIS SHEET MUST BE READ IN CONJUNCTION WITH ALL SHEETS OF THIS SET AND ANY ACCOMPANYING DOCUMENTS. PLOT DATE: 28/10/2024 FILE: C:\T20\DATA\TOMKING66C-1250011352001 - EMU CREEK HOLDINGS 2 PTY LTD, STRATHFIELDSAYE_3098ENG000CAD\CURRENT\STAGE 30\1352030 R-D PLANS\REV.CADWG

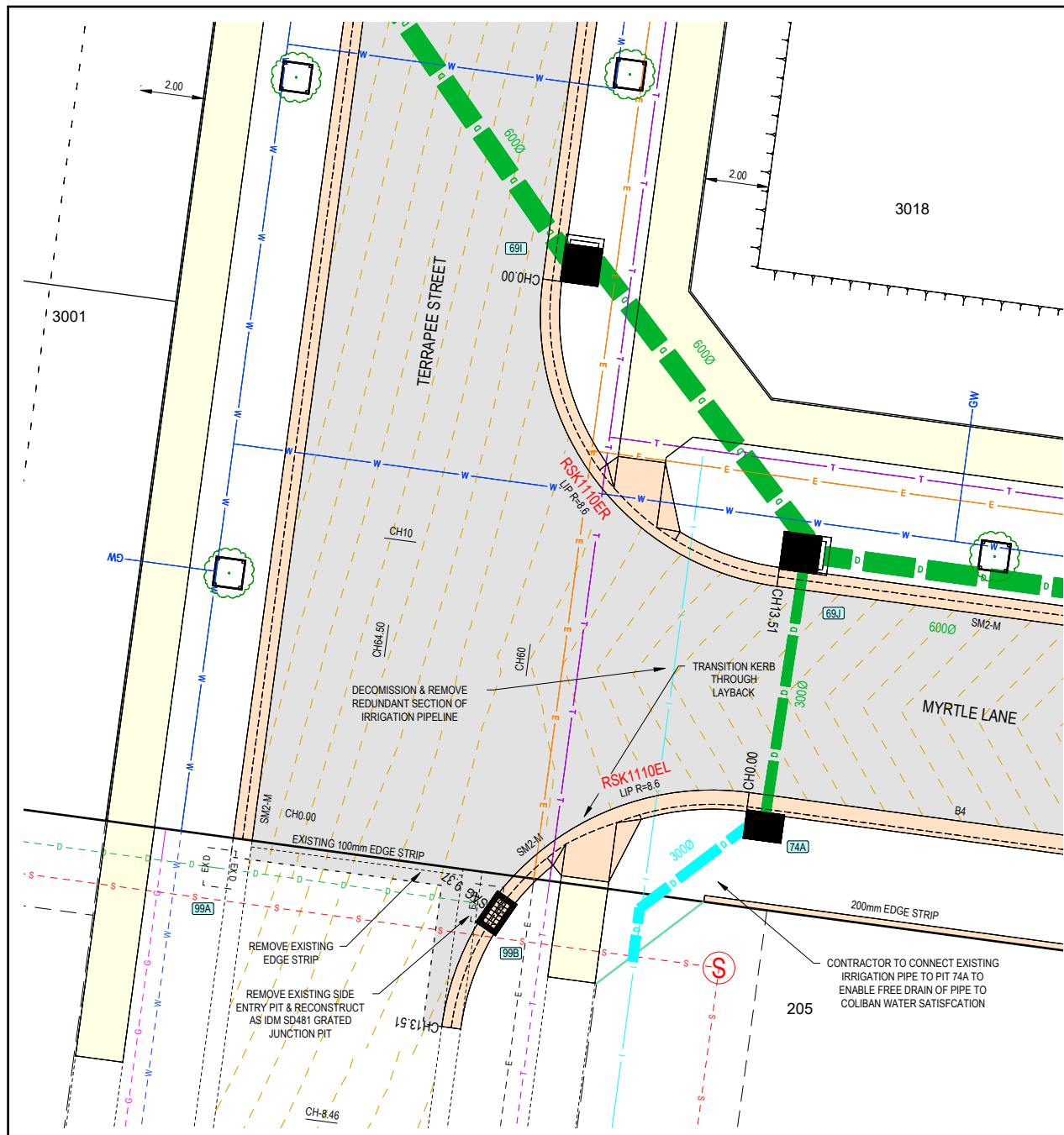

GENERAL DESIGN DETAIL PLAN NOTES
 APPLIES IN ALL CASES UNLESS STATED OTHERWISE

- KERB TYPES:
 - FRONTING LOTS = MODIFIED SM2 (IDM SD 100 - SM2-M)
 - FRONTING RESERVES = 600mm B2 AS PER IDM SD 100
- ALL KERB RETURNS ARE 8.0m RADIUS TO BcK
- ALL DRIVEWAYS AS PER IDM SD 240 & 245
- ALL FOOTPATHS CONCRETE & 1.5m WIDE @ 0.05m O/S AS PER IDM SD 205
- ALL SHARED PATHS CONCRETE & 2.5m WIDE @ 0.10m O/S BL AS PER IDM SD 205
- ALL EASEMENT DRAINAGE PIPES & PITS ARE 1.0m O/S BL & SIDE BOUNDARIES
- LEVEL 1 SUPERVISION REQUIRED FOR LOT EARTHWORKS UNLESS SPECIFIED OTHERWISE - REFER GENERAL NOTES
- ALL LOTS TO HAVE CATCH DRAINS ALONG SIDE & REAR BOUNDARIES
- CONTOUR INTERVAL 0.5m @ 1:1000 & 0.05m @ 1:200 / 1:250(A3) WHERE SHOWN
- CONTRACTOR TO UNDERTAKE WORKS IN ACCORDANCE WITH THE APPROVED CULTURAL HERITAGE MANAGEMENT PLAN (CHMP)

WARNING
 BEWARE OF UNDERGROUND SERVICES
 THE LOCATIONS OF UNDERGROUND SERVICES ARE APPROXIMATE ONLY AND THEIR EXACT POSITION SHOULD BE PROVEN ON SITE. NO GUARANTEE IS GIVEN THAT ALL EXISTING SERVICES ARE SHOWN.

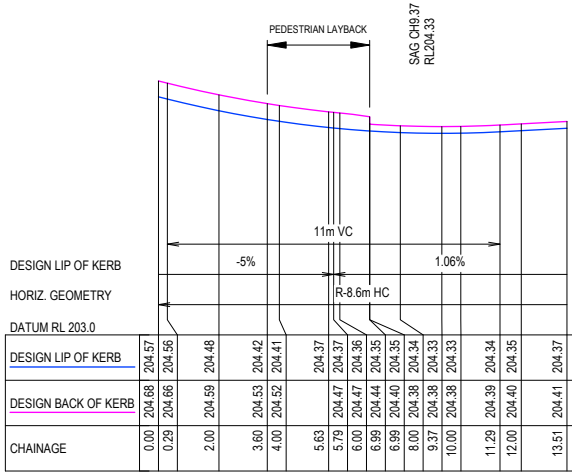
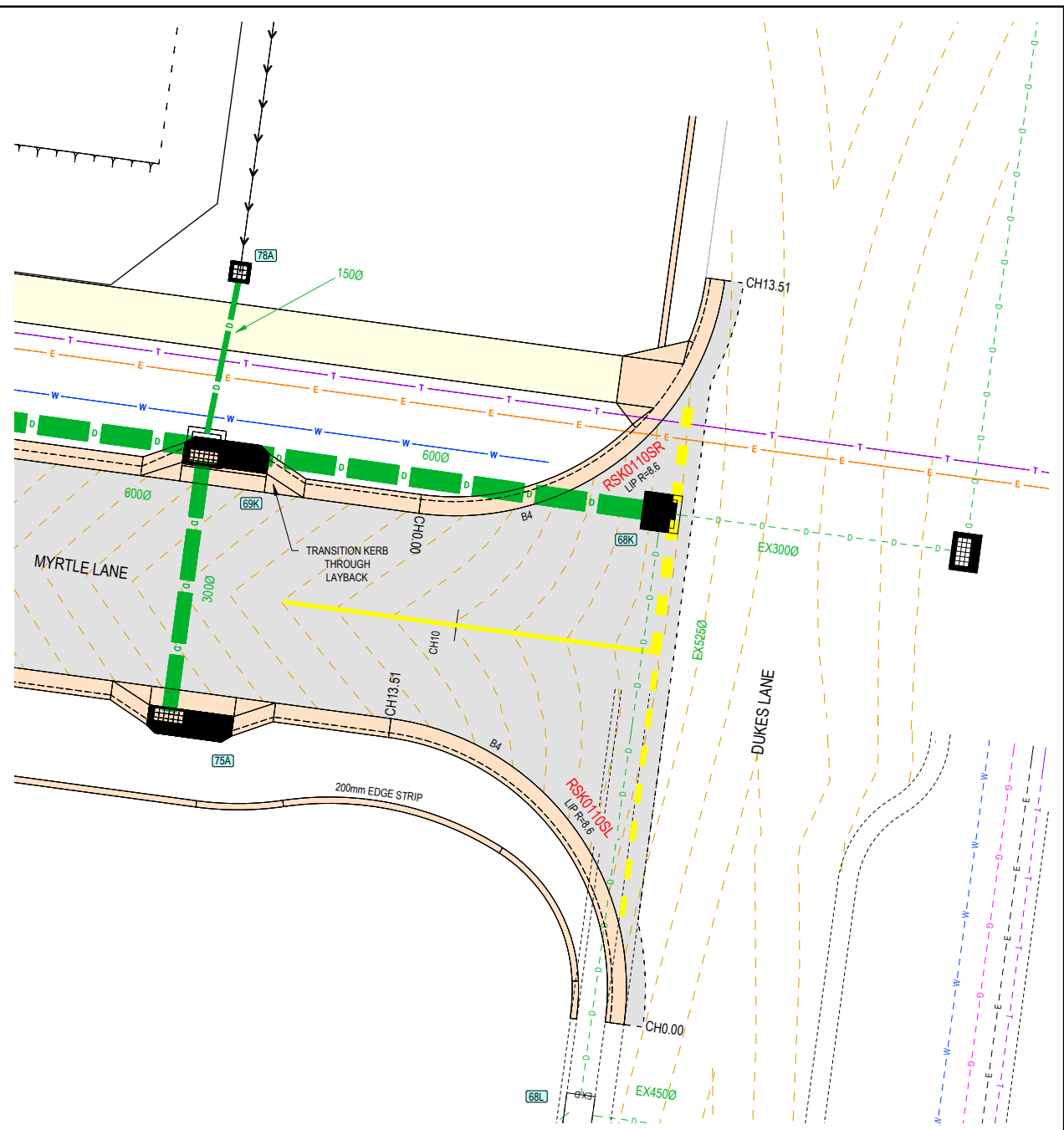

RSK110EL
 SCALE H 1: 250 V 1: 50

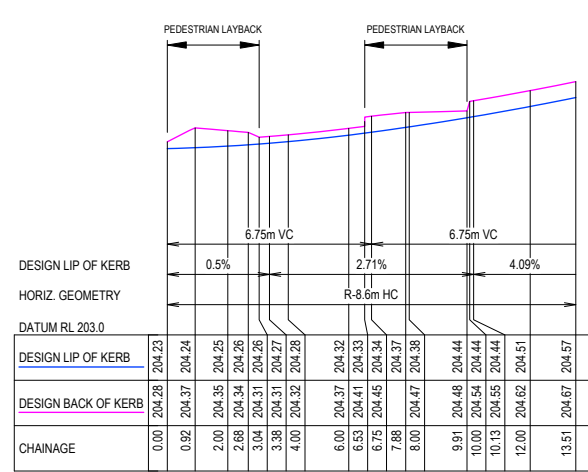

RSK110ER
 SCALE H 1: 250 V 1: 50

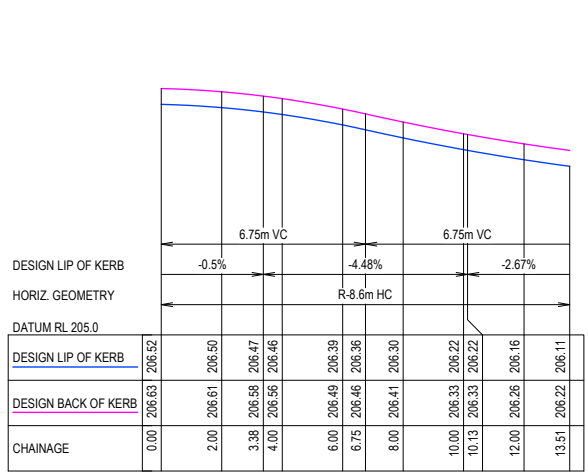

RSK0110SL
 SCALE H 1: 250 V 1: 50

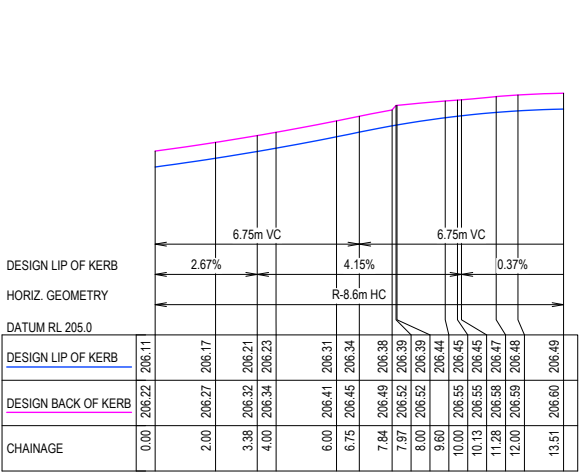

RSK0110SR
 SCALE H 1: 250 V 1: 50

REV	REVISION	DES	DWG	CHK	AUTH	DATE
C	REGRADED LOTS - ADDED DRAINAGE LINE 76, 77 & 78 - AMENDED SHARED DRIVEWAY	SA	SA	NJB	NJB	29/10/24
B	ISSUED FOR CONSTRUCTION	NJB	SA	HB	AR	11/12/23
A	AS SUBMITTED TO COUNCIL	NJB	SA	AR	AR	12/10/23

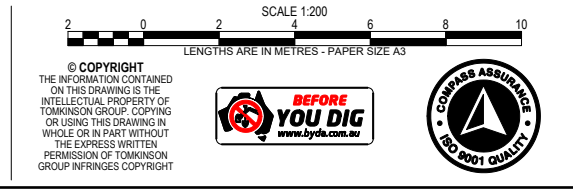

IMAGINE STAGE 30
53 DUKES LANE STRATHFIELDSAYE
 INTERSECTION DETAILS
 CITY OF GREATER BENDIGO REF: DS/188/216
 EMU CREEK HOLDINGS 2 PTY LTD
 DWG STATUS: **PRELIMINARY**
 PROJECT & DWG No: 1352030R08 / 18 C

NOTE: THIS IS AN UNCONTROLLED DOCUMENT AND WILL NOT BE UPDATED. IT IS THE RESPONSIBILITY OF THE USER TO CONFIRM THAT THIS IS A CURRENT COPY AND SUITABLE FOR THE PROPOSED USE. THIS SHEET MUST BE READ IN CONJUNCTION WITH ALL SHEETS OF THIS SET AND ANY ACCOMPANYING DOCUMENTS. PLOT DATE: 29/10/2024 FILE: C:\TZ\DATA\TOMKINSON\30989\EMUCAD\CURRENT\STAGE 30\1352030 R-D PLANS REV.CADW

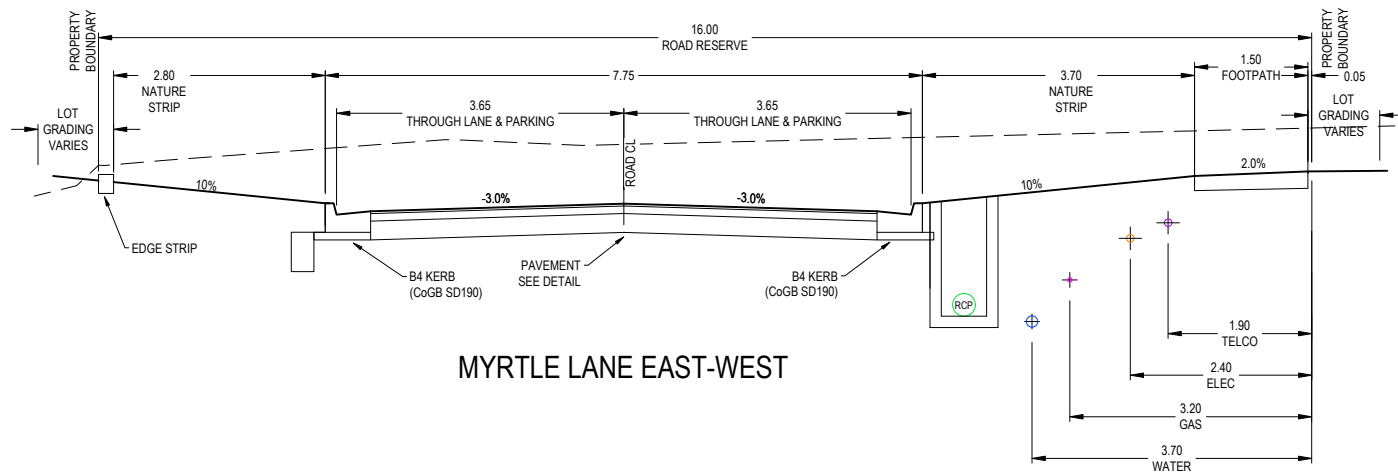

MYRTLE LANE EAST-WEST

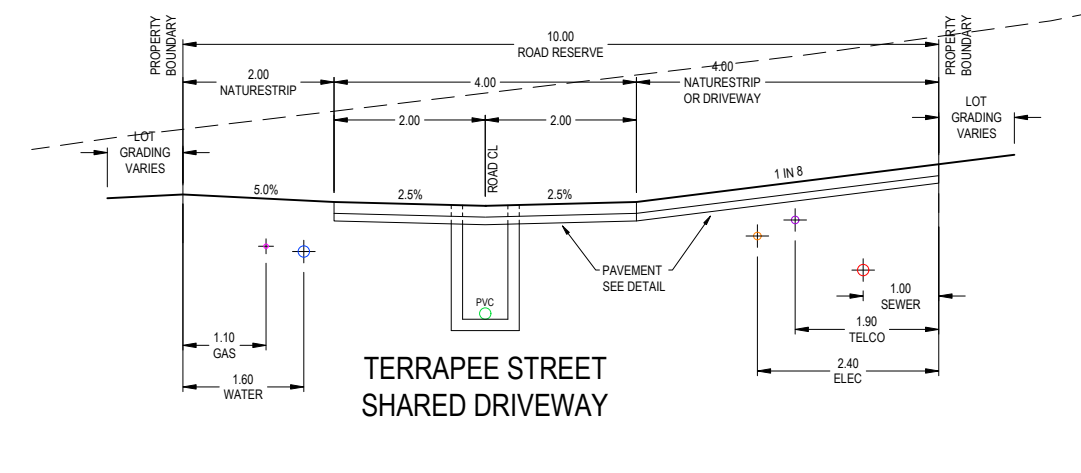

TERRAPEE STREET SHARED DRIVEWAY

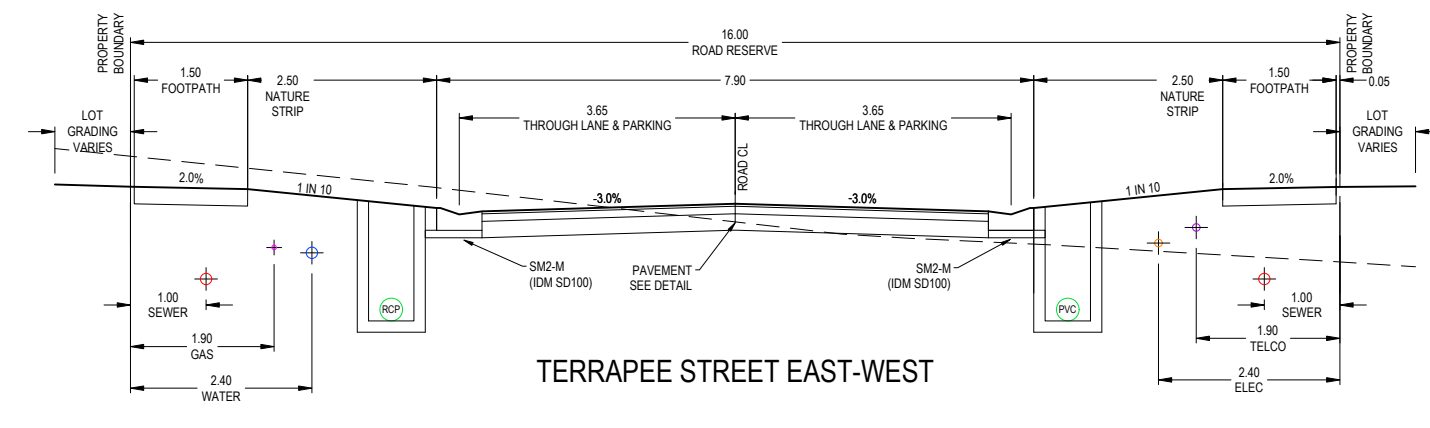

TERRAPEE STREET EAST-WEST

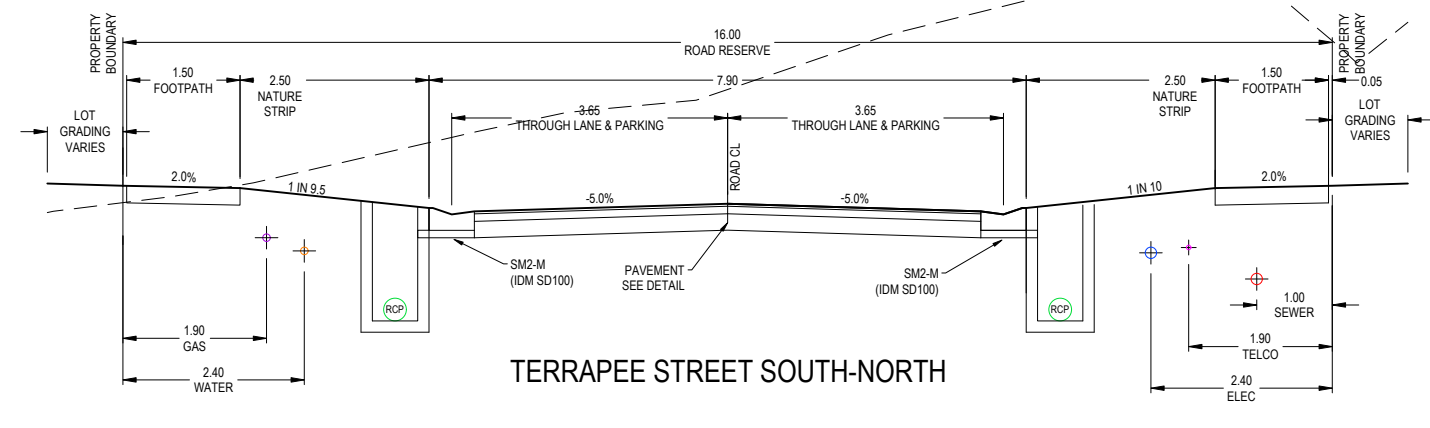

TERRAPEE STREET SOUTH-NORTH

REV	DES	DWG	CHK	AUTH	DATE
C	SA	SA	NJB	NJB	29/10/24
B	NJB	SA	HB	AR	11/12/23
A	NJB	SA	AR	AR	12/10/23

REVISION

DES DWG CHK AUTH DATE

RPE: N.BAWDEN - 0015036

Tomkinson
SURVEY > ENGINEERING > PLANNING > PROJECT MANAGEMENT

HEAD OFFICE: 57 MYERS STREET BENDIGO PH 03 5445 8700
ABN 11 103 336 358 WWW.TOMKINSON.COM

imagine
STRATHFIELDSAYE

SCALE 1:100
LENGTHS ARE IN METRES - PAPER SIZE A3

© COPYRIGHT
THE INFORMATION CONTAINED
ON THIS DRAWING IS THE
INTELLECTUAL PROPERTY OF
TOMKINSON GROUP. COPYING
OR USING THIS DRAWING IN
WHOLE OR IN PART WITHOUT
THE EXPRESS WRITTEN
PERMISSION OF TOMKINSON
GROUP INFRINGES COPYRIGHT

IMAGINE STAGE 30
53 DUKES LANE STRATHFIELDSAYE
TYPICAL SECTIONS
CITY OF GREATER BENDIGO REF: DS/188/216
EMU CREEK HOLDINGS 2 PTY LTD

DWG STATUS:
PRELIMINARY

PROJECT & DWG No: 1352030R09 / 18 C

NOTE: THIS IS AN UNCONTROLLED DOCUMENT AND WILL NOT BE UPDATED. IT IS THE RESPONSIBILITY OF THE USER TO CONFIRM THAT THIS IS A CURRENT COPY AND SUITABLE FOR THE PROPOSED USE. THIS SHEET MUST BE READ IN CONJUNCTION WITH ALL SHEETS OF THIS SET AND ANY ACCOMPANYING DOCUMENTS.
PLOT DATE: 28/10/2024 FILE: C:\TZ\DATA\TOMKINSON\3098\EMUCAD\CURRENT\STAGE 30\1352030R09\PLANS REV.CADWG

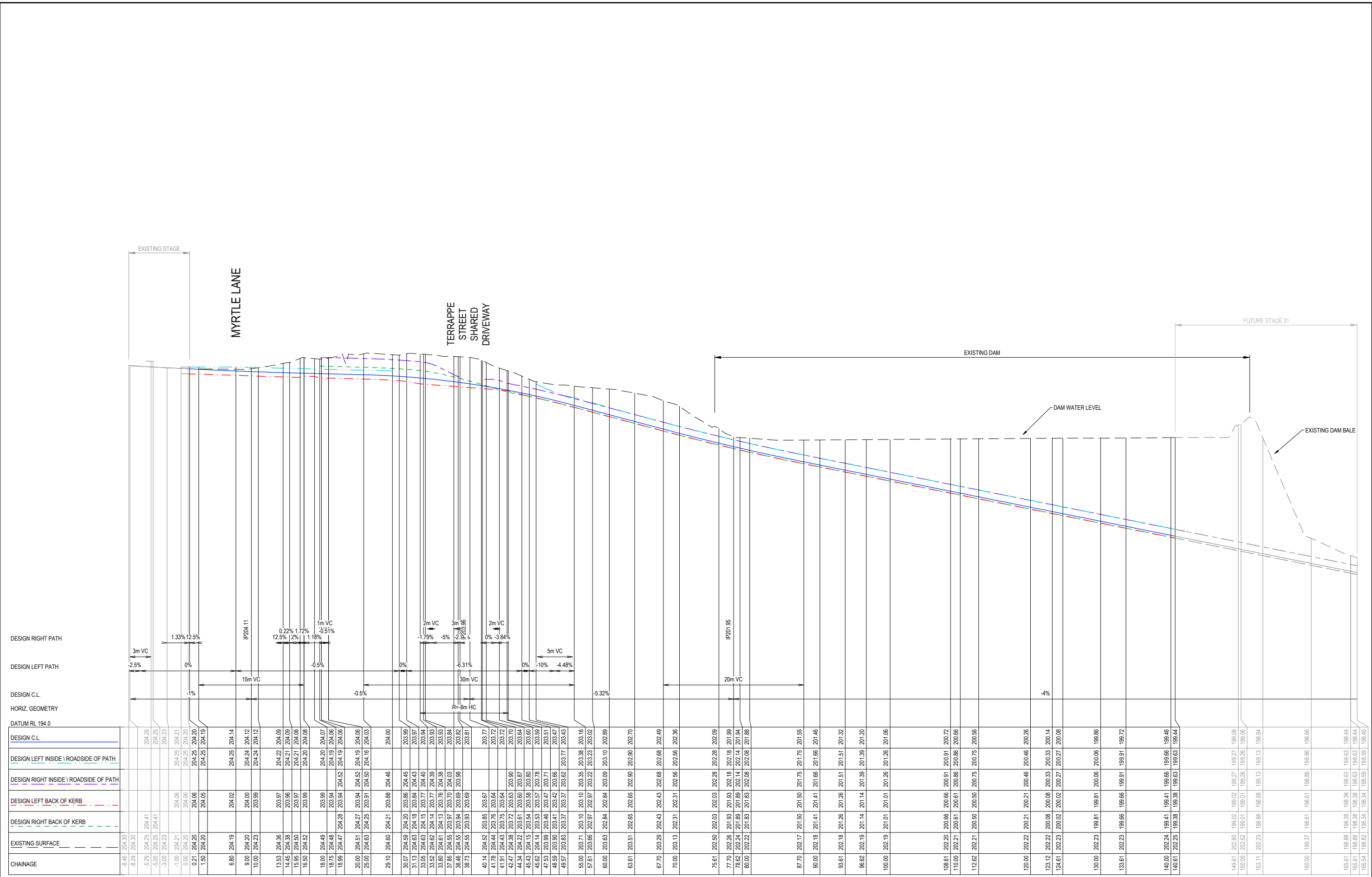

CHAINAGE	EXISTING SURFACE	DESIGN RIGHT BACK OF KERB	DESIGN LEFT BACK OF KERB	DESIGN RIGHT INSIDE \ ROADSIDE OF PATH	DESIGN LEFT INSIDE \ ROADSIDE OF PATH	DESIGN C.L.
-8.46	204.30					
-8.29	204.30					
-5.78	204.25	204.41				204.26
-5.00	204.25	204.41				204.25
-3.00	204.23					204.23
-1.00	204.21	204.06				204.21
0.00	204.20	204.06				204.20
0.21	204.20	204.06				204.20
1.50	204.20	204.05				204.19
6.80	204.19	204.02				204.14
9.00	204.20	204.00				204.20
10.00	204.23	203.99				204.24
13.53	204.36	203.97				204.22
14.45	204.38	203.96				204.21
15.95	204.50	203.97				204.21
16.50	204.52	203.99				204.20
18.00	204.49	203.99				204.20
18.75	204.48	203.94				204.19
18.99	204.47	204.28	204.52			204.19
20.00	204.51	204.27	203.94	204.52	204.19	204.06
25.00	204.63	204.25	203.91	204.50	204.16	204.03
29.10	204.60	204.21	203.88	204.46		204.00
30.07	204.59	204.20	203.86	204.45		203.99
31.13	204.63	204.18	203.84	204.43		203.97
33.05	204.63	204.15	203.77	204.40		203.94
33.52	204.62	204.14	203.77	204.39		203.93
33.80	204.61	204.13	203.76	204.38		203.93
37.85	204.55	203.97	203.70	204.03		203.84
38.46	204.55	203.94	203.69	203.98		203.82
38.73	204.55	203.93	203.69			203.81
40.14	204.52	203.85	203.67			203.77
41.78	204.44	203.76	203.64			203.72
41.91	204.43	203.75	203.64			203.72
42.47	204.38	203.72	203.63	203.90		203.70
44.34	204.22	203.61	203.60	203.87		203.64
45.43	204.15	203.54	203.58	203.80		203.60
45.62	204.14	203.53	203.57	203.78		203.59
47.53	203.99	203.46	203.47	203.71		203.51
48.59	203.90	203.41	203.42	203.66		203.47
49.57	203.83	203.37	203.37	203.62	203.77	203.43
55.00	203.71	203.10	203.35	203.38	203.16	203.16
57.61	203.66	202.97	202.97	203.22	203.23	203.02
60.00	203.63	202.84	202.84	203.09	203.10	202.89
63.61	203.51	202.65	202.65	202.90	202.90	202.70
67.70	203.29	202.43	202.43	202.68	202.68	202.49
70.00	203.13	202.31	202.31	202.56	202.56	202.36
75.61	202.50	202.03	202.03	202.28	202.28	202.09
77.70	202.26	201.93	202.18	202.18	202.18	201.99
78.62	202.24	201.89	202.14	202.14	202.14	201.94
80.00	202.22	201.83	201.83	202.08	202.08	201.88
87.70	202.17	201.50	201.50	201.75	201.75	201.55
90.00	202.18	201.41	201.41	201.66	201.66	201.46
93.61	202.18	201.26	201.26	201.51	201.51	201.32
96.62	202.19	201.14	201.14	201.39	201.39	201.20
100.00	202.19	201.01	201.01	201.26	201.26	201.06
108.61	202.20	200.66	200.66	200.91	200.91	200.72
110.00	202.21	200.61	200.61	200.86	200.86	200.66
112.62	202.21	200.50	200.50	200.75	200.75	200.56
120.00	202.22	200.21	200.21	200.46	200.46	200.26
123.12	202.22	200.08	200.08	200.33	200.33	200.14
124.61	202.23	200.02	200.02	200.27	200.27	200.08
130.00	202.23	199.81	199.81	200.06	200.06	199.86
133.61	202.23	199.66	199.66	199.91	199.91	199.72
140.00	202.24	199.41	199.41	199.66	199.66	199.46
140.51	202.25	199.38	199.38	199.63	199.63	199.44
148.61	202.60	199.02	199.02	199.27	199.27	199.08
150.00	202.62	199.01	199.01	199.26	199.26	199.06
153.11	202.23	198.88	198.88	199.13	199.13	198.94
160.00	199.37	198.61	198.61	198.86	198.86	198.66
165.61	198.88	198.38	198.38	198.63	198.63	198.44
165.61	198.88	198.38	198.38	198.63	198.63	198.44
166.54	198.82	198.34	198.34	198.59	198.59	198.40

TERRAPEE ST
SCALE H 1 : 500 V 1 : 100

C	REGRADED LOTS - ADDED DRAINAGE LINE 76, 77 & 78 - AMENDED SHARED DRIVEWAY	SA	SA	NJB	NJB	29/10/24
B	ISSUED FOR CONSTRUCTION	NJB	SA	HB	AR	11/12/23
A	AS SUBMITTED TO COUNCIL	NJB	SA	AR	AR	12/10/23
REV	REVISION	DES	DWG	CHK	AUTH	DATE

RPE: N.BAWDEN - 0015036

Tomkinson
SURVEY | ENGINEERING | PLANNING | PROJECT MANAGEMENT

HEAD OFFICE: 57 MYERS STREET BENDIGO PH 03 5445 8700
ABN 11 103 336 358 WWW.TOMKINSON.COM

imagine
STRATHFIELDSAYE

SCALE H 1:500 V 1:100

© COPYRIGHT
THE INFORMATION CONTAINED
ON THIS DRAWING IS THE
INTELLECTUAL PROPERTY OF
TOMKINSON GROUP. COPYING
OR USING THIS DRAWING IN
WHOLE OR IN PART WITHOUT
THE EXPRESS WRITTEN
PERMISSION OF TOMKINSON
GROUP INFRINGES COPYRIGHT

IMAGINE STAGE 30
53 DUKES LANE STRATHFIELDSAYE
TERRAPEE STREET LONG SECTION
CITY OF GREATER BENDIGO REF: DS/188/216
EMU CREEK HOLDINGS 2 PTY LTD

DWG STATUS:
PRELIMINARY

PROJECT & DWG No:
1352030R10 / 18 C

NOTE: THIS IS AN UNCONTROLLED DOCUMENT AND WILL NOT BE UPDATED. IT IS THE RESPONSIBILITY OF THE USER TO CONFIRM THAT THIS IS A CURRENT COPY AND SUITABLE FOR THE PROPOSED USE. THIS SHEET MUST BE READ IN CONJUNCTION WITH ALL SHEETS OF THIS SET AND ANY ACCOMPANYING DOCUMENTS.
PLOT DATE: 28/10/2024 FILE: C:\TZDD\DATA\TOMKINSON\1352030\1352030_01\STRATHFIELDSAYE_3098ENG000\CAD\CURRENT\STAGE 30\1352030 R-D PLANS REV CADWG

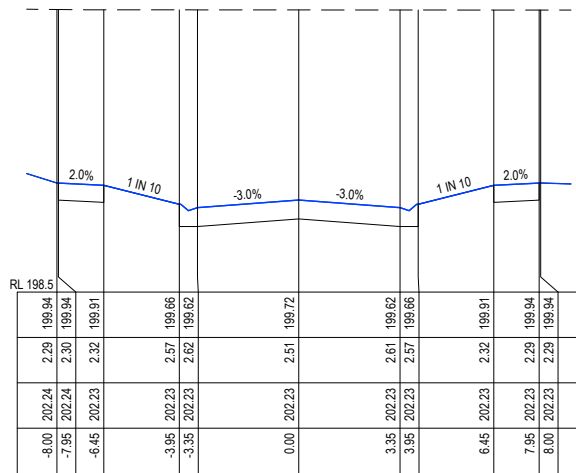

CH 133.61

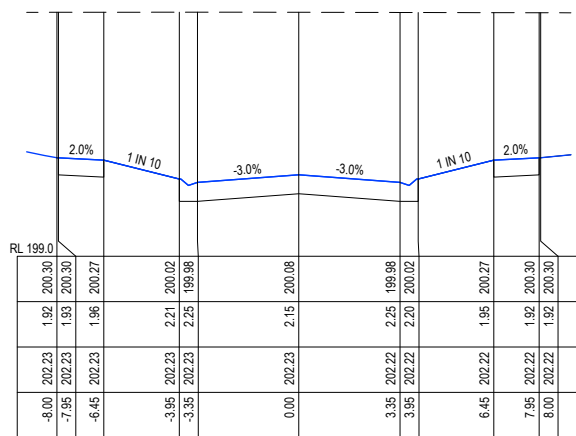

CH 124.61

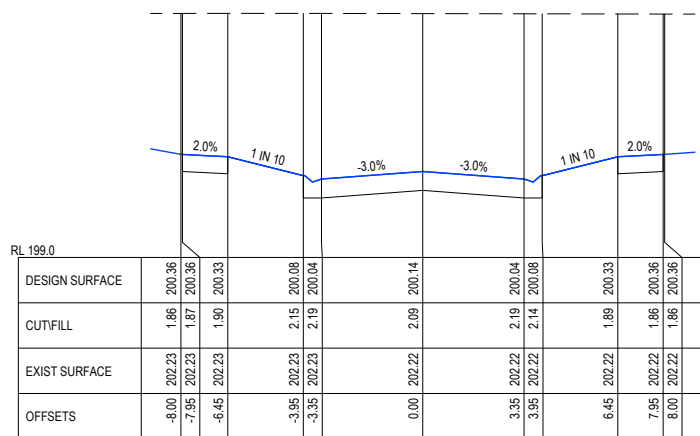

CH 123.12

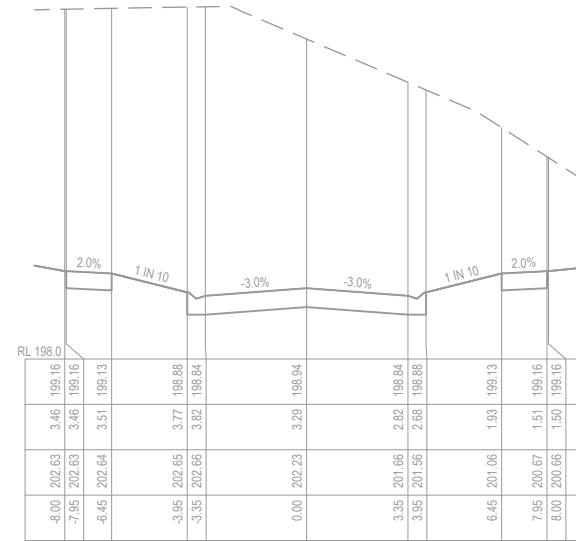

CH 153.11

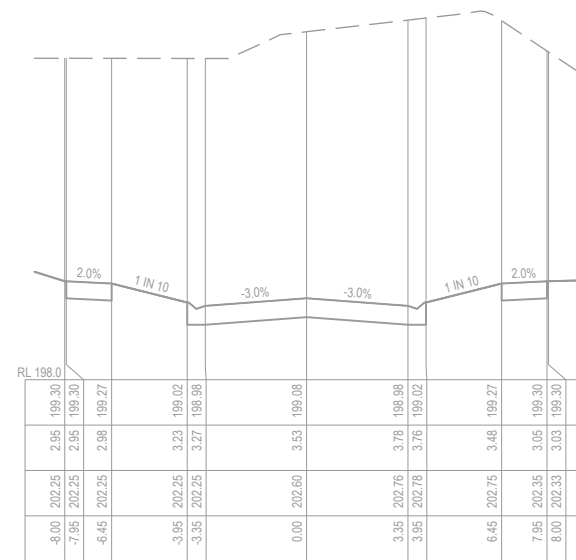

CH 149.61

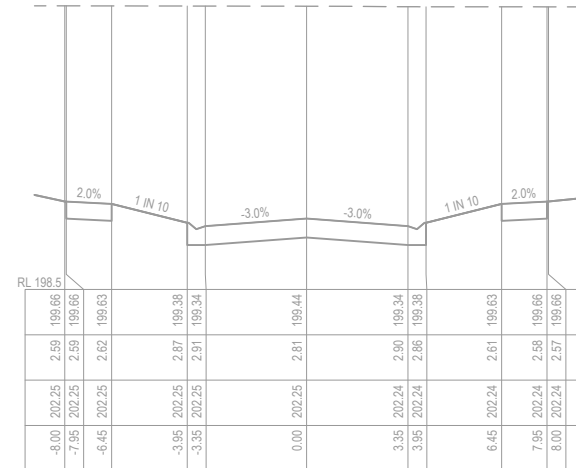

CH 140.61

TERRAPEE ST
SCALE H 1:250 V 1:100

C	REGRADED LOTS - ADDED DRAINAGE LINE 76, 77 & 78 - AMENDED SHARED DRIVEWAY	SA	SA	NJB	NJB	29/10/24
B	ISSUED FOR CONSTRUCTION	NJB	SA	HB	AR	11/12/23
A	AS SUBMITTED TO COUNCIL	NJB	SA	AR	AR	12/10/23
REV	REVISION	DES	DWG	CHK	AUTH	DATE

RPE: N.BAWIEN - 0015036

Tomkinson
SURVEY • ENGINEERING • PLANNING • PROJECT MANAGEMENT
HEAD OFFICE: 57 MYERS STREET BENDIGO PH 03 5445 8700
ABN 11 103 336 358 WWW.TOMKINSON.COM



SCALE H 1:250 V 1:100
LENGTHS ARE IN METRES - PAPER SIZE A3
© COPYRIGHT THE INFORMATION CONTAINED ON THIS DRAWING IS THE INTELLECTUAL PROPERTY OF TOMKINSON GROUP. COPYING OR USING THIS DRAWING IN WHOLE OR IN PART WITHOUT THE EXPRESS WRITTEN PERMISSION OF TOMKINSON GROUP INFRINGES COPYRIGHT.
BEFORE YOU DIG
COMPASS ASSURANCE ISO 9001 QUALITY

IMAGINE STAGE 30
53 DUKES LANE STRATHFIELDSAYE
TERRAPEE STREET CROSS SECTION (SHEET 2 OF 2)
CITY OF GREATER BENDIGO REF: DS/188/216
EMU CREEK HOLDINGS 2 PTY LTD
DWG STATUS: **PRELIMINARY**
PROJECT & DWG No: 1352030R12 / 18 C

NOTE: THIS IS AN UNCONTROLLED DOCUMENT AND WILL NOT BE UPDATED. IT IS THE RESPONSIBILITY OF THE USER TO CONFIRM THAT THIS IS A CURRENT COPY AND SUITABLE FOR THE PROPOSED USE. THIS SHEET MUST BE READ IN CONJUNCTION WITH ALL SHEETS OF THIS SET AND ANY ACCOMPANYING DOCUMENTS.
PLOT DATE: 28/10/2024 FILE: C:\TZD\DATA\TOMK66C-1250\1352030-1 - EMU CREEK HOLDINGS 2 PTY LTD - STRATHFIELDSAYE_309BENG00\CAD\CURRENT\STAGE 30\1352030 R-D PLANS REV.CADWG

DUKES LANE

TERRAPEE STREET

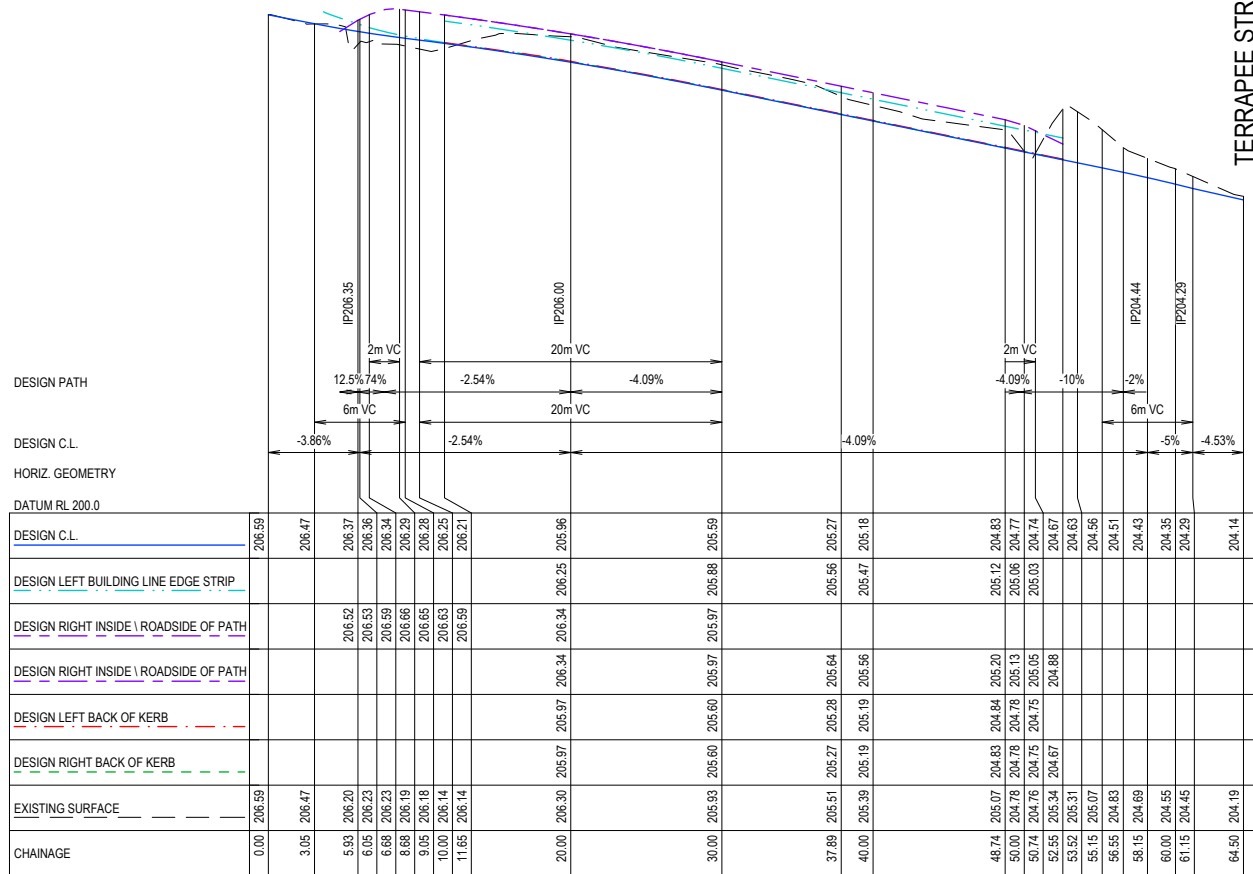

MYRTLE STREET
SCALE H 1:500 V 1:100

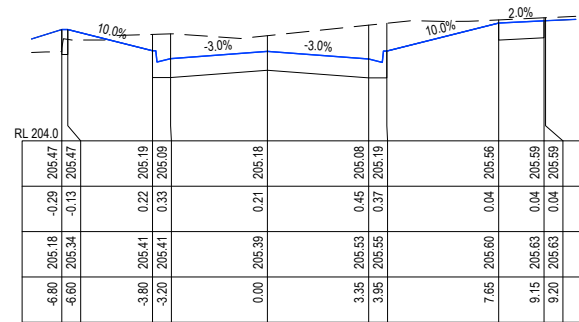

CH 40

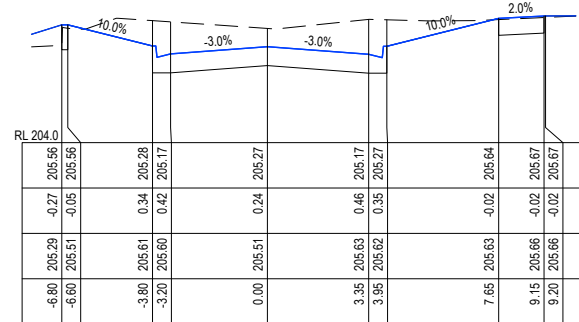

CH 37.89

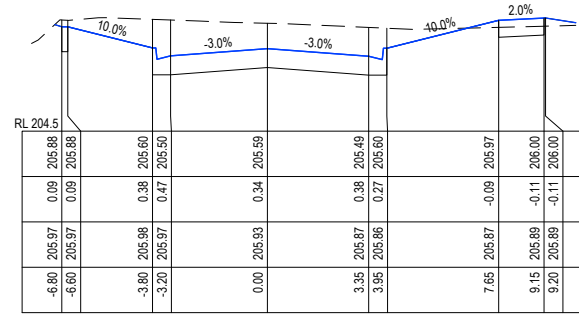

CH 30

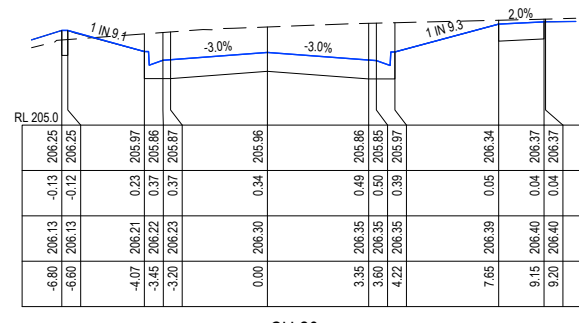

CH 20

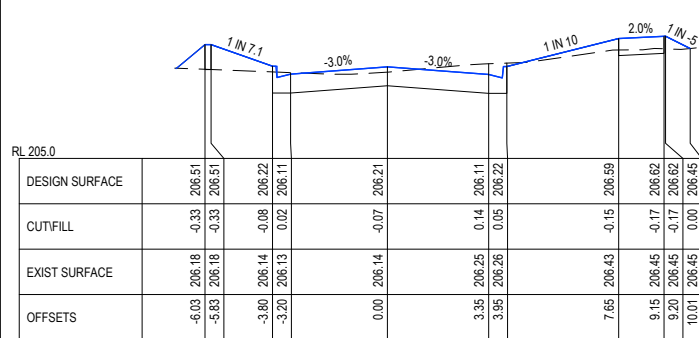

CH 11.65

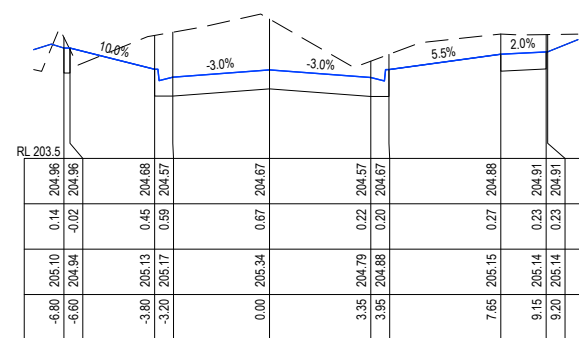

CH 52.55

MYRTLE STREET
SCALE H 1:250 V 1:100

C	REGRADED LOTS - ADDED DRAINAGE LINE 76, 77 & 78 - AMENDED SHARED DRIVEWAY	SA	SA	NJB	NJB	29/10/24
B	ISSUED FOR CONSTRUCTION	NJB	SA	HB	AR	11/12/23
A	AS SUBMITTED TO COUNCIL	NJB	SA	AR	AR	12/10/23
REV	REVISION	DES	DWG	CHK	AUT	DATE

RPE: N.BAWIEN - 0015036

Tomkinson
SURVEY | ENGINEERING | PLANNING | PROJECT MANAGEMENT
HEAD OFFICE: 57 MYERS STREET BENDIGO PH 03 5445 8700
ABN 11 103 336 358 WWW.TOMKINSON.COM

imagine
STRATHFIELDSAYE

SCALE AS SHOWN
LENGTHS ARE IN METRES - PAPER SIZE A3
© COPYRIGHT THE INFORMATION CONTAINED ON THIS DRAWING IS THE INTELLECTUAL PROPERTY OF TOMKINSON GROUP. COPYING OR USING THIS DRAWING IN WHOLE OR IN PART WITHOUT THE EXPRESS WRITTEN PERMISSION OF TOMKINSON GROUP INFRINGES COPYRIGHT.
BEFORE YOU DIG
www.byda.com.au
COMPASS ASSURANCE ISO 9001 QUALITY

IMAGINE STAGE 30
53 DUKES LANE STRATHFIELDSAYE
MYRTLE LANE LONG & CROSS SECTION
CITY OF GREATER BENDIGO REF: DS/188/216
EMU CREEK HOLDINGS 2 PTY LTD
DWG STATUS: **PRELIMINARY**
PROJECT & DWG No: 1352030R13 / 18 C

NOTE: THIS IS AN UNCONTROLLED DOCUMENT AND WILL NOT BE UPDATED. IT IS THE RESPONSIBILITY OF THE USER TO CONFIRM THAT THIS IS A CURRENT COPY AND SUITABLE FOR THE PROPOSED USE. THIS SHEET MUST BE READ IN CONJUNCTION WITH ALL SHEETS OF THIS SET AND ANY ACCOMPANYING DOCUMENTS.
PLOT DATE: 28/10/2024 FILE: C:\TZD\DATA\TOMKINSON\66-1250511352001 - EMU CREEK HOLDINGS 2 PTY LTD, STRATHFIELDSAYE_3098ENG00\CAD\CURRENT\STAGE 30\1352030 R-D PLANS REV.CADWG

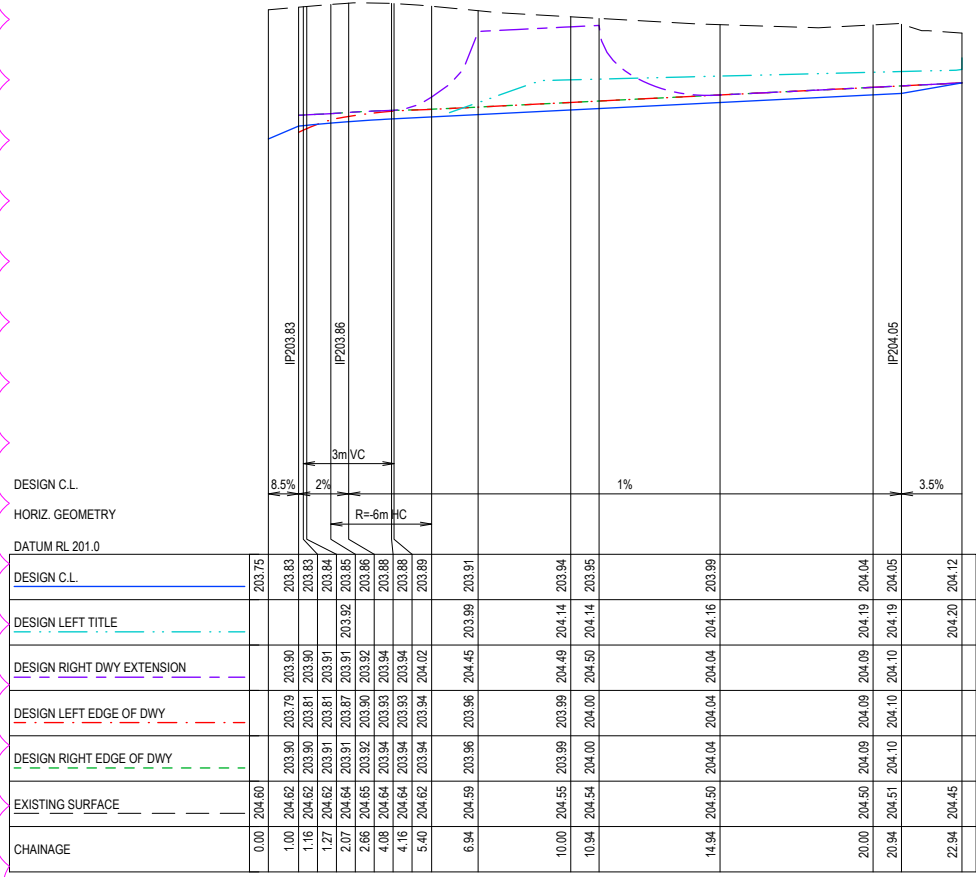

SHARED DRIVEWAY
SCALE H:1 - 250 V:1 - 50

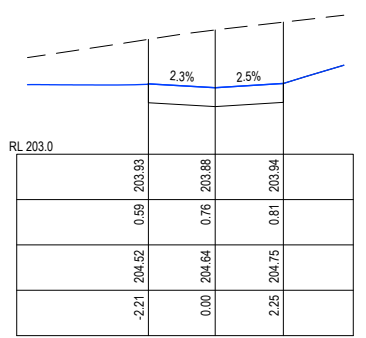

CH 4.08

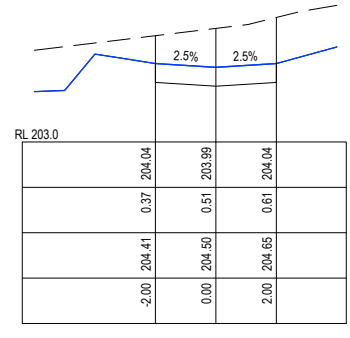

CH 14.94

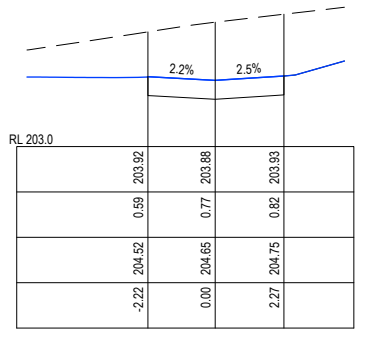

CH 3.78

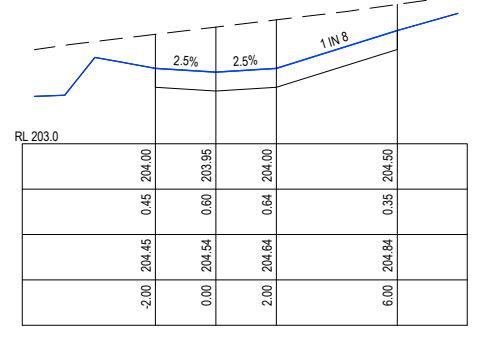

CH 10.94

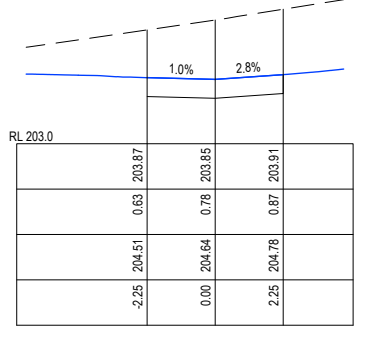

CH 2.07

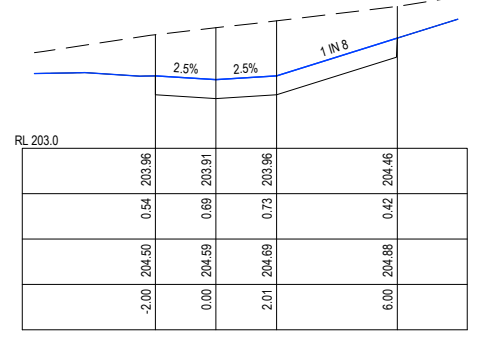

CH 6.94

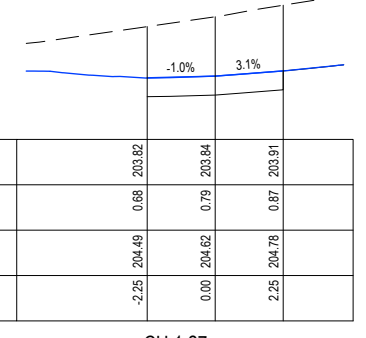

CH 1.27

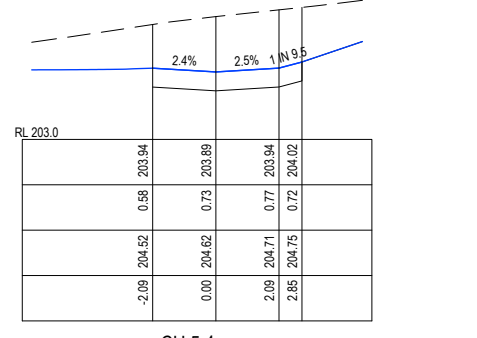

CH 5.4

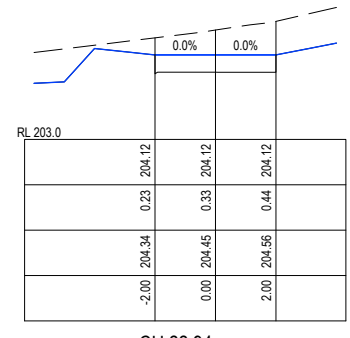

CH 22.94

SHARED DRIVEWAY
SCALE H:1 - 250 V:1 - 100

REV	REVISION	DES	DWG	CHK	AUTH	DATE
C	REGRADED LOTS - ADDED DRAINAGE LINE 76, 77 & 78 - AMENDED SHARED DRIVEWAY	SA	SA	NJB	NJB	29/10/24
B	ISSUED FOR CONSTRUCTION	NJB	SA	HB	AR	11/12/23
A	AS SUBMITTED TO COUNCIL	NJB	SA	AR	AR	12/10/23

RPE: N.BAWIEN - 0015036

Tomkinson
SURVEY > ENGINEERING > PLANNING > PROJECT MANAGEMENT
HEAD OFFICE: 57 MYERS STREET BENDIGO PH 03 5445 8700
ABN 11 103 336 358 WWW.TOMKINSON.COM

imagine
STRATHFIELDSAYE

SCALE AS SHOWN
LENGTHS ARE IN METRES - PAPER SIZE A3
© COPYRIGHT THE INFORMATION CONTAINED ON THIS DRAWING IS THE INTELLECTUAL PROPERTY OF TOMKINSON GROUP. COPYING OR USING THIS DRAWING IN WHOLE OR IN PART WITHOUT THE EXPRESS WRITTEN PERMISSION OF TOMKINSON GROUP INFRINGES COPYRIGHT.
BEFORE YOU DIG
COMPASS ASSURANCE ISO 9001 QUALITY

IMAGINE STAGE 30
53 DUKES LANE STRATHFIELDSAYE
SHARED DRIVEWAY CROSS & LONG SECTIONS
CITY OF GREATER BENDIGO REF: DS/188/216
EMU CREEK HOLDINGS 2 PTY LTD
DWG STATUS: **PRELIMINARY**
PROJECT & DWG No: 1352030R14 / 18 C

NOTE: THIS IS AN UNCONTROLLED DOCUMENT AND WILL NOT BE UPDATED. IT IS THE RESPONSIBILITY OF THE USER TO CONFIRM THAT THIS IS A CURRENT COPY AND SUITABLE FOR THE PROPOSED USE. THIS SHEET MUST BE READ IN CONJUNCTION WITH ALL SHEETS OF THIS SET AND ANY ACCOMPANYING DOCUMENTS.
PLOT DATE: 29/10/2024 FILE: C:\12\DATA\TOMKINSON\3098\EMUCAD\CURRENT\STAGE 30\1352030 R-D PLANS REV.CADWG

69D 69E 69F 69G 69H 69I 69J 69K 68K TP 68L 99A TP 99B 69E 72A TP 72B

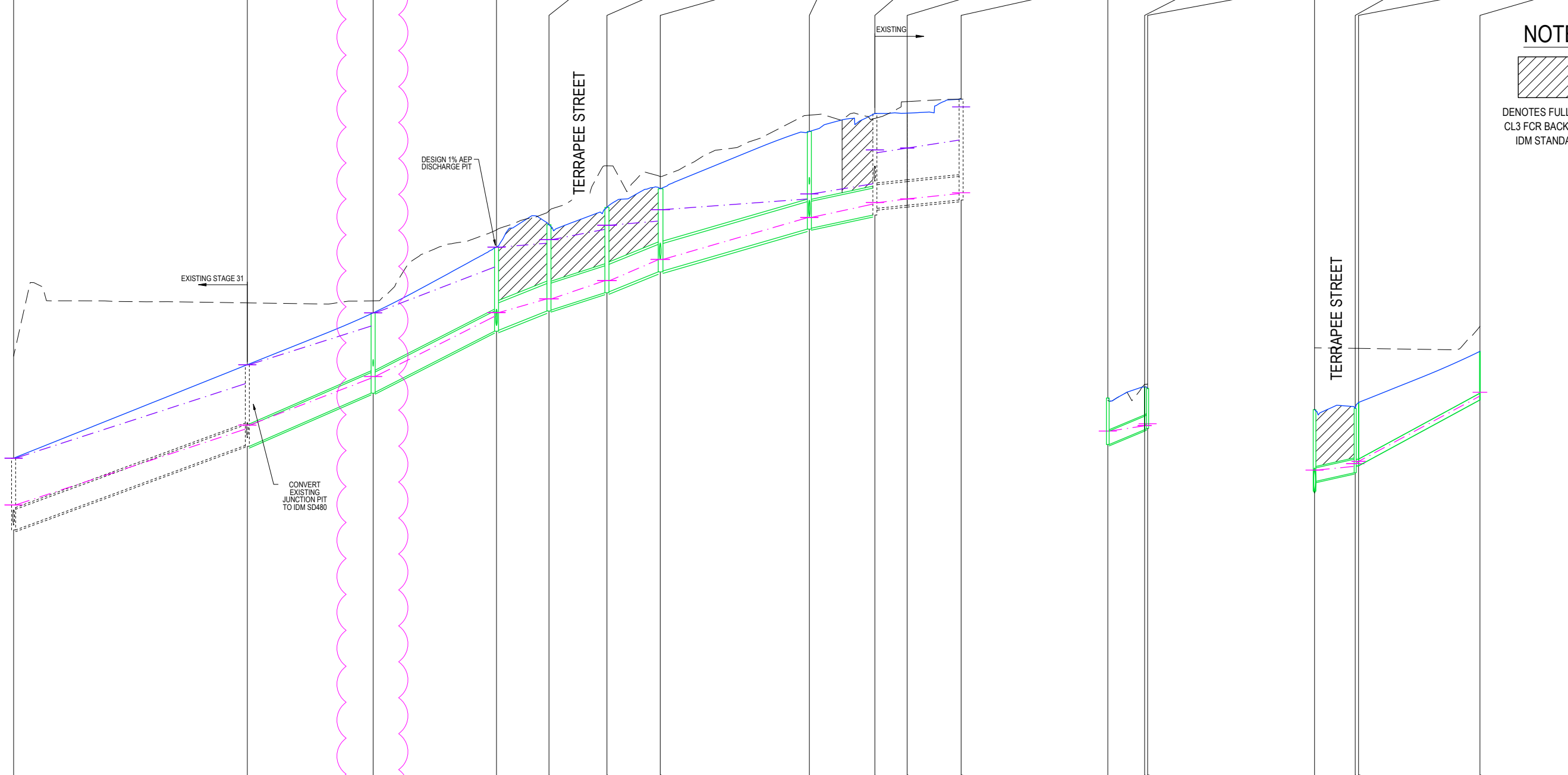

NOTE:

 DENOTES FULL DEPTH
 CL3 FCR BACKFILL TO
 IDM STANDARDS

DESIGN FLOW (l/s)	270 1073	227 965	219 945	173 823	169 816	170 820	158 791	146 766	47 518	48 523	14	33	9	9
CAPACITY (l/s)	826	893	634	1796	1064	1811	1567	870	421	421	194	140	16	51
VELOCITY (m/s)	4.46 6.48	4.5 5.83	3.62 5.94	3.86 5.97	2.75 4.15	3.87 6	3.41 5.34	2.28 3.47	1.28 2.39	1.29 2.41	1.58	1.63	0.91	2.18
PIPE DIAMETER (mm)	4500 HDPE	4500 HDPE	4500 RCP CL2 RRJ	6000 HDPE	6000 RCP CL2 FJ	6000 HDPE	6000 HDPE	6000 RCP CL2 FJ	5250 RCP CL2 FJ	5250 RCP CL2 FJ	3000 RCP CL2 FJ	3000 RCP CL2 FJ	1500 PVC	1500 PVC
PIPE GRADE	1:27.7 (3.62%)	1:23.7 (4.23%)	1:20.2 (4.95%)	1:27.1 (3.69%)	1:33.4 (3.00%)	1:26.7 (3.75%)	1:35.6 (2.81%)	1:49.8 (2.01%)	1:104 (0.96%)	1:104 (0.96%)	1:24.8 (4.02%)	1:24.9 (4.02%)	1:18.5 (5.42%)	1:18.5 (5.42%)
DATUM RL														
DEPTH TO INVERT	1.59 1.60	1.80 1.82	1.79 1.77	1.87 1.85	1.92 1.90	1.88 1.86	1.85 1.83	2.26 2.11	2.05 2.03	2.05 2.03	1.04 1.04	0.95 0.95	0.89 0.89	0.89 0.89
H.G.L. 20% / 1% AEP	198.21 197.55 197.15 197.71 197.15 198.75	200.40 199.39 199.01 199.48 199.01 200.83	201.69 200.53 200.19 200.36 200.21 201.38	203.00 201.90 201.57 201.90 201.99 203.44	203.53 202.29 202.02 202.29 202.04 203.61	203.84 202.69 202.43 202.69 202.45 203.93	204.02 203.17 203.16 203.17 203.17 204.26	204.51 203.10 203.84 203.10 203.96 204.63	204.85 204.43 204.16 204.43 204.31 205.43 205.60 205.54	205.65 204.38 204.38 204.38 204.38 204.38	203.35 203.05 203.05 203.05 203.05 203.05	193.0 193.0 193.0 193.0 193.0 193.0	193.0 193.0 193.0 193.0 193.0 193.0	193.0 193.0 193.0 193.0 193.0 193.0
INVERT LEVEL	197.16 197.15	199.03 199.01	200.19 200.21	201.57 201.59	202.02 202.04	202.43 202.45	202.89 202.91	203.84 203.86	204.16 204.31	204.38 204.38	203.05 203.05	203.38 203.38	203.38 203.38	203.41 203.41
DESIGN SURFACE	198.75	200.83	201.98	203.44	203.94	204.33	204.74	205.75	206.42	206.42	204.09	204.33	204.98	205.12
CHAINAGE	122.25	174.25	202.24	229.69	241.36	254.26	266.12	292.29	313.87	321.06	333.06	367.99	367.99	367.99

C	REGRADED LOTS - ADDED DRAINAGE LINE 76, 77 & 78 - AMENDED SHARED DRIVEWAY	SA	SA	NJB	NJB	29/10/24
B	ISSUED FOR CONSTRUCTION	NJB	SA	HB	AR	11/12/23
A	AS SUBMITTED TO COUNCIL	NJB	SA	AR	AR	12/10/23
REV	REVISION	DES	DWG	CHK	AUTH	DATE

RPE: N.BAWDEN - 0016036

Tomkinson
 SURVEY • ENGINEERING • PLANNING • PROJECT MANAGEMENT
 HEAD OFFICE: 57 MYERS STREET BENDIGO PH 03 5445 8700
 ABN 11 103 336 358 WWW.TOMKINSON.COM

imagine STRATHFIELDSAYE
 THE INFORMATION CONTAINED ON THIS DRAWING IS THE INTELLECTUAL PROPERTY OF TOMKINSON GROUP. COPYING OR USING THIS DRAWING IN WHOLE OR IN PART WITHOUT THE EXPRESS WRITTEN PERMISSION OF TOMKINSON GROUP INFRINGES COPYRIGHT.

SCALE H 1:1,000 V 1:100
 LENGTHS ARE IN METRES - PAPER SIZE A3
 BEFORE YOU DIG
 COMPASS ASSURANCE ISO 9001 QUALITY

IMAGINE STAGE 30
53 DUKES LANE STRATHFIELDSAYE
 DRAINAGE LONG SECTIONS (1 OF 2)
 CITY OF GREATER BENDIGO REF: DS/188/216
 EMU CREEK HOLDINGS 2 PTY LTD
 DWG STATUS: **PRELIMINARY**
 PROJECT & DWG No: 1352030R15 / 18 C

NOTE: THIS IS AN UNCONTROLLED DOCUMENT AND WILL NOT BE UPDATED. IT IS THE RESPONSIBILITY OF THE USER TO CONFIRM THAT THIS IS A CURRENT COPY AND SUITABLE FOR THE PROPOSED USE. THIS SHEET MUST BE READ IN CONJUNCTION WITH ALL SHEETS OF THIS SET AND ANY ACCOMPANYING DOCUMENTS.
 PLOT DATE: 28/10/2024 FILE: C:\TZ\DATA\TOMKINSON\1352030\1352030_30\BENGING00\CAD\CURRENT\STAGE 30\1352030 R-D PLANS REV.CADW

NOTE:

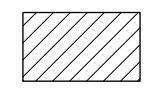

DENOTES FULL DEPTH CL3 FOR BACKFILL TO IDM STANDARDS

PIT SCHEDULE												
PIT NAME	TYPE	EASTING	NORTHING	INTERNAL		INLET DIA	INV LEV	OUTLET DIA	INV LEV	PIT SETOUT RL	DEPTH	REMARKS
				WD	LEN							
69E	JP + GJP	265488.207	5923647.884	600	900	450	199.01	450	199.03	200.827	1.817	CONVERT TEMPORARY JUNCTION PIT TO IDM SD480
						300	199.231					
69F	JP	265515.944	5923644.127	600	900	450	200.213	450	200.193	201.98	1.787	IDM SD420
						150	201.36					
69G	SEP	265543.113	5923640.194	1200	900	525	201.591	450	201.571	203.444	1.873	CoGB SEP SD590BG WITH CLASS 'D' GRATED INSERT
						300	201.73					
69H	SEP	265550.01	5923631.138	900	1200	600	202.041	525	202.021	203.942	1.921	CoGB SEP SD590BG 900x900 LID
69I	SEP	265557.742	5923621.157	900	1200	600	202.448	600	202.428	204.327	1.9	CoGB SEP SD590BG 900x900 LID
69J	SEP	265564.767	5923611.931	900	1200	600	202.912	600	202.892	204.742	1.85	CoGB SEP SD590BG 900x900 LID
						300	203.204					
69K	SEP	265597.641	5923607.484	900	900	600	203.864	600	203.844	205.775	1.935	CoGB SD590I 2700mm EKI (LEFT)
						300	204.156					
68K	JP	265612.076	5923605.429	900	900	525	204.306	600	204.156	206.419	2.263	CONVERT SEP TO CLASS 'D' GATIC JP
						300	204.94					
72A	GJP IN KERB	265493.247	5923655.324	450	900	150	199.572	300	199.422	200.856	1.435	IDM SD481
72B	EP	265520.104	5923652.444	0	0			150	201.038	202.123	1.085	BLANK END
73A	SEP	265549.125	5923648.462	600	900	300	201.912	300	201.892	203.585	1.692	CoGB SEP SD590G
73B	GJP	265559.227	5923650.726	600	900	150	202.538	300	202.388	203.898	1.51	IDM SD420 WITH CLASS 'D' GRATED INSERT
						150	203.138					
73C	JP	265561.173	5923665.094	600	900			150	202.69	204.043	1.352	IDM SD420
74A	SEP	265563.457	5923603.329	600	900			300	203.378	204.744	1.366	CoGB SEP SD590G
75A	SEP	265596.472	5923598.853	600	900			300	204.64	205.776	1.135	CoGB SD590I 2700mm EKI (RIGHT)
76A	GJP	265513.134	5923623.36	450	450			150	202.102	202.771	0.67	IDM SD425 WITH GRATED INSERT
77A	GJP	265584.407	5923647.316	450	450			150	204.567	205.27	0.703	IDM SD425 WITH GRATED INSERT
78A	GJP	265598.745	5923613.031	450	450			150	205.209	206.111	0.902	CoGB GJP SD590N

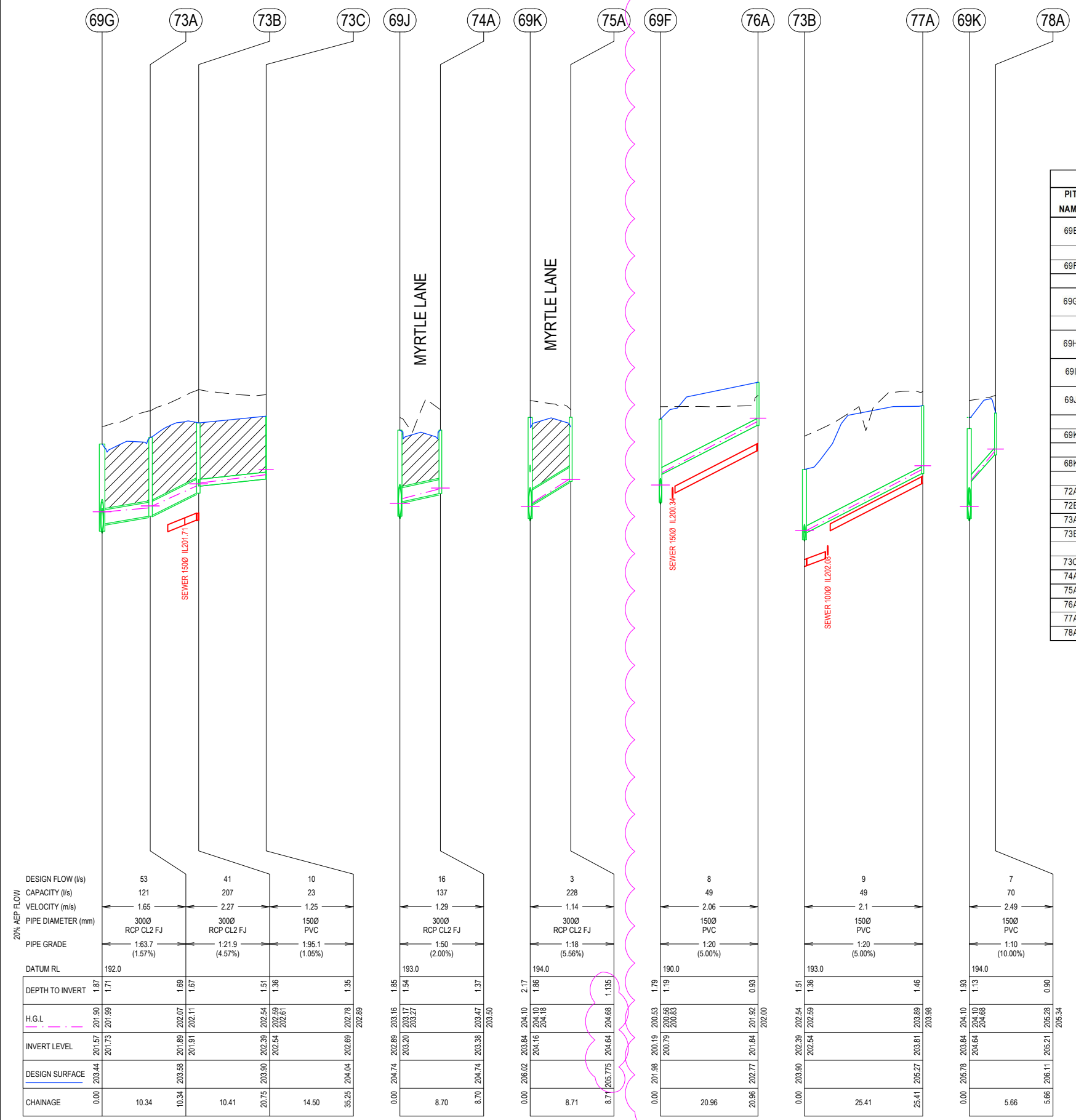

C	REGRADED LOTS - ADDED DRAINAGE LINE 76, 77 & 78 - AMENDED SHARED DRIVEWAY	SA	SA	NJB	NJB	29/10/24
B	ISSUED FOR CONSTRUCTION	NJB	SA	HB	AR	11/12/23
A	AS SUBMITTED TO COUNCIL	NJB	SA	AR	AR	12/10/23
REV	REVISION	DES	DWG	CHK	AUTH	DATE

Tomkinson
SURVEY • ENGINEERING • PLANNING • PROJECT MANAGEMENT
HEAD OFFICE: 57 MYERS STREET BENDIGO PH 03 5445 8700
ABN 11 103 336 358 WWW.TOMKINSON.COM

imagine STRATHFIELDSAYE

SCALE H 1:1000 V 1:100
LENGTHS ARE IN METRES - PAPER SIZE A3
© COPYRIGHT THE INFORMATION CONTAINED ON THIS DRAWING IS THE INTELLECTUAL PROPERTY OF TOMKINSON GROUP. COPYING OR USING THIS DRAWING IN WHOLE OR IN PART WITHOUT THE EXPRESS WRITTEN PERMISSION OF TOMKINSON GROUP INFRINGES COPYRIGHT.
BEFORE YOU DIG www.byda.com.au
COMPASS ASSURANCE ISO 9001 QUALITY

IMAGINE STAGE 30
53 DUKES LANE STRATHFIELDSAYE
DRAINAGE LONG SECTIONS (2 OF 2) + PIT SCHEDULE
CITY OF GREATER BENDIGO REF: DS/188/216
EMU CREEK HOLDINGS 2 PTY LTD
DWG STATUS: **PRELIMINARY** PROJECT & DWG No: 1352030R16 / 18 C

NOTE: THIS IS AN UNCONTROLLED DOCUMENT AND WILL NOT BE UPDATED. IT IS THE RESPONSIBILITY OF THE USER TO CONFIRM THAT THIS IS A CURRENT COPY AND SUITABLE FOR THE PROPOSED USE. THIS SHEET MUST BE READ IN CONJUNCTION WITH ALL SHEETS OF THIS SET AND ANY ACCOMPANYING DOCUMENTS. PLOT DATE: 29/10/2024 FILE: C:\12\DATA\TOMKINSON\3098\ENG\00\CAD\CURRENT\STAGE 30\1352030 R-D PLANS REV.CADWG

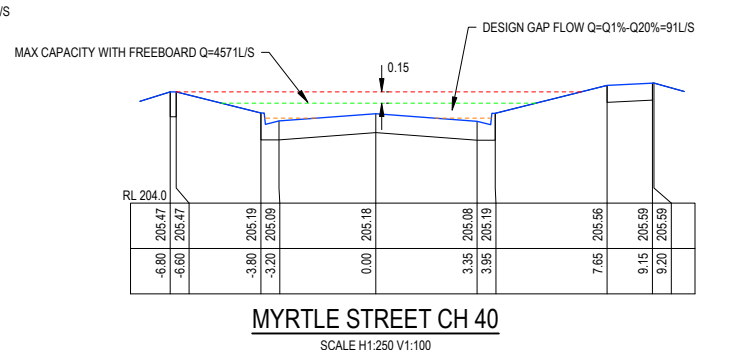
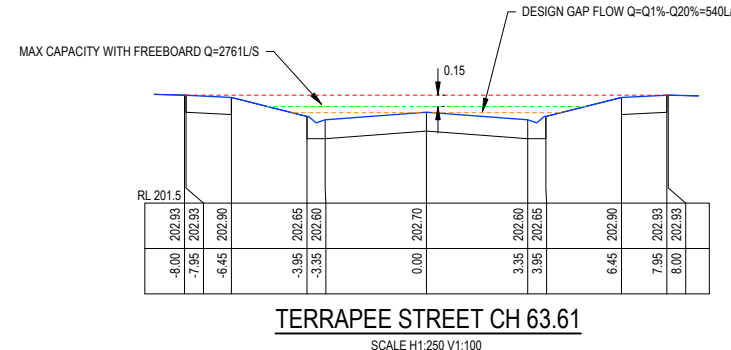
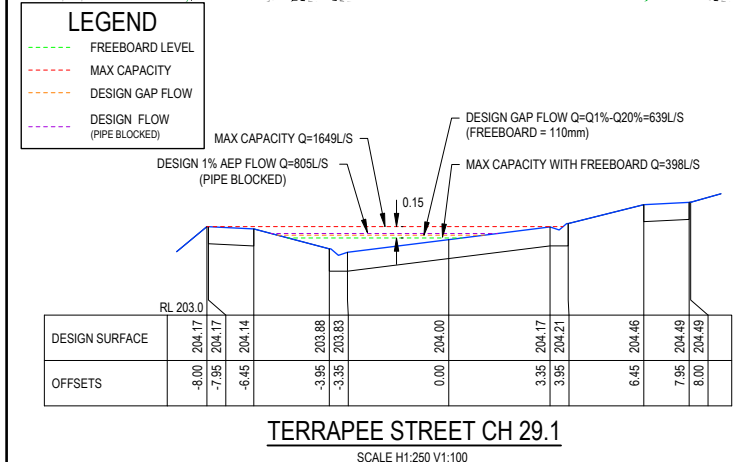
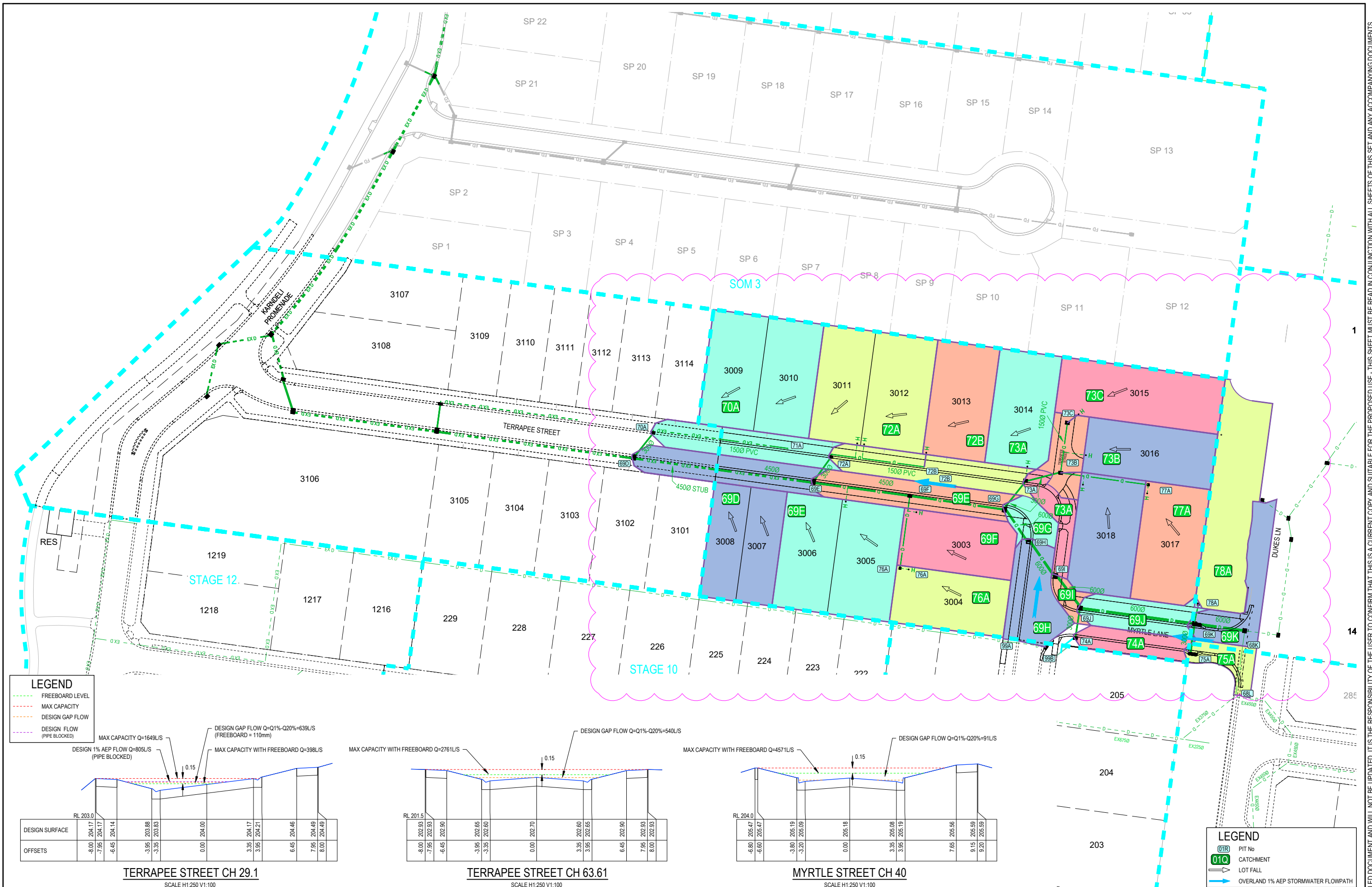

LEGEND

- PIT No
- CATCHMENT
- LOT FALL
- OVERLAND 1% AEP STORMWATER FLOWPATH

C REGRADED LOTS - ADDED DRAINAGE LINE 76, 77 & 78 - AMENDED SHARED DRIVEWAY

B ISSUED FOR CONSTRUCTION

A AS SUBMITTED TO COUNCIL

REV	DES	DWG	CHK	DATE
	SA	SA	NJB	29/10/24
	NJB	SA	HB	11/12/23
	NJB	SA	AR	12/10/23

REVISION



Tomkinson
SURVEY • ENGINEERING • PLANNING • PROJECT MANAGEMENT

HEAD OFFICE: 57 MYERS STREET BENDIGO PH 03 5445 8700
ABN 11 103 336 358 WWW.TOMKINSON.COM



SCALE 1:1,000
LENGTHS ARE IN METRES - PAPER SIZE A3

© COPYRIGHT THE INFORMATION CONTAINED ON THIS DRAWING IS THE INTELLECTUAL PROPERTY OF TOMKINSON GROUP. COPYING OR USING THIS DRAWING IN WHOLE OR IN PART WITHOUT THE EXPRESS WRITTEN PERMISSION OF TOMKINSON GROUP INFRINGES COPYRIGHT

BEFORE YOU DIG
www.byda.com.au

COMPASS ASSURANCE
ISO 9001 QUALITY

IMAGINE STAGE 30
53 DUKES LANE STRATHFIELDSAYE
DRAINAGE CATCHMENT PLAN

CITY OF GREATER BENDIGO REF: DS/188/216
EMU CREEK HOLDINGS 2 PTY LTD

DWG STATUS: **PRELIMINARY**

PROJECT & DWG No: 1352030R17 / 18 C

NOTE: THIS IS AN UNCONTROLLED DOCUMENT AND WILL NOT BE UPDATED. IT IS THE RESPONSIBILITY OF THE USER TO CONFIRM THAT THIS IS A CURRENT COPY AND SUITABLE FOR THE PROPOSED USE. THIS SHEET MUST BE READ IN CONJUNCTION WITH ALL SHEETS OF THIS SET AND ANY ACCOMPANYING DOCUMENTS.
PLOT DATE: 28/10/2024 FILE: C:\12\DATA\TOMKINSON\3098\ENG\00\CAD\CURRENT\STAGE 30\1352030 R-D PLANS REV.CADWG

12D MODEL - HYDRAULIC DESIGN SHEET

Project: Design
 Drainage Model: DRN
 Rainfall File: Bendigo 100820.12dhydro

Rainfall Method: IFD Table
 Freeboard Limit: 0.15 m
 Minor 20.00 AEP(%) Storm Event

Pipe ID	Pipe Type	Pipe Length (m)	Pipe Size (mm)	Full Pipe Area (sq.m)	Pipe Grade (%)	Pipe Grade (1 in)	Full-area Tct (min)	Full-area I (mm/hr)	Full-area Sum CA (ha)	Full-area Qc=CA (L/s)	Part-area Tct (min)	Part-area I (mm/hr)	Part-area Sum CA (ha)	Part-area Qc=CA (L/s)	Catchment Flow Qc (L/s)	Direct Node Flow Qd (L/s)	Pipe Flow Q (L/s)	Capacity Flow Qcap (L/s)	Q/Qcap Ratio	Full Pipe Vel V=Q/Af (m/s)	Norm Depth Vel Vn=Q/An (m/s)	Crit Depth Vel Vc=Q/Ac (m/s)	Capacity Vel Vcap=Qcap/Af (m/s)	US Node Grate RL (m)	Pipe US IL (m)	Pipe DS IL (m)	DS Node Grate RL (m)	Cover Limit (m)	Cover Min (m)	Pipe DS Bend (deg)	Pipe DS Drop (m)	US Node Ku (-)	US Node Kw (-)	Pipe V-head (m)	P-head Loss (Ku.V-head) (m)	WSE Loss (Kw.V-head) (m)	Manning n (-)	Pipe T-head Loss (m)	US Node HGL (m)	Pipe US HGL (m)	Pipe DS HGL (m)	Pipe HGL (m)	DS Node HGL (m)	HGL Grade (%)	HGL Grade (1 in)	F'board US (m)
69E to 69D	HDPE	52	450	0.165	3.62	27.7	9.02	75.99	2.4619	519.7	8.12	80.24	2.3089	514.6	519.7	-250	260.7	825.9	0.33	1.63	4.46	1.92	4.99	200.83	199.03	197.15	198.75	1.1	1.12	0	-0.01	0.65		0.14	0.09	0.009	1.74	199.48	199.39	197.71	197.71	3.25	30.8	1.35		

12D MODEL - HYDROLOGICAL DESIGN SHEET

Project: Design
 Drainage Model: DRN
 Rainfall File: Bendigo 100820.12dhydro

Tc Method: Direct
 Rainfall Method: IFD Table
 Runoff C Method: Direct
 Minor 20.00 AEP(%) Storm Event

Node Name	Node Type	Setout Easting (m)	Setout Northing (m)	Setout RL (m)	Grate RL (m)	Catch ID	Time Tc (min)	Intensity I (mm/hr)	Runoff C	Area A (ha)	Full CA (ha)	Full Sum CA (ha)	Full Qc=CA (L/s)	Partial CA (ha)	Partial Sum CA (ha)	Partial Qc=CA (L/s)	Approach Flow Qa (L/s)
69E	IDM 900x600 GJP+JP SD480	265488.21	5923647.88	200.83	200.83	4P	6	90.22	0.6	0.1124	0.0674	0.1007	25.2	0.0674	0.1007	25.2	25.2

C REGRADED LOTS - ADDED DRAINAGE LINE 76, 77 & 78 - AMENDED SHARED DRIVEWAY	SA SA NB NB 29/10/24
B ISSUED FOR CONSTRUCTION	NB SA HB AR 11/12/23
A AS SUBMITTED TO COUNCIL	NB SA AR AR 12/10/23
REV	DES DWG CHK AUTH DATE
	REVISION

RFE: N.BAWKEN - 0015036



HEAD OFFICE: 57 MYERS STREET BENDIGO PH 03 5445 8700
 ABN 11 103 336 358 WWW.TOMKINSON.COM



STRAHFIELDSAYE

SCALE: NA
 LENGTHS ARE IN METRES - PAPER SIZE A3

© COPYRIGHT THE INFORMATION CONTAINED ON THIS DRAWING IS THE INTELLECTUAL PROPERTY OF TOMKINSON GROUP. COPYING OR USING THIS DRAWING IN WHOLE OR IN PART WITHOUT THE EXPRESS WRITTEN PERMISSION OF TOMKINSON GROUP INFRINGES COPYRIGHT.



IMAGINE STAGE 30
 53 DUKES LANE STRATHFIELDSAYE
 DRAINAGE HYDRAULIC / HYDROLOGY CALC SHEET
 CITY OF GREATER BENDIGO REF: DS/188/216
 EMU CREEK HOLDINGS 2 PTY LTD

DWG STATUS:
PRELIMINARY

PROJECT & DWG No: 1352030R18 / 18 C

NOTE: THIS IS AN UNCONTROLLED DOCUMENT AND WILL NOT BE UPDATED. IT IS THE RESPONSIBILITY OF THE USER TO CONFIRM THAT THIS IS A CURRENT COPY AND SUITABLE FOR THE PROPOSED USE - THIS SHEET MUST BE READ IN CONJUNCTION WITH ALL SHEETS OF THIS SET AND ANY ACCOMPANYING DOCUMENTS. PLOT DATE: 28/10/2024 FILE: C:\12D\DATA\TOMKINSON\1352030R18\1352030R18.DWG