

**LEGEND**

- STAGE BOUNDARY
- ↘ LOT FALL
- ▨ CUT
- ▧ FILL 300 - 600
- ▩ FILL 600 - 1000
- FS99.99 FINISHED SURFACE LEVEL
- ES99.99 EXISTING SURFACE LEVEL

- NOTES:**
- CUT/FILL HATCHING ASSUMES TOPSOIL STRIPPING OF 200mm.
  - LEVELS ARE SUBJECT TO DETAILED DESIGN.
  - FILL LEVELS 300mm AND ABOVE REQUIRE LEVEL 1 SUPERVISION.

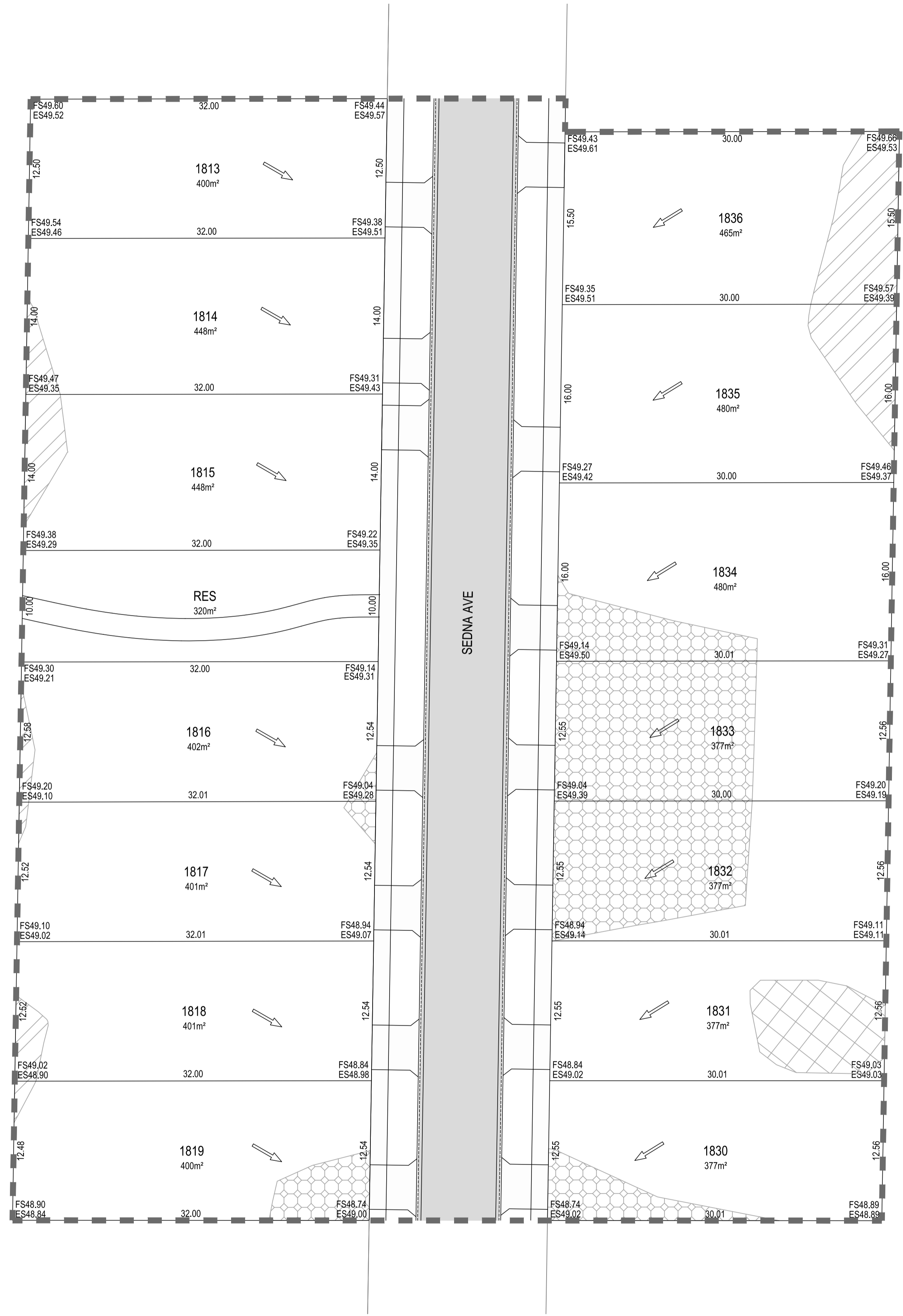

REV	REVISION	DES	DWG	CHK	DATE
D	LOT 1836 DRIVEWAY RELOCATED TO THE NORTH	MM	PW	MM	23/06/22
C	LOT 1815 DRIVEWAY RELOCATED TO THE NORTH	MM	PW	MM	05/05/22
B	CUT/FILL HATCH AMENDED	MM	MM	MM	20/04/22
A	PRELIMINARY ISSUE	MM	PW	MM	31/03/22



**Tomkinson**  
 SURVEY • ENGINEERING • PLANNING • PROJECT MANAGEMENT  
 12/99-101 WESTERN AVENUE, WESTMEADOWS PH 03 8746 9988  
 ABN 11 103 336 358 WWW.TOMKINSON.COM

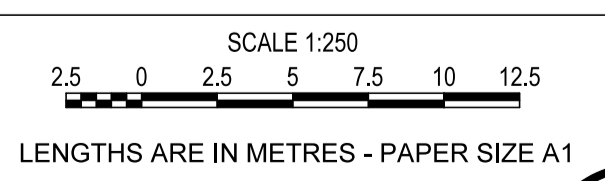

© COPYRIGHT  
 THE INFORMATION CONTAINED ON THIS DRAWING IS THE INTELLECTUAL PROPERTY OF TOMKINSON GROUP. COPYING OR USING THIS DRAWING IN WHOLE OR IN PART WITHOUT THE EXPRESS WRITTEN PERMISSION OF TOMKINSON GROUP INFRINGES COPYRIGHT



**ESTUARY II - NORTH  
 ASH ROAD, LEOPOLD  
 SALES PLAN  
 LOT LEVELS - RELEASE 18B**  
 AUTHORITY: CITY OF GREATER GEELONG  
 CLIENT: ASH ROAD LEOPOLD PTY LTD

DWG STATUS: PROJECT & DWG No: **PRELIMINARY A401D-SP310**

NOTE: THIS IS AN UNCONTROLLED DOCUMENT AND WILL NOT BE UPDATED. IT IS THE RESPONSIBILITY OF THE USER TO CONFIRM THAT THIS IS A CURRENT COPY AND SUITABLE FOR THE PROPOSED USE. THIS SHEET MUST BE READ IN CONJUNCTION WITH ALL SHEETS OF THIS SET AND ANY ACCOMPANYING DOCUMENTS. PLOT DATE: 23/06/2022 FILE: C:\112D\DATA\TOMKINSON\18B\ENGINEERING\CAD\CURRENT\MARKETING\RELEASE\_18A401D-SP310 (RELEASE\_18B).DWG

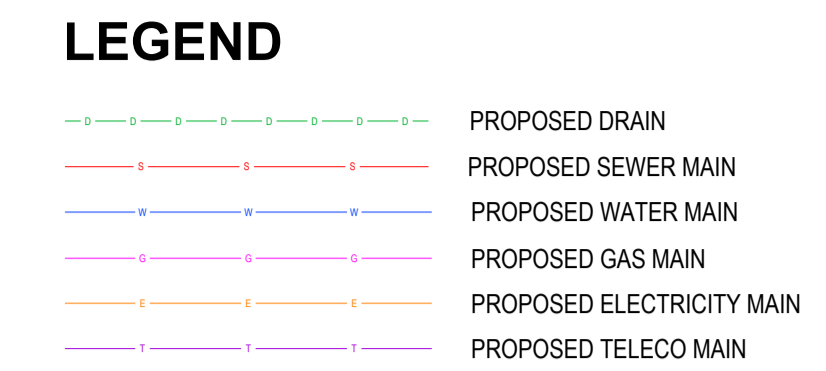

NOTES:

- LEVELS AND PROPERTY SERVICE CONNECTIONS ARE SUBJECT TO DETAILED DESIGN.
- FILL LEVELS 300mm AND ABOVE REQUIRE LEVEL 1 SUPERVISION.

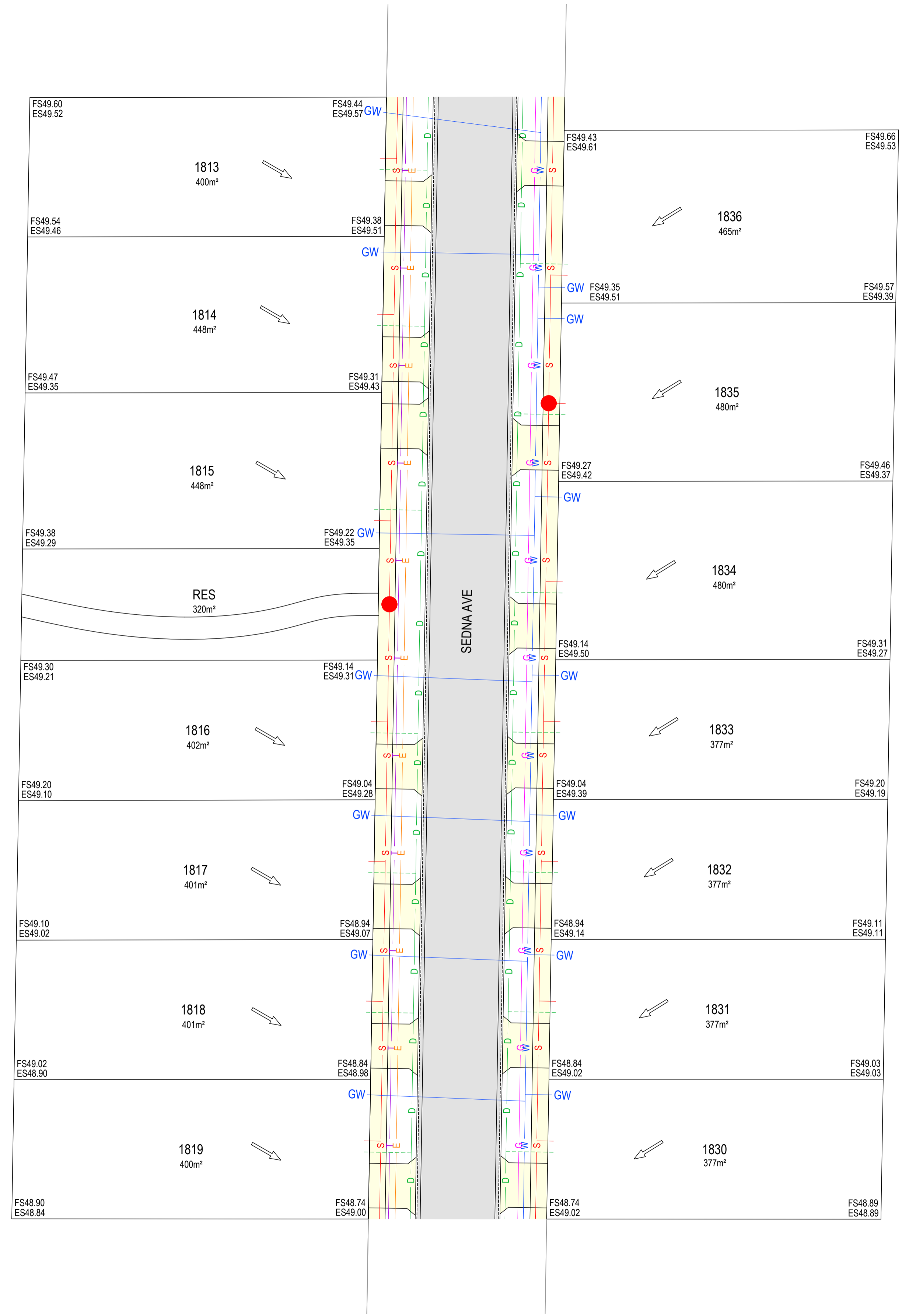

C	LOT 1836 DRIVEWAY RELOCATED TO THE NORTH	MM	PW	MM	24/06/22
B	LOT 1815 DRIVEWAY RELOCATED TO THE NORTH	MM	PW	MM	05/05/22
A	PRELIMINARY ISSUE	MM	PW	MM	31/03/22
REV		DES	DWG	CHK	DATE



**Tomkinson**  
SURVEY • ENGINEERING • PLANNING • PROJECT MANAGEMENT

12/99-101 WESTERN AVENUE, WESTMEADOWS PH 03 8746 9988  
ABN 11 103 336 358 WWW.TOMKINSON.COM

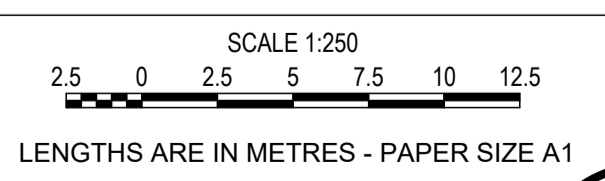

© COPYRIGHT  
THE INFORMATION CONTAINED ON THIS DRAWING IS THE INTELLECTUAL PROPERTY OF TOMKINSON GROUP. COPYING OR USING THIS DRAWING IN WHOLE OR IN PART WITHOUT THE EXPRESS WRITTEN PERMISSION OF TOMKINSON GROUP INFRINGES COPYRIGHT.



**ESTUARY II - NORTH  
ASH ROAD, LEOPOLD  
FUNCTIONAL PLAN  
LAYOUT PLAN - RELEASE 18B**

AUTHORITY: CITY OF GREATER GEELONG  
CLIENT: ASH ROAD LEOPOLD PTY LTD

DWG STATUS: PROJECT & DWG No: **PRELIMINARY** A4041D-FP310

NOTE: THIS IS AN UNCONTROLLED DOCUMENT AND WILL NOT BE UPDATED. IT IS THE RESPONSIBILITY OF THE USER TO CONFIRM THAT THIS IS A CURRENT COPY AND SUITABLE FOR THE PROPOSED USE. THIS SHEET MUST BE READ IN CONJUNCTION WITH ALL SHEETS OF THIS SET AND ANY ACCOMPANYING DOCUMENTS. PLOT DATE: 24/06/2022 FILE: C:\112\DATA\TOMKINSON\860-42\DS01\44041 - ASH ROAD, LEOPOLD C - VILLAWOOD BENDIGO, LEOPOLD - 986\ENGINEERING\CAD\CURRENT\MARKETING\RELEASE\_18\A4041D-FP310 (RELEASE 18B).DWG