

GREATER GEELONG CITY COUNCIL
PLANNING & ENVIRONMENT ACT 1987
GREATER GEELONG PLANNING SCHEME
 Endorsed Plan referred to in Permit No. 4961202/H
 STAGE 25 BUILDING ENVELOPES PGS 1-15
 Signed Date 15/4/19
 FOR AND ON BEHALF OF THE GREATER GEELONG
 CITY COUNCIL AS RESPONSIBLE AUTHORITY
NOTE: THIS IS NOT A BUILDING APPROVAL



MGA ZONE 55

KEY SHEET 1
 REFER TO SHEETS
 1 TO 13
 FOR DETAIL

ARMSTRONG Mt DUNEED
 BUILDING ENVELOPE PLAN
 STAGE 25

August 2018
 Version:G

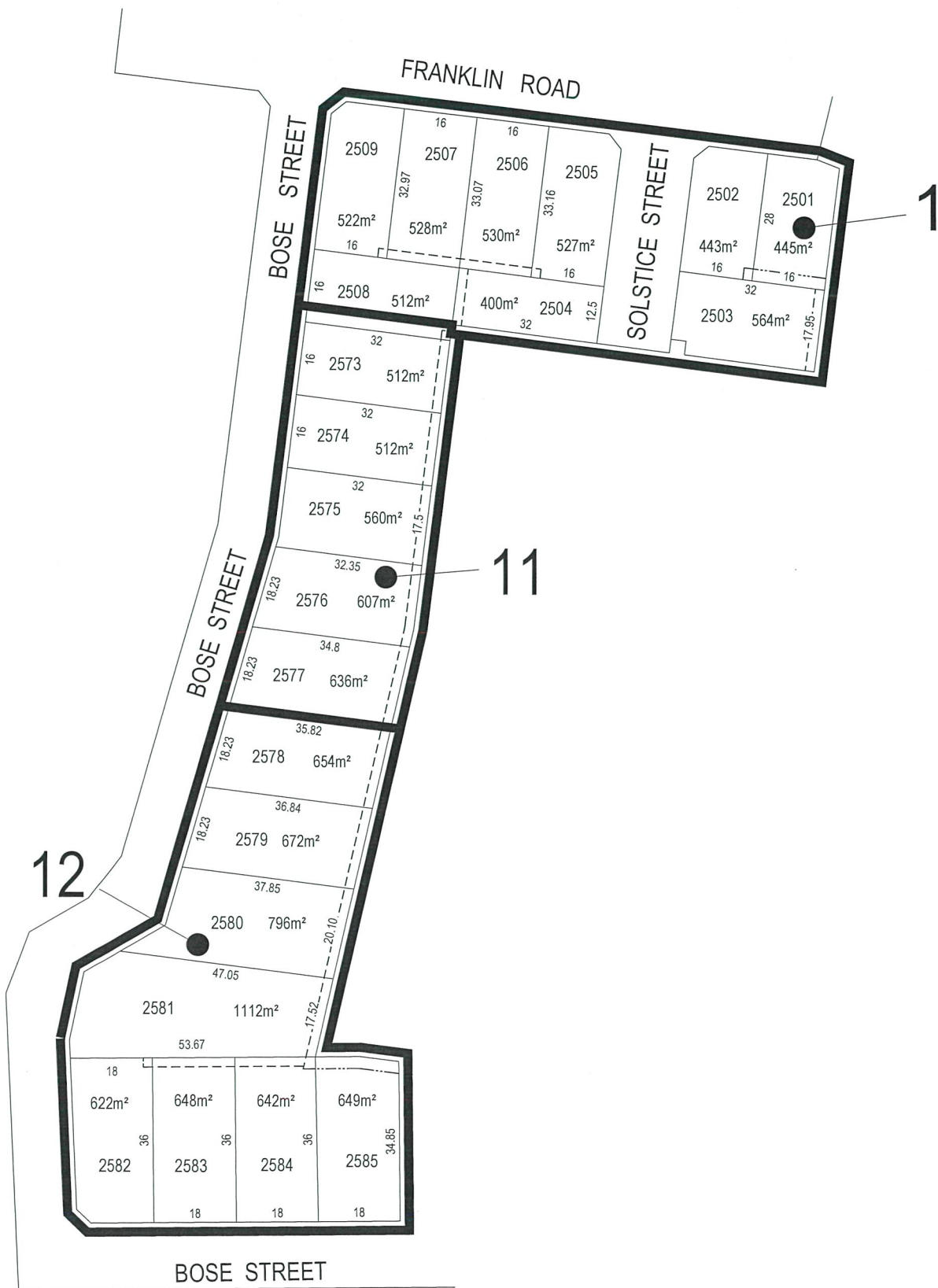

MGA ZONE 55

KEY SHEET 2

REFER TO SHEETS
1 TO 13
FOR DETAIL



ARMSTRONG Mt DUNEED

BUILDING ENVELOPE PLAN
STAGE 25

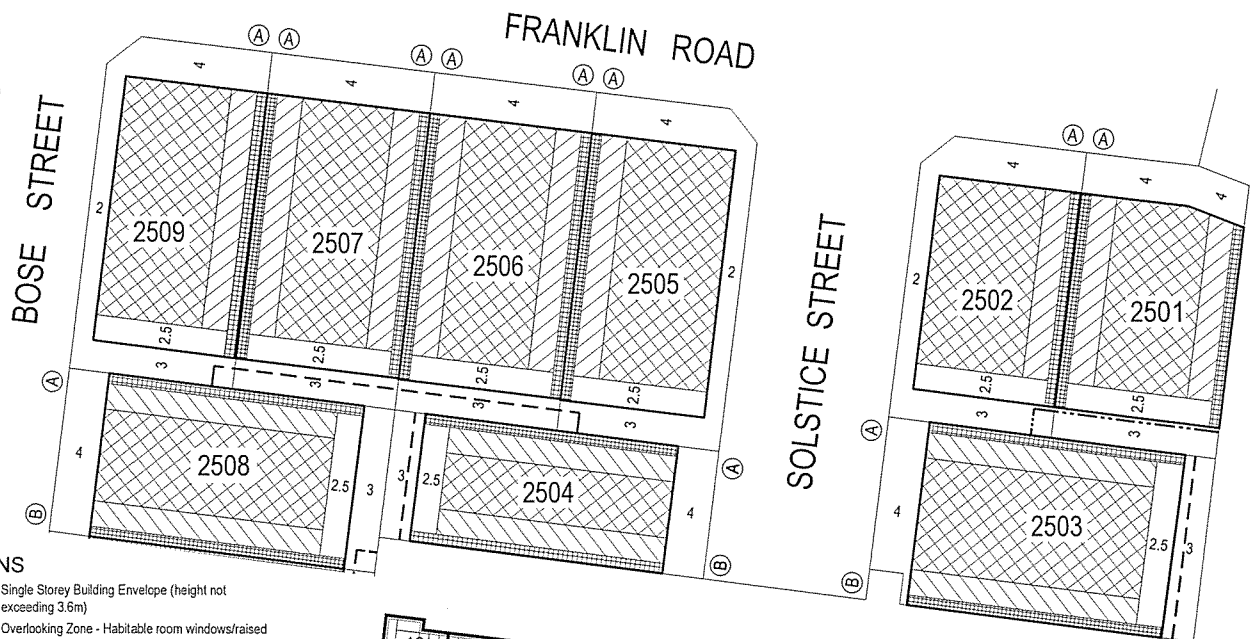
August 2018
Version:G

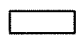
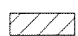

NOTATIONS

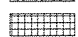
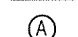
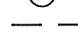
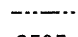
-  Single Storey Building Envelope (height not exceeding 3.6m)
-  Overlooking Zone - Habitable room windows/raised open spaces are a source of overlooking
-  Non Overlooking Zone - Habitable room windows/raised open spaces are not a source of overlooking
-  Building to Boundary Zone
-  Building Envelope Boundary Profile Type
-  2 metre wide easement
-  3 metre wide easement
- 2505** Lot number
- 3** Setback minimum required (if 0, a building can be constructed on the boundary provided that the building height and length requirements are met)

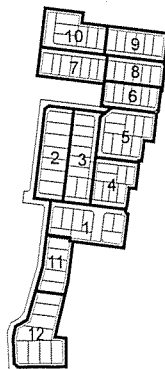

KEY TO SHEETS

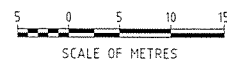

This Building Envelope Plan is to be read in conjunction with the associated Building Envelope Profiles and Design Guidelines.

The registered proprietor/s of the lot are required to build in accordance with building envelopes shown hereon and in the "Profile Diagrams" in sheet 13.

Detailed design of roads, driveways and footpaths is provided in the relevant Engineering Plans.

Detailed design of landscape works is provided in the relevant Landscape Plans.

All details subject to City of Greater Geelong Council approval.

ARMSTRONG Mt DUNEED

BUILDING ENVELOPE PLAN
STAGE 25

25/1
stage sheet

Sheet 1 of 13

August 2018
Version G



PASCAL CRESCENT

PASCAL CRESCENT

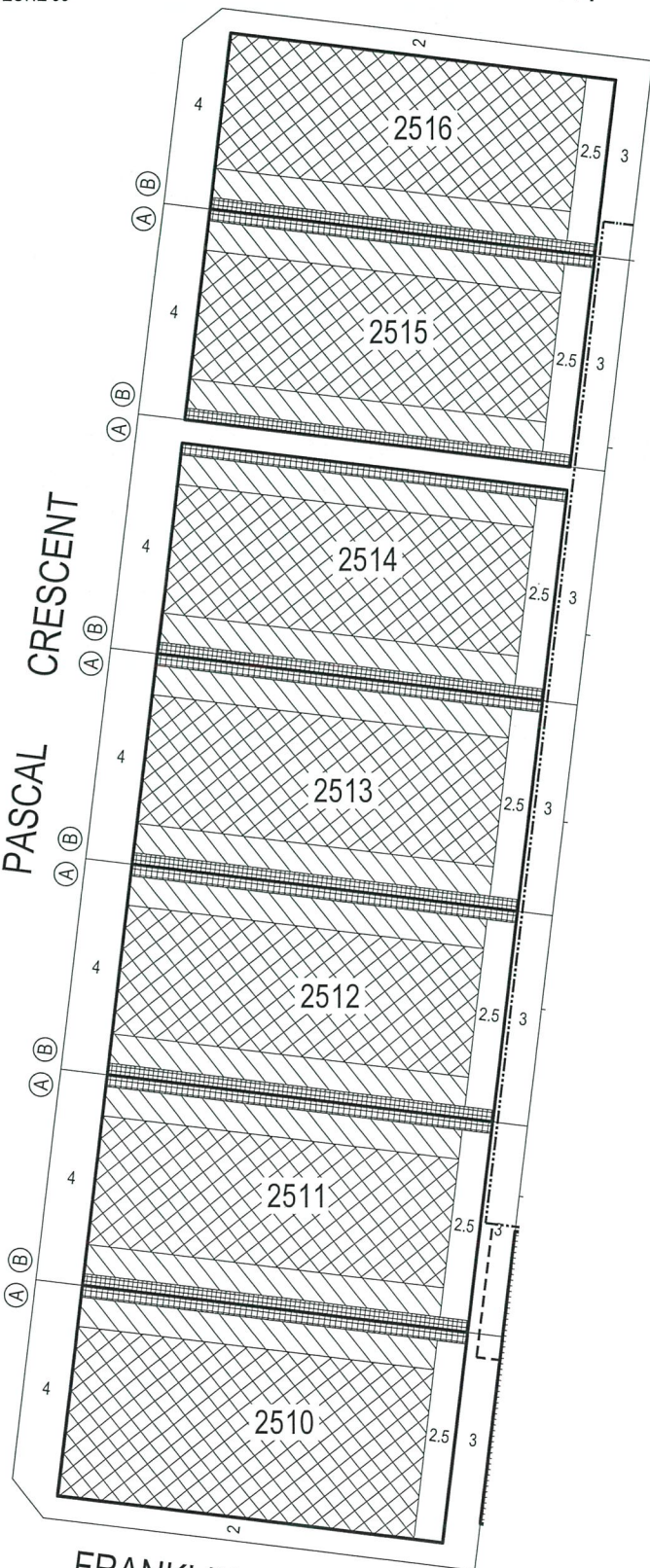

FRANKLIN ROAD



NOTATIONS

	Single Storey Building Envelope (height not exceeding 3.6m)
	Overlooking Zone - Habitable room windows/raised open spaces are a source of overlooking
	Non Overlooking Zone - Habitable room windows/raised open spaces are not a source of overlooking
	Building to Boundary Zone)
	Building Envelope Boundary Profile Type
	2 metre wide easement
	3 metre wide easement
2505	Lot number
3	Setback minimum required (if 0, a building can be constructed on the boundary provided that the building height and length requirements are met)

This Building Envelope Plan is to be read in conjunction with the associated Building Envelope Profiles and Design Guidelines.

The registered proprietor/s of the lot are required to build in accordance with building envelopes shown hereon and in the "Profile Diagrams" in sheet 13.

Detailed design of roads, driveways and footpaths is provided in the relevant Engineering Plans.

Detailed design of landscape works is provided in the relevant Landscape Plans.

All details subject to City of Greater Geelong Council approval.

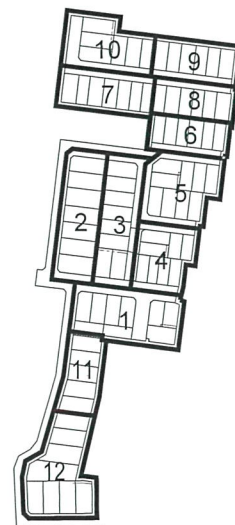

KEY TO SHEETS

ARMSTRONG Mt DUNEED

BUILDING ENVELOPE PLAN
STAGE 25

25 / 2
stage sheet

Sheet 2 of 13

August 2018
Version:G



PASCAL CRESCENT

NOTATIONS



Single Storey Building Envelope (height not exceeding 3.6m)



Overlooking Zone - Habitable room windows/raised open spaces are a source of overlooking



Non Overlooking Zone - Habitable room windows/raised open spaces are not a source of overlooking



Building to Boundary Zone)



Building Envelope Boundary Profile Type

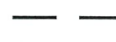

2 metre wide easement

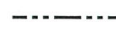

3 metre wide easement

2505

Lot number

3

Setback minimum required (if 0, a building can be constructed on the boundary provided that the building height and length requirements are met)

This Building Envelope Plan is to be read in conjunction with the associated Building Envelope Profiles and Design Guidelines.

The registered proprietor/s of the lot are required to build in accordance with building envelopes shown hereon and in the "Profile Diagrams" in sheet 13.

Detailed design of roads, driveways and footpaths is provided in the relevant Engineering Plans.

Detailed design of landscape works is provided in the relevant Landscape Plans.

All details subject to City of Greater Geelong Council approval.

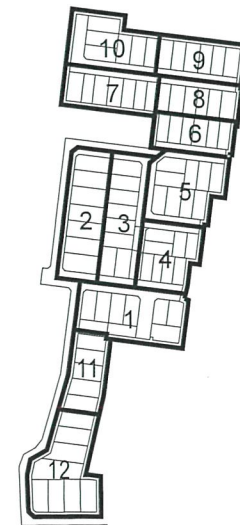
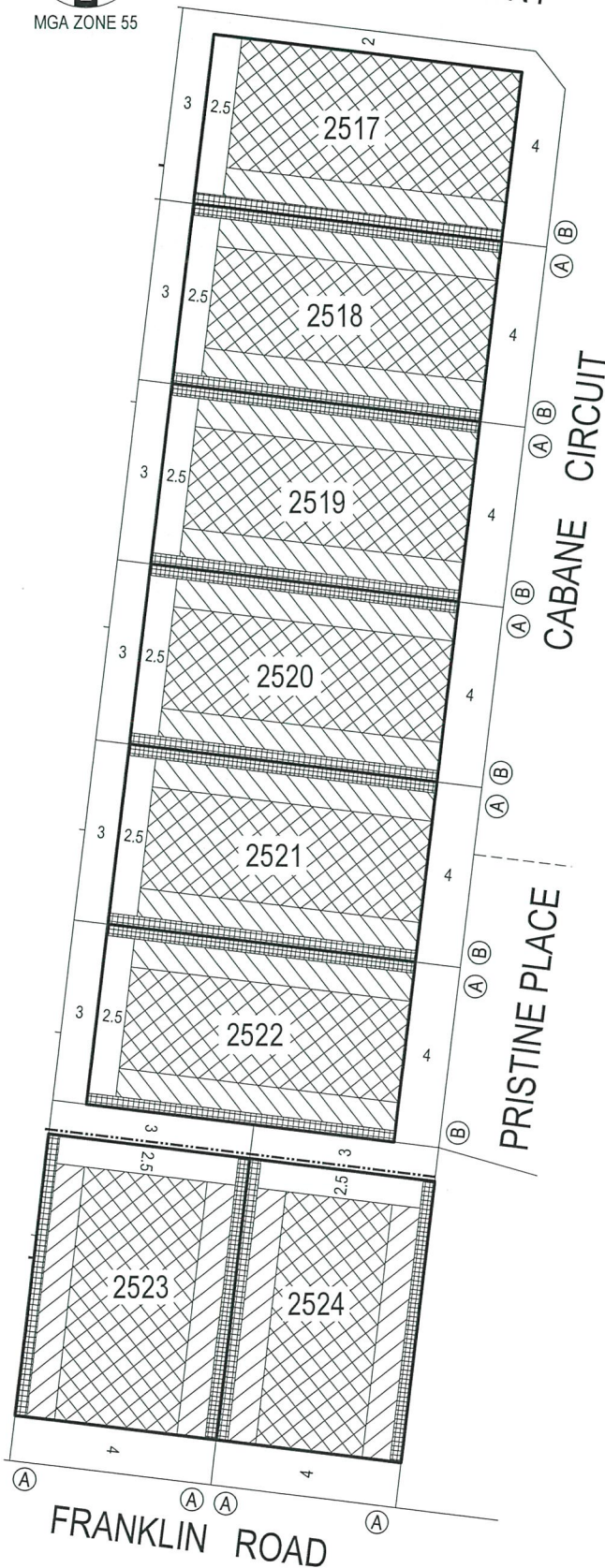

KEY TO SHEETS

ARMSTRONG Mt DUNEED

BUILDING ENVELOPE PLAN
STAGE 25

25 / 3

stage sheet

Sheet 3 of 13

August 2018
Version:G



SCALE OF METRES



NOTATIONS

- Single Storey Building Envelope (height not exceeding 3.6m)
- Overlooking Zone - Habitable room windows/raised open spaces are a source of overlooking
- Non Overlooking Zone - Habitable room windows/raised open spaces are not a source of overlooking
- Building to Boundary Zone

- Building Envelope Boundary Profile Type
- 2 metre wide easement
- 3 metre wide easement

- 2505 Lot number
- 3 Setback minimum required (if 0, a building can be constructed on the boundary provided that the building height and length requirements are met)

This Building Envelope Plan is to be read in conjunction with the associated Building Envelope Profiles and Design Guidelines.
The registered proprietor/s of the lot are required to build in accordance with building envelopes shown hereon and in the "Profile Diagrams" in sheet 13.
Detailed design of roads, driveways and footpaths is provided in the relevant Engineering Plans.
Detailed design of landscape works is provided in the relevant Landscape Plans.
All details subject to City of Greater Geelong Council approval.

ARMSTRONG Mt DUNEED BUILDING ENVELOPE PLAN STAGE 25

25/4
stage sheet

Sheet 4 of 13 August 2018 Version G

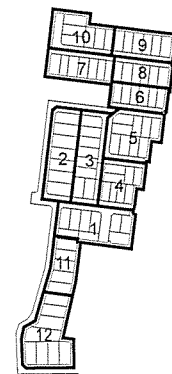

KEY TO SHEETS

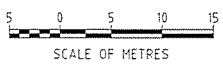
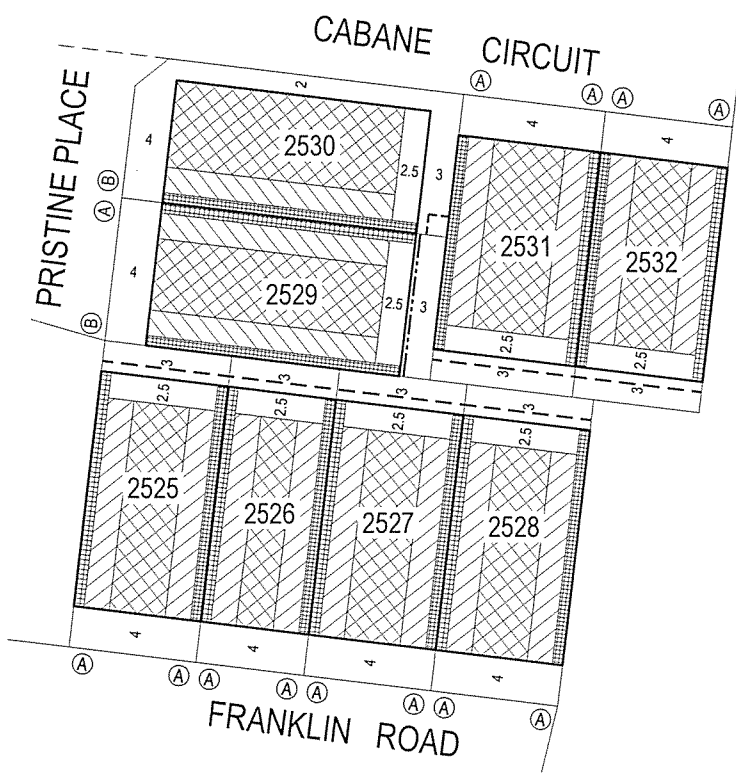



NOTATIONS

	Single Storey Building Envelope (height not exceeding 3.6m)
	Overlooking Zone - Habitable room windows/raised open spaces are a source of overlooking
	Non Overlooking Zone - Habitable room windows/raised open spaces are not a source of overlooking
	Building to Boundary Zone

	Building Envelope Boundary Profile Type
	2 metre wide easement
	3 metre wide easement
2505	Lot number
3	Setback minimum required (if 0, a building can be constructed on the boundary provided that the building height and length requirements are met)

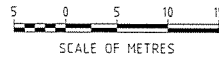
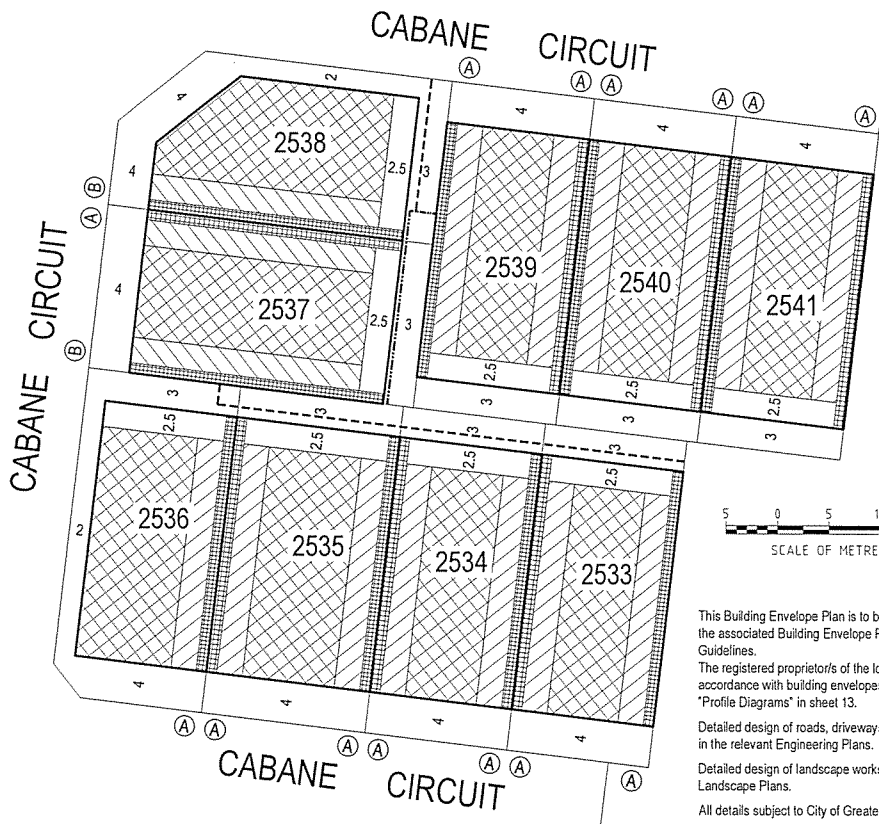

This Building Envelope Plan is to be read in conjunction with the associated Building Envelope Profiles and Design Guidelines.
The registered proprietor/s of the lot are required to build in accordance with building envelopes shown hereon and in the "Profile Diagrams" in sheet 13.
Detailed design of roads, driveways and footpaths is provided in the relevant Engineering Plans.
Detailed design of landscape works is provided in the relevant Landscape Plans.
All details subject to City of Greater Geelong Council approval.

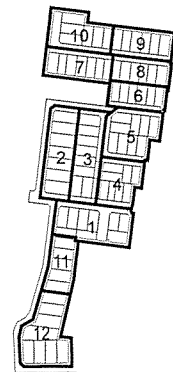

KEY TO SHEETS

ARMSTRONG Mt DUNEED
BUILDING ENVELOPE PLAN
STAGE 25

25/5
stage sheet

Sheet 5 of 13 August 2018 Version G

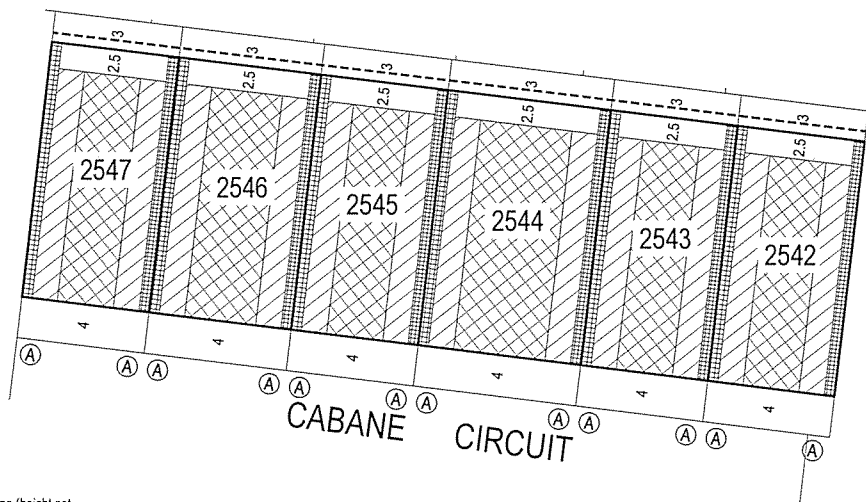

NOTATIONS

- Single Storey Building Envelope (height not exceeding 3.6m)
- Overlooking Zone - Habitable room windows/raised open spaces are a source of overlooking
- Non Overlooking Zone - Habitable room windows/raised open spaces are not a source of overlooking
- Building to Boundary Zone
- Building Envelope Boundary Profile Type
- 2 metre wide easement
- 3 metre wide easement
- 2505 Lot number
- 3 Setback minimum required (if 0, a building can be constructed on the boundary provided that the building height and length requirements are met)

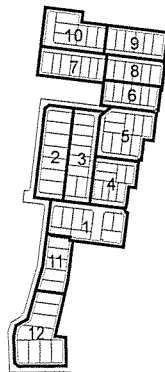

KEY TO SHEETS

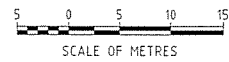

This Building Envelope Plan is to be read in conjunction with the associated Building Envelope Profiles and Design Guidelines.
The registered proprietor/s of the lot are required to build in accordance with building envelopes shown hereon and in the "Profile Diagrams" in sheet 13.
Detailed design of roads, driveways and footpaths is provided in the relevant Engineering Plans.
Detailed design of landscape works is provided in the relevant Landscape Plans.
All details subject to City of Greater Geelong Council approval.

ARMSTRONG Mt DUNEED
BUILDING ENVELOPE PLAN
STAGE 25

25/6
stage sheet

Sheet 6 of 13 August 2018 Version G

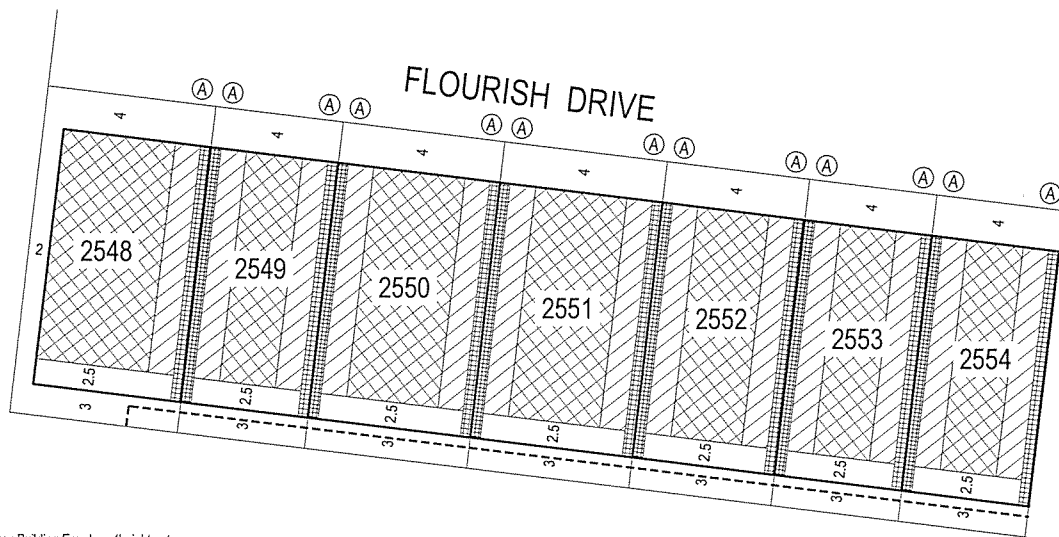

NOTATIONS

- Single Storey Building Envelope (height not exceeding 3.6m)
- Overlooking Zone - Habitable room windows/raised open spaces are a source of overlooking
- Non Overlooking Zone - Habitable room windows/raised open spaces are not a source of overlooking
- Building to Boundary Zone
- Building Envelope Boundary Profile Type
- 2 metre wide easement
- 3 metre wide easement
- 2505 Lot number
- 3 Setback minimum required (if 0, a building can be constructed on the boundary provided that the building height and length requirements are met)

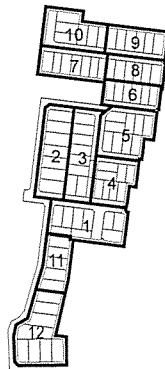

KEY TO SHEETS

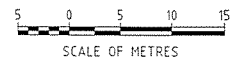

This Building Envelope Plan is to be read in conjunction with the associated Building Envelope Profiles and Design Guidelines.
The registered proprietor/s of the lot are required to build in accordance with building envelopes shown hereon and in the "Profile Diagrams" in sheet 13.
Detailed design of roads, driveways and footpaths is provided in the relevant Engineering Plans.
Detailed design of landscape works is provided in the relevant Landscape Plans.
All details subject to City of Greater Geelong Council approval.

ARMSTRONG Mt DUNEED BUILDING ENVELOPE PLAN STAGE 25

25/7
stage sheet

Sheet 7 of 13 August 2018 Version G

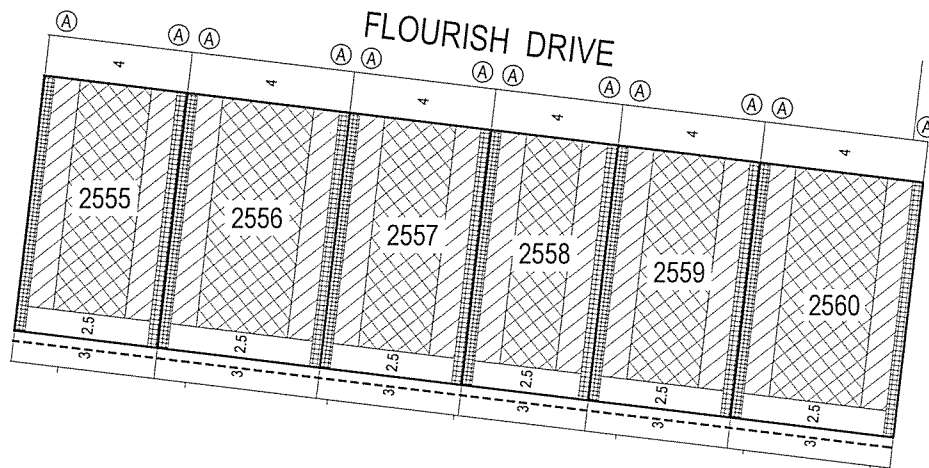

NOTATIONS

- Single Storey Building Envelope (height not exceeding 3.6m)
- Overlooking Zone - Habitable room windows/raised open spaces are a source of overlooking
- Non Overlooking Zone - Habitable room windows/raised open spaces are not a source of overlooking
- Building to Boundary Zone
- Building Envelope Boundary Profile Type
- 2 metre wide easement
- 3 metre wide easement
- 2505 Lot number
- 3 Setback minimum required (if 0, a building can be constructed on the boundary provided that the building height and length requirements are met)

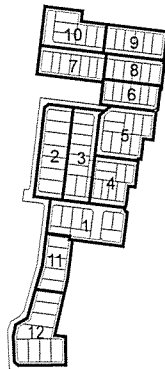

KEY TO SHEETS

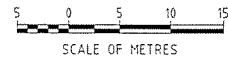

This Building Envelope Plan is to be read in conjunction with the associated Building Envelope Profiles and Design Guidelines.

The registered proprietor/s of the lot are required to build in accordance with building envelopes shown hereon and in the "Profile Diagrams" in sheet 13.

Detailed design of roads, driveways and footpaths is provided in the relevant Engineering Plans.

Detailed design of landscape works is provided in the relevant Landscape Plans.

All details subject to City of Greater Geelong Council approval.

ARMSTRONG Mt DUNEED

BUILDING ENVELOPE PLAN
STAGE 25

25/8
stage sheet

Sheet 8 of 13

August 2018
Version G

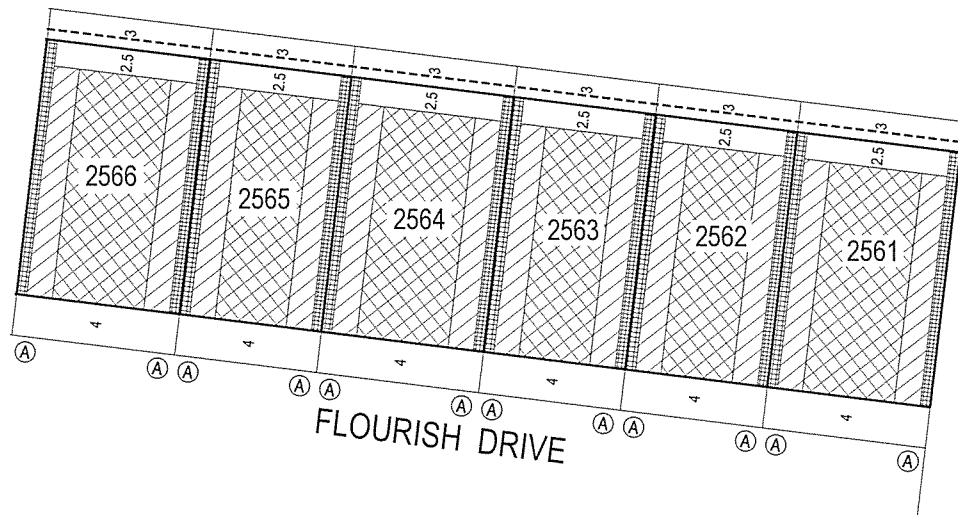

NOTATIONS

- Single Storey Building Envelope (height not exceeding 3.6m)
- Overlooking Zone - Habitable room windows/raised open spaces are a source of overlooking
- Non Overlooking Zone - Habitable room windows/raised open spaces are not a source of overlooking
- Building to Boundary Zone
- Building Envelope Boundary Profile Type
- 2 metre wide easement
- 3 metre wide easement
- 2505** Lot number
- 3** Setback minimum required (if 0, a building can be constructed on the boundary provided that the building height and length requirements are met)

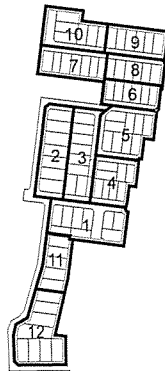

KEY TO SHEETS

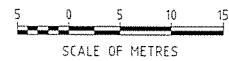

This Building Envelope Plan is to be read in conjunction with the associated Building Envelope Profiles and Design Guidelines.

The registered proprietor/s of the lot are required to build in accordance with building envelopes shown hereon and in the "Profile Diagrams" in sheet 13.

Detailed design of roads, driveways and footpaths is provided in the relevant Engineering Plans.

Detailed design of landscape works is provided in the relevant Landscape Plans.

All details subject to City of Greater Geelong Council approval.

ARMSTRONG Mt DUNEED

BUILDING ENVELOPE PLAN
STAGE 25

25/9
stage sheet

Sheet 9 of 13

August 2018
Version G



MGA ZONE 55

NOTATIONS



Single Storey Building Envelope (height not exceeding 3.6m)



Overlooking Zone - Habitable room windows/raised open spaces are a source of overlooking



Non Overlooking Zone - Habitable room windows/raised open spaces are not a source of overlooking



Building to Boundary Zone)



Building Envelope Boundary Profile Type



2 metre wide easement



3 metre wide easement

2505

Lot number

3

Setback minimum required (if 0, a building can be constructed on the boundary provided that the building height and length requirements are met)

This Building Envelope Plan is to be read in conjunction with the associated Building Envelope Profiles and Design Guidelines.

The registered proprietor/s of the lot are required to build in accordance with building envelopes shown hereon and in the "Profile Diagrams" in sheet 13.

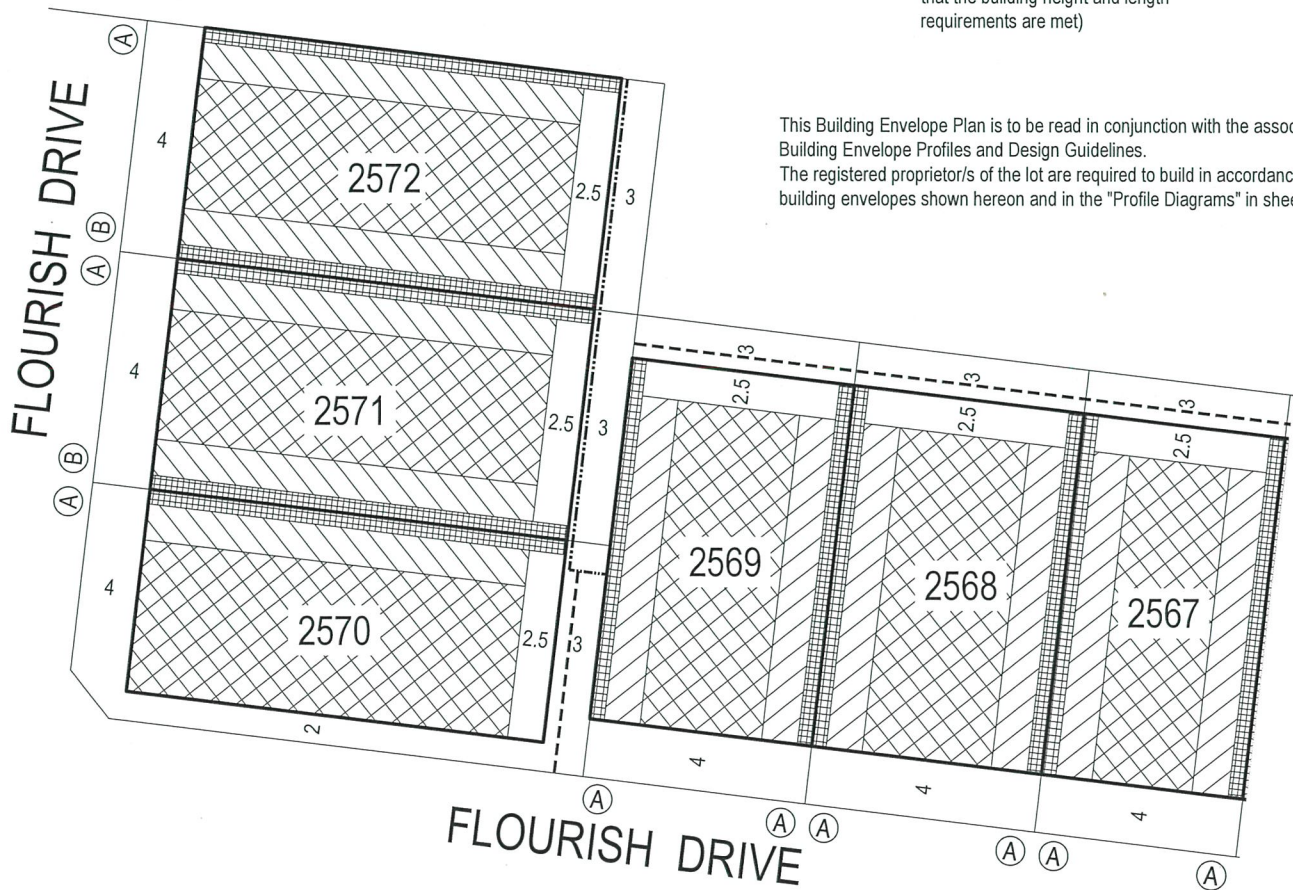

ARMSTRONG Mt DUNED

BUILDING ENVELOPE PLAN
STAGE 25

25/10

stage sheet

Sheet 10 of 13

August 2018
Version:G

Detailed design of roads, driveways and footpaths is provided in the relevant Engineering Plans.

Detailed design of landscape works is provided in the relevant Landscape Plans.

All details subject to City of Greater Geelong Council approval.

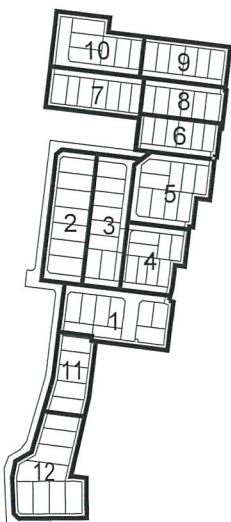

KEY TO SHEETS

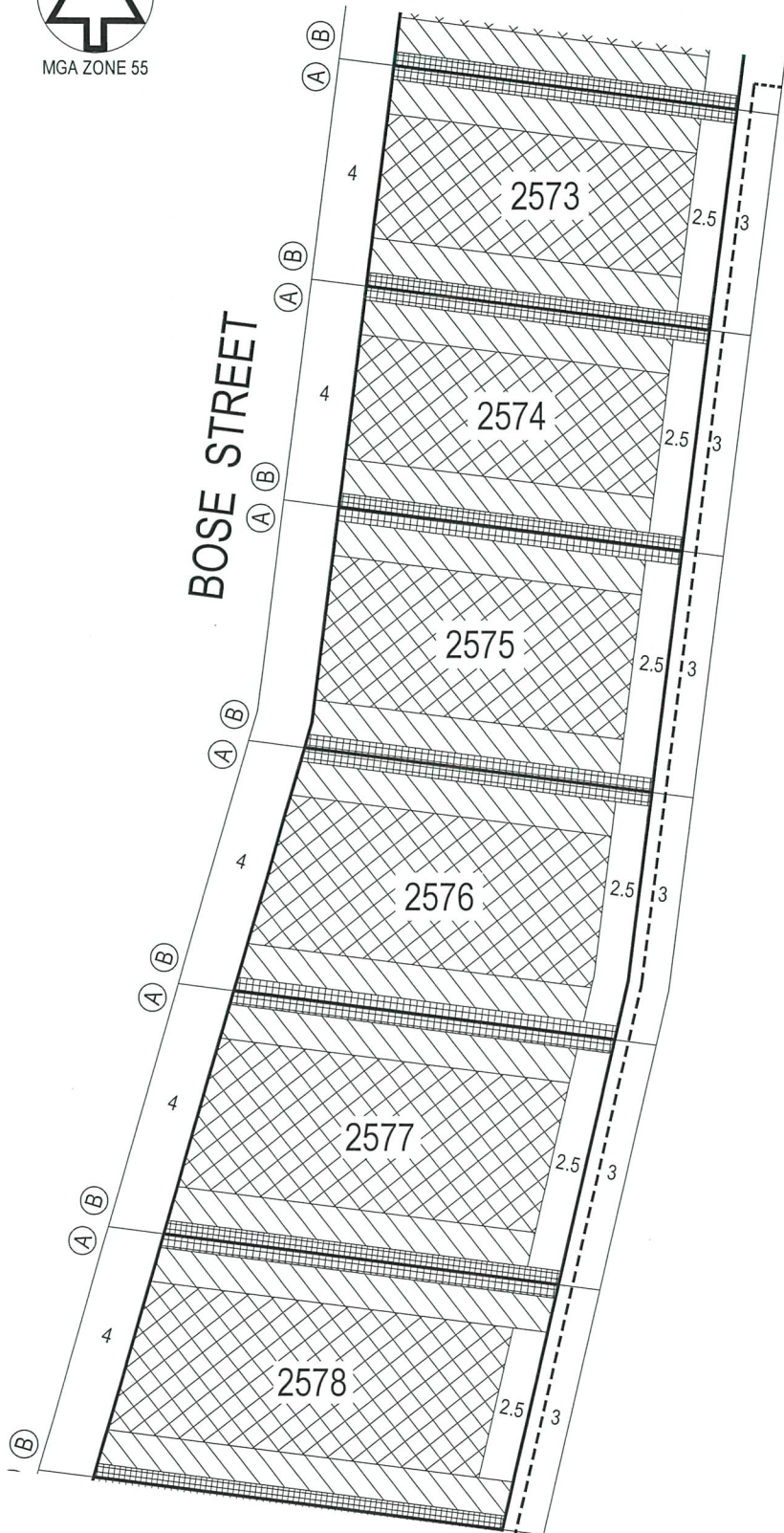

NOTATIONS

- Single Storey Building Envelope (height not exceeding 3.6m)
- Overlooking Zone - Habitable room windows/raised open spaces are a source of overlooking
- Non Overlooking Zone - Habitable room windows/raised open spaces are not a source of overlooking
- Building to Boundary Zone)

(A) Building Envelope Boundary Profile Type

— 2 metre wide easement

- - - 3 metre wide easement

2505

Lot number

3

Setback minimum required (if 0, a building can be constructed on the boundary provided that the building height and length requirements are met)

This Building Envelope Plan is to be read in conjunction with the associated Building Envelope Profiles and Design Guidelines.

The registered proprietor/s of the lot are required to build in accordance with building envelopes shown hereon and in the "Profile Diagrams" in sheet 13.

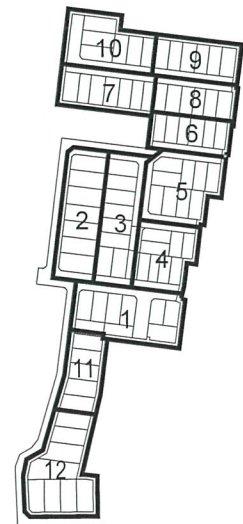

KEY TO SHEETS

ARMSTRONG Mt DUNED

BUILDING ENVELOPE PLAN
STAGE 25

25/11

stage

sheet

Sheet 11 of 13

August 2018
Version:G







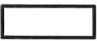

Detailed design of roads, driveways and footpaths is provided in the relevant Engineering Plans.

Detailed design of landscape works is provided in the relevant Landscape Plans.

All details subject to City of Greater Geelong Council approval.

NOTATIONS

- Single Storey Building Envelope (height not exceeding 3.6m)
- Overlooking Zone - Habitable room windows/raised open spaces are a source of overlooking
- Non Overlooking Zone - Habitable room windows/raised open spaces are not a source of overlooking
- Building to Boundary Zone)
- Building Envelope Boundary Profile Type
- 2 metre wide easement
- 3 metre wide easement
- 2505

3
- Lot number
- Setback minimum required (if 0, a building can be constructed on the boundary provided that the building height and length requirements are met)

This Building Envelope Plan is to be read in conjunction with the associated Building Envelope Profiles and Design Guidelines. The registered proprietor/s of the lot are required to build in accordance with building envelopes shown hereon and in the "Profile Diagrams" in sheet 13.

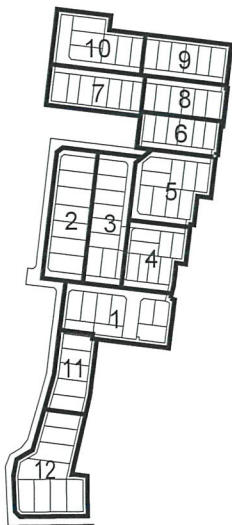
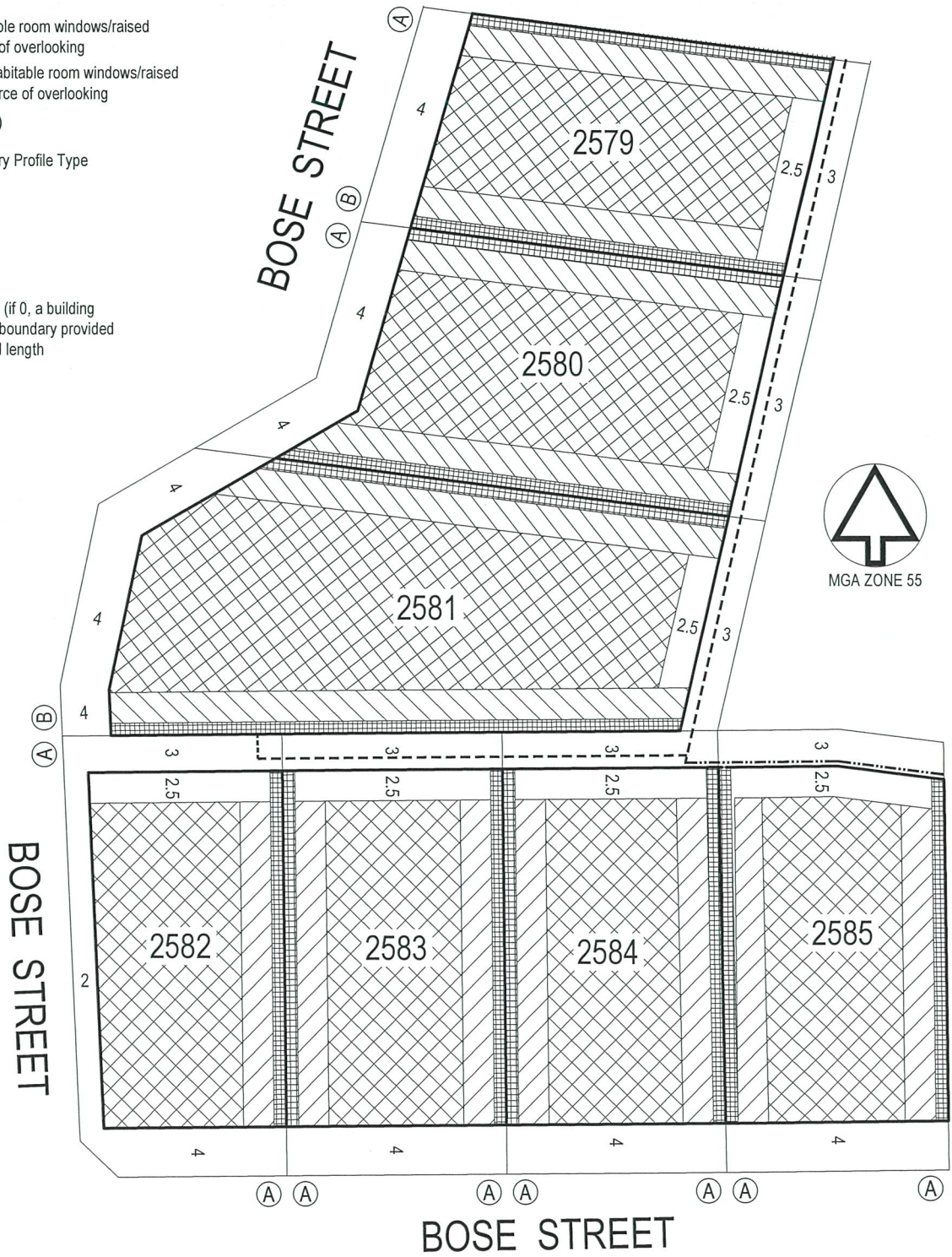

KEY TO SHEETS



ARMSTRONG Mt DUNED

BUILDING ENVELOPE PLAN
STAGE 25

25/12
stage sheet

Detailed design of roads, driveways and footpaths is provided in the relevant Engineering Plans.

Detailed design of landscape works is provided in the relevant Landscape Plans.

All details subject to City of Greater Geelong Council approval.

Sheet 12 of 13

August 2018
Version:G

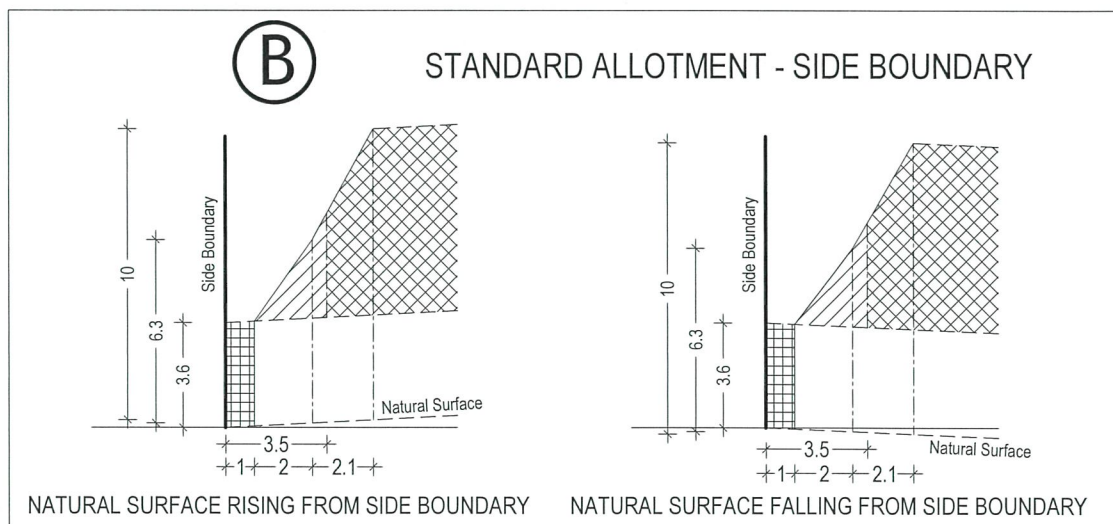
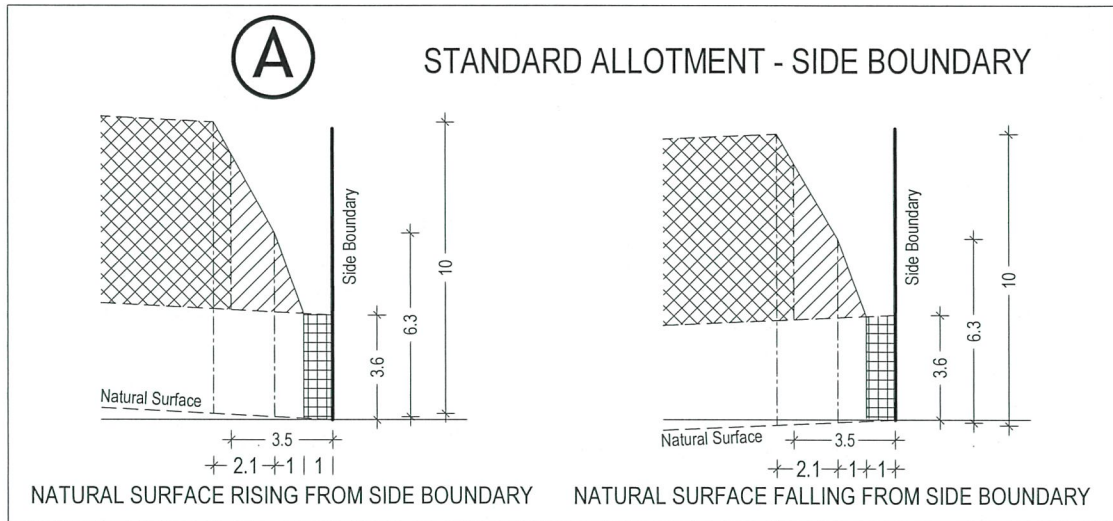

ARMSTRONG Mt DUNEED

BUILDING ENVELOPE PROFILES
STAGE 25

25/13
stage sheet

 Single Storey Building Envelope

 Overlooking Zone
Habitable room windows/raised open spaces are a source of overlooking

 Non Overlooking Zone
Habitable room windows/raised open spaces are not a source of overlooking

 Building to Boundary Zone

sheet 13 of 13

August 2018
Version:G