

FOR CONTINUATION REFER TO INSET

PROPOSED CLYDE SPRINGS ESTATE - STAGE 7

FUTURE STAGE 17B

FUTURE STAGE 17B

RESERVE

FUTURE STAGE 17B

EXISTING STAGE 15
PLAN
SCALE 1:500
SCALE 1 : 500
LENGTHS ARE IN METRES

SYMBOL LEGEND

Prop Exist
Drains
Sewer <300
Sewer >300
Water
House Drain
Property Inlet
Street Sign
PSM
Retaining Wall
Conduits 50mm
Conduits 100mm
Ex Gas/Elect/Tel

Ex/Natural/FS Level 28.51
FS @ Building Line 28.51
Top/Toe of Batter 28.51
Top Ret. Wall Level 28.51
100yr Flood Level 28.51
Fill Prop/Ex
Cut Prop/Ex

AMENDMENTS

VER DATE

REMARKS

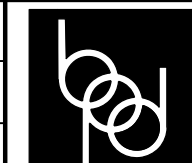

MELWAY REF. 135-B-5
SURVEY BPD
DESIGN GL
DRAWN GL

breese pitt dixon pty. ltd.
land surveyors
1/19 coto street
hawthorn east, 3123
telephone 8823 2300
fax no. 8823 2310
civil engineers

DELARAY ESTATE
STAGE 17

MUNICIPALITY
CASEY
REFERENCE
8974 E/17
SHEET 1 OF 14

SERVICES OFFSETS AND LOCATIONS

STREET NAME	Rd RESERVE	WATER		GAS	ELECTRICITY		FIBRE TO THE HOME		Bk. of KERB	JOINT TRENCHING	VICCODE STREET CLASSIFICATION
		DW	NDW		CABLES	POLES	FTTH CABLES	FTTH PITS			
DOMINGO AVENUE	16-00	3-20 E	2-70 E	2-25 E	2-55 W	1-00 POLES	1-85 W	1-78 E	4-35 E 4-05 W	G & W, FTTH & E	STREET - LEVEL 1
AZZAM STREET (LOTS 1701-1702)	13-00	2-70 N	2-25 N	1-80 N	1-33 S	0-90 BOX	0-50 S	1-20 #	4-35 S 4-05 N	G & W, FTTH & E	STREET - LEVEL 1
AZZAM STREET (LOTS 1775-1776)	16-00	2-70 S	2-20 S	1-80 S	2-55 N	1-00 BOX	1-85 N	1-20 S #	4-35 S 4-05 N	G & W, FTTH & E	STREET - LEVEL 1
KHAN BOULEVARD	20-00	3-20 E	2-70 E	2-25 E	2-55 W	1-00 BOX	1-85 W	1-78 E	4-35 S 4-05 N	G & W, FTTH & E	STREET - LEVEL 1
SUTIL DRIVE (LOTS 1721-1724)	16-00	2-85 N	2-35 N	1-90 N	2-55 S	1-00 BOX	1-85 S	1-20 N #	4-35 N 4-05 S	G & W, FTTH & E	STREET - LEVEL 1
SUTIL DRIVE (EAST)	16-00	2-85 W	2-35 W	1-90 W	2-55 E	1-00 BOX	1-85 E	1-20 W #	4-35 W 4-05 E	G & W, FTTH & E	STREET - LEVEL 1
HACIENDA LANE	8-00	-	-	-	2-10 E	0-80 BOX	-	-	1-00 E 0-00 W	G & W, FTTH & E	ACCESS LANE
PANILLO WALK	4-50	2-75 W	2-30 W	1-85 W	-	0-80 BOX	3-25 W	3-25 W	-	G & W, FTTH & E	ACCESS WALKWAY

DENOTES PIT IS LOCATED IN FOOTPATH

WARNING
BEWARE OF UNDERGROUND SERVICES
THE LOCATIONS OF UNDERGROUND SERVICES ARE APPROXIMATE ONLY AND THEIR EXACT POSITION SHOULD BE PROVEN ON SITE. NO GUARANTEE IS GIVEN THAT ALL EXISTING SERVICES ARE SHOWN.

ATTENTION TO CONTRACTOR

- IT IS THE CONTRACTORS RESPONSIBILITY TO ENSURE THAT THE DIGITAL PLAN, PROVIDED FOR SETOUT PURPOSES, MATCHES THE TBM COORDINATES SHOWN.
- Contractor to ensure that the site is pegged and or set out checked by the licenced surveyor responsible for certifying the Plan of Subdivision prior to underground infrastructure being installed.
- Where concrete works about a sewer access chamber surround or similar structure, an expansion joint of approved material shall be provided between the two faces.

LOCALITY PLAN

NTS
MELWAYS: 135 C5

SHEET INDEX

SHT No.	VER	DESCRIPTION
1	P3	DETAIL PLAN, SERVICES SCHEDULE & SHEET INDEX
2	P3	NOTES, PAVEMENT DETAILS, TYPICAL SECTIONS
3	P3	INTERSECTION DETAILS - SHEET 1
4	P3	INTERSECTION DETAILS - SHEET 2
5	P3	KHAN BOULEVARD - LONGITUDINAL & CROSS SECTIONS
6	P3	KHAN BOULEVARD - CROSS SECTIONS
7	P3	AZZAM STREET - LONGITUDINAL & CROSS SECTIONS
8	P3	SUTIL DRIVE - LONGITUDINAL & CROSS SECTIONS
9	P3	DOMINGO AVENUE - LONGITUDINAL & CROSS SECTIONS
10	P3	DRAINAGE LONGITUDINAL SECTIONS
11	P3	DRAINAGE LONGITUDINAL SECTIONS
12	P3	DRAINAGE LONGITUDINAL SECTIONS & PIT SCHEDULE
13	P3	PIT DETAILS
14	P3	SIGNAGE & LINEMARKING PLAN

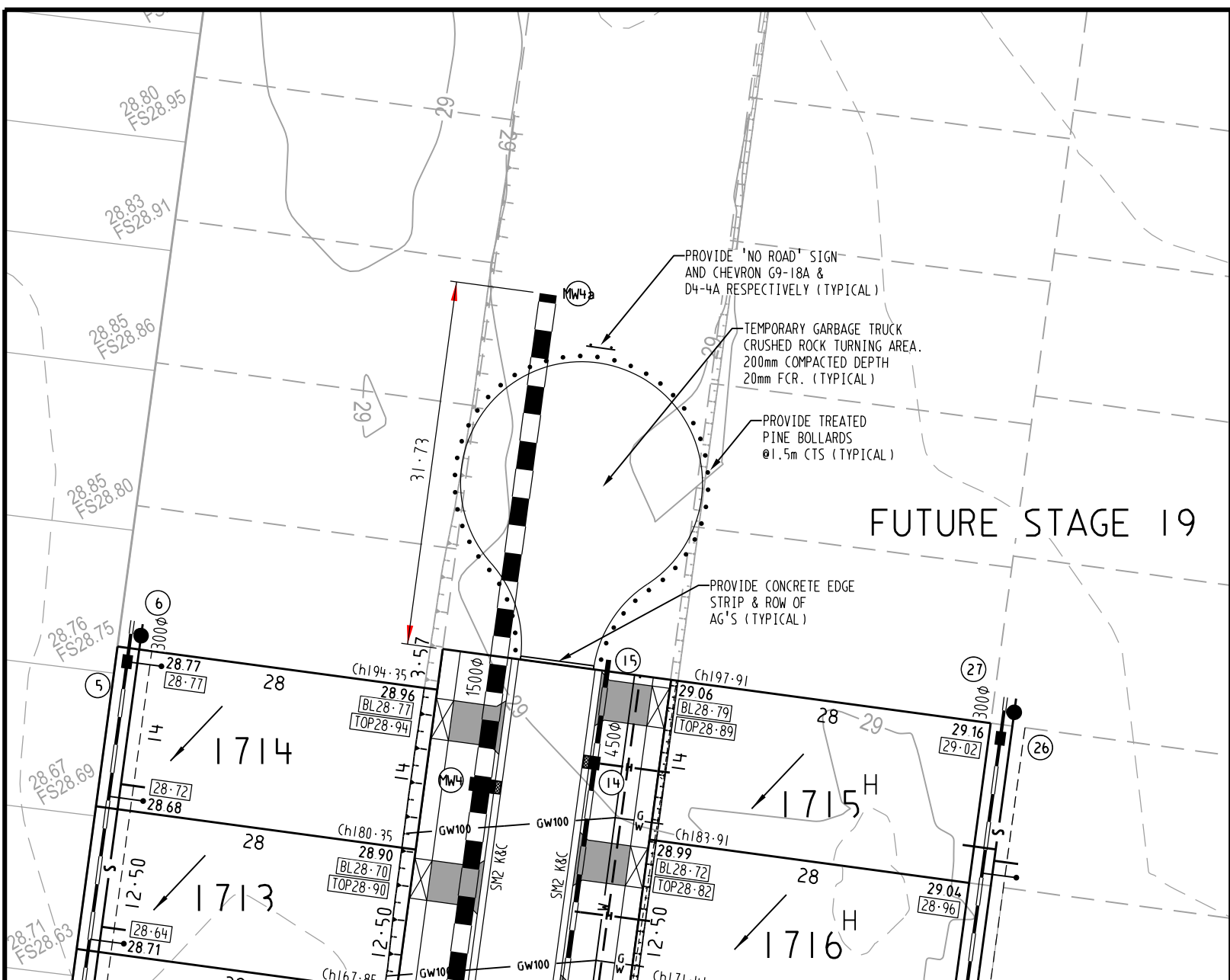
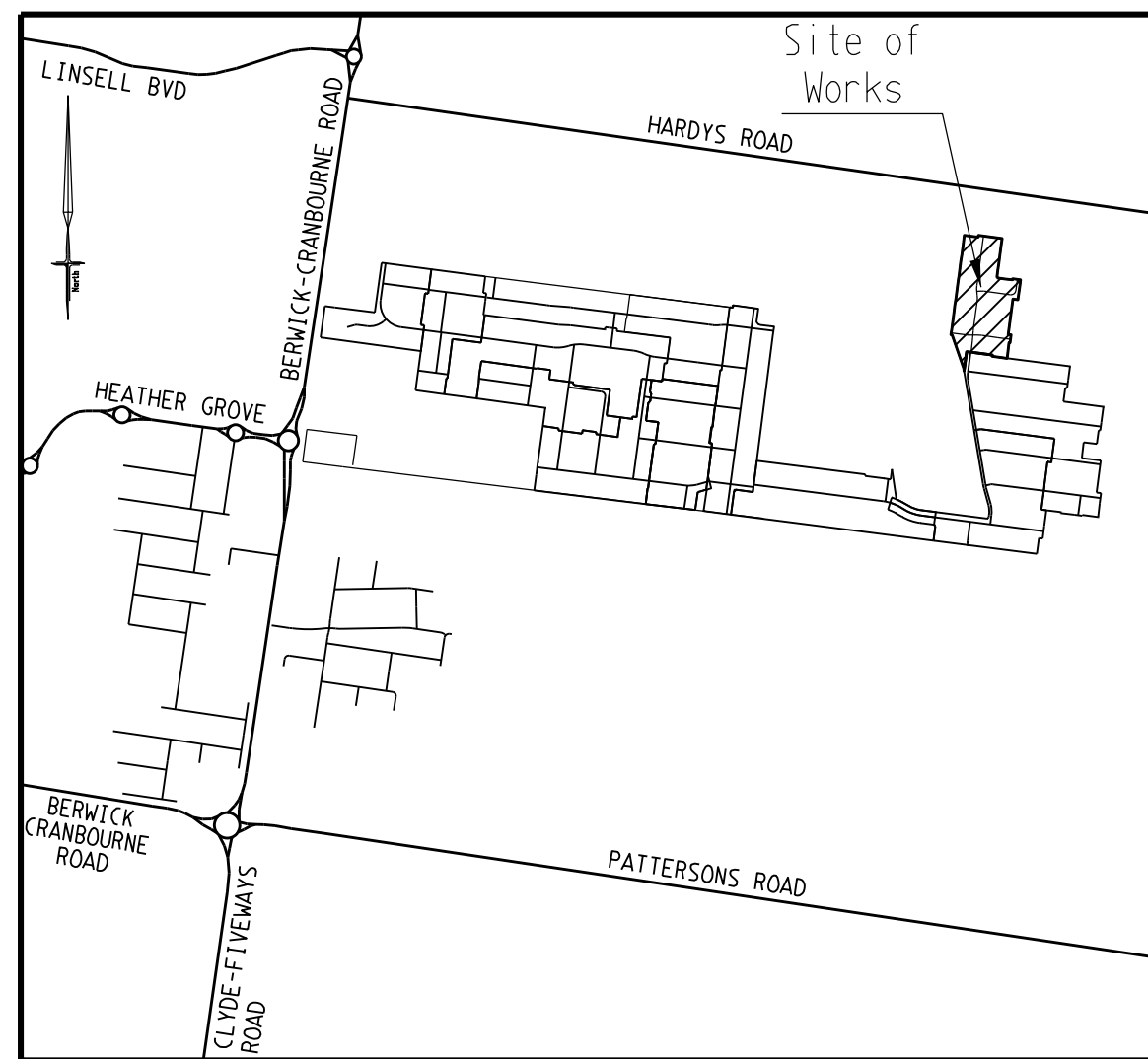

INSET