

# IMAGINE STAGE 18

## ROADS & DRAINAGE PLANS

### SOMERSET PARK ROAD - STRATHFIELDSAYE

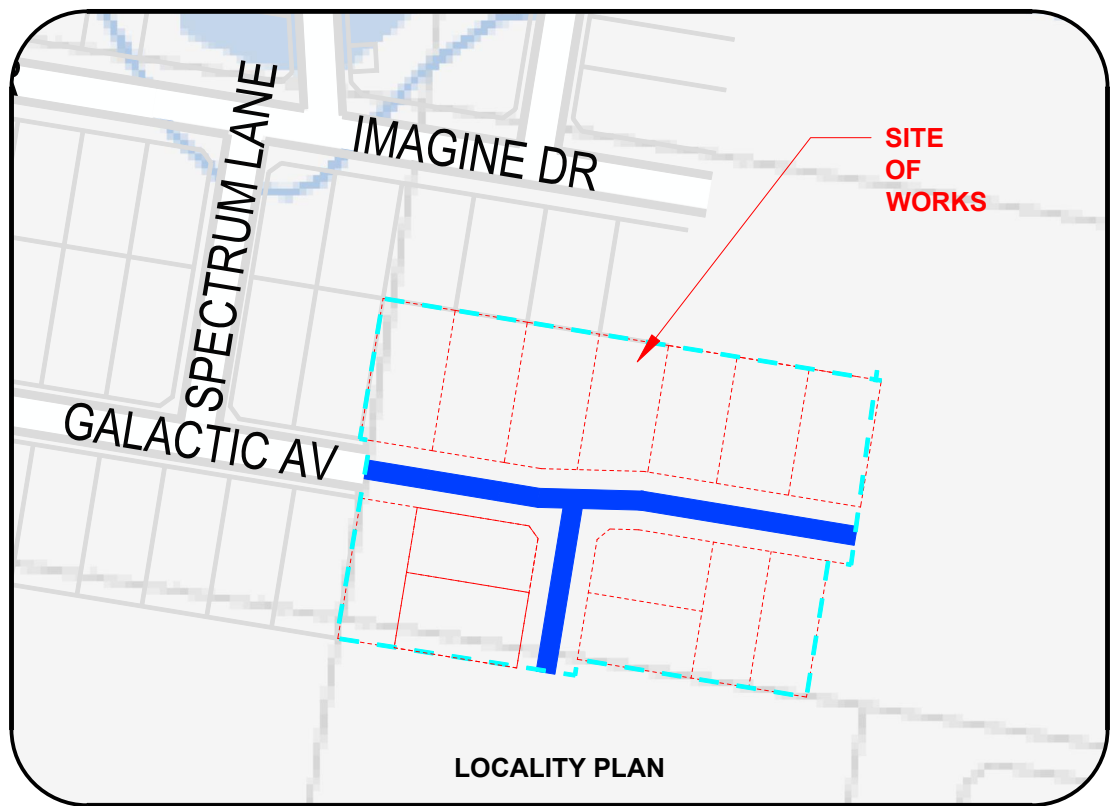

#### LEGEND

|  |  |   |
|--|--|---|
| EXISTING SHRUBS / TREES                            | PROPOSED SEWER AND MANHOLE               | PROPOSED SEALED PAVEMENT                        |
| PROPOSED STREET TREE                               | PROPOSED SEWER RISING MAIN               | PROPOSED CRUSHED ROCK                           |
| SHRUBS / TREES TO BE REMOVED                       | PROPOSED PRIVATE SEWER                   | PROPOSED CONCRETE FOOTPATH                      |
| SIGN   | EXISTING SEWER & MANHOLE                 | PROPOSED ASPHALT FOOTPATH                       |
| TELCO PILLAR                                       | PROPOSED FUTURE SEWER                    | PROPOSED CONCRETE PAVEMENT (DRIVEWAY OR INFILL) |
| TELCO PITS   | PROPOSED WATER MAIN                      | PROPOSED ALTERNATE PAVEMENT                     |
| ELECTRICITY LIGHT & POLE                           | PROPOSED PRIVATE WATER MAIN              | PROPOSED KERB                                   |
| PROPOSED KERB & CHANNEL                            | PROPOSED RECYCLED WATER MAIN             | PROPOSED NATURESTRIP / LANDSCAPING              |
| EXISTING KERB & CHANNEL                            | EXISTING WATER MAIN, FIRE PLUG AND VALVE | PROPOSED LOT EARTHWORKS NO TOPSOIL              |
| PROPOSED DRAIN / PIT / I.S.                        | PROPOSED FUTURE WATER                    | PROPOSED OTHER                                  |
| EXISTING DRAIN / PIT                               | PROPOSED ELECTRICITY MAIN                | PROPOSED ROCK BEACHING                          |
| PROPOSED HOUSE DRAIN / EASEMENT CONNECTION         | PROPOSED PRIVATE ELECTRICITY MAIN        | PROPOSED STAGE BOUNDARY                         |
| FUTURE DRAIN / PIT                                 | EXISTING ELECTRICITY MAIN & PIT          | OVERLAND 1% AEP STORMWATER FLOWPATH             |
| FENCE LINE   | PROPOSED FUTURE ELECTRICITY              | UNDERGROUND DRAINAGE CATCHMENT BOUNDARY         |
| INVERT (DESIGN \ EXISTING)                         | PROPOSED GAS MAIN                        | DIMENSION (IN METRES UNLESS STATED OTHERWISE)   |
| EDGE OF SEAL / EDGE OF BITUMEN (DESIGN \ EXISTING) | PROPOSED PRIVATE GAS MAIN                | LEADER / ARROW                                  |
| TOP OF BANK (DESIGN \ EXISTING)                    | EXISTING GAS MAIN                        | NS 101.95 EXISTING/NATURAL SURFACE LEVEL        |
| BOTTOM OF BANK                                     | PROPOSED FUTURE GAS                      | FS 101.95 FINISHED SURFACE LEVEL                |
| PROPOSED TITLE BOUNDARY & SITE TITLE BOUNDARY      | PROPOSED TELCO MAIN                      | TK 101.95 PROPOSED BACK OF KERB                 |
| PROPOSED FUTURE TITLE BOUNDARY                     | PROPOSED PRIVATE TELCO MAIN              | P 101.95 PROPOSED PAVEMENT FOOTPATH LEVEL       |
| PREVIOUS STAGE TITLE BOUNDARY                      | EXISTING TELCO CABLE                     | DIRECTION OF LOT GRADING                        |
| PROPOSED OR EXISTING EASEMENT                      | PROPOSED FUTURE TELCO                    | DIRECTION OF BASIN GRADING                      |
| HOUSE  | CATCH                                    | PROPOSED FLAT TOP SPEED HUMP                    |
| PROPOSED ELEC / TELSTRA CONDUIT & PIT              | D AG                                     | PERMANENT SURVEY MARK                           |
| PROPOSED GAS & WATER CONDUIT                       |  | SURVEY STATION                                  |

#### DRAWING LIST

|            |  |
|------------|--|
| 1065318R01 | LOCALITY PLAN & GENERAL NOTES                  |
| 1065318R02 | OVERALL DEVELOPMENT PLAN                       |
| 1065318R03 | EXISTING CONDITIONS & SURVEY STATIONS \ TBMS   |
| 1065318R04 | DETAIL PLAN                                    |
| 1065318R05 | CUT & FILL DEPTH RANGE & LOT LEVELS            |
| 1065318R06 | RETAINING WALL PLAN                            |
| 1065318R07 | PAVEMENT, SIGNAGE & LINEMARKING PLAN           |
| 1065318R08 | STREET TREE CONCEPT PLAN                       |
| 1065318R09 | INTERSECTION DETAIL                            |
| 1065318R10 | TYPICAL SECTIONS                               |
| 1065318R11 | GALACTIC & LUNAR LONG & CROSS SECTIONS         |
| 1065318R12 | GALACTIC AV & LUNAR COURT CROSS SECTIONS       |
| 1065318R13 | GALACTIC AV (N-S) LONG & CROSS SECTIONS        |
| 1065318R14 | RETAINING WALL LONG SECTIONS                   |
| 1065318R15 | DRAINAGE LONG SECTIONS (1 OF 2)                |
| 1065318R16 | DRAINAGE LONG SECTIONS (2 OF 2) + PIT SCHEDULE |

#### TABLE OF OFFSETS FOR SERVICES

| STREET                        | GAS  | NDW | DW | TELCO | UG ELEC | LIGHTING | BOK |      |   |   |   |               |
|-------------------------------|------|-----|----|-------|---------|----------|-----|------|---|---|---|---------------|
| GALACTIC AVENUE / LUNAR COURT | 1.90 | N   | -  | 2.40  | N       | 1.90     | S   | 2.40 | S | - | - | 4.05N / 4.05S |
| GALACTIC AVENUE               | 1.90 | E   | -  | 2.40  | E       | 1.90     | W   | 2.40 | W | - | - | 4.05N / 4.05S |

#### GENERAL NOTES

##### PRIOR TO THE COMMENCEMENT OF WORKS

- THE CONTRACTOR MUST NOTIFY THE RELEVANT AUTHORITY 7 DAYS PRIOR TO COMMENCEMENT OF CONSTRUCTION OF THE RELEVANT WORKS.
- THE CONTRACTOR MUST OBTAIN ALL NECESSARY PERMITS FROM THE MUNICIPALITY & VICEROADS FOR ANY WORKS UNDERTAKEN WITHIN AN EXISTING ROAD RESERVE PRIOR TO THE COMMENCEMENT OF WORKS.
- THE CONSULTANT HAS MADE EVERY REASONABLE ATTEMPT TO LOCATE EXISTING SERVICES AND HAS SHOWN THESE ON THE DRAWINGS. THE CONTRACTOR SHALL TAKE PHOTOGRAPHS AND PROVIDE A WRITTEN REPORT DETAILING THE CONDITION REGARDING ALL EXISTING INFRASTRUCTURE WHICH THEY ARE INTERFACING WITH, OR OTHERWISE HAVING AN IMPACT ON.
- PRIOR TO COMMENCING WORKS THE CONTRACTOR SHALL VERIFY THE LOCATION OF ALL SERVICES BY SITE SURVEY (INSPECTION AND CONSULTATION WITH ALL RELEVANT SERVICING AUTHORITIES). THE CONTRACTOR SHALL BE RESPONSIBLE FOR ANY DAMAGE TO EXISTING SERVICES, WHETHER SHOWN OR NOT.
- THE CONTRACTOR MUST CONTACT DIAL BEFORE YOU DIG (CALL 1100), OR VISIT THE DIAL BEFORE YOU DIG WEBSITE PRIOR TO COMMENCING WORKS AND SATISFY THEMSELVES THAT THERE ARE NO SERVICES WITHIN THE VICINITY OF THE WORK AREA.
- NO WORK IS TO COMMENCE BEFORE THE CONTRACTOR HAS ASCERTAINED WHAT UNDERGROUND SERVICES ARE PRESENT.
- CONTRACTOR MUST FOLLOW THE "NO GO ZONE" SAFETY PROCEDURES AT ALL TIMES, WHICH ARE AVAILABLE FROM ALL UTILITY AND TELECOMMUNICATIONS COMPANIES, INCLUDING THE OFFICE OF THE CHIEF ELECTRICAL INSPECTOR, THE OFFICE OF GAS SAFETY AND WORKSAFE VICTORIA.
- IF THESE SAFETY PROCEDURES CANNOT BE COMPLIED WITH THEN NO WORK IS TO BE UNDERTAKEN WITHOUT PERMISSION FROM THE UTILITY COMPANY.
- THE CONTRACTOR MUST PREPARE A PROJECT MANAGEMENT PLAN (OTHERWISE CALLED A CONSTRUCTION OR SITE MANAGEMENT PLAN) AND HAVE IT APPROVED BY BOTH COUNCIL & THE SUPERINTENDENT PRIOR TO THE COMMENCEMENT OF ANY WORKS. THIS PROJECT MANAGEMENT PLAN IS TO INCORPORATE THE FOLLOWING AT A MINIMUM AND IN ACCORDANCE WITH ANY LEGISLATION REQUIREMENTS:
  - OCCUPATIONAL HEALTH & SAFETY PROCEDURES
  - SITE STAFFING INCLUDING CONTACT DETAILS
  - TRAFFIC MANAGEMENT PLAN

- ENVIRONMENTAL MANAGEMENT PLAN
- QUALITY ASSURANCE DETAILS (FOR QA CERTIFIED CONTRACTORS)
- CONSTRUCTION PROGRAM

##### CONSTRUCTION SETOUT

- ALL LEVELS ARE TO A.H.D. AND ARE REFERENCED TO THE T.B.M. INDICATED.
- COORDINATION OF THIS DESIGN USES MGA2020, CORRECT AS OF THE DATE OF THESE PLANS. MGA94 MAY HAVE BEEN USED PREVIOUSLY ON THIS SITE OR AN ADJOINING PROPERTY AND SUCH WORK WILL DIFFER IN POSITION BY AROUND 1.8 METRES FROM THIS DOCUMENT. ORIENTATION (NORTH) REMAINS THE SAME BETWEEN MGA94 AND MGA2020.
- NO TBM CAN BE USED WITHOUT FIRST PROVING IT TO BE CORRECT TO A SECOND TBM. NO HORIZONTAL SETOUT CONTROL CAN BE USED WITHOUT FIRST PROVING IT TO BE CORRECT TO A THIRD KNOWN POINT. THE CONSULTING SURVEYOR IS TO BE NOTIFIED OF ANY DISCREPANCIES IMMEDIATELY. TITLE PEGS AND T.B.M.'s TO BE RE-ESTABLISHED BY A LICENSED SURVEYOR IF FOUND TO BE MISSING.
- IF USING GNSS \ GPS TO SETOUT FOR CONSTRUCTION PLEASE NOTE:
  - GNSS HAS REDUCED VERTICAL PRECISION COMPARED TO TRADITIONAL SURVEY METHODS.
  - ONLY USE A SINGLE POINT CALIBRATION FOR THE VERTICAL THEN TEST TO AT LEAST 1 OTHER STATED TBM BEFORE PROCEEDING.
  - IF YOU HAVE ANY QUERIES OR CONCERNS CONTACT THE CONSULTING SURVEYOR.

##### SITE MANAGEMENT DURING CONSTRUCTION

- THE SUPERINTENDENT IS RESPONSIBLE FOR THE DESIGN AND MANAGEMENT OF THE CONSTRUCTION WORKS. ANY PROBLEMS ARISING DURING CONSTRUCTION SHALL BE DIRECTED TO THE SUPERINTENDENT.
- ALL WORKS SHALL BE CONSTRUCTED IN ACCORDANCE WITH THE INFRASTRUCTURE DESIGN MANUAL AND ANY OTHER RELEVANT AUTHORITY SPECIFICATIONS. A COPY OF THE INFRASTRUCTURE DESIGN MANUAL CAN BE FOUND AT [www.designmanual.com.au](http://www.designmanual.com.au). IF YOU HAVE ANY ISSUES INTERPRETING THE MANUAL CONTACT THE SUPERINTENDENT.
- ALL WORKS MUST ABIDE BY THE APPROVED CONSTRUCTION MANAGEMENT PLAN AND MUST COMPLY WITH THE RECOMMENDATIONS OF THE ENVIRONMENT PROTECTION AUTHORITY PUBLICATION "CONSTRUCTION TECHNIQUES FOR SEDIMENT POLLUTION CONTROL" (PUBLICATION NO 275). APPROPRIATE SILTATION CONTROL IS TO BE CARRIED OUT DURING THE CONSTRUCTION AND MAINTENANCE PERIOD.
- BEFORE COMMENCING ANY EXCAVATION WORKS OF 1.5m DEPTH OR GREATER,

THE CONTRACTOR IS REQUIRED TO SUBMIT THE REQUIRED NOTIFICATION TO WORKSAFE VICTORIA. THE NOTIFICATION MUST BE RECEIVED BY THE AUTHORITY AT LEAST 3 DAYS PRIOR TO COMMENCING EXCAVATIONS. A COPY OF THE NOTIFICATION IS TO BE PROVIDED TO THE SUPERINTENDENT. THE CONTRACTOR SHALL COMPLY WITH THE MINES ACT, OCCUPATIONAL HEALTH AND SAFETY ACT, WORKSAFE VICTORIA REQUIREMENTS INCLUDING COMPLIANCE CODES.

20. THE CONTRACTOR SHALL TAKE THE UTMOST CARE TO PRESERVE EXISTING TREES. NO TREES SHALL BE REMOVED WITHOUT THE PRIOR APPROVAL OF THE SUPERINTENDENT.

21. THE CONTRACTOR SHALL TO THE SATISFACTION OF THE SUPERINTENDENT AND COUNCIL'S SUPERVISING OFFICER PROVIDE AND MAINTAIN ALL NECESSARY WARNING SIGNAGE, LIGHTING AND BARRICADING TO COMPLY WITH THE REQUIREMENTS OF THE ROAD MANAGEMENT ACT.

22. DISPOSAL OF EXCESS SPOIL TRUCK ROUTE AND DISPOSAL LOCATION ARE TO BE APPROVED BY THE MUNICIPAL ENGINEERING DEPARTMENT.

23. AT THE COMPLETION OF WORKS ALL RUBBISH, DEBRIS AND SURPLUS SPOIL IS TO BE REMOVED AND ALL LOTS AND ROAD RESERVE TO BE LEFT IN A TIDY CONDITION TO THE SATISFACTION OF THE SUPERINTENDENT & RELEVANT AUTHORITY.

##### PROTECTION OF VEGETATION

- NO WORKS ARE TO BE UNDERTAKEN WITHIN THE DRIP ZONE (CANOPY) OF AN EXISTING TREE UNLESS APPROVED BY THE RESPONSIBLE AUTHORITY.
- MACHINERY IS NOT TO BE DRIVEN OVER OR PARKED WITHIN THE DRIP ZONE OF ANY TREE.

##### EARTHWORKS

- ALL EARTHWORKS ARE TO BE UNDERTAKEN IN ACCORDANCE WITH AS 3798 (2007) - GUIDELINES ON EARTHWORKS FOR COMMERCIAL AND RESIDENTIAL DEVELOPMENTS.
- ALL FILLING WITHIN AREAS OF PROPOSED ROAD PAVEMENT IS TO ACHIEVE A MINIMUM COMPACTION OF 98% STANDARD.
- ALL FILLING WITHIN OTHER AREAS IS TO ACHIEVE A MINIMUM COMPACTION OF

95% STANDARD.

29. ANY FILLING IN EXCESS OF 300mm DEPTH IS TO BE CARRIED OUT UNDER LEVEL 1 SUPERVISION UNLESS DIRECTED OTHERWISE. FILL AREAS ARE TO BE STRIPPED OF TOPSOIL & FILLED USING APPROVED CLAY FILL. TOPSOIL IS TO BE REPLACED NO MORE THAN 150mm THICK TO OBTAIN FINAL FILL LEVELS AS SHOWN ON PLANS. ALL FILLING TO BE CARRIED OUT IN 150mm LAYERS AND COMPACTED AS DETAILED ABOVE IN ACCORDANCE WITH AS3798-2007 (GUIDELINES ON EARTHWORKS FOR COMMERCIAL AND RESIDENTIAL DEVELOPMENTS). ON COMPLETION THE CONTRACTOR SHALL PRESENT A "LEVEL 1" TYPED REPORT NOMINATING THE EXTENT OF FILL PLACED, ITS CONFORMANCE WITH THE SPECIFICATION AND ITS CLASSIFICATION AS "CONTROLLED FILL". IF ANY SUBSTANDARD FILLING IS ENCOUNTERED ON THE SITE IT MUST BE REMOVED AND REPLACED WITH VERIFICATION PROVIDED TO THE SUPERVISING ENGINEER. A GEO-TECHNICAL REPORT MUST BE SUBMITTED SHOWING DETAILS OF DEPTH, TYPE OF MATERIAL AND DENSITY OF THE FILL AREAS CONCERNED.

30. THE SUPERINTENDENT IS TO BE ADVISED OF ANY FILLING THAT ACHIEVES A DEPTH OF 300mm OR GREATER.

31. THE CONTRACTOR IS RESPONSIBLE FOR ENSURING THAT ALL IMPORTED FILL MATERIAL, INCLUDING TOPSOIL, SATISFIES THE DESCRIPTION FOR CLEAN FILL MATERIAL IN EPA BULLETIN PUBLICATION NO. 448 (MAY 2007) AND SUBSEQUENT REVISIONS. THE CONTRACTOR SHALL PROVIDE VERIFICATION INCLUDING TEST CERTIFICATES TO THE SUPERVISING ENGINEER.

32. ALL TRENCHES ARE TO ACHIEVE THE SPECIFIED COMPACTION RESULTS WITHOUT EXCEPTION. THE SUPERINTENDENT RESERVES THE RIGHT TO REQUIRE COMPACTION TESTING BY A NATA APPROVED LABORATORY AT THE CONTRACTORS EXPENSE.

33. ALL EXCAVATIONS OF DEPTH 1.5m OR GREATER MUST COMPLY WITH LEGISLATION ENFORCED BY WORKSAFE VICTORIA. A "NOTICE OF INTENTION TO COMMENCE EXCAVATION" MUST BE SUBMITTED TO YOUR LOCAL WORKSAFE OFFICE.

34. ALL LOTS ARE TO ACHIEVE A MINIMUM CROSS FALL OF 1 IN 150 (0.67%) TO A LEGAL POINT OF DISCHARGE (DRAINAGE POINT OR ROAD RESERVE) UNLESS STATED OTHERWISE.

35. RESERVES TO BE FREE DRAINING AND TO BE LEFT IN A CONDITION SATISFACTORY TO THE SUPERINTENDENT.

##### ROAD WORKS AND FOOTPATHS

- ALL KERB & CHANNEL IS MODIFIED SM2 (DM SD 100) UNLESS STATED OTHERWISE.
- ALL ASPHALT ROAD SEALS ARE TO BE 7mm TYPE 'N' UNLESS STATED OTHERWISE.

38. ALL KERB RADII ARE TO BACK OF KERB UNLESS STATED OTHERWISE.

39. ALL FOOTPATHS ARE TO BE CONSTRUCTED AS PER INFRASTRUCTURE DESIGN MANUAL (IDM) 200 SERIES STANDARD DRAWINGS AND IN ACCORDANCE WITH COUNCIL STANDARDS UNLESS STATED OTHERWISE.

40. TGSs ARE TO BE INSTALLED ON ALL PEDESTRIAN CROSSINGS AS PER AS 1428.4.

41. ALL NEW INTERSECTIONS ARE TO HAVE STREET SIGNS INSTALLED TO COUNCIL STANDARDS IRRESPECTIVE OF WHETHER THEY ARE DETAILED ON THE ENGINEERING PLANS OR NOT.

42. AT ALL TEMPORARY STAGE BOUNDARY TERMINATIONS TO ROADS THE CONTRACTOR IS TO INSTALL A D4-HAZARD SIGN.

43. ALL CONCRETE IS TO HAVE A MINIMUM COMPRESSIVE STRENGTH OF 25MPa AT 28 DAYS AND MINIMUM CEMENT CONTENT OF 320 kg/m<sup>3</sup>.

44. TRANSITIONS BETWEEN DIFFERENT KERB TYPES TO BE OVER 3.0m MINIMUM, IF IT CANNOT BE ACHIEVED AT A PRAM CROSSING OR DRIVEWAY CROSSOVER.

45. ROAD PAVEMENT COMPACTION & TESTING REQUIREMENTS ARE AS PER THE INFRASTRUCTURE DESIGN MANUAL.

46. ALL EASEMENT DRAINAGE PIPES ARE 1.0m OFFSET TITLE BOUNDARY UNLESS DIMENSIONED OTHERWISE.

47. ALL EASEMENT DRAINAGE PITS ARE TO BE 1.0m PAST TITLE BOUNDARY UNLESS DIMENSIONED OTHERWISE.

48. ALL PROPERTY DRAINAGE CONNECTIONS FROM ROAD RESERVES ARE TO ENTER THE PROPERTY 1.0m O/S SIDE BOUNDARY ON THE LOW SIDE WITH 0.5m COVER UNLESS NOTED OTHERWISE.

49. REFER TO THE CERTIFIED PLAN OF SUBDIVISION FOR ALL EASEMENT WIDTHS, DO NOT SCALE FROM DRAWING.

50. STORMWATER DRAINS SHALL BE RCP FLUSH JOINTED CLASS 2 OR PVC CLASS SN8 UNLESS OTHERWISE SHOWN.

51. ALL RCP FLUSH JOINTED PIPES BELOW 600mm DIA ARE TO HAVE EXTERIOR MORTARED JOINTS. ALL PIPES 600 DIA AND GREATER ARE TO HAVE INTERIOR MORTAR JOINTS.

52. ALL PROPOSED DRAINAGE STUBS TO BE BLANKED OFF AT END OF PIPE WITH TIMBER PLANKS TO THE SATISFACTION OF THE SUPERVISING ENGINEER.

53. ALL CONDUIT LOCATIONS ARE TO BE STAMPED IN THE CONCRETE KERBING.

54. ALL CONCRETE IS TO HAVE A MINIMUM COMPRESSIVE STRENGTH OF 25MPa AT 28 DAYS.

55. ALL GRATES ARE TO BE HOT DIPPED GALVANISED.

56. 100mm DEEP CATCH DRAINS TO BE CONSTRUCTED ALONG ALL EASEMENT DRAINAGE AND DIRECTED TO LEGAL POINT OF DISCHARGE.

57. STEP IRONS ARE NOT TO BE INSTALLED IN ANY DRAINAGE PIT. ACCESS LIDS ARE TO BE LOCATED TO ENABLE REASONABLE ACCESS.

58. ALL HOUSE DRAIN CONNECTIONS TO REINFORCED CONCRETE PIPES ARE TO UTILISE "CONCONNECT" OR COUNCIL APPROVED EQUIVALENT PRODUCTS TO AVOID PIPE PROTRUSIONS INTO THE LARGER PIPE.

59. REFER ROAD LAYOUT PLANS FOR WATER & GAS ROAD SERVICE CONDUIT LOCATIONS. INTERSECTION DETAILS PLANS DO NOT SHOW CONDUITS.

60. ELECTRICITY & TELECOMMUNICATIONS CONDUITS SHOWN ON THESE PLANS ARE CONCEPTUAL ONLY. REFER TO ELECTRICITY & TELECOMMUNICATIONS PLANS FOR ACTUAL ROAD SERVICE CONDUIT LOCATIONS. IF THERE ARE ANY DISCREPANCIES BETWEEN THESE PLANS CONTACT SUPERINTENDENT FOR CLARIFICATION.

##### CONSTRUCTION HOLD POINTS

61. CONSTRUCTION HOLD POINTS ARE TO BE IN ACCORDANCE WITH THE INFRASTRUCTURE DESIGN MANUAL.

##### EMERGENCY CONTACTS

| SERVICE        | AUTHORITY & CONTACT     | TELEPHONE    |
|----------------|-------------------------|--------------|
| DRAINAGE       | CITY OF GREATER BENDIGO | 5434 6000    |
| ELECTRICITY    | POWERCOR                | 132 412      |
| GAS            | SP AUSNET               | 136 707      |
| COMMUNICATIONS | TELSTRA                 | 132 203      |
| SEWER & WATER  | COLIBAN WATER           | 1300 363 200 |

62. THE PROJECT AREA CONTAINS THE FOLLOWING SERVICES FOR ASSISTANCE IN EMERGENCY CONTACT:

63. IN ANY EMERGENCY IF YOU BELIEVE LIFE OR PROPERTY IS THREATENED DO NOT HESITATE TO CONTACT STATE EMERGENCY SERVICES ON TELEPHONE 000.

# DRAFT

| REV | AS SUBMITTED TO COUNCIL | REVISION | NB SA X X xx/xx/xx | DES DWG CHK AUTH DATE |
|-----|-------------------------|----------|--------------------|-----------------------|
|     |                         |          |                    |                       |

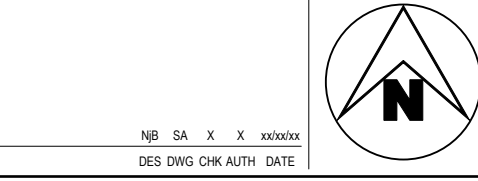

HEAD OFFICE: 57 MYERS STREET BENDIGO PH 03 5445 8700  
ABN 11 103 336 358 WWW.TOMKINSON.COM

© COPYRIGHT  
THE INFORMATION CONTAINED  
ON THIS DRAWING IS THE  
INTELLECTUAL PROPERTY OF  
TOMKINSON GROUP. COPYING  
OR USING THIS DRAWING IN  
WHOLE OR IN PART WITHOUT  
THE EXPRESS WRITTEN  
PERMISSION OF TOMKINSON  
GROUP INFRINGES COPYRIGHT

SCALE N/A  
LENGTHS ARE IN METRES - PAPER SIZE A3

### IMAGINE STAGE 18

#### SOMERSET PARK ROAD STRATHFIELDSAYE

##### LOCALITY PLAN & GENERAL NOTES

CITY OF GREATER BENDIGO REF: DS/188/2016  
STRATHFIELDSAYE HOLDINGS PTY LTD

DWG STATUS: **PRELIMINARY** PROJECT & DWG No: 1065318R01 / 17 REV: A

NOTE: THIS IS AN UNCONTROLLED DOCUMENT AND WILL NOT BE UPDATED. IT IS THE RESPONSIBILITY OF THE USER TO CONFIRM THAT THIS IS A CURRENT COPY AND SUITABLE FOR THE PROPOSED USE. THIS SHEET MUST BE READ IN CONJUNCTION WITH ALL SHEETS OF THIS SET AND ANY ACCOMPANYING DOCUMENTS.  
PLOT DATE: 04/05/2023 FILE: C:\TZD\DATA\TOMKINSON\1065318 - STRATHFIELDSAYE - IMAGINE STAGE 18 - 065318ENGIN000\CURRENT\1065318 R-D CTN PLANS REV A.DWG

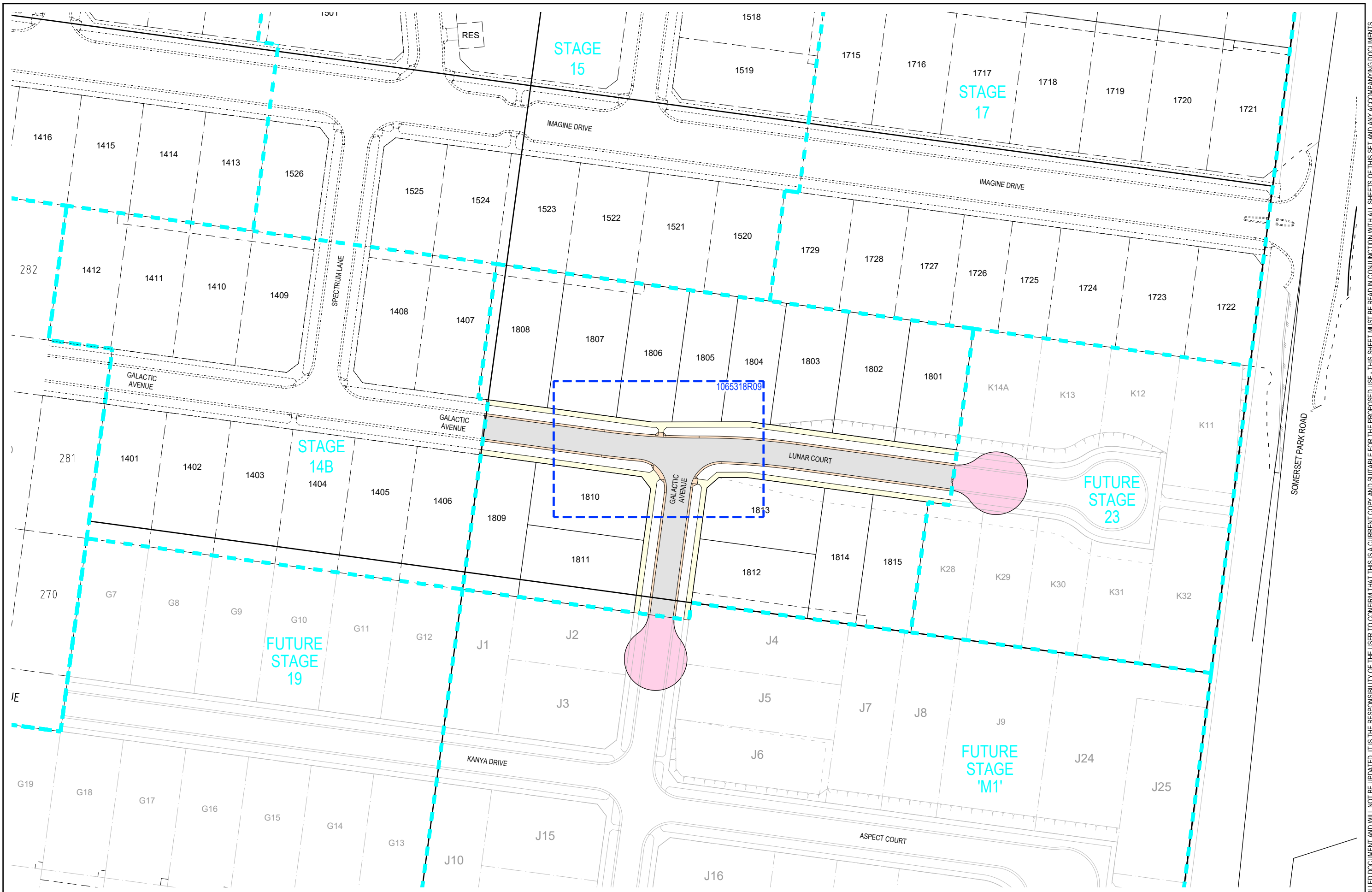

# DRAFT

A AS SUBMITTED TO COUNCIL

NJB SA X X xx/xx/xx  
DES DWG CHK AUTH DATE



**Tomkinson**  
SURVEY > ENGINEERING > PLANNING > PROJECT MANAGEMENT

HEAD OFFICE: 57 MYERS STREET BENDIGO PH 03 5445 8700  
ABN 11 103 336 358 WWW.TOMKINSON.COM



SCALE 1:1,000  
LENGTHS ARE IN METRES - PAPER SIZE A3

© COPYRIGHT  
THE INFORMATION CONTAINED  
ON THIS DRAWING IS THE  
INTELLECTUAL PROPERTY OF  
TOMKINSON GROUP. COPYING  
OR USING THIS DRAWING IN  
WHOLE OR IN PART WITHOUT  
THE EXPRESS WRITTEN  
PERMISSION OF TOMKINSON  
GROUP INFRINGES COPYRIGHT

**DIAL BEFORE YOU DIG**  
www.100.com.au

COMPASS ASSURANCE  
ISO 9001 QUALITY

**IMAGINE STAGE 18**  
**SOMERSET PARK ROAD STRATHFIELDSAYE**  
**OVERALL DEVELOPMENT PLAN**  
CITY OF GREATER BENDIGO REF: DS/188/2016  
STRATHFIELDSAYE HOLDINGS PTY LTD

DWG STATUS: **PRELIMINARY** PROJECT & DWG No: 1065318R02 / 17 A

NOTE: THIS IS AN UNCONTROLLED DOCUMENT AND WILL NOT BE UPDATED. IT IS THE RESPONSIBILITY OF THE USER TO CONFIRM THAT THIS IS A CURRENT COPY AND SUITABLE FOR THE PROPOSED USE. THIS SHEET MUST BE READ IN CONJUNCTION WITH ALL SHEETS OF THIS SET AND ANY ACCOMPANYING DOCUMENTS.  
PLOT DATE: 04/05/2023 FILE: C:\TZD\DATA\TOMKINSON\STRATHFIELDSAYE - IMAGINE STAGE 18\_26839ENG000\CURRENT\1065318 R-D CTN PLANS REV A.DWG



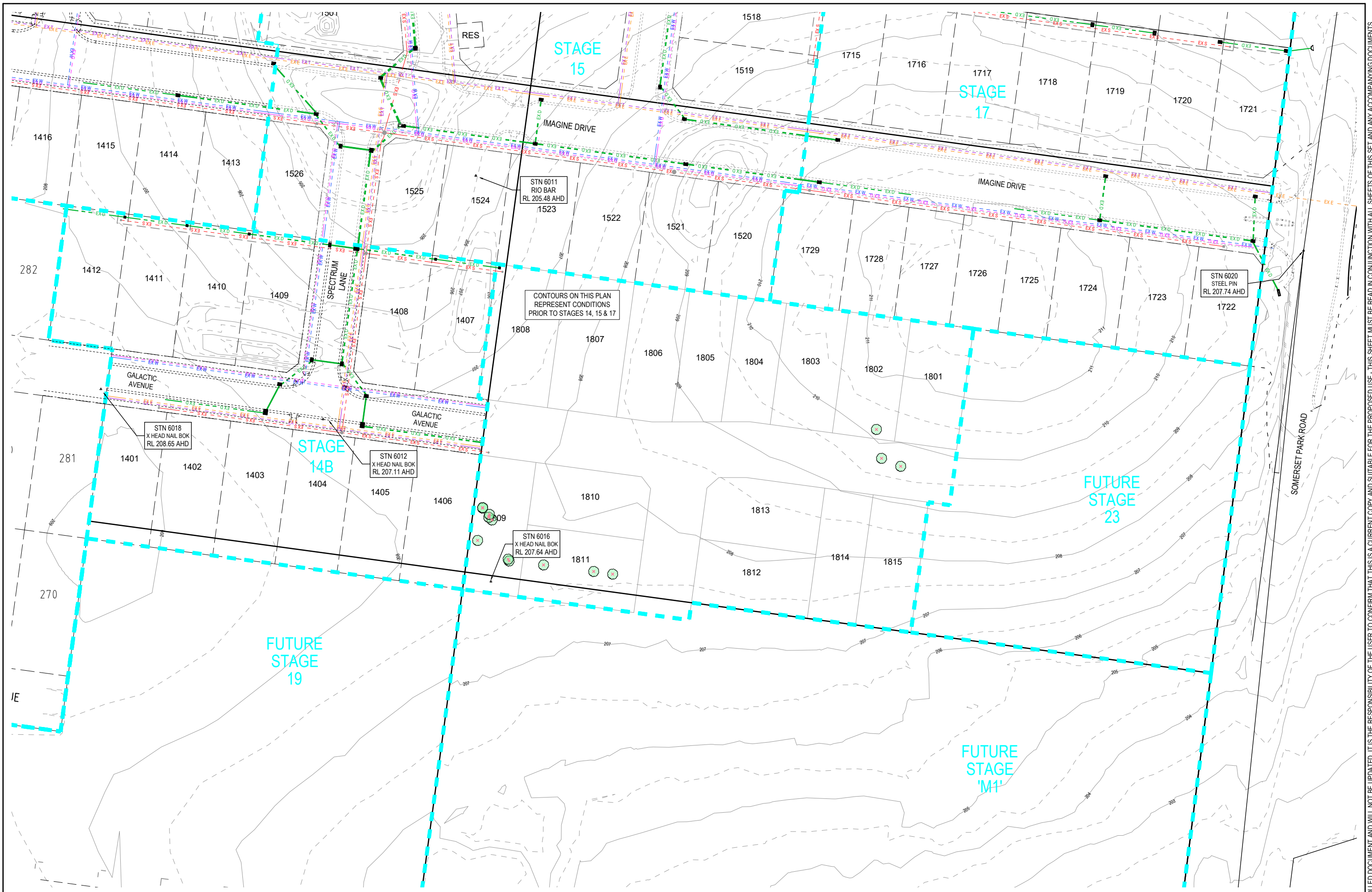

**DRAFT**

A AS SUBMITTED TO COUNCIL  
REV

REVISION

NJB SA X X xx/xx/xx  
DES DWG CHK AUTH DATE



HEAD OFFICE: 57 MYERS STREET BENDIGO PH 03 5445 8700  
ABN 11 103 336 358 WWW.TOMKINSON.COM

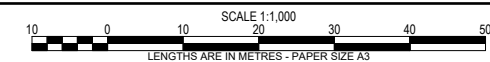

© COPYRIGHT  
THE INFORMATION CONTAINED  
ON THIS DRAWING IS THE  
INTELLECTUAL PROPERTY OF  
TOMKINSON GROUP. COPYING  
OR USING THIS DRAWING IN  
WHOLE OR IN PART WITHOUT  
THE EXPRESS WRITTEN  
PERMISSION OF TOMKINSON  
GROUP INFRINGES COPYRIGHT



**IMAGINE STAGE 18**  
**SOMERSET PARK ROAD STRATHFIELDSAYE**  
**EXISTING CONDITIONS & TBM PLAN**

CITY OF GREATER BENDIGO REF: DS/188/2016  
STRATHFIELDSAYE HOLDINGS PTY LTD

DWG STATUS: **PRELIMINARY** PROJECT & DWG No: 1065318R03 / 17 A

NOTE: THIS IS AN UNCONTROLLED DOCUMENT AND WILL NOT BE UPDATED. IT IS THE RESPONSIBILITY OF THE USER TO CONFIRM THAT THIS IS A CURRENT COPY AND SUITABLE FOR THE PROPOSED USE. THIS SHEET MUST BE READ IN CONJUNCTION WITH ALL SHEETS OF THIS SET AND ANY ACCOMPANYING DOCUMENTS.  
PLOT DATE: 04/05/2023 FILE: C:\TZD\DATA\TOMKINSON\1065318 - STRATHFIELDSAYE - IMAGINE STAGE 18 - 06839ENGIN000\CAD\CURRENT\1065318 R-D CTN PLANS REV A.DWG

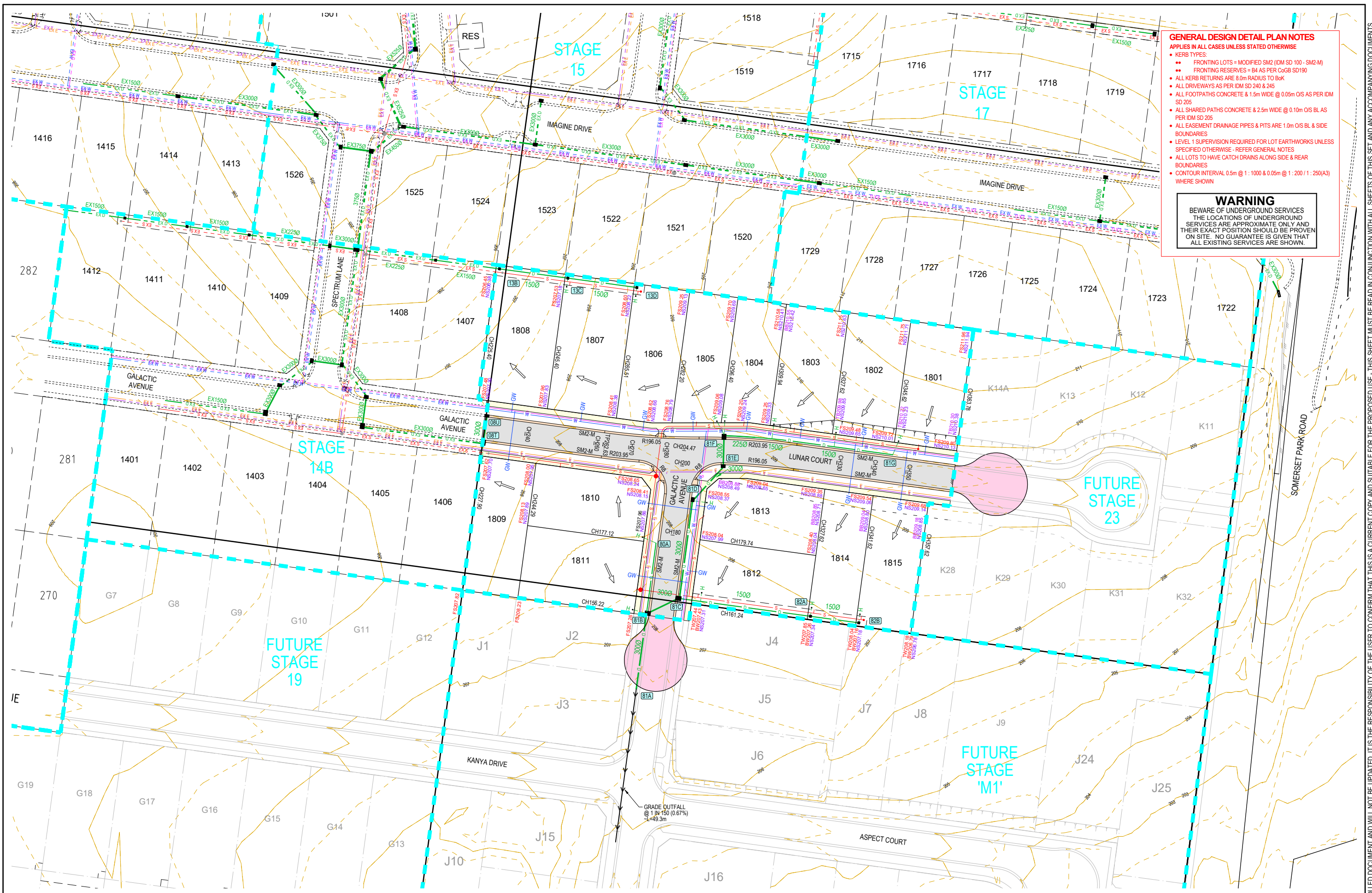

**GENERAL DESIGN DETAIL PLAN NOTES**  
 APPLIES IN ALL CASES UNLESS STATED OTHERWISE

- KERB TYPES:
  - FRONTING LOTS = MODIFIED SM2 (DM SD 100 - SM2-M)
  - FRONTING RESERVES = B4 AS PER C&G SD190
- ALL KERB RETURNS ARE 8.0m RADIUS TO B&K
- ALL DRIVEWAYS AS PER IDM SD 240 & 245
- ALL FOOTPATHS CONCRETE & 1.5m WIDE @ 0.05m O/S AS PER IDM SD 205
- ALL SHARED PATHS CONCRETE & 2.5m WIDE @ 0.10m O/S BL AS PER IDM SD 205
- ALL EASEMENT DRAINAGE PIPES & PITS ARE 1.0m O/S BL & SIDE BOUNDARIES
- LEVEL 1 SUPERVISION REQUIRED FOR LOT EARTHWORKS UNLESS SPECIFIED OTHERWISE - REFER GENERAL NOTES
- ALL LOTS TO HAVE CATCH DRAINS ALONG SIDE & REAR BOUNDARIES
- CONTOUR INTERVAL 0.5m @ 1:1000 & 0.05m @ 1:200 (1:250(A3)) WHERE SHOWN

**WARNING**  
 BEWARE OF UNDERGROUND SERVICES  
 THE LOCATIONS OF UNDERGROUND SERVICES ARE APPROXIMATE ONLY AND THEIR EXACT POSITION SHOULD BE PROVEN ON SITE. NO GUARANTEE IS GIVEN THAT ALL EXISTING SERVICES ARE SHOWN.

NOTE: THIS IS AN UNCONTROLLED DOCUMENT AND WILL NOT BE UPDATED. IT IS THE RESPONSIBILITY OF THE USER TO CONFIRM THAT THIS IS A CURRENT COPY AND SUITABLE FOR THE PROPOSED USE. THIS SHEET MUST BE READ IN CONJUNCTION WITH ALL SHEETS OF THIS SET AND ANY ACCOMPANYING DOCUMENTS.  
 PLOT DATE: 04/05/2023 FILE: C:\TZ\DATA\TOMKINSON\1250511065318 - STRATHFIELDSAYE - IMAGINE STAGE 18 - 06839ENGL000\CURRENT\1065318 R-D CTN PLANS REV A.DWG

**DRAFT**

| REV | AS SUBMITTED TO COUNCIL | NJB | SA   | X    | X | xx/xx/xx |
|-----|-------------------------|-----|------|------|---|----------|
| DES | DWG                     | CHK | AUTH | DATE |   |          |
|     |                         |     |      |      |   |          |



**Tomkinson**  
 SURVEY • ENGINEERING • PLANNING • PROJECT MANAGEMENT

HEAD OFFICE: 57 MYERS STREET BENDIGO PH 03 5445 8700  
 ABN 11 103 336 358 WWW.TOMKINSON.COM



SCALE 1:1,000  
 LENGTHS ARE IN METRES - PAPER SIZE A3

© COPYRIGHT  
 THE INFORMATION CONTAINED  
 ON THIS DRAWING IS THE  
 INTELLECTUAL PROPERTY OF  
 TOMKINSON GROUP. COPYING  
 OR USING THIS DRAWING IN  
 WHOLE OR IN PART WITHOUT  
 THE EXPRESS WRITTEN  
 PERMISSION OF TOMKINSON  
 GROUP INFRINGES COPYRIGHT

**DIAL BEFORE YOU DIG**  
 www.1100.com.au

COMPASS ASSURANCE  
 ISO 9001 QUALITY

**IMAGINE STAGE 18**  
**SOMERSET PARK ROAD STRATHFIELDSAYE**  
**CONSTRUCTION LAYOUT PLAN**  
 CITY OF GREATER BENDIGO REF: DS/188/2016  
 STRATHFIELDSAYE HOLDINGS PTY LTD

DWG STATUS: **PRELIMINARY**  
 PROJECT & DWG No: 1065318R04 / 17 A



| Levels Table |            |            |             |     |            |            |              |
|--------------|------------|------------|-------------|-----|------------|------------|--------------|
| No.          | Min. Level | Max. Level | Colour      | No. | Min. Level | Max. Level | Colour       |
| 1            | -2.5       | -2.0       | Red         | 7   | 0.0        | 0.3        | Light Green  |
| 2            | -2.0       | -1.5       | Orange      | 8   | 0.3        | 0.6        | Light Blue   |
| 3            | -1.5       | -1.0       | Yellow      | 9   | 0.6        | 1.0        | Light Purple |
| 4            | -1.0       | -0.6       | Light Green | 10  | 1.0        | 1.5        | Light Blue   |
| 5            | -0.6       | -0.3       | Light Green | 11  | 1.5        | 2.0        | Light Purple |
| 6            | -0.3       | 0.0        | Light Green | 12  | 2.0        | 2.5        | Light Purple |

NOTES: CUT & FILL DEPTHS ARE A COMPARISON BETWEEN EXISTING SURFACE (100mm STRIPPED) & BULK EARTHWORKS SURFACE - NO ALLOWANCE HAS BEEN MADE FOR ANY EXTRA CLEAN OUT OF DAMS & RACES. CONTRACTOR TO ENSURE A CLEAN BASE IS ACHIEVED PRIOR TO ANY FILLING. NS LEVELS ARE ORIGINAL AS-SURVEYED EXISTING SURFACE LEVELS PRIOR TO STRIPPING & FS LEVELS ARE FINAL FINISHED SURFACE LEVELS AFTER TOPSOILING ETC.

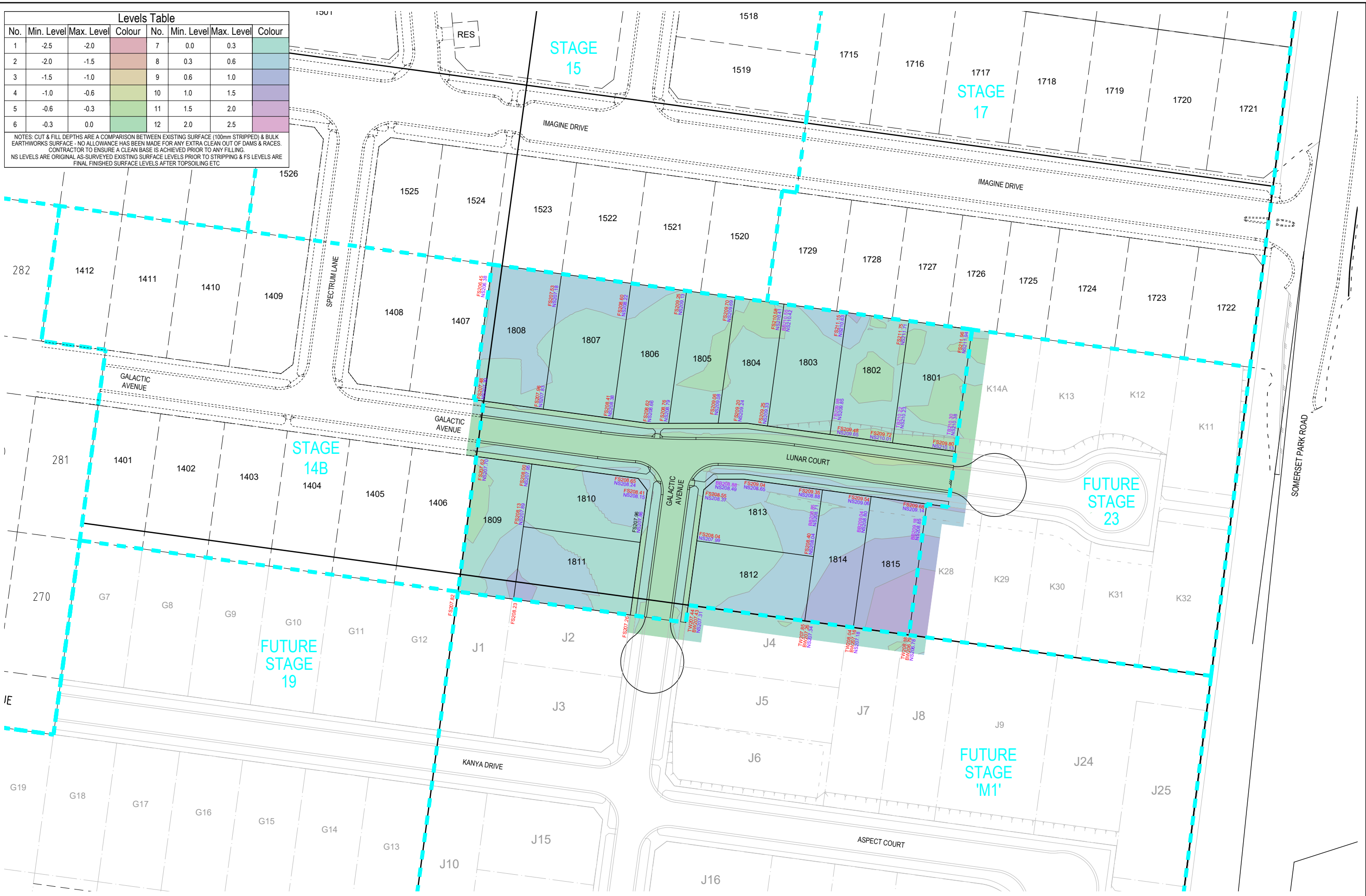

**DRAFT**

A AS SUBMITTED TO COUNCIL  
 REV DES DWG CHK AUTH DATE  
 NJB SA X X xx/xx/xx  
 DES DWG CHK AUTH DATE



**Tomkinson**  
 SURVEY > ENGINEERING > PLANNING > PROJECT MANAGEMENT  
 HEAD OFFICE: 57 MYERS STREET BENDIGO PH 03 5445 8700  
 ABN 11 103 336 358 WWW.TOMKINSON.COM

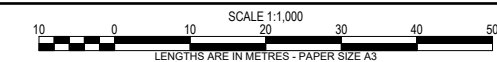

© COPYRIGHT  
 THE INFORMATION CONTAINED  
 ON THIS DRAWING IS THE  
 INTELLECTUAL PROPERTY OF  
 TOMKINSON GROUP. COPYING  
 OR USING THIS DRAWING IN  
 WHOLE OR IN PART WITHOUT  
 THE EXPRESS WRITTEN  
 PERMISSION OF TOMKINSON  
 GROUP INFRINGES COPYRIGHT



**IMAGINE STAGE 18**  
**SOMERSET PARK ROAD STRATHFIELDSAYE**  
**CUT & FILL DEPTH RANGE & LOT LEVELS**  
 CITY OF GREATER BENDIGO REF: DS/188/2016  
 STRATHFIELDSAYE HOLDINGS PTY LTD  
 DWG STATUS: **PRELIMINARY**  
 PROJECT & DWG No: 1065318R05 / 17 A

NOTE: THIS IS AN UNCONTROLLED DOCUMENT AND WILL NOT BE UPDATED. IT IS THE RESPONSIBILITY OF THE USER TO CONFIRM THAT THIS IS A CURRENT COPY AND SUITABLE FOR THE PROPOSED USE. THIS SHEET MUST BE READ IN CONJUNCTION WITH ALL SHEETS OF THIS SET AND ANY ACCOMPANYING DOCUMENTS. PLOT DATE: 04/05/2023 FILE: C:\TZD\DATA\TOMKINSON\STRATHFIELDSAYE - IMAGINE STAGE 18 - 06839ENG000\CURRENT\1065318 R-00 CTN PLANS REV A.DWG

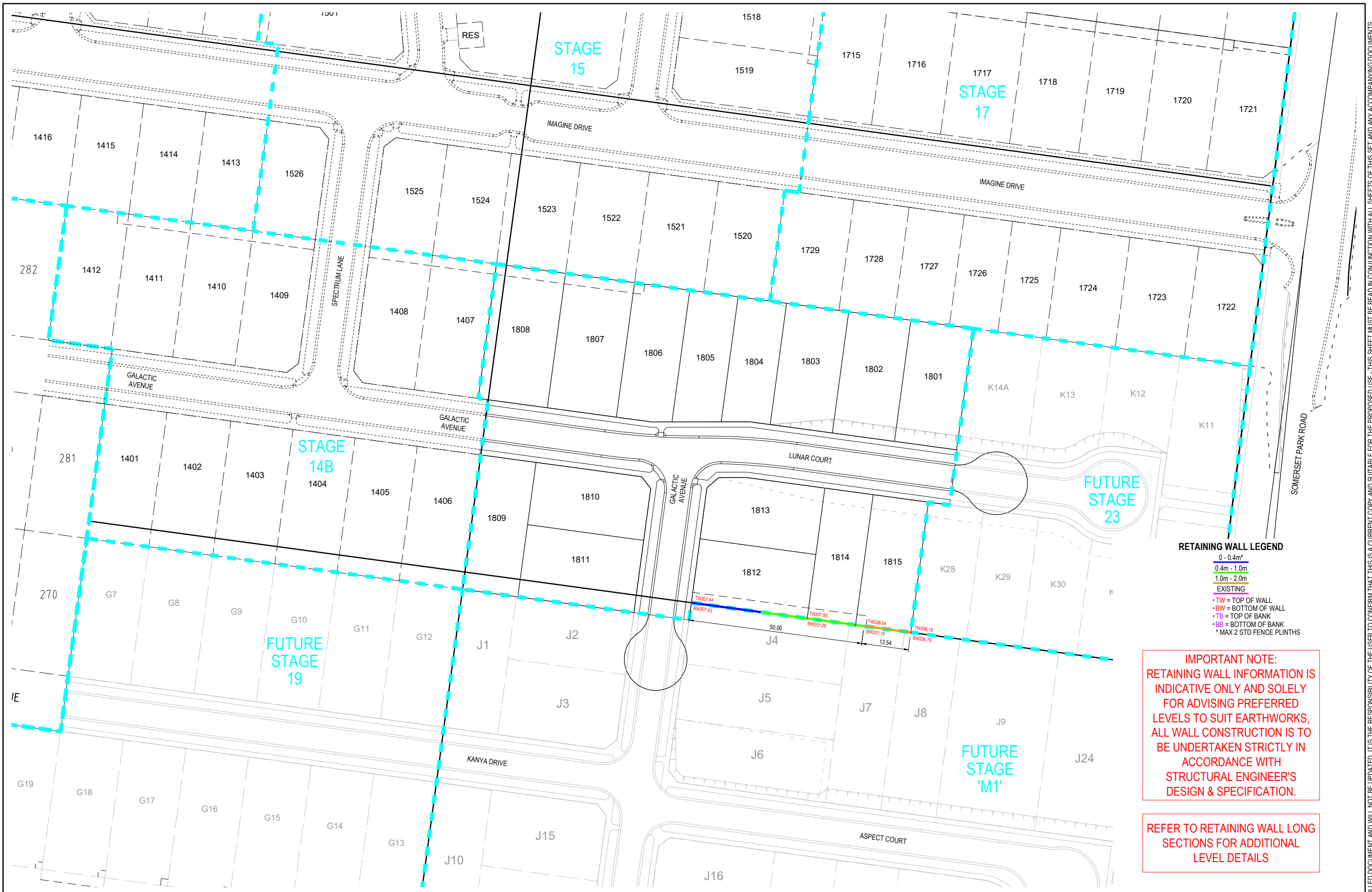

**RETAINING WALL LEGEND**

|             |
|-------------|
| 0 - 0.4m    |
| 0.4m - 1.0m |
| 1.0m - 2.0m |
| EXISTING    |

- TW = TOP OF WALL
- BW = BOTTOM OF WALL
- TB = TOP OF BANK
- BB = BOTTOM OF BANK
- \* MAX 2 STD FENCE PLINTHS

**IMPORTANT NOTE:**  
 RETAINING WALL INFORMATION IS INDICATIVE ONLY AND SOLELY FOR ADVISING PREFERRED LEVELS TO SUIT EARTHWORKS, ALL WALL CONSTRUCTION IS TO BE UNDERTAKEN STRICTLY IN ACCORDANCE WITH STRUCTURAL ENGINEER'S DESIGN & SPECIFICATION.

REFER TO RETAINING WALL LONG SECTIONS FOR ADDITIONAL LEVEL DETAILS

**DRAFT**

|     |                         |     |     |     |      |          |
|-----|-------------------------|-----|-----|-----|------|----------|
| A   | AS SUBMITTED TO COUNCIL | NJB | SA  | X   | X    | xx/xx/xx |
| REV | REVISION                | DES | DWG | CHK | AUTH | DATE     |



**Tomkinson**  
 SURVEY • ENGINEERING • PLANNING • PROJECT MANAGEMENT  
 HEAD OFFICE: 57 MYERS STREET BENDIGO PH 03 5445 8700  
 ABN 11 103 336 358 WWW.TOMKINSON.COM



SCALE 1:1,000  
 LENGTHS ARE IN METRES - PAPER SIZE A3

© COPYRIGHT THE INFORMATION CONTAINED ON THIS DRAWING IS THE INTELLECTUAL PROPERTY OF TOMKINSON GROUP. COPYING OR USING THIS DRAWING IN WHOLE OR IN PART WITHOUT THE EXPRESS WRITTEN PERMISSION OF TOMKINSON GROUP INFRINGES COPYRIGHT

**DIAL BEFORE YOU DIG**  
 www.100.com.au

COMPASS ASSURANCE  
 ISO 9001 QUALITY

**IMAGINE STAGE 18**  
**SOMERSET PARK ROAD STRATHFIELDSAYE**  
 RETAINING WALL PLAN  
 CITY OF GREATER BENDIGO REF: DS/188/2016  
 STRATHFIELDSAYE HOLDINGS PTY LTD  
 DWG STATUS: **PRELIMINARY**  
 PROJECT & DWG No: 1065318R06 / 17 A

NOTE: THIS IS AN UNCONTROLLED DOCUMENT AND WILL NOT BE UPDATED. IT IS THE RESPONSIBILITY OF THE USER TO CONFIRM THAT THIS IS A CURRENT COPY AND SUITABLE FOR THE PROPOSED USE. THIS SHEET MUST BE READ IN CONJUNCTION WITH ALL SHEETS OF THIS SET AND ANY ACCOMPANYING DOCUMENTS. PLOT DATE: 04/05/2023 FILE: C:\TZ\DATA\TOMKINSON\1205011065318 - STRATHFIELDSAYE - IMAGINE STAGE 18 - 06839ENG000\CAD\CURRENT\1065318 R-D CTN PLANS REV A.DWG

| 250mm DEPTH PAVEMENT |                      |   |
|----------------------|----------------------|---|
| PAVEMENT LAYER       | LAYER THICKNESS (mm) | MATERIAL  |
| 1 WEARING COURSE     | 30                   | SIZE 10 TYPE N ASPHALT                                      |
| 2 PRIME              |                      |   |
| 3 BASE COURSE        | 110                  | 20mm NOM. SIZE CLASS 2 FINE CRUSHED ROCK (SEE NOTE B BELOW) |
| 4 SUBBASE COURSE     | 110                  | 40mm NOM. SIZE CLASS 3 FINE CRUSHED ROCK (SEE NOTE C BELOW) |
| 5 SUBGRADE           | 200                  | SUBGRADE STABILISATION 3% LIME (MINIMUM CBR 8)              |

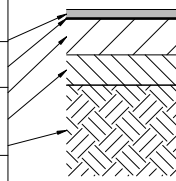

| TEMPORARY GRAVEL PAVEMENT |                      |  |
|---------------------------|----------------------|--|
| PAVEMENT LAYER            | LAYER THICKNESS (mm) | MATERIAL                                 |
| 1 BASE COURSE             | 100                  | 20mm NOM. SIZE CLASS 2 FINE CRUSHED ROCK |

PAVEMENT DESIGN  
SUBJECT TO  
GEOTECHNICAL  
INVESTIGATION

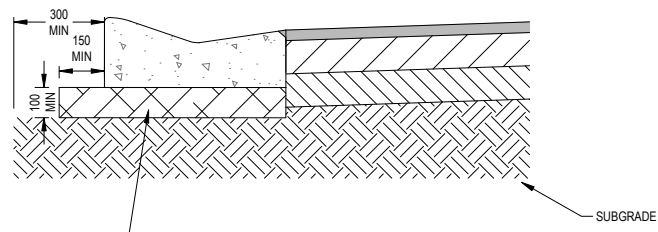

100mm MINIMUM COMPACTED DEPTH OF CLASS 3, 20mm FCR BEDDING TO 97% MMD OR EXTENSION OF ROAD PAVEMENT LAYERS, WHICH EVER IS GREATER

**SM2-M KERB & CHANNEL INSTALLATION**  
250mm DEPTH PAVEMENT  
SCALE 1:25 (A3)

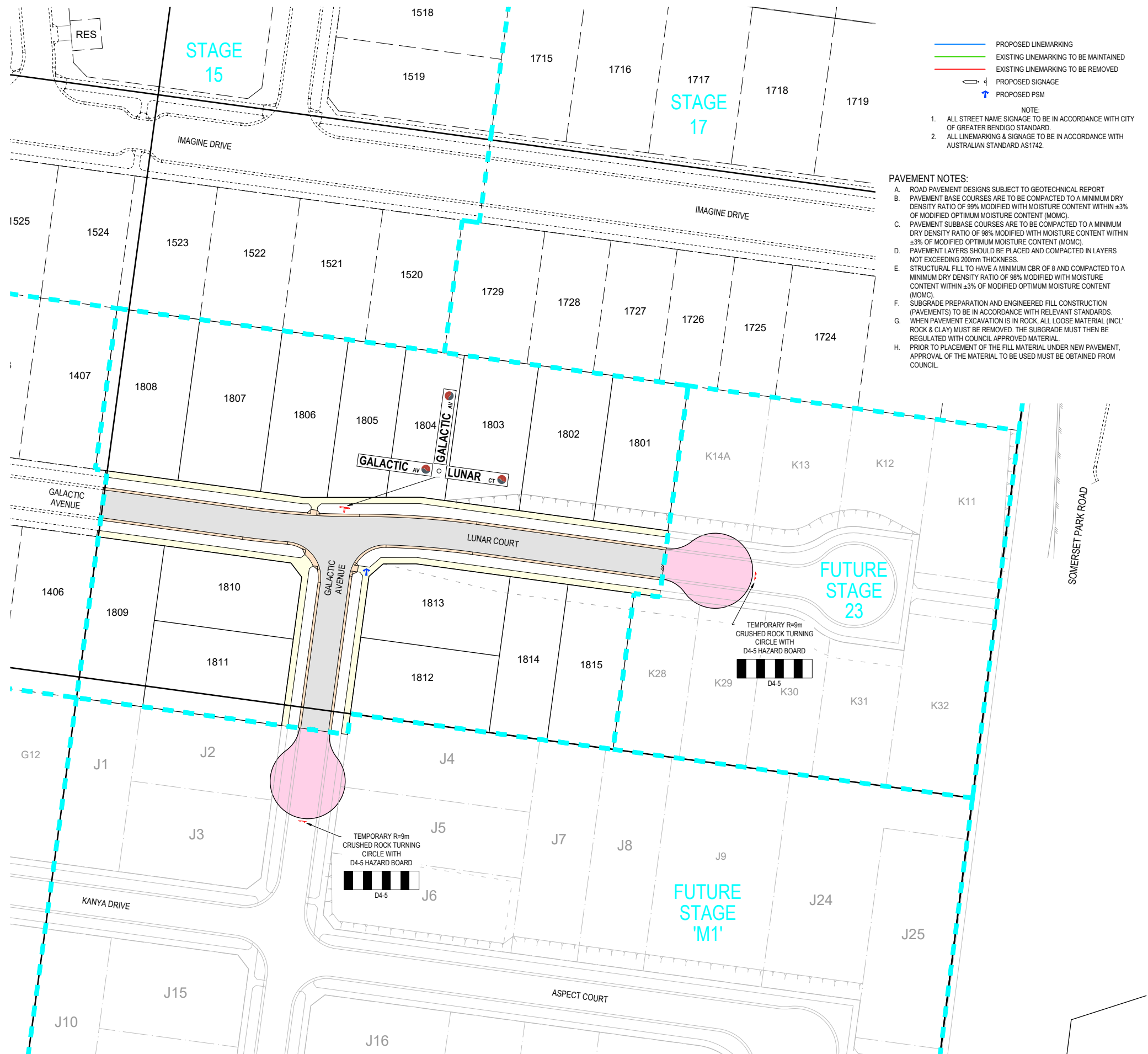

- PROPOSED LINEMARKING
- EXISTING LINEMARKING TO BE MAINTAINED
- EXISTING LINEMARKING TO BE REMOVED
- PROPOSED SIGNAGE
- PROPOSED PSM

NOTE:  
1. ALL STREET NAME SIGNAGE TO BE IN ACCORDANCE WITH CITY OF GREATER BENDIGO STANDARD.  
2. ALL LINEMARKING & SIGNAGE TO BE IN ACCORDANCE WITH AUSTRALIAN STANDARD AS1742.

- PAVEMENT NOTES:**
- A. ROAD PAVEMENT DESIGNS SUBJECT TO GEOTECHNICAL REPORT
  - B. PAVEMENT BASE COURSES ARE TO BE COMPACTED TO A MINIMUM DRY DENSITY RATIO OF 99% MODIFIED WITH MOISTURE CONTENT WITHIN ±3% OF MODIFIED OPTIMUM MOISTURE CONTENT (MOMC)
  - C. PAVEMENT SUBBASE COURSES ARE TO BE COMPACTED TO A MINIMUM DRY DENSITY RATIO OF 98% MODIFIED WITH MOISTURE CONTENT WITHIN ±3% OF MODIFIED OPTIMUM MOISTURE CONTENT (MOMC)
  - D. PAVEMENT LAYERS SHOULD BE PLACED AND COMPACTED IN LAYERS NOT EXCEEDING 200mm THICKNESS.
  - E. STRUCTURAL FILL TO HAVE A MINIMUM CBR OF 8 AND COMPACTED TO A MINIMUM DRY DENSITY RATIO OF 98% MODIFIED WITH MOISTURE CONTENT WITHIN ±3% OF MODIFIED OPTIMUM MOISTURE CONTENT (MOMC)
  - F. SUBGRADE PREPARATION AND ENGINEERED FILL CONSTRUCTION (PAVEMENTS) TO BE IN ACCORDANCE WITH RELEVANT STANDARDS.
  - G. WHEN PAVEMENT EXCAVATION IS IN ROCK, ALL LOOSE MATERIAL (INCL. ROCK & CLAY) MUST BE REMOVED. THE SUBGRADE MUST THEN BE REGULATED WITH COUNCIL APPROVED MATERIAL.
  - H. PRIOR TO PLACEMENT OF THE FILL MATERIAL UNDER NEW PAVEMENT, APPROVAL OF THE MATERIAL TO BE USED MUST BE OBTAINED FROM COUNCIL.

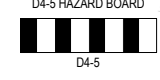
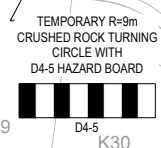

DRAFT



**Tomkinson**  
SURVEY • ENGINEERING • PLANNING • PROJECT MANAGEMENT  
HEAD OFFICE: 57 MYERS STREET BENDIGO PH 03 5445 8700  
ABN 11 103 336 358 WWW.TOMKINSON.COM



SCALE 1:1,000  
LENGTHS ARE IN METRES - PAPER SIZE A3

© COPYRIGHT THE INFORMATION CONTAINED ON THIS DRAWING IS THE INTELLECTUAL PROPERTY OF TOMKINSON GROUP. COPYING OR USING THIS DRAWING IN WHOLE OR IN PART WITHOUT THE EXPRESS WRITTEN PERMISSION OF TOMKINSON GROUP INFRINGES COPYRIGHT

**IMAGINE STAGE 18**  
**SOMERSET PARK ROAD STRATHFIELDSAYE**  
**PAVEMENT, SIGNAGE & LINEMARKING PLAN**  
CITY OF GREATER BENDIGO REF: DS/188/2016  
STRATHFIELDSAYE HOLDINGS PTY LTD  
DWG STATUS: **PRELIMINARY** PROJECT & DWG No: 1065318R07 / 17 A

|     |                         |                     |     |     |     |      |      |
|-----|-------------------------|---------------------|-----|-----|-----|------|------|
| REV | AS SUBMITTED TO COUNCIL | NJB SA X X xx/xx/xx | DES | DWG | CHK | AUTH | DATE |
|     |                         |                     |     |     |     |      |      |

NOTE: THIS IS AN UNCONTROLLED DOCUMENT AND WILL NOT BE UPDATED. IT IS THE RESPONSIBILITY OF THE USER TO CONFIRM THAT THIS IS A CURRENT COPY AND SUITABLE FOR THE PROPOSED USE. THIS SHEET MUST BE READ IN CONJUNCTION WITH ALL SHEETS OF THIS SET AND ANY ACCOMPANYING DOCUMENTS. PLOT DATE: 04/05/2023 FILE: C:\TZD\DATA\TOMKINSON\STRATHFIELDSAYE - STRATHFIELDSAYE - IMAGINE STAGE 18 - 06839ENGIN000\CAD\CURRENT\1065318 R-D CTN PLANS REV A.DWG



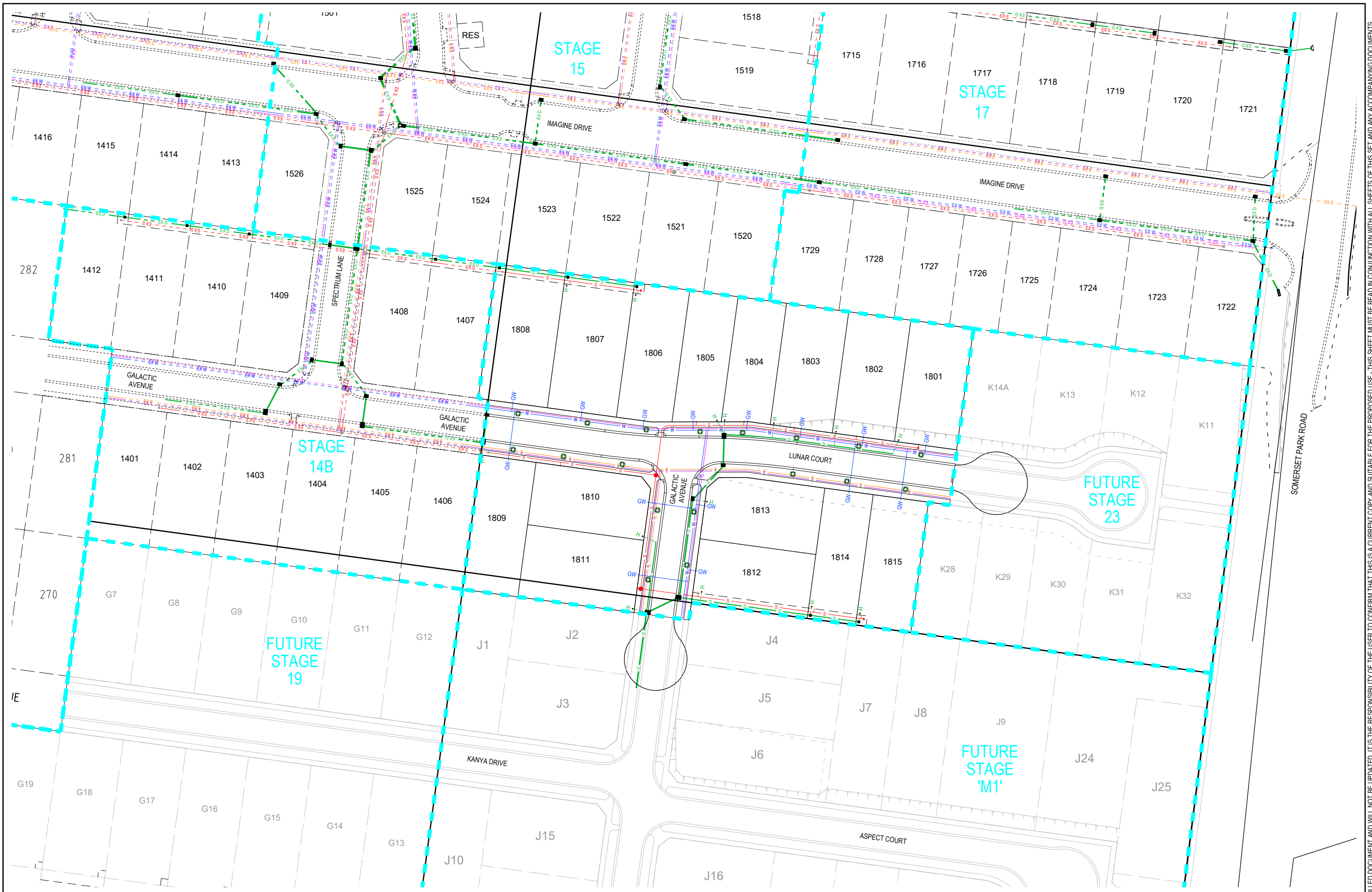

**DRAFT**

|     |                         |     |      |      |   |          |
|-----|-------------------------|-----|------|------|---|----------|
| REV | AS SUBMITTED TO COUNCIL | NJB | SA   | X    | X | xx/xx/xx |
| DES | DWG                     | CHK | AUTH | DATE |   |          |



HEAD OFFICE: 57 MYERS STREET BENDIGO PH 03 5445 8700  
 ABN 11 103 336 358 WWW.TOMKINSON.COM

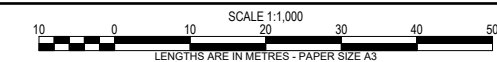

© COPYRIGHT  
 THE INFORMATION CONTAINED  
 ON THIS DRAWING IS THE  
 INTELLECTUAL PROPERTY OF  
 TOMKINSON GROUP. COPYING  
 OR USING THIS DRAWING IN  
 WHOLE OR IN PART WITHOUT  
 THE EXPRESS WRITTEN  
 PERMISSION OF TOMKINSON  
 GROUP INFRINGES COPYRIGHT



**IMAGINE STAGE 18  
 SOMERSET PARK ROAD STRATHFIELDSAYE  
 STREET TREE CONCEPT PLAN**

CITY OF GREATER BENDIGO REF: DS/188/2016  
 STRATHFIELDSAYE HOLDINGS PTY LTD

DWG STATUS: **PRELIMINARY** PROJECT & DWG No: 1065318R08 / 17 A

NOTE: THIS IS AN UNCONTROLLED DOCUMENT AND WILL NOT BE UPDATED. IT IS THE RESPONSIBILITY OF THE USER TO CONFIRM THAT THIS IS A CURRENT COPY AND SUITABLE FOR THE PROPOSED USE. THIS SHEET MUST BE READ IN CONJUNCTION WITH ALL SHEETS OF THIS SET AND ANY ACCOMPANYING DOCUMENTS.  
 PLOT DATE: 04/05/2023 FILE: C:\TZD\DATA\TOMKINSON\STRATHFIELDSAYE - IMAGINE STAGE 18 - 26839ENGIN000\CURRENT\1065318 R-D CTN PLANS REV A.DWG



- GENERAL DESIGN DETAIL PLAN NOTES**  
 APPLIES IN ALL CASES UNLESS STATED OTHERWISE
- KERB TYPES:
    - FRONTING LOTS = MODIFIED SM2 (IDM SD 100 - SM2-M)
    - FRONTING RESERVES = B4 AS PER CoGB SD190
  - ALL KERB RETURNS ARE 8.0m RADIUS TO BACK
  - ALL DRIVEWAYS AS PER IDM SD 240 & 245
  - ALL FOOTPATHS CONCRETE & 1.5m WIDE @ 0.05m O/S AS PER IDM SD 205
  - ALL SHARED PATHS CONCRETE & 2.5m WIDE @ 0.10m O/S BL AS PER IDM SD 205
  - ALL EASEMENT DRAINAGE PIPES & PITS ARE 1.0m O/S BL & SIDE BOUNDARIES
  - LEVEL 1 SUPERVISION REQUIRED FOR LOT EARTHWORKS UNLESS SPECIFIED OTHERWISE - REFER GENERAL NOTES
  - ALL LOTS TO HAVE CATCH DRAINS ALONG SIDE & REAR BOUNDARIES
  - CONTOUR INTERVAL 0.5m @ 1:1000 & 0.05m @ 1:200 / 1:250(A3) WHERE SHOWN

**WARNING**  
 BEWARE OF UNDERGROUND SERVICES  
 THE LOCATIONS OF UNDERGROUND SERVICES ARE APPROXIMATE ONLY AND THEIR EXACT POSITION SHOULD BE PROVEN ON SITE. NO GUARANTEE IS GIVEN THAT ALL EXISTING SERVICES ARE SHOWN.

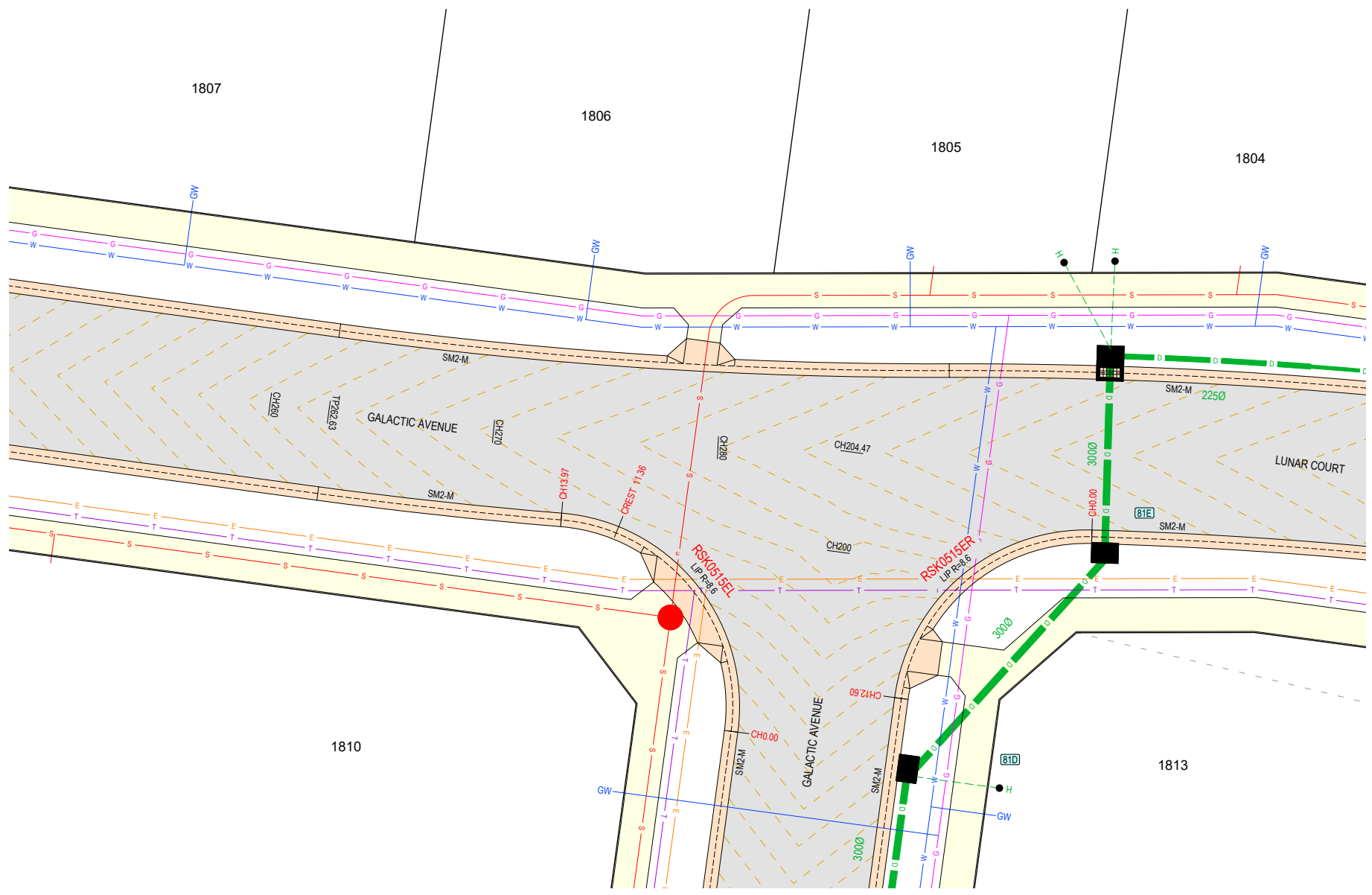

**RSK0515EL**  
 SCALE H 1:250 V 1:50

| CHAINAGE            | 208.23 | 208.29 | 208.33 | 208.34 | 208.36 | 208.42 | 208.46 | 208.47 | 208.47 | 208.47 | 208.41 |
|---------------------|--------|--------|--------|--------|--------|--------|--------|--------|--------|--------|--------|
| DESIGN LIP OF KERB  | 208.23 | 208.29 | 208.33 | 208.34 | 208.36 | 208.42 | 208.46 | 208.47 | 208.47 | 208.47 | 208.41 |
| DESIGN BACK OF KERB | 208.23 | 208.29 | 208.33 | 208.34 | 208.36 | 208.42 | 208.46 | 208.47 | 208.47 | 208.47 | 208.41 |

**RSK0515ER**  
 SCALE H 1:250 V 1:50

| CHAINAGE            | 208.77 | 208.73 | 208.69 | 208.65 | 208.62 | 208.58 | 208.54 | 208.52 | 208.44 | 208.39 | 208.37 | 208.35 | 208.28 | 208.26 |
|---------------------|--------|--------|--------|--------|--------|--------|--------|--------|--------|--------|--------|--------|--------|--------|
| DESIGN LIP OF KERB  | 208.77 | 208.73 | 208.69 | 208.65 | 208.62 | 208.58 | 208.54 | 208.52 | 208.44 | 208.39 | 208.37 | 208.35 | 208.28 | 208.26 |
| DESIGN BACK OF KERB | 208.77 | 208.73 | 208.69 | 208.65 | 208.62 | 208.58 | 208.54 | 208.52 | 208.44 | 208.39 | 208.37 | 208.35 | 208.28 | 208.26 |

**DRAFT**



**Tomkinson**  
 SURVEY > ENGINEERING > PLANNING > PROJECT MANAGEMENT  
 HEAD OFFICE: 57 MYERS STREET BENDIGO PH 03 5445 8700  
 ABN 11 103 336 358 WWW.TOMKINSON.COM



SCALE 1:250  
 LENGTHS ARE IN METRES - PAPER SIZE A3

© COPYRIGHT THE INFORMATION CONTAINED ON THIS DRAWING IS THE INTELLECTUAL PROPERTY OF TOMKINSON GROUP. COPYING OR USING THIS DRAWING IN WHOLE OR IN PART WITHOUT THE EXPRESS WRITTEN PERMISSION OF TOMKINSON GROUP INFRINGES COPYRIGHT

**DIAL BEFORE YOU DIG**  
 www.1100.com.au

COMPASS ASSURANCE  
 ISO 9001 QUALITY

**IMAGINE STAGE 18**  
**SOMERSET PARK ROAD STRATHFIELDSAYE**  
**INTERSECTION DETAIL**  
 CITY OF GREATER BENDIGO REF: DS/188/2016  
 STRATHFIELDSAYE HOLDINGS PTY LTD  
 DWG STATUS: **PRELIMINARY**  
 PROJECT & DWG No: 1065318R09 / 17 A

| REV | AS SUBMITTED TO COUNCIL | DES | DWG | CHK | AUTH | DATE     |
|-----|-------------------------|-----|-----|-----|------|----------|
|     |                         | NJB | SA  | X   | X    | xx/xx/xx |

NOTE: THIS IS AN UNCONTROLLED DOCUMENT AND WILL NOT BE UPDATED. IT IS THE RESPONSIBILITY OF THE USER TO CONFIRM THAT THIS IS A CURRENT COPY AND SUITABLE FOR THE PROPOSED USE. THIS SHEET MUST BE READ IN CONJUNCTION WITH ALL SHEETS OF THIS SET AND ANY ACCOMPANYING DOCUMENTS.  
 PLOT DATE: 04/05/2023 FILE: C:\TZD\DATA\TOMKINSON\1065318 - STRATHFIELDSAYE - IMAGINE STAGE 18 - 065318R09\CURRENT\1065318 R-D CTN PLANS REV A.DWG

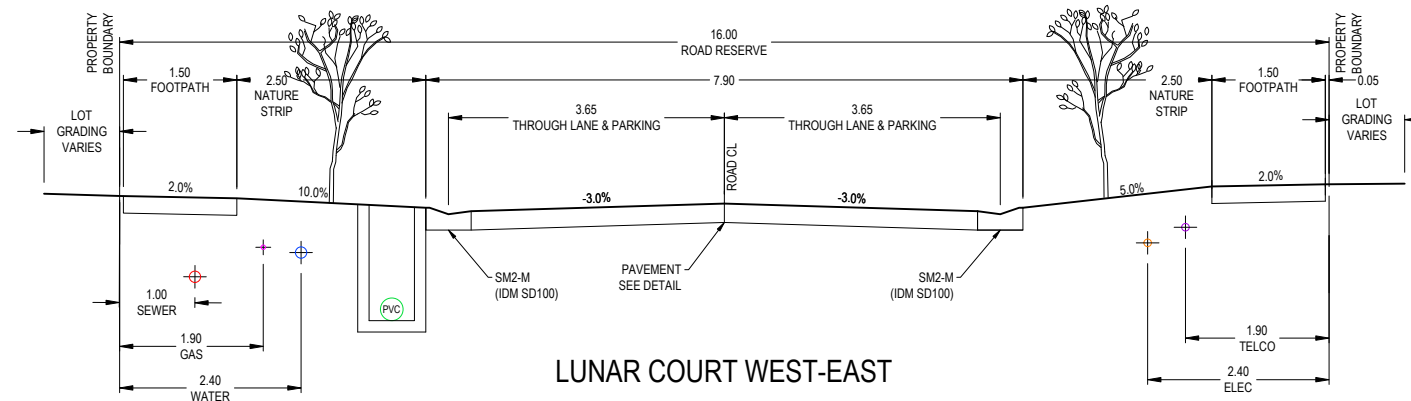
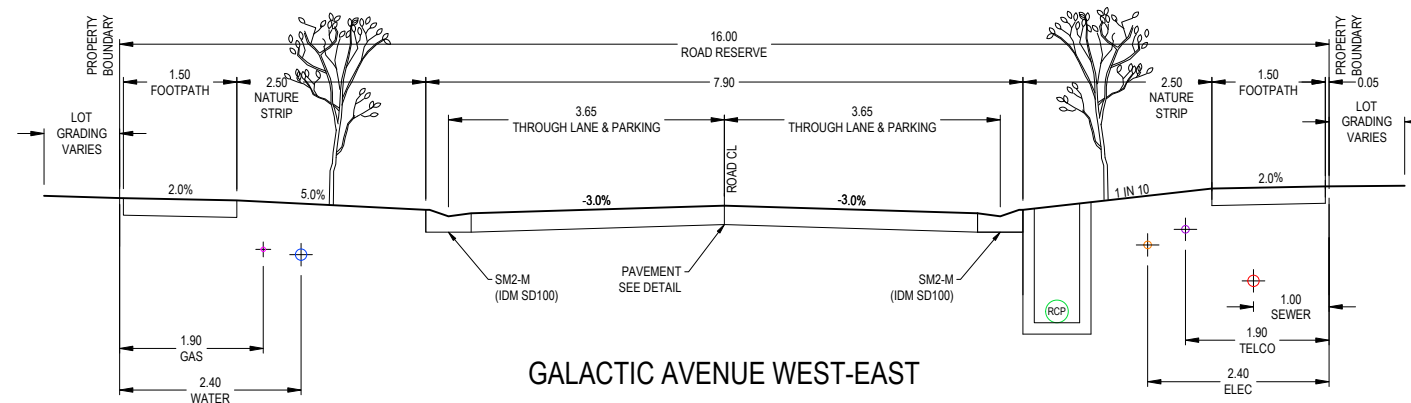
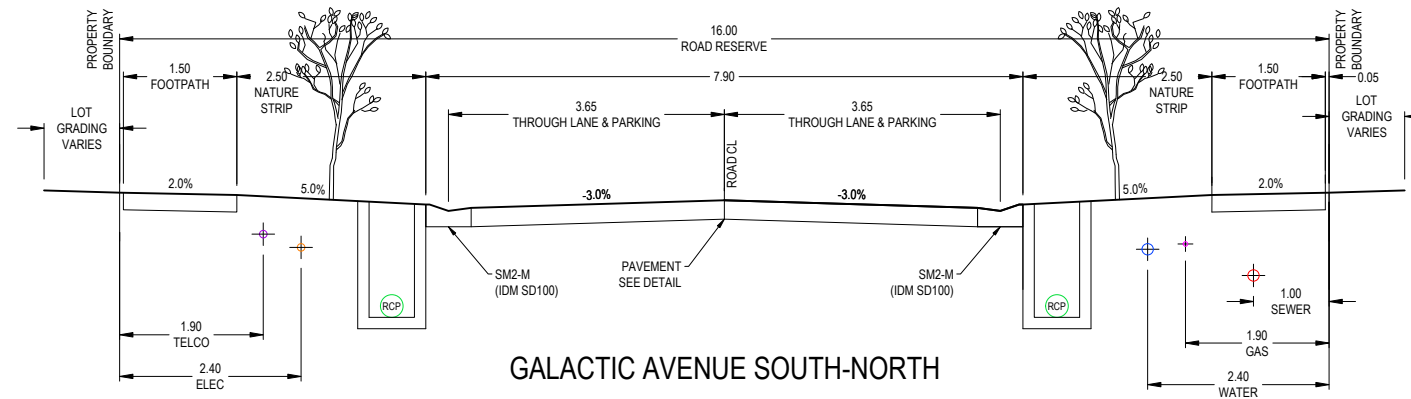

**DRAFT**

AS SUBMITTED TO COUNCIL  
 NJB SA X X xx/xx/xx  
 DES DWG CHK AUTH DATE



**Tomkinson**  
 SURVEY > ENGINEERING > PLANNING > PROJECT MANAGEMENT  
 HEAD OFFICE: 57 MYERS STREET BENDIGO PH 03 5445 8700  
 ABN 11 103 336 358 WWW.TOMKINSON.COM

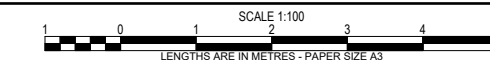

© COPYRIGHT  
 THE INFORMATION CONTAINED  
 ON THIS DRAWING IS THE  
 INTELLECTUAL PROPERTY OF  
 TOMKINSON GROUP. COPYING  
 OR USING THIS DRAWING IN  
 WHOLE OR IN PART WITHOUT  
 THE EXPRESS WRITTEN  
 PERMISSION OF TOMKINSON  
 GROUP INFRINGES COPYRIGHT



**IMAGINE STAGE 18**  
**SOMERSET PARK ROAD STRATHFIELDSAYE**  
 TYPICAL SECTIONS  
 CITY OF GREATER BENDIGO REF: DS/188/2016  
 STRATHFIELDSAYE HOLDINGS PTY LTD  
 DWG STATUS: **PRELIMINARY**  
 PROJECT & DWG No: 1065318R10 / 17 A

NOTE: THIS IS AN UNCONTROLLED DOCUMENT AND WILL NOT BE UPDATED. IT IS THE RESPONSIBILITY OF THE USER TO CONFIRM THAT THIS IS A CURRENT COPY AND SUITABLE FOR THE PROPOSED USE. THIS SHEET MUST BE READ IN CONJUNCTION WITH ALL SHEETS OF THIS SET AND ANY ACCOMPANYING DOCUMENTS.  
 PLOT DATE: 04/05/2023 FILE: C:\TZD\DATA\TOMKINSON\STRATHFIELDSAYE - STRATHFIELDSAYE - IMAGINE STAGE 18 - 0639ENGIN000CAD\CURRENT\1065318 R-D CTN PLANS REV A.DWG





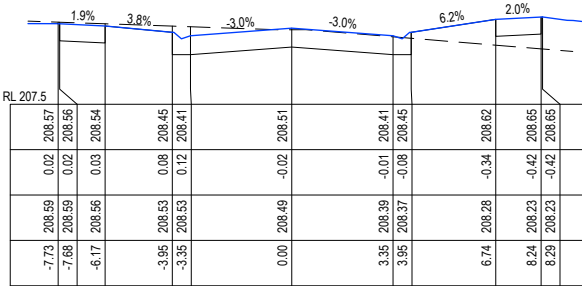

CH 273.32

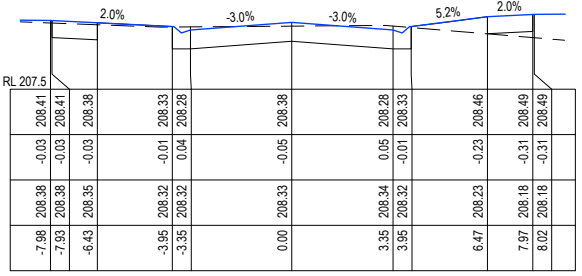

CH 265.51

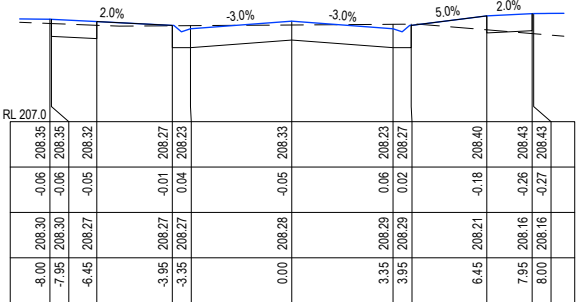

CH 262.63

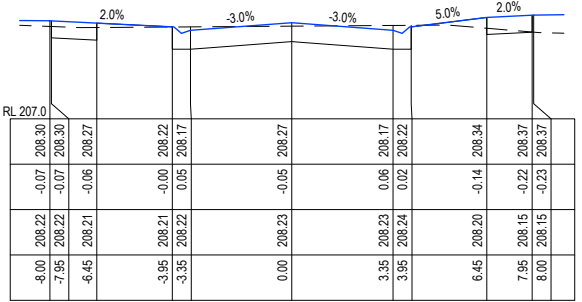

CH 259.9

|                | 0.00   | 0.25   | 0.50   | 0.75   | 1.00   | 1.25   | 1.50   | 1.75   | 2.00   |
|----------------|--------|--------|--------|--------|--------|--------|--------|--------|--------|
| DESIGN SURFACE | -8.00  | -7.95  | -7.90  | -7.85  | -7.80  | -7.75  | -7.70  | -7.65  | -7.60  |
| CUT/FILL       | -0.10  | -0.10  | -0.07  | -0.05  | -0.04  | -0.03  | -0.02  | -0.01  | 0.00   |
| EXIST SURFACE  | 207.96 | 207.95 | 207.94 | 207.93 | 207.92 | 207.91 | 207.90 | 207.89 | 207.88 |
| OFFSETS        | -7.95  | -7.90  | -7.85  | -7.80  | -7.75  | -7.70  | -7.65  | -7.60  | -7.55  |

CH 250

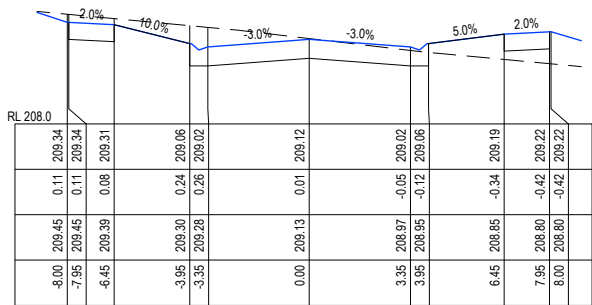

CH 317.95

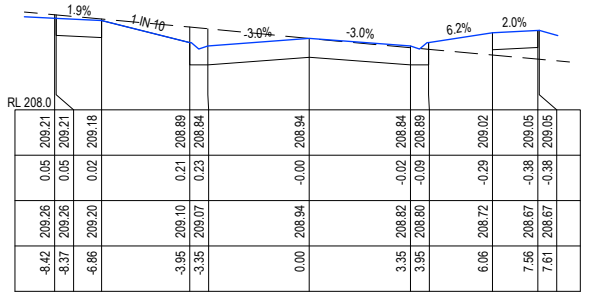

CH 305.3

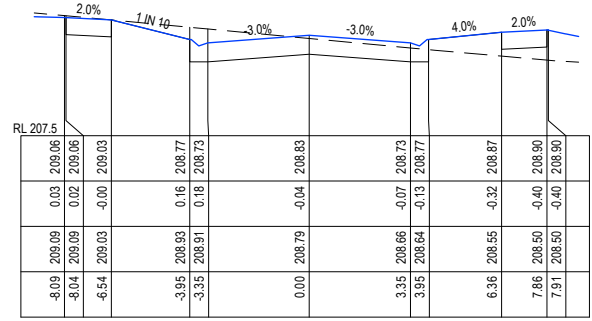

CH 296.72

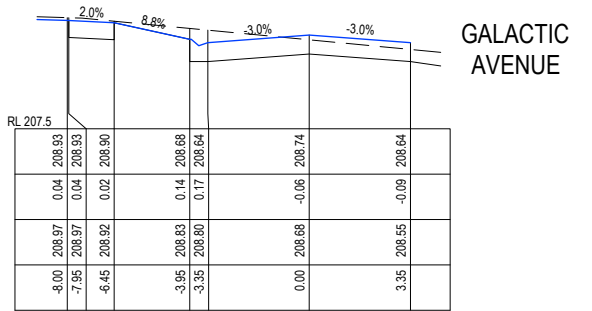

CH 290.29

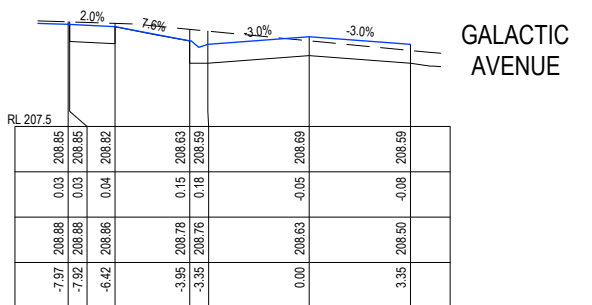

CH 286.4

GALACTIC AVENUE

GALACTIC AVENUE

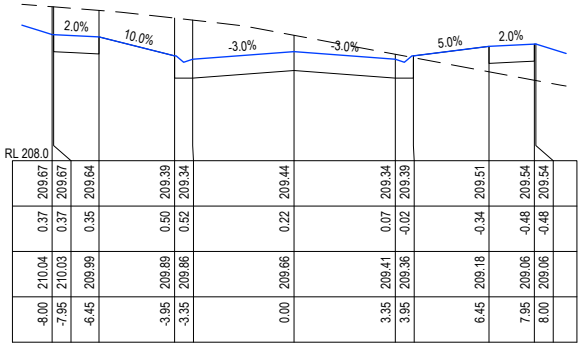

CH 341.62

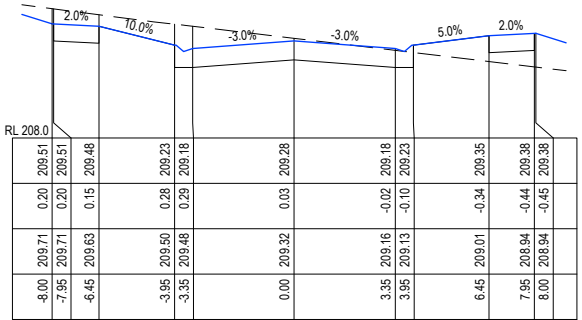

CH 330

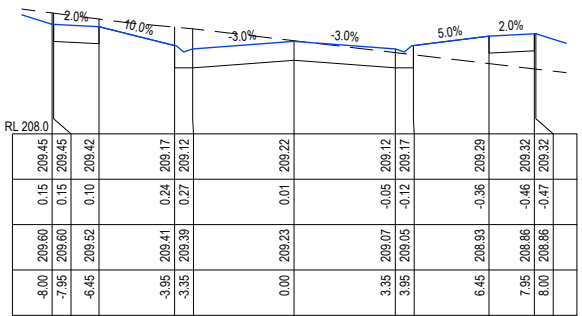

CH 325.62

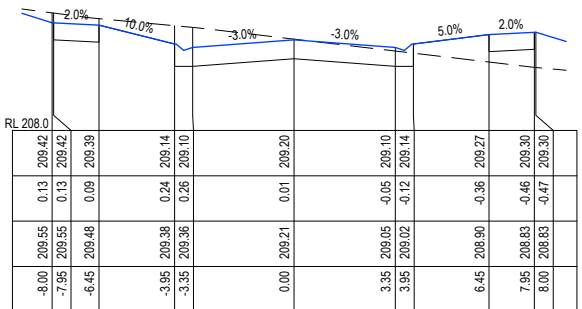

CH 323.78

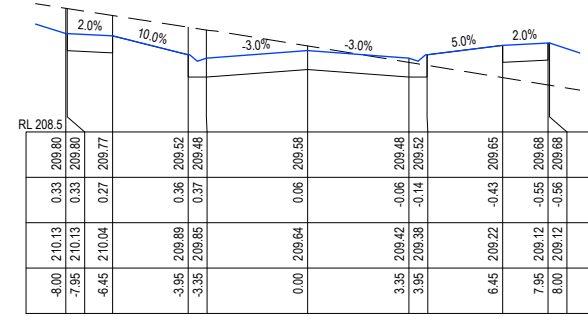

CH 363.78

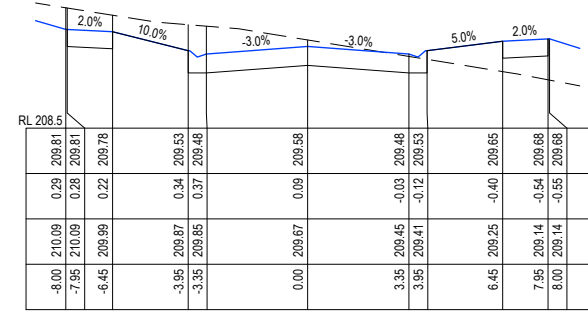

CH 357.62

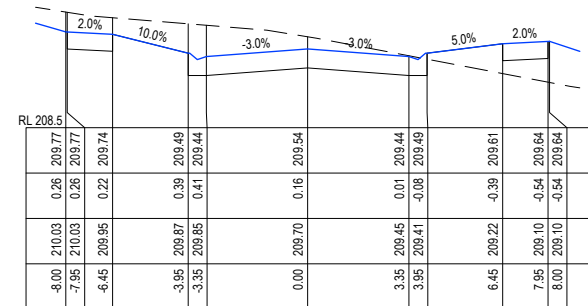

CH 350

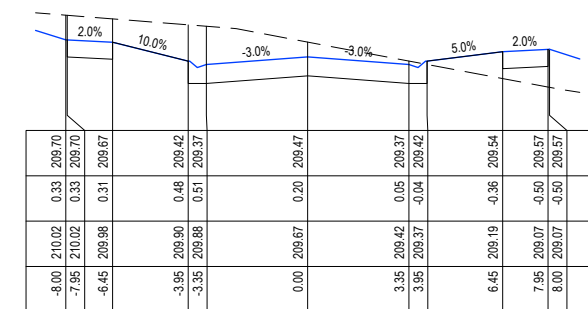

CH 343.78

DRAFT

| REV | AS SUBMITTED TO COUNCIL | REVISION | NJB | SA | X | X | xx/xx/xx |
|-----|-------------------------|----------|-----|----|---|---|----------|
|-----|-------------------------|----------|-----|----|---|---|----------|



**Tomkinson**  
SURVEY | ENGINEERING | PLANNING | PROJECT MANAGEMENT  
HEAD OFFICE: 57 MYERS STREET BENDIGO PH 03 5445 8700  
ABN 11 103 336 358 WWW.TOMKINSON.COM

*imagine*  
STRATHFIELDSAYE

SCALE H 1:250 V 1:100  
LENGTHS ARE IN METRES - PAPER SIZE A3  
© COPYRIGHT... THE INFORMATION CONTAINED ON THIS DRAWING IS THE INTELLECTUAL PROPERTY OF TOMKINSON GROUP...  
DIAL BEFORE YOU DIG www.1100.com.au  
COMPASS ASSURANCE ISO 9001 QUALITY

**IMAGINE STAGE 18**  
**SOMERSET PARK ROAD STRATHFIELDSAYE**  
**GALACTIC AV & LUNAR COURT CROSS SECTIONS**  
CITY OF GREATER BENDIGO REF: DS/188/2016  
STRATHFIELDSAYE HOLDINGS PTY LTD  
DWG STATUS: **PRELIMINARY**  
PROJECT & DWG No: 1065318R12 / 17

NOTE: THIS IS AN UNCONTROLLED DOCUMENT AND WILL NOT BE UPDATED. IT IS THE RESPONSIBILITY OF THE USER TO CONFIRM THAT THIS IS A CURRENT COPY AND SUITABLE FOR THE PROPOSED USE. THIS SHEET MUST BE READ IN CONJUNCTION WITH ALL SHEETS OF THIS SET AND ANY ACCOMPANYING DOCUMENTS.  
PLOT DATE: 04/05/2023 FILE: C:\TZD\DATA\TOMKINSON\1065318\1065318 R-D CTN PLANS REV.DWG



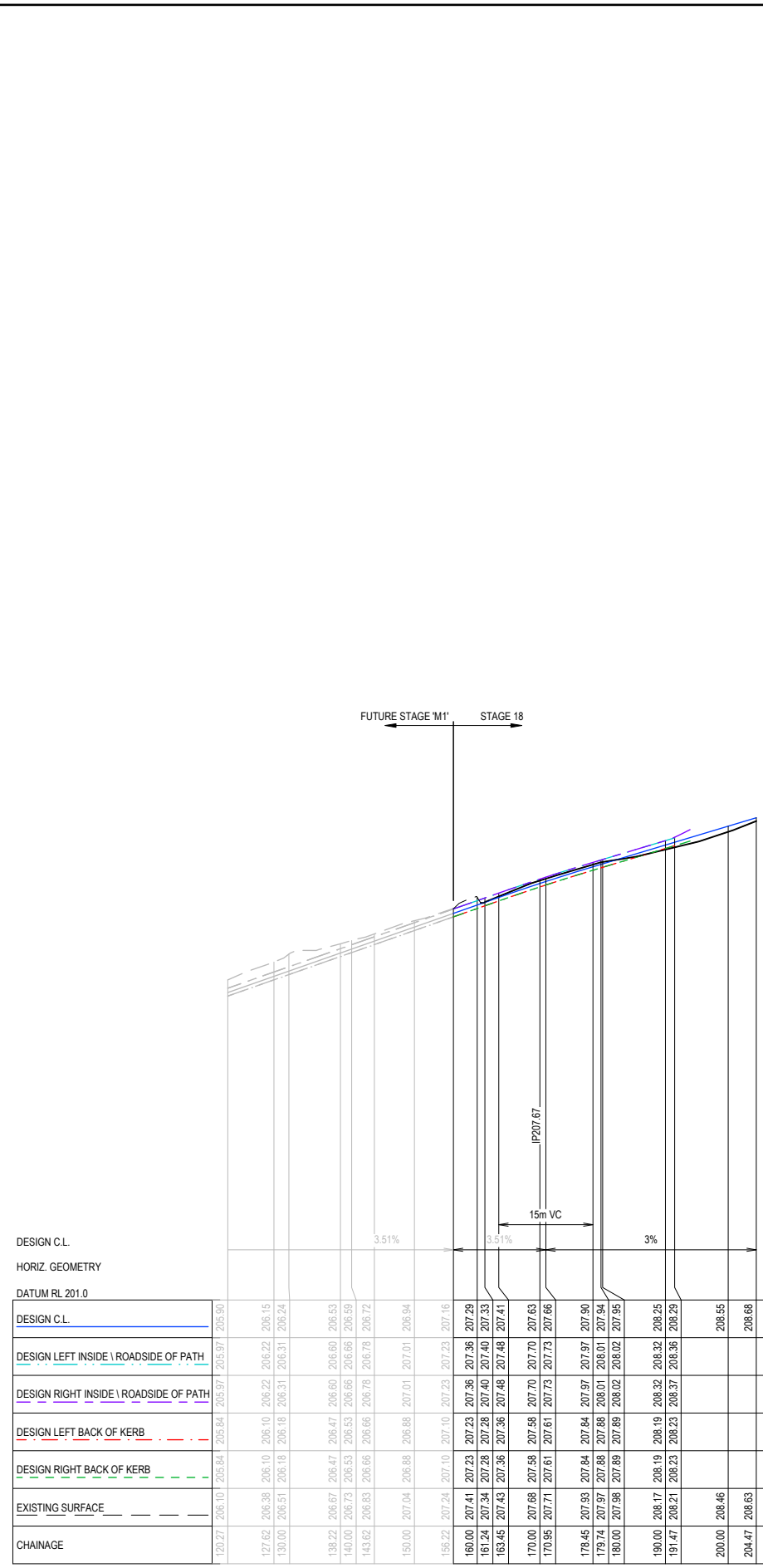

GALACTIC AV N-S  
SCALE H 1 : 1000 V 1 : 100

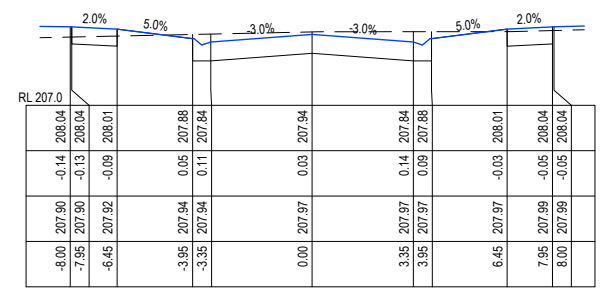

CH 179.74

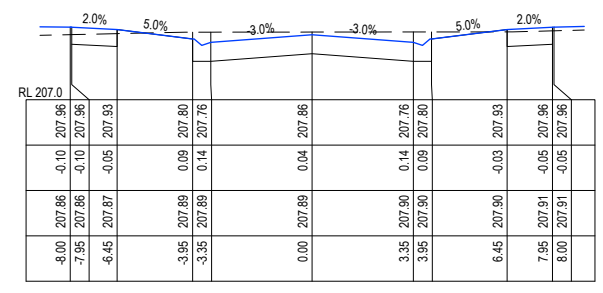

CH 177.12

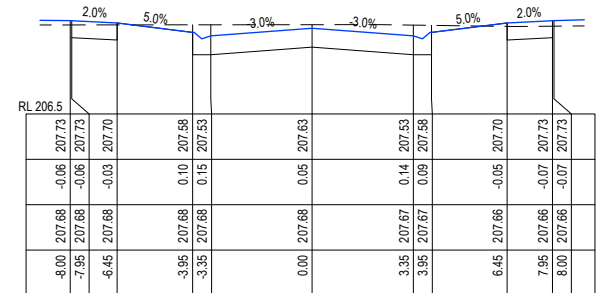

CH 170

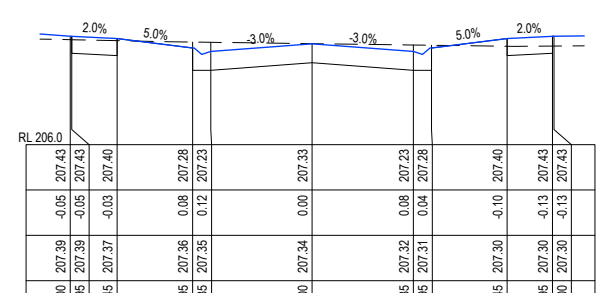

CH 161.24

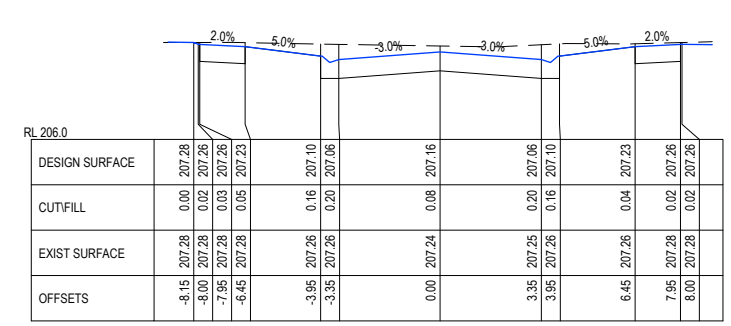

CH 156.22

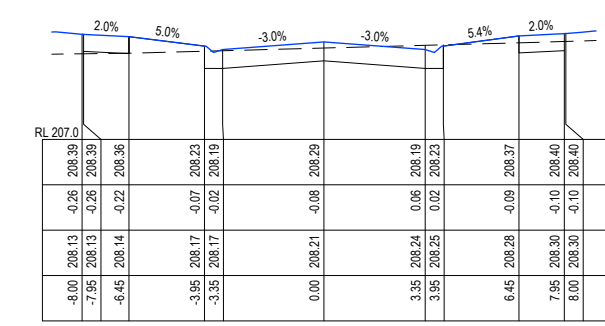

CH 191.47

GALACTIC AV N-S  
SCALE H 1 : 250 V 1 : 100

**DRAFT**

|          |   |                         |     |     |     |      |          |
|----------|---|-------------------------|-----|-----|-----|------|----------|
| REV      | A | AS SUBMITTED TO COUNCIL | NJB | SA  | X   | X    | xx/xx/xx |
| REVISION |   |                         | DES | DWG | CHK | AUTH | DATE     |

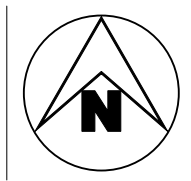

**Tomkinson**  
SURVEY • ENGINEERING • PLANNING • PROJECT MANAGEMENT  
HEAD OFFICE: 57 MYERS STREET BENDIGO PH 03 5445 8700  
ABN 11 103 336 358 WWW.TOMKINSON.COM

**imagine**  
STRATHFIELDSAYE

SCALE AS SHOWN  
LENGTHS ARE IN METRES - PAPER SIZE A3

**IMAGINE STAGE 18**  
**SOMERSET PARK ROAD STRATHFIELDSAYE**  
**GALACTIC AV (N-S) LONG & CROSS SECTIONS**  
CITY OF GREATER BENDIGO REF: DS/188/2016  
STRATHFIELDSAYE HOLDINGS PTY LTD  
DWG STATUS: **PRELIMINARY**  
PROJECT & DWG No: 1065318R13 / 17 A

NOTE: THIS IS AN UNCONTROLLED DOCUMENT AND WILL NOT BE UPDATED. IT IS THE RESPONSIBILITY OF THE USER TO CONFIRM THAT THIS IS A CURRENT COPY AND SUITABLE FOR THE PROPOSED USE. THIS SHEET MUST BE READ IN CONJUNCTION WITH ALL SHEETS OF THIS SET AND ANY ACCOMPANYING DOCUMENTS.  
PLOT DATE: 04/05/2023 FILE: C:\TZD\DATA\TOMKINSON\1065318 - STRATHFIELDSAYE - IMAGINE STAGE 18 - 06591600\CAD\CURRENT\1065318 R-D CTN PLANS REV A.DWG

NOTE: THIS IS AN UNCONTROLLED DOCUMENT AND WILL NOT BE UPDATED. IT IS THE RESPONSIBILITY OF THE USER TO CONFIRM THAT THIS IS A CURRENT COPY AND SUITABLE FOR THE PROPOSED USE. THIS SHEET MUST BE READ IN CONJUNCTION WITH ALL SHEETS OF THIS SET AND ANY ACCOMPANYING DOCUMENTS. PLOT DATE: 04/05/2023 FILE: C:\TZD\DATA\TOMKINSON\1205011065318 - STRATHFIELDSAYE - IMAGINE STAGE 18\_2639ENGIN000CAD\CURRENT\1065318 R-D CTN PLANS REV A.DWG

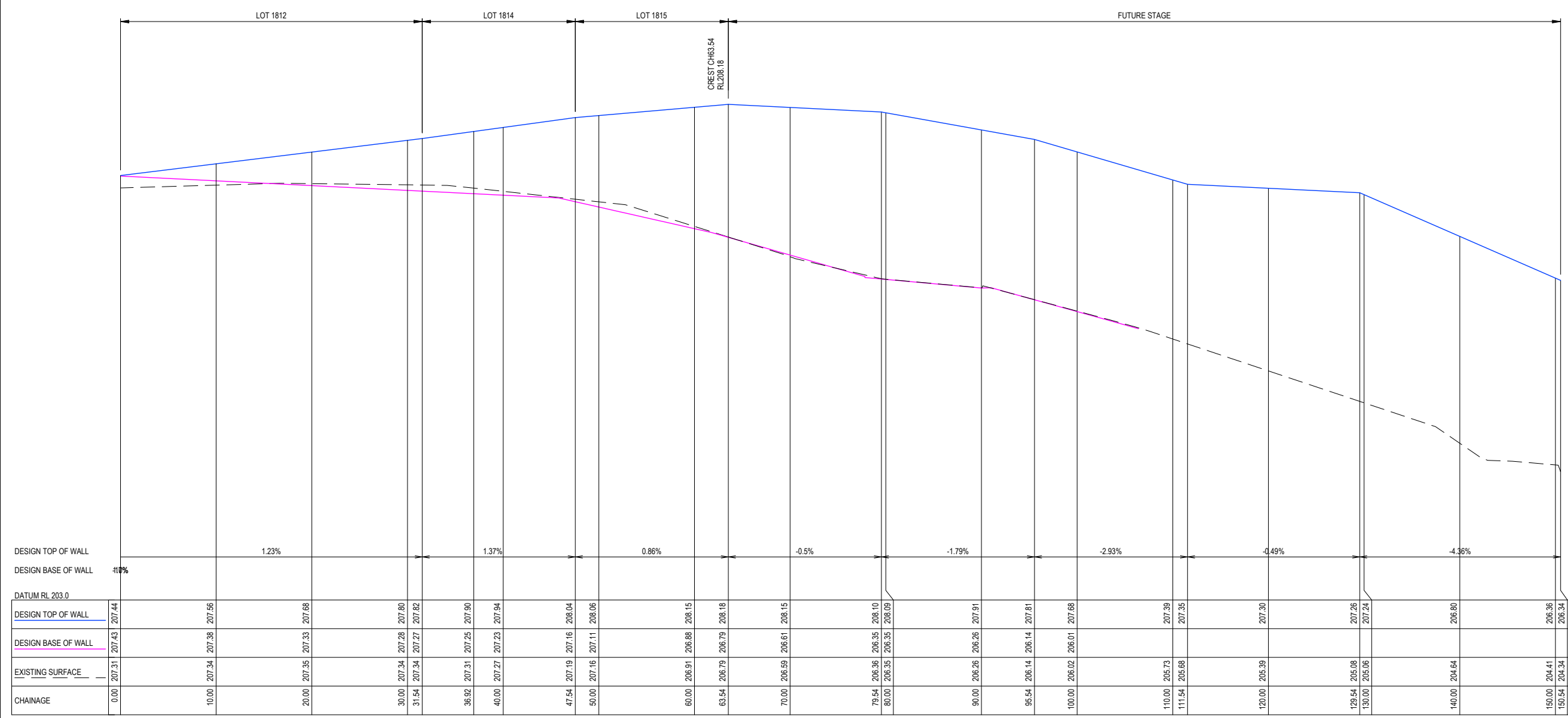

**IMPORTANT NOTE:**  
 RETAINING WALL INFORMATION IS INDICATIVE ONLY AND SOLELY FOR ADVISING PREFERRED LEVELS TO SUIT EARTHWORKS, ALL WALL CONSTRUCTION IS TO BE UNDERTAKEN STRICTLY IN ACCORDANCE WITH STRUCTURAL ENGINEER'S DESIGN & SPECIFICATION.

K24+26-32 RW  
SCALE H:1:500 V:1:50

# DRAFT

|                           |                       |
|---------------------------|-----------------------|
| A AS SUBMITTED TO COUNCIL | NJB SA X X xx/xx/xx   |
| REV                       | DES DWG CHK AUTH DATE |



**Tomkinson**  
 SURVEY > ENGINEERING > PLANNING > PROJECT MANAGEMENT  
 HEAD OFFICE: 57 MYERS STREET BENDIGO PH 03 5445 8700  
 ABN 11 103 336 358 WWW.TOMKINSON.COM



SCALE H 1:500 V 1:50

© COPYRIGHT THE INFORMATION CONTAINED ON THIS DRAWING IS THE INTELLECTUAL PROPERTY OF TOMKINSON GROUP. COPYING OR USING THIS DRAWING IN WHOLE OR IN PART WITHOUT THE EXPRESS WRITTEN PERMISSION OF TOMKINSON GROUP INFRINGES COPYRIGHT.

**IMAGINE STAGE 18**  
**SOMERSET PARK ROAD STRATHFIELDSAYE**  
**RETAINING WALL LONG SECTION**  
 CITY OF GREATER BENDIGO REF: DS/188/2016  
 STRATHFIELDSAYE HOLDINGS PTY LTD  
 DWG STATUS: **PRELIMINARY** PROJECT & DWG No: 1065318R14 / 17 A



81C 82A 82B

81A 81B 81C 81D 81E 81F TP TP 81G 81B 80A

**NOTE:**

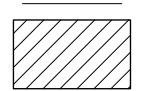

DENOTES FULL DEPTH CL3 FCR BACKFILL TO IDM STANDARDS

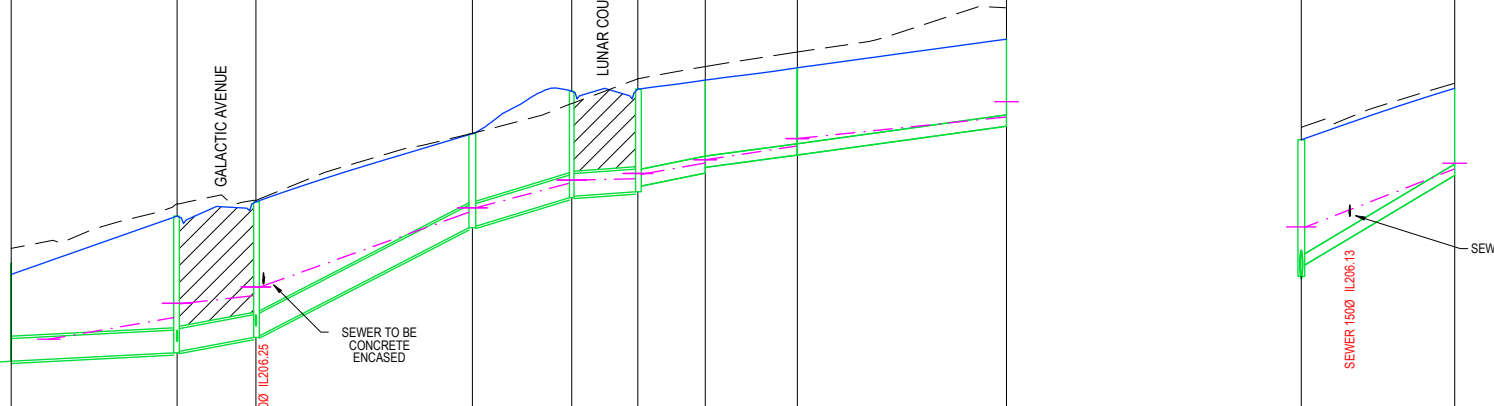
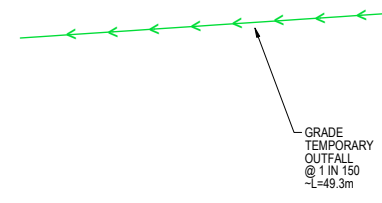
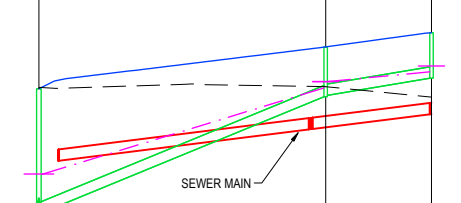

|                    |                |                |
|--------------------|----------------|----------------|
| DESIGN FLOW (l/s)  | 16             | 8              |
| CAPACITY (l/s)     | 44             | 28             |
| VELOCITY (m/s)     | 2.31           | 1.38           |
| PIPE DIAMETER (mm) | 1500 PVC       | 1500 PVC       |
| PIPE GRADE         | 1:24.7 (4.05%) | 1:61.9 (1.62%) |
| DATUM RL           | 196.0          |                |
| DEPTH TO INVERT    | 1.79           | 0.66           |
| H.G.L.             | 206.09         | 207.35         |
| INVERT LEVEL       | 205.54         | 207.25         |
| DESIGN SURFACE     | 207.34         | 207.48         |
| CHAINAGE           | 0.00           | 37.94          |

|                 |                 |                 |                 |                 |                 |                |                |                |                |        |      |
|-----------------|-----------------|-----------------|-----------------|-----------------|-----------------|----------------|----------------|----------------|----------------|--------|------|
|                 | 121             | 97              | 69              | 59              | 50              | 26             | 17             |                |                |        | 8    |
|                 | 68              | 129             | 216             | 164             | 79              | 90             | 25             | 26             | 53             |        |      |
|                 | 1.72            | 2               | 2.72            | 2.13            | 1.18            | 1.96           | 1.55           | 1.57           | 2.19           |        |      |
|                 | 3000 RCP CL2 FJ | 3000 RCP CL2 FJ | 3000 RCP CL2 FJ | 3000 RCP CL2 FJ | 3000 RCP CL2 FJ | 2250 PVC       | 1500 PVC       | 1500 PVC       | 1500 PVC       |        |      |
|                 | 1:200 (0.50%)   | 1:56.6 (1.77%)  | 1:20 (5.00%)    | 1:34.9 (2.87%)  | 1:150 (0.67%)   | 1:51.6 (1.94%) | 1:74.8 (1.34%) | 1:72.5 (1.38%) | 1:17.1 (5.84%) |        |      |
| DATUM RL        | 196.0           |                 |                 |                 |                 |                |                |                | 195.0          |        |      |
| DEPTH TO INVERT | 1.30            | 1.81            | 1.79            | 1.25            | 1.41            | 1.38           | 1.23           | 1.15           | 1.66           | 1.15   |      |
| H.G.L.          | 205.52          | 205.80          | 206.09          | 207.20          | 207.58          | 207.64         | 207.85         | 208.07         | 208.46         | 208.66 |      |
| INVERT LEVEL    | 205.25          | 205.99          | 206.21          | 207.01          | 207.17          | 207.26         | 207.54         | 207.71         | 208.33         | 208.67 |      |
| DESIGN SURFACE  | 206.55          | 207.15          | 207.34          | 208.24          | 208.80          | 208.82         | 208.94         | 209.11         | 209.49         | 209.83 |      |
| CHAINAGE        | 21.95           | 16.97           | 10.43           | 27.39           | 28.63           | 58.03          | 13.15          | 69.17          | 8.75           | 77.92  | 8.91 |

SCALE H:1 - 1000 V:1 - 100

SCALE H 1:1000 V 1:100  
LENGTHS ARE IN METRES - PAPER SIZE A3

**DRAFT**

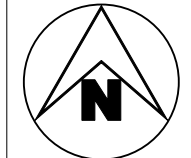

**Tomkinson**  
SURVEY > ENGINEERING > PLANNING > PROJECT MANAGEMENT  
HEAD OFFICE: 57 MYERS STREET BENDIGO PH 03 5445 8700  
ABN 11 103 336 358 WWW.TOMKINSON.COM

**imagine**  
STRATHFIELDSAYE

© COPYRIGHT THE INFORMATION CONTAINED ON THIS DRAWING IS THE INTELLECTUAL PROPERTY OF TOMKINSON GROUP. COPYING OR USING THIS DRAWING IN WHOLE OR IN PART WITHOUT THE EXPRESS WRITTEN PERMISSION OF TOMKINSON GROUP INFRINGES COPYRIGHT



**IMAGINE STAGE 18**  
**SOMERSET PARK ROAD STRATHFIELDSAYE**  
**DRAINAGE LONG SECTIONS (1 OF 2)**  
CITY OF GREATER BENDIGO REF: DS/188/2016  
STRATHFIELDSAYE HOLDINGS PTY LTD  
DWG STATUS: **PRELIMINARY**  
PROJECT & DWG No: 1065318R15 / 17 A

NOTE: THIS IS AN UNCONTROLLED DOCUMENT AND WILL NOT BE UPDATED. IT IS THE RESPONSIBILITY OF THE USER TO CONFIRM THAT THIS IS A CURRENT COPY AND SUITABLE FOR THE PROPOSED USE. THIS SHEET MUST BE READ IN CONJUNCTION WITH ALL SHEETS OF THIS SET AND ANY ACCOMPANYING DOCUMENTS. PLOT DATE: 04/05/2023 FILE: C:\TZDD\DATA\TOMK66C-TZDS011065318 - STRATHFIELDSAYE - IMAGINE STAGE 18 - 0639ENGG000\AC\CURRENT\1065318 R-D CTN PLANS REV A.DWG

**NOTE:**



DENOTES FULL DEPTH  
CL3 FCR BACKFILL TO  
IDM STANDARDS

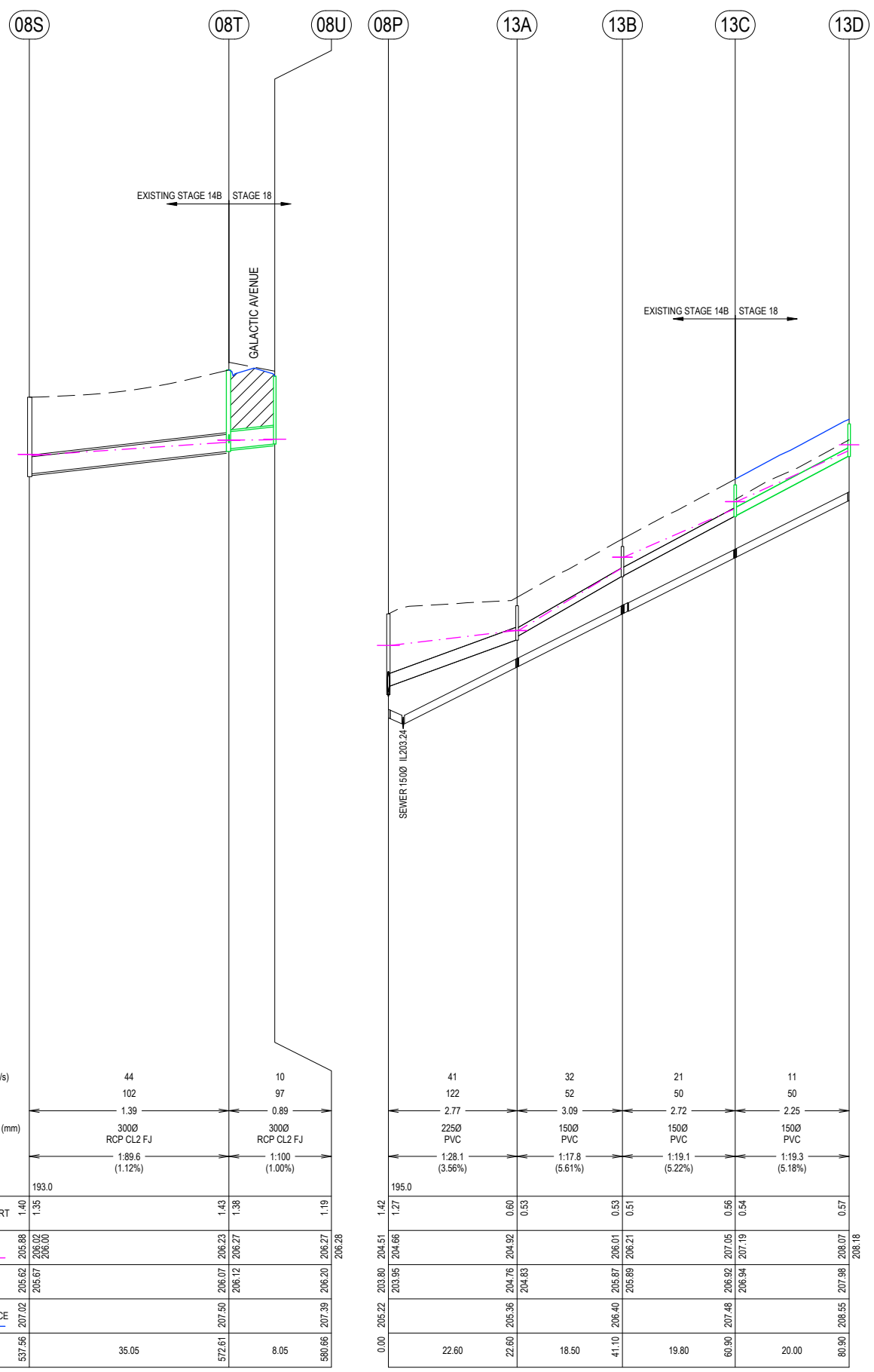

| DESIGN FLOW (l/s)  | 44                         | 10                         | 41                | 32                         | 21                         | 11                |
|--------------------|----------------------------|----------------------------|-------------------|----------------------------|----------------------------|-------------------|
| CAPACITY (l/s)     | 102                        | 97                         | 122               | 52                         | 50                         | 50                |
| VELOCITY (m/s)     | 1.39                       | 0.89                       | 2.77              | 3.09                       | 2.72                       | 2.25              |
| PIPE DIAMETER (mm) | 3000<br>RCP CL2 FJ         | 3000<br>RCP CL2 FJ         | 2250<br>PVC       | 1500<br>PVC                | 1500<br>PVC                | 1500<br>PVC       |
| PIPE GRADE         | 1:89.6<br>(1.12%)          | 1:100<br>(1.00%)           | 1:28.1<br>(3.56%) | 1:17.8<br>(5.61%)          | 1:19.1<br>(5.22%)          | 1:19.3<br>(5.18%) |
| DATUM RL           | 193.0                      |                            | 195.0             |                            |                            |                   |
| DEPTH TO INVERT    | 1.40<br>1.35               | 1.43<br>1.38               | 0.60<br>0.53      | 0.53<br>0.51               | 0.56<br>0.54               | 0.57              |
| H.G.L.             | 205.62<br>206.02<br>206.00 | 206.07<br>206.23<br>206.27 | 204.76<br>204.92  | 205.87<br>206.01<br>206.21 | 206.92<br>207.05<br>207.19 | 206.07<br>206.07  |
| INVERT LEVEL       | 205.62<br>205.67           | 206.07<br>206.12           | 204.76<br>204.83  | 205.87<br>205.89           | 206.92<br>206.94           | 206.07<br>206.07  |
| DESIGN SURFACE     | 207.02                     | 207.50                     | 205.36            | 206.40                     | 207.48                     | 208.55            |
| CHAINAGE           | 537.56<br>35.05            | 572.61<br>8.05             | 22.60             | 18.50                      | 19.80                      | 20.00             |

**PIT SCHEDULE**

| PIT NAME | TYPE        | EASTING    | NORTHING    | INTERNAL |     | INLET DIA | INLET INV LEV | OUTLET DIA | OUTLET INV LEV | PIT SETOUT RL | DEPTH | REMARKS                      |
|----------|-------------|------------|-------------|----------|-----|-----------|---------------|------------|----------------|---------------|-------|------------------------------|
|          |             |            |             | WD       | LEN |           |               |            |                |               |       |                              |
| 08T      | JP + GJP    | 265837.672 | 5923538.405 | 600      | 900 | 300       | 206.115       | 300        | 206.065        | 207.496       | 1.431 | IDM SD480                    |
| 08U      | GJP IN KERB | 265838.752 | 5923546.382 | 450      | 900 |           |               | 300        | 206.196        | 207.389       | 1.193 | IDM SD481                    |
| 13B      | GJP         | 265842.342 | 5923588.532 | 450      | 450 | 150       | 205.888       | 150        | 205.868        | 206.4         | 0.532 | IDM SD425 WITH GRATED INSERT |
| 13C      | GJP         | 265861.963 | 5923585.874 | 450      | 450 | 150       | 206.943       | 150        | 206.923        | 207.48        | 0.557 | IDM SD425 WITH GRATED INSERT |
| 13D      | GJP         | 265881.782 | 5923583.189 | 450      | 450 |           |               | 150        | 207.978        | 208.55        | 0.572 | IDM SD425 WITH GRATED INSERT |
| 80A      | END         | 265887.293 | 5923509.886 | 0        | 150 |           |               | 150        | 206.674        | 207.826       | 1.152 | BLANK END                    |
| 81A      | WWALL       | 265882.291 | 5923472.958 | 0        | 0   | 300       | 205.252       |            |                | 206.55        | 1.298 | APPROVED PRECAST WINGWALL    |
| 81B      | JP + GJP    | 265884.568 | 5923489.77  | 600      | 900 | 300       | 205.357       | 300        | 205.337        | 207.145       | 1.808 | IDM SD480                    |
|          |             |            |             |          |     | 150       | 205.487       |            |                |               |       |                              |
| 81C      | JP + GJP    | 265894.016 | 5923493.959 | 600      | 900 | 300       | 205.562       | 300        | 205.542        | 207.336       | 1.794 | IDM SD480                    |
|          |             |            |             |          |     | 150       | 205.692       |            |                |               |       |                              |
| 81D      | SEP         | 265897.809 | 5923522.34  | 600      | 900 | 300       | 207.012       | 300        | 206.992        | 208.237       | 1.245 | CoGb SEP SD590G              |
| 81E      | SEP         | 265906.566 | 5923531.928 | 600      | 900 | 300       | 207.409       | 300        | 207.389        | 208.797       | 1.408 | CoGb SEP SD590G              |
| 81F      | JP + GJP    | 265906.817 | 5923540.675 | 600      | 900 | 225       | 207.542       | 300        | 207.467        | 208.825       | 1.358 | IDM SD480                    |
| TP       | TP          | 265915.719 | 5923540.202 | 0        | 0   | 150       | 207.79        | 225        | 207.715        | 208.945       | 1.23  |                              |
| TP       | TP          | 265927.836 | 5923538.927 | 0        | 0   | 150       | 207.953       | 150        | 207.953        | 209.108       | 1.155 |                              |
| 81G      | END         | 265955.249 | 5923535.214 | 0        | 150 |           |               | 150        | 208.334        | 209.485       | 1.151 | BLANK END                    |
| 82A      | GJP         | 265931.614 | 5923488.867 | 450      | 450 | 150       | 207.249       | 150        | 207.229        | 207.889       | 0.661 | IDM SD425 WITH GRATED INSERT |
| 82B      | GJP         | 265945.488 | 5923486.987 | 450      | 450 |           |               | 150        | 207.475        | 208.077       | 0.602 | IDM SD425 WITH GRATED INSERT |

**DRAFT**

A AS SUBMITTED TO COUNCIL  
 REV DES DWG CHK AUTH DATE  
 NJB SA X X xx/xx/xx

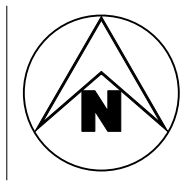

**Tomkinson**  
 SURVEY • ENGINEERING • PLANNING • PROJECT MANAGEMENT  
 HEAD OFFICE: 57 MYERS STREET BENDIGO PH 03 5445 8700  
 ABN 11 103 336 358 WWW.TOMKINSON.COM



SCALE H 1:1000 V 1:100  
 H 10 0 10 20 30 40 50 H  
 V 1 2 3 4 5 V  
 © COPYRIGHT THE INFORMATION CONTAINED ON THIS DRAWING IS THE INTELLECTUAL PROPERTY OF TOMKINSON GROUP. COPYING OR USING THIS DRAWING IN WHOLE OR IN PART WITHOUT THE EXPRESS WRITTEN PERMISSION OF TOMKINSON GROUP INFRINGES COPYRIGHT.  
 DIAL BEFORE YOU DIG www.100.com.au  
 COMPASS ASSURANCE ISO 9001 QUALITY

**IMAGINE STAGE 18**  
**SOMERSET PARK ROAD STRATHFIELDSAYE**  
**DRAINAGE LONG SECTIONS (2 OF 2) + PIT SCHEDULE**  
 CITY OF GREATER BENDIGO REF: DS/188/2016  
 STRATHFIELDSAYE HOLDINGS PTY LTD  
 DWG STATUS: **PRELIMINARY** PROJECT & DWG No: 1065318R16 / 17 A  
 REV: A

NOTE: THIS IS AN UNCONTROLLED DOCUMENT AND WILL NOT BE UPDATED. IT IS THE RESPONSIBILITY OF THE USER TO CONFIRM THAT THIS IS A CURRENT COPY AND SUITABLE FOR THE PROPOSED USE. THIS SHEET MUST BE READ IN CONJUNCTION WITH ALL SHEETS OF THIS SET AND ANY ACCOMPANYING DOCUMENTS. PLOT DATE: 04/05/2023 FILE: C:\TZD\DATA\TOMKINSON\1205011065318 - STRATHFIELDSAYE - IMAGINE STAGE 18 - 06591ENG000\CAD\CURRENT\1065318 R-D CTN PLANS REV A.DWG



| LEGEND |                                     |
|--------|-------------------------------------|
|        | PIT No                              |
|        | CATCHMENT                           |
|        | LOT FALL                            |
|        | OVERLAND 1% AEP STORMWATER FLOWPATH |

**DRAFT**

A AS SUBMITTED TO COUNCIL  
 REV DES DWG CHK AUTH DATE  
 NJB SA X X xx/xx/xx



HEAD OFFICE: 57 MYERS STREET BENDIGO PH 03 5445 8700  
 ABN 11 103 336 358 WWW.TOMKINSON.COM

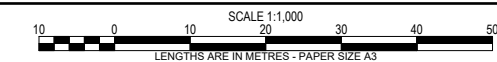

© COPYRIGHT  
 THE INFORMATION CONTAINED  
 ON THIS DRAWING IS THE  
 INTELLECTUAL PROPERTY OF  
 TOMKINSON GROUP. COPYING  
 OR USING THIS DRAWING IN  
 WHOLE OR IN PART WITHOUT  
 THE EXPRESS WRITTEN  
 PERMISSION OF TOMKINSON  
 GROUP INFRINGES COPYRIGHT



**IMAGINE STAGE 18**  
**SOMERSET PARK ROAD STRATHFIELDSAYE**  
**DRAINAGE CATCHMENT PLAN**  
 CITY OF GREATER BENDIGO REF: DS/188/2016  
 STRATHFIELDSAYE HOLDINGS PTY LTD  
 DWG STATUS: **PRELIMINARY** PROJECT & DWG No: 1065318D01 / 17 A

NOTE: THIS IS AN UNCONTROLLED DOCUMENT AND WILL NOT BE UPDATED. IT IS THE RESPONSIBILITY OF THE USER TO CONFIRM THAT THIS IS A CURRENT COPY AND SUITABLE FOR THE PROPOSED USE. THIS SHEET MUST BE READ IN CONJUNCTION WITH ALL SHEETS OF THIS SET AND ANY ACCOMPANYING DOCUMENTS. PLOT DATE: 04/05/2023 FILE: C:\12\DATA\TOMKINSON\STRATHFIELDSAYE - IMAGINE STAGE 18 - 26839ENGIN000\CURRENT\1065318 R-D CTN PLANS REV A.DWG



12D MODEL - HYDRAULIC DESIGN SHEET

Project: Design  
 Drainage Model: DRN  
 Rainfall File: Bendigo 100820.12dhydro  
 Rainfall Method: IFD Table  
 Freeboard Limit: 0.15 m  
 Minor 20.00 AEP(%) Storm Event

| Pipe ID    | Pipe Type  | Pipe Length (m) | Pipe Size (mm) | Full Pipe Area Af (sq.m) | Pipe Grade (%) | Pipe Grade (1 in) | Full-area Tct (min) | Full-area I (mm/hr) | Full-area Sum CA (ha) | Full-area Qc=CA (L/s) | Part-area Tct (min) | Part-area I (mm/hr) | Part-area Sum CA (ha) | Part-area Qc=CA (L/s) | Pipe Flow Q (L/s) | Capacity Flow Qcap (L/s) | Q/Qcap Ratio | Full Pipe Vel V=Q/Af (m/s) | Norm Depth Vel Vn=Q/An (m/s) | Crit Depth Vel Vc=Q/Ac (m/s) | Capacity Vel Vcap=Qcap/Af (m/s) | US Pit Grate RL (m) | Pipe US IL (m) | Pipe DS IL (m) | DS Pit Grate RL (m) | Cover Limit (m) | Cover Min (m) | Pipe DS Bend (deg) | Pipe DS Drop (m) | US Pit Ku | US Pit Kw | Pipe Vhead (m) | P'head Loss (Ku.Vhead) (m) | WSE Loss (Kw.Vhead) (m) | Mannings 'n' Roughness | Pipe T'head Loss (m) | US Pit HGL (m) | Pipe US HGL (m) | Pipe DS HGL (m) | DS Pit HGL (m) | HGL Grade (%) | HGL Grade (1 in) | F'board US (m) |
|------------|------------|-----------------|----------------|--------------------------|----------------|-------------------|---------------------|---------------------|-----------------------|-----------------------|---------------------|---------------------|-----------------------|-----------------------|-------------------|--------------------------|--------------|----------------------------|------------------------------|------------------------------|---------------------------------|---------------------|----------------|----------------|---------------------|-----------------|---------------|--------------------|------------------|-----------|-----------|----------------|----------------------------|-------------------------|------------------------|----------------------|----------------|-----------------|-----------------|----------------|---------------|------------------|----------------|
| 08U to 08T | RCP CL2 FJ | 8.05            | 300            | 0.071                    | 1              | 100               | 6                   | 90.22               | 0.0402                | 10.1                  | 6                   | 90.22               | 0.0402                | 10.1                  | 10.1              | 96.7                     | 0.1          | 0.14                       | 0.89                         | 0.72                         | 1.37                            | 207.39              | 206.2          | 206.1          | 207.5               | 0.9             | 0.89          | -90                | 0.05             | 9.7       | 0         | 0.01           | 0.013                      | 0.03                    | 206.3                  | 206.27               | 206.27         | 206.3           | 0.06            | 1548           | 1.11          |                  |                |
| 13C to 13B | PVC        | 19.8            | 150            | 0.018                    | 5.22           | 19.1              | 6.17                | 89.43               | 0.0769                | 19.1                  | 6                   | 90.22               | 0.076                 | 19                    | 19.1              | 50.3                     | 0.38         | 1.08                       | 2.65                         | 1.2                          | 2.85                            | 207.48              | 206.9          | 205.9          | 206.4               | 0.5             | 0.49          | 0                  | 0.02             | 2.19      | 0.06      | 0.13           | 0.009                      | 0.87                    | 207.2                  | 207.05               | 206.2          | 206.2           | 4.31            | 23.2           | 0.3           |                  |                |
| 13D to 13C | PVC        | 20              | 150            | 0.018                    | 5.18           | 19.3              | 6                   | 90.22               | 0.0341                | 8.5                   | 6                   | 90.22               | 0.0341                | 8.5                   | 8.5               | 50.1                     | 0.17         | 0.48                       | 2.11                         | 0.83                         | 2.83                            | 208.55              | 208            | 206.9          | 207.48              | 0.5             | 0.49          | 0                  | 0.02             | 6.81      | 0.01      | 0.08           | 0.009                      | 0.91                    | 208.1                  | 208.06               | 207.18         | 207.2           | 4.42            | 22.6           | 0.41          |                  |                |
| 80A to 81B | PVC        | 20.3            | 150            | 0.018                    | 5.84           | 17.1              | 6                   | 90.22               | 0.033                 | 8.3                   | 6                   | 90.22               | 0.033                 | 8.3                   | 8.3               | 53.2                     | 0.16         | 0.47                       | 2.19                         | 0.82                         | 3.01                            | 207.83              | 206.7          | 205.5          | 207.15              | 1               | 1             | 0                  | 0.15             | 6.93      | 0.01      | 0.08           | 0.009                      | 0.79                    | 206.8                  | 206.76               | 205.99         | 206             | 3.79            | 26.4           | 0.99          |                  |                |
| 81B to 81A | RCP CL2 FJ | 16.97           | 300            | 0.071                    | 0.5            | 200               | 6.91                | 85.91               | 0.5022                | 119.8                 | 6.51                | 87.83               | 0.4969                | 121.2                 | 121.2             | 68.4                     | 1.77         | 1.72                       | 1.72                         | 1.83                         | 0.97                            | 207.15              | 205.3          | 205.3          | 206.55              | 0.9             | 0.97          | 0                  |                  | 1.22      | 1.25      | 0.15           | 0.18                       | 0.19                    | 0.013                  | 0.26                 | 206            | 205.8           | 205.52          | 205.5          | 1.69          | 59.2             | 1.15           |
| 81C to 81B | RCP CL2 FJ | 10.43           | 300            | 0.071                    | 1.77           | 56.6              | 6.83                | 86.32               | 0.4003                | 96                    | 6.43                | 88.18               | 0.3953                | 96.8                  | 96.8              | 128.6                    | 0.75         | 1.37                       | 2                            | 1.59                         | 1.82                            | 207.34              | 205.5          | 205.4          | 207.15              | 1.35            | 1.35          | 56.5               | 0.02             | 1.19      | 1.22      | 0.1            | 0.11                       | 0.12                    | 0.013                  | 0.1                  | 206.2          | 206.09          | 205.99          | 206            | 1             | 99.8             | 1.13           |
| 81D to 81C | RCP CL2 FJ | 28.63           | 300            | 0.071                    | 5              | 20                | 6.59                | 87.45               | 0.2849                | 69.2                  | 6.26                | 89.01               | 0.281                 | 69.5                  | 69.5              | 216.2                    | 0.32         | 0.98                       | 2.72                         | 1.35                         | 3.06                            | 208.24              | 207            | 205.6          | 207.34              | 0.9             | 0.9           | -56.6              | 0.02             | 1.2       | 0.05      | 0.06           | 0.013                      | 1.04                    | 207.3                  | 207.2                | 206.21         | 206.2           | 3.46            | 28.9           | 0.98          |                  |                |
| 81E to 81D | RCP CL2 FJ | 13.15           | 300            | 0.071                    | 2.87           | 34.9              | 6.48                | 87.96               | 0.2406                | 58.8                  | 6.15                | 89.52               | 0.2367                | 58.9                  | 58.9              | 163.8                    | 0.36         | 0.83                       | 2.13                         | 1.26                         | 2.32                            | 208.8               | 207.4          | 207            | 208.24              | 0.9             | 0.91          | 36.9               | 0.02             | 1.26      | 0.04      | 0.04           | 0.013                      | 0.36                    | 207.6                  | 207.58               | 207.26         | 207.3           | 2.44            | 40.9           | 1.17          |                  |                |
| 81F to 81E | RCP CL2 FJ | 8.75            | 300            | 0.071                    | 0.67           | 150               | 6.41                | 88.3                | 0.2036                | 50                    | 6.07                | 89.87               | 0.1998                | 49.9                  | 50                | 79                       | 0.63         | 0.71                       | 1.18                         | 1.18                         | 1.12                            | 208.82              | 207.5          | 207.4          | 208.8               | 0.9             | 0.9           | -42.9              | 0.02             | 2.29      | 2.74      | 0.03           | 0.06                       | 0.07                    | 0.013                  | 0.05                 | 207.7          | 207.64          | 207.62          | 207.6          | 0.21          | 477.8            | 1.11           |
| TP to 81F  | PVC        | 8.91            | 225            | 0.04                     | 1.94           | 51.6              | 6.33                | 88.65               | 0.1045                | 25.7                  | 6                   | 90.22               | 0.1006                | 25.2                  | 25.7              | 90.3                     | 0.28         | 0.65                       | 1.96                         | 1.05                         | 2.27                            | 208.94              | 207.7          | 207.5          | 208.82              | 1               | 1             | 90.3               | 0.075            | 2         | 0.02      | 0.04           | 0.009                      | 0.17                    | 207.9                  | 207.85               | 207.7          | 207.7           | 1.68            | 59.4           | 1.05          |                  |                |
| TP to TP   | PVC        | 12.19           | 150            | 0.018                    | 1.34           | 74.8              | 6.23                | 89.13               | 0.0698                | 17.3                  | 6.23                | 89.13               | 0.0698                | 17.3                  | 17.3              | 25.4                     | 0.68         | 0.98                       | 1.55                         | 1.13                         | 1.44                            | 209.11              | 208            | 207.8          | 208.94              | 1               | 1             | 0                  | 0.075            | 2         | 0.05      | 0.1            | 0.009                      | 0.15                    | 208.2                  | 208.07               | 207.89         | 207.9           | 1.5             | 66.6           | 0.94          |                  |                |
| 81G to TP  | PVC        | 27.66           | 150            | 0.018                    | 1.38           | 72.5              | 6                   | 90.22               | 0.0698                | 17.5                  | 6                   | 90.22               | 0.0698                | 17.5                  | 17.5              | 25.8                     | 0.68         | 0.99                       | 1.57                         | 1.14                         | 1.46                            | 209.49              | 208.3          | 208            | 209.11              | 1               | 1             | 0                  | 0                | 4.06      | 0.05      | 0.2            | 0.009                      | 0.3                     | 208.7                  | 208.46               | 208.17         | 208.2           | 1.03            | 97.1           | 0.83          |                  |                |
| 82A to 81C | PVC        | 37.94           | 150            | 0.018                    | 4.05           | 24.7              | 6.12                | 89.67               | 0.0648                | 16.2                  | 6                   | 90.22               | 0.0642                | 16.1                  | 16.2              | 44.3                     | 0.36         | 0.91                       | 2.31                         | 1.09                         | 2.51                            | 207.89              | 207.2          | 205.7          | 207.34              | 0.5             | 0.51          | 33.5               | 0.15             | 1.97      | 0.04      | 0.08           | 0.009                      | 1.16                    | 207.4                  | 207.35               | 206.21         | 206.2           | 3.01            | 33.2           | 0.46          |                  |                |
| 82B to 82A | PVC        | 14              | 150            | 0.018                    | 1.62           | 61.9              | 6                   | 90.22               | 0.0332                | 8.3                   | 6                   | 90.22               | 0.0332                | 8.3                   | 8.3               | 28                       | 0.3          | 0.47                       | 1.38                         | 0.82                         | 1.58                            | 208.08              | 207.5          | 207.3          | 207.89              | 0.45            | 0.45          | 0                  | 0.02             | 6.91      | 0.01      | 0.08           | 0.009                      | 0.15                    | 207.6                  | 207.56               | 207.43         | 207.4           | 0.92            | 108.8          | 0.44          |                  |                |

12D MODEL - HYDROLOGICAL DESIGN SHEET

Project: Design  
 Drainage Model: DRN  
 Rainfall File: Bendigo 100820.12dhydro  
 Tc Method: Direct  
 Rainfall Method: IFD Table  
 Runoff C Method: Direct  
 Minor 20.00 AEP(%) Storm Event

| Pit Name | Setout Easting | Setout Northing | Setout RL | Grate RL | Catch ID | Time Tc (min) | Intensity I (mm/hr) | Runoff C | Area A (ha) | Full CA (ha) | Full Sum CA (ha) | Full Qc=CA (L/s) | Partial CA (ha) | Partial Sum CA (ha) | Partial Qc=CA (L/s) | Approach Flow Qa (L/s) |
|----------|----------------|-----------------|-----------|----------|----------|---------------|---------------------|----------|-------------|--------------|------------------|------------------|-----------------|---------------------|---------------------|------------------------|
| 08T      | 265837.7       | 5923538.4       | 207.5     | 207.5    | 3P       | 6             | 90.22               | 0.55     | 0.134       | 0.074        | 0.102            | 25.6             | 0.074           | 0.102               | 25.6                | 25.6                   |
|          |                |                 |           |          | 5P       | 6             | 90.22               | 0.75     | 0.038       | 0.028        |                  |                  | 0.028           |                     |                     |                        |
| 08U      | 265838.8       | 5923546.4       | 207.4     | 207.4    | 5P       | 6             | 90.22               | 0.75     | 0.054       | 0.04         | 0.0402           | 10.1             | 0.04            | 0.0402              | 10.1                | 10.1                   |
| 13C      | 265862         | 5923585.9       | 207.5     | 207.5    | 3P       | 6             | 90.22               | 0.55     | 0.078       | 0.043        | 0.0428           | 10.7             | 0.043           | 0.0428              | 10.7                | 10.7                   |
| 13D      | 265881.8       | 5923583.2       | 208.6     | 208.6    | 3P       | 6             | 90.22               | 0.55     | 0.062       | 0.034        | 0.0341           | 8.5              | 0.034           | 0.0341              | 8.5                 | 8.5                    |
| 80A      | 265887.3       | 5923509.9       | 207.8     | 207.8    | 3P       | 6             | 90.22               | 0.55     | 0.06        | 0.033        | 0.033            | 8.3              | 0.033           | 0.033               | 8.3                 | 8.3                    |
| 81A      | 265882.3       | 5923473         | 206.6     | 206.6    |          |               |                     |          |             |              |                  |                  |                 |                     |                     |                        |
| 81B      | 265884.6       | 5923489.8       | 207.2     | 207.2    | 3P       | 6             | 90.22               | 0.55     | 0.07        | 0.039        | 0.0689           | 17.3             | 0.039           | 0.0689              | 17.3                | 17.3                   |
|          |                |                 |           |          | 5P       | 6             | 90.22               | 0.75     | 0.04        | 0.03         |                  |                  | 0.03            |                     |                     |                        |
| 81C      | 265894         | 5923494         | 207.3     | 207.3    | 3P       | 6             | 90.22               | 0.55     | 0.062       | 0.034        | 0.0505           | 12.7             | 0.034           | 0.0505              | 12.7                | 12.7                   |
|          |                |                 |           |          | 5P       | 6             | 90.22               | 0.75     | 0.022       | 0.016        |                  |                  | 0.016           |                     |                     |                        |
| 81D      | 265897.8       | 5923522.3       | 208.2     | 208.2    | 3P       | 6             | 90.22               | 0.55     | 0.063       | 0.035        | 0.0443           | 11.1             | 0.035           | 0.0443              | 11.1                | 11.1                   |
|          |                |                 |           |          | 5P       | 6             | 90.22               | 0.75     | 0.013       | 0.01         |                  |                  | 0.01            |                     |                     |                        |
| 81E      | 265906.6       | 5923531.9       | 208.8     | 208.8    | 5P       | 6             | 90.22               | 0.75     | 0.049       | 0.037        | 0.0369           | 9.3              | 0.037           | 0.0369              | 9.3                 | 9.3                    |
| 81F      | 265906.8       | 5923540.7       | 208.8     | 208.8    | 4P       | 6             | 90.22               | 0.6      | 0.102       | 0.061        | 0.0991           | 24.8             | 0.061           | 0.0991              | 24.8                | 24.8                   |
|          |                |                 |           |          | 5P       | 6             | 90.22               | 0.75     | 0.051       | 0.038        |                  |                  | 0.038           |                     |                     |                        |
| TP       | 265915.7       | 5923540.2       | 208.9     | 208.9    | 3P       | 6             | 90.22               | 0.55     | 0.063       | 0.035        | 0.0347           | 8.7              | 0.035           | 0.0347              | 8.7                 | 8.7                    |
| TP       | 265927.8       | 5923538.9       | 209.1     | 209.1    |          |               |                     |          |             |              |                  |                  |                 |                     |                     | 0                      |
| 81G      | 265955.3       | 5923535.2       | 209.5     | 209.5    | 3P       | 6             | 90.22               | 0.55     | 0.127       | 0.07         | 0.0698           | 17.5             | 0.07            | 0.0698              | 17.5                | 17.5                   |
| 82A      | 265931.6       | 5923488.9       | 207.9     | 207.9    | 4P       | 6             | 90.22               | 0.6      | 0.053       | 0.032        | 0.0317           | 7.9              | 0.032           | 0.0317              | 7.9                 | 7.9                    |
| 82B      | 265945.5       | 5923487         | 208.1     | 208.1    | 3P       | 6             | 90.22               | 0.55     | 0.06        | 0.033        | 0.0332           | 8.3              | 0.033           | 0.0332              | 8.3                 | 8.3                    |

**DRAFT**

A AS SUBMITTED TO COUNCIL  
 NNB SA X X xx/xx/xx  
 REV DES DWG CHK AUTH DATE



SCALE H 1:250 V 1:100  
 LENGTHS ARE IN METRES - PAPER SIZE A3  
 © COPYRIGHT THE INFORMATION CONTAINED ON THIS DRAWING IS THE INTELLECTUAL PROPERTY OF TOMKINSON GROUP. COPYING OR USING THIS DRAWING IN WHOLE OR IN PART WITHOUT THE EXPRESS WRITTEN PERMISSION OF TOMKINSON GROUP INFRINGES COPYRIGHT.  
 DIAL BEFORE YOU DIG www.1100.com.au  
 COMPASS ASSURANCE ISO 9001 QUALITY

**IMAGINE STAGE 18**  
**SOMERSET PARK ROAD STRATHFIELDSAYE**  
**DRAINAGE HYDRAULIC / HYDROLOGY CALC SHEET**  
 CITY OF GREATER BENDIGO REF: DS/188/2016  
 STRATHFIELDSAYE HOLDINGS PTY LTD  
 DWG STATUS: **PRELIMINARY**  
 PROJECT & DWG No: 1065318D02 / 17 A

NOTE: THIS IS AN UNCONTROLLED DOCUMENT AND WILL NOT BE UPDATED. IT IS THE RESPONSIBILITY OF THE USER TO CONFIRM THAT THIS IS A CURRENT COPY AND SUITABLE FOR THE PROPOSED USE. THIS SHEET MUST BE READ IN CONJUNCTION WITH ALL SHEETS OF THIS SET AND ANY ACCOMPANYING DOCUMENTS. PLOT DATE: 04/05/2023 FILE: C:\TZDDATA\TOMKINSON\12DS011065318 - STRATHFIELDSAYE - IMAGINE STAGE 18 - 0639ENGIN000ACAD\CURRENT\1065318 R-D CTN PLANS REV A.DWG