



MGA ZONE 55

4

3

2

1



--- 2 or 2.5 metre wide easement
 - - - 3 metre wide easement

KEY TO SHEETS

REFER TO SHEETS
1 TO 5
FOR DETAIL

ARMSTRONG Mt DUNED

BUILDING ENVELOPE PLAN
STAGE 46A

September 2020
Version:G

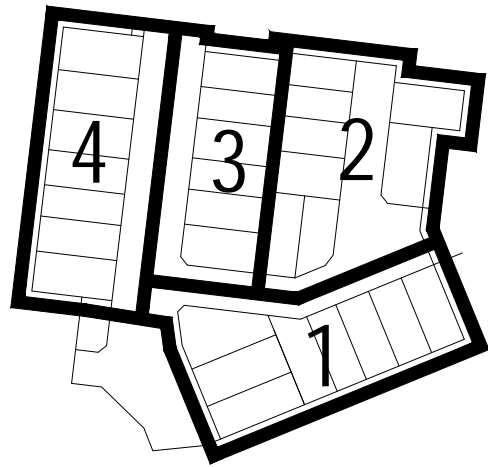

KEY TO SHEETS

NOTATIONS

- Single Storey Building Envelope (height not exceeding 3.6m)
- Overlooking Zone - Habitable room windows/raised open spaces are a source of overlooking
- Non Overlooking Zone - Habitable room windows/raised open spaces are not a source of overlooking
- Building to Boundary Zone

(A) Building Envelope Boundary Profile Type

4605 Lot number

3 Setback minimum required (if 0, a building can be constructed on the boundary provided that the building height and length requirements are met)

* The registered proprietor or proprietors for the time being of lots identified thus must not build or permit to be built any building(s) that does not provide 1.0 metre clear horizontal access along the full length of a minimum one side boundary of the lot.

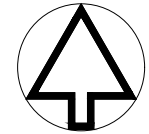

MGA ZONE 55

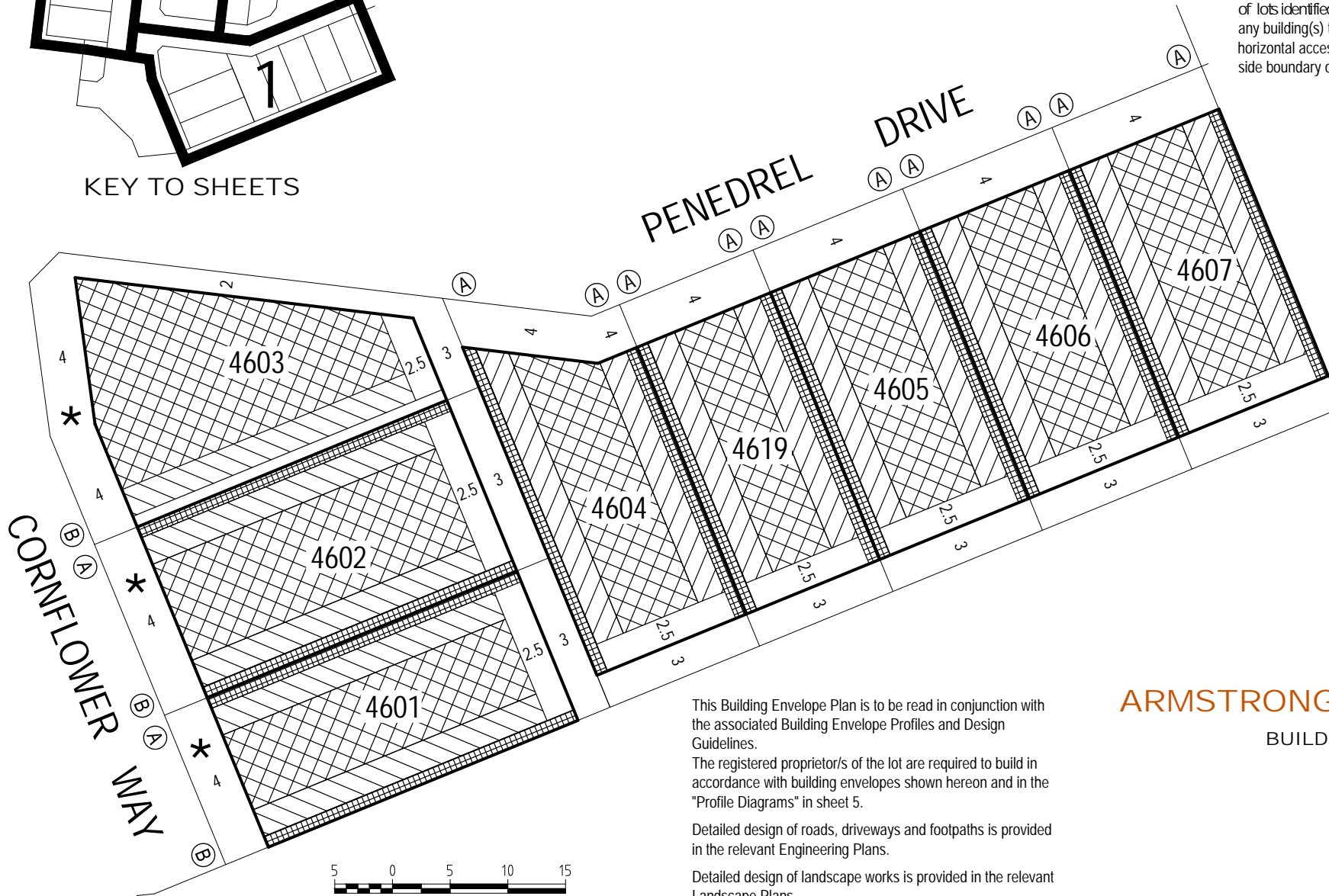

This Building Envelope Plan is to be read in conjunction with the associated Building Envelope Profiles and Design Guidelines.

The registered proprietor/s of the lot are required to build in accordance with building envelopes shown hereon and in the "Profile Diagrams" in sheet 5.

Detailed design of roads, driveways and footpaths is provided in the relevant Engineering Plans.

Detailed design of landscape works is provided in the relevant Landscape Plans.

All details subject to City of Greater Geelong Council approval.

ARMSTRONG Mt DUNED

BUILDING ENVELOPE PLAN
STAGE 46A

46A/1

stage sheet

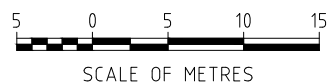

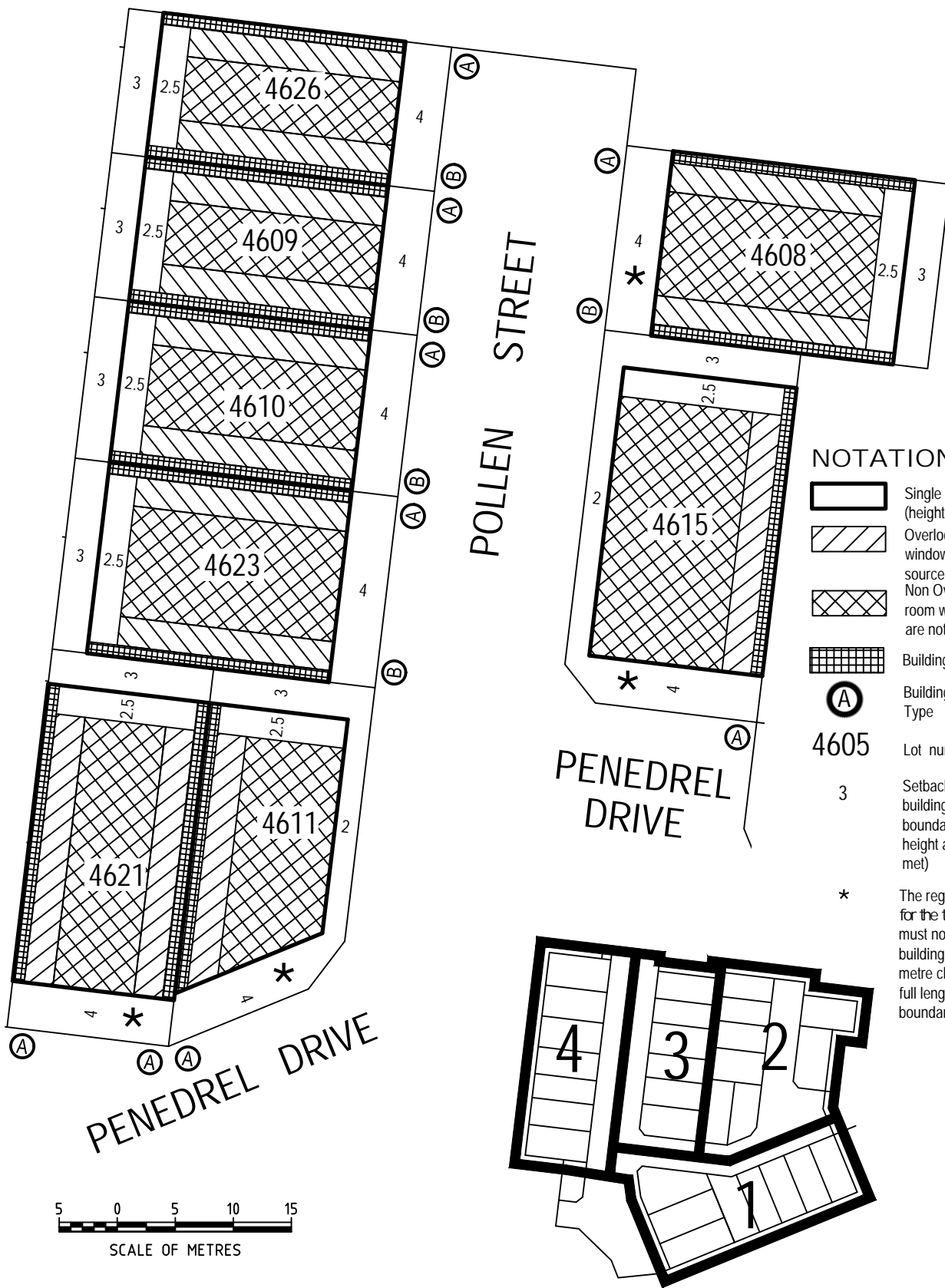

NOTATIONS

- Single Storey Building Envelope (height not exceeding 3.6m)
- Overlooking Zone - Habitable room windows/raised open spaces are a source of overlooking
- Non Overlooking Zone - Habitable room windows/raised open spaces are not a source of overlooking
- Building to Boundary Zone)
- Building Envelope Boundary Profile Type
- 4605 Lot number
- 3 Setback minimum required (if 0, a building can be constructed on the boundary provided that the building height and length requirements are met)
- * The registered proprietor or proprietors for the time being of lots identified thus must not build or permit to be built any building(s) that does not provide 1.0 metre clear horizontal access along the full length of a minimum one side boundary of the lot.

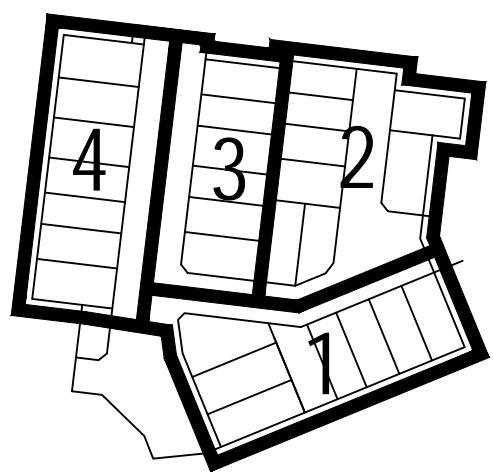

KEY TO SHEETS

ARMSTRONG Mt DUNED

BUILDING ENVELOPE PLAN
STAGE 46A

46A/2
stage sheet

Sheet 2 of 5 September 2020 Version:G

Detailed design of roads, driveways and footpaths is provided in the relevant Engineering Plans.

Detailed design of landscape works is provided in the relevant Landscape Plans.

All details subject to City of Greater Geelong Council approval.

This Building Envelope Plan is to be read in conjunction with the associated Building Envelope Profiles and Design Guidelines.

The registered proprietor/s of the lot are required to build in accordance with building envelopes shown hereon and in the "Profile Diagrams" in sheet 5.



MGA ZONE 55

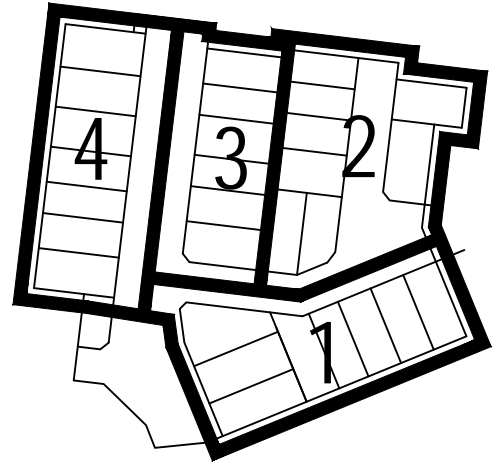
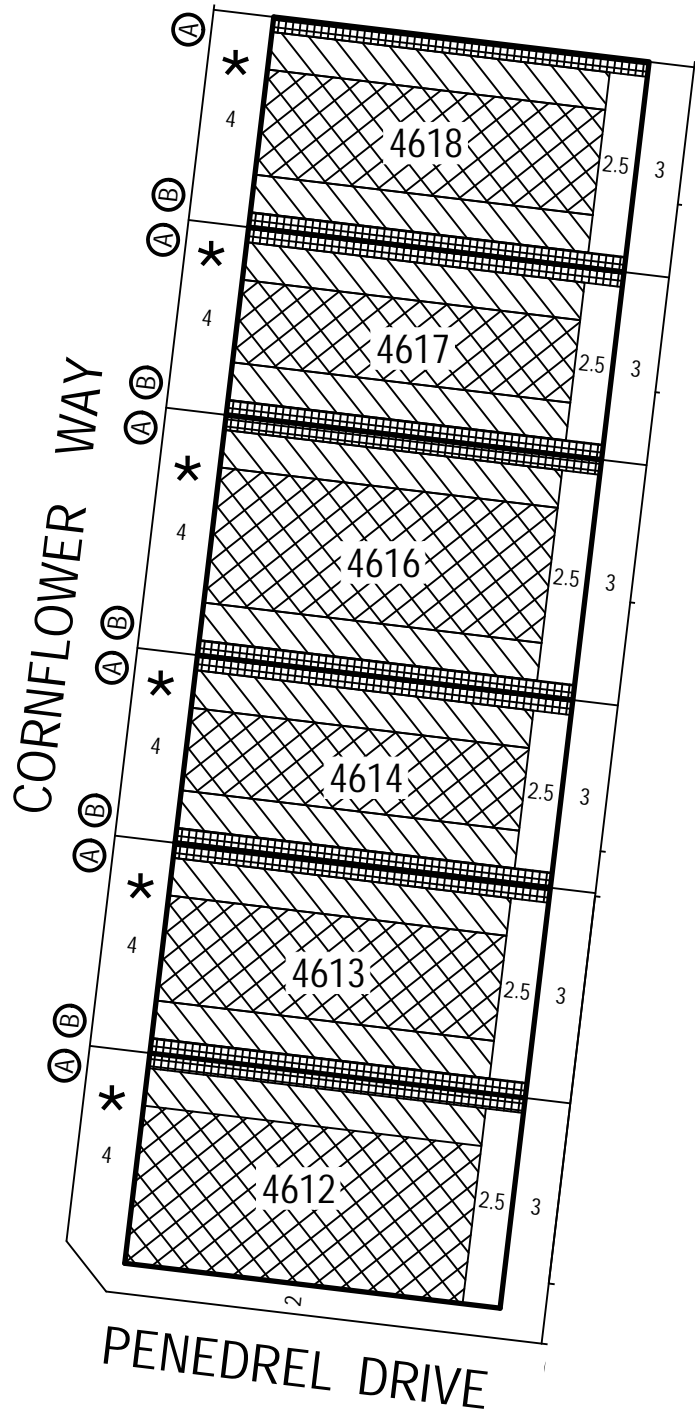

KEY TO SHEETS

NOTATIONS

- Single Storey Building Envelope (height not exceeding 3.6m)
- Overlooking Zone - Habitable room windows/raised open spaces are a source of overlooking
- Non Overlooking Zone - Habitable room windows/raised open spaces are not a source of overlooking
- Building to Boundary Zone)
- Building Envelope Boundary Profile Type
- 4605** Lot number
- 3** Setback minimum required (if 0, a building can be constructed on the boundary provided that the building height and length requirements are met)
- *** The registered proprietor or proprietors for the time being of lots identified thus must not build or permit to be built any building(s) that does not provide 1.0 metre clear horizontal access along the full length of a minimum one side boundary of the lot.

This Building Envelope Plan is to be read in conjunction with the associated Building Envelope Profiles and Design Guidelines. The registered proprietor/s of the lot are required to build in accordance with building envelopes shown hereon and in the "Profile Diagrams" in sheet 5.

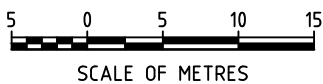

ARMSTRONG Mt DUNED

BUILDING ENVELOPE PLAN
STAGE 46A

46A / 3
stage sheet

Sheet 3 of 5 September 2020
Version:G

Detailed design of roads, driveways and footpaths is provided in the relevant Engineering Plans.

Detailed design of landscape works is provided in the relevant Landscape Plans.

All details subject to City of Greater Geelong Council approval.

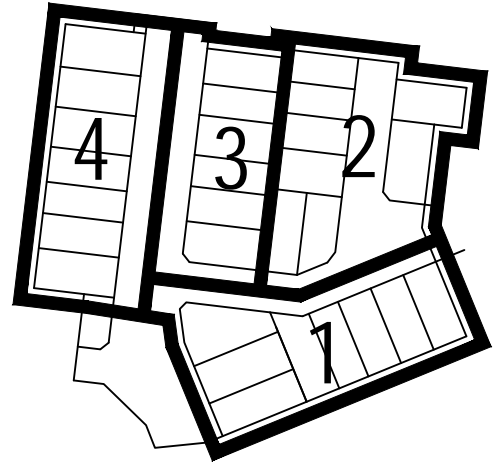
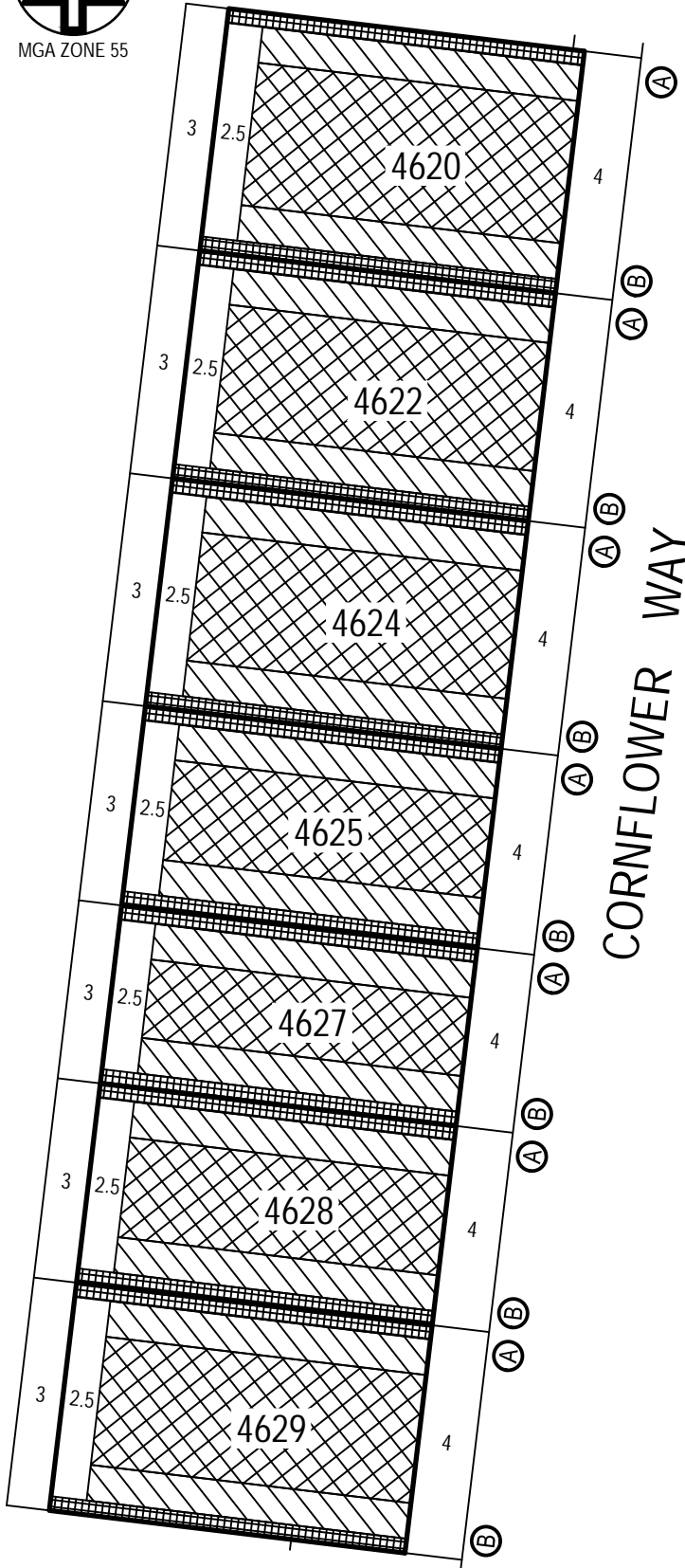

KEY TO SHEETS

NOTATIONS

- Single Storey Building Envelope (height not exceeding 3.6m)
- Overlooking Zone - Habitable room windows/raised open spaces are a source of overlooking
- Non Overlooking Zone - Habitable room windows/raised open spaces are not a source of overlooking
- Building to Boundary Zone)
- Building Envelope Boundary Profile Type
- 4605** Lot number
- 3** Setback minimum required (if 0, a building can be constructed on the boundary provided that the building height and length requirements are met)
- *** The registered proprietor or proprietors for the time being of lots identified thus must not build or permit to be built any building(s) that does not provide 1.0 metre clear horizontal access along the full length of a minimum one side boundary of the lot.

This Building Envelope Plan is to be read in conjunction with the associated Building Envelope Profiles and Design Guidelines. The registered proprietor/s of the lot are required to build in accordance with building envelopes shown hereon and in the "Profile Diagrams" in sheet 5.

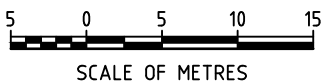

Detailed design of roads, driveways and footpaths is provided in the relevant Engineering Plans.
 Detailed design of landscape works is provided in the relevant Landscape Plans.
 All details subject to City of Greater Geelong Council approval.

ARMSTRONG Mt DUNED

BUILDING ENVELOPE PLAN
 STAGE 46A

46A / 4
 stage sheet

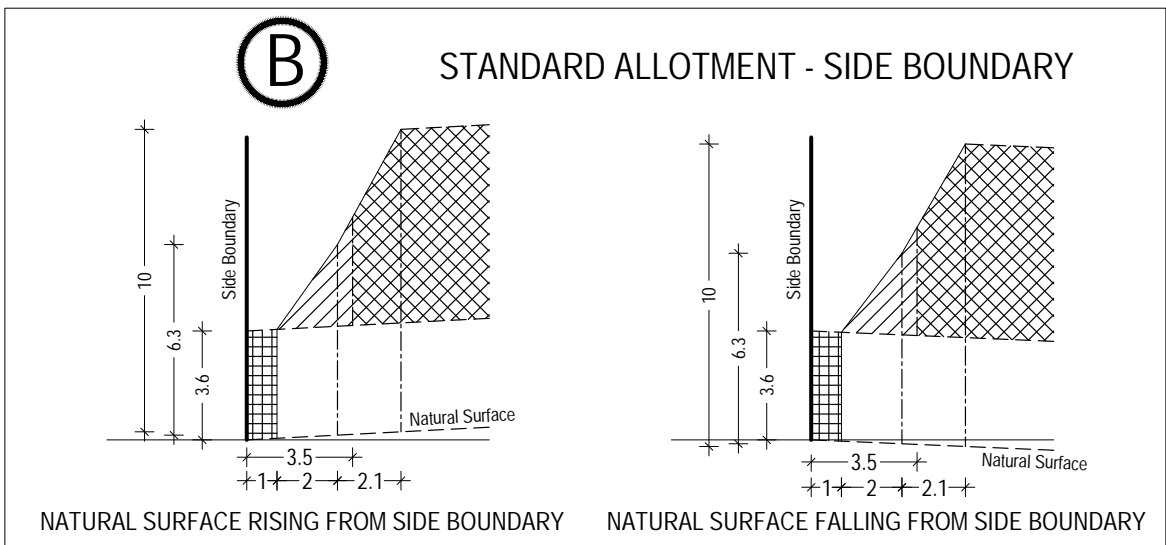
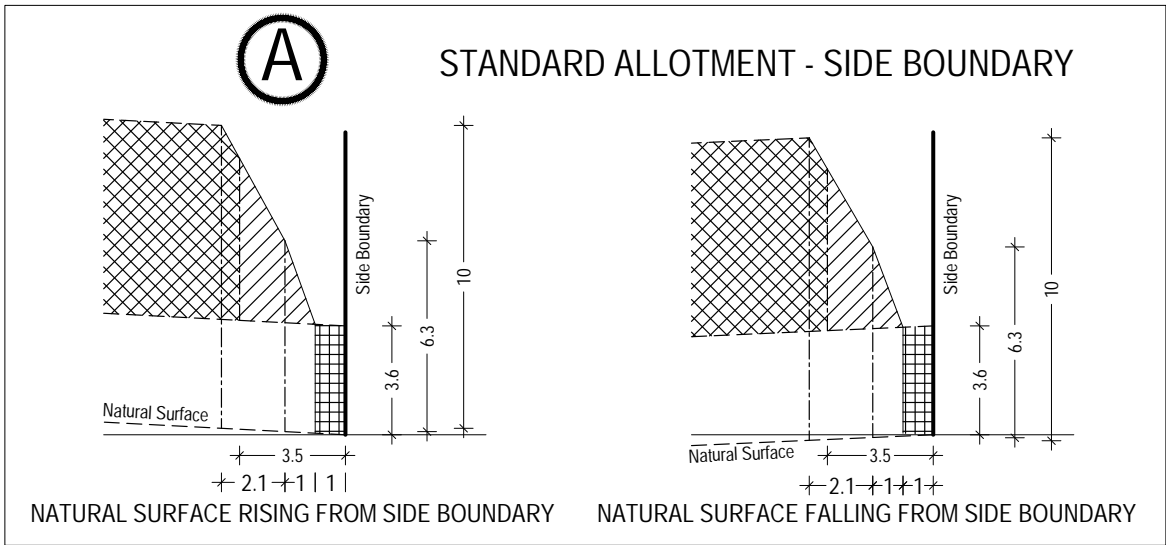

SCALE 1:250@A4

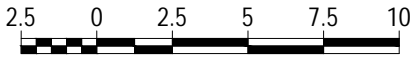

ARMSTRONG Mt DUNEED

BUILDING ENVELOPE PROFILES
STAGE 46A

46A / 5
stage sheet

Sheet 5 of 5

September 2020
Version:G

 Single Storey Building Envelope

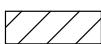

Non Overlooking Zone
Habitable room windows/raised open spaces are not a source of overlooking

 **Overlooking Zone**
Habitable room windows/raised open spaces are a source of overlooking



Building to Boundary Zone