

NOTES

- CONSTRUCTION PLANS MUST BE ACCOMPANIED BY THE APPROVED SPECIFICATION. NO WORK IS TO COMMENCE WITHOUT EVIDENCE OF POSSESSION OF EACH.
- ALL WORKS TO BE CARRIED OUT TO STANDARD DRAWINGS AND SPECIFICATION AS APPROVED BY SHIRE OF MELTON AND TO THE SATISFACTION OF THE ENGINEER AND THE MUNICIPAL ENGINEER. IN CASE OF A DISPUTE THE SPECIFICATION MUST TAKE PRECEDENCE.
- FOR SPECIFICATION REFER SPECIFICATION STAGE 1. (INCORPORATING UPDATED SECTION 1A)
- COUNCIL TO BE NOTIFIED SEVEN (7) CLEAR DAYS PRIOR TO COMMENCEMENT OF WORKS.
- PROPERTY INLETS ARE TO BE PLACED 1.0m FROM THE LOW CORNER OF LOT UNLESS OTHERWISE SHOWN. MINIMUM COVER TO BE 500mm. REFER GAA STD DWGS FIG016, FIG017 & FIG018.
- LOTS DENOTED 'H' WITH LOT NO ARE TO BE PROVIDED WITH A 100mm DIA. HOUSE DRAIN PLACED 5.0m FROM LOW CORNER OF LOT UNLESS OTHERWISE SHOWN. REFER GAA STD DWGS FIG016, FIG017 & FIG018.
- AGRICULTURAL PIPE DRAINS, AS PER GAA STD DWG FIG020, TO BE PLACED BEHIND ALL KERB AND CHANNEL AND BUFFER PITCHERS AND WHERE DIRECTED BY THE ENGINEER.
- DRAINAGE AND PITS TO BE SET OUT FROM OFFSETS SHOWN RATHER THAN FROM PIPE CHAINAGES. CENTRELINE OF PITS AT TP'S TO BE OFFSET 1.00 METRE.
- ALL 150mm DIA. PIPES TO BE P.V.C., 225mm DIA. TO BE P.V.C. OR R.C.(RRJ), 300mm TO 750mm DIA. TO BE R.C.(RRJ) AND 825mm DIA. AND GREATER TO BE R.C.(I.J). PIPES LAYED ON A CURVE TO BE RRJ. ALL CONCRETE PIPES TO BE CLASS 2 UNLESS OTHERWISE SPECIFIED.
- WHERE DRAINAGE PIPES ARE LOCATED WITHIN NATURE STRIPS, THE TRENCH SHALL BE BACKFILLED WITH COMPACTED CLASS 3 F.C.R. UPTO A LEVEL WHERE THE 45deg. INFLUENCE LINE FROM THE B.O.K. INTERSECTS WITH THE NEAREST TRENCH SIDE. PROVIDE CRUSHED ROCK BACKFILL WHERE DRAINAGE CROSSES BELOW FOOTPATHS.
- PIPE TRENCHES WITHIN THE ROAD RESERVE MUST BE BACKFILLED WITH 20mm CLASS 3 CRUSHED ROCK TO A RELATIVE COMPACTION OF 97% OF THE MAXIMUM FOUND IN THE STANDARD COMPACTION TEST FOR THE FOLLOWING :
  - BENEATH THE ROAD OR DRIVEWAY PAVEMENT TO THE UNDERSIDE OF THE PAVEMENT.
  - ADJACENT TO KERBING OR CONCRETE WORKS TO A LEVEL THAT IS NOT AFFECTED BY A 45 DEGREE ANGLE OF REPOSE FROM THE NEAR LOWER EDGE.
 ( TRENCHES TO BE BACKFILLED IN LAYERS NOT EXCEEDING 200mm LOOSE. )
- PRIOR TO COMMENCEMENT OF WORKS ON SITE, THE CONTRACTOR MUST ENSURE THAT ALL MATTERS RELATING TO THE OCCUPATIONAL HEALTH AND SAFETY ACT 2004, INCLUDING ALL RELEVANT REGULATIONS, HAVE BEEN ADDRESSED. IN PARTICULAR, THE REQUIRED NOTIFICATIONS MUST BE CONVEYED TO THE VICTORIAN WORKCOVER AUTHORITY - HEALTH & SAFETY DIVISION WITH RESPECT TO TRENCHING OPERATIONS. DETAILS OF THE CONTRACTORS OCCUPATIONAL HEALTH & SAFETY PROCEDURES MUST BE LODGED WITH THE SUPERINTENDENT PRIOR TO COMMENCEMENT OF WORKS.
- BATTERS SHALL BE 1 IN 6 FOR FILL AND 1 IN 6 FOR CUT UNLESS OTHERWISE SHOWN.
- ON COMPLETION THE CONTRACTOR IS RESPONSIBLE FOR THE REMOVAL OF ALL RUBBISH AND SPOIL FROM SITE.
- LOTS TO BE GRADED AND LEFT CLEAN TO THE SATISFACTION OF THE ENGINEER, ALL LOTS TO BE 1 IN 150 MINIMUM SLOPE.
- ALL RESERVE AREAS ARE TO BE SMOOTHED, GRADED, TOPSOILED WHERE REQUIRED WITH A 100mm COMPACTED LAYER OF TOPSOIL AND SEEDED USING AN APPROVED SEED MIX AND METHOD OF SOWING, SUCH THAT THE SURFACE IS SELF-DRAINING, STONE FREE AND ABLE TO BE MAINTAINED BY CONVENTIONAL MOWING EQUIPMENT.
- FILL AREAS ARE TO BE STRIPPED OF TOPSOIL, FILLED AND TOPSOIL REPLACED TO OBTAIN FINAL FILL LEVELS AS SHOWN ON THE PLANS. FILLING TO BE CLEAN CLAY COMPACTED TO A DRY DENSITY NOT LESS THAN 95% OF THE MAXIMUM DRY DENSITY VALUE DETERMINED BY THE STANDARD COMPACTION TEST IN ACCORDANCE WITH AUSTRALIAN STANDARD AS1289.5.2.1-1993. TESTING TO COMPLY WITH AS3798-1996 APPENDIX B, LEVEL 1.
- THE CONTRACTOR IS RESPONSIBLE FOR ENSURING THAT ALL IMPORTED FILL MATERIAL, INCLUDING TOPSOIL, SATISFIES THE DESCRIPTION FOR CLEAN FILL MATERIAL IN EPA BULLETIN PUBLICATION No. 448 (SEPT '95) AND SUBSEQUENT REVISIONS. THE CONTRACTOR SHALL PROVIDE VERIFICATION INCLUDING TEST CERTIFICATES TO THE SUPERVISING ENGINEER.
- EARTH FILL IS TO BE COMPACTED TO A RELATIVE COMPACTION COMPARED TO A STANDARD COMPACTION TEST AS SPECIFIED BY VICROADS CORPORATION OF :
  - 100% FOR ALL FILL MATERIAL AND MATERIAL UNDER FILL THAT IS LESS THAN 450mm FROM THE SURFACE.
  - 95% FOR ALL FILL NOT COVERED AS ABOVE.
- NATURESTRIP AND AREAS OF CUT ARE TO BE TOPSOILED AND GRASSED TO THE SATISFACTION OF THE ENGINEER. MINIMUM DEPTH TO BE 100mm.
- ALL NATIVE TREES AND SHRUBS TO BE RETAINED UNLESS ROAD CONSTRUCTION NECESSITATES THEIR REMOVAL OR REMOVAL IS DIRECTED BY THE ENGINEER. NO EXCAVATION WITHIN 5m OF ANY EXISTING NATIVE TREE WITHOUT APPROVAL OF THE ENGINEER.
- WHERE WORKS ARE IN THE VICINITY OF EXISTING SERVICES THESE SERVICES ARE TO BE LOCATED AND THE VARIOUS AUTHORITIES NOTIFIED, BY THE CONTRACTOR, PRIOR TO THE COMMENCEMENT OF WORKS.
- SERVICES CONDUITS ARE TO BE PROVIDED AT 90deg TO KERB AND CHANNEL UNLESS OTHERWISE SHOWN AND THE LOCATION IS TO BE MARKED ON THE FACE OF KERB. ALL SERVICE CONDUITS TO BE MINIMUM STANDARD OF CLASS 6, WITH A MINIMUM COVER OF 75mm ABOVE TOP OF CONDUIT TO SUB GRADE LEVEL, AND A SIZE SUITABLE TO SERVICE BUT NOT LESS THAN 50mm.
- WATER AND GAS CONDUITS TO BE CONSTRUCTED ACROSS NATURE STRIPS AFTER ELECTRICAL CABLE WORK IS COMPLETED.
- THE WATER CONDUIT OFFSET FROM THE LOT BOUNDARY IS GIVEN ON THE WATER RETICULATION PLAN. THE CONTRACTOR MUST CONSTRUCT CONDUITS TO ACCORD WITH THE GIVEN OFFSET AND ENSURE THAT THE CONCRETE MARKS THE KERB AND FOOTPATH EXACTLY ABOVE THE CONDUIT.
- NBN Co TO BE NOTIFIED SEVEN (7) DAYS PRIOR TO CONCRETE WORKS BEING PLACED.
- VEHICULAR CROSSINGS TO BE CONSTRUCTED IN ACCORDANCE WITH CITY OF MELTON STANDARD DRAWINGS MSC301 TO MSC306.
- ALL RESIDENTIAL FOOTPATHS SHALL BE 1.5m WIDE (MIN.) AND SHARED PEDESTRIAN/CYCLE PATHS SHALL BE 2.5m (MIN.). CONCRETE PATHS ARE TO BE 125mm THICK REINFORCED WITH SL72 PLACED CENTRALLY AND UNDERLAIN BY 50mm OF CLASS 3 CR. REFER GAA STD DWG FIG006.
- PRAM CROSSINGS ARE TO BE CONSTRUCTED WHERE FOOTPATHS CONNECT TO THE BACK OF KERB & CHANNEL. REFER GAA STD DWG FIG009.
- STREET SIGNS ARE TO BE CONSTRUCTED IN ACCORDANCE WITH COUNCIL STANDARDS.
- THE CONTRACTOR SHALL TO THE SATISFACTION OF THE ENGINEER AND THE MUNICIPAL ENGINEER, PROVIDE AND MAINTAIN INCLUSIVE OF STREET SIGNS, ALL NECESSARY REGULATORY SIGNS, WARNING SIGNS, LIGHTING, LINEMARKING AND BARRICADING TO COMPLY WITH THE REQUIREMENTS OF VICROADS SIGNING CODE OF PRACTICE.

- THE CONTRACTOR IS TO SUPPLY AND ERECT ALL RELEVANT STREET SIGNAGE AND LINE MARKING AS PART OF THE CONTRACT IN ACCORDANCE WITH VICROADS SPECIFICATION SECTIONS 710 & 722 AND AS1742.1, .2 & .3
- ALL ROADS TO BE CONSTRUCTED WITH B2 KERB & CHANNEL. REFER GAA STD DWG FIG008.
- THE CONTRACTOR IS RESPONSIBLE FOR OBTAINING A ROAD OPENING PERMIT FOR WORKS IN PREVIOUSLY CONSTRUCTED ROADWAYS.
- IF BLASTING IS REQUIRED THE CONTRACTOR IS RESPONSIBLE FOR OBTAINING A PERMIT TO BLAST AND MAINTAINING SAFETY REGULATIONS ON SITE IN COMPLIANCE WITH THE EXPLOSIVES ACT 1960. THE PERSON WHO IS USING THE EXPLOSIVES ON THE SITE IS TO BE A HOLDER OF A CURRENT PERMIT TO USE EXPLOSIVES ISSUED UNDER THE EXPLOSIVES ACT 1960.
- THE RELATIVE COMPACTION OF CRUSHED ROCK SHALL BE COMPLETED AT THE OPTIMUM MOISTURE CONTENT TO A DRY DENSITY (BASED ON THE PERCENTAGE OF THE MAXIMUM DRY DENSITY OBTAINED IN THE MODIFIED COMPACTION TEST) AS BELOW.
  - FOR DEPTH 0-100mm BELOW TOP OF BASE: RELATIVE COMPACTION = 100%
  - FOR DEPTH 100-300mm BELOW TOP OF BASE: RELATIVE COMPACTION = 98%
  - FOR DEPTH OVER 300mm BELOW TOP OF BASE: RELATIVE COMPACTION = 97%
- THE SUBGRADE BELOW ALL PAVEMENTS SHALL BE COMPACTED TO A DRY DENSITY OF NOT LESS THAN 100% OF THE MAXIMUM DRY DENSITY OBTAINED IN THE STANDARD COMPACTION TEST IN AREAS OF CUT TO A DEPTH OF 150mm AND IN AREAS OF FILL TO A DEPTH OF 450mm.
- CONCRETE TO HAVE A 28 DAY STRENGTH OF 25 Mpa.
- ALL SPLAYS ARE 3.00m X 3.00m UNLESS OTHERWISE SHOWN.
- ALL LEVELS ARE TO THE AUSTRALIAN HEIGHT DATUM (A.H.D.)
- EXISTING WATERCOURSES TO BE EXCAVATED TO A FIRM BASE AND BACKFILLED AS SPECIFIED. DEVELOPER'S CONSULTANT TO BE NOTIFIED WHEN THE WATERCOURSES ARE EXCAVATED TO A FIRM BASE. NO FILLING IS TO BE PLACED PRIOR TO WATERCOURSES BEING INSPECTED AND LEVELS TAKEN. BACKFILLING IS TO BE CARRIED OUT TO THE SATISFACTION OF THE COUNCIL SUPERVISING ENGINEER.
- THE CONTRACTOR MUST COMPLETE A LEVEL CHECK BETWEEN ALL TBM'S TO VERIFY LEVEL VALUES BEFORE COMMENCEMENT OF WORKS. ALL TBM'S AND CONTROL POINTS ARE TO BE MAINTAINED AND PROTECTED AT ALL TIMES DURING CONSTRUCTION. SHOULD ANY MARKS BE DISTURBED, THE CONTRACTOR WILL IMMEDIATELY NOTIFY THE DEVELOPER'S CONSULTANT TO ARRANGE RE-INSTAEMENT AT THE CONTRACTORS EXPENSE.
- PRIOR TO COMMENCEMENT OF WORKS, THE CONTRACTOR MUST SUBMIT A SMP TO THE DEVELOPER'S CONSULTANT FOR APPROVAL. THE CONTRACTOR MUST COMPLY WITH THE RECOMMENDATIONS OF THE ENVIRONMENT PROTECTION AUTHORITY PUBLICATION No.275 "CONSTRUCTION TECHNIQUES FOR SEDIMENT POLLUTION CONTROL" AND MW SITE ENVIRONMENTAL MANAGEMENT POLICY 3.8.2. APPROPRIATE SILTATION CONTROL IS TO BE MAINTAINED THROUGHOUT THE CONSTRUCTION AND MAINTENANCE PERIOD OF THE WORKS.
- PROVIDE TEMPORARY SAFETY BARRIER FENCE (FARM FENCE AS PER MW STD. DWG. 7251/4/203) FOR DRAIN DEPTHS GREATER THAN 1.0m. SAFETY FENCE TO REMAIN UNTIL PERMANENT UNDERGROUND DRAINAGE IS INSTALLED.

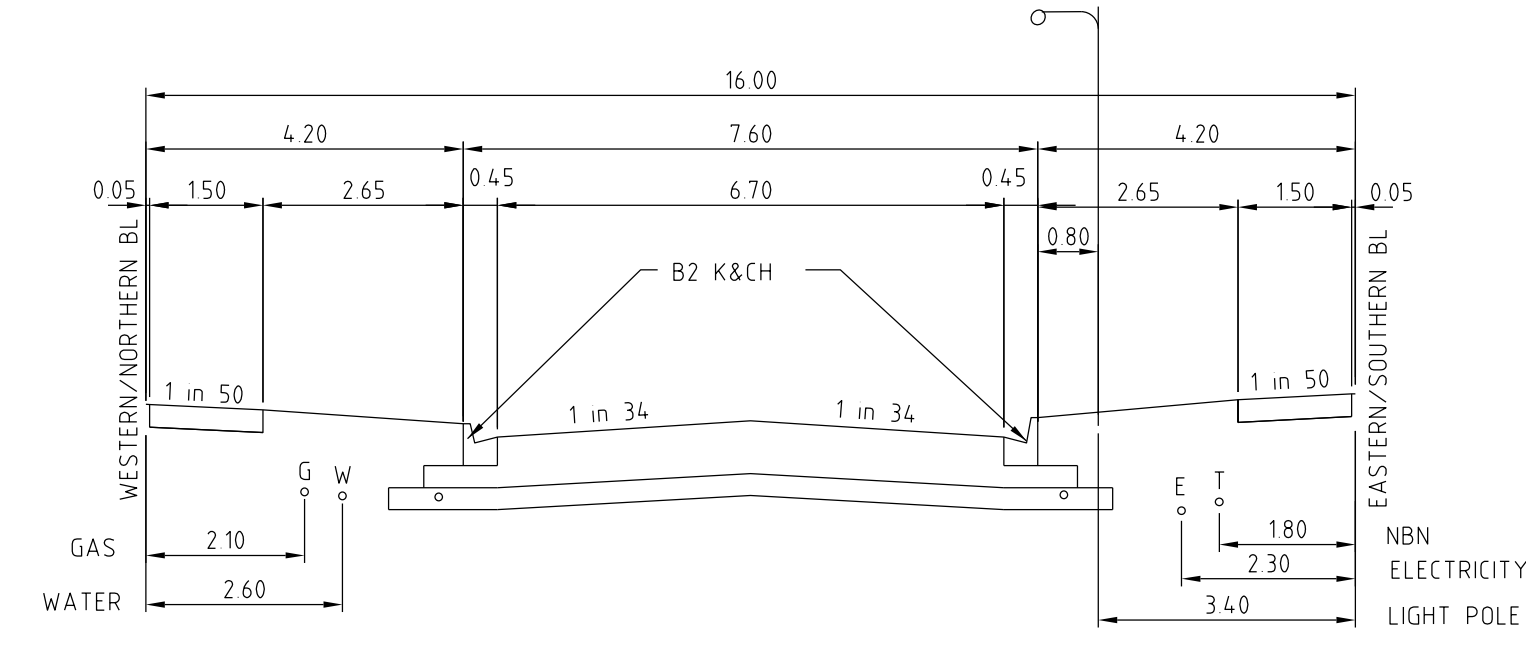

16m ROAD RESERVE - HIGGINS STREET

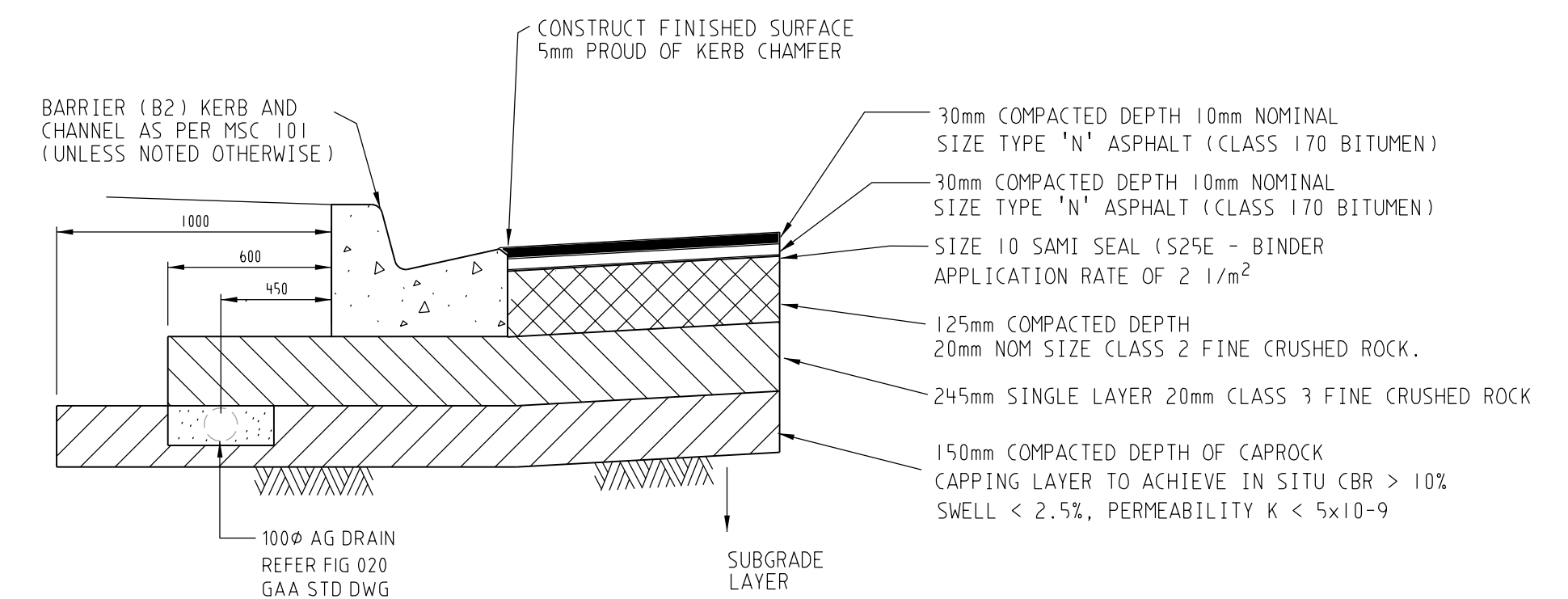

HIGGINS STREET - 590mm DEPTH  
PAVEMENT COMPOSITION  
(Dimensions in millimetres)  
NOT TO SCALE

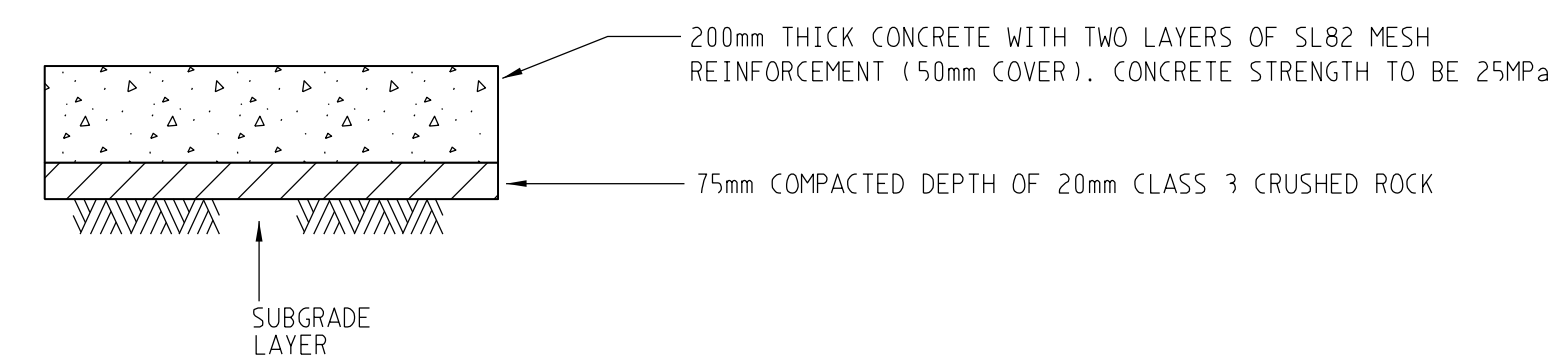

EXTENDED DRIVEWAY - 275mm DEPTH  
CONCRETE PAVEMENT COMPOSITION  
(Dimensions in millimetres)  
NOT TO SCALE

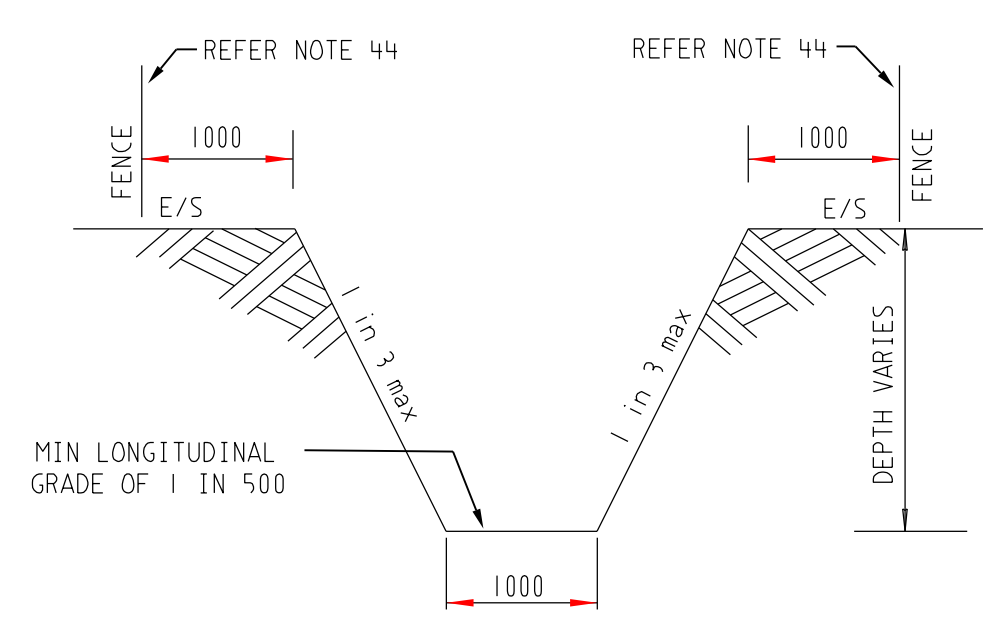

TEMPORARY OUTFALL CHANNEL DETAIL  
(Dimensions in millimetres)  
NOT TO SCALE

|            |          |   |         |   |           |  |   |
|------------|----------|---|---------|---|-----------|--|---|
|            |          | breese pitt dixon pty. ltd.<br>land surveyors civil engineers |         | 1/19 cato street<br>hawthorn east, 3123<br>telephone 8823 2300<br>fax no. 8823 2310 |           |  |   |
|            |          |   |         | MELWAY REF. 356-D-2<br>SURVEY BPD<br>DESIGN JT<br>DRAWN JT                          |           | MUNICIPALITY<br>MELTON<br>REFERENCE<br>8226 E/12 |   |
| AMENDMENTS |          |   |         | ASPIRE ESTATE<br>STAGE 12   |           | SHEET 2 OF 7                                     |   |
| VER        | DATE     | REMARKS   | CHECKED | SCALE AS SHOWN  | DATUM AHD | DATE MAY'15                                      | A |
| A          | 15/05/15 | ISSUED FOR CONSTRUCTION                                       |         |   |           |  |   |