

LEGEND

- ⊙ SEWER MANHOLE
- ⊕ STORMWATER MANHOLE/ MAINTENANCE SHAFT
- ⌒ GULLY TRAP
- ⊞ FIELD INLET
- ⊞ WATER METER
- ⊞ FIRE HYDRANT
- SW-SW STORMWATER
- STORMWATER SWALE
- W— WATER PIPE
- S— SEWER
- + 3.44 SURFACE LEVEL
- IL INVERT LEVEL
- SL SURFACE LEVEL
- ▭ DRIVEWAY / FOOTPATH
- ▬ KERB & CHANNEL
- ROOFWATER DRAINAGE PIPE
- ▽ ROOFWATER KERB ADAPTOR
- ▶ ROOFWATER KERB ADAPTOR WITH CONNECTION TO LOT

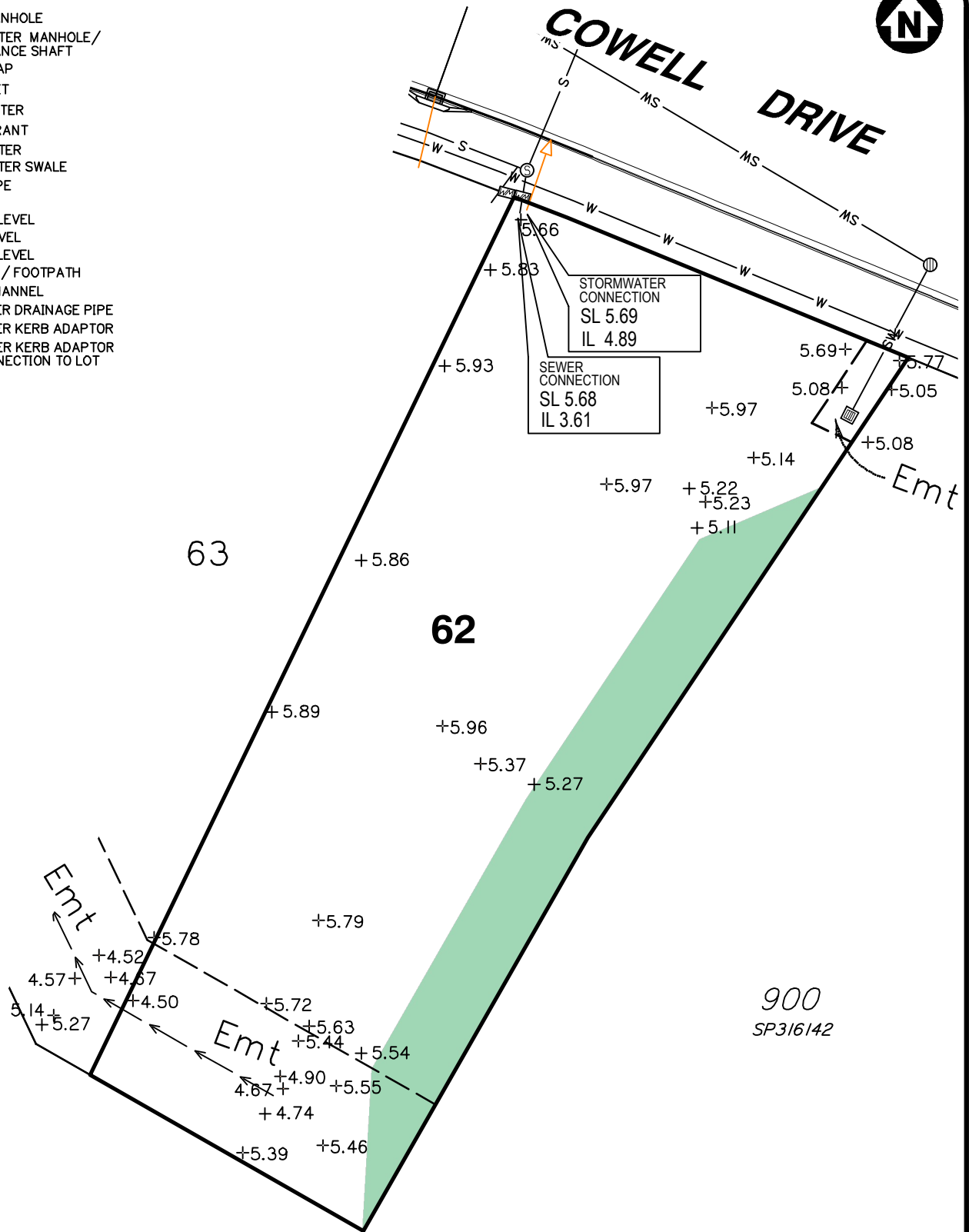

Notes:
 - 5m Setback to Endangered Regional Ecosystem to be retained. Vegetation Clearing is Not permitted within this Zone.

Scale 1:400 - Lengths are in Metres.

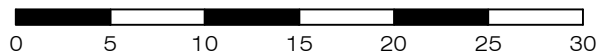

**gassman
development
perspectives**
 est 1985
 planning | environment | landscape | engineering | survey
 T: 3807 3333 | F: 3287 5461 | www.gassman.com.au
 Gold Coast & Logan | 176 Business Street, Yatala QLD | PO Box 392, Beenleigh 4207

Client
 Burleigh Heads Estate Pty Ltd

Project **SERVICE LOCATION SKETCH PLAN**

LOT 62 on SP316165

**Stage 1C, The Arbour Burleigh
 Cowell Drive, Burleigh Heads**

Locality	BURLEIGH HEADS	Issue Date	23/03/2023
Local Govt	GOLD COAST CITY COUNCIL	Meridian	SP316165
Scale (on A4 original)	1:400	Level Datum	AHD
		Drawn	S. Holt
		Date Drafted	22/03/2023
		Checked	T. Geraghty

Real Property Description:
 Lot 62 on SP316165

REFERENCE No. 5967-1C
PLAN No. 5967 S SK LOT 62

LEGEND

- ⊙ SEWER MANHOLE
- ⊕ STORMWATER MANHOLE/ MAINTENANCE SHAFT
- ⌒ GULLY TRAP
- ⊠ FIELD INLET
- ⊞ WATER METER
- ⊞ FIRE HYDRANT
- SW-SW STORMWATER
- STORMWATER SWALE
- W— WATER PIPE
- S— SEWER
- + 3.44 SURFACE LEVEL
- IL INVERT LEVEL
- SL SURFACE LEVEL
- ▭ DRIVEWAY / FOOTPATH
- ▬ KERB & CHANNEL
- (orange) ROOFWATER DRAINAGE PIPE
- ▽ (orange) ROOFWATER KERB ADAPTOR
- ▷ (orange) ROOFWATER KERB ADAPTOR WITH CONNECTION TO LOT

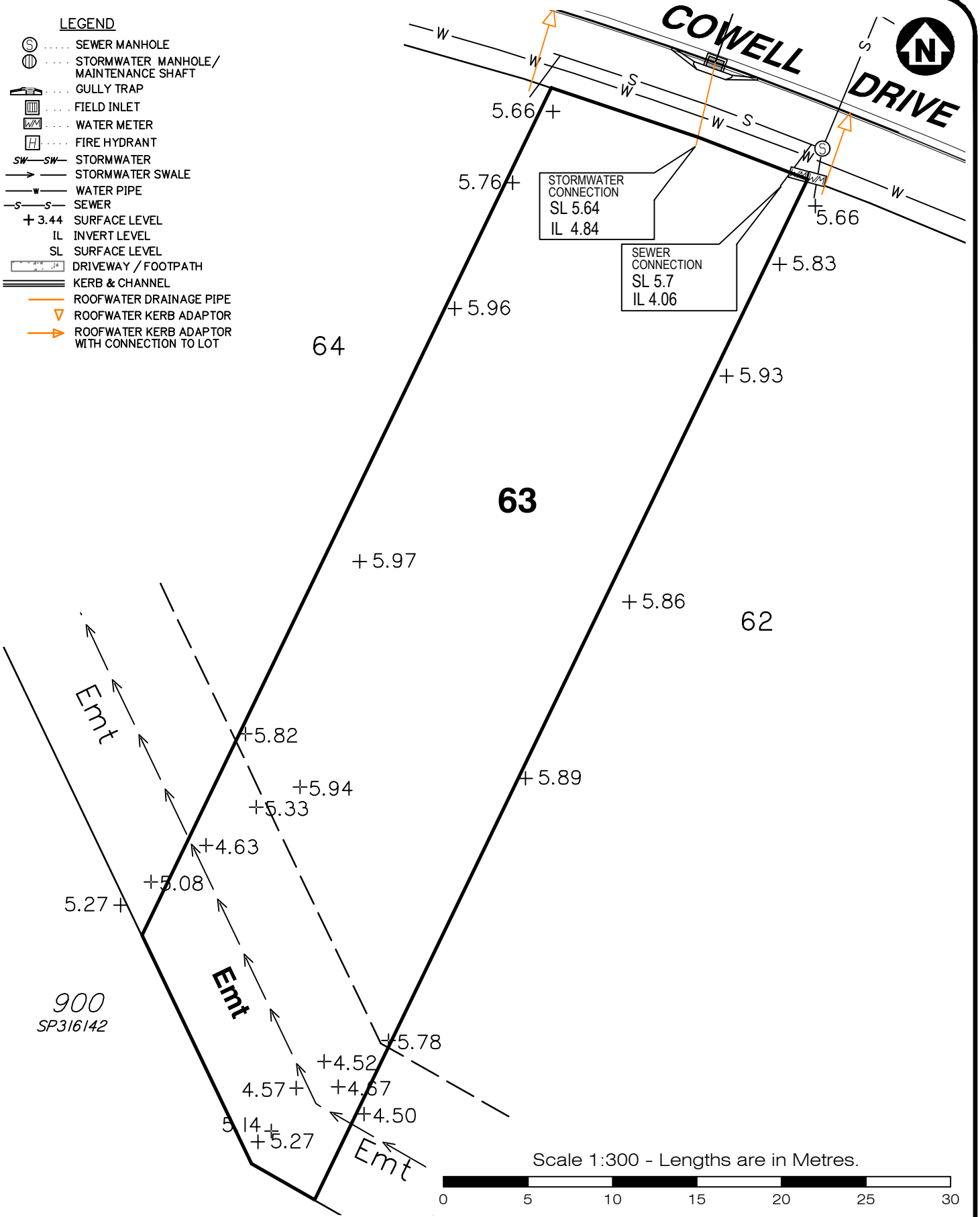

Scale 1:300 - Lengths are in Metres.

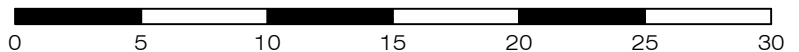

**gassman
development
perspectives**

planning | environment | landscape | engineering | survey

T: 3807 3333 | F: 3287 5461 | www.gassman.com.au

Gold Coast & Logan | 76 Business Street, Yatala QLD | PO Box 392, Beenleigh 4207

Client
Burleigh Heads Estate Pty Ltd

Project **SERVICE LOCATION SKETCH PLAN**

LOT 63 on SP316165

**Stage 1C, The Arbour Burleigh
Cowell Drive, Burleigh Heads**

Real Property Description:
Lot 63 on SP316165

Locality	BURLEIGH HEADS	Issue Date	23/03/2023
Local Govt	GOLD COAST CITY COUNCIL	Meridian	SP316165
		Level Datum	AHD
Scale (on A4 original)	1:300	Drawn	S. Holt
		Date Drafted	22/03/2023
		Checked	T. Geraghty
REFERENCE No.	5967-1C		
PLAN No.	5967 S SK LOT 63		



LEGEND

- ⊙ SEWER MANHOLE
- ⊕ STORMWATER MANHOLE/ MAINTENANCE SHAFT
- ⌒ GULLY TRAP
- ⊞ FIELD INLET
- ⊞ WATER METER
- ⊞ FIRE HYDRANT
- SW-SW STORMWATER
- STORMWATER SWALE
- W— WATER PIPE
- S— SEWER
- + 3.44 SURFACE LEVEL
- IL INVERT LEVEL
- SL SURFACE LEVEL
- ▭ DRIVEWAY / FOOTPATH
- ▬ KERB & CHANNEL
- ROOFWATER DRAINAGE PIPE
- ▽ ROOFWATER KERB ADAPTOR
- ROOFWATER KERB ADAPTOR WITH CONNECTION TO LOT

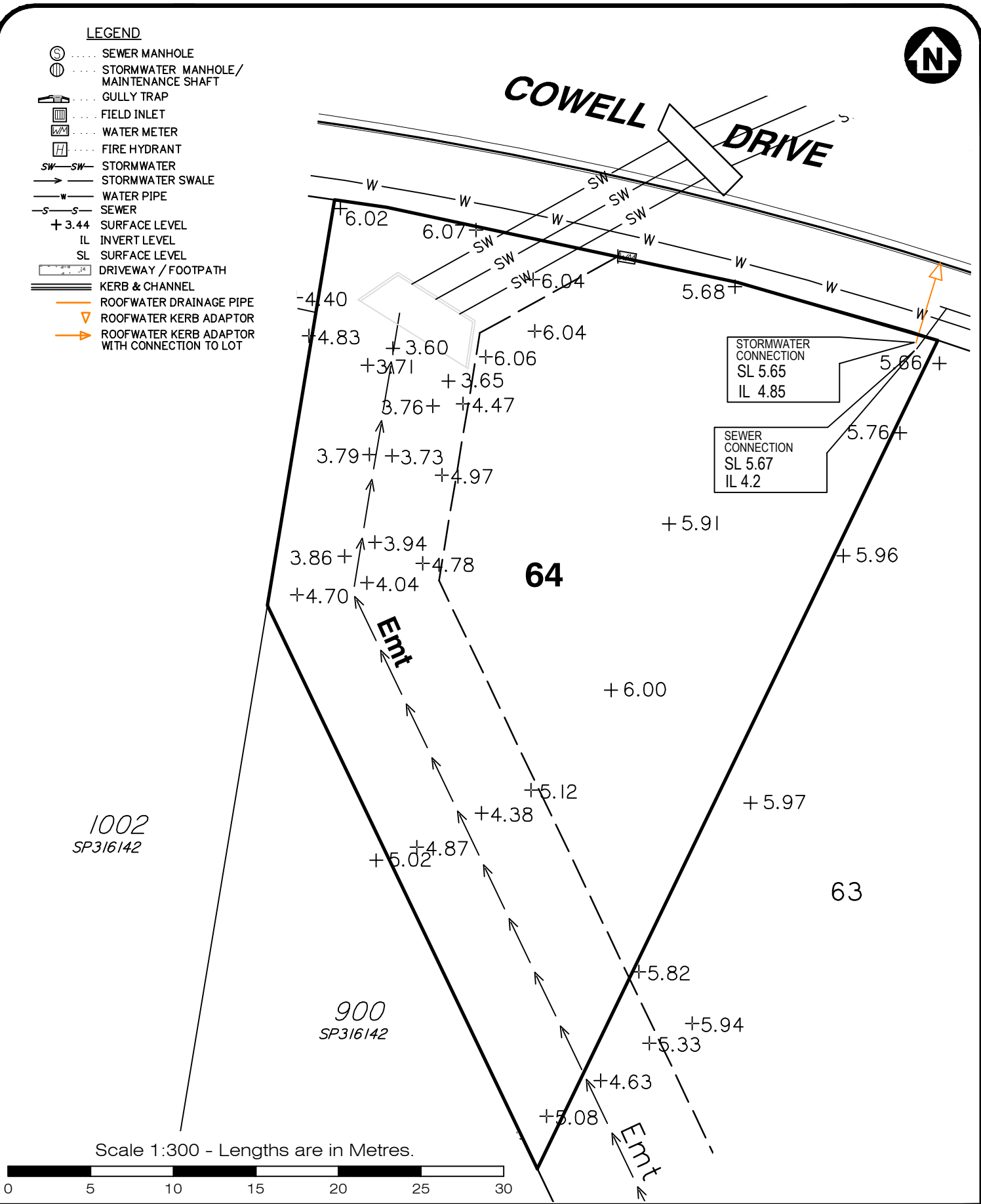

**gassman
development
perspectives**
estd 1985

planning | environment | landscape | engineering | survey

T: 3807 3333 | F: 3287 5461 | www.gassman.com.au

Gold Coast & Logan | 176 Business Street, Yatala QLD | PO Box 392, Beenleigh 4207

Client
Burleigh Heads Estate Pty Ltd

Project **SERVICE LOCATION SKETCH PLAN**

LOT 64 on SP316165

**Stage 1C, The Arbour Burleigh
Cowell Drive, Burleigh Heads**

Locality BURLEIGH HEADS

Local Govt GOLD COAST CITY COUNCIL

Scale (on A4 original)
1:300

Issue Date 23/03/2023

Meridian SP316165

Level Datum AHD

Drawn S. Holt

Date Drafted 22/03/2023

Checked T. Geraghty

Real Property Description:
Lot 64 on SP316165

REFERENCE No. 5967-1C

PLAN No. 5967 S SK LOT 64