

FOR CONTINUATION REFER DWG 31-26332-L701

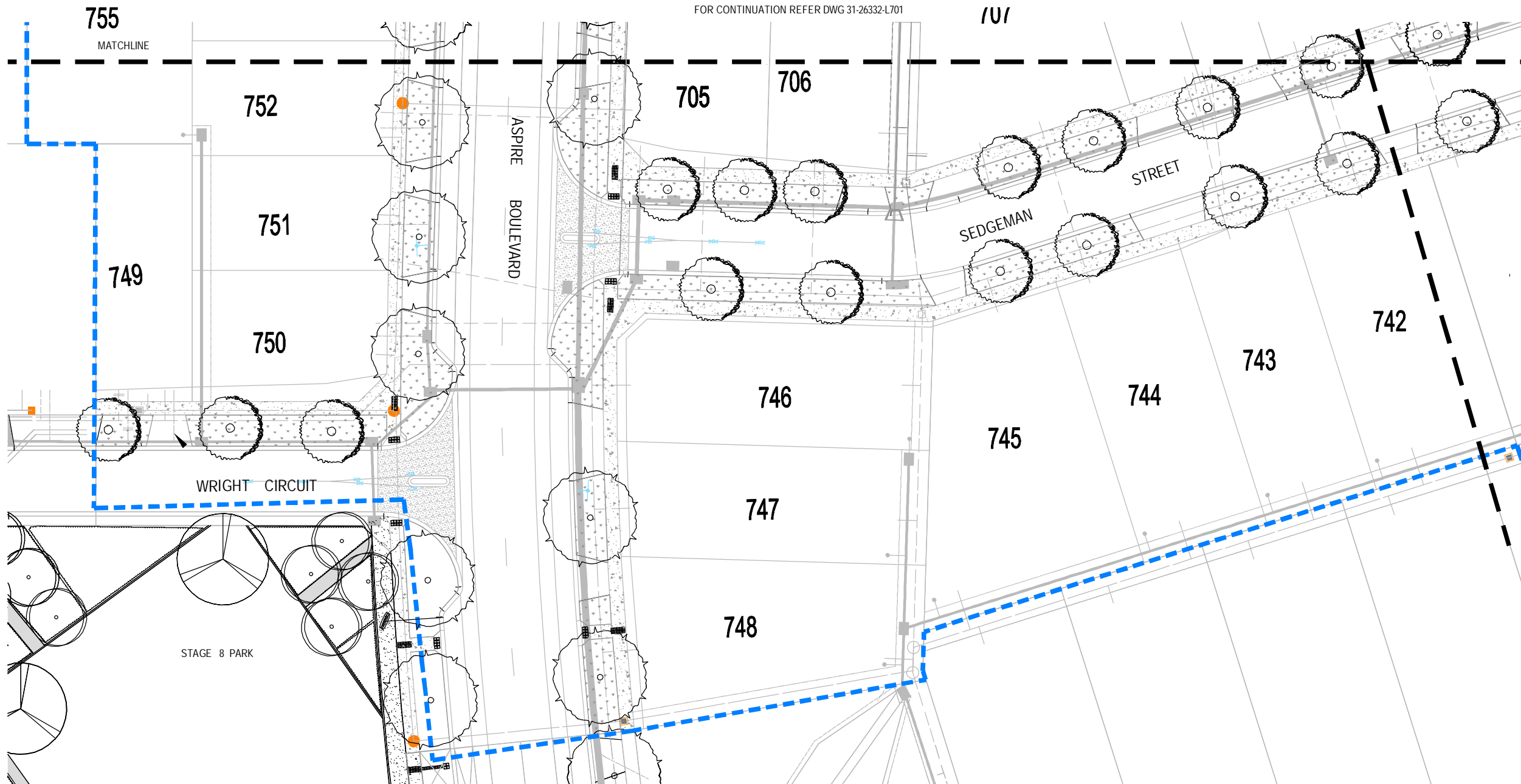

LEGEND:

CONCRETE BY CIVIL CONTRACTOR

GRASS AREAS HYDROSEED

STAGE BOUNDARY

STREET TREE - *Angophora costata*

STREET TREE - *Lagerstroemia indica x L. fauriei* 'Natchez'

STREET TREE - *Tristania Laurina*

STREET TREE - *Pyrus calleryana* 'Edgewood'

STREET TREE - *Ulmus parvifolia* 'Todd'

STREET TREE - *Prunus cerasifera* 'Oakville Crimson Spire'

PLANT SCHEDULE STAGE 7

CODE	SPECIES	COMMON NAME	PLANTS/ m2	COMP %	PLANT SIZE	QUANTITY	COMMENTS
ADVANCE TREE PLANTING STREETSCAPES							
ANG cos	<i>Angophora costata</i>	SMOOTH BARKED APPLE	AS SHOWN	0	100 Litre 50mm CAL 3.5m HIGH	8	AS SHOWN
PYR ED	<i>Pyrus calleryana</i> 'Edgewood'	EDGEWOOD	AS SHOWN	0	45 Litre 30mm CAL 2.5m HIGH	16	AS SHOWN
						TOTAL PLANTS	24

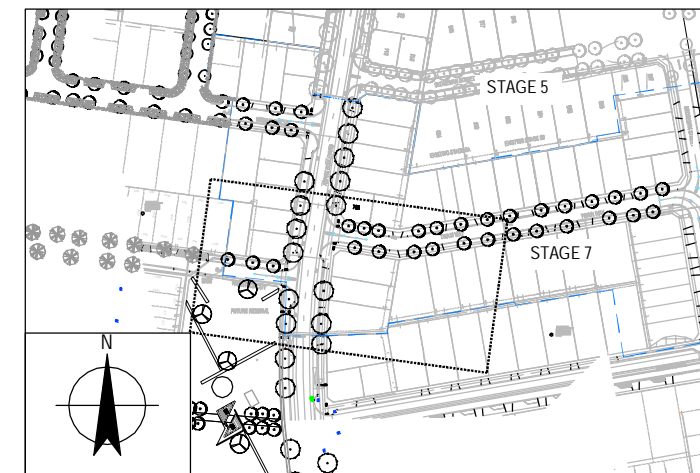

LOCATION PLAN
SCALE 1:2000



WARNING
ALL SERVICES SHOWN ON THIS DRAWING ARE APPROXIMATE ONLY AND EXACT LOCATION IS TO BE CONFIRMED ON SITE BY CONTRACTOR PRIOR TO COMMENCEMENT OF ANY WORKS.

PRELIMINARY

C	ISSUED FOR APPROVAL	GC	GC	SG	21.01.14	
B	ISSUED FOR APPROVAL	GC	GC	SG	13.12.13	
A	ISSUE FOR APPROVAL	GC	GC	SG	19.08.13	
No	Revision	Note: * indicates signatures on original issue of drawing or last revision of drawing	Drawn	Job Manager	Project Director	Date



0 2.5 5 7.5 10 12.5m
SCALE 1:250 AT ORIGINAL SIZE

Level 8, 180 Lonsdale Street, Melbourne VIC 3000 Australia
T 61 3 8687 8000 F 61 3 8687 8111
E mel@mail@ghd.com.au W www.ghd.com

DO NOT SCALE

Conditions of Use.
This document may only be used by GHD's client (and any other person who GHD has agreed can use this document) for the purpose for which it was prepared and must not be used by any other person or for any other purpose.

Drawn	Designer G. CATER
Drafting Check	Design Check
Approved (Project Director)	Date
Scale 1:250	This Drawing must not be used for Construction unless signed as Approved

Client **VILLAWOOD PROPERTIES ASPIRE DEVELOPMENT**
Project **STAGE 7 STREET TREE PLAN SHEET 2 of 4**

Original Size **A1 Drawing No: 31-26332-L702**

Rev: C