

## LEGEND

- Proposed Tree  
As scheduled, detailed and specified
- Proposed Grass  
As scheduled, detailed and specified
- Existing Underground Services  
By others
- Street lights  
By others
- Extent of Works

## PLANNING AND ENVIRONMENT ACT CITY OF WHITTLESEA

### PLANNING SCHEME

Plan referred to in Permit to use  
and/or develop land.

Application No. 716630 - Condition # 18.2

Sheet 4 of 9

Date Permit Issued 04/03/2017

Town Planner [Signature] Date 17/04/2018

PLANT SCHEDULE - LD401					
CODE	BOTANICAL NAME	COMMON NAME	QTY	DENSITY	INSTALL SIZE
TREES					
Ce	<i>Corymbia eximia</i>	Yellow Bloodwood	8	As shown	45L pot
Cm	<i>Corymbia maculata</i>	Spotted Gum	4	As shown	45L pot
Lc	<i>Lophospermum confertus</i>	Brush Box	10	As shown	45L pot
Total			20		

NOTE: 45L tree stock to have a minimum height of 1.8m - 2.2m and calliper of 25mm - 30mm

H 1:250  
SCALE @ A1



© Spiire Australia Pty Ltd All Rights Reserved  
This document is produced by Spiire Australia Pty Ltd solely for the  
benefit of and use by the client in accordance with the terms of the  
retainer. Spiire Australia Pty Ltd does not and shall not assume any  
responsibility or liability whatsoever to any third party arising out of  
any use or reliance by third party on the content of this document.

**spiire**

469 La Trobe Street PO Box 16084 Melbourne  
Victoria 8007 Australia T 61 3 9993 7888  
spiire.com.au ABN 55 050 029 635



Designed  
SF  
Authorised  
SB

Checked  
SV  
Date  
22-02-18

RATHDOWNE ESTATE  
STAGE 2 STREETSCAPES  
STREETSCAPE PLAN 2

CITY OF WHITTLESEA  
CRAIGIEBURN ROAD PROJECTS PTY LTD

**PRELIMINARY** Drg No **304813LD401** Rev **B**



file name: Stage 2 LD402 layout name: LD402, plotted by: Adam Gardner  
file location: G:\303\10481\Landscapes\Products\Plot date: 22/07/2018 17:28 PM Sheet 4 of 8 Sheets

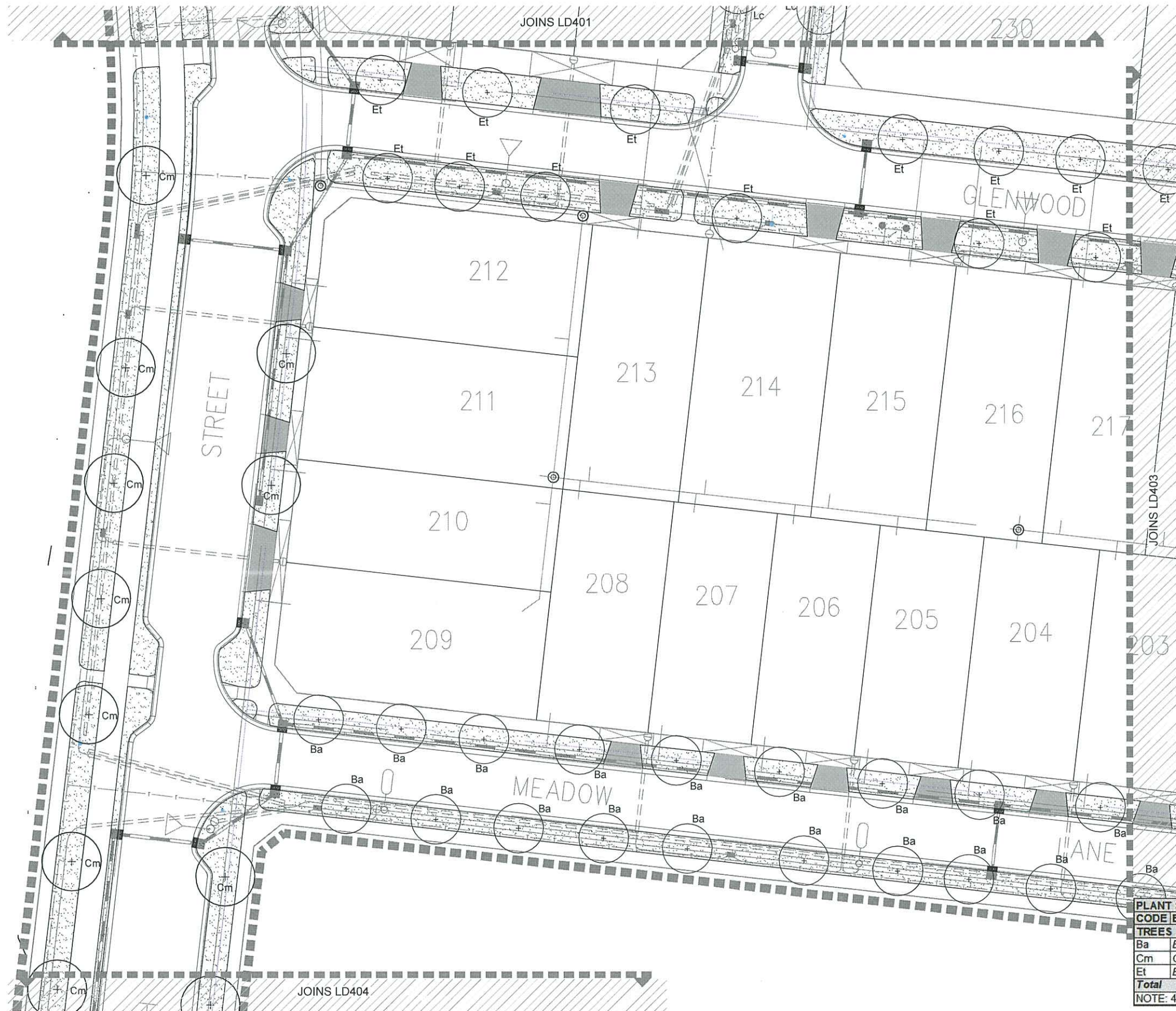

## LEGEND

- Proposed Tree  
As scheduled, detailed and specified
- Proposed Grass  
As scheduled, detailed and specified
- Existing Underground Services  
By others
- Street lights  
By others
- Extent of Works

## PLANNING AND ENVIRONMENT AC1 CITY OF WHITTLESEA PLANNING SCHEME

Plan referred to in Permit to use  
and/or develop land.

Application No. 716630 - Condition #18.2

Sheet 5 of 9

Date Permit Issued 04/08/2017

[Signature] 17/04/2018  
Town Planner Date

PLANT SCHEDULE - LD402					
CODE	BOTANICAL NAME	COMMON NAME	QTY	DENSITY	INSTALL SIZE
TREES					
Ba	<i>Brachychiton acerifolius</i> 'Jerrilder'	Illawarra Plane Tree	18	As shown	45L pot
Cm	<i>Corymbia maculata</i>	Spotted Gum	9	As shown	45L pot
Et	<i>Eucalyptus torquata</i>	Coral Gum	12	As shown	45L pot
Total			39		

NOTE: 45L tree stock to have a minimum height of 1.8m - 2.2m and calliper of 25mm - 30mm

Rev	Amendments	Approved	Date
B	ISSUED TO COUNCIL	SV	22-02-18
A	ISSUED TO COUNCIL	SB	08-11-17

H 1:250  
SCALE @ A1



© Spiire Australia Pty Ltd All Rights Reserved  
This document is produced by Spiire Australia Pty Ltd solely for the  
benefit of and use by the client in accordance with the terms of the  
retainer. Spiire Australia Pty Ltd does not and shall not assume any  
responsibility or liability whatsoever to any third party arising out of  
any use or reliance by third party on the content of this document.

**spiire**

469 La Trobe Street PO Box 16084 Melbourne  
Victoria 8007 Australia T 61 3 9993 7888  
spiire.com.au ABN 55 050 029 635

Designed  
SF  
Authorised  
SB



Checked  
SV  
Date  
22-02-18

**RATHDOWNE ESTATE  
STAGE 2 STREETSCAPES  
STREETSCAPE PLAN 3**

CITY OF WHITTLESEA  
CRAIGIEBURN ROAD PROJECTS PTY LTD

**PRELIMINARY** 304813LD402

Rev  
B





# LEGEND

- Proposed Tree  
As scheduled, detailed and specified
- Proposed Grass  
As scheduled, detailed and specified
- Existing Underground Services  
By others
- Street lights  
By others
- Extent of Works

## PLANNING AND ENVIRONMENT ACT CITY OF WHITTLESEA

### PLANNING SCHEME

Plan referred to in Permit to use  
and/or develop land.

Application No. 716630-Condition # 18.2

Sheet 6 of 9

Date Permit Issued 04/08/2017

Town Planner [Signature] Date 17/04/2018

PLANT SCHEDULE - LD403					
CODE	BOTANICAL NAME	COMMON NAME	QTY	DENSITY	INSTALL SIZE
TREES					
Ba	<i>Brachychiton acerifolius</i> 'Jerriden'	Illawarra Plane Tree	4	As shown	45L pot
Et	<i>Eucalyptus torquata</i>	Coral Gum	11	As shown	45L pot
Total			15		

NOTE: 45L tree stock to have a minimum height of 1.8m - 2.2m and calliper of 25mm - 30mm

File name: Stage 2 LD403 layout name: LD403 Plotted by: Adam Gardner  
The location is: 100/100/100/100 Product Plot date: 22/02/2018 5:28 PM Sheet 5 of 8 Sheets

Rev	Amendments	Approved	Date
B	ISSUED TO COUNCIL	SV	22-02-18
A	ISSUED TO COUNCIL	SB	08-11-17

H 1:250  
SCALE @ A1



© Spiire Australia Pty Ltd All Rights Reserved  
This document is produced by Spiire Australia Pty Ltd solely for the  
benefit of and use by the client in accordance with the terms of the  
retainer. Spiire Australia Pty Ltd does not and shall not assume any  
responsibility or liability whatsoever to any third party arising out of  
any use or reliance by third party on the content of this document.

**spiire**

469 La Trobe Street PO Box 16084 Melbourne  
Victoria 8007 Australia T 61 3 9993 7888  
spiire.com.au ABN 55 050 029 635



Designed  
SF  
Authorised  
SB

Checked  
SV  
Date  
22-02-18

**RATHDOWNE ESTATE  
STAGE 2 STREETSCAPES  
STREETSCAPE PLAN 4**



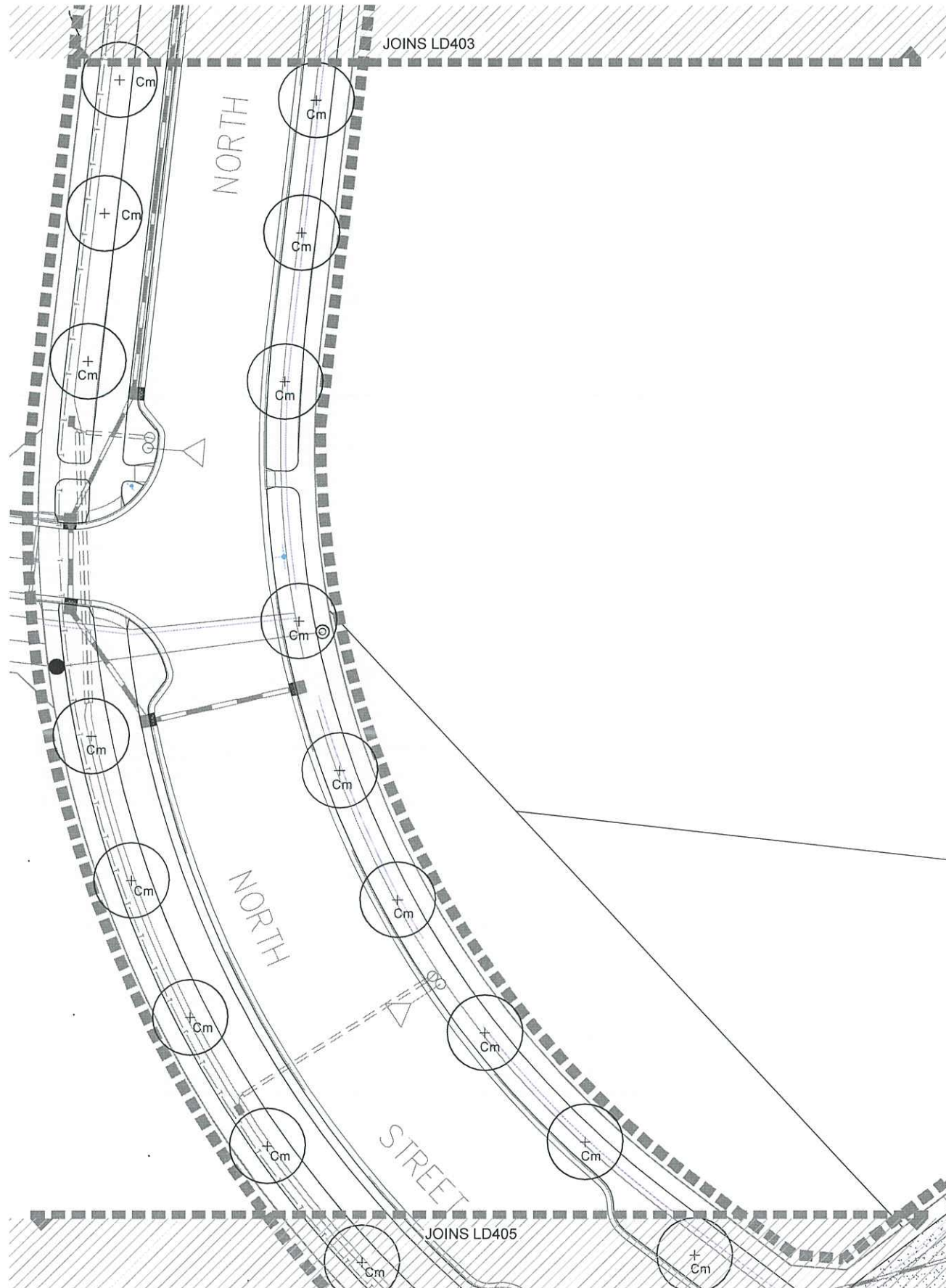

CITY OF WHITTLESEA  
CRAIGIEBURN ROAD PROJECTS PTY LTD

**PRELIMINARY** Drg No 304813LD403 Rev B





## LEGEND

-  Proposed Tree  
As scheduled, detailed and specified
-  Proposed Grass  
As scheduled, detailed and specified
-  Existing Underground Services  
By others
-  Street lights  
By others
-  Extent of Works

## PLANNING AND ENVIRONMENT AC1 CITY OF WHITTLESEA

### PLANNING SCHEME

Plan referred to in Permit to use  
and/or develop land.

Application No. 716630 - Condition # 18.2

Sheet 7 of 9

Date Permit Issued 04/08/2017

Town Planner [Signature] Date 17/04/2018

PLANT SCHEDULE - LD404					
CODE	BOTANICAL NAME	COMMON NAME	QTY	DENSITY	INSTALL SIZE
TREES					
Cm	Corymbia maculata	Spotted Gum	15	As shown	45L pot
Total			15		

NOTE: 45L tree stock to have a minimum height of 1.8m - 2.2m and calliper of 25mm - 30mm

File name: Stage 2\_LD404.dwg, plotted by: Adam Gardner, Plot date: 22/07/2018 2:29 PM Sheet 6 of 8 Streets

Rev	Amendments	Approved	Date
B	ISSUED TO COUNCIL	SV	22-02-18
A	ISSUED TO COUNCIL	SB	08-11-17

H 1:250  
SCALE @ A1



© Spiire Australia Pty Ltd All Rights Reserved  
This document is produced by Spiire Australia Pty Ltd solely for the  
benefit of and use by the client in accordance with the terms of the  
retainer. Spiire Australia Pty Ltd does not and shall not assume any  
responsibility or liability whatsoever to any third party arising out of  
any use or reliance by third party on the content of this document.

**spiire**

469 La Trobe Street PO Box 16084 Melbourne  
Victoria 8007 Australia T 61 3 9993 7888  
spiire.com.au ABN 55 050 029 635



Designed  
SF  
Authorised  
SB

Checked  
SV  
Date  
22-02-18

RATHDOWNE ESTATE  
STAGE 2 STREETSCAPES  
STREETSCAPE PLAN 5

CITY OF WHITTLESEA  
CRAIGIEBURN ROAD PROJECTS PTY LTD

**PRELIMINARY** Drg No 304813LD404 Rev B



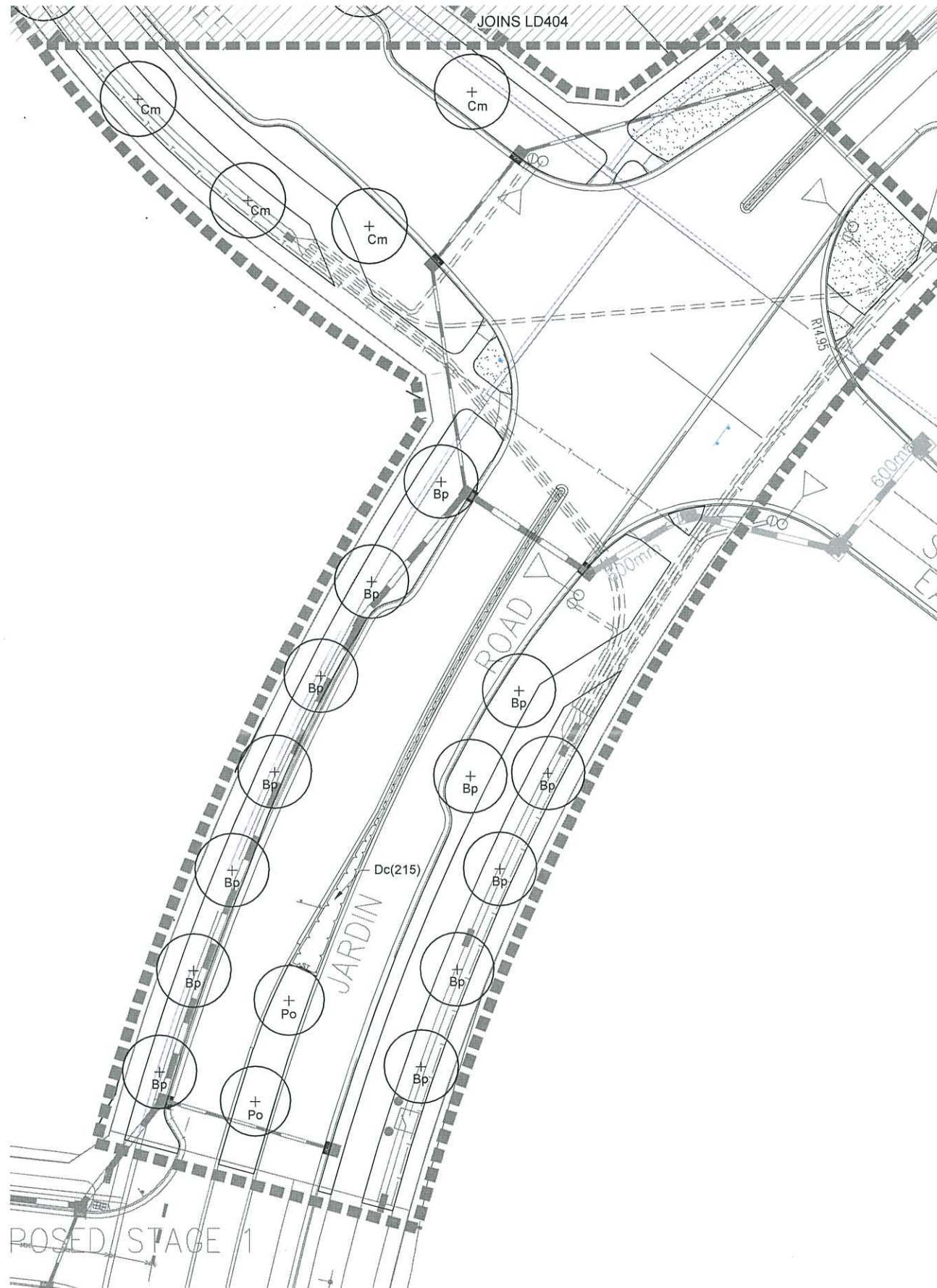

## LEGEND

- Proposed Tree  
As scheduled, detailed and specified
- Proposed Grass  
As scheduled, detailed and specified
- PLANTED BED  
As scheduled, detailed and specified
- Steel Edge  
As scheduled, detailed and specified
- Existing Underground Services  
By others
- Street lights  
By others
- Extent of Works

## PLANNING AND ENVIRONMENT AC1 CITY OF WHITTLESEA

### PLANNING SCHEME

Plan referred to in Permit to use  
and/or develop land.

Application No. 716630 - Condition # 18.2

Sheet 8 of 9

Date Permit Issued 04/08/2017

Town Planner [Signature] Date 17/04/2018

PLANT SCHEDULE - LD405					
CODE	BOTANICAL NAME	COMMON NAME	QTY	DENSITY	INSTALL SIZE
TREES					
Bp	<i>Brachychiton populneus</i>	Kurajong Tree	13	As shown	100L pot
Cm	<i>Corymbia maculata</i>	Spotted Gum	4	As shown	45L pot
Po	<i>Platanus orientalis 'Digitata'</i>	Cyprian Plane	2	As shown	45L pot
Total			19		
SHRUBS					
Dc	<i>Dianella caerulea 'Little Jess'</i>	Little Jess	215	4/m <sup>2</sup>	150mm pot
Total			215		

NOTE: 45L tree stock to have a minimum height of 1.8m - 2.2m and calliper of 25mm - 30mm

H 1:250  
SCALE @ A1



© Spiire Australia Pty Ltd All Rights Reserved  
This document is produced by Spiire Australia Pty Ltd solely for the  
benefit of and use by the client in accordance with the terms of the  
retainer. Spiire Australia Pty Ltd does not and shall not assume any  
responsibility or liability whatsoever to any third party arising out of  
any use or reliance by third party on the content of this document.

**spiire**

469 La Trobe Street PO Box 16084 Melbourne  
Victoria 8007 Australia T 61 3 9993 7888  
spiire.com.au ABN 55 050 029 635



Designed  
SF  
Authorised  
SB

Checked  
SV  
Date  
22-02-18

RATHDOWNE ESTATE  
STAGE 2 STREETSCAPES  
STREETSCAPE PLAN 6

CITY OF WHITTLESEA  
CRAIGIEBURN ROAD PROJECTS PTY LTD

**PRELIMINARY** Drg No 304813LD405

Rev  
B



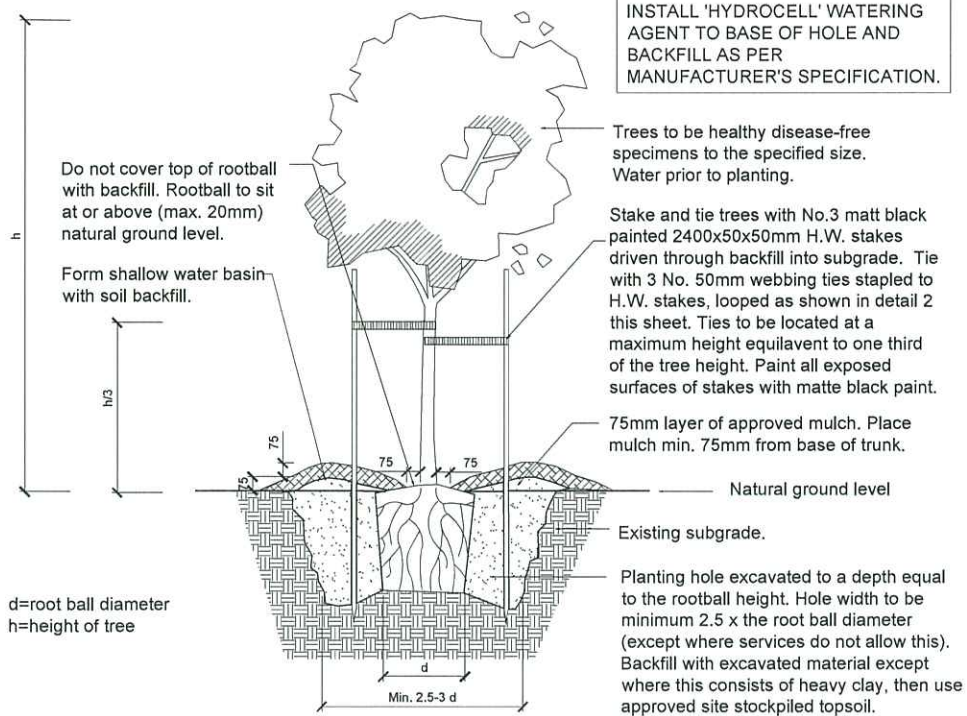

1 SEMI-ADVANCED TREE PLANTING DETAIL  
LD700 Scale 1:20 @ A1

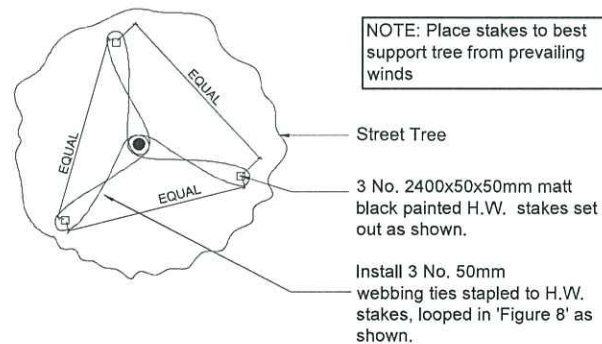

2 SEMI ADVANCED TREE TIE DETAIL  
LD700 Scale 1:20 @ A1

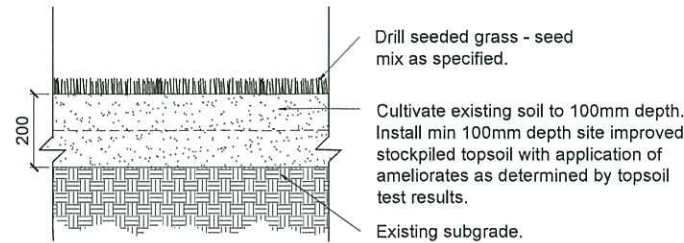

- NOTES:
- Existing pasture grass and/or weeds are to be sprayed with herbicide.
  - No machinery to be used within the drip line of existing trees.
  - Topsoil to be raked to a fine tilth, removal of all surface rocks, large lumps of clay, weeds, rubbish prior to application of drill seeded grass to all areas as shown.
  - New grassed areas to be protected from trespass and traffic with star pickets and barrier rope until grass is established.

3 HYDROMULCH GRASS DETAIL  
LD700 Scale 1:10 @ A1

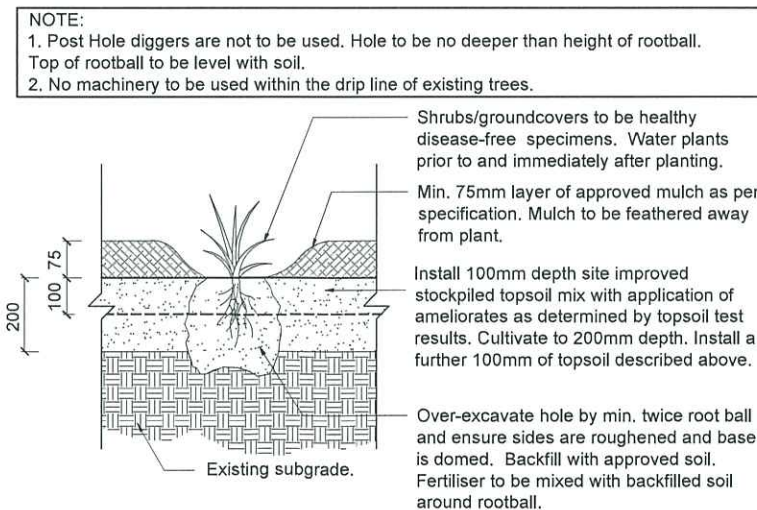

4 SHRUB PLANTING DETAIL  
LD700 Scale 1:10 @ A1

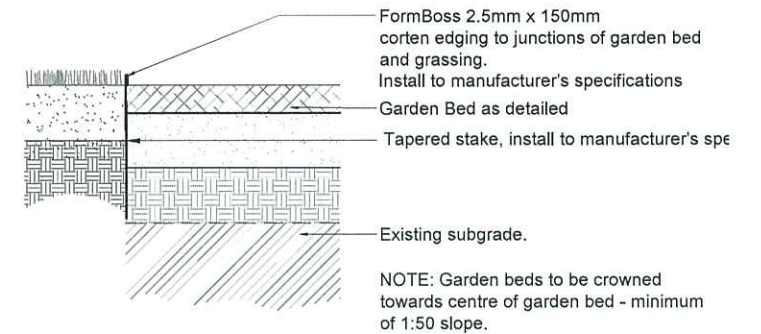

5 STEEL EDGE DETAIL  
LD700 Scale 1:10 @ A1

## PLANNING AND ENVIRONMENT ACT CITY OF WHITTLESEA

### PLANNING SCHEME

Plan referred to in Permit to use  
and/or develop land.

Application No. 716630 - Condition # 18.2

Sheet 9 of 9

Date Permit Issued 04/08/2017

Town Planner [Signature] Date 17/04/2018

AS SHOWN



© Spiire Australia Pty Ltd All Rights Reserved  
This document is produced by Spiire Australia Pty Ltd solely for the  
benefit of and use by the client in accordance with the terms of the  
retainer. Spiire Australia Pty Ltd does not and shall not assume any  
responsibility or liability whatsoever to any third party arising out of  
any use or reliance by third party on the content of this document.

**spiire**

469 La Trobe Street PO Box 16084 Melbourne  
Victoria 3007 Australia T 61 3 9993 7888  
spiire.com.au ABN 55 050 029 635



Designed  
SF  
Authorised  
SB

Checked  
SV  
Date  
22-02-18

RATHDOWNE ESTATE  
STAGE 2 STREETSCAPES  
LANDSCAPE DETAILS

CITY OF WHITTLESEA  
CRAIGIEBURN ROAD PROJECTS PTY LTD

**PRELIMINARY** Drg No **304813LD700** Rev **B**