



**CIVIL GEOTECHNICAL SERVICES**  
**ABN 26 474 013 724**  
**PO Box 678 Croydon Vic 3136**  
**Telephone: 9723 0744 Facsimile: 9723 0799**

13<sup>th</sup> September 2023

Our Reference: 23688:NB1661

Winslow Constructors Pty Ltd  
50 Barry Road  
CAMPBELLFIELD VIC 3061

Dear Sirs/Madams,

**RE: LEVEL 1 EARTHWORKS INSPECTION AND TESTING  
ALAMORA - STAGE 14 (TARNEIT)**

Please find attached our Report No's 23688/R001 to 23688/R005 which relates to the field density testing that was conducted within the filled allotments at the above subdivision. The level 1 inspections and associated field density testing was performed in August 2023.

The inspections and testing of the earthworks was undertaken in general accordance with the Level 1 requirements of AS 3798 - Guidelines on Earthworks for Commercial and Residential Developments.

The site inspection and testing was performed by experienced geotechnicians from this office. Any areas that were deemed unsatisfactory were reworked and retested under their supervision. The testing was performed to the relevant Australian Standards and the accompanying test reports carry NATA endorsement. The attached compaction results, which were located randomly throughout the fill profile, are considered to be representative of the bulk fill materials that were placed across the reported allotments by Winslow Constructors during the aforementioned period. The approximate locations of the field density tests can be seen on the attached plan (Figure 1).

We are of the view that the bulk fill materials that have been placed across the reported allotments by Winslow Constructors during the aforementioned period can be considered as having been placed in a controlled manner to a minimum density ratio of 95% (standard compactive effort).

Please contact the undersigned if you require any additional information.

Civil Geotechnical Services

A handwritten signature in blue ink, appearing to read 'Nick Brock', is written over a light blue circular stamp.

Nick Brock

# FIGURE 1

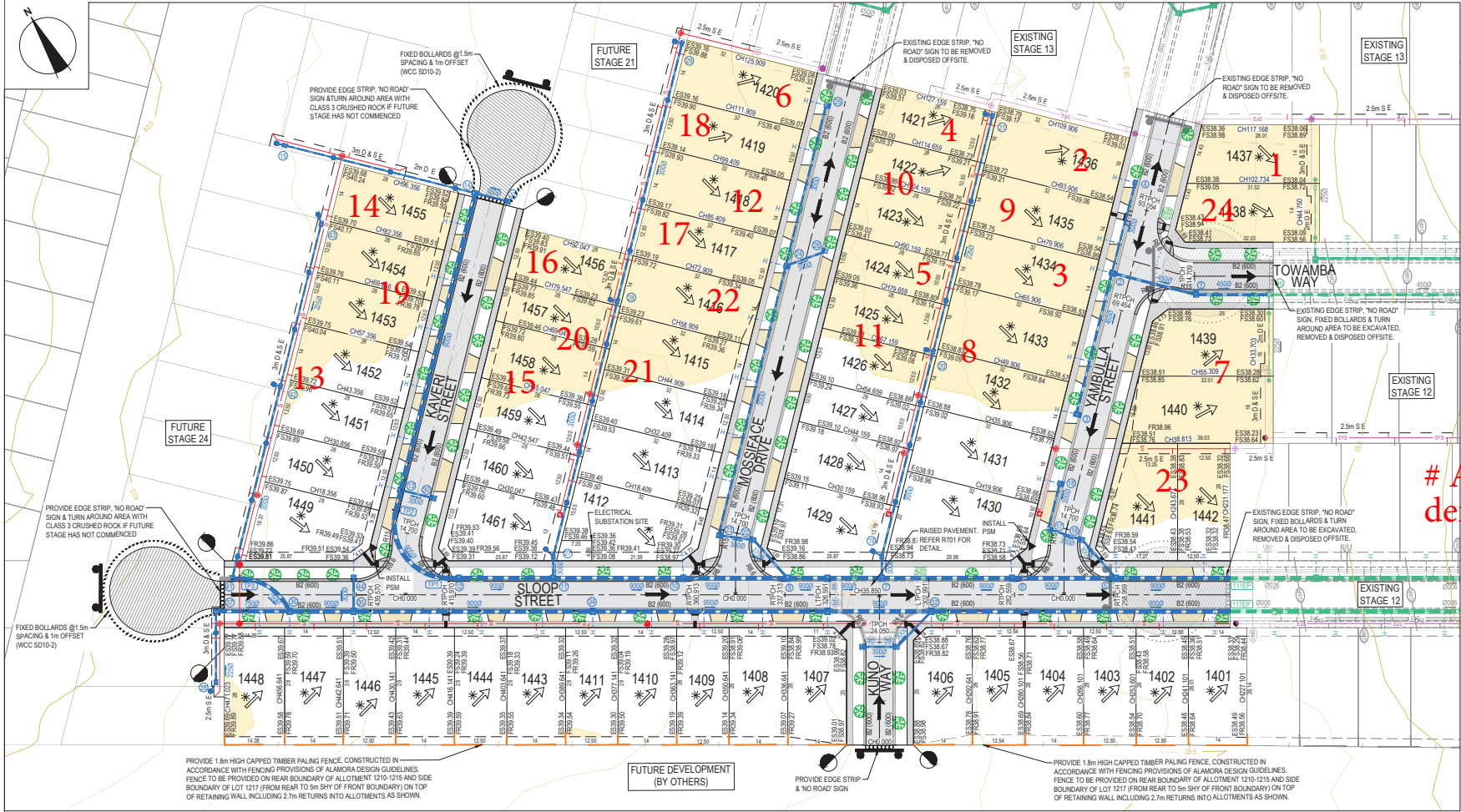
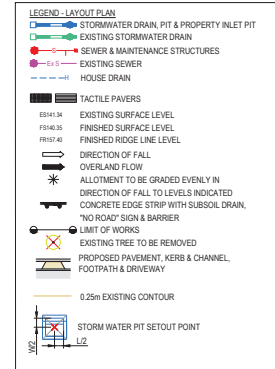
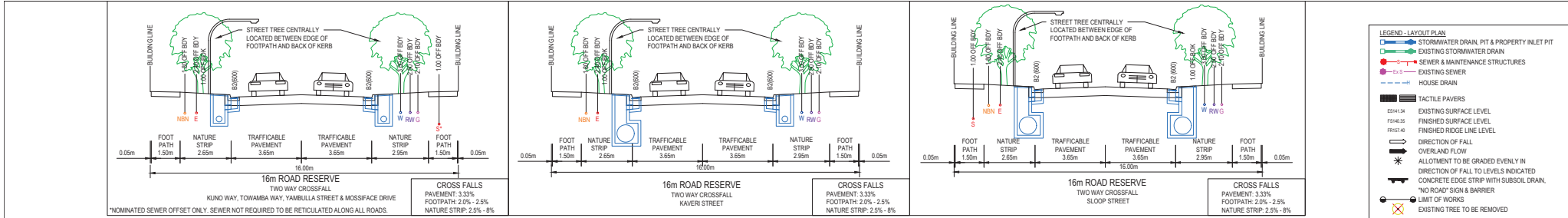

# Approximate field density test location

NOTE: STREET TREE LOCATIONS SHOWN ARE INDICATIVE ONLY. ULTIMATE LOCATION IS TO BE PROVIDED/CONFIRMED BY LANDSCAPE ARCHITECTS

**WARNING**  
**BEWARE OF UNDERGROUND & OVERHEAD SERVICES**  
The locations of underground & overhead services are approximate only & their exact position should be proven on site. No guarantee is given that all existing services are shown. Locate all underground services before commencement of works  
**DIAL 1100 BEFORE YOU DIG**  
[www.1100.com.au](http://www.1100.com.au)

REVISION	DATE	ISSUE DESCRIPTION	DRAWN	CHECKED	APPROVED
0	06/07/23	ISSUED FOR CONSTRUCTION	M.P.	M.P.	M.T.
B	27/06/23	ISSUED FOR TENDER	M.P.	M.P.	M.T.
A	02/06/23	ISSUED FOR APPROVAL	M.P.	M.P.	M.T.



PROJECT: ALAMORA - STAGE 14 LAYOUT PLAN

STATUS: ISSUED FOR CONSTRUCTION

SCALE	DRAWN	DESIGNED
1:500 @ A1	M.PLANT	M.PLANT
PROJECT ENGINEER	PROJECT MANAGER	DATE FIRST ISSUE
M.TROUNCE	M.TROUNCE	JUNE 2023
PROJECT NO.	DRAWING NO.	REVISION
200282.14	R200	0



# COMPACTION ASSESSMENT

Job No 23688  
 Report No 23688/R001  
 Date Issued 08/09/23

## CIVIL GEOTECHNICAL SERVICES

6 - 8 Rose Avenue, Croydon 3136

Client	WINSLOW CONSTRUCTORS PTY LTD (CAMPBELLFIELD)	Tested by	JB
Project	ALAMORA - STAGE 14	Date tested	22/08/23
Location	TARNEIT	Checked by	JHF

Feature	EARTHWORKS	Layer thickness	200 mm	Time: 10:00
---------	------------	-----------------	--------	-------------

### Test procedure AS 1289.2.1.1 & 5.8.1

Test No	1	2	3	-	-	-
Location	REFER TO FIGURE 1	REFER TO FIGURE 1	REFER TO FIGURE 1			
Approximate depth below FSL						
Measurement depth	mm	175	175	175	-	-
Field wet density	t/m <sup>3</sup>	2.01	2.03	2.03	-	-
Field moisture content	%	25.5	26.8	27.5	-	-

### Test procedure AS 1289.5.7.1

Test No	1	2	3	-	-	-
Compactive effort	Standard					
Oversize rock retained on sieve	mm	19.0	19.0	19.0	-	-
Percent of oversize material	wet	0	0	0	-	-
Peak Converted Wet Density	t/m <sup>3</sup>	2.06	2.07	2.06	-	-
Adjusted Peak Converted Wet Density	t/m <sup>3</sup>	-	-	-	-	-
Optimum Moisture Content	%	28.0	27.0	30.0	-	-

Moisture Variation From Optimum Moisture Content	2.5% dry	0.0%	2.0% dry	-	-	-
--	----------	------	----------	---	---	---

density and moisture ratio results relate only to the soil to the depth of test and not to the full depth of the layer

Density Ratio ( R <sub>HD</sub> )	%	97.5	98.0	98.5	-	-
-----------------------------------	---	------	------	------	---	---

### Material description

No 1 - 3 Clay Fill
--------------------

AVRLOT HILF V1.10 MAR 13



NATA Accredited Laboratory No 9909  
 Accredited for compliance with  
 ISO/IEC 17025 - Testing

Approved Signatory : Justin Fry



# COMPACTION ASSESSMENT

Job No 23688  
 Report No 23688/R002  
 Date Issued 08/09/23

## CIVIL GEOTECHNICAL SERVICES

6 - 8 Rose Avenue, Croydon 3136

Client	WINSLOW CONSTRUCTORS PTY LTD (CAMPBELLFIELD)	Tested by	JB
Project	ALAMORA - STAGE 14	Date tested	23/08/23
Location	TARNEIT	Checked by	JHF

Feature	EARTHWORKS	Layer thickness	200 mm	Time: 07:30
---------	------------	-----------------	--------	-------------

### Test procedure AS 1289.2.1.1 & 5.8.1

Test No	4	5	6	7	8	9
Location	REFER TO FIGURE 1	REFER TO FIGURE 1	REFER TO FIGURE 1	REFER TO FIGURE 1	REFER TO FIGURE 1	REFER TO FIGURE 1
Approximate depth below FSL						
Measurement depth	mm	175	175	175	175	175
Field wet density	t/m <sup>3</sup>	1.82	1.85	1.89	1.86	1.85
Field moisture content	%	26.0	25.1	23.9	23.1	24.7

### Test procedure AS 1289.5.7.1

Test No	4	5	6	7	8	9
Compactive effort	Standard					
Oversize rock retained on sieve	mm	19.0	19.0	19.0	19.0	19.0
Percent of oversize material	wet	0	0	0	0	0
Peak Converted Wet Density	t/m <sup>3</sup>	1.86	1.86	1.88	1.87	1.86
Adjusted Peak Converted Wet Density	t/m <sup>3</sup>	-	-	-	-	-
Optimum Moisture Content	%	28.5	27.5	24.5	26.0	26.5

Moisture Variation From Optimum Moisture Content	2.5% dry	2.5% dry	0.5% dry	2.5% dry	2.0% dry	0.5% dry
--	----------	----------	----------	----------	----------	----------

density and moisture ratio results relate only to the soil to the depth of test and not to the full depth of the layer

Density Ratio ( R <sub>HD</sub> )	%	98.0	99.5	101.0	99.5	99.5	98.5
-----------------------------------	---	------	------	-------	------	------	------

### Material description

No 4 - 9 Clay Fill
--------------------

AVRLOT HILF V1.10 MAR 13



NATA Accredited Laboratory No 9909  
 Accredited for compliance with  
 ISO/IEC 17025 - Testing

Approved Signatory : Justin Fry



# COMPACTION ASSESSMENT

Job No 23688  
 Report No 23688/R003  
 Date Issued 07/09/23

## CIVIL GEOTECHNICAL SERVICES

6 - 8 Rose Avenue, Croydon 3136

Client	WINSLOW CONSTRUCTORS PTY LTD (CAMPBELLFIELD)	Tested by	JB
Project	ALAMORA - STAGE 14	Date tested	24/08/23
Location	TARNEIT	Checked by	JHF

Feature	EARTHWORKS	Layer thickness	200 mm	Time: 10:30
---------	------------	-----------------	--------	-------------

### Test procedure AS 1289.2.1.1 & 5.8.1

Test No	10	11	12	-	-	-
Location	REFER TO FIGURE 1	REFER TO FIGURE 1	REFER TO FIGURE 1			
Approximate depth below FSL						
Measurement depth	mm	175	175	175	-	-
Field wet density	t/m <sup>3</sup>	1.77	1.81	1.84	-	-
Field moisture content	%	27.1	26.2	26.2	-	-

### Test procedure AS 1289.5.7.1

Test No	10	11	12	-	-	-
Compactive effort	Standard					
Oversize rock retained on sieve	mm	19.0	19.0	19.0	-	-
Percent of oversize material	wet	0	0	0	-	-
Peak Converted Wet Density	t/m <sup>3</sup>	1.76	1.83	1.88	-	-
Adjusted Peak Converted Wet Density	t/m <sup>3</sup>	-	-	-	-	-
Optimum Moisture Content	%	29.0	28.0	29.0	-	-

Moisture Variation From Optimum Moisture Content	2.0% dry	1.5% dry	2.5% dry	-	-	-
--	----------	----------	----------	---	---	---

density and moisture ratio results relate only to the soil to the depth of test and not to the full depth of the layer

Density Ratio ( R <sub>HD</sub> )	%	100.5	98.5	98.0	-	-
-----------------------------------	---	-------	------	------	---	---

### Material description

No 10 - 12 Clay Fill
----------------------

AVRLOT HILF V1.10 MAR 13



NATA Accredited Laboratory No 9909  
 Accredited for compliance with  
 ISO/IEC 17025 - Testing

Approved Signatory : Justin Fry



# COMPACTION ASSESSMENT

Job No 23688  
 Report No 23688/R004  
 Date Issued 01/09/23

## CIVIL GEOTECHNICAL SERVICES

6 - 8 Rose Avenue, Croydon 3136

Client	WINSLOW CONSTRUCTORS PTY LTD (CAMPBELLFIELD)	Tested by	JB
Project	ALAMORA - STAGE 14	Date tested	25/08/23
Location	TARNEIT	Checked by	JHF

Feature	EARTHWORKS	Layer thickness	200 mm	Time: 07:00
---------	------------	-----------------	--------	-------------

### Test procedure AS 1289.2.1.1 & 5.8.1

Test No	13	14	15	16	17	18
Location	REFER TO FIGURE 1	REFER TO FIGURE 1	REFER TO FIGURE 1	REFER TO FIGURE 1	REFER TO FIGURE 1	REFER TO FIGURE 1
Approximate depth below FSL						
Measurement depth	mm	175	175	175	175	175
Field wet density	t/m <sup>3</sup>	1.87	1.88	1.84	1.88	1.88
Field moisture content	%	27.1	23.7	29.6	24.7	19.9

### Test procedure AS 1289.5.7.1

Test No	13	14	15	16	17	18
Compactive effort	Standard					
Oversize rock retained on sieve	mm	19.0	19.0	19.0	19.0	19.0
Percent of oversize material	wet	0	0	0	0	0
Peak Converted Wet Density	t/m <sup>3</sup>	1.96	1.88	1.92	1.93	1.93
Adjusted Peak Converted Wet Density	t/m <sup>3</sup>	-	-	-	-	-
Optimum Moisture Content	%	29.5	26.0	32.0	27.5	22.5

Moisture Variation From Optimum Moisture Content	2.0% dry	2.5% dry	2.0% dry	2.5% dry	2.5% dry	2.5% dry
--	----------	----------	----------	----------	----------	----------

density and moisture ratio results relate only to the soil to the depth of test and not to the full depth of the layer

Density Ratio ( R <sub>HD</sub> )	%	95.5	100.0	96.0	97.5	98.5	98.0
-----------------------------------	---	------	-------	------	------	------	------

### Material description

No 13 - 18 Clay Fill
----------------------

AVRLOT HILF V1.10 MAR 13



NATA Accredited Laboratory No 9909  
 Accredited for compliance with  
 ISO/IEC 17025 - Testing

Approved Signatory : Justin Fry



# COMPACTION ASSESSMENT

Job No 23688  
 Report No 23688/R005  
 Date Issued 01/09/23

## CIVIL GEOTECHNICAL SERVICES

6 - 8 Rose Avenue, Croydon 3136

Client	WINSLOW CONSTRUCTORS PTY LTD (CAMPBELLFIELD)	Tested by	JB
Project	ALAMORA - STAGE 14	Date tested	28/08/23
Location	TARNEIT	Checked by	JHF

Feature	EARTHWORKS	Layer thickness	200 mm	Time: 10:00
---------	------------	-----------------	--------	-------------

### Test procedure AS 1289.2.1.1 & 5.8.1

Test No	19	20	21	22	23	24
Location	REFER TO FIGURE 1	REFER TO FIGURE 1	REFER TO FIGURE 1	REFER TO FIGURE 1	REFER TO FIGURE 1	REFER TO FIGURE 1
Approximate depth below FSL						
Measurement depth	mm	175	175	175	175	175
Field wet density	t/m <sup>3</sup>	1.97	1.82	1.83	1.81	1.88
Field moisture content	%	19.9	20.5	21.5	26.8	27.4

### Test procedure AS 1289.5.7.1

Test No	19	20	21	22	23	24
Compactive effort	Standard					
Oversize rock retained on sieve	mm	19.0	19.0	19.0	19.0	19.0
Percent of oversize material	wet	0	0	0	0	0
Peak Converted Wet Density	t/m <sup>3</sup>	1.99	1.86	1.86	1.84	1.88
Adjusted Peak Converted Wet Density	t/m <sup>3</sup>	-	-	-	-	-
Optimum Moisture Content	%	22.5	23.0	24.0	28.5	29.5

Moisture Variation From Optimum Moisture Content	2.5% dry	2.5% dry	2.5% dry	2.0% dry	2.0% dry	2.5% dry
--	----------	----------	----------	----------	----------	----------

density and moisture ratio results relate only to the soil to the depth of test and not to the full depth of the layer

Density Ratio ( R <sub>HD</sub> )	%	99.0	98.0	98.5	98.5	100.0	98.0
-----------------------------------	---	------	------	------	------	-------	------

### Material description

No 19 - 24 Clay Fill
----------------------

AVRLOT HILF V1.10 MAR 13



NATA Accredited Laboratory No 9909  
 Accredited for compliance with  
 ISO/IEC 17025 - Testing

Approved Signatory : Justin Fry