

**RAKIA LANE**  
TYPICAL SECTION A - A  
8.0m ROAD RESERVE  
LANEWAY

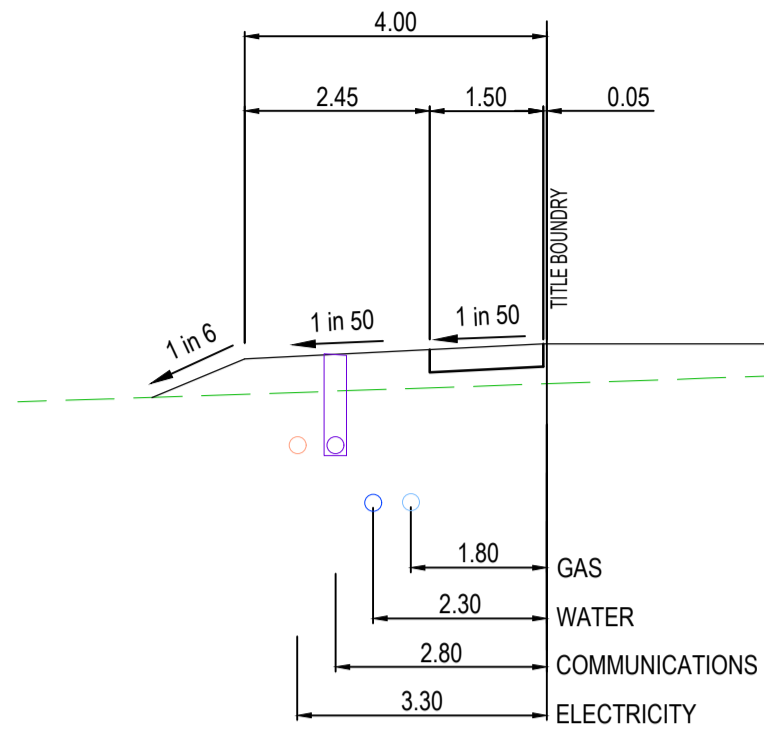

**HARMONICA WALK**  
TYPICAL SECTION B - B  
4.0m EASEMENT

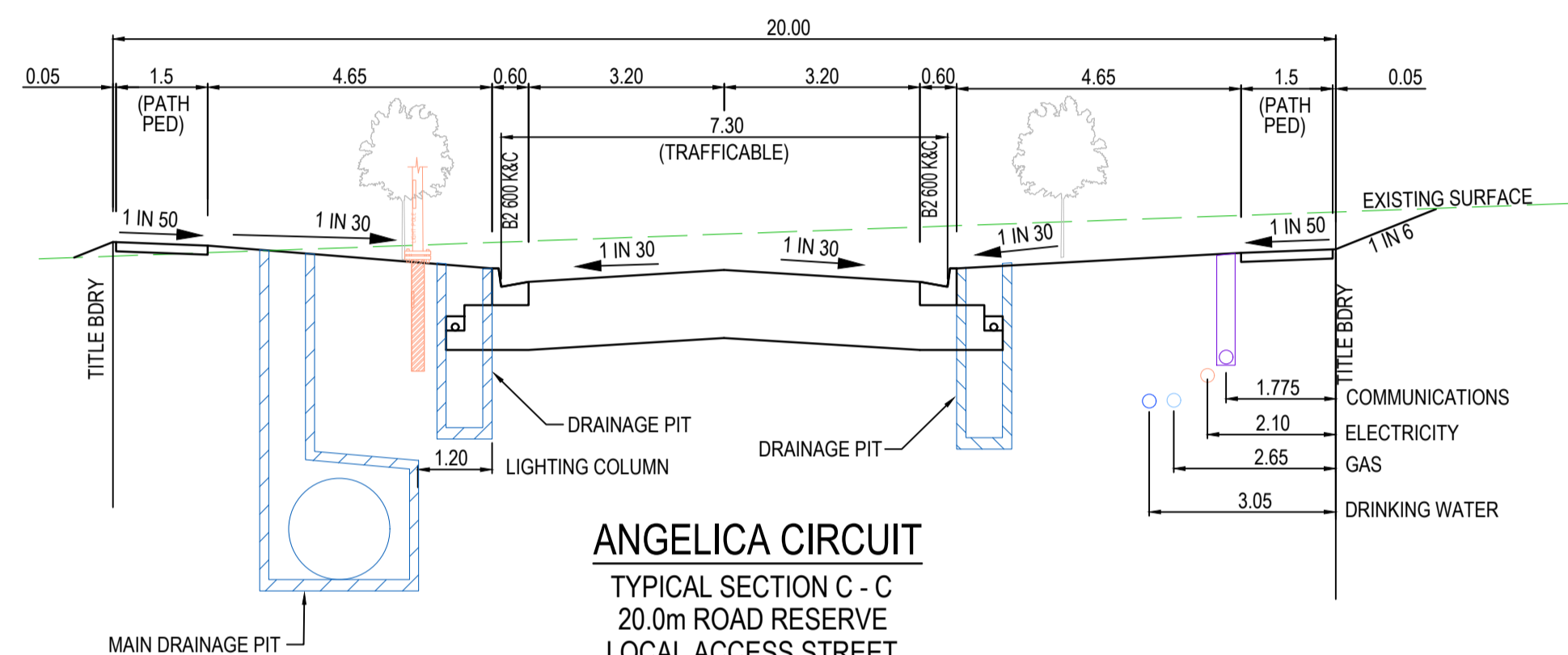

**ANGELICA CIRCUIT**  
TYPICAL SECTION C - C  
20.0m ROAD RESERVE  
LOCAL ACCESS STREET

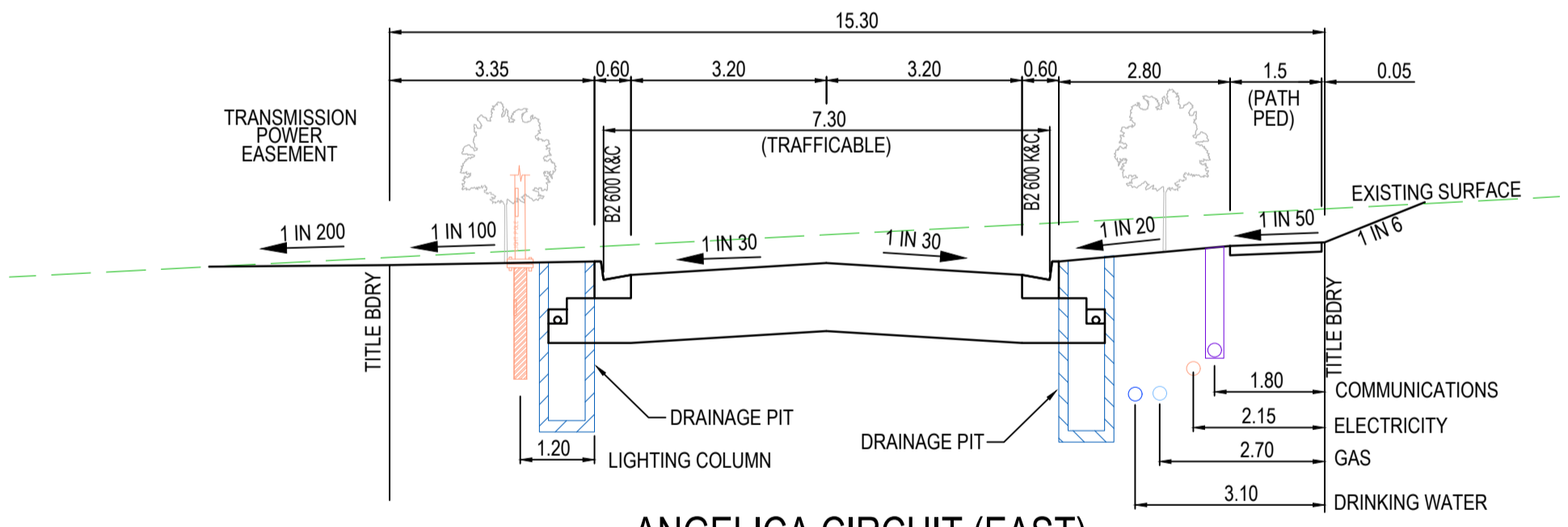

**ANGELICA CIRCUIT (EAST)**  
TYPICAL SECTION D - D  
15.3m ROAD RESERVE  
LOCAL ACCESS STREET

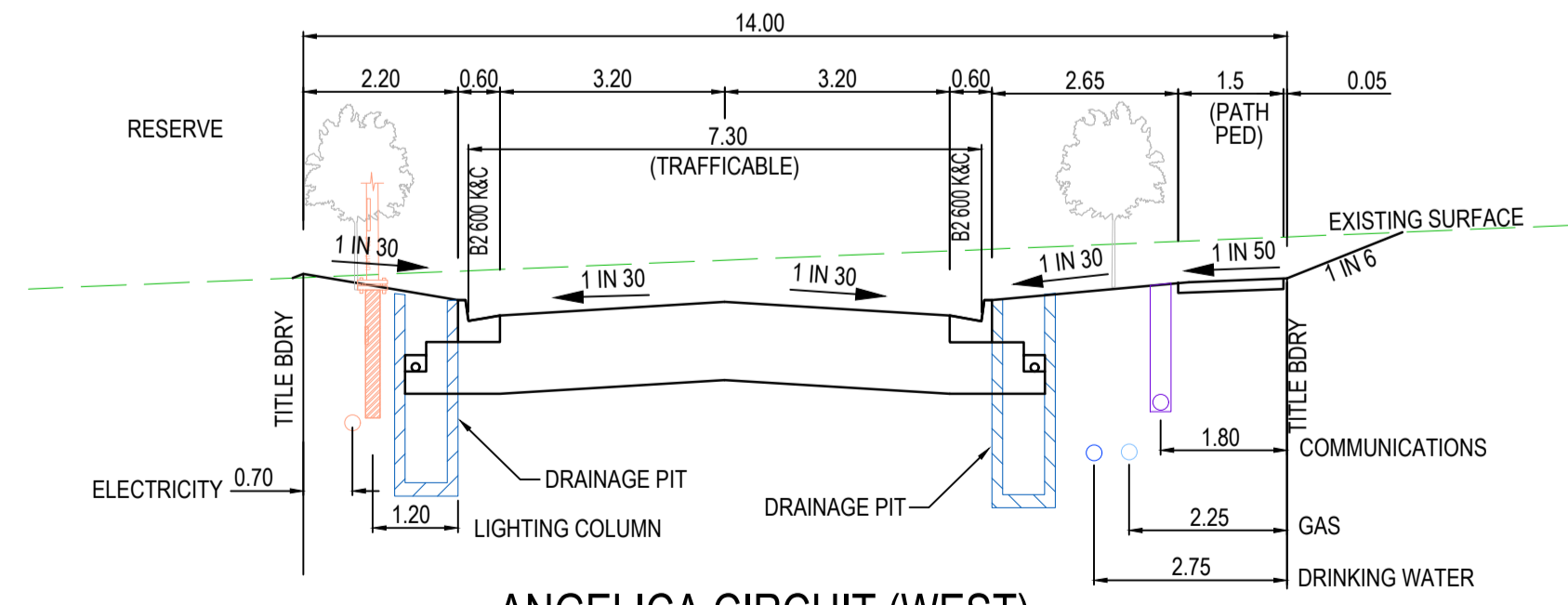

**ANGELICA CIRCUIT (WEST)**  
TYPICAL SECTION E - E  
14.0m ROAD RESERVE  
LOCAL ACCESS STREET

**TYPICAL CROSS SECTIONS**  
SCALE HORIZONTAL 1:100  
VERTICAL 1:50

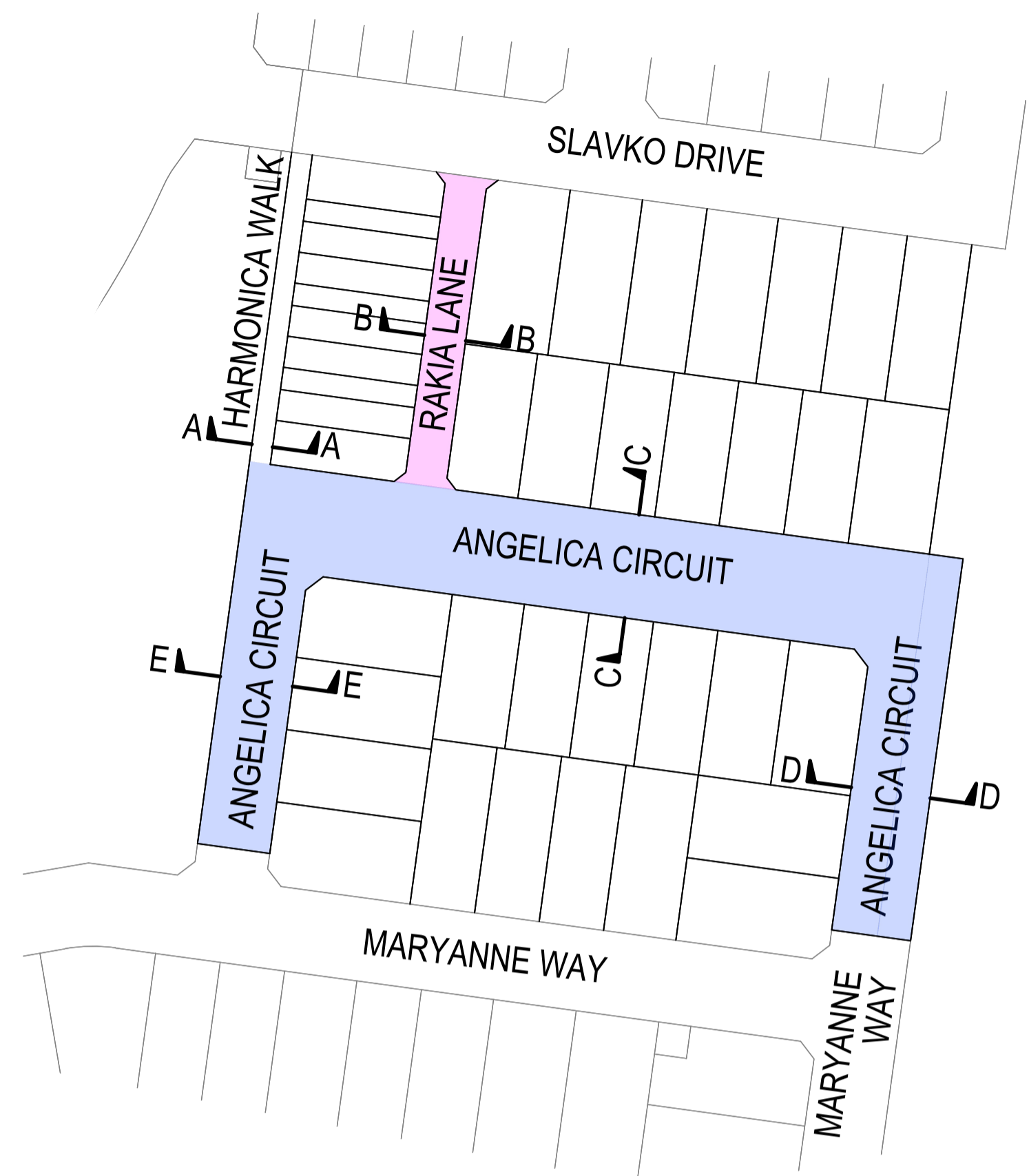

REFER SHEET 03 FOR  
PAVEMENT PROFILES

**PLAN**  
NOT TO SCALE

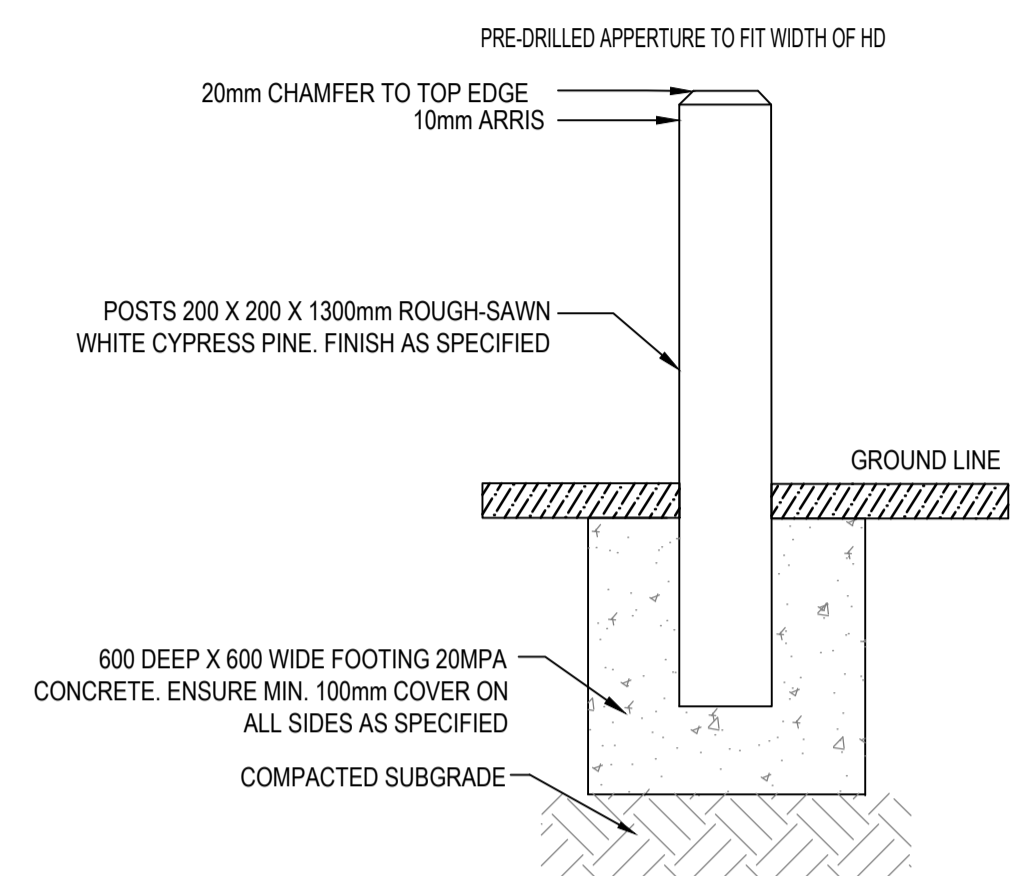
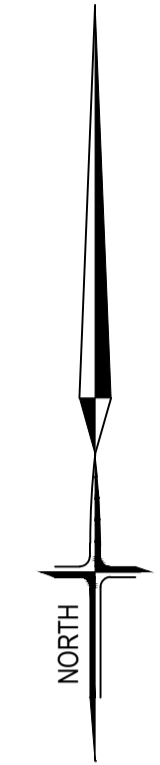

**TYPICAL BOLLARD DETAIL**  
NOT TO SCALE

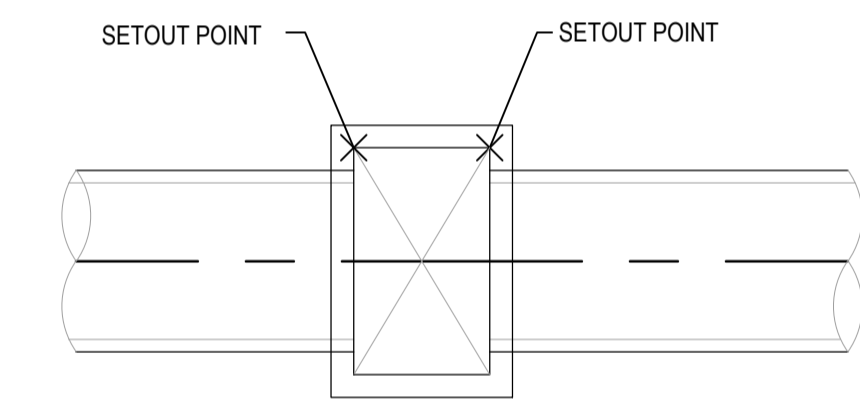

**PIT SETOUT POINT DETAIL**  
NOT TO SCALE

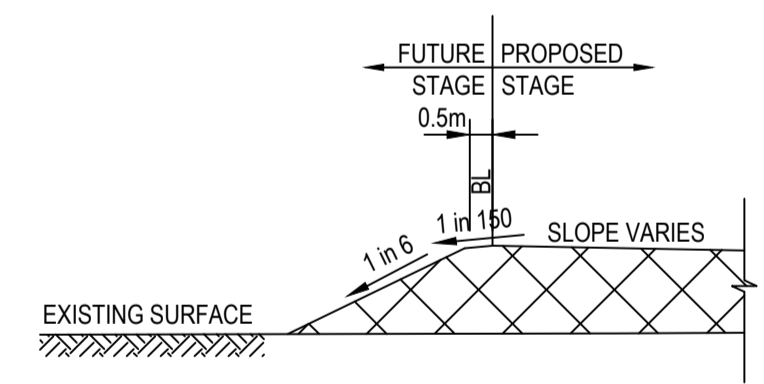

**TYPICAL SECTION WHEN  
IN FILL ON BOUNDARY  
OF FUTURE STAGE**  
NOT TO SCALE

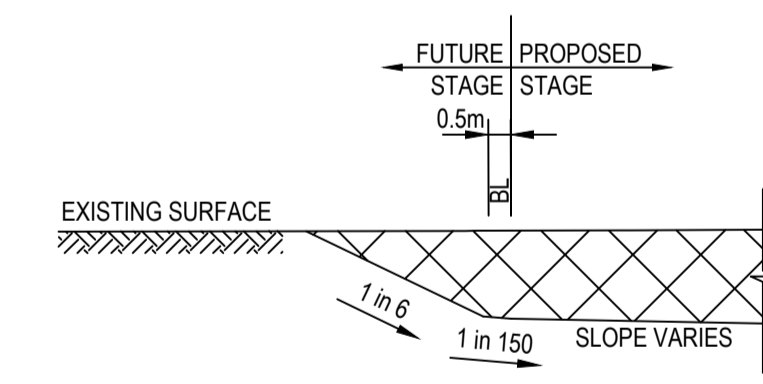

**TYPICAL SECTION WHEN  
IN CUT ON BOUNDARY  
OF FUTURE STAGE**  
NOT TO SCALE

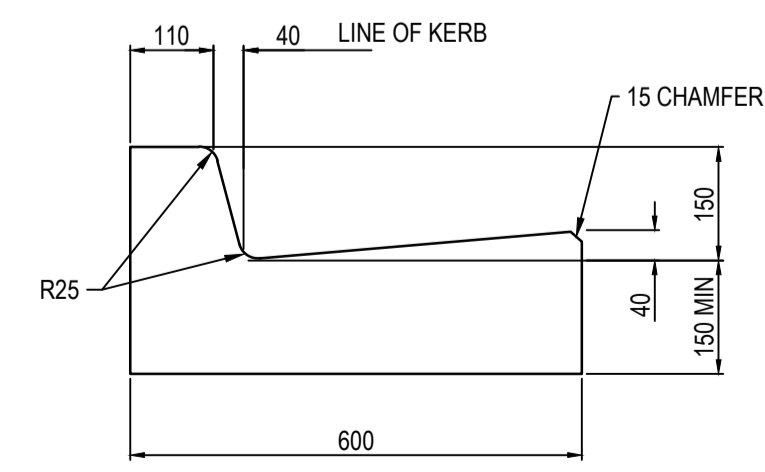

**B2 600 KERB DETAIL**  
NOT TO SCALE

		 <b>breese pitt dixon pty. ltd.</b> land surveyors civil engineers		1/19 cato street hawthorn east, 3123 telephone 8823 2300 fax no. 8823 2310	
		MELWAY REF. 356-C-1 SURVEY BPD DESIGN J.B. DRAWN I.W.		<b>ASPIRE ESTATE STAGE 30 TYPICAL CROSS SECTIONS</b>	
		MUNICIPALITY <b>MELTON</b> REFERENCE 8226 E/30			
AMENDMENTS	DATE	REMARKS	CHECKED	SCALE AS SHOWN	DATUM AHD
B	26.06.2023	LOT 3017-3026 ARRANGEMENT AMENDED			DATE AUG 2022
A	31.01.2023	CONSTRUCTION ISSUE			SHEET 02 OF 16
VER					B







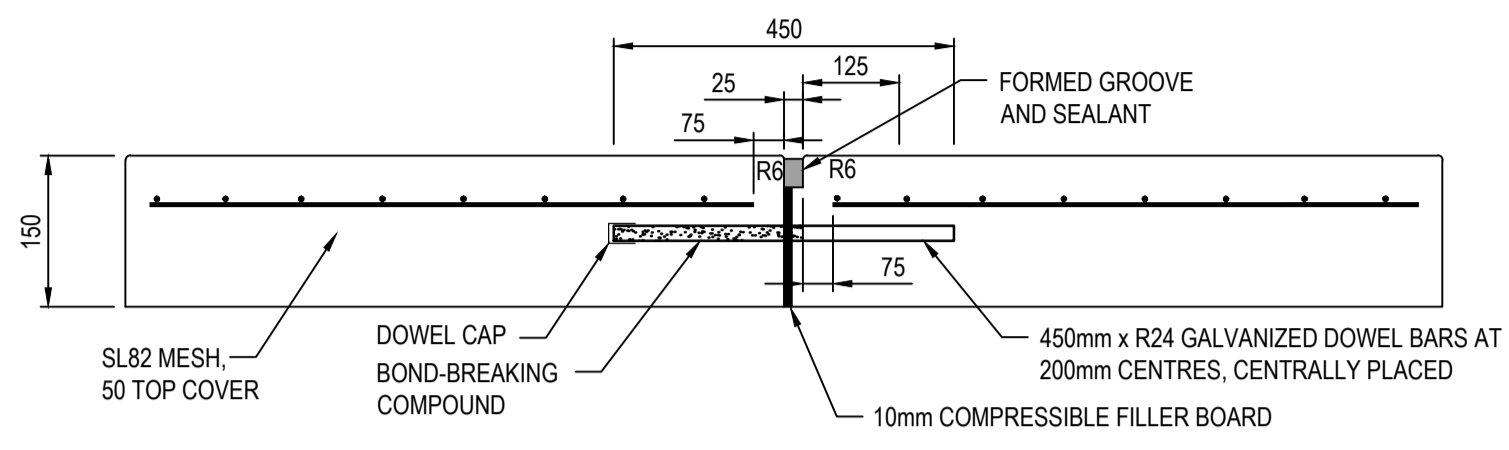

**TRANSVERSE EXPANSION JOINT - DOWELLED  
BUTT JOINT AT CONSTRUCTION JOINT (EJ)**

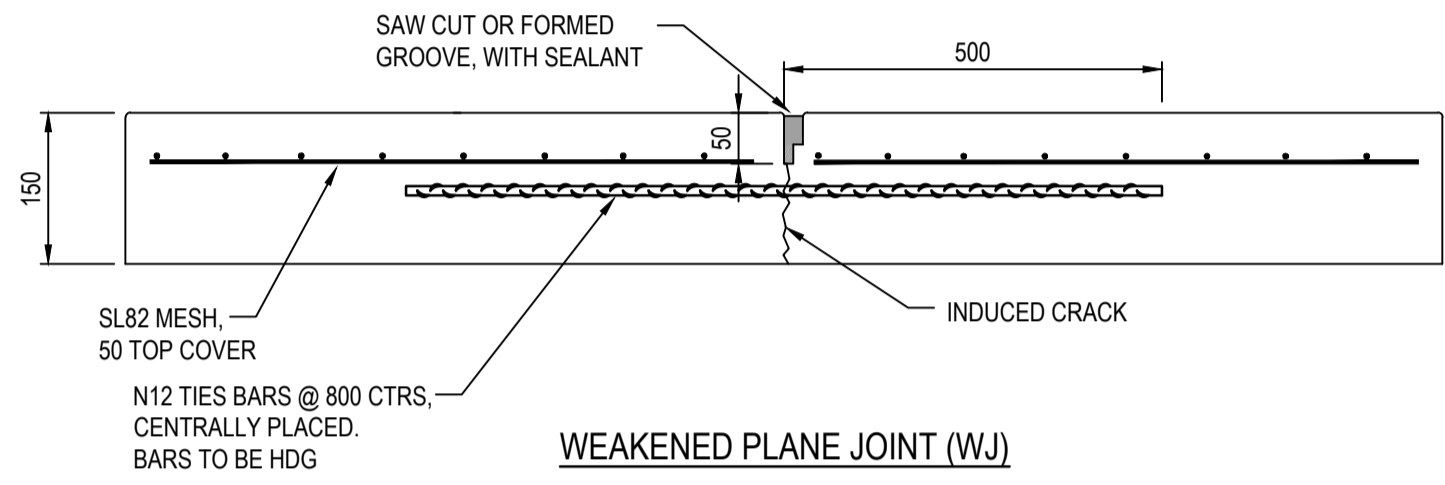

**WEAKENED PLANE JOINT (WJ)**

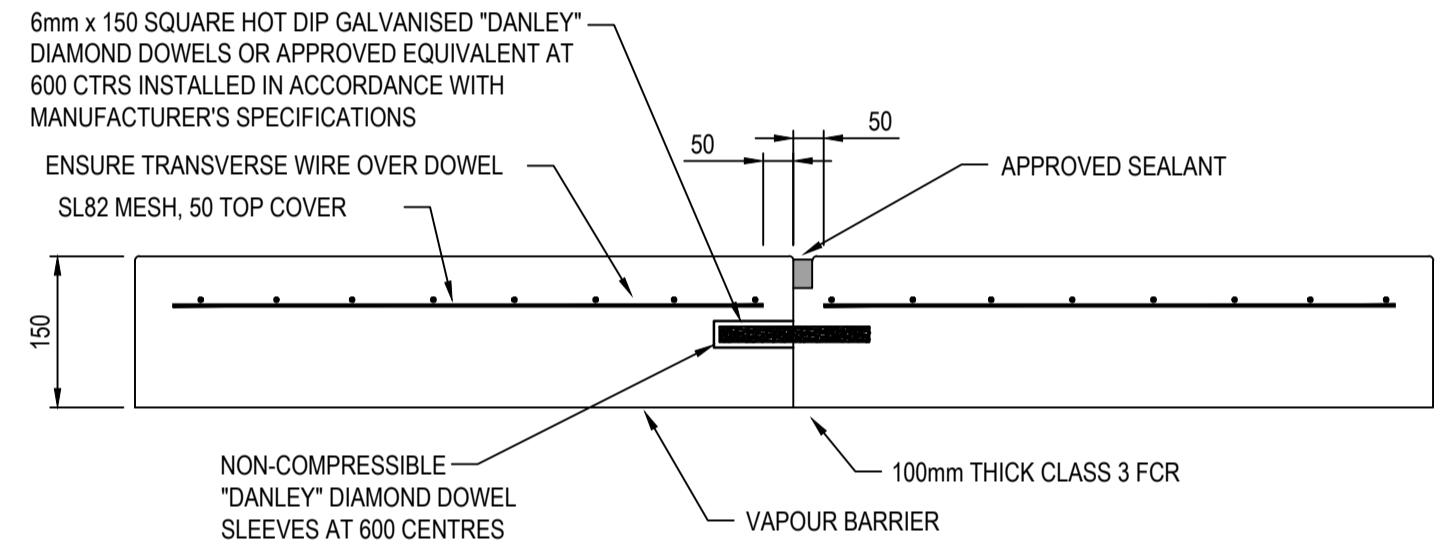

**TRANSVERSE CONTRACTION JOINT - DOWELLED  
BUTT JOINT AT CONSTRUCTION JOINT (CJ)**

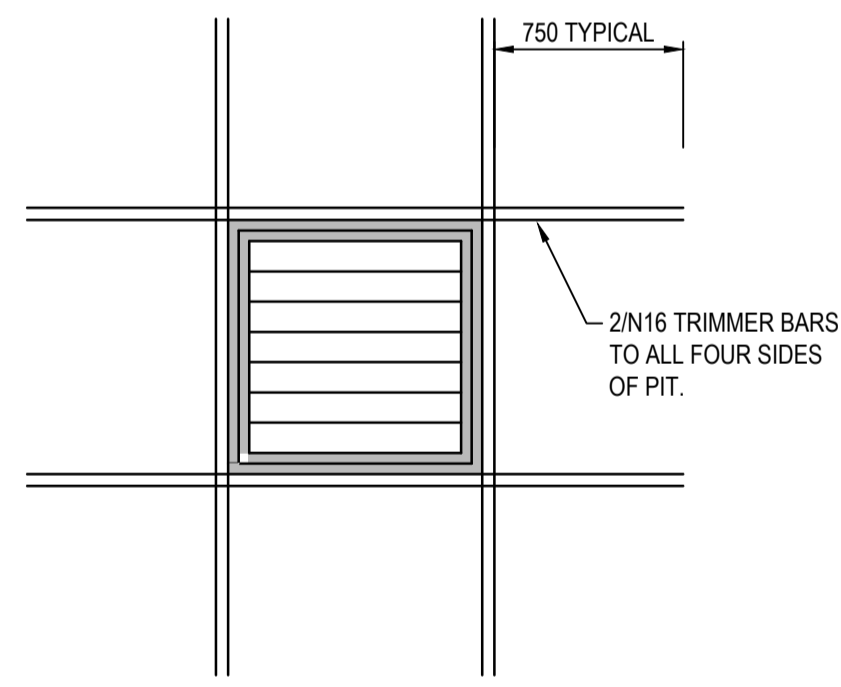

**PIT DETAIL**

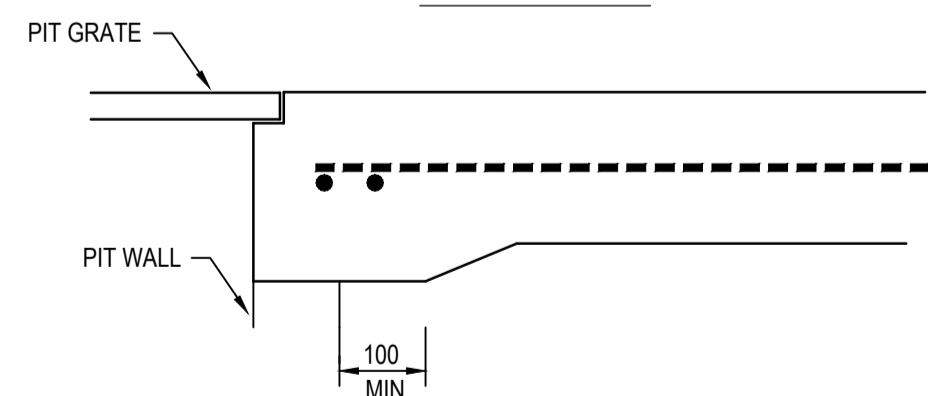

**PIT SECTION**

**CONCRETE JOINTING DETAILS  
NOT TO SCALE**

**JOINT DETAIL NOTES:**

1. SAW JOINTS ARE TO BE PLACED AT A MAXIMUM 6m SPACING AND CONSTRUCTED 18-24 HOURS AFTER POURING EXPANSION.
2. TRANSVERSE/CONTRACTION JOINTS ARE TO BE PLACED AT A MAXIMUM SPACING OF 12m.
3. ALL JOINTS SHALL BE LOCATED AND SPACED IN ACCORDANCE WITH "CEMENT AND CONCRETE ASSOCIATION OF AUSTRALIA - CONCRETE PAVEMENT DESIGN FOR RESIDENTIAL STREETS 1997".
4. CONCRETE SHALL BE CURED IN ACCORDANCE WITH AS3600 AND NOT TO BE TRAFFICKED UNTIL AT LEAST 75% CONCRETE NOMINATED ULTIMATE STRENGTH.
5. CONCRETE TO BE CLASS N32.



**RAKIA LANE  
JOINT LOCATIONS & TYPES  
NOT TO SCALE**

		 land surveyors civil engineers		1/19 cato street hawthorn east, 3123 telephone 8823 2300 fax no. 8823 2310	
AMENDMENTS		MELWAY REF. 356-C-1	<b>ASPIRE ESTATE STAGE 30 ROAD PAVEMENT DETAILS</b>		MUNICIPALITY MELTON
		SURVEY BPD			REFERENCE 8226 E/30
B	26.06.2023	LOT 3017-3026 ARRANGEMENT AMENDED	DESIGN J.B		
A	31.01.2023	CONSTRUCTION ISSUE	DRAWN I.W		
VER	DATE	REMARKS	CHECKED -	SCALE AS SHOWN	DATUM AHD
			DATE AUG 2022	SHEET 04 OF 16	B



CURVE SETOUT DETAILS	
I	90.000
R	8.600
Arc	13.509
A	2.519
B	1.864
X	3.291
Y	2.790
I	3.377
Mid Level	123.104

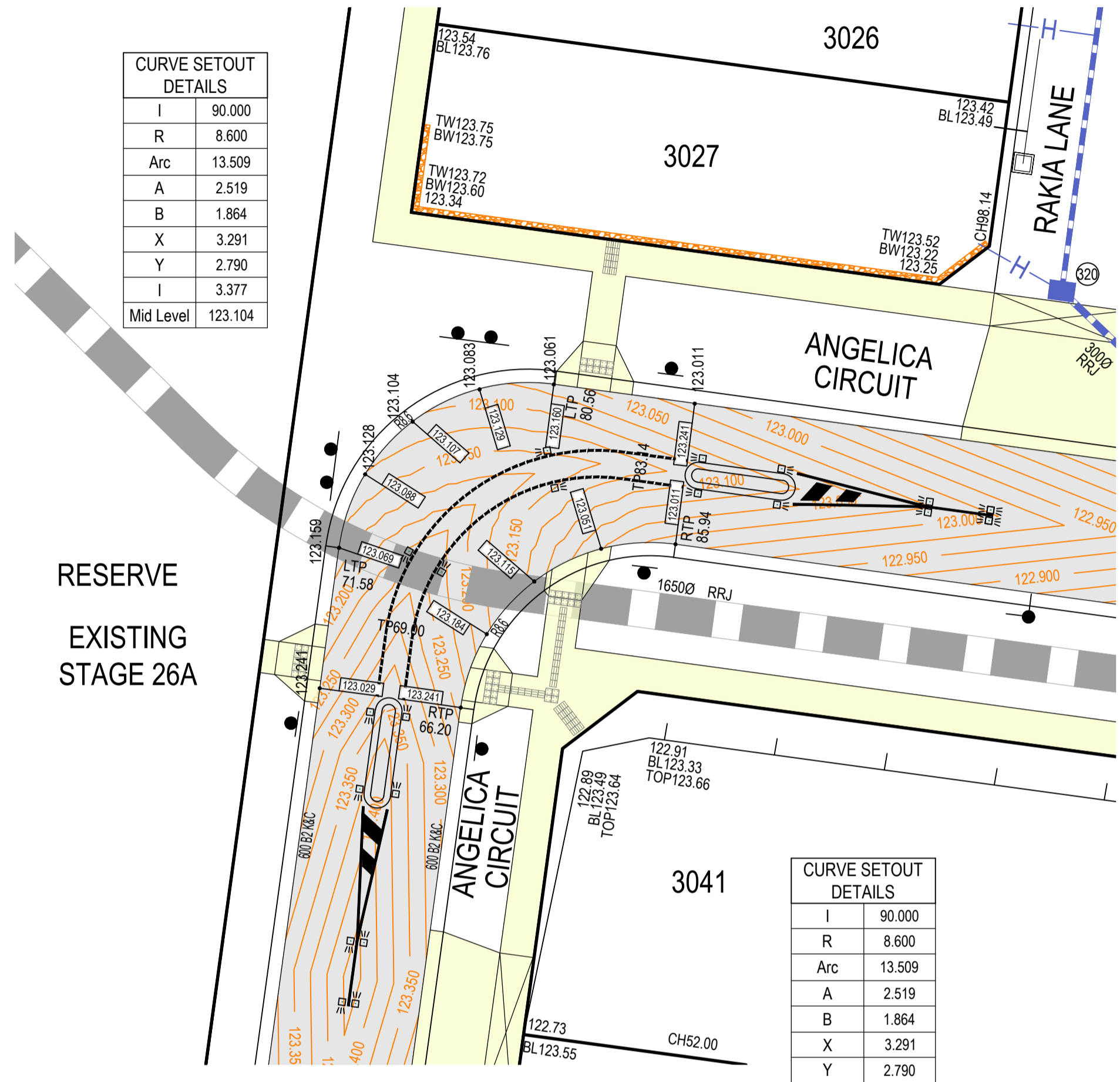

CURVE SETOUT DETAILS	
I	90.000
R	8.600
Arc	13.509
A	2.519
B	1.864
X	3.291
Y	2.790
I	3.377
Mid Level	123.115

CURVE SETOUT DETAILS	
I	90.047
R	8.600
Arc	13.516
A	2.521
B	1.866
X	3.293
Y	2.791
I	3.379
Mid Level	122.082

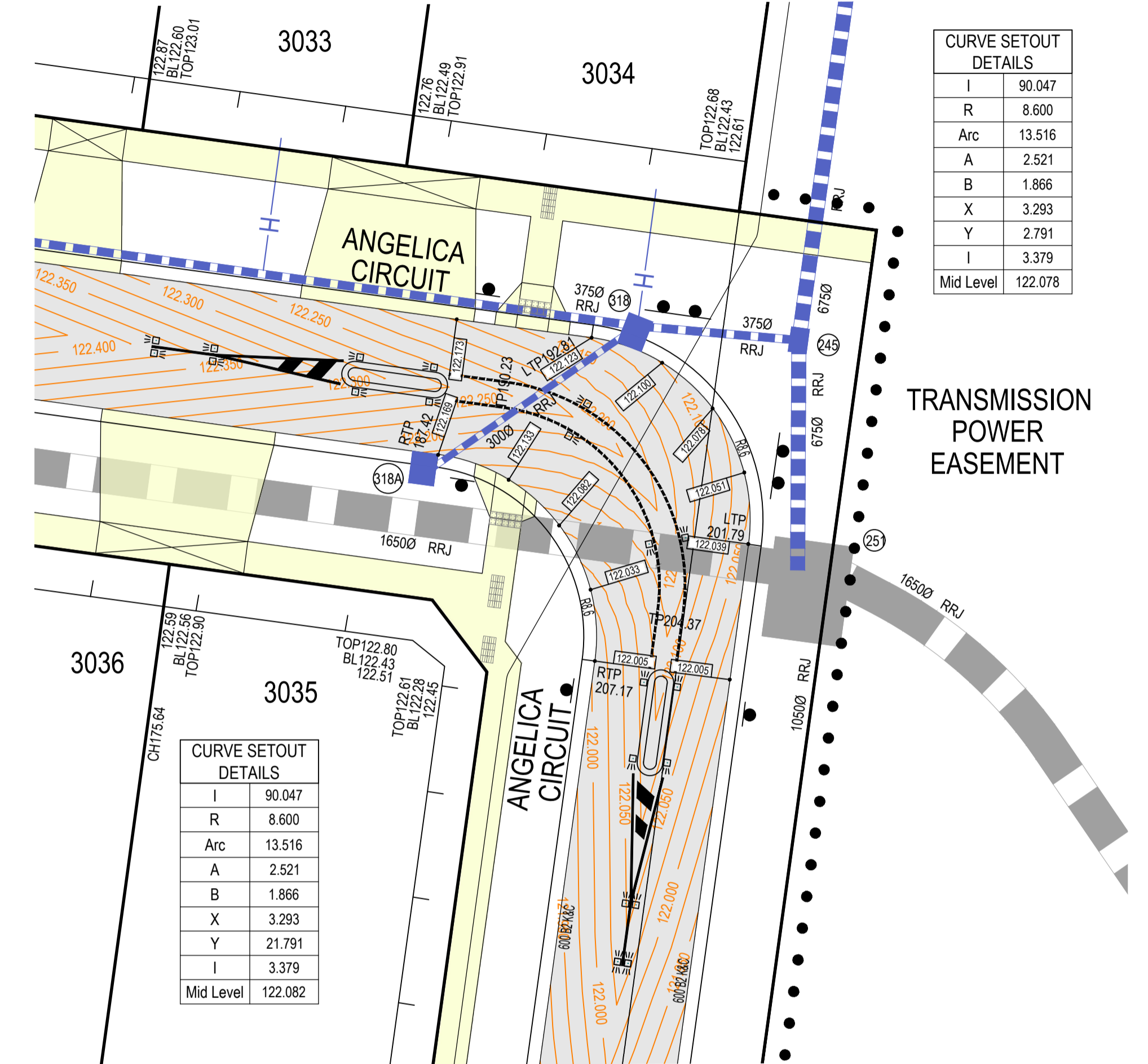

CURVE SETOUT DETAILS	
I	90.047
R	8.600
Arc	13.516
A	2.521
B	1.866
X	3.293
Y	2.791
I	3.379
Mid Level	122.078

- NOTES**
- ALL SIGNS TO BE SLEEVED USING A SL27 SLEEVE.
  - INDICATES UNIDIRECTIONAL & BIDIRECTIONAL RRPMS PLACED AT 6.00m CTS
  - HAZARD / DIRECTIONAL TGS'S SHOWN THUS AND FOOTPATH RAMPS SHALL BE CONSTRUCTED IN ACCORDANCE WITH VICROADS STD DWGS SD2031 TO SD2035. TGS'S SHALL CONFORM TO AS1428.4
  - PROVIDE EMERALD GREEN COLOURED HIGH FRICTION SURFACE TREATMENTS ALONG SHARED PATH DENOTED THUS: SURFACE TREATMENT MUST COMPLY WITH VICROADS STANDARD SECTION 430.
  - STREET SIGNS TO HAVE MINIMUM 2 WEDGES IN THE SLEEVES
  - SWLM - INDICATES SOLID WHITE "LONGLIFE" LINE MARKING  
BWLM - INDICATES BROKEN WHITE "LONGLIFE" LINE MARKING
  - RETURN & ELBOW LIP OF KERB CHAINAGES PREFIXED WITH AN "L" (eg LTP35.83)

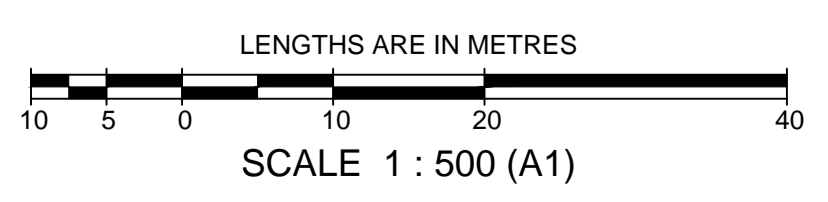
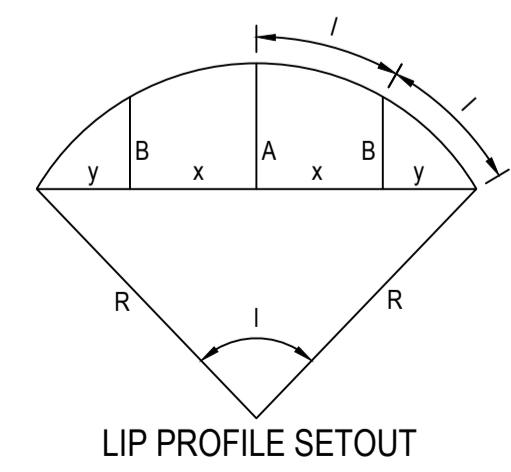

SYMBOL LEGEND	
Drains	Prop
Main Drains	Prev Stage
Sewer < 3000	
Sewer ≥ 3000	
Water (DW)	
Water (NDW)	
House Drain	
Property Inlet	
Street Sign	
PSM	
Rock Ret Wall	
Sleeper Ret Wall	
Conduits 50mm	
Conduits 100mm	
Street Tree without/with Passive Irrigation (Refer Detail)	
Ex Drains	
Ex Water DW/NDW	
Ex Sewer/Gas	
Ex Elect/Comm	
Ex Optic Fibre	
Ex/Natural/FS Level	
FS @ Building Line	
Top/Toe of Batter	
Top Ret. Wall Level	
100yr Flood Level	
Fill Proposed (<0.3m/≥0.3m)	
Cut Proposed	
Asphalt Surface Prop	
Concrete Surface Prop (Paths/Driveways/Slabs)	
Tree To Be Removed	
Tree To Be Retained with Tree Protection Zone (TPZ)	

		1/19 cato street hawthorn east, 3123 telephone 8823 2300 fax no. 8823 2310	
MELWAY REF.	356-C-1	<b>ASPIRE ESTATE          STAGE 30          INTERSECTION PLAN</b>	
SURVEY	BPD		
DATE	26.06.2023	DESIGN	J.B
DATE	31.01.2023	DRAWN	I.W
DATE		CHECKED	-
DATE		SCALE	AS SHOWN
DATE		DATUM	AHD
DATE		DATE	AUG 2022
SHEET	05 OF 16	MUNICIPALITY	MELTON
REFERENCE	8226 E/30		







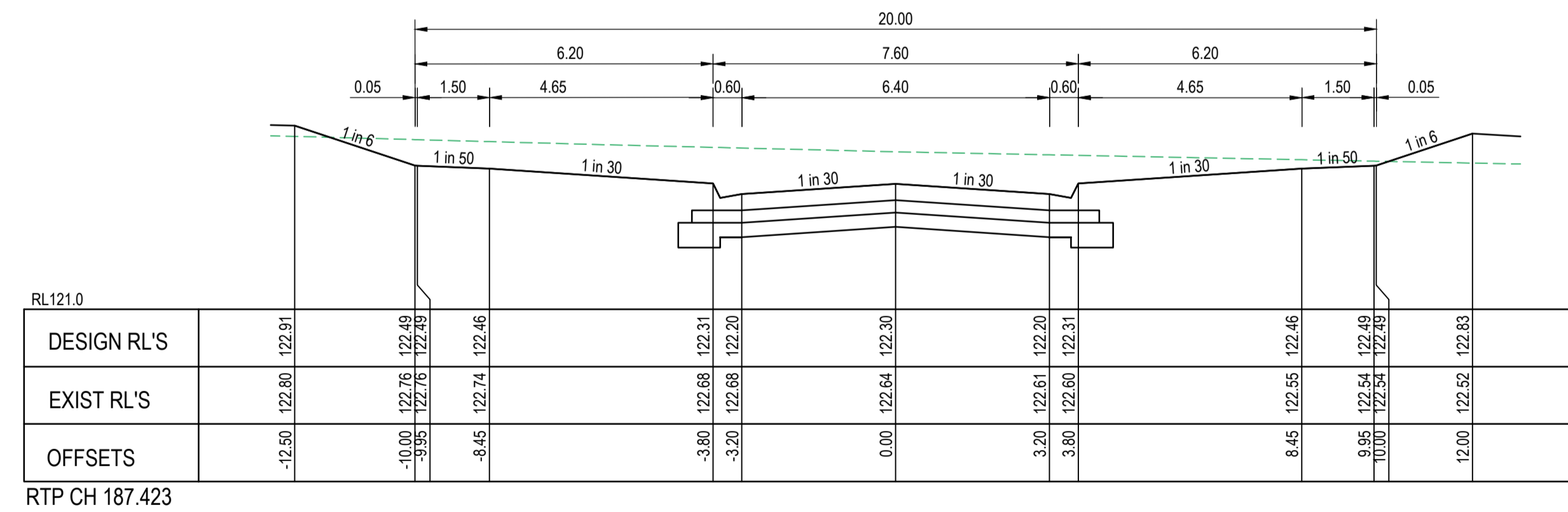
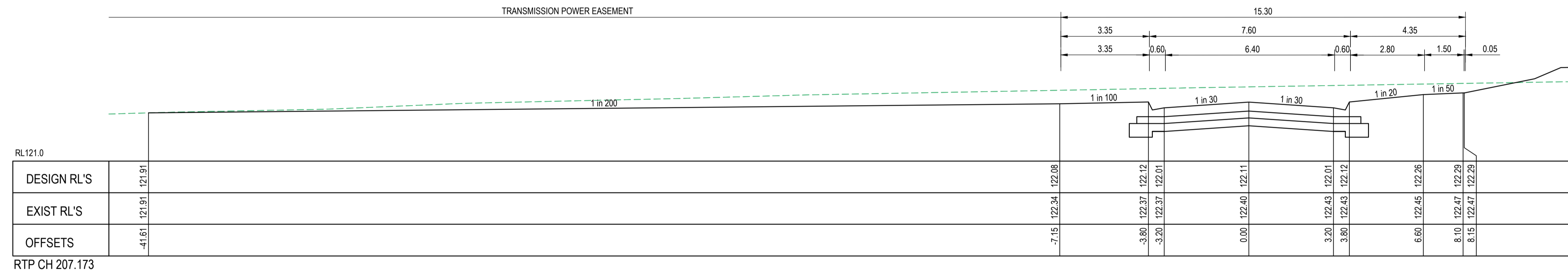
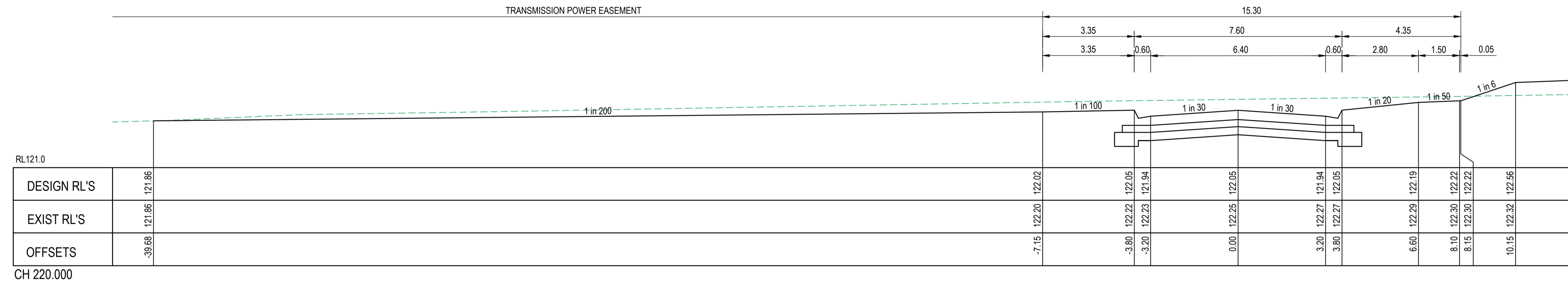

### ANGELICA CIRCUIT

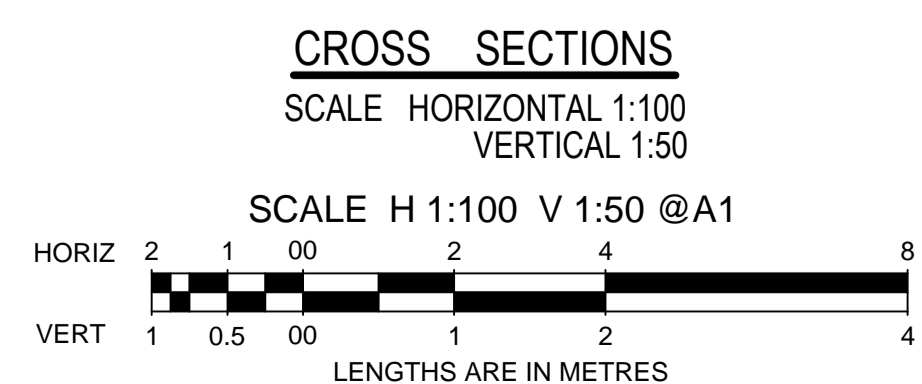
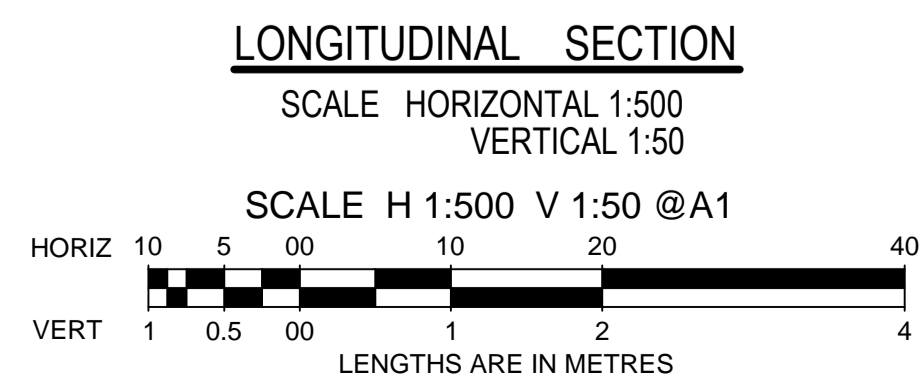

 <b>breese pitt dixon pty. ltd.</b> land surveyors      civil engineers		1/19 cato street hawthorn east, 3123 telephone 8823 2300 fax no. 8823 2310	
		<b>ASPIRE ESTATE STAGE 30</b> <b>ANGELICA CIRCUIT - SHEET 3 OF 4</b>	
MELWAY REF.	354-C-12	MUNICIPALITY	
SURVEY	BPD	MELTON	
DESIGN	J.B	REFERENCE	
DRAWN	I.W	8226 E/30	
CHECKED	-	SCALE	AS SHOWN
DATE	31.01.2023	DATUM	AHD
REMARKS	CONSTRUCTION ISSUE	DATE	AUG 2022
AMENDMENTS	VER	SHEET	08 OF 16
A	31.01.2023	CONSTRUCTION ISSUE	A











PROPOSED STAGE 30 ← | → EXISTING STAGE 27

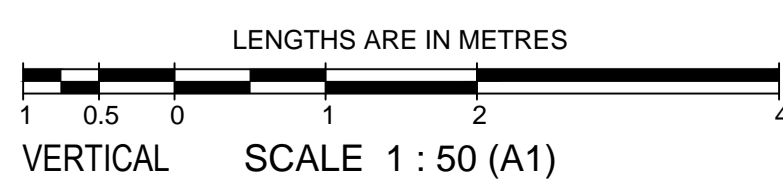
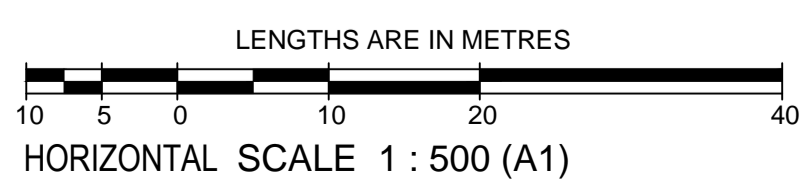
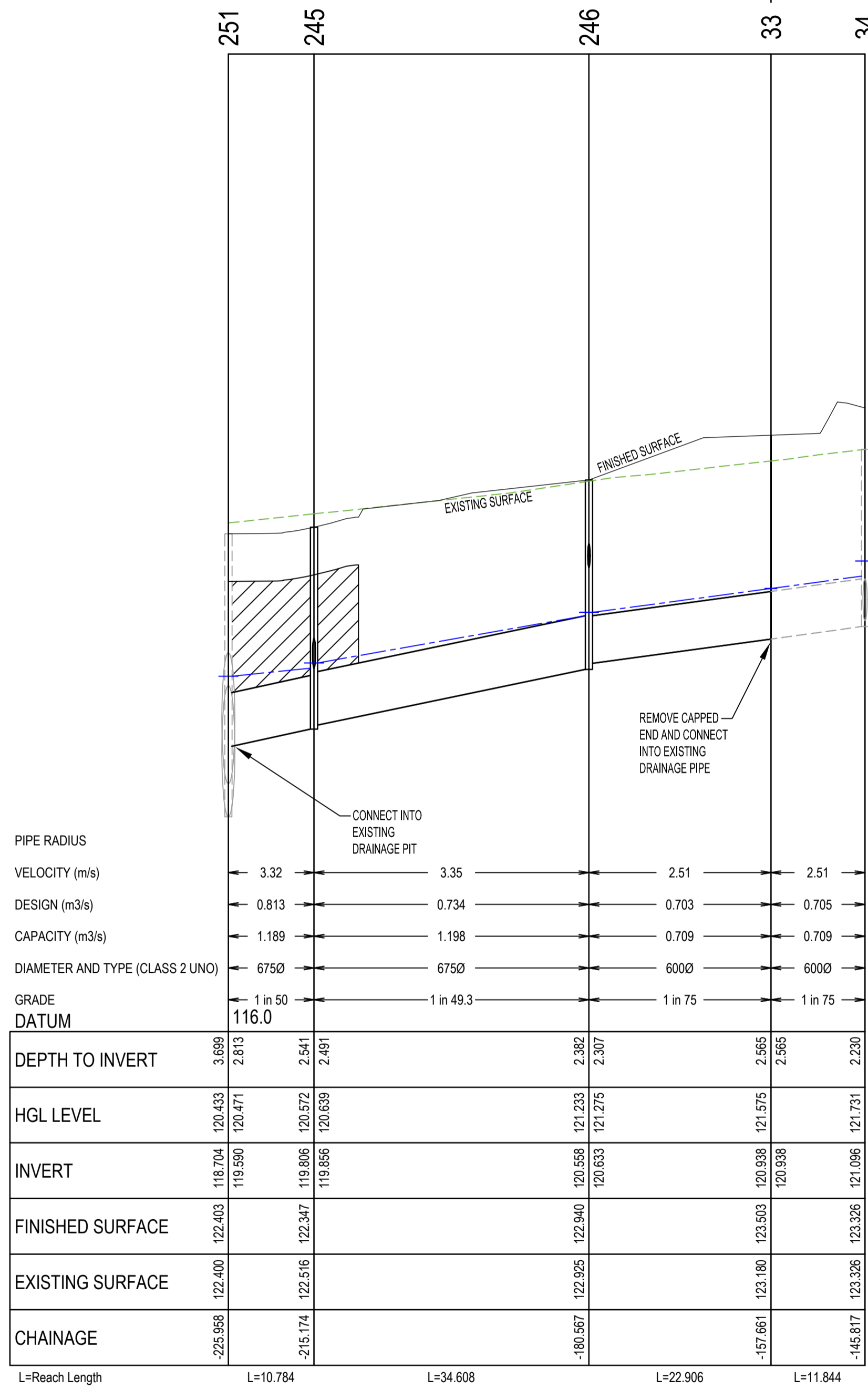

<b>breese pitt dixon pty. ltd.</b> land surveyors      civil engineers		1/19 cato street hawthorn east, 3123 telephone 8823 2300 fax no. 8823 2310					
		<b>MELWAY REF. 354-C-12</b> SURVEY BPD DESIGN J.B.		MUNICIPALITY <b>MELTON</b>			
		<b>ASPIRE ESTATE STAGE 30</b>		REFERENCE <b>8226 E/30</b>			
		<b>DRAINAGE LONGITUDINAL SECTIONS - SHEET 1</b>		SHEET 11 OF 16			
AMENDMENTS							
A	31.01.2023	CONSTRUCTION ISSUE	DRAWN I.W.	CHECKED -	SCALE AS SHOWN	DATUM AHD	DATE AUG 2022



EXISTING STAGE 30A PROPOSED STAGE 30

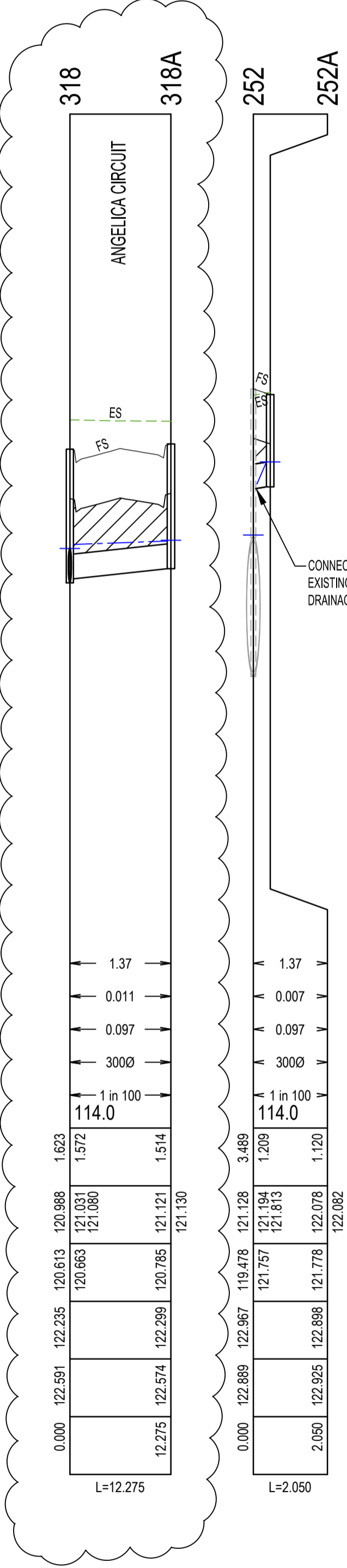
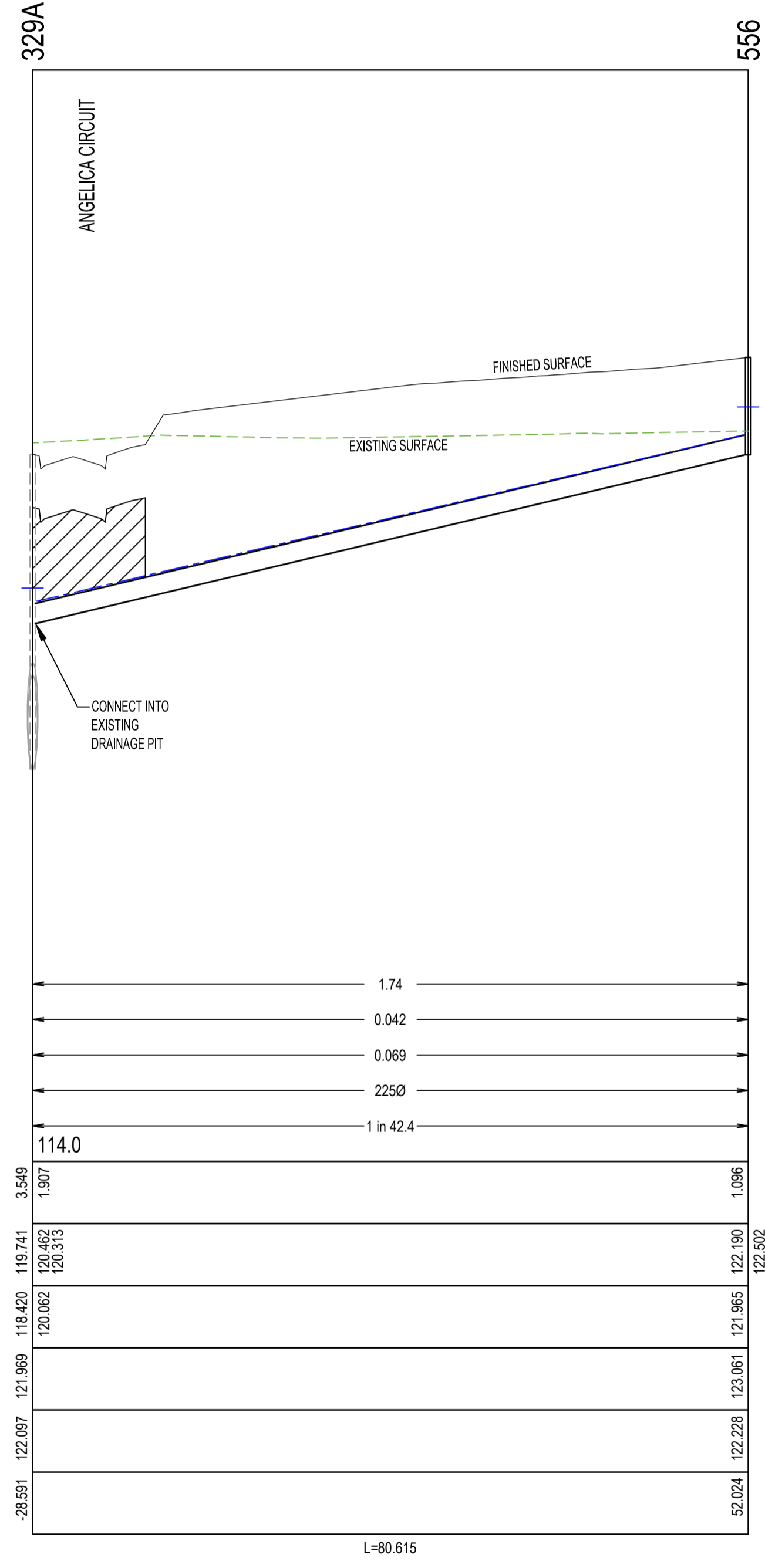
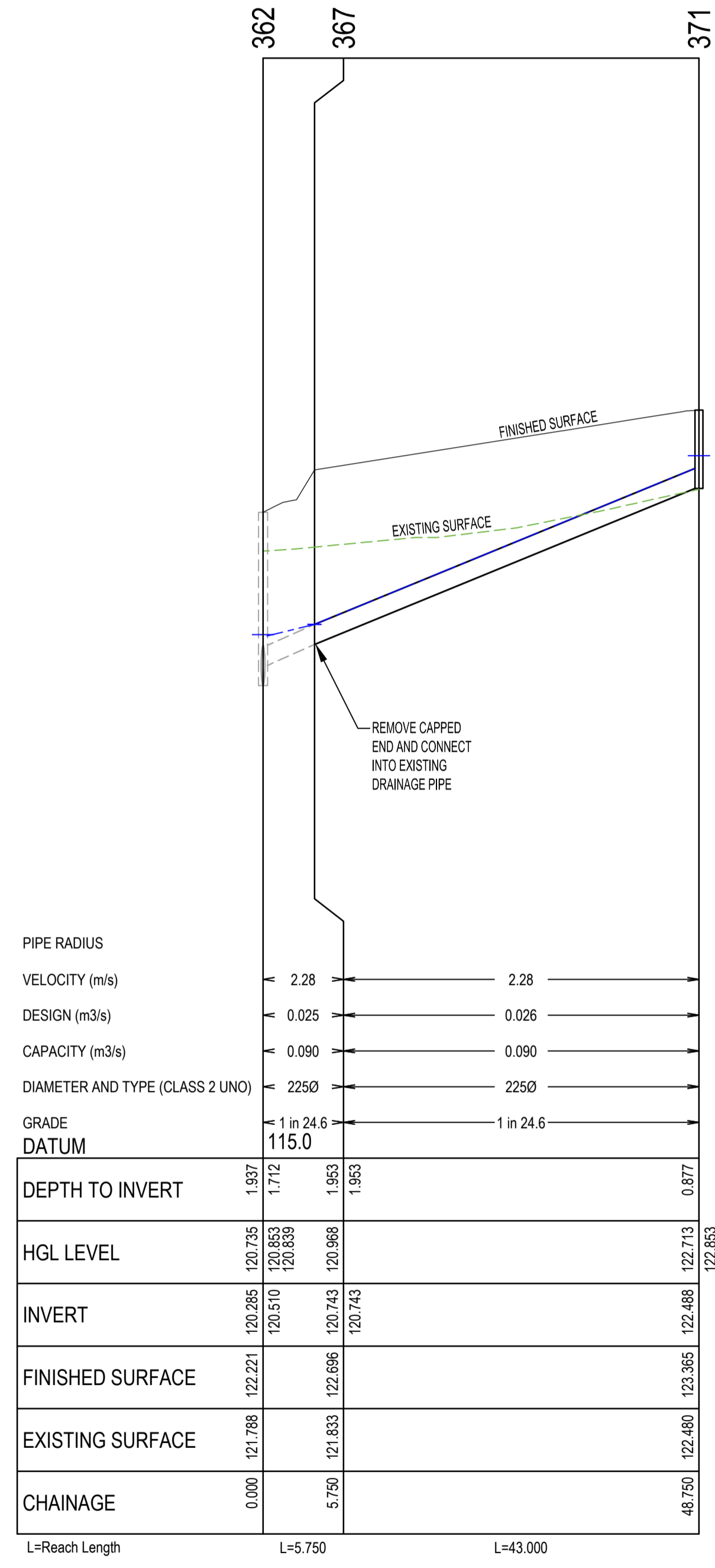

PIT No.	DESCRIPTION	INTERNAL DIMENSIONS		INLET		OUTLET		BRANCH CONNECTION		TOP OF PIT	DEPTH OF PIT	REMARKS
		L	W	DIA	LEVEL	DIA	LEVEL	DIA	LEVEL			
33	End of Pipe (Existing)			675	119.856	600	120.938			123.503	2.565	Connect into Existing Drainage Pipe.
245	Junction Pit	900	900	675	119.806	675	119.806	375	120.572	122.576	2.77	EDCM605-EDCM607 with Class B Cover. Haunched at top 600 * 900 E: 299224.7157, N: 5824823.9702 / E: 299224.5944, N: 5824923.0785
246	Junction Pit	900	900	600	120.633	675	120.558	300	121.839	122.94	2.382	EDCM605-EDCM607 with Class B Cover. Haunched at top 600 * 900 E: 299229.3374, N: 5824957.3595 / E: 299229.4586, N: 5824958.2513
251	Junction Pit (Existing)			675	119.59	1650	118.704			122.403	3.699	Connect into Existing Drainage Pit, Adjust lid to suit new design levels
252	Junction Pit (Existing)			300	121.757	1650	119.478			123.036	3.558	Connect into Existing Drainage Pit, Adjust lid to suit new design levels
252A	Channel Grating Pit	600	900			300	121.778			122.968	1.19	EDCM601-EDCM605 with Class B Cover. E: 299136.2447, N: 5824927.1401 / E: 299135.3530, N: 5824927.2615
317	Junction Pit	600	900			300	122.772			123.881	1.109	EDCM605-EDCM607 with Class B Cover E: 299147.6253, N: 5824989.2397 / E: 299148.5171, N: 5824969.1184
318	Channel Grating Pit	600	900	375	120.663	375	120.613	300	120.663	122.235	1.623	EDCM601-EDCM605 with Class B Cover. E: 299216.8517, N: 5824924.0302 / E: 299217.6907, N: 5824923.7044
318A	Channel Grating Pit	600	900			300	120.785			122.299	1.514	EDCM601-EDCM605 with Class B Cover.
319	Channel Grating Pit	600	900	300	121.301	375	121.201			122.997	1.796	EDCM601-EDCM605 with Class B Cover. E: 299132.8495, N: 5824935.5751 / E: 299131.9577, N: 5824935.6965
320	Junction Pit	600	900	225	121.618	300	121.527			123.234	1.707	EDCM605 with Class B Cover. Install Trafficable Lid E: 299125.2635, N: 5824942.8651 / E: 299124.3717, N: 5824942.9863
321	Junction Pit	600	900			225	122.827			124.454	1.628	EDCM605 with Class B Cover. Install Trafficable Lid E: 299132.6335, N: 5824998.1765 / E: 299132.5122, N: 5824997.2847
329A	Junction Pit (Existing)			225	120.062	1200	118.42			122.124	3.704	Connect into Existing Drainage Pit
367	End of Pipe (Existing)					225	120.743			122.696	1.953	Connect into Existing Drainage Pipe.
371	Junction Pit	600	900			225	122.488			123.367	0.879	EDCM605-EDCM607 with Class B Cover. E: 299127.2712, N: 5824907.5716 / E: 299127.1500, N: 5824906.6798
556	Junction Pit	600	900			225	121.965			123.085	1.12	EDCM605-EDCM607 with Class B Cover E: 299140.2476, N: 5824893.5432 / E: 299139.3558, N: 5824893.6644

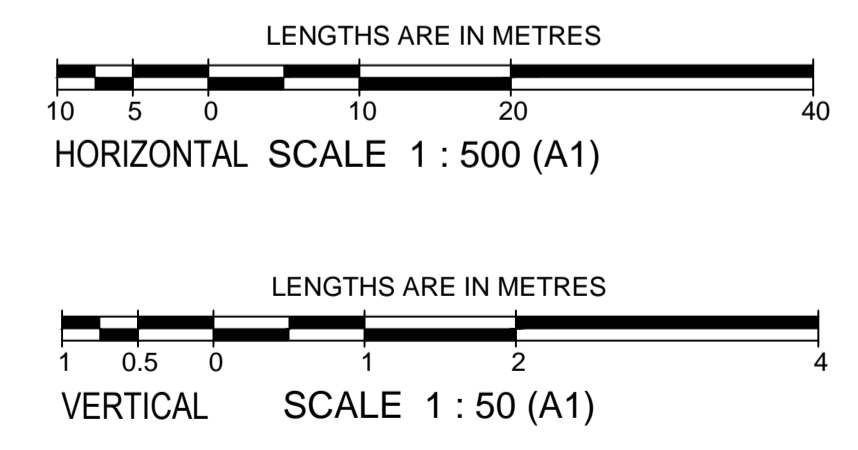
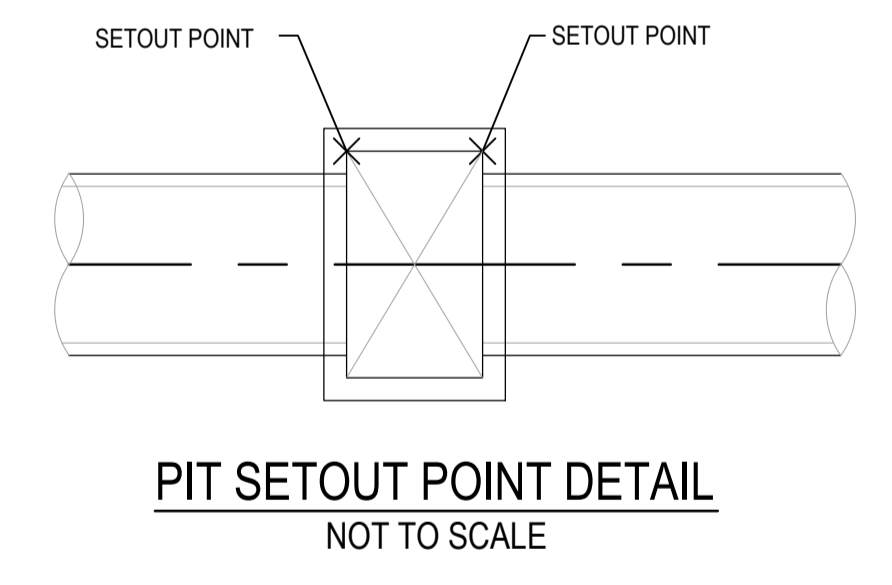

- LEGEND:
- EXISTING SURFACE PROFILE
  - FINISHED SURFACE PROFILE
  - - - INDICATES SYR HGL
  - ▨ INDICATES CRUSHED ROCK BACKFILL

		<b>breese pitt dixon pty. ltd.</b> land surveyors civil engineers		1/19 cato street hawthorn east, 3123 telephone 8823 2300 fax no. 8823 2310	
MELWAY REF. 354-C-12 SURVEY BPD		<b>ASPIRE ESTATE</b> <b>STAGE 30</b> DRAINAGE LONGITUDINAL SECTIONS - SHEET 2 & DRAINAGE STRUCTURE DETAILS		MUNICIPALITY <b>MELTON</b> REFERENCE <b>8226 E/30</b>	
AMENDMENTS B 27.02.2023 DRAINAGE LINE REVISED A 31.01.2023 CONSTRUCTION ISSUE	DESIGN J.B DRAWN I.W	SCALE AS SHOWN DATUM AHD	DATE AUG 2022	SHEET 12 OF 16	B



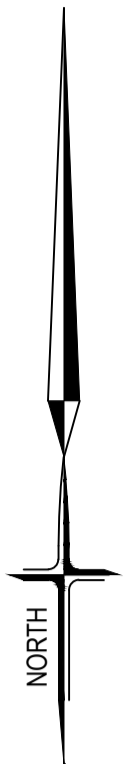

PLAN  
SCALE 1:500

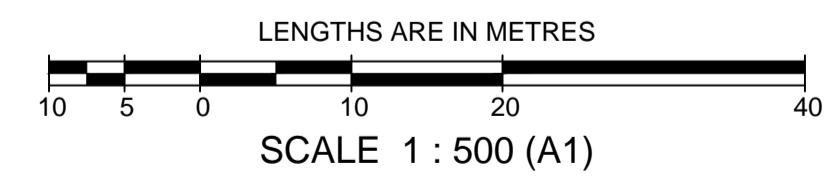
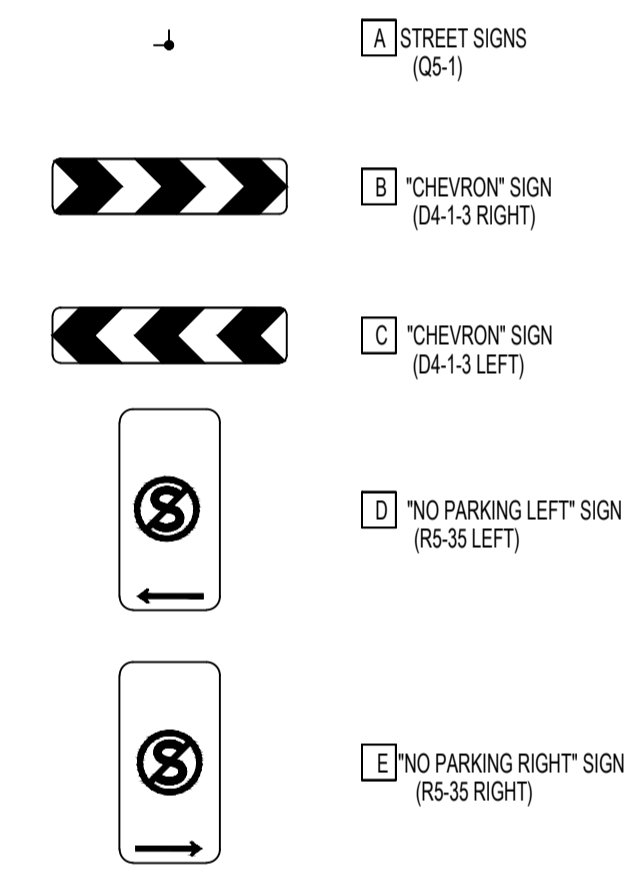

SYMBOL LEGEND		Prop		Prev Stage	
Drains					
Main Drains					
Sewer < 300Ø					
Sewer ≥ 300Ø					
Water (DW)					
Water (NDW)					
House Drain					
Property Inlet					
Street Sign					
PSM					
Rock Ret Wall					
Sleeper Ret Wall					
Conduits 50mm					
Conduits 100mm					
Street Tree without/with Passive Irrigation (Refer Detail)					
Ex Drains					
Ex Water DW/NDW					
Ex Sewer/Gas					
Ex Elect/Comm					
Ex Optic Fibre					
Ex/Natural/FS Level					
FS @ Building Line					
Top/Toe of Batter					
Top Ret. Wall Level					
100yr Flood Level					
Fill Proposed (<0.3m/≥0.3m)					
Cut Proposed					
Asphalt Surface Prop					
Concrete Surface Prop (Paths/Driveways/Slabs)					
Tree To Be Removed					
Tree To Be Retained with Tree Protection Zone (TPZ)					

		 breese pitt dixon pty. ltd. land surveyors civil engineers		1/19 cato street hawthorn east, 3123 telephone 8823 2300 fax no. 8823 2310				
				MUNICIPALITY MELTON				
		MELWAY REF. 356-C-1		REFERENCE 8226 E/30				
		SURVEY BPD		ASPIRE ESTATE STAGE 30 SIGNAGE AND LINEMARKING				
B 26.06.2023 LOT 3017-3026 ARRANGEMENT AMENDED		DESIGN J.B		MUNICIPALITY MELTON				
A 31.01.2023 CONSTRUCTION ISSUE		DRAWN I.W		REFERENCE 8226 E/30				
VER	DATE	REMARKS	CHECKED	SCALE AS SHOWN	DATUM AHD	DATE AUG 2022	SHEET 13 of 16	B







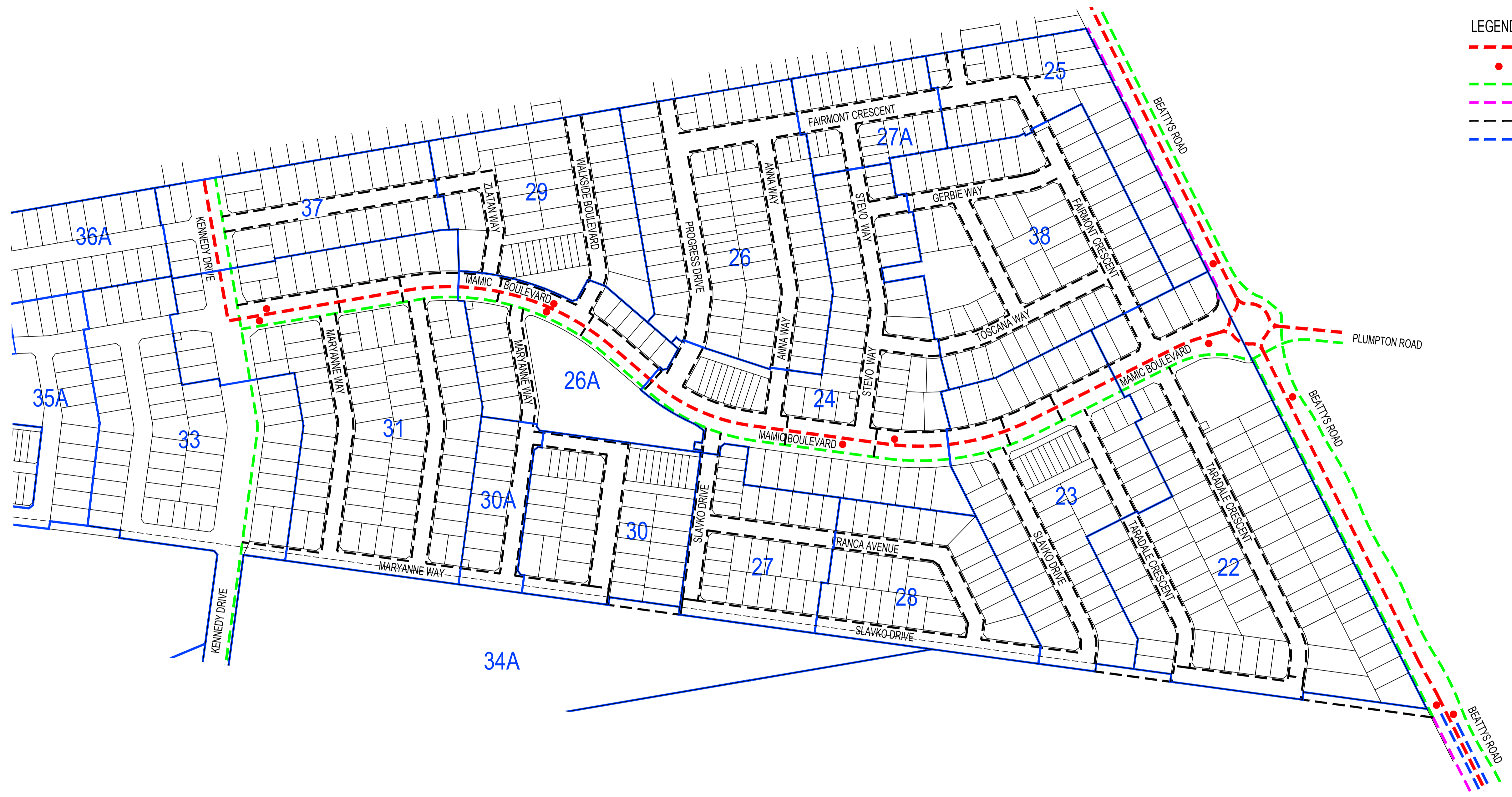
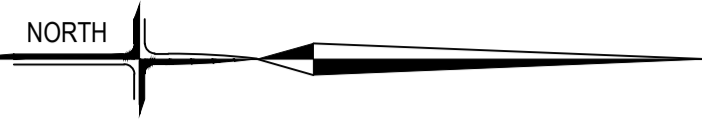

- LEGEND:**
- - - POTENTIAL BUS ROUTE (AS PER PSP)
  - TV BUS STOP LOCATION
  - - - 3.0m WIDE SHARED PATH
  - - - 2.0m WIDE SHARED PATH
  - - - 1.5m WIDE FOOTPATH
  - - - ON ROAD BIKE LANE (BOTH SIDES) AS PER PSP

PLAN  
SCALE 1:2000

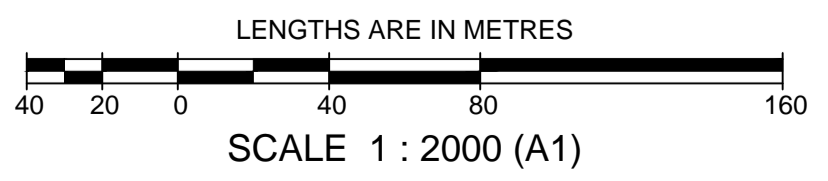

		 <b>breese pitt dixon pty. ltd.</b> land surveyors      civil engineers		1/19 cato street hawthorn east, 3123 telephone 8823 2300 fax no. 8823 2310	
				<b>ASPIRE ESTATE STAGE 30 MOBILITY PLAN</b>	
AMENDMENTS		MELWAY REF.	354-C-1	REFERENCE <b>8226 E/30</b>	
B	26.06.2023	SURVEY	BPD		
A	31.01.2023	DESIGN	J.B	SHEET 15 OF 16 <i>B</i>	
		DRAWN	I.W		
VER	DATE	REMARKS	CHECKED	-	SCALE AS SHOWN
					DATUM AHD
					DATE AUG 2022



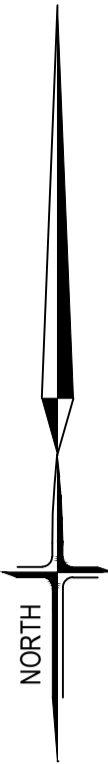

**WARNING**  
 BEWARE OF UNDERGROUND SERVICES  
 THE LOCATION OF UNDERGROUND SERVICES ARE APPROXIMATE ONLY AND THEIR EXACT POSITION SHOULD BE PROVEN ON SITE. NO GUARANTEE IS GIVEN THAT ALL EXISTING SERVICES ARE SHOWN.

SYMBOL LEGEND		Prop		Prev Stage	
Drains					
Main Drains					
Sewer < 3000					
Sewer ≥ 3000					
Water (DW)					
Water (NDW)					
House Drain					
Property Inlet					
Street Sign					
FSM					
Rock Ret Wall					
Sleeper Ret Wall					
Conduits 50mm					
Conduits 100mm					
Street Tree without/with Passive Irrigation (Refer Detail)					
Ex Drains					
Ex Water DW/NDW					
Ex Sewer/Gas					
Ex Elect/Comm					
Ex Optic Fibre					
Ex/Natural/FS Level					
FS @ Building Line					
Top/Toe of Batter					
Top Ret. Wall Level					
100yr Flood Level					
Fill Proposed (<0.3m/≥0.3m)					
Cut Proposed					
Asphalt Surface Prop					
Concrete Surface Prop (Paths/Driveways/Slabs)					
Tree To Be Removed					
Tree To Be Retained with Tree Protection Zone (TPZ)					

**PLAN**  
SCALE 1:500

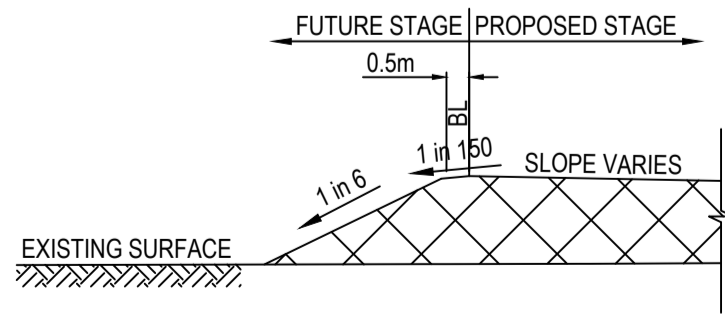

TYPICAL SECTION WHEN IN FILL ON BOUNDARY OF FUTURE STAGE  
NOT TO SCALE

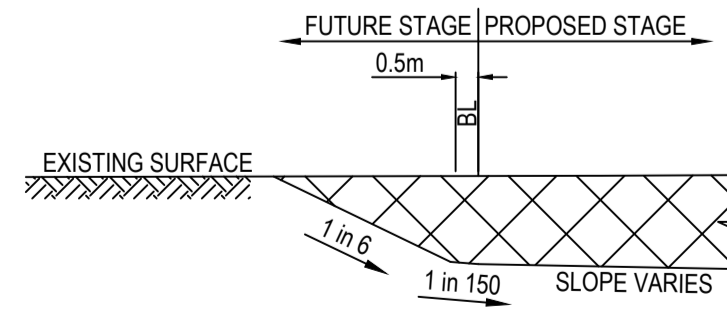

TYPICAL SECTION WHEN IN CUT ON BOUNDARY OF FUTURE STAGE  
NOT TO SCALE

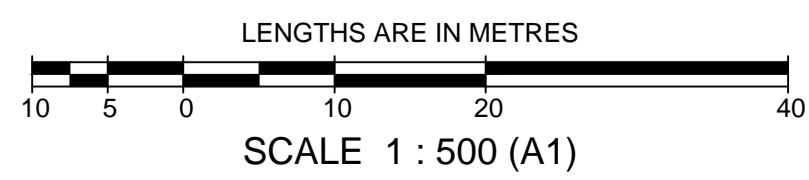

AMENDMENTS		<b>breese pitt dixon pty. ltd.</b> land surveyors      civil engineers		1/19 cato street hawthorn east, 3123 telephone 8823 2300 fax no. 8823 2310	
B	26.06.2023	LOT 3017-3026 ARRANGEMENT AMENDED	MELWAY REF. 356-C-1	<b>ASPIRE ESTATE STAGE 30 EARTHWORKS PLAN</b>	
A	31.01.2023	CONSTRUCTION ISSUE	SURVEY BPD		
VER	DATE	REMARKS	DESIGN J.B.	MUNICIPALITY <b>MELTON</b> REFERENCE <b>8226 E/30</b>	
			DRAWN I.W.		
			CHECKED -	SCALE AS SHOWN	DATUM AHD
				DATE AUG 2022	SHEET 16 OF 16