

# BUILDING ENVELOPES

## FOR

# ASPIRE ESTATE

## STAGE 13

### PS 724925H version K

**ENDORSEMENT**  
Planning And Environment Act 1987  
Melton Planning Scheme

This Plan is Hereby Endorsed And Forms  
Page 1 Of 9 Of The  
Plan Referred To In Planning Permit  
No: PA2010/2849  
(CONDITION 10 F11) Date 1/6/15

Signed For And On Behalf Of [Signature]  
The Responsible Authority  
This Plan Supersedes The Corresponding Plan  
Endorsed On 2/7/2014 (Date)

ref: 2705913BK  
date: 22/07/2014  
version: K

**Bosco Jonson Pty Ltd**  
A.B.N 95 282 532 642  
P.O. Box 5075, South Melbourne, Vic 3205  
16 Eastern Road, South Melbourne  
Vic 3205 Australia DX 20524 Emerald Hill  
Tel 03) 9699 1400 Fax 03) 9699 5992



# BUILDING ENVELOPES





**ENDORSEMENT**  
 Planning And Environment Act 1987  
 Melton Planning Scheme

This Plan is hereby Endorsed And Forms  
 Page 2 Of 9 Of The  
 Plan Referred To In Planning Permit  
 No. PA2010/2849  
 (COMPTON'S B F 11) Date 1/6/2015

Signed For And On Behalf Of  
 The Responsible Authority  
 This Plan Supersedes The Corresponding Plan  
 Endorsed On 2/9/2014 (Date)

**LEGEND**

Refer "Diagrams and Plans" in this document for further definitions

-  Single storey Building Envelope (wall height not exceeding 3.6m)
-  Building to Boundary Zone
-  Overlooking Zone - Habitable room windows or raised open spaces are a source of overlooking
-  Non Overlooking Zone - Habitable room windows or raised open spaces are not a source of overlooking

The registered proprietor or proprietors of the lot are required to build in accordance with the approved building envelopes shown hereon and in the "Profile Diagrams" in this document.

**EXAMPLE OF TYPICAL BUILDING ENVELOPE SETBACKS**

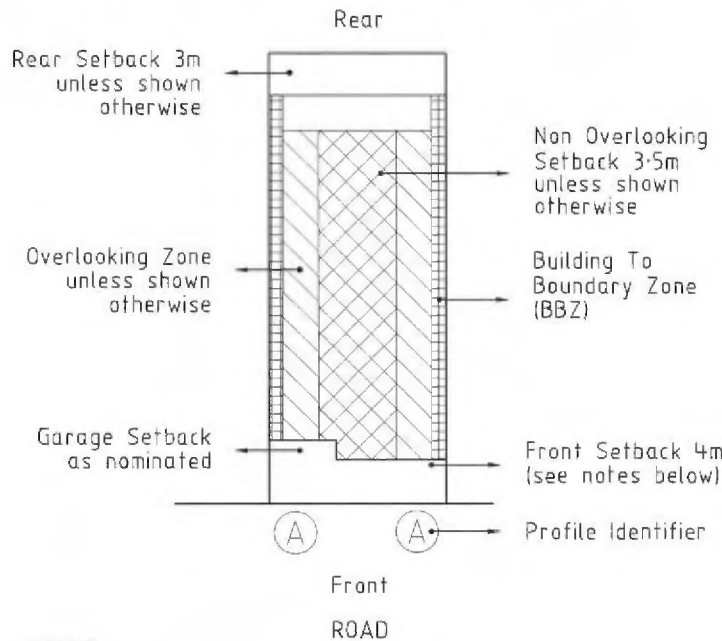

**EXAMPLE OF REAR LOADED TERRACE LOT**

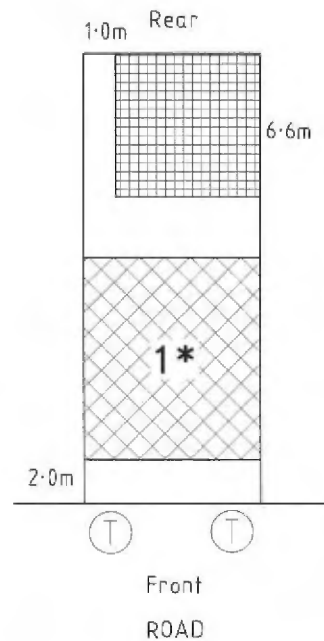

**NOTES**

- The front and side setbacks are measured to the outermost walls of the buildings.
- Garages must be setback a minimum of 5.0m from the front street boundary unless otherwise noted.
- Walls less than 1.0m from the boundary must be within 150mm of the boundary.
- The setback to a side street boundary for a corner lot is 2m unless noted otherwise.
- Porches and verandahs can encroach into the front setback by up to 1.5m at heights of up to 4.5m for a single storey home and heights of up to 9m for a two-storey home.

**ADDITIONAL NOTATION FOR LOTS MARKED '\*'**

- With the exception of garages with access from a laneway, garages must be located or setback behind the front facade of the home.
- Garages setback between 5.0m and 3.9m behind the front street building line are not permitted.
- Minimum private open space required is 25 square metres with a 3m minimum width.
- Maximum building site coverage of 70% is permitted.

ref: 2705913BK  
 date: 22/07/2014  
 version: K

**Bosco Jonson Pty Ltd**  
 A.B.N 95 282 532 642  
 P.O. Box 5075, South Melbourne, Vic 3205  
 16 Eastern Road, South Melbourne  
 Vic 3205 Australia DX 20524 Emerald Hill  
 Tel 03) 9699 1400 Fax 03) 9699 5992



STAGE 13  
BUILDING ENVELOPES

**ENDORSEMENT**  
Planning And Environment Act 1987  
Melton Planning Scheme

This Plan is Hereby Endorsed And Forms  
Page 3 Of 9 Of The  
Plan Referred To In Planning Permit  
No: PA2016/2809  
22/07/2014 + 11) Date 1/6/2015  
Signed For And On Behalf Of [Signature]  
The Responsible Authority  
This Plan Supersedes The Corresponding Plan  
Endorsed On 2/4/2014 (Date)

WRIGHT  
CIRCUIT

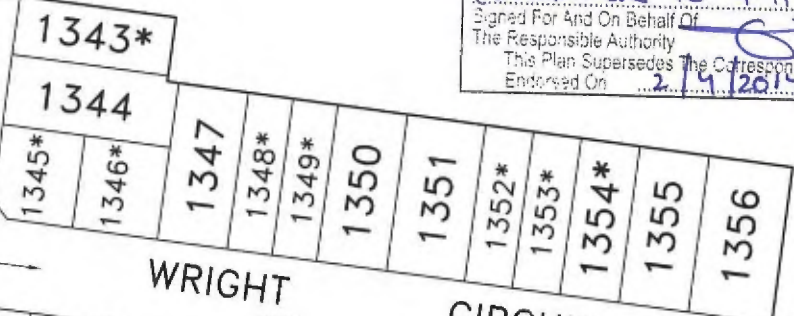

WRIGHT  
SEE SHEET 4 CIRCUIT

WRIGHT  
CIRCUIT

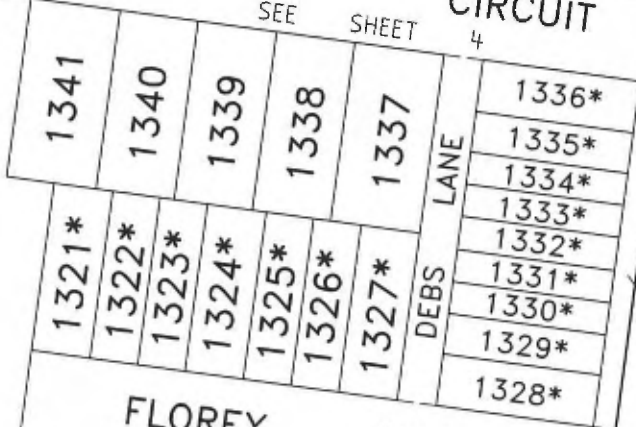

FLOREY  
AVENUE

BOHR  
WALK



MAWSON  
WAY

KENNEDY  
SEE SHEET 5 DRIVE

KENNEDY  
DRIVE

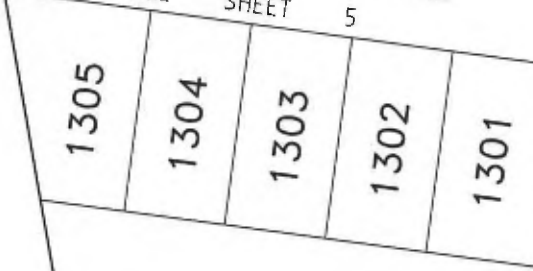

scale 1:1250  
ref: 2705913BK  
date: 22/07/2014  
version: K

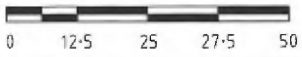

**Bosco Jonson Pty Ltd**  
A.B.N 95 262 532 642  
P.O. Box 5075, South Melbourne, Vic 3205  
16 Eastern Road, South Melbourne  
Vic 3205 Australia DX 20524 Emerald Hill  
Tel 03) 9699 1400 Fax 03) 9699 5992



STAGE 13  
BUILDING ENVELOPES

**ENDORSEMENT**  
Planning And Environment Act 1987  
Melton Planning Scheme

This Plan Is Heraby Endorsed And Forms  
Page 4 Of 9 Of The  
Plan Referred To In Planning Permit  
No. PA2010/2849  
(Completed 10.7.11) Date 1/6/2015  
Signed For And On Behalf Of \_\_\_\_\_  
The Responsible Authority  
This Plan Supersedes The Corresponding Plan  
Endorsed On 2/9/2014 (Date)

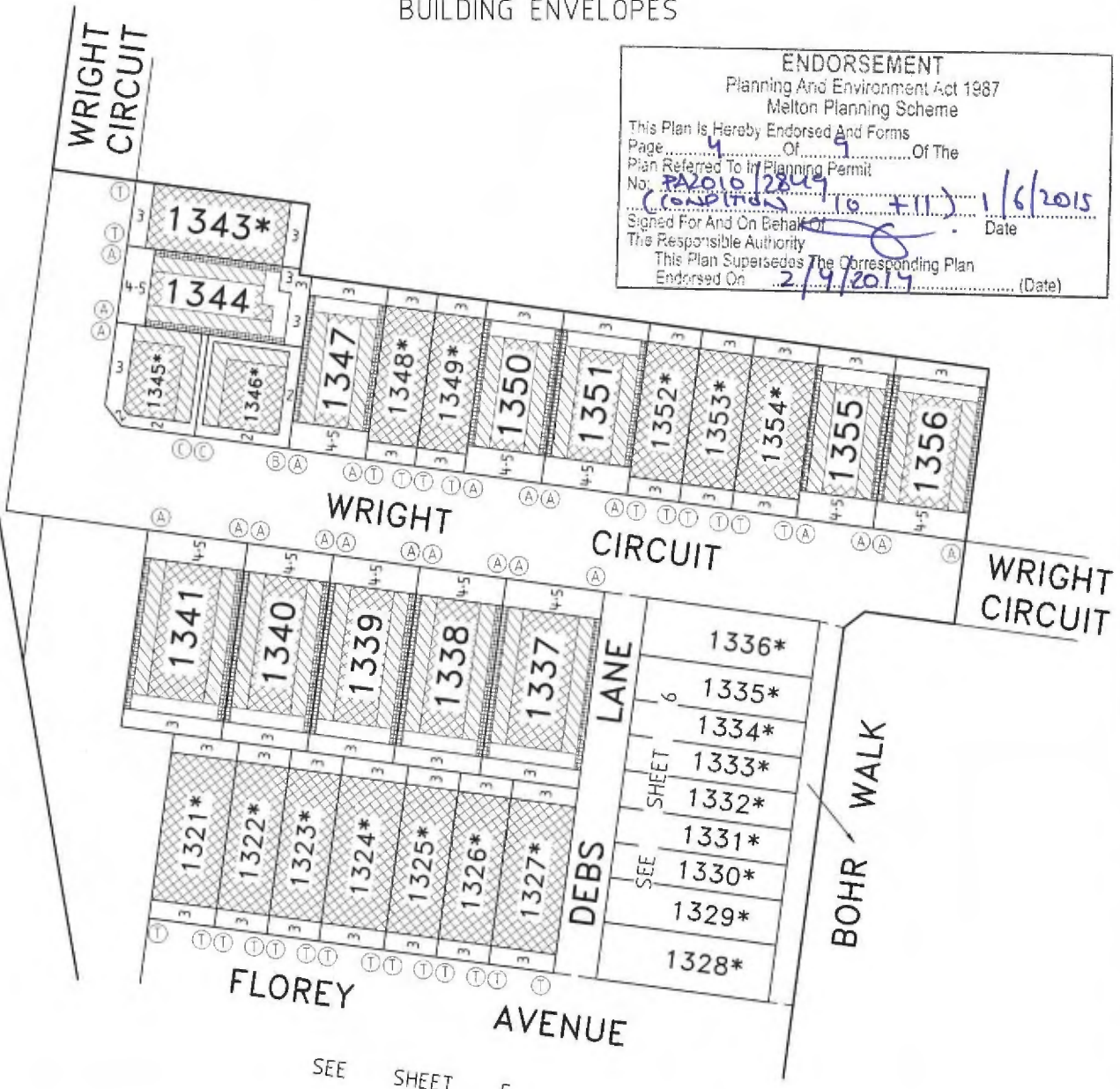

- Notations:
1. The Building Envelopes on this plan are shown enclosed by continuous thick lines.
  2. This diagram is to be read in conjunction with "Profile Diagrams" in this document.
  3. Profile types (A), (B), (C), (D), (E) & (T) are contained in "Profile Diagrams" in this document.

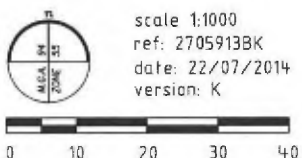

**Bosco Jonson Pty Ltd**  
A.B.N 95 282 532 642  
P.O. Box 5075, South Melbourne, Vic 3205  
16 Eastern Road, South Melbourne  
Vic 3205 Australia DX 20524 Emerald Hill  
Tel 03) 9699 1400 Fax 03) 9699 5992



STAGE 13  
BUILDING ENVELOPES

**ENDORSEMENT**  
Planning And Environment Act 1987  
Melton Planning Scheme

This Plan Is Hereby Endorsed And Forms  
Page 5 Of 9 Of The  
Plan Referred To In Planning Permit  
No: PA20013019  
(COMPLIANT TO F11) Date 1/6/2015

Signed For And On Behalf Of \_\_\_\_\_ The Responsible Authority  
This Plan Supersedes The Corresponding Plan  
Endorsed On 2/4/2014 (Date)

SEE SHEET 4

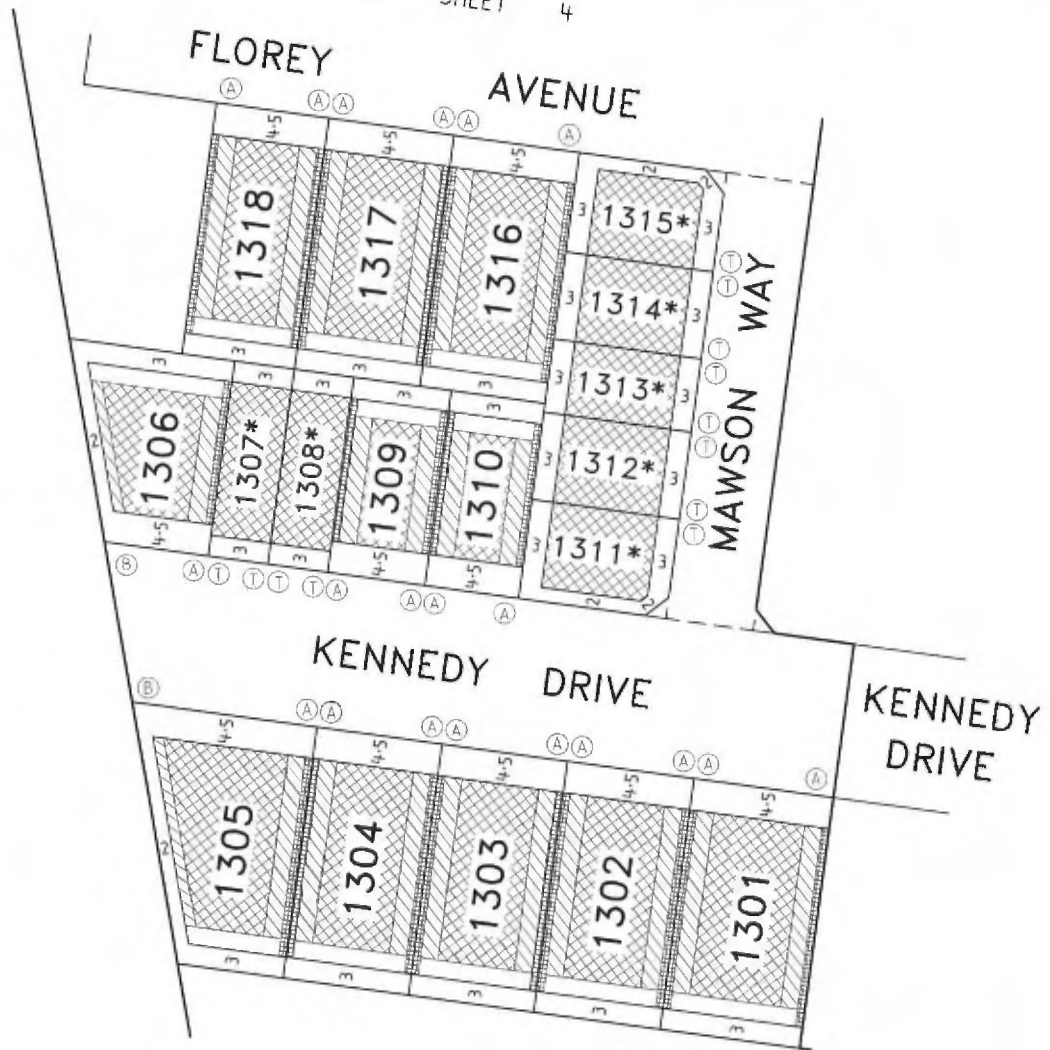

**Notations:**

1. The Building Envelopes on this plan are shown enclosed by continuous thick lines.
2. This diagram is to be read in conjunction with "Profile Diagrams" in this document.
3. Profile types (A), (B), (C), (D), (E) & (T) are contained in "Profile Diagrams" in this document.



scale 1:1000  
ref: 2705913BK  
date: 22/07/2014  
version: K

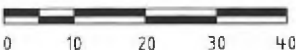

**Bosco Jonson Pty Ltd**

A.B.N 95 282 532 642  
P.O. Box 5075, South Melbourne, Vic 3205  
16 Eastern Road, South Melbourne  
Vic 3205 Australia DX 20524 Emerald Hill  
Tel 03) 9699 1400 Fax 03) 9699 5992



STAGE 13  
BUILDING ENVELOPES

ENDORSEMENT	
Planning And Environment Act 1987 Melton Planning Scheme	
This Plan is Hereby Endorsed And Forms	
Page <u>6</u> Of <u>9</u>	Of The
Plan Referred To In Planning Permit	
No. <u>PA2010/2249</u>	Date <u>11/6/2015</u>
Signed For And On Behalf Of <u>CONCEPTS 10+11</u>	
The Responsible Authority	
This Plan Supersedes The Corresponding Plan	
Endorsed On <u>2/9/2014</u>	(Date)

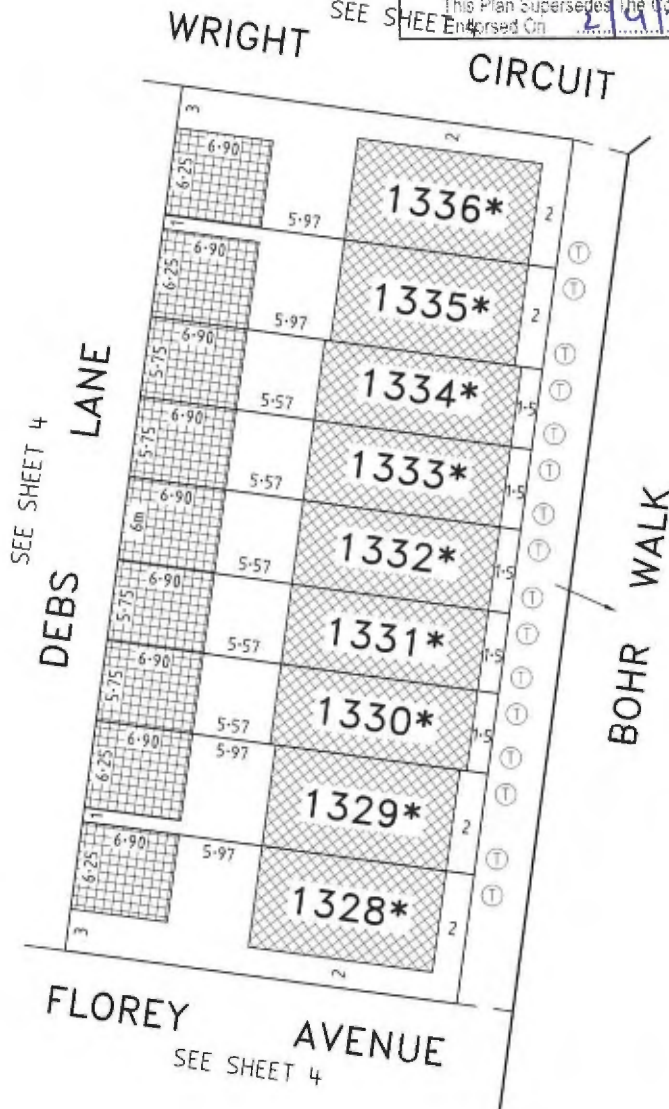

Notations:

1. The Building Envelopes on this plan are shown enclosed by continuous thick lines.
2. This diagram is to be read in conjunction with "Profile Diagrams" in this document.
3. Profile types (A), (B), (C), (D), (E) & (T) are contained in "Profile Diagrams" in this document.



scale 1:500  
ref: 2705913BK  
date: 22/07/2014  
version: K



**Bosco Jonson Pty Ltd**

A.B.N 95 282 532 642  
P.O. Box 5075, South Melbourne, Vic 3205  
16 Eastern Road, South Melbourne  
Vic 3205 Australia DX 20524 Emerald Hill  
Tel 03) 9699 1400 Fax 03) 9699 5992



# PROFILE DIAGRAMS

## (A) Profile

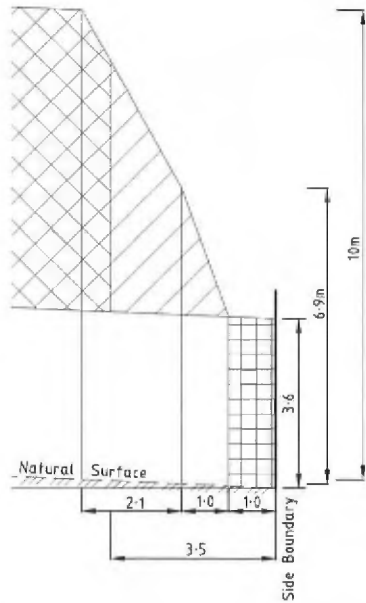

Natural surface rising from side boundary

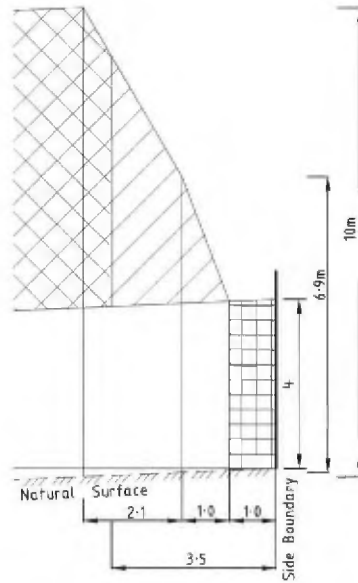

Natural surface falling from side boundary

## (B) Profile

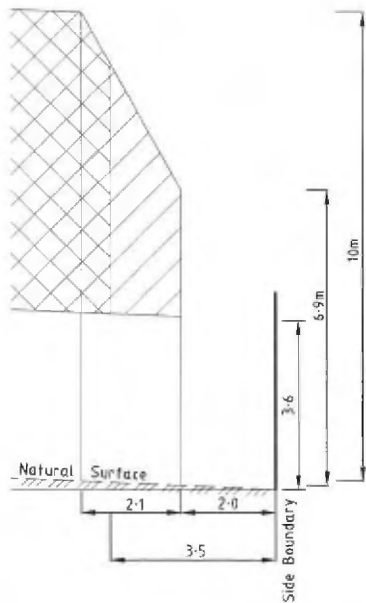

Natural surface rising from side boundary

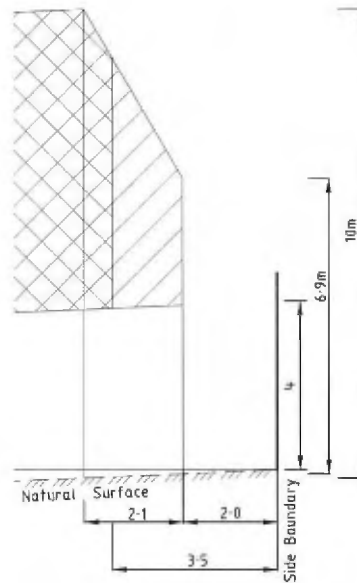

Natural surface falling from side boundary

ref: 27059138K  
date: 22/07/2015  
version: K

ENDORSEMENT	
Planning and Environment Act 1987 Melton Planning Scheme	
This Plan is hereby Endorsed And Forms	
Page 7	Of 9
Plan Referred To in Planning Permit	
No. 27059138K	page 10 of 11
Signed For And On Behalf Of	
The Responsible Authority	
This Plan Supersedes The Corresponding Plan	
Endorsed On 21/11/2015	(Date)

**Bosco Jonson Pty Ltd**  
A.B.N 95 282 532 642  
P.O. Box 5075, South Melbourne, Vic 3205  
16 Eastern Road, South Melbourne  
Vic 3205 Australia DX 20524 Emerald Hill  
Tel 03) 9699 1400 Fax 03) 9699 5992



PROFILE DIAGRAMS

(C) Profile

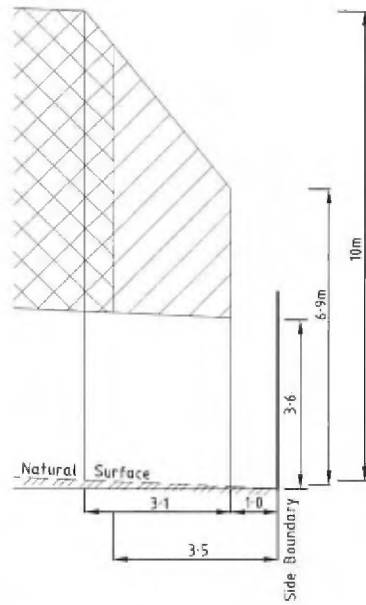

Natural surface rising from side boundary

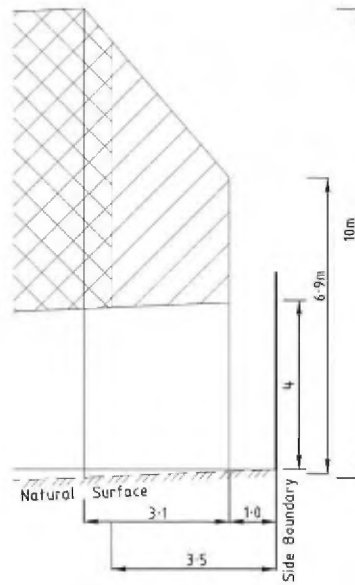

Natural surface falling from side boundary

(D) Profile

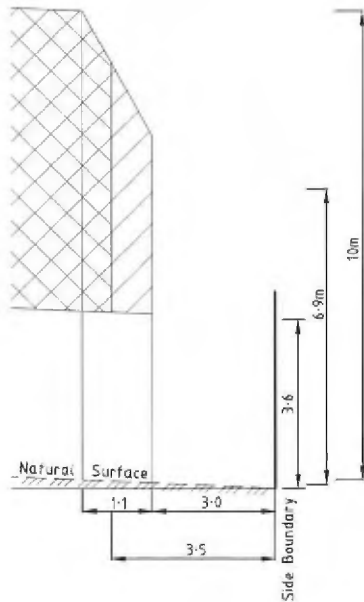

Natural surface rising from side boundary

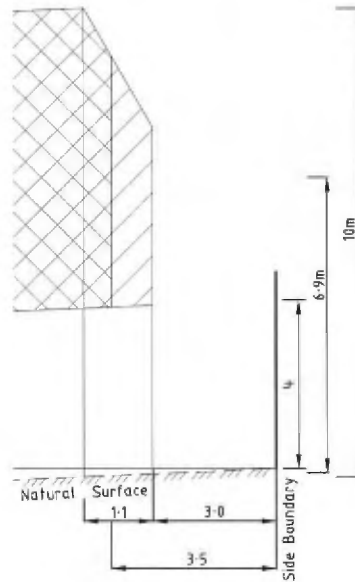

Natural surface falling from side boundary

ref: 2705913BK  
date: 22/07/2014  
version: K

**ENDORSEMENT**  
Planning And Environment Act 1987  
Melton Planning Scheme

This Plan Is Herby Endorsed And Forms  
Page 8 Of 9 Of The  
Plan Referred To In Planning Permit  
No: PA2010/2849 page 8  
COMPTON 10 + 117 Date 1/6/2015  
Signed For And On Behalf of  
The Responsible Authority  
This Plan Supersedes The Corresponding Plan  
Endorsed On 2/6/2014 (Date)

**Bosco Jonson Pty Ltd**  
A.B.N 95 282 532 542  
P.O. Box 5075, South Melbourne, Vic 3205  
16 Eastern Road, South Melbourne  
Vic 3205 Australia DX 20524 Emerald Hill  
Tel 03) 9699 1400 Fax 03) 9699 5992





PROFILE DIAGRAMS

(E) Profile

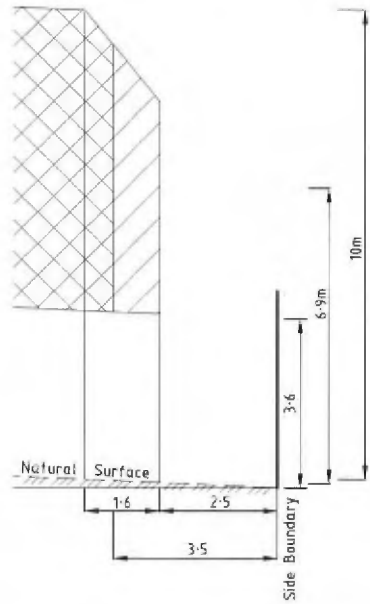

Natural surface rising from side boundary

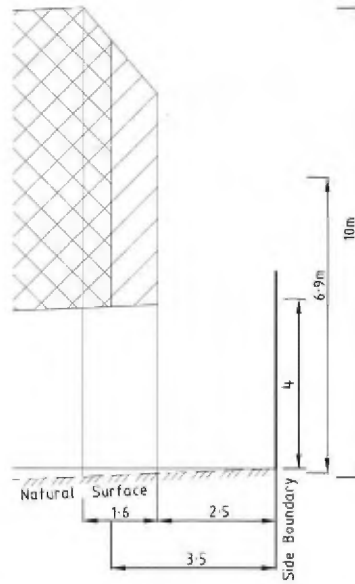

Natural surface falling from side boundary

(T) Profile

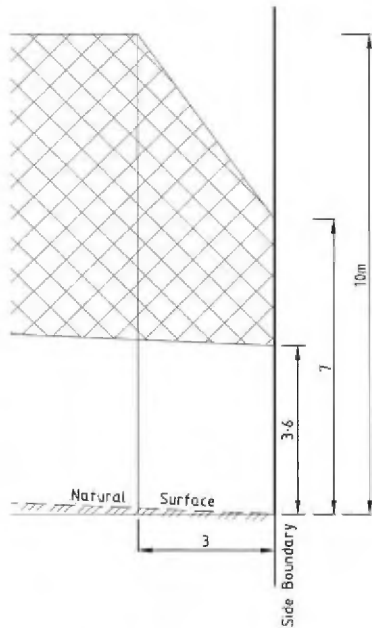

Natural surface rising from side boundary

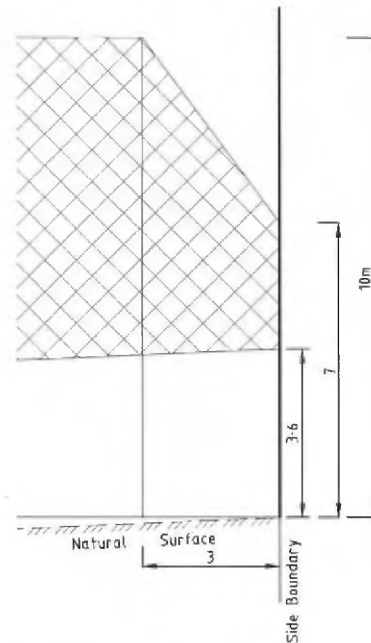

Natural surface falling from side boundary

ref: 2705913BK  
date: 22/07/2014  
version: K

**ENDORSEMENT**  
Planning And Environment Act 1987  
Melton Planning Scheme

This Plan Is Hereby Endorsed And Forms  
Page 9 Of 9 Of The  
Plan Referred To In Planning Permit  
No: PA2010/2899 page 9  
CONTRIBUTOR (1) 1/6/2014  
Signed For And On Behalf Of 1/6/2014  
The Responsible Authority 1/6/2014 Date  
This Plan Supersedes The Corresponding Plan  
Endorsed On 2/10/2014 (Date)

**Bosco Jonson Pty Ltd**  
A.B.N 95 292 532 642  
P.O. Box 5075, South Melbourne, Vic 3205  
16 Eastern Road, South Melbourne  
Vic 3205 Australia DX 20524 Emerald Hill  
Tel 03) 9689 1400 Fax 03) 9689 5992

