

IMAGINE STAGE 16C

ROADS & DRAINAGE PLANS

TRANQUIL STREET - STRATHFIELDSAYE



LOCALITY PLAN
MELWAYS REF: X921 D9

LEGEND

	EXISTING SHRUBS / TREES		PROPOSED GAS & WATER CONDUIT		PROPOSED SEALED PAVEMENT
	PROPOSED STREET TREE		PROPOSED SEWER AND MANHOLE		PROPOSED CRUSHED ROCK
	SHRUBS / TREES TO BE REMOVED		PROPOSED SEWER RISING MAIN		PROPOSED CONCRETE FOOTPATH
	SIGN		PROPOSED PRIVATE SEWER		PROPOSED ASPHALT FOOTPATH
	TELCO PILLAR		EXISTING SEWER & MANHOLE		PROPOSED CONCRETE PAVEMENT (DRIVEWAY OR INFILL)
	TELCO PITS		PROPOSED FUTURE SEWER		PROPOSED ALTERNATE PAVEMENT
	ELECTRICITY LIGHT & POLE		PROPOSED WATER MAIN		PROPOSED KERB
	PROPOSED KERB & CHANNEL		PROPOSED PRIVATE WATER MAIN		PROPOSED NATURESTRIP / LANDSCAPING
	EXISTING KERB & CHANNEL		PROPOSED RECYCLED WATER MAIN		PROPOSED LOT EARTHWORKS NO TOPSOIL
	PROPOSED DRAIN / PIT / I.S.		EXISTING WATER MAIN, FIRE PLUG AND VALVE		PROPOSED OTHER
	EXISTING DRAIN / PIT		PROPOSED FUTURE WATER		PROPOSED ROCK BEACHING
	PROPOSED HOUSE DRAIN / EASEMENT CONNECTION		PROPOSED ELECTRICITY MAIN		PROPOSED STAGE BOUNDARY
	FUTURE DRAIN / PIT		PROPOSED PRIVATE ELECTRICITY MAIN		OVERLAND 1% AEP STORMWATER FLOWPATH
	FENCE LINE		EXISTING ELECTRICITY MAIN & PIT		UNDERGROUND DRAINAGE CATCHMENT BOUNDARY
	INVERT (DESIGN \ EXISTING)		PROPOSED FUTURE ELECTRICITY		DIMENSION (IN METRES UNLESS STATED OTHERWISE)
	EDGE OF SEAL / EDGE OF BITUMEN (DESIGN \ EXISTING)		PROPOSED GAS MAIN		LEADER / ARROW
	TOP OF BANK (DESIGN \ EXISTING)		PROPOSED PRIVATE GAS MAIN		NS 101.95 EXISTING/NATURAL SURFACE LEVEL
	BOTTOM OF BANK		EXISTING GAS MAIN		FS 101.95 FINISHED SURFACE LEVEL
	PROPOSED TITLE BOUNDARY & SITE TITLE BOUNDARY		PROPOSED FUTURE GAS MAIN		TBB 101.95 TOP OF BANK / BOTTOM OF BANK SURFACE LEVEL
	PROPOSED FUTURE TITLE BOUNDARY		PROPOSED TELCO MAIN		TK 101.95 PROPOSED BACK OF KERB
	PREVIOUS STAGE TITLE BOUNDARY		PROPOSED PRIVATE TELCO MAIN		P 101.95 PROPOSED PAVEMENT FOOTPATH LEVEL
	PROPOSED OR EXISTING EASEMENT		EXISTING TELCO CABLE		DIRECTION OF LOT GRADING
	HOUSE		PROPOSED FUTURE TELCO		DIRECTION OF BASIN GRADING
			PROPOSED CATCH DRAIN		PROPOSED FLAT TOP SPEED HUMPS
			PROPOSED AG DRAIN		PERMANENT SURVEY MARK
					SURVEY STATION

DRAWING LIST

- 14112R01 LOCALITY PLAN & GENERAL NOTES
- 14112R02 OVERALL DEVELOPMENT PLAN
- 14112R03 EXISTING CONDITIONS & TBM PLAN
- 14112R04 CONSTRUCTION LAYOUT PLAN
- 14112R05 CUT & FILL DEPTH RANGE & LOT LEVELS
- 14112R06 PAVEMENT, SIGNAGE & LINEMARKING PLAN
- 14112R07 INTERSECTION DETAILS
- 14112R08 TYPICAL SECTIONS
- 14112R09 TRANQUIL STREET LONG SECTION
- 14112R10 TRANQUIL STREET CROSS SECTIONS
- 14112R11 SERENE DRIVE LONG & CROSS SECTIONS
- 14112R12 DRAINAGE LONG SECTIONS & PIT SCHEDULE
- 14112R13 DRAINAGE CATCHMENT PLAN
- 14112R14 DRAINAGE HYDRAULIC / HYDROLOGY CALC SHEET

TABLE OF OFFSETS FOR SERVICES

STREET	GAS	NDW	DW	TELCO	UG ELEC	LIGHTING	BOK
TRANQUIL STREET	1.90 W	-	2.40 W	1.90 E	2.40 E	-	4.05E / 4.05W
SERENE DRIVE	1.90 S	-	2.40 S	1.90 N	2.40 N	-	4.05N / 4.05S



WARNING
BEWARE OF UNDERGROUND SERVICES
THE LOCATIONS OF UNDERGROUND SERVICES ARE APPROXIMATE ONLY AND THEIR EXACT POSITION SHOULD BE PROVEN ON SITE. NO GUARANTEE IS GIVEN THAT ALL EXISTING SERVICES ARE SHOWN.

GENERAL NOTES

- PRIOR TO THE COMMENCEMENT OF WORKS**
- THE CONTRACTOR MUST NOTIFY THE RELEVANT AUTHORITY 7 DAYS PRIOR TO COMMENCEMENT OF CONSTRUCTION OF THE RELEVANT WORKS.
 - THE CONTRACTOR MUST OBTAIN ALL NECESSARY PERMITS FROM THE MUNICIPALITY & VICROADS FOR ANY WORKS UNDERTAKEN WITHIN AN EXISTING ROAD RESERVE PRIOR TO THE COMMENCEMENT OF WORKS.
 - THE CONSULTANT HAS MADE EVERY REASONABLE ATTEMPT TO LOCATE EXISTING SERVICES AND HAS SHOWN THESE ON THE DRAWINGS. THE CONTRACTOR SHALL TAKE PHOTOGRAPHS AND PROVIDE A WRITTEN REPORT DETAILING THE CONDITION REGARDING ALL EXISTING INFRASTRUCTURE WHICH THEY ARE INTERFACING WITH, OR OTHERWISE HAVING AN IMPACT ON.
 - PRIOR TO COMMENCING WORKS THE CONTRACTOR SHALL VERIFY THE LOCATION OF ALL SERVICES BY SITE SURVEY (INSPECTION AND CONSULTATION WITH ALL RELEVANT SERVICING AUTHORITIES). THE CONTRACTOR SHALL BE RESPONSIBLE FOR ANY DAMAGE TO EXISTING SERVICES, WHETHER SHOWN OR NOT.
 - THE CONTRACTOR MUST CONTACT BEFORE YOU DIG AUSTRALIA (CALL 1100), OR VISIT THE BEFORE YOU DIG AUSTRALIA WEBSITE PRIOR TO COMMENCING WORKS AND SATISFY THEMSELVES THAT THERE ARE NO SERVICES WITHIN THE VICINITY OF THE WORK AREA.
 - NO WORK IS TO COMMENCE BEFORE THE CONTRACTOR HAS ASCERTAINED WHAT UNDERGROUND SERVICES ARE PRESENT.
 - CONTRACTOR MUST FOLLOW THE "NO GO ZONE" SAFETY PROCEDURES AT ALL TIMES, WHICH ARE AVAILABLE FROM ALL UTILITY AND TELECOMMUNICATIONS COMPANIES, INCLUDING THE OFFICE OF THE CHIEF ELECTRICAL INSPECTOR, THE OFFICE OF GAS SAFETY AND WORKSAFE VICTORIA.
 - IF THESE SAFETY PROCEDURES CANNOT BE COMPLIED WITH THEN NO WORK IS TO BE UNDERTAKEN WITHOUT PERMISSION FROM THE UTILITY COMPANY.
 - THE CONTRACTOR MUST PREPARE A PROJECT MANAGEMENT PLAN (OTHERWISE CALLED A CONSTRUCTION OR SITE MANAGEMENT PLAN) AND HAVE IT APPROVED BY BOTH COUNCIL & THE SUPERINTENDENT PRIOR TO THE COMMENCEMENT OF ANY WORKS. THIS PROJECT MANAGEMENT PLAN IS TO INCORPORATE THE FOLLOWING AT A MINIMUM AND IN ACCORDANCE WITH ANY LEGISLATION REQUIREMENTS:
 - OCCUPATIONAL HEALTH & SAFETY PROCEDURES
 - SITE STAFFING INCLUDING CONTACT DETAILS
 - TRAFFIC MANAGEMENT PLAN

- ENVIRONMENTAL MANAGEMENT PLAN
 - QUALITY ASSURANCE DETAILS (FOR QA CERTIFIED CONTRACTORS)
 - CONSTRUCTION PROGRAM
- CONSTRUCTION SETOUT**
- ALL LEVELS ARE TO A.H.D. AND ARE REFERENCED TO THE T.B.M. INDICATED.
 - COORDINATION OF THIS DESIGN USES MGA2020, CORRECT AS OF THE DATE OF THESE PLANS. MGA94 MAY HAVE BEEN USED PREVIOUSLY ON THIS SITE OR AN ADJOINING PROPERTY AND SUCH WORK WILL DIFFER IN POSITION BY AROUND 1.8 METRES FROM THIS DOCUMENT. ORIENTATION (NORTH) REMAINS THE SAME BETWEEN MGA94 AND MGA2020.
 - NO TBM CAN BE USED WITHOUT FIRST PROVING IT TO BE CORRECT TO A SECOND TBM. NO HORIZONTAL SETOUT CONTROL CAN BE USED WITHOUT FIRST PROVING IT TO BE CORRECT TO A THIRD KNOWN POINT. THE CONSULTING SURVEYOR IS TO BE NOTIFIED OF ANY DISCREPANCIES IMMEDIATELY. TITLE PEGS AND T.B.M.'s TO BE RE-ESTABLISHED BY A LICENSED SURVEYOR IF FOUND TO BE MISSING.
 - IF USING GNSS \ GPS TO SETOUT FOR CONSTRUCTION PLEASE NOTE:
 - GNSS HAS REDUCED VERTICAL PRECISION COMPARED TO TRADITIONAL SURVEY METHODS.
 - ONLY USE A SINGLE POINT CALIBRATION FOR THE VERTICAL THEN TEST TO AT LEAST 1 OTHER STATED TBM BEFORE PROCEEDING.
 - IF YOU HAVE ANY QUERIES OR CONCERNS CONTACT THE CONSULTING SURVEYOR.
- SITE MANAGEMENT DURING CONSTRUCTION**
- THE SUPERINTENDENT IS RESPONSIBLE FOR THE DESIGN AND MANAGEMENT OF THE CONSTRUCTION WORKS. ANY PROBLEMS ARISING DURING CONSTRUCTION SHALL BE DIRECTED TO THE SUPERINTENDENT.
 - ALL WORKS SHALL BE CONSTRUCTED IN ACCORDANCE WITH THE INFRASTRUCTURE DESIGN MANUAL AND ANY OTHER RELEVANT AUTHORITY SPECIFICATIONS. A COPY OF THE INFRASTRUCTURE DESIGN MANUAL CAN BE FOUND AT www.designmanual.com.au. IF YOU HAVE ANY ISSUES INTERPRETING THE MANUAL CONTACT THE SUPERINTENDENT.
 - ALL WORKS MUST ABIDE BY THE APPROVED CONSTRUCTION MANAGEMENT PLAN AND MUST COMPLY WITH THE RECOMMENDATIONS OF THE ENVIRONMENT PROTECTION AUTHORITY PUBLICATION "CONSTRUCTION TECHNIQUES FOR SEDIMENT POLLUTION CONTROL" (PUBLICATION NO 275). APPROPRIATE SILTATION CONTROL IS TO BE CARRIED OUT DURING THE CONSTRUCTION AND MAINTENANCE PERIOD.
 - BEFORE COMMENCING ANY EXCAVATION WORKS OF 1.5m DEPTH OR GREATER,

- THE CONTRACTOR IS REQUIRED TO SUBMIT THE REQUIRED NOTIFICATION TO WORKSAFE VICTORIA. THE NOTIFICATION MUST BE RECEIVED BY THE AUTHORITY AT LEAST 3 DAYS PRIOR TO COMMENCING EXCAVATIONS. A COPY OF THE NOTIFICATION IS TO BE PROVIDED TO THE SUPERINTENDENT. THE CONTRACTOR SHALL COMPLY WITH THE MINES ACT, OCCUPATIONAL HEALTH AND SAFETY ACT, WORKSAFE VICTORIA REQUIREMENTS INCLUDING COMPLIANCE CODES.
- TWENTY-FOUR (24) HOURS NOTIFICATION TO INSPECTORS OF RELEVANT AUTHORITY IS REQUIRED PRIOR TO AN INSPECTION BEING CONDUCTED ON ANY PARTICULAR PORTION OF THE WORKS.
 - THE CONTRACTOR SHALL TAKE THE UTMOST CARE TO PRESERVE EXISTING TREES. NO TREES SHALL BE REMOVED WITHOUT THE PRIOR APPROVAL OF THE SUPERINTENDENT.
 - THE CONTRACTOR IS REQUIRED TO CONFINE CONSTRUCTION VEHICLES TO THE ROAD RESERVE AND EASEMENTS. ANY DAMAGE CAUSED TO THE ALLOTMENTS MUST BE MADE GOOD.
 - THE CONTRACTOR SHALL TO THE SATISFACTION OF THE SUPERINTENDENT AND COUNCIL'S SUPERVISING OFFICER PROVIDE AND MAINTAIN ALL NECESSARY WARNING SIGNAGE, LIGHTING AND BARRICADING TO COMPLY WITH THE REQUIREMENTS OF THE ROAD MANAGEMENT ACT.
 - DISPOSAL OF EXCESS SPOIL TRUCK ROUTE AND DISPOSAL LOCATION ARE TO BE APPROVED BY THE MUNICIPAL ENGINEERING DEPARTMENT.
 - AT THE COMPLETION OF WORKS ALL RUBBISH, DEBRIS AND SURPLUS SPOIL IS TO BE REMOVED AND ALL LOTS AND ROAD RESERVE TO BE LEFT IN A TIDY CONDITION TO THE SATISFACTION OF THE SUPERINTENDENT & RELEVANT AUTHORITY.
- PROTECTION OF VEGETATION**
- NO WORKS ARE TO BE UNDERTAKEN WITHIN THE DRIP ZONE (CANOPY) OF AN EXISTING TREE UNLESS APPROVED BY THE RESPONSIBLE AUTHORITY.
 - MACHINERY IS NOT TO BE DRIVEN OVER OR PARKED WITHIN THE DRIP ZONE OF ANY TREE.
- EARTHWORKS**
- ALL EARTHWORKS ARE TO BE UNDERTAKEN IN ACCORDANCE WITH AS 3798 (2007) - GUIDELINES ON EARTHWORKS FOR COMMERCIAL AND RESIDENTIAL DEVELOPMENTS.
 - ALL FILLING WITHIN AREAS OF PROPOSED ROAD PAVEMENT IS TO ACHIEVE A MINIMUM COMPACTION OF 98% STANDARD.

- ALL FILLING WITHIN OTHER AREAS IS TO ACHIEVE A MINIMUM COMPACTION OF 95% STANDARD.
 - ANY FILLING IN EXCESS OF 300mm DEPTH IS TO BE CARRIED OUT UNDER LEVEL 1 SUPERVISION UNLESS DIRECTED OTHERWISE. FILL AREAS ARE TO BE STRIPPED OF TOPSOIL & FILLED USING APPROVED CLAY FILL. TOPSOIL IS TO BE REPLACED NO MORE THAN 150mm THICK TO OBTAIN FINAL FILL LEVELS AS SHOWN ON PLANS. ALL FILLING IS TO BE CARRIED OUT IN 150mm LAYERS AND COMPACTED AS DETAILED ABOVE IN ACCORDANCE WITH AS3798-2007 (GUIDELINES ON EARTHWORKS FOR COMMERCIAL AND RESIDENTIAL DEVELOPMENTS). ON COMPLETION THE CONTRACTOR SHALL PRESENT A "LEVEL 1" TYPED REPORT NOMINATING THE EXTENT OF FILL PLACED, ITS CONFORMANCE WITH THE SPECIFICATION AND ITS CLASSIFICATION AS "CONTROLLED FILL". IF ANY SUBSTANDARD FILLING IS ENCOUNTERED ON THE SITE IT MUST BE REMOVED AND REPLACED WITH VERIFICATION PROVIDED TO THE SUPERVISING ENGINEER. A GEO-TECHNICAL REPORT MUST BE SUBMITTED SHOWING DETAILS OF DEPTH, TYPE OF MATERIAL AND DENSITY OF THE FILL AREAS CONCERNED.
 - THE SUPERINTENDENT IS TO BE ADVISED OF ANY FILLING THAT ACHIEVES A DEPTH OF 300mm OR GREATER.
 - THE CONTRACTOR IS RESPONSIBLE FOR ENSURING THAT ALL IMPORTED FILL MATERIAL, INCLUDING TOPSOIL, SATISFIES THE DESCRIPTION FOR CLEAN FILL MATERIAL IN EPA BULLETIN PUBLICATION NO. 448 (MAY 2007) AND SUBSEQUENT REVISIONS. THE CONTRACTOR SHALL PROVIDE VERIFICATION INCLUDING TEST CERTIFICATES TO THE SUPERVISING ENGINEER.
 - ALL TRENCHES ARE TO ACHIEVE THE SPECIFIED COMPACTION RESULTS WITHOUT EXCEPTION. THE SUPERINTENDENT RESERVES THE RIGHT TO REQUIRE COMPACTION TESTING BY A NATA APPROVED LABORATORY AT THE CONTRACTORS EXPENSE.
 - ALL EXCAVATIONS OF DEPTH 1.5m OR GREATER MUST COMPLY WITH LEGISLATION ENFORCED BY WORKSAFE VICTORIA. A "NOTICE OF INTENTION TO COMMENCE EXCAVATION" MUST BE SUBMITTED TO YOUR LOCAL WORKSAFE OFFICE.
 - ALL LOTS ARE TO ACHIEVE A MINIMUM CROSS FALL OF 1 IN 150 (0.67%) TO A LEGAL POINT OF DISCHARGE (DRAINAGE POINT OR ROAD RESERVE) UNLESS STATED OTHERWISE.
 - RESERVES ARE TO BE FREE DRAINING AND TO BE LEFT IN A CONDITION SATISFACTORY TO THE SUPERINTENDENT.
- ROAD WORKS AND FOOTPATHS**
- ALL KERB & CHANNEL IS MODIFIED SM2 (IDM SD 100) UNLESS STATED OTHERWISE.

- ALL ASPHALT ROAD SEALS ARE TO BE 7mm TYPE 'N' UNLESS STATED OTHERWISE.
 - ALL KERB RADII ARE TO BACK OF KERB UNLESS STATED OTHERWISE.
 - ALL FOOTPATHS ARE TO BE CONSTRUCTED AS PER INFRASTRUCTURE DESIGN MANUAL (IDM) 200 SERIES STANDARD DRAWINGS AND IN ACCORDANCE WITH COUNCIL STANDARDS UNLESS STATED OTHERWISE.
 - TGSI'S ARE TO BE INSTALLED ON ALL PEDESTRIAN CROSSINGS AS PER AS 1428.4.
 - ALL NEW INTERSECTIONS ARE TO HAVE STREET SIGNS INSTALLED TO COUNCIL STANDARDS IRRESPECTIVE OF WHETHER THEY ARE DETAILED ON THE ENGINEERING PLANS OR NOT.
 - AT ALL TEMPORARY STAGE BOUNDARY TERMINATIONS TO ROADS THE CONTRACTOR IS TO INSTALL A D4-HAZARD SIGN.
 - ALL CONCRETE IS TO HAVE A MINIMUM COMPRESSIVE STRENGTH OF 25MPa AT 28 DAYS AND MINIMUM CEMENT CONTENT OF 320 kg/m³.
 - TRANSITIONS BETWEEN DIFFERENT KERB TYPES TO BE OVER 3.0m MINIMUM, IF IT CANNOT BE ACHIEVED AT A PRAM CROSSING OR DRIVEWAY CROSSOVER.
 - ROAD PAVEMENT DESIGN & TESTING REQUIREMENTS ARE AS PER THE INFRASTRUCTURE DESIGN MANUAL.
- STORMWATER DRAINAGE AND SERVICE CONDUIT NOTES**
- ALL EASEMENT DRAINAGE PIPES ARE 1.0m OFFSET TITLE BOUNDARY UNLESS DIMENSIONED OTHERWISE.
 - ALL EASEMENT DRAINAGE PITS ARE TO BE 1.0m PAST TITLE BOUNDARY UNLESS DIMENSIONED OTHERWISE.
 - ALL PROPERTY DRAINAGE CONNECTIONS FROM ROAD RESERVES ARE TO ENTER THE PROPERTY 1.0m O/S SIDE BOUNDARY ON THE LOW SIDE WITH 0.5m COVER UNLESS NOTED OTHERWISE.
 - ALL STORMWATER AND CONDUIT TRENCHES UNDER ROAD PAVEMENT, KERB & CHANNEL AND FOOTPATH SHALL BE BACKFILLED IN ACCORDANCE WITH THE IDM UNLESS STATED OTHERWISE.
 - REFER TO THE CERTIFIED PLAN OF SUBDIVISION FOR ALL EASEMENT WIDTHS, DO NOT SCALE FROM DRAWING.
 - STORMWATER DRAINS SHALL BE RCP FLUSH JOINTED CLASS 2 OR PVC CLASS SN8 UNLESS OTHERWISE SHOWN.
 - ALL RCP FLUSH JOINTED PIPES BELOW 600mm DIA ARE TO HAVE EXTERIOR

- MORTARED JOINTS. ALL PIPES 600 DIA AND GREATER ARE TO HAVE INTERIOR MORTAR JOINTS.
 - ALL PROPOSED DRAINAGE STUBS TO BE BLANKED OFF AT END OF PIPE WITH TIMBER PLANKS TO THE SATISFACTION OF THE SUPERVISING ENGINEER.
 - ALL CONDUIT LOCATIONS ARE TO BE STAMPED IN THE CONCRETE KERBING.
 - ALL CONCRETE IS TO HAVE A MINIMUM COMPRESSIVE STRENGTH OF 25MPa AT 28 DAYS.
 - ALL GRATES ARE TO BE HOT DIPPED GALVANISED.
 - 100mm DEEP CATCH DRAINS TO BE CONSTRUCTED ALONG ALL EASEMENT DRAINAGE AND DIRECTED TO LEGAL POINT OF DISCHARGE.
 - STEP IRONS ARE NOT TO BE INSTALLED IN ANY DRAINAGE PIT. ACCESS LIDS ARE TO BE LOCATED TO ENABLE REASONABLE ACCESS.
 - ALL HOUSE DRAIN CONNECTIONS TO REINFORCED CONCRETE PIPES ARE TO UTILISE "CONCONNECT" OR COUNCIL APPROVED EQUIVALENT PRODUCTS TO AVOID PIPE PROTRUSIONS INTO THE LARGER PIPE.
 - REFER ROAD LAYOUT PLANS FOR WATER & GAS ROAD SERVICE CONDUIT LOCATIONS. INTERSECTION DETAILS PLANS DO NOT SHOW CONDUITS.
 - ELECTRICITY & TELECOMMUNICATIONS CONDUITS SHOWN ON THESE PLANS ARE CONCEPTUAL ONLY. REFER TO ELECTRICITY & TELECOMMUNICATION PLANS FOR ACTUAL ROAD SERVICE CONDUIT LOCATIONS. IF THERE ARE ANY DISCREPANCIES BETWEEN THESE PLANS CONTACT SUPERINTENDENT FOR CLARIFICATION.
- CONSTRUCTION HOLD POINTS**
- CONSTRUCTION HOLD POINTS ARE TO BE IN ACCORDANCE WITH THE INFRASTRUCTURE DESIGN MANUAL.
- EMERGENCY CONTACTS**
- THE PROJECT AREA CONTAINS THE FOLLOWING SERVICES FOR ASSISTANCE IN EMERGENCY CONTACT.

SERVICE	AUTHORITY & CONTACT	TELEPHONE
DRAINAGE	CITY OF GREATER BENDIGO	5434 6000
ELECTRICITY	POWERCOR	132 412
GAS	SP AUSNET	136 707
COMMUNICATIONS	TELSTRA	132 203
SEWER & WATER	COLIBAN WATER	1300 363 200
 - IN ANY EMERGENCY IF YOU BELIEVE LIFE OR PROPERTY IS THREATENED DO NOT HESITATE TO CONTACT STATE EMERGENCY SERVICES ON TELEPHONE 000.

DRAFT

A AS SUBMITTED TO COUNCIL	BB BB	07/07/23
REV	REVISION	DES DWG CHK AUTH DATE

Tomkinson
SURVEY • ENGINEERING • PLANNING • PROJECT MANAGEMENT

HEAD OFFICE: 57 MYERS STREET BENDIGO PH 03 5445 8700
ABN 11 103 336 358 WWW.TOMKINSON.COM

imagine
STRATHFIELDSAYE

SCALE N/A
LENGTHS ARE IN METRES - PAPER SIZE A3

© COPYRIGHT THE INFORMATION CONTAINED ON THIS DRAWING IS THE INTELLECTUAL PROPERTY OF TOMKINSON GROUP. COPYING OR USING THIS DRAWING IN WHOLE OR IN PART WITHOUT THE EXPRESS WRITTEN PERMISSION OF TOMKINSON GROUP INFRINGES COPYRIGHT

BEFORE YOU DIG
www.byda.com.au

COMPASS ASSURANCE
ISO 9001 QUALITY

IMAGINE STAGE 16C
TRANQUIL STREET STRATHFIELDSAYE
LOCALITY PLAN & GENERAL NOTES
CITY OF GREATER BENDIGO REF: DS/459/2021
STRATHFIELDSAYE HOLDINGS PTY LTD

DWG STATUS: **PRELIMINARY** PROJECT & DWG No: 14112R01 / 14 A REV: A

NOTE: THIS IS AN UNCONTROLLED DOCUMENT AND WILL NOT BE UPDATED. IT IS THE RESPONSIBILITY OF THE USER TO CONFIRM THAT THIS IS A CURRENT COPY AND SUITABLE FOR THE PROPOSED USE. THIS SHEET MUST BE READ IN CONJUNCTION WITH ALL SHEETS OF THIS SET AND ANY ACCOMPANYING DOCUMENTS. PLOT DATE: 15/12/2023 FILE: C:\TZD\DATA\TOMK66C-T2050114-T12 - ENU CREEK HOLDINGS, STRATHFIELDSAYE_#188ENUG00CAD\CURRENT\14112R01.DWG

GENERAL DESIGN DETAIL PLAN NOTES
 APPLIES IN ALL CASES UNLESS STATED OTHERWISE

- KERB TYPES:
 - FRONTING LOTS = MODIFIED SM2-M (IDM SD 100 - SM2-M)
 - FRONTING RESERVES = 600mm B2 AS PER IDM SD 100
- ALL KERB RETURNS ARE 8.0m RADIUS TO B&K
- ALL DRIVEWAYS AS PER IDM SD 240 & 245
- ALL FOOTPATHS CONCRETE & 1.5m WIDE @ 0.05m O/S AS PER IDM SD 205
- ALL SHARED PATHS CONCRETE & 2.5m WIDE @ 0.10m O/S BL AS PER IDM SD 205
- ALL EASEMENT DRAINAGE PIPES & PITS ARE 1.0m O/S BL & SIDE BOUNDARIES
- LEVEL 1 SUPERVISION REQUIRED FOR LOT EARTHWORKS UNLESS SPECIFIED OTHERWISE - REFER GENERAL NOTES
- ALL LOTS TO HAVE CATCH DRAINS ALONG SIDE & REAR BOUNDARIES
- CONTOUR INTERVAL 0.5m @ 1:1000 & 0.05m @ 1:200 | 1:250(A3) WHERE SHOWN
- CONTRACTOR TO UNDERTAKE WORKS IN ACCORDANCE WITH THE APPROVED CULTURAL HERITAGE MANAGEMENT PLAN (CHMP)

WARNING
 BEWARE OF UNDERGROUND SERVICES
 THE LOCATIONS OF UNDERGROUND SERVICES ARE APPROXIMATE ONLY AND THEIR EXACT POSITION SHOULD BE PROVEN ON SITE. NO GUARANTEE IS GIVEN THAT ALL EXISTING SERVICES ARE SHOWN.

DESIGN LIP OF KERB	1.34%		6.75m VC		0.85%		6.75m VC		0.5%			
HORIZ. GEOMETRY							R-8.6m HC					
DATUM RL 197.0												
DESIGN LIP OF KERB	198.80	198.84	198.87	198.88	198.84	198.80	198.86	198.88	198.89	198.90	198.91	198.92
DESIGN BACK OF KERB	198.84	198.89	198.92	198.93	198.89	198.84	198.87	198.91	198.92	198.93	198.88	198.82
EXISTING SURFACE	198.82	198.89	198.92	198.93	198.89	198.84	198.87	198.91	198.92	198.93	198.88	198.82
CHAINAGE	0.00	2.00	3.38	4.00	6.00	6.75	8.00	10.00	10.13	12.00	13.51	

RSK0806ER
 SCALE H 1 : 250 V 1 : 50

DESIGN LIP OF KERB	-0.5%		6.75m VC		-0.99%		6.75m VC		-0.5%			
HORIZ. GEOMETRY							R-8.6m HC					
DATUM RL 197.0												
DESIGN LIP OF KERB	198.92	198.95	198.90	198.89	198.89	198.87	198.85	198.84	198.84	198.82	198.81	
DESIGN BACK OF KERB	198.18	198.17	198.17	198.17	198.17	198.17	198.17	198.17	198.17	198.17	198.17	
EXISTING SURFACE	198.18	198.17	198.17	198.17	198.17	198.17	198.17	198.17	198.17	198.17	198.17	
CHAINAGE	0.00	2.00	3.38	4.00	6.00	6.75	8.00	10.00	10.13	12.00	13.51	

RSK0806EL
 SCALE H 1 : 250 V 1 : 50

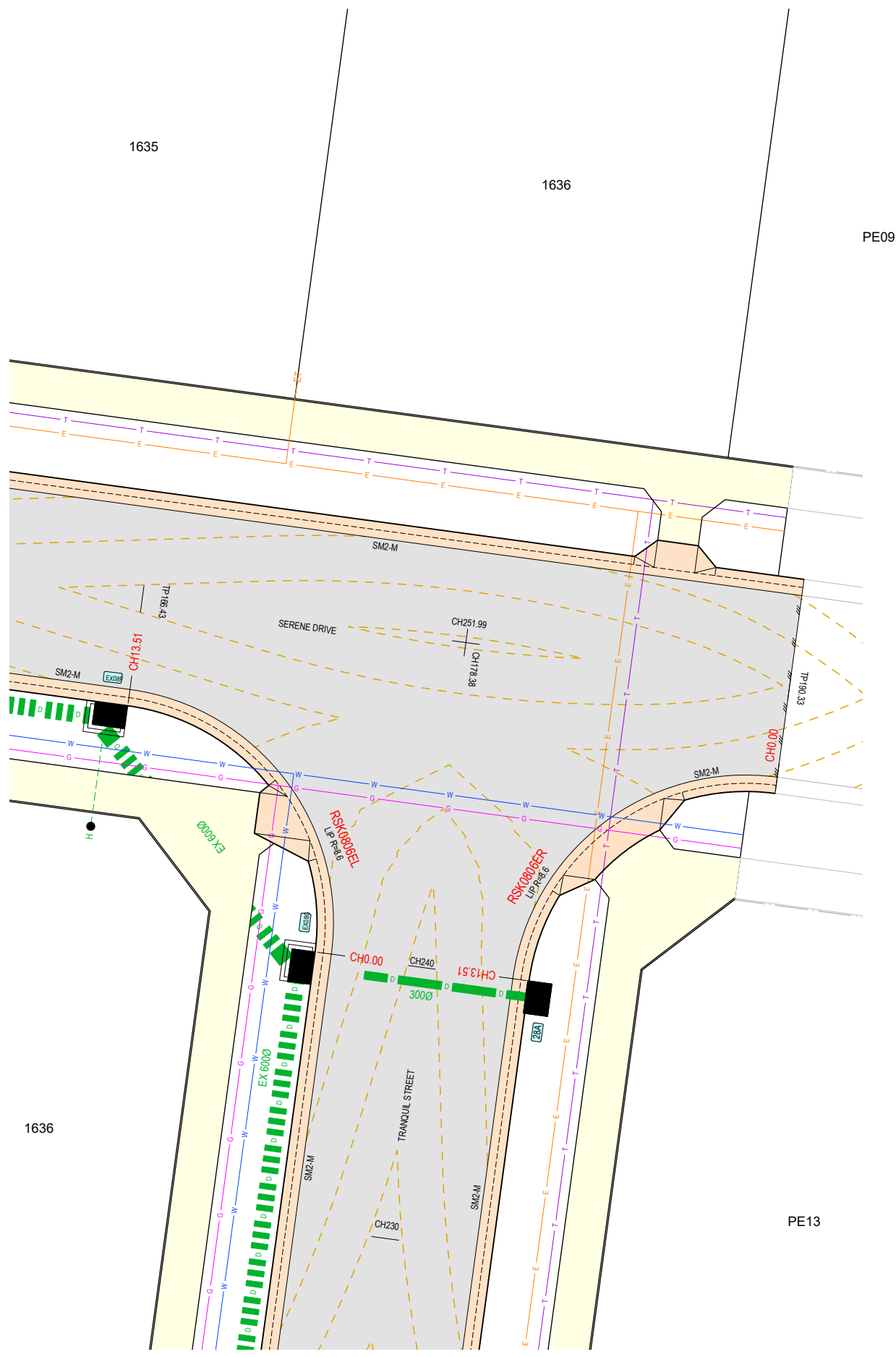

NOTE: THIS IS AN UNCONTROLLED DOCUMENT AND WILL NOT BE UPDATED. IT IS THE RESPONSIBILITY OF THE USER TO CONFIRM THAT THIS IS A CURRENT COPY AND SUITABLE FOR THE PROPOSED USE. THIS SHEET MUST BE READ IN CONJUNCTION WITH ALL SHEETS OF THIS SET AND ANY ACCOMPANYING DOCUMENTS. PLOT DATE: 15/12/2023 FILE: C:\12\DATA\TOMKINSON\STRATHFIELDSAYE_#188ENG00\CAD\CURRENT\14112_R07\DWG\PLANS REV ADWG

DRAFT



Tomkinson
 SURVEY • ENGINEERING • PLANNING • PROJECT MANAGEMENT
 HEAD OFFICE: 57 MYERS STREET BENDIGO PH 03 5445 8700
 ABN 11 103 336 358 WWW.TOMKINSON.COM

imagine
 STRATHFIELDSAYE

SCALE 1:200
 LENGTHS ARE IN METRES - PAPER SIZE A3

© COPYRIGHT THE INFORMATION CONTAINED ON THIS DRAWING IS THE INTELLECTUAL PROPERTY OF TOMKINSON GROUP. COPYING OR USING THIS DRAWING IN WHOLE OR IN PART WITHOUT THE EXPRESS WRITTEN PERMISSION OF TOMKINSON GROUP INFRINGES COPYRIGHT

BEFORE YOU DIG
 www.byda.com.au

COMPASS ASSURANCE
 ISO 9001 QUALITY

IMAGINE STAGE 16C
TRANQUIL STREET STRATHFIELDSAYE
 INTERSECTION DETAILS
 CITY OF GREATER BENDIGO REF: DS/459/2021
 STRATHFIELDSAYE HOLDINGS PTY LTD

DWG STATUS: **PRELIMINARY** PROJECT & DWG No: 14112R07 / 14 A

REV	AS SUBMITTED TO COUNCIL	BB	BB	07/07/23	
	REVISION	DES	CHK	AUTH	DATE

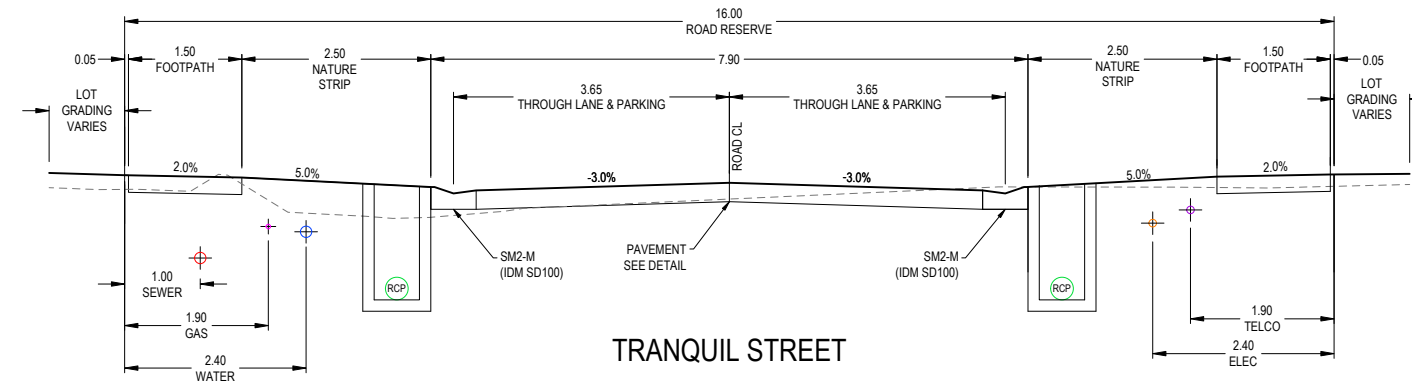
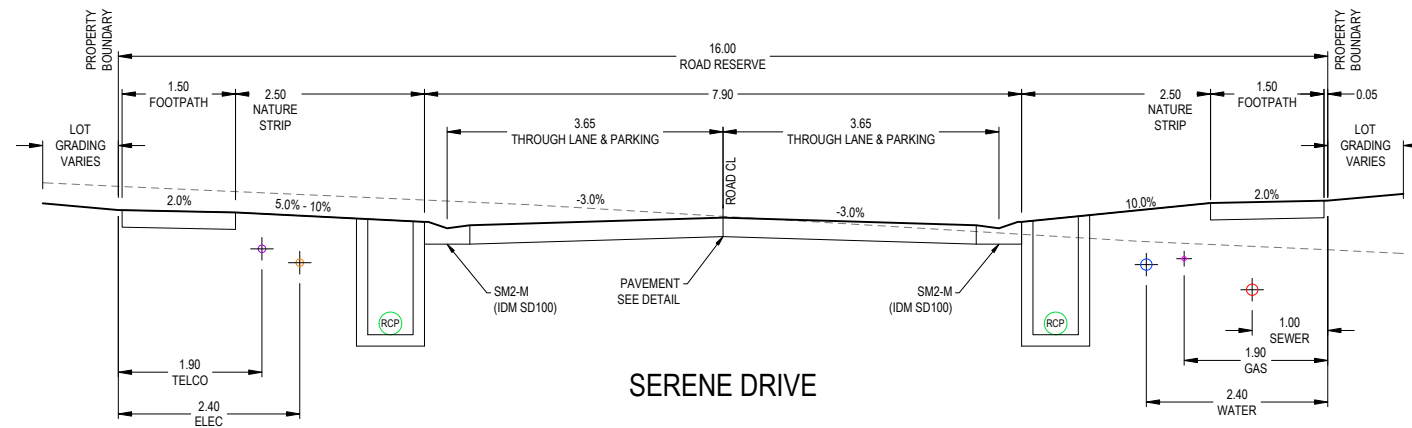

DRAFT

REV	DES	CHK	AUTH	DATE
A	AS	BB	BB	07/07/23

Tomkinson
 SURVEY > ENGINEERING > PLANNING > PROJECT MANAGEMENT
 HEAD OFFICE: 57 MYERS STREET BENDIGO PH 03 5445 8700
 ABN 11 103 336 358 WWW.TOMKINSON.COM

imagine 00
 STRATHFIELDSAYE

SCALE 1:100
 LENGTHS ARE IN METRES - PAPER SIZE A3

© COPYRIGHT THE INFORMATION CONTAINED ON THIS DRAWING IS THE INTELLECTUAL PROPERTY OF TOMKINSON GROUP. COPYING OR USING THIS DRAWING IN WHOLE OR IN PART WITHOUT THE EXPRESS WRITTEN PERMISSION OF TOMKINSON GROUP INFRINGES COPYRIGHT

BEFORE YOU DIG
 www.byda.com.au

COMPASS ASSURANCE
 ISO 9001 QUALITY

IMAGINE STAGE 16C
TRANQUIL STREET STRATHFIELDSAYE
 TYPICAL SECTIONS
 CITY OF GREATER BENDIGO REF: DS/459/2021
 STRATHFIELDSAYE HOLDINGS PTY LTD

DWG STATUS: **PRELIMINARY** PROJECT & DWG No: 14112R08 / 14 A

NOTE: THIS IS AN UNCONTROLLED DOCUMENT AND WILL NOT BE UPDATED. IT IS THE RESPONSIBILITY OF THE USER TO CONFIRM THAT THIS IS A CURRENT COPY AND SUITABLE FOR THE PROPOSED USE. THIS SHEET MUST BE READ IN CONJUNCTION WITH ALL SHEETS OF THIS SET AND ANY ACCOMPANYING DOCUMENTS. PLOT DATE: 15/12/2023 FILE: C:\12\DATA\TOMKINSON\STRATHFIELDSAYE_#188ENG00\CAD\CURRENT\14112 R-D\CD\IN PLANS REV ADWG

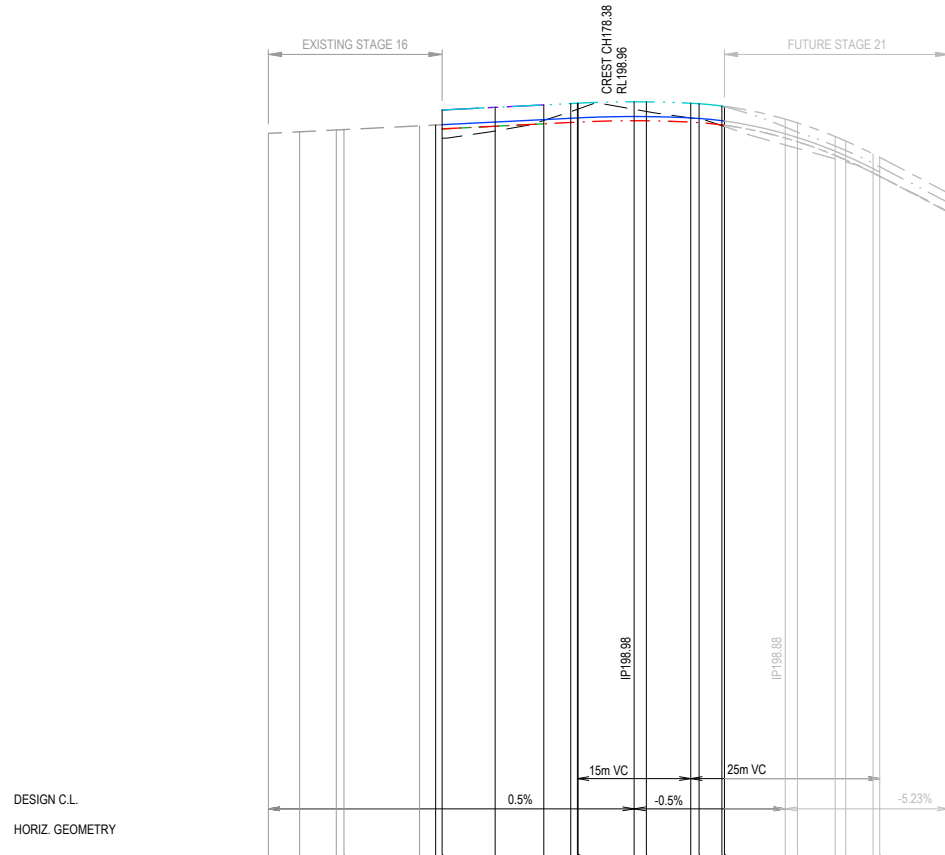

CHAINAGE	130.00	135.00	140.00	145.00	150.00	155.00	160.00	165.00	170.00	175.00	180.00	185.00	190.00	195.00	200.00	205.00	210.00	215.00	220.00
DESIGN C.L.	198.93	198.73	198.55	198.38	198.22	198.07	197.93	197.80	197.68	197.57	197.47	197.38	197.29	197.20	197.11	197.02	196.93	196.84	196.75
DESIGN LEFT INSIDE \ ROADSIDE OF PATH	198.93	198.73	198.55	198.38	198.22	198.07	197.93	197.80	197.68	197.57	197.47	197.38	197.29	197.20	197.11	197.02	196.93	196.84	196.75
DESIGN RIGHT INSIDE \ ROADSIDE OF PATH	198.93	198.73	198.55	198.38	198.22	198.07	197.93	197.80	197.68	197.57	197.47	197.38	197.29	197.20	197.11	197.02	196.93	196.84	196.75
DESIGN LEFT BACK OF KERB	198.93	198.73	198.55	198.38	198.22	198.07	197.93	197.80	197.68	197.57	197.47	197.38	197.29	197.20	197.11	197.02	196.93	196.84	196.75
DESIGN RIGHT BACK OF KERB	198.93	198.73	198.55	198.38	198.22	198.07	197.93	197.80	197.68	197.57	197.47	197.38	197.29	197.20	197.11	197.02	196.93	196.84	196.75
EXISTING SURFACE	198.68	198.48	198.28	198.08	197.88	197.68	197.48	197.28	197.08	196.88	196.68	196.48	196.28	196.08	195.88	195.68	195.48	195.28	195.08

SCALE H 1 : 1000 V 1 : 100

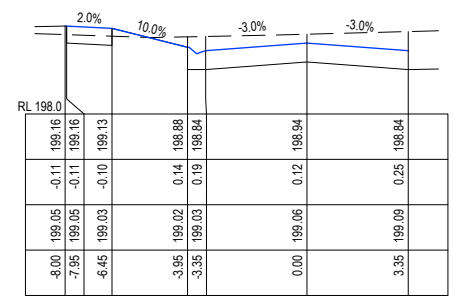

CH 170.98

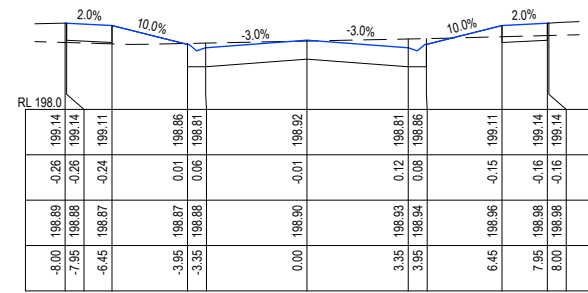

CH 166.43

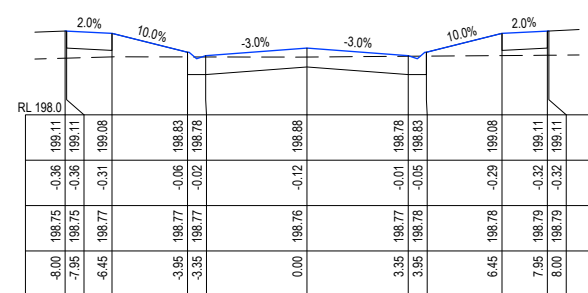

CH 160

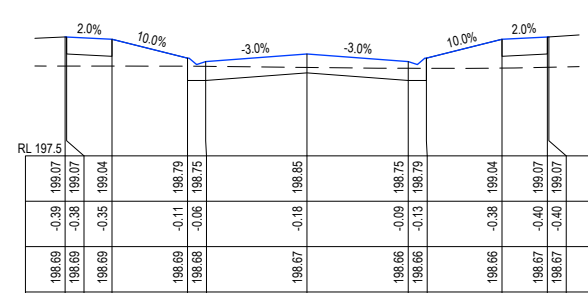

CH 152.98

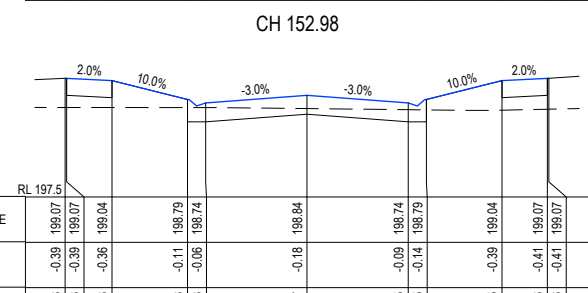

CH 152.13

SCALE H 1 : 250 V 1 : 100

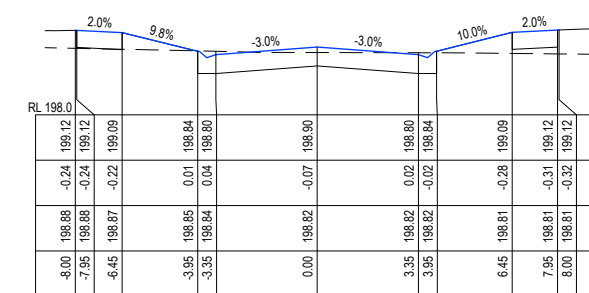

CH 190.33

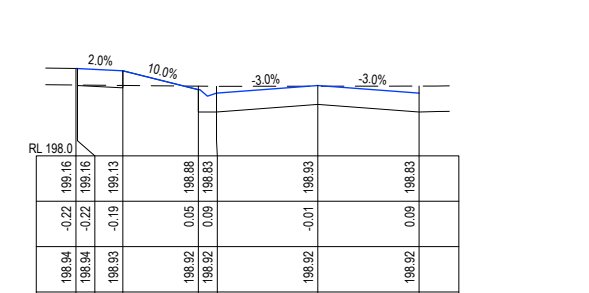

CH 186.98

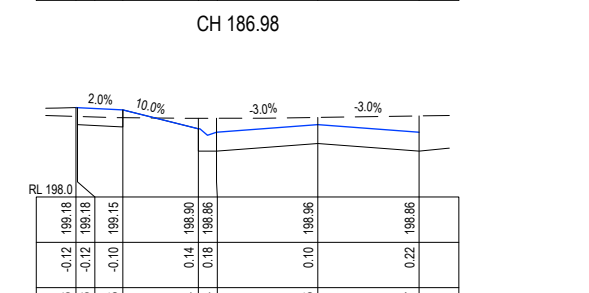

CH 178.38

DRAFT

REV	AS SUBMITTED TO COUNCIL	BB	BB	07/07/23		
REVISION		DES	DWG	CHK	AUTH	DATE

HEAD OFFICE: 57 MYERS STREET BENDIGO PH 03 5445 8700
ABN 11 103 336 358 WWW.TOMKINSON.COM

SCALE AS SHOWN
LENGTHS ARE IN METRES - PAPER SIZE A3

© COPYRIGHT THE INFORMATION CONTAINED ON THIS DRAWING IS THE INTELLECTUAL PROPERTY OF TOMKINSON GROUP. COPYING OR USING THIS DRAWING IN WHOLE OR IN PART WITHOUT THE EXPRESS WRITTEN PERMISSION OF TOMKINSON GROUP INFRINGES COPYRIGHT

IMAGINE STAGE 16C
TRANQUIL STREET STRATHFIELDSAYE
SERENE DRIVE LONG & CROSS SECTIONS
CITY OF GREATER BENDIGO REF: DS/459/2021
STRATHFIELDSAYE HOLDINGS PTY LTD

DWG STATUS: **PRELIMINARY**
PROJECT & DWG No: 14112R11 / 14 A

NOTE: THIS IS AN UNCONTROLLED DOCUMENT AND WILL NOT BE UPDATED. IT IS THE RESPONSIBILITY OF THE USER TO CONFIRM THAT THIS IS A CURRENT COPY AND SUITABLE FOR THE PROPOSED USE. THIS SHEET MUST BE READ IN CONJUNCTION WITH ALL SHEETS OF THIS SET AND ANY ACCOMPANYING DOCUMENTS. PLOT DATE: 15/12/2023 FILE: C:\TZDD\DATA\TOMK66C-TZDS0114112 - ENU CREEK HOLDINGS, STRATHFIELDSAYE_#188ENG00CADCURRENT\14112 R-D-CIN PLANS REV.ADWG

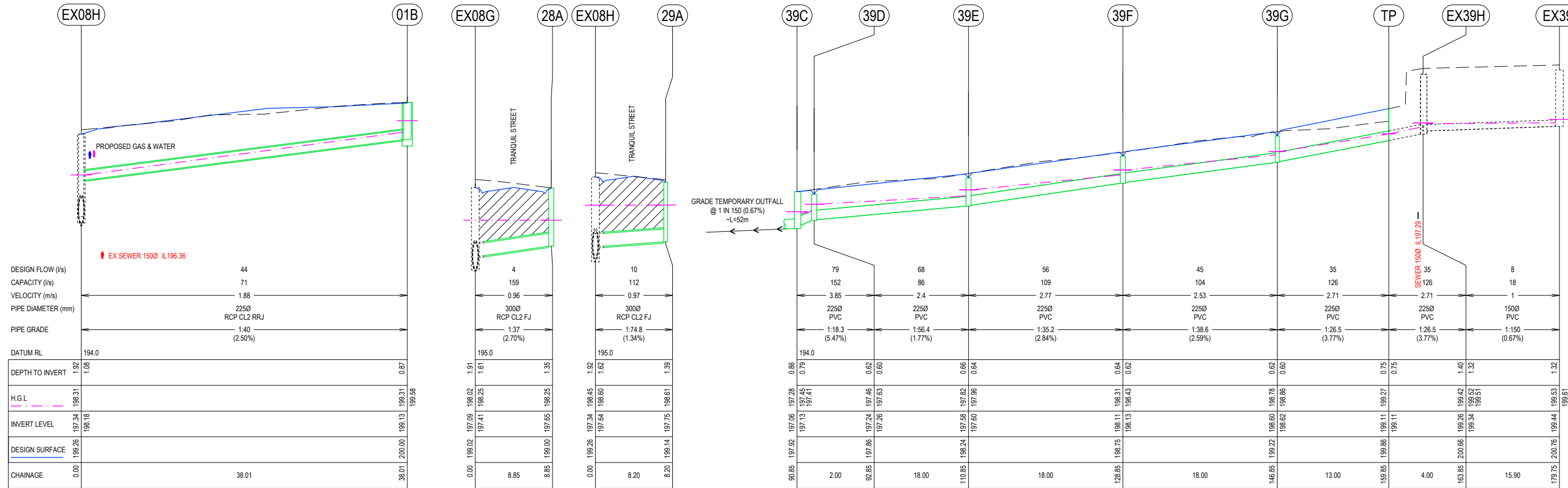

PIT NAME	TYPE	EASTING	NORTHING	INTERNAL		INLET DIA	INV LEV	OUTLET DIA	INV LEV	PIT SETOUT RL	DEPTH	REMARKS
				WD	LEN							
01B	JP	265776.54	5923852.61	600	600	612	197.130	300	199.07	200.00	0.935	IDM SD425 WITH GRATED INSERT
EX08G	JP	265817.78	5923873.54	900	1200	300	197.410	612	197.110	199.019	1.909	IDM SD420 (FUTURE CoGB SEP SD590BG)
EX08H	JP + GJP	265814.20	5923847.51	900	900	300	197.41	600	197.42	199.26	1.923	EX IDM SD480 BREAK INTO PIT & MAKE GOOD
28A	SEP	265826.54	5923872.35	450	900	300	197.77	300	197.77	199.00	1.35	IDM SD440
29A	GJP IN KERB	265822.33	5923846.41	450	900	300	197.75	300	197.75	199.14	1.39	IDM SD481
39C	JP	265873.98	5923837.22	600	900	225	197.14	300	197.06	197.92	0.86	IDM SD425
39D	GJP	265873.72	5923835.23	450	450	225	197.26	225	197.24	197.86	0.62	IDM SD425 WITH GRATED INSERT
39E	GJP	265871.30	5923817.40	450	450	225	197.60	225	197.58	198.24	0.66	IDM SD425 WITH GRATED INSERT

DRAFT

REV	REVISION	DES	DWG	CHK	AUTH	DATE
A	AS SUBMITTED TO COUNCIL	BB	BB			07/07/23

HEAD OFFICE: 57 MYERS STREET BENDIGO PH 03 5445 8700
ABN 11 103 336 358 WWW.TOMKINSON.COM

SCALE H 1:500 V 1:100

© COPYRIGHT THE INFORMATION CONTAINED ON THIS DRAWING IS THE INTELLECTUAL PROPERTY OF TOMKINSON GROUP. COPYING OR USING THIS DRAWING IN WHOLE OR IN PART WITHOUT THE EXPRESS WRITTEN PERMISSION OF TOMKINSON GROUP INFRINGES COPYRIGHT.

IMAGINE STAGE 16C
TRANQUIL STREET STRATHFIELDSAYE
DRAINAGE LONG SECTIONS & PIT SCHEDULE
CITY OF GREATER BENDIGO REF: DS/459/2021
STRATHFIELDSAYE HOLDINGS PTY LTD

DWG STATUS: **PRELIMINARY** PROJECT & DWG No: 14112R12 / 14 A

NOTE: THIS IS AN UNCONTROLLED DOCUMENT AND WILL NOT BE UPDATED. IT IS THE RESPONSIBILITY OF THE USER TO CONFIRM THAT THIS IS A CURRENT COPY AND SUITABLE FOR THE PROPOSED USE. THIS SHEET MUST BE READ IN CONJUNCTION WITH ALL SHEETS OF THIS SET AND ANY ACCOMPANYING DOCUMENTS. PLOT DATE: 15/12/2023 FILE: C:\12\DATA\TOMKINSON\14112R12\14112R12.DWG

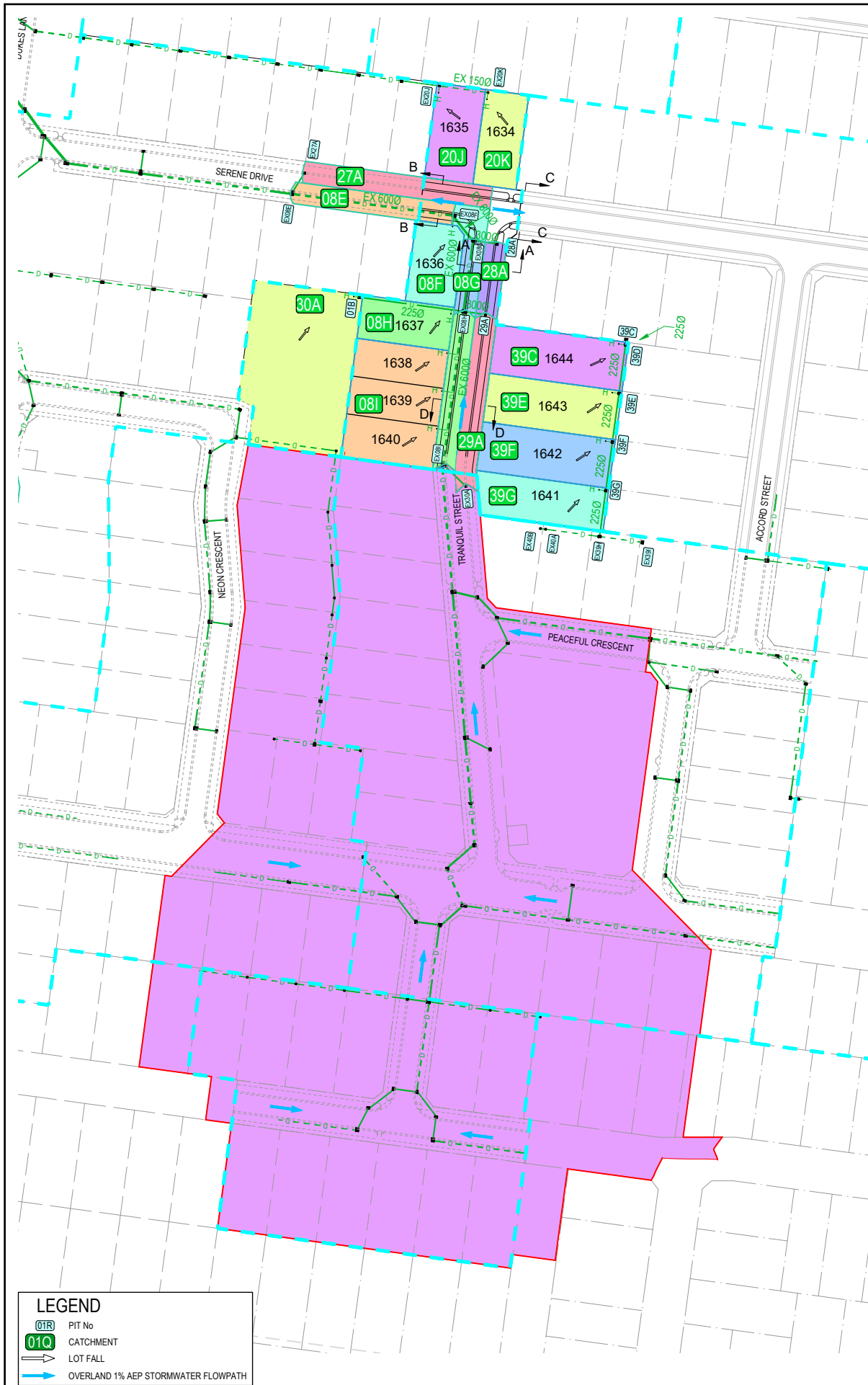

LEGEND

- DESIGN GAP FLOW
- MAX CAPACITY
- DESIGN FLOW (PIPE BLOCKED)

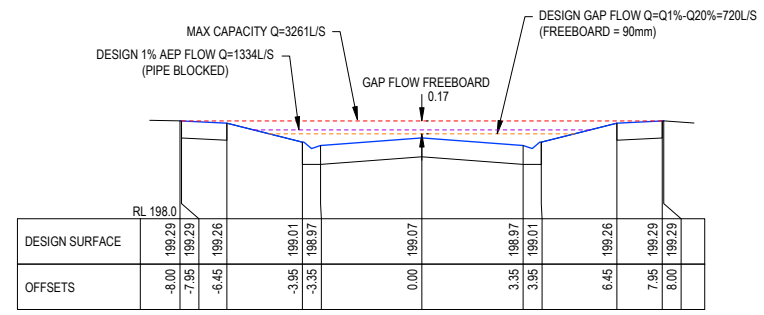

TRANQUIL STREET CH 230 A - A
SCALE H1:250 V1:100

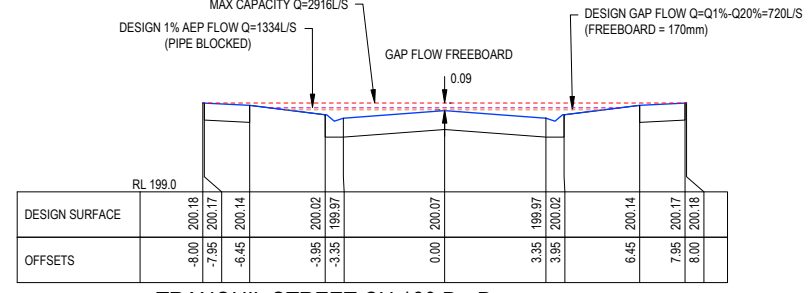

TRANQUIL STREET CH 180 D - D
SCALE H1:250 V1:100

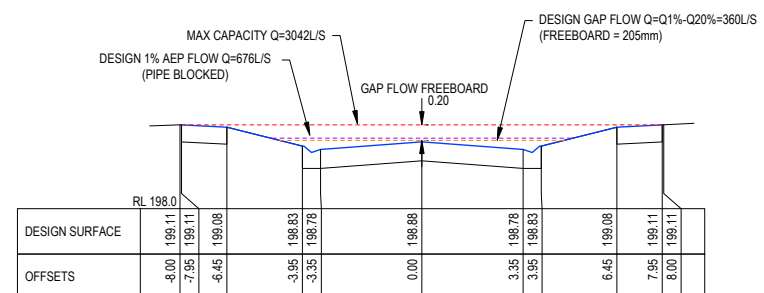

SERENE DRIVE CH 160 B - B
SCALE H1:250 V1:100

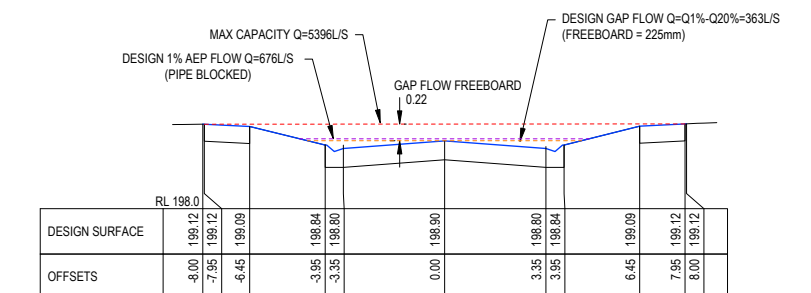

SERENE DRIVE CH 190.33 C - C
SCALE H1:250 V1:100

LEGEND

- PIT No
- CATCHMENT
- LOT FALL
- OVERLAND 1% AEP STORMWATER FLOWPATH

DRAFT



Tomkinson
SURVEY > ENGINEERING > PLANNING > PROJECT MANAGEMENT
HEAD OFFICE: 57 MYERS STREET BENDIGO PH 03 5445 8700
ABN 11 103 336 358 WWW.TOMKINSON.COM



SCALE 1:2,000
LENGTHS ARE IN METRES - PAPER SIZE A3

© COPYRIGHT THE INFORMATION CONTAINED ON THIS DRAWING IS THE INTELLECTUAL PROPERTY OF TOMKINSON GROUP. COPYING OR USING THIS DRAWING IN WHOLE OR IN PART WITHOUT THE EXPRESS WRITTEN PERMISSION OF TOMKINSON GROUP INFRINGES COPYRIGHT.

BEFORE YOU DIG
www.byda.com.au

COMPASS ASSURANCE ISO 9001 QUALITY

IMAGINE STAGE 16C
TRANQUIL STREET STRATHFIELDSAYE
DRAINAGE CATCHMENT PLAN
CITY OF GREATER BENDIGO REF: DS/459/2021
STRATHFIELDSAYE HOLDINGS PTY LTD
DWG STATUS: **PRELIMINARY**
PROJECT & DWG No: 14112R13 / 14 A

REV	AS SUBMITTED TO COUNCIL	DES	BB	CHK	BB	DATE	07/07/23
	REVISION						

NOTE: THIS IS AN UNCONTROLLED DOCUMENT AND WILL NOT BE UPDATED. IT IS THE RESPONSIBILITY OF THE USER TO CONFIRM THAT THIS IS A CURRENT COPY AND SUITABLE FOR THE PROPOSED USE. THIS SHEET MUST BE READ IN CONJUNCTION WITH ALL SHEETS OF THIS SET AND ANY ACCOMPANYING DOCUMENTS. PLOT DATE: 15/12/2023 FILE: C:\12\DATA\TOMKINSON\14112R13\14112R13.DWG

12D MODEL - HYDRAULIC DESIGN SHEET

Project: Design
 Drainage Model: DRN
 Rainfall File: Strath_2023_0619.12dhydro

Rainfall Method: IFD Table
 Freeboard Limit: 0.3 m
 Minor 20.00 AEP(%) Storm Event

Pipe ID	Pipe Type	Pipe Length (m)	Pipe Size (mm)	Full Pipe Area Af (sq.m)	Pipe Grade (%)	Pipe Grade (1 in)	Full-area Tct (min)	Full-area I (mm/hr)	Full-area Sum CA (ha)	Full-area Qc=CA (L/s)	Part-area Tct (min)	Part-area I (mm/hr)	Part-area Sum CA (ha)	Part-area Qc=CA (L/s)	Pipe Flow Q (L/s)	Capacity Flow Qcap (L/s)	Q/Qcap Ratio	Full Pipe Vel Vf=Q/Af (m/s)	Norm Depth Vel Vn=Q/A (m/s)	Crit Depth Vel Vc=Q/Ac (m/s)	Capacity Vel Vcap=Qcap/Af (m/s)	US Node Grate RL (m)	Pipe US IL (m)	Pipe DS IL (m)	DS Node Grate RL (m)	Cover Min (m)	Pipe DS Bend (deg)	Pipe DS Drop (m)	US Node Ku (-)	Pipe V'head (m)	P'head Loss (Ku.V'head) (m)	Pipe T'head Loss (m)	US Node HGL (m)	Pipe US HGL (m)	Pipe DS HGL (m)	DS Node HGL (m)	HGL Grade (%)	HGL Grade (1 in)	F'board US (m)
01B to EX08H	RCP CL2 RRJ	38.01	225	0.04	2.5	40.0	6.00	89.93	0.1744	43.6	6.00	89.93	0.1744	43.6	43.6	71.0	0.61	1.1	1.88	1.32	1.79	200.00	199.13	198.18	199.26	0.60	0.0		4.39	0.06	0.27	0.91	199.58	199.31	198.31	198.31	2.62	38.1	0.43
28A to EX08G	RCP CL2 FJ	8.85	300	0.071	2.70	37.0	6.00	90.22	0.0163	4.1	6.00	90.22	0.0163	4.1	4.1	159.1	0.03	0.06	0.96	0.57	2.25	199.00	197.65	197.41	199.02	0.91	-44.4	0.300	6.92	0.00	0.00	0.00	198.25	198.25	198.25	198.25	0.00	56398.9	0.75
29A to EX08H	RCP CL2 FJ	8.20	300	0.071	1.34	74.8	6.00	90.22	0.0381	9.6	6.00	90.22	0.0381	9.6	9.6	111.9	0.09	0.14	0.97	0.71	1.58	199.14	197.75	197.64	199.26	1.09	-90.1	0.300	4.10	0.00	0.00	0.00	198.61	198.61	198.60	198.60	0.01	10249.3	0.53
39C to 39B	RCP CL2 FJ	53.65	300	0.071	3.84	26.0	6.79	86.50	0.3280	78.8	6.61	87.35	0.3252	78.9	78.9	189.6	0.42	1.12	2.56	1.43	2.68	197.92	197.06	195.00	196.49	0.52	90.0	0.020	2.06	0.06	0.13	1.96	197.45	197.28	195.36	195.40	3.57	28.0	0.47
39D to 39C	PVC	2.00	225	0.040	5.47	18.3	6.77	86.57	0.3280	78.9	6.59	87.43	0.3252	79.0	79.0	151.7	0.52	1.99	3.85	2.02	3.82	197.86	197.24	197.13	197.92	0.48	-90.0	0.075	0.83	0.20	0.17	0.06	197.63	197.46	197.41	197.45	2.45	40.8	0.23
39E to 39D	PVC	18.00	225	0.040	1.77	56.4	6.62	87.28	0.2794	67.7	6.57	87.52	0.2789	67.8	67.8	86.4	0.78	1.71	2.40	1.77	2.17	198.24	197.58	197.26	197.86	0.48	0.0	0.020	0.94	0.15	0.14	0.20	197.96	197.82	197.63	197.63	1.09	91.6	0.28
39F to 39E	PVC	18.00	225	0.040	2.84	35.2	6.47	87.99	0.2308	56.4	6.42	88.22	0.2303	56.4	56.4	109.3	0.52	1.42	2.77	1.54	2.75	198.75	198.11	197.60	198.24	0.50	0.0	0.020	1.13	0.10	0.12	0.37	198.43	198.31	197.96	197.96	1.94	51.7	0.32
39G to 39F	PVC	18.00	225	0.040	2.59	38.6	6.32	88.69	0.1823	44.9	6.31	88.77	0.1822	44.9	44.9	104.4	0.43	1.13	2.53	1.34	2.63	199.22	198.60	198.13	198.75	0.49	0.0	0.020	1.20	0.07	0.08	0.38	198.86	198.78	198.43	198.43	1.95	51.2	0.36
TP to 39G	PVC	13.00	225	0.040	3.77	26.5	6.22	89.20	0.1406	34.8	6.20	89.28	0.1405	34.9	34.9	126.1	0.28	0.88	2.71	1.18	3.17	199.86	199.11	198.62	199.22	0.50	-0.0	0.020		0.04		0.44	199.27	199.27	198.86	198.86	3.17	31.6	0.59

12D MODEL - HYDROLOGICAL DESIGN SHEET

Project: Design
 Drainage Model: DRN
 Rainfall File: Strath_2023_0619.12dhydro

Tc Method: Direct
 Rainfall Method: IFD Table
 Runoff C Method: Direct
 Minor 20.00 AEP(%) Storm Event

Node Name	Node Type	Setout Easting (m)	Setout Northing (m)	Setout RL (m)	Catch ID	Time Tc (min)	Intensity I (mm/hr)	Runoff C	Area A (ha)	Full CA (ha)	Full Sum CA (ha)	Full Qc=CA (L/s)	Partial CA (ha)	Partial Sum CA (ha)	Partial Qc=CA (L/s)	Approach Flow Qa (L/s)
01B	IDM 900x600 JP SD420	265776.54	5923852.61	200.00	2P	6.00	89.93	0.75	0.2325	0.1744	0.1744	43.6	0.1744	0.1744	43.6	43.6
28A	IDM 900x450 SEP SD440	265826.54	5923872.35	199.00	5P	6.00	90.22	0.75	0.0217	0.0163	0.0163	4.1	0.0163	0.0163		4.1
29A	IDM 900x450 GJP SD481	265822.33	5923846.41	199.14	5P	6.00	90.22	0.75	0.0508	0.0381	0.0381	9.6	0.0381	0.0381		9.6
39C	IDM 900x600 JP SD425	265873.98	5923837.21	197.92												0.0
39D	IDM 600x600 GJP SD425	265873.72	5923835.23	197.96	3P	6.00	90.22	0.55	0.0883	0.0486	0.0486	12.2	0.0486	0.0486		12.2
39E	IDM 600x600 GJP SD425	265871.30	5923817.40	198.34	3P	6.00	90.22	0.55	0.0883	0.0486	0.0486	12.2	0.0486	0.0486		12.2
39F	IDM 600x600 GJP SD425	265868.88	5923799.56	198.85	3P	6.00	90.22	0.55	0.0883	0.0486	0.0486	12.2	0.0486	0.0486		12.2
39G	IDM 450x450 GJP SD425	265866.47	5923781.72	199.34	3P	6.00	90.22	0.55	0.0757	0.0416	0.0416	10.4	0.0416	0.0416		10.4
TP	TP	265864.72	5923768.84	199.86												0.0

DRAFT

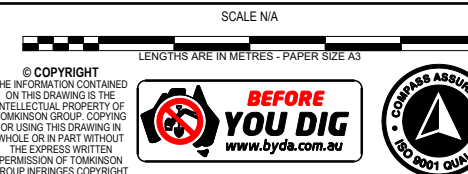

IMAGINE STAGE 16C
 TRANQUIL STREET STRATHFIELDSAYE
 DRAINAGE HYDRAULIC / HYDROLOGY CALC SHEET
 CITY OF GREATER BENDIGO REF: DS/459/2021
 STRATHFIELDSAYE HOLDINGS PTY LTD
 DWG STATUS: PRELIMINARY PROJECT & DWG No: 14112R14 / 14 A

AS SUBMITTED TO COUNCIL BB BB 07/07/23
 REV REVISION DES DWG CHK AUTH DATE

NOTE: THIS IS AN UNCONTROLLED DOCUMENT AND WILL NOT BE UPDATED. IT IS THE RESPONSIBILITY OF THE USER TO CONFIRM THAT THIS IS A CURRENT COPY AND SUITABLE FOR THE PROPOSED USE. THIS SHEET MUST BE READ IN CONJUNCTION WITH ALL SHEETS OF THIS SET AND ANY ACCOMPANYING DOCUMENTS. PLOT DATE: 15/12/2023 FILE: C:\TZDDATA\TOMKINSON\14112R14\14112R14.DWG