

'IMAGINE" ESTATE - STAGE 5

SEWER PLANS

STRATHFIELDSAYE EAST PRECINCT

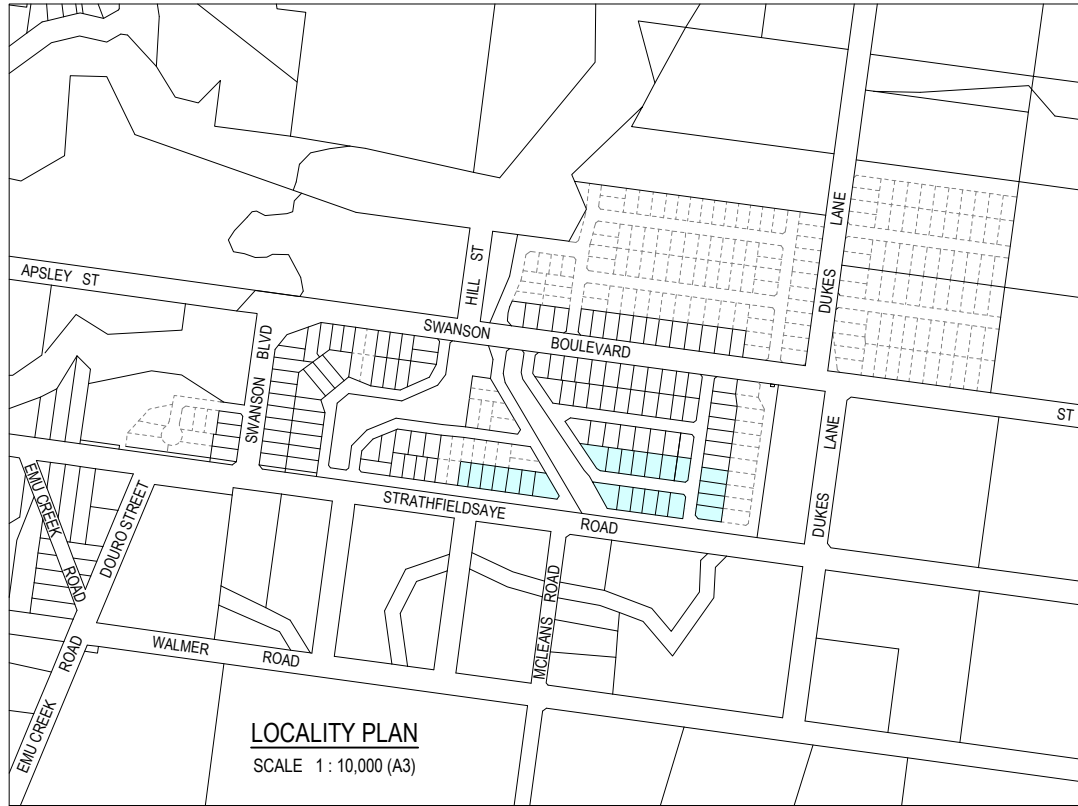

TABLE OF OFFSETS FOR SERVICES

STREET	GAS		WATER		ELECTRICITY		COMMS	
	OFFSET	SIDE	OFFSET	SIDE	U/G CABLE OFFSET*	SIDE	OFFSET	SIDE
COOMOORA CIRCUIT (ADJACENT TO RESERVE)	1.9m	WEST	2.3m	WEST	1.0m	EAST	0.5m	EAST
COOMOORA CIRCUIT (EAST-WEST)	2.9m	NORTH	3.4m	NORTH	2.3m	NORTH	1.9m	NORTH
McENIRY WAY	1.9m	SOUTH	2.3m	SOUTH	2.4m	NORTH	1.9m	NORTH
YIRRILIL WAY (ADJACENT TO RESERVE)	1.9m	EAST	2.3m	EAST	1.0m	WEST	0.5m	WEST
YIRRILIL WAY (EAST-WEST)	1.9m	SOUTH	2.3m	SOUTH	2.4m	NORTH	1.9m	NORTH
WALLAROO AVE (NORTH-SOUTH)	1.9m	EAST	2.3m	EAST	2.4m	WEST	1.9m	WEST
WALLAROO AVE (ADJ STRATHFIELDSAYE RD)	4.2m	NORTH	4.7m	NORTH	3.4m	NORTH	2.9m	NORTH

* ELECTRICITY OFFSET NOMINATED IS TO THE CABLE CLOSEST TO THE BUILDING LINE

GENERAL NOTES

GENERAL

- ALL LEVELS ARE IN METRES TO AUSTRALIAN HEIGHT DATUM (A.H.D)
- SEWER MAINS WILL BE INSTALLED IN ACCORDANCE WITH THE SEWERAGE CODE OF AUSTRALIA (WSA 02-2002-2.3, MELBOURNE RETAIL WATER AGENCIES EDITION, VERSION 1.0) AND ASSOCIATED COLIBAN WATER ADDENDUM.
- NUMBER OF LOTS SERVICED : 33
- LENGTH OF PIPELINE TO BE CONSTRUCTED
1500 PVC (CLASS SN8) = 615Lm
2250 PVC (CLASS SN8) = 108Lm
- NOTE TO CONTRACTOR - THE CONSULTING ENGINEER IS RESPONSIBLE FOR THE DESIGN AND MANAGEMENT OF THE CONSTRUCTION WORKS. ANY PROBLEMS ARISING DURING CONSTRUCTION SHALL BE DIRECTED TO THE CONSULTANT.
- NO TBM CAN BE USED WITHOUT FIRST PROVING IT CORRECT TO A SECOND TBM. TOMKINSON IS TO BE NOTIFIED OF ANY DISCREPANCIES IMMEDIATELY.
- NO HORIZONTAL SETOUT CONTROL CAN BE USED WITHOUT FIRST PROVING IT CORRECT TO A THIRD KNOWN POINT. TOMKINSON IS TO BE NOTIFIED OF ANY DISCREPANCIES IMMEDIATELY.

PIPELINE CONSTRUCTION

- PIPELINE CONSTRUCTION IS TO BE WITH THE FOLLOWING MATERIALS UNLESS OTHERWISE DETAILED ON THE DRAWINGS

PIPE TYPE: PVC
PIPE CLASS: SN8 (1500 & GREATER) - SN6 (1000)
AUSTRALIAN STANDARD: AS 1260

PIPE JOINTING

- PRECAST RUBBER RING OR MASTIC JOINTED ACCESS CHAMBER SYSTEMS ARE TO BE USED OR APPROVED PVC MANHOLES. PVC MANHOLES NOT TO BE USED.

PROPERTY BRANCH SEWERS

- ALL PROPERTIES ARE BOUNDARY TRAP OMITTED

ACCESS CHAMBERS

- ALL CHAMBERS SHALL BE 1000mm DIA UNLESS SHOWN OTHERWISE

CHAMBER COVERS

- ALL ACCESS CHAMBER COVERS SHALL BE CIRCULAR DUCTILE IRON SOLID DN600 COVERS THAT COMPLY WITH AS3996 AND WSA 104 UNLESS OTHERWISE SPECIFIED, WITH NOMINAL 600mm OPENING - CLASS 'D' IN ROAD RESERVES
- ALL CHAMBER COVERS SHALL BE LEVEL WITH AND SHALL CONFORM TO SLOPE AND CROSSFALL OF THE FINISHED SURFACE. THE FINISHED SURFACE LEVELS ARE TO BE CONFIRMED WITH THE SUPERINTENDENT AND ROAD CONTRACTOR PRIOR TO CONSTRUCTION.

OUTLET

- THESE BRANCHES DRAIN DIRECTLY TO EXISTING SEWERS.

EARTHWORKS

- IN AREAS SUBJECT TO EARTHWORKS, THE CONSTRUCTION OF SEWERS MUST NOT COMMENCE UNTIL THE EARTHWORKS HAVE BEEN COMPLETED OR THE SUPERINTENDENT GIVES WRITTEN NOTICE TO COMMENCE.

SERVICE CONNECTIONS

- ALL NEW SERVICE CONNECTIONS MUST BE IN ACCORDANCE WITH THE REQUIREMENTS OF COLIBAN WATER SPECIFICATIONS

REINSTATEMENT OF DISTURBED AREAS

- ON COMPLETION OF SEWER WORKS, THE CONTRACTOR MUST REINSTATE TO THE SATISFACTION OF THE SUPERINTENDENT AND TO THE RESPONSIBLE AUTHORITY ANY AREAS, STRUCTURES, PAVEMENTS OR SERVICES DAMAGED, DIRTIED OR MADE UNSERVICEABLE DUE TO CONSTRUCTION WORKS.

CONNECTION TO LIVE SEWER

- NO CONNECTION TO EXISTING AUTHORITY SERVICES WILL BE PERMITTED WITHOUT ATTENDANCE BY THE AUTHORITY PERSONNEL AND WITH COLIBAN WATER PERSONNEL BEING PROVIDED WITH A MINIMUM OF FIVE (5) DAYS PRIOR WRITTEN NOTIFICATION DUE TO CONSTRUCTION WORKS.

SERVICES

- THE CONTRACTOR MUST CONTACT DIAL BEFORE YOU DIG (CALL 1100), OR VISIT THE DIAL BEFORE YOU DIG WEBSITE PRIOR TO COMMENCING WORKS AND SATISFY THEMSELVES THAT THERE ARE NO SERVICES WITHIN THE VICINITY OF THE WORK AREA
- NO WORK IS TO COMMENCE BEFORE THE CONTRACTOR HAS ASCERTAINED WHAT UNDERGROUND SERVICES ARE PRESENT
- CONTRACTOR MUST FOLLOW THE 'NO GO ZONE' SAFETY PROCEDURES AT ALL TIMES, WHICH ARE AVAILABLE FROM ALL UTILITY AND TELECOMMUNICATIONS COMPANIES, INCLUDING THE OFFICE OF THE CHIEF ELECTRICAL INSPECTOR, THE OFFICE OF GAS SAFETY AND WORKSAFE VICTORIA
- IF THESE SAFETY PROCEDURES CANNOT BE COMPLIED WITH THEN NO WORK IS TO BE UNDERTAKEN WITHOUT PERMISSION FROM THE UTILITY COMPANY
- THE PROJECT AREA CONTAINS THE FOLLOWING SERVICES FOR ASSISTANCE IN EMERGENCY CONTACT.

SERVICES	AUTHORITY & CONTACT	TELEPHONE
DRAINAGE	CITY OF GREATER BENDIGO	5434 6000
ELECTRICITY	POWERCOR	132 412
GAS	SP AUSNET	136 707
COMMUNICATIONS	TELSTRA	132 203
SEWER & WATER	COLIBAN WATER	1300 363 200

DRAWING LIST

SEWER CONSTRUCTION PLANS

- 1065305S01 LOCALITY PLAN & GENERAL NOTES
- 1065305S02 SEWER DETAIL PLAN (SHEET 1 OF 2)
- 1065305S03 SEWER DETAIL PLAN (SHEET 2 OF 2)
- 1065305S04 SEWER LONG SECTIONS (SHEET 1 OF 5)
- 1065305S05 SEWER LONG SECTIONS (SHEET 2 OF 5)
- 1065305S06 SEWER LONG SECTIONS (SHEET 3 OF 5)
- 1065305S07 SEWER LONG SECTIONS (SHEET 4 OF 5)
- 1065305S08 SEWER LONG SECTIONS (SHEET 5 OF 5)

APPROVED FOR CONSTRUCTION

© COPYRIGHT - THE INFORMATION CONTAINED ON THIS DRAWING IS THE INTELLECTUAL PROPERTY OF TOMKINSON GROUP. COPYING OR USING THIS DRAWING IN WHOLE OR IN PART WITHOUT THE EXPRESS WRITTEN PERMISSION OF TOMKINSON GROUP INFRINGES COPYRIGHT

REV	DESCRIPTION	DES	DWG	CHK	DATE
F	LOT 122 NARROWED TO 16m & LOT 123 WIDENED TO 18m + ADDED NOTES ABOUT CLASS 'D' LIDS ON LONG SECS	NJB	NJB	NJB	03/06/15
E	SHT 1: ADJ 150 DIA QTY - SHT 3: FIX MH15E TO MH + FIX DIMS LOT 122 - SHT 6: MH39A-MH39B CHANGE TO FUTURE	NJB	NJB	NJB	22/05/15
D	MINOR AMENDS AT CLIENT REQUEST	NJB	NJB	NJB	07/04/15
C	REALIGNED SOME EXISTING LOTS AND ADDED LOTS 181-187 + ASSOC SEWER TO FINISH COOMOORA CIRCUIT	NJB	NJB	NJB	02/04/15
B	CONCEPTUAL ALTERNATIVE SEWER ALIGNMENT FOR LOTS 126-131	NJB	NJB	NJB	03/02/15
A	AS SUBMITTED TO COUNCIL	NJB	NJB	RK	03/06/14

tomkinson Group
 PROJECT MANAGERS DEVELOPMENT PLANNERS
 LICENSED SURVEYORS CIVIL ENGINEERS
 FREECALL: 1800 810 170 TEL: (03) 5445 8700 FAX: (03) 5441 3648
 PO BOX 421, BENDIGO 3552 57 MYERS STREET, BENDIGO 3550
 WEB: www.tomkinson.com EMAIL: bendigo@tomkinson.com

Principal STRATHFIELDSAYE HOLDINGS PTY LTD

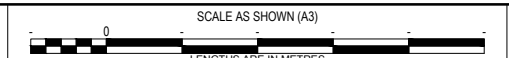

"IMAGINE ESTATE" - STAGE 5
 STRATHFIELDSAYE EAST PRECINCT
 LOCALITY PLAN & GENERAL NOTES

Municipality & Ref:
 COLIBAN WATER
 SME 15650
 SHT 1 of 8 REV F
 Drawing No.
 1065305S01

NOTE: THIS PLAN IS AN UNCONTROLLED DOCUMENT AND WILL NOT BE UPDATED. IT IS THE RESPONSIBILITY OF THE USER TO CONFIRM THAT THIS IS A CURRENT COPY AND SUITABLE FOR THE PROPOSED USE. THIS SHEET MUST BE READ IN CONJUNCTION WITH ALL SHEETS OF THIS SET AND ANY ACCOMPANYING DOCUMENTS. PLO DATE: 04/06/2015 FILE: P:\JOB DATA\10600710693\10693\STRATHFIELDSAYE HOLDINGS\STRATHFIELDSAYE\ENGINEERING\CIVIL\CURRENT DESIGN\1065305 SEWER CONSTRUCTION PLANS.DWG

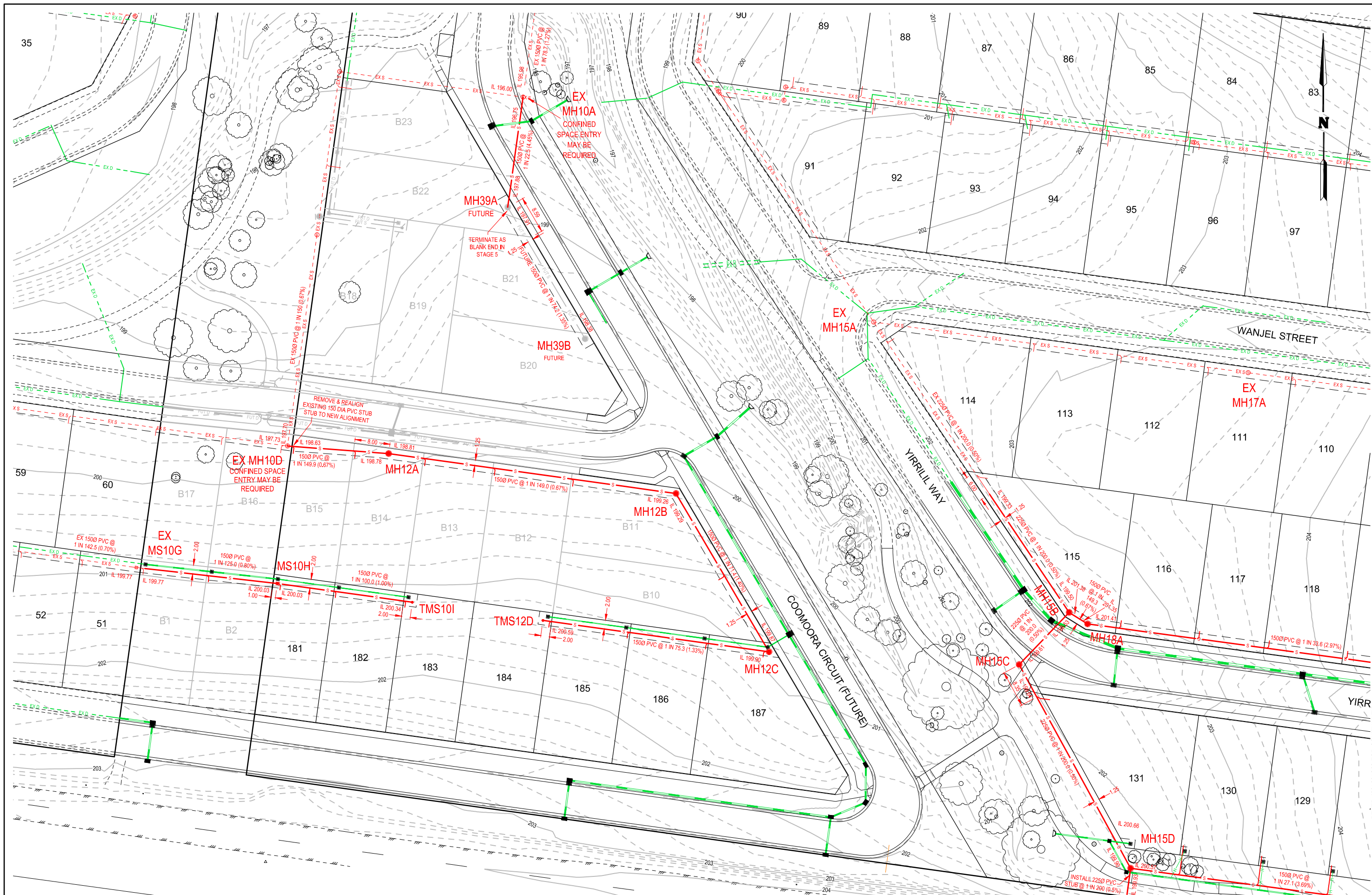

NOTE: THIS PLAN IS AN UNCONTROLLED DOCUMENT AND WILL NOT BE UPDATED. IT IS THE RESPONSIBILITY OF THE USER TO CONFIRM THAT THIS IS CURRENT COPY AND SUITABLE FOR THE PROPOSED USE. THIS SHEET MUST BE READ IN CONJUNCTION WITH ALL SHEETS OF THIS SET AND ANY ACCOMPANYING DOCUMENTS.
 PLO DATE: 04/06/20 15 FILE: P:\JOB DATA\10665305S03 - STRATHFIELDSAYE HOLDINGS - STRATHFIELDSAYE HOLDINGS - CIVIL ENGINEERING\CONSTRUCTION PLANS.DWG

APPROVED
 FOR
 CONSTRUCTION

REV	DESCRIPTION	DES	DWG	CHK	DATE
F	LOT 122 NARROWED TO 16m & LOT 123 WIDENED TO 18m + ADDED NOTES ABOUT CLASS 'D' LIDS ON LONG SECS	NJB	NJB	NJB	03/06/15
E	SHT 1: ADJ 150 DIA QTY - SHT 3: FIX MH15E TO MH + FIX DIMS LOT 122 - SHT 6: MH39A-MH39B CHANGE TO FUTURE	NJB	NJB	NJB	22/05/15
D	MINOR AMENDS AT CLIENT REQUEST	NJB	NJB	NJB	07/04/15
C	REALIGNED SOME EXISTING LOTS AND ADDED LOTS 181-187 + ASSOC SEWER TO FINISH COOMOORA CIRCUIT	NJB	NJB	NJB	02/04/15
B	CONCEPTUAL ALTERNATIVE SEWER ALIGNMENT FOR LOTS 126-131	NJB	NJB	NJB	03/02/15
A	AS SUBMITTED TO COUNCIL	NJB	NJB	RK	03/06/14

Tomkinson Group

PROJECT MANAGERS DEVELOPMENT PLANNERS ISO 9001:2008
 LICENSED SURVEYORS CIVIL ENGINEERS FS520488
 FREECALL: 1800 810 170 TEL: (03) 5445 8700 FAX: (03) 5441 3648
 PO BOX 421, BENDIGO 3552 57 MYERS STREET, BENDIGO 3550
 WEB: www.tomkinson.com EMAIL: bendigo@tomkinson.com

Principal STRATHFIELDSAYE HOLDINGS
PTY LTD

SCALE 1:800 (A3)

 LENGTHS ARE IN METRES

"IMAGINE ESTATE" - STAGE 5
 STRATHFIELDSAYE EAST PRECINCT
 SEWER DETAIL PLAN (SHEET 1 OF 2)

Municipality & Ref:
COLIBAN
WATER
SME 15650

SHT 2 of 8 REV F

Drawing No.
1065305S02

REFER 1065305S03 FOR CONTINUATION

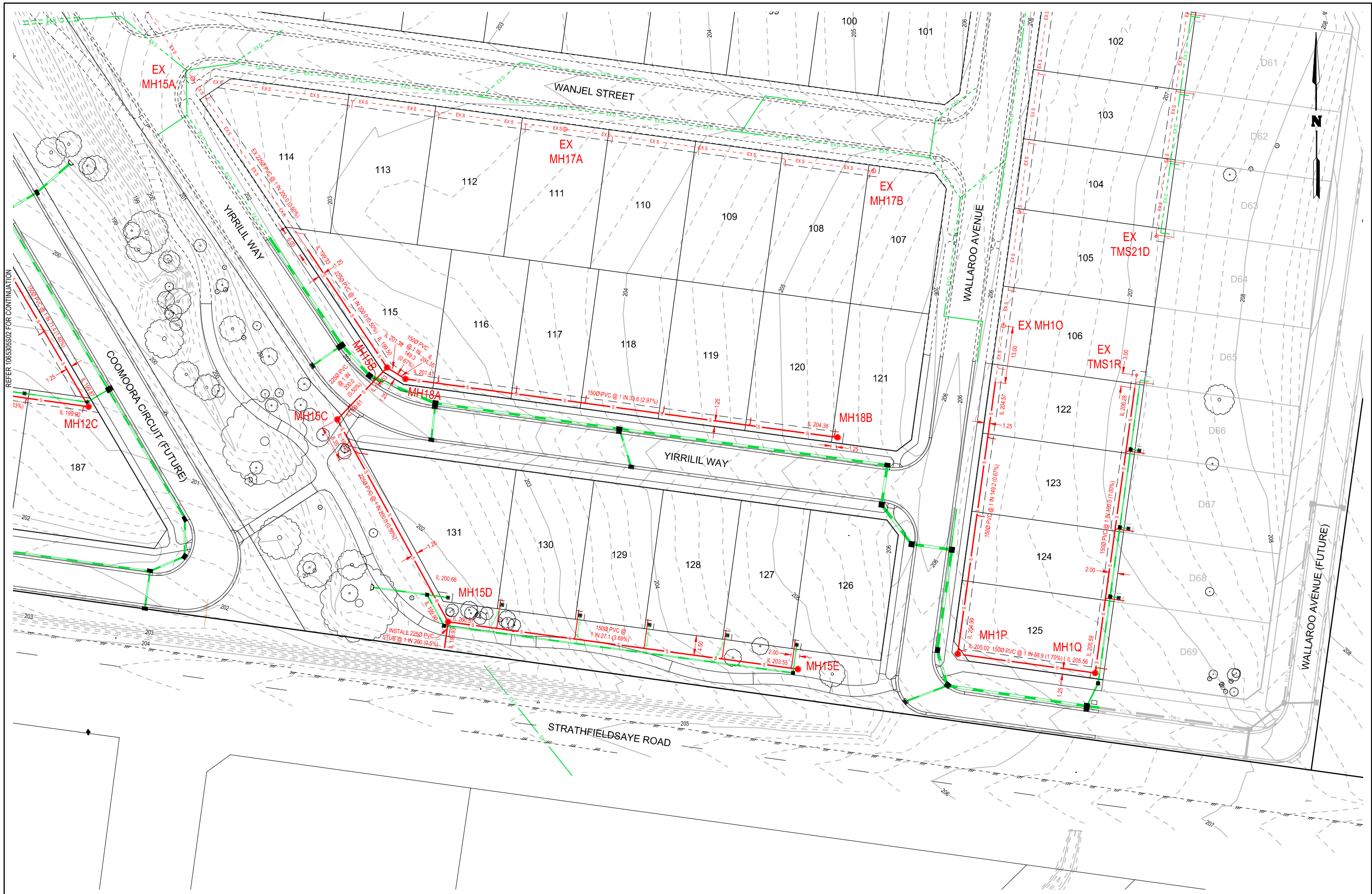

REFER 106530S02 FOR CONTINUATION

APPROVED FOR CONSTRUCTION

© COPYRIGHT. THE INFORMATION CONTAINED ON THIS DRAWING IS THE INTELLECTUAL PROPERTY OF TOMKINSON GROUP. COPYING OR USING THIS DRAWING IN WHOLE OR IN PART WITHOUT THE EXPRESS WRITTEN PERMISSION OF TOMKINSON GROUP INFRINGES COPYRIGHT

REV	DWG	CHK	DATE	REVISION
F	NJB	NJB	03/06/15	LOT 122 NARROWED TO 16m & LOT 123 WIDENED TO 18m + ADDED NOTES ABOUT CLASS 'D' LIDS ON LONG SECS
E	NJB	NJB	22/05/15	SHT 1: ADJ 150 DIA QTY - SHT 3: FIX MH15E TO MH + FIX DIMS LOT 122 - SHT 6: MH39A-MH39B CHANGE TO FUTURE
D	NJB	NJB	07/04/15	MINOR AMENDS AT CLIENT REQUEST
C	NJB	NJB	02/04/15	REALIGNED SOME EXISTING LOTS AND ADDED LOTS 181-187 + ASSOC SEWER TO FINISH COOMOORA CIRCUIT
B	NJB	NJB	03/02/15	CONCEPTUAL ALTERNATIVE SEWER ALIGNMENT FOR LOTS 126-131
A	NJB	RK	03/06/14	AS SUBMITTED TO COUNCIL

tomkinson Group
 PROJECT MANAGERS DEVELOPMENT PLANNERS
 LICENSED SURVEYORS CIVIL ENGINEERS
 FREECALL: 1800 810 170 TEL: (03) 5445 8700 FAX: (03) 5441 3648
 PO BOX 421, BENDIGO 3552 57 MYERS STREET, BENDIGO 3550
 WEB: www.tomkinson.com EMAIL: bendigo@tomkinson.com

Principal STRATHFIELDSAYE HOLDINGS
 PTY LTD

SCALE 1:800 (A3)
 8 0 8 16 24 32 40
 LENGTHS ARE IN METRES

"IMAGINE ESTATE" - STAGE 5
 STRATHFIELDSAYE EAST PRECINCT
 SEWER DETAIL PLAN (SHEET 2 OF 2)

Municipality & Ref:
 COLIBAN WATER
 SME 15650

SHT 3 of 8 REV F

Drawing No.
 106530S03

NOTE: THIS PLAN IS AN UNCONTROLLED DOCUMENT AND WILL NOT BE UPDATED. IT IS THE RESPONSIBILITY OF THE USER TO CONFIRM THAT THIS IS A CURRENT COPY AND SUITABLE FOR THE PROPOSED USE. THIS SHEET MUST BE READ IN CONJUNCTION WITH ALL SHEETS OF THIS SET AND ANY ACCOMPANYING DOCUMENTS. PLO DATE: 04/06/2015 FILE: P:\JOB DATA\106530S03 - STRATHFIELDSAYE HOLDINGS - STRATHFIELDSAYE HOLDINGS ENGINEERING\CIVIL\CURRENT DESIGN\106530S03 ENGINEERING CONSTRUCTION PLANS.DWG

EX MH10

MH1P

MH1Q

EXTMS1R

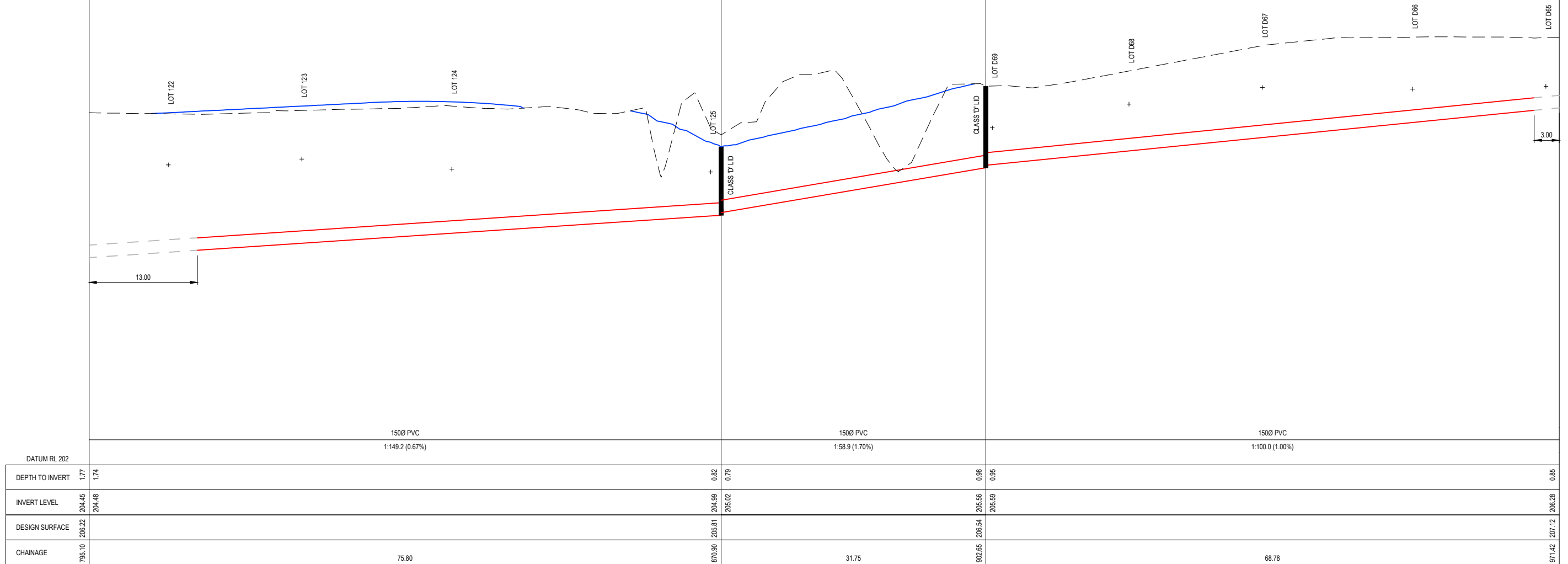

DATUM RL 202		1500 PVC 1:149.2 (0.67%)		1500 PVC 1:58.9 (1.70%)		1500 PVC 1:100.0 (1.00%)	
DEPTH TO INVERT	1.77 1.74	0.82 0.79	0.98 0.95	0.85			
INVERT LEVEL	204.45 204.48	204.99 205.02	205.56 205.59	206.28			
DESIGN SURFACE	206.22	205.81	206.54	207.12			
CHAINAGE	795.10	870.90	902.85	971.42			

APPROVED FOR CONSTRUCTION

© COPYRIGHT - THE INFORMATION CONTAINED ON THIS DRAWING IS THE INTELLECTUAL PROPERTY OF TOMKINSON GROUP. COPYING OR USING THIS DRAWING IN WHOLE OR IN PART WITHOUT THE EXPRESS WRITTEN PERMISSION OF TOMKINSON GROUP INFRINGES COPYRIGHT

REV	DESCRIPTION	DES	DWG	CHK	DATE
F	LOT 122 NARROWED TO 16m & LOT 123 WIDENED TO 18m + ADDED NOTES ABOUT CLASS 'D' LIDS ON LONG SECS	NJB	NJB	NJB	03/06/15
E	SHT 1: ADJ 150 DIA QTY - SHT 3: FIX MH15E TO MH + FIX DIMS LOT 122 - SHT 6: MH39A-MH39B CHANGE TO FUTURE	NJB	NJB	NJB	22/05/15
D	MINOR AMENDS AT CLIENT REQUEST	NJB	NJB	NJB	07/04/15
C	REALIGNED SOME EXISTING LOTS AND ADDED LOTS 181-187 + ASSOC SEWER TO FINISH COOMOORA CIRCUIT	NJB	NJB	NJB	02/04/15
B	CONCEPTUAL ALTERNATIVE SEWER ALIGNMENT FOR LOTS 126-131	NJB	NJB	NJB	03/02/15
A	AS SUBMITTED TO COUNCIL	NJB	NJB	RK	03/06/14

tomkinson Group

PROJECT MANAGERS DEVELOPMENT PLANNERS
 LICENSED SURVEYORS CIVIL ENGINEERS
 FREECALL: 1800 810 170 TEL: (03) 5445 8700 FAX: (03) 5441 3648
 PO BOX 421, BENDIGO 3552 57 MYERS STREET, BENDIGO 3550
 WEB: www.tomkinson.com EMAIL: bendigo@tomkinson.com

bsi ISO 9001:2008 FS520488

Principal STRATHFIELDSAYE HOLDINGS PTY LTD

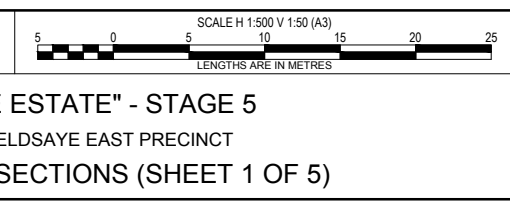

"IMAGINE ESTATE" - STAGE 5
 STRATHFIELDSAYE EAST PRECINCT
 SEWER LONG SECTIONS (SHEET 1 OF 5)

Municipality & Ref:
 COLIBAN WATER
 SME 15650

SHT 4 of 8 REV F

Drawing No.
 1065305S04

NOTE: THIS PLAN IS AN UNCONTROLLED DOCUMENT AND WILL NOT BE UPDATED. IT IS THE RESPONSIBILITY OF THE USER TO CONFIRM THAT THIS IS A CURRENT COPY AND SUITABLE FOR THE PROPOSED USE. THIS SHEET MUST BE READ IN CONJUNCTION WITH ALL SHEETS OF THIS SET AND ANY ACCOMPANYING DOCUMENTS. PLOD DATE: 04/06/2015 FILE: P:\JOB DATA\10600710653\STRATHFIELDSAYE HOLDINGS - STRATHFIELDSAYE ENGINEERING\CIVIL\CURRENT DESIGN\1065305 ENGINEERING CONSTRUCTION PLANS.DWG

MS10G

MS10H

TMS10

MH10D

MH12A

MH12B

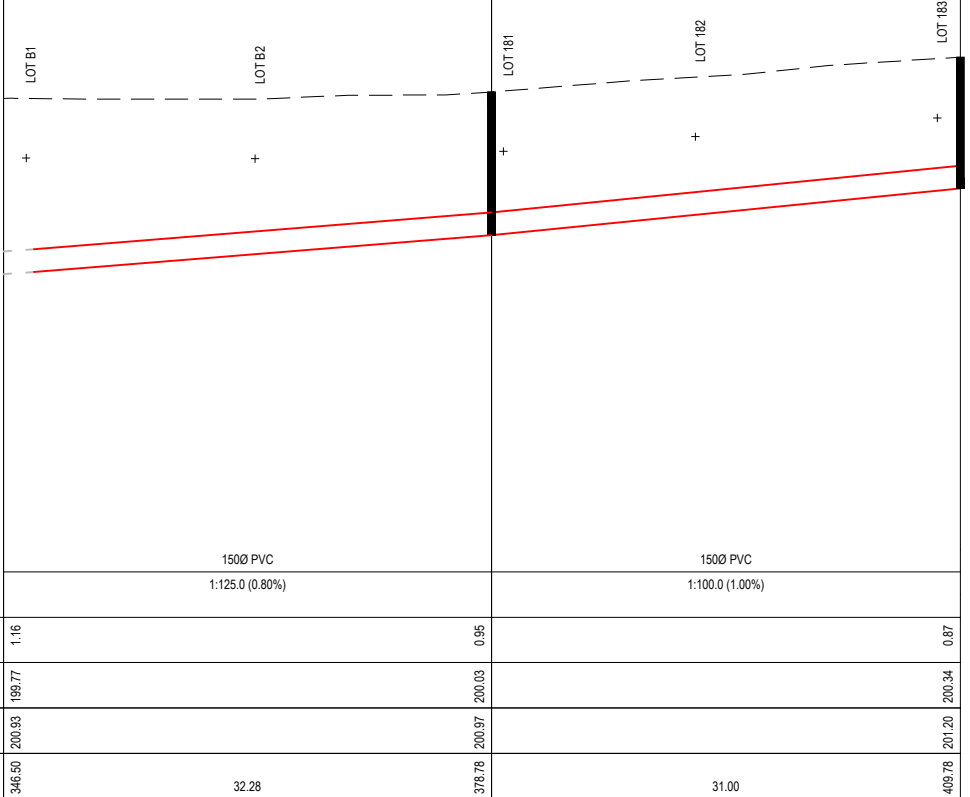

DATUM RL 197.5	
DEPTH TO INVERT	1.16
INVERT LEVEL	199.77
DESIGN SURFACE	200.93
CHAINAGE	346.50
	32.28
	378.78
	31.00
	409.78

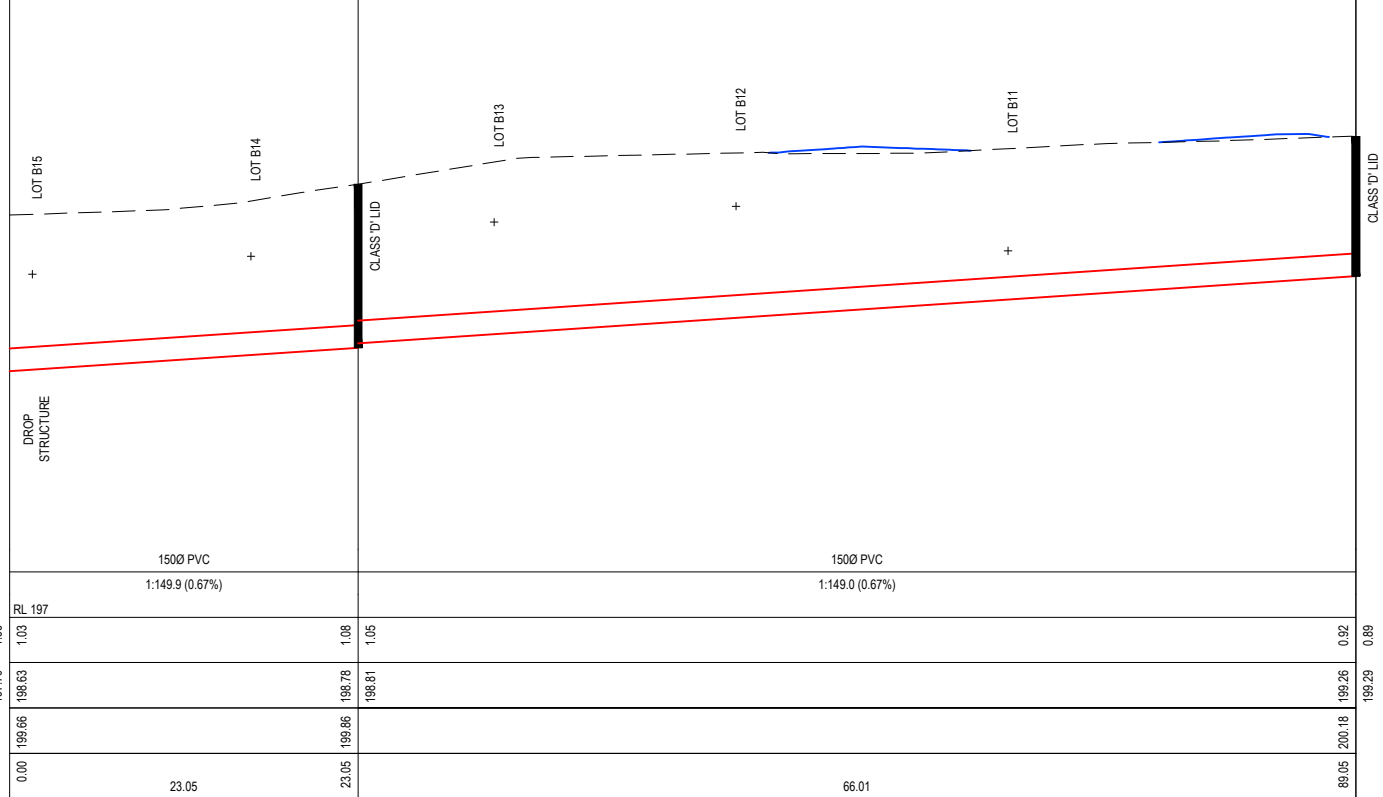

DATUM RL 197	
DEPTH TO INVERT	1.03
INVERT LEVEL	198.81
DESIGN SURFACE	199.86
CHAINAGE	23.05
	23.05
	66.01
	89.05

APPROVED FOR CONSTRUCTION

© COPYRIGHT - THE INFORMATION CONTAINED ON THIS DRAWING IS THE INTELLECTUAL PROPERTY OF TOMKINSON GROUP. COPYING OR USING THIS DRAWING IN WHOLE OR IN PART WITHOUT THE EXPRESS WRITTEN PERMISSION OF TOMKINSON GROUP INFRINGES COPYRIGHT

REV	DES	DWG	CHK	DATE	REVISION
F	NJB	NJB	NJB	03/06/15	LOT 122 NARROWED TO 16m & LOT 123 WIDENED TO 18m + ADDED NOTES ABOUT CLASS 'D' LIDS ON LONG SECS
E	NJB	NJB	NJB	22/05/15	SHT 1: ADJ 150 DIA QTY - SHT 3: FIX MH15E TO MH + FIX DIMS LOT 122 - SHT 6: MH39A-MH39B CHANGE TO FUTURE
D	NJB	NJB	NJB	07/04/15	MINOR AMENDS AT CLIENT REQUEST
C	NJB	NJB	NJB	02/04/15	REALIGNED SOME EXISTING LOTS AND ADDED LOTS 181-187 + ASSOC SEWER TO FINISH COOMOORA CIRCUIT
B	NJB	NJB	NJB	03/02/15	CONCEPTUAL ALTERNATIVE SEWER ALIGNMENT FOR LOTS 126-131
A	NJB	NJB	RK	03/06/14	AS SUBMITTED TO COUNCIL

tomkinson Group

PROJECT MANAGERS DEVELOPMENT PLANNERS
 LICENSED SURVEYORS CIVIL ENGINEERS
 FREECALL: 1800 810 170 TEL: (03) 5445 8700 FAX: (03) 5441 3648
 PO BOX 421, BENDIGO 3552 57 MYERS STREET, BENDIGO 3550
 WEB: www.tomkinson.com EMAIL: bendigo@tomkinson.com

bsi ISO 9001:2008 FS520488

Principal STRATHFIELDSAYE HOLDINGS PTY LTD

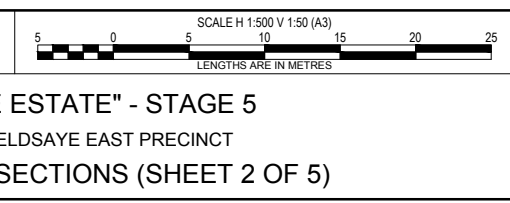

"IMAGINE ESTATE" - STAGE 5
 STRATHFIELDSAYE EAST PRECINCT
 SEWER LONG SECTIONS (SHEET 2 OF 5)

Municipality & Ref:
 COLIBAN WATER SME 15650
 SHT 5 of 8 REV F
 Drawing No. 1065305S05

NOTE: THIS PLAN IS AN UNCONTROLLED DOCUMENT AND WILL NOT BE UPDATED. IT IS THE RESPONSIBILITY OF THE USER TO CONFIRM THAT THIS IS A CURRENT COPY AND SUITABLE FOR THE PROPOSED USE. THIS SHEET MUST BE READ IN CONJUNCTION WITH ALL SHEETS OF THIS SET AND ANY ACCOMPANYING DOCUMENTS. PLO DATE: 04/06/2015 FILE: P:\JOB DATA\10600710695\10633 - STRATHFIELDSAYE HOLDINGS - STRATHFIELDSAYE HOLDINGS ENGINEERING\CIVIL\CURRENT DESIGN\1065305 ENGINEERING CONSTRUCTION PLANS.DWG

MH12B

MH12C

TMS12D

MH10A

MH39A

MH39B

NOTE:

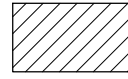

DENOTES 3% CEMENT STABILISED FULL DEPTH FCR BACKFILL REFER STANDARD NOTES

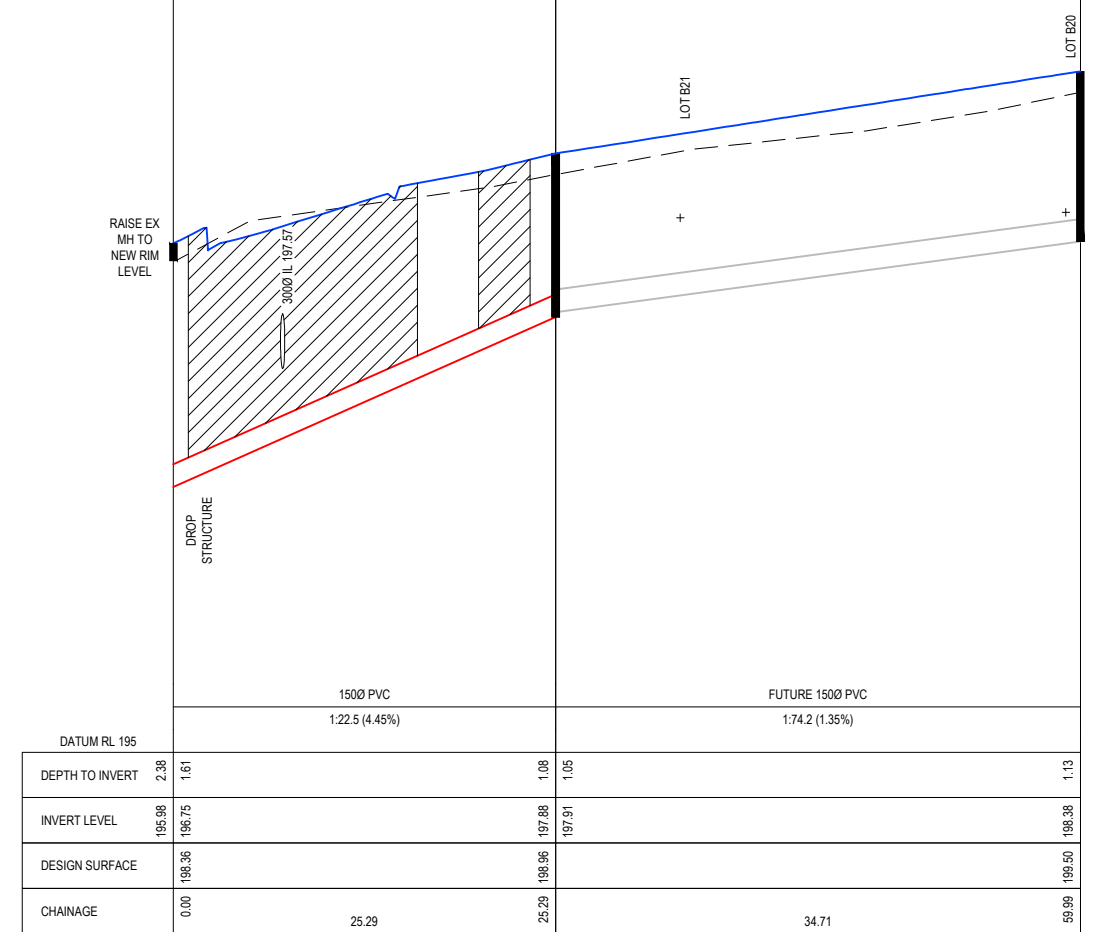
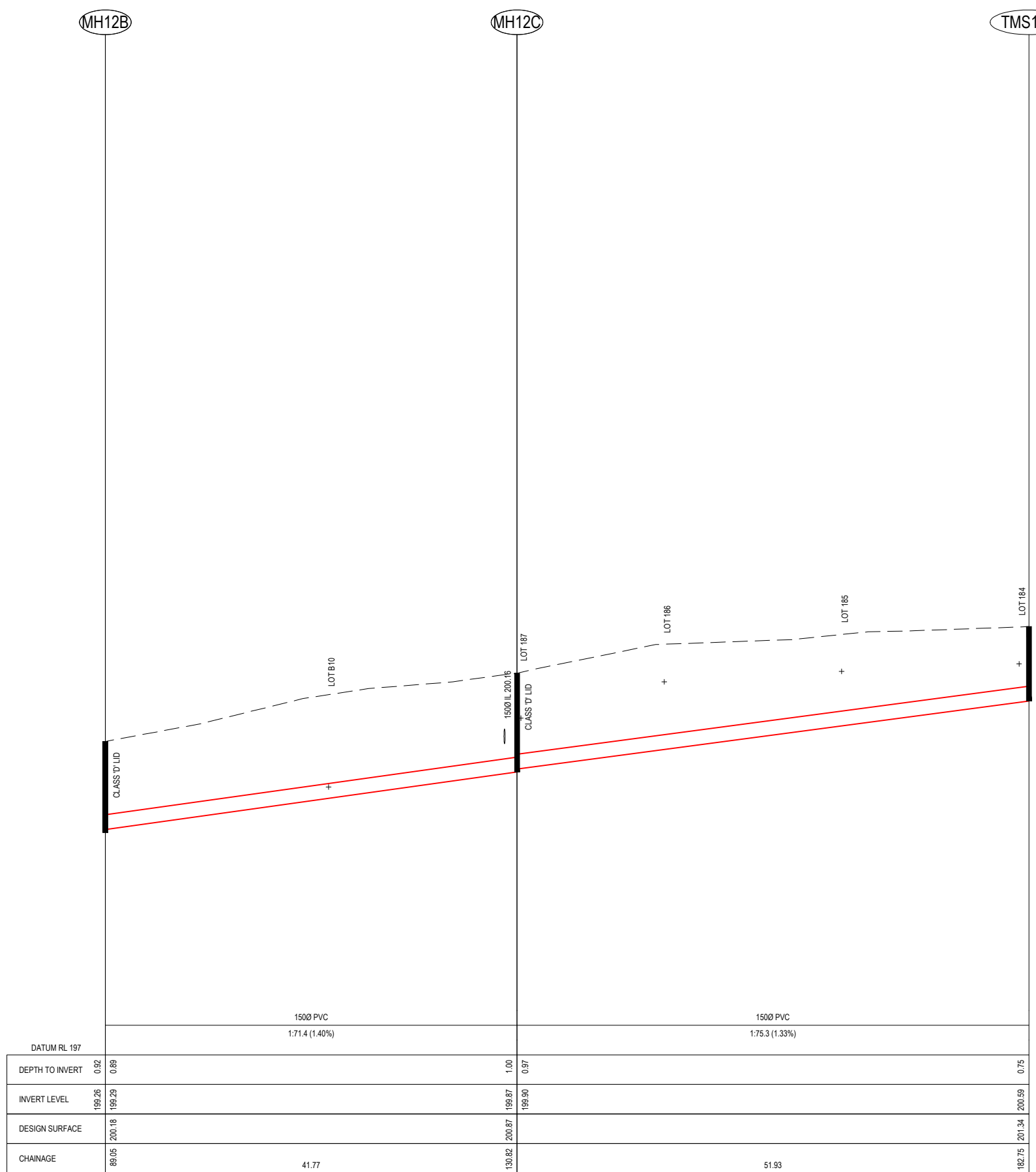

APPROVED FOR CONSTRUCTION

REV	DESCRIPTION	DES	DWG	CHK	DATE
F	LOT 122 NARROWED TO 16m & LOT 123 WIDENED TO 18m + ADDED NOTES ABOUT CLASS 'D' LIDS ON LONG SECS	NJB	NJB	NJB	03/06/15
E	SHT 1: ADJ 150 DIA QTY - SHT 3: FIX MH15E TO MH + FIX DIMS LOT 122 - SHT 6: MH39A-MH39B CHANGE TO FUTURE	NJB	NJB	NJB	22/05/15
D	MINOR AMENDS AT CLIENT REQUEST	NJB	NJB	NJB	07/04/15
C	REALIGNED SOME EXISTING LOTS AND ADDED LOTS 181-187 + ASSOC SEWER TO FINISH COOMOORA CIRCUIT	NJB	NJB	NJB	02/04/15
B	CONCEPTUAL ALTERNATIVE SEWER ALIGNMENT FOR LOTS 126-131	NJB	NJB	NJB	03/02/15
A	AS SUBMITTED TO COUNCIL	NJB	NJB	RK	03/06/14

tomkinson Group
 PROJECT MANAGERS DEVELOPMENT PLANNERS
 LICENSED SURVEYORS CIVIL ENGINEERS
 FREECALL: 1800 810 170 TEL: (03) 5445 8700 FAX: (03) 5441 3648
 PO BOX 421, BENDIGO 3552 57 MYERS STREET, BENDIGO 3550
 WEB: www.tomkinson.com EMAIL: bendigo@tomkinson.com

Principal STRATHFIELDSAYE HOLDINGS PTY LTD

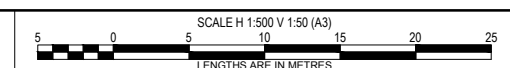

"IMAGINE ESTATE" - STAGE 5
STRATHFIELDSAYE EAST PRECINCT
SEWER LONG SECTIONS (SHEET 3 OF 5)

Municipality & Ref: COLIBAN WATER SME 15650
SHT 6 of 8 REV F
Drawing No. 1065305S06

NOTE: THIS PLAN IS AN UNCONTROLLED DOCUMENT AND WILL NOT BE UPDATED. IT IS THE RESPONSIBILITY OF THE USER TO CONFIRM THAT THIS IS A CURRENT COPY AND SUITABLE FOR THE PROPOSED USE. THIS SHEET MUST BE READ IN CONJUNCTION WITH ALL SHEETS OF THIS SET AND ANY ACCOMPANYING DOCUMENTS. PLO DATE: 04/06/2015 FILE: P:\JOB DATA\1060071065305 STRATHFIELDSAYE HOLDINGS - STRATHFIELDSAYE CIVIL\CURRENT DESIGN\1065305 ENGINEERING CONSTRUCTION PLANS.DWG

BLANK END FROM MH15A

MH15B

MH15C

MH15D

MH15E

NOTE:

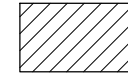

DENOTES 3% CEMENT STABILISED FULL DEPTH FCR BACKFILL REFER STANDARD NOTES

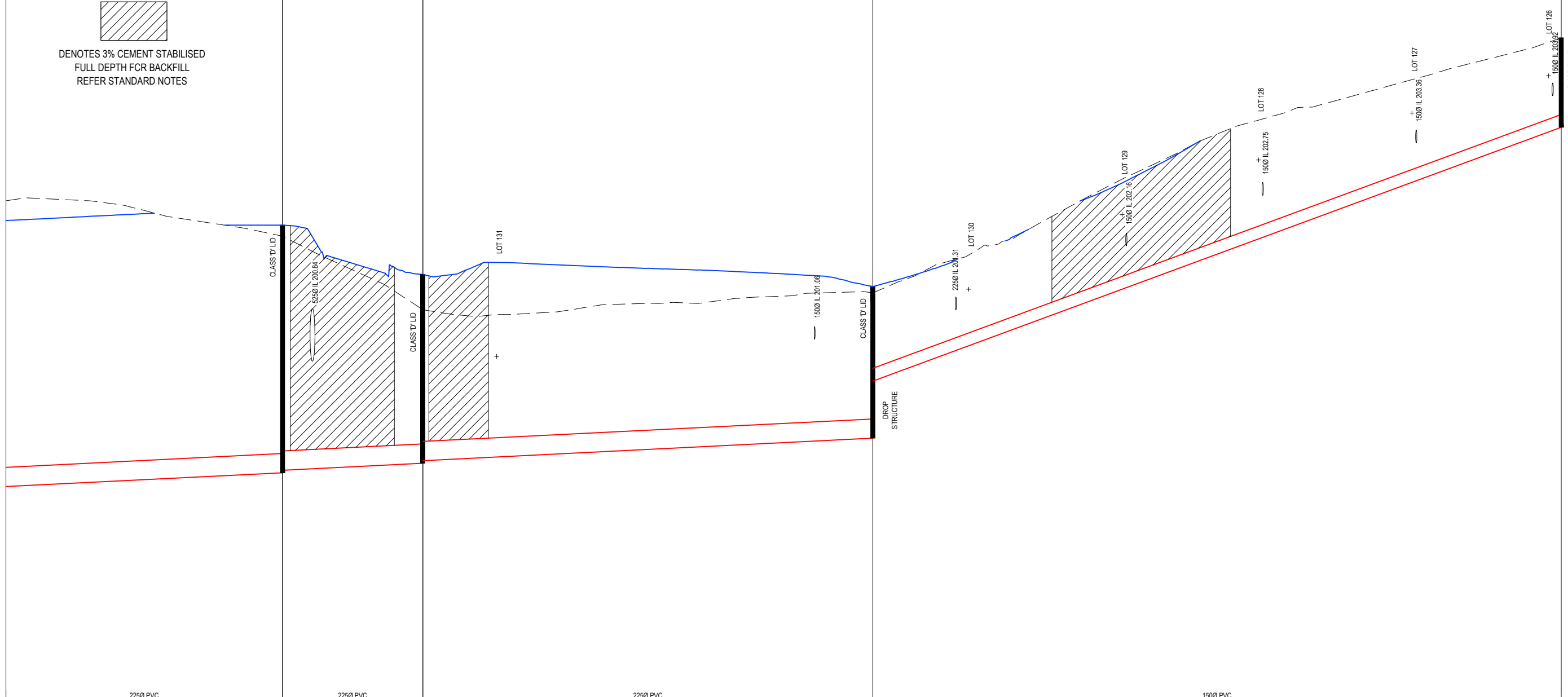

DATUM RL 196.5	2250 PVC 1:200.0 (0.50%)	2250 PVC 1:200.0 (0.50%)	2250 PVC 1:200.0 (0.50%)	1500 PVC 1:27.1 (3.69%)
DEPTH TO INVERT	3.12	2.90	2.21	1.05
INVERT LEVEL	199.33	199.50	199.64	200.57
DESIGN SURFACE	202.45	202.40	201.62	204.60
CHAINAGE	110.40	142.85	159.30	212.08

APPROVED FOR CONSTRUCTION

REV	DESCRIPTION	DES	DWG	CHK	DATE
F	LOT 122 NARROWED TO 16m & LOT 123 WIDENED TO 18m + ADDED NOTES ABOUT CLASS 'D' LIDS ON LONG SECS	NJB	NJB	NJB	03/06/15
E	SHT 1: ADJ 150 DIA QTY - SHT 3: FIX MH15E TO MH + FIX DIMS LOT 122 - SHT 6: MH39A-MH39B CHANGE TO FUTURE	NJB	NJB	NJB	22/05/15
D	MINOR AMENDS AT CLIENT REQUEST	NJB	NJB	NJB	07/04/15
C	REALIGNED SOME EXISTING LOTS AND ADDED LOTS 181-187 + ASSOC SEWER TO FINISH COOMOORA CIRCUIT	NJB	NJB	NJB	02/04/15
B	CONCEPTUAL ALTERNATIVE SEWER ALIGNMENT FOR LOTS 126-131	NJB	NJB	NJB	03/02/15
A	AS SUBMITTED TO COUNCIL	NJB	NJB	RK	03/06/14

tomkinson Group
 PROJECT MANAGERS DEVELOPMENT PLANNERS
 LICENSED SURVEYORS CIVIL ENGINEERS
 FREECALL: 1800 810 170 TEL: (03) 5445 8700 FAX: (03) 5441 3648
 PO BOX 421, BENDIGO 3552 57 MYERS STREET, BENDIGO 3550
 WEB: www.tomkinson.com EMAIL: bendigo@tomkinson.com

Principal STRATHFIELDSAYE HOLDINGS PTY LTD

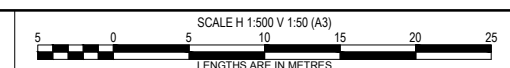

"IMAGINE ESTATE" - STAGE 5
 STRATHFIELDSAYE EAST PRECINCT
 SEWER LONG SECTIONS (SHEET 4 OF 5)

Municipality & Ref:
 COLIBAN WATER
 SME 15650
 SHT 7 of 8 REV F
 Drawing No.
 1065305S07

NOTE: THIS PLAN IS AN UNCONTROLLED DOCUMENT AND WILL NOT BE UPDATED. IT IS THE RESPONSIBILITY OF THE USER TO CONFIRM THAT THIS IS A CURRENT COPY AND SUITABLE FOR THE PROPOSED USE. THIS SHEET MUST BE READ IN CONJUNCTION WITH ALL SHEETS OF THIS SET AND ANY ACCOMPANYING DOCUMENTS. PLO DATE: 04/06/2015 FILE: P:\JOB DATA\1060071065305\ENGINEERING\CIVIL\CURRENT DESIGN\1065305 ENGINEERING CONSTRUCTION PLANS.DWG