

PLAN OF SUBDIVISION

EDITION

PS 845657F

LOCATION OF LAND

PARISH: PYWHEITJORRK

TOWNSHIP: -

SECTION: 17

CROWN ALLOTMENT: -

CROWN PORTION: 1 (PART)

TITLE REFERENCE: VOL 12427 FOL 279

LAST PLAN REFERENCE: LOT B ON PS840613E

POSTAL ADDRESS: 414 GREIGS ROAD
(at time of subdivision) ROCKBANK 3335

MGA 2020 CO-ORDINATES: E 293 400 ZONE: 55
(approx. centre of land in plan) N 5 820 050

VESTING OF ROADS AND/OR RESERVES

NOTATIONS

IDENTIFIER

COUNCIL/BODY/PERSON

ROAD R1
RESERVE No.1

MELTON CITY COUNCIL
POWERCOR AUSTRALIA LTD

STAGING

THIS IS / IS NOT A STAGED SUBDIVISION
PLANNING PERMIT NO. PA2018/6307/2

SURVEY

THIS PLAN IS / ~~IS NOT~~ BASED ON SURVEY
THIS SURVEY HAS BEEN CONNECTED TO PERMANENT MARKS NO(S) PM9 (Pywheitjorrk),
IN PROCLAIMED SURVEY AREA NO. - PM 9 and 54 (Kororoit)

DEPTH LIMITATION

DOES NOT APPLY

LOTS 1 TO 7, 12 TO 22, 28, 35 TO 45, 53 TO 57, 67 TO 121, 125 TO 145 (ALL INCLUSIVE),
151, 152 AND LOTS A & B HAVE BEEN OMITTED FROM THIS PLAN.

LAND SUBDIVIDED (EXCLUDING LOT C) - 2.516ha

EASEMENTS E-1, E-2 AND E-4 HAVE BEEN OMITTED FROM THIS PLAN.

OTHER PURPOSE OF PLAN

TO REMOVE THAT PART OF DRAINAGE AND SEWERAGE EASEMENT E-6
ON PS840613E NOW CONTAINED IN PAPYRUS WAY ON THIS PLAN.

GROUND FOR REMOVAL OF EASEMENT

BY AGREEMENT OF ALL INTERESTED PARTIES PURSUANT TO
SECTION 6(1)(k)(iv) OF THE SUBDIVISION ACT 1988.

EASEMENT INFORMATION

LEGEND: E - ENCUMBERING EASEMENT, CONDITION IN CROWN GRANT IN THE NATURE OF AN EASEMENT OR OTHER ENCUMBRANCE A - APPURTENANT EASEMENT

SUBJECT LAND	PURPOSE	WIDTH (metres)	ORIGIN	LAND BENEFITED/IN FAVOUR OF
E-3	DRAINAGE	SEE DIAG	PS840613E	MELTON CITY COUNCIL
E-5	DRAINAGE	SEE DIAG	PS840613E	MELTON CITY COUNCIL
E-5	SEWERAGE	SEE DIAG	PS840613E	GREATER WESTERN WATER CORPORATION
E-6	DRAINAGE	SEE DIAG	PS840613E	MELTON CITY COUNCIL
E-6	SEWERAGE	SEE DIAG	PS840602K	GREATER WESTERN WATER CORPORATION
E-7	DRAINAGE	SEE DIAG	THIS PLAN	MELTON CITY COUNCIL
E-8	SEWERAGE	SEE DIAG	THIS PLAN	GREATER WESTERN WATER CORPORATION
E-9	DRAINAGE	SEE DIAG	THIS PLAN	MELTON CITY COUNCIL
E-9	SEWERAGE	SEE DIAG	THIS PLAN	GREATER WESTERN WATER CORPORATION

WILLIAMS WALK - 3

44 LOTS & BALANCE LOT C

LICENSED SURVEYOR ADRIAN A. THOMAS

DATE 10/10/22

REFERENCE 301436-ST03

ORIGINAL SHEET SIZE A3

VERSION F

DRAWING 301436-ST03-AF

SHEET 1 OF 5 SHEETS

veris

VERIS AUSTRALIA PTY LTD
A | Level 3, 1 Southbank Blvd
Southbank VIC 3006
T | +61 3 7019 8400
E | melbourne@veris.com.au
W | www.veris.com.au

PLAN OF SUBDIVISION

PS 845657F

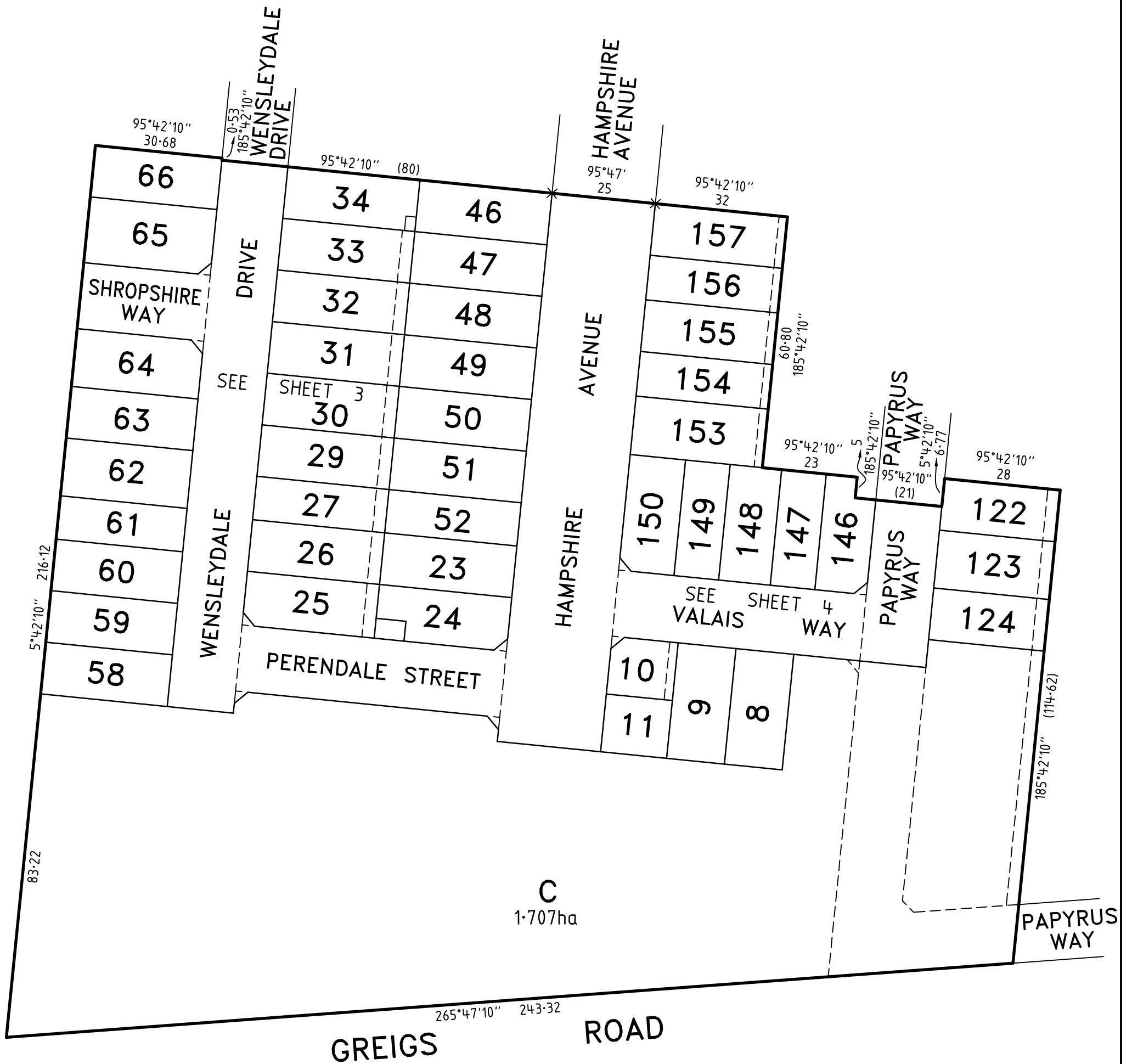
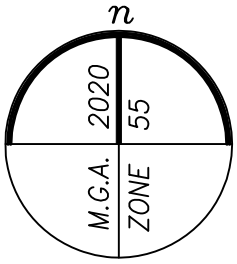

WILLIAMS WALK - 3



VERIS AUSTRALIA PTY LTD
A | Level 3, 1 Southbank Blvd
Southbank VIC 3006
T | +61 3 7019 8400
E | melbourne@veris.com.au
W | www.veris.com.au

LICENSED SURVEYOR ADRIAN A. THOMAS

SCALE
1:1000

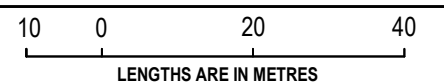

DATE 10/10/22

REFERENCE 301436-ST03

ORIGINAL SHEET SIZE A3

VERSION F

DRAWING 301436-ST03-AF

SHEET 2

PLAN OF SUBDIVISION

PS 845657F

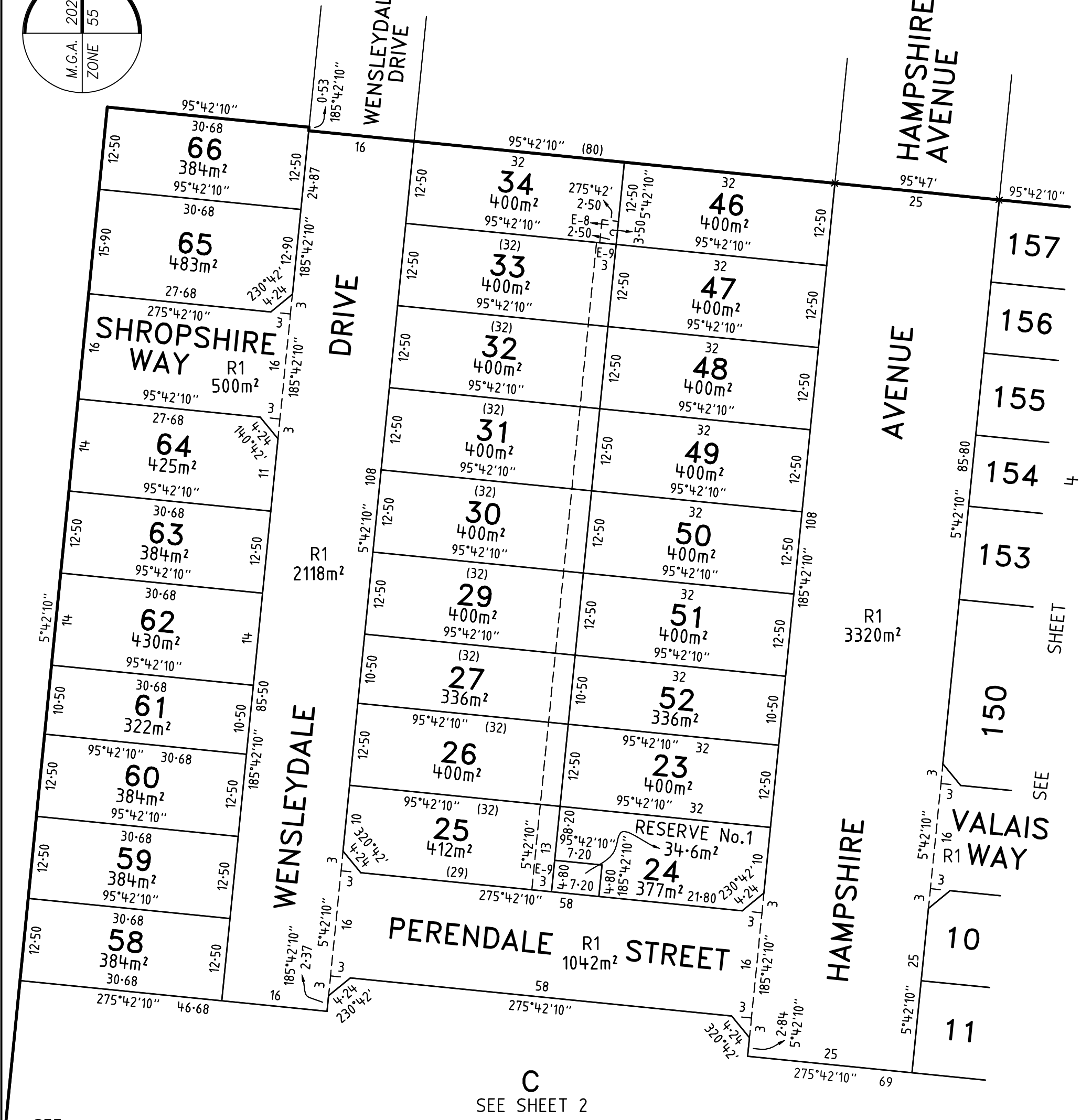
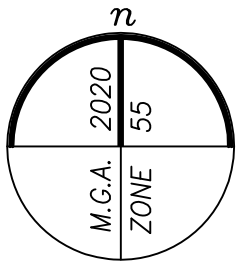

SEE SHEET 2

C
SEE SHEET 2

WILLIAMS WALK - 3 	LICENSED SURVEYOR ADRIAN A. THOMAS		SCALE 1:600	
	DATE 10/10/22	REFERENCE 301436-ST03	ORIGINAL SHEET SIZE A3	
	VERSION F	DRAWING 301436-ST03-AF	SHEET 3	
	VERIS AUSTRALIA PTY LTD A Level 3, 1 Southbank Blvd Southbank VIC 3006 T +61 3 7019 8400 E melbourne@veris.com.au W www.veris.com.au			

PLAN OF SUBDIVISION

PS 845657F

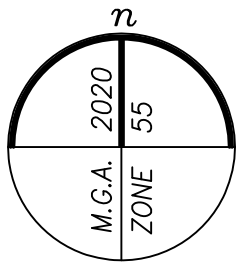
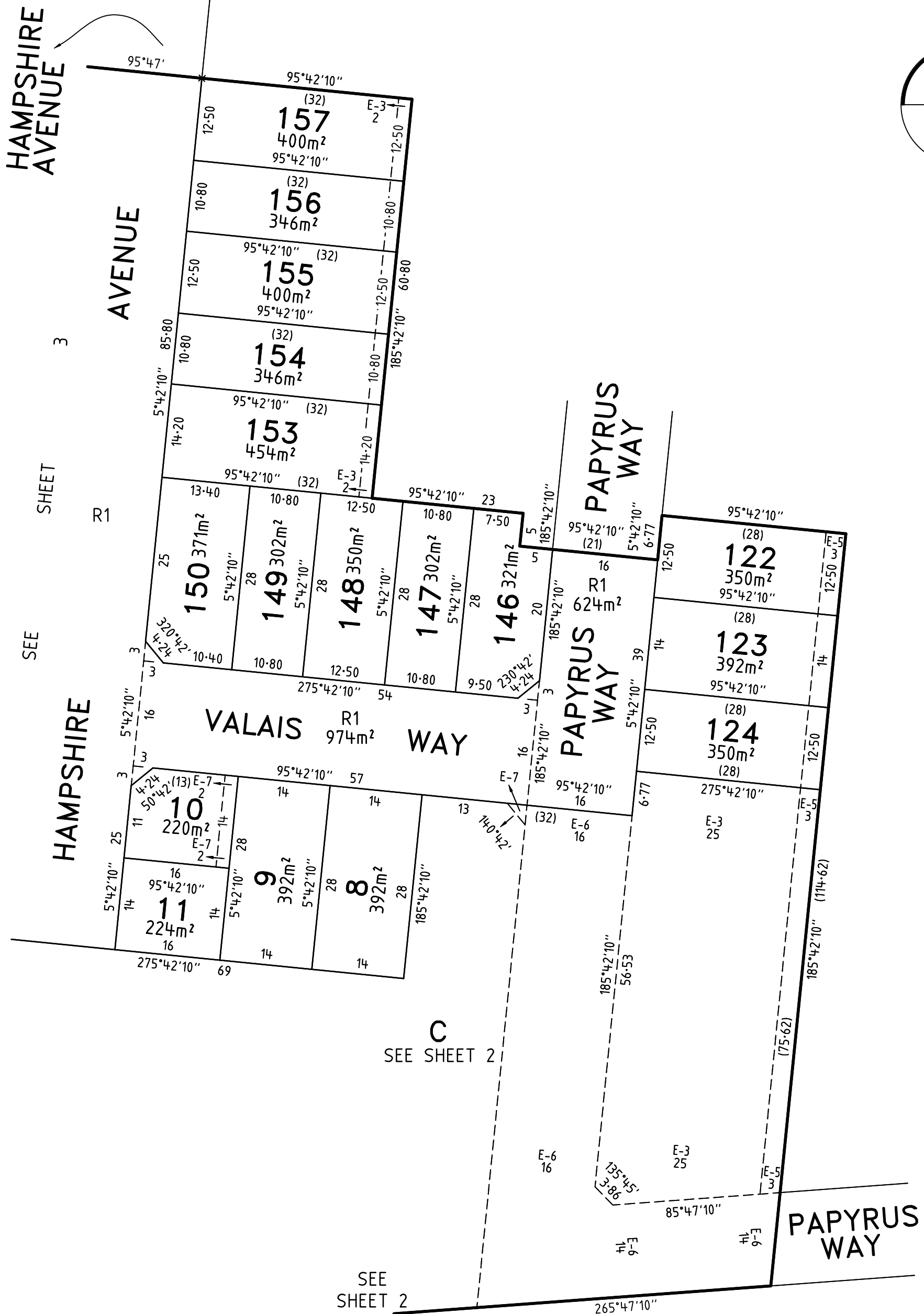

WILLIAMS WALK - 3

LICENSED SURVEYOR ADRIAN A. THOMAS

SCALE
1:600

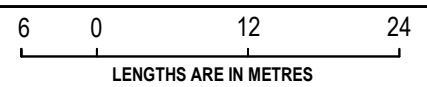

VERIS AUSTRALIA PTY LTD
A | Level 3, 1 Southbank Blvd
Southbank VIC 3006
T | +61 3 7019 8400
E | melbourne@veris.com.au
W | www.veris.com.au

DATE 10/10/22
VERSION F

REFERENCE 301436-ST03
DRAWING 301436-ST03-AF

ORIGINAL SHEET SIZE A3
SHEET 4

PLAN OF SUBDIVISION

PS 845657F

CREATION OF RESTRICTION A

THE REGISTERED PROPRIETORS OF THE BURDENED LAND COVENANT WITH THE REGISTERED PROPRIETORS OF THE BENEFITED LAND AS SET OUT IN THE RESTRICTION WITH THE INTENT THAT THE BURDEN OF THE RESTRICTION RUNS WITH AND BINDS THE BURDENED LAND AND THE BENEFIT OF THE RESTRICTION IS ANNEXED TO AND RUNS WITH THE BENEFITED LAND.

TABLE OF LAND BURDENED AND LAND BENEFITED

BURDENED LOT No.	BENEFITING LOTS ON THIS PLAN
8	9
9	8, 10, 11
23	24, 26, 52
24	23, 25
25	24, 26
26	23, 25, 27
27	26, 29, 52
29	27, 30, 51
30	29, 31, 50
31	30, 32, 49
32	31, 33, 48
33	32, 34, 47
34	33, 46
46	34, 47

BURDENED LOT No.	BENEFITING LOTS ON THIS PLAN
47	33, 46, 48
48	32, 47, 49
49	31, 48, 50
50	30, 49, 51
51	29, 50, 52
52	23, 27, 51
58	59
59	58, 60
60	59, 61
61	60, 62
62	61, 63
63	62, 64
64	63
65	66

BURDENED LOT No.	BENEFITING LOTS ON THIS PLAN
66	65
122	123
123	122, 124
124	123
146	147
147	146, 148
148	147, 149, 153
149	148, 150, 153
150	149, 153
153	148, 149, 150, 154
154	153, 155
155	154, 156
156	155, 157
157	156

RESTRICTION:

THE REGISTERED PROPRIETOR OR PROPRIETORS FOR THE TIME BEING OF THE BURDENED LOT SHOWN IN THE TABLE ABOVE SHALL NOT BUILD OR ERECT OR ALLOW TO BE BUILT OR ERECTED ANY BUILDING OR STRUCTURE OTHER THAN A BUILDING OR STRUCTURE WHICH IS BUILT OR ERECTED IN ACCORDANCE WITH MEMORANDUM OF COMMON PROVISIONS REGISTERED IN DEALING NUMBER EXCEPT WITH THE PRIOR WRITTEN CONSENT OF THE RESPONSIBLE AUTHORITY.

EXPIRY DATE: 31/12/2032

CREATION OF RESTRICTION B

THE REGISTERED PROPRIETORS OF THE BURDENED LAND COVENANT WITH THE REGISTERED PROPRIETORS OF THE BENEFITED LAND AS SET OUT IN THE RESTRICTION WITH THE INTENT THAT THE BURDEN OF THE RESTRICTION RUNS WITH AND BINDS THE BURDENED LAND AND THE BENEFIT OF THE RESTRICTION IS ANNEXED TO AND RUNS WITH THE BENEFITED LAND.

TABLE OF LAND BURDENED AND LAND BENEFITED

BURDENED LOT SUBJECT TO TYPE 'A' OF THE SMALL LOT HOUSING CODE	BENEFITING LOTS ON THIS PLAN
10	9, 11
11	9, 10

RESTRICTION:

THE REGISTERED PROPRIETOR OR PROPRIETORS FOR THE TIME BEING OF ANY BURDENED LOT ON THIS PLAN IN THE TABLE AS A LOT SUBJECT TO THE 'SMALL LOT HOUSING CODE (TYPE A)' MUST NOT BUILD OR PERMIT TO BE BUILT OR REMAIN ON THE LOT ANY BUILDING OR STRUCTURE THAT HAS NOT BEEN CONSTRUCTED IN ACCORDANCE WITH THE 'SMALL LOT HOUSING CODE (TYPE A)' UNLESS IN ACCORDANCE WITH A PERMIT GRANTED TO CONSTRUCT A DWELLING ON THE LOT.

EXPIRY DATE: 31/12/2032

WILLIAMS WALK - 3



VERIS AUSTRALIA PTY LTD
A | Level 3, 1 Southbank Blvd
Southbank VIC 3006
T | +61 3 7019 8400
E | melbourne@veris.com.au
W | www.veris.com.au

LICENSED SURVEYOR **ADRIAN A. THOMAS**

SCALE



DATE 10/10/22

REFERENCE 301436-ST03

ORIGINAL SHEET SIZE A3

VERSION F

DRAWING 301436-ST03-AF

SHEET 5