

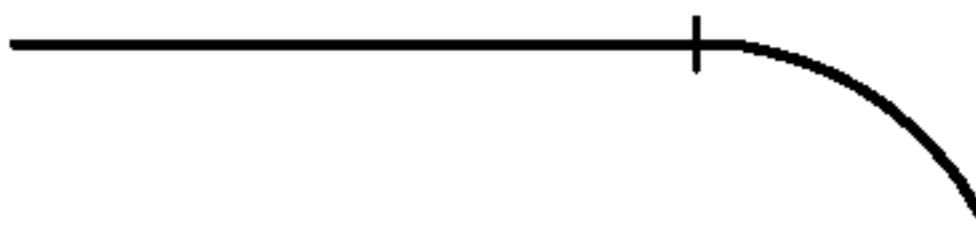

PLAN OF SUBDIVISION		EDITION 1	PS 905666X	
LOCATION OF LAND		Council Name: Melton City Council Council Reference Number: Sub6247 Planning Permit Reference: PA2017/5637 SPEAR Reference Number: S189813C		
PARISH:	MARIBYRNONG	Certification This plan is certified under section 11 (7) of the Subdivision Act 1988 Date of original certification under section 6 of the Subdivision Act 1988: 16/02/2023 Public Open Space A requirement for public open space under section 18 or 18A of the Subdivision Act 1988 has not been made Digitally signed by: Julie Stafford for Melton City Council on 21/05/2024 Statement of Compliance issued: 31/05/2024		
TOWNSHIP:	-			
SECTION:	B			
CROWN ALLOTMENT:	9 (PART)			
CROWN PORTION:	-			
TITLE REFERENCE:	VOL 12491 FOL 617			
LAST PLAN REFERENCE:	LOT V ON PS900034Q			
POSTAL ADDRESS: (at time of subdivision)	53 KENNEDY DRIVE FRASER RISE 3336			
MGA 94 CO-ORDINATES: (approx. centre of land in plan)	E 299 100 N 5 824 580	ZONE:	55	
VESTING OF ROADS AND/OR RESERVES		NOTATIONS		
IDENTIFIER	COUNCIL/BODY/PERSON	STAGING	THIS IS / IS NOT A STAGED SUBDIVISION PLANNING PERMIT NO. PA2017/5637	
ROAD R1	MELTON CITY COUNCIL	SURVEY	THIS PLAN IS / IS NOT BASED ON SURVEY VIDE BP3327P THIS SURVEY HAS BEEN CONNECTED TO PERMANENT MARKS NO(S) 53, 136 & 776 IN PROCLAIMED SURVEY AREA NO. -	
		DEPTH LIMITATION	15.24 METRES BELOW THE SURFACE	
		LOTS 1 TO 3300 (BOTH INCLUSIVE) HAVE BEEN OMITTED FROM THIS PLAN.		
		EASEMENTS E-2 TO E-21 (BOTH INCLUSIVE) & E-23 HAVE BEEN OMITTED FROM THIS PLAN.		
		LAND SUBDIVIDED - 3.305ha		
		TANGENT POINTS ARE SHOWN THUS: 		
		WARNING: The restrictive covenant(s)/restriction(s) in this plan may have been varied or removed. For current information, please refer to the relevant folio(s) of the Register, noting section 88(3) of the Transfer of Land Act 1958		
EASEMENT INFORMATION				
LEGEND: E - ENCUMBERING EASEMENT, CONDITION IN CROWN GRANT IN THE NATURE OF AN EASEMENT OR OTHER ENCUMBRANCE A - APPURTENANT EASEMENT				
SUBJECT LAND	PURPOSE	WIDTH (metres)	ORIGIN	LAND BENEFITED/IN FAVOUR OF
E-1	TRANSMISSION OF ELECTRICITY	SEE DIAG	INST. K305859	STATE ELECTRICITY COMMISSION OF VICTORIA
E-22	SEWERAGE	SEE DIAG	PS905653H	GREATER WESTERN WATER CORPORATION
E-24 E-24	DRAINAGE SEWERAGE	SEE DIAG SEE DIAG	PS900034Q PS900034Q	MELTON CITY COUNCIL GREATER WESTERN WATER CORPORATION
E-25 E-25	DRAINAGE SEWERAGE	SEE DIAG SEE DIAG	PS900034Q PS905653H	MELTON CITY COUNCIL GREATER WESTERN WATER CORPORATION
E-26 E-26	DRAINAGE SEWERAGE	SEE DIAG SEE DIAG	THIS PLAN THIS PLAN	MELTON CITY COUNCIL GREATER WESTERN WATER CORPORATION
E-27	SEWERAGE	SEE DIAG	THIS PLAN	GREATER WESTERN WATER CORPORATION
ASPIRE - 33		LICENSED SURVEYOR BRENDAN MUNARI		
48 LOTS		DATE 13/05/24	REFERENCE 329896-ST33	ORIGINAL SHEET SIZE A3
 VERIS AUSTRALIA PTY LTD A Level 3, 1 Southbank Blvd Southbank VIC 3006 T +61 3 7019 8400 E melbourne@veris.com.au W www.veris.com.au		VERSION E	DRAWING 329896-ST33-AE	SHEET 1 OF 5 SHEETS
		Digitally signed by: Brendan Munari, Licensed Surveyor, Surveyor's Plan Version (E), 13/05/2024, SPEAR Ref: S189813C		PLAN REGISTERED TIME: 5:11 PM DATE: 6/06/2024

PLAN OF SUBDIVISION

PS 905666X


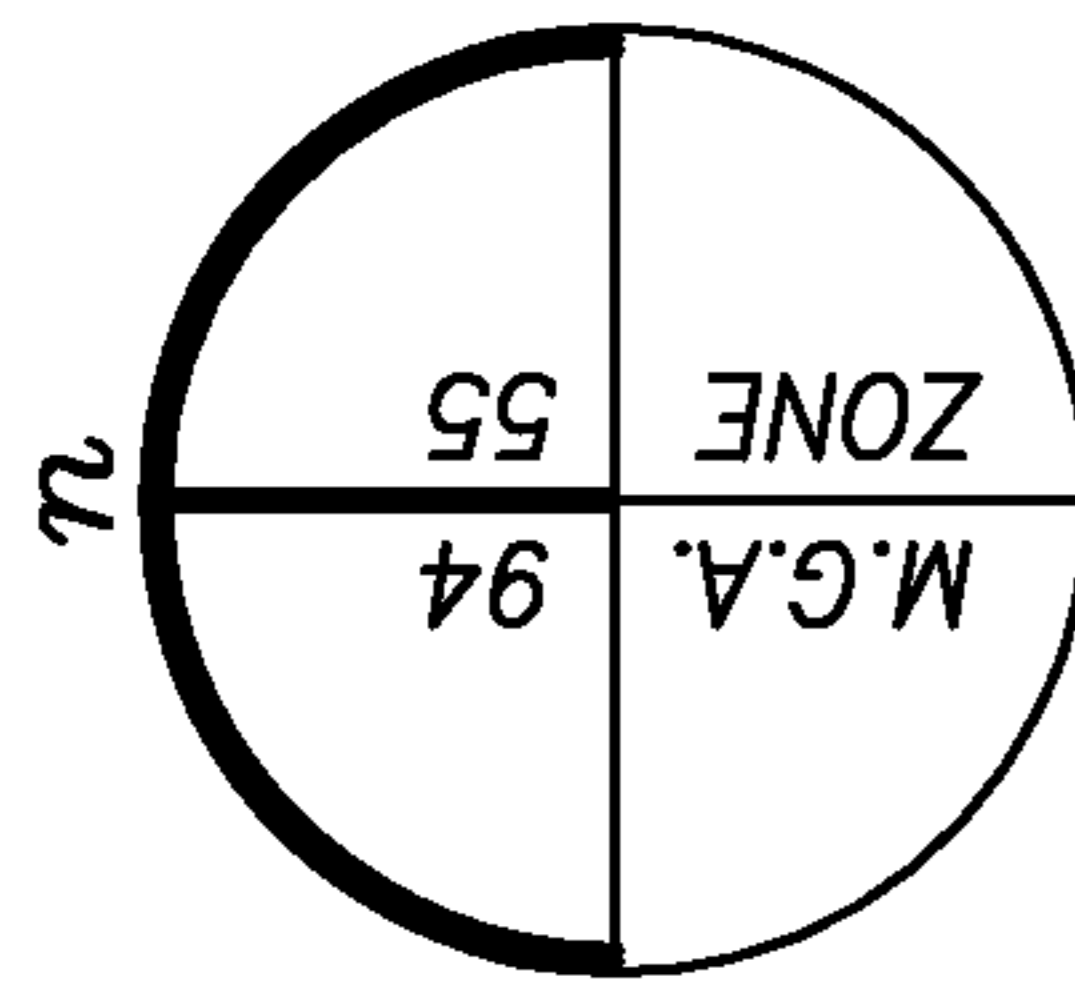

VERIS AUSTRALIA PTY LTD
 A | Level 3, 1 Southbank Blvd
 Southbank VIC 3006
 T | +61 3 7019 8400
 E | melbourne@veris.com.au
 W | www.veris.com.au

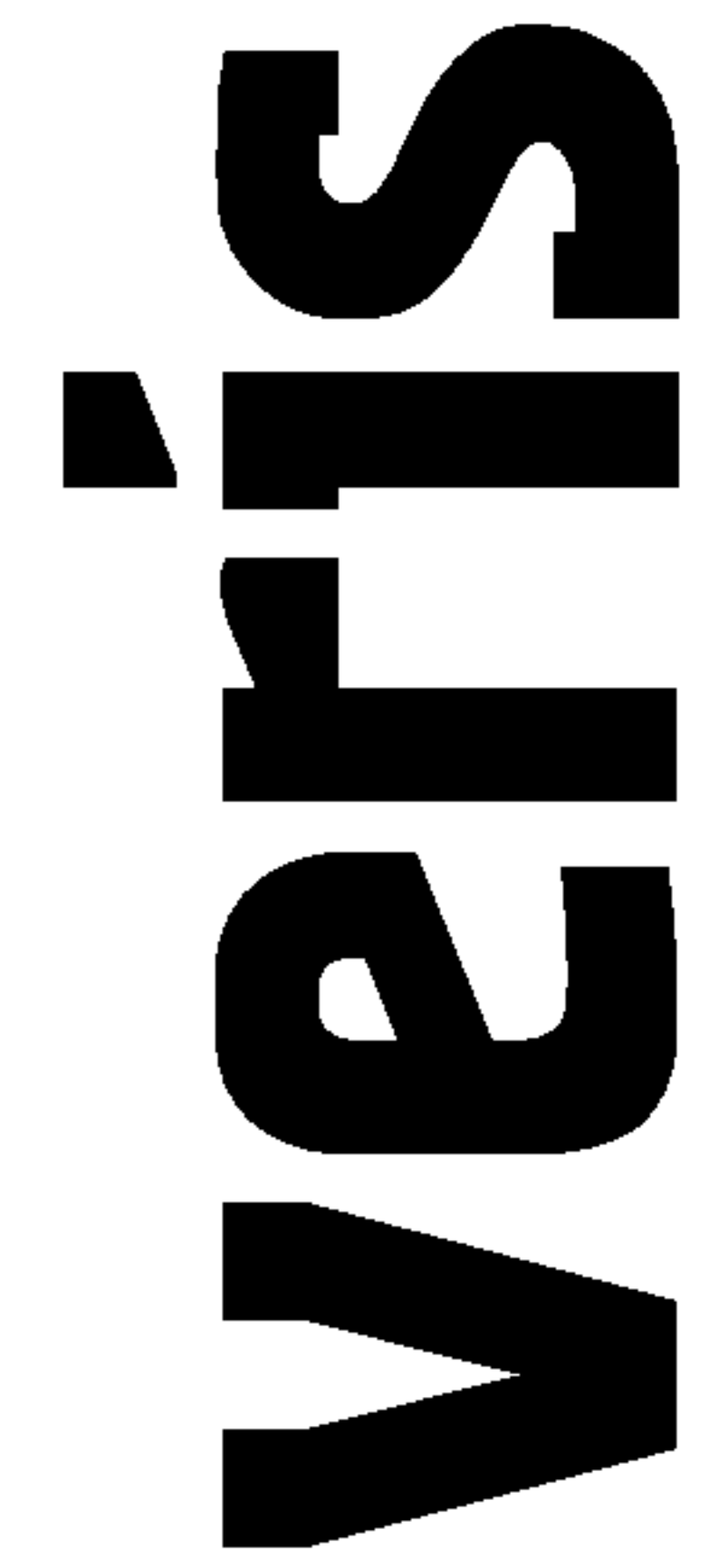

ASPIRE - 33
 LICENSED SURVEYOR **BRENDAN MUNARI**
 DATE 13/05/24
 VERSION E
 REFERENCE 329896-ST33
 DRAWING 329896-ST33-AE

Digitally signed by: Brendan Munari, Licensed Surveyor,
 Surveyor's Plan Version (E),
 13/05/2024, SPEAR Ref: S189813C

Digitally signed by:
 Melton City Council,
 21/05/2024,
 SPEAR Ref: S189813C

SCALE 1:1250
 ORIGINAL SHEET SIZE A3
 SHEET 2

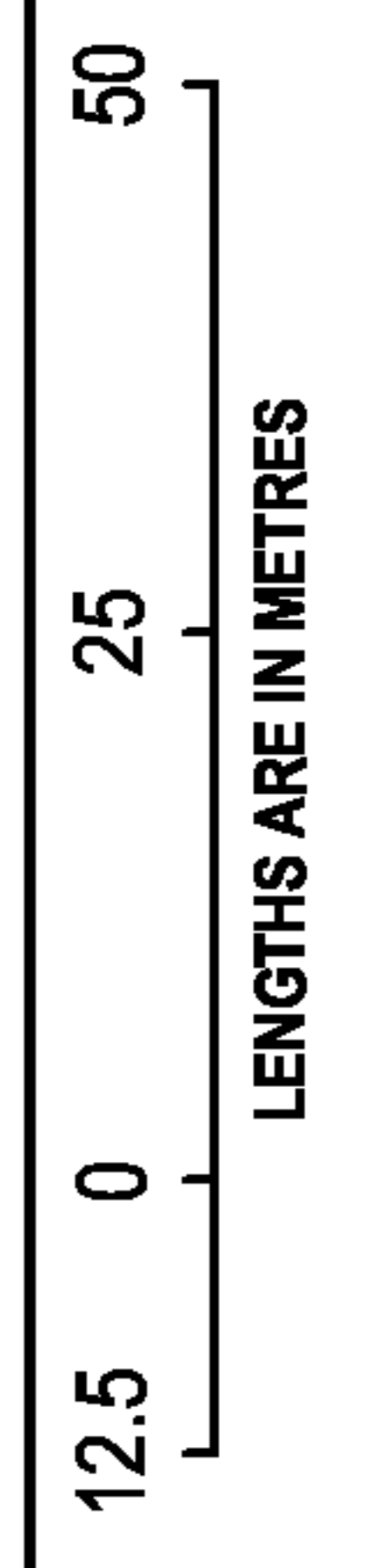

PS 905666X

PLAN OF SUBDIVISION


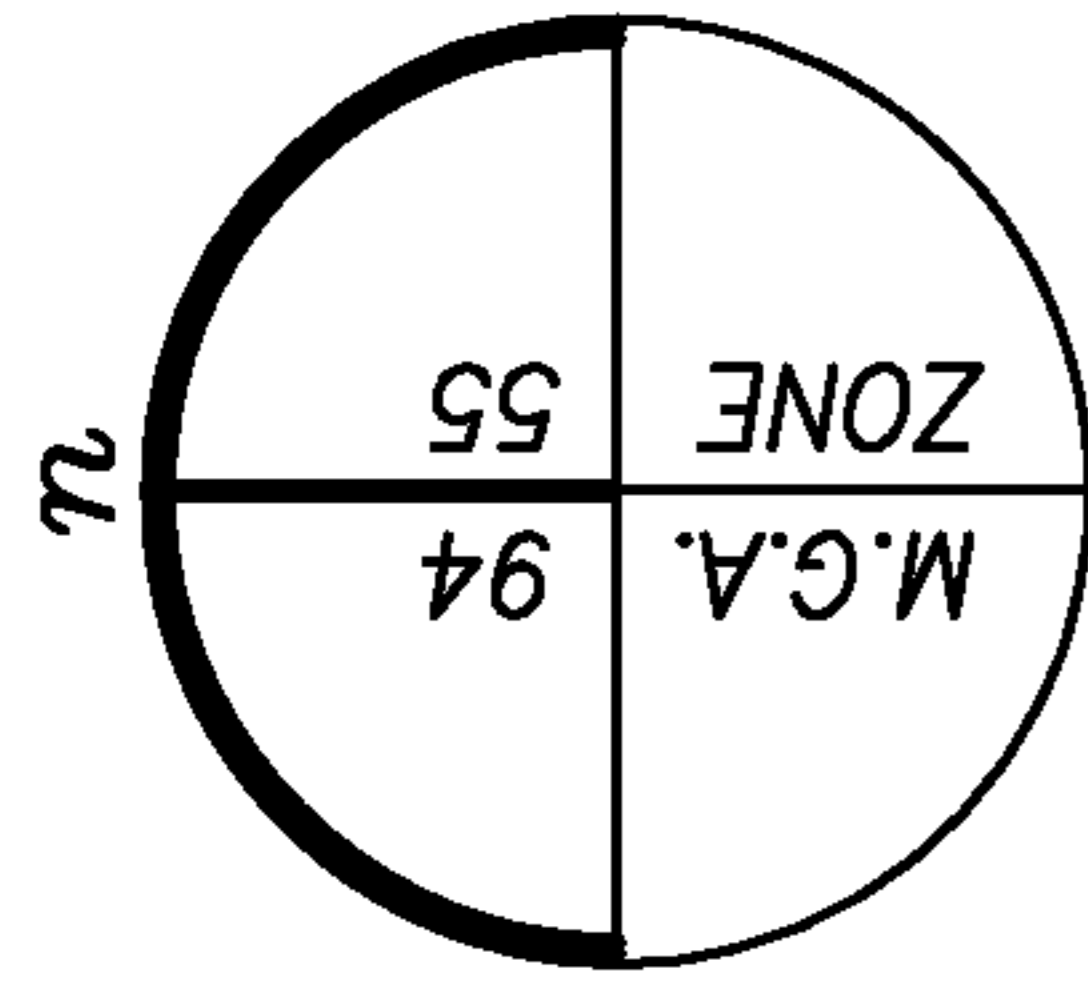

VERIS AUSTRALIA PTY LTD
 A | Level 3, 1 Southbank Blvd
 Southbank VIC 3006
 T | +61 3 7019 8400
 E | melbourne@veris.com.au
 W | www.veris.com.au

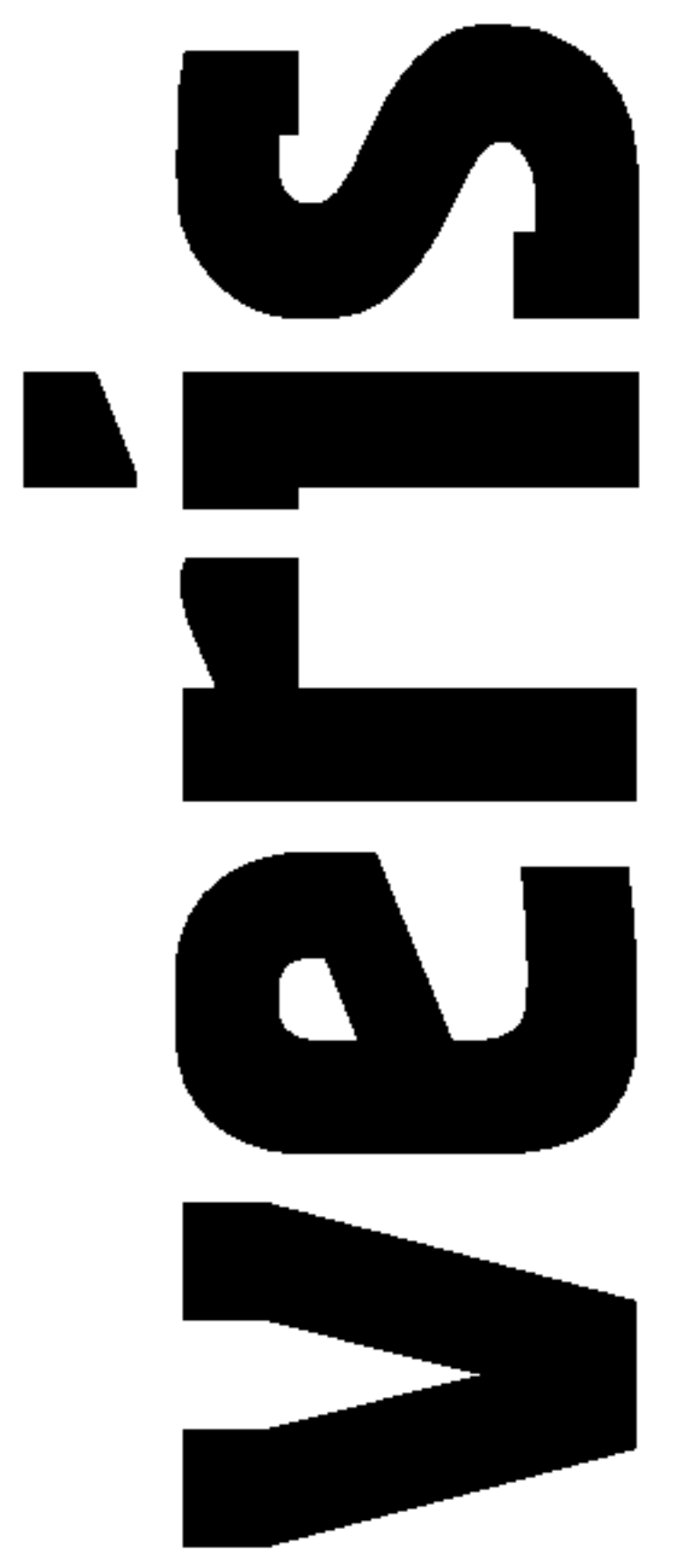

ASPIRE - 33
 LICENSED SURVEYOR BRENDAN MUNARI
 DATE 13/05/24
 VERSION E

REFERENCE 329896-ST33
 DRAWING 329896-ST33-AE

Digitally signed by: Brendan Munari, Licensed Surveyor,
 Surveyor's Plan Version (E),
 13/05/2024, SPEAR Ref: S189813C

SCALE 1:600
 ORIGINAL SHEET SIZE A3
 SHEET 3
 Digitally signed by: Melton City Council,
 21/05/2024, SPEAR Ref: S189813C

M.G.A. 94
ZONE 55

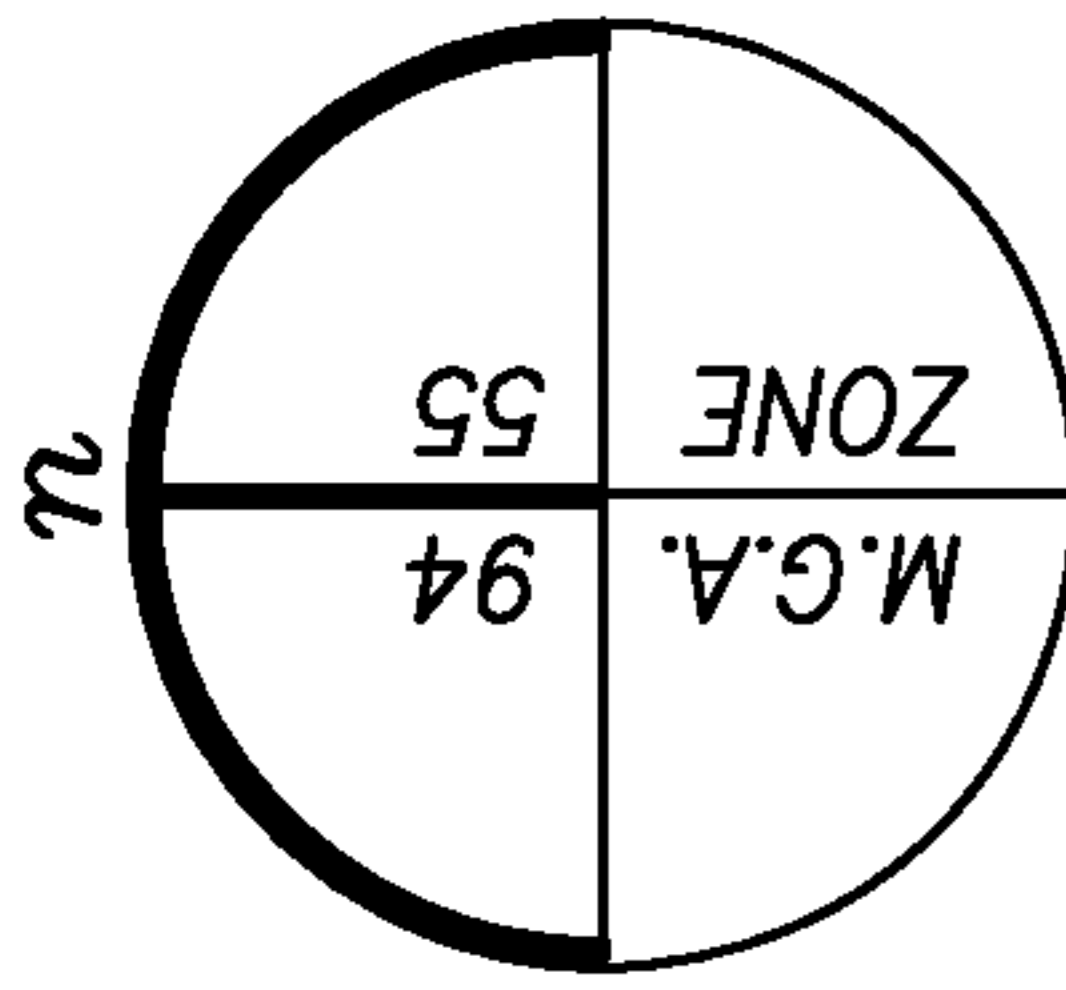

PLAN OF SUBDIVISION

PS 905666X

SEE SHEET 3



VERIS AUSTRALIA PTY LTD
 A | Level 3, 1 Southbank Blvd
 Southbank VIC 3006
 T | +61 3 7019 8400
 E | melbourne@veris.com.au
 W | www.veris.com.au

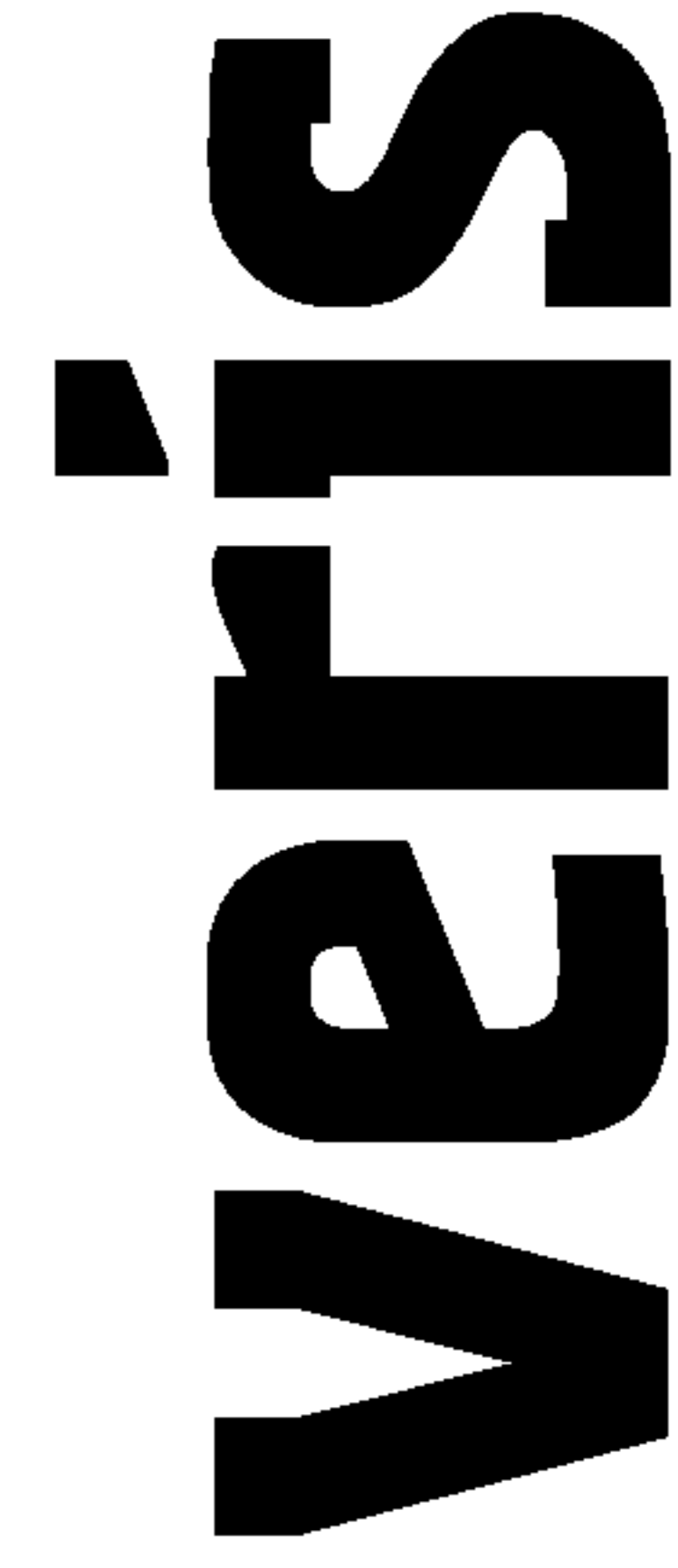

ASPIRE - 33

LICENSED SURVEYOR **BRENDAN MUNARI**

DATE 13/05/24

VERSION E

REFERENCE 329896-ST33

DRAWING 329896-ST33-AE

LENGTHS ARE IN METRES

SCALE 1:600

ORIGINAL SHEET SIZE A3
SHEET 4

Digitally signed by: Brendan Munari, Licensed Surveyor,
 Surveyor's Plan Version (E),
 13/05/2024, SPEAR Ref: S189813C

Digitally signed by:
 Melton City Council,
 21/05/2024,
 SPEAR Ref: S189813C

PLAN OF SUBDIVISION

PS 905666X

CREATION OF RESTRICTION A

THE REGISTERED PROPRIETORS OF THE BURDENED LAND COVENANT WITH THE REGISTERED PROPRIETORS OF THE BENEFITED LAND AS SET OUT IN THE RESTRICTION WITH THE INTENT THAT THE BURDEN OF THE RESTRICTION RUNS WITH AND BINDS THE BURDENED LAND AND THE BENEFIT OF THE RESTRICTION IS ANNEXED TO AND RUNS WITH THE BENEFITED LAND.

TABLE OF LAND BURDENED AND LAND BENEFITED

BURDENED LOT No.	BENEFITING LOTS ON THIS PLAN
3301	3302, 3303
3302	3301, 3303
3303	3301, 3302, 3304
3304	3303, 3305
3305	3304, 3306
3306	3305, 3307
3307	3306, 3308
3308	3307, 3309
3309	3308, 3310
3310	3309
3311	3312, 3328, 3329
3312	3311, 3313, 3327, 3328
3313	3312, 3314, 3327
3314	3313, 3315, 3326, 3327
3315	3314, 3316, 3325, 3326

BURDENED LOT No.	BENEFITING LOTS ON THIS PLAN
3316	3315, 3317, 3324, 3325
3317	3316, 3318, 3319, 3320, 3323, 3324
3322	3321, 3323
3323	3317, 3320, 3321, 3322, 3324
3324	3316, 3317, 3323, 3325
3325	3315, 3316, 3324, 3326
3326	3314, 3315, 3325, 3327
3327	3312, 3313, 3314, 3326, 3328
3328	3311, 3312, 3327, 3329
3329	3311, 3328, 3330
3330	3329, 3331
3331	3330, 3332
3332	3331
3333	3334
3334	3333, 3335

BURDENED LOT No.	BENEFITING LOTS ON THIS PLAN
3335	3334, 3336
3336	3335, 3337
3337	3336
3338	3339
3339	3338, 3340
3340	3339, 3341
3341	3340, 3342
3342	3341, 3343
3343	3342, 3344
3344	3343, 3345
3345	3344, 3346
3346	3345, 3347
3347	3346, 3348
3348	3347

RESTRICTION:

THE REGISTERED PROPRIETOR OR PROPRIETORS OF ANY BURDENED LOT SHOWN IN THE TABLE ABOVE SHALL NOT BUILD OR ERECT OR ALLOW TO BE BUILT OR ERECTED ANY BUILDING OR STRUCTURE OTHER THAN A BUILDING OR STRUCTURE WHICH IS BUILT OR ERECTED IN ACCORDANCE WITH BUILDING ENVELOPES CONTAINED IN MEMORANDUM OF COMMON PROVISIONS REGISTERED IN DEALING NUMBER AA010076 EXCEPT WITH THE PRIOR WRITTEN CONSENT OF THE RESPONSIBLE AUTHORITY.

EXPIRY DATE: 31/12/2034

CREATION OF RESTRICTION B

THE REGISTERED PROPRIETORS OF THE BURDENED LAND COVENANT WITH THE REGISTERED PROPRIETORS OF THE BENEFITED LAND AS SET OUT IN THE RESTRICTION WITH THE INTENT THAT THE BURDEN OF THE RESTRICTION RUNS WITH AND BINDS THE BURDENED LAND AND THE BENEFIT OF THE RESTRICTION IS ANNEXED TO AND RUNS WITH THE BENEFITED LAND.

TABLE OF LAND BURDENED AND LAND BENEFITED

BURDENED LOT SUBJECT TO TYPE 'A' OF THE SMALL LOT HOUSING CODE	BENEFITING LOTS ON THIS PLAN
3318	3317, 3319
3319	3317, 3318, 3320
3320	3317, 3319, 3321, 3323
3321	3320, 3322, 3323

RESTRICTION:

THE REGISTERED PROPRIETOR OR PROPRIETORS FOR THE TIME BEING OF ANY BURDENED LOT ON THIS PLAN IN THE TABLE AS A LOT SUBJECT TO THE 'SMALL LOT HOUSING CODE (TYPE A)' MUST NOT BUILD OR PERMIT TO BE BUILT OR REMAIN ON THE LOT ANY BUILDING OR STRUCTURE THAT HAS NOT BEEN CONSTRUCTED IN ACCORDANCE WITH THE 'SMALL LOT HOUSING CODE (TYPE A)' UNLESS IN ACCORDANCE WITH A PERMIT GRANTED TO CONSTRUCT A DWELLING ON THE LOT.

EXPIRY DATE: 31/12/2034

<p>ASPIRE - 33</p> <p>VERIS AUSTRALIA PTY LTD A Level 3, 1 Southbank Blvd Southbank VIC 3006 T +61 3 7019 8400 E melbourne@veris.com.au W www.veris.com.au</p>	LICENSED SURVEYOR BRENDAN MUNARI	SCALE	<p>LENGTHS ARE IN METRES</p>
	DATE 13/05/24 REFERENCE 329896-ST33	ORIGINAL SHEET SIZE A3	
	VERSION E DRAWING 329896-ST33-AE	SHEET 5	
Digitally signed by: Brendan Munari, Licensed Surveyor, Surveyor's Plan Version (E), 13/05/2024, SPEAR Ref: S189813C		Digitally signed by: Melton City Council, 21/05/2024, SPEAR Ref: S189813C	