



Soil Surveys Engineering Pty Limited
Specialists in Applied Geotechnics
A.B.N. 70 054 043 631

www.soilsurveys.com.au

Principals

PJ Dixon
NT Perkins
MV Geale
GEJ Gray
CP Johnson

BE(Hons) RPEQ
BAppSc(AppGeol) BEng(Hons1) RPEQ
BEng(Civil) MBA CPEng MIE Aust RPEQ
BEng(Civil) RPEQ

Gold Coast Office

Job No: 214-11753

Ref: Controlled Filling - Lot 2014

Author: Curtis Skinner

15 May 2017

Villawood Developments

Country Club Drive

Helensvale QLD 4212

Email: michaelw@villawoodproperties.com

**RE: CONTROLLED FILLING – LOT 2014
THE SURROUNDS – STAGE TWO – 2A – 2E**

Fill was placed on this lot during the construction of this estate.

Soil Surveys Engineering Pty Ltd was commissioned on this project to provide earthworks inspection and testing services in general accordance with AS 3798-2007 "Guidelines on earthworks for commercial and residential developments". Full details of the inspection and testing program are provided in the Soil Surveys Engineering report (ref 2-11753, 2017-05-04, BR VER 1).

Based on the inspection and testing services carried out by Soils Surveys Engineering Pty Limited, it is considered that the fill placed at Lot 2014 of The Surrounds – Stage Two – as shown on all attached plans, has been carried out in a responsible manner and in accordance with table 5.1.1 AS 3798 and the project specifications.

All fill in the areas defined in the attached lot location plan, within the time frame of our inspection and testing program between 16/08/2016 and 12/05/2017 (excluding topsoil placed subsequent to completion of controlled filling) is considered to be "controlled fill" in accordance with AS 2870 "Residential Slabs and Footings" (Clause 6.4.2 (a)) and AS 3798.

Unless otherwise stated, this earthworks assessment does not address any other geotechnical issues which may be relevant to building construction and serviceability.

A full geotechnical site investigation/site classification and foundation design should be carried out by suitably qualified and experienced personnel for the proposed residential construction.

SOIL SURVEYS ENGINEERING PTY LIMITED

Attached: Drawing Showing Location of Lot

Celebrating over 40 years in Geotechnics

Ph +617 3369 6000 Fax +617 3369 6660

PO Box 317, Milton, QLD, 4064, Australia

info@soilsurveys.com.au

Brisbane, Level 2, 19 Finchley Street, Milton, QLD, 4064
Gold Coast, Unit 8, 140 Millaroo Drive, Helensvale, QLD 4212



SOIL SURVEYS ENGINEERING PTY LIMITED
A.C.N. 054 043 631
Consulting Geotechnical Engineers

Drawn BI	Project:	Certification Of Earthwork	Drawing No. 2-11753-03	A4
Date May 2017	Location:	Stage Two (A-E) and Three (A-G), The Surrounds		
Checked CS	Client:	Villawood Developments		



Soil Surveys Engineering Pty Limited
Specialists in Applied Geotechnics
A.B.N. 70 054 043 631

www.soilsurveys.com.au

Principals

PJ Dixon
NT Perkins
MV Geale
GEJ Gray
CP Johnson

BE(Hons) RPEQ
BAppSc(AppGeol) BEng(Hons1) RPEQ
BEng(Civil) MBA CPEng MIE Aust RPEQ
BEng(Civil) RPEQ

Gold Coast Office

Job No: 214-11753

Ref: Controlled Filling - Lot 2015

Author: Curtis Skinner

15 May 2017

Villawood Developments

Country Club Drive

Helensvale QLD 4212

Email: michaelw@villawoodproperties.com

**RE: CONTROLLED FILLING – LOT 2015
THE SURROUNDS – STAGE TWO – 2A – 2E**

Fill was placed on this lot during the construction of this estate.

Soil Surveys Engineering Pty Ltd was commissioned on this project to provide earthworks inspection and testing services in general accordance with AS 3798-2007 "Guidelines on earthworks for commercial and residential developments". Full details of the inspection and testing program are provided in the Soil Surveys Engineering report (ref 2-11753, 2017-05-04, BR VER 1).

Based on the inspection and testing services carried out by Soils Surveys Engineering Pty Limited, it is considered that the fill placed at Lot 2015 of The Surrounds – Stage Two – as shown on all attached plans, has been carried out in a responsible manner and in accordance with table 5.1.1 AS 3798 and the project specifications.

All fill in the areas defined in the attached lot location plan, within the time frame of our inspection and testing program between 16/08/2016 and 12/05/2017 (excluding topsoil placed subsequent to completion of controlled filling) is considered to be "controlled fill" in accordance with AS 2870 "Residential Slabs and Footings" (Clause 6.4.2 (a)) and AS 3798.

Unless otherwise stated, this earthworks assessment does not address any other geotechnical issues which may be relevant to building construction and serviceability.

A full geotechnical site investigation/site classification and foundation design should be carried out by suitably qualified and experienced personnel for the proposed residential construction.

SOIL SURVEYS ENGINEERING PTY LIMITED

Attached: Drawing Showing Location of Lot

Celebrating over 40 years in Geotechnics

Ph +617 3369 6000 Fax +617 3369 6660

PO Box 317, Milton, QLD, 4064, Australia

info@soilsurveys.com.au

Brisbane, Level 2, 19 Finchley Street, Milton, QLD, 4064
Gold Coast, Unit 8, 140 Millaroo Drive, Helensvale, QLD 4212



SOIL SURVEYS ENGINEERING PTY LIMITED
A.C.N. 054 043 631
Consulting Geotechnical Engineers

Drawn BI	Project:	Certification Of Earthwork	Drawing No. 2-11753-03	A4
Date May 2017	Location:	Stage Two (A-E) and Three (A-G), The Surrounds		
Checked CS	Client:	Villawood Developments		



Soil Surveys Engineering Pty Limited
Specialists in Applied Geotechnics
A.B.N. 70 054 043 631

www.soilsurveys.com.au

Principals

PJ Dixon
NT Perkins
MV Geale
GEJ Gray
CP Johnson

BE(Hons) RPEQ
BAppSc(AppGeol) BEng(Hons1) RPEQ
BEng(Civil) MBA CPEng MIE Aust RPEQ
BEng(Civil) RPEQ

Gold Coast Office

Job No: 214-11753

Ref: Controlled Filling - Lot 2016

Author: Curtis Skinner

15 May 2017

Villawood Developments

Country Club Drive

Helensvale QLD 4212

Email: michaelw@villawoodproperties.com

**RE: CONTROLLED FILLING – LOT 2016
THE SURROUNDS – STAGE TWO – 2A – 2E**

Fill was placed on this lot during the construction of this estate.

Soil Surveys Engineering Pty Ltd was commissioned on this project to provide earthworks inspection and testing services in general accordance with AS 3798-2007 "Guidelines on earthworks for commercial and residential developments". Full details of the inspection and testing program are provided in the Soil Surveys Engineering report (ref 2-11753, 2017-05-04, BR VER 1).

Based on the inspection and testing services carried out by Soils Surveys Engineering Pty Limited, it is considered that the fill placed at Lot 2016 of The Surrounds – Stage Two – as shown on all attached plans, has been carried out in a responsible manner and in accordance with table 5.1.1 AS 3798 and the project specifications.

All fill in the areas defined in the attached lot location plan, within the time frame of our inspection and testing program between 16/08/2016 and 12/05/2017 (excluding topsoil placed subsequent to completion of controlled filling) is considered to be "controlled fill" in accordance with AS 2870 "Residential Slabs and Footings" (Clause 6.4.2 (a)) and AS 3798.

Unless otherwise stated, this earthworks assessment does not address any other geotechnical issues which may be relevant to building construction and serviceability.

A full geotechnical site investigation/site classification and foundation design should be carried out by suitably qualified and experienced personnel for the proposed residential construction.

SOIL SURVEYS ENGINEERING PTY LIMITED

Attached: Drawing Showing Location of Lot

Celebrating over 40 years in Geotechnics

Ph +617 3369 6000 Fax +617 3369 6660

PO Box 317, Milton, QLD, 4064, Australia

info@soilsurveys.com.au

Brisbane, Level 2, 19 Finchley Street, Milton, QLD, 4064
Gold Coast, Unit 8, 140 Millaroo Drive, Helensvale, QLD 4212



SOIL SURVEYS ENGINEERING PTY LIMITED
A.C.N. 054 043 631
Consulting Geotechnical Engineers

Drawn BI	Project:	Certification Of Earthwork	Drawing No. 2-11753-03	A4
Date May 2017	Location:	Stage Two (A-E) and Three (A-G), The Surrounds		
Checked CS	Client:	Villawood Developments		



Soil Surveys Engineering Pty Limited
Specialists in Applied Geotechnics
A.B.N. 70 054 043 631

www.soilsurveys.com.au

Principals

PJ Dixon
NT Perkins
MV Geale
GEJ Gray
CP Johnson

BE(Hons) RPEQ
BAppSc(AppGeol) BEng(Hons1) RPEQ
BEng(Civil) MBA CPEng MIE Aust RPEQ
BEng(Civil) RPEQ

Gold Coast Office

Job No: 214-11753

Ref: Controlled Filling - Lot 2017

Author: Curtis Skinner

15 May 2017

Villawood Developments

Country Club Drive

Helensvale QLD 4212

Email: michaelw@villawoodproperties.com

**RE: CONTROLLED FILLING – LOT 2017
THE SURROUNDS – STAGE TWO – 2A – 2E**

Fill was placed on this lot during the construction of this estate.

Soil Surveys Engineering Pty Ltd was commissioned on this project to provide earthworks inspection and testing services in general accordance with AS 3798-2007 "Guidelines on earthworks for commercial and residential developments". Full details of the inspection and testing program are provided in the Soil Surveys Engineering report (ref 2-11753, 2017-05-04, BR VER 1).

Based on the inspection and testing services carried out by Soils Surveys Engineering Pty Limited, it is considered that the fill placed at Lot 2017 of The Surrounds – Stage Two – as shown on all attached plans, has been carried out in a responsible manner and in accordance with table 5.1.1 AS 3798 and the project specifications.

All fill in the areas defined in the attached lot location plan, within the time frame of our inspection and testing program between 16/08/2016 and 12/05/2017 (excluding topsoil placed subsequent to completion of controlled filling) is considered to be "controlled fill" in accordance with AS 2870 "Residential Slabs and Footings" (Clause 6.4.2 (a)) and AS 3798.

Unless otherwise stated, this earthworks assessment does not address any other geotechnical issues which may be relevant to building construction and serviceability.

A full geotechnical site investigation/site classification and foundation design should be carried out by suitably qualified and experienced personnel for the proposed residential construction.

SOIL SURVEYS ENGINEERING PTY LIMITED

Attached: Drawing Showing Location of Lot

Celebrating over 40 years in Geotechnics

Ph +617 3369 6000 Fax +617 3369 6660

PO Box 317, Milton, QLD, 4064, Australia

info@soilsurveys.com.au

Brisbane, Level 2, 19 Finchley Street, Milton, QLD, 4064
Gold Coast, Unit 8, 140 Millaroo Drive, Helensvale, QLD 4212



SOIL SURVEYS ENGINEERING PTY LIMITED
A.C.N. 054 043 631
Consulting Geotechnical Engineers

Drawn BI	Project:	Certification Of Earthwork	Drawing No. 2-11753-03	A4
Date May 2017	Location:	Stage Two (A-E) and Three (A-G), The Surrounds		
Checked CS	Client:	Villawood Developments		



Soil Surveys Engineering Pty Limited
Specialists in Applied Geotechnics
A.B.N. 70 054 043 631

www.soilsurveys.com.au

Principals

PJ Dixon
NT Perkins
MV Geale
GEJ Gray
CP Johnson

BE(Hons) RPEQ
BAppSc(AppGeol) BEng(Hons1) RPEQ
BEng(Civil) MBA CPEng MIE Aust RPEQ
BEng(Civil) RPEQ

Gold Coast Office

Job No: 214-11753

Ref: Controlled Filling - Lot 2018

Author: Cameron Johnson

15 May 2017

Villawood Developments

Country Club Drive

Helensvale QLD 4212

Email: michaelw@villawoodproperties.com

**RE: CONTROLLED FILLING – LOT 2018
THE SURROUNDS – STAGE TWO – 2A – 2E**

Fill was placed on this lot during the construction of this estate.

Soil Surveys Engineering Pty Ltd was commissioned on this project to provide earthworks inspection and testing services in general accordance with AS 3798-2007 "Guidelines on earthworks for commercial and residential developments". Full details of the inspection and testing program are provided in the Soil Surveys Engineering report (ref 2-11753, 2017-05-04, BR VER 1).

Based on the inspection and testing services carried out by Soils Surveys Engineering Pty Limited, it is considered that the fill placed at Lot 2018 of The Surrounds – Stage Two – as shown on all attached plans, has been carried out in a responsible manner and in accordance with table 5.1.1 AS 3798 and the project specifications.

All fill in the areas defined in the attached lot location plan, within the time frame of our inspection and testing program between 16/08/2016 and 12/05/2017 (excluding topsoil placed subsequent to completion of controlled filling) is considered to be "controlled fill" in accordance with AS 2870 "Residential Slabs and Footings" (Clause 6.4.2 (a)) and AS 3798.

Unless otherwise stated, this earthworks assessment does not address any other geotechnical issues which may be relevant to building construction and serviceability.

A full geotechnical site investigation/site classification and foundation design should be carried out by suitably qualified and experienced personnel for the proposed residential construction.

SOIL SURVEYS ENGINEERING PTY LIMITED

Attached: Drawing Showing Location of Lot

Celebrating over 40 years in Geotechnics

Ph +617 3369 6000 Fax +617 3369 6660

PO Box 317, Milton, QLD, 4064, Australia

info@soilsurveys.com.au

Brisbane, Level 2, 19 Finchley Street, Milton, QLD, 4064
Gold Coast, Unit 8, 140 Millaroo Drive, Helensvale, QLD 4212

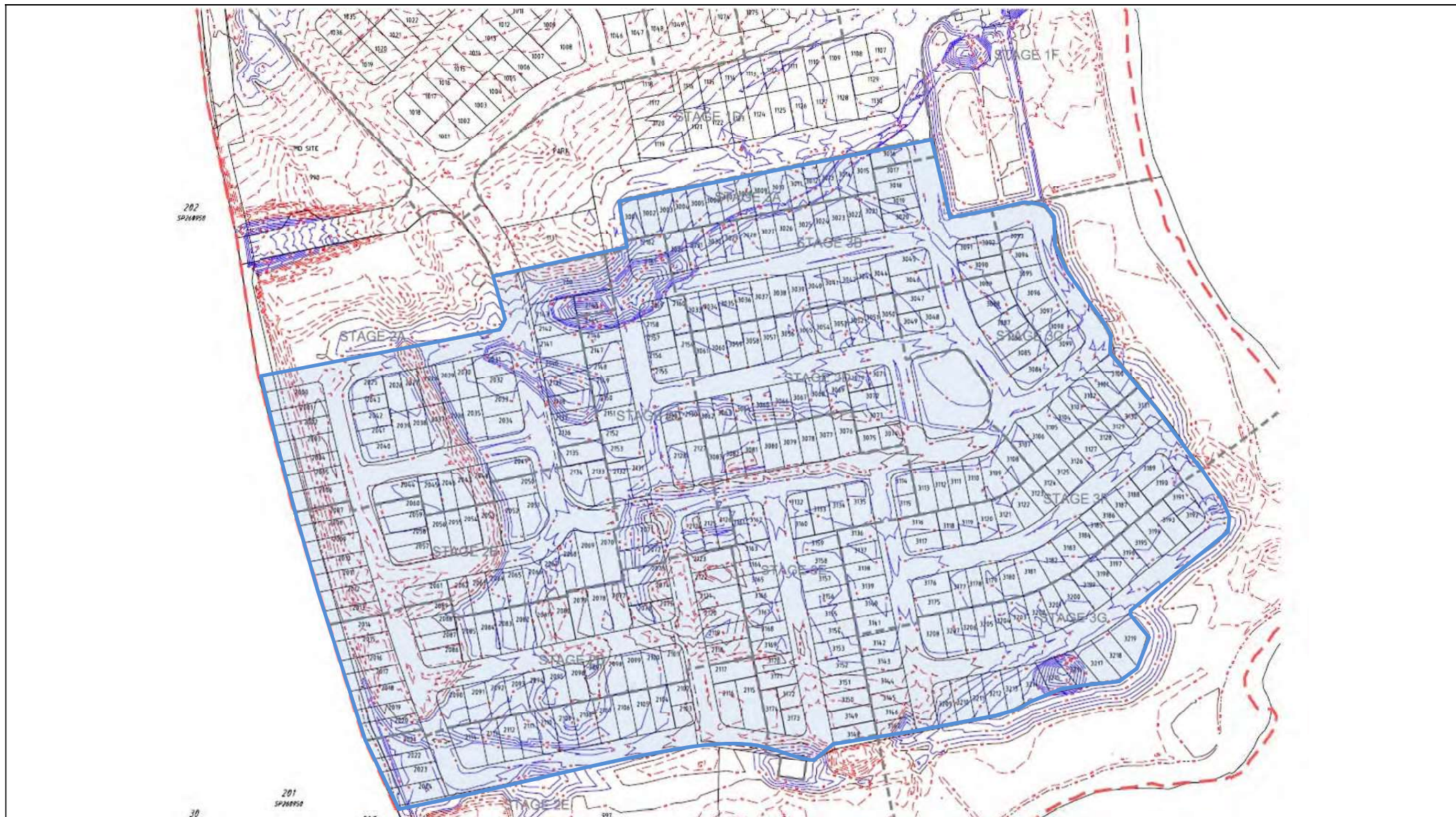

SOIL SURVEYS ENGINEERING PTY LIMITED
A.C.N. 054 043 631
Consulting Geotechnical Engineers

Drawn BI	Project:	Certification Of Earthwork	Drawing No. 2-11753-03	A4
Date May 2017	Location:	Stage Two (A-E) and Three (A-G), The Surrounds		
Checked CS	Client:	Villawood Developments		



Soil Surveys Engineering Pty Limited
Specialists in Applied Geotechnics
A.B.N. 70 054 043 631

www.soilsurveys.com.au

Principals

PJ Dixon
NT Perkins
MV Geale
GEJ Gray
CP Johnson

BE(Hons) RPEQ
BAppSc(AppGeol) BEng(Hons1) RPEQ
BEng(Civil) MBA CPEng MIE Aust RPEQ
BEng(Civil) RPEQ

Gold Coast Office

Job No: 214-11753

Ref: Controlled Filling - Lot 2019

Author: Curtis Skinner

15 May 2017

Villawood Developments

Country Club Drive

Helensvale QLD 4212

Email: michaelw@villawoodproperties.com

**RE: CONTROLLED FILLING – LOT 2019
THE SURROUNDS – STAGE TWO – 2A – 2E**

Fill was placed on this lot during the construction of this estate.

Soil Surveys Engineering Pty Ltd was commissioned on this project to provide earthworks inspection and testing services in general accordance with AS 3798-2007 "Guidelines on earthworks for commercial and residential developments". Full details of the inspection and testing program are provided in the Soil Surveys Engineering report (ref 2-11753, 2017-05-04, BR VER 1).

Based on the inspection and testing services carried out by Soils Surveys Engineering Pty Limited, it is considered that the fill placed at Lot 2019 of The Surrounds – Stage Two – as shown on all attached plans, has been carried out in a responsible manner and in accordance with table 5.1.1 AS 3798 and the project specifications.

All fill in the areas defined in the attached lot location plan, within the time frame of our inspection and testing program between 16/08/2016 and 12/05/2017 (excluding topsoil placed subsequent to completion of controlled filling) is considered to be "controlled fill" in accordance with AS 2870 "Residential Slabs and Footings" (Clause 6.4.2 (a)) and AS 3798.

Unless otherwise stated, this earthworks assessment does not address any other geotechnical issues which may be relevant to building construction and serviceability.

A full geotechnical site investigation/site classification and foundation design should be carried out by suitably qualified and experienced personnel for the proposed residential construction.

SOIL SURVEYS ENGINEERING PTY LIMITED

Attached: Drawing Showing Location of Lot

Celebrating over 40 years in Geotechnics

Ph +617 3369 6000 Fax +617 3369 6660

PO Box 317, Milton, QLD, 4064, Australia

info@soilsurveys.com.au

Brisbane, Level 2, 19 Finchley Street, Milton, QLD, 4064
Gold Coast, Unit 8, 140 Millaroo Drive, Helensvale, QLD 4212



SOIL SURVEYS ENGINEERING PTY LIMITED
A.C.N. 054 043 631
Consulting Geotechnical Engineers

Drawn BI	Project:	Certification Of Earthwork	Drawing No. 2-11753-03	A4
Date May 2017	Location:	Stage Two (A-E) and Three (A-G), The Surrounds		
Checked CS	Client:	Villawood Developments		



Soil Surveys Engineering Pty Limited
Specialists in Applied Geotechnics
A.B.N. 70 054 043 631

www.soilsurveys.com.au

Principals

PJ Dixon
NT Perkins
MV Geale
GEJ Gray
CP Johnson

BE(Hons) RPEQ
BAppSc(AppGeol) BEng(Hons1) RPEQ
BEng(Civil) MBA CPEng MIE Aust RPEQ
BEng(Civil) RPEQ

Gold Coast Office

Job No: 214-11753

Ref: Controlled Filling - Lot 2020

Author: Curtis Skinner

15 May 2017

Villawood Developments

Country Club Drive

Helensvale QLD 4212

Email: michaelw@villawoodproperties.com

**RE: CONTROLLED FILLING – LOT 2020
THE SURROUNDS – STAGE TWO – 2A – 2E**

Fill was placed on this lot during the construction of this estate.

Soil Surveys Engineering Pty Ltd was commissioned on this project to provide earthworks inspection and testing services in general accordance with AS 3798-2007 "Guidelines on earthworks for commercial and residential developments". Full details of the inspection and testing program are provided in the Soil Surveys Engineering report (ref 2-11753, 2017-05-04, BR VER 1).

Based on the inspection and testing services carried out by Soils Surveys Engineering Pty Limited, it is considered that the fill placed at Lot 2020 of The Surrounds – Stage Two – as shown on all attached plans, has been carried out in a responsible manner and in accordance with table 5.1.1 AS 3798 and the project specifications.

All fill in the areas defined in the attached lot location plan, within the time frame of our inspection and testing program between 16/08/2016 and 12/05/2017 (excluding topsoil placed subsequent to completion of controlled filling) is considered to be "controlled fill" in accordance with AS 2870 "Residential Slabs and Footings" (Clause 6.4.2 (a)) and AS 3798.

Unless otherwise stated, this earthworks assessment does not address any other geotechnical issues which may be relevant to building construction and serviceability.

A full geotechnical site investigation/site classification and foundation design should be carried out by suitably qualified and experienced personnel for the proposed residential construction.

SOIL SURVEYS ENGINEERING PTY LIMITED

Attached: Drawing Showing Location of Lot

Celebrating over 40 years in Geotechnics

Ph +617 3369 6000 Fax +617 3369 6660

PO Box 317, Milton, QLD, 4064, Australia

info@soilsurveys.com.au

Brisbane, Level 2, 19 Finchley Street, Milton, QLD, 4064
Gold Coast, Unit 8, 140 Millaroo Drive, Helensvale, QLD 4212



SOIL SURVEYS ENGINEERING PTY LIMITED
A.C.N. 054 043 631
Consulting Geotechnical Engineers

Drawn BI	Project:	Certification Of Earthwork	Drawing No. 2-11753-03	A4
Date May 2017	Location:	Stage Two (A-E) and Three (A-G), The Surrounds		
Checked CS	Client:	Villawood Developments		



Soil Surveys Engineering Pty Limited
Specialists in Applied Geotechnics
A.B.N. 70 054 043 631

www.soilsurveys.com.au

Principals

PJ Dixon
NT Perkins
MV Geale
GEJ Gray
CP Johnson

BE(Hons) RPEQ
BAppSc(AppGeol) BEng(Hons1) RPEQ
BEng(Civil) MBA CPEng MIE Aust RPEQ
BEng(Civil) RPEQ

Gold Coast Office

Job No: 214-11753

Ref: Controlled Filling - Lot 2073

Author: Curtis Skinner

15 May 2017

Villawood Developments

Country Club Drive

Helensvale QLD 4212

Email: michaelw@villawoodproperties.com

**RE: CONTROLLED FILLING – LOT 2073
THE SURROUNDS – STAGE TWO – 2A – 2E**

Fill was placed on this lot during the construction of this estate.

Soil Surveys Engineering Pty Ltd was commissioned on this project to provide earthworks inspection and testing services in general accordance with AS 3798-2007 "Guidelines on earthworks for commercial and residential developments". Full details of the inspection and testing program are provided in the Soil Surveys Engineering report (ref 2-11753, 2017-05-04, BR VER 1).

Based on the inspection and testing services carried out by Soils Surveys Engineering Pty Limited, it is considered that the fill placed at Lot 2073 of The Surrounds – Stage Two – as shown on all attached plans, has been carried out in a responsible manner and in accordance with table 5.1.1 AS 3798 and the project specifications.

All fill in the areas defined in the attached lot location plan, within the time frame of our inspection and testing program between 16/08/2016 and 12/05/2017 (excluding topsoil placed subsequent to completion of controlled filling) is considered to be "controlled fill" in accordance with AS 2870 "Residential Slabs and Footings" (Clause 6.4.2 (a)) and AS 3798.

Unless otherwise stated, this earthworks assessment does not address any other geotechnical issues which may be relevant to building construction and serviceability.

A full geotechnical site investigation/site classification and foundation design should be carried out by suitably qualified and experienced personnel for the proposed residential construction.

SOIL SURVEYS ENGINEERING PTY LIMITED

Attached: Drawing Showing Location of Lot

Celebrating over 40 years in Geotechnics

Ph +617 3369 6000 Fax +617 3369 6660

PO Box 317, Milton, QLD, 4064, Australia

info@soilsurveys.com.au

Brisbane, Level 2, 19 Finchley Street, Milton, QLD, 4064
Gold Coast, Unit 8, 140 Millaroo Drive, Helensvale, QLD 4212



SOIL SURVEYS ENGINEERING PTY LIMITED
A.C.N. 054 043 631
Consulting Geotechnical Engineers

Drawn BI	Project:	Certification Of Earthwork	Drawing No. 2-11753-03	A4
Date May 2017	Location:	Stage Two (A-E) and Three (A-G), The Surrounds		
Checked CS	Client:	Villawood Developments		



Soil Surveys Engineering Pty Limited
Specialists in Applied Geotechnics
A.B.N. 70 054 043 631

www.soilsurveys.com.au

Principals

PJ Dixon
NT Perkins
MV Geale
GEJ Gray
CP Johnson

BE(Hons) RPEQ
BAppSc(AppGeol) BEng(Hons1) RPEQ
BEng(Civil) MBA CPEng MIE Aust RPEQ
BEng(Civil) RPEQ

Gold Coast Office

Job No: 214-11753

Ref: Controlled Filling - Lot 2074

Author: Curtis Skinner

15 May 2017

Villawood Developments

Country Club Drive

Helensvale QLD 4212

Email: michaelw@villawoodproperties.com

**RE: CONTROLLED FILLING – LOT 2074
THE SURROUNDS – STAGE TWO – 2A – 2E**

Fill was placed on this lot during the construction of this estate.

Soil Surveys Engineering Pty Ltd was commissioned on this project to provide earthworks inspection and testing services in general accordance with AS 3798-2007 "Guidelines on earthworks for commercial and residential developments". Full details of the inspection and testing program are provided in the Soil Surveys Engineering report (ref 2-11753, 2017-05-04, BR VER 1).

Based on the inspection and testing services carried out by Soils Surveys Engineering Pty Limited, it is considered that the fill placed at Lot 2074 of The Surrounds – Stage Two – as shown on all attached plans, has been carried out in a responsible manner and in accordance with table 5.1.1 AS 3798 and the project specifications.

All fill in the areas defined in the attached lot location plan, within the time frame of our inspection and testing program between 16/08/2016 and 12/05/2017 (excluding topsoil placed subsequent to completion of controlled filling) is considered to be "controlled fill" in accordance with AS 2870 "Residential Slabs and Footings" (Clause 6.4.2 (a)) and AS 3798.

Unless otherwise stated, this earthworks assessment does not address any other geotechnical issues which may be relevant to building construction and serviceability.

A full geotechnical site investigation/site classification and foundation design should be carried out by suitably qualified and experienced personnel for the proposed residential construction.

SOIL SURVEYS ENGINEERING PTY LIMITED

Attached: Drawing Showing Location of Lot

Celebrating over 40 years in Geotechnics

Ph +617 3369 6000 Fax +617 3369 6660

PO Box 317, Milton, QLD, 4064, Australia

info@soilsurveys.com.au

Brisbane, Level 2, 19 Finchley Street, Milton, QLD, 4064
Gold Coast, Unit 8, 140 Millaroo Drive, Helensvale, QLD 4212



SOIL SURVEYS ENGINEERING PTY LIMITED
A.C.N. 054 043 631
Consulting Geotechnical Engineers

Drawn BI	Project:	Certification Of Earthwork	Drawing No. 2-11753-03	A4
Date May 2017	Location:	Stage Two (A-E) and Three (A-G), The Surrounds		
Checked CS	Client:	Villawood Developments		



Soil Surveys Engineering Pty Limited
Specialists in Applied Geotechnics
A.B.N. 70 054 043 631

www.soilsurveys.com.au

Principals

PJ Dixon
NT Perkins
MV Geale
GEJ Gray
CP Johnson

BE(Hons) RPEQ
BAppSc(AppGeol) BEng(Hons1) RPEQ
BEng(Civil) MBA CPEng MIE Aust RPEQ
BEng(Civil) RPEQ

Gold Coast Office

Job No: 214-11753

Ref: Controlled Filling - Lot 2075

Author: Curtis Skinner

15 May 2017

Villawood Developments

Country Club Drive

Helensvale QLD 4212

Email: michaelw@villawoodproperties.com

**RE: CONTROLLED FILLING – LOT 2075
THE SURROUNDS – STAGE TWO – 2A – 2E**

Fill was placed on this lot during the construction of this estate.

Soil Surveys Engineering Pty Ltd was commissioned on this project to provide earthworks inspection and testing services in general accordance with AS 3798-2007 "Guidelines on earthworks for commercial and residential developments". Full details of the inspection and testing program are provided in the Soil Surveys Engineering report (ref 2-11753, 2017-05-04, BR VER 1).

Based on the inspection and testing services carried out by Soils Surveys Engineering Pty Limited, it is considered that the fill placed at Lot 2075 of The Surrounds – Stage Two – as shown on all attached plans, has been carried out in a responsible manner and in accordance with table 5.1.1 AS 3798 and the project specifications.

All fill in the areas defined in the attached lot location plan, within the time frame of our inspection and testing program between 16/08/2016 and 12/05/2017 (excluding topsoil placed subsequent to completion of controlled filling) is considered to be "controlled fill" in accordance with AS 2870 "Residential Slabs and Footings" (Clause 6.4.2 (a)) and AS 3798.

Unless otherwise stated, this earthworks assessment does not address any other geotechnical issues which may be relevant to building construction and serviceability.

A full geotechnical site investigation/site classification and foundation design should be carried out by suitably qualified and experienced personnel for the proposed residential construction.

SOIL SURVEYS ENGINEERING PTY LIMITED

Attached: Drawing Showing Location of Lot

Celebrating over 40 years in Geotechnics

Ph +617 3369 6000 Fax +617 3369 6660

PO Box 317, Milton, QLD, 4064, Australia

info@soilsurveys.com.au

Brisbane, Level 2, 19 Finchley Street, Milton, QLD, 4064

Gold Coast, Unit 8, 140 Millaroo Drive, Helensvale, QLD 4212



SOIL SURVEYS ENGINEERING PTY LIMITED
A.C.N. 054 043 631
Consulting Geotechnical Engineers

Drawn BI	Project:	Certification Of Earthwork	Drawing No. 2-11753-03	A4
Date May 2017	Location:	Stage Two (A-E) and Three (A-G), The Surrounds		
Checked CS	Client:	Villawood Developments		



Soil Surveys Engineering Pty Limited
Specialists in Applied Geotechnics
A.B.N. 70 054 043 631

www.soilsurveys.com.au

Principals

PJ Dixon
NT Perkins
MV Geale
GEJ Gray
CP Johnson

BE(Hons) RPEQ
BAppSc(AppGeol) BEng(Hons1) RPEQ
BEng(Civil) MBA CPEng MIE Aust RPEQ
BEng(Civil) RPEQ

Gold Coast Office

Job No: 214-11753

Ref: Controlled Filling - Lot 2076

Author: Curtis Skinner

15 May 2017

Villawood Developments

Country Club Drive

Helensvale QLD 4212

Email: michaelw@villawoodproperties.com

**RE: CONTROLLED FILLING – LOT 2076
THE SURROUNDS – STAGE TWO – 2A – 2E**

Fill was placed on this lot during the construction of this estate.

Soil Surveys Engineering Pty Ltd was commissioned on this project to provide earthworks inspection and testing services in general accordance with AS 3798-2007 "Guidelines on earthworks for commercial and residential developments". Full details of the inspection and testing program are provided in the Soil Surveys Engineering report (ref 2-11753, 2017-05-04, BR VER 1).

Based on the inspection and testing services carried out by Soils Surveys Engineering Pty Limited, it is considered that the fill placed at Lot 2076 of The Surrounds – Stage Two – as shown on all attached plans, has been carried out in a responsible manner and in accordance with table 5.1.1 AS 3798 and the project specifications.

All fill in the areas defined in the attached lot location plan, within the time frame of our inspection and testing program between 16/08/2016 and 12/05/2017 (excluding topsoil placed subsequent to completion of controlled filling) is considered to be "controlled fill" in accordance with AS 2870 "Residential Slabs and Footings" (Clause 6.4.2 (a)) and AS 3798.

Unless otherwise stated, this earthworks assessment does not address any other geotechnical issues which may be relevant to building construction and serviceability.

A full geotechnical site investigation/site classification and foundation design should be carried out by suitably qualified and experienced personnel for the proposed residential construction.

SOIL SURVEYS ENGINEERING PTY LIMITED

Attached: Drawing Showing Location of Lot

Celebrating over 40 years in Geotechnics

Ph +617 3369 6000 Fax +617 3369 6660

PO Box 317, Milton, QLD, 4064, Australia

info@soilsurveys.com.au

Brisbane, Level 2, 19 Finchley Street, Milton, QLD, 4064
Gold Coast, Unit 8, 140 Millaroo Drive, Helensvale, QLD 4212



SOIL SURVEYS ENGINEERING PTY LIMITED
A.C.N. 054 043 631
Consulting Geotechnical Engineers

Drawn BI	Project:	Certification Of Earthwork	Drawing No. 2-11753-03	A4
Date May 2017	Location:	Stage Two (A-E) and Three (A-G), The Surrounds		
Checked CS	Client:	Villawood Developments		



Soil Surveys Engineering Pty Limited
Specialists in Applied Geotechnics
A.B.N. 70 054 043 631

www.soilsurveys.com.au

Principals

PJ Dixon
NT Perkins
MV Geale
GEJ Gray
CP Johnson

BE(Hons) RPEQ
BAppSc(AppGeol) BEng(Hons1) RPEQ
BEng(Civil) MBA CPEng MIE Aust RPEQ
BEng(Civil) RPEQ

Gold Coast Office

Job No: 214-11753

Ref: Controlled Filling - Lot 2077

Author: Curtis Skinner

15 May 2017

Villawood Developments

Country Club Drive

Helensvale QLD 4212

Email: michaelw@villawoodproperties.com

**RE: CONTROLLED FILLING – LOT 2077
THE SURROUNDS – STAGE TWO – 2A – 2E**

Fill was placed on this lot during the construction of this estate.

Soil Surveys Engineering Pty Ltd was commissioned on this project to provide earthworks inspection and testing services in general accordance with AS 3798-2007 "Guidelines on earthworks for commercial and residential developments". Full details of the inspection and testing program are provided in the Soil Surveys Engineering report (ref 2-11753, 2017-05-04, BR VER 1).

Based on the inspection and testing services carried out by Soils Surveys Engineering Pty Limited, it is considered that the fill placed at Lot 2077 of The Surrounds – Stage Two – as shown on all attached plans, has been carried out in a responsible manner and in accordance with table 5.1.1 AS 3798 and the project specifications.

All fill in the areas defined in the attached lot location plan, within the time frame of our inspection and testing program between 16/08/2016 and 12/05/2017 (excluding topsoil placed subsequent to completion of controlled filling) is considered to be "controlled fill" in accordance with AS 2870 "Residential Slabs and Footings" (Clause 6.4.2 (a)) and AS 3798.

Unless otherwise stated, this earthworks assessment does not address any other geotechnical issues which may be relevant to building construction and serviceability.

A full geotechnical site investigation/site classification and foundation design should be carried out by suitably qualified and experienced personnel for the proposed residential construction.

SOIL SURVEYS ENGINEERING PTY LIMITED

Attached: Drawing Showing Location of Lot

Celebrating over 40 years in Geotechnics

Ph +617 3369 6000 Fax +617 3369 6660

PO Box 317, Milton, QLD, 4064, Australia

info@soilsurveys.com.au

Brisbane, Level 2, 19 Finchley Street, Milton, QLD, 4064
Gold Coast, Unit 8, 140 Millaroo Drive, Helensvale, QLD 4212



SOIL SURVEYS ENGINEERING PTY LIMITED
A.C.N. 054 043 631
Consulting Geotechnical Engineers

Drawn BI	Project:	Certification Of Earthwork	Drawing No. 2-11753-03	A4
Date May 2017	Location:	Stage Two (A-E) and Three (A-G), The Surrounds		
Checked CS	Client:	Villawood Developments		



Soil Surveys Engineering Pty Limited
Specialists in Applied Geotechnics
A.B.N. 70 054 043 631

www.soilsurveys.com.au

Principals

PJ Dixon
NT Perkins
MV Geale
GEJ Gray
CP Johnson

BE(Hons) RPEQ
BAppSc(AppGeol) BEng(Hons1) RPEQ
BEng(Civil) MBA CPEng MIE Aust RPEQ
BEng(Civil) RPEQ

Gold Coast Office

Job No: 214-11753

Ref: Controlled Filling - Lot 2078

Author: Curtis Skinner

15 May 2017

Villawood Developments

Country Club Drive

Helensvale QLD 4212

Email: michaelw@villawoodproperties.com

**RE: CONTROLLED FILLING – LOT 2078
THE SURROUNDS – STAGE TWO – 2A – 2E**

Fill was placed on this lot during the construction of this estate.

Soil Surveys Engineering Pty Ltd was commissioned on this project to provide earthworks inspection and testing services in general accordance with AS 3798-2007 "Guidelines on earthworks for commercial and residential developments". Full details of the inspection and testing program are provided in the Soil Surveys Engineering report (ref 2-11753, 2017-05-04, BR VER 1).

Based on the inspection and testing services carried out by Soils Surveys Engineering Pty Limited, it is considered that the fill placed at Lot 2078 of The Surrounds – Stage Two – as shown on all attached plans, has been carried out in a responsible manner and in accordance with table 5.1.1 AS 3798 and the project specifications.

All fill in the areas defined in the attached lot location plan, within the time frame of our inspection and testing program between 16/08/2016 and 12/05/2017 (excluding topsoil placed subsequent to completion of controlled filling) is considered to be "controlled fill" in accordance with AS 2870 "Residential Slabs and Footings" (Clause 6.4.2 (a)) and AS 3798.

Unless otherwise stated, this earthworks assessment does not address any other geotechnical issues which may be relevant to building construction and serviceability.

A full geotechnical site investigation/site classification and foundation design should be carried out by suitably qualified and experienced personnel for the proposed residential construction.

SOIL SURVEYS ENGINEERING PTY LIMITED

Attached: Drawing Showing Location of Lot

Celebrating over 40 years in Geotechnics

Ph +617 3369 6000 Fax +617 3369 6660

PO Box 317, Milton, QLD, 4064, Australia

info@soilsurveys.com.au

Brisbane, Level 2, 19 Finchley Street, Milton, QLD, 4064
Gold Coast, Unit 8, 140 Millaroo Drive, Helensvale, QLD 4212



SOIL SURVEYS ENGINEERING PTY LIMITED
A.C.N. 054 043 631
Consulting Geotechnical Engineers

Drawn BI	Project:	Certification Of Earthwork	Drawing No. 2-11753-03	A4
Date May 2017	Location:	Stage Two (A-E) and Three (A-G), The Surrounds		
Checked CS	Client:	Villawood Developments		



Soil Surveys Engineering Pty Limited
Specialists in Applied Geotechnics
A.B.N. 70 054 043 631

www.soilsurveys.com.au

Principals

PJ Dixon
NT Perkins
MV Geale
GEJ Gray
CP Johnson

BE(Hons) RPEQ
BAppSc(AppGeol) BEng(Hons1) RPEQ
BEng(Civil) MBA CPEng MIE Aust RPEQ
BEng(Civil) RPEQ

Gold Coast Office

Job No: 214-11753

Ref: Controlled Filling - Lot 2079

Author: Curtis Skinner

15 May 2017

Villawood Developments

Country Club Drive

Helensvale QLD 4212

Email: michaelw@villawoodproperties.com

**RE: CONTROLLED FILLING – LOT 2079
THE SURROUNDS – STAGE TWO – 2A – 2E**

Fill was placed on this lot during the construction of this estate.

Soil Surveys Engineering Pty Ltd was commissioned on this project to provide earthworks inspection and testing services in general accordance with AS 3798-2007 "Guidelines on earthworks for commercial and residential developments". Full details of the inspection and testing program are provided in the Soil Surveys Engineering report (ref 2-11753, 2017-05-04, BR VER 1).

Based on the inspection and testing services carried out by Soils Surveys Engineering Pty Limited, it is considered that the fill placed at Lot 2079 of The Surrounds – Stage Two – as shown on all attached plans, has been carried out in a responsible manner and in accordance with table 5.1.1 AS 3798 and the project specifications.

All fill in the areas defined in the attached lot location plan, within the time frame of our inspection and testing program between 16/08/2016 and 12/05/2017 (excluding topsoil placed subsequent to completion of controlled filling) is considered to be "controlled fill" in accordance with AS 2870 "Residential Slabs and Footings" (Clause 6.4.2 (a)) and AS 3798.

Unless otherwise stated, this earthworks assessment does not address any other geotechnical issues which may be relevant to building construction and serviceability.

A full geotechnical site investigation/site classification and foundation design should be carried out by suitably qualified and experienced personnel for the proposed residential construction.

SOIL SURVEYS ENGINEERING PTY LIMITED

Attached: Drawing Showing Location of Lot

Celebrating over 40 years in Geotechnics

Ph +617 3369 6000 Fax +617 3369 6660

PO Box 317, Milton, QLD, 4064, Australia

info@soilsurveys.com.au

Brisbane, Level 2, 19 Finchley Street, Milton, QLD, 4064
Gold Coast, Unit 8, 140 Millaroo Drive, Helensvale, QLD 4212



SOIL SURVEYS ENGINEERING PTY LIMITED
A.C.N. 054 043 631
Consulting Geotechnical Engineers

Drawn BI	Project:	Certification Of Earthwork	Drawing No. 2-11753-03	A4
Date May 2017	Location:	Stage Two (A-E) and Three (A-G), The Surrounds		
Checked CS	Client:	Villawood Developments		



Soil Surveys Engineering Pty Limited
Specialists in Applied Geotechnics
A.B.N. 70 054 043 631

www.soilsurveys.com.au

Principals

PJ Dixon
NT Perkins
MV Geale
GEJ Gray
CP Johnson

BE(Hons) RPEQ
BAppSc(AppGeol) BEng(Hons1) RPEQ
BEng(Civil) MBA CPEng MIE Aust RPEQ
BEng(Civil) RPEQ

Gold Coast Office

Job No: 214-11753

Ref: Controlled Filling - Lot 2080

Author: Curtis Skinner

15 May 2017

Villawood Developments

Country Club Drive

Helensvale QLD 4212

Email: michaelw@villawoodproperties.com

**RE: CONTROLLED FILLING – LOT 2080
THE SURROUNDS – STAGE TWO – 2A – 2E**

Fill was placed on this lot during the construction of this estate.

Soil Surveys Engineering Pty Ltd was commissioned on this project to provide earthworks inspection and testing services in general accordance with AS 3798-2007 "Guidelines on earthworks for commercial and residential developments". Full details of the inspection and testing program are provided in the Soil Surveys Engineering report (ref 2-11753, 2017-05-04, BR VER 1).

Based on the inspection and testing services carried out by Soils Surveys Engineering Pty Limited, it is considered that the fill placed at Lot 2080 of The Surrounds – Stage Two – as shown on all attached plans, has been carried out in a responsible manner and in accordance with table 5.1.1 AS 3798 and the project specifications.

All fill in the areas defined in the attached lot location plan, within the time frame of our inspection and testing program between 16/08/2016 and 12/05/2017 (excluding topsoil placed subsequent to completion of controlled filling) is considered to be "controlled fill" in accordance with AS 2870 "Residential Slabs and Footings" (Clause 6.4.2 (a)) and AS 3798.

Unless otherwise stated, this earthworks assessment does not address any other geotechnical issues which may be relevant to building construction and serviceability.

A full geotechnical site investigation/site classification and foundation design should be carried out by suitably qualified and experienced personnel for the proposed residential construction.

SOIL SURVEYS ENGINEERING PTY LIMITED

Attached: Drawing Showing Location of Lot

Celebrating over 40 years in Geotechnics

Ph +617 3369 6000 Fax +617 3369 6660

PO Box 317, Milton, QLD, 4064, Australia

info@soilsurveys.com.au

Brisbane, Level 2, 19 Finchley Street, Milton, QLD, 4064
Gold Coast, Unit 8, 140 Millaroo Drive, Helensvale, QLD 4212



SOIL SURVEYS ENGINEERING PTY LIMITED
A.C.N. 054 043 631
Consulting Geotechnical Engineers

Drawn BI	Project:	Certification Of Earthwork	Drawing No. 2-11753-03	A4
Date May 2017	Location:	Stage Two (A-E) and Three (A-G), The Surrounds		
Checked CS	Client:	Villawood Developments		



Soil Surveys Engineering Pty Limited
Specialists in Applied Geotechnics
A.B.N. 70 054 043 631

www.soilsurveys.com.au

Principals

PJ Dixon
NT Perkins
MV Geale
GEJ Gray
CP Johnson

BE(Hons) RPEQ
BAppSc(AppGeol) BEng(Hons1) RPEQ
BEng(Civil) MBA CPEng MIE Aust RPEQ
BEng(Civil) RPEQ

Gold Coast Office

Job No: 214-11753
Ref: Controlled Filling - Lot 2081
Author: Curtis Skinner

15 May 2017

Villawood Developments
Country Club Drive
Helensvale QLD 4212
Email: michaelw@villawoodproperties.com

**RE: CONTROLLED FILLING – LOT 2081
THE SURROUNDS – STAGE TWO – 2A – 2E**

Fill was placed on this lot during the construction of this estate.

Soil Surveys Engineering Pty Ltd was commissioned on this project to provide earthworks inspection and testing services in general accordance with AS 3798-2007 "Guidelines on earthworks for commercial and residential developments". Full details of the inspection and testing program are provided in the Soil Surveys Engineering report (ref 2-11753, 2017-05-04, BR VER 1).

Based on the inspection and testing services carried out by Soils Surveys Engineering Pty Limited, it is considered that the fill placed at Lot 2081 of The Surrounds – Stage Two – as shown on all attached plans, has been carried out in a responsible manner and in accordance with table 5.1.1 AS 3798 and the project specifications.

All fill in the areas defined in the attached lot location plan, within the time frame of our inspection and testing program between 16/08/2016 and 12/05/2017 (excluding topsoil placed subsequent to completion of controlled filling) is considered to be "controlled fill" in accordance with AS 2870 "Residential Slabs and Footings" (Clause 6.4.2 (a)) and AS 3798.

Unless otherwise stated, this earthworks assessment does not address any other geotechnical issues which may be relevant to building construction and serviceability.

A full geotechnical site investigation/site classification and foundation design should be carried out by suitably qualified and experienced personnel for the proposed residential construction.

SOIL SURVEYS ENGINEERING PTY LIMITED

Attached: Drawing Showing Location of Lot

Celebrating over 40 years in Geotechnics

Ph +617 3369 6000 Fax +617 3369 6660
PO Box 317, Milton, QLD, 4064, Australia
info@soilsurveys.com.au
Brisbane, Level 2, 19 Finchley Street, Milton, QLD, 4064
Gold Coast, Unit 8, 140 Millaroo Drive, Helensvale, QLD 4212



SOIL SURVEYS ENGINEERING PTY LIMITED
A.C.N. 054 043 631
Consulting Geotechnical Engineers

Drawn BI	Project:	Certification Of Earthwork	Drawing No. 2-11753-03	A4
Date May 2017	Location:	Stage Two (A-E) and Three (A-G), The Surrounds		
Checked CS	Client:	Villawood Developments		



Soil Surveys Engineering Pty Limited
Specialists in Applied Geotechnics
A.B.N. 70 054 043 631

www.soilsurveys.com.au

Principals

PJ Dixon
NT Perkins
MV Geale
GEJ Gray
CP Johnson

BE(Hons) RPEQ
BAppSc(AppGeol) BEng(Hons1) RPEQ
BEng(Civil) MBA CPEng MIE Aust RPEQ
BEng(Civil) RPEQ

Gold Coast Office

Job No: 214-11753

Ref: Controlled Filling - Lot 2082

Author: Curtis Skinner

15 May 2017

Villawood Developments

Country Club Drive

Helensvale QLD 4212

Email: michaelw@villawoodproperties.com

**RE: CONTROLLED FILLING – LOT 2082
THE SURROUNDS – STAGE TWO – 2A – 2E**

Fill was placed on this lot during the construction of this estate.

Soil Surveys Engineering Pty Ltd was commissioned on this project to provide earthworks inspection and testing services in general accordance with AS 3798-2007 "Guidelines on earthworks for commercial and residential developments". Full details of the inspection and testing program are provided in the Soil Surveys Engineering report (ref 2-11753, 2017-05-04, BR VER 1).

Based on the inspection and testing services carried out by Soils Surveys Engineering Pty Limited, it is considered that the fill placed at Lot 2082 of The Surrounds – Stage Two – as shown on all attached plans, has been carried out in a responsible manner and in accordance with table 5.1.1 AS 3798 and the project specifications.

All fill in the areas defined in the attached lot location plan, within the time frame of our inspection and testing program between 16/08/2016 and 12/05/2017 (excluding topsoil placed subsequent to completion of controlled filling) is considered to be "controlled fill" in accordance with AS 2870 "Residential Slabs and Footings" (Clause 6.4.2 (a)) and AS 3798.

Unless otherwise stated, this earthworks assessment does not address any other geotechnical issues which may be relevant to building construction and serviceability.

A full geotechnical site investigation/site classification and foundation design should be carried out by suitably qualified and experienced personnel for the proposed residential construction.

SOIL SURVEYS ENGINEERING PTY LIMITED

Attached: Drawing Showing Location of Lot

Celebrating over 40 years in Geotechnics

Ph +617 3369 6000 Fax +617 3369 6660

PO Box 317, Milton, QLD, 4064, Australia

info@soilsurveys.com.au

Brisbane, Level 2, 19 Finchley Street, Milton, QLD, 4064
Gold Coast, Unit 8, 140 Millaroo Drive, Helensvale, QLD 4212



SOIL SURVEYS ENGINEERING PTY LIMITED
A.C.N. 054 043 631
Consulting Geotechnical Engineers

Drawn BI	Project:	Certification Of Earthwork	Drawing No. 2-11753-03	A4
Date May 2017	Location:	Stage Two (A-E) and Three (A-G), The Surrounds		
Checked CS	Client:	Villawood Developments		



Soil Surveys Engineering Pty Limited
Specialists in Applied Geotechnics
A.B.N. 70 054 043 631

www.soilsurveys.com.au

Principals

PJ Dixon
NT Perkins
MV Geale
GEJ Gray
CP Johnson

BE(Hons) RPEQ
BAppSc(AppGeol) BEng(Hons1) RPEQ
BEng(Civil) MBA CPEng MIE Aust RPEQ
BEng(Civil) RPEQ

Gold Coast Office

Job No: 214-11753

Ref: Controlled Filling - Lot 2083

Author: Curtis Skinner

15 May 2017

Villawood Developments

Country Club Drive

Helensvale QLD 4212

Email: michaelw@villawoodproperties.com

**RE: CONTROLLED FILLING – LOT 2083
THE SURROUNDS – STAGE TWO – 2A – 2E**

Fill was placed on this lot during the construction of this estate.

Soil Surveys Engineering Pty Ltd was commissioned on this project to provide earthworks inspection and testing services in general accordance with AS 3798-2007 "Guidelines on earthworks for commercial and residential developments". Full details of the inspection and testing program are provided in the Soil Surveys Engineering report (ref 2-11753, 2017-05-04, BR VER 1).

Based on the inspection and testing services carried out by Soils Surveys Engineering Pty Limited, it is considered that the fill placed at Lot 2083 of The Surrounds – Stage Two – as shown on all attached plans, has been carried out in a responsible manner and in accordance with table 5.1.1 AS 3798 and the project specifications.

All fill in the areas defined in the attached lot location plan, within the time frame of our inspection and testing program between 16/08/2016 and 12/05/2017 (excluding topsoil placed subsequent to completion of controlled filling) is considered to be "controlled fill" in accordance with AS 2870 "Residential Slabs and Footings" (Clause 6.4.2 (a)) and AS 3798.

Unless otherwise stated, this earthworks assessment does not address any other geotechnical issues which may be relevant to building construction and serviceability.

A full geotechnical site investigation/site classification and foundation design should be carried out by suitably qualified and experienced personnel for the proposed residential construction.

SOIL SURVEYS ENGINEERING PTY LIMITED

Attached: Drawing Showing Location of Lot

Celebrating over 40 years in Geotechnics

Ph +617 3369 6000 Fax +617 3369 6660

PO Box 317, Milton, QLD, 4064, Australia

info@soilsurveys.com.au

Brisbane, Level 2, 19 Finchley Street, Milton, QLD, 4064
Gold Coast, Unit 8, 140 Millaroo Drive, Helensvale, QLD 4212



SOIL SURVEYS ENGINEERING PTY LIMITED
A.C.N. 054 043 631
Consulting Geotechnical Engineers

Drawn BI	Project:	Certification Of Earthwork	Drawing No. 2-11753-03	A4
Date May 2017	Location:	Stage Two (A-E) and Three (A-G), The Surrounds		
Checked CS	Client:	Villawood Developments		



Soil Surveys Engineering Pty Limited
Specialists in Applied Geotechnics
A.B.N. 70 054 043 631

www.soilsurveys.com.au

Principals

PJ Dixon
NT Perkins
MV Geale
GEJ Gray
CP Johnson

BE(Hons) RPEQ
BAppSc(AppGeol) BEng(Hons1) RPEQ
BEng(Civil) MBA CPEng MIE Aust RPEQ
BEng(Civil) RPEQ

Gold Coast Office

Job No: 214-11753

Ref: Controlled Filling - Lot 2084

Author: Curtis Skinner

15 May 2017

Villawood Developments

Country Club Drive

Helensvale QLD 4212

Email: michaelw@villawoodproperties.com

**RE: CONTROLLED FILLING – LOT 2084
THE SURROUNDS – STAGE TWO – 2A – 2E**

Fill was placed on this lot during the construction of this estate.

Soil Surveys Engineering Pty Ltd was commissioned on this project to provide earthworks inspection and testing services in general accordance with AS 3798-2007 "Guidelines on earthworks for commercial and residential developments". Full details of the inspection and testing program are provided in the Soil Surveys Engineering report (ref 2-11753, 2017-05-04, BR VER 1).

Based on the inspection and testing services carried out by Soils Surveys Engineering Pty Limited, it is considered that the fill placed at Lot 2084 of The Surrounds – Stage Two – as shown on all attached plans, has been carried out in a responsible manner and in accordance with table 5.1.1 AS 3798 and the project specifications.

All fill in the areas defined in the attached lot location plan, within the time frame of our inspection and testing program between 16/08/2016 and 12/05/2017 (excluding topsoil placed subsequent to completion of controlled filling) is considered to be "controlled fill" in accordance with AS 2870 "Residential Slabs and Footings" (Clause 6.4.2 (a)) and AS 3798.

Unless otherwise stated, this earthworks assessment does not address any other geotechnical issues which may be relevant to building construction and serviceability.

A full geotechnical site investigation/site classification and foundation design should be carried out by suitably qualified and experienced personnel for the proposed residential construction.

SOIL SURVEYS ENGINEERING PTY LIMITED

Attached: Drawing Showing Location of Lot

Celebrating over 40 years in Geotechnics

Ph +617 3369 6000 Fax +617 3369 6660

PO Box 317, Milton, QLD, 4064, Australia

info@soilsurveys.com.au

Brisbane, Level 2, 19 Finchley Street, Milton, QLD, 4064
Gold Coast, Unit 8, 140 Millaroo Drive, Helensvale, QLD 4212



SOIL SURVEYS ENGINEERING PTY LIMITED
A.C.N. 054 043 631
Consulting Geotechnical Engineers

Drawn BI	Project:	Certification Of Earthwork	Drawing No. 2-11753-03	A4
Date May 2017	Location:	Stage Two (A-E) and Three (A-G), The Surrounds		
Checked CS	Client:	Villawood Developments		



Soil Surveys Engineering Pty Limited
Specialists in Applied Geotechnics
A.B.N. 70 054 043 631

www.soilsurveys.com.au

Principals

PJ Dixon
NT Perkins
MV Geale
GEJ Gray
CP Johnson

BE(Hons) RPEQ
BAppSc(AppGeol) BEng(Hons1) RPEQ
BEng(Civil) MBA CPEng MIE Aust RPEQ
BEng(Civil) RPEQ

Gold Coast Office

Job No: 214-11753

Ref: Controlled Filling - Lot 2085

Author: Curtis Skinner

15 May 2017

Villawood Developments

Country Club Drive

Helensvale QLD 4212

Email: michaelw@villawoodproperties.com

**RE: CONTROLLED FILLING – LOT 2085
THE SURROUNDS – STAGE TWO – 2A – 2E**

Fill was placed on this lot during the construction of this estate.

Soil Surveys Engineering Pty Ltd was commissioned on this project to provide earthworks inspection and testing services in general accordance with AS 3798-2007 "Guidelines on earthworks for commercial and residential developments". Full details of the inspection and testing program are provided in the Soil Surveys Engineering report (ref 2-11753, 2017-05-04, BR VER 1).

Based on the inspection and testing services carried out by Soils Surveys Engineering Pty Limited, it is considered that the fill placed at Lot 2085 of The Surrounds – Stage Two – as shown on all attached plans, has been carried out in a responsible manner and in accordance with table 5.1.1 AS 3798 and the project specifications.

All fill in the areas defined in the attached lot location plan, within the time frame of our inspection and testing program between 16/08/2016 and 12/05/2017 (excluding topsoil placed subsequent to completion of controlled filling) is considered to be "controlled fill" in accordance with AS 2870 "Residential Slabs and Footings" (Clause 6.4.2 (a)) and AS 3798.

Unless otherwise stated, this earthworks assessment does not address any other geotechnical issues which may be relevant to building construction and serviceability.

A full geotechnical site investigation/site classification and foundation design should be carried out by suitably qualified and experienced personnel for the proposed residential construction.

SOIL SURVEYS ENGINEERING PTY LIMITED

Attached: Drawing Showing Location of Lot

Celebrating over 40 years in Geotechnics

Ph +617 3369 6000 Fax +617 3369 6660

PO Box 317, Milton, QLD, 4064, Australia

info@soilsurveys.com.au

Brisbane, Level 2, 19 Finchley Street, Milton, QLD, 4064
Gold Coast, Unit 8, 140 Millaroo Drive, Helensvale, QLD 4212



SOIL SURVEYS ENGINEERING PTY LIMITED
A.C.N. 054 043 631
Consulting Geotechnical Engineers

Drawn BI	Project:	Certification Of Earthwork	Drawing No. 2-11753-03	A4
Date May 2017	Location:	Stage Two (A-E) and Three (A-G), The Surrounds		
Checked CS	Client:	Villawood Developments		



Soil Surveys Engineering Pty Limited
Specialists in Applied Geotechnics
A.B.N. 70 054 043 631

www.soilsurveys.com.au

Principals

PJ Dixon
NT Perkins
MV Geale
GEJ Gray
CP Johnson

BE(Hons) RPEQ
BAppSc(AppGeol) BEng(Hons1) RPEQ
BEng(Civil) MBA CPEng MIE Aust RPEQ
BEng(Civil) RPEQ

Gold Coast Office

Job No: 214-11753
Ref: Controlled Filling - Lot 2086
Author: Curtis Skinner

15 May 2017

Villawood Developments
Country Club Drive
Helensvale QLD 4212
Email: michaelw@villawoodproperties.com

**RE: CONTROLLED FILLING – LOT 2086
THE SURROUNDS – STAGE TWO – 2A – 2E**

Fill was placed on this lot during the construction of this estate.

Soil Surveys Engineering Pty Ltd was commissioned on this project to provide earthworks inspection and testing services in general accordance with AS 3798-2007 "Guidelines on earthworks for commercial and residential developments". Full details of the inspection and testing program are provided in the Soil Surveys Engineering report (ref 2-11753, 2017-05-04, BR VER 1).

Based on the inspection and testing services carried out by Soils Surveys Engineering Pty Limited, it is considered that the fill placed at Lot 2086 of The Surrounds – Stage Two – as shown on all attached plans, has been carried out in a responsible manner and in accordance with table 5.1.1 AS 3798 and the project specifications.

All fill in the areas defined in the attached lot location plan, within the time frame of our inspection and testing program between 16/08/2016 and 12/05/2017 (excluding topsoil placed subsequent to completion of controlled filling) is considered to be "controlled fill" in accordance with AS 2870 "Residential Slabs and Footings" (Clause 6.4.2 (a)) and AS 3798.

Unless otherwise stated, this earthworks assessment does not address any other geotechnical issues which may be relevant to building construction and serviceability.

A full geotechnical site investigation/site classification and foundation design should be carried out by suitably qualified and experienced personnel for the proposed residential construction.

SOIL SURVEYS ENGINEERING PTY LIMITED

Attached: Drawing Showing Location of Lot

Celebrating over 40 years in Geotechnics

Ph +617 3369 6000 Fax +617 3369 6660
PO Box 317, Milton, QLD, 4064, Australia
info@soilsurveys.com.au
Brisbane, Level 2, 19 Finchley Street, Milton, QLD, 4064
Gold Coast, Unit 8, 140 Millaroo Drive, Helensvale, QLD 4212



SOIL SURVEYS ENGINEERING PTY LIMITED
A.C.N. 054 043 631
Consulting Geotechnical Engineers

Drawn BI	Project:	Certification Of Earthwork	Drawing No. 2-11753-03	A4
Date May 2017	Location:	Stage Two (A-E) and Three (A-G), The Surrounds		
Checked CS	Client:	Villawood Developments		



Soil Surveys Engineering Pty Limited
Specialists in Applied Geotechnics
A.B.N. 70 054 043 631

www.soilsurveys.com.au

Principals

PJ Dixon
NT Perkins
MV Geale
GEJ Gray
CP Johnson

BE(Hons) RPEQ
BAppSc(AppGeol) BEng(Hons1) RPEQ
BEng(Civil) MBA CPEng MIE Aust RPEQ
BEng(Civil) RPEQ

Gold Coast Office

Job No: 214-11753

Ref: Controlled Filling - Lot 2087

Author: Curtis Skinner

15 May 2017

Villawood Developments

Country Club Drive

Helensvale QLD 4212

Email: michaelw@villawoodproperties.com

**RE: CONTROLLED FILLING – LOT 2087
THE SURROUNDS – STAGE TWO – 2A – 2E**

Fill was placed on this lot during the construction of this estate.

Soil Surveys Engineering Pty Ltd was commissioned on this project to provide earthworks inspection and testing services in general accordance with AS 3798-2007 "Guidelines on earthworks for commercial and residential developments". Full details of the inspection and testing program are provided in the Soil Surveys Engineering report (ref 2-11753, 2017-05-04, BR VER 1).

Based on the inspection and testing services carried out by Soils Surveys Engineering Pty Limited, it is considered that the fill placed at Lot 2087 of The Surrounds – Stage Two – as shown on all attached plans, has been carried out in a responsible manner and in accordance with table 5.1.1 AS 3798 and the project specifications.

All fill in the areas defined in the attached lot location plan, within the time frame of our inspection and testing program between 16/08/2016 and 12/05/2017 (excluding topsoil placed subsequent to completion of controlled filling) is considered to be "controlled fill" in accordance with AS 2870 "Residential Slabs and Footings" (Clause 6.4.2 (a)) and AS 3798.

Unless otherwise stated, this earthworks assessment does not address any other geotechnical issues which may be relevant to building construction and serviceability.

A full geotechnical site investigation/site classification and foundation design should be carried out by suitably qualified and experienced personnel for the proposed residential construction.

SOIL SURVEYS ENGINEERING PTY LIMITED

Attached: Drawing Showing Location of Lot

Celebrating over 40 years in Geotechnics

Ph +617 3369 6000 Fax +617 3369 6660

PO Box 317, Milton, QLD, 4064, Australia

info@soilsurveys.com.au

Brisbane, Level 2, 19 Finchley Street, Milton, QLD, 4064
Gold Coast, Unit 8, 140 Millaroo Drive, Helensvale, QLD 4212



SOIL SURVEYS ENGINEERING PTY LIMITED
A.C.N. 054 043 631
Consulting Geotechnical Engineers

Drawn BI	Project:	Certification Of Earthwork	Drawing No. 2-11753-03	A4
Date May 2017	Location:	Stage Two (A-E) and Three (A-G), The Surrounds		
Checked CS	Client:	Villawood Developments		



Soil Surveys Engineering Pty Limited
Specialists in Applied Geotechnics
A.B.N. 70 054 043 631

www.soilsurveys.com.au

Principals

PJ Dixon
NT Perkins
MV Geale
GEJ Gray
CP Johnson

BE(Hons) RPEQ
BAppSc(AppGeol) BEng(Hons1) RPEQ
BEng(Civil) MBA CPEng MIE Aust RPEQ
BEng(Civil) RPEQ

Gold Coast Office

Job No: 214-11753
Ref: Controlled Filling - Lot 2088
Author: Curtis Skinner

15 May 2017

Villawood Developments
Country Club Drive
Helensvale QLD 4212
Email: michaelw@villawoodproperties.com

**RE: CONTROLLED FILLING – LOT 2088
THE SURROUNDS – STAGE TWO – 2A – 2E**

Fill was placed on this lot during the construction of this estate.

Soil Surveys Engineering Pty Ltd was commissioned on this project to provide earthworks inspection and testing services in general accordance with AS 3798-2007 "Guidelines on earthworks for commercial and residential developments". Full details of the inspection and testing program are provided in the Soil Surveys Engineering report (ref 2-11753, 2017-05-04, BR VER 1).

Based on the inspection and testing services carried out by Soils Surveys Engineering Pty Limited, it is considered that the fill placed at Lot 2088 of The Surrounds – Stage Two – as shown on all attached plans, has been carried out in a responsible manner and in accordance with table 5.1.1 AS 3798 and the project specifications.

All fill in the areas defined in the attached lot location plan, within the time frame of our inspection and testing program between 16/08/2016 and 12/05/2017 (excluding topsoil placed subsequent to completion of controlled filling) is considered to be "controlled fill" in accordance with AS 2870 "Residential Slabs and Footings" (Clause 6.4.2 (a)) and AS 3798.

Unless otherwise stated, this earthworks assessment does not address any other geotechnical issues which may be relevant to building construction and serviceability.

A full geotechnical site investigation/site classification and foundation design should be carried out by suitably qualified and experienced personnel for the proposed residential construction.

SOIL SURVEYS ENGINEERING PTY LIMITED

Attached: Drawing Showing Location of Lot

Celebrating over 40 years in Geotechnics

Ph +617 3369 6000 Fax +617 3369 6660
PO Box 317, Milton, QLD, 4064, Australia
info@soilsurveys.com.au
Brisbane, Level 2, 19 Finchley Street, Milton, QLD, 4064
Gold Coast, Unit 8, 140 Millaroo Drive, Helensvale, QLD 4212



SOIL SURVEYS ENGINEERING PTY LIMITED
A.C.N. 054 043 631
Consulting Geotechnical Engineers

Drawn BI	Project:	Certification Of Earthwork	Drawing No. 2-11753-03	A4
Date May 2017	Location:	Stage Two (A-E) and Three (A-G), The Surrounds		
Checked CS	Client:	Villawood Developments		



Soil Surveys Engineering Pty Limited
Specialists in Applied Geotechnics
A.B.N. 70 054 043 631

www.soilsurveys.com.au

Principals

PJ Dixon
NT Perkins
MV Geale
GEJ Gray
CP Johnson

BE(Hons) RPEQ
BAppSc(AppGeol) BEng(Hons1) RPEQ
BEng(Civil) MBA CPEng MIE Aust RPEQ
BEng(Civil) RPEQ

Gold Coast Office

Job No: 214-11753
Ref: Controlled Filling - Lot 2089
Author: Curtis Skinner

15 May 2017

Villawood Developments
Country Club Drive
Helensvale QLD 4212
Email: michaelw@villawoodproperties.com

**RE: CONTROLLED FILLING – LOT 2089
THE SURROUNDS – STAGE TWO – 2A – 2E**

Fill was placed on this lot during the construction of this estate.

Soil Surveys Engineering Pty Ltd was commissioned on this project to provide earthworks inspection and testing services in general accordance with AS 3798-2007 "Guidelines on earthworks for commercial and residential developments". Full details of the inspection and testing program are provided in the Soil Surveys Engineering report (ref 2-11753, 2017-05-04, BR VER 1).

Based on the inspection and testing services carried out by Soils Surveys Engineering Pty Limited, it is considered that the fill placed at Lot 2089 of The Surrounds – Stage Two – as shown on all attached plans, has been carried out in a responsible manner and in accordance with table 5.1.1 AS 3798 and the project specifications.

All fill in the areas defined in the attached lot location plan, within the time frame of our inspection and testing program between 16/08/2016 and 12/05/2017 (excluding topsoil placed subsequent to completion of controlled filling) is considered to be "controlled fill" in accordance with AS 2870 "Residential Slabs and Footings" (Clause 6.4.2 (a)) and AS 3798.

Unless otherwise stated, this earthworks assessment does not address any other geotechnical issues which may be relevant to building construction and serviceability.

A full geotechnical site investigation/site classification and foundation design should be carried out by suitably qualified and experienced personnel for the proposed residential construction.

SOIL SURVEYS ENGINEERING PTY LIMITED

Attached: Drawing Showing Location of Lot

Celebrating over 40 years in Geotechnics

Ph +617 3369 6000 Fax +617 3369 6660
PO Box 317, Milton, QLD, 4064, Australia
info@soilsurveys.com.au
Brisbane, Level 2, 19 Finchley Street, Milton, QLD, 4064
Gold Coast, Unit 8, 140 Millaroo Drive, Helensvale, QLD 4212



SOIL SURVEYS ENGINEERING PTY LIMITED
A.C.N. 054 043 631
Consulting Geotechnical Engineers

Drawn BI	Project:	Certification Of Earthwork	Drawing No. 2-11753-03	A4
Date May 2017	Location:	Stage Two (A-E) and Three (A-G), The Surrounds		
Checked CS	Client:	Villawood Developments		



Soil Surveys Engineering Pty Limited
Specialists in Applied Geotechnics
A.B.N. 70 054 043 631

www.soilsurveys.com.au

Principals

PJ Dixon
NT Perkins
MV Geale
GEJ Gray
CP Johnson

BE(Hons) RPEQ
BAppSc(AppGeol) BEng(Hons1) RPEQ
BEng(Civil) MBA CPEng MIE Aust RPEQ
BEng(Civil) RPEQ

Gold Coast Office

Job No: 214-11753

Ref: Controlled Filling - Lot 2090

Author: Curtis Skinner

15 May 2017

Villawood Developments

Country Club Drive

Helensvale QLD 4212

Email: michaelw@villawoodproperties.com

**RE: CONTROLLED FILLING – LOT 2090
THE SURROUNDS – STAGE TWO – 2A – 2E**

Fill was placed on this lot during the construction of this estate.

Soil Surveys Engineering Pty Ltd was commissioned on this project to provide earthworks inspection and testing services in general accordance with AS 3798-2007 "Guidelines on earthworks for commercial and residential developments". Full details of the inspection and testing program are provided in the Soil Surveys Engineering report (ref 2-11753, 2017-05-04, BR VER 1).

Based on the inspection and testing services carried out by Soils Surveys Engineering Pty Limited, it is considered that the fill placed at Lot 2090 of The Surrounds – Stage Two – as shown on all attached plans, has been carried out in a responsible manner and in accordance with table 5.1.1 AS 3798 and the project specifications.

All fill in the areas defined in the attached lot location plan, within the time frame of our inspection and testing program between 16/08/2016 and 12/05/2017 (excluding topsoil placed subsequent to completion of controlled filling) is considered to be "controlled fill" in accordance with AS 2870 "Residential Slabs and Footings" (Clause 6.4.2 (a)) and AS 3798.

Unless otherwise stated, this earthworks assessment does not address any other geotechnical issues which may be relevant to building construction and serviceability.

A full geotechnical site investigation/site classification and foundation design should be carried out by suitably qualified and experienced personnel for the proposed residential construction.

SOIL SURVEYS ENGINEERING PTY LIMITED

Attached: Drawing Showing Location of Lot

Celebrating over 40 years in Geotechnics

Ph +617 3369 6000 Fax +617 3369 6660

PO Box 317, Milton, QLD, 4064, Australia

info@soilsurveys.com.au

Brisbane, Level 2, 19 Finchley Street, Milton, QLD, 4064
Gold Coast, Unit 8, 140 Millaroo Drive, Helensvale, QLD 4212

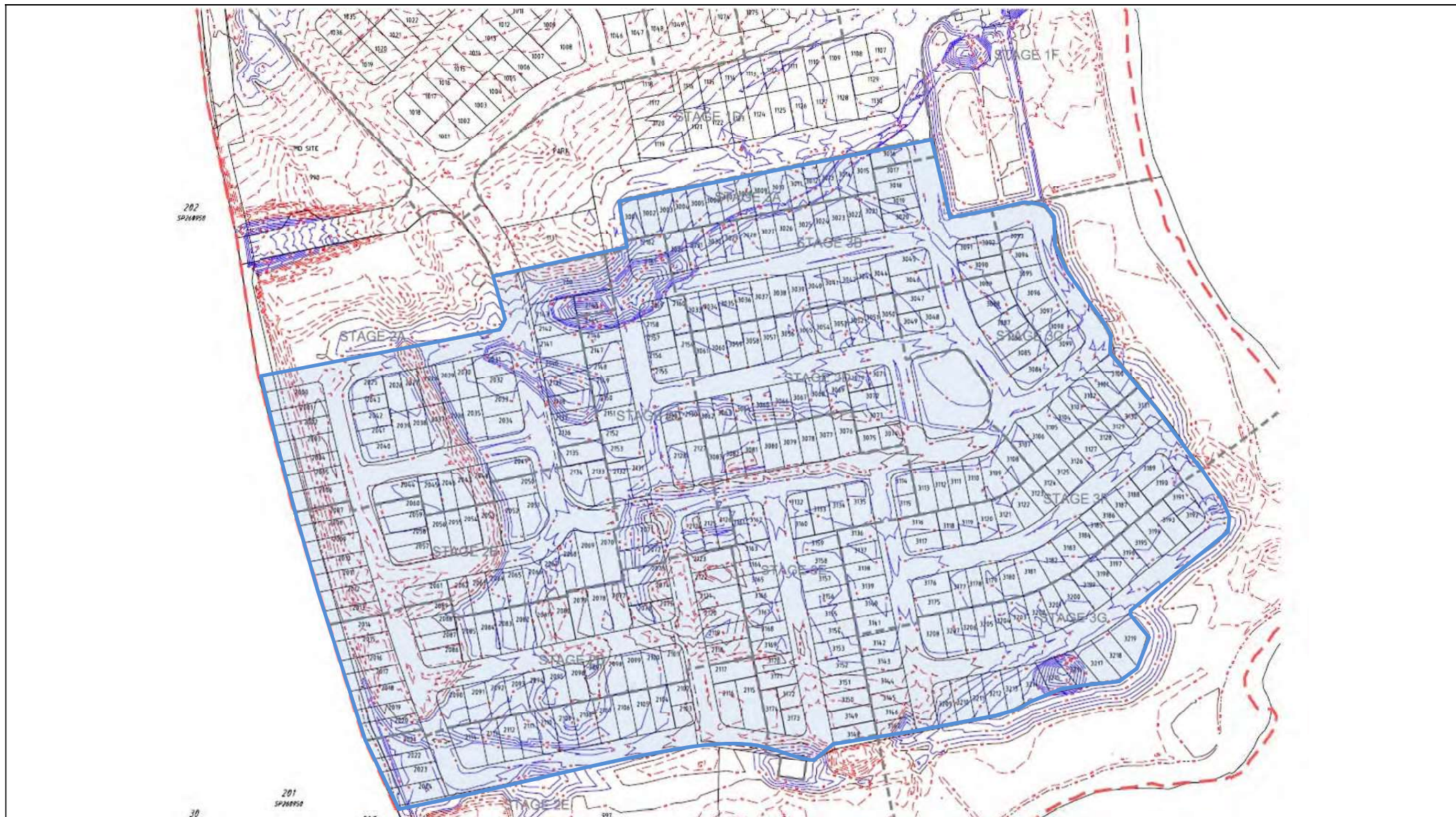

SOIL SURVEYS ENGINEERING PTY LIMITED
A.C.N. 054 043 631
Consulting Geotechnical Engineers

Drawn BI	Project:	Certification Of Earthwork	Drawing No. 2-11753-03	A4
Date May 2017	Location:	Stage Two (A-E) and Three (A-G), The Surrounds		
Checked CS	Client:	Villawood Developments		



Soil Surveys Engineering Pty Limited
Specialists in Applied Geotechnics
A.B.N. 70 054 043 631

www.soilsurveys.com.au

Principals

PJ Dixon
NT Perkins
MV Geale
GEJ Gray
CP Johnson

BE(Hons) RPEQ
BAppSc(AppGeol) BEng(Hons1) RPEQ
BEng(Civil) MBA CPEng MIE Aust RPEQ
BEng(Civil) RPEQ

Gold Coast Office

Job No: 214-11753

Ref: Controlled Filling - Lot 2091

Author: Curtis Skinner

15 May 2017

Villawood Developments

Country Club Drive

Helensvale QLD 4212

Email: michaelw@villawoodproperties.com

**RE: CONTROLLED FILLING – LOT 2091
THE SURROUNDS – STAGE TWO – 2A – 2E**

Fill was placed on this lot during the construction of this estate.

Soil Surveys Engineering Pty Ltd was commissioned on this project to provide earthworks inspection and testing services in general accordance with AS 3798-2007 "Guidelines on earthworks for commercial and residential developments". Full details of the inspection and testing program are provided in the Soil Surveys Engineering report (ref 2-11753, 2017-05-04, BR VER 1).

Based on the inspection and testing services carried out by Soils Surveys Engineering Pty Limited, it is considered that the fill placed at Lot 2091 of The Surrounds – Stage Two – as shown on all attached plans, has been carried out in a responsible manner and in accordance with table 5.1.1 AS 3798 and the project specifications.

All fill in the areas defined in the attached lot location plan, within the time frame of our inspection and testing program between 16/08/2016 and 12/05/2017 (excluding topsoil placed subsequent to completion of controlled filling) is considered to be "controlled fill" in accordance with AS 2870 "Residential Slabs and Footings" (Clause 6.4.2 (a)) and AS 3798.

Unless otherwise stated, this earthworks assessment does not address any other geotechnical issues which may be relevant to building construction and serviceability.

A full geotechnical site investigation/site classification and foundation design should be carried out by suitably qualified and experienced personnel for the proposed residential construction.

SOIL SURVEYS ENGINEERING PTY LIMITED

Attached: Drawing Showing Location of Lot

Celebrating over 40 years in Geotechnics

Ph +617 3369 6000 Fax +617 3369 6660

PO Box 317, Milton, QLD, 4064, Australia

info@soilsurveys.com.au

Brisbane, Level 2, 19 Finchley Street, Milton, QLD, 4064
Gold Coast, Unit 8, 140 Millaroo Drive, Helensvale, QLD 4212

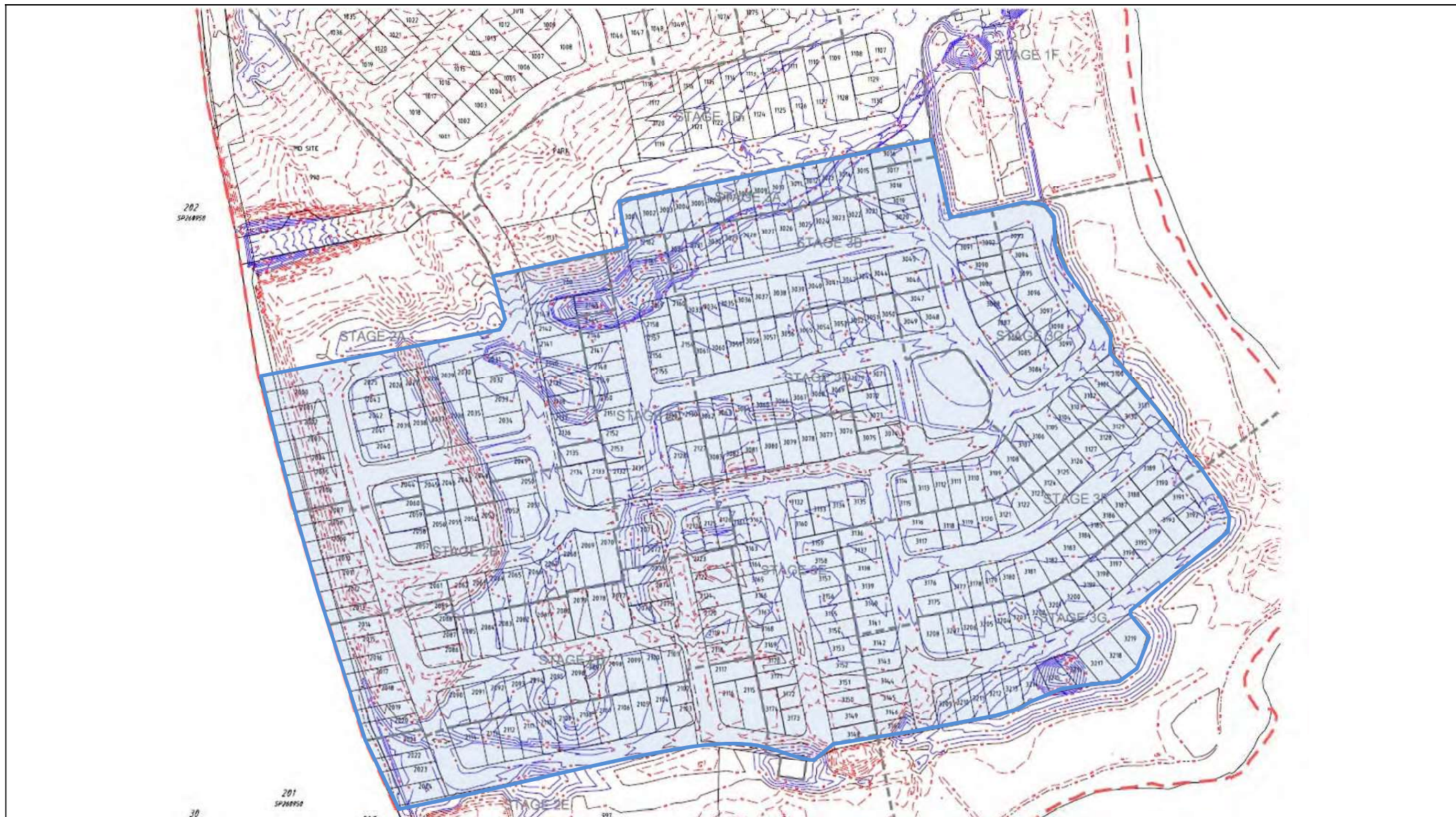

SOIL SURVEYS ENGINEERING PTY LIMITED
A.C.N. 054 043 631
Consulting Geotechnical Engineers

Drawn BI	Project:	Certification Of Earthwork	Drawing No. 2-11753-03	A4
Date May 2017	Location:	Stage Two (A-E) and Three (A-G), The Surrounds		
Checked CS	Client:	Villawood Developments		



Soil Surveys Engineering Pty Limited
Specialists in Applied Geotechnics
A.B.N. 70 054 043 631

www.soilsurveys.com.au

Principals

PJ Dixon
NT Perkins
MV Geale
GEJ Gray
CP Johnson

BE(Hons) RPEQ
BAppSc(AppGeol) BEng(Hons1) RPEQ
BEng(Civil) MBA CPEng MIE Aust RPEQ
BEng(Civil) RPEQ

Gold Coast Office

Job No: 214-11753

Ref: Controlled Filling - Lot 2092

Author: Curtis Skinner

15 May 2017

Villawood Developments

Country Club Drive

Helensvale QLD 4212

Email: michaelw@villawoodproperties.com

**RE: CONTROLLED FILLING – LOT 2092
THE SURROUNDS – STAGE TWO – 2A – 2E**

Fill was placed on this lot during the construction of this estate.

Soil Surveys Engineering Pty Ltd was commissioned on this project to provide earthworks inspection and testing services in general accordance with AS 3798-2007 "Guidelines on earthworks for commercial and residential developments". Full details of the inspection and testing program are provided in the Soil Surveys Engineering report (ref 2-11753, 2017-05-04, BR VER 1).

Based on the inspection and testing services carried out by Soils Surveys Engineering Pty Limited, it is considered that the fill placed at Lot 2092 of The Surrounds – Stage Two – as shown on all attached plans, has been carried out in a responsible manner and in accordance with table 5.1.1 AS 3798 and the project specifications.

All fill in the areas defined in the attached lot location plan, within the time frame of our inspection and testing program between 16/08/2016 and 12/05/2017 (excluding topsoil placed subsequent to completion of controlled filling) is considered to be "controlled fill" in accordance with AS 2870 "Residential Slabs and Footings" (Clause 6.4.2 (a)) and AS 3798.

Unless otherwise stated, this earthworks assessment does not address any other geotechnical issues which may be relevant to building construction and serviceability.

A full geotechnical site investigation/site classification and foundation design should be carried out by suitably qualified and experienced personnel for the proposed residential construction.

SOIL SURVEYS ENGINEERING PTY LIMITED

Attached: Drawing Showing Location of Lot

Celebrating over 40 years in Geotechnics

Ph +617 3369 6000 Fax +617 3369 6660

PO Box 317, Milton, QLD, 4064, Australia

info@soilsurveys.com.au

Brisbane, Level 2, 19 Finchley Street, Milton, QLD, 4064
Gold Coast, Unit 8, 140 Millaroo Drive, Helensvale, QLD 4212

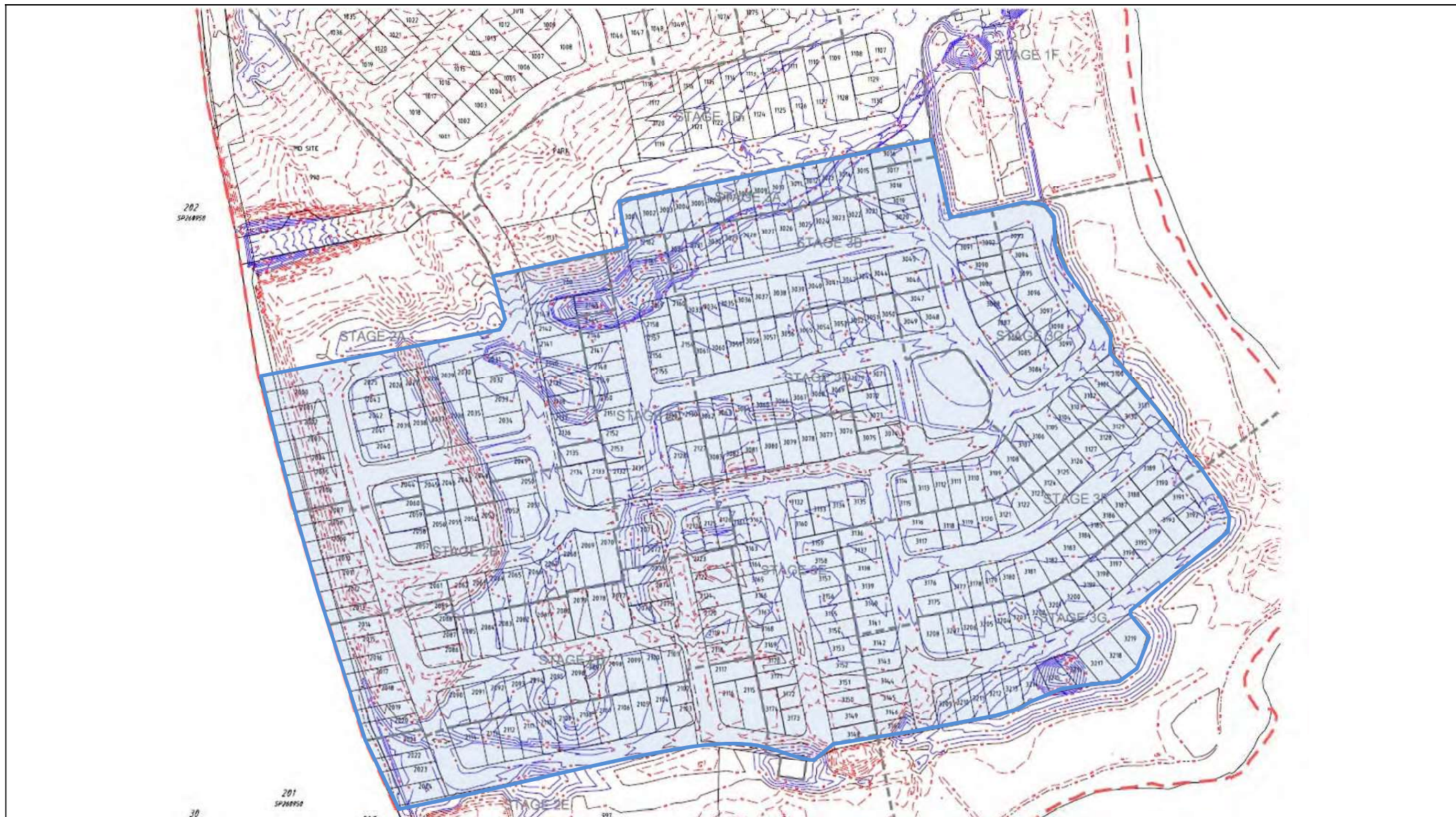

SOIL SURVEYS ENGINEERING PTY LIMITED
A.C.N. 054 043 631
Consulting Geotechnical Engineers

Drawn BI	Project:	Certification Of Earthwork	Drawing No. 2-11753-03	A4
Date May 2017	Location:	Stage Two (A-E) and Three (A-G), The Surrounds		
Checked CS	Client:	Villawood Developments		



Soil Surveys Engineering Pty Limited
Specialists in Applied Geotechnics
A.B.N. 70 054 043 631

www.soilsurveys.com.au

Principals

PJ Dixon
NT Perkins
MV Geale
GEJ Gray
CP Johnson

BE(Hons) RPEQ
BAppSc(AppGeol) BEng(Hons1) RPEQ
BEng(Civil) MBA CPEng MIE Aust RPEQ
BEng(Civil) RPEQ

Gold Coast Office

Job No: 214-11753

Ref: Controlled Filling - Lot 2093

Author: Curtis Skinner

15 May 2017

Villawood Developments

Country Club Drive

Helensvale QLD 4212

Email: michaelw@villawoodproperties.com

**RE: CONTROLLED FILLING – LOT 2093
THE SURROUNDS – STAGE TWO – 2A – 2E**

Fill was placed on this lot during the construction of this estate.

Soil Surveys Engineering Pty Ltd was commissioned on this project to provide earthworks inspection and testing services in general accordance with AS 3798-2007 "Guidelines on earthworks for commercial and residential developments". Full details of the inspection and testing program are provided in the Soil Surveys Engineering report (ref 2-11753, 2017-05-04, BR VER 1).

Based on the inspection and testing services carried out by Soils Surveys Engineering Pty Limited, it is considered that the fill placed at Lot 2093 of The Surrounds – Stage Two – as shown on all attached plans, has been carried out in a responsible manner and in accordance with table 5.1.1 AS 3798 and the project specifications.

All fill in the areas defined in the attached lot location plan, within the time frame of our inspection and testing program between 16/08/2016 and 12/05/2017 (excluding topsoil placed subsequent to completion of controlled filling) is considered to be "controlled fill" in accordance with AS 2870 "Residential Slabs and Footings" (Clause 6.4.2 (a)) and AS 3798.

Unless otherwise stated, this earthworks assessment does not address any other geotechnical issues which may be relevant to building construction and serviceability.

A full geotechnical site investigation/site classification and foundation design should be carried out by suitably qualified and experienced personnel for the proposed residential construction.

SOIL SURVEYS ENGINEERING PTY LIMITED

Attached: Drawing Showing Location of Lot

Celebrating over 40 years in Geotechnics

Ph +617 3369 6000 Fax +617 3369 6660

PO Box 317, Milton, QLD, 4064, Australia

info@soilsurveys.com.au

Brisbane, Level 2, 19 Finchley Street, Milton, QLD, 4064
Gold Coast, Unit 8, 140 Millaroo Drive, Helensvale, QLD 4212



SOIL SURVEYS ENGINEERING PTY LIMITED
A.C.N. 054 043 631
Consulting Geotechnical Engineers

Drawn BI	Project:	Certification Of Earthwork	Drawing No. 2-11753-03	A4
Date May 2017	Location:	Stage Two (A-E) and Three (A-G), The Surrounds		
Checked CS	Client:	Villawood Developments		



Soil Surveys Engineering Pty Limited
Specialists in Applied Geotechnics
A.B.N. 70 054 043 631

www.soilsurveys.com.au

Principals

PJ Dixon
NT Perkins
MV Geale
GEJ Gray
CP Johnson

BE(Hons) RPEQ
BAppSc(AppGeol) BEng(Hons1) RPEQ
BEng(Civil) MBA CPEng MIE Aust RPEQ
BEng(Civil) RPEQ

Gold Coast Office

Job No: 214-11753

Ref: Controlled Filling - Lot 2094

Author: Curtis Skinner

15 May 2017

Villawood Developments

Country Club Drive

Helensvale QLD 4212

Email: michaelw@villawoodproperties.com

**RE: CONTROLLED FILLING – LOT 2094
THE SURROUNDS – STAGE TWO – 2A – 2E**

Fill was placed on this lot during the construction of this estate.

Soil Surveys Engineering Pty Ltd was commissioned on this project to provide earthworks inspection and testing services in general accordance with AS 3798-2007 "Guidelines on earthworks for commercial and residential developments". Full details of the inspection and testing program are provided in the Soil Surveys Engineering report (ref 2-11753, 2017-05-04, BR VER 1).

Based on the inspection and testing services carried out by Soils Surveys Engineering Pty Limited, it is considered that the fill placed at Lot 2094 of The Surrounds – Stage Two – as shown on all attached plans, has been carried out in a responsible manner and in accordance with table 5.1.1 AS 3798 and the project specifications.

All fill in the areas defined in the attached lot location plan, within the time frame of our inspection and testing program between 16/08/2016 and 12/05/2017 (excluding topsoil placed subsequent to completion of controlled filling) is considered to be "controlled fill" in accordance with AS 2870 "Residential Slabs and Footings" (Clause 6.4.2 (a)) and AS 3798.

Unless otherwise stated, this earthworks assessment does not address any other geotechnical issues which may be relevant to building construction and serviceability.

A full geotechnical site investigation/site classification and foundation design should be carried out by suitably qualified and experienced personnel for the proposed residential construction.

SOIL SURVEYS ENGINEERING PTY LIMITED

Attached: Drawing Showing Location of Lot

Celebrating over 40 years in Geotechnics

Ph +617 3369 6000 Fax +617 3369 6660

PO Box 317, Milton, QLD, 4064, Australia

info@soilsurveys.com.au

Brisbane, Level 2, 19 Finchley Street, Milton, QLD, 4064
Gold Coast, Unit 8, 140 Millaroo Drive, Helensvale, QLD 4212



SOIL SURVEYS ENGINEERING PTY LIMITED
A.C.N. 054 043 631
Consulting Geotechnical Engineers

Drawn BI	Project:	Certification Of Earthwork	Drawing No. 2-11753-03	A4
Date May 2017	Location:	Stage Two (A-E) and Three (A-G), The Surrounds		
Checked CS	Client:	Villawood Developments		



Soil Surveys Engineering Pty Limited
Specialists in Applied Geotechnics
A.B.N. 70 054 043 631

www.soilsurveys.com.au

Principals

PJ Dixon
NT Perkins
MV Geale
GEJ Gray
CP Johnson

BE(Hons) RPEQ
BAppSc(AppGeol) BEng(Hons1) RPEQ
BEng(Civil) MBA CPEng MIE Aust RPEQ
BEng(Civil) RPEQ

Gold Coast Office

Job No: 214-11753

Ref: Controlled Filling - Lot 2095

Author: Curtis Skinner

15 May 2017

Villawood Developments

Country Club Drive

Helensvale QLD 4212

Email: michaelw@villawoodproperties.com

**RE: CONTROLLED FILLING – LOT 2095
THE SURROUNDS – STAGE TWO – 2A – 2E**

Fill was placed on this lot during the construction of this estate.

Soil Surveys Engineering Pty Ltd was commissioned on this project to provide earthworks inspection and testing services in general accordance with AS 3798-2007 "Guidelines on earthworks for commercial and residential developments". Full details of the inspection and testing program are provided in the Soil Surveys Engineering report (ref 2-11753, 2017-05-04, BR VER 1).

Based on the inspection and testing services carried out by Soils Surveys Engineering Pty Limited, it is considered that the fill placed at Lot 2095 of The Surrounds – Stage Two – as shown on all attached plans, has been carried out in a responsible manner and in accordance with table 5.1.1 AS 3798 and the project specifications.

All fill in the areas defined in the attached lot location plan, within the time frame of our inspection and testing program between 16/08/2016 and 12/05/2017 (excluding topsoil placed subsequent to completion of controlled filling) is considered to be "controlled fill" in accordance with AS 2870 "Residential Slabs and Footings" (Clause 6.4.2 (a)) and AS 3798.

Unless otherwise stated, this earthworks assessment does not address any other geotechnical issues which may be relevant to building construction and serviceability.

A full geotechnical site investigation/site classification and foundation design should be carried out by suitably qualified and experienced personnel for the proposed residential construction.

SOIL SURVEYS ENGINEERING PTY LIMITED

Attached: Drawing Showing Location of Lot

Celebrating over 40 years in Geotechnics

Ph +617 3369 6000 Fax +617 3369 6660

PO Box 317, Milton, QLD, 4064, Australia

info@soilsurveys.com.au

Brisbane, Level 2, 19 Finchley Street, Milton, QLD, 4064
Gold Coast, Unit 8, 140 Millaroo Drive, Helensvale, QLD 4212



SOIL SURVEYS ENGINEERING PTY LIMITED
A.C.N. 054 043 631
Consulting Geotechnical Engineers

Drawn BI	Project:	Certification Of Earthwork	Drawing No. 2-11753-03	A4
Date May 2017	Location:	Stage Two (A-E) and Three (A-G), The Surrounds		
Checked CS	Client:	Villawood Developments		



Soil Surveys Engineering Pty Limited
Specialists in Applied Geotechnics
A.B.N. 70 054 043 631

www.soilsurveys.com.au

Principals

PJ Dixon
NT Perkins
MV Geale
GEJ Gray
CP Johnson

BE(Hons) RPEQ
BAppSc(AppGeol) BEng(Hons1) RPEQ
BEng(Civil) MBA CPEng MIE Aust RPEQ
BEng(Civil) RPEQ

Gold Coast Office

Job No: 214-11753
Ref: Controlled Filling - Lot 2096
Author: Curtis Skinner

15 May 2017

Villawood Developments
Country Club Drive
Helensvale QLD 4212
Email: michaelw@villawoodproperties.com

**RE: CONTROLLED FILLING – LOT 2096
THE SURROUNDS – STAGE TWO – 2A – 2E**

Fill was placed on this lot during the construction of this estate.

Soil Surveys Engineering Pty Ltd was commissioned on this project to provide earthworks inspection and testing services in general accordance with AS 3798-2007 "Guidelines on earthworks for commercial and residential developments". Full details of the inspection and testing program are provided in the Soil Surveys Engineering report (ref 2-11753, 2017-05-04, BR VER 1).

Based on the inspection and testing services carried out by Soils Surveys Engineering Pty Limited, it is considered that the fill placed at Lot 2096 of The Surrounds – Stage Two – as shown on all attached plans, has been carried out in a responsible manner and in accordance with table 5.1.1 AS 3798 and the project specifications.

All fill in the areas defined in the attached lot location plan, within the time frame of our inspection and testing program between 16/08/2016 and 12/05/2017 (excluding topsoil placed subsequent to completion of controlled filling) is considered to be "controlled fill" in accordance with AS 2870 "Residential Slabs and Footings" (Clause 6.4.2 (a)) and AS 3798.

Unless otherwise stated, this earthworks assessment does not address any other geotechnical issues which may be relevant to building construction and serviceability.

A full geotechnical site investigation/site classification and foundation design should be carried out by suitably qualified and experienced personnel for the proposed residential construction.

SOIL SURVEYS ENGINEERING PTY LIMITED

Attached: Drawing Showing Location of Lot

Celebrating over 40 years in Geotechnics

Ph +617 3369 6000 Fax +617 3369 6660
PO Box 317, Milton, QLD, 4064, Australia
info@soilsurveys.com.au
Brisbane, Level 2, 19 Finchley Street, Milton, QLD, 4064
Gold Coast, Unit 8, 140 Millaroo Drive, Helensvale, QLD 4212



SOIL SURVEYS ENGINEERING PTY LIMITED
A.C.N. 054 043 631
Consulting Geotechnical Engineers

Drawn BI	Project:	Certification Of Earthwork	Drawing No. 2-11753-03	A4
Date May 2017	Location:	Stage Two (A-E) and Three (A-G), The Surrounds		
Checked CS	Client:	Villawood Developments		



Soil Surveys Engineering Pty Limited
Specialists in Applied Geotechnics
A.B.N. 70 054 043 631

www.soilsurveys.com.au

Principals

PJ Dixon
NT Perkins
MV Geale
GEJ Gray
CP Johnson

BE(Hons) RPEQ
BAppSc(AppGeol) BEng(Hons1) RPEQ
BEng(Civil) MBA CPEng MIE Aust RPEQ
BEng(Civil) RPEQ

Gold Coast Office

Job No: 214-11753

Ref: Controlled Filling - Lot 2097

Author: Curtis Skinner

15 May 2017

Villawood Developments

Country Club Drive

Helensvale QLD 4212

Email: michaelw@villawoodproperties.com

**RE: CONTROLLED FILLING – LOT 2097
THE SURROUNDS – STAGE TWO – 2A – 2E**

Fill was placed on this lot during the construction of this estate.

Soil Surveys Engineering Pty Ltd was commissioned on this project to provide earthworks inspection and testing services in general accordance with AS 3798-2007 "Guidelines on earthworks for commercial and residential developments". Full details of the inspection and testing program are provided in the Soil Surveys Engineering report (ref 2-11753, 2017-05-04, BR VER 1).

Based on the inspection and testing services carried out by Soils Surveys Engineering Pty Limited, it is considered that the fill placed at Lot 2097 of The Surrounds – Stage Two – as shown on all attached plans, has been carried out in a responsible manner and in accordance with table 5.1.1 AS 3798 and the project specifications.

All fill in the areas defined in the attached lot location plan, within the time frame of our inspection and testing program between 16/08/2016 and 12/05/2017 (excluding topsoil placed subsequent to completion of controlled filling) is considered to be "controlled fill" in accordance with AS 2870 "Residential Slabs and Footings" (Clause 6.4.2 (a)) and AS 3798.

Unless otherwise stated, this earthworks assessment does not address any other geotechnical issues which may be relevant to building construction and serviceability.

A full geotechnical site investigation/site classification and foundation design should be carried out by suitably qualified and experienced personnel for the proposed residential construction.

SOIL SURVEYS ENGINEERING PTY LIMITED

Attached: Drawing Showing Location of Lot

Celebrating over 40 years in Geotechnics

Ph +617 3369 6000 Fax +617 3369 6660

PO Box 317, Milton, QLD, 4064, Australia

info@soilsurveys.com.au

Brisbane, Level 2, 19 Finchley Street, Milton, QLD, 4064
Gold Coast, Unit 8, 140 Millaroo Drive, Helensvale, QLD 4212



SOIL SURVEYS ENGINEERING PTY LIMITED
A.C.N. 054 043 631
Consulting Geotechnical Engineers

Drawn BI	Project:	Certification Of Earthwork	Drawing No. 2-11753-03	A4
Date May 2017	Location:	Stage Two (A-E) and Three (A-G), The Surrounds		
Checked CS	Client:	Villawood Developments		



Soil Surveys Engineering Pty Limited
Specialists in Applied Geotechnics
A.B.N. 70 054 043 631

www.soilsurveys.com.au

Principals

PJ Dixon
NT Perkins
MV Geale
GEJ Gray
CP Johnson

BE(Hons) RPEQ
BAppSc(AppGeol) BEng(Hons1) RPEQ
BEng(Civil) MBA CPEng MIE Aust RPEQ
BEng(Civil) RPEQ

Gold Coast Office

Job No: 214-11753

Ref: Controlled Filling - Lot 2098

Author: Curtis Skinner

15 May 2017

Villawood Developments

Country Club Drive

Helensvale QLD 4212

Email: michaelw@villawoodproperties.com

**RE: CONTROLLED FILLING – LOT 2098
THE SURROUNDS – STAGE TWO – 2A – 2E**

Fill was placed on this lot during the construction of this estate.

Soil Surveys Engineering Pty Ltd was commissioned on this project to provide earthworks inspection and testing services in general accordance with AS 3798-2007 "Guidelines on earthworks for commercial and residential developments". Full details of the inspection and testing program are provided in the Soil Surveys Engineering report (ref 2-11753, 2017-05-04, BR VER 1).

Based on the inspection and testing services carried out by Soils Surveys Engineering Pty Limited, it is considered that the fill placed at Lot 2098 of The Surrounds – Stage Two – as shown on all attached plans, has been carried out in a responsible manner and in accordance with table 5.1.1 AS 3798 and the project specifications.

All fill in the areas defined in the attached lot location plan, within the time frame of our inspection and testing program between 16/08/2016 and 12/05/2017 (excluding topsoil placed subsequent to completion of controlled filling) is considered to be "controlled fill" in accordance with AS 2870 "Residential Slabs and Footings" (Clause 6.4.2 (a)) and AS 3798.

Unless otherwise stated, this earthworks assessment does not address any other geotechnical issues which may be relevant to building construction and serviceability.

A full geotechnical site investigation/site classification and foundation design should be carried out by suitably qualified and experienced personnel for the proposed residential construction.

SOIL SURVEYS ENGINEERING PTY LIMITED

Attached: Drawing Showing Location of Lot

Celebrating over 40 years in Geotechnics

Ph +617 3369 6000 Fax +617 3369 6660

PO Box 317, Milton, QLD, 4064, Australia

info@soilsurveys.com.au

Brisbane, Level 2, 19 Finchley Street, Milton, QLD, 4064
Gold Coast, Unit 8, 140 Millaroo Drive, Helensvale, QLD 4212



SOIL SURVEYS ENGINEERING PTY LIMITED
A.C.N. 054 043 631
Consulting Geotechnical Engineers

Drawn BI	Project:	Certification Of Earthwork	Drawing No. 2-11753-03	A4
Date May 2017	Location:	Stage Two (A-E) and Three (A-G), The Surrounds		
Checked CS	Client:	Villawood Developments		



Soil Surveys Engineering Pty Limited
Specialists in Applied Geotechnics
A.B.N. 70 054 043 631

www.soilsurveys.com.au

Principals

PJ Dixon
NT Perkins
MV Geale
GEJ Gray
CP Johnson

BE(Hons) RPEQ
BAppSc(AppGeol) BEng(Hons1) RPEQ
BEng(Civil) MBA CPEng MIE Aust RPEQ
BEng(Civil) RPEQ

Gold Coast Office

Job No: 214-11753

Ref: Controlled Filling - Lot 2099

Author: Curtis Skinner

15 May 2017

Villawood Developments

Country Club Drive

Helensvale QLD 4212

Email: michaelw@villawoodproperties.com

**RE: CONTROLLED FILLING – LOT 2099
THE SURROUNDS – STAGE TWO – 2A – 2E**

Fill was placed on this lot during the construction of this estate.

Soil Surveys Engineering Pty Ltd was commissioned on this project to provide earthworks inspection and testing services in general accordance with AS 3798-2007 "Guidelines on earthworks for commercial and residential developments". Full details of the inspection and testing program are provided in the Soil Surveys Engineering report (ref 2-11753, 2017-05-04, BR VER 1).

Based on the inspection and testing services carried out by Soils Surveys Engineering Pty Limited, it is considered that the fill placed at Lot 2099 of The Surrounds – Stage Two – as shown on all attached plans, has been carried out in a responsible manner and in accordance with table 5.1.1 AS 3798 and the project specifications.

All fill in the areas defined in the attached lot location plan, within the time frame of our inspection and testing program between 16/08/2016 and 12/05/2017 (excluding topsoil placed subsequent to completion of controlled filling) is considered to be "controlled fill" in accordance with AS 2870 "Residential Slabs and Footings" (Clause 6.4.2 (a)) and AS 3798.

Unless otherwise stated, this earthworks assessment does not address any other geotechnical issues which may be relevant to building construction and serviceability.

A full geotechnical site investigation/site classification and foundation design should be carried out by suitably qualified and experienced personnel for the proposed residential construction.

SOIL SURVEYS ENGINEERING PTY LIMITED

Attached: Drawing Showing Location of Lot

Celebrating over 40 years in Geotechnics

Ph +617 3369 6000 Fax +617 3369 6660

PO Box 317, Milton, QLD, 4064, Australia

info@soilsurveys.com.au

Brisbane, Level 2, 19 Finchley Street, Milton, QLD, 4064
Gold Coast, Unit 8, 140 Millaroo Drive, Helensvale, QLD 4212



SOIL SURVEYS ENGINEERING PTY LIMITED
A.C.N. 054 043 631
Consulting Geotechnical Engineers

Drawn BI	Project:	Certification Of Earthwork	Drawing No. 2-11753-03	A4
Date May 2017	Location:	Stage Two (A-E) and Three (A-G), The Surrounds		
Checked CS	Client:	Villawood Developments		



Soil Surveys Engineering Pty Limited
Specialists in Applied Geotechnics
A.B.N. 70 054 043 631

www.soilsurveys.com.au

Principals

PJ Dixon
NT Perkins
MV Geale
GEJ Gray
CP Johnson

BE(Hons) RPEQ
BAppSc(AppGeol) BEng(Hons1) RPEQ
BEng(Civil) MBA CPEng MIE Aust RPEQ
BEng(Civil) RPEQ

Gold Coast Office

Job No: 214-11753
Ref: Controlled Filling - Lot 2100
Author: Curtis Skinner

15 May 2017

Villawood Developments
Country Club Drive
Helensvale QLD 4212
Email: michaelw@villawoodproperties.com

**RE: CONTROLLED FILLING – LOT 2100
THE SURROUNDS – STAGE TWO – 2A – 2E**

Fill was placed on this lot during the construction of this estate.

Soil Surveys Engineering Pty Ltd was commissioned on this project to provide earthworks inspection and testing services in general accordance with AS 3798-2007 "Guidelines on earthworks for commercial and residential developments". Full details of the inspection and testing program are provided in the Soil Surveys Engineering report (ref 2-11753, 2017-05-04, BR VER 1).

Based on the inspection and testing services carried out by Soils Surveys Engineering Pty Limited, it is considered that the fill placed at Lot 2100 of The Surrounds – Stage Two – as shown on all attached plans, has been carried out in a responsible manner and in accordance with table 5.1.1 AS 3798 and the project specifications.

All fill in the areas defined in the attached lot location plan, within the time frame of our inspection and testing program between 16/08/2016 and 12/05/2017 (excluding topsoil placed subsequent to completion of controlled filling) is considered to be "controlled fill" in accordance with AS 2870 "Residential Slabs and Footings" (Clause 6.4.2 (a)) and AS 3798.

Unless otherwise stated, this earthworks assessment does not address any other geotechnical issues which may be relevant to building construction and serviceability.

A full geotechnical site investigation/site classification and foundation design should be carried out by suitably qualified and experienced personnel for the proposed residential construction.

SOIL SURVEYS ENGINEERING PTY LIMITED

Attached: Drawing Showing Location of Lot

Celebrating over 40 years in Geotechnics

Ph +617 3369 6000 Fax +617 3369 6660
PO Box 317, Milton, QLD, 4064, Australia
info@soilsurveys.com.au
Brisbane, Level 2, 19 Finchley Street, Milton, QLD, 4064
Gold Coast, Unit 8, 140 Millaroo Drive, Helensvale, QLD 4212

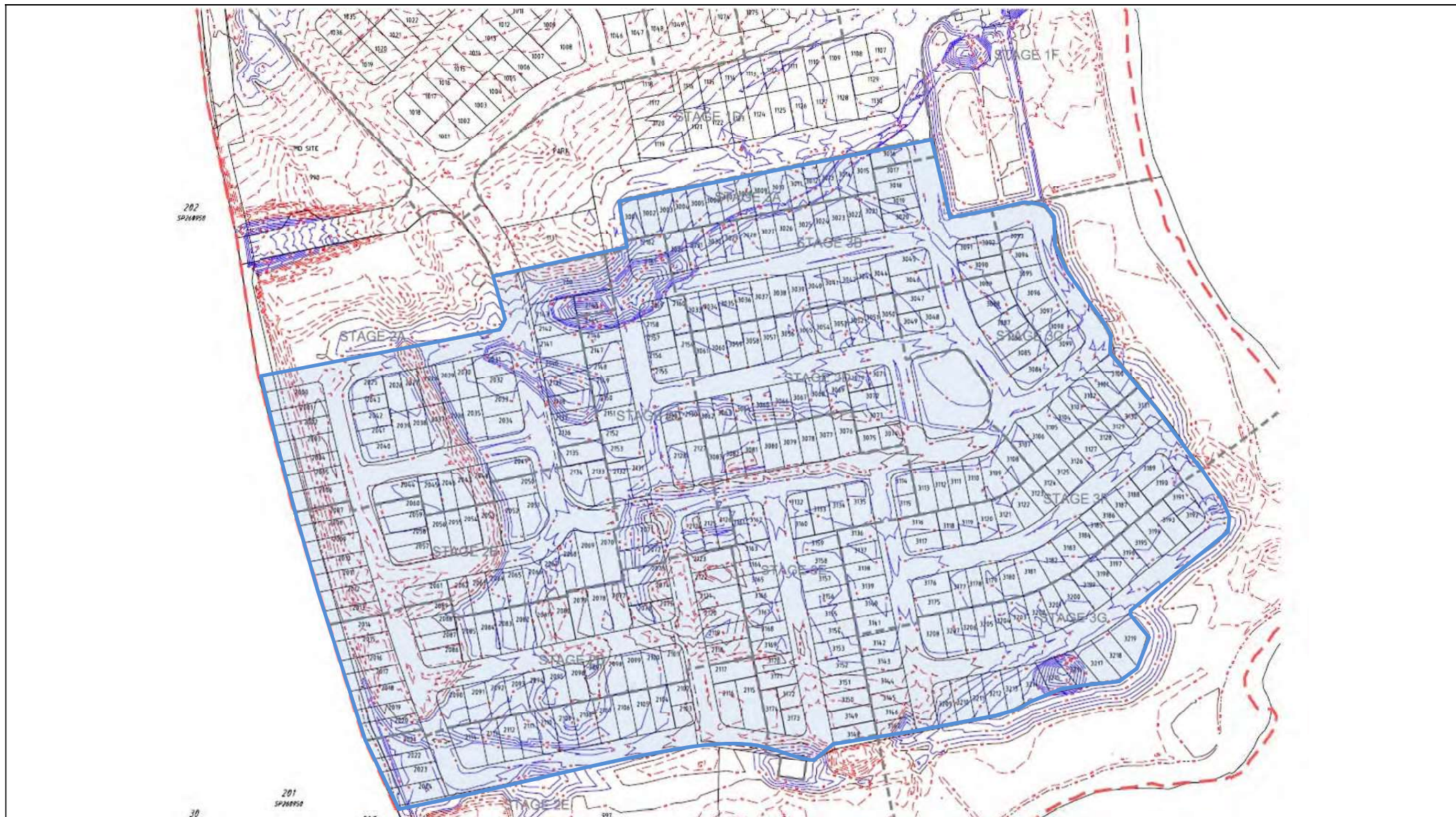

SOIL SURVEYS ENGINEERING PTY LIMITED
A.C.N. 054 043 631
Consulting Geotechnical Engineers

Drawn BI	Project:	Certification Of Earthwork	Drawing No. 2-11753-03	A4
Date May 2017	Location:	Stage Two (A-E) and Three (A-G), The Surrounds		
Checked CS	Client:	Villawood Developments		



Soil Surveys Engineering Pty Limited
Specialists in Applied Geotechnics
A.B.N. 70 054 043 631

www.soilsurveys.com.au

Principals

PJ Dixon
NT Perkins
MV Geale
GEJ Gray
CP Johnson

BE(Hons) RPEQ
BAppSc(AppGeol) BEng(Hons1) RPEQ
BEng(Civil) MBA CPEng MIE Aust RPEQ
BEng(Civil) RPEQ

Gold Coast Office

Job No: 214-11753
Ref: Controlled Filling - Lot 2101
Author: Curtis Skinner

15 May 2017

Villawood Developments
Country Club Drive
Helensvale QLD 4212
Email: michaelw@villawoodproperties.com

**RE: CONTROLLED FILLING – LOT 2101
THE SURROUNDS – STAGE TWO – 2A – 2E**

Fill was placed on this lot during the construction of this estate.

Soil Surveys Engineering Pty Ltd was commissioned on this project to provide earthworks inspection and testing services in general accordance with AS 3798-2007 "Guidelines on earthworks for commercial and residential developments". Full details of the inspection and testing program are provided in the Soil Surveys Engineering report (ref 2-11753, 2017-05-04, BR VER 1).

Based on the inspection and testing services carried out by Soils Surveys Engineering Pty Limited, it is considered that the fill placed at Lot 2101 of The Surrounds – Stage Two – as shown on all attached plans, has been carried out in a responsible manner and in accordance with table 5.1.1 AS 3798 and the project specifications.

All fill in the areas defined in the attached lot location plan, within the time frame of our inspection and testing program between 16/08/2016 and 12/05/2017 (excluding topsoil placed subsequent to completion of controlled filling) is considered to be "controlled fill" in accordance with AS 2870 "Residential Slabs and Footings" (Clause 6.4.2 (a)) and AS 3798.

Unless otherwise stated, this earthworks assessment does not address any other geotechnical issues which may be relevant to building construction and serviceability.

A full geotechnical site investigation/site classification and foundation design should be carried out by suitably qualified and experienced personnel for the proposed residential construction.

SOIL SURVEYS ENGINEERING PTY LIMITED

Attached: Drawing Showing Location of Lot

Celebrating over 40 years in Geotechnics

Ph +617 3369 6000 Fax +617 3369 6660
PO Box 317, Milton, QLD, 4064, Australia
info@soilsurveys.com.au
Brisbane, Level 2, 19 Finchley Street, Milton, QLD, 4064
Gold Coast, Unit 8, 140 Millaroo Drive, Helensvale, QLD 4212



SOIL SURVEYS ENGINEERING PTY LIMITED
A.C.N. 054 043 631
Consulting Geotechnical Engineers

Drawn BI	Project:	Certification Of Earthwork	Drawing No. 2-11753-03	A4
Date May 2017	Location:	Stage Two (A-E) and Three (A-G), The Surrounds		
Checked CS	Client:	Villawood Developments		



Soil Surveys Engineering Pty Limited
Specialists in Applied Geotechnics
A.B.N. 70 054 043 631

www.soilsurveys.com.au

Principals

PJ Dixon
NT Perkins
MV Geale
GEJ Gray
CP Johnson

BE(Hons) RPEQ
BAppSc(AppGeol) BEng(Hons1) RPEQ
BEng(Civil) MBA CPEng MIE Aust RPEQ
BEng(Civil) RPEQ

Gold Coast Office

Job No: 214-11753

Ref: Controlled Filling - Lot 2118

Author: Curtis Skinner

15 May 2017

Villawood Developments

Country Club Drive

Helensvale QLD 4212

Email: michaelw@villawoodproperties.com

**RE: CONTROLLED FILLING – LOT 2118
THE SURROUNDS – STAGE TWO – 2A – 2E**

Fill was placed on this lot during the construction of this estate.

Soil Surveys Engineering Pty Ltd was commissioned on this project to provide earthworks inspection and testing services in general accordance with AS 3798-2007 "Guidelines on earthworks for commercial and residential developments". Full details of the inspection and testing program are provided in the Soil Surveys Engineering report (ref 2-11753, 2017-05-04, BR VER 1).

Based on the inspection and testing services carried out by Soils Surveys Engineering Pty Limited, it is considered that the fill placed at Lot 2118 of The Surrounds – Stage Two – as shown on all attached plans, has been carried out in a responsible manner and in accordance with table 5.1.1 AS 3798 and the project specifications.

All fill in the areas defined in the attached lot location plan, within the time frame of our inspection and testing program between 16/08/2016 and 12/05/2017 (excluding topsoil placed subsequent to completion of controlled filling) is considered to be "controlled fill" in accordance with AS 2870 "Residential Slabs and Footings" (Clause 6.4.2 (a)) and AS 3798.

Unless otherwise stated, this earthworks assessment does not address any other geotechnical issues which may be relevant to building construction and serviceability.

A full geotechnical site investigation/site classification and foundation design should be carried out by suitably qualified and experienced personnel for the proposed residential construction.

SOIL SURVEYS ENGINEERING PTY LIMITED

Attached: Drawing Showing Location of Lot

Celebrating over 40 years in Geotechnics

Ph +617 3369 6000 Fax +617 3369 6660

PO Box 317, Milton, QLD, 4064, Australia

info@soilsurveys.com.au

Brisbane, Level 2, 19 Finchley Street, Milton, QLD, 4064
Gold Coast, Unit 8, 140 Millaroo Drive, Helensvale, QLD 4212



SOIL SURVEYS ENGINEERING PTY LIMITED
A.C.N. 054 043 631
Consulting Geotechnical Engineers

Drawn BI	Project:	Certification Of Earthwork	Drawing No. 2-11753-03	A4
Date May 2017	Location:	Stage Two (A-E) and Three (A-G), The Surrounds		
Checked CS	Client:	Villawood Developments		



Soil Surveys Engineering Pty Limited
Specialists in Applied Geotechnics
A.B.N. 70 054 043 631

www.soilsurveys.com.au

Principals

PJ Dixon
NT Perkins
MV Geale
GEJ Gray
CP Johnson

BE(Hons) RPEQ
BAppSc(AppGeol) BEng(Hons1) RPEQ
BEng(Civil) MBA CPEng MIE Aust RPEQ
BEng(Civil) RPEQ

Gold Coast Office

Job No: 214-11753
Ref: Controlled Filling - Lot 2119
Author: Curtis Skinner

15 May 2017

Villawood Developments
Country Club Drive
Helensvale QLD 4212
Email: michaelw@villawoodproperties.com

**RE: CONTROLLED FILLING – LOT 2119
THE SURROUNDS – STAGE TWO – 2A – 2E**

Fill was placed on this lot during the construction of this estate.

Soil Surveys Engineering Pty Ltd was commissioned on this project to provide earthworks inspection and testing services in general accordance with AS 3798-2007 "Guidelines on earthworks for commercial and residential developments". Full details of the inspection and testing program are provided in the Soil Surveys Engineering report (ref 2-11753, 2017-05-04, BR VER 1).

Based on the inspection and testing services carried out by Soils Surveys Engineering Pty Limited, it is considered that the fill placed at Lot 2119 of The Surrounds – Stage Two – as shown on all attached plans, has been carried out in a responsible manner and in accordance with table 5.1.1 AS 3798 and the project specifications.

All fill in the areas defined in the attached lot location plan, within the time frame of our inspection and testing program between 16/08/2016 and 12/05/2017 (excluding topsoil placed subsequent to completion of controlled filling) is considered to be "controlled fill" in accordance with AS 2870 "Residential Slabs and Footings" (Clause 6.4.2 (a)) and AS 3798.

Unless otherwise stated, this earthworks assessment does not address any other geotechnical issues which may be relevant to building construction and serviceability.

A full geotechnical site investigation/site classification and foundation design should be carried out by suitably qualified and experienced personnel for the proposed residential construction.

SOIL SURVEYS ENGINEERING PTY LIMITED

Attached: Drawing Showing Location of Lot

Celebrating over 40 years in Geotechnics

Ph +617 3369 6000 Fax +617 3369 6660
PO Box 317, Milton, QLD, 4064, Australia
info@soilsurveys.com.au
Brisbane, Level 2, 19 Finchley Street, Milton, QLD, 4064
Gold Coast, Unit 8, 140 Millaroo Drive, Helensvale, QLD 4212

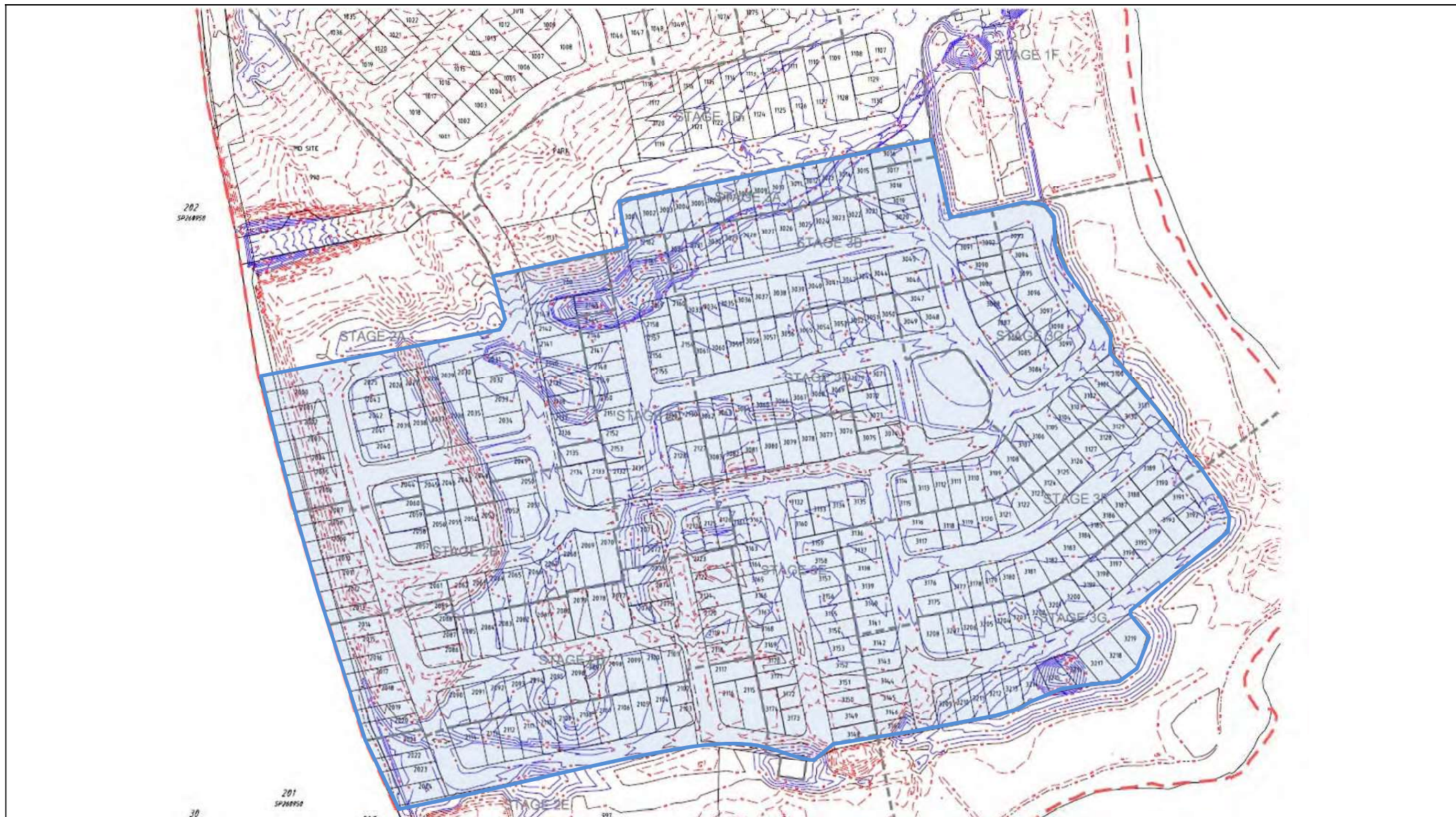

SOIL SURVEYS ENGINEERING PTY LIMITED
A.C.N. 054 043 631
Consulting Geotechnical Engineers

Drawn BI	Project:	Certification Of Earthwork	Drawing No. 2-11753-03	A4
Date May 2017	Location:	Stage Two (A-E) and Three (A-G), The Surrounds		
Checked CS	Client:	Villawood Developments		



Soil Surveys Engineering Pty Limited
Specialists in Applied Geotechnics
A.B.N. 70 054 043 631

www.soilsurveys.com.au

Principals

PJ Dixon
NT Perkins
MV Geale
GEJ Gray
CP Johnson

BE(Hons) RPEQ
BAppSc(AppGeol) BEng(Hons1) RPEQ
BEng(Civil) MBA CPEng MIE Aust RPEQ
BEng(Civil) RPEQ

Gold Coast Office

Job No: 214-11753

Ref: Controlled Filling - Lot 2120

Author: Curtis Skinner

15 May 2017

Villawood Developments

Country Club Drive

Helensvale QLD 4212

Email: michaelw@villawoodproperties.com

**RE: CONTROLLED FILLING – LOT 2120
THE SURROUNDS – STAGE TWO – 2A – 2E**

Fill was placed on this lot during the construction of this estate.

Soil Surveys Engineering Pty Ltd was commissioned on this project to provide earthworks inspection and testing services in general accordance with AS 3798-2007 "Guidelines on earthworks for commercial and residential developments". Full details of the inspection and testing program are provided in the Soil Surveys Engineering report (ref 2-11753, 2017-05-04, BR VER 1).

Based on the inspection and testing services carried out by Soils Surveys Engineering Pty Limited, it is considered that the fill placed at Lot 2120 of The Surrounds – Stage Two – as shown on all attached plans, has been carried out in a responsible manner and in accordance with table 5.1.1 AS 3798 and the project specifications.

All fill in the areas defined in the attached lot location plan, within the time frame of our inspection and testing program between 16/08/2016 and 12/05/2017 (excluding topsoil placed subsequent to completion of controlled filling) is considered to be "controlled fill" in accordance with AS 2870 "Residential Slabs and Footings" (Clause 6.4.2 (a)) and AS 3798.

Unless otherwise stated, this earthworks assessment does not address any other geotechnical issues which may be relevant to building construction and serviceability.

A full geotechnical site investigation/site classification and foundation design should be carried out by suitably qualified and experienced personnel for the proposed residential construction.

SOIL SURVEYS ENGINEERING PTY LIMITED

Attached: Drawing Showing Location of Lot

Celebrating over 40 years in Geotechnics

Ph +617 3369 6000 Fax +617 3369 6660

PO Box 317, Milton, QLD, 4064, Australia

info@soilsurveys.com.au

Brisbane, Level 2, 19 Finchley Street, Milton, QLD, 4064
Gold Coast, Unit 8, 140 Millaroo Drive, Helensvale, QLD 4212



SOIL SURVEYS ENGINEERING PTY LIMITED
A.C.N. 054 043 631
Consulting Geotechnical Engineers

Drawn BI	Project:	Certification Of Earthwork	Drawing No. 2-11753-03	A4
Date May 2017	Location:	Stage Two (A-E) and Three (A-G), The Surrounds		
Checked CS	Client:	Villawood Developments		



Soil Surveys Engineering Pty Limited
Specialists in Applied Geotechnics
A.B.N. 70 054 043 631

www.soilsurveys.com.au

Principals

PJ Dixon
NT Perkins
MV Geale
GEJ Gray
CP Johnson

BE(Hons) RPEQ
BAppSc(AppGeol) BEng(Hons1) RPEQ
BEng(Civil) MBA CPEng MIE Aust RPEQ
BEng(Civil) RPEQ

Gold Coast Office

Job No: 214-11753

Ref: Controlled Filling - Lot 2121

Author: Curtis Skinner

15 May 2017

Villawood Developments

Country Club Drive

Helensvale QLD 4212

Email: michaelw@villawoodproperties.com

**RE: CONTROLLED FILLING – LOT 2121
THE SURROUNDS – STAGE TWO – 2A – 2E**

Fill was placed on this lot during the construction of this estate.

Soil Surveys Engineering Pty Ltd was commissioned on this project to provide earthworks inspection and testing services in general accordance with AS 3798-2007 "Guidelines on earthworks for commercial and residential developments". Full details of the inspection and testing program are provided in the Soil Surveys Engineering report (ref 2-11753, 2017-05-04, BR VER 1).

Based on the inspection and testing services carried out by Soils Surveys Engineering Pty Limited, it is considered that the fill placed at Lot 2121 of The Surrounds – Stage Two – as shown on all attached plans, has been carried out in a responsible manner and in accordance with table 5.1.1 AS 3798 and the project specifications.

All fill in the areas defined in the attached lot location plan, within the time frame of our inspection and testing program between 16/08/2016 and 12/05/2017 (excluding topsoil placed subsequent to completion of controlled filling) is considered to be "controlled fill" in accordance with AS 2870 "Residential Slabs and Footings" (Clause 6.4.2 (a)) and AS 3798.

Unless otherwise stated, this earthworks assessment does not address any other geotechnical issues which may be relevant to building construction and serviceability.

A full geotechnical site investigation/site classification and foundation design should be carried out by suitably qualified and experienced personnel for the proposed residential construction.

SOIL SURVEYS ENGINEERING PTY LIMITED

Attached: Drawing Showing Location of Lot

Celebrating over 40 years in Geotechnics

Ph +617 3369 6000 Fax +617 3369 6660

PO Box 317, Milton, QLD, 4064, Australia

info@soilsurveys.com.au

Brisbane, Level 2, 19 Finchley Street, Milton, QLD, 4064
Gold Coast, Unit 8, 140 Millaroo Drive, Helensvale, QLD 4212



SOIL SURVEYS ENGINEERING PTY LIMITED
A.C.N. 054 043 631
Consulting Geotechnical Engineers

Drawn BI	Project:	Certification Of Earthwork	Drawing No. 2-11753-03	A4
Date May 2017	Location:	Stage Two (A-E) and Three (A-G), The Surrounds		
Checked CS	Client:	Villawood Developments		



Soil Surveys Engineering Pty Limited
Specialists in Applied Geotechnics
A.B.N. 70 054 043 631

www.soilsurveys.com.au

Principals

PJ Dixon
NT Perkins
MV Geale
GEJ Gray
CP Johnson

BE(Hons) RPEQ
BAppSc(AppGeol) BEng(Hons1) RPEQ
BEng(Civil) MBA CPEng MIE Aust RPEQ
BEng(Civil) RPEQ

Gold Coast Office

Job No: 214-11753

Ref: Controlled Filling - Lot 2122

Author: Curtis Skinner

15 May 2017

Villawood Developments

Country Club Drive

Helensvale QLD 4212

Email: michaelw@villawoodproperties.com

**RE: CONTROLLED FILLING – LOT 2122
THE SURROUNDS – STAGE TWO – 2A – 2E**

Fill was placed on this lot during the construction of this estate.

Soil Surveys Engineering Pty Ltd was commissioned on this project to provide earthworks inspection and testing services in general accordance with AS 3798-2007 "Guidelines on earthworks for commercial and residential developments". Full details of the inspection and testing program are provided in the Soil Surveys Engineering report (ref 2-11753, 2017-05-04, BR VER 1).

Based on the inspection and testing services carried out by Soils Surveys Engineering Pty Limited, it is considered that the fill placed at Lot 2122 of The Surrounds – Stage Two – as shown on all attached plans, has been carried out in a responsible manner and in accordance with table 5.1.1 AS 3798 and the project specifications.

All fill in the areas defined in the attached lot location plan, within the time frame of our inspection and testing program between 16/08/2016 and 12/05/2017 (excluding topsoil placed subsequent to completion of controlled filling) is considered to be "controlled fill" in accordance with AS 2870 "Residential Slabs and Footings" (Clause 6.4.2 (a)) and AS 3798.

Unless otherwise stated, this earthworks assessment does not address any other geotechnical issues which may be relevant to building construction and serviceability.

A full geotechnical site investigation/site classification and foundation design should be carried out by suitably qualified and experienced personnel for the proposed residential construction.

SOIL SURVEYS ENGINEERING PTY LIMITED

Attached: Drawing Showing Location of Lot

Celebrating over 40 years in Geotechnics

Ph +617 3369 6000 Fax +617 3369 6660

PO Box 317, Milton, QLD, 4064, Australia

info@soilsurveys.com.au

Brisbane, Level 2, 19 Finchley Street, Milton, QLD, 4064
Gold Coast, Unit 8, 140 Millaroo Drive, Helensvale, QLD 4212



SOIL SURVEYS ENGINEERING PTY LIMITED
A.C.N. 054 043 631
Consulting Geotechnical Engineers

Drawn BI	Project:	Certification Of Earthwork	Drawing No. 2-11753-03	A4
Date May 2017	Location:	Stage Two (A-E) and Three (A-G), The Surrounds		
Checked CS	Client:	Villawood Developments		



Soil Surveys Engineering Pty Limited
Specialists in Applied Geotechnics
A.B.N. 70 054 043 631

www.soilsurveys.com.au

Principals

PJ Dixon
NT Perkins
MV Geale
GEJ Gray
CP Johnson

BE(Hons) RPEQ
BAppSc(AppGeol) BEng(Hons1) RPEQ
BEng(Civil) MBA CPEng MIE Aust RPEQ
BEng(Civil) RPEQ

Gold Coast Office

Job No: 214-11753

Ref: Controlled Filling - Lot 2123

Author: Curtis Skinner

15 May 2017

Villawood Developments

Country Club Drive

Helensvale QLD 4212

Email: michaelw@villawoodproperties.com

**RE: CONTROLLED FILLING – LOT 2123
THE SURROUNDS – STAGE TWO – 2A – 2E**

Fill was placed on this lot during the construction of this estate.

Soil Surveys Engineering Pty Ltd was commissioned on this project to provide earthworks inspection and testing services in general accordance with AS 3798-2007 "Guidelines on earthworks for commercial and residential developments". Full details of the inspection and testing program are provided in the Soil Surveys Engineering report (ref 2-11753, 2017-05-04, BR VER 1).

Based on the inspection and testing services carried out by Soils Surveys Engineering Pty Limited, it is considered that the fill placed at Lot 2123 of The Surrounds – Stage Two – as shown on all attached plans, has been carried out in a responsible manner and in accordance with table 5.1.1 AS 3798 and the project specifications.

All fill in the areas defined in the attached lot location plan, within the time frame of our inspection and testing program between 16/08/2016 and 12/05/2017 (excluding topsoil placed subsequent to completion of controlled filling) is considered to be "controlled fill" in accordance with AS 2870 "Residential Slabs and Footings" (Clause 6.4.2 (a)) and AS 3798.

Unless otherwise stated, this earthworks assessment does not address any other geotechnical issues which may be relevant to building construction and serviceability.

A full geotechnical site investigation/site classification and foundation design should be carried out by suitably qualified and experienced personnel for the proposed residential construction.

SOIL SURVEYS ENGINEERING PTY LIMITED

Attached: Drawing Showing Location of Lot

Celebrating over 40 years in Geotechnics

Ph +617 3369 6000 Fax +617 3369 6660

PO Box 317, Milton, QLD, 4064, Australia

info@soilsurveys.com.au

Brisbane, Level 2, 19 Finchley Street, Milton, QLD, 4064
Gold Coast, Unit 8, 140 Millaroo Drive, Helensvale, QLD 4212



SOIL SURVEYS ENGINEERING PTY LIMITED
A.C.N. 054 043 631
Consulting Geotechnical Engineers

Drawn BI	Project:	Certification Of Earthwork	Drawing No. 2-11753-03	A4
Date May 2017	Location:	Stage Two (A-E) and Three (A-G), The Surrounds		
Checked CS	Client:	Villawood Developments		