

SERVICES OFFSETS AND LOCATIONS

STREET NAME	Rd RESERVE	WATER		SEWER RISING MAIN	GAS	ELECTRICITY		FIBRE TO THE HOME		Bk. of KERB	JOINT TRENCHING
		DW	NDW			CABLES	POLES	FTTH CABLES	FTTH PITS		
RAINWATER ROAD (North of Splash Way)	18.00	3.15 E	2.70 E	1.80 E	2.25 E	4.80 E	1.00 BOK	3.75 E	3.75 E	1.85 W 7.60 E	G/DW/NDW & FTTH/E
RAINWATER ROAD (South of Splash Way)	18.00	4.35 E	3.90 E	3.00 E	3.45 E	5.50 E	1.00 BOK	4.95 E	4.95 E	1.85 W 7.60 E	G/DW/NDW & FTTH/E
BROOKWATER PARADE (Lot 530)	18.00	3.20 N	2.70 N	1.55 N	2.25 N	3.35 S	1.00 BOK	1.80 S	1.80 N	5.05	G/DW/NDW & FTTH/E
BROOKWATER PARADE (Lots 525-529)	18.00	3.20 N	2.70 N	1.55 N	2.25 N	3.40 S	1.00 BOK	1.80 S	1.80 N	5.05	G/DW/NDW & FTTH/E
SPRINGLANDS STREET	18.00	3.20 N	2.70 N	1.55 N	2.25 N	3.50 S	1.00 BOK	1.80 S	1.80 N	5.05	G/DW/NDW & FTTH/E
SPLASH WAY	16.00	2.95 S	2.50 S	1.55 S	2.10 S	2.20 N	1.00 BOK	1.00 N	1.80 S	4.20 S 3.90 N	G/DW/NDW & FTTH/E
SUSTAIN CIRCUIT	16.00	2.95 S	2.50 S	1.55 S	2.10 S	2.20 N	1.00 BOK	1.00 N	1.80 S	4.20 S 3.90 N	G/DW/NDW & FTTH/E

SHT. No.	VER	DRAWING INDEX
		DESCRIPTION
1	A	LAYOUT PLAN AND DETAILS - SHEET 1
2	A	LAYOUT PLAN AND DETAILS - SHEET 2
3	A	NOTES AND TYPICAL CROSS SECTIONS
4	A	INTERSECTION DETAILS - SHEET 1
5	A	INTERSECTION DETAILS - SHEET 2
6	A	RAINWATER DRIVE - LONGITUDINAL & CROSS SECTIONS
7	A	RAINWATER DRIVE - LONGITUDINAL & CROSS SECTIONS
8	A	BROOKWATER PARADE - LONGITUDINAL & CROSS SECTIONS
9	A	SPRINGLANDS STREET - LONGITUDINAL & CROSS SECTIONS
10	A	SPLASH WAY - LONGITUDINAL & CROSS SECTIONS
11	A	SUSTAIN DRIVE - LONGITUDINAL & CROSS SECTIONS
12	A	DRAINAGE LONGITUDINAL SECTIONS - SHEET 1
13	A	DRAINAGE LONGITUDINAL SECTIONS - SHEET 2
14	A	DRAINAGE LONGITUDINAL SECTIONS - SHEET 3
15	A	DRAINAGE LONGITUDINAL SECTIONS - SHEET 4
16	A	SIGNAGE AND LINEMARKING PLAN

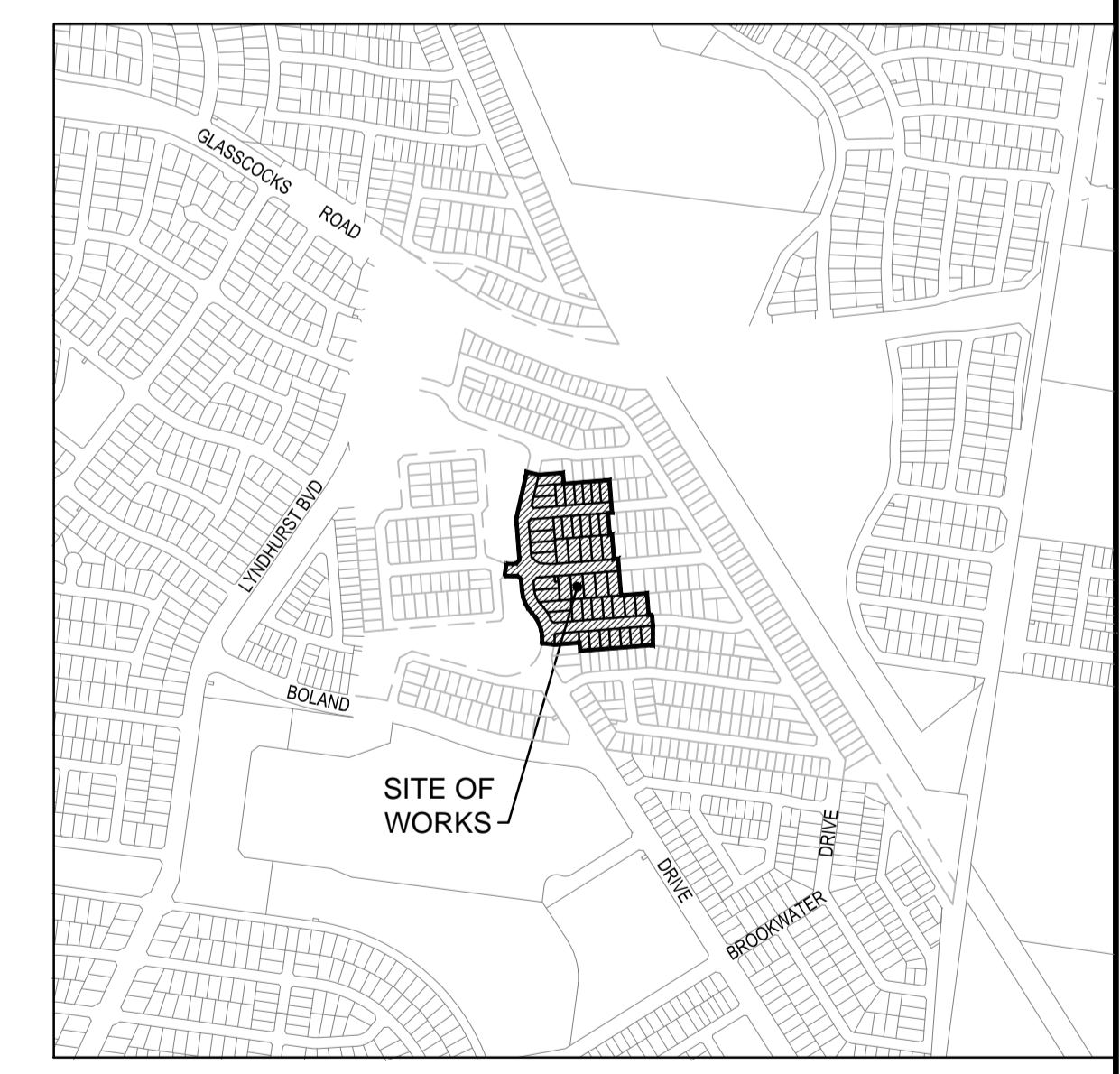

PLAN 1500

LEGEND	
PROP DRAINAGE	LOT FALL
EXIST DRAINAGE	LOT LEVEL - F.S. / EXIST
DRAINAGE PIT/DIA./FLOW	F.S. AT BUILDING LINE
PROPERTY INLET	TOP / TOE OF BATTER
HOUSE DRAIN	KERBING TYPE
RETAINING WALL DRAIN	LOT Bdy CHAINAGE
PROP/EX/FUT SEWER	LOTS EASEMENT
PROP/EX/FUT WATER	STREET SIGN
PROP/EX/FUT 100mm CONDUIT	LINEMARKING
PROP RETAINING WALL	DRIVEWAY
EXIST RETAINING WALL	PSM
EXIST HP OR OIL	REMOVE EXIST TREE
EXIST TELECOMS	
100Φ IRRIGATION CONDUIT	
FILL - PROP / EXIST	
CUT - PROP / EXIST	

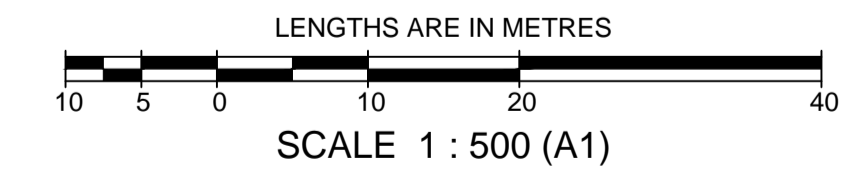

ATTENTION TO CONTRACTOR

- IT IS THE CONTRACTORS RESPONSIBILITY TO ENSURE THAT THE DIGITAL PLAN, PROVIDED FOR SETOUT PURPOSES, MATCHES THE TBM COORDINATES SHOWN.
- CONTRACTOR TO ENSURE THAT THE SITE IS PEGGED AND OR SET OUT CHECKED BY THE LICENCED SURVEYOR RESPONSIBLE FOR CERTIFYING THE PLAN OF SUBDIVISION PRIOR TO UNDERGROUND INFRASTRUCTURE BEING INSTALLED.
- WHERE CONCRETE WORKS ABOUT A SEWER ACCESS CHAMBER SURROUND OR SIMILAR STRUCTURE, AN EXPANSION JOINT OF APPROVED MATERIAL SHALL BE PROVIDED BETWEEN THE TWO FACES.



WARNING
BEWARE OF UNDERGROUND SERVICES
THE LOCATIONS OF UNDERGROUND SERVICES ARE APPROXIMATE ONLY AND THEIR EXACT POSITION SHOULD BE PROVEN ON SITE. NO GUARANTEE IS GIVEN THAT ALL EXISTING SERVICES ARE SHOWN.

		1/19 cafo street hawthorn east, 3123 telephone 8823 2300 fax no. 8823 2310	
MELWAY REF 129-C6 SURVEY BPD DESIGN DRAWN CHECKED		AQUAREVO ESTATE STAGE 5 LAYOUT PLAN AND DETAILS	
MUNICIPALITY CASEY		REFERENCE 8766 E/05	
SCALE As Shown DATUM AHD DATE July'18		SHEET 1 OF 16 A	

T:\Projects\1338\Plan\1338_Plan_1500.dwg (1338_Plan_1500.dwg) 13/07/2018 10:00:00 AM

FOR CONTINUATION SEE SHEET 1

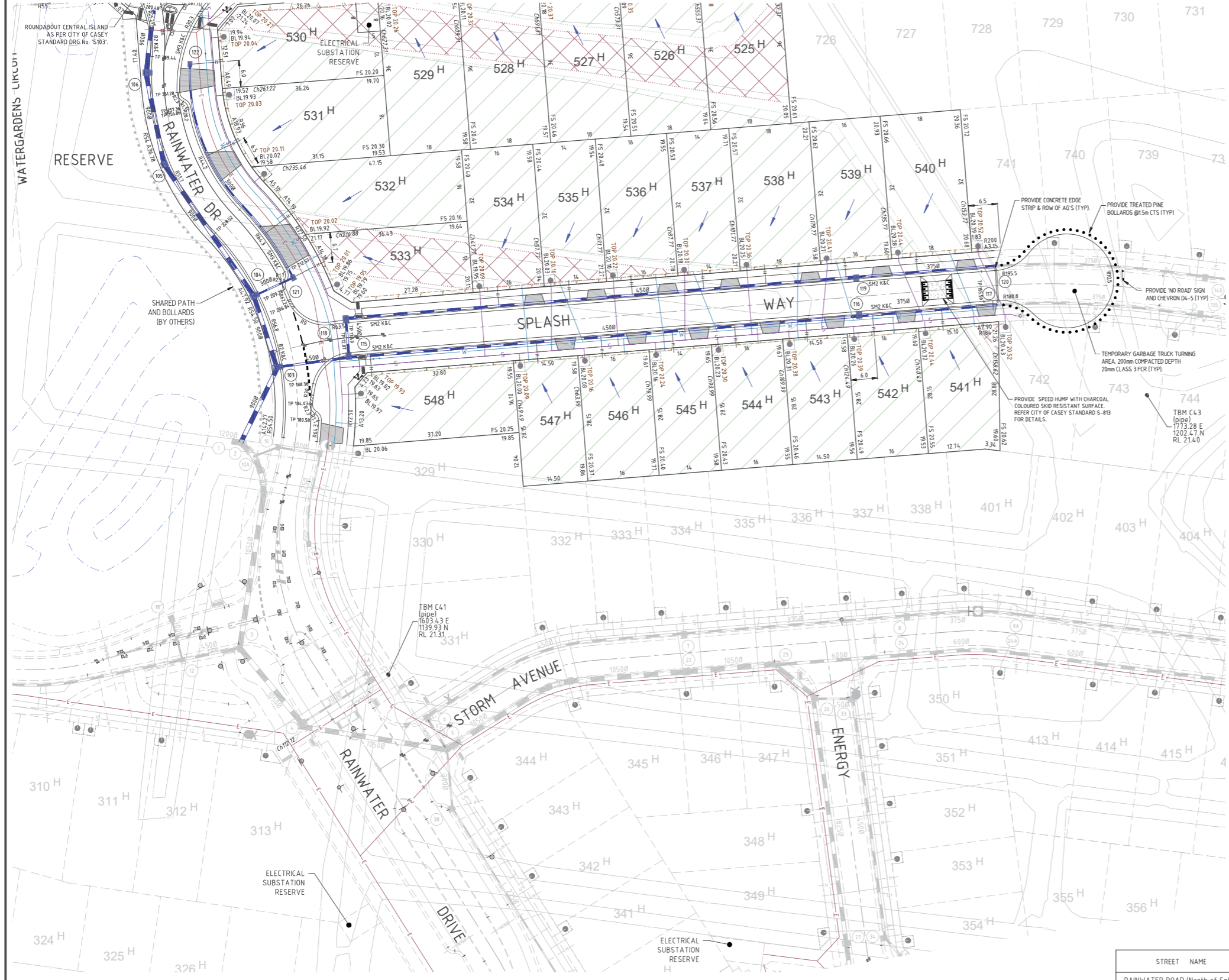

PLAN
1:500

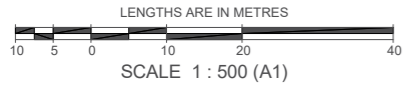

WARNING
BEWARE OF UNDERGROUND SERVICES
THE LOCATIONS OF UNDERGROUND SERVICES ARE APPROXIMATE ONLY AND THEIR EXACT POSITION SHOULD BE PROVEN ON SITE. NO GUARANTEE IS GIVEN THAT ALL EXISTING SERVICES ARE SHOWN.

LEGEND	
PROP DRAINAGE	LOT FALL
EXIST DRAINAGE	LOT LEVEL - F.S. / EXIST
DRAINAGE PIT/DIA./FLOW	F.S. AT BUILDING LINE
PROPERTY INLET	TOP / TOE OF BATTER
HOUSE DRAIN	KERBING TYPE
RETAINING WALL DRAIN	LOT BDY CHAINAGE
PROP/EX/FUT SEWER	LOTS EASEMENT
PROP/EX/FUT WATER	STREET SIGN
PROP/EX/FUT 100mm CONDUIT	LINEMARKING
PROP RETAINING WALL	DRIVEWAY
EXIST RETAINING WALL	PSM
EXIST HP OIL	REMOVE EXIST TREE
EXIST TELECOMS	
100Ø IRRIGATION CONDUIT	
FILL - PROP / EXIST	
CUT - PROP / EXIST	

SERVICES OFFSETS AND LOCATIONS

STREET NAME	Rd/RESERVE	WATER		SEWER RISING MAIN	GAS	ELECTRICITY		FIBRE TO THE HOME		Bk. of KERB	JOINT TRENCHING
		DW	NDW			CABLES	POLES	FTTH CABLES	FTTH PITS		
RAINWATER ROAD (North of Splash Way)	18.00	3.15 E	2.70 E	1.80 E	2.25 E	4.80 E	1.00 BOK	3.75 E	3.75 E	1.85 W 7.60 E	G/DW/NDW & FTTH/E
RAINWATER ROAD (South of Splash Way)	18.00	4.35 E	3.90 E	3.00 E	3.45 E	5.50 E	1.00 BOK	4.95 E	4.95 E	1.85 W 7.60 E	G/DW/NDW & FTTH/E
BROOKWATER PARADE (Lot 530)	18.00	3.20 N	2.70 N	1.55 N	2.25 N	3.35 S	1.00 BOK	1.80 S	1.80 N	5.05	G/DW/NDW & FTTH/E
BROOKWATER PARADE (Lots 525-529)	18.00	3.20 N	2.70 N	1.55 N	2.25 N	3.40 S	1.00 BOK	1.80 S	1.80 N	5.05	G/DW/NDW & FTTH/E
SPRINGLANDS STREET	18.00	3.20 N	2.70 N	1.55 N	2.25 N	3.50 S	1.00 BOK	1.80 S	1.80 N	5.05	G/DW/NDW & FTTH/E
SPLASH WAY	16.00	2.95 S	2.50 S	1.55 S	2.10 S	2.20 N	1.00 BOK	1.00 N	1.80 S	4.20 S 3.90 N	G/DW/NDW & FTTH/E
SUNFAST CIRCUIT	16.00	2.95 S	2.50 S	1.55 S	2.10 S	2.20 N	1.00 BOK	1.00 N	1.80 S	4.20 S 3.90 N	G/DW/NDW & FTTH/E

ATTENTION TO CONTRACTOR

- IT IS THE CONTRACTORS RESPONSIBILITY TO ENSURE THAT THE DIGITAL PLAN, PROVIDED FOR SETOUT PURPOSES, MATCHES THE TBM COORDINATES SHOWN.
- CONTRACTOR TO ENSURE THAT THE SITE IS PEGGED AND OR SET OUT CHECKED BY THE LICENCED SURVEYOR RESPONSIBLE FOR CERTIFYING THE PLAN OF SUBDIVISION PRIOR TO UNDERGROUND INFRASTRUCTURE BEING INSTALLED.
- WHERE CONCRETE WORKS ABOUT A SEWER ACCESS CHAMBER SURROUND OR SIMILAR STRUCTURE, AN EXPANSION JOINT OF APPROVED MATERIAL SHALL BE PROVIDED BETWEEN THE TWO FACES.

breese pitt dixon pty. ltd.
land surveyors civil engineers

1/19 cafo street
hawthorn east, 3123
telephone 8823 2300
fax no. 8823 2310

MELWAY REF: 129-C6	AQUAREVO ESTATE STAGE 5	MUNICIPALITY: CASEY
SURVEY: BPD		REFERENCE: 8766 E/05
DESIGN:	LAYOUT PLAN AND DETAILS	
DRAWN:		
CHECKED:	SCALE: As Shown	DATUM: AHD
DATE:	DATE: July'18	SHEET: 2 OF 16

T:\Projects\23081\Drawings\8766_Aquarevo\PLAN\Subdiv\8766_BPD_01.dwg (01/07/18) 11:00:00 AM